

ORIGINAL



A Touchstone Energy® Cooperative 

FILED
OFFICE OF THE
SECRETARY
2004 OCT 27 A 11:07
FEDERAL ENERGY
REGULATORY COMMISSION

October 25, 2004

Ms. Magalie Roman Salas, Secretary
Federal Energy Regulatory Commission
Mail Code: DTCA, HL 21.3
888 First Street, N.E.
Washington, D.C. 20426

FERC Project No. 1981

Dear Secretary Salas:

As per the Order Issuing New License for the Stiles Hydroelectric Project (FERC Project No. 1981) dated February 26, 2003, Oconto Electric Cooperative (OEC) is enclosing documentation of the recently completed Exotic Species Control Plan for 2004, required in Article 407 of the License.

The Exotic Species Control Plan specifically addresses purple loosestrife (*Lythrum salicaria*.) A copy of the plan is attached as Exhibit I.

OEC conducted the survey similar to the 2003 project. Brochures outlining the elimination of purple loosestrife were secured from Laura Felda-Marquardt of the Wisconsin Department of Natural Resources (WDNR). Judie Gowaski and Sharon Seidel of the Machickanee Advancement Association (MAA), the property owners' association around the flowage, were contacted and they agreed to once again conduct the shoreline survey of the flowage. The Wisconsin Wetlands Association (WWA) provided data sheets for use during the survey. It was agreed that OEC and MAA would cooperate in the survey work and that upon completion of the survey, results would be provided to the WWA as well as to FERC and the DNR.

The purpose of the survey is to identify and quantify possible colonies of purple loosestrife. If colonies of 1-5 plants are found on OEC owned land, removal or treatment is required. If colonies are found on private land, OEC is responsible for contacting the property owners and encouraging them to remove and destroy the plants.

On August 16, 2004 Sharon Seidel and Judie Gowaski of the MAA conducted a survey by water of the shoreline of the Machickanee Flowage. They located a few small colonies of the plant and were able to identify the property owners on whose land the purple loosestrife was found. The surveyors noted locations on a map and indicated the GPS coordinates for the plants they discovered. Their survey sheets are included as Exhibit II (a) and their map is Exhibit II (b).

On September 17, 2004 Kent Lyng of OEC conducted a shore survey of the 14 acres of land owned by OEC. Exhibit III (a) is a copy of the survey data sheet and Exhibit III (b) is a copy the map that together indicate the occurrences of purple loosestrife on OEC owned land. The

surveyor noted GPS coordinates for the locations of the plants. Also recorded on the survey sheet are the treatment measures that were taken to eliminate the purple loosestrife colonies. OEC sent a letter to each of ten property owners around the Machickanee Flowage on whose land purple loosestrife was found. A copy of the letter is included as Exhibit IV. Each letter contained a brochure provided by the WDNR describing purple loosestrife and methods of controlling it. Exhibit V is a copy of the cover of the information brochure. Several dozen copies of this brochure were also provided to the MAA for distribution at its annual meeting on September 25, 2004.

An article addressing the need to remove purple loosestrife colonies was published in the Oconto County Times-Herald and the Oconto County Reporter. A copy of the article is included as Exhibit VI. In addition, OEC's local editor of the WEC News (a statewide electric cooperative magazine) published an article in the October 2004 issue featuring the purple loosestrife survey conducted by the MAA. The article is included as Exhibit VII. As another item within the scope of the Exotic Species Control Plan, signs will be posted at recreational areas owned by OEC as those facilities are developed in other Articles of the Order Issuing New License.

If you have questions about this report, please contact Kent Lyng, OEC's Vice President of Engineering, at (920) 846-2816.

Sincerely,

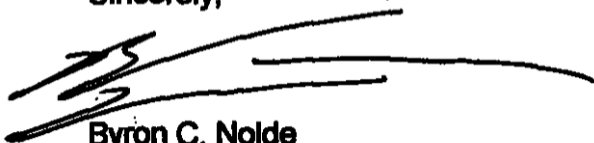

Byron C. Nolde
Chief Executive Officer

Attachments

Eight (8) Copies to FERC

**CC: Coordinator-FERC Projects, Wisconsin Department of Natural Resources
Janet Smith, U.S. Fish & Wildlife Service
Judie Gowaski, President-Machickanee Advancement Association**

Exotic Species Control Plan

General Guidelines

Oconto Electric Cooperative (OEC), along with appropriate local groups and resource agencies, will continually work to control/eliminate exotic species, such as purple loosestrife, Eurasian milfoil and zebra mussels, in the project area. The project area is defined as those lands owned by OEC and the shoreline observable from the flowage. Although OEC will be responsible for coordinating efforts to control and eliminate exotics occurring on its own property, it is limited to supplying information to neighboring property owners.

When exotics are classified and identified by local or state authorities, OEC will proceed with a plan to monitor the identified species. The plan elements include: 1) method of monitoring, 2) frequency of monitoring, 3) documentation of transmission of monitoring data to the Wisconsin Department of Natural Resources (WDNR), U. S. Fish & Wildlife Service (USFWS), and the Machickanee Flowage Advancement Association (MFAA), 4) procedures for obtaining technical assistance and input from the WDNR, or other appropriate agencies, and 5) specific information on how OEC will cooperate with the agencies to control/eliminate the exotic species.

Along with the plan, OEC will include documentation of consultation, copies of comments and recommendations on the completed plan after it has been provided to the agencies, and descriptions of how the agencies' comments are accommodated by the plan. OEC will allow thirty (30) days for the agencies to comment and make recommendations before filing the plan with the Federal Energy Regulatory Commission (FERC). If OEC does not adopt a recommendation, the filing will include OEC's reasons based on project-specific information.

Oconto Electric Cooperative will post signs at recreation facilities on its property describing identified exotic species and informing the public on the control of the species. OEC will distribute fact sheets provided by the WDNR, or other appropriate agencies, at the project.

Purple Loosestrife (*Lythrum salicaria*) Plan

OEC shall, in consultation with the MFAA, the WDNR, and the USFWS, monitor purple loosestrife (*Lythrum salicaria*) in specified project areas. The project lands, reservoir area, and ¼ mile downstream from the project will be surveyed by OEC during peak flowering stage, being mid July/mid August of each year. OEC will estimate and map the amount of infestation of purple loosestrife.

If small colonies of purple loosestrife consisting of 1-5 plants are found on OEC-owned land, OEC will remove it and all of its roots, or cut and then spray it with an appropriate aquatic herbicide. Larger colonies will be removed after consultation with the resource agencies. If purple loosestrife is found on lands NOT owned by OEC, then OEC, in conjunction with the MFAA, will contact the property owner and encourage the owner to remove the plants.

Oconto Electric Cooperative will post signs at recreation facilities on its property describing purple loosestrife and informing the public on the control of this plant. OEC will distribute fact sheets provided by the WDNR, or other appropriate agencies, at the project.

After survey results are compiled and any remedial actions are taken, a report detailing such results and actions will be submitted by OEC to the MFAA, WDNR, and USFWS, with a copy to FERC by October 31 of each year.

Eurasian Milfoil

There is no plan to monitor or map Eurasian milfoil in the Machickanee Flowage because of its prolific presence throughout the flowage. The MFAA, in cooperation with the WDNR and other groups, has been attempting for years to eradicate this exotic species. OEC agrees that Eurasian milfoil is undesirable. If any agency or group devises a cost-effective plan to control/eradicate this species, OEC will cooperate with that plan.

Purple Loosestrife Survey Data Sheet

Time spent surveying: 3 hrs, Page 1 of 2

Survey date: 8/16/04	County: Oconto	Name(s) of waterbody(ies): Machickane Flouage
Volunteer: Judie Gouski	Address: 6104 Dogwood Ln, Oconto WI 54153	Phone/e-mail: (920) 826-5358
Volunteer: Sharon Seidel	Address: 4919 Machickane Ln, Lena WI 54139	Phone/e-mail: (920) 848-3697
Volunteer:	Address:	Phone/e-mail:

Exhibit II(a)

SAMPLE

Site #	Number of plants			Acreage (1 acre = 1 football field)		Density of PL plants		Galerucella beetles		NOTES
	1-10	11-49	50+	Less than 1 acre	More than 1 acre	Sparse	Very dense	Leaf damage	Gal. beetles	
11		X		X			X	X		At site of river, all of them are empty. Saw several larvae, no beetles.
1	X			X		X				44°57.58N 088°03.69W (Stone's Prop.)
2	X			X		X				In Cove, by bridge City, E. of Culvert
3	X			X		X				City E. of Dam Sign 100', in riprap
4	X			X		X				44°57.69N 088°03.47W - at dock
5	X			X		X				Just west of DEC fence on shore
6		X		X		X				44°57.38N 088°03.47W - Between
										dock + home, both sides of both of
										their docks + 2 places in cove (gingler)
										west of DeBaker dock
7	X			X		X				44°57.24N 088°03.67W - In cattails
8		X			X	X				by point on Berendt prop. - east +
										west of dock + along shore, several
										places
9	X			X		X				44°57.12N 088°03.75W - W. of Berendt +

east of dock w/roolshed on shore

RH Wise
4947 Spira Ln.

Mail this data sheet and your map to
WWA, Purple Loosestrife Survey Data, 222 South Hamilton Street, Suite 1, Madison, Wisconsin 53703

Page 2 of 2

Survey date:	County:	Name(s) of waterbody(ies):
Volunteer: <i>Jacdie Gociasty</i>	Address:	Phone/e-mail:
Volunteer: <i>Sharon Seidel</i>	Address:	Phone/e-mail:
Volunteer:	Address:	Phone/e-mail:

Site #	Number of plants			Acreage (1 acre = 1 football field)		Density of PL. plants		Galerucella beetles		NOTES
	1-10	11-49	50+	Less than 1 acre	More than 1 acre	Sparse	Very dense	Leaf damage	Gal. beetles	
77		X		X			X	X		W side of river, N of Hwy 94 bridge. Saw several larvae, no beetles.
10	X			X		X				44°57.15N 088.03.87W - E. of Ness prop.
11	X			X		X				44°57.14N 088.03.91W - Between Ness and Brown properties
12	X			X		X				44°52.85N 088.04.86W - Ninebark
13	X			X		X				Both sides of 2 docks 0350 Birchwood
14	X			X		X				44°50.88N 088.04.88W - In cove off Ninebark
15	X			X		X				44°57.23N 088.05.70W - E. of canoe
16	X			X		X				Access end of Birchwood Shores
										44°57.22N 088.06.07W - by Beaver Lodge
										44°5.29N 088.05.14W - In everglades
										In water-off Kalish property

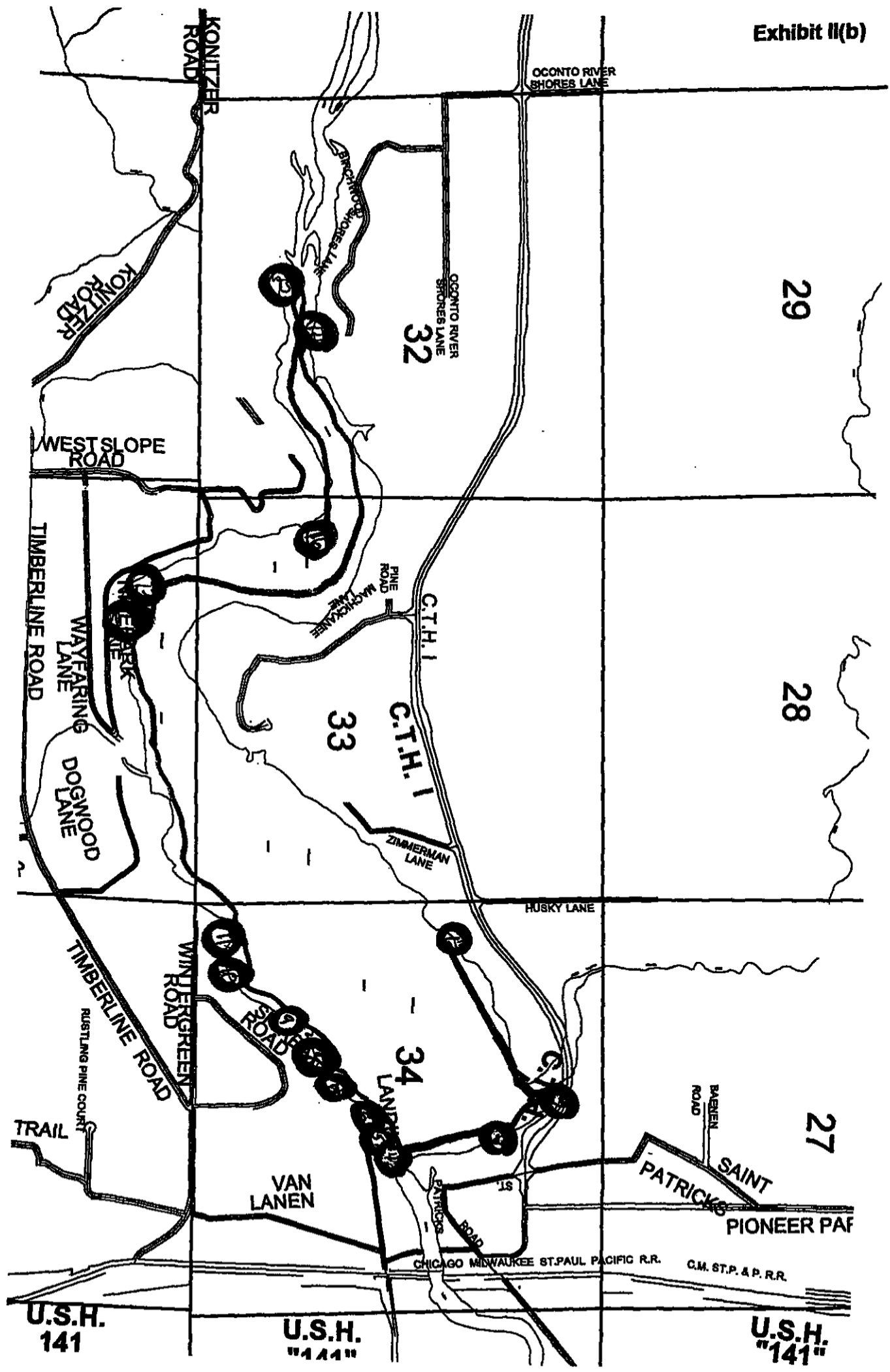

Purple Loosestripe Survey Data SheetTime spent surveying: 2 hours Page 1 of 1

Survey date: <u>9/17/09</u>	County: <u>Oconto</u>	Name(s) of waterbody(ies): <u>Machikane Flowage</u>
Volunteer: <u>Kent Lyns</u>	Address: <u>Oconto Electric Cooperative</u>	Phone/e-mail: <u>920-846-2816</u>
Volunteer: <u>Cooperative</u>	Address: <u>7479 RER Road, Oconto Falls WI 54154</u>	Phone/e-mail: <u></u>
Volunteer: <u></u>	Address: <u></u>	Phone/e-mail: <u></u>

Site #	Number of plants			Acreage (1 acre = 1 football field)		Density of PL plants		Galernucella beetles		NOTES
	1-10	11-49	50+	Less than 1 acre	More than 1 acre	Sparse	Very dense	Leaf damage	Gal. beetles	
17		X		X			X	X		W side of river, N of Hwy 67 bridge. Saw several flowers in bushes.
1	X			X		X				44° 51.41'N 88° 03.33'W
										West side of covey head landing dock
										cut stems and treated to kill roots
2	X			X		X				44° 51.42'N 88° 03.28'W
										between Oconto Electric fence & County dock
										cut stems and treated to kill roots
3			X	X			X			44° 51.69'N 88° 03.33'W
										downstream side of dike
										cut flower heads on mature plants
										many plants without flowers.

SAMPLE

Mail this data sheet and your map to

WWA, Purple Loosestripe Survey Data, 222 South Hamilton Street, Suite 1, Madison, Wisconsin 53703

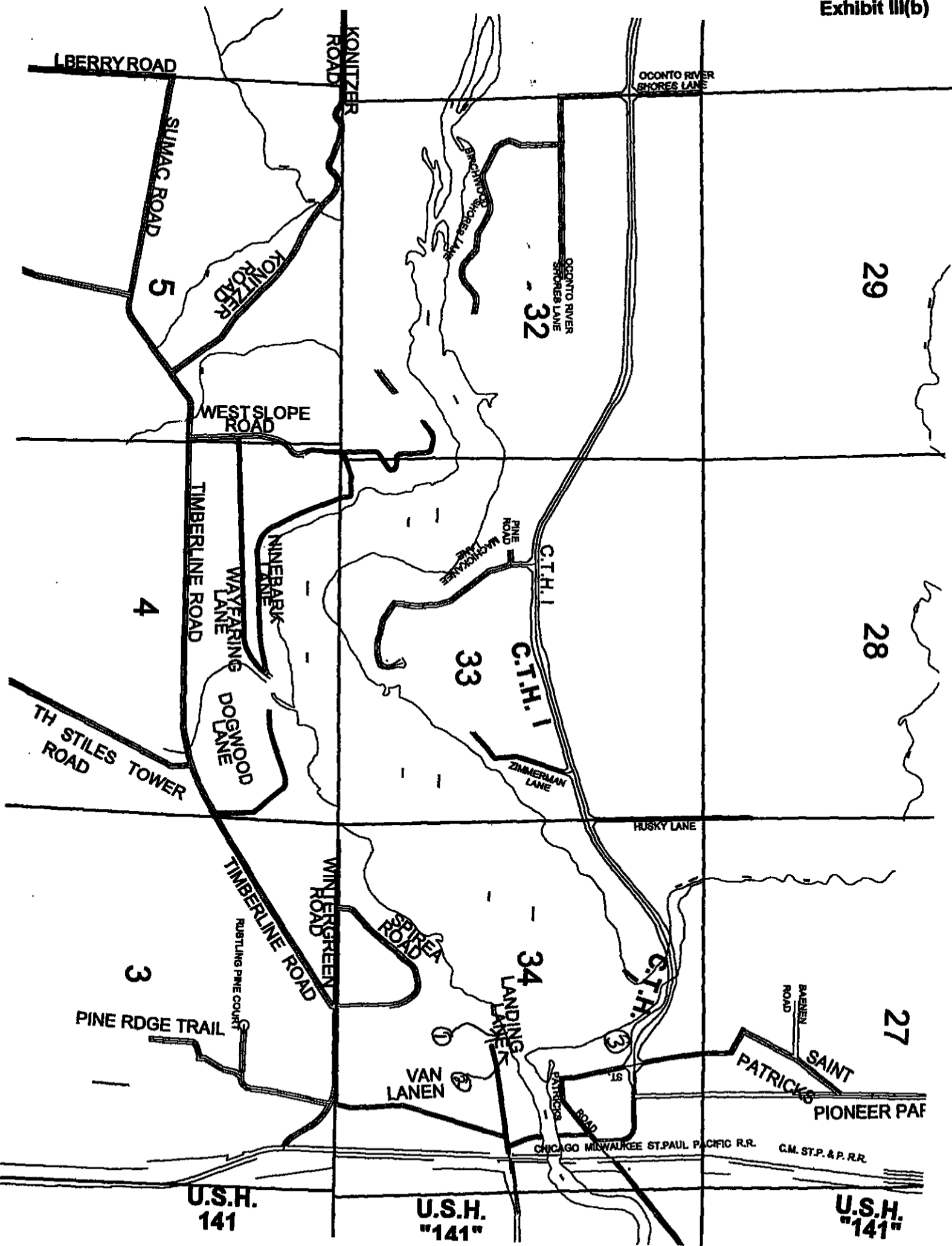



September 17, 2004

Ms. Penny Zander
4987 Spirea Lane
Oconto, WI 54153

Dear Penny:

As you know, Oconto Electric Cooperative (OEC) owns and operates the hydroelectric facility on the Machickanee Flowage. One of the license requirements for the facility is to monitor the environment in the area of the flowage for certain exotic plant species. On behalf of Oconto Electric Cooperative, volunteers from the Machickanee Advancement Association (MAA) recently conducted a purple loosestrife survey along the shoreline of the flowage. Results of their survey indicate that purple loosestrife is growing on or near the shoreline of your property.

Even though purple loosestrife has a beautiful, showy flower, the plant is an exotic species that causes harm to native vegetation, thereby affecting the food source for many aquatic animal species. Because of its invasive characteristics, it is necessary to attempt to eliminate the occurrences of this plant before it gets an even stronger hold in the Machickanee Flowage area.

OEC, in conjunction with the MAA, respectfully requests that you check your shoreline for purple loosestrife and make an effort to remove it. Enclosed is a booklet that describes ways to remove the plant to minimize chances for the plant to propagate.

Thank you for your help in this very important effort to enhance a healthy natural environment around the Machickanee Flowage. We know that your efforts will be appreciated by all who value a sound aquatic habitat around the Machickanee Flowage.

Sincerely,

Jan Stranz
VP - Member Services Director

Kent Lyng
VP - Engineering

Enclosure

THE ECOLOGICAL PROBLEM

Purple loosestrife is an attractive wetland perennial plant from Europe and Asia that was introduced to North America without the specialized insects and diseases that keep it in check in its native lands. Freed from its natural controls, purple loosestrife grows taller and faster than our native wetland plants. These advantages and prolific seed production have allowed it to invade many Wisconsin wetlands to the near total exclusion of most other vegetation. Once established, it literally shades everything else out. Loosestrife has spread rapidly in Wisconsin over the last 20 to 30 years.

FOR MORE INFORMATION :

On invasive species, including purple loosestrife, access the Department of Natural Resources web site (search for purple loosestrife) at:

www.dnr.wi.gov/org/caer/ce/invasives

Contact your region's WDNR Aquatic Plant Management Coordinator for herbicide permits. For purple loosestrife biocontrol information contact the Wisconsin Purple Loosestrife Biocontrol Program at: 1350 Femrite Dr., Monona WI 53716, (608) 221-6349, or email: brock.woods@dnr.state.wi.us

DNR-PUB-WT-799-2004

PURPLE Loosestrife

(*Lythrum salicaria* & *Lythrum virgatum*)



**A MAJOR THREAT TO
WISCONSIN'S WETLANDS
AND WATERWAYS**

Oconto Electric monitors invasive vegetation along Flowage

Oconto Electric Cooperative (OEC), an electric utility serving Oconto, Marinette, Shawano and Menominee counties, owns and operates the Stiles hydroelectric facility. As part of their license, Oconto Electric is required to monitor the Purple Loosestrife growth around the Machickance Flowage.

Purple Loosestrife is a very pretty weed. It was originally brought to this country from Europe in the 1890's as an ornamental and medicinal plant. Unlike Europe and Asia, where it originated, there is no natural enemy of the plant in North America to keep it in check. The result is that it multiplies very quickly and causes natural vegetation to die out.

The attractive purple plant grows mainly in wetlands, but can also adapt quickly to drier areas. Each root produces 30-50 stems and 3 to 5 million seeds annually. Not only does it overtake all natural vegetation, but also many wetland bird species do not like Purple Loosestrife and will leave an area that has too much of this weed.

As the owner of the hydroelectric dam at Stiles, it is the responsibility of OEC to eliminate any Purple Loosestrife that is growing on their property and to monitor the growth along the rest of the flowage. The Machickance Advancement Association has gone out the last two years and mapped the Purple Loosestrife plants along the water's edge. (The number of plants found nearly doubled from one year to the next.) Oconto Electric then sends letters to the property owners encouraging them to properly dispose of the plants found on their property. Machickance Advancement Association President, Julie Gowaski, states, "The flowage that we all enjoy so much is here because of Oconto Electric. The invasion of Purple Loosestrife should concern everyone along the flowage so it makes sense that our Association helps with this project."

If anyone would like more information about Purple Loosestrife and how to properly dispose of it, contact OEC Vice President of Member Services, Jan Stranz, at 800-472-8410.

Oconto Electric Monitors Invasive Vegetation Along Flowage

OCONTO FALLS - Oconto Electric Cooperative (OEC), an electric utility serving Oconto, Marinette, Shawano and Menominee counties, owns and operates the Stiles hydroelectric facility. As part of their license, Oconto Electric is required to monitor the Purple Loosestrife growth around the Machickance Flowage.

Purple Loosestrife is a very pretty weed. It was originally brought to this country from Europe in the 1890's as an ornamental and medicinal plant. Unlike Europe and Asia, where it originated, there is no natural enemy of the plant in North America to keep it in check. The result is that it multiplies very quickly and causes natural vegetation to die out.

The attractive purple plant grows mainly in wetlands but can also adapt quickly to drier areas. Each root produces 30-50 stems and 3 to 5 million seeds annually. Not only does it overtake all natural vegetation, but also many wetland bird species do not like purple loosestrife and will leave an area that has too much of this weed.

As the owner of the hydro-

electric dam at Stiles, it is the responsibility of OEC to eliminate any purple loosestrife that is growing on their property and to monitor the growth along the rest of the flowage. The Machickance Advancement Association has gone out the last two years and mapped the purple loosestrife plants along the water's edge. (The number of plants found nearly doubled from one year to the next.) Oconto Electric then sends letters to the property owners encouraging them to properly dispose of the plants found on their property. Machickance Advancement Association President, Julie Gowaski, states, "The flowage that we all enjoy so much is here because of Oconto Electric. The invasion of purple loosestrife should concern everyone along the flowage so it makes sense that our Association helps with this project."

If anyone would like more information about Purple Loosestrife and how to properly dispose of it, contact OEC Vice President of Member Services, Jan Stranz, at 800-472-8410.

Oconto Electric Cooperative

Policing Purple Loosestrife



As part of our hydroelectric license, Oconto Electric is required to monitor the Purple Loosestrife growth around the Machickanee Flowage.

Purple Loosestrife is a very pretty weed. As a matter of fact, one of the reasons we have Purple Loosestrife in this country is because it was brought over from Europe in the 1800s as an ornamental and medicinal plant. The problem is that it multiplies very quickly and causes natural vegetation to die out.

This attractive purple plant grows mainly in wetlands but can also adapt quickly to drier areas. Each root produces 30 to 50 stems and 3 to 5 million seeds annually. Not only is all natural vegetation overtaken by Purple Loosestrife, but also many wetland bird species do not like the weed and will leave an area that has too much of it.

Since OEC owns the hydroelectric dam at Stiles, it is our responsibility to eliminate any Purple

Loosestrife that is growing on our property and to monitor the growth along the rest of the flowage. The Machickanee Advancement Associa-



President of the Machickanee Advancement Association Judie Gowaski looks for Purple Loosestrife along the banks of the Machickanee Flowage.

tion has gone out the last two years and mapped the Purple Loosestrife plants along the water's edge. (The number of plants found nearly doubled from one year to the next.) Oconto Electric then sends letters to the property owners encouraging them to properly dispose of the plants found on their property. Machickanee Advancement Association President Judie Gowaski states, "The flowage that we all enjoy so much is here because of Oconto Electric. The invasion of Purple Loosestrife should concern everyone along the flowage, so it makes sense that our Association helps with this project."

If anyone would like more information about Purple Loosestrife and how to properly dispose of it, contact OEC Vice President of Member Services Jan Stranz at 800-472-8410. ■

Hidden Account Numbers

Oconto Electric Cooperative hides two account numbers in the local pages of the *Wisconsin Energy Cooperative News* each month. If you spot your account number, call our office before you receive the next issue, and OEC will give you a \$15 credit on your electric bill or a \$25 credit if you have a load management receiver on your water heater. The September account numbers belonged to Oconto Catholic Cemetary and Mark St. Louis, Coleman. ■

REAL ESTATE

WISCONSIN REAL ESTATE.ORG: Green Bay real estate.net, Milwaukee real estate.net, Madison real estate.org, hunting real estate.net, Wisconsin farm.com. Global network, global exposure. You don't need a computer to advertize on the Internet. Toll free 877/655-1544.

OTTER CREEK LOG WORKS HANDCRAFTED DOVE-TAIL KNOTCHED PINE LOG CABINS AND SAUNAS. Mike Falls, 715-658-1936. 24 years log building experience.

CABIN FEVER? Best medicine is Birch Lake Getaway near Tomah. Luxurious lakeside vacation homes with fireplaces, hot tubs, satellite TV. Classy! 608-374-3150.

SELLING OR BUYING REAL ESTATE? Call us for all your real estate needs including legal representation, document drafting, title insurance, closings, construction draws, refinances, tax-deferred exchanges. Prompt, courteous, professional. Kammer & Studinski, Chartered, Portage, WI. 608-742-3234.

TRAVEL & CAMPING

HUNT THE WORLD.COM: Pheasant hunt.com, elk hunts.com, mule deer hunts.com, fish walleyes.com, Wisconsin hunt.com, Wisconsin guides.net. 1500+ web sites. Global network, global exposure. You don't need a computer to advertize on the Internet. Toll free 877/655-1544.

EMPLOYMENT & BUSINESS

100 WORKERS NEEDED—Assemble crafts, wood items. Materials provided. To \$480+ wk. Free info pkg. 24 hr. 801-428-4879.

CASH FOR OWNER FINANCED MORTGAGE AND BUSINESS NOTES, DEEDS OF TRUST, LAND CONTRACTS. Call Marcia 608-269-7957 or toll free 877-834-2014.

HOME-BASED BUSINESS: no selling, no inventory, no risk, profit sharing \$\$\$ each month, not an MLM, "Inc-500" company, 608-269-7957, <http://livingwell.yourfamilyfirst.com>.

INC 500 INTERNATIONAL CHRISTIAN BASED HEALTHY LIVING TECHNOLOGIES COMPANY. Looking for managers and dealers. P/T or F/T working from home. 1-888-447-5335.

FREE HEARING CATALOG!

• 45 DAY TRIAL
• \$199 & UP
BETTER HEARING

DEPT B34, Brookport, IL 62910
1-800-320-3300 EXT B34



KENTUCKY STEEL TRUSS BUILDINGS
2070
FREE CATALOGUE
1-859-745-0606
www.kstbuild.com

24' x 30' x 8' \$ 3,503
30' x 36' x 8' \$ 4,903
40' x 48' x 10' \$ 7,203
50' x 60' x 12' \$ 11,203
60' x 70' x 12' \$ 15,703
75' x 80' x 14' \$ 21,603

AMERICA'S BEST BUY



FARM • CHURCH • SPORTS • HORSE • CAR • PLANE
ALL STEEL • ALL COLOR • 25/50 WARRANTY

DR® BRUSH MOWERS...

LARGEST SAVINGS of the Year!

Our Largest-of-the-Year "OFF-SEASON" Savings and extended risk-free trial are available for a very limited time!
Call, write, or visit us online TODAY!

This fall with the DR® FIELD and BRUSH MOWER you can —

- **CLEAR & MAINTAIN** meadows, pastures, roadsides, fencelines walking paths with ease!
- **CUT** tall grass, weeds, brush, brambles — even saplings up to 2-1/2" thick!
- **CHOP/MULCH** most everything you cut!
- **USE IT UNTIL NEXT SUMMER — RISK-FREE!** Because it's now the off-season, we're extending our normal 6-month Risk-Free Trial until July 1, 2005!

Please mail coupon or call TOLL FREE for complete FREE DETAILS!

www.drfieldbrush.com

NOW 20% OFF!

1-800-218-5454

YES! Please send me your FREE Catalog and Video about the new DR® FIELD and BRUSH MOWER, including models, powered attachments, LARGEST-of-the-Year Factory-Direct Savings now in effect, plus how I can try one out Risk-Free until July 1, 2005!

Name _____ WRC
Address _____
City _____ State _____ ZIP _____
E-mail _____



COUNTRY HOME PRODUCTS®, Dept. 49100X
Meigs Road, P.O. Box 25, Vergennes, VT 05491



Walters Buildings



SUBURBAN
AGRICULTURAL
COMMERCIAL
EQUESTRIAN

SERVING WISCONSIN FOR OVER 45 YEARS!

- Strong Warranty
- Dependable Service
- Professional Construction Crews

1-800-558-7800

WWW.WALTERSBUILDINGS.COM

NORWOOD INDUSTRIES INC.

LumberMate 2000

From \$3,895.

Personal Sawmill

1-800-661-7746 Ext 332
www.norwoodindustries.com

HERITAGE BUILDING SYSTEMS®

Established 1979

800-643-5555

WE SHIP ANYWHERE IN THE USA!

24' x 30' x 10'	\$4,990
40' x 50' x 10'	\$9,450
50' x 60' x 12'	\$13,890
60' x 100' x 12'	\$25,900

For 25 years, Heritage has been the low price leader. Any size is available featuring easy bolt up rigid frame design for industry, office, mini-storage, shop, farm and All Steel Homes. Call us today for a free information package and quote on the best buildings made. Codes and options may affect prices.

Visit Heritage Online at
www.heritagebuildings.com