

Appendix A. Trout Stream Classification Checklist (revised 2/2016)

(This completed checklist should accompany any trout stream classification changes. Check the items as appropriate and attach comments if desired.)

Stream name: Danuser Creek

(if stream is known by another name please list both names with the more common name first)

County: Buffalo WBIC: 1812000

Define the portion of the stream to be classified. Please provide both a written description and the coordinate locations of the upstream and downstream beginning and end points.

Danuser Creek is a 7.0 mile tributary of Waumandee Creek that originates in Sec. 15, T22NR10W, Buffalo Co. The Class II trout water flows from the origin generally south and then west for 7.0 miles to its mouth at Waumandee Creek in Sec. 36, T22NR11W, Buffalo Co.

This written description should reference permanent, unambiguous landmarks that would allow a person unfamiliar with the area to locate the points (e.g., dams, road crossings, stream confluences, county lines, section lines, township lines)

Please provide coordinate locations in one of three formats:

Longitude/Latitude (Degrees, Minutes, Seconds): 89° 41' 28.7" W , 44° 55' 14.0" N

Longitude/Latitude (Decimal Degrees): -89.691332, 44.920576

WTM91 (easting and northing in meters): 544361, 494173

Upstream point coordinates: 44.3875, -91.5751

Downstream point coordinates: 44.3454, -91.6664

Classification proposed Class II

☒ Fish survey (including relative abundance, length distribution, and age structure) and habitat survey completed on water to be classified. Survey on file at Black River Falls (office location)

☒ Fish team supervisor and district fisheries supervisor have approved the classification.
Date 09/05/2018 (Hujik) 09/19/2018 (Benike)

☒ Fish Biologist has consulted with the following staff in their office or district

☒ Permit Drafter Name 1,2 Date 09/05&06/2018 Concerns No

☒ Water Resource Specialist Name 3 Date 09/05/2018 Concerns No

☒ Water Management Specialist Name 4 Date 09/06/2018 Concerns No

☒ Drinking and Groundwater staff Name 5 Date 09/16/2018 Concerns No

X Public notice published in local newspaper or other media. Date 09/13,20/2018

X Notice sent to all clerks of the county, town, city, or village in which the stream is located.
Date 09/06/2018

Trout Stream Classification Checklist (revised 8/2013) - Continued

X Notice sent to legislators in the affected districts. Date 09/06/2018

X Notice sent to chairpersons of legislative committees with jurisdiction for natural resources
issues. Date 09/06/2018

IP No hearing requested 30 days after public notice.

IP Hearing requested, held, and classification recommended. Date _____

Signed: David C. Hallett Date: 09/26/18
Fisheries Biologist

Approved: Hen Ball Date: 9-25-18
Fish Team Supervisor

Robert H. Hujik Date: 9-25-18
District Fisheries Supervisor

- 1 - Jason Gazdecki, Stormwater Specialist
- 2 - Stacey Carlson, Water Management Specialist
- 3 - Camille Bruhn
- 4 - David Hon
- 5 - Adam Freihoefer

Brook Trout Length Frequency-Danuser Creek,2017.

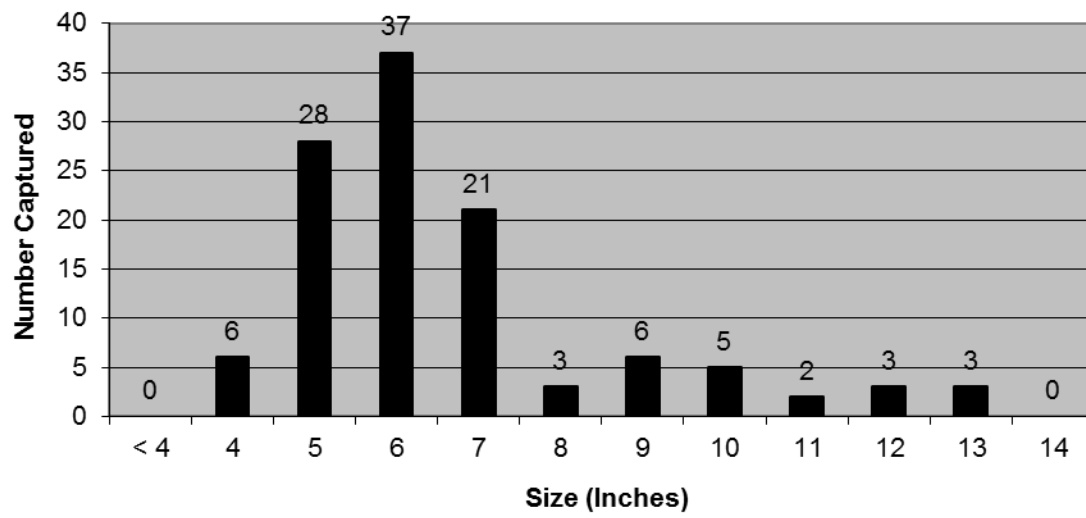
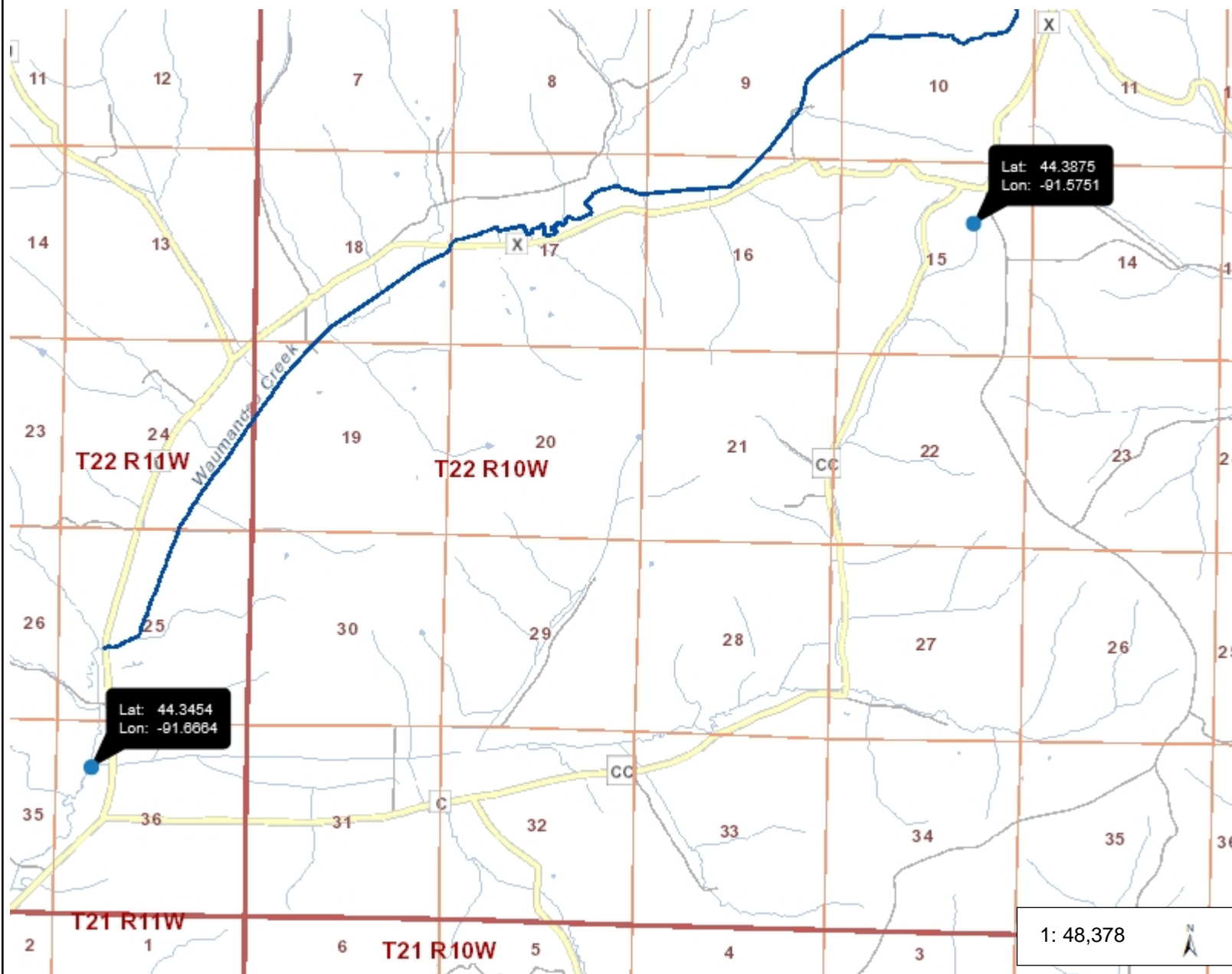



Exhibit A. Danuser Creek (WBIC 1812000), Buffalo County Current Classification and Proposed Class II Boundaries



Legend

- Trout Stream Lines
 - Class 1
 - Class 2
 - Class 3
- Trout Spring Ponds
- Township
- Section
- Major Roads
 - Interstates
 - US Highways
 - State Highways
- Rivers and Streams
- Open Water
- Airports

Notes

Blue Dots indicate upper and lower boundary of proposed Class II trout water. Total length = 7.0 miles. Stream is not currently classified as trout water.

1.5 0 0.76 1.5 Miles

NAD_1983_HARN_Wisconsin_TM
© Latitude Geographics Group Ltd.

DISCLAIMER: The information shown on these maps has been obtained from various sources, and are of varying age, reliability and resolution. These maps are not intended to be used for navigation, nor are these maps an authoritative source of information about legal land ownership or public access. No warranty, expressed or implied, is made regarding accuracy, applicability for a particular use, completeness, or legality of the information depicted on this map. For more information, see the DNR Legal Notices web page: <http://dnr.wi.gov/org/legal/>

Public Notice – Danuser Creek, Buffalo County, WI
Date

Pursuant to NR 1.02(7)(c), Wis. Adm. Code, the Department of Natural Resources gives public notice of the classification of the entire length, 7 miles, of Danuser Creek, in Buffalo County as a Class II Trout water.

Danuser Creek is a 7.0 mile tributary of Waumandee Creek that originates in Sec. 15, T22NR10W, Buffalo County, and flows generally south and then west to its mouth at Waumandee Creek in Sec. 36, T22NR11W, Buffalo County.

This classification is based upon a survey which indicates this portion of stream contains a population of brook trout made up of one or more age groups, above the age of one year, in sufficient numbers to indicate substantial survival from one year to the next, and has some natural reproduction occurring; however, stocking is necessary to fully utilize the available trout habitat and sustain the fishery.

The Department shall waive any hearing requirement on this classification unless a written request for hearing is received within 30 days after publication of this public notice. Requests should be sent to Daniel C. Hatleli, Fish Biologist, 910 Highway 54 East, Black River Falls, WI 54615.

WBIC # 1812000