

**The following site is being submitted for inclusion into the GIS registry:**

- For DNR County and Region list go to:  
g:\pf\pecfa\site\gis\BRRTS County and Region Codes.xls
- To begin, click on cell to the right of; *This is a:*
- Use Tab, ↓ or Pg Down to navigate form. Print & include with file when completed.

This is a:	pdf File Update
BRRTS ID (no dashes):	0336100462
Comm # (no dashes):	54220481137
County:	Manitowoc
Region:	Northeast
Site name:	Manitowoc Brake
Street Address:	1037 S 26th St
City:	Manitowoc
Final Closure Date	2001-12-26
Closure Conditions:	met
Off-source property contamination? (If yes, attach locational data and deed information on pg. 2)	No
Right-of-way contamination?	Yes
Contaminated media:	Groundwater
GPS Coordinates (meters in the <b>WTM91</b> projection)	
Easting (X):	705740.000000000
Northing (Y):	404207.000000000
Collection Method:	Direct Location
Scale or Resolution:	1:08,000
(1:24,000 scale or finer)	("1:" and comma is default)
Prepared by:	Cheryl Nelson
Submitted by:	Cheryl Nelson

Source Property Checklist

- Final Closure Letter
- Copy of the most recent deed, which includes legal description for all properties w/ GW > NR 140 ES
- Where the legal description in the deed(s) refers to a certified survey map or recorded plat map, include those documents
- Parcel ID for all properties w/ GW > NR 140 ES
- General Location Map
- Detailed Location Map showing property boundaries, buildings, MW(s) and/or potable wells etc for properties with GW > NR140 ES
- Latest Map(s) showing extent or outline of current GW plume (isoconcentrations)
- Map showing GW flow direction
- Latest Table of GW results
- Geologic cross section (if generated as part of the site investigation)
- Statement signed by RP certifying correctness of legal descriptions
- Updated Database



December 26, 2001

Mr. Richard Peltier  
1037 South 26<sup>th</sup> Street  
Manitowoc, WI 54220

RE: **Case Closure Approved**

**Commerce #54220-4811-37A** WDNR BRRTS #03-36-100462  
Manitowoc Brake, 1037 South 26<sup>th</sup> Street, Manitowoc

One 4,000-gallon unleaded gasoline UST  
One 6,000-gallon unleaded gasoline UST  
One 4,000-gallon leaded gasoline UST  
One 4,000-gallon diesel UST  
One 550-gallon kerosene UST  
One 550-gallon waste oil UST

Dear Mr. Peltier:

The Wisconsin Department of Commerce (Department) Bureau of PECFA Site Review Section is in receipt of documentation that the conditions necessary for site closure detailed in the CONDITIONAL CASE CLOSURE letter, dated September 21, 2001 for Manitowoc Brake, 1037 South 26<sup>th</sup> Street, Manitowoc, have been met. The Department considers no further action is necessary and has updated our database to reflect this closure. The Department suggests that case documents for the site be maintained for future reference.

Thank you for your efforts in restoring Wisconsin's environment. If you have questions, please contact me at 920-424-0046.

Sincerely,

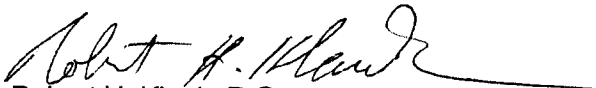

Robert H. Klauk, P.G.  
Hydrogeologist  
Site Review Section

cc: Bradd L. Seegers -- GHD, Inc.  
Case File



Document Number

NOTICE OF CONTAMINATION TO PROPERTY

RECEIPT\* 23384

\$13 00 MISC

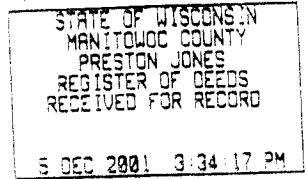

Legal Description of the Property: In re:

(as it appears on the most recent deed)

LOT 17 + 20' OF LOT 21 + ALL OF LOT 22 EXC. 126 SQ FT FOR HIWAY, BLK. I

ORIGINAL PLAT City of Manitowoc

Recording Area

Name and Return Address

MANITOWOC BRAKE Sem 1037 SO 2674 MANITOWOC WIS 54220 513 (A)

STATE OF WISCONSIN ) ) COUNTY OF ) ss

52-000-166-22000 Parcel Identification Number (PIN)

Section 1. Richard J. Pelletier is the owner of the above-described property.

Section 2. One or more petroleum discharges have occurred at this property. Documented diesel range organic contamination exceeding Wisconsin Administrative Code chapter NR 720 residual contaminant levels is present in the vicinity of the former north pump island on the property. Furthermore, naphthalene groundwater contamination exceeding Wisconsin Administrative Code chapter NR 140 enforcement standards is present on the property.

Section 3. The owner hereby declares that all of the property described above is held and shall be held, conveyed or encumbered, leased, rented, used, occupied and improved subject to the following limitations and/or restrictions:

Anyone who proposes to construct or reconstruct a well on this property is required to contact the Department of Natural Resources' Bureau of Drinking Water and Groundwater, or its successor agency, to determine what specific prohibitions or requirements are applicable, prior to constructing or reconstructing a well on this property. No well may be constructed or reconstructed on this property unless applicable requirements are met.

Residual petroleum contaminated soil remains on this site beneath the building. It has been shown that these levels are protective of health and the environment. If this contaminated soil is excavated in the future, it may be considered a solid waste and will need to be disposed in accordance with all applicable laws.

Any person who is or becomes owner of the property described above may request that the Wisconsin Department of Commerce, or its successor, issue a determination that the restrictions set forth in this covenant are no longer required.

That property owner shall provide any and all necessary information to the Department in order for the Department to be able to make a determination. Upon receipt of such a request, the Department shall determine whether or not the restrictions contained herein can be extinguished. Conditions under which a restriction may be extinguished will be determined in accordance with the site specific standards, rules and laws for this property. If the Department determines that the restrictions can be extinguished, an affidavit, with a copy of the Department's written determination, may be recorded to give notice that this restriction, or portions of this restriction are no longer binding. Any restriction placed upon this property shall not be extinguished without the Department's written determination.

IN WITNESS WHEREOF, the owner of the property has executed this document, this 3<sup>rd</sup> day of Dec, 2001.

[When appropriate use the following clause]:

By signing this document, [he/she] acknowledges that [he/she] is duly authorized to sign this document on behalf of \_\_\_\_\_.

Signature: Richard T Peltier

Printed Name: RICHARD T PELTIER

Title: OWNER

Subscribed and sworn to before me this 3 day of Dec., 2001.

Cef J Gamble Cheryl Gamble

Notary Public, State of Wisconsin

My commission - 6-1-03

This document was drafted by the Wisconsin Department of Commerce.



VCL 1587 PG 21

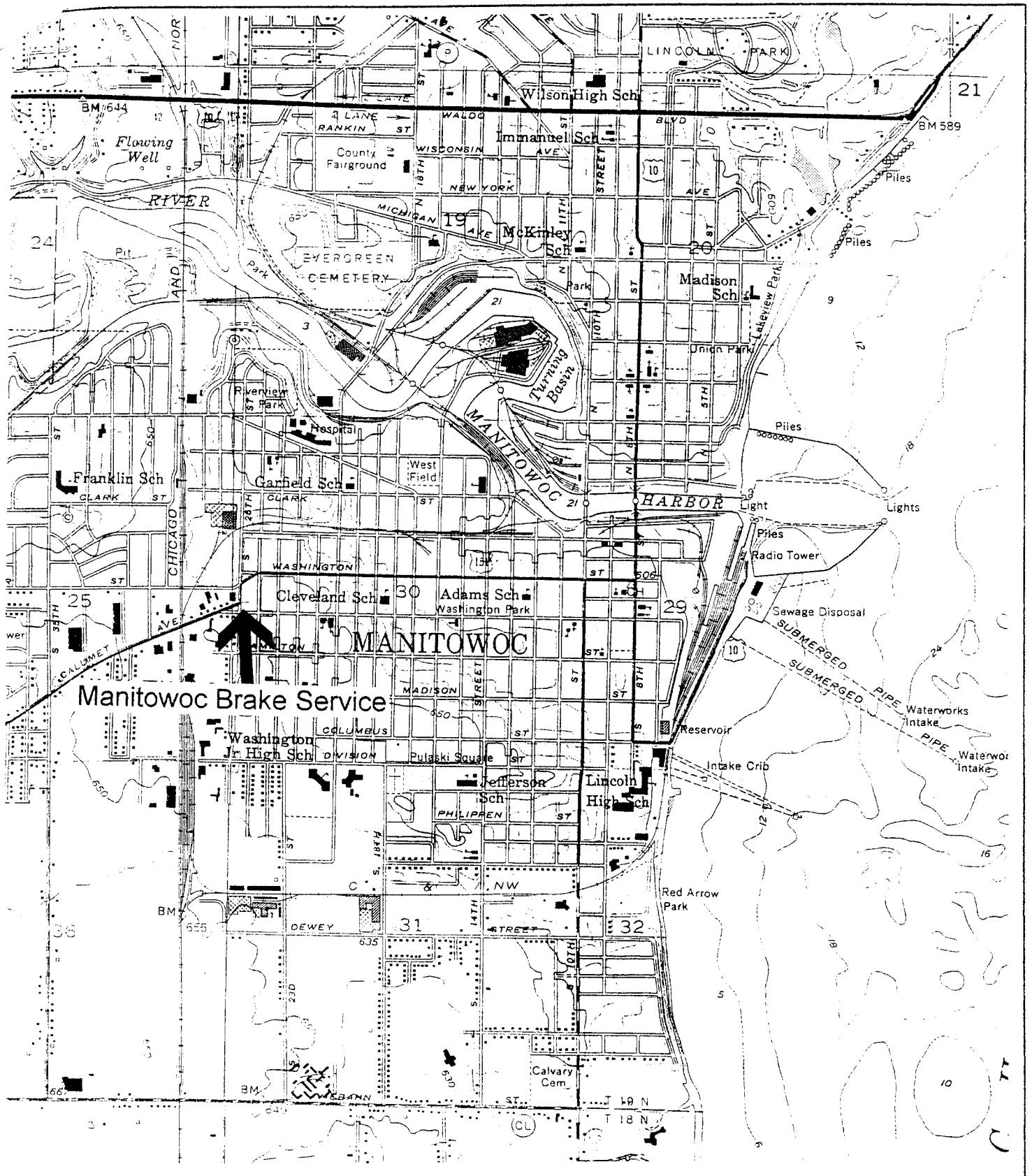

**Manitowoc Brake Service**

GHD Inc. Environmental Services  
 Manitowoc Brake Service  
 1037 South 26th Street  
 Manitowoc, WI 54220

**Figure 1**  
**Site Location Map**

Prepared By: RLJ      Date: 11/6/00

Map taken from Manitowoc  
 Quadrangle, USGS, 1973

Scale 1"=2000'



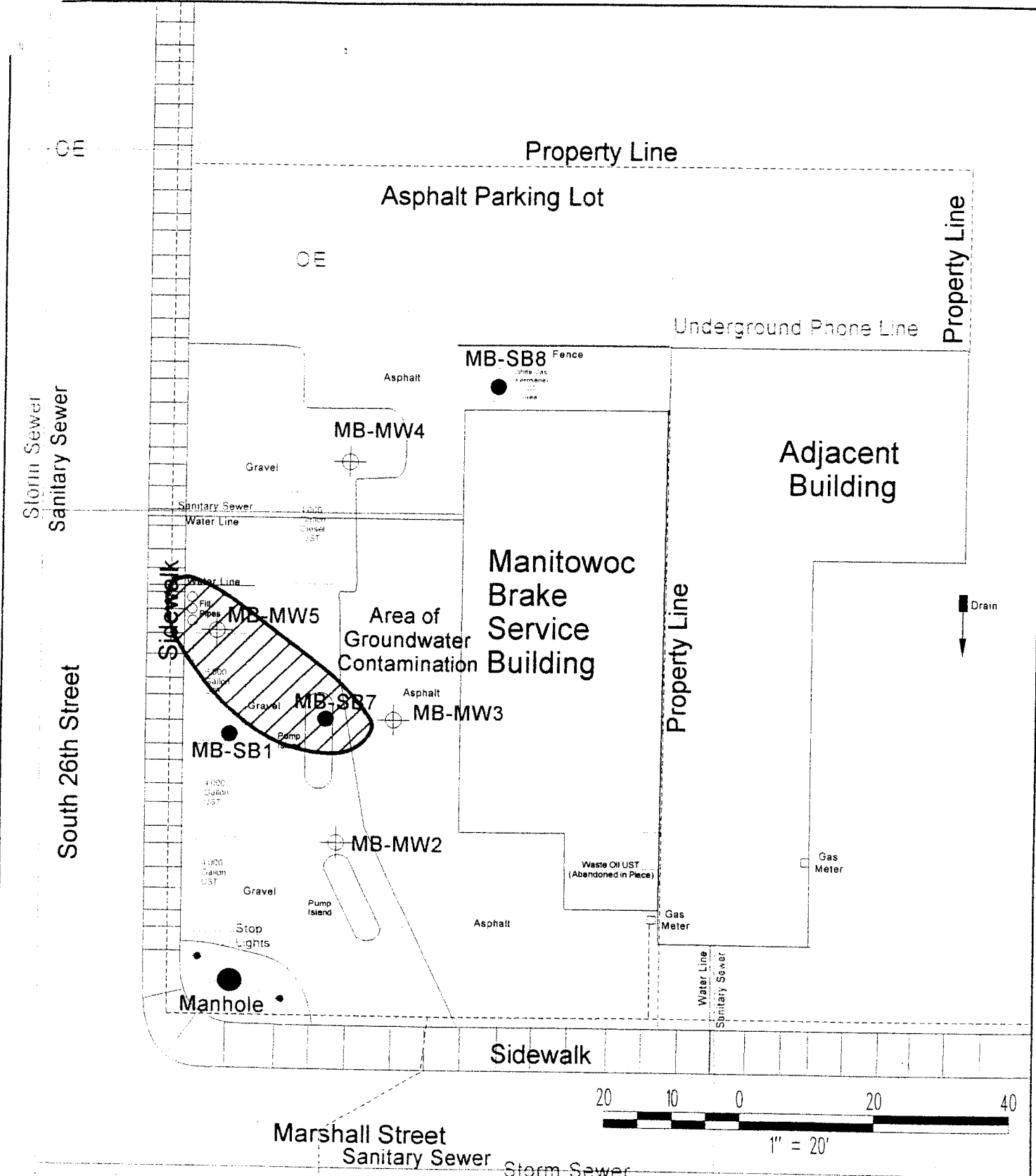

GHD Inc. Environmental Services  
 Manitowoc Brake Service  
 1037 South 26th Street  
 Manitowoc, WI 54220

**Figure 1**  
**Area of Groundwater Contamination**

Prepared By: RLJ Date: 09/14/01

- ⊕ Monitoring Well Location
- Soil Boring Locations



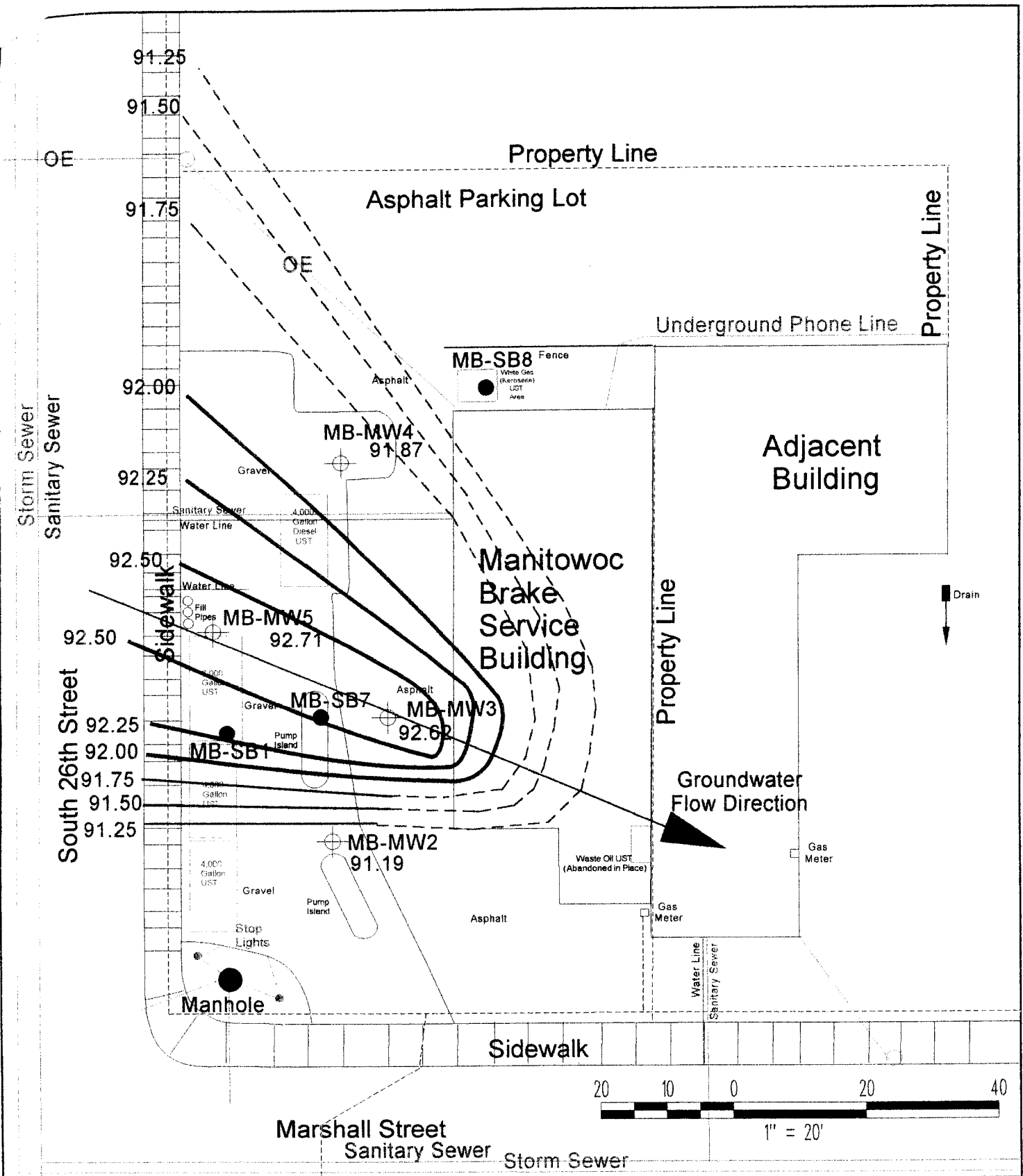

GHD Inc. Environmental Services  
 Manitowoc Brake Service  
 1037 South 26th Street  
 Manitowoc, WI 54220

**Figure 3**  
 Potentiometric Surface  
 on 8-27-01

Prepared By: RLJ Date: 09/14/01

- Monitoring Well Location
- Soil Boring Locations



Table 2  
 Groundwater Analytical Results  
 Manitowoc Brake Service - Manitowoc, Wisconsin  
 Long Term Monitoring - September 2001

PARAMETER	NR 140 ES / PAL Standards	MB-MW2			
		12/04/00	01/02/01	05/31/2001	08/27/2001
GRO (ppm)	none	< 0.015			
Dissolved Lead (ppm)	15 / 1.5	< 1.4			
Benzene	5 / 0.5	< 0.32	< 0.51	< 1.1	< 1.1
Ethylbenzene	700 / 140	< 0.14	< 0.51	< 1.2	< 1.2
Toluene	1,000 / 200	< 0.37	< 0.51	< 1.2	< 1.2
Total Trimethylbenzenes	480 / 96	< 0.14	< 0.54	< 1.2	< 1.2
Total Xylenes	10,000 / 1,000	< 0.71	< 1.2	< 2.6	< 2.6
Methyl tert-butyl Ether	60 / 12	< 0.29	< 1.0	< 1.2	< 1.2
Naphthalene	40 / 8	< 0.37	< 0.52		
1,2-Dichloroethane	5 / 0.5	< 0.14			
Total PVOCs	none	0.	0.	0.	0.
Total VOCs	none	0.	0.		
Nitrogen, ammonia as N	9.7 / 1.9 ppm	< 0.024	< 0.036		
Nitrogen N+N (mg/L)	10 / 2 ppm	6.1	2.		
Nitrogen, Kjeldahl (mg/L)	none	0.98	< 0.27 >		
Sulfate (mg/L)	none	32.	44.		
Alkalinity (mg/L)	none	260.	260.		
Iron (mg/L)	none	1.8	1.6		
Conductivity (uS)	none	810.	864.		835
pH (SU)	none		7.5		7.5
Dissolved Oxygen (mg/L)	none	3.71	3.66	3.71	1.26

Notes:  
 All results are reported in parts per billion (ppb) unless otherwise noted.  
 ppm stands for parts per million, GRO stands for Gasoline Range Organics  
 Results in BOLD exceed NR 140 ES or PALs for specified parameter.



Table 2  
 Groundwater Analytical Results  
 Manitowoc Brake Service - Manitowoc, Wisconsin  
 Long Term Monitoring - September 2001

PARAMETER	NR 140 ES / PAL Standards	MB-MW3			
		12/04/00	01/02/01	05/31/2001	08/27/2001
GRO (ppm)	none	< 0.15			
Dissolved Lead (ppm)	15 / 1.5	< 1.4			
Benzene	5 / 0.5	< 0.32	< 0.51	< 1.1	< 1.1
Ethylbenzene	700 / 140	< 0.14	< 0.51	< 1.2	< 1.2
Toluene	1,000 / 200	< 0.37	< 0.51	< 1.2	< 1.2
Total Trimethylbenzenes	480 / 96	< 0.14 >	< 0.54	< 1.2	< 1.2
Total Xylenes	10,000 / 2,000	< 0.15 >	< 1.2	< 2.6	< 2.6
Methyl tert-butyl Ether	60 / 12	< 0.29	< 1	< 1.2	< 1.2
Naphthalene	40 / 8	< 0.37	< 0.52		
1,2-Dichloroethane	5 / 0.5	< 0.14			
Total PVOCs	none	0.29	0	0	
Total VOCs	none	0.29	0		
Nitrogen, ammonia as N	9.7 / 1.9 ppm	< 0.024	< 0.034 >		
Nitrogen N+N (mg/L)	10 / 2 ppm	0.3	< 0.046 >		
Nitrogen, Kjeldahl (mg/L)	none	0.48	< 0.32 >		
Sulfate (mg/L)	none	120	120		
Alkalinity (mg/L)	none	270	320		
Iron (mg/L)	none	7.9	3		
Conductivity (uS)	none	1,090	989		1,010
pH (SU)	none		7.7		7.4
Dissolved Oxygen (mg/L)	none	2.61	2.84	0.85	1.03

Notes:  
 All results are reported in parts per billion (ppb) unless otherwise noted.  
 ppm stands for parts per million, GRO stands for Gasoline Range Organics  
 Results in BOLD exceed NR 140 ES or PALs for specified parameter.

Table 2  
Groundwater Analytical Results  
Manitowoc Brake Service - Manitowoc, Wisconsin  
Long Term Monitoring - September 2001

PARAMETER	NR 140 ES / PAL Standards	MB-MW4			
		12/04/00	01/02/01	05/31/2001	08/27/2001
GRO (ppm)	none	< 0.015			
DRO (ppm)	none	0.22			
Dissolved Lead (ppm)	15 / 1.5	< 1.4			
Benzene	5 / 0.5	< 0.32	< 0.51	< 1.1	< 1.1
Ethylbenzene	700 / 140	< 0.14	< 0.51	< 1.2	< 1.2
Toluene	1,000 / 200	< 0.37	< 0.51	< 1.2	< 1.2
Total Trimethylbenzenes	480 / 96	< 0.14	< 0.54	< 1.2	< 1.2
Total Xylenes	10,000 / 2,000	< 0.71	< 1.2	< 2.6	< 2.6
Methyl tert-butyl Ether	60 / 12	< 0.29	< 1	< 1.2	< 1.2
Naphthalene	40 / 8	< 0.37	< 0.52		
1,2-Dichloroethane	5 / 0.5	< 0.14			
Total PVOCs	none	0	0	0	0
Total VOCs	none	0	0		
Nitrogen, ammonia as N	9.7 / 1.9 ppm	< 0.024	< 0.024		
Nitrogen N+N (mg/L)	10 / 2 ppm	5.8	3.3		
Nitrogen, Kjeldahl (mg/L)	none	< 0.20 >	< 0.1		
Sulfate (mg/L)	none	22	29		
Alkalinity (mg/L)	none	280	300		
Iron (mg/L)	none	36	1.4		
Conductivity (uS)	none	653	622		648
pH (SU)	none		7.6		7.5
Dissolved Oxygen (mg/L)	none	2.49	2.37	4.64	3.84

Notes:  
All results are reported in parts per billion (ppb) unless otherwise noted.  
ppm stands for parts per million, GRO stands for Gasoline Range Organics  
Results in BOLD exceed NR 140 ES or PALs for specified parameter.

Table 2  
 Groundwater Analytical Results  
 Manitowoc Brake Service - Manitowoc, Wisconsin  
 Long Term Monitoring - September 2001

PARAMETER	NR 140 ES / PAL Standards	MB-MW5			
		12/04/00	01/02/01	05/31/2001	08/27/2001
GRO (ppm)	none	4.4			
Dissolved Lead (ppm)	15 / 1.5	< 2.9	>		
Benzene	5 / 0.5	< 16	< 10	< 23	< 45
Ethylbenzene	700 / 140	31.	< 10	100.	[80]
Toluene	1,000 / 200	92.	< 10	< 23	< 46
Total Trimethylbenzenes	480 / 96	<b>540.</b>	<b>96.</b>	429.	350.
Total Xylenes	10,000 / 2,000	1,560.	350.	670.	640.
Methyl tert-butyl Ether	60 / 12	< 15	< 20	< 23	< 46
Naphthalene	40 / 8	<b>96.</b>	< 10	<b>94.</b>	<b>84.</b>
1,2-Dichloroethane	5 / 0.5	< 7.0			
Total PVOCs	none	2,223.	446.	1,199.	1,070.
Total VOCs	none	2,319.	446.	1,293.	1,154.
Nitrogen, ammonia as N	9.7 / 1.9 ppm	0.12	0.26		
Nitrogen N+N (mg/L)	10 / 2 ppm	< 0.044	>	< 0.024	
Nitrogen, Kjeldahl (mg/L)	none	1.4	1.7		
Sulfate (mg/L)	none	28.	26.		
Alkalinity (mg/L)	none	550.	520.		
Iron (mg/L)	none	22.	12.		
Conductivity (uS)	none	1,320.	1,204.		1,183.
pH (SU)	none		7.1		7.3
Dissolved Oxygen (mg/L)	none	1.91	0.76	0.71	0.70

Notes:  
 All results are reported in parts per billion (ppb) unless otherwise noted.  
 ppm stands for parts per million, GRO stands for Gasoline Range Organics  
 Results in BOLD exceed NR 140 ES or PALs for specified parameter.