

# GIS REGISTRY

## Cover Sheet

March, 2010  
(RR 5367)

### Source Property Information

BRRTS #: 03-32-120909

ACTIVITY NAME: LINDVIG AUTO & TRUCK REPAIR

PROPERTY ADDRESS: 650 W Hwy 16

MUNICIPALITY: West Salem

PARCEL ID #: 16-1021-27

CLOSURE DATE: May 25, 2011

FID #: 632094980

DATCP #:

COMM #: 54669113250

#### \*WTM COORDINATES:

X: 432232 Y: 381276

*\* Coordinates are in  
WTM83, NAD83 (1991)*

#### WTM COORDINATES REPRESENT:

Approximate Center Of Contaminant Source

Approximate Source Parcel Center

Please check as appropriate: (BRRTS Action Code)

#### Contaminated Media:

Groundwater Contamination > ES (236)

Contamination in ROW

Off-Source Contamination

*(note: for list of off-source properties  
see "Impacted Off-Source Property" form)*

Soil Contamination > \*RCL or \*\*SSRCL (232)

Contamination in ROW

Off-Source Contamination

*(note: for list of off-source properties  
see "Impacted Off-Source Property" form)*

#### Land Use Controls:

N/A (Not Applicable)

Soil: maintain industrial zoning (220)

*(note: soil contamination concentrations  
between non-industrial and industrial levels)*

Structural Impediment (224)

Site Specific Condition (228)

Cover or Barrier (222)

*(note: maintenance plan for  
groundwater or direct contact)*

Vapor Mitigation (226)

Maintain Liability Exemption (230)

*(note: local government unit or economic  
development corporation was directed to  
take a response action)*

#### Monitoring Wells:

Are all monitoring wells properly abandoned per NR 141? (234)

Yes  No  N/A

*\* Residual Contaminant Level*

*\*\*Site Specific Residual Contaminant Level*

This Adobe Fillable form is intended to provide a list of information that is required for evaluation for case closure. It is to be used in conjunction with Form 4400-202, Case Closure Request. The closure of a case means that the Department has determined that no further response is required at that time based on the information that has been submitted to the Department.

**NOTICE: Completion of this form is mandatory** for applications for case closure pursuant to ch. 292, Wis. Stats. and ch. NR 726, Wis. Adm. Code, including cases closed under ch. NR 746 and ch. NR 726. The Department will not consider, or act upon your application, unless all applicable sections are completed on this form and the closure fee and any other applicable fees, required under ch. NR 749, Wis. Adm. Code, Table 1 are included. It is not the Department's intention to use any personally identifiable information from this form for any purpose other than reviewing closure requests and determining the need for additional response action. The Department may provide this information to requesters as required by Wisconsin's Open Records law [ss. 19.31 - 19.39, Wis. Stats.].

BRRTS #: 03-32-120909 PARCEL ID #: 16-1021-27  
ACTIVITY NAME: Lindvig Auto & Truck Repair WTM COORDINATES: X: 432232 Y: 381276

**CLOSURE DOCUMENTS** (the Department adds these items to the final GIS packet for posting on the Registry)

- Closure Letter**
- Maintenance Plan** (if activity is closed with a land use limitation or condition (land use control) under s. 292.12, Wis. Stats.)
- Continuing Obligation Cover Letter** (for property owners affected by residual contamination and/or continuing obligations)
- Conditional Closure Letter**
- Certificate of Completion (COC)** (for VPLE sites)

**SOURCE LEGAL DOCUMENTS**

- Deed:** The most recent deed as well as legal descriptions, for the **Source Property** (where the contamination originated). Deeds for other, off-source (off-site) properties are located in the **Notification** section.  
*Note: If a property has been purchased with a land contract and the purchaser has not yet received a deed, a copy of the land contract which includes the legal description shall be submitted instead of the most recent deed. If the property has been inherited, written documentation of the property transfer should be submitted along with the most recent deed.*
- Certified Survey Map:** A copy of the certified survey map or the relevant section of the recorded plat map for those properties where the legal description in the most recent deed refers to a certified survey map or a recorded plat map. (lots on subdivided or platted property (e.g. lot 2 of xyz subdivision)).  
**Figure #:**                      **Title:**
- Signed Statement:** A statement signed by the Responsible Party (RP), which states that he or she believes that the attached legal description accurately describes the correct contaminated property.

**MAPS** (meeting the visual aid requirements of s. NR 716.15(2)(h))

Maps must be no larger than 11 x 17 inches unless the map is submitted electronically.

- Location Map:** A map outlining all properties within the contaminated site boundaries on a U.S.G.S. topographic map or plat map in sufficient detail to permit easy location of all parcels. If groundwater standards are exceeded, include the location of all potable wells within 1200 feet of the site.  
*Note: Due to security reasons municipal wells are not identified on GIS Packet maps. However, the locations of these municipal wells must be identified on Case Closure Request maps.*  
**Figure #:**                      **Title: Site Location Map**
- Detailed Site Map:** A map that shows all relevant features (buildings, roads, individual property boundaries, contaminant sources, utility lines, monitoring wells and potable wells) within the contaminated area. This map is to show the location of all contaminated public streets, and highway and railroad rights-of-way in relation to the source property and in relation to the boundaries of groundwater contamination exceeding a ch. NR 140 Enforcement Standard (ES), and/or in relation to the boundaries of soil contamination exceeding a Residual Contaminant Level (RCL) or a Site Specific Residual Contaminant Levels (SSRCL) as determined under s. NR 720.09, 720.11 and 720.19.  
**Figure #:**                      **Title: Site Layout Map**
- Soil Contamination Contour Map:** For sites closing with residual soil contamination, this map is to show the location of all contaminated soil and a single contour showing the horizontal extent of each area of contiguous residual soil contamination that exceeds a Residual Contaminant Level (RCL) or a Site Specific Residual Contaminant Level (SSRCL) as determined under s. NR 720.09, 720.11 and 720.19.  
**Figure #:**                      **Title: Soil Contamination Map**

BRRTS #: 03-32-120909

ACTIVITY NAME: Lindvig Auto & Truck Repair

**MAPS (continued)**

- Geologic Cross-Section Map:** A map showing the source location and vertical extent of residual soil contamination exceeding a Residual Contaminant Level (RCL) or a Site Specific Residual Contaminant Level (SSRCL). If groundwater contamination exceeds a ch. NR 140 Enforcement Standard (ES) when closure is requested, show the source location and vertical extent, water table and piezometric elevations, and locations and elevations of geologic units, bedrock and confining units, if any.

Figure #: Title: **Cross Section Map**

Figure #: Title: **Geologic Cross Section**

- Groundwater Isoconcentration Map:** For sites closing with residual groundwater contamination, this map shows the horizontal extent of all groundwater contamination exceeding a ch. NR140 Preventive Action Limit (PAL) and an Enforcement Standard (ES). Indicate the direction and date of groundwater flow, based on the most recent sampling data.

*Note: This is intended to show the total area of contaminated groundwater.*

Figure #: Title:

- Groundwater Flow Direction Map:** A map that represents groundwater movement at the site. If the flow direction varies by more than 20° over the history of the site, submit 2 groundwater flow maps showing the maximum variation in flow direction.

Figure #: Title:

Figure #: Title:

**TABLES (meeting the requirements of s. NR 16.15(2)(h)(3))**

Tables must be no larger than 11 x 17 inches unless the table is submitted electronically. Tables must not contain shading and/or cross-hatching. The use of **BOLD** or *ITALICS* is acceptable.

- Soil Analytical Table:** A table showing remaining soil contamination with analytical results and collection dates.  
**Note:** This is one table of results for the contaminants of concern. Contaminants of concern are those that were found during the site investigation, that remain after remediation. It may be necessary to create a new table to meet this requirement.

Table #: Title: **Soil Analytical Results Summary**

- Groundwater Analytical Table:** Table(s) that show the most recent analytical results and collection dates, for all monitoring wells and any potable wells for which samples have been collected.

Table #: Title:

- Water Level Elevations:** Table(s) that show the previous four (at minimum) water level elevation measurements/dates from all monitoring wells. If present, free product is to be noted on the table.

Table #: Title:

**IMPROPERLY ABANDONED MONITORING WELLS**

For each monitoring well not properly abandoned according to requirements of s. NR 141.25 include the following documents.  
**Note:** If the site is being listed on the GIS Registry for only an improperly abandoned monitoring well you will only need to submit the documents in this section for the GIS Registry Packet.

- Not Applicable**

- Site Location Map:** A map showing all surveyed monitoring wells with specific identification of the monitoring wells which have not been properly abandoned.

**Note:** If the applicable monitoring wells are distinctly identified on the Detailed Site Map this Site Location Map is not needed.

Figure #: Title:

- Well Construction Report:** Form 4440-113A for the applicable monitoring wells.

- Deed:** The most recent deed as well as legal descriptions for each property where a monitoring well was not properly abandoned.

- Notification Letter:** Copy of the notification letter to the affected property owner(s).

BRRTS #: 03-32-120909

ACTIVITY NAME: Lindvig Auto & Truck Repair

**NOTIFICATIONS**

**Source Property**

**Not Applicable**

**Letter To Current Source Property Owner:** If the source property is owned by someone other than the person who is applying for case closure, include a copy of the letter notifying the current owner of the source property that case closure has been requested.

**Return Receipt/Signature Confirmation:** Written proof of date on which confirmation was received for notifying current source property owner.

**Off-Source Property**

Group the following information per individual property and label each group according to alphabetic listing on the "Impacted Off-Source Property" attachment.

**Not Applicable**

**Letter To "Off-Source" Property Owners:** Copies of all letters sent by the Responsible Party (RP) to owners of properties with groundwater exceeding an Enforcement Standard (ES), and to owners of properties that will be affected by a land use control under s. 292.12, Wis. Stats.

*Note: Letters sent to off-source properties regarding residual contamination must contain standard provisions in Appendix A of ch. NR 726.*

**Number of "Off-Source" Letters:**

**Return Receipt/Signature Confirmation:** Written proof of date on which confirmation was received for notifying any off-source property owner.

**Deed of "Off-Source" Property:** The most recent deed(s) as well as legal descriptions, for all affected deeded **off-source property(ies)**. This does not apply to right-of-ways.

*Note: If a property has been purchased with a land contract and the purchaser has not yet received a deed, a copy of the land contract which includes the legal description shall be submitted instead of the most recent deed. If the property has been inherited, written documentation of the property transfer should be submitted along with the most recent deed.*

**Letter To "Governmental Unit/Right-Of-Way" Owners:** Copies of all letters sent by the Responsible Party (RP) to a city, village, municipality, state agency or any other entity responsible for maintenance of a public street, highway, or railroad right-of-way, within or partially within the contaminated area, for contamination exceeding a groundwater Enforcement Standard (ES) and/or soil exceeding a Residual Contaminant Level (RCL) or a Site Specific Residual Contaminant Level (SSRCL).

**Number of "Governmental Unit/Right-Of-Way Owner" Letters: Two**



May 25, 2011

Jerold M Ming  
25212 W Lake Shore Dr  
Ingleside, IL 60041

RE: **Final Closure**

**Commerce # 54669-1132-50-A DNR BRRTS # 03-32-120909**  
Lindvig Auto and Truck, 650 W City Hwy. 16, West Salem

Dear Mr. Ming:

The Wisconsin Department of Commerce (Commerce) has reviewed the request for case closure prepared by your consultant, Metco, for the site referenced above. Commerce has determined that this site does not pose a significant threat to human health or the environment. No further investigation or remedial action is necessary.

This case is now listed as "closed" on the Commerce database and will be included on the Department of Natural Resources (DNR) Geographic Information System (GIS) Registry of Closed Remediation Sites to address residual contamination. To review sites on the GIS Registry web page, visit <http://dnr.wi.gov/org/aw/rr/gis/index.htm>. If you intend to construct or reconstruct a potable well on this property, you must get prior DNR approval.

All current and future owners and occupants of the property need to be aware that excavation of contaminated soil may pose a hazard. Special precautions may be needed to prevent inhalation, ingestion or dermal contact with the residual contamination when it is removed. If soil is excavated, the property owner at the time of excavation must have the soil sampled and analyzed to determine if residual contamination remains. If sampling confirms that contamination is present, the property owner at the time of excavation must determine whether the material would be considered solid or hazardous waste and ensure that any storage, treatment or disposal is in compliance with applicable statutes and rules.

Costs for sampling and excavation activities conducted after case closure are not eligible for PECFA reimbursement. However, if it is determined that any undisturbed remaining petroleum contamination poses a threat, the case may be reopened and further investigation or remediation may be required. If this case is reopened, any original claim under the PECFA fund would also reopen and you may apply for assistance to the extent of remaining eligibility.

Thank you for your efforts to protect Wisconsin's environment. If you have any questions, please contact me in writing at the letterhead address or by telephone at (608) 266-0593.

Sincerely,

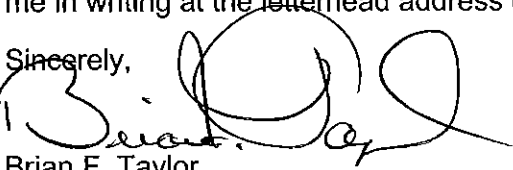

Brian F. Taylor  
Senior Hydrogeologist  
Site Review Section

cc: Jason Powell, Metco

**NOTICE OF LIEN**

§101.143(4)(ee), Stats.



Document Number

Title of Document

1543515

LACROSSE COUNTY  
REGISTER OF DEEDS  
CHERYL A. HCBRIDE

RECORDED ON  
01/27/2010 09:44AM

REC FEE: 11.00

EXEMPT #:

PAGES: 1

As provided by §101.143(4)(ee), Stats., the Department of Commerce (department) has granted a waiver of the deductible due from the owner of property eligible for reimbursement of petroleum cleanup costs under the Petroleum Environmental Cleanup Fund Act (PECFA) to Jerold M Ming owner of the following property:

A 20 foot wide permanent easement located in part of the SE ¼ of the SE ¼ of Section 33, Town 17N, Range 8 East, Village of West Salem, the centerline being 10 feet east of and adjacent to the following described reference line:

Commencing at the southeast corner of Section 33 thence west 309 feet along the south line of Section 3; thence north 94 feet parallel with the east line of the SE ¼ of the SE ¼ of Section 3 to the north right of way line of U.S. Highway 16; thence continuing north parallel with said east line 166 feet; thence west 150 feet to the northwest corner of Mings' property and the point of beginning of said reference line; thence south 60 feet parallel with said east line and said easement reference line there terminating.

Record this record with the Register of Deeds.

Name and return address:

Tanya Herranz  
PECFA Program Specialist  
Division of Environmental and Regulatory Services  
PO Box 7838  
Madison WI 53707-7838  
Phone (608) 266-6796

**ENV**

Tax Parcel: # 16-1021-27

Under §101.143(4)(ee), Stats., when the deductible is waived, the department is required to file a statement of lien for the amount of the deductible with the register of deeds in the county where the storage system is located.

The deductible amount waived by the department is *Five Thousand Three Hundred Fifty Dollars (\$5,350.00)*. The property remains subject to this lien until the deductible is paid in full to the Department. No interest is recoverable on this lien.

The department makes and files this claim for the interest held by the Owner(s) in this property under §101.143(4)(ee), Stats. The department certifies that to the best of its knowledge and belief, all information contained in this Notice of Lien is correct, and this lien represents a legal encumbrance upon the property. Based on the above information, the department claims a lien on all the interest, which the Owner(s) have in the above-

Department of Commerce

By:

Tanya Herranz, PECFA Program Specialist  
Division of Environmental and Regulatory Services

**AUTHENTICATION OF ACKNOWLEDGMENT**

The above named person was sworn to before me on this 25 day of Jan, 2010.

Laura M. Varriale, Notary Public  
State of Wisconsin, County of Dane  
My Commission is Permanent.

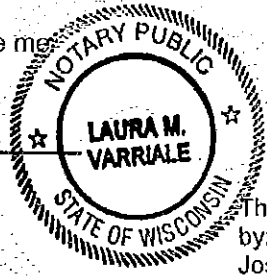

This document was drafted & approved by:  
Joseph Thomas  
Chief Legal Counsel  
Department of Commerce  
PO Box 7970  
Madison WI 53707-7970  
Bar #1015480

**Run Date:** July 27, 2011

**2010 Property Record  
La Crosse County, WI  
City of La Crosse**

**Parcel ID:** 16-1021-27

**Deed Information:**

<b>Property Description:</b>	Assessed Acreage: 0.56	<u>Volume</u>	<u>Page</u>	<u>Document</u>	<u>Recorded</u>	<u>Type</u>
650 CITY HIGHWAY 16 W		656	612	914621	1981-01-20	WD PRIOR 9-1-81

\*\*Multiple Addresses on file

Sec/Twn/Rng/Qtr: 33-17-06 SE-SE  
PRT SE-SE COM SE COR W 309FT  
N P/W E LN 94FT TO N LN USH-  
16 POB CONT N 166FT W 150FT  
S P/W E LN 194.8FT TO N LN  
USH-16 NELY ALG HWY 152.2FT

<b>Owner(s):</b>	<b>Relation</b>	<b>Mailing Address</b>	<b>City</b>	<b>St</b>	<b>Zip</b>
JEROLD M MING	Owner	320 ALLEGHANY	GRAYSLAKE	IL	60030

**Districts:** **Additional Parcel Information:**

<u>Code</u>	<u>Description</u>	<u>Taxation District</u>	<u>Category</u>	<u>Description</u>
0420	Fire District	Y		
8030	Neshonoc LD	Y		
6370	West Salem School	Y		
WSPO	WEST SALEM POSTAL DISTRICT	N		
22	County Supervisory District 22	N		
191004	Ward 4	N		

**Tax Information:**

**Tax Year:** 2010

General Tax: \$939.65	Total Woodlands: \$0.00	Total Due: \$918.51	Total Mill Rate: 0.018533564
Lottery Credit: \$0.00	First Dollar Credit: 66.94	Special Charges: \$45.80	
Total Assessed Value: \$50,700.00	Total Fair Market Value: \$51,400.00		

**Assessments:** Values are still subject to SS70.43 for corrections; or SS70.44 for omitted property; or SS70.47 for Certiorari appeals.

!!!!These values have not been finalized through the Local Board of Review Adjournment and are subject to change!!!!

<u>Class</u>	<u>Description</u>	<u>Acreage</u>	<u>Land</u>	<u>Improvement</u>	<u>Total</u>	<u>Last Modified</u>
G2	Commercial	0.56	\$45,700.00	\$5,000.00	\$50,700.00	2007-11-05

(for more detailed and complete information on any category, go to Land Records Information Website at <http://www.co.la-crosse.wi.us/LandRecordsPortal/Default.aspx>)

# Map

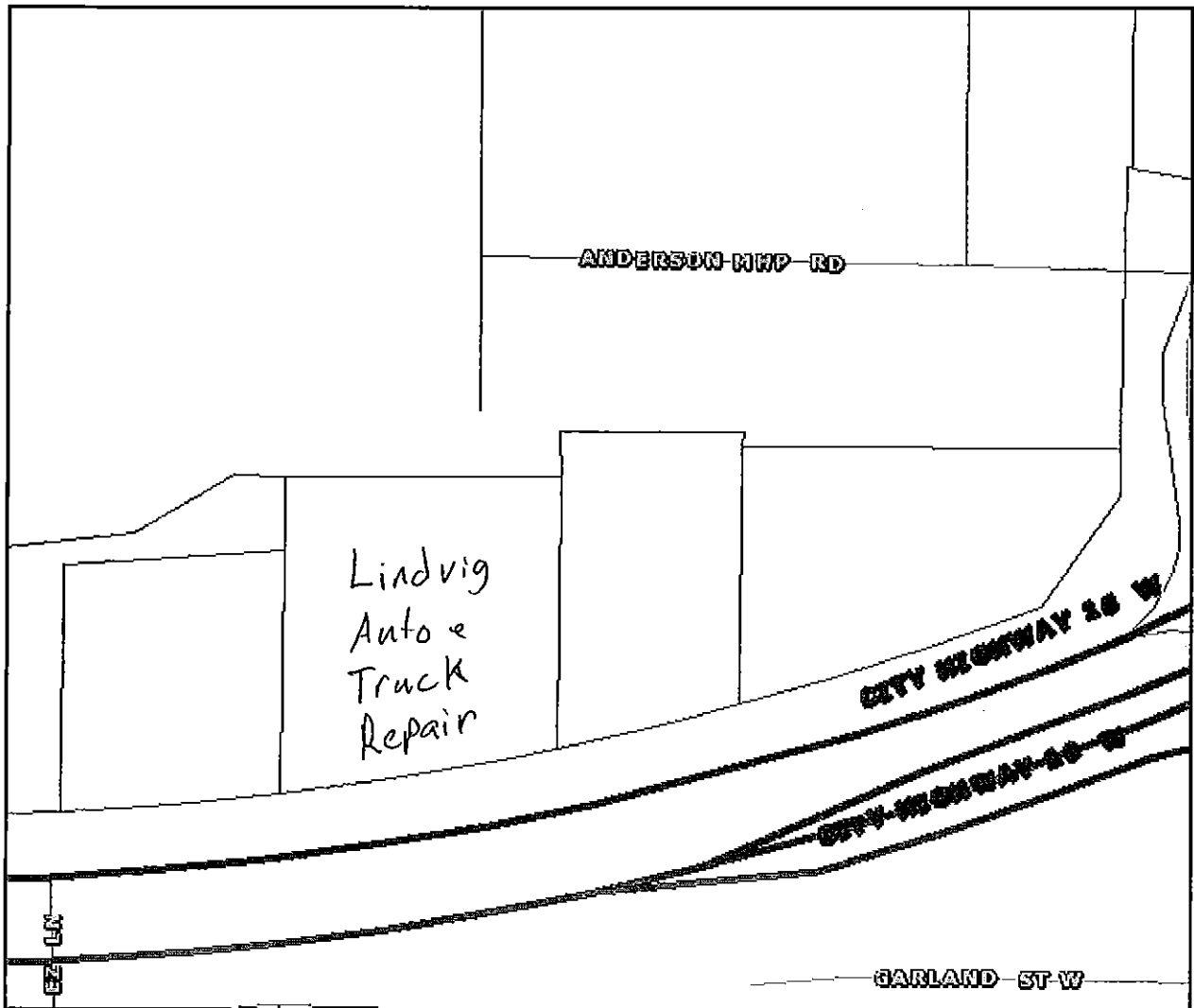

1:1186 (1"=98)

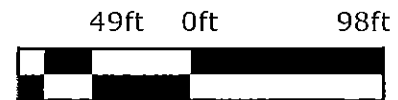

- ◊ Unincorporated Areas
- ▣ County Limits
- ▣ Municipality Limits
- Major Roads
- Municipal, County & Town Roads
- ++ Rail Roads
- Streams
- Lakes, Rivers & Other Bodies of Water
- Current Parcel

### Disclaimer:

La Crosse County strives to produce and publish the most accurate and up-to-date information. Due to variances in sources and update cycles, La Crosse County makes no representation or warranties, either express or implied regarding the accuracy and/or completeness of the information contained herein. Map scale accuracy is dependant on your printer. THIS DATA IS SUBJECT TO CHANGE ON A DAILY BASIS.



WDNR BRRTS Case #: 03-32-120909

WDNR Site Name: Lindvig Auto & Truck Repair

**Geographic Information System (GIS) Registry of Closed Remediation Sites**

In compliance with the revisions to the NR 700 rule series requiring certain closed sites to be listed on the Geographic Information System (GIS) Registry of Closed Remediation Sites (Registry) effective Nov., 2001, I have provided the following information.

To the best of my knowledge the legal descriptions provided and attached to this statement are complete and accurate.

Responsible Party:

Jerry Ming - OWNER  
(print name/title)

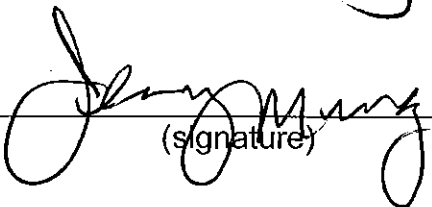
  
(signature)

4/9/11  
(date)

TOPO! map printed on 10/26/10 from "wisconsin.tpo" and "Untitled.tpg"  
 91°06.000' W WGS84 91°05.000' W

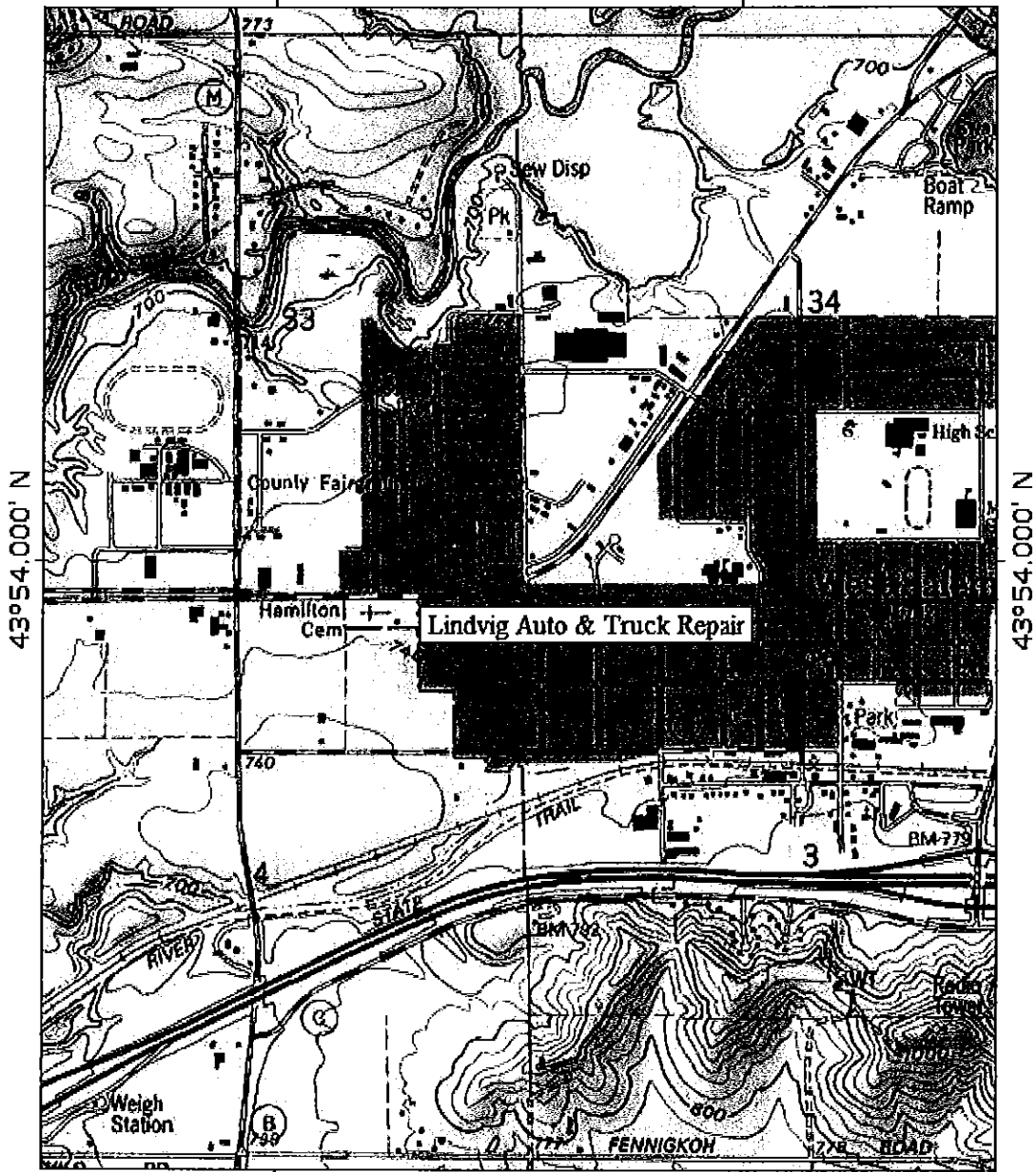

TN MN  
 1°

91°06.000' W WGS84 91°05.000' W  
 0 5 1 MILE  
 0 1000 FEET 0 500 1000 METERS

Printed from TOPO! ©2001 National Geographic Holdings (www.topo.com)

SITE LOCATION MAP – CONTOUR INTERVAL 20 FEET
LINDVIG AUTO & TRUCK REPAIR – WEST SALEM, WI
SEAMLESS USGS TOPOGRAPHIC MAPS ON CD-ROM

**SITE LAYOUT MAP**

**LINDVIG AUTO**

1421 State Road 16  
La Crosse, WI 54601  
Tel: (608) 781-8879  
Fax: (608) 781-8893

WEST SALEM, WISCONSIN

DRAWN BY: ED  
DATE: 6/22/10

**METCO**  
Excellence through experience

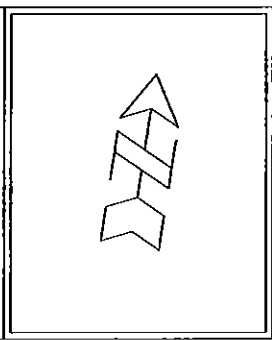

- NOTE: INFORMATION BASED ON AVAILABLE DATA ACTUAL CONDITIONS MAY DIFFER
- - - - - PROPERTY LINE
  - ≡≡≡≡≡≡ OVERHEAD LINES
  - - - - - WATER LINE
  - ..... TELEPHONE/CABLE LINE
  - ♦ - TANK REMOVAL SOIL SAMPLE LOCATION
  - - GEOPROBE BORING LOCATION

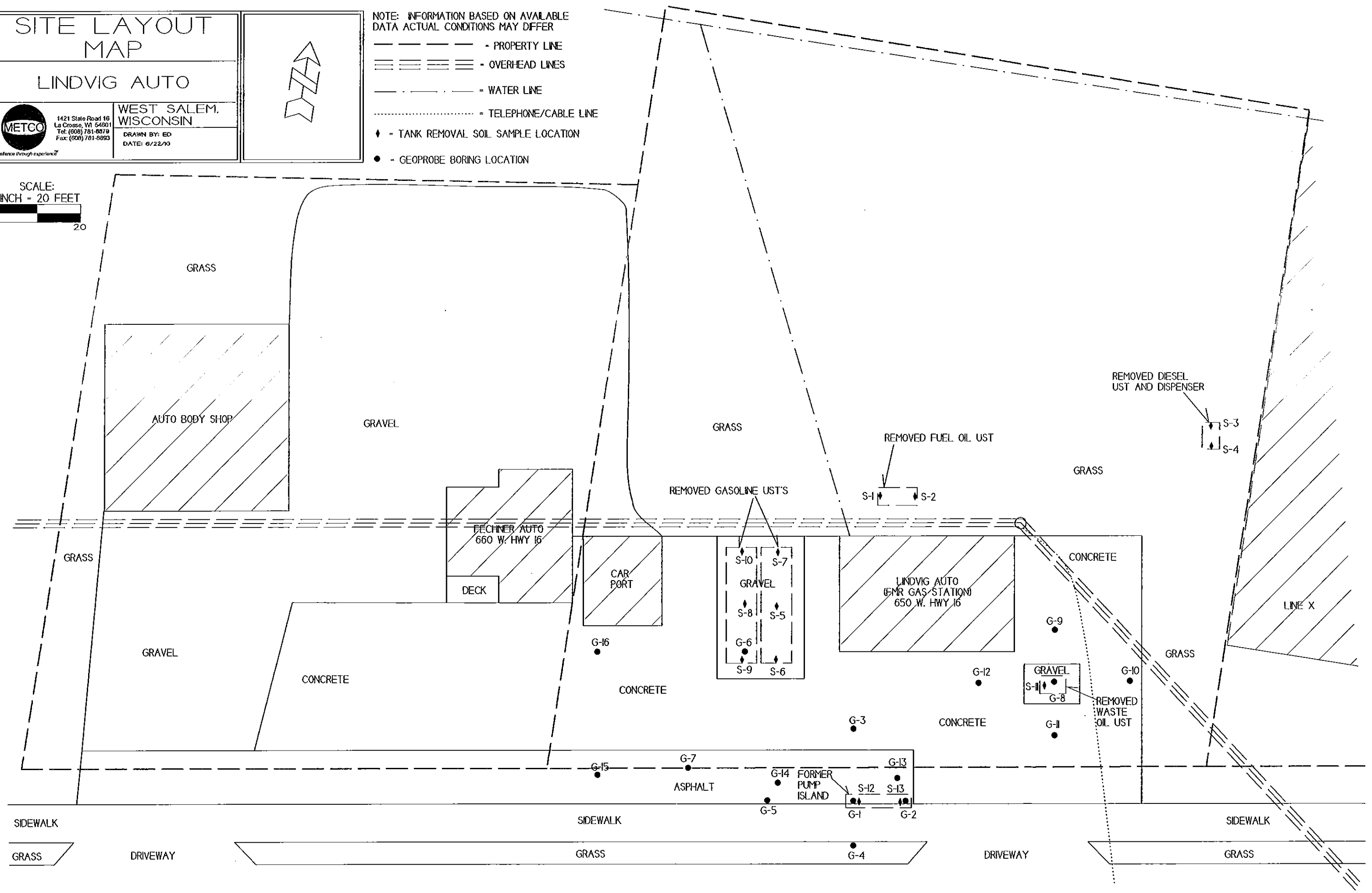
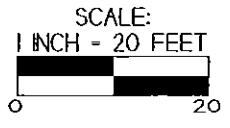

STATE HIGHWAY 16

# SOIL CONTAMINATION MAP

## LINDVIG AUTO



1421 State Road 16  
La Crosse, WI 54601  
Tel: (608) 781-8879  
Fax: (608) 781-8893

WEST SALEM,  
WISCONSIN

DRAWN BY: ED  
DATE: 1/3/90

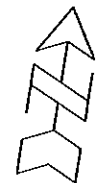

NOTE: INFORMATION BASED ON AVAILABLE DATA ACTUAL CONDITIONS MAY DIFFER

- - PROPERTY LINE
- =====  
=====  
=====  
=====  
----- - OVERHEAD LINES
- - WATER LINE
- ..... - TELEPHONE/CABLE LINE
- ♦ - TANK REMOVAL SOIL SAMPLE LOCATION
- - GEOPROBE BORING LOCATION

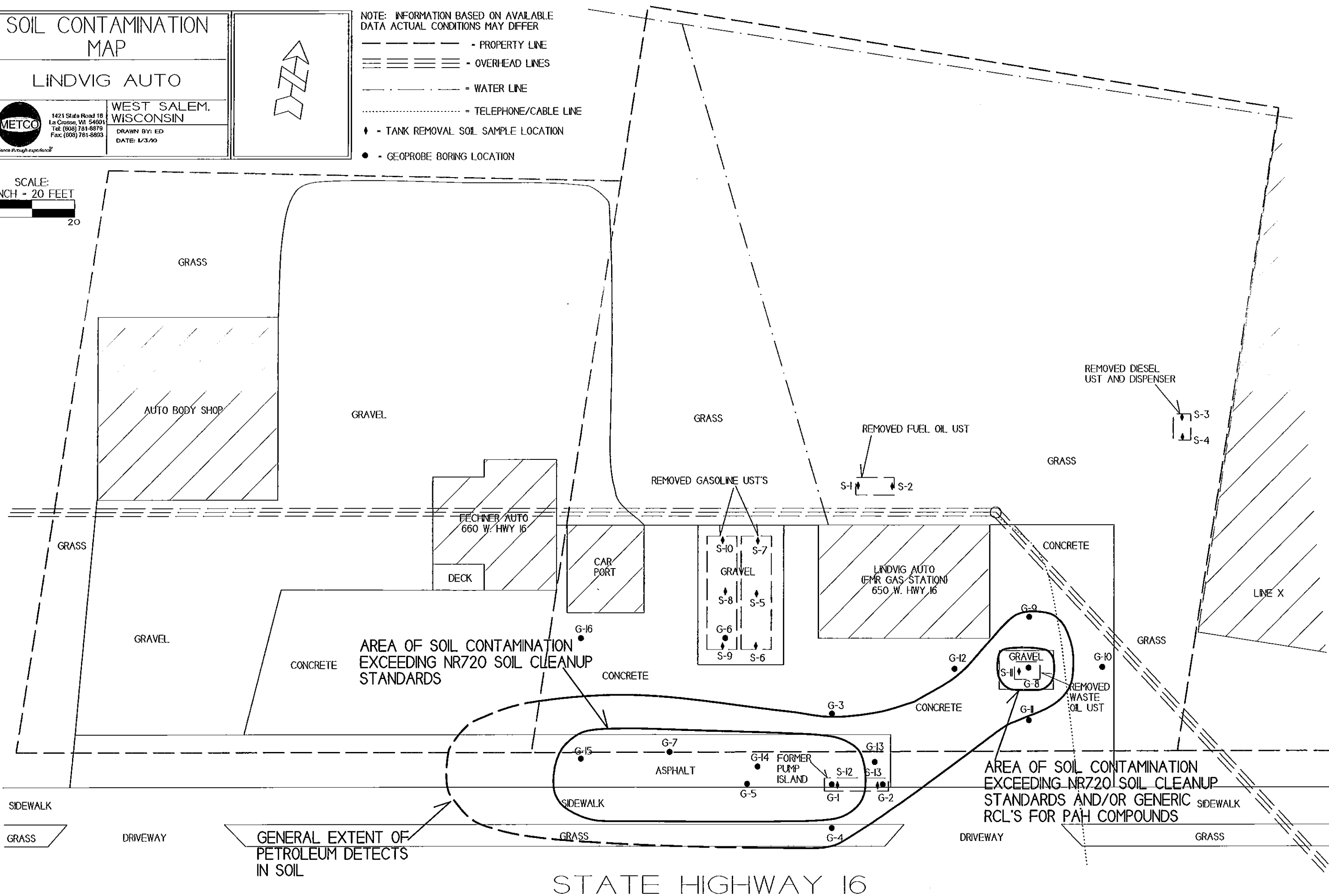
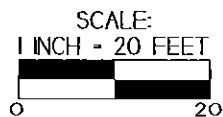

### STATE HIGHWAY 16

# CROSS SECTION MAP

LINDVIG AUTO



1421 State Road 16  
La Crosse, WI 54601  
Tel: (608) 781-8879  
Fax: (608) 781-8893

WEST SALEM,  
WISCONSIN

DRAWN BY: ED  
DATE: 1/3/70



NOTE: INFORMATION BASED ON AVAILABLE DATA ACTUAL CONDITIONS MAY DIFFER

- - PROPERTY LINE
- =====  
=====  
=====  
=====  
----- - OVERHEAD LINES
- - WATER LINE
- ..... - TELEPHONE/CABLE LINE
- ♦ - TANK REMOVAL SOIL SAMPLE LOCATION
- - GEOPROBE BORING LOCATION

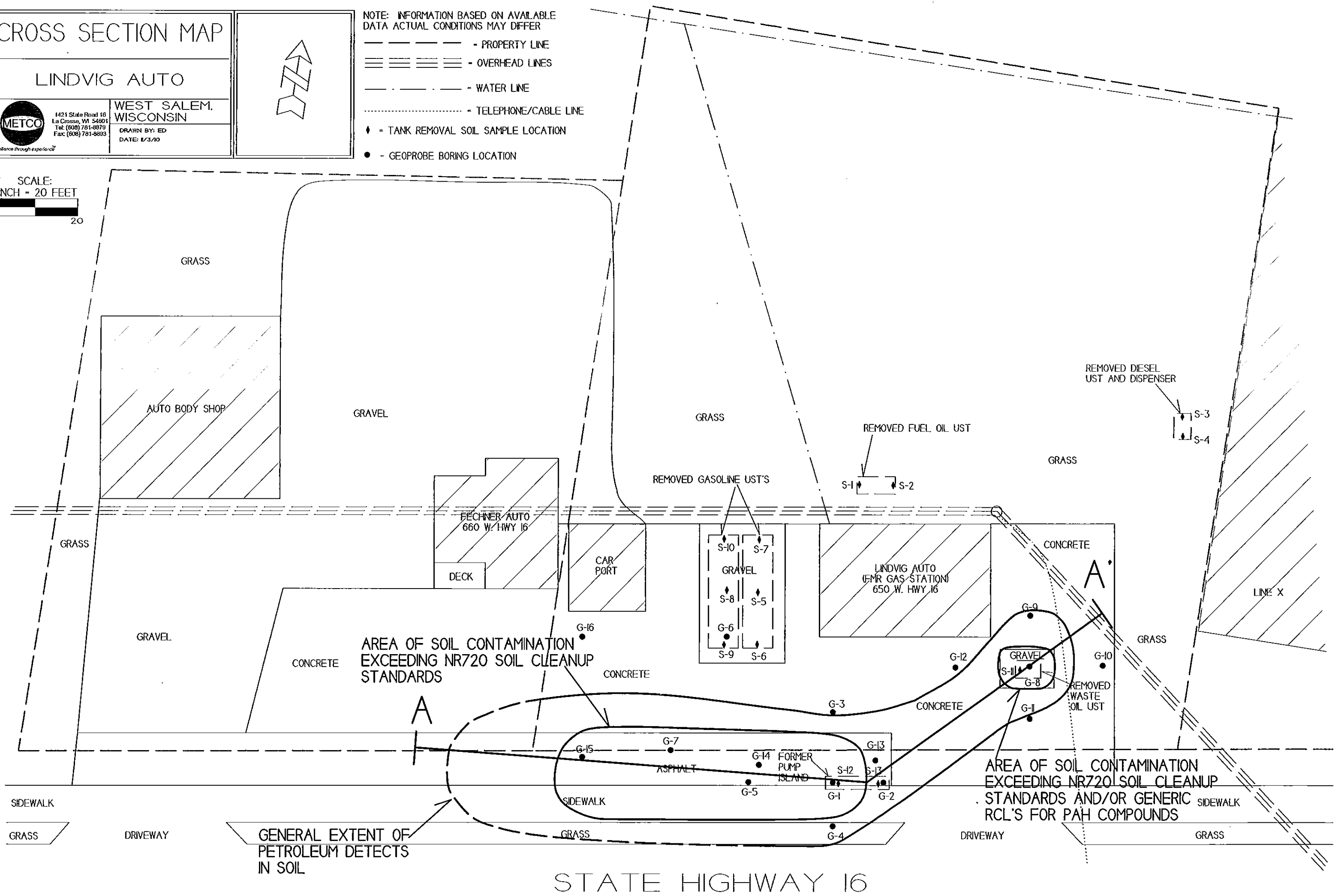
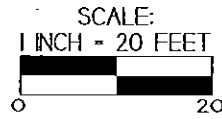

GENERAL EXTENT OF  
PETROLEUM DETECTS  
IN SOIL

STATE HIGHWAY 16

A WEST A EAST

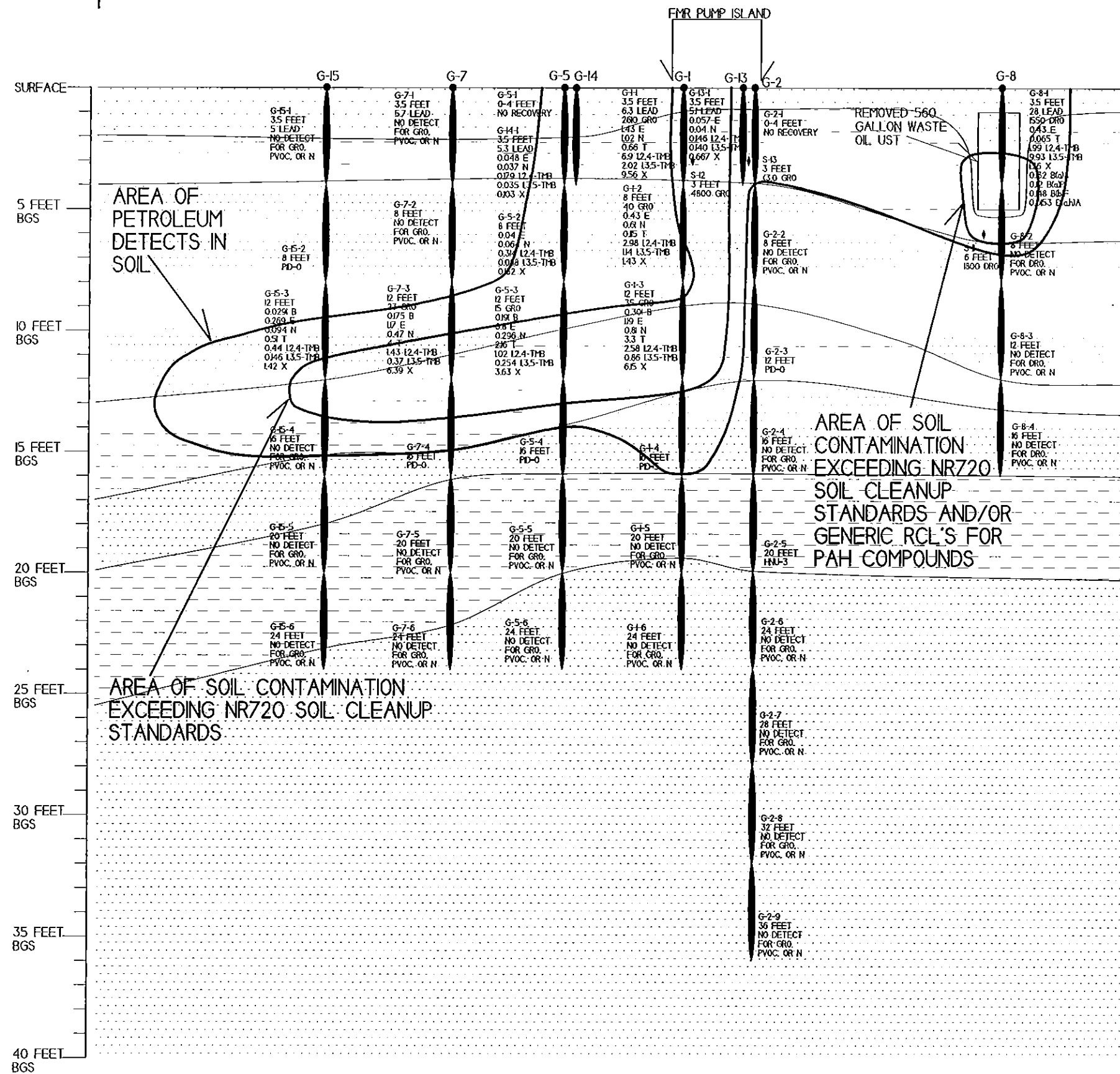

**GEOLOGIC CROSS SECTION**

**LINDVIG AUTO**



1421 State Road 16  
La Crosse, WI 54601  
Tel: (608) 781-8879  
Fax: (608) 781-8893

**WEST SALEM, WISCONSIN**

DRAWN BY: ED  
DATE: 1/03/10



INFORMATION BASED ON AVAILABLE DATA. ACTUAL CONDITIONS MAY DIFFER.

SOIL SAMPLE RESULTS ARE PRESENTED IN PARTS PER MILLION (PPM).

NOTE: SOIL SAMPLE DATA IS BASED ON LABORATORY RESULTS FROM SAMPLES COLLECTED DURING THE FOLLOWING EVENTS:  
 - UST SITE ASSESSMENT (4/7/97)  
 - GEOPROBE PROJECT (6/22-23/10)

- PID - PHOTO IONIZATION DETECTOR
- DRO - DIESEL RANGE ORGANICS
- GRO - GASOLINE RANGE ORGANICS
- B - BENZENE
- E - ETHYLBENZENE
- MTBE - METHYL TERT-BUTYL ETHER
- N - NAPHTHALENE
- T - TOLUENE
- TMB - TRIMETHYLBENZENE
- X - XYLENE

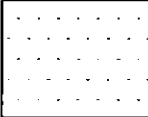
- ◆ - SOIL SAMPLING LOCATION (UST SITE ASSESSMENT)
- - GEOPROBE BORING LOCATION
- - GEOPROBE SOIL SAMPLE LOCATION

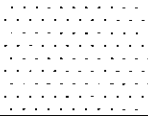
-  TAN TO BROWN TO GRAY SAND AND GRAVEL (FILL)
-  TAN TO BROWN TO ORANGE TO GRAY TO GREEN CLAY TO SANDY CLAY
-  TAN TO BROWN TO ORANGE TO GRAY TO GREEN VERY FINE TO FINE GRAINED SAND

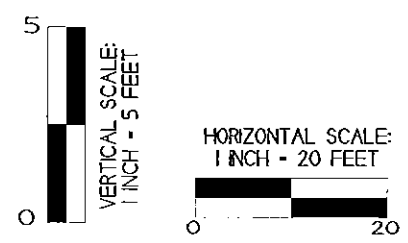

Soil Analytical Results Summary  
Lindvig Auto & Truck Repair Site BRR's# 03-32-120909

Sample ID	Date	Depth (feet)	PID	Lead (ppm)	DRO (ppm)	GRO (ppm)	Benzene (ppb)	Ethyl Benzene (ppb)	MTBE (ppb)	Naphthalene (ppb)	Toluene (ppb)	1,2,4-Trime-thylbenzene (ppb)	1,3,5-Trime-thylbenzene (ppb)	Xylene (Total) (ppb)
S-1	04/07/97	8.5	<10	NS	<4.2	NS	NS	NS	NS	NS	NS	NS	NS	NS
S-2	04/07/97	8.5	<10	NS	79	NS	<25	<25	<25	NS	<25	<25	<25	<75
S-3	04/07/97	8	<10	NS	7.2	NS	NS	NS	NS	NS	NS	NS	NS	NS
S-4	04/07/97	8	<10	NS	<4.2	NS	NS	NS	NS	NS	NS	NS	NS	NS
S-5	04/07/97	11	<10	NS	NS	<3.0	NS	NS	NS	NS	NS	NS	NS	NS
S-6	04/07/97	11	24	NS	NS	<2.8	NS	NS	NS	NS	NS	NS	NS	NS
S-7	04/07/97	11	<10	NS	NS	<2.8	NS	NS	NS	NS	NS	NS	NS	NS
S-8	04/07/97	11	<10	NS	NS	<2.9	NS	NS	NS	NS	NS	NS	NS	NS
S-9	04/07/97	11	<10	NS	NS	<2.9	NS	NS	NS	NS	NS	NS	NS	NS
S-10	04/07/97	11	<10	NS	NS	<2.7	NS	NS	NS	NS	NS	NS	NS	NS
S-11	04/07/97	6	105	NS	1800	NS	NS	NS	NS	NS	NS	NS	NS	NS
S-12	04/07/97	3	960	NS	NS	4800	NS	NS	NS	NS	NS	NS	NS	NS
S-13	04/07/97	3	10.8	NS	NS	<3.0	NS	NS	NS	NS	NS	NS	NS	NS
G-1-1	06/22/10	3.5	300	6.3	NS	2610	<35	1430	<27	1020	660	6900	2020	9560
G-1-2	06/22/10	8	180	NS	NS	40	<25	430	<25	610	115	2980	1140	1430
G-1-3	06/22/10	12	30	NS	NS	35	301	1190	<25	810	3300	2580	860	6150
G-1-4	06/22/10	16	5											
NOT SAMPLED														
G-1-5	06/22/10	20	0	NS	NS	<10	<25	<25	<25	<25	<25	<25	<25	<75
G-1-6	06/22/10	24	0	NS	NS	<10	<25	<25	<25	<25	<25	<25	<25	<75
G-2-1	06/22/10													
NO RECOVERY														
G-2-2	06/22/10	8	0	NS	NS	<10	<25	<25	<25	<25	<25	<25	<25	<75
G-2-3	06/22/10	12	0											
NOT SAMPLED														
G-2-4	06/22/10	16	3	NS	NS	<10	<25	<25	<25	<25	<25	<25	<25	<75
G-2-5	06/22/10	20	3											
NOT SAMPLED														
G-2-6	06/22/10	24	0	NS	NS	<10	<25	<25	<25	<25	<25	<25	<25	<75
G-2-7	06/22/10	28	3	NS	NS	<10	<25	<25	<25	<25	<25	<25	<25	<75
G-2-8	06/22/10	32	0	NS	NS	<10	<25	<25	<25	<25	<25	<25	<25	<75
G-2-9	06/22/10	36	0	NS	NS	<10	<25	<25	<25	<25	<25	<25	<25	<75
G-3-1	06/22/10	3.5	0	4.2	NS	<10	<25	<25	<25	<25	<25	<25	<25	<75
G-3-2	06/22/10	8	0											
NOT SAMPLED														
G-3-3	06/22/10	12	30	NS	NS	<10	<25	<25	<25	<25	<25	<25	<25	<75
G-3-4	06/22/10	16	5											
NOT SAMPLED														
G-3-5	06/22/10	20	0	NS	NS	<10	<25	<25	<25	<25	<25	<25	<25	<75
G-3-6	06/22/10	24	0	NS	NS	<10	<25	<25	<25	<25	<25	<25	<25	<75
G-4-1	06/22/10	3.5	0	5	NS	<10	<25	<25	<25	<25	<25	<25	<25	<75
G-4-2	06/22/10	8	20	NS	NS	<10	<25	25.9	<25	<25	33	47	<25	81.7
G-4-3	06/22/10	12	0											
NOT SAMPLED														
G-4-4	06/22/10	16	0	NS	NS	<10	<25	<25	<25	<25	<25	<25	<25	<75
G-4-5	06/22/10	20	0											
NOT SAMPLED														
G-4-6	06/22/10	24	0	NS	NS	<10	<25	<25	<25	<25	<25	<25	<25	<75
G-5-1	06/22/10													
NO RECOVERY														
G-5-2	06/22/10	8	0	NS	NS	<10	<25	40	<25	64	<25	314	88	152
G-5-3	06/22/10	12	0	NS	NS	15	191	800	<25	296	2160	1020	254	3630
G-5-4	06/22/10	16	0											
NOT SAMPLED														
G-5-5	06/22/10	20	0	NS	NS	<10	<25	<25	<25	<25	<25	<25	<25	<75
G-5-6	06/22/10	24	0	NS	NS	<10	<25	<25	<25	<25	<25	<25	<25	<75
G-6-1	06/22/10	3.5	0	1.6	NS	<10	<25	<25	<25	<25	<25	<25	<25	<75
G-6-2	06/22/10	8	0											
NOT SAMPLED														
G-6-3	06/22/10	12	0											
NOT SAMPLED														
G-6-4	06/22/10	16	0	NS	NS	<10	<25	<25	<25	<25	<25	<25	<25	<75
G-6-5	06/22/10	20	0											
NOT SAMPLED														
G-6-6	06/22/10	24	0	NS	NS	<10	<25	<25	<25	<25	<25	<25	<25	<75
G-7-1	06/22/10	3.5	0	5.7	NS	<10	<25	<25	<25	<25	<25	<25	<25	<75
G-7-2	06/22/10	8	30	NS	NS	<10	<25	<25	<25	<25	<25	<25	<25	<75
G-7-3	06/22/10	12	30	NS	NS	23	175	1170	<25	470	4000	1430	370	6390
G-7-4	06/22/10	16	0											
NOT SAMPLED														
G-7-5	06/22/10	20	0	NS	NS	<10	<25	<25	<25	<25	<25	<25	<25	<75
G-7-6	06/22/10	24	0	NS	NS	<10	<25	<25	<25	<25	<25	<25	<25	<75
G-8-1	06/22/10	3.5	0	28	1550	NS	<25	430	<25	25.9	65	1990	2930	1260
G-8-2	06/22/10	8	0	NS	<10	NS	<25	<25	<25	<25	<25	<25	<25	<75
G-8-3	06/22/10	12	0	NS	<10	NS	<25	<25	<25	<25	<25	<25	<25	<75
G-8-4	06/22/10	16	0	NS	<10	NS	<25	<25	<25	<25	<25	<25	<25	<75
G-9-1	06/22/10	3.5	0	3.1	<10	NS	<25	<25	<25	<25	<25	<25	<25	<75
G-9-2	06/22/10	8	0											
NOT SAMPLED														
G-9-3	06/22/10	10	0	NS	<10	NS	<25	<25	<25	<25	<25	<25	<25	<75
G-9-4	06/22/10	16	0	NS	<10	NS	<25	<25	<25	<25	<25	<25	<25	<75
G-10-1	06/22/10	3.5	0	3.1	<10	NS	<25	<25	<25	<25	<25	<25	<25	<75
G-10-2	06/22/10	8	0											
NOT SAMPLED														
G-10-3	06/22/10	10	0	NS	<10	NS	<25	<25	<25	<25	<25	<25	<25	<75
G-10-4	06/22/10	16	0	NS	<10	NS	<25	<25	<25	<25	<25	<25	<25	<75
G-11-1	06/22/10	3.5	0	3.6	<10	<10	<25	<25	<25	<25	<25	<25	<25	<75
G-11-2	06/22/10	8	0											
NOT SAMPLED														
G-11-3	06/22/10	10	0	NS	<10	<10	<25	<25	<25	<25	<25	<25	<25	<75
G-11-4	06/22/10	16	0	NS	<10	<10	<25	<25	<25	<25	<25	<25	<25	<75
G-11-5	06/22/10	16-20	0											
NOT SAMPLED														
G-11-6	06/22/10	24	0	NS	<10	<10	<25	<25	<25	<25	<25	<25	<25	<75
G-12-1	06/22/10	3.5	0	7.2	<10	<10	<25	<25	<25	<25	<25	<25	<25	<75
G-12-2	06/22/10	8	0											
NOT SAMPLED														
G-12-3	06/22/10	10	0	NS	<10	<10	<25	<25	<25	<25	<25	<25	<25	<75
G-12-4	06/22/10	16	0	NS	<10	<10	<25	<25	<25	<25	<25	<25	<25	<75
G-12-5	06/22/10	20	0											
NOT SAMPLED														
G-12-6	06/22/10	24	0	NS	<10	<10	<25	<25	<25	<25	<25	<25	<25	<75
G-13-1	06/22/10	3.5	10	5.1	NS	<10	<25	57	<25	40	<25	146	140	67-91
G-14-1	06/22/10	3.5	15	5.3	NS	<10	<25	48	<25	37	<25	179	35	103-128
G-15-1	06/22/10	3.5	0	5	NS	<10	<25	<25	<25	<25	<25	<25	<25	<75
G-15-2	06/22/10	8	0											
NOT SAMPLED														
G-15-3	06/22/10	12	25	NS	NS	<10	29.1	269	<25	94	510	440	146	1420
G-15-4	06/22/10	16	0	NS	NS	<10	<25	<25	<25	<25	<25	<25	<25	<75
G-15-5	06/22/10	20	0											
NOT SAMPLED														
G-15-6	06/22/10	24	0	NS	NS	<10	<25	<25	<25	<25	<25	<25	<25	<75
G-16-1	06/22/10	3.5	0	4.3	NS	<10	<25	<25	<25	<25	<25	<25	<25	<75
G-16-2	06/22/10	8	0											
NOT SAMPLED														
G-16-3	06/22/10	12	0	NS	NS	<10	<25	<25	<25	<25	<25	<25	<25	<75
G-16-4	06/22/10	16	0											
NOT SAMPLED														
G-16-5	06/22/10	20	0											
NOT SAMPLED														
G-16-6	06/22/10	24	0	NS	NS	<10	<25	<25	<25	<25	<25	<25	<25	<75
NR720				50	100	100	5.5	2900			1500			4100
NR746 Table 1							8500	4600		2700	38000	83000	11000	42000
NR746 Table 2							1100							

Bold = NR720 Exceedance  
Underline = NR746 Exceedance  
NS = Not Sampled

Soil Analytical Results Summary (PAH)  
 Lindvig Auto & Truck Repair Site BRRT's# 03-32-120909

Sample	Date	Depth (feet)	Aconaph-thene (ppb)	Aconaph-thylene (ppb)	Anthracene (ppb)	Benzo(a) anthracene (ppb)	Benzo(a) pyrene (ppb)	Benzo(b) fluoranthene (ppb)	Benzo(g,h,i) perylene (ppb)	Benzo(k) fluoranthene (ppb)	Chrysene (ppb)	Dibenzo(e,h) anthracene (ppb)	Fluoranthene (ppb)	Fluorone (ppb)	Indeno(1,2,3-cd) pyrene (ppb)	1-Methyl-naphthalene (ppb)	2-Methyl-naphthalene (ppb)	Naphthalene (ppb)	Phenanthrene (ppb)	Pyrene (ppb)
G-8-1	08/22/10	3.5	42	<5.1	87	132	112	148	97	63	127	15.3	430	42	66	86	115	25.6	292	360
G-9-1	08/22/10	3.5	<15.2	<5.1	<6.4	<12.9	5	8.1	<7.7	<9.8	<8.9	<5.5	14.4	<5.6	<7.8	<15	<9.7	<16.2	<10.6	12.2
G-10-1	08/22/10	3.5	<15.2	<5.1	<6.4	<12.9	<4.7	<6.5	<7.7	<9.8	<8.9	<5.5	<9.2	<5.6	<7.8	<15	<9.7	<16.2	<10.6	<7.7
G-11-1	08/22/10	3.5	<15.2	<5.1	<6.4	<12.9	<4.7	<6.5	<7.7	<9.8	<8.9	<5.5	<9.2	<5.6	<7.8	<15	<9.7	<16.2	<10.6	<7.7
G-12-1	08/22/10	3.5	<15.2	<5.1	<6.4	<12.9	<4.7	<6.5	<7.7	<9.8	<8.9	<5.5	<9.2	<5.6	<7.8	<15	<9.7	<16.2	<10.6	<7.7
<b>Non-Industrial RCL</b>			900,000	18,000	5,000,000	88	8.8	88	1,800	880	8,800	8.8	600,000	600,000	88	1,100,000	600,000	20,000	18,000	500,000
<b>Industrial RCL</b>			60,000,000	360,000	300,000,000	3,900	390	3,900	39,000	3,900	390,000	3,900	40,000,000	40,000,000	3,900	70,000,000	40,000,000	110,000	360,000	30,000,000

Bold = Non-Industrial RCL Exceedance, Underline = Industrial RCL Exceedance





Excellence through experience™

**COPY**

1421 State Road 16 ♦ La Crosse, WI 54601 ♦ 1-800-552-2932 ♦ Fax (608) 781-8893 Email: [rona@metcohq.com](mailto:rona@metcohq.com) ♦ [www.metcohq.com](http://www.metcohq.com)

February 2, 2011

Scott Halbrucker  
Village of West Salem Director of Public Works  
900 West Avenue North  
West Salem, WI 54669

Notification: Lindvig Auto & Truck Repair LUST Site (BRRTS # 03-32-120909), Conditional Case Closure Notification

Dear Mr. Halbrucker,

I am writing to inform you that soil contamination from the Lindvig Auto & Truck Repair site, located at 650 West City Highway 16, West Salem, WI, exists within the right of way of West City Highway 16.

As part of the required documentation, you are hereby notified that residual petroleum contamination exists in the soil within the right-of-way of West City Highway 16 to the south of the Lindvig Auto & Truck Repair site. Soil contamination was found to exist in the area of the former gasoline pump island along the right of way of West City Highway 16. Soil contamination was encountered from surface to approximately 13 feet below ground surface.

If the contaminated soil is encountered during future construction, it may pose inhalation or other direct contact hazards. Any contaminated soil encountered will require sampling and analysis, as well as proper storage, treatment, and disposal of any excavated materials. We are enclosing a site map displaying an inferred soil contamination plume.

If you have any questions, or require more detailed information, please contact me at METCO's La Crosse office (608-781-8879).

Sincerely,

A handwritten signature in black ink that reads "Jason T. Powell".

Jason T. Powell  
Staff Scientist

Enclosure: Map

**Subject:** RE: ED Notification of Contamination within the Right of Way - Lindvig Auto & Truck Repair

**From:** "TeBeest, Sharlene - DOT" <Sharlene.TeBeest@dot.wi.gov>

**Date:** Tue, 8 Feb 2011 17:40:01 -0600

**To:** "'Diana Symitczek, METCO - Environmental Program Assistant'" <dianaajs@metcohq.com>

Hi Diana,  
Sorry for the delay in response – I was out all of last week.

I've received the notification for the Lindvig Auto & Truck Repair site in West Salem, WI BRRTS # 03-32-120909.

Thank you!

Shar

Sharlene Te Beest  
Hazardous Materials Specialist  
WisDOT- BEES  
4802 Sheboygan Ave Rm 451  
PO Box 7965  
Madison, WI 53707-7965  
Phone 608-266-1476  
Cell 608-692-4546  
e-mail sharlene.tebeest@dot.wi.gov

---

**From:** Diana Symitczek, METCO - Environmental Program Assistant [mailto:dianaajs@metcohq.com]

**Sent:** Wednesday, February 02, 2011 2:45 PM

**To:** TeBeest, Sharlene - DOT

**Subject:** ED Notification of Contamination within the Right of Way - Lindvig Auto & Truck Repair

## **Diana Symitczek - Environmental Program Assistant METCO**

1421 State Road 16  
La Crosse, WI 54601  
608-781-8879 Phone:  
608-781-8893 Fax:  
Email: [dianaajs@metcohq.com](mailto:dianaajs@metcohq.com)

----- Original Message -----

**Subject:** Attached Image

**Date:** Wed, 02 Feb 2011 14:49:21 -0500

**From:** Metco <[dianaajs@metcohq.com](mailto:dianaajs@metcohq.com)>

**To:** Diana - email <[dianaajs@metcohq.com](mailto:dianaajs@metcohq.com)>

Notification of Contamination within the Right of Way

County: La Crosse

Highway: State Highway 16

Site Name: Lindvig Auto & Truck Repair

Site Address: 650 West City Highway 16, West Salem, Wisconsin 54669

BRRTS Number: 03-32-120909

PECFA Number: 54669-1132-50

FID Number: 632094980

Owner's Name: Jerry Ming

Owner's Address: 25212 West Lakeshore Drive, Ingleside, IL 60041

Consulting Firm: METCO

Consultant Contact: Jason Powell

Consultant Address: 1421 State Road 16, La Crosse, WI 54601

Consultant Phone, Fax and E-mail: (608) 781-8879, (608) 781-8893, jasonp@metcohq.com

Soil contamination? Yes

Depth to contaminated soil: 0 feet

Vertical extent of contaminated soil: (e.g. from 0 feet to 14 feet below ground surface)

Groundwater contamination? No

Depth to water table: Not Encountered

Describe the type(s) of contamination present. Gasoline (Leaded and Unleaded)

Brief summary of cleanup activity: Natural Attenuation

Attach a current plume map for groundwater contamination (Not Applicable)

Attach a current plume map for soil contamination