

## GIS REGISTRY INFORMATION

<b>SITE NAME:</b>	Ellingers Wood Flour		
<b>BRRTS #:</b>	03-60-150765	<b>FID #</b>	
<b>COMMERCE #:</b>	53081-4702-23-A	(if appropriate):	
<b>CLOSURE DATE:</b>	August 5, 2008		
<b>STREET ADDRESS:</b>	923 South 21st Street		
<b>CITY:</b>	Sheboygan		
<b>SOURCE PROPERTY GPS COORDINATES</b> (meters in WTM91 projection):	X = 702493	Y = 366040	
<b>CONTAMINATED MEDIA:</b>	Groundwater <input type="checkbox"/>	Soil <input type="checkbox"/>	Both <input checked="" type="checkbox"/>
<b>OFF-SOURCE GW CONTAMINATION &gt;ES:</b>	Yes <input checked="" type="checkbox"/>	No <input type="checkbox"/>	
• <b>IF YES, STREET ADDRESS:</b>	905 South 21 <sup>st</sup> Street		
• <b>GPS COORDINATES</b> (meters in WTM91 projection):	X = 702456	Y = 366051	
<b>OFF-SOURCE SOIL CONTAMINATION</b> >Generic or Site-Specific RCL (SSRCL):	Yes <input type="checkbox"/>	No <input checked="" type="checkbox"/>	
• <b>IF YES, STREET ADDRESS 1:</b>			
• <b>GPS COORDINATES</b> (meters in WTM91 projection):	X =	Y =	
<b>CONTAMINATION IN RIGHT OF WAY:</b>	Yes <input type="checkbox"/>	No <input checked="" type="checkbox"/>	
<b><u>DOCUMENTS NEEDED</u></b>			
Closure Letter, and any conditional closure letter issued or denial letter issued			<input checked="" type="checkbox"/>
Copy of any maintenance plan referenced in the final closure letter			<input type="checkbox"/>
Copy of (soil or land use) deed notice <i>if any required as a condition of closure</i>			<input type="checkbox"/>
Copy of most recent deed, including legal description, for all affected properties			<input checked="" type="checkbox"/>
Certified survey map or relevant portion of the recorded plat map <i>(if referenced in the legal description)</i> for all affected properties			<input checked="" type="checkbox"/>
County Parcel ID number, <i>if used for county</i> , for all affected properties			<input checked="" type="checkbox"/>
Location Map that outlines all properties within contaminated site boundaries on USGS topographic map or plat map in sufficient detail to permit the parcels to be located easily. If groundwater standards are exceeded, the map must also include the location of all municipal and potable wells within 1200' of the site.			<input checked="" type="checkbox"/>
Detailed Site Map(s) for all affected properties, showing buildings, roads, property boundaries, contaminant sources, utility lines, monitoring wells and potable wells. This map shall also show the location of all contaminated public streets, highway and railroad rights-of-way in relation to the source property and in relation to the boundaries of groundwater contamination exceeding ch. NR 140 ESs and soil contamination exceeding ch. NR 720 generic or SSRCLs.			<input checked="" type="checkbox"/>
Tables of Latest Groundwater Analytical Results (no shading or cross-hatching)			<input checked="" type="checkbox"/>
Tables of Latest Soil Analytical Results (no shading or cross-hatching)			<input checked="" type="checkbox"/>
Isoconcentration map(s), <i>if required for site investigation (SI)</i> . The isoconcentration map should have flow direction and extent of groundwater contamination defined. If not available, include the latest extent of contaminant plume map.			<input checked="" type="checkbox"/>
GW: Table of water level elevations, with sampling dates, and free product noted if present			<input checked="" type="checkbox"/>
GW: Latest groundwater flow direction/monitoring well location map (should be 2 maps if maximum variation in flow direction is greater than 20 degrees)			<input checked="" type="checkbox"/>
SOIL: Latest horizontal extent of contamination exceeding generic or SSRCLs, with one contour			<input checked="" type="checkbox"/>
Geologic cross-sections, <i>if required for SI</i>			<input checked="" type="checkbox"/>
RP certified statement that legal descriptions are complete and accurate			<input checked="" type="checkbox"/>
Copies of off-source notification letters (if applicable)			<input checked="" type="checkbox"/>
Letter informing ROW owner of residual contamination (if applicable) (public, highway or railroad ROW)			<input type="checkbox"/>



ENVIRONMENTAL & REGULATORY SERVICES DIVISION  
BUREAU OF PECFA  
9316 North 107th Street  
Milwaukee, Wisconsin 53224-1121  
TDD #: (608) 264-8777  
Fax #: (414) 357-4700  
Jim Doyle, Governor  
Jack L. Fischer, A.I.A., Secretary

August 5, 2008

Mr. Will Neese  
Ellingers Wood Flour  
923 South 21st Street  
Sheboygan, WI 53081

RE: **Final Closure**

**Commerce # 53081-4702-23-A DNR BRRTS # 03-60-150765**  
Ellingers Wood Flour, 923 South 21st Street, Sheboygan

Dear Mr. Neese:

The Wisconsin Department of Commerce (Commerce) has received all items required as conditions for closure of the site referenced above. This case is now listed as "closed" on the Commerce database and will be included on the Department of Natural Resources (DNR) Geographic Information System (GIS) Registry of Closed Remediation Sites to address residual soil and groundwater contamination. It is in your best interest to keep all documentation related to the environmental activities that were conducted.

If residual contamination is encountered in the future, it must be managed in accordance with all applicable state and federal regulations. If it is determined that any remaining contamination poses a threat, the case may be reopened and further investigation or remediation may be required.

Thank you for your efforts to bring this case to closure. If you have any questions, please contact me in writing at the letterhead address or by telephone at (414) 357-4701.

Sincerely,

Lee R. Delcore  
Senior Hydrogeologist  
Site Review Section

cc: M & K Environmental & Soils Drilling, LLC

1485260

W.B.A. 111143

Wisconsin Barbers Association 1986

DOCUMENT NO.

VOL 1525 Page 048

RECORDED SHEBOYGAN COUNTY, WI

Date of Record Registrar In Vol. 1525 of Record on page 4879

71 SEP 11 11:03

REAL ESTATE MORTGAGE (For Consumer or Business Mortgage Transactions)

WILLARD E NEESE, JR. A SINGLE PERSON

Mortgagor, whether one or more mortgages, conveys and warrants to Firststar Bank U.S.A., N.A. 1529 White Oak Drive, Waukegan, IL 60085 (Lender) in consideration of the sum of SEVENTEEN THOUSAND ONE HUNDRED AND NO/100 Dollars (\$17,100.00), loaned or to be loaned to WILLARD E NEESE, JR.

UI1EMU136 0006 JR \$6.00 UI1EN0156 0006 LRIB \$2.00 UI1EN0156 0006 CD LRH \$4.00

(Borrower, whether one or more), evidenced by Borrower's note(s) or agreement dated AUGUST 25, 1997, the real estate described below, together with all privileges, hereditaments, accretions and appurtenances, all rents, leases, issues and profits, all claims, awards and payments made as a result of the exercise of the right of eminent domain, and all existing and future improvements and fixtures (all called the "Property").

1. Description of Property. (This Property is the homestead of Mortgagor.)

LOT NUMBER TWENTY-ONE (21) OF BLOCKI'S SUBDIVISION OF THE CITY OF SHEBOYGAN, ACCORDING TO THE RECORDED PLAT THEREOF. LKA 1604 BLOCKI CT SHEBOYGAN WI

- Check boxes for: If checked here, description continues or appears on attached sheet. If checked here, this Mortgage is a "construction mortgage" under 409.313(1)(a) Wis. Stats. If checked here, Condominium Rider is attached.

2. Title. Mortgagor warrants title to the Property, excepting only restrictions and easements of record, municipal and zoning ordinances, current taxes and assessments not yet due and EXCEPTING OTHER PRIOR OUTSTANDING MORTGAGES OF RECORD, IF ANY.

3. Escrow. Interest will not be paid on escrowed funds if an escrow is required under paragraph 3(a) on the reverse side.

4. Additional Provisions. Mortgagor agrees to the Additional Provisions on the reverse side, which are incorporated herein. The undersigned acknowledges receipt of an exact copy of this Mortgage.

NOTICE TO CUSTOMER IN A TRANSACTION GOVERNED BY THE WISCONSIN CONSUMER ACT (a) DO NOT SIGN THIS BEFORE YOU READ THE WRITING ON THE REVERSE SIDE, EVEN IF OTHERWISE ADVISED. (b) DO NOT SIGN THIS IF IT CONTAINS ANY BLANK SPACES. (c) YOU ARE ENTITLED TO AN EXACT COPY OF ANY AGREEMENT YOU SIGN. (d) YOU HAVE THE RIGHT AT ANY TIME TO PAY IN ADVANCE THE UNPAID BALANCE DUE UNDER THIS AGREEMENT AND YOU MAY BE ENTITLED TO A PARTIAL REFUND OF THE FINANCE CHARGE.

Signed and Sealed AUGUST 25, 1997

Signature of Willard E Neese, Jr. (SEAL)

(Type of Organization) WILLARD E NEESE, JR.

By: (SEAL)

(Title)

By: (SEAL)

(Title)

AUTHENTICATION OR ACKNOWLEDGEMENT

Signatures of STATE OF WISCONSIN County of Manitowish

This instrument was acknowledged before me on AUGUST 25, 1997 by WILLARD E NEESE, JR.

(Name of person(s))

(Type of authority, e.g., officer, trustee, etc., if any)

Title: Member State Bar of Wisconsin or authorized under 706.06, Wis. Stats.

This instrument was drafted by Susan K. Hoppe

Notary Public, Wisconsin My Commission (Expires)(s) 10-19-97

Type or print name signed above.

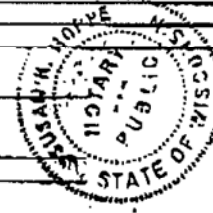

27 129 00

20.00

210180

ELLINGER  
27 129 00

### MARYLAND AVENUE

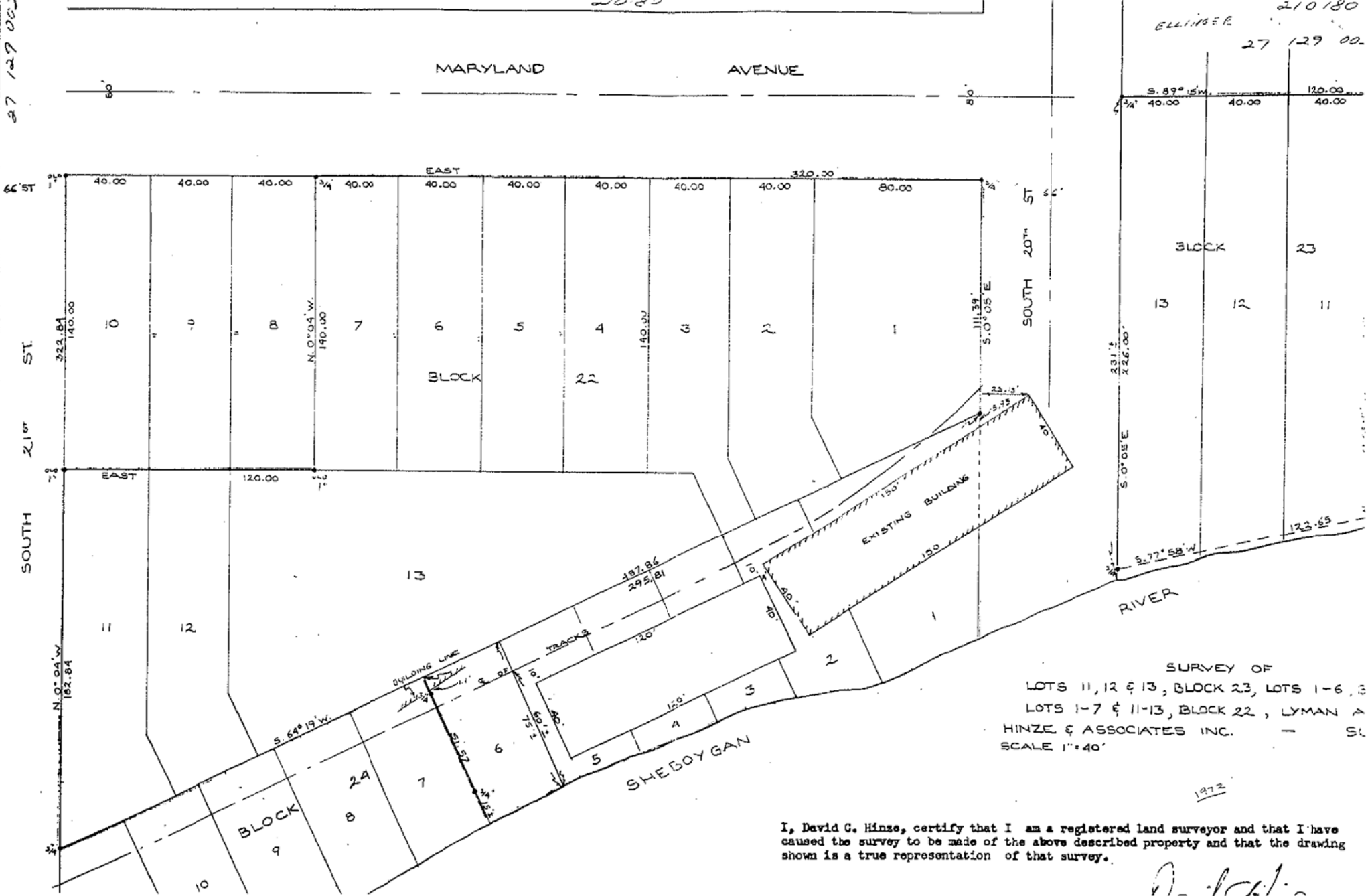

SURVEY OF  
 LOTS 11, 12 & 13, BLOCK 23, LOTS 1-6, 8  
 LOTS 1-7 & 11-13, BLOCK 22, LYMAN A  
 HINZE & ASSOCIATES INC. — ST.  
 SCALE 1" = 40'

1972

I, David G. Hinze, certify that I am a registered land surveyor and that I have caused the survey to be made of the above described property and that the drawing shown is a true representation of that survey.

*D. G. Hinze*

DOCUMENT NO. STATE BAR OF WISCONSIN FORM 1 - 1982

VOL 1325 PAGE 227 THIS SPACE RESERVED FOR RECORDING DATA

1395191

WARRANTY DEED

This Deed, made between Dolores Pohl a/k/a Dolores M. Pohl and Willard Pohl a/k/a Willard W. Pohl, husband and wife,

Grantor, and David Goelzer and Joyce K. Goelzer, husband and wife, as survivorship marital property,

Witnesseth, That the said Grantor, for a valuable consideration of \$1.00 and other good and valuable consideration conveys to Grantee the following described real estate in Sheboygan County, State of Wisconsin:

TRANSFER \$ 30.00 FEE

RECORDED SHEBOYGAN COUNTY, WI

Darius J. Haisel Registrar by Vol. 1325 of Records on page 227

94 JAN 13 AM 27

RETURN TO OKG&C

Tax Parcel No: 210210

Lots Eight (8), Nine (9) and Ten (10), Block Twenty-two (22), Lyman's Addition to the City of Sheboygan, Sheboygan County, Wisconsin.

This Deed is given in fulfillment of a Land Contract between Willard Pohl a/k/a Willard W. Pohl and Dolores Pohl a/k/a Dolores M. Pohl to the Grantee herein, dated 9/8/72 and recorded 9/8/72 in Volume 678 of Records on pages 281/2 as Document No. 951465.

001E#1796	0004	JF:	\$4.00
001E#1796	0004	LRIE	\$2.00
001E#1796	0004	CD LRM	\$4.00
001E#1796	0004	TF	\$30.00

This IS NOT homestead property.

Together with all and singular the hereditaments and appurtenances thereunto belonging; And Dolores Pohl a/k/a Dolores M. Pohl and Willard Pohl a/k/a Willard W. Pohl warrants that the title is good, indefeasible in fee simple and free and clear of encumbrances except municipal and zoning ordinances, recorded easements for public utilities serving the property, recorded building and use restrictions and covenants, general taxes and special assessments levied in the year of closing, and will warrant and defend the same.

Dated this January 5 day of January 5 19 94. Dolores Pohl a/k/a Dolores M. Pohl Willard Pohl a/k/a Willard W. Pohl

AUTHENTICATION

ACKNOWLEDGMENT

Signature(s) authenticated this day of 19

STATE OF WISCONSIN SHEBOYGAN County. Personally came before me this 5th day of January, 19 94, the above named Dolores Pohl a/k/a Dolores M. Pohl and Willard Pohl a/k/a Willard W. Pohl

TITLE: MEMBER STATE BAR OF WISCONSIN (If not authorized by § 706.06, Wis. Stats.)

to me known to be the person who executed the foregoing instrument and acknowledge the same.

THIS INSTRUMENT WAS DRAFTED BY JOEL S. SANDEE OLSEN, KLOPFER, GUNDERSON & CONWAY

By: John N. Gunderson Notary Public Sheboygan County, Wis. My Commission is permanent (if not, state expiration date: January 26 1997)

\*Names of persons signing in any capacity should be typed or printed below their signatures.

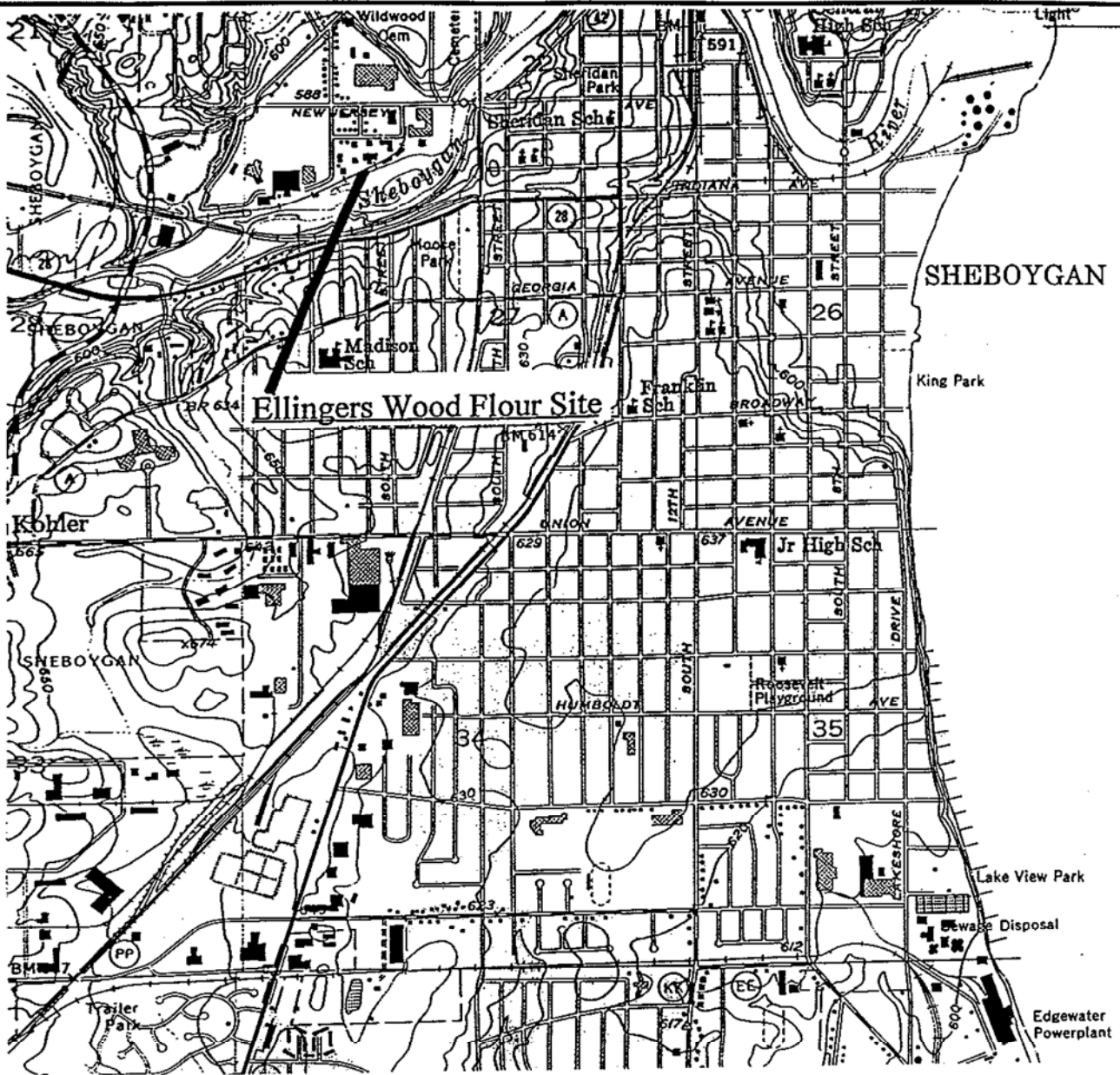

(USGS [1954] 1994) SCALE  
 SHEBOYGAN SOUTH QUADRANGLE 1:24000

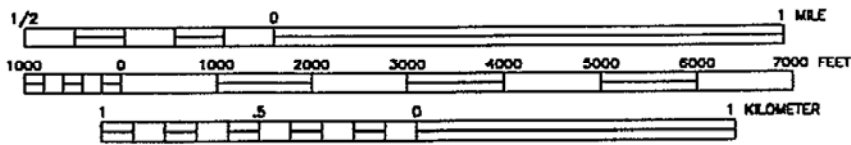

CONTOUR INTERVAL 10 FEET



LOCATION



**ENVIROGEN**

COST EFFECTIVE LEADERSHIP FOR A CLEANER ENVIRONMENT

790 Marvella Lane  
 Green Bay, Wisconsin

SITE LOCATION MAP	FIGURE NO. 1
ELLINGERS WOOD FLOUR SITE SHEBOYGAN, WISCONSIN	

DATE	ENGINEER	DATE	ENGINEER	REVISIONS:	APPROVED BY:	CHECKED BY:	RRT	DRAWN BY:	DRAWING NO.
					ASC	KKB	12/06/99		96.772L21

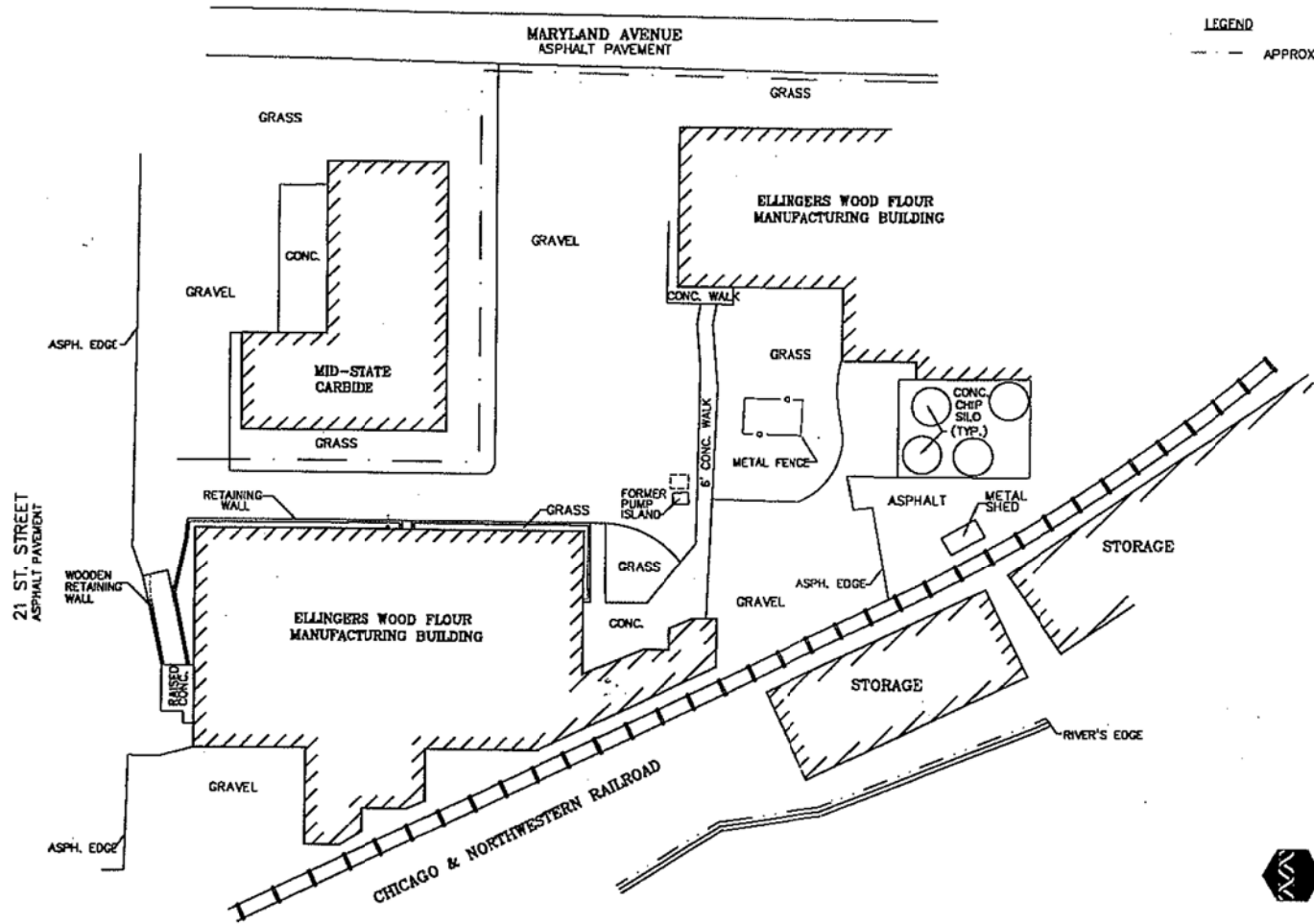

**TANK LEGEND**

☐ FORMER 550-GALLON UNLEADED GASOLINE UST

**LEGEND**

--- APPROXIMATE PROPERTY LINE



DRAWN BY:	RET
DRAWING NO.:	9.C.772L22
CHECKED BY:	RAE
APPROVED BY:	AGL
REVISIONS:	
DESIGNED BY:	
DATE:	

**ENVIROGEN**  
 COST EFFECTIVE LEADERSHIP FOR A CLEANER ENVIRONMENT  
 730 Mervette Lane  
 Green Bay, Wisconsin 54304

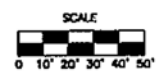

SITE PLAN VIEW	FIGURE NO.
ELLINGERS WOOD FLOUR SITE SHEBOYGAN, WISCONSIN	2

**TABLE 1**  
**Groundwater Sample Laboratory Analytical Results**  
**Ellingers Wood Flour Site**  
**Sheboygan, Wisconsin**

Monitoring Well	Date	GRO	Benzene	Ethyl-benzene	Toluene	Total Xylenes	1,2,4-TMB	1,3,5-TMB	1,2-DCA	MTBE	Naphthalene	Dissolved Lead
MW-1	12/16/97	NA	0.31	<0.068	0.4	0.18	0.15	<0.1	<0.44	<0.18	<0.15	<1
	3/26/98	<100	0.63	0.57	<0.38	<1.0	<0.34	<0.36	NA	<0.21	<0.73	NA
	8/19/98	NA	<b>7.4</b>	0.91	0.84	3.8	1.7	0.6	NA	0.98	1.1	NA
	11/11/98	NA	<0.10	<0.25	<0.10	<0.25	<0.10	<0.10	NA	<0.25	<0.10	NA
	2/24/99	NA	<b>160</b>	8.4	4.8	4.7	3.1	0.89	NA	15	<0.92	NA
	6/11/99	NA	0.56	4.9	0.79	1.87	<0.86	<0.54	NA	0.96	<0.89	NA
	5/3/01	NA	<b>190</b>	35	12	40.8	11	4.1	NA	<0.46	NA	NA
	1/8/02	NA	<b>47</b>	19	23	180	53	15	NA	<0.46	NA	NA
	3/26/03	NA	<b>78</b>	<0.60	2.6	24.7	7.9	1.7	NA	6.2	NA	NA
MW-2	12/16/97	NA	4.3	0.44	0.46	2.0	0.28	0.12	<0.44	<0.18	0.29	<1
	3/26/98	140	2.5	0.62	<0.38	<1.0	<0.34	<0.36	NA	<0.21	<0.73	NA
	8/19/98	NA	1.8	<0.22	<0.20	0.42	<0.22	<0.29	NA	<0.55	<0.46	NA
	11/11/98	NA	<0.10	<0.25	<0.10	<0.25	<0.10	<0.10	NA	<0.25	<0.10	NA
	2/24/99	NA	1.2	<0.22	0.47	0.48	<0.22	<0.29	NA	1	<0.46	NA
	6/11/99	NA	1.2	0.54	<0.21	1.47	<0.86	<0.54	NA	1.5	<0.89	NA
NR 140 ES		NS	5	700	343	620	480		5	60	40	15
NR 140 PAL		NS	0.5	140	68.6	124	96		0.5	12	8	1.5

Notes: All results are reported in ppb  
 Bold indicates NR 140 ES exceedance  
 Italics indicates NR 140 PAL exceedance

GRO: Gasoline range organics    DCA: Dichloroethane  
 TMB: Trimethylbenzene        MTBE: Methyl t-butyl ether  
 NA: Not analyzed                ES: Enforcement standard  
 PAL: Preventive action limit    NS: No standard

(Continued)

Checked by: \_\_\_\_\_

Approved by: \_\_\_\_\_



**TABLE 1 (Continued)**  
**Groundwater Sample Laboratory Analytical Results**  
**Ellingers Wood Flour Site**  
**Sheboygan, Wisconsin**

Monitoring Well	Date	GRO	Benzene	Ethyl-benzene	Toluene	Total Xylenes	1,2,4-TMB	1,3,5-TMB	1,2-DCA	MTBE	Napthalene	Dissolved Lead
MW-3	12/16/97	NA	<0.1	<0.068	2.4	0.15	<0.063	<0.1	<0.44	0.26	<0.15	<1
	3/26/98	<100	<0.25	<0.32	<0.38	<1.0	<0.34	<0.36	NA	<0.21	<0.73	NA
	8/19/98	NA	<0.13	<0.22	<0.20	<0.23	<0.22	<0.29	NA	<0.16	<0.46	NA
	11/11/98	NA	<0.10	<0.25	<0.10	<0.25	<0.10	<0.10	NA	<0.25	<0.10	NA
	2/24/99	NA	<0.13	<0.22	<0.20	<0.23	<0.22	<0.29	NA	<0.16	<0.46	NA
	6/11/99	NA	<0.26	<0.24	<0.21	<1.34	<0.86	<0.54	NA	<0.22	<0.89	NA
MW-4	12/16/97	NA	<0.1	<0.068	0.12	<0.174	<0.063	<0.1	<0.44	0.8	<0.15	<1
	3/26/98	<100	<0.25	<0.32	<0.38	<1.0	<0.34	<0.36	NA	<0.21	<0.73	NA
	8/19/98	NA	<0.13	<0.22	<0.20	<0.23	<0.22	<0.29	NA	<0.16	3.0	NA
	11/11/98	NA	<0.13	<0.22	<0.20	<0.23	<0.22	<0.29	NA	<0.16	<0.46	NA
	2/24/99	NA	<0.13	<0.22	<0.20	<0.23	<0.22	<0.29	NA	<0.16	<0.46	NA
	6/11/99	NA	<0.26	<0.24	<0.21	<1.34	<0.86	<0.54	NA	<0.22	<0.89	NA
NR 140 ES		NS	5	700	343	620	480		5	60	40	15
NR 140 PAL		NS	0.5	140	68.6	124	96		0.5	12	8	1.5

Notes: All results are reported in ppb  
 Bold indicates NR 140 ES exceedance  
 Italics indicates NR 140 PAL exceedance

(Continued)  
 (Continued)

GRO: Gasoline range organics      DCA: Dichloroethane  
 TMB: Trimethylbenzene              MTBE: Methyl t-butyl ether  
 NA: Not analyzed                      ES: Enforcement standard  
 PAL: Preventive action limit        NS: No standard

Checked by: \_\_\_\_\_  
 Approved by: \_\_\_\_\_

**TABLE 1 (Continued)**  
**Groundwater Sample Laboratory Analytical Results**  
**Ellingers Wood Flour Site**  
**Sheboygan, Wisconsin**

Monitoring Well	Date	GRO	Benzene	Ethylbenzene	Toluene	Total Xylenes	1,2,4-TMB	1,3,5-TMB	1,2-DCA	MTBE	Naphthalene	Dissolved Lead
MW-5	12/16/97	NA	<b>460</b>	<i>640</i>	<i>240</i>	<b>2,000</b>	<b>430</b>	<b>110</b>	<22*	<9	<b>75</b>	<b>2'</b>
	3/26/98	10,000	<b>96</b>	<i>530</i>	<i>54</i>	<b>1,700</b>	<b>780</b>	<b>230</b>	NA	<4.2	<b>200</b>	NA
	8/19/98	NA	<b>84</b>	<i>150</i>	<i>32</i>	<i>480</i>	<i>260</i>	<i>77</i>	NA	<3.2	<b>73</b>	NA
	11/11/98	NA	<b>160</b>	<i>350</i>	<i>75</i>	<b>1,200</b>	<b>580</b>	<b>150</b>	NA	<b>62</b>	<b>160</b>	NA
	2/24/99	NA	<b>83</b>	<i>200</i>	<i>37</i>	<i>500</i>	<i>310</i>	<i>63</i>	NA	<b>28</b>	<b>79</b>	NA
	6/11/99	NA	<b>92</b>	<i>270</i>	<i>81</i>	<b>794</b>	<b>400</b>	<b>96</b>	NA	<b>8.6</b>	<b>130</b>	NA
	5/3/01	NA	<b>66</b>	<i>140</i>	<i>26</i>	<i>406</i>	<i>250</i>	<i>82</i>	NA	<4.6	NA	NA
	1/8/02	NA	<b>13</b>	<i>53</i>	<i>15</i>	<i>180</i>	<i>120</i>	<i>40</i>	NA	<0.46	NA	NA
	3/26/03	NA	<i>1.6</i>	<i>36</i>	<i>4.8</i>	<i>269</i>	<i>130</i>	<i>70</i>	NA	<b>3.5</b>	<b>20</b>	NA
MW-6	12/16/97	NA	<b>13</b>	<i>340</i>	<i>12</i>	<b>1,210</b>	<b>670</b>	<b>180</b>	<4.4	<1.8	<b>110</b>	<1
	3/26/98	4,300	<b>130</b>	<i>230</i>	<i>58</i>	<i>580</i>	<i>200</i>	<i>60</i>	NA	<2.1	<b>48</b>	NA
	8/19/98	NA	<b>33</b>	<i>50</i>	<i>14</i>	<i>88</i>	<i>36</i>	<i>6.9</i>	NA	<b>6.4</b>	<i>10</i>	NA
	11/11/98	NA	<b>22</b>	<i>37</i>	<i>8.7</i>	<i>65</i>	<i>21</i>	<i>3.6</i>	NA	<b>5.0</b>	<b>5.5</b>	NA
	2/24/99	NA	<b>6.6</b>	<i>11</i>	<i>2.6</i>	<i>16</i>	<i>5.4</i>	<i>0.92</i>	NA	<b>0.87</b>	<b>2.9</b>	NA
	6/11/99	NA	<b>14</b>	<i>16</i>	<i>3.9</i>	<i>31</i>	<i>12</i>	<i>3.2</i>	NA	<b>2.4</b>	<b>2.7</b>	NA
	1/8/02	NA	<b>45</b>	<i>44</i>	<i>16</i>	<i>47</i>	<i>29</i>	<i>4.7</i>	NA	<4.6	<6.9	NA
	3/26/03	NA	<i>3.9</i>	<i>3.3</i>	<i>0.97</i>	<i>4.24</i>	<0.66	<0.52	NA	<b>1.1</b>	<0.58	NA
NR 140 ES		NS	<b>5</b>	<b>700</b>	<b>343</b>	<b>620</b>	<b>480</b>		<b>5</b>	<b>60</b>	<b>40</b>	<b>15</b>
NR 140 PAL		NS	<i>0.5</i>	<i>140</i>	<i>68.6</i>	<i>124</i>	<i>96</i>		<i>0.5</i>	<i>12</i>	<i>8</i>	<i>1.5</i>

Notes: All results are reported in ppb  
 Bold indicates NR 140 ES exceedance  
 Italic indicates NR 140 PAL exceedance

(Continued)

(<sup>1</sup>): Analyte detected between limit of detection and limit of quantification

GRO: Gasoline range organics

TMB: Trimethylbenzene

NA: Not analyzed

PAL: Preventive action limit

DCA: Dichloroethane

MTBE: Methyl t-butyl ether

ES: Enforcement standard

NS: No standard

Checked by: \_\_\_\_\_

Approved by: \_\_\_\_\_

**TABLE 3**  
**Soil Sample Laboratory Analytical Results**  
**Ellingers Wood Flour Site**  
**Sheboygan, Wisconsin**

Sampling Location	Date	Sample Depth (feet bls)	PID (ppmv)	GRO (ppm)	Benzene	Ethylbenzene	Toluene	1,2,4-TMB	1,3,5-TMB	Total Xylenes	1,2-DCA	Naphthalene	Lead (ppm)
GP-1	10/14/97	14.0 - 16.0	12	<10	<25	<25	<25	<25	<25	<50	<25	<25	9 <sup>1</sup>
GP-8	10/14/97	4.0 - 5.0	<10	<10	<25	<25	<25	<25	<25	<50	<25	30	8 <sup>1</sup>
GP-9	10/14/97	4.0 - 5.0	776	<b>760</b>	<b>4,500</b>	<b>15,000</b>	<b>58,000</b>	120,000	34,000	<b>153,000</b>	<250*	12,000	10 <sup>1</sup>
GP-10	10/14/97	4.0 - 5.0	11	<10	<25	<25	100	59	<25	175	<25	<25	9 <sup>1</sup>
GP-12	10/14/97	4.0 - 5.0	591	<b>10,000</b>	<2,500**	<b>61,000</b>	<b>7,000</b>	130,000	41,000	<b>224,000</b>	<2,500**	16,000	15
GP-13	10/14/97	5.0 - 6.0	<10	<b>620</b>	<250*	<b>3,400</b>	<250*	22,000	6,800	<b>13,600</b>	<250*	2,800	8 <sup>1</sup>
GP-15	10/14/97	3.0 - 4.0	<10	<10	<25	<25	<25	<25	<25	<50	<25	<25	6 <sup>1</sup>
GP-18	10/14/97	5.5 - 6.5	27	11	<b>38</b>	45	27	180	120	180	<25	140	8 <sup>1</sup>
GP-19	10/14/97	3.0 - 4.0	<10	<10	<25	<25	<25	<25	<25	<50	<25	100	13
TB-2	12/9/97	2.0 - 4.0	28	32	<25	28	<25	62	85	290	<25	<25	11 <sup>1</sup>
TB-3	12/9/97	4.0 - 6.0	294	<b>740</b>	<250*	<b>3,800</b>	<250*	43,000	13,000	<b>24,550</b>	<250*	2,400	22
TB-4	12/9/97	4.0 - 6.0	<10	<10	<25	<25	<25	<25	<25	<75	<25	<25	7 <sup>1</sup>
TB-5	12/9/97	4.0 - 6.0	<10	<10	<25	<25	<25	<25	<25	<75	<25	<25	7 <sup>1</sup>
TB-6	12/9/97	6.0 - 8.0	<10	<10	<25	<25	<25	<25	<25	<75	<25	<25	8 <sup>1</sup>
NR 720 Generic Soil Standard				100	5.5	2,900	1,500	NS	NS	4,100	4.9	NS	500

Notes: All results are reported in ppb unless otherwise noted.

Bold indicates value equals or exceeds the NR 720 generic soil standard

Only regulated VOCs with concentrations exceeding reporting limits are listed. For a complete list of compounds analyzed, see Attachment A.

Nonregulated compounds with concentrations above reporting limits included n-butylbenzene, sec-butylbenzene, p-isopropyltoluene, n-propylbenzene, and isopropylbenzene

The official Wisconsin Department of Natural Resources reporting limit for VOCs is 25 ppb

(<sup>1</sup>): Analyte detected between limit of detection and limit of quantification

(<sup>\*</sup>): Sample was diluted by a factor of 10 for laboratory gas chromatograph analysis

(<sup>\*\*</sup>): Sample was diluted by a factor of 100 for a laboratory gas chromatograph analysis

bls: Below land surface

PID: Photoionization detector

GRO: Gasoline range organics

TMB: Trimethylbenzene

DCA: Dichloroethane

NS: No standard

VOC: Volatile organic compound

Checked by: \_\_\_\_\_

Approved by: \_\_\_\_\_

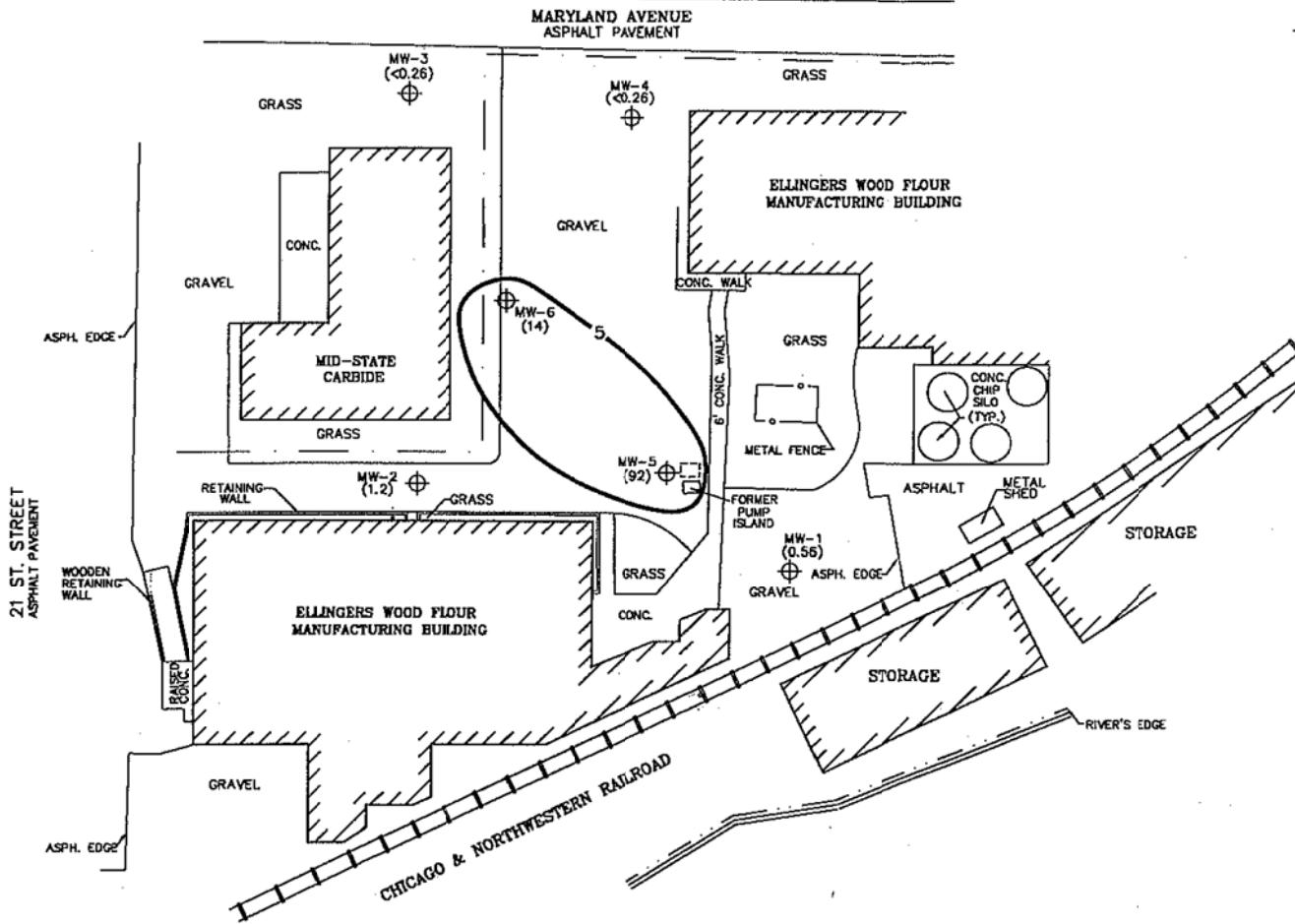

**TANK LEGEND**  
 [ ] FORMER 550-GALLON UNLEADED GASOLINE UST

**LEGEND**  
 - - - APPROXIMATE PROPERTY LINE  
 ⊕ MONITORING WELL  
 ( ) CONCENTRATION IN PPB  
 5 ISOCONCENTRATION CONTOUR

**NOTE:** THE NR140 ENFORCEMENT STANDARD FOR BENZENE IS 5 PPB.



DATE: [ ]  
 CHECKED BY: [ ]  
 REVISIONS: [ ]  
 APPROVED BY: [ ]  
 CHECKED BY: [ ]  
 DATE: 12/08/99  
 DRAWN BY: [ ]  
 DRAWING NO. 96.772L23

**ENVIROGEN**  
 DON'T EFFORTIVE LEADERSHIP FOR A CLEANER ENVIRONMENT  
 730 Marvick Lane  
 Green Bay, Wisconsin 54304

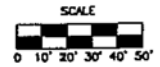

GROUNDWATER BENZENE  
 DISTRIBUTION (G/I 1/99)  
 ELLINGERS WOOD FLOUR SITE  
 SHEBOYGAN, WISCONSIN

FIGURE NO.  
 9

**TABLE 2**  
**Groundwater Elevation Data**  
**Ellingers Wood Flour Site**  
**Sheboygan Wisconsin**

Well	Top-of-Casing	Top-of-Screen Elevation	Date	Top-of-Casing to Water (feet)	Groundwater Elevation
MW-1	585.63	581.87	12/16/97	5.29	580.34
			1/13/98	NM	NM
			3/26/98	5.90	579.73
			8/18/98	5.77	579.86
			8/19/98	5.77	579.86
			10/13/98	6.84	578.79
			11/11/98	7.35	578.28
			2/24/99	7.34	578.29
			6/11/99	7.17	578.46
			5/3/01	8.61	577.02
			1/8/02	8.56	577.07
			3/26/03	9.00	576.63
MW-2	585.83	582.33	12/16/97	5.56	580.27
			1/13/98	5.49	580.34
			3/26/98	4.66	581.17
			8/18/98	4.85	580.98
			8/19/98	4.85	580.98
			10/13/98	5.58	580.25
			11/11/98	5.31	580.52
			2/24/99	5.69	580.14
			6/11/99	4.88	580.95
			5/3/01	5.13	580.70
			1/8/02	6.73	579.10
			3/26/03	7.18	578.65

Notes: Elevations are in feet above mean sea level

(Continued)

Checked by: \_\_\_\_\_  
 Approved by: \_\_\_\_\_

**TABLE 2 (Continued)**  
**Groundwater Elevation Data**  
**Ellingers Wood Flour Site**  
**Sheboygan Wisconsin**

Well	Top-of-Casing	Top-of-Screen Elevation	Date	Top-of-Casing to Water (feet)	Groundwater Elevation
MW-3	586.75	583.74	12/16/97	6.24	580.51
			1/13/98	6.07	580.68
			3/26/98	5.10	581.65
			8/18/98	5.42	581.33
			8/19/98	5.42	581.33
			10/13/98	6.11	580.64
			11/11/98	5.71	581.04
			2/24/99	5.98	580.77
			6/11/99	4.98	581.77
			5/3/01	5.75	581.00
			1/8/02	6.92	579.83
			3/26/03	7.29	579.46
MW-4	585.00	581.75	12/16/97	4.59	580.41
			1/13/98	4.51	580.49
			3/26/98	3.57	581.43
			8/18/98	3.84	581.16
			8/19/98	3.84	581.16
			10/13/98	4.53	580.47
			11/11/98	4.18	580.82
			2/24/99	4.41	580.59
			6/11/99	3.58	581.42
			5/3/01	4.76	580.24
			1/8/02	5.39	579.61
			3/26/03	5.38	579.62

Notes: Elevations are in feet above mean sea level

(Continued)

Checked by: \_\_\_\_\_  
 Approved by: \_\_\_\_\_

**TABLE 2 (Continued)**  
**Groundwater Elevation Data**  
**Ellingers Wood Flour Site**  
**Sheboygan Wisconsin**

Well	Top-of-Casing	Top-of-Screen Elevation	Date	Top-of-Casing to Water (feet)	Groundwater Elevation
MW-5	586.18	583.78	12/16/97	5.37	580.81
			1/13/98	6.98	579.20
			3/26/98	6.22	579.96
			8/18/98	6.29	579.89
			8/19/98	6.29	579.89
			10/13/98	7.31	578.87
			11/11/98	7.81	578.37
			2/24/99	7.83	578.35
			6/11/99	7.59	578.59
			5/3/01	9.10	577.08
			1/8/02	9.10	577.08
			3/26/03	9.57	576.61
MW-6	585.73	582.46	12/16/97	6.86	578.87
			1/13/98	5.31	580.42
			3/26/98	4.39	581.34
			8/18/98	4.63	581.10
			8/19/98	4.63	581.10
			10/13/98	5.36	580.37
			11/11/98	5.07	580.66
			2/24/99	5.36	580.37
			6/11/99	4.53	581.20
			5/3/01	5.50	580.23
			1/8/02	6.34	579.39
			3/26/03	6.55	579.18

Notes: Elevations are in feet above mean sea level

Checked by: \_\_\_\_\_  
 Approved by: \_\_\_\_\_

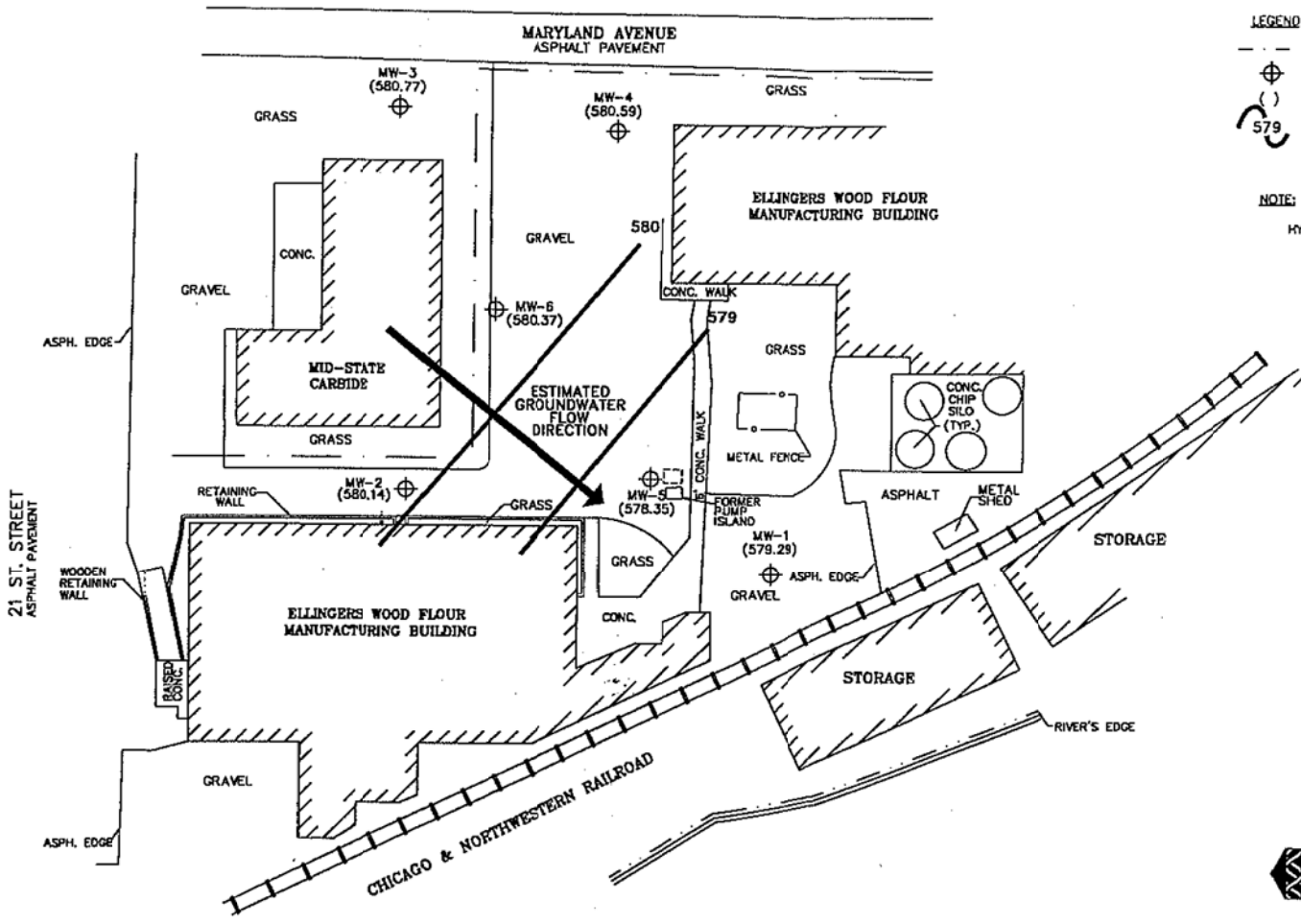

**TANK LEGEND**

FORMER 550-GALLON UNLEADED GASOLINE UST

**LEGEND**

- - - APPROXIMATE PROPERTY LINE
- ⊕ MONITORING WELL
- ( ) GROUNDWATER ELEVATION IN FEET ABOVE MSL
- 579 ISOELEVATION CONTOUR

**NOTE:**

HYDRAULIC GRADIENT (dh/dl) = 0.02 ft/ft



**ENVIROGEN**  
 COST EFFECTIVE LEADERSHIP FOR A CLEANER ENVIRONMENT  
 790 Mendota Lane  
 Grafton, Wisconsin 54304

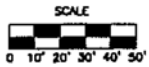

POTENTIOMETRIC SURFACE  
 (2/24/99)  
 ELLINGERS WOOD FLOUR SITE  
 SHEBOYGAN, WISCONSIN

FIGURE NO.  
**5**

DRAWING NO.	96-772L25
DRAWN BY:	RRT
CHECKED BY:	ASL
APPROVED BY:	ASL
REVISIONS:	
ISSUED DATE	
DESIGNED DATE	



TANK LEGEND

☐ FORMER 550-GALLON UNLEADED GASOLINE UST

LEGEND

- - - APPROXIMATE PROPERTY LINE
- ⊕ MONITORING WELL
- ⊕ TEST BORING
- GEOPROBE BORING
- ( ) CONCENTRATION IN ppb
- (NA) NOT ANALYZED
- 25 ISOCONCENTRATION CONTOUR

NOTES: THE NR720 GENERIC SOIL STANDARD FOR BENZENE IS 5.5 ppb. THE OFFICIAL WDNR REPORTING LIMIT IS 25 ppb.  
 GP-1 SOIL SAMPLE WAS TAKEN FROM 14'-16' BELOW LAND SURFACE.  
 REFUSAL WAS EXPERIENCED AT GP-2; THE BORING WAS NOT COMPLETED.  
 GP-1 AND GP-3 THROUGH GP-21 WERE SAMPLED ON 10/14/97.  
 TB-1 THROUGH TB-6 WERE SAMPLED ON 12/8-9/97.  
 MW-1 THROUGH MW-6 WERE NOT SAMPLED.

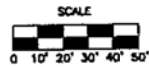
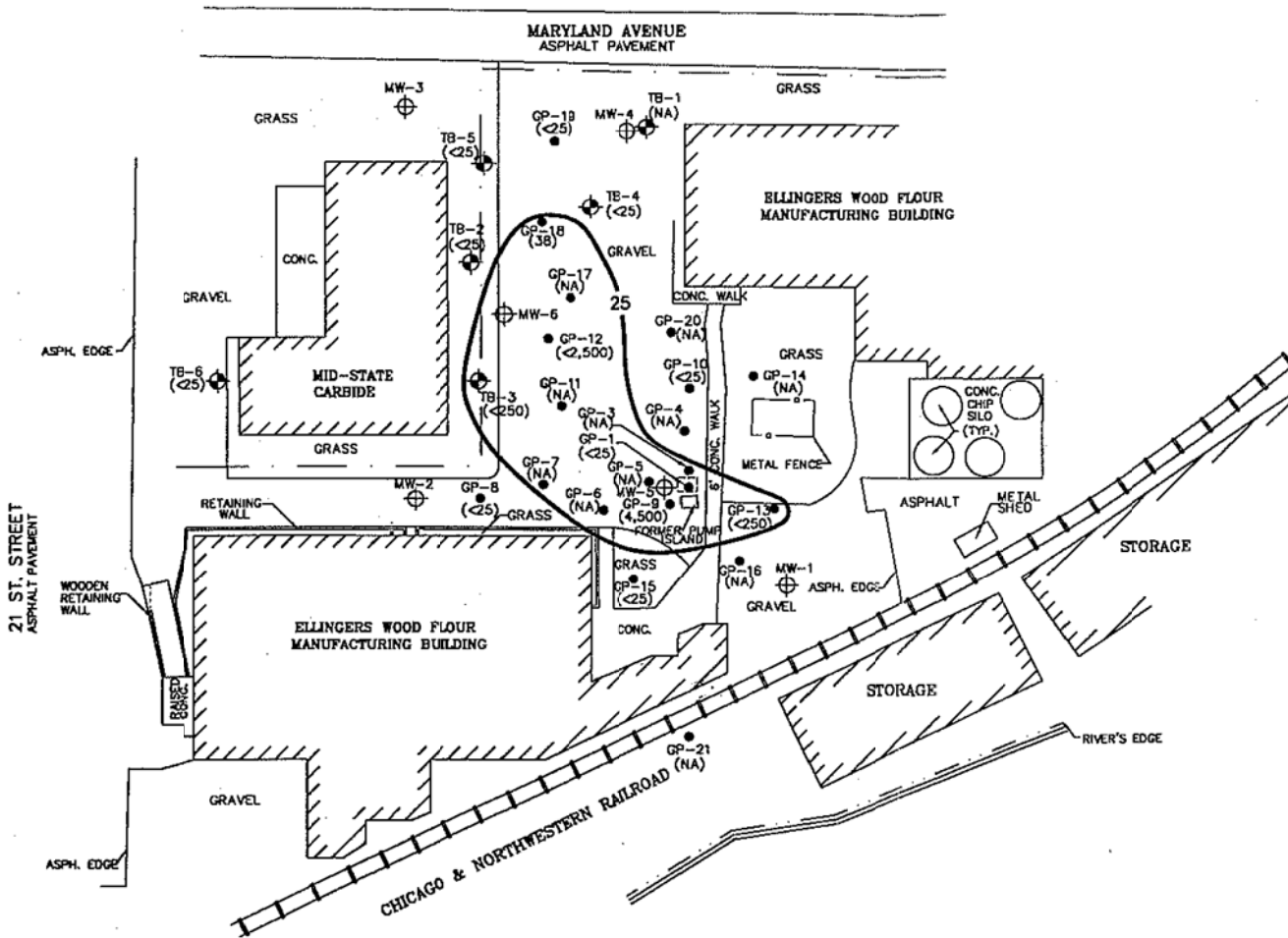

**ENVIROGEN**  
 COST EFFECTIVE LEADERSHIP FOR A CLEANER ENVIRONMENT  
 790 Marvelle Lane  
 Green Bay, Wisconsin 54304

SOIL BENZENE DISTRIBUTION	FIGURE NO.
ELLINGERS WOOD FLOUR SITE SHEBOYGAN, WISCONSIN	7

DRAWING NO.	96.772L27
DRAWN BY:	RKT
CHECKED BY:	JAS
APPROVED BY:	JSC
REVISIONS:	
DATE	
PROJECT	

ELEVATION IN FEET ABOVE MSL.

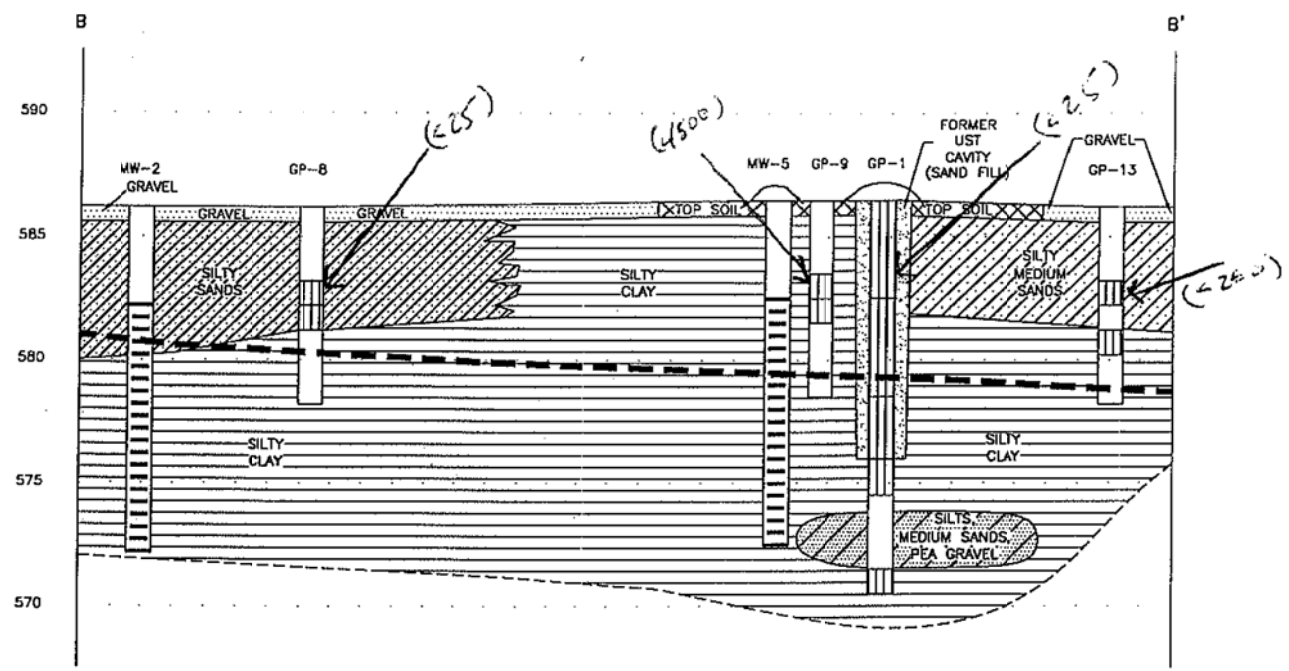

PLAN VIEW

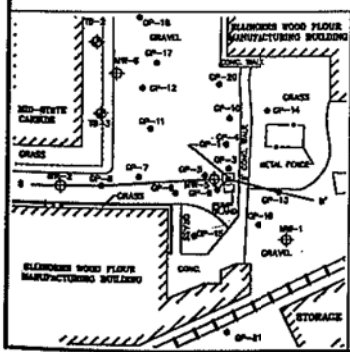

- LEGEND
- SAMPLE INTERVAL
  - SCREENED INTERVAL
  - GROUNDWATER TABLE (1/13/98)

( ) Benzene conc ppb

SCALE

HORIZONTAL: 1" = 20'  
 VERTICAL: 1" = 5'



GEOLOGIC CROSS-SECTION B-B'		FIGURE NO.
ELLINGERS WOOD FLOUR SITE SHEBOYGAN, WISCONSIN		4

DRAWING NO.	96-772L24
DRAWN BY:	RKT
CHECKED BY:	KAZ
APPROVED BY:	ASL
REVISIONS:	
DATE	
DATE	
DATE	

## CERTIFICATE OF LEGAL DESCRIPTION

I hereby certify on behalf of Mr. Willard Neese, the responsible party, the legal description provided below is a true and accurate description of the property located at 923 21<sup>st</sup> Street, City of Sheboygan, Sheboygan County, Wisconsin.

Lot number twenty-one (21) of Blocki's subdivision of the City of Sheboygan. According to the recorded plat thereof. LKA 1604 Blocki CT Sheboygan, WI

PARCEL ID NUMBER 707-640

*Erma Baran (Erma Baran Inc)*  
Signature

9/3/03  
Date

## GEOGRAPHIC POSTIONING

The Geographic Position of the contaminated site boundary based upon the WTM91 Interactive Map is 702493, 366040.

August 30, 2007

Mid States Carbide, Inc.  
905 S. 21<sup>st</sup> Street  
Sheboygan, WI 53081

Subject: **Notification of Ground Water Contamination  
Exceeding Enforcement Standard  
Ellingers Wood Flour/Ellingers Realty Inc.**  
WDNR: 03-60-150765  
DCOMM No.: 53081-4702-23

Dear Sir or Madam,

Ellingers Wood Flour has conducted investigation and remediation of soil and groundwater at the site at 923 S. 21<sup>st</sup> Street in Sheboygan. This investigation was completed in response to the discovery of petroleum contamination on the property. Based on available data, groundwater contamination appears to exist under your property at 905 S. 21<sup>st</sup> Street. The levels of benzene contamination detected at a point near your east property line (monitoring well MW6) have, at times, exceeded the State groundwater Enforcement Standard (ES) found in Chapter NR140, Wisconsin Administrative Code (WAC). The ES for benzene is 5 ug/L. No other ES exceedances were observed since 1997 at MW6, which was adjacent to your east property line.

The environmental consultants who investigated this contamination feel that the groundwater contaminant plume is stable or receding and will naturally degrade over time. Ellingers believes that allowing natural attenuation to complete the cleanup at this site meets the requirements for case closure that are found in Chapter Comm 46, WAC. The Wisconsin Department of Commerce accepts natural attenuation as the final remedy for this site and is granting case closure. Closure means that the Department will not be requiring any further investigation or cleanup action to be taken, other than the reliance on natural attenuation.

Since the source of the groundwater contamination has not been demonstrated to be on your property, neither you nor any subsequent owner of your property will be held responsible for investigation or cleanup of the groundwater contamination with respect to WDNR Case #03-60-150765, as long as you and any subsequent owners comply with the requirements of Section 292.13, Wisconsin Statutes, including allowing access to your property for environmental investigation or cleanup if access is required. To obtain a copy of the Department of Natural Resources' Publication #RR-589, Fact Sheet 10: *Guidance for Dealing with Properties Affected by Off-Site Contamination*, you may visit <http://www.dnr.state.wi.us/org/aw/rr/archives/pubs/RR589.pdf>, or call 608-267-3859.

The Department of Commerce will not officially close this case for 30 days after the date of this letter. As an affected property owner, you have a right to contact the Department to provide any

Mid States Carbide  
August 30, 2007  
Page 2

technical information that you may have that indicates that closure should not be granted for this site. If you would like to submit any information to the Department of Commerce that is relevant to the closure request, mail that information to Ms. Monica Weis, Wisconsin Department of Commerce, 9316 N 107th St, Milwaukee, WI 53224-1121. You can also contact Ms. Weis at 414-357-4705.

If this case is closed, all properties within the site boundaries where groundwater contamination exceeds Chapter NR140 groundwater Enforcement Standards will be listed on the Department of Natural Resources' Geographic Information System (GIS) Registry of Closed Remediation Sites. The information on the GIS Registry includes maps showing the location of properties in Wisconsin where groundwater contamination above Chapter NR140 Enforcement Standards was found at the time that the case was closed. This GIS Registry will be available to the general public on the Department of Natural Resources' internet web site.

Once the Department makes a decision on the closure request, it will be documented in a letter. You may obtain a copy of that letter by writing to the agency address given above, or by accessing the WDNR GIS Registry of Closed Remediation Sites on the internet at <http://www.dnr.wi.gov/org/aw/rr/gis/index.htm>. A copy of the closure letter is included as part of the site file on the GIS Registry of Closed Remediation Sites.

Should you or any subsequent property owner wish to construct or reconstruct a well on your property, special well construction standards may be necessary to protect the well from the residual groundwater contamination. Any well driller who proposes to construct a well on your property in the future will first need to obtain approval from a regional water supply specialist in WDNR's Drinking Water and Groundwater Program. The well construction application, form 3300-254, is on the internet, or may be accessed through the GIS Registry web address given above.

If you need more information or have any questions, please call Ms. Monica Weis of WDComm at 414-357-4705.

Sincerely,

Mr. Will Neese

This letter received by:

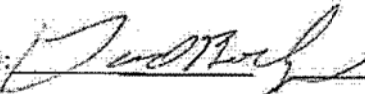

on

8-30-07