

LEGEND

- ◆ MONITORING WELL LOCATION
- ★ PIEZOMETER LOCATION
- ✦ SOIL PROBE/TEMPORARY WELL LOCATION
- ✦ SOIL VAPOR SAMPLE LOCATION
- ✖ ABANDONED MONITORING WELL LOCATION
- ✖ APPROXIMATE FORMER TEMPORARY WELL LOCATION (FORMER McDONALDS PROPERTY)
- ⊙ MONITORING WELL LOCATION (MATANAER SITE)

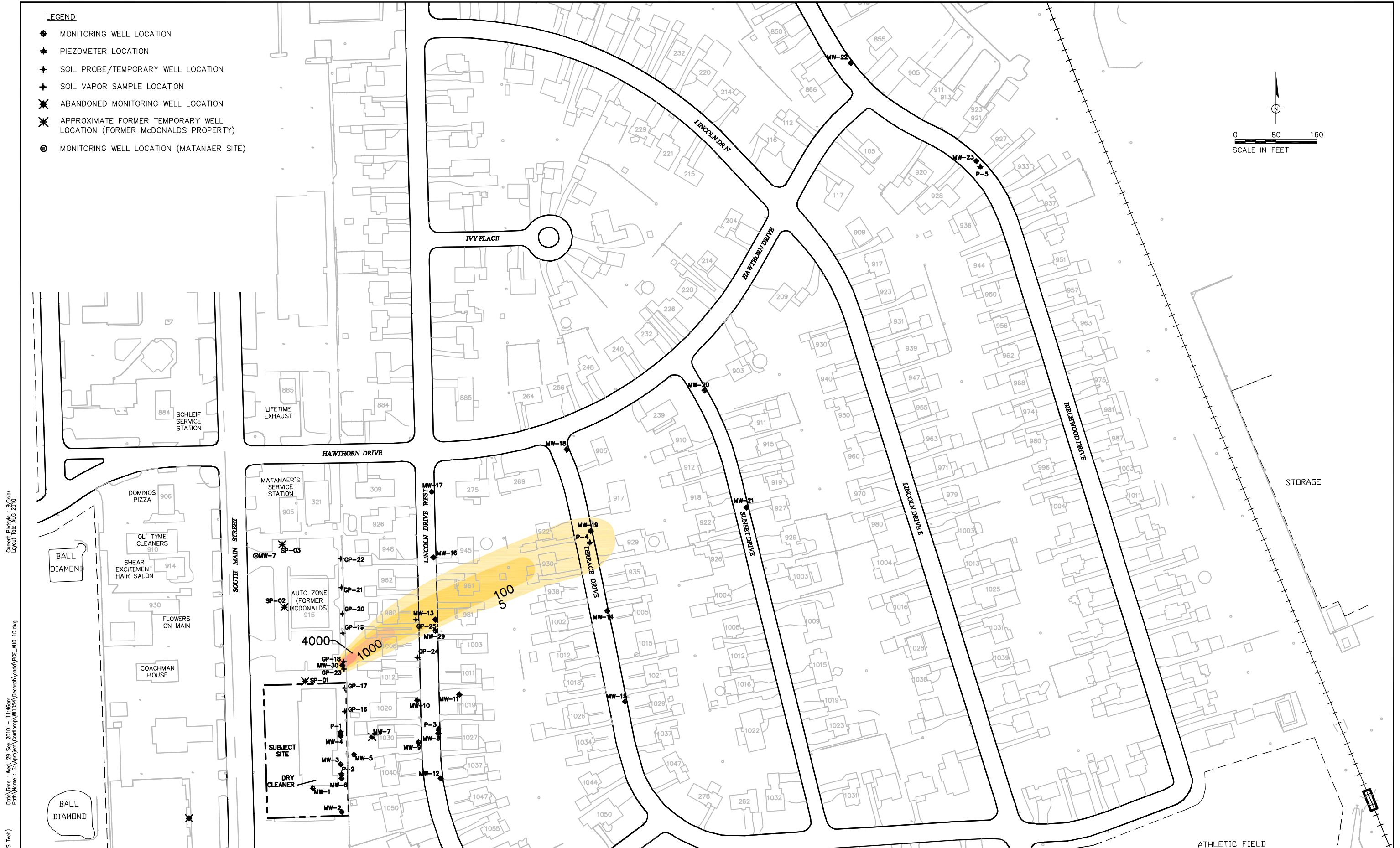
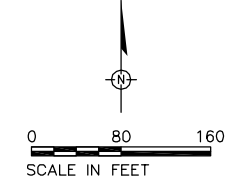

Date/Time : Wed, 29 Sep 2010 - 11:46am  
 Path/Name : C:\projects\Conti\proj\W1054\Decorah\load\pce\_aug\_10.dwg  
 Acad Version : R16.0a (LMS Tech)  
 User Name : cmaesoug  
 Current PlotStyle : BkColor  
 Layout Tab: AUG 2010

ORIGINAL DRAWING SOURCE:  
 KEY ENGINEERING GROUP, LTD., JULY 28, 2003.

REV.	ISSUED DATE	DESCRIPTION

126 North Jefferson Street, Suite 400  
 Milwaukee, Wisconsin 53202  
 Tel: 414-276-7742 Fax: 414-276-7603  
 www.arcadis-us.com

**SUMMARY OF GROUNDWATER PCE  
 ANALYTICAL RESULTS, AUGUST 2010  
 DECORAH SHOPPING CENTER ANNEX  
 WEST BEND, WISCONSIN**

PROJECT MANAGER <b>J. BANWANTINE</b>	DEPARTMENT MANAGER <b>M. MAERLE</b>	LEAD DESIGN PROF.	CHECKED BY <b>D. GABARDI</b>
SHEET TITLE		TASK/PHASE NUMBER <b>0001.00001</b>	DRAWN BY <b>C. MCKEOUGH</b>
PROJECT NUMBER <b>W1001054</b>		DRAWING NUMBER <b>2</b>	