

State of Wisconsin \ DEPARTMENT OF NATURAL RESOURCES

Tommy G. Thompson, Governor
George E. Meyer, Secretary
Scott Humrickhouse, Regional Director

West Central Region Headquarters
1300 W. Clairemont Avenue
PO Box 4001
Eau Claire, WI 54702-4001
TELEPHONE 715-839-3700
FAX 715-839-6076/1605
TTY 715-839-2786

October 2, 1997

R&R Case# 02-18-151537
Eau Claire County

Mr. Robert Nuss
Mack Trucks of Rochester
P.O. Box 6699
Rochester, MN 55903

SUBJECT: Petroleum Contamination at the Eau Claire Mack Truck Facility
Located at 2412 Frank St., Eau Claire, Wisconsin

Dear Mr. Nuss:

On August 13, 1997, I received the results of the environmental remedial action which you completed at the above referenced site, from your consultant, Cedar Corporation. On August 26, 1997, I received the additional information clarifying issues which I had discussed with Cedar Corporation related to your remedial action. Based on the information which you have provided, I have determined that the remedial action taken at this site meets the requirements of ch. NR 708, Wis. Adm. Code, and that all actions necessary to remediate the soil contamination which you have reported, have been completed in compliance with chs. NR 708 and NR 720, Wis. Adm. Code.

Consequently, the Department finds that no further action is needed at this site, pursuant to s. NR 708.09, Wis. Adm. Code. The Department may require additional response actions if future information indicates that this site poses a threat to public health, safety, welfare or the environment.

I appreciate your concern and cooperation in this matter. If you have any questions about this letter, please feel free to contact me at (715) 839-1602.

Sincerely,



Doug Joseph
Hydrogeologist

enclosures

c: Mr. Matt Taylor, Cedar Corp., 604 Wilson Ave., Menomonie, WI 54751

ERP CASE

Department of Natural Resources

LEAKING UNDERGROUND STORAGE TANK (Case Tracking)
Form 4400-146 Rev. 2-93



UID Number: <u>02-18-151537</u>		FID Number: <u>618086150</u>		PMN Number:
County: <u>EAU CLAIRE</u>		Initial Contact Date: <u>6, 19, 97</u>		
Site Name: <u>EAU CLAIRE MACK SALES</u>		Date RPLetter Sent: <u>6, 25, 97</u>		
Address: <u>2712 FRANK ST.</u>		Date Closure Approved: <u>10, 2, 97</u>		
<u>EAU CLAIRE, WI 54903</u>				
Municipality: <u>EAU CLAIRE</u>		Person/Firm Reporting: <u>BOB NUSS, E.C. MACK SALES</u>		
Legal Descript.: <u>SE 1/4 NW 1/4 sec. 13 T 27 N R 10 (E/W)</u>		Phone Number: <u>(715) 834-2665</u>		
Lat.: _____ Long.: _____				

Priority Screening	Scoring Criteria	Funding Source	Effective Date	LUST Trust Eligible
<input type="checkbox"/> 1 = High	1. _____	<input checked="" type="checkbox"/> 1 = RP	<input type="checkbox"/> / <input type="checkbox"/> / <input type="checkbox"/>	<input type="checkbox"/> 1 = Federal
<input type="checkbox"/> 2 = Medium	2. _____	<input type="checkbox"/> 2 = LTF	<input type="checkbox"/> / <input type="checkbox"/> / <input type="checkbox"/>	<input checked="" type="checkbox"/> 2 = Non-Federal
<input type="checkbox"/> 3 = Low	3. _____	<input type="checkbox"/> 3 = EF	<input type="checkbox"/> / <input type="checkbox"/> / <input type="checkbox"/>	
<input checked="" type="checkbox"/> 4 = Unknown	4. _____	<input type="checkbox"/> 4 = Other	<input type="checkbox"/> / <input type="checkbox"/> / <input type="checkbox"/>	
	5. _____			
Score: _____ Init.: _____ Date: _____				

Case Status

	Start Date	End Date
<input type="checkbox"/> (F) Free Product Removal	<input type="checkbox"/> / <input type="checkbox"/> / <input type="checkbox"/>	<input type="checkbox"/> / <input type="checkbox"/> / <input type="checkbox"/>
<input type="checkbox"/> (E) RP Emergency Response	<input type="checkbox"/> / <input type="checkbox"/> / <input type="checkbox"/>	<input type="checkbox"/> / <input type="checkbox"/> / <input type="checkbox"/>
<input type="checkbox"/> (R) LTF Emergency Response	<input type="checkbox"/> / <input type="checkbox"/> / <input type="checkbox"/>	<input type="checkbox"/> / <input type="checkbox"/> / <input type="checkbox"/>
<input type="checkbox"/> (L) Long Term Monitoring	<input type="checkbox"/> / <input type="checkbox"/> / <input type="checkbox"/>	<input type="checkbox"/> / <input type="checkbox"/> / <input type="checkbox"/>

Responsible Party

Contact Person: BOB NUSS

Company Name: MACK TRUCKS OF ROCHESTER

Address: P.O. BOX 6699
ROCHESTER, MN 55903

Phone Number: (800) 562-1505

CC's: _____

Impacts

Enter "P" for potential and "K" for known

(1) Fire/Explosion Threat

(2) Contaminated Private Well(s) _____ # of Wells

(3) Contaminated Public Well

(4) Groundwater Contamination

(5) Soil Contamination

(6) Other: _____

(7) Surface Water Impacts

(9) Floating Product

Consultant

Contact Name: MATT TAYLOR

Company Name: CDMA CORP.

Address: 607 WILSON AVE.
MONOMONIE, WI 54951

Telephone: (915) 235-9081

Substances	# Tank(s)	Size
<input type="checkbox"/> (1) Leaded Gas	_____	_____
<input type="checkbox"/> (2) Unleaded Gas	_____	_____
<input checked="" type="checkbox"/> (3) Diesel	_____	_____
<input type="checkbox"/> (4) Fuel Oil	_____	_____
<input type="checkbox"/> (5) Unkwn Hydrocrbn	_____	_____
<input type="checkbox"/> (8) Other	_____	_____
<input checked="" type="checkbox"/> (12) Waste Oil	_____	_____

PRIORITY SCREENING WORKSHEET

HIGH FACTORS: (DEFINITION: Any case which presents an actual threat to human health, or has a high potential of causing a threat to human health and property, and/or any case which has caused or has a high potential of causing substantial impacts to the soil, water and air of the State of Wisconsin).

EMERGENCY FACTORS:

- Contaminated private or public well >NR 140 enf. std.
- Explosive or toxic vapors in structures
- Threat of fire

HIGH FACTORS:

- Floating product (including sheen)
- GW contamination (>140 enf. std.)
- Impacted surface water -- wetland, trout stream, etc. impacted
- Saturated soil contamination posing ^{significant} risk to groundwater *

* e.g. >1500 ppm GRO/DRO and gw < 25'

MEDIUM FACTORS: (DEFINITION: Any case which does not appear to be an immediate threat to human health or vital natural resources but which shows levels of contamination that may cause substantial environmental impacts if left unaddressed.)

- Moderate soil contamination with potential for impacting groundwater.
- Impacted surface water -- no critical habitat threats.
- Groundwater contamination >NR 140 PAL.

LOW FACTORS: (DEFINITION: Any case where contamination has been documented, but which presents limited potential for immediate threat to human health and vital natural resources.)

- Soil contamination which appears to have a limited potential for impacting groundwater.
- Initial Remedial action has substantially reduced environmental threat.

UNKNOWN FACTORS: (DEFINITION: Any case where some indication of contamination is present, but due to incomplete or inaccurate information the level of threat to human health or the environment can not be assessed at this time.)

- Inadequate information to assign a high, medium, or low ranking.

NUMERICAL LUST SCORING WORKSHEET

1. **GROUNDWATER & SOILS:**

POINTS:

- 20 Municipal well impacted
- 18 >6 private wells impacted
- 16 4 - 6 private wells impacted
- 14 2 - 3 private wells impacted
- 12 1 private well impacted

- Points:
 "Major Soil" \approx GRO/DRO > 3500 ppm and gw < 25'
 10 "Major soil" and/or gw > ES within 1200' of a public well
 8 "Major soil" and/or gw > ES within 1200' of one or more private wells
 6 Groundwater contamination > ES
 4 Groundwater contamination < ES
 2 Soil contamination

For purposes of this scoring private well includes any non-municipal water supply system (e.g. non-community and other than municipal)

2. **EXPLOSIVE OR TOXIC VAPORS:**

- POINTS: **CONFIRMED**
- 20
 - 16
 - 12

- "POTENTIAL"**
- 10
 - 8
 - 6

"Potential" applies if gw or confining layer < 12' from surface
 "Potential Explosive" applies if free product
 "Explosive" levels in a residence or building or GRO > 7,500 ppm
 "Explosive" levels in a sewer or other confined space
 Toxic levels in a residence or building

NOTE: Explosive levels determined to be >20% LEL as per an explosivity meter, toxicity levels are based on OSHA permissible exposure limits (PEL's)

3. **SURFACE WATER IMPACTS:**

- POINTS: **CONFIRMED**
- 14
 - 10
 - 6

- "POTENTIAL"**
- 7
 - 5
 - 3

Apply if surface water < 200' from site) and
 (free product observed in gw, or if GRO/DRO > 7,500 ppm)
 Visible sheen or product on sensitive surface water environment (e.g. wetland, trout stream)
 Visible sheen or product on non-sensitive surface water area
 Exceedance of NR 102, 103 or 104 surface water quality standards.

Request assistance from District Water Resources staff in evaluating surface water impacts.

4. **HYDROGEOLOGIC SETTING:**

Points:

- 12 Permeable stratigraphy (gravel, sand, fractured bedrock or utilities capable of intercepting and directing flow) and groundwater within 25 feet of the ground surface.
- 10 Permeable stratigraphy and groundwater greater than 25 feet below ground surface.
- 8 Moderately permeable stratigraphy (silty sands, silty gravel, clayey sands) and groundwater within 25 feet of ground surface
- 6 Moderately permeable stratigraphy and groundwater greater than 25 feet below ground surface.
- 4 Low permeability stratigraphy (silt, clayey silt, sand clays) and groundwater within 25 feet of ground surface
- 2 Low permeability stratigraphy and groundwater greater than 25 feet below ground surface

5. **TYPE OF PRODUCT Released (Assign the score most applicable):**

- POINTS: *FREE PRODUCT Type of PRODUCT
- 12
 - 8

Gasoline, mixture of gasoline and other products, other light petroleum products

August 22, 1997

RECEIVED

AUG 26 1997

Mr. Doug Joseph
WDNR - Western District
PO Box 4001
Eau Claire, WI 54702-4001

SUBJECT: Mack Truck Facility, 2412 Frank Street, Eau Claire, WI
WDNR R&R Case #02-18-151537

Dear Mr. Joseph:

This letter serves as a follow-up to our phone conversation of August 21, 1997, regarding the remedial activities that took place at the site and were reported in Cedar Corporation's letter of August 11, 1997.

In regards to your request for clarification on the remediation of the waste oil surface release off the northeast corner of the building, post excavation soil samples were not collected based on the following:

1. Size of the surface stain - the waste oil stain was approximately 2.5 feet in diameter.
2. Analytical results from the Phase 1 Assessment - the soil sample collected at depth in boring B-8 (through the center of the surface stain) had no detections of DRO, VOCs, or PNAs.
3. The area was over-excavated - an area of 5' x 5' x 4.5' deep was removed to encompass the observed surficial staining.

Further clarification was also requested regarding the identification of sample collection depth for the Phase I results presented in Table 1 of the August 11th letter. The samples from boring B-8 were identified as 8-1 and 8-5 and presented as being collected at a depth of 1 and 5 feet below ground surface (bgs). The presentation of collection depth for soil samples from boring B-8 is inaccurate. The soil samples were actually collected at 0.5 and 4 feet bgs. The error in presentation is attributed to the sample intervals for other borings completed during the Phase I which were sampled from 1 to 5 feet bgs being carried through to labeling of the sample interval in boring B-8. A 48" "Macro-Core" Geoprobe® sampler was utilized in all of the borings completed during the Phase I. Sample collection in B-8 was from surface to 4 feet bgs.

Cedar Corporation apologizes for any confusion this may have caused and presents the above discussions as clarification in this matter. If you have any further questions regarding this project, please feel free to call me at 715-235-9081.

Sincerely,

CEDAR CORPORATION



Matt Taylor
Hydrogeologist

MAT/jlk

cc: Mr. Robert Nass
Mack Truck of Rochester, Inc.
PO Box 6699
Rochester, MN 55903

CEDAR CORPORATION
 604 Wilson Avenue
 MENOMONIE, WISCONSIN 54751

LETTER OF TRANSMITTAL

715-235-9081 800-472-7372
 FAX 715-235-2727

TO WDNR
P.O. Box 4001
E.C. WI 54702-4001

DATE	8-12-97	JOB NO.
ATTENTION	Doug Joseph	
RE:	Mack Truck - 2412 Frank St. 02-18-151537	

RECEIVED
 AUG 13 1997
 DNR WD

WE ARE SENDING YOU Attached Under separate cover via _____ the following items:
 Shop drawings Prints Plans Samples Specifications
 Copy of letter Change order _____

COPIES	DATE	NO.	DESCRIPTION

THESE ARE TRANSMITTED as checked below:
 For approval Approved as submitted Resubmit _____ copies for approval
 For your use Approved as noted Submit _____ copies for distribution
 As requested Returned for corrections Return _____ corrected prints
 For review and comment _____
 FOR BIDS DUE _____ 19 _____ PRINTS RETURNED AFTER LOAN TO US

REMARKS Doug if you have any questions please feel free to call me at 800-472-7372.
Matt

COPY TO _____
 SIGNED: _____

If enclosures are not as noted, kindly notify us at once.

August 11, 1997

RECEIVED
AUG 13 1997
DNR - WVD

Mr. Doug Joseph
Wisconsin DNR-Western District
P.O. Box 4001
Eau Claire, WI 54702-4001

RE: Results of Environmental Remedial Action at Eau Claire Mack Sales, 2412 Frank Street,
Eau Claire, WI (WDNR R&R Case #02-18-151537)

Dear Mr. Joseph:

Cedar Corporation, on behalf of Mack Trucks of Rochester, Inc., has completed an environmental remedial action at the above-referenced site located in Eau Claire (Figure 1). The remedial action was conducted in response to soil contamination discovered during a modified Phase 1 Environmental Property Assessment completed in May 1997 by Cedar Corporation. The remedial action consisted of the excavation and disposal of contaminated soil and post excavation soil sampling for field screening and laboratory analysis.

The Phase 1 Assessment determined two areas of soil contamination on the property. Residual Contaminant Levels (RCLs) for petroleum parameters exceeded the Wisconsin Department of Natural Resources (WDNR) allowable levels. One of the areas is located inside the shop area adjacent to a floor drain and the sump for the floor drain system. The other area is outside of the northeast corner of the building where a small waste oil surface spill had occurred. Through laboratory analysis of soil samples collected during the Phase 1 Assessment (presented in Tale 1), these two areas were determined to have levels of Diesel Range Organics (DRO) in exceedance of the WDNR's 100 mg/kg RCL for sandy soil. Based on the pending sale of the property, Mack Trucks of Rochester, Inc. decided to remediate the site by excavation and disposal of the contaminated soil.

The remediation field work completed on July 17, 1997, consisted of excavation of 26.62 tons of contaminated soil and collection of soil samples for separate field screening and laboratory analysis. Laboratory samples from the base and sidewalls of the excavation inside the building were analyzed for DRO, Volatile Organic Compounds (VOCs) and Polynuclear Aromatic Hydrocarbons (PNAs). In addition, a Total Organic Carbon (TOC) sample was collected and analyzed due to the relatively high organic matter content of the surrounding loamy soils, and the known propensity for some organic matter to return low level false positives on DRO analysis.

An estimated 15 cubic yards of contaminated soil was removed inside the building and four cubic yards of contaminated soil was removed where the waste oil surface spill occurred. The areas of excavation are presented in Figure 2. The contaminated soils were disposed of at the Seven Mile Creek Biopile.

August 11, 1997

Page two

The results of post-excavation soil samples collected for laboratory analysis indicate that low level DRO responses were reported in all samples collected except for the "East wall." The levels of DRO detected ranged from 22.6 mg/kg in the "West wall" sample to 6.74 mg/kg in the "North wall" sample. No VOCs were detected in any of the post-excavation samples analyzed. PNA analysis indicated low level responses in all of the samples except for the "North wall" sample. The levels of DRO and PNA compounds in those samples that did have detections are well below the NR 720 RCLs and Interim PAH guidance. The pre-excavation analytical results are attached as Table 1 and the post-excavation results as Table 2. The complete analytical reports for the post-excavation samples are attached.

The results of the Total Organic Carbon analysis indicated that 2900 mg/kg or 0.29% of the soil was comprised of organic carbon matter.

Based on the results of soil samples collected during the modified Phase 1 and post-excavation sampling, Cedar Corporation feels that the areas determined to have contamination exceeding NR 720 residual contaminant levels have been remediated. In addition, Cedar Corporation feels the site warrants no further action and should be granted case closure. If you should have any questions regarding this project, please feel free to contact me at 715-235-9081.

Sincerely,

CEDAR CORPORATION



Matt Taylor
Hydrogeologist

MT:srb
Enclosure

cc: Mr. Bob Nuss
Mack Trucks of Rochester, Inc.
P.O. Box 6699
Rochester, MN 55903

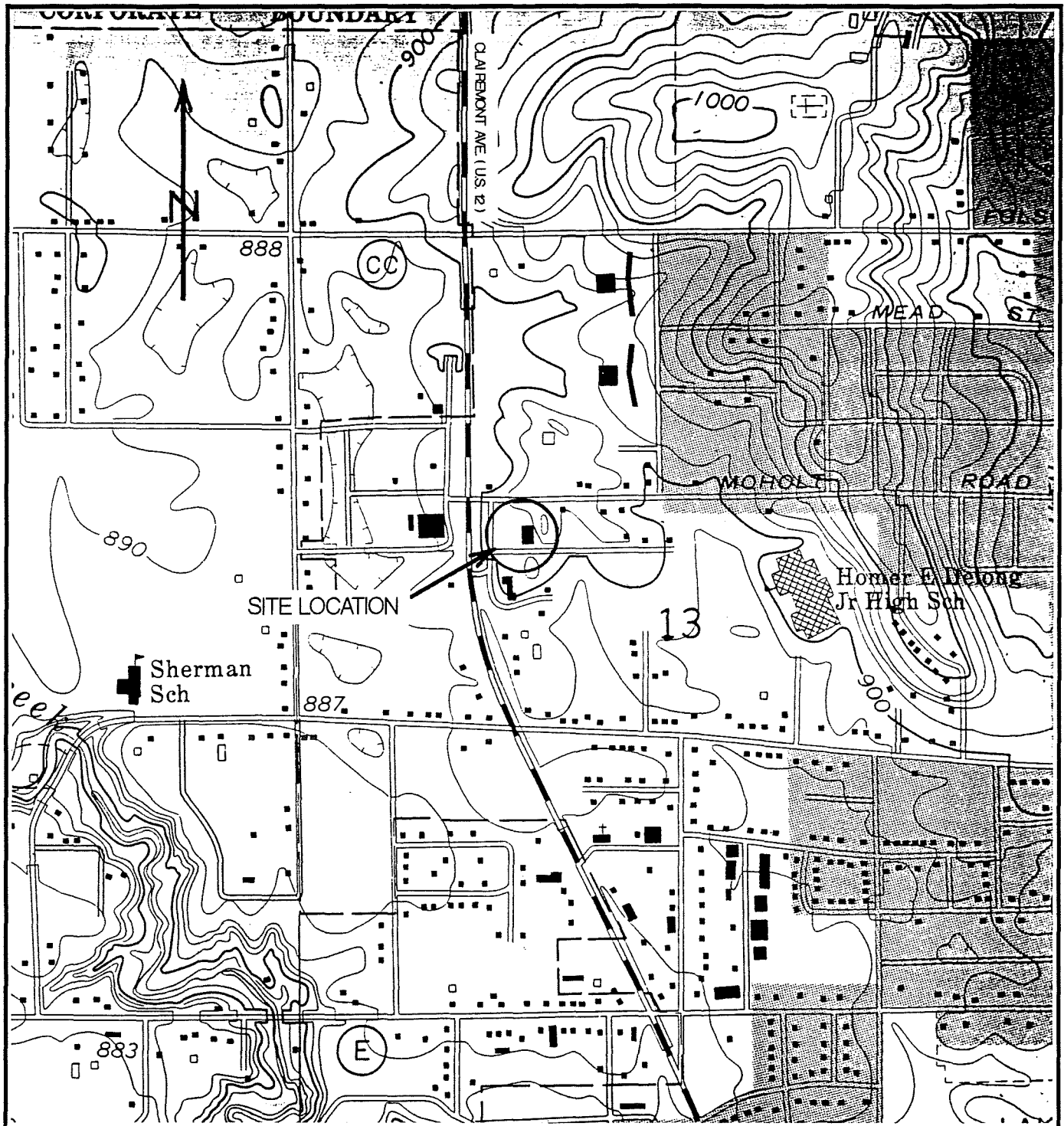

LEGEND

Eau Claire west, Wis. (1982)
 USGS Topographic Quadrangle
 7.5 Minute Series

Contour Interval - 10 feet

SE 1/4, NW 1/4, Section 13, T 27N, R 10W

architects - engineers - environmental specialists

cedar corporation

land surveyors - planners - landscape architects

DRAWN BY
 MAT

DATE
 5/97

REVISED BY
 MAT

SCALE
 1" : 1000'

SITE LOCATION MAP

**MACK TRUCK SALES
 OF EAU CLAIRE
 2412 FRANK STREET**

EAU CLAIRE , WI

CHECKED BY
 MAT

JOB NO.
 2295-001-62

FIGURE

1

P/L

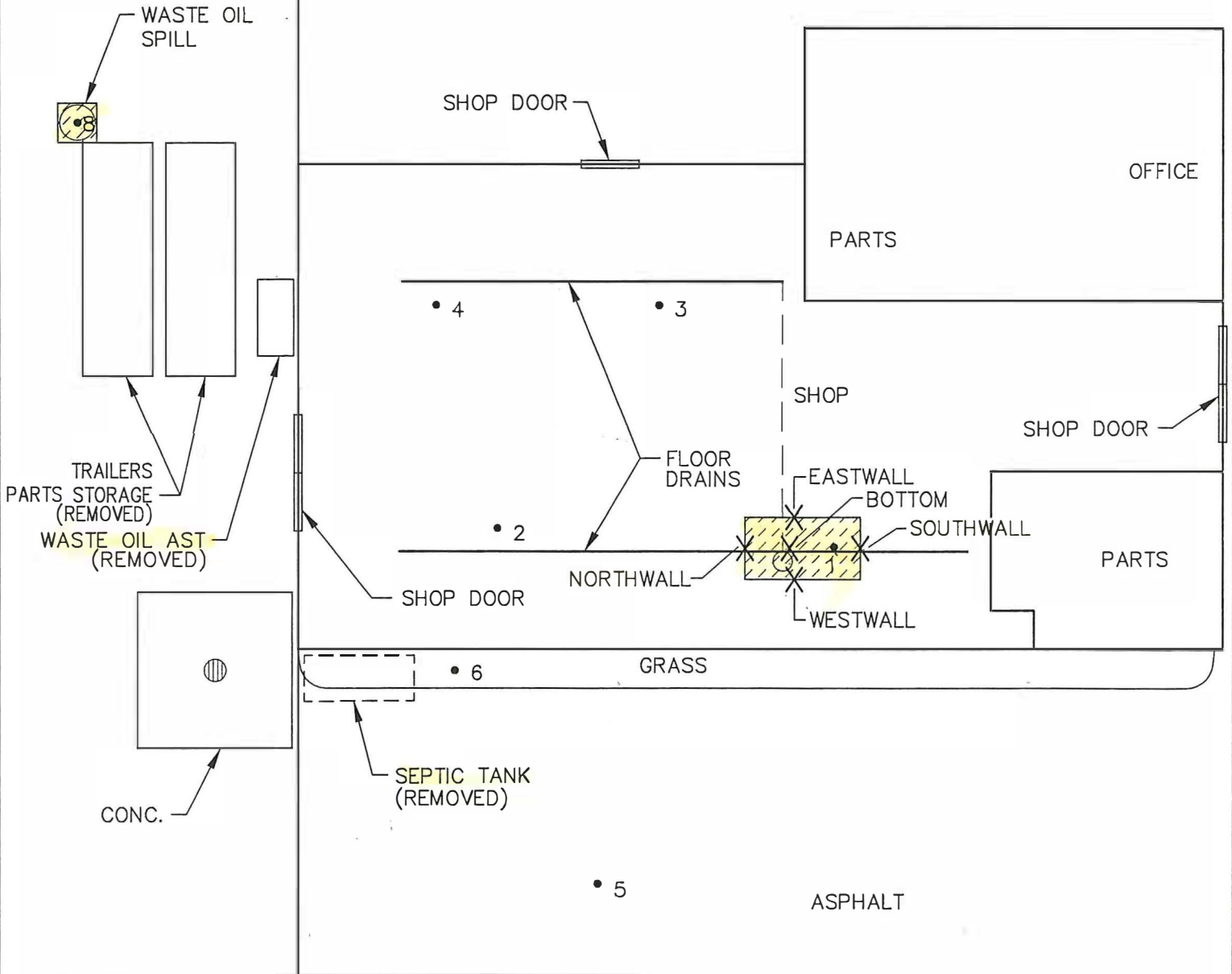

KEY	
	— AREA OF SOIL EXCAVATION
	— POST EXCAVATION SOIL SAMPLE LOCATION
	• 2 — SOIL SAMPLE LOCATION (PHASE 2)

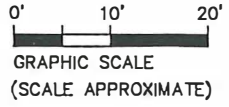

		604 Wilson Avenue Menomonie, Wisconsin 54751 715-235-9081 800-472-7372 FAX 715-235-2722 www.cedarcorp.com	
		DRAWN BY PKF	PROJECT TITLE MACK TRUCK SALES OF EAU CLAIRE 2412 FRANK STREET
DATE JUNE '97	FILE MACK2.DWG	JOB NO. 2295-001-62	FIGURE 2
SCALE 1"=20'			

M:\SOSKPRO\NEW\DWG\MACK2 8-6-97 17-33-46

TABLE 1.
MACK TRUCKS OF EAU CLAIRE
SOIL SAMPLE ANALYTICAL RESULTS - DRO, DETECTED VOCs, PAHs

ANALYTE	WDNR SOIL STANDARDS (mg/kg)	RESULTS IN mg/kg (PARTS PER MILLION)						
		1	2	3	5	6	8 - 1	8 - 5
DRO	100	4340	< 5.2	< 5.2	< 5.2	< 5.2	8350	< 5.2
n-BUTYLBENZENE	NA	0.828	< 0.028	< 0.027	< 0.03	< 0.029	--	< 0.026
sec-BUTYLBENZENE	NA	0.125	< 0.028	< 0.027	< 0.03	< 0.029	--	< 0.026
CHLOROFORM	NA	< 0.028	0.0505	< 0.027	< 0.03	< 0.029	--	< 0.026
CHLOROMETHANE	NA	< 0.028	0.029	< 0.027	< 0.03	< 0.029	--	< 0.026
o-CHLOROTOLUENE	NA	0.193	< 0.028	< 0.027	< 0.03	< 0.029	--	< 0.026
p-CHLOROTOLUENE	A	0.111	< 0.028	< 0.027	< 0.03	< 0.029	--	< 0.026
p-ISOPROPYLTOLUENE	NA	0.59	< 0.028	< 0.027	< 0.03	< 0.029	--	< 0.026
NAPHTHALENE	20	0.397	< .0019	< .0018	< 0.002	< 0.002	--	< 0.0018
n-PROPOYLBENZENE	NA	0.0675	< 0.028	< 0.027	< 0.03	< 0.029	--	< 0.026
1,2,4-TRIMETHYLBENZENE	NA	1.52	< 0.028	< 0.027	< 0.03	< 0.029	--	< 0.026
1,3,5-TRIMETHYLBENZENE	NA	0.816	< 0.028	< 0.027	< 0.03	< 0.029	--	< 0.026
XYLENES	4100	0.1317	< 0.028	< 0.027	< 0.03	< 0.029	--	< 0.026
BENZO(k)FLUORANTHENE	0.88	0.021	< .0011	< .0011	< 0.0012	< 0.0012	--	< 0.001
FLUORENE	600	0.712	< .0015	< .0014	< 0.0015	< 0.0015	--	< 0.0013
1-METHYLNAPHTHALENE	1100	2.53	< .0023	< .0022	< 0.0024	< 0.0023	--	< 0.0021
2-METHYLNAPHTHALENE	600	3.30	< .0026	< .0025	< 0.0027	< 0.0026	--	< 0.0024

DRO = DIESEL RANGE ORGANICS
A " < " SIGN BEFORE A RESULT MEANS NO DETECTION OF THAT COMPOUND AT OR ABOVE THAT LEVEL
NA = NOT ESTABLISHED

TABLE 2.
MACK TRUCKS OF EAU CLAIRE
POST EXCAVATION SOIL SAMPLE ANALYTICAL RESULTS - DRO, DETECTED VOCs, PAHs

ANALYTE	WDNR SOIL STANDARDS (mg/kg)	RESULTS IN mg/kg (PARTS PER MILLION)				
		EAST WALL	SOUTH WALL	WEST WALL	NORTH WALL	BOTTOM
DRO	100	< 5	20.0	22.6	6.74	18.1
FLUORENE	600	< 0.0015	< 0.0015	0.00271	< 0.0015	< 0.0016
1-METHYLNAPHTHALENE	1100	0.00802	0.00412	0.00634	< 0.0024	0.00381
2-METHYLNAPHTHALENE	600	0.0097	0.0046	0.00842	< 0.0028	0.00447
DRO = DIESEL RANGE ORGANICS						
A " < " SIGN BEFORE A RESULT MEANS NO DETECTION OF THAT COMPOUND AT OR ABOVE THAT LEVEL						
NA = NOT ESTABLISHED						

August 4, 1997

Cedar Corporation
604 Wilson Ave.
Menomonie, WI 54751

Attn: Matt Taylor

Re: 2295-002-61

Please find enclosed the analytical results for the samples received July 18, 1997.

All analyses were completed in accordance with appropriate EPA and Wisconsin methodologies. Methods and dates of analysis are included in the report tables.

The chain of custody document is enclosed.

If you have any questions about the results, please call. Thank you for using US Filter/Enviroscan for your analytical needs.

Sincerely,

US Filter/Enviroscan

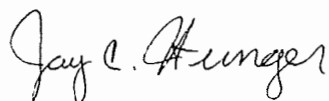

Jay C. Hunger
Analytical Chemist

Cedar Corporation
604 Wilson Ave.
Menomonie, WI 54751

CUST NUMBER: 2295-002-61
SAMPLED BY: Client
DATE REC'D: 07/18/97
REPORT DATE: 08/01/97
PREPARED BY: DM
REVIEWED BY: Zem

Attn: Matt Taylor

Modified Diesel Range Organics (DRO)
Parameter # 78919

	Reporting Limit	DRO	Qualifiers	Date Ext	Date Analyzed	Analytical No.
BOTTOM	5.0	18.1	D1 D4	07/18/97	07/18/97	11009
EAST WALL	5.0	X		07/18/97	07/18/97	11010
SOUTH WALL	5.0	20.0	D1 D4	07/18/97	07/18/97	11011
WEST WALL	5.0	22.6	D2 D4	07/18/97	07/18/97	11012
NORTH WALL	5.0	6.74	D3 D4	07/18/97	07/18/97	11013

Units mg/kg

X = Analyzed but not detected.

Results calculated on a dry weight basis.
Reporting Limit is adjusted for dilution.

Qualifiers: Only above indicated qualifiers apply.

- (D1) The chromatogram is characteristic for a fuel oil/diesel.
(i.e. #1 or #2 Diesel, jet fuel, kerosene, aged or degraded diesel, etc.)
- (D2) The chromatogram is not characteristic for diesel. It has the characteristics of a product which has significant peaks within the DRO window.
- (D2A) The chromatogram is characteristic for a light petroleum product (i.e. gasoline, aged or degraded gasoline, mineral spirits, etc.)
- (D2B) The chromatogram is characteristic for a heavier petroleum product other than diesel (i.e. motor oil, hydraulic oil, etc.)
- (D3) The chromatogram is not characteristic for diesel or any single common petroleum product.
- (D4) The chromatogram contained significant peaks outside the DRO window.
- (D5) The chromatogram contained significant peaks and a raised baseline outside the DRO window.

The entire area within the DRO window was quantitated.

The replicate spike recovery of this batch of samples was found to be 102.% and 96.9%.

Cedar Corporation
604 Wilson Ave.
Menomonie, WI 54751

CUST NUMBER: 2295-002-61
SAMPLED BY: Client
DATE REC'D: 07/18/97
REPORT DATE: 08/01/97
PREPARED BY: DJB
REVIEWED BY: SJM

Attn: Matt Taylor

	<u>Units</u>	<u>Reporting Limit</u>	<u>BOTTOM 07/17/97</u>	<u>Qualifiers</u>	<u>Date Analyzed</u>
<u>EPA 8310</u>					
Acenaphthene	mg/kg	0.0052	X		07/28/97
Acenaphthylene	mg/kg	0.0019	X		07/28/97
Anthracene	mg/kg	0.0012	X		07/28/97
Benzo (a) Anthracene	mg/kg	0.0024	X		07/28/97
Benzo (a) Pyrene	mg/kg	0.0024	X		07/28/97
Benzo (b) Fluoranthene	mg/kg	0.0012	X		07/28/97
Benzo (k) Fluoranthene	mg/kg	0.0012	X		07/28/97
Benzo (ghi) Perylene	mg/kg	0.0019	X		07/28/97
Chrysene	mg/kg	0.0016	X		07/28/97
Dibenzo (a, h) Anthracene	mg/kg	0.0024	X		07/28/97
Fluoranthene	mg/kg	0.0016	X		07/28/97
Fluorene	mg/kg	0.0016	X		07/28/97
Indeno (1, 2, 3-cd) Pyrene	mg/kg	0.0016	X		07/28/97
1-Methyl Naphthalene	mg/kg	0.0024	0.00381		07/28/97
2-Methyl Naphthalene	mg/kg	0.0028	0.00447		07/28/97
Naphthalene	mg/kg	0.0019	X		07/28/97
Phenanthrene	mg/kg	0.0031	X		07/28/97
Pyrene	mg/kg	0.0067	X		07/28/97
LUST Soil Org Ext - PNAs		-	COMP		07/21/97

Analytical No.:

11009

X = Analyzed but not detected.
Results calculated on a dry weight basis.

Cedar Corporation
604 Wilson Ave.
Menomonie, WI 54751

CUST NUMBER: 2295-002-61
SAMPLED BY: Client
DATE REC'D: 07/18/97
REPORT DATE: 08/01/97
PREPARED BY: DJB
REVIEWED BY: SM

Attn: Matt Taylor

	<u>Units</u>	<u>Reporting Limit</u>	<u>EAST WALL 07/17/97</u>	<u>Qualifiers</u>	<u>Date Analyzed</u>
<u>EPA 8310</u>					
Acenaphthene	mg/kg	0.005	X		07/28/97
Acenaphthylene	mg/kg	0.002	X		07/28/97
Anthracene	mg/kg	0.0012	X		07/28/97
Benzo (a) Anthracene	mg/kg	0.0023	X		07/28/97
Benzo (a) Pyrene	mg/kg	0.0023	X		07/28/97
Benzo (b) Fluoranthene	mg/kg	0.0012	X		07/28/97
Benzo (k) Fluoranthene	mg/kg	0.0012	X		07/28/97
Benzo (ghi) Perylene	mg/kg	0.002	X		07/28/97
Chrysene	mg/kg	0.0015	X		07/28/97
Dibenzo (a, h) Anthracene	mg/kg	0.0023	X		07/28/97
Fluoranthene	mg/kg	0.0015	X		07/28/97
Fluorene	mg/kg	0.0015	X		07/28/97
Indeno (1, 2, 3-cd) Pyrene	mg/kg	0.0015	X		07/28/97
1-Methyl Naphthalene	mg/kg	0.0023	0.00802		07/28/97
2-Methyl Naphthalene	mg/kg	0.0027	0.0097		07/28/97
Naphthalene	mg/kg	0.002	X		07/28/97
Phenanthrene	mg/kg	0.0032	X		07/28/97
Pyrene	mg/kg	0.0067	X		07/28/97
LUST Soil Org Ext - PNAs		-	COMP		07/21/97

Analytical No.:

11010

X = Analyzed but not detected.
Results calculated on a dry weight basis.

Cedar Corporation
604 Wilson Ave.
Menomonie, WI 54751

CUST NUMBER: 2295-002-61
SAMPLED BY: Client
DATE REC'D: 07/18/97
REPORT DATE: 08/01/97
PREPARED BY: DJB
REVIEWED BY: *zjm*

Attn: Matt Taylor

	<u>Units</u>	<u>Reporting Limit</u>	<u>SOUTH WALL 07/17/97</u>	<u>Qualifiers</u>	<u>Date Analyzed</u>
<u>EPA 8310</u>					
Acenaphthene	mg/kg	0.0051	X		07/28/97
Acenaphthylene	mg/kg	0.002	X		07/28/97
Anthracene	mg/kg	0.0012	X		07/28/97
Benzo (a) Anthracene	mg/kg	0.0024	X		07/28/97
Benzo (a) Pyrene	mg/kg	0.0024	X		07/28/97
Benzo (b) Fluoranthene	mg/kg	0.0012	X		07/28/97
Benzo (k) Fluoranthene	mg/kg	0.0012	X		07/28/97
Benzo (ghi) Perylene	mg/kg	0.002	X		07/28/97
Chrysene	mg/kg	0.0015	X		07/28/97
Dibenzo (a, h) Anthracene	mg/kg	0.0024	X		07/28/97
Fluoranthene	mg/kg	0.0015	X		07/28/97
Fluorene	mg/kg	0.0015	X		07/28/97
Indeno (1, 2, 3-cd) Pyrene	mg/kg	0.0015	X		07/28/97
1-Methyl Naphthalene	mg/kg	0.0024	0.00412		07/28/97
2-Methyl Naphthalene	mg/kg	0.0027	0.00460		07/28/97
Naphthalene	mg/kg	0.002	X		07/28/97
Phenanthrene	mg/kg	0.0032	X		07/28/97
Pyrene	mg/kg	0.0067	X		07/28/97
LUST Soil Org Ext - PNAs		-	COMP		07/21/97

Analytical No.:

11011

X = Analyzed but not detected.
Results calculated on a dry weight basis.

Cedar Corporation
604 Wilson Ave.
Menomonie, WI 54751

CUST NUMBER: 2295-002-61
SAMPLED BY: Client
DATE REC'D: 07/18/97
REPORT DATE: 08/01/97
PREPARED BY: DJB
REVIEWED BY: zjm

Attn: Matt Taylor

	<u>Units</u>	<u>Reporting Limit</u>	<u>WEST WALL 07/17/97</u>	<u>Qualifiers</u>	<u>Date Analyzed</u>
<u>EPA 8310</u>					
Acenaphthene	mg/kg	0.0051	X		07/28/97
Acenaphthylene	mg/kg	0.002	X		07/28/97
Anthracene	mg/kg	0.0012	X		07/28/97
Benzo (a) Anthracene	mg/kg	0.0024	X		07/28/97
Benzo (a) Pyrene	mg/kg	0.0024	X		07/28/97
Benzo (b) Fluoranthene	mg/kg	0.0012	X		07/28/97
Benzo (k) Fluoranthene	mg/kg	0.0012	X		07/28/97
Benzo (ghi) Perylene	mg/kg	0.002	X		07/28/97
Chrysene	mg/kg	0.0015	X		07/28/97
Dibenzo (a, h) Anthracene	mg/kg	0.0024	X		07/28/97
Fluoranthene	mg/kg	0.0015	X		07/28/97
Fluorene	mg/kg	0.0015	0.00271		07/28/97
Indeno (1, 2, 3-cd) Pyrene	mg/kg	0.0015	X		07/28/97
1-Methyl Naphthalene	mg/kg	0.0024	0.00634		07/28/97
2-Methyl Naphthalene	mg/kg	0.0028	0.00842		07/28/97
Naphthalene	mg/kg	0.002	X		07/28/97
Phenanthrene	mg/kg	0.0032	X		07/28/97
Pyrene	mg/kg	0.0067	X		07/28/97
LUST Soil Org Ext - PNAs		-	COMP		07/21/97

Analytical No.:

11012

X = Analyzed but not detected.
Results calculated on a dry weight basis.

Cedar Corporation
604 Wilson Ave.
Menomonie, WI 54751

CUST NUMBER: 2295-002-61
SAMPLED BY: Client
DATE REC'D: 07/18/97
REPORT DATE: 08/01/97
PREPARED BY: DJB
REVIEWED BY: Sjm

Attn: Matt Taylor

	<u>Units</u>	<u>Reporting Limit</u>	<u>NORTH WALL 07/17/97</u>	<u>Qualifiers</u>	<u>Date Analyzed</u>
<u>EPA 8310</u>					
Acenaphthene	mg/kg	0.0052	X		07/28/97
Acenaphthylene	mg/kg	0.0021	X		07/28/97
Anthracene	mg/kg	0.0012	X		07/28/97
Benzo (a) Anthracene	mg/kg	0.0024	X		07/28/97
Benzo (a) Pyrene	mg/kg	0.0024	X		07/28/97
Benzo (b) Fluoranthene	mg/kg	0.0012	X		07/28/97
Benzo (k) Fluoranthene	mg/kg	0.0012	X		07/28/97
Benzo (ghi) Perylene	mg/kg	0.0021	X		07/28/97
Chrysene	mg/kg	0.0016	X		07/28/97
Dibenzo (a, h) Anthracene	mg/kg	0.0024	X		07/28/97
Fluoranthene	mg/kg	0.0016	X		07/28/97
Fluorene	mg/kg	0.0016	X		07/28/97
Indeno (1, 2, 3-cd) Pyrene	mg/kg	0.0016	X		07/28/97
1-Methyl Naphthalene	mg/kg	0.0024	X		07/28/97
2-Methyl Naphthalene	mg/kg	0.0028	X		07/28/97
Naphthalene	mg/kg	0.0021	X		07/28/97
Phenanthrene	mg/kg	0.0033	X		07/28/97
Pyrene	mg/kg	0.007	X		07/28/97
LUST Soil Org Ext - PNAs		-	COMP		07/21/97

Analytical No.:

11013

X = Analyzed but not detected.
Results calculated on a dry weight basis.



Cedar Corporation
604 Wilson Ave.
Menomonie, WI 54751

Attn: Matt Taylor

CUST NUMBER: 2295-002-61
SAMPLED BY: Client
DATE REC'D: 07/18/97
REPORT DATE: 08/01/97
PREPARED BY: DJB
REVIEWED BY: SPM

Client Sample BOTTOM, Enviroscan Analytical # 11009, Results are in Units of mg/kg

Method EPA 8021	MDL	LUST		RESULT		Quality Control Qualifiers	Analysis Date	
		LOD	LOQ	Wet	Dry			
Benzene	0.012	0.025	0.060	<	0.025	<	0.030	07/20/97
Bromobenzene	0.007	0.025	0.060	<	0.025	<	0.030	07/20/97
Bromodichloromethane	0.005	0.025	0.060	<	0.025	<	0.030	07/20/97
Carbon Tetrachloride	0.008	0.025	0.060	<	0.025	<	0.030	07/20/97
Chlorobenzene	0.003	0.025	0.060	<	0.025	<	0.030	07/20/97
Chloroethane	0.006	0.025	0.060	<	0.025	<	0.030	SPL DUP 07/20/97
Chloroform	0.002	0.025	0.060	<	0.025	<	0.030	07/20/97
Chloromethane	0.012	0.025	0.060	<	0.250	<	0.301	CSH SPL DUP 07/20/97
o-Chlorotoluene	0.003	0.025	0.060	<	0.025	<	0.030	07/20/97
p-Chlorotoluene	0.005	0.025	0.060	<	0.025	<	0.030	07/20/97
Chlorodibromomethane	0.004	0.025	0.060	<	0.025	<	0.030	07/20/97
1,2-Dibromo-3-chloropropane	0.017	0.025	0.060	<	0.025	<	0.030	07/20/97
1,2-Dichlorobenzene	0.014	0.025	0.060	<	0.025	<	0.030	07/20/97
1,3-Dichlorobenzene	0.003	0.025	0.060	<	0.025	<	0.030	07/20/97
1,4-Dichlorobenzene	0.002	0.025	0.060	<	0.025	<	0.030	07/20/97
1,1-Dichloroethane	0.002	0.025	0.060	<	0.025	<	0.030	07/20/97
1,2-Dichloroethane	0.001	0.025	0.060	<	0.025	<	0.030	07/20/97
1,1-Dichloroethylene	0.006	0.025	0.060	<	0.025	<	0.030	07/20/97
cis-1,2-Dichloroethylene	0.007	0.025	0.060	<	0.025	<	0.030	07/20/97
trans-1,2-Dichloroethylene	0.002	0.025	0.060	<	0.025	<	0.030	07/20/97
Methylene Chloride	0.009	0.025	0.060	<	0.055	<	0.066	CSL LBC 07/20/97
1,2-Dichloropropane	0.002	0.025	0.060	<	0.025	<	0.030	07/20/97
1,3-Dichloropropane	0.002	0.025	0.060	<	0.025	<	0.030	07/20/97
2,2-Dichloropropane	0.007	0.025	0.060	<	0.025	<	0.030	07/20/97
Ethylbenzene	0.006	0.025	0.060	<	0.025	<	0.030	07/20/97
1,2-Dibromoethane	0.002	0.025	0.060	<	0.025	<	0.030	07/20/97
1,1,2,2-Tetrachloroethane	0.002	0.025	0.060	<	0.025	<	0.030	07/20/97
Tetrachloroethylene	0.002	0.025	0.060	<	0.025	<	0.030	07/20/97
Toluene	0.003	0.025	0.060	<	0.025	<	0.030	07/20/97
1,1,1-Trichloroethane	0.007	0.025	0.060	<	0.025	<	0.030	07/20/97
1,1,2-Trichloroethane	0.007	0.025	0.060	<	0.025	<	0.030	07/20/97
Trichloroethylene	0.002	0.025	0.060	<	0.025	<	0.030	SPH 07/20/97
Vinyl Chloride	0.002	0.025	0.060	<	0.025	<	0.030	SPL 07/20/97
o-Xylene & Styrene	0.010	0.025	0.060	<	0.025	<	0.030	07/20/97
m- & p-Xylene	0.011	0.025	0.060	<	0.025	<	0.030	07/20/97
Methyl tert Butyl Ether	0.016	0.025	0.060	<	0.025	<	0.030	07/20/97
1,3,5-Trimethylbenzene	0.019	0.025	0.060	<	0.025	<	0.030	07/20/97
1,2,4-Trichlorobenzene	0.002	0.025	0.060	<	0.025	<	0.030	07/20/97
1,2,3-Trichlorobenzene	0.003	0.025	0.060	<	0.025	<	0.030	07/20/97
Isopropylbenzene	0.006	0.025	0.060	<	0.025	<	0.030	07/20/97
Dichlorodifluoromethane	0.004	0.025	0.060	<	0.025	<	0.030	SPL DUP 07/20/97
Naphthalene	0.016	0.025	0.060	<	0.025	<	0.030	07/20/97
Trichlorofluoromethane	0.002	0.025	0.060	<	0.025	<	0.030	SPL 07/20/97
Hexachlorobutadiene	0.003	0.025	0.060	<	0.025	<	0.030	07/20/97
n-Propylbenzene	0.007	0.025	0.060	<	0.025	<	0.030	07/20/97
n-Butylbenzene	0.006	0.025	0.060	<	0.025	<	0.030	07/20/97
1,2,4-Trimethylbenzene	0.007	0.025	0.060	<	0.025	<	0.030	07/20/97
sec-Butylbenzene	0.006	0.025	0.060	<	0.025	<	0.030	CSL 07/20/97
tert-Butylbenzene	0.004	0.025	0.060	<	0.025	<	0.030	07/20/97
p-Isopropyltoluene	0.002	0.025	0.060	<	0.025	<	0.030	07/20/97
Isopropyl Ether	0.006	0.025	0.060	<	0.025	<	0.030	07/20/97

Cedar Corporation
604 Wilson Ave.
Menomonie, WI 54751

CUST NUMBER: 2295-002-61
SAMPLED BY: Client
DATE REC'D: 07/18/97
REPORT DATE: 08/01/97
PREPARED BY: DJB
REVIEWED BY: Sum

Attn: Matt Taylor

Client Sample EAST WALL , Enviroscan Analytical # 11010, Results are in Units of mg/kg

Method EPA 8021	MDL	LUST		RESULT		Quality Control Qualifiers	Analysis Date	
		LOD	LOQ	Wet	Dry			
Benzene	0.012	0.025	0.060	<	0.025	<	0.029	07/20/97
Bromobenzene	0.007	0.025	0.060	<	0.025	<	0.029	07/20/97
Bromodichloromethane	0.005	0.025	0.060	<	0.025	<	0.029	07/20/97
Carbon Tetrachloride	0.008	0.025	0.060	<	0.025	<	0.029	07/20/97
Chlorobenzene	0.003	0.025	0.060	<	0.025	<	0.029	07/20/97
Chloroethane	0.006	0.025	0.060	<	0.025	<	0.029	SPL DUP 07/20/97
Chloroform	0.002	0.025	0.060	<	0.025	<	0.029	07/20/97
Chloromethane	0.012	0.025	0.060	<	0.250	<	0.292	CSH SPL DUP 07/20/97
o-Chlorotoluene	0.003	0.025	0.060	<	0.025	<	0.029	07/20/97
p-Chlorotoluene	0.005	0.025	0.060	<	0.025	<	0.029	07/20/97
Chlorodibromomethane	0.004	0.025	0.060	<	0.025	<	0.029	07/20/97
1,2-Dibromo-3-chloropropane	0.017	0.025	0.060	<	0.025	<	0.029	07/20/97
1,2-Dichlorobenzene	0.014	0.025	0.060	<	0.025	<	0.029	07/20/97
1,3-Dichlorobenzene	0.003	0.025	0.060	<	0.025	<	0.029	07/20/97
1,4-Dichlorobenzene	0.002	0.025	0.060	<	0.025	<	0.029	07/20/97
1,1-Dichloroethane	0.002	0.025	0.060	<	0.025	<	0.029	07/20/97
1,2-Dichloroethane	0.001	0.025	0.060	<	0.025	<	0.029	07/20/97
1,1-Dichloroethylene	0.006	0.025	0.060	<	0.025	<	0.029	07/20/97
cis-1,2-Dichloroethylene	0.007	0.025	0.060	<	0.025	<	0.029	07/20/97
trans-1,2-Dichloroethylene	0.002	0.025	0.060	<	0.025	<	0.029	07/20/97
Methylene Chloride	0.009	0.025	0.060	<	0.089	<	0.104	CSL LBC 07/20/97
1,2-Dichloropropane	0.002	0.025	0.060	<	0.025	<	0.029	07/20/97
1,3-Dichloropropane	0.002	0.025	0.060	<	0.025	<	0.029	07/20/97
2,2-Dichloropropane	0.007	0.025	0.060	<	0.025	<	0.029	07/20/97
Ethylbenzene	0.006	0.025	0.060	<	0.025	<	0.029	07/20/97
1,2-Dibromoethane	0.002	0.025	0.060	<	0.025	<	0.029	07/20/97
1,1,2,2-Tetrachloroethane	0.002	0.025	0.060	<	0.025	<	0.029	07/20/97
Tetrachloroethylene	0.002	0.025	0.060	<	0.025	<	0.029	07/20/97
Toluene	0.003	0.025	0.060	<	0.025	<	0.029	07/20/97
1,1,1-Trichloroethane	0.007	0.025	0.060	<	0.025	<	0.029	07/20/97
1,1,2-Trichloroethane	0.007	0.025	0.060	<	0.025	<	0.029	07/20/97
Trichloroethylene	0.002	0.025	0.060	<	0.025	<	0.029	SPH 07/20/97
Vinyl Chloride	0.002	0.025	0.060	<	0.025	<	0.029	SPL 07/20/97
o-Xylene & Styrene	0.010	0.025	0.060	<	0.025	<	0.029	07/20/97
m- & p-Xylene	0.011	0.025	0.060	<	0.025	<	0.029	07/20/97
Methyl tert Butyl Ether	0.016	0.025	0.060	<	0.025	<	0.029	07/20/97
1,3,5-Trimethylbenzene	0.019	0.025	0.060	<	0.025	<	0.029	07/20/97
1,2,4-Trichlorobenzene	0.002	0.025	0.060	<	0.025	<	0.029	07/20/97
1,2,3-Trichlorobenzene	0.003	0.025	0.060	<	0.025	<	0.029	07/20/97
Isopropylbenzene	0.006	0.025	0.060	<	0.025	<	0.029	07/20/97
Dichlorodifluoromethane	0.004	0.025	0.060	<	0.025	<	0.029	SPL DUP 07/20/97
Naphthalene	0.016	0.025	0.060	<	0.025	<	0.029	07/20/97
Trichlorofluoromethane	0.002	0.025	0.060	<	0.025	<	0.029	SPL 07/20/97
Hexachlorobutadiene	0.003	0.025	0.060	<	0.025	<	0.029	07/20/97
n-Propylbenzene	0.007	0.025	0.060	<	0.025	<	0.029	07/20/97
n-Butylbenzene	0.006	0.025	0.060	<	0.025	<	0.029	07/20/97
1,2,4-Trimethylbenzene	0.007	0.025	0.060	<	0.025	<	0.029	07/20/97
sec-Butylbenzene	0.006	0.025	0.060	<	0.025	<	0.029	CSL 07/20/97
tert-Butylbenzene	0.004	0.025	0.060	<	0.025	<	0.029	07/20/97
p-Isopropyltoluene	0.002	0.025	0.060	<	0.025	<	0.029	07/20/97
Isopropyl Ether	0.006	0.025	0.060	<	0.025	<	0.029	07/20/97

All Analyses conducted in accordance with U.S. Filter Quality Assurance Program.

Wisconsin Lab Certification No. 737053130/U.S. Filter Corp., 301 W. Military Rd., Rothschild, WI 54474 Ph. (800) 338-7226 Fax (715) 355-3221

Cedar Corporation
604 Wilson Ave.
Menomonie, WI 54751

Attn: Matt Taylor

CUST NUMBER: 2295-002-61
SAMPLED BY: Client
DATE REC'D: 07/18/97
REPORT DATE: 08/01/97
PREPARED BY: DJB
REVIEWED BY: Jom

Client Sample SOUTH WALL , Enviroscan Analytical # 11011, Results are in Units of mg/kg

Method EPA 8021	MDL	LUST LOD	LUST LOQ	RESULT		Quality Control Qualifiers	Analysis Date
				Wet	Dry		
Benzene	0.012	0.025	0.060	< 0.025	< 0.030		07/20/97
Bromobenzene	0.007	0.025	0.060	< 0.025	< 0.030		07/20/97
Bromodichloromethane	0.005	0.025	0.060	< 0.025	< 0.030		07/20/97
Carbon Tetrachloride	0.008	0.025	0.060	< 0.025	< 0.030		07/20/97
Chlorobenzene	0.003	0.025	0.060	< 0.025	< 0.030		07/20/97
Chloroethane	0.006	0.025	0.060	< 0.025	< 0.030	SPL DUP	07/20/97
Chloroform	0.002	0.025	0.060	< 0.025	< 0.030		07/20/97
Chloromethane	0.012	0.025	0.060	< 0.250	< 0.298	CSH SPL DUP	07/20/97
o-Chlorotoluene	0.003	0.025	0.060	< 0.025	< 0.030		07/20/97
p-Chlorotoluene	0.005	0.025	0.060	< 0.025	< 0.030		07/20/97
Chlorodibromomethane	0.004	0.025	0.060	< 0.025	< 0.030		07/20/97
1,2-Dibromo-3-chloropropane	0.017	0.025	0.060	< 0.025	< 0.030		07/20/97
1,2-Dichlorobenzene	0.014	0.025	0.060	< 0.025	< 0.030		07/20/97
1,3-Dichlorobenzene	0.003	0.025	0.060	< 0.025	< 0.030		07/20/97
1,4-Dichlorobenzene	0.002	0.025	0.060	< 0.025	< 0.030		07/20/97
1,1-Dichloroethane	0.002	0.025	0.060	< 0.025	< 0.030		07/20/97
1,2-Dichloroethane	0.001	0.025	0.060	< 0.025	< 0.030		07/20/97
1,1-Dichloroethylene	0.006	0.025	0.060	< 0.025	< 0.030		07/20/97
cis-1,2-Dichloroethylene	0.007	0.025	0.060	< 0.025	< 0.030		07/20/97
trans-1,2-Dichloroethylene	0.002	0.025	0.060	< 0.025	< 0.030		07/20/97
Methylene Chloride	0.009	0.025	0.060	0.086	0.102	CSL LBC	07/20/97
1,2-Dichloropropane	0.002	0.025	0.060	< 0.025	< 0.030		07/20/97
1,3-Dichloropropane	0.002	0.025	0.060	< 0.025	< 0.030		07/20/97
2,2-Dichloropropane	0.007	0.025	0.060	< 0.025	< 0.030		07/20/97
Ethylbenzene	0.006	0.025	0.060	< 0.025	< 0.030		07/20/97
1,2-Dibromoethane	0.002	0.025	0.060	< 0.025	< 0.030		07/20/97
1,1,2,2-Tetrachloroethane	0.002	0.025	0.060	< 0.025	< 0.030		07/20/97
Tetrachloroethylene	0.002	0.025	0.060	< 0.025	< 0.030		07/20/97
Toluene	0.003	0.025	0.060	< 0.025	< 0.030		07/20/97
1,1,1-Trichloroethane	0.007	0.025	0.060	< 0.025	< 0.030		07/20/97
1,1,2-Trichloroethane	0.007	0.025	0.060	< 0.025	< 0.030		07/20/97
Trichloroethylene	0.002	0.025	0.060	< 0.025	< 0.030	SPH	07/20/97
Vinyl Chloride	0.002	0.025	0.060	< 0.025	< 0.030	SPL	07/20/97
o-Xylene & Styrene	0.010	0.025	0.060	< 0.025	< 0.030		07/20/97
m- & p-Xylene	0.011	0.025	0.060	< 0.025	< 0.030		07/20/97
Methyl tert Butyl Ether	0.016	0.025	0.060	< 0.025	< 0.030		07/20/97
1,3,5-Trimethylbenzene	0.019	0.025	0.060	< 0.025	< 0.030		07/20/97
1,2,4-Trichlorobenzene	0.002	0.025	0.060	< 0.025	< 0.030		07/20/97
1,2,3-Trichlorobenzene	0.003	0.025	0.060	< 0.025	< 0.030		07/20/97
Isopropylbenzene	0.006	0.025	0.060	< 0.025	< 0.030		07/20/97
Dichlorodifluoromethane	0.004	0.025	0.060	< 0.025	< 0.030	SPL DUP	07/20/97
Naphthalene	0.016	0.025	0.060	< 0.025	< 0.030		07/20/97
Trichlorofluoromethane	0.002	0.025	0.060	< 0.025	< 0.030	SPL	07/20/97
Hexachlorobutadiene	0.003	0.025	0.060	< 0.025	< 0.030		07/20/97
n-Propylbenzene	0.007	0.025	0.060	< 0.025	< 0.030		07/20/97
n-Butylbenzene	0.006	0.025	0.060	< 0.025	< 0.030		07/20/97
1,2,4-Trimethylbenzene	0.007	0.025	0.060	< 0.025	< 0.030		07/20/97
sec-Butylbenzene	0.006	0.025	0.060	< 0.025	< 0.030	CSL	07/20/97
tert-Butylbenzene	0.004	0.025	0.060	< 0.025	< 0.030		07/20/97
p-Isopropyltoluene	0.002	0.025	0.060	< 0.025	< 0.030		07/20/97
Isopropyl Ether	0.006	0.025	0.060	< 0.025	< 0.030		07/20/97

All Analyses conducted in accordance with U.S. Filter Quality Assurance Program.

Wisconsin Lab Certification No. 737053130/U.S. Filter Corp., 301 W. Military Rd., Rothschild, WI 54474 Ph. (800) 338-7226 Fax (715) 355-3221



Cedar Corporation
604 Wilson Ave.
Menomonie, WI 54751

Attn: Matt Taylor

CUST NUMBER: 2295-002-61
SAMPLED BY: Client
DATE REC'D: 07/18/97
REPORT DATE: 08/01/97
PREPARED BY: DJB
REVIEWED BY: [Signature]

Client Sample WEST WALL, Enviroscan Analytical # 11012, Results are in Units of mg/kg

Table with columns: Method EPA 8021, MDL, LUST LOD, LUST LOQ, RESULT Wet, RESULT Dry, Quality Control Qualifiers, Analysis Date. Lists various chemical compounds and their detection levels.

All Analyses conducted in accordance with U.S. Filter Quality Assurance Program.



Cedar Corporation
604 Wilson Ave.
Menomonie, WI 54751

Attn: Matt Taylor

CUST NUMBER: 2295-002-61
SAMPLED BY: Client
DATE REC'D: 07/18/97
REPORT DATE: 08/01/97
PREPARED BY: DJB
REVIEWED BY: Jm

Client Sample NORTH WALL , Enviroscan Analytical # 11013, Results are in Units of mg/kg

Table with columns: Method EPA 8021, MDL, LUST LOD, LUST LOQ, RESULT Wet, RESULT Dry, Quality Control Qualifiers, Analysis Date. Lists various chemical compounds and their detection levels.

All Analyses conducted in accordance with U.S. Filter Quality Assurance Program.

Wisconsin Lab Certification No. 737053130/U.S. Filter Corp., 301 W. Military Rd., Rothschild, WI 54474 Ph. (800) 338-7226 Fax (715) 355-3221

Cedar Corporation
604 Wilson Ave.
Menomonie, WI 54751

CUST NUMBER: 2295-002-61
SAMPLED BY: Client
DATE REC'D: 07/18/97
REPORT DATE: 08/01/97
PREPARED BY: DJB
REVIEWED BY: SM

Attn: Matt Taylor

	<u>Units</u>	<u>Reporting Limit</u>	<u>DIRTY 07/17/97</u>	<u>Qualifiers</u>	<u>Date Analyzed</u>
<u>EPA 6010</u>					
Cadmium	mg/kg	0.017	0.167		07/23/97
Chromium	mg/kg	0.039	8.88		07/23/97
Lead	mg/kg	0.14	6.26	DUP	07/23/97
<u>EPA 8081</u>					
PCB-1016	mg/kg	0.0083	X		07/31/97
PCB-1221	mg/kg	0.0083	X		07/31/97
PCB-1232	mg/kg	0.0083	X		07/31/97
PCB-1242	mg/kg	0.0083	X		07/31/97
PCB-1248	mg/kg	0.0083	X		07/31/97
PCB-1254	mg/kg	0.0083	X		07/31/97
PCB-1260	mg/kg	0.0083	X		07/31/97
Soil Org. Ext.		-	COMP		07/23/97

Analytical No.:

11014

X = Analyzed but not detected.
Results calculated on a dry weight basis.

Cedar Corporation
604 Wilson Ave.
Menomonie, WI 54751

CUST NUMBER: 2295-002-61
SAMPLED BY: Client
DATE REC'D: 07/18/97
REPORT DATE: 08/01/97
PREPARED BY: DJB
REVIEWED BY: Jim

Attn: Matt Taylor

<u>Sample ID</u>	<u>Total Solids</u>		<u>Analytical</u>
	<u>EPA 160.3</u>	<u>Qualifiers</u>	
BOTTOM	83.0		11009
EAST WALL	85.5		11010
SOUTH WALL	84.0		11011
WEST WALL	85.0		11012
NORTH WALL	82.0		11013
DIRTY	84.0		11014
Units	%		
Date Analyzed:	07/21/97		

Cedar Corporation
604 Wilson Ave.
Menomonie, WI 54751

CUST NUMBER: 2295-002-61
SAMPLED BY: Client
DATE REC'D: 07/18/97
REPORT DATE: 08/01/97
PREPARED BY: DJB
REVIEWED BY: JDR

Attn: Matt Taylor

Qualifier Descriptions

CSL	Check standard for this analyte exhibited a low bias. Sample results may also be biased low. Non-detects verified with a low standard comparison.
SPL	Matrix spike recovery within analytical batch was low. Sample matrix appears similar to your sample; result may be biased low.
DUP	Result of duplicate analysis in this quality assurance batch exceeds the limits for precision.
CSH	Check standard for this analyte exhibited a high bias. Sample results may also be biased high.
LBC	Analyte is a common laboratory solvent or chemical. Positive identification may be due to laboratory contamination.
SPH	Matrix spike recovery within analytical batch was high. Sample matrix appears similar to your sample; result may be biased high.

Pace Analytical

Pace Analytical Services, Inc.
1700 Elm Street - Suite 200
Minneapolis, MN 55414

Tel: 612-617-6400

Fax: 612-617-6444

DATE: 08/01/97

PAGE: 1

U.S. Filter/Enviroscan
303 W. Military Road
Rothschild, WI 54474

Pace Project Number: 102321
Client Project ID: TOC soil samples

Attn: Mr. Jim Salkowski
Phone: 800-338-7226

Solid results are reported on a dry weight basis

Pace Sample No:	10203065	Date Collected:	07/17/97	Matrix:	Soil
Client Sample ID:	11009	Date Received:	07/22/97		

Parameters	Results	Units	PRL	Analyzed	Analyst	CAS#	Footnotes
Wet Chemistry							
Total Organic Carbon in Soil		Method: SM 5310				Prep Method: SM 5310	
Total Organic Carbon	2900	mg/kg	1200	07/30/97	DKP	7440-44-0	
Organics, Prep							
Percent Moisture		Method:				Prep Method:	
Percent Moisture	17.6	%		07/24/97	DWM		

REPORT OF LABORATORY ANALYSIS

This report shall not be reproduced, except in full,
without the written consent of Pace Analytical Services, Inc.

Pace Project Number: 102321

Client Project ID: TOC soil samples

PARAMETER FOOTNOTES

ND Not Detected
NC Not Calculable
PRL Pace Reporting Limit

REPORT OF LABORATORY ANALYSIS

This report shall not be reproduced, except in full,
without the written consent of Pace Analytical Services, Inc.

QUALITY CONTROL DATA

DATE: 08/01/97

PAGE: 3

U.S. Filter/Enviroscan
303 W. Military Road
Rothschild, WI 54474

Pace Project Number: 102321
Client Project ID: TOC soil samples

Attn: Mr. Jim Salkowski
Phone: 800-338-7226

QC Batch ID: 4071
Analysis Method:
Associated Pace Samples: 10203065

QC Batch Method:
Analysis Description: Percent Moisture

METHOD BLANK: 10205821
Associated Pace Samples:

10203065

Parameter	Units	Method Blank Result	PRL	Footnotes
Percent Moisture	%	0		

SAMPLE DUPLICATE: 10207546

Parameter	Units	10201945	Dup. Result	RPD	Footnotes
Percent Moisture	%	21.00	20.40	3	

REPORT OF LABORATORY ANALYSIS

This report shall not be reproduced, except in full,
without the written consent of Pace Analytical Services, Inc.

QUALITY CONTROL DATA

DATE: 08/01/97
PAGE: 4

U.S. Filter/Enviroscan
303 W. Military Road
Rothschild, WI 54474

Pace Project Number: 102321
Client Project ID: TOC soil samples

Attn: Mr. Jim Salkowski
Phone: 800-338-7226

QC Batch ID: 4289
Analysis Method: SM 5310
Associated Pace Samples: 10203065

QC Batch Method: SM 5310
Analysis Description: Total Organic Carbon in Soil

METHOD BLANK: 10215598
Associated Pace Samples:

10203065

Parameter	Units	Method Blank Result	PRL	Footnotes
Total Organic Carbon	mg/kg	ND	1000	

LABORATORY CONTROL SAMPLE & LCSD: 10215614

10215622

Parameter	Units	Spike Conc.	LCS Result	Spike % Rec	LCSD Result	Spike Dup % Rec	RPD	Footnotes
Total Organic Carbon	mg/kg	6250	7702	123	7329	117	5	

SAMPLE DUPLICATE: 10215606

Parameter	Units	10201705	Dup. Result	RPD	Footnotes
Total Organic Carbon	mg/kg	2000	1600	26	

REPORT OF LABORATORY ANALYSIS

This report shall not be reproduced, except in full,
without the written consent of Pace Analytical Services, Inc.

Pace Project Number: 102321

Client Project ID: TOC soil samples

QUALITY CONTROL DATA PARAMETER FOOTNOTES

Consistent with EPA guidelines unrounded concentrations are displayed and have been used to calculate % Rec and RPD values.

ND	Not Detected
NC	Not Calculable
PRL	Pace Reporting Limit
RPD	Relative Percent Difference

REPORT OF LABORATORY ANALYSIS

This report shall not be reproduced, except in full,
without the written consent of Pace Analytical Services, Inc.

REQUEST FOR SERVICES

U.S. FILTER/ENVIROSCAN 301 W. MILITARY RD. ROTHSCCHILD, WI 54474 1-800-338-SCAN

REPORT TO:

Name: Matt Taylor
 Company: Cedar Corporation
 Address: 604 Wilson Ave.
Menomonie, WI 54751
 Phone: (715) 235-9081
 P.O. # 2295-002-61
 Project # _____ Quote # 5735-5
 Location Track Truck

BILL TO: (if different from Report To info):

Name: _____
 Company: _____
 Address: _____
 Phone: (_____) _____

ANALYTICAL REQUESTS

(use separate sheet if necessary)

- Sample Type**
 (Check all that apply)
- Groundwater
 - Wastewater
 - Soil/Solid
 - Drinking Water
 - Oil
 - Vapor
 - Other
- Turnaround Time**
- Normal
 - Rush (Pre-approved by Lab) "c"
- Date Needed 8/1/97
 Approved By Evette

*Send to Matt Taylor
 DRO / LUST VOCs *
 PCBs S-LPWA
 Total Pb
 Total Organic Carbon
 TICP-SUBS*

LAB USE ONLY	DATE	TIME	No. of Containers		SAMPLE ID	ANALYTICAL REQUESTS					REMARKS	
			COMP	GRAB		DRO	LUST VOCs	PCBs	Total Pb	Total Organic Carbon		
12011009	7/17/97	1330		5	Bottom	X	X			X		
12011010		1310		4	East well							
12011011		1150		4	South well							
12011012		1300		4	West well							
12011013		1320		4	North well	↓	↓					
12011014	↓	1335		2	Dirty			X	X			

CEDAR

CHAIN OF CUSTODY RECORD

SAMPLERS: (Signature)
Matt Taylor

Del'v: Hand Comm.
 Ship. Cont. OK? N N/A
 Samples leaking? Y N/A
 Seals OK? Y N N/A
 Rec'd on ice? Y N N/A °C

RELINQUISHED BY: (Signature) <u>M. Taylor</u>	DATE/TIME <u>7/17/97 1600</u>	RECEIVED BY: (Signature) _____
RELINQUISHED BY: (Signature) _____	DATE/TIME _____	RECEIVED BY: (Signature) _____
RELINQUISHED BY: (Signature) _____	DATE/TIME _____	RECEIVED FOR LABORATORY BY: (Signature) <u>R. Salomish</u>

Comments: _____

DATE/TIME
7/18/97 1035 AM

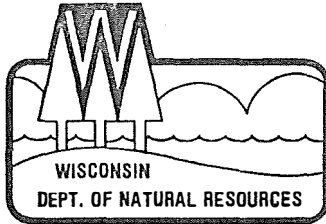

State of Wisconsin \ DEPARTMENT OF NATURAL RESOURCES

Tommy G. Thompson, Governor
George E. Meyer, Secretary
Scott Humrickhouse, Regional Director

West Central Region Headquarters
1300 W. Clairmont Avenue
PO Box 4001
Eau Claire, WI 54702-4001
TELEPHONE 715-839-3700
FAX 715-839-6076/1605
TTY 715-839-2786

August 4, 1997

R&R Case# 02-18-151537
Eau Claire County

Mr. Robert Nuss
Mack Trucks of Rochester
P.O. Box 6699
Rochester, MN 55903

SUBJECT: Sampling Requirements for Petroleum Contamination at the Eau Claire Mack Truck Facility Located at 2412 Frank St., Eau Claire, Wisconsin

Dear Mr. Nuss:

On July 16, 1997, I received a FAX from your consultant, Matt Taylor of Cedar Corp., requesting clarification of the Department's sampling requirements for your petroleum contamination investigation. Based on review of current analytical data which Cedar Corp. provided, the Department requests that a full VOC analysis be performed on future soil samples, as opposed to only PVOC analysis. In addition, Cedar Corp. indicated that they would also include DRO and PAH analyses.

I appreciate your concern and cooperation in this matter. If you have any questions about this letter or your responsibilities, please feel free to contact me at (715) 839-1602.

Sincerely,

Doug Joseph
Hydrogeologist

enclosures

c: Bill Evans - WCR
Mr. Matt Taylor, Cedar Corp., 604 Wilson Ave., Menomonie, WI 54751

FACSIMILE TRANSMISSION COVER SHEET

**CEDAR CORPORATION
604 WILSON AVENUE
MENOMONIE, WI 54751**

PHONE: 715-235-9081



FAX: 715-235-2727

COMPANY: WIDNR ATTN: Doug Joseph

FAX #: 715-839-6076

FROM: Matt Taylor

DATE: 7-16-97

PROJECT: Mack Truck soil excavation

NUMBER OF PAGES, INCLUDING THIS SHEET: 2

COMMENTS/INSTRUCTIONS:

Here is a table of all the compounds detected
in soil samples collected during the Phase 1 - I was
wondering if you thought it would be necessary to
sample VOCs or can we do PVOC's. (we are planning
to do DRO & PAHs).

- Matt

TABLE 1.
MACK TRUCKS OF EAU CLAIRE
SOIL SAMPLE ANALYTICAL RESULTS - DRO, DETECTED VOCs, PAHs

ANALYTE	WDNR SOIL STANDARDS (mg/kg)	RESULTS IN mg/kg (PARTS PER MILLION)						
		1	2	3	5	6	8 - 1	8 - 5
DRO	100	4340	< 5.2	< 5.2	< 5.2	< 5.2	8350	< 5.2
n-BUTYLBENZENE	NA	0.828	< 0.028	< 0.027	< 0.03	< 0.029	--	< 0.026
sec-BUTYLBENZENE	NA	0.125	< 0.028	< 0.027	< 0.03	< 0.029	--	< 0.026
CHLOROFORM	NA	< 0.028	0.0505	< 0.027	< 0.03	< 0.029	--	< 0.026
CHLOROMETHANE	NA	< 0.028	0.029	< 0.027	< 0.03	< 0.029	--	< 0.026
o-CHLOROTOLUENE	NA	0.193	< 0.028	< 0.027	< 0.03	< 0.029	--	< 0.026
p-CHLOROTOLUENE	A	0.111	< 0.028	< 0.027	< 0.03	< 0.029	--	< 0.026
p-ISOPROPYLTOLUENE	NA	0.59	< 0.028	< 0.027	< 0.03	< 0.029	--	< 0.026
NAPHTHALENE	20	0.397	< .0019	< .0018	< 0.002	< 0.002	--	< 0.0018
n-PROPOYLBENZENE	NA	0.0675	< 0.028	< 0.027	< 0.03	< 0.029	--	< 0.026
1,2,4-TRIMETHYLBENZENE	NA	1.52	< 0.028	< 0.027	< 0.03	< 0.029	--	< 0.026
1,3,5-TRIMETHYLBENZENE	NA	0.818	< 0.028	< 0.027	< 0.03	< 0.029	--	< 0.026
XYLENES	4100	0.1317	< 0.028	< 0.027	< 0.03	< 0.029	--	< 0.026
BENZO(k)FLUORANTHENE	0.88	0.021	< .0011	< .0011	< 0.0012	< 0.0012	--	< 0.001
FLUORENE	600	0.712	< .0015	< .0014	< 0.0015	< 0.0015	--	< 0.0013
1-METHYLNAPHTHALENE	1100	2.53	< .0023	< .0022	< 0.0024	< 0.0023	--	< 0.0021
2-METHYLNAPHTHALENE	600	3.30	< .0026	< .0025	< 0.0027	< 0.0026	--	< 0.0024

DRO = DIESEL RANGE ORGANICS
A " < " SIGN BEFORE A RESULT MEANS NO DETECTION OF THAT COMPOUND AT OR ABOVE THAT LEVEL
NA = NOT ESTABLISHED

CEDAR CORPORATION
 604 Wilson Avenue
 MENOMONIE, WISCONSIN 54751

LETTER OF TRANSMITTAL

715-235-9081 800-472-7372
 FAX 715-235-2727

DATE	7-14-97	JOB NO.
ATTENTION	Doug Joseph	
RE:	Mack Truck Eau Claire	
	02-18-151537	
	RECEIVED	
	JUL 16 1997	
	DNR-WD	

TO WDNR - Western District
P.O. Box 4001
Eau Claire, WI 54702-4001

WE ARE SENDING YOU Attached Under separate cover via _____ the following items:

- Shop drawings Prints Plans Samples Specifications
 Copy of letter Change order _____

COPIES	DATE	NO.	DESCRIPTION

THESE ARE TRANSMITTED as checked below:

- For approval Approved as submitted Resubmit _____ copies for approval
 For your use Approved as noted Submit _____ copies for distribution
 As requested Returned for corrections Return _____ corrected prints
 For review and comment _____
 FOR BIDS DUE _____ 19 _____ PRINTS RETURNED AFTER LOAN TO US

REMARKS _____

Attached is Notification to Treat Form.

COPY TO _____

SIGNED: Matt Taylor

State of Wisconsin
 Department of Natural Resources

**NOTIFICATION TO TREAT OR DISPOSE OF
 PETROLEUM CONTAMINATED SOIL & WATER**
 Form 400-120 Rev. 10-95

This form is required by the Department of Natural Resources (DNR) to ensure that the remediation of petroleum contaminated soil and water is in compliance with NR 158, NR 500-540, NR 419 and NR 445, Wis. Adm. Code. Failure to comply with applicable statutes and administrative rules may lead to violations of subchapters III and IV of Ch. 144, Wis. Stats. and may result in forfeitures of not less than \$10 or more than \$25,000 for each violation, pursuant to s. 144.426(1), 144.74(1), 144.99, Wis. Stats., or fines of not less than \$100 or more than \$150,000 or imprisonment for not more than 10 years, or both, pursuant to s. 144.74(2), Wis. Stats. Each day of a continuing violation constitutes a separate violation. Except for the remediation of virgin petroleum spills, this form needs to be submitted to the DNR 10 business days prior to the commencement of the remediation. Personally identifiable information found on this form is not intended to be used for any other purpose.

DIRECTIONS: 1) complete both sides of the form. 2) Have the responsible party sign the form. This signature certifies that the information on this form and in all supporting documents is accurate. 3) Submit the form with supporting documentation, lab reports and any maps to the appropriate District Air Management Program at least 10 business days prior to the commencement of remediation. 4) Submit a copy of this form to the DNR project manager and retain a copy for your records.

PART I - GENERAL INFORMATION

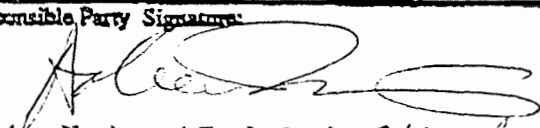
Site Name & Address: Eau Claire Made Sales 2412 Frank St. Eau Claire, WI 54703	Date of Form Completion: July 9, 1997
Site Number: 02-18-151537	Do Other Remediation Systems Exist at This Site: <input type="checkbox"/> Yes <input checked="" type="checkbox"/> No
County: Eau Claire	Site Type: <input type="checkbox"/> LUST <input type="checkbox"/> ERP <input type="checkbox"/> CERCLA <input checked="" type="checkbox"/> Other, Explain: Leaking floor drains
Responsible Party Name & Address: Mack Trucks of Rochester P.O. Box 6699 Rochester, MN 55903 Attn: Mr. Robert Nuss	Responsible Party Signature:  Telephone Number: (507) 288-9488 R.N. OR 715-874-5000 E.C.
Consulting Firm Name & Address: Cedar Corporation 604-Wilson Ave. Menomonie, WI 54751	Consulting Firm Contact: Matt Taylor Telephone Number: (715) 235-9081

PART II - SOIL AND WATER DATA (Attach Lab Reports and Calculations)

Type of Contaminant: <input type="checkbox"/> Gasoline <input type="checkbox"/> Diesel <input type="checkbox"/> Fuel Oil <input type="checkbox"/> Waste Oil <input type="checkbox"/> Chlorinated Organics <input type="checkbox"/> Other: _____																																								
Soil Concentration: <table style="width:100%; border:none;"> <tr> <td>GRO:</td> <td><u> </u> mg/kg/10⁶</td> <td>x</td> <td>2800 lb/yd³</td> <td>x</td> <td><u> </u> yd³</td> <td>=</td> <td><u> </u> lb</td> </tr> <tr> <td>DRO:</td> <td><u>4340</u> mg/kg/10⁶</td> <td>x</td> <td>2800 lb/yd³</td> <td>x</td> <td><u>25</u> yd³</td> <td>=</td> <td><u>303</u> lb</td> </tr> <tr> <td>Benzene:</td> <td><u><0.028</u> mg/kg/10⁶</td> <td>x</td> <td>2800 lb/yd³</td> <td>x</td> <td><u>25</u> yd³</td> <td>=</td> <td><u><0.002</u> lb</td> </tr> <tr> <td>Chlorinated Organics:</td> <td><u> </u> mg/kg/10⁶</td> <td>x</td> <td>2800 lb/yd³</td> <td>x</td> <td><u> </u> yd³</td> <td>=</td> <td><u> </u> lb</td> </tr> <tr> <td>Other:</td> <td><u> </u> mg/kg/10⁶</td> <td>x</td> <td>2800 lb/yd³</td> <td>x</td> <td><u> </u> yd³</td> <td>=</td> <td><u> </u> lb</td> </tr> </table>	GRO:	<u> </u> mg/kg/10 ⁶	x	2800 lb/yd ³	x	<u> </u> yd ³	=	<u> </u> lb	DRO:	<u>4340</u> mg/kg/10 ⁶	x	2800 lb/yd ³	x	<u>25</u> yd ³	=	<u>303</u> lb	Benzene:	<u><0.028</u> mg/kg/10 ⁶	x	2800 lb/yd ³	x	<u>25</u> yd ³	=	<u><0.002</u> lb	Chlorinated Organics:	<u> </u> mg/kg/10 ⁶	x	2800 lb/yd ³	x	<u> </u> yd ³	=	<u> </u> lb	Other:	<u> </u> mg/kg/10 ⁶	x	2800 lb/yd ³	x	<u> </u> yd ³	=	<u> </u> lb
GRO:	<u> </u> mg/kg/10 ⁶	x	2800 lb/yd ³	x	<u> </u> yd ³	=	<u> </u> lb																																	
DRO:	<u>4340</u> mg/kg/10 ⁶	x	2800 lb/yd ³	x	<u>25</u> yd ³	=	<u>303</u> lb																																	
Benzene:	<u><0.028</u> mg/kg/10 ⁶	x	2800 lb/yd ³	x	<u>25</u> yd ³	=	<u><0.002</u> lb																																	
Chlorinated Organics:	<u> </u> mg/kg/10 ⁶	x	2800 lb/yd ³	x	<u> </u> yd ³	=	<u> </u> lb																																	
Other:	<u> </u> mg/kg/10 ⁶	x	2800 lb/yd ³	x	<u> </u> yd ³	=	<u> </u> lb																																	
Water Concentration: <table style="width:100%; border:none;"> <tr> <td>GRO:</td> <td><u> </u> mg/L</td> <td>DRO:</td> <td><u> </u> mg/L</td> <td>Benzene:</td> <td><u> </u> mg/L</td> </tr> <tr> <td>Chlorinated Organics:</td> <td><u> </u> mg/L</td> <td>Other:</td> <td><u> </u> mg/L</td> <td></td> <td></td> </tr> </table>	GRO:	<u> </u> mg/L	DRO:	<u> </u> mg/L	Benzene:	<u> </u> mg/L	Chlorinated Organics:	<u> </u> mg/L	Other:	<u> </u> mg/L																														
GRO:	<u> </u> mg/L	DRO:	<u> </u> mg/L	Benzene:	<u> </u> mg/L																																			
Chlorinated Organics:	<u> </u> mg/L	Other:	<u> </u> mg/L																																					

PART III - TREATMENT OR DISPOSAL FACILITY INFORMATION

Treatment/Disposal Facility Name & Address: Superior Sevenmile Creek Biopile 8001 Olson Dr. Eau Claire, WI 54703	Facility ID: 391858947
	Air Pollution Control Permit Number: 04026
Facility Contact: Alan Albee	Facility Located in 10-county Area in Southeast Wisconsin? <input type="checkbox"/> Yes <input checked="" type="checkbox"/> No
	Distance to Nearest Residence or Business: 400 ft
Telephone Number: (715) 830-0284	
Headquarter Address: Superior Sevenmile Creek Landfill 8001 Olson Dr. Eau Claire, WI 54703	Portable Sources Only: Has a Portable Sources Relocation Notification (Form 4500-25) Been Submitted for This Location? <input type="checkbox"/> Yes <input type="checkbox"/> No

PART III - SOIL VACUUM EXTRACTION OR GROUNDWATER REMEDIATION

Site Contact:	Proposed Operations: (Attach Calculations)
Telephones Number: ()	Anticipated Start-Up Date:
Site Located in 10-county Area in Southeast Wisconsin? <input type="checkbox"/> Yes <input type="checkbox"/> No	Estimated Project Duration:
Distance to Nearest Residence or Business:	Number of Wells:
Pilot Test/Soil Venting Only: (Attach Lab Reports and Calculations)	Number of Emission Points:
Date of Test:	Stack Height:
Flow Rate (scfm):	Maximum Equipment Flow Rate (scfm or gpm):
Total Withdrawal of Air (scf):	Total VOC Emission Rate (lb/hr):
Total VOC Emission Rate (lb/hr):	Benzene Emission Rate (lb/hr):
Benzene Emission Rate (lb/hr):	Benzene Emission Rate (lb/yr):

PART III - OTHER REMEDIATION METHODS (Attach Lab Reports and Calculations)

Proposing Other Remediation Method? <input type="checkbox"/> Yes	Method Name: _____
Attach a project description for other remediation methods including landspreading, passive aeration and bioremediation. At a minimum, the information submitted should include the following items (with any supporting lab reports and calculations):	
<ul style="list-style-type: none"> ✓ Address/Location of Remediation Site - Indicate if this location is in the 10-county area in Southeast Wisconsin and the distance to the nearest residence or business. Include a map or site plan if appropriate. ✓ Description of Remediation Method. ✓ Project Contact & Telephone Number. ✓ Anticipated Start-Up and Estimated Project Duration. ✓ Highest Estimated Hourly VOC Emissions. ✓ Highest Estimated Hourly and Annual Benzene Emissions. ✓ Emission Testing Methodology. ✓ Final Destination of Soil. 	

June 11, 1997

Cedar Corporation
604 Wilson Ave.
Menomonie, WI 54751

Attn: Matt Taylor

Re: 2295-001-62

Please find enclosed the analytical results for the samples received May 24, 1997.

All analyses were completed in accordance with appropriate EPA and Wisconsin methodologies. Methods and dates of analysis are included in the report tables.

The chain of custody document is enclosed.

If you have any questions about the results, please call. Thank you for using US Filter/Enviroscan for your analytical needs.

Sincerely,

US Filter/Enviroscan

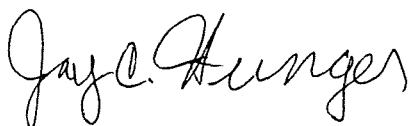

Jay C. Hunger
Analytical Chemist

Cedar Corporation
604 Wilson Ave.
Menomonie, WI 54751

CUST NUMBER: 2295-001-62
SAMPLED BY: Client
DATE REC'D: 05/24/97
REPORT DATE: 06/11/97
PREPARED BY: JCH
REVIEWED BY: *[Signature]*

Attn: Matt Taylor

	Units	Reporting Limit	1 05/23/97	Qualifiers	Date Analyzed
EPA 160.3					
Total Solids	%	-	89.6		05/27/97
EPA 8260					
Benzene	mg/kg	0.028	X		06/06/97
Bromobenzene	mg/kg	0.028	X	CSL SPL	06/06/97
Bromodichloromethane	mg/kg	0.028	X		06/06/97
n-Butylbenzene	mg/kg	0.028	0.828		06/06/97
sec-Butylbenzene	mg/kg	0.028	0.125		06/06/97
tert-Butylbenzene	mg/kg	0.028	X		06/06/97
Carbon Tetrachloride	mg/kg	0.028	X		06/06/97
Chlorobenzene	mg/kg	0.028	X		06/06/97
Chlorodibromomethane	mg/kg	0.028	X		06/06/97
Chloroethane	mg/kg	0.056	X		06/06/97
Chloroform	mg/kg	0.028	X		06/06/97
Chloromethane	mg/kg	0.028	X	CSL	06/06/97
o-Chlorotoluene	mg/kg	0.028	0.193		06/06/97
p-Chlorotoluene	mg/kg	0.028	0.111		06/06/97
1,2-Dibromo-3-chloropropane	mg/kg	0.028	X		06/06/97
1,2-Dibromoethane	mg/kg	0.028	X		06/06/97
1,2-Dichlorobenzene	mg/kg	0.028	X		06/06/97
1,3-Dichlorobenzene	mg/kg	0.028	X		06/06/97
1,4-Dichlorobenzene	mg/kg	0.028	X		06/06/97
Dichlorodifluoromethane	mg/kg	0.028	X		06/06/97
1,1-Dichloroethane	mg/kg	0.028	X		06/06/97
1,2-Dichloroethane	mg/kg	0.028	X		06/06/97
1,1-Dichloroethylene	mg/kg	0.028	X	SPL	06/06/97
cis-1,2-Dichloroethylene	mg/kg	0.028	X		06/06/97
trans-1,2-Dichloroethylene	mg/kg	0.028	X		06/06/97
1,2-Dichloropropane	mg/kg	0.028	X		06/06/97
1,3-Dichloropropane	mg/kg	0.028	X		06/06/97
2,2-Dichloropropane	mg/kg	0.028	X		06/06/97
Ethylbenzene	mg/kg	0.028	X		06/06/97
Hexachlorobutadiene	mg/kg	0.056	X		06/06/97
Isopropylbenzene	mg/kg	0.028	X		06/06/97
Isopropyl Ether	mg/kg	0.028	X		06/06/97
p-Isopropyltoluene	mg/kg	0.028	0.590		06/06/97
Methyl tert Butyl Ether	mg/kg	0.028	X		06/06/97
Methylene Chloride	mg/kg	0.056	X	CSL	06/06/97
Naphthalene	mg/kg	0.028	0.453	CSL	06/06/97
n-Propylbenzene	mg/kg	0.028	0.0675		06/06/97
Tetrachloroethylene	mg/kg	0.028	X		06/06/97
1,1,2,2-Tetrachloroethane	mg/kg	0.65	X		06/06/97

Analytical No.:

5860

X = Analyzed but not detected.
Results calculated on a dry weight basis.

Cedar Corporation
604 Wilson Ave.
Menomonie, WI 54751

CUST NUMBER: 2295-001-62
SAMPLED BY: Client
DATE REC'D: 05/24/97
REPORT DATE: 06/11/97
PREPARED BY: JCA
REVIEWED BY: *[Signature]*

Attn: Matt Taylor

	Units	Reporting Limit	1 05/23/97	Qualifiers	Date Analyzed
<u>EPA 8260</u>					
Toluene	mg/kg	0.028	X		06/06/97
1,2,3-Trichlorobenzene	mg/kg	0.056	X	SPL	06/06/97
1,2,4-Trichlorobenzene	mg/kg	0.056	X		06/06/97
1,1,1-Trichloroethane	mg/kg	0.028	X		06/06/97
1,1,2-Trichloroethane	mg/kg	0.028	X		06/06/97
Trichloroethylene	mg/kg	0.028	X		06/06/97
Trichlorofluoromethane	mg/kg	0.028	X	SPL DUP	06/06/97
1,2,4-Trimethylbenzene	mg/kg	0.028	1.52		06/06/97
1,3,5-Trimethylbenzene	mg/kg	0.028	0.816		06/06/97
Vinyl Chloride	mg/kg	0.028	X		06/06/97
m- & p-Xylene	mg/kg	0.028	0.0746		06/06/97
o-Xylene	mg/kg	0.028	0.0571		06/06/97
<u>EPA 8310</u>					
Acenaphthene	mg/kg	0.048	X		06/04/97
Acenaphthylene	mg/kg	0.019	X		06/04/97
Anthracene	mg/kg	0.011	X		06/04/97
Benzo (a) Anthracene	mg/kg	0.022	X		06/04/97
Benzo (a) Pyrene	mg/kg	0.022	X		06/04/97
Benzo (b) Fluoranthene	mg/kg	0.011	X		06/04/97
Benzo (k) Fluoranthene	mg/kg	0.0011	0.021		06/04/97
Benzo (ghi) Perylene	mg/kg	0.019	X		06/04/97
Chrysene	mg/kg	0.016	X		06/04/97
Dibenzo (a, h) Anthracene	mg/kg	0.022	X		06/04/97
Fluoranthene	mg/kg	0.016	X		06/04/97
Fluorene	mg/kg	0.0022	0.712		06/04/97
Indeno (1, 2, 3-cd) Pyrene	mg/kg	0.016	X		06/04/97
1-Methyl Naphthalene	mg/kg	0.0008	2.53		06/04/97
2-Methyl Naphthalene	mg/kg	0.0022	3.30		06/04/97
Naphthalene	mg/kg	0.0011	0.397		06/04/97
Phenanthrene	mg/kg	0.03	X		06/04/97
Pyrene	mg/kg	0.064	X		06/04/97
LUST Soil Org Ext - PNAs		-	COMP		05/30/97

Analytical No.:

5860

X = Analyzed but not detected.
Results calculated on a dry weight basis.

Cedar Corporation
604 Wilson Ave.
Menomonie, WI 54751

CUST NUMBER: 2295-001-62
SAMPLED BY: Client
DATE REC'D: 05/24/97
REPORT DATE: 06/11/97
PREPARED BY: JCN
REVIEWED BY: *[Signature]*

Attn: Matt Taylor

	Units	Reporting Limit	2 05/23/97	Qualifiers	Date Analyzed
EPA 160.3					
Total Solids	%	-	87.8		05/27/97
EPA 8260					
Benzene	mg/kg	0.028	X		06/06/97
Bromobenzene	mg/kg	0.028	X	CSL SPL	06/06/97
Bromodichloromethane	mg/kg	0.028	X		06/06/97
n-Butylbenzene	mg/kg	0.028	X		06/06/97
sec-Butylbenzene	mg/kg	0.028	X		06/06/97
tert-Butylbenzene	mg/kg	0.028	X		06/06/97
Carbon Tetrachloride	mg/kg	0.028	X		06/06/97
Chlorobenzene	mg/kg	0.028	X		06/06/97
Chlorodibromomethane	mg/kg	0.028	X		06/06/97
Chloroethane	mg/kg	0.057	X		06/06/97
Chloroform	mg/kg	0.028	0.0505		06/06/97
Chloromethane	mg/kg	0.028	0.0290	CSL	06/06/97
o-Chlorotoluene	mg/kg	0.028	X		06/06/97
p-Chlorotoluene	mg/kg	0.028	X		06/06/97
1,2-Dibromo-3-chloropropane	mg/kg	0.028	X		06/06/97
1,2-Dibromoethane	mg/kg	0.028	X		06/06/97
1,2-Dichlorobenzene	mg/kg	0.028	X		06/06/97
1,3-Dichlorobenzene	mg/kg	0.028	X		06/06/97
1,4-Dichlorobenzene	mg/kg	0.028	X		06/06/97
Dichlorodifluoromethane	mg/kg	0.028	X		06/06/97
1,1-Dichloroethane	mg/kg	0.028	X		06/06/97
1,2-Dichloroethane	mg/kg	0.028	X		06/06/97
1,1-Dichloroethylene	mg/kg	0.028	X	SPL	06/06/97
cis-1,2-Dichloroethylene	mg/kg	0.028	X		06/06/97
trans-1,2-Dichloroethylene	mg/kg	0.028	X		06/06/97
1,2-Dichloropropane	mg/kg	0.028	X		06/06/97
1,3-Dichloropropane	mg/kg	0.028	X		06/06/97
2,2-Dichloropropane	mg/kg	0.028	X		06/06/97
Ethylbenzene	mg/kg	0.028	X		06/06/97
Hexachlorobutadiene	mg/kg	0.057	X		06/06/97
Isopropylbenzene	mg/kg	0.028	X		06/06/97
Isopropyl Ether	mg/kg	0.028	X		06/06/97
p-Isopropyltoluene	mg/kg	0.028	X		06/06/97
Methyl tert Butyl Ether	mg/kg	0.028	X		06/06/97
Methylene Chloride	mg/kg	0.028	0.0574	LBC CSL	06/06/97
Naphthalene	mg/kg	0.057	X	CSL	06/06/97
n-Propylbenzene	mg/kg	0.028	X		06/06/97
Tetrachloroethylene	mg/kg	0.028	X		06/06/97
1,1,2,2-Tetrachloroethane	mg/kg	0.028	X		06/06/97

Analytical No.:

5861

X = Analyzed but not detected.
Results calculated on a dry weight basis.

Cedar Corporation
604 Wilson Ave.
Menomonie, WI 54751

CUST NUMBER: 2295-001-62
SAMPLED BY: Client
DATE REC'D: 05/24/97
REPORT DATE: 06/11/97
PREPARED BY: JCH
REVIEWED BY: *[Signature]*

Attn: Matt Taylor

	<u>Units</u>	<u>Reporting Limit</u>	<u>2 05/23/97</u>	<u>Qualifiers</u>	<u>Date Analyzed</u>
<u>EPA 8260</u>					
Toluene	mg/kg	0.028	X		06/06/97
1,2,3-Trichlorobenzene	mg/kg	0.057	X	SPL	06/06/97
1,2,4-Trichlorobenzene	mg/kg	0.057	X		06/06/97
1,1,1-Trichloroethane	mg/kg	0.028	X		06/06/97
1,1,2-Trichloroethane	mg/kg	0.028	X		06/06/97
Trichloroethylene	mg/kg	0.028	X		06/06/97
Trichlorofluoromethane	mg/kg	0.028	X	SPL DUP	06/06/97
1,2,4-Trimethylbenzene	mg/kg	0.028	X		06/06/97
1,3,5-Trimethylbenzene	mg/kg	0.028	X		06/06/97
Vinyl Chloride	mg/kg	0.028	X		06/06/97
m- & p-Xylene	mg/kg	0.028	X		06/06/97
o-Xylene	mg/kg	0.028	X		06/06/97
<u>EPA 8310</u>					
Acenaphthene	mg/kg	0.0049	X		06/04/97
Acenaphthylene	mg/kg	0.0019	X		06/04/97
Anthracene	mg/kg	0.0011	X		06/04/97
Benzo (a) Anthracene	mg/kg	0.0023	X		06/04/97
Benzo (a) Pyrene	mg/kg	0.0023	X		06/04/97
Benzo (b) Fluoranthene	mg/kg	0.0011	X		06/04/97
Benzo (k) Fluoranthene	mg/kg	0.0011	X		06/04/97
Benzo (ghi) Perylene	mg/kg	0.0019	X		06/04/97
Chrysene	mg/kg	0.0015	X		06/04/97
Dibenzo (a, h) Anthracene	mg/kg	0.0023	X		06/04/97
Fluoranthene	mg/kg	0.0015	X		06/04/97
Fluorene	mg/kg	0.0015	X		06/04/97
Indeno (1, 2, 3-cd) Pyrene	mg/kg	0.0015	X		06/04/97
1-Methyl Naphthalene	mg/kg	0.0023	X		06/04/97
2-Methyl Naphthalene	mg/kg	0.0026	X		06/04/97
Naphthalene	mg/kg	0.0019	X		06/04/97
Phenanthrene	mg/kg	0.0031	X		06/04/97
Pyrene	mg/kg	0.0065	X		06/04/97
LUST Soil Org Ext - PNAs		-		COMP	05/30/97
Analytical No.:			5861		

X = Analyzed but not detected.
Results calculated on a dry weight basis.

Cedar Corporation
604 Wilson Ave.
Menomonie, WI 54751

CUST NUMBER: 2295-001-62
SAMPLED BY: Client
DATE REC'D: 05/24/97
REPORT DATE: 06/11/97
PREPARED BY: JCH
REVIEWED BY: *[Signature]*

Attn: Matt Taylor

	<u>Units</u>	<u>Reporting Limit</u>	<u>3 05/23/97</u>	<u>Qualifiers</u>	<u>Date Analyzed</u>
<u>EPA 160.3</u>					
Total Solids	%	-	92.9		05/27/97
<u>EPA 8260</u>					
Benzene	mg/kg	0.027	X		06/06/97
Bromobenzene	mg/kg	0.027	X	CSL SPL	06/06/97
Bromodichloromethane	mg/kg	0.027	X		06/06/97
n-Butylbenzene	mg/kg	0.027	X		06/06/97
sec-Butylbenzene	mg/kg	0.027	X		06/06/97
tert-Butylbenzene	mg/kg	0.027	X		06/06/97
Carbon Tetrachloride	mg/kg	0.027	X		06/06/97
Chlorobenzene	mg/kg	0.027	X		06/06/97
Chlorodibromomethane	mg/kg	0.027	X		06/06/97
Chloroethane	mg/kg	0.054	X		06/06/97
Chloroform	mg/kg	0.027	X		06/06/97
Chloromethane	mg/kg	0.027	X	CSL	06/06/97
o-Chlorotoluene	mg/kg	0.027	X		06/06/97
p-Chlorotoluene	mg/kg	0.027	X		06/06/97
1,2-Dibromo-3-chloropropane	mg/kg	0.027	X		06/06/97
1,2-Dibromoethane	mg/kg	0.027	X		06/06/97
1,2-Dichlorobenzene	mg/kg	0.027	X		06/06/97
1,3-Dichlorobenzene	mg/kg	0.027	X		06/06/97
1,4-Dichlorobenzene	mg/kg	0.027	X		06/06/97
Dichlorodifluoromethane	mg/kg	0.027	X		06/06/97
1,1-Dichloroethane	mg/kg	0.027	X		06/06/97
1,2-Dichloroethane	mg/kg	0.027	X		06/06/97
1,1-Dichloroethylene	mg/kg	0.027	X	SPL	06/06/97
cis-1,2-Dichloroethylene	mg/kg	0.027	X		06/06/97
trans-1,2-Dichloroethylene	mg/kg	0.027	X		06/06/97
1,2-Dichloropropane	mg/kg	0.027	X		06/06/97
1,3-Dichloropropane	mg/kg	0.027	X		06/06/97
2,2-Dichloropropane	mg/kg	0.027	X		06/06/97
Ethylbenzene	mg/kg	0.027	X		06/06/97
Hexachlorobutadiene	mg/kg	0.054	X		06/06/97
Isopropylbenzene	mg/kg	0.027	X		06/06/97
Isopropyl Ether	mg/kg	0.027	X		06/06/97
p-Isopropyltoluene	mg/kg	0.027	X		06/06/97
Methyl tert Butyl Ether	mg/kg	0.027	X		06/06/97
Methylene Chloride	mg/kg	0.054	X	CSL	06/06/97
Naphthalene	mg/kg	0.054	X	CSL	06/06/97
n-Propylbenzene	mg/kg	0.027	X		06/06/97
Tetrachloroethylene	mg/kg	0.027	X		06/06/97
1,1,2,2-Tetrachloroethane	mg/kg	0.027	X		06/06/97

Analytical No.:

5862

X = Analyzed but not detected.
Results calculated on a dry weight basis.

Cedar Corporation
604 Wilson Ave.
Menomonie, WI 54751

CUST NUMBER: 2295-001-62
SAMPLED BY: Client
DATE REC'D: 05/24/97
REPORT DATE: 06/11/97
PREPARED BY: JSH
REVIEWED BY: *[Signature]*

Attn: Matt Taylor

	<u>Units</u>	<u>Reporting Limit</u>	<u>3 05/23/97</u>	<u>Qualifiers</u>	<u>Date Analyzed</u>
<u>EPA 8260</u>					
Toluene	mg/kg	0.027	X		06/06/97
1,2,3-Trichlorobenzene	mg/kg	0.054	X	SPL	06/06/97
1,2,4-Trichlorobenzene	mg/kg	0.054	X		06/06/97
1,1,1-Trichloroethane	mg/kg	0.027	X		06/06/97
1,1,2-Trichloroethane	mg/kg	0.027	X		06/06/97
Trichloroethylene	mg/kg	0.027	X		06/06/97
Trichlorofluoromethane	mg/kg	0.027	X	SPL DUP	06/06/97
1,2,4-Trimethylbenzene	mg/kg	0.027	X		06/06/97
1,3,5-Trimethylbenzene	mg/kg	0.027	X		06/06/97
Vinyl Chloride	mg/kg	0.027	X		06/06/97
m- & p-Xylene	mg/kg	0.027	X		06/06/97
o-Xylene	mg/kg	0.027	X		06/06/97
<u>EPA 8310</u>					
Acenaphthene	mg/kg	0.0046	X		06/04/97
Acenaphthylene	mg/kg	0.0018	X		06/04/97
Anthracene	mg/kg	0.0011	X		06/04/97
Benzo(a) Anthracene	mg/kg	0.0022	X		06/04/97
Benzo(a) Pyrene	mg/kg	0.0022	X		06/04/97
Benzo(b) Fluoranthene	mg/kg	0.0011	X		06/04/97
Benzo(k) Fluoranthene	mg/kg	0.0011	X		06/04/97
Benzo(ghi) Perylene	mg/kg	0.0018	X		06/04/97
Chrysene	mg/kg	0.0014	X		06/04/97
Dibenzo(a,h) Anthracene	mg/kg	0.0022	X		06/04/97
Fluoranthene	mg/kg	0.0014	X		06/04/97
Fluorene	mg/kg	0.0014	X		06/04/97
Indeno(1,2,3-cd) Pyrene	mg/kg	0.0014	X		06/04/97
1-Methyl Naphthalene	mg/kg	0.0022	X		06/04/97
2-Methyl Naphthalene	mg/kg	0.0025	X		06/04/97
Naphthalene	mg/kg	0.0018	X		06/04/97
Phenanthrene	mg/kg	0.0029	X		06/04/97
Pyrene	mg/kg	0.0061	X		06/04/97
LUST Soil Org Ext - PNAs		-	COMP		05/30/97

Analytical No.:

5862

X = Analyzed but not detected.
Results calculated on a dry weight basis.

Cedar Corporation
604 Wilson Ave.
Menomonie, WI 54751

CUST NUMBER: 2295-001-62
SAMPLED BY: Client
DATE REC'D: 05/24/97
REPORT DATE: 06/11/97
PREPARED BY: JCH
REVIEWED BY: *[Signature]*

Attn: Matt Taylor

	Units	Reporting Limit	5 05/23/97	Qualifiers	Date Analyzed
EPA 160.3					
Total Solids	%	-	84.2		05/27/97
EPA 8260					
Benzene	mg/kg	0.03	X		06/06/97
Bromobenzene	mg/kg	0.03	X	CSL SPL	06/06/97
Bromodichloromethane	mg/kg	0.03	X		06/06/97
n-Butylbenzene	mg/kg	0.03	X		06/06/97
sec-Butylbenzene	mg/kg	0.03	X		06/06/97
tert-Butylbenzene	mg/kg	0.03	X		06/06/97
Carbon Tetrachloride	mg/kg	0.03	X		06/06/97
Chlorobenzene	mg/kg	0.03	X		06/06/97
Chlorodibromomethane	mg/kg	0.03	X		06/06/97
Chloroethane	mg/kg	0.059	X		06/06/97
Chloroform	mg/kg	0.03	X		06/06/97
Chloromethane	mg/kg	0.03	X	CSL	06/06/97
o-Chlorotoluene	mg/kg	0.03	X		06/06/97
p-Chlorotoluene	mg/kg	0.03	X		06/06/97
1,2-Dibromo-3-chloropropane	mg/kg	0.03	X		06/06/97
1,2-Dibromoethane	mg/kg	0.03	X		06/06/97
1,2-Dichlorobenzene	mg/kg	0.03	X		06/06/97
1,3-Dichlorobenzene	mg/kg	0.03	X		06/06/97
1,4-Dichlorobenzene	mg/kg	0.03	X		06/06/97
Dichlorodifluoromethane	mg/kg	0.03	X		06/06/97
1,1-Dichloroethane	mg/kg	0.03	X		06/06/97
1,2-Dichloroethane	mg/kg	0.03	X		06/06/97
1,1-Dichloroethylene	mg/kg	0.03	X	SPL	06/06/97
cis-1,2-Dichloroethylene	mg/kg	0.03	X		06/06/97
trans-1,2-Dichloroethylene	mg/kg	0.03	X		06/06/97
1,2-Dichloropropane	mg/kg	0.03	X		06/06/97
1,3-Dichloropropane	mg/kg	0.03	X		06/06/97
2,2-Dichloropropane	mg/kg	0.03	X		06/06/97
Ethylbenzene	mg/kg	0.03	X		06/06/97
Hexachlorobutadiene	mg/kg	0.059	X		06/06/97
Isopropylbenzene	mg/kg	0.03	X		06/06/97
Isopropyl Ether	mg/kg	0.03	X		06/06/97
p-Isopropyltoluene	mg/kg	0.03	X		06/06/97
Methyl tert Butyl Ether	mg/kg	0.03	X		06/06/97
Methylene Chloride	mg/kg	0.059	X	CSL	06/06/97
Naphthalene	mg/kg	0.059	X	CSL	06/06/97
n-Propylbenzene	mg/kg	0.03	X		06/06/97
Tetrachloroethylene	mg/kg	0.03	X		06/06/97
1,1,2,2-Tetrachloroethane	mg/kg	0.03	X		06/06/97

Analytical No.:

5863

X = Analyzed but not detected.
Results calculated on a dry weight basis.

Cedar Corporation
604 Wilson Ave.
Menomonie, WI 54751

CUST NUMBER: 2295-001-62
SAMPLED BY: Client
DATE REC'D: 05/24/97
REPORT DATE: 06/11/97
PREPARED BY: JCH
REVIEWED BY: *my*

Attn: Matt Taylor

	<u>Units</u>	<u>Reporting Limit</u>	<u>5 05/23/97</u>	<u>Qualifiers</u>	<u>Date Analyzed</u>
<u>EPA 8260</u>					
Toluene	mg/kg	0.03	X		06/06/97
1,2,3-Trichlorobenzene	mg/kg	0.059	X	SPL	06/06/97
1,2,4-Trichlorobenzene	mg/kg	0.059	X		06/06/97
1,1,1-Trichloroethane	mg/kg	0.03	X		06/06/97
1,1,2-Trichloroethane	mg/kg	0.03	X		06/06/97
Trichloroethylene	mg/kg	0.03	X		06/06/97
Trichlorofluoromethane	mg/kg	0.03	X	SPL DUP	06/06/97
1,2,4-Trimethylbenzene	mg/kg	0.03	X		06/06/97
1,3,5-Trimethylbenzene	mg/kg	0.03	X		06/06/97
Vinyl Chloride	mg/kg	0.03	X		06/06/97
m- & p-Xylene	mg/kg	0.03	X		06/06/97
o-Xylene	mg/kg	0.03	X		06/06/97
<u>EPA 8310</u>					
Acenaphthene	mg/kg	0.0051	X		06/04/97
Acenaphthylene	mg/kg	0.002	X		06/04/97
Anthracene	mg/kg	0.0012	X		06/04/97
Benzo (a) Anthracene	mg/kg	0.0024	X		06/04/97
Benzo (a) Pyrene	mg/kg	0.0024	X		06/04/97
Benzo (b) Fluoranthene	mg/kg	0.0012	X		06/04/97
Benzo (k) Fluoranthene	mg/kg	0.0012	X		06/04/97
Benzo (ghi) Perylene	mg/kg	0.002	X		06/04/97
Chrysene	mg/kg	0.0015	X		06/04/97
Dibenzo (a, h) Anthracene	mg/kg	0.0024	X		06/04/97
Fluoranthene	mg/kg	0.0015	X		06/04/97
Fluorene	mg/kg	0.0015	X		06/04/97
Indeno (1,2,3-cd) Pyrene	mg/kg	0.0015	X		06/04/97
1-Methyl Naphthalene	mg/kg	0.0024	X		06/04/97
2-Methyl Naphthalene	mg/kg	0.0027	X		06/04/97
Naphthalene	mg/kg	0.002	X		06/04/97
Phenanthrene	mg/kg	0.0032	X		06/04/97
Pyrene	mg/kg	0.0067	X		06/04/97
LUST Soil Org Ext - PNAs			COMP		05/30/97

Analytical No.:

5863

X = Analyzed but not detected.
Results calculated on a dry weight basis.

Cedar Corporation
 604 Wilson Ave.
 Menomonie, WI 54751

CUST NUMBER: 2295-001-62
 SAMPLED BY: Client
 DATE REC'D: 05/24/97
 REPORT DATE: 06/11/97
 PREPARED BY: JCH
 REVIEWED BY: *[Signature]*

Attn: Matt Taylor

	Units	Reporting Limit	6 05/23/97	Qualifiers	Date Analyzed
EPA 160.3					
Total Solids	%	-	86.9		05/27/97
EPA 8260					
Benzene	mg/kg	0.029	X		06/06/97
Bromobenzene	mg/kg	0.029	X	CSL SPL	06/06/97
Bromodichloromethane	mg/kg	0.029	X		06/06/97
n-Butylbenzene	mg/kg	0.029	X		06/06/97
sec-Butylbenzene	mg/kg	0.029	X		06/06/97
tert-Butylbenzene	mg/kg	0.029	X		06/06/97
Carbon Tetrachloride	mg/kg	0.029	X		06/06/97
Chlorobenzene	mg/kg	0.029	X		06/06/97
Chlorodibromomethane	mg/kg	0.029	X		06/06/97
Chloroethane	mg/kg	0.058	X		06/06/97
Chloroform	mg/kg	0.029	X		06/06/97
Chloromethane	mg/kg	0.029	X	CSL	06/06/97
o-Chlorotoluene	mg/kg	0.029	X		06/06/97
p-Chlorotoluene	mg/kg	0.029	X		06/06/97
1,2-Dibromo-3-chloropropane	mg/kg	0.029	X		06/06/97
1,2-Dibromoethane	mg/kg	0.029	X		06/06/97
1,2-Dichlorobenzene	mg/kg	0.029	X		06/06/97
1,3-Dichlorobenzene	mg/kg	0.029	X		06/06/97
1,4-Dichlorobenzene	mg/kg	0.029	X		06/06/97
Dichlorodifluoromethane	mg/kg	0.029	X		06/06/97
1,1-Dichloroethane	mg/kg	0.029	X		06/06/97
1,2-Dichloroethane	mg/kg	0.029	X		06/06/97
1,1-Dichloroethylene	mg/kg	0.029	X	SPL	06/06/97
cis-1,2-Dichloroethylene	mg/kg	0.029	X		06/06/97
trans-1,2-Dichloroethylene	mg/kg	0.029	X		06/06/97
1,2-Dichloropropane	mg/kg	0.029	X		06/06/97
1,3-Dichloropropane	mg/kg	0.029	X		06/06/97
2,2-Dichloropropane	mg/kg	0.029	X		06/06/97
Ethylbenzene	mg/kg	0.029	X		06/06/97
Hexachlorobutadiene	mg/kg	0.058	X		06/06/97
Isopropylbenzene	mg/kg	0.029	X		06/06/97
Isopropyl Ether	mg/kg	0.029	X		06/06/97
p-Isopropyltoluene	mg/kg	0.029	X		06/06/97
Methyl tert Butyl Ether	mg/kg	0.029	X		06/06/97
Methylene Chloride	mg/kg	0.058	X	CSL	06/06/97
Naphthalene	mg/kg	0.058	X	CSL	06/06/97
n-Propylbenzene	mg/kg	0.029	X		06/06/97
Tetrachloroethylene	mg/kg	0.029	X		06/06/97
1,1,2,2-Tetrachloroethane	mg/kg	0.029	X		06/06/97

Analytical No.:

5864

X = Analyzed but not detected.
 Results calculated on a dry weight basis.

Cedar Corporation
604 Wilson Ave.
Menomonie, WI 54751

CUST NUMBER: 2295-001-62
SAMPLED BY: Client
DATE REC'D: 05/24/97
REPORT DATE: 06/11/97
PREPARED BY: JCH
REVIEWED BY: *[Signature]*

Attn: Matt Taylor

	Units	Reporting Limit	6 05/23/97	Qualifiers	Date Analyzed
<u>EPA 8260</u>					
Toluene	mg/kg	0.029	X		06/06/97
1,2,3-Trichlorobenzene	mg/kg	0.058	X	SPL	06/06/97
1,2,4-Trichlorobenzene	mg/kg	0.058	X		06/06/97
1,1,1-Trichloroethane	mg/kg	0.029	X		06/06/97
1,1,2-Trichloroethane	mg/kg	0.029	X		06/06/97
Trichloroethylene	mg/kg	0.029	X		06/06/97
Trichlorofluoromethane	mg/kg	0.029	X	SPL DUP	06/06/97
1,2,4-Trimethylbenzene	mg/kg	0.029	X		06/06/97
1,3,5-Trimethylbenzene	mg/kg	0.029	X		06/06/97
Vinyl Chloride	mg/kg	0.029	X		06/06/97
m- & p-Xylene	mg/kg	0.029	X		06/06/97
o-Xylene	mg/kg	0.029	X		06/06/97
<u>EPA 8310</u>					
Acenaphthene	mg/kg	0.0049	X		06/04/97
Acenaphthylene	mg/kg	0.002	X		06/04/97
Anthracene	mg/kg	0.0012	X		06/04/97
Benzo (a) Anthracene	mg/kg	0.0023	X		06/04/97
Benzo (a) Pyrene	mg/kg	0.0023	X		06/04/97
Benzo (b) Fluoranthene	mg/kg	0.0012	X		06/04/97
Benzo (k) Fluoranthene	mg/kg	0.0012	X		06/04/97
Benzo (ghi) Perylene	mg/kg	0.002	X		06/04/97
Chrysene	mg/kg	0.0015	X		06/04/97
Dibenzo (a, h) Anthracene	mg/kg	0.0023	X		06/04/97
Fluoranthene	mg/kg	0.0015	X		06/04/97
Fluorene	mg/kg	0.0015	X		06/04/97
Indeno (1, 2, 3-cd) Pyrene	mg/kg	0.0015	X		06/04/97
1-Methyl Naphthalene	mg/kg	0.0023	X		06/04/97
2-Methyl Naphthalene	mg/kg	0.0026	X		06/04/97
Naphthalene	mg/kg	0.002	X		06/04/97
Phenanthrene	mg/kg	0.0031	X		06/04/97
Pyrene	mg/kg	0.0066	X		06/04/97
LUST Soil Org Ext - PNAs		-	COMP		05/30/97

Analytical No.: 5864

X = Analyzed but not detected.
Results calculated on a dry weight basis.

Cedar Corporation
604 Wilson Ave.
Menomonie, WI 54751

CUST NUMBER: 2295-001-62
SAMPLED BY: Client
DATE REC'D: 05/24/97
REPORT DATE: 06/11/97
PREPARED BY: JCH
REVIEWED BY: *[Signature]*

Attn: Matt Taylor

	<u>Units</u>	<u>Reporting Limit</u>	<u>8-1 05/23/97</u>	<u>Qualifiers</u>	<u>Date Analyzed</u>
<u>EPA 160.3</u>					
Total Solids	%	-	90.5		05/27/97
Analytical No.:			5865		

Results calculated on a dry weight basis.

Cedar Corporation
604 Wilson Ave.
Menomonie, WI 54751

CUST NUMBER: 2295-001-62
SAMPLED BY: Client
DATE REC'D: 05/24/97
REPORT DATE: 06/11/97
PREPARED BY: JCH
REVIEWED BY: *[Signature]*

Attn: Matt Taylor

	<u>Units</u>	<u>Reporting Limit</u>	<u>8-5 05/23/97</u>	<u>Qualifiers</u>	<u>Date Analyzed</u>
EPA 160.3					
Total Solids	%	-	96.8		05/27/97
EPA 8260					
Benzene	mg/kg	0.026	X		06/06/97
Bromobenzene	mg/kg	0.026	X	CSL SPL	06/06/97
Bromodichloromethane	mg/kg	0.026	X		06/06/97
n-Butylbenzene	mg/kg	0.026	X		06/06/97
sec-Butylbenzene	mg/kg	0.026	X		06/06/97
tert-Butylbenzene	mg/kg	0.026	X		06/06/97
Carbon Tetrachloride	mg/kg	0.026	X		06/06/97
Chlorobenzene	mg/kg	0.026	X		06/06/97
Chlorodibromomethane	mg/kg	0.026	X		06/06/97
Chloroethane	mg/kg	0.052	X		06/06/97
Chloroform	mg/kg	0.026	X		06/06/97
Chloromethane	mg/kg	0.026	X	CSL	06/06/97
o-Chlorotoluene	mg/kg	0.026	X		06/06/97
p-Chlorotoluene	mg/kg	0.026	X		06/06/97
1,2-Dibromo-3-chloropropane	mg/kg	0.026	X		06/06/97
1,2-Dibromoethane	mg/kg	0.026	X		06/06/97
1,2-Dichlorobenzene	mg/kg	0.026	X		06/06/97
1,3-Dichlorobenzene	mg/kg	0.026	X		06/06/97
1,4-Dichlorobenzene	mg/kg	0.026	X		06/06/97
Dichlorodifluoromethane	mg/kg	0.026	X		06/06/97
1,1-Dichloroethane	mg/kg	0.026	X		06/06/97
1,2-Dichloroethane	mg/kg	0.026	X		06/06/97
1,1-Dichloroethylene	mg/kg	0.026	X	SPL	06/06/97
cis-1,2-Dichloroethylene	mg/kg	0.026	X		06/06/97
trans-1,2-Dichloroethylene	mg/kg	0.026	X		06/06/97
1,2-Dichloropropane	mg/kg	0.026	X		06/06/97
1,3-Dichloropropane	mg/kg	0.026	X		06/06/97
2,2-Dichloropropane	mg/kg	0.026	X		06/06/97
Ethylbenzene	mg/kg	0.026	X		06/06/97
Hexachlorobutadiene	mg/kg	0.052	X		06/06/97
Isopropylbenzene	mg/kg	0.026	X		06/06/97
Isopropyl Ether	mg/kg	0.026	X		06/06/97
p-Isopropyltoluene	mg/kg	0.026	X		06/06/97
Methyl tert Butyl Ether	mg/kg	0.026	X		06/06/97
Methylene Chloride	mg/kg	0.052	X	CSL	06/06/97
Naphthalene	mg/kg	0.052	X	CSL	06/06/97
n-Propylbenzene	mg/kg	0.026	X		06/06/97
Tetrachloroethylene	mg/kg	0.026	X		06/06/97
1,1,2,2-Tetrachloroethane	mg/kg	0.026	X		06/06/97

Analytical No.:

5866

X = Analyzed but not detected.
Results calculated on a dry weight basis.

Cedar Corporation
604 Wilson Ave.
Menomonie, WI 54751

CUST NUMBER: 2295-001-62
SAMPLED BY: Client
DATE REC'D: 05/24/97
REPORT DATE: 06/11/97
PREPARED BY: JCH
REVIEWED BY: *[Signature]*

Attn: Matt Taylor

	<u>Units</u>	<u>Reporting Limit</u>	<u>8-5 05/23/97</u>	<u>Qualifiers</u>	<u>Date Analyzed</u>
<u>EPA 8260</u>					
Toluene	mg/kg	0.026	X		06/06/97
1,2,3-Trichlorobenzene	mg/kg	0.052	X	SPL	06/06/97
1,2,4-Trichlorobenzene	mg/kg	0.052	X		06/06/97
1,1,1-Trichloroethane	mg/kg	0.026	X		06/06/97
1,1,2-Trichloroethane	mg/kg	0.026	X		06/06/97
Trichloroethylene	mg/kg	0.026	X		06/06/97
Trichlorofluoromethane	mg/kg	0.026	X	SPL DUP	06/06/97
1,2,4-Trimethylbenzene	mg/kg	0.026	X		06/06/97
1,3,5-Trimethylbenzene	mg/kg	0.026	X		06/06/97
Vinyl Chloride	mg/kg	0.026	X		06/06/97
m- & p-Xylene	mg/kg	0.026	X		06/06/97
o-Xylene	mg/kg	0.026	X		06/06/97
<u>EPA 8310</u>					
Acenaphthene	mg/kg	0.0044	X		06/04/97
Acenaphthylene	mg/kg	0.0018	X		06/04/97
Anthracene	mg/kg	0.001	X		06/04/97
Benzo(a)Anthracene	mg/kg	0.0021	X		06/04/97
Benzo(a)Pyrene	mg/kg	0.0021	X		06/04/97
Benzo(b)Fluoranthene	mg/kg	0.001	X		06/04/97
Benzo(k)Fluoranthene	mg/kg	0.001	X		06/04/97
Benzo(ghi)Perylene	mg/kg	0.0018	X		06/04/97
Chrysene	mg/kg	0.0013	X		06/04/97
Dibenzo(a,h)Anthracene	mg/kg	0.0021	X		06/04/97
Fluoranthene	mg/kg	0.0013	X		06/04/97
Fluorene	mg/kg	0.0013	X		06/04/97
Indeno(1,2,3-cd)Pyrene	mg/kg	0.0013	X		06/04/97
1-Methyl Naphthalene	mg/kg	0.0021	X		06/04/97
2-Methyl Naphthalene	mg/kg	0.0024	X		06/04/97
Naphthalene	mg/kg	0.0018	X		06/04/97
Phenanthrene	mg/kg	0.0028	X		06/04/97
Pyrene	mg/kg	0.0059	X		06/04/97
LUST Soil Org Ext - PNAs		-	COMP		05/30/97
Analytical No.:			5866		

X = Analyzed but not detected.
Results calculated on a dry weight basis.

Cedar Corporation
604 Wilson Ave.
Menomonie, WI 54751

CUST NUMBER: 2295-001-62
SAMPLED BY: Client
DATE REC'D: 05/24/97
REPORT DATE: 06/11/97
PREPARED BY: JCH
REVIEWED BY: *[Signature]*

Attn: Matt Taylor

Modified Diesel Range Organics (DRO)
Parameter # 78919

	DRO	Qualifiers	Date Ext	Date Analyzed	Analytical No.
1	4,340.	D1 D2B D5	05/27/97	06/03/97	5860
2	X		05/27/97	05/30/97	5861
3	X		05/27/97	05/30/97	5862
5	X		05/27/97	05/30/97	5863
6	X		05/27/97	05/30/97	5864
8-1	8,350.	D2B D5	05/27/97	05/30/97	5865
8-5	X		05/27/97	05/30/97	5866

Reporting Limit 5.2

Units mg/kg

X = Analyzed but not detected.
Results calculated on a dry weight basis.

Qualifiers: Only above indicated qualifiers apply.

- (D1) The chromatogram is characteristic for a fuel oil/diesel. (i.e. #1 or #2 Diesel, jet fuel, kerosene, aged or degraded diesel, etc.)
- (D2) The chromatogram is not characteristic for diesel. It has the characteristics of a product which has significant peaks within the DRO window.
- (D2A) The chromatogram is characteristic for a light petroleum product (i.e. gasoline, aged or degraded gasoline, mineral spirits, etc.)
- (D2B) The chromatogram is characteristic for a heavier petroleum product other than diesel (i.e. motor oil, hydraulic oil, etc.)
- (D3) The chromatogram is not characteristic for diesel or any single common petroleum product.
- (D4) The chromatogram contained significant peaks outside the DRO window.
- (D5) The chromatogram contained significant peaks and a raised baseline outside the DRO window.

The entire area within the DRO window was quantitated.

The replicate spike recovery of this batch of samples was found to be 69.7% and 70.0%.

The spike recovery of 69.7% is below the 70.0% limit defined by the method.

Cedar Corporation
604 Wilson Ave.
Menomonie, WI 54751

CUST NUMBER: 2295-001-62
SAMPLED BY: Client
DATE REC'D: 05/24/97
REPORT DATE: 06/11/97
PREPARED BY: JCH
REVIEWED BY: *[Signature]*

Attn: Matt Taylor

Qualifier Descriptions

CSL	Check standard for this analyte exhibited a low bias. Sample results may also be biased low. Non-detects verified with a low standard comparison.
SPL	Matrix spike recovery within analytical batch was low. Sample matrix appears similar to your sample; result may be biased low.
DUP	Result of duplicate analysis in this quality assurance batch exceeds the limits for precision.
LBC	Analyte is a common laboratory solvent or chemical. Positive identification may be due to laboratory contamination.

Sample Receipt Report

Client: CedarDate Received: 5/26/97Analytical No.: 5860 Through 5866**Check all deviations from EPA or WDNR sample protocol.**

- Sample(s) received at ____ °C which is above the EPA and WDNR limit of 4°C.
- VOC vial(s) received with headspace. Explain: _____
- Sample(s) received in bottles not furnished by Enviroscan. Preservation method, if used, is unknown.
- Sample(s) not properly preserved per EPA/WDNR protocol for the following: _____
- Sample(s) received beyond EPA holding time for: _____
- Sample date/time not supplied by client. Actual holding time unknown.
- GRO/PVOC/VOC/DRO (circle appropriate) sample(s) are < 19.5 gms and this report is the flag for that information. Sample(s) under-weight: _____
- GRO/PVOC/VOC (circle appropriate) sample(s) were between 26.4-35.4 gms so methanol was added in a 1:1 ratio. Sample(s) included: 5864 - 2ml
- GRO/PVOC/VOC/DRO (circle appropriate) sample(s) were > 35.4 gms and are required to be rejected. Sample(s) included: _____
- Other: _____

Client contact concerning the above deviations:

Client _____ (contact name) notified of the above deviation(s) on ___/___/___
at ___:___ am/pm by _____ and the client ordered:
(signature)

- Proceed with analyses as ordered.
- Proceed with analyses after taking the following corrective action: _____
- Do NOT proceed with analyses.

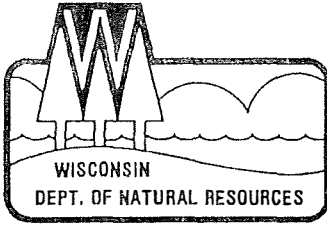

State of Wisconsin \ DEPARTMENT OF NATURAL RESOURCES

Tommy G. Thompson, Governor
George E. Meyer, Secretary
Scott Humrickhouse, Regional Director

West Central Region Headquarters
1300 W. Clairemont Avenue
PO Box 4001
Eau Claire, WI 54702-4001
TELEPHONE 715-839-3700
FAX 715-839-6076/1605
TTY 715-839-2786

June 25, 1997

R&R Case# 02-18-151537
Eau Claire County

Mr. Robert Nuss
Mack Trucks of Rochester
P.O. Box 6699
Rochester, MN 55903

SUBJECT: Petroleum Contamination at the Eau Claire Mack Truck Facility
Located at 2412 Frank St., Eau Claire, Wisconsin

Dear Mr. Nuss:

On June 19, 1997, you had contacted me to report to the Department of Natural Resources (DNR) that petroleum contamination had been discovered on the above referenced property. A release notification form was subsequently received by the DNR from Matt Taylor, of Cedar Corporation, on June 24, 1997.

Based on the information received by the Department of Natural Resources, we believe you are responsible for restoring the environment at this site under Section 292.11, Wisconsin Stats., known as the hazardous substances spills law. Your responsibilities include investigating the extent of the contamination and then selecting and implementing the most appropriate remedial action. Enclosed is information to help you understand what you need to do to ensure your compliance with the spills law.

Legal Responsibilities:

Your legal responsibilities are defined both in statute and in administrative codes. The hazardous substances spill law, Section 292.11(3) Wisconsin Statutes, states:

RESPONSIBILITY: A person who possesses or controls a hazardous substance which is discharged or who causes the discharge of a hazardous substance shall take the actions necessary to restore the environment to the extent practicable and minimize the harmful effects from the discharge to the air, lands, or waters of the state.

Wisconsin Administrative Codes chapters NR 700 through NR 728 establish requirements for emergency and interim actions, public information, site investigations, design and operation of remedial action systems, and case closure. Chapter NR 708 includes provisions for immediate actions in response to limited contamination. Wisconsin Administrative Code chapter NR 140 establishes groundwater standards for contaminants that reach groundwater.

Steps to Take:

The longer contamination is left in the environment, the farther it can spread and the more it may cost to clean up. Quick action may lessen damage to your property and to neighboring properties and reduce your costs in investigating and cleaning up the contamination. To ensure that your cleanup complies with Wisconsin's laws and administrative codes, you should hire a professional environmental consultant who understands what needs to be done. These are the first four steps to take:

1. By July 25, 1997, please submit written verification (such as a letter from the consultant) that you have hired an environmental consultant.
2. By August 25, 1997, your consultant must submit a workplan and schedule for conducting the investigation in accordance with s. NR 716.09, Wis. Adm. Code, and submit it to the DNR. The consultant must follow the Department's administrative codes and our technical guidance documents. Please include with your workplan a copy of any previous information that has been completed.
3. When the site investigation is complete, your consultant must submit a full report on the degree and extent of soil and groundwater contamination and a proposal for cleaning up the contamination.
4. If the results of the site investigation indicates that groundwater is not contaminated, the responsibility for government oversight of this site will be transferred to the Department of Commerce in accordance with Wisconsin Act 27.

Due to the number of contaminated sites and our staffing levels, we will be unable to review all workplans and reports for your site. You are still required to proceed in accordance with NR 716. To maintain your compliance with the spills law and chs. NR 700 through NR 728, do not delay the investigation and cleanup of your site by waiting for DNR responses. We have provided detailed technical guidance to environmental consultants. Your consultant is expected to be familiar with our technical procedures and administrative codes and should be able to answer your questions on meeting Wisconsin's cleanup requirements. Please send only one copy of all reports and correspondence should be identified with the assigned DNR identification number which is listed at the top of this letter.

Your correspondence and reports regarding this site should be sent to the Department at the following address:

Doug Joseph
Wisconsin Dept. of Natural Resources
P.O. Box 4001
Eau Claire, WI 54702-4001

Information for Site Owners:

Enclosed is a list of environmental consultants and some important information on selecting a consultant. If you are eligible for reimbursement of costs under Wisconsin's PECFA program (see last paragraph), you will need to compare at least three consultants' proposals before hiring a consultant. Consultants and laboratories working in the PECFA program are required to carry errors and omissions insurance to help protect you against unsuitable work. Also enclosed are materials on controlling costs, understanding the cleanup process, and choosing a site cleanup method. This information has been prepared to help you understand your responsibilities and what your environmental consultant needs to do. Please read this information carefully.

If you are interested in obtaining the protection of limited liability, please contact Mark Giesfeldt at (608) 267-7562 or Darsi Foss at (608) 267-6713, in the Department of Natural Resources' Madison office for more information. The liability exemption is available to persons who meet the definition of "purchaser" and receive Department approval for the response actions taken at the property undergoing cleanup. The Department will determine eligibility for this program on a case-by-case basis, PRIOR to the "purchaser" developing a scope of work for conducting a ch. NR 716 site investigation at the property.

Financial Information:

Reimbursement from the Petroleum Environmental Cleanup Fund (PECFA) is available for the costs of cleaning up contamination from eligible petroleum storage tanks. The fund is administered by the Department of Commerce (DCOM). Please contact DCOM at (608) 266-2424 for more information on eligibility and regulations for this program.

I appreciate your concern and cooperation in this matter. If you have any questions about this letter or your responsibilities, please feel free to contact me at (715) 839-1602.

Sincerely,

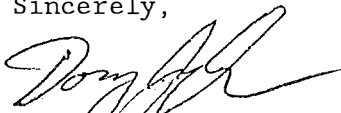

Doug Joseph
Hydrogeologist

enclosures

c: Bill Evans - WCR
Mr. Matt Taylor, Cedar Corp., 604 Wilson Ave., Menomonie, WI 54751

Wisconsin Department of Natural Resources

Notification of Petroleum Contamination from Underground Storage Tank System

Please complete this form and FAX it to the appropriate DNR contact person listed on the back page of this form immediately upon discovery of a release from an UST system.

TO: DNR, Attn: Doug Joseph
FAX #: 715-839-6076

1. Name, company, mailing address and phone number of person reporting the discharge

Matt Taylor / Cedar Corporation

2. Site Information:

Name of site at which discharge occurred (local name of site/business, not responsible party name -unless a residence):

Eau Claire Mack Sales Inc.

Location (actual street address, not P.O. box; if no street address, describe as precisely as possible, e.g., 1/4 mile NW of CTHs 60 & 123 on E side of CTH 60):

2412 Frank St.

Municipality (city, village, township in which the site is located - not mailing address):

Eau Claire, WI

County:

Eau Claire

Legal Description: SE 1/4, NW 1/4, Section 13, Tn 27N, Range 10 E (W)

3. Responsible Party (RP) and/or RP Representative Information

Company Name: Mack Trucks of Rochester, Inc.

Contact Person: Robert Nass

Mailing Address (with zip code):

P.O. Box 6699
Rochester, MN 55903

Telephone Number:

507-288-9488

4. Identity, physical state and quantity of the hazardous substance discharged (check all that apply):

- Unleaded gasoline
Leaded gasoline
[X] Diesel

- Fuel oil
[X] Waste oil
Other

5. Impacts to the environment (enter "K" for known or "P" for potential for all that apply):

- Fire/explosion threat
- Contaminated private wells (# of wells) _____
- Contaminated public wells
- Groundwater contamination

- Soil contamination
- Surface water impacts
- Floating product
- Other _____

6. Contamination was discovered as a result of:

- Tank closure assessment
- Site assessment

Other Expanded Phase I

On what date: 5/23/97, Lab results 6/16/97

Additional Comments:

DRO, low level VOC, PAH contamination adjacent to floor drain system in shop area.

FAX numbers to report LUST sites in DNR's six districts:

- Lake Michigan District: 414-492-5859 Attention: Janis DeBrock**
(Florence, Marinette, Oconto, Menominee, Shawano, Waupaca, Outagamie, Brown, Door, Kewaunee, Waushara, Winnebago, Calumet and Manitowoc Counties)
- North Central District: 715-365-8932 Attention: Janet Kazda**
(Vilas, Oneida, Forest, Lincoln, Langlade, Marathon, Wood, Portage, Juneau, and Adams Counties)
- Northwest District: 715-635-4105 Attention: Susie Sutton**
(Douglas, Bayfield, Ashland, Iron, Burnett, Washburn, Sawyer, Price, Polk, Barron, Rusk and Taylor Counties)
- Southern District: 608-275-3338 Attention: Marilyn Jahake**
(Marquette, Green Lake, Richland, Sauk, Fond du Lac, Columbia, Dodge, Dane, Jefferson, Grant, Iowa, Lafayette, Green and Rock Counties)
- Southeast District: 414-229-0810 Attention: Giselle Red**
(Sheboygan, Washington, Ozaukee, Waukesha, Milwaukee, Walworth, Racine, and Kenosha Counties)
- Western District: 715-839-6076 Attention: John Grump**
(St. Croix, Dunn, Chippewa, Pierce, Pepin, Eau Claire, Clark, Buffalo, Trempealeau, Jackson, LaCrosse, Monroe, Vernon and Crawford Counties)