

From: [Paul Lindquist](#)
To: [Ross, Issac A - DNR](#); [Moll, John G - DNR \(Gregory\)](#)
Cc: [Smullen, Joel](#); [Jeanne Tarvin](#); [Susan Petrofske](#); [Mark Mejac](#)
Subject: Groundwater Data Transmittal E-mail - Former One-Hour Valet (TAXMAN Investment)
Date: Tuesday, December 7, 2021 9:38:35 AM
Attachments: [01_Site Layout.pdf](#)
[Table 1_Historic MNA \(Oct 2021\).pdf](#)
[Table 2_Historic Groundwater Analytical Results \(Oct 2021\).pdf](#)
[Oct 2021 GW Lab Report \(40235956_frc\).pdf](#)

**CAUTION: This email originated from outside the organization.
Do not click links or open attachments unless you recognize the sender and know the content is safe.**

Good morning Issac and Greg,

We have received the analytical results of the October 2021 groundwater sampling event of six groundwater monitoring wells (MW-4, MW-5, MW-6, PZ-1R, PZ-2R, and PZ-4) from the former One-Hour Valet Drycleaners (TAXMAN Investment) facility located at 1214 Wells Street in Milwaukee, WI. The monitoring well locations are shown on Figure 1 and the field and laboratory analytical results are summarized in Table 1 and 2. This is the initial groundwater sampling event three months after the second injection of additional organic carbon amendments was conducted on July 14, 2021.

As shown in Table 1, the applied amendments appear to have reinforced reducing conditions through fermentation of the carbon substrate. These conditions are shown through the following observations and concentrations in treatment zone monitoring well PZ-1R:

- Increased total organic carbon (TOC) concentrations, from 499 milligrams per liter (mg/L) in April 2021 to 959 mg/L in October 2021.
- Low oxidation-reduction potential (ORP) reading of -58.6 millivolts (mV) and low dissolved oxygen reading of 0.18 mg/L.
- Continued absence of detectable sulfate (<2.2 mg/L).
- High methane concentration of 1,820 micrograms per liter (µg/L).

As indicated in Table 2, tetrachloroethene (PCE) was detected in PZ-1R at a concentration of 21,800 µg/L in October 2021, which is lower than the detected 64,500 µg/L PCE concentration in April 2021. The continued PCE concentrations detected in PZ-1R is consistent with back-diffusion of PCE from the fine-grained silty clay soils within the treatment zone in response to the groundwater remedial action. Observed decreased concentration ratios of PCE to the degradation products cis-1,2-dichloroethene and vinyl chloride are encouraging, as they preliminarily may indicate increased rates of reductive dechlorination. A semi-annual 2021 progress report will be submitted to the WDNR in early 2022 and the next groundwater sampling event is tentatively scheduled for April 2022.

Please let us know if you have any questions or comments in the interim.

Paul Lindquist

Managing Consultant
1692722 - Great Lakes

D 262-901-3510
M 612-209-8676
plindquist@ramboll.com

Connect with us  

Ramboll
234 W. Florida Street
Fifth Floor
Milwaukee, WI 53204
USA
<https://ramboll.com>

L:\Loop Project Files\CAD\1690005819_Former 1hr Dry Cleaners\2021-01\02_Site Layout.dwg

HOSPITAL PARKING STRUCTURE



LEGEND

- PROPERTY BOUNDARY
- /// BUILDING FOOTPRINT
- ASPHALT
- CONCRETE
- FENCE LINE
- 75 1-FT ELEVATION CONTOUR
- E—E— UNDERGROUND ELECTRIC
- OHE— OVERHEAD ELECTRIC
- T—T— TELEPHONE
- W—W— WATER LINE
- G—G— GAS
- TV— CABLE TV
- FO—FO— FIBER OPTIC
- STM— STORMWATER SEWER
- SAN— SANITARY SEWER
- STEAM— STEAM
- ☐ CATCH BASIN
- MANHOLE
- ⊗ VALVE
- ⬆ TRAFFIC LIGHT
- ⊠ TRANSFORMER
- ⊗ METER
- ⊗ LIGHT POLE
- ⊠ GUY UTILITY POLE / GUY
- 🌳 TREE
- ⊗ FIRE HYDRANT
- ⊠ TELEPHONE PEDESTAL
- ⊠ CONTROL BOX
- ⊕ MONITORING WELL
- ▲ SOIL GAS SAMPLE
- ⊗ INJECTION WELL (APPROXIMATE LOCATION)
- INJECTION POINT (APPROXIMATE LOCATION)

REFERENCE: THE SITE LAYOUT, SITE FEATURES, ELEVATIONS, UTILITIES, AND OTHER FEATURES NEAR THE PROPERTY WERE OBTAINED FROM GRAEF-USA IN DECEMBER 2017. MONITORING WELLS WERE SURVEYED IN OCTOBER 2019.



SITE LAYOUT
FORMER ONE-HOUR VALET DRY CLEANERS
1214 WEST WELLS STREET
MILWAUKEE, WISCONSIN



FIGURE
1

DRAFTED BY: HJW/PDL

DATE: 1/20/2021

1690005819

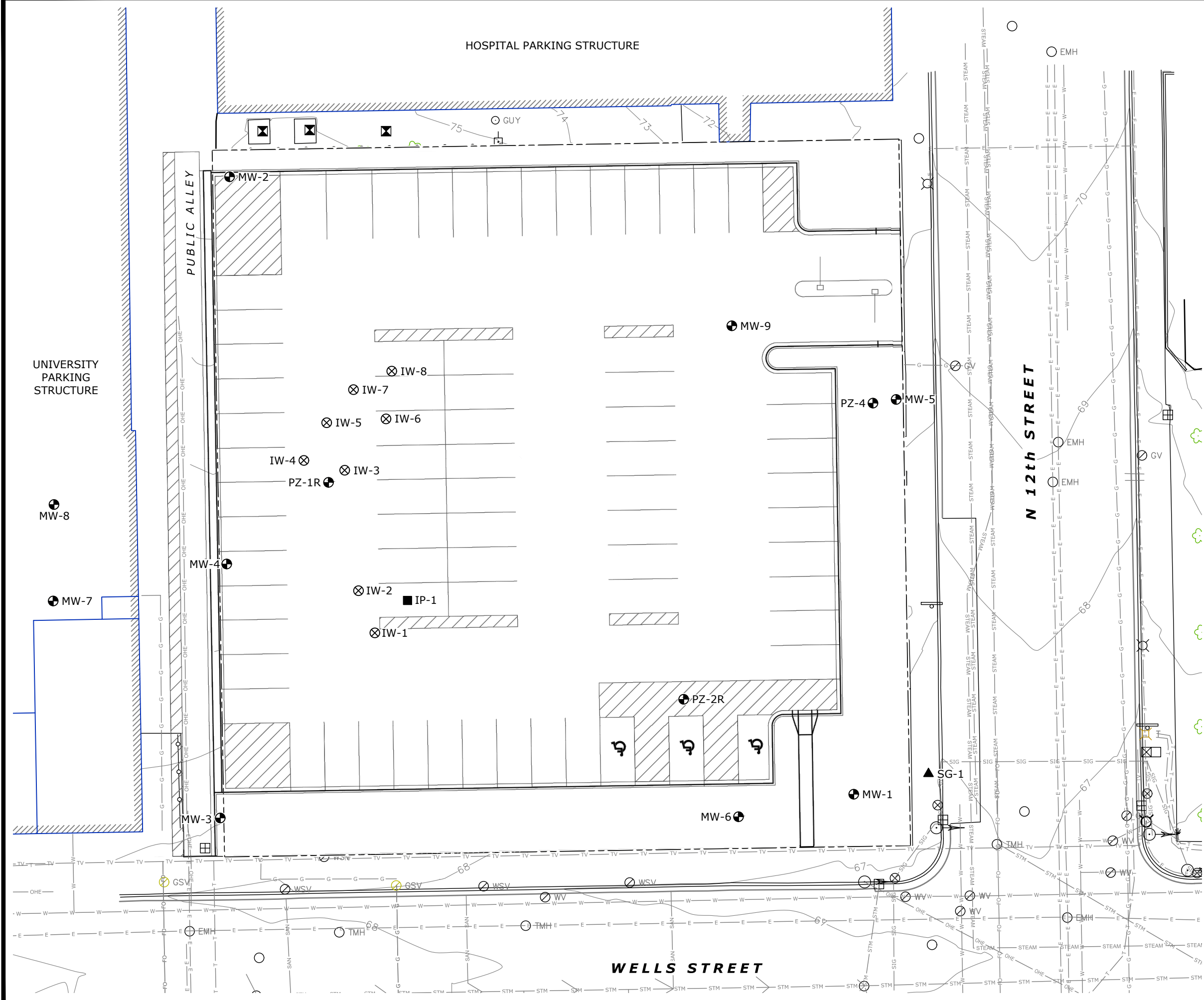

TABLE 1
MNA Parameter Groundwater Sampling Results
 Former One-Hour Valet Dry Cleaners
 1214 West Wells Street, Milwaukee, Wisconsin
 Ramboll Project No. 1690005819

Well ID	Sample Date	Dissolved Oxygen (mg/L)	Ethane (µg/L)	Ethene (µg/L)	Iron, Dissolved (mg/L)	Iron, Ferric (mg/L)	Iron, Ferrous (mg/L)	Methane (µg/L)	Nitrogen, NO ₂ plus NO ₃ (mg/L)	ORP (mV)	Sulfate (mg/L)	Total Organic Carbon (mg/L)
MW-1	1/14/2002	10.39	NA	NA	NA	NA	NA	NA	NA	-37.0	NA	NA
	5/8/2002	3.57	NA	NA	NA	NA	NA	NA	NA	287.1	NA	NA
	8/7/2003	0.22	NA	NA	NA	NA	NA	NA	NA	161.3	NA	NA
	10/7/2003	1.05	0.028	0.049	NA	NA	NA	14	NA	396.8	NA	NA
	8/25/2009	0.69	<10	<10	NA	NA	NA	<10	NA	95.0	NA	1.26
	11/1/2017	1.69	<0.58	<0.52	0.0126 J	0.00 J	<0.017	<1.4	<0.095	57.7	<100	<0.25
MW-2	1/14/2002	6.42	NA	NA	NA	NA	NA	NA	NA	168.4	NA	NA
	5/8/2002	1.07	NA	NA	NA	NA	NA	NA	NA	256.9	NA	NA
	8/7/2003	0.10	NA	NA	NA	NA	NA	NA	NA	2.3	NA	NA
	10/7/2003	4.43	0.018	0.021	NA	NA	NA	22	NA	364.0	NA	NA
	8/27/2009	0.98	NA	NA	NA	NA	NA	NA	NA	86.0	NA	NA
	11/1/2017	1.71	<0.58	<0.52	1.77	0.54	1.2 H3	<1.4	<0.095	-74.3	93.5	<0.25
MW-3	8/7/2003	0.15	NA	NA	NA	NA	NA	NA	NA	68.0	NA	NA
	10/7/2003	5.74	0.16	0.056	NA	NA	NA	45	NA	327.8	NA	NA
	8/27/2009	1.01	NA	NA	NA	NA	NA	NA	NA	16.0	NA	NA
	11/1/2017 ¹	0.73	NA	NA	NA	NA	NA	NA	NA	-125.6	NA	NA
MW-4	8/7/2003	5.83	NA	NA	NA	NA	NA	NA	NA	139.0	NA	NA
	10/7/2003	3.44	0.021	0.033	NA	NA	NA	22	NA	383.4	NA	NA
	8/25/2009	2.55	NA	NA	NA	NA	NA	NA	NA	77.0	NA	NA
	11/2/2017	0.88	NA	NA	NA	NA	NA	NA	NA	-19.8	NA	NA
	5/2/2019	8.40	NA	NA	NA	NA	NA	NA	NA	140.7	NA	NA
	8/14/2019	1.82	NA	NA	NA	NA	NA	NA	NA	79.4	NA	NA
	3/10/2020	8.53	NA	NA	NA	NA	NA	NA	NA	81.6	NA	NA
	10/28/2020	1.45	NA	NA	NA	NA	NA	NA	NA	116.0	NA	NA
	4/21/2021	5.40	NA	NA	NA	NA	NA	NA	NA	53.9	NA	NA
	10/27/2021	2.13	NA	NA	NA	NA	NA	NA	NA	64.6	NA	NA
MW-5	8/7/2003	0.86	NA	NA	NA	NA	NA	NA	NA	190.5	NA	NA
	10/7/2003	1.05	0.041	0.0097	NA	NA	NA	0.99	NA	396.8	NA	NA
	8/27/2009	0.99	<10	<10	NA	NA	NA	136	NA	98.0	NA	1.82
	11/2/2017	2.04	NA	NA	NA	NA	NA	NA	NA	18.6	NA	NA
	5/2/2019	2.01	NA	NA	NA	NA	NA	NA	NA	159.1	NA	NA
	8/14/2019	0.18	NA	NA	NA	NA	NA	NA	NA	63.4	NA	NA
	3/10/2020	0.00	NA	NA	NA	NA	NA	NA	NA	21.1	NA	NA
	10/28/2020	0.29	NA	NA	NA	NA	NA	NA	NA	47.2	NA	NA
	4/21/2021	0.19	NA	NA	NA	NA	NA	NA	NA	-18.0	NA	NA
	10/27/2021	0.52	NA	NA	NA	NA	NA	NA	NA	15.4	NA	NA
MW-6	8/25/2009	1.0	NA	NA	NA	NA	NA	NA	NA	-50.0	NA	NA
	11/9/2017 ¹	0.62	<0.58	<0.52	13.6	8.3	5.2 H3	<1.4	<0.095	-112.7	82.4	<0.25
	5/2/2019	11.38	<0.58	<0.52	103	1,030	<0.20	<1.4	0.25 J	94.8	41.8	6.0
	8/14/2019	0.83	<0.58	<0.52	1.7	<0.20	2.1 H3	<1.4	<0.0	3.1	95.6	0.57 J
	3/10/2020	0.01	<1.2	<1.2	6.68	<0.20	7.4 H3	75.2	<0.059	-154.3	87 J	1.8
	10/28/2020	0.26	NA	NA	NA	NA	NA	NA	NA	-137.5	NA	NA
	4/21/2021	0.41	NA	NA	NA	NA	NA	NA	NA	-98.1	NA	NA
	10/27/2021	0.44	NA	NA	NA	NA	NA	NA	NA	-50.4	NA	NA
MW-7	8/26/2009	NA	NA	NA	NA	NA	NA	NA	NA	NA	NA	NA
	11/9/2017 ²	7.49	NA	NA	NA	NA	NA	NA	NA	-50.7	NA	NA
MW-8	8/26/2009	NA	NA	NA	NA	NA	NA	NA	NA	NA	NA	NA
	11/9/2017 ³	4.03	NA	NA	NA	NA	NA	NA	NA	-28.7	NA	NA
MW-9	8/27/2009	NA	<10	<10	NA	NA	NA	<10	NA	NA	NA	1.27
	11/9/2017	6.40	NA	NA	NA	NA	NA	NA	NA	-42.6	NA	NA

TABLE 1
MNA Parameter Groundwater Sampling Results
 Former One-Hour Valet Dry Cleaners
 1214 West Wells Street, Milwaukee, Wisconsin
 Ramboll Project No. 1690005819

Well ID	Sample Date	Dissolved Oxygen (mg/L)	Ethane (µg/L)	Ethene (µg/L)	Iron, Dissolved (mg/L)	Iron, Ferric (mg/L)	Iron, Ferrous (mg/L)	Methane (µg/L)	Nitrogen, NO ₂ plus NO ₃ (mg/L)	ORP (mV)	Sulfate (mg/L)	Total Organic Carbon (mg/L)		
PZ-1	1/15/2002	0.66	NA	NA	NA	NA	NA	NA	NA	-65.3	NA	NA		
	5/8/2003	1.31	NA	NA	NA	NA	NA	NA	NA	-18.3	NA	NA		
	8/8/2003	0.12	NA	NA	NA	NA	NA	NA	NA	-93.7	NA	NA		
	10/7/2003	0.09	1.7	0.48	NA	NA	NA	7	NA	-97.1	NA	NA		
	8/25/2009	0.83	<10	<10	NA	NA	NA	<10	NA	-73.0	NA	2.04		
	11/2/2017	0.64	<0.58	<0.52	2.29	2.2	0.060	H3	<1.4	0.33	38.5	155	0.50 J	
PZ-1R	5/2/2019	1.01	337	32.4	5.88	<0.20	5.8	H3	23.1	<0.095	-102.6	101	124 J	
	8/14/2019	0.21	3,060	87.2	5.70	<0.20	6.5	H3	129	<0.095	-138.4	93.1	184	
	3/10/2020	0.00	2,130	974	4.60	<0.20	5.1	H3	162	<0.059	-270.1	85.9	115	
	10/28/2020	0.21	1,560	1,320	NA	NA	168	C4, H3	1510	NA	-126.9	4.9	J, D3	2,440
	4/21/2021	0.19	1,540	1,090	NA	NA	19.7	H3	2,680	NA	-487.7	<2.2	499	
	10/27/2021	0.18	2.7	J	21.9	17.1	<28.1	H3	19.0	H3	1,820	NA	<2.2	D3
PZ-2	8/8/2003	0.19	NA	NA	NA	NA	NA	NA	NA	NA	-41.3	NA	NA	
	10/6/2003	0.15	1.3	0.79	NA	NA	NA	60	NA	NA	-35.1	NA	NA	
	8/27/2009	0.78	NA	NA	NA	NA	NA	NA	NA	NA	-16.0	NA	NA	
	11/1/2017 ¹	2.67	<0.58	<0.52	8.82	5.7	3.1	23.1	<0.095	-100.3	178	<0.25		
PZ-2R	8/14/2019	0.13	0.82	J	<0.52	3.20	<0.20	3.6	H3	22	<0.095	-36.8	164	0.40 J
	3/10/2020	0.10	<1.2	<1.2	2.80	<0.20	2.9	H3, M1	10.3	<0.059	-68.3	140	0.36 M0	
	10/28/2020	0.35	NA	NA	NA	NA	NA	NA	NA	NA	-80.6	NA	NA	
	4/21/2021	0.47	NA	NA	NA	NA	NA	NA	NA	NA	-81.7	NA	NA	
	10/27/2021	0.38	NA	NA	NA	NA	NA	NA	NA	NA	-45.8	NA	NA	
PZ-3	8/25/2009	0.72	NA	NA	NA	NA	NA	NA	NA	NA	-53.0	NA	NA	
	11/2/2017	1.34	NA	NA	NA	NA	NA	NA	NA	NA	-103.8	NA	NA	
PZ-4	8/25/2009	0.72	NA	NA	NA	NA	NA	NA	NA	NA	-55.0	NA	NA	
	11/2/2017	1.47	NA	NA	NA	NA	NA	NA	NA	NA	-111.8	NA	NA	
	5/2/2019	2.99	NA	NA	NA	NA	NA	NA	NA	NA	48.2	NA	NA	
	8/14/2019	0.24	NA	NA	NA	NA	NA	NA	NA	NA	-40.0	NA	NA	
	3/10/2020	0.24	NA	NA	NA	NA	NA	NA	NA	NA	-61.7	NA	NA	
	10/28/2020	7.72	NA	NA	NA	NA	NA	NA	NA	NA	12.4	NA	NA	
	4/21/2021	0.54	NA	NA	NA	NA	NA	NA	NA	NA	-88.1	NA	NA	
	10/27/2021	0.31	NA	NA	NA	NA	NA	NA	NA	NA	-36.9	NA	NA	

Notes:

J = Estimated concentration at or above the level of detection and below the level of quantification.

mg/L = milligrams per liter

mV = millivolts

NA = Data was not collected or not able to be collected.

NS = Not sampled.

ORP = Oxidation-reduction potential; measured in the field.

ug/L = micrograms per liter

All sampling results prior to 2017 obtained from a Site Investigation Report prepared by GZA GeoEnvironmental, Inc. dated February 24, 2012.

(1) Well cap either missing or not plugged at time of inspection; potential for water and other constituents to have entered the well.

(2) Monitoring well purged dry after first stabilization parameter reading. Well sampled later in day without collecting new stabilization parameters.

(3) Monitoring well purged dry before water passed completely through flow-through cell. Stabilization parameters collected from flow-through cell approximately 4/5 of the way full.

(4) Monitoring well was damaged during site redevelopment activities and was not sampled.

C4 = Sample container did not meet EPA or method requirements

D3 = Sample was diluted due to the presence of high levels of non-target analytes or other matrix interference.

H3 = Sample was received or analysis requested beyond the recognized method holding time.

M0 = Matrix spike recovery and/or matrix spike duplicate recovery was outside laboratory control limits.

M1 = Matrix spike recovery exceeded QC limits. Batch accepted based on laboratory control sample (LCS) recovery.

TABLE 2
Groundwater Analytical Results - Summary of Detected Constituents
Former One-Hour Valet Dry Cleaners
1214 West Wells Street, Milwaukee, Wisconsin
Ramboll Project No. 1690005819

DRAFT

Analyte ^{1,2}		Benzene	Chloroform	1,1-Dichloroethene	cis-1,2-Dichloroethene	trans-1,2-Dichloroethene	Ethylbenzene	Methylene chloride	Tetrachloroethene	Toluene	Trichloroethene	1,2,4-Trimethylbenzene ³	Vinyl chloride	Xylenes, total ⁴
CAS		71-43-2	67-66-3	75-35-4	156-59-2	156-60-5	100-41-4	75-09-2	127-18-4	108-88-3	79-01-6	95-63-6	75-01-4	1330-20-7
Units		ug/L	ug/L	ug/L	ug/L	ug/L	ug/L	ug/L	ug/L	ug/L	ug/L	ug/L	ug/L	ug/L
NR 140 ES		5	6	7	70	100	700	5	5	800	5	480	0.2	2000
NR 140 PAL		0.5	0.6	0.7	7	20	140	0.5	0.5	160	0.5	96	0.02	400
MW-1	1/14/2002	ND	<0.23	<0.27	<0.21	<0.25	<0.22	<0.24	<0.22	<0.41	0.46 J	<0.15	44	#N/A
	5/8/2002	ND	<0.1	<0.11	<0.11	<0.11	<0.08	<0.24	<0.15	<0.08	<0.13	<0.11	<0.16	#N/A
	8/7/2003	ND	<0.25	<0.5	<0.5	<0.5	<0.5	<1	<0.5	0.9	0.3 J	<0.25	<0.25	<0.5
	10/7/2003	ND	<0.25	<0.5	<0.5	<0.5	<0.5	<1	<0.5	<0.25	<0.25	<0.25	<0.25	<0.5
	8/25/2009	<0.2	<0.2	<0.5	<0.5	<0.5	<0.5	<1	<0.5	<0.5	<0.2	<0.2	<0.2	<0.5
	11/1/2017	<0.50	<2.5	<0.41	<0.26	<0.26	<0.50	<0.23	<0.50	<0.50	<0.33	<0.50	<0.18	<1.5
MW-2	1/14/2002	ND	<0.23	<0.21	<0.21	<0.25	<0.22	<0.22	<0.22	<0.41	<0.24	<0.26	<0.25	#N/A
	5/8/2002	ND	<0.1	<0.11	<0.11	<0.11	<0.08	<0.24	<0.15	<0.08	<0.13	<0.11	<0.16	#N/A
	8/7/2003	ND	<0.25	<0.5	<0.5	<0.5	<0.5	<1	<0.5	0.32 J	<0.25	<0.25	<0.25	<0.5
	10/7/2003	ND	<0.25	<0.5	<0.5	<0.5	<0.5	<1	<0.5	<0.25	<0.25	<0.25	<0.25	<0.5
	8/27/2009	<0.2	<0.2	<0.5	<0.5	<0.5	<0.5	<1	<0.5	<0.5	<0.2	<0.2	<0.2	<0.5
	11/1/2017	<0.50	<2.5	<0.41	<0.26	<0.26	<0.50	<0.23	<0.50	<0.50	<0.33	<0.50	<0.18	<1.5
MW-3	1/15/2002	ND	<0.23	<0.27	<0.21	<0.25	<0.22	<0.22	<0.22	<0.41	<0.24	<0.26	<0.25	#N/A
	5/8/2002	ND	<0.1	<0.11	<0.11	<0.11	<0.08	<0.24	<0.15	0.32	0.34 J	<0.11	<0.16	#N/A
	8/7/2003	ND	<0.25	<0.5	<0.5	<0.5	<0.5	<1	<0.5	0.88	0.42 J	<0.25	<0.25	<0.5
	10/7/2003	ND	<0.25	<0.5	<0.5	<0.5	<0.5	<1	<0.5	<0.25	<0.25	<0.25	<0.25	<0.5
	8/27/2009	<0.2	<0.2	<0.5	<0.5	<0.5	<0.5	<1	<0.5	<0.5	<0.2	<0.2	<0.2	<0.5
	11/1/2017	<0.50	<2.5	<0.41	<0.26	<0.26	<0.50	<0.23	<0.50	<0.50	<0.33	<0.50	<0.18	<1.5
MW-4	8/7/2003	ND	<0.25	<0.5	<0.5	<0.5	<0.5	<1	0.88 J	0.9	0.71 J	0.34 J	<0.25	<0.5
	10/7/2003	ND	<0.25	<0.5	<0.5	<0.5	<0.5	<1	0.57 J	<0.25	<0.25	<0.25	<0.25	<0.5
	8/25/2009	<0.2	<0.2	<0.5	<0.5	<0.5	<0.5	<1	7	<0.5	<0.2	<0.2	<0.2	<0.5
	11/2/2017	<0.50	<2.5	<0.41	<0.26	<0.26	<0.50	<0.23	7.8	<0.50	<0.33	<0.50	<0.18	<1.5
	5/2/2019	<0.49	<2.5	<0.49	23.0	<2.2	<0.44	<1.2	850	<0.34	5.0	<1.7	<0.35	<3.0
	8/14/2019	<0.25	<1.3	<0.24	0.43 J	<1.1	<0.22	<0.58	79.1	<0.17	0.99 J	<0.84	<0.17	<1.5
	3/10/2020	<0.25	<1.3	<0.24	<0.27	<1.1	<0.32	<0.58	57	<0.27	0.47 J	<0.84	<0.17	<1.5
	10/28/2020	<0.25	<1.3	<0.24	<0.27	<0.46	<0.32	<0.58	24.0	<0.27	0.26 J	<0.84	<0.17	<1.5
	4/21/2021	<0.30	<1.2	<0.58	<0.47	<0.53	<0.33	<0.32	31.8	<0.29	<0.32	<0.45	<0.17	<1.0
	10/27/2021	<0.30	<1.2	<0.58	<0.47	<0.53	<0.33	<0.32	26.8	<0.29	<0.32	<0.45	<0.17	<1.0
MW-5	8/7/2003	ND	<0.25	<0.5	11	<0.5	<0.5	<1	80	0.9	7.9	0.34 J	<0.25	<0.5
	10/7/2003	ND	<0.25	<0.5	150	1.2	<0.5	<1	93	<0.25	6.4	<0.25	<0.25	<0.5
	8/27/2009	<0.2	<0.2	<0.5	110	1.2	<0.5	<1	140	<0.5	<0.2	32	22	<0.5
	11/2/2017	<0.50	<2.5	<0.41	73.6	1.5	<0.50	<0.23	30.3	<0.50	3.2	<0.50	0.45 J	<1.5
	5/2/2019	<0.25	<1.3	<0.24	11.3	<1.1	<0.22	<0.58	20.5	<0.17	3.8	<0.84	2.1	<1.5
	8/14/2019	<0.25	<1.3	<0.24	31.2	<1.1	<0.22	<0.58	29.1	<0.17	5.9	<0.84	0.73 J	<1.5
	3/10/2020	<0.25	<1.3	<0.24	14.1	<1.1	<0.32	<0.58	23.8	<0.27	5.0	<0.84	2.2	<1.5
	10/28/2020	<0.25	<1.3	<0.24	11.3	0.72 J	<0.32	<0.58	21.7	<0.27	5.2	<0.84	1.5	<1.5
	4/21/2021	<0.30	<1.2	<0.58	7.6	0.59 J	<0.33	<0.32	20.9	<0.29	4.2	<0.45	1.5	<1.0
	10/27/2021	<0.30	<1.2	<0.58	12.3	1.7	<0.33	<0.32	24.0	<0.29	5.6	<0.45	1.1	<1.0
MW-6	8/25/2009	<0.2	<2	<5	980	<5	<5	<10	<5	<5	18	<2	57	<5
	11/9/2017	<0.50	<2.5	<0.41	4.5	<0.26	<0.50	<0.23	<0.50	<0.50	<0.33	<0.50	1.0	<1.5
	5/2/2019	<0.25	<1.3	<0.24	<0.27	<1.1	<0.22	<0.58	<0.33	<0.17	<0.26	<0.84	<0.17	<1.5
	8/14/2019	<0.25	<1.3	<0.24	14.7 MI	<1.1	<0.22	<0.58	1.3	<0.17	0.37 J	<0.84	1.6	<1.5
	3/10/2020	<0.25	<1.3	<0.24	239	6.8	<0.32	<0.58	<0.33	<0.27	13.5	<0.84	11.5	<1.5
	10/28/2020	<0.25	<1.3	<0.24	172	5.4	<0.32	<0.58	<0.33	<0.27	15.6	<0.84	8.4	<1.5
	4/21/2021	<0.30	<1.2	<0.58	1.9	<0.53	<0.33	<0.32	<0.41	<0.29	<0.32	<0.45	0.32 J	<1.0
10/27/2021	<0.30	<1.2	<0.58	1.3	<0.53	<0.33	<0.32	<0.41	<0.29	<0.32	<0.45	0.19 J	<1.0	
MW-7	8/26/2009	<0.2	<0.2	<0.5	<0.5	<0.5	<0.5	<1	<0.5	<0.5	<0.2	<0.2	<0.2	<0.5
	11/9/2017	<0.50	<2.5	<0.41	<0.26	<0.26	<0.50	<0.23	<0.50	<0.50	<0.33	<0.50	<0.18	<1.5
MW-8	8/26/2009	<0.2	<0.2	<0.5	<0.5	<0.5	<0.5	<1	<0.5	<0.5	<0.2	<0.2	<0.2	<0.5
	11/9/2017 ⁵	NS	NS	NS	NS	NS	NS	NS	NS	NS	NS	NS	NS	NS
MW-9	8/27/2009	0.28	<0.2	<0.5	<0.5	<0.5	<0.5	<1	<0.5	0.64	<0.2	<0.2	<0.2	<0.5
	11/9/2017	<0.50	<2.5	<0.41	<0.26	<0.26	<0.50	<0.23	<0.50	0.59 J	<0.33	<0.50	<0.18	<1.5

TABLE 2
Groundwater Analytical Results - Summary of Detected Constituents
Former One-Hour Valet Dry Cleaners
1214 West Wells Street, Milwaukee, Wisconsin
Ramboll Project No. 1690005819

DRAFT

Analyte ^{1,2}		Benzene	Chloroform	1,1-Dichloroethene	cis-1,2-Dichloroethene	trans-1,2-Dichloroethene	Ethylbenzene	Methylene chloride	Tetrachloroethene	Toluene	Trichloroethene	1,2,4-Trimethylbenzene ³	Vinyl chloride	Xylenes, total ⁴
CAS		71-43-2	67-66-3	75-35-4	156-59-2	156-60-5	100-41-4	75-09-2	127-18-4	108-88-3	79-01-6	95-63-6	75-01-4	1330-20-7
Units		ug/L	ug/L	ug/L	ug/L	ug/L	ug/L	ug/L	ug/L	ug/L	ug/L	ug/L	ug/L	ug/L
NR 140 ES		5	6	7	70	100	700	5	5	800	5	480	0.2	2000
NR 140 PAL		0.5	0.6	0.7	7	20	140	0.5	0.5	160	0.5	96	0.02	400
PZ-1	1/15/2002	ND	<1.2	<1.4	400	4	<1.1	<1.1	<1.1	<2.1	<1.2	<0.75	<1.3	#N/A
	5/8/2003	ND	<5	<5.5	3,000	22	23	8,500	<4	2,800	<5.5	22	#N/A	
	8/8/2003	ND	0.3	8.4	2,600	18.0	1.8	<1	27,000	4.8	2,500	<0.25	11	1.2
	10/7/2003	ND	<120	<250	2,600	<250	<250	<500	36,000	<120	2,600	<120	<120	<250
	8/25/2009	<32	<32	<80	2,000	<80	<80	<160	61,000	<80	1,600	<32	<32	<80
	11/2/2017	<125	<625	<103	414	<64.1	<125	<58.1	16,200	<125	435	<125	<43.9	<375
PZ-1 abandoned on 1/11/2018. PZ-1R was installed on 4/18/2019.														
PZ-1R	5/2/2019	<123	<637	<122	30,000	<545	<109	<290	60,300	<86.1	3,310	<420	<87.3	<750
	8/14/2019	<123	<637	140	108,000	<545	<109	<290	83,700	<86.1	5,450	<420	1,110	<750
	3/10/2020	<123	<637	<122	36,400	<545	<159	<290	23,200	<135	9,060	<420	2,630	<750
	10/28/2020	<123	<637	<122	6,500	<232	<159	<290	28,800	<135	2,280	<420	822	<750
	4/21/2021	<148	<591	<291	98,200	<264	<163	<160	64,500	<144	26,000	<224	10,800	<524
	10/27/2021	<148	<591	<291	69,500	<264	<163	<160	21,800	<144	10,800	<224	14,200	<524
PZ-2	8/8/2003	ND	<0.25	<0.5	<0.5	<0.5	<0.5	<1	<0.5	0.43	<0.25	<0.25	5.8	<0.5
	10/6/2003	ND	<0.25	<0.5	<0.5	<0.5	<0.5	<1	<0.5	<0.25	<0.25	<0.25	8.9	<0.5
	8/27/2009	<0.2	<0.2	<0.5	<0.5	<0.5	<0.5	<1	<0.5	<0.5	<0.2	<0.2	14	<0.5
	11/1/2017	<0.50	<2.5	<0.41	4.1	<0.26	<0.50	<0.23	<0.50	<0.50	<0.33	<0.50	11.0	<1.5
	5/2/2019 ⁵	NS	NS	NS	NS	NS	NS	NS	NS	NS	NS	NS	NS	NS
PZ-2 abandoned on 7/19/2019. PZ-2R was installed on 7/19/2019.														
PZ-2R	8/14/2019	<0.25	<1.3	<0.24	26.9	<1.1	<0.22	<0.58	12.7	<0.17	0.39	<0.84	15.5	<1.5
	3/10/2020	<0.25	<1.3	<0.24	33.9	<1.1	<0.32	<0.58	<0.33	<0.27	<0.26	<0.84	11.3	<1.5
	10/28/2020	<0.25	<1.3	<0.24	90.2	1.1	<0.32	<0.58	<0.33	<0.27	<0.26	<0.84	10.8	<1.5
	4/21/2021	<0.30	<1.2	<0.58	109	1.5	<0.33	<0.32	<0.41	<0.29	<0.32	<0.45	14.1	<1.0
	10/27/2021	<0.30	<1.2	<0.58	104	1.3	<0.33	<0.32	<0.41	<0.29	<0.32	<0.45	12.6	<1.0
PZ-3	8/26/2004	ND	<2	<5	440	<5	<5	<10	56	<2	<2	<2	<2	<5
	10/7/2004	ND	<1	<2.5	300	<2.5	<2.5	<5	73	<1	<1	<1	<1	<2.5
	8/25/2009	<2	<2	<5	1,100	11.0	<5	<10	5.6	<5	7.1	<2	3.9	<5
	11/2/2017	<25.0	<125	<20.5	2,060	22.4	<25.0	<11.6	<25.0	<25.0	144	<25.0	<8.8	<75.0
PZ-3 abandoned on 1/11/2018.														
PZ-4	8/25/2009	<0.20	<0.2	<0.5	4.4	<0.5	<0.5	<1	0.84	<0.5	0.56	<0.2	<0.2	<0.5
	11/2/2017	<0.50	<2.5	<0.41	<0.26	<0.26	<0.50	<0.23	<0.50	<0.50	<0.33	<0.50	1.3	<1.5
	5/2/2019	<0.49	<2.5	<0.49	20.8	<2.2	<0.44	<1.2	35.1	<0.34	3	<1.7	1	<3.0
	8/14/2019	<0.25	<1.3	<0.24	<0.27	<1.1	<0.22	<0.58	15.8	<0.17	<0.26	<0.84	1.8	<1.5
	3/10/2020	<0.25	<1.3	<0.24	1.4	<1.1	<0.32	<0.58	16	<0.27	<0.26	<0.84	1.7	<1.5
	10/28/2020	<0.25	<1.3	<0.24	0.42	<0.46	<0.32	<0.58	23.5	<0.27	0.37	<0.84	<0.17	<1.5
	4/21/2021	<0.30	<1.2	<0.58	<0.47	<0.53	<0.33	<0.32	0.94	<0.29	<0.32	<0.45	3.1	<1.0
	10/27/2021	<0.30	<1.2	<0.58	<0.47	<0.53	<0.33	<0.32	<0.41	<0.29	<0.32	<0.45	3.2	<1.0

Notes:
All results reported in micrograms per Liter (ug/L)
ES = Enforcement Standard
PAL = Preventive Action Limit
Bold value = NR 140 ES Exceedance
Italic Value = NR 140 PAL Exceedance
#N/A = Not analyzed
NS = Not sampled
J = Estimated concentration. Laboratory results reported between the limit of detection and limit of quantification.
¹ Analytical results are displayed for detected parameters only.
² All sampling results prior to 2017 obtained from a Site Investigation Report prepared by GZA GeoEnvironmental, Inc. on February 24, 2012.
³ Standards are for 1,2,4- and 1,3,5-Trimethylbenzene
⁴ Standards are for Total Xylenes (-m-, -p, and -o).
⁵ MW-8 not sampled during the November 2017 groundwater sampling event because well did not recharge sufficiently.
⁶ PZ-2 was not sampled during the May 2019 groundwater sampling event because well was damaged during site redevelopment activities.
ND = Not detected at or above limit of detection.
M1 = Matrix spike recovery exceeded QC limits. Batch accepted based on laboratory control sample (LCS) recovery.
C4 = Sample container did not meet EPA or method requirements.
D3 = Sample was diluted due to the presence of high levels of non-target analytes or other matrix interference.

November 19, 2021

Susan Petrofske
Ramboll US Consulting, Inc.
234 W. Florida Street
Fifth Floor
Milwaukee, WI 53204

RE: Project: 1690005819 FORMER ONE-HOUR VAL
Pace Project No.: 40235956

Dear Susan Petrofske:

Enclosed are the analytical results for sample(s) received by the laboratory on October 28, 2021. The results relate only to the samples included in this report. Results reported herein conform to the applicable TNI/NELAC Standards and the laboratory's Quality Manual, where applicable, unless otherwise noted in the body of the report.

The test results provided in this final report were generated by each of the following laboratories within the Pace Network:

- Pace National - Mt. Juliet
- Pace Analytical Services - Green Bay

If you have any questions concerning this report, please feel free to contact me.

Sincerely,



Steven Mieczko
steve.mieczko@pacelabs.com
(920)469-2436
Project Manager

Enclosures

cc: Kyle Heimstead, Ramboll US Consulting, Inc.
Michele Peters, Ramboll



REPORT OF LABORATORY ANALYSIS

This report shall not be reproduced, except in full,
without the written consent of Pace Analytical Services, LLC.

CERTIFICATIONS

Project: 1690005819 FORMER ONE-HOUR VAL
Pace Project No.: 40235956

Pace Analytical Services Green Bay

1241 Bellevue Street, Green Bay, WI 54302
Florida/NELAP Certification #: E87948
Illinois Certification #: 200050
Kentucky UST Certification #: 82
Louisiana Certification #: 04168
Minnesota Certification #: 055-999-334
New York Certification #: 12064
North Dakota Certification #: R-150

Virginia VELAP ID: 460263
South Carolina Certification #: 83006001
Texas Certification #: T104704529-14-1
Wisconsin Certification #: 405132750
Wisconsin DATCP Certification #: 105-444
USDA Soil Permit #: P330-16-00157
Federal Fish & Wildlife Permit #: LE51774A-0

Pace Analytical Services National

12065 Lebanon Road, Mt. Juliet, TN 37122
Alabama Certification #: 40660
Alaska Certification #: 17-026
Arizona Certification #: AZ0612
Arkansas Certification #: 88-0469
California Certification #: 2932
Canada Certification #: 1461.01
Colorado Certification #: TN00003
Connecticut Certification #: PH-0197
DOD Certification #: #1461.01
EPA# TN00003
Florida Certification #: E87487
Georgia DW Certification #: 923
Georgia Certification: NELAP
Idaho Certification #: TN00003
Illinois Certification #: 200008
Indiana Certification #: C-TN-01
Iowa Certification #: 364
Kansas Certification #: E-10277
Kentucky UST Certification #: 16
Kentucky Certification #: 90010
Louisiana Certification #: AI30792
Louisiana DW Certification #: LA180010
Maine Certification #: TN0002
Maryland Certification #: 324
Massachusetts Certification #: M-TN003
Michigan Certification #: 9958
Minnesota Certification #: 047-999-395
Mississippi Certification #: TN00003
Missouri Certification #: 340
Montana Certification #: CERT0086
Nebraska Certification #: NE-OS-15-05

Nevada Certification #: TN-03-2002-34
New Hampshire Certification #: 2975
New Jersey Certification #: TN002
New Mexico DW Certification
New York Certification #: 11742
North Carolina Aquatic Toxicity Certification #: 41
North Carolina Drinking Water Certification #: 21704
North Carolina Environmental Certificate #: 375
North Dakota Certification #: R-140
Ohio VAP Certification #: CL0069
Oklahoma Certification #: 9915
Oregon Certification #: TN200002
Pennsylvania Certification #: 68-02979
Rhode Island Certification #: LAO00356
South Carolina Certification #: 84004
South Dakota Certification
Tennessee DW/Chem/Micro Certification #: 2006
Texas Mold Certification #: LAB0152
Texas Certification #: T 104704245-17-14
USDA Soil Permit #: P330-15-00234
Utah Certification #: TN00003
Virginia Certification #: VT2006
Vermont Dept. of Health: ID# VT-2006
Virginia Certification #: 460132
Washington Certification #: C847
West Virginia Certification #: 233
Wisconsin Certification #: 998093910
Wyoming UST Certification #: via A2LA 2926.01
A2LA-ISO 17025 Certification #: 1461.01
A2LA-ISO 17025 Certification #: 1461.02
AIHA-LAP/LLC EMLAP Certification #:100789

REPORT OF LABORATORY ANALYSIS

This report shall not be reproduced, except in full,
without the written consent of Pace Analytical Services, LLC.

SAMPLE SUMMARY

Project: 1690005819 FORMER ONE-HOUR VAL

Pace Project No.: 40235956

Lab ID	Sample ID	Matrix	Date Collected	Date Received
40235956001	PZ-2R	Water	10/27/21 09:15	10/28/21 08:15
40235956002	MW-6	Water	10/27/21 09:50	10/28/21 08:15
40235956003	MW-6DUP	Water	10/27/21 09:50	10/28/21 08:15
40235956004	PZ-4	Water	10/27/21 10:30	10/28/21 08:15
40235956005	MW-5	Water	10/27/21 11:05	10/28/21 08:15
40235956006	MW-4	Water	10/27/21 11:45	10/28/21 08:15
40235956007	PZ-1R	Water	10/27/21 12:45	10/28/21 08:15
40235956008	TRIP BLANK	Water	10/27/21 00:00	10/28/21 08:15

REPORT OF LABORATORY ANALYSIS

This report shall not be reproduced, except in full,
without the written consent of Pace Analytical Services, LLC.

SAMPLE ANALYTE COUNT

Project: 1690005819 FORMER ONE-HOUR VAL

Pace Project No.: 40235956

Lab ID	Sample ID	Method	Analysts	Analytes Reported	Laboratory
40235956001	PZ-2R	EPA 8260	JAV	65	PASI-G
40235956002	MW-6	EPA 8260	JAV	65	PASI-G
40235956003	MW-6DUP	EPA 8260	JAV	65	PASI-G
40235956004	PZ-4	EPA 8260	JAV	65	PASI-G
40235956005	MW-5	EPA 8260	JAV	65	PASI-G
40235956006	MW-4	EPA 8260	JAV	65	PASI-G
40235956007	PZ-1R	EPA 8015B Modified	ALD	3	PASI-G
		EPA 6020	JPD	1	PAN
		EPA 8260	JAV	65	PASI-G
		SM 3500-Fe B	MRM	1	PAN
		Calculated	JPD	1	PAN
		EPA 300.0	HMB	1	PASI-G
		SM 5310C	TJJ	1	PASI-G
40235956008	TRIP BLANK	EPA 8260	JAV	65	PASI-G

PAN = Pace National - Mt. Juliet

PASI-G = Pace Analytical Services - Green Bay

REPORT OF LABORATORY ANALYSIS

This report shall not be reproduced, except in full,
without the written consent of Pace Analytical Services, LLC.

SUMMARY OF DETECTION

Project: 1690005819 FORMER ONE-HOUR VAL
Pace Project No.: 40235956

Lab Sample ID Method	Client Sample ID Parameters	Result	Units	Report Limit	Analyzed	Qualifiers
40235956001	PZ-2R					
EPA 8260	cis-1,2-Dichloroethene	104	ug/L	1.0	11/01/21 13:28	
EPA 8260	trans-1,2-Dichloroethene	1.3	ug/L	1.0	11/01/21 13:28	
EPA 8260	Vinyl chloride	12.6	ug/L	1.0	11/01/21 13:28	
40235956002	MW-6					
EPA 8260	cis-1,2-Dichloroethene	1.3	ug/L	1.0	11/01/21 13:48	
EPA 8260	Vinyl chloride	0.19J	ug/L	1.0	11/01/21 13:48	
40235956003	MW-6DUP					
EPA 8260	cis-1,2-Dichloroethene	1.3	ug/L	1.0	11/01/21 14:07	
EPA 8260	Vinyl chloride	0.21J	ug/L	1.0	11/01/21 14:07	
40235956004	PZ-4					
EPA 8260	Vinyl chloride	3.2	ug/L	1.0	11/01/21 14:26	
40235956005	MW-5					
EPA 8260	cis-1,2-Dichloroethene	12.3	ug/L	1.0	11/01/21 14:46	
EPA 8260	trans-1,2-Dichloroethene	1.7	ug/L	1.0	11/01/21 14:46	
EPA 8260	Tetrachloroethene	24.0	ug/L	1.0	11/01/21 14:46	
EPA 8260	Trichloroethene	5.6	ug/L	1.0	11/01/21 14:46	
EPA 8260	Vinyl chloride	1.1	ug/L	1.0	11/01/21 14:46	
40235956006	MW-4					
EPA 8260	Tetrachloroethene	26.8	ug/L	1.0	11/01/21 15:05	
40235956007	PZ-1R					
EPA 8015B Modified	Ethane	2.7J	ug/L	5.6	11/02/21 14:28	
EPA 8015B Modified	Ethene	21.9	ug/L	5.0	11/02/21 14:28	
EPA 8015B Modified	Methane	1820	ug/L	56.0	11/02/21 18:42	
EPA 6020	Iron	17100	ug/L	93.7	11/19/21 13:56	
EPA 8260	cis-1,2-Dichloroethene	69500	ug/L	500	11/01/21 18:53	
EPA 8260	Tetrachloroethene	21800	ug/L	500	11/01/21 18:53	
EPA 8260	Trichloroethene	10800	ug/L	500	11/01/21 18:53	
EPA 8260	Vinyl chloride	14200	ug/L	500	11/01/21 18:53	
SM 3500-Fe B	Iron, Ferrous	19000	ug/L	500	11/04/21 10:33	H3
SM 5310C	Total Organic Carbon	959	mg/L	150	11/03/21 05:36	

REPORT OF LABORATORY ANALYSIS

This report shall not be reproduced, except in full,
without the written consent of Pace Analytical Services, LLC.

ANALYTICAL RESULTS

Project: 1690005819 FORMER ONE-HOUR VAL

Pace Project No.: 40235956

Sample: PZ-2R **Lab ID: 40235956001** Collected: 10/27/21 09:15 Received: 10/28/21 08:15 Matrix: Water

Parameters	Results	Units	LOQ	LOD	DF	Prepared	Analyzed	CAS No.	Qual
8260 MSV									
Analytical Method: EPA 8260									
Pace Analytical Services - Green Bay									
Benzene	<0.30	ug/L	1.0	0.30	1		11/01/21 13:28	71-43-2	
Bromobenzene	<0.36	ug/L	1.0	0.36	1		11/01/21 13:28	108-86-1	
Bromochloromethane	<0.36	ug/L	5.0	0.36	1		11/01/21 13:28	74-97-5	
Bromodichloromethane	<0.42	ug/L	1.0	0.42	1		11/01/21 13:28	75-27-4	
Bromoform	<3.8	ug/L	5.0	3.8	1		11/01/21 13:28	75-25-2	
Bromomethane	<1.2	ug/L	5.0	1.2	1		11/01/21 13:28	74-83-9	
n-Butylbenzene	<0.86	ug/L	1.0	0.86	1		11/01/21 13:28	104-51-8	
sec-Butylbenzene	<0.42	ug/L	1.0	0.42	1		11/01/21 13:28	135-98-8	
tert-Butylbenzene	<0.59	ug/L	1.0	0.59	1		11/01/21 13:28	98-06-6	
Carbon tetrachloride	<0.37	ug/L	1.0	0.37	1		11/01/21 13:28	56-23-5	
Chlorobenzene	<0.86	ug/L	1.0	0.86	1		11/01/21 13:28	108-90-7	
Chloroethane	<1.4	ug/L	5.0	1.4	1		11/01/21 13:28	75-00-3	
Chloroform	<1.2	ug/L	5.0	1.2	1		11/01/21 13:28	67-66-3	
Chloromethane	<1.6	ug/L	5.0	1.6	1		11/01/21 13:28	74-87-3	
2-Chlorotoluene	<0.89	ug/L	5.0	0.89	1		11/01/21 13:28	95-49-8	
4-Chlorotoluene	<0.89	ug/L	5.0	0.89	1		11/01/21 13:28	106-43-4	
1,2-Dibromo-3-chloropropane	<2.4	ug/L	5.0	2.4	1		11/01/21 13:28	96-12-8	
Dibromochloromethane	<2.6	ug/L	5.0	2.6	1		11/01/21 13:28	124-48-1	
1,2-Dibromoethane (EDB)	<0.31	ug/L	1.0	0.31	1		11/01/21 13:28	106-93-4	
Dibromomethane	<0.99	ug/L	5.0	0.99	1		11/01/21 13:28	74-95-3	
1,2-Dichlorobenzene	<0.33	ug/L	1.0	0.33	1		11/01/21 13:28	95-50-1	
1,3-Dichlorobenzene	<0.35	ug/L	1.0	0.35	1		11/01/21 13:28	541-73-1	
1,4-Dichlorobenzene	<0.89	ug/L	1.0	0.89	1		11/01/21 13:28	106-46-7	
Dichlorodifluoromethane	<0.46	ug/L	5.0	0.46	1		11/01/21 13:28	75-71-8	
1,1-Dichloroethane	<0.30	ug/L	1.0	0.30	1		11/01/21 13:28	75-34-3	
1,2-Dichloroethane	<0.29	ug/L	1.0	0.29	1		11/01/21 13:28	107-06-2	
1,1-Dichloroethene	<0.58	ug/L	1.0	0.58	1		11/01/21 13:28	75-35-4	
cis-1,2-Dichloroethene	104	ug/L	1.0	0.47	1		11/01/21 13:28	156-59-2	
trans-1,2-Dichloroethene	1.3	ug/L	1.0	0.53	1		11/01/21 13:28	156-60-5	
1,2-Dichloropropane	<0.45	ug/L	1.0	0.45	1		11/01/21 13:28	78-87-5	
1,3-Dichloropropane	<0.30	ug/L	1.0	0.30	1		11/01/21 13:28	142-28-9	
2,2-Dichloropropane	<4.2	ug/L	5.0	4.2	1		11/01/21 13:28	594-20-7	
1,1-Dichloropropene	<0.41	ug/L	1.0	0.41	1		11/01/21 13:28	563-58-6	
cis-1,3-Dichloropropene	<0.36	ug/L	1.0	0.36	1		11/01/21 13:28	10061-01-5	
trans-1,3-Dichloropropene	<3.5	ug/L	5.0	3.5	1		11/01/21 13:28	10061-02-6	
Diisopropyl ether	<1.1	ug/L	5.0	1.1	1		11/01/21 13:28	108-20-3	
Ethylbenzene	<0.33	ug/L	1.0	0.33	1		11/01/21 13:28	100-41-4	
Hexachloro-1,3-butadiene	<2.7	ug/L	5.0	2.7	1		11/01/21 13:28	87-68-3	
Isopropylbenzene (Cumene)	<1.0	ug/L	5.0	1.0	1		11/01/21 13:28	98-82-8	
p-Isopropyltoluene	<1.0	ug/L	5.0	1.0	1		11/01/21 13:28	99-87-6	
Methylene Chloride	<0.32	ug/L	5.0	0.32	1		11/01/21 13:28	75-09-2	
Methyl-tert-butyl ether	<1.1	ug/L	5.0	1.1	1		11/01/21 13:28	1634-04-4	
Naphthalene	<1.1	ug/L	5.0	1.1	1		11/01/21 13:28	91-20-3	
n-Propylbenzene	<0.35	ug/L	1.0	0.35	1		11/01/21 13:28	103-65-1	
Styrene	<0.36	ug/L	1.0	0.36	1		11/01/21 13:28	100-42-5	

REPORT OF LABORATORY ANALYSIS

This report shall not be reproduced, except in full,
without the written consent of Pace Analytical Services, LLC.

ANALYTICAL RESULTS

Project: 1690005819 FORMER ONE-HOUR VAL
Pace Project No.: 40235956

Sample: PZ-2R **Lab ID: 40235956001** Collected: 10/27/21 09:15 Received: 10/28/21 08:15 Matrix: Water

Parameters	Results	Units	LOQ	LOD	DF	Prepared	Analyzed	CAS No.	Qual
8260 MSV									
Analytical Method: EPA 8260									
Pace Analytical Services - Green Bay									
1,1,1,2-Tetrachloroethane	<0.36	ug/L	1.0	0.36	1		11/01/21 13:28	630-20-6	
1,1,2,2-Tetrachloroethane	<0.38	ug/L	1.0	0.38	1		11/01/21 13:28	79-34-5	
Tetrachloroethene	<0.41	ug/L	1.0	0.41	1		11/01/21 13:28	127-18-4	
Toluene	<0.29	ug/L	1.0	0.29	1		11/01/21 13:28	108-88-3	
1,2,3-Trichlorobenzene	<1.0	ug/L	5.0	1.0	1		11/01/21 13:28	87-61-6	
1,2,4-Trichlorobenzene	<0.95	ug/L	5.0	0.95	1		11/01/21 13:28	120-82-1	
1,1,1-Trichloroethane	<0.30	ug/L	1.0	0.30	1		11/01/21 13:28	71-55-6	
1,1,2-Trichloroethane	<0.34	ug/L	5.0	0.34	1		11/01/21 13:28	79-00-5	
Trichloroethene	<0.32	ug/L	1.0	0.32	1		11/01/21 13:28	79-01-6	
Trichlorofluoromethane	<0.42	ug/L	1.0	0.42	1		11/01/21 13:28	75-69-4	
1,2,3-Trichloropropane	<0.56	ug/L	5.0	0.56	1		11/01/21 13:28	96-18-4	
1,2,4-Trimethylbenzene	<0.45	ug/L	1.0	0.45	1		11/01/21 13:28	95-63-6	
1,3,5-Trimethylbenzene	<0.36	ug/L	1.0	0.36	1		11/01/21 13:28	108-67-8	
Vinyl chloride	12.6	ug/L	1.0	0.17	1		11/01/21 13:28	75-01-4	
Xylene (Total)	<1.0	ug/L	3.0	1.0	1		11/01/21 13:28	1330-20-7	
m&p-Xylene	<0.70	ug/L	2.0	0.70	1		11/01/21 13:28	179601-23-1	
o-Xylene	<0.35	ug/L	1.0	0.35	1		11/01/21 13:28	95-47-6	
Surrogates									
4-Bromofluorobenzene (S)	89	%	70-130		1		11/01/21 13:28	460-00-4	
1,2-Dichlorobenzene-d4 (S)	104	%	70-130		1		11/01/21 13:28	2199-69-1	
Toluene-d8 (S)	102	%	70-130		1		11/01/21 13:28	2037-26-5	

REPORT OF LABORATORY ANALYSIS

This report shall not be reproduced, except in full,
without the written consent of Pace Analytical Services, LLC.

ANALYTICAL RESULTS

Project: 1690005819 FORMER ONE-HOUR VAL

Pace Project No.: 40235956

Sample: MW-6 **Lab ID: 40235956002** Collected: 10/27/21 09:50 Received: 10/28/21 08:15 Matrix: Water

Parameters	Results	Units	LOQ	LOD	DF	Prepared	Analyzed	CAS No.	Qual
8260 MSV									
Analytical Method: EPA 8260									
Pace Analytical Services - Green Bay									
Benzene	<0.30	ug/L	1.0	0.30	1		11/01/21 13:48	71-43-2	
Bromobenzene	<0.36	ug/L	1.0	0.36	1		11/01/21 13:48	108-86-1	
Bromochloromethane	<0.36	ug/L	5.0	0.36	1		11/01/21 13:48	74-97-5	
Bromodichloromethane	<0.42	ug/L	1.0	0.42	1		11/01/21 13:48	75-27-4	
Bromoform	<3.8	ug/L	5.0	3.8	1		11/01/21 13:48	75-25-2	
Bromomethane	<1.2	ug/L	5.0	1.2	1		11/01/21 13:48	74-83-9	
n-Butylbenzene	<0.86	ug/L	1.0	0.86	1		11/01/21 13:48	104-51-8	
sec-Butylbenzene	<0.42	ug/L	1.0	0.42	1		11/01/21 13:48	135-98-8	
tert-Butylbenzene	<0.59	ug/L	1.0	0.59	1		11/01/21 13:48	98-06-6	
Carbon tetrachloride	<0.37	ug/L	1.0	0.37	1		11/01/21 13:48	56-23-5	
Chlorobenzene	<0.86	ug/L	1.0	0.86	1		11/01/21 13:48	108-90-7	
Chloroethane	<1.4	ug/L	5.0	1.4	1		11/01/21 13:48	75-00-3	
Chloroform	<1.2	ug/L	5.0	1.2	1		11/01/21 13:48	67-66-3	
Chloromethane	<1.6	ug/L	5.0	1.6	1		11/01/21 13:48	74-87-3	
2-Chlorotoluene	<0.89	ug/L	5.0	0.89	1		11/01/21 13:48	95-49-8	
4-Chlorotoluene	<0.89	ug/L	5.0	0.89	1		11/01/21 13:48	106-43-4	
1,2-Dibromo-3-chloropropane	<2.4	ug/L	5.0	2.4	1		11/01/21 13:48	96-12-8	
Dibromochloromethane	<2.6	ug/L	5.0	2.6	1		11/01/21 13:48	124-48-1	
1,2-Dibromoethane (EDB)	<0.31	ug/L	1.0	0.31	1		11/01/21 13:48	106-93-4	
Dibromomethane	<0.99	ug/L	5.0	0.99	1		11/01/21 13:48	74-95-3	
1,2-Dichlorobenzene	<0.33	ug/L	1.0	0.33	1		11/01/21 13:48	95-50-1	
1,3-Dichlorobenzene	<0.35	ug/L	1.0	0.35	1		11/01/21 13:48	541-73-1	
1,4-Dichlorobenzene	<0.89	ug/L	1.0	0.89	1		11/01/21 13:48	106-46-7	
Dichlorodifluoromethane	<0.46	ug/L	5.0	0.46	1		11/01/21 13:48	75-71-8	
1,1-Dichloroethane	<0.30	ug/L	1.0	0.30	1		11/01/21 13:48	75-34-3	
1,2-Dichloroethane	<0.29	ug/L	1.0	0.29	1		11/01/21 13:48	107-06-2	
1,1-Dichloroethene	<0.58	ug/L	1.0	0.58	1		11/01/21 13:48	75-35-4	
cis-1,2-Dichloroethene	1.3	ug/L	1.0	0.47	1		11/01/21 13:48	156-59-2	
trans-1,2-Dichloroethene	<0.53	ug/L	1.0	0.53	1		11/01/21 13:48	156-60-5	
1,2-Dichloropropane	<0.45	ug/L	1.0	0.45	1		11/01/21 13:48	78-87-5	
1,3-Dichloropropane	<0.30	ug/L	1.0	0.30	1		11/01/21 13:48	142-28-9	
2,2-Dichloropropane	<4.2	ug/L	5.0	4.2	1		11/01/21 13:48	594-20-7	
1,1-Dichloropropene	<0.41	ug/L	1.0	0.41	1		11/01/21 13:48	563-58-6	
cis-1,3-Dichloropropene	<0.36	ug/L	1.0	0.36	1		11/01/21 13:48	10061-01-5	
trans-1,3-Dichloropropene	<3.5	ug/L	5.0	3.5	1		11/01/21 13:48	10061-02-6	
Diisopropyl ether	<1.1	ug/L	5.0	1.1	1		11/01/21 13:48	108-20-3	
Ethylbenzene	<0.33	ug/L	1.0	0.33	1		11/01/21 13:48	100-41-4	
Hexachloro-1,3-butadiene	<2.7	ug/L	5.0	2.7	1		11/01/21 13:48	87-68-3	
Isopropylbenzene (Cumene)	<1.0	ug/L	5.0	1.0	1		11/01/21 13:48	98-82-8	
p-Isopropyltoluene	<1.0	ug/L	5.0	1.0	1		11/01/21 13:48	99-87-6	
Methylene Chloride	<0.32	ug/L	5.0	0.32	1		11/01/21 13:48	75-09-2	
Methyl-tert-butyl ether	<1.1	ug/L	5.0	1.1	1		11/01/21 13:48	1634-04-4	
Naphthalene	<1.1	ug/L	5.0	1.1	1		11/01/21 13:48	91-20-3	
n-Propylbenzene	<0.35	ug/L	1.0	0.35	1		11/01/21 13:48	103-65-1	
Styrene	<0.36	ug/L	1.0	0.36	1		11/01/21 13:48	100-42-5	

REPORT OF LABORATORY ANALYSIS

This report shall not be reproduced, except in full,
without the written consent of Pace Analytical Services, LLC.

ANALYTICAL RESULTS

Project: 1690005819 FORMER ONE-HOUR VAL
Pace Project No.: 40235956

Sample: MW-6 **Lab ID: 40235956002** Collected: 10/27/21 09:50 Received: 10/28/21 08:15 Matrix: Water

Parameters	Results	Units	LOQ	LOD	DF	Prepared	Analyzed	CAS No.	Qual
8260 MSV									
Analytical Method: EPA 8260									
Pace Analytical Services - Green Bay									
1,1,1,2-Tetrachloroethane	<0.36	ug/L	1.0	0.36	1		11/01/21 13:48	630-20-6	
1,1,2,2-Tetrachloroethane	<0.38	ug/L	1.0	0.38	1		11/01/21 13:48	79-34-5	
Tetrachloroethene	<0.41	ug/L	1.0	0.41	1		11/01/21 13:48	127-18-4	
Toluene	<0.29	ug/L	1.0	0.29	1		11/01/21 13:48	108-88-3	
1,2,3-Trichlorobenzene	<1.0	ug/L	5.0	1.0	1		11/01/21 13:48	87-61-6	
1,2,4-Trichlorobenzene	<0.95	ug/L	5.0	0.95	1		11/01/21 13:48	120-82-1	
1,1,1-Trichloroethane	<0.30	ug/L	1.0	0.30	1		11/01/21 13:48	71-55-6	
1,1,2-Trichloroethane	<0.34	ug/L	5.0	0.34	1		11/01/21 13:48	79-00-5	
Trichloroethene	<0.32	ug/L	1.0	0.32	1		11/01/21 13:48	79-01-6	
Trichlorofluoromethane	<0.42	ug/L	1.0	0.42	1		11/01/21 13:48	75-69-4	
1,2,3-Trichloropropane	<0.56	ug/L	5.0	0.56	1		11/01/21 13:48	96-18-4	
1,2,4-Trimethylbenzene	<0.45	ug/L	1.0	0.45	1		11/01/21 13:48	95-63-6	
1,3,5-Trimethylbenzene	<0.36	ug/L	1.0	0.36	1		11/01/21 13:48	108-67-8	
Vinyl chloride	0.19J	ug/L	1.0	0.17	1		11/01/21 13:48	75-01-4	
Xylene (Total)	<1.0	ug/L	3.0	1.0	1		11/01/21 13:48	1330-20-7	
m&p-Xylene	<0.70	ug/L	2.0	0.70	1		11/01/21 13:48	179601-23-1	
o-Xylene	<0.35	ug/L	1.0	0.35	1		11/01/21 13:48	95-47-6	
Surrogates									
4-Bromofluorobenzene (S)	87	%	70-130		1		11/01/21 13:48	460-00-4	
1,2-Dichlorobenzene-d4 (S)	101	%	70-130		1		11/01/21 13:48	2199-69-1	
Toluene-d8 (S)	100	%	70-130		1		11/01/21 13:48	2037-26-5	

REPORT OF LABORATORY ANALYSIS

This report shall not be reproduced, except in full,
without the written consent of Pace Analytical Services, LLC.

ANALYTICAL RESULTS

Project: 1690005819 FORMER ONE-HOUR VAL

Pace Project No.: 40235956

Sample: MW-6DUP **Lab ID: 40235956003** Collected: 10/27/21 09:50 Received: 10/28/21 08:15 Matrix: Water

Parameters	Results	Units	LOQ	LOD	DF	Prepared	Analyzed	CAS No.	Qual
8260 MSV									
Analytical Method: EPA 8260									
Pace Analytical Services - Green Bay									
Benzene	<0.30	ug/L	1.0	0.30	1		11/01/21 14:07	71-43-2	
Bromobenzene	<0.36	ug/L	1.0	0.36	1		11/01/21 14:07	108-86-1	
Bromochloromethane	<0.36	ug/L	5.0	0.36	1		11/01/21 14:07	74-97-5	
Bromodichloromethane	<0.42	ug/L	1.0	0.42	1		11/01/21 14:07	75-27-4	
Bromoform	<3.8	ug/L	5.0	3.8	1		11/01/21 14:07	75-25-2	
Bromomethane	<1.2	ug/L	5.0	1.2	1		11/01/21 14:07	74-83-9	
n-Butylbenzene	<0.86	ug/L	1.0	0.86	1		11/01/21 14:07	104-51-8	
sec-Butylbenzene	<0.42	ug/L	1.0	0.42	1		11/01/21 14:07	135-98-8	
tert-Butylbenzene	<0.59	ug/L	1.0	0.59	1		11/01/21 14:07	98-06-6	
Carbon tetrachloride	<0.37	ug/L	1.0	0.37	1		11/01/21 14:07	56-23-5	
Chlorobenzene	<0.86	ug/L	1.0	0.86	1		11/01/21 14:07	108-90-7	
Chloroethane	<1.4	ug/L	5.0	1.4	1		11/01/21 14:07	75-00-3	
Chloroform	<1.2	ug/L	5.0	1.2	1		11/01/21 14:07	67-66-3	
Chloromethane	<1.6	ug/L	5.0	1.6	1		11/01/21 14:07	74-87-3	
2-Chlorotoluene	<0.89	ug/L	5.0	0.89	1		11/01/21 14:07	95-49-8	
4-Chlorotoluene	<0.89	ug/L	5.0	0.89	1		11/01/21 14:07	106-43-4	
1,2-Dibromo-3-chloropropane	<2.4	ug/L	5.0	2.4	1		11/01/21 14:07	96-12-8	
Dibromochloromethane	<2.6	ug/L	5.0	2.6	1		11/01/21 14:07	124-48-1	
1,2-Dibromoethane (EDB)	<0.31	ug/L	1.0	0.31	1		11/01/21 14:07	106-93-4	
Dibromomethane	<0.99	ug/L	5.0	0.99	1		11/01/21 14:07	74-95-3	
1,2-Dichlorobenzene	<0.33	ug/L	1.0	0.33	1		11/01/21 14:07	95-50-1	
1,3-Dichlorobenzene	<0.35	ug/L	1.0	0.35	1		11/01/21 14:07	541-73-1	
1,4-Dichlorobenzene	<0.89	ug/L	1.0	0.89	1		11/01/21 14:07	106-46-7	
Dichlorodifluoromethane	<0.46	ug/L	5.0	0.46	1		11/01/21 14:07	75-71-8	
1,1-Dichloroethane	<0.30	ug/L	1.0	0.30	1		11/01/21 14:07	75-34-3	
1,2-Dichloroethane	<0.29	ug/L	1.0	0.29	1		11/01/21 14:07	107-06-2	
1,1-Dichloroethene	<0.58	ug/L	1.0	0.58	1		11/01/21 14:07	75-35-4	
cis-1,2-Dichloroethene	1.3	ug/L	1.0	0.47	1		11/01/21 14:07	156-59-2	
trans-1,2-Dichloroethene	<0.53	ug/L	1.0	0.53	1		11/01/21 14:07	156-60-5	
1,2-Dichloropropane	<0.45	ug/L	1.0	0.45	1		11/01/21 14:07	78-87-5	
1,3-Dichloropropane	<0.30	ug/L	1.0	0.30	1		11/01/21 14:07	142-28-9	
2,2-Dichloropropane	<4.2	ug/L	5.0	4.2	1		11/01/21 14:07	594-20-7	
1,1-Dichloropropene	<0.41	ug/L	1.0	0.41	1		11/01/21 14:07	563-58-6	
cis-1,3-Dichloropropene	<0.36	ug/L	1.0	0.36	1		11/01/21 14:07	10061-01-5	
trans-1,3-Dichloropropene	<3.5	ug/L	5.0	3.5	1		11/01/21 14:07	10061-02-6	
Diisopropyl ether	<1.1	ug/L	5.0	1.1	1		11/01/21 14:07	108-20-3	
Ethylbenzene	<0.33	ug/L	1.0	0.33	1		11/01/21 14:07	100-41-4	
Hexachloro-1,3-butadiene	<2.7	ug/L	5.0	2.7	1		11/01/21 14:07	87-68-3	
Isopropylbenzene (Cumene)	<1.0	ug/L	5.0	1.0	1		11/01/21 14:07	98-82-8	
p-Isopropyltoluene	<1.0	ug/L	5.0	1.0	1		11/01/21 14:07	99-87-6	
Methylene Chloride	<0.32	ug/L	5.0	0.32	1		11/01/21 14:07	75-09-2	
Methyl-tert-butyl ether	<1.1	ug/L	5.0	1.1	1		11/01/21 14:07	1634-04-4	
Naphthalene	<1.1	ug/L	5.0	1.1	1		11/01/21 14:07	91-20-3	
n-Propylbenzene	<0.35	ug/L	1.0	0.35	1		11/01/21 14:07	103-65-1	
Styrene	<0.36	ug/L	1.0	0.36	1		11/01/21 14:07	100-42-5	

REPORT OF LABORATORY ANALYSIS

This report shall not be reproduced, except in full,
without the written consent of Pace Analytical Services, LLC.

ANALYTICAL RESULTS

Project: 1690005819 FORMER ONE-HOUR VAL

Pace Project No.: 40235956

Sample: MW-6DUP **Lab ID: 40235956003** Collected: 10/27/21 09:50 Received: 10/28/21 08:15 Matrix: Water

Parameters	Results	Units	LOQ	LOD	DF	Prepared	Analyzed	CAS No.	Qual
8260 MSV									
Analytical Method: EPA 8260									
Pace Analytical Services - Green Bay									
1,1,1,2-Tetrachloroethane	<0.36	ug/L	1.0	0.36	1		11/01/21 14:07	630-20-6	
1,1,2,2-Tetrachloroethane	<0.38	ug/L	1.0	0.38	1		11/01/21 14:07	79-34-5	
Tetrachloroethene	<0.41	ug/L	1.0	0.41	1		11/01/21 14:07	127-18-4	
Toluene	<0.29	ug/L	1.0	0.29	1		11/01/21 14:07	108-88-3	
1,2,3-Trichlorobenzene	<1.0	ug/L	5.0	1.0	1		11/01/21 14:07	87-61-6	
1,2,4-Trichlorobenzene	<0.95	ug/L	5.0	0.95	1		11/01/21 14:07	120-82-1	
1,1,1-Trichloroethane	<0.30	ug/L	1.0	0.30	1		11/01/21 14:07	71-55-6	
1,1,2-Trichloroethane	<0.34	ug/L	5.0	0.34	1		11/01/21 14:07	79-00-5	
Trichloroethene	<0.32	ug/L	1.0	0.32	1		11/01/21 14:07	79-01-6	
Trichlorofluoromethane	<0.42	ug/L	1.0	0.42	1		11/01/21 14:07	75-69-4	
1,2,3-Trichloropropane	<0.56	ug/L	5.0	0.56	1		11/01/21 14:07	96-18-4	
1,2,4-Trimethylbenzene	<0.45	ug/L	1.0	0.45	1		11/01/21 14:07	95-63-6	
1,3,5-Trimethylbenzene	<0.36	ug/L	1.0	0.36	1		11/01/21 14:07	108-67-8	
Vinyl chloride	0.21J	ug/L	1.0	0.17	1		11/01/21 14:07	75-01-4	
Xylene (Total)	<1.0	ug/L	3.0	1.0	1		11/01/21 14:07	1330-20-7	
m&p-Xylene	<0.70	ug/L	2.0	0.70	1		11/01/21 14:07	179601-23-1	
o-Xylene	<0.35	ug/L	1.0	0.35	1		11/01/21 14:07	95-47-6	
Surrogates									
4-Bromofluorobenzene (S)	90	%	70-130		1		11/01/21 14:07	460-00-4	
1,2-Dichlorobenzene-d4 (S)	102	%	70-130		1		11/01/21 14:07	2199-69-1	
Toluene-d8 (S)	102	%	70-130		1		11/01/21 14:07	2037-26-5	

REPORT OF LABORATORY ANALYSIS

This report shall not be reproduced, except in full,
without the written consent of Pace Analytical Services, LLC.

ANALYTICAL RESULTS

Project: 1690005819 FORMER ONE-HOUR VAL

Pace Project No.: 40235956

Sample: PZ-4 **Lab ID: 40235956004** Collected: 10/27/21 10:30 Received: 10/28/21 08:15 Matrix: Water

Parameters	Results	Units	LOQ	LOD	DF	Prepared	Analyzed	CAS No.	Qual
8260 MSV									
Analytical Method: EPA 8260									
Pace Analytical Services - Green Bay									
Benzene	<0.30	ug/L	1.0	0.30	1		11/01/21 14:26	71-43-2	
Bromobenzene	<0.36	ug/L	1.0	0.36	1		11/01/21 14:26	108-86-1	
Bromochloromethane	<0.36	ug/L	5.0	0.36	1		11/01/21 14:26	74-97-5	
Bromodichloromethane	<0.42	ug/L	1.0	0.42	1		11/01/21 14:26	75-27-4	
Bromoform	<3.8	ug/L	5.0	3.8	1		11/01/21 14:26	75-25-2	
Bromomethane	<1.2	ug/L	5.0	1.2	1		11/01/21 14:26	74-83-9	
n-Butylbenzene	<0.86	ug/L	1.0	0.86	1		11/01/21 14:26	104-51-8	
sec-Butylbenzene	<0.42	ug/L	1.0	0.42	1		11/01/21 14:26	135-98-8	
tert-Butylbenzene	<0.59	ug/L	1.0	0.59	1		11/01/21 14:26	98-06-6	
Carbon tetrachloride	<0.37	ug/L	1.0	0.37	1		11/01/21 14:26	56-23-5	
Chlorobenzene	<0.86	ug/L	1.0	0.86	1		11/01/21 14:26	108-90-7	
Chloroethane	<1.4	ug/L	5.0	1.4	1		11/01/21 14:26	75-00-3	
Chloroform	<1.2	ug/L	5.0	1.2	1		11/01/21 14:26	67-66-3	
Chloromethane	<1.6	ug/L	5.0	1.6	1		11/01/21 14:26	74-87-3	
2-Chlorotoluene	<0.89	ug/L	5.0	0.89	1		11/01/21 14:26	95-49-8	
4-Chlorotoluene	<0.89	ug/L	5.0	0.89	1		11/01/21 14:26	106-43-4	
1,2-Dibromo-3-chloropropane	<2.4	ug/L	5.0	2.4	1		11/01/21 14:26	96-12-8	
Dibromochloromethane	<2.6	ug/L	5.0	2.6	1		11/01/21 14:26	124-48-1	
1,2-Dibromoethane (EDB)	<0.31	ug/L	1.0	0.31	1		11/01/21 14:26	106-93-4	
Dibromomethane	<0.99	ug/L	5.0	0.99	1		11/01/21 14:26	74-95-3	
1,2-Dichlorobenzene	<0.33	ug/L	1.0	0.33	1		11/01/21 14:26	95-50-1	
1,3-Dichlorobenzene	<0.35	ug/L	1.0	0.35	1		11/01/21 14:26	541-73-1	
1,4-Dichlorobenzene	<0.89	ug/L	1.0	0.89	1		11/01/21 14:26	106-46-7	
Dichlorodifluoromethane	<0.46	ug/L	5.0	0.46	1		11/01/21 14:26	75-71-8	
1,1-Dichloroethane	<0.30	ug/L	1.0	0.30	1		11/01/21 14:26	75-34-3	
1,2-Dichloroethane	<0.29	ug/L	1.0	0.29	1		11/01/21 14:26	107-06-2	
1,1-Dichloroethene	<0.58	ug/L	1.0	0.58	1		11/01/21 14:26	75-35-4	
cis-1,2-Dichloroethene	<0.47	ug/L	1.0	0.47	1		11/01/21 14:26	156-59-2	
trans-1,2-Dichloroethene	<0.53	ug/L	1.0	0.53	1		11/01/21 14:26	156-60-5	
1,2-Dichloropropane	<0.45	ug/L	1.0	0.45	1		11/01/21 14:26	78-87-5	
1,3-Dichloropropane	<0.30	ug/L	1.0	0.30	1		11/01/21 14:26	142-28-9	
2,2-Dichloropropane	<4.2	ug/L	5.0	4.2	1		11/01/21 14:26	594-20-7	
1,1-Dichloropropene	<0.41	ug/L	1.0	0.41	1		11/01/21 14:26	563-58-6	
cis-1,3-Dichloropropene	<0.36	ug/L	1.0	0.36	1		11/01/21 14:26	10061-01-5	
trans-1,3-Dichloropropene	<3.5	ug/L	5.0	3.5	1		11/01/21 14:26	10061-02-6	
Diisopropyl ether	<1.1	ug/L	5.0	1.1	1		11/01/21 14:26	108-20-3	
Ethylbenzene	<0.33	ug/L	1.0	0.33	1		11/01/21 14:26	100-41-4	
Hexachloro-1,3-butadiene	<2.7	ug/L	5.0	2.7	1		11/01/21 14:26	87-68-3	
Isopropylbenzene (Cumene)	<1.0	ug/L	5.0	1.0	1		11/01/21 14:26	98-82-8	
p-Isopropyltoluene	<1.0	ug/L	5.0	1.0	1		11/01/21 14:26	99-87-6	
Methylene Chloride	<0.32	ug/L	5.0	0.32	1		11/01/21 14:26	75-09-2	
Methyl-tert-butyl ether	<1.1	ug/L	5.0	1.1	1		11/01/21 14:26	1634-04-4	
Naphthalene	<1.1	ug/L	5.0	1.1	1		11/01/21 14:26	91-20-3	
n-Propylbenzene	<0.35	ug/L	1.0	0.35	1		11/01/21 14:26	103-65-1	
Styrene	<0.36	ug/L	1.0	0.36	1		11/01/21 14:26	100-42-5	

REPORT OF LABORATORY ANALYSIS

This report shall not be reproduced, except in full,
without the written consent of Pace Analytical Services, LLC.

ANALYTICAL RESULTS

Project: 1690005819 FORMER ONE-HOUR VAL
Pace Project No.: 40235956

Sample: PZ-4 **Lab ID: 40235956004** Collected: 10/27/21 10:30 Received: 10/28/21 08:15 Matrix: Water

Parameters	Results	Units	LOQ	LOD	DF	Prepared	Analyzed	CAS No.	Qual
8260 MSV									
Analytical Method: EPA 8260									
Pace Analytical Services - Green Bay									
1,1,1,2-Tetrachloroethane	<0.36	ug/L	1.0	0.36	1		11/01/21 14:26	630-20-6	
1,1,2,2-Tetrachloroethane	<0.38	ug/L	1.0	0.38	1		11/01/21 14:26	79-34-5	
Tetrachloroethene	<0.41	ug/L	1.0	0.41	1		11/01/21 14:26	127-18-4	
Toluene	<0.29	ug/L	1.0	0.29	1		11/01/21 14:26	108-88-3	
1,2,3-Trichlorobenzene	<1.0	ug/L	5.0	1.0	1		11/01/21 14:26	87-61-6	
1,2,4-Trichlorobenzene	<0.95	ug/L	5.0	0.95	1		11/01/21 14:26	120-82-1	
1,1,1-Trichloroethane	<0.30	ug/L	1.0	0.30	1		11/01/21 14:26	71-55-6	
1,1,2-Trichloroethane	<0.34	ug/L	5.0	0.34	1		11/01/21 14:26	79-00-5	
Trichloroethene	<0.32	ug/L	1.0	0.32	1		11/01/21 14:26	79-01-6	
Trichlorofluoromethane	<0.42	ug/L	1.0	0.42	1		11/01/21 14:26	75-69-4	
1,2,3-Trichloropropane	<0.56	ug/L	5.0	0.56	1		11/01/21 14:26	96-18-4	
1,2,4-Trimethylbenzene	<0.45	ug/L	1.0	0.45	1		11/01/21 14:26	95-63-6	
1,3,5-Trimethylbenzene	<0.36	ug/L	1.0	0.36	1		11/01/21 14:26	108-67-8	
Vinyl chloride	3.2	ug/L	1.0	0.17	1		11/01/21 14:26	75-01-4	
Xylene (Total)	<1.0	ug/L	3.0	1.0	1		11/01/21 14:26	1330-20-7	
m&p-Xylene	<0.70	ug/L	2.0	0.70	1		11/01/21 14:26	179601-23-1	
o-Xylene	<0.35	ug/L	1.0	0.35	1		11/01/21 14:26	95-47-6	
Surrogates									
4-Bromofluorobenzene (S)	86	%	70-130		1		11/01/21 14:26	460-00-4	
1,2-Dichlorobenzene-d4 (S)	101	%	70-130		1		11/01/21 14:26	2199-69-1	
Toluene-d8 (S)	102	%	70-130		1		11/01/21 14:26	2037-26-5	

REPORT OF LABORATORY ANALYSIS

This report shall not be reproduced, except in full,
without the written consent of Pace Analytical Services, LLC.

ANALYTICAL RESULTS

Project: 1690005819 FORMER ONE-HOUR VAL

Pace Project No.: 40235956

Sample: MW-5 **Lab ID: 40235956005** Collected: 10/27/21 11:05 Received: 10/28/21 08:15 Matrix: Water

Parameters	Results	Units	LOQ	LOD	DF	Prepared	Analyzed	CAS No.	Qual
8260 MSV									
Analytical Method: EPA 8260									
Pace Analytical Services - Green Bay									
Benzene	<0.30	ug/L	1.0	0.30	1		11/01/21 14:46	71-43-2	
Bromobenzene	<0.36	ug/L	1.0	0.36	1		11/01/21 14:46	108-86-1	
Bromochloromethane	<0.36	ug/L	5.0	0.36	1		11/01/21 14:46	74-97-5	
Bromodichloromethane	<0.42	ug/L	1.0	0.42	1		11/01/21 14:46	75-27-4	
Bromoform	<3.8	ug/L	5.0	3.8	1		11/01/21 14:46	75-25-2	
Bromomethane	<1.2	ug/L	5.0	1.2	1		11/01/21 14:46	74-83-9	
n-Butylbenzene	<0.86	ug/L	1.0	0.86	1		11/01/21 14:46	104-51-8	
sec-Butylbenzene	<0.42	ug/L	1.0	0.42	1		11/01/21 14:46	135-98-8	
tert-Butylbenzene	<0.59	ug/L	1.0	0.59	1		11/01/21 14:46	98-06-6	
Carbon tetrachloride	<0.37	ug/L	1.0	0.37	1		11/01/21 14:46	56-23-5	
Chlorobenzene	<0.86	ug/L	1.0	0.86	1		11/01/21 14:46	108-90-7	
Chloroethane	<1.4	ug/L	5.0	1.4	1		11/01/21 14:46	75-00-3	
Chloroform	<1.2	ug/L	5.0	1.2	1		11/01/21 14:46	67-66-3	
Chloromethane	<1.6	ug/L	5.0	1.6	1		11/01/21 14:46	74-87-3	
2-Chlorotoluene	<0.89	ug/L	5.0	0.89	1		11/01/21 14:46	95-49-8	
4-Chlorotoluene	<0.89	ug/L	5.0	0.89	1		11/01/21 14:46	106-43-4	
1,2-Dibromo-3-chloropropane	<2.4	ug/L	5.0	2.4	1		11/01/21 14:46	96-12-8	
Dibromochloromethane	<2.6	ug/L	5.0	2.6	1		11/01/21 14:46	124-48-1	
1,2-Dibromoethane (EDB)	<0.31	ug/L	1.0	0.31	1		11/01/21 14:46	106-93-4	
Dibromomethane	<0.99	ug/L	5.0	0.99	1		11/01/21 14:46	74-95-3	
1,2-Dichlorobenzene	<0.33	ug/L	1.0	0.33	1		11/01/21 14:46	95-50-1	
1,3-Dichlorobenzene	<0.35	ug/L	1.0	0.35	1		11/01/21 14:46	541-73-1	
1,4-Dichlorobenzene	<0.89	ug/L	1.0	0.89	1		11/01/21 14:46	106-46-7	
Dichlorodifluoromethane	<0.46	ug/L	5.0	0.46	1		11/01/21 14:46	75-71-8	
1,1-Dichloroethane	<0.30	ug/L	1.0	0.30	1		11/01/21 14:46	75-34-3	
1,2-Dichloroethane	<0.29	ug/L	1.0	0.29	1		11/01/21 14:46	107-06-2	
1,1-Dichloroethene	<0.58	ug/L	1.0	0.58	1		11/01/21 14:46	75-35-4	
cis-1,2-Dichloroethene	12.3	ug/L	1.0	0.47	1		11/01/21 14:46	156-59-2	
trans-1,2-Dichloroethene	1.7	ug/L	1.0	0.53	1		11/01/21 14:46	156-60-5	
1,2-Dichloropropane	<0.45	ug/L	1.0	0.45	1		11/01/21 14:46	78-87-5	
1,3-Dichloropropane	<0.30	ug/L	1.0	0.30	1		11/01/21 14:46	142-28-9	
2,2-Dichloropropane	<4.2	ug/L	5.0	4.2	1		11/01/21 14:46	594-20-7	
1,1-Dichloropropene	<0.41	ug/L	1.0	0.41	1		11/01/21 14:46	563-58-6	
cis-1,3-Dichloropropene	<0.36	ug/L	1.0	0.36	1		11/01/21 14:46	10061-01-5	
trans-1,3-Dichloropropene	<3.5	ug/L	5.0	3.5	1		11/01/21 14:46	10061-02-6	
Diisopropyl ether	<1.1	ug/L	5.0	1.1	1		11/01/21 14:46	108-20-3	
Ethylbenzene	<0.33	ug/L	1.0	0.33	1		11/01/21 14:46	100-41-4	
Hexachloro-1,3-butadiene	<2.7	ug/L	5.0	2.7	1		11/01/21 14:46	87-68-3	
Isopropylbenzene (Cumene)	<1.0	ug/L	5.0	1.0	1		11/01/21 14:46	98-82-8	
p-Isopropyltoluene	<1.0	ug/L	5.0	1.0	1		11/01/21 14:46	99-87-6	
Methylene Chloride	<0.32	ug/L	5.0	0.32	1		11/01/21 14:46	75-09-2	
Methyl-tert-butyl ether	<1.1	ug/L	5.0	1.1	1		11/01/21 14:46	1634-04-4	
Naphthalene	<1.1	ug/L	5.0	1.1	1		11/01/21 14:46	91-20-3	
n-Propylbenzene	<0.35	ug/L	1.0	0.35	1		11/01/21 14:46	103-65-1	
Styrene	<0.36	ug/L	1.0	0.36	1		11/01/21 14:46	100-42-5	

REPORT OF LABORATORY ANALYSIS

This report shall not be reproduced, except in full,
without the written consent of Pace Analytical Services, LLC.

ANALYTICAL RESULTS

Project: 1690005819 FORMER ONE-HOUR VAL

Pace Project No.: 40235956

Sample: MW-5 **Lab ID: 40235956005** Collected: 10/27/21 11:05 Received: 10/28/21 08:15 Matrix: Water

Parameters	Results	Units	LOQ	LOD	DF	Prepared	Analyzed	CAS No.	Qual
8260 MSV									
Analytical Method: EPA 8260									
Pace Analytical Services - Green Bay									
1,1,1,2-Tetrachloroethane	<0.36	ug/L	1.0	0.36	1		11/01/21 14:46	630-20-6	
1,1,2,2-Tetrachloroethane	<0.38	ug/L	1.0	0.38	1		11/01/21 14:46	79-34-5	
Tetrachloroethene	24.0	ug/L	1.0	0.41	1		11/01/21 14:46	127-18-4	
Toluene	<0.29	ug/L	1.0	0.29	1		11/01/21 14:46	108-88-3	
1,2,3-Trichlorobenzene	<1.0	ug/L	5.0	1.0	1		11/01/21 14:46	87-61-6	
1,2,4-Trichlorobenzene	<0.95	ug/L	5.0	0.95	1		11/01/21 14:46	120-82-1	
1,1,1-Trichloroethane	<0.30	ug/L	1.0	0.30	1		11/01/21 14:46	71-55-6	
1,1,2-Trichloroethane	<0.34	ug/L	5.0	0.34	1		11/01/21 14:46	79-00-5	
Trichloroethene	5.6	ug/L	1.0	0.32	1		11/01/21 14:46	79-01-6	
Trichlorofluoromethane	<0.42	ug/L	1.0	0.42	1		11/01/21 14:46	75-69-4	
1,2,3-Trichloropropane	<0.56	ug/L	5.0	0.56	1		11/01/21 14:46	96-18-4	
1,2,4-Trimethylbenzene	<0.45	ug/L	1.0	0.45	1		11/01/21 14:46	95-63-6	
1,3,5-Trimethylbenzene	<0.36	ug/L	1.0	0.36	1		11/01/21 14:46	108-67-8	
Vinyl chloride	1.1	ug/L	1.0	0.17	1		11/01/21 14:46	75-01-4	
Xylene (Total)	<1.0	ug/L	3.0	1.0	1		11/01/21 14:46	1330-20-7	
m&p-Xylene	<0.70	ug/L	2.0	0.70	1		11/01/21 14:46	179601-23-1	
o-Xylene	<0.35	ug/L	1.0	0.35	1		11/01/21 14:46	95-47-6	
Surrogates									
4-Bromofluorobenzene (S)	89	%	70-130		1		11/01/21 14:46	460-00-4	
1,2-Dichlorobenzene-d4 (S)	104	%	70-130		1		11/01/21 14:46	2199-69-1	
Toluene-d8 (S)	101	%	70-130		1		11/01/21 14:46	2037-26-5	

REPORT OF LABORATORY ANALYSIS

This report shall not be reproduced, except in full,
without the written consent of Pace Analytical Services, LLC.

ANALYTICAL RESULTS

Project: 1690005819 FORMER ONE-HOUR VAL

Pace Project No.: 40235956

Sample: MW-4 **Lab ID: 40235956006** Collected: 10/27/21 11:45 Received: 10/28/21 08:15 Matrix: Water

Parameters	Results	Units	LOQ	LOD	DF	Prepared	Analyzed	CAS No.	Qual
8260 MSV									
Analytical Method: EPA 8260									
Pace Analytical Services - Green Bay									
Benzene	<0.30	ug/L	1.0	0.30	1		11/01/21 15:05	71-43-2	
Bromobenzene	<0.36	ug/L	1.0	0.36	1		11/01/21 15:05	108-86-1	
Bromochloromethane	<0.36	ug/L	5.0	0.36	1		11/01/21 15:05	74-97-5	
Bromodichloromethane	<0.42	ug/L	1.0	0.42	1		11/01/21 15:05	75-27-4	
Bromoform	<3.8	ug/L	5.0	3.8	1		11/01/21 15:05	75-25-2	
Bromomethane	<1.2	ug/L	5.0	1.2	1		11/01/21 15:05	74-83-9	
n-Butylbenzene	<0.86	ug/L	1.0	0.86	1		11/01/21 15:05	104-51-8	
sec-Butylbenzene	<0.42	ug/L	1.0	0.42	1		11/01/21 15:05	135-98-8	
tert-Butylbenzene	<0.59	ug/L	1.0	0.59	1		11/01/21 15:05	98-06-6	
Carbon tetrachloride	<0.37	ug/L	1.0	0.37	1		11/01/21 15:05	56-23-5	
Chlorobenzene	<0.86	ug/L	1.0	0.86	1		11/01/21 15:05	108-90-7	
Chloroethane	<1.4	ug/L	5.0	1.4	1		11/01/21 15:05	75-00-3	
Chloroform	<1.2	ug/L	5.0	1.2	1		11/01/21 15:05	67-66-3	
Chloromethane	<1.6	ug/L	5.0	1.6	1		11/01/21 15:05	74-87-3	
2-Chlorotoluene	<0.89	ug/L	5.0	0.89	1		11/01/21 15:05	95-49-8	
4-Chlorotoluene	<0.89	ug/L	5.0	0.89	1		11/01/21 15:05	106-43-4	
1,2-Dibromo-3-chloropropane	<2.4	ug/L	5.0	2.4	1		11/01/21 15:05	96-12-8	
Dibromochloromethane	<2.6	ug/L	5.0	2.6	1		11/01/21 15:05	124-48-1	
1,2-Dibromoethane (EDB)	<0.31	ug/L	1.0	0.31	1		11/01/21 15:05	106-93-4	
Dibromomethane	<0.99	ug/L	5.0	0.99	1		11/01/21 15:05	74-95-3	
1,2-Dichlorobenzene	<0.33	ug/L	1.0	0.33	1		11/01/21 15:05	95-50-1	
1,3-Dichlorobenzene	<0.35	ug/L	1.0	0.35	1		11/01/21 15:05	541-73-1	
1,4-Dichlorobenzene	<0.89	ug/L	1.0	0.89	1		11/01/21 15:05	106-46-7	
Dichlorodifluoromethane	<0.46	ug/L	5.0	0.46	1		11/01/21 15:05	75-71-8	
1,1-Dichloroethane	<0.30	ug/L	1.0	0.30	1		11/01/21 15:05	75-34-3	
1,2-Dichloroethane	<0.29	ug/L	1.0	0.29	1		11/01/21 15:05	107-06-2	
1,1-Dichloroethene	<0.58	ug/L	1.0	0.58	1		11/01/21 15:05	75-35-4	
cis-1,2-Dichloroethene	<0.47	ug/L	1.0	0.47	1		11/01/21 15:05	156-59-2	
trans-1,2-Dichloroethene	<0.53	ug/L	1.0	0.53	1		11/01/21 15:05	156-60-5	
1,2-Dichloropropane	<0.45	ug/L	1.0	0.45	1		11/01/21 15:05	78-87-5	
1,3-Dichloropropane	<0.30	ug/L	1.0	0.30	1		11/01/21 15:05	142-28-9	
2,2-Dichloropropane	<4.2	ug/L	5.0	4.2	1		11/01/21 15:05	594-20-7	
1,1-Dichloropropene	<0.41	ug/L	1.0	0.41	1		11/01/21 15:05	563-58-6	
cis-1,3-Dichloropropene	<0.36	ug/L	1.0	0.36	1		11/01/21 15:05	10061-01-5	
trans-1,3-Dichloropropene	<3.5	ug/L	5.0	3.5	1		11/01/21 15:05	10061-02-6	
Diisopropyl ether	<1.1	ug/L	5.0	1.1	1		11/01/21 15:05	108-20-3	
Ethylbenzene	<0.33	ug/L	1.0	0.33	1		11/01/21 15:05	100-41-4	
Hexachloro-1,3-butadiene	<2.7	ug/L	5.0	2.7	1		11/01/21 15:05	87-68-3	
Isopropylbenzene (Cumene)	<1.0	ug/L	5.0	1.0	1		11/01/21 15:05	98-82-8	
p-Isopropyltoluene	<1.0	ug/L	5.0	1.0	1		11/01/21 15:05	99-87-6	
Methylene Chloride	<0.32	ug/L	5.0	0.32	1		11/01/21 15:05	75-09-2	
Methyl-tert-butyl ether	<1.1	ug/L	5.0	1.1	1		11/01/21 15:05	1634-04-4	
Naphthalene	<1.1	ug/L	5.0	1.1	1		11/01/21 15:05	91-20-3	
n-Propylbenzene	<0.35	ug/L	1.0	0.35	1		11/01/21 15:05	103-65-1	
Styrene	<0.36	ug/L	1.0	0.36	1		11/01/21 15:05	100-42-5	

REPORT OF LABORATORY ANALYSIS

This report shall not be reproduced, except in full,
without the written consent of Pace Analytical Services, LLC.

ANALYTICAL RESULTS

Project: 1690005819 FORMER ONE-HOUR VAL

Pace Project No.: 40235956

Sample: MW-4 **Lab ID: 40235956006** Collected: 10/27/21 11:45 Received: 10/28/21 08:15 Matrix: Water

Parameters	Results	Units	LOQ	LOD	DF	Prepared	Analyzed	CAS No.	Qual
8260 MSV									
Analytical Method: EPA 8260									
Pace Analytical Services - Green Bay									
1,1,1,2-Tetrachloroethane	<0.36	ug/L	1.0	0.36	1		11/01/21 15:05	630-20-6	
1,1,2,2-Tetrachloroethane	<0.38	ug/L	1.0	0.38	1		11/01/21 15:05	79-34-5	
Tetrachloroethene	26.8	ug/L	1.0	0.41	1		11/01/21 15:05	127-18-4	
Toluene	<0.29	ug/L	1.0	0.29	1		11/01/21 15:05	108-88-3	
1,2,3-Trichlorobenzene	<1.0	ug/L	5.0	1.0	1		11/01/21 15:05	87-61-6	
1,2,4-Trichlorobenzene	<0.95	ug/L	5.0	0.95	1		11/01/21 15:05	120-82-1	
1,1,1-Trichloroethane	<0.30	ug/L	1.0	0.30	1		11/01/21 15:05	71-55-6	
1,1,2-Trichloroethane	<0.34	ug/L	5.0	0.34	1		11/01/21 15:05	79-00-5	
Trichloroethene	<0.32	ug/L	1.0	0.32	1		11/01/21 15:05	79-01-6	
Trichlorofluoromethane	<0.42	ug/L	1.0	0.42	1		11/01/21 15:05	75-69-4	
1,2,3-Trichloropropane	<0.56	ug/L	5.0	0.56	1		11/01/21 15:05	96-18-4	
1,2,4-Trimethylbenzene	<0.45	ug/L	1.0	0.45	1		11/01/21 15:05	95-63-6	
1,3,5-Trimethylbenzene	<0.36	ug/L	1.0	0.36	1		11/01/21 15:05	108-67-8	
Vinyl chloride	<0.17	ug/L	1.0	0.17	1		11/01/21 15:05	75-01-4	
Xylene (Total)	<1.0	ug/L	3.0	1.0	1		11/01/21 15:05	1330-20-7	
m&p-Xylene	<0.70	ug/L	2.0	0.70	1		11/01/21 15:05	179601-23-1	
o-Xylene	<0.35	ug/L	1.0	0.35	1		11/01/21 15:05	95-47-6	
Surrogates									
4-Bromofluorobenzene (S)	89	%	70-130		1		11/01/21 15:05	460-00-4	
1,2-Dichlorobenzene-d4 (S)	103	%	70-130		1		11/01/21 15:05	2199-69-1	
Toluene-d8 (S)	104	%	70-130		1		11/01/21 15:05	2037-26-5	

REPORT OF LABORATORY ANALYSIS

This report shall not be reproduced, except in full,
without the written consent of Pace Analytical Services, LLC.

ANALYTICAL RESULTS

Project: 1690005819 FORMER ONE-HOUR VAL

Pace Project No.: 40235956

Sample: PZ-1R **Lab ID: 40235956007** Collected: 10/27/21 12:45 Received: 10/28/21 08:15 Matrix: Water

Parameters	Results	Units	LOQ	LOD	DF	Prepared	Analyzed	CAS No.	Qual
Methane, Ethane, Ethene GCV									
Analytical Method: EPA 8015B Modified Pace Analytical Services - Green Bay									
Ethane	2.7J	ug/L	5.6	0.39	1		11/02/21 14:28	74-84-0	
Ethene	21.9	ug/L	5.0	0.25	1		11/02/21 14:28	74-85-1	
Methane	1820	ug/L	56.0	11.5	20		11/02/21 18:42	74-82-8	
Metals (ICPMS) 6020									
Analytical Method: EPA 6020 Preparation Method: 3015 Pace National - Mt. Juliet									
Iron	17100	ug/L	93.7	28.1	1	11/18/21 11:50	11/19/21 13:56	7439-89-6	
8260 MSV									
Analytical Method: EPA 8260 Pace Analytical Services - Green Bay									
Benzene	<148	ug/L	500	148	500		11/01/21 18:53	71-43-2	
Bromobenzene	<180	ug/L	500	180	500		11/01/21 18:53	108-86-1	
Bromochloromethane	<179	ug/L	2500	179	500		11/01/21 18:53	74-97-5	
Bromodichloromethane	<208	ug/L	500	208	500		11/01/21 18:53	75-27-4	
Bromoform	<1900	ug/L	2500	1900	500		11/01/21 18:53	75-25-2	
Bromomethane	<596	ug/L	2500	596	500		11/01/21 18:53	74-83-9	
n-Butylbenzene	<429	ug/L	500	429	500		11/01/21 18:53	104-51-8	
sec-Butylbenzene	<212	ug/L	500	212	500		11/01/21 18:53	135-98-8	
tert-Butylbenzene	<293	ug/L	500	293	500		11/01/21 18:53	98-06-6	
Carbon tetrachloride	<185	ug/L	500	185	500		11/01/21 18:53	56-23-5	
Chlorobenzene	<428	ug/L	500	428	500		11/01/21 18:53	108-90-7	
Chloroethane	<690	ug/L	2500	690	500		11/01/21 18:53	75-00-3	
Chloroform	<591	ug/L	2500	591	500		11/01/21 18:53	67-66-3	
Chloromethane	<818	ug/L	2500	818	500		11/01/21 18:53	74-87-3	
2-Chlorotoluene	<445	ug/L	2500	445	500		11/01/21 18:53	95-49-8	
4-Chlorotoluene	<447	ug/L	2500	447	500		11/01/21 18:53	106-43-4	
1,2-Dibromo-3-chloropropane	<1180	ug/L	2500	1180	500		11/01/21 18:53	96-12-8	
Dibromochloromethane	<1320	ug/L	2500	1320	500		11/01/21 18:53	124-48-1	
1,2-Dibromoethane (EDB)	<155	ug/L	500	155	500		11/01/21 18:53	106-93-4	
Dibromomethane	<495	ug/L	2500	495	500		11/01/21 18:53	74-95-3	
1,2-Dichlorobenzene	<163	ug/L	500	163	500		11/01/21 18:53	95-50-1	
1,3-Dichlorobenzene	<176	ug/L	500	176	500		11/01/21 18:53	541-73-1	
1,4-Dichlorobenzene	<446	ug/L	500	446	500		11/01/21 18:53	106-46-7	
Dichlorodifluoromethane	<228	ug/L	2500	228	500		11/01/21 18:53	75-71-8	
1,1-Dichloroethane	<148	ug/L	500	148	500		11/01/21 18:53	75-34-3	
1,2-Dichloroethane	<146	ug/L	500	146	500		11/01/21 18:53	107-06-2	
1,1-Dichloroethene	<291	ug/L	500	291	500		11/01/21 18:53	75-35-4	
cis-1,2-Dichloroethene	69500	ug/L	500	236	500		11/01/21 18:53	156-59-2	
trans-1,2-Dichloroethene	<264	ug/L	500	264	500		11/01/21 18:53	156-60-5	
1,2-Dichloropropane	<224	ug/L	500	224	500		11/01/21 18:53	78-87-5	
1,3-Dichloropropane	<152	ug/L	500	152	500		11/01/21 18:53	142-28-9	
2,2-Dichloropropane	<2090	ug/L	2500	2090	500		11/01/21 18:53	594-20-7	
1,1-Dichloropropene	<205	ug/L	500	205	500		11/01/21 18:53	563-58-6	
cis-1,3-Dichloropropene	<179	ug/L	500	179	500		11/01/21 18:53	10061-01-5	
trans-1,3-Dichloropropene	<1730	ug/L	2500	1730	500		11/01/21 18:53	10061-02-6	

REPORT OF LABORATORY ANALYSIS

This report shall not be reproduced, except in full,
without the written consent of Pace Analytical Services, LLC.

ANALYTICAL RESULTS

Project: 1690005819 FORMER ONE-HOUR VAL
Pace Project No.: 40235956

Sample: PZ-1R **Lab ID: 40235956007** Collected: 10/27/21 12:45 Received: 10/28/21 08:15 Matrix: Water

Parameters	Results	Units	LOQ	LOD	DF	Prepared	Analyzed	CAS No.	Qual
8260 MSV									
Analytical Method: EPA 8260									
Pace Analytical Services - Green Bay									
Diisopropyl ether	<550	ug/L	2500	550	500		11/01/21 18:53	108-20-3	
Ethylbenzene	<163	ug/L	500	163	500		11/01/21 18:53	100-41-4	
Hexachloro-1,3-butadiene	<1370	ug/L	2500	1370	500		11/01/21 18:53	87-68-3	
Isopropylbenzene (Cumene)	<500	ug/L	2500	500	500		11/01/21 18:53	98-82-8	
p-Isopropyltoluene	<522	ug/L	2500	522	500		11/01/21 18:53	99-87-6	
Methylene Chloride	<160	ug/L	2500	160	500		11/01/21 18:53	75-09-2	
Methyl-tert-butyl ether	<565	ug/L	2500	565	500		11/01/21 18:53	1634-04-4	
Naphthalene	<565	ug/L	2500	565	500		11/01/21 18:53	91-20-3	
n-Propylbenzene	<173	ug/L	500	173	500		11/01/21 18:53	103-65-1	
Styrene	<178	ug/L	500	178	500		11/01/21 18:53	100-42-5	
1,1,1,2-Tetrachloroethane	<178	ug/L	500	178	500		11/01/21 18:53	630-20-6	
1,1,2,2-Tetrachloroethane	<189	ug/L	500	189	500		11/01/21 18:53	79-34-5	
Tetrachloroethene	21800	ug/L	500	204	500		11/01/21 18:53	127-18-4	
Toluene	<144	ug/L	500	144	500		11/01/21 18:53	108-88-3	
1,2,3-Trichlorobenzene	<509	ug/L	2500	509	500		11/01/21 18:53	87-61-6	
1,2,4-Trichlorobenzene	<475	ug/L	2500	475	500		11/01/21 18:53	120-82-1	
1,1,1-Trichloroethane	<151	ug/L	500	151	500		11/01/21 18:53	71-55-6	
1,1,2-Trichloroethane	<172	ug/L	2500	172	500		11/01/21 18:53	79-00-5	
Trichloroethene	10800	ug/L	500	160	500		11/01/21 18:53	79-01-6	
Trichlorofluoromethane	<209	ug/L	500	209	500		11/01/21 18:53	75-69-4	
1,2,3-Trichloropropane	<278	ug/L	2500	278	500		11/01/21 18:53	96-18-4	
1,2,4-Trimethylbenzene	<224	ug/L	500	224	500		11/01/21 18:53	95-63-6	
1,3,5-Trimethylbenzene	<179	ug/L	500	179	500		11/01/21 18:53	108-67-8	
Vinyl chloride	14200	ug/L	500	87.2	500		11/01/21 18:53	75-01-4	
Xylene (Total)	<524	ug/L	1500	524	500		11/01/21 18:53	1330-20-7	
m&p-Xylene	<350	ug/L	1000	350	500		11/01/21 18:53	179601-23-1	
o-Xylene	<174	ug/L	500	174	500		11/01/21 18:53	95-47-6	
Surrogates									
4-Bromofluorobenzene (S)	86	%	70-130		500		11/01/21 18:53	460-00-4	
1,2-Dichlorobenzene-d4 (S)	101	%	70-130		500		11/01/21 18:53	2199-69-1	
Toluene-d8 (S)	102	%	70-130		500		11/01/21 18:53	2037-26-5	
Wet Chemistry 3500Fe B-2011									
Analytical Method: SM 3500-Fe B Preparation Method: 3500Fe B-2011									
Pace National - Mt. Juliet									
Iron, Ferrous	19000	ug/L	500	150	10	11/04/21 10:33	11/04/21 10:33		H3
Calculated Results									
Analytical Method: Calculated Preparation Method: Calc.									
Pace National - Mt. Juliet									
Iron, Ferric	<28.1	ug/L	93.7	28.1	1	11/19/21 13:56	11/19/21 13:56	7439-89-6	H3
300.0 IC Anions									
Analytical Method: EPA 300.0									
Pace Analytical Services - Green Bay									
Sulfate	<2.2	mg/L	10.0	2.2	5		11/04/21 00:47	14808-79-8	D3

REPORT OF LABORATORY ANALYSIS

This report shall not be reproduced, except in full,
without the written consent of Pace Analytical Services, LLC.

ANALYTICAL RESULTS

Project: 1690005819 FORMER ONE-HOUR VAL

Pace Project No.: 40235956

Sample: PZ-1R **Lab ID: 40235956007** Collected: 10/27/21 12:45 Received: 10/28/21 08:15 Matrix: Water

Parameters	Results	Units	LOQ	LOD	DF	Prepared	Analyzed	CAS No.	Qual
5310C TOC									
Analytical Method: SM 5310C									
Pace Analytical Services - Green Bay									
Total Organic Carbon	959	mg/L	150	41.5	300		11/03/21 05:36	7440-44-0	

REPORT OF LABORATORY ANALYSIS

This report shall not be reproduced, except in full,
without the written consent of Pace Analytical Services, LLC.

ANALYTICAL RESULTS

Project: 1690005819 FORMER ONE-HOUR VAL

Pace Project No.: 40235956

Sample: TRIP BLANK **Lab ID: 40235956008** Collected: 10/27/21 00:00 Received: 10/28/21 08:15 Matrix: Water

Parameters	Results	Units	LOQ	LOD	DF	Prepared	Analyzed	CAS No.	Qual
8260 MSV									
Analytical Method: EPA 8260									
Pace Analytical Services - Green Bay									
Benzene	<0.30	ug/L	1.0	0.30	1		11/01/21 10:54	71-43-2	
Bromobenzene	<0.36	ug/L	1.0	0.36	1		11/01/21 10:54	108-86-1	
Bromochloromethane	<0.36	ug/L	5.0	0.36	1		11/01/21 10:54	74-97-5	
Bromodichloromethane	<0.42	ug/L	1.0	0.42	1		11/01/21 10:54	75-27-4	
Bromoform	<3.8	ug/L	5.0	3.8	1		11/01/21 10:54	75-25-2	
Bromomethane	<1.2	ug/L	5.0	1.2	1		11/01/21 10:54	74-83-9	
n-Butylbenzene	<0.86	ug/L	1.0	0.86	1		11/01/21 10:54	104-51-8	
sec-Butylbenzene	<0.42	ug/L	1.0	0.42	1		11/01/21 10:54	135-98-8	
tert-Butylbenzene	<0.59	ug/L	1.0	0.59	1		11/01/21 10:54	98-06-6	
Carbon tetrachloride	<0.37	ug/L	1.0	0.37	1		11/01/21 10:54	56-23-5	
Chlorobenzene	<0.86	ug/L	1.0	0.86	1		11/01/21 10:54	108-90-7	
Chloroethane	<1.4	ug/L	5.0	1.4	1		11/01/21 10:54	75-00-3	
Chloroform	<1.2	ug/L	5.0	1.2	1		11/01/21 10:54	67-66-3	
Chloromethane	<1.6	ug/L	5.0	1.6	1		11/01/21 10:54	74-87-3	
2-Chlorotoluene	<0.89	ug/L	5.0	0.89	1		11/01/21 10:54	95-49-8	
4-Chlorotoluene	<0.89	ug/L	5.0	0.89	1		11/01/21 10:54	106-43-4	
1,2-Dibromo-3-chloropropane	<2.4	ug/L	5.0	2.4	1		11/01/21 10:54	96-12-8	
Dibromochloromethane	<2.6	ug/L	5.0	2.6	1		11/01/21 10:54	124-48-1	
1,2-Dibromoethane (EDB)	<0.31	ug/L	1.0	0.31	1		11/01/21 10:54	106-93-4	
Dibromomethane	<0.99	ug/L	5.0	0.99	1		11/01/21 10:54	74-95-3	
1,2-Dichlorobenzene	<0.33	ug/L	1.0	0.33	1		11/01/21 10:54	95-50-1	
1,3-Dichlorobenzene	<0.35	ug/L	1.0	0.35	1		11/01/21 10:54	541-73-1	
1,4-Dichlorobenzene	<0.89	ug/L	1.0	0.89	1		11/01/21 10:54	106-46-7	
Dichlorodifluoromethane	<0.46	ug/L	5.0	0.46	1		11/01/21 10:54	75-71-8	
1,1-Dichloroethane	<0.30	ug/L	1.0	0.30	1		11/01/21 10:54	75-34-3	
1,2-Dichloroethane	<0.29	ug/L	1.0	0.29	1		11/01/21 10:54	107-06-2	
1,1-Dichloroethene	<0.58	ug/L	1.0	0.58	1		11/01/21 10:54	75-35-4	
cis-1,2-Dichloroethene	<0.47	ug/L	1.0	0.47	1		11/01/21 10:54	156-59-2	
trans-1,2-Dichloroethene	<0.53	ug/L	1.0	0.53	1		11/01/21 10:54	156-60-5	
1,2-Dichloropropane	<0.45	ug/L	1.0	0.45	1		11/01/21 10:54	78-87-5	
1,3-Dichloropropane	<0.30	ug/L	1.0	0.30	1		11/01/21 10:54	142-28-9	
2,2-Dichloropropane	<4.2	ug/L	5.0	4.2	1		11/01/21 10:54	594-20-7	
1,1-Dichloropropene	<0.41	ug/L	1.0	0.41	1		11/01/21 10:54	563-58-6	
cis-1,3-Dichloropropene	<0.36	ug/L	1.0	0.36	1		11/01/21 10:54	10061-01-5	
trans-1,3-Dichloropropene	<3.5	ug/L	5.0	3.5	1		11/01/21 10:54	10061-02-6	
Diisopropyl ether	<1.1	ug/L	5.0	1.1	1		11/01/21 10:54	108-20-3	
Ethylbenzene	<0.33	ug/L	1.0	0.33	1		11/01/21 10:54	100-41-4	
Hexachloro-1,3-butadiene	<2.7	ug/L	5.0	2.7	1		11/01/21 10:54	87-68-3	
Isopropylbenzene (Cumene)	<1.0	ug/L	5.0	1.0	1		11/01/21 10:54	98-82-8	
p-Isopropyltoluene	<1.0	ug/L	5.0	1.0	1		11/01/21 10:54	99-87-6	
Methylene Chloride	<0.32	ug/L	5.0	0.32	1		11/01/21 10:54	75-09-2	
Methyl-tert-butyl ether	<1.1	ug/L	5.0	1.1	1		11/01/21 10:54	1634-04-4	
Naphthalene	<1.1	ug/L	5.0	1.1	1		11/01/21 10:54	91-20-3	
n-Propylbenzene	<0.35	ug/L	1.0	0.35	1		11/01/21 10:54	103-65-1	
Styrene	<0.36	ug/L	1.0	0.36	1		11/01/21 10:54	100-42-5	

REPORT OF LABORATORY ANALYSIS

This report shall not be reproduced, except in full,
without the written consent of Pace Analytical Services, LLC.

ANALYTICAL RESULTS

Project: 1690005819 FORMER ONE-HOUR VAL
Pace Project No.: 40235956

Sample: TRIP BLANK **Lab ID: 40235956008** Collected: 10/27/21 00:00 Received: 10/28/21 08:15 Matrix: Water

Parameters	Results	Units	LOQ	LOD	DF	Prepared	Analyzed	CAS No.	Qual
8260 MSV									
Analytical Method: EPA 8260									
Pace Analytical Services - Green Bay									
1,1,1,2-Tetrachloroethane	<0.36	ug/L	1.0	0.36	1		11/01/21 10:54	630-20-6	
1,1,2,2-Tetrachloroethane	<0.38	ug/L	1.0	0.38	1		11/01/21 10:54	79-34-5	
Tetrachloroethene	<0.41	ug/L	1.0	0.41	1		11/01/21 10:54	127-18-4	
Toluene	<0.29	ug/L	1.0	0.29	1		11/01/21 10:54	108-88-3	
1,2,3-Trichlorobenzene	<1.0	ug/L	5.0	1.0	1		11/01/21 10:54	87-61-6	
1,2,4-Trichlorobenzene	<0.95	ug/L	5.0	0.95	1		11/01/21 10:54	120-82-1	
1,1,1-Trichloroethane	<0.30	ug/L	1.0	0.30	1		11/01/21 10:54	71-55-6	
1,1,2-Trichloroethane	<0.34	ug/L	5.0	0.34	1		11/01/21 10:54	79-00-5	
Trichloroethene	<0.32	ug/L	1.0	0.32	1		11/01/21 10:54	79-01-6	
Trichlorofluoromethane	<0.42	ug/L	1.0	0.42	1		11/01/21 10:54	75-69-4	
1,2,3-Trichloropropane	<0.56	ug/L	5.0	0.56	1		11/01/21 10:54	96-18-4	
1,2,4-Trimethylbenzene	<0.45	ug/L	1.0	0.45	1		11/01/21 10:54	95-63-6	
1,3,5-Trimethylbenzene	<0.36	ug/L	1.0	0.36	1		11/01/21 10:54	108-67-8	
Vinyl chloride	<0.17	ug/L	1.0	0.17	1		11/01/21 10:54	75-01-4	
Xylene (Total)	<1.0	ug/L	3.0	1.0	1		11/01/21 10:54	1330-20-7	
m&p-Xylene	<0.70	ug/L	2.0	0.70	1		11/01/21 10:54	179601-23-1	
o-Xylene	<0.35	ug/L	1.0	0.35	1		11/01/21 10:54	95-47-6	
Surrogates									
4-Bromofluorobenzene (S)	87	%	70-130		1		11/01/21 10:54	460-00-4	
1,2-Dichlorobenzene-d4 (S)	101	%	70-130		1		11/01/21 10:54	2199-69-1	
Toluene-d8 (S)	101	%	70-130		1		11/01/21 10:54	2037-26-5	

REPORT OF LABORATORY ANALYSIS

This report shall not be reproduced, except in full,
without the written consent of Pace Analytical Services, LLC.

QUALITY CONTROL DATA

Project: 1690005819 FORMER ONE-HOUR VAL
Pace Project No.: 40235956

QC Batch: 400349	Analysis Method: EPA 8015B Modified
QC Batch Method: EPA 8015B Modified	Analysis Description: Methane, Ethane, Ethene GCV
	Laboratory: Pace Analytical Services - Green Bay

Associated Lab Samples: 40235956007

METHOD BLANK: 2311980 Matrix: Water
Associated Lab Samples: 40235956007

Parameter	Units	Blank Result	Reporting Limit	Analyzed	Qualifiers
Ethane	ug/L	<0.39	5.6	11/02/21 10:35	
Ethene	ug/L	<0.25	5.0	11/02/21 10:35	
Methane	ug/L	<0.58	2.8	11/02/21 10:35	

LABORATORY CONTROL SAMPLE & LCSD: 2311981

Parameter	Units	2311982							RPD	Max RPD	Qualifiers
		Spike Conc.	LCS Result	LCSD Result	LCS % Rec	LCSD % Rec	% Rec Limits				
Ethane	ug/L	53.6	56.4	57.7	105	108	80-120	2	20		
Ethene	ug/L	50	53.5	54.4	107	109	80-120	2	20		
Methane	ug/L	28.6	33.0	34.0	115	119	80-121	3	20		

MATRIX SPIKE & MATRIX SPIKE DUPLICATE: 2311983 2311984

Parameter	Units	2311983										
		40235597009 Result	MS Spike Conc.	MSD Spike Conc.	MS Result	MSD Result	MS % Rec	MSD % Rec	% Rec Limits	RPD	Max RPD	Qual
Ethane	ug/L	<3.9	536	536	502	546	94	102	80-122	9	20	
Ethene	ug/L	<2.5	500	500	472	513	94	103	80-122	8	20	
Methane	ug/L	1800	286	286	2990	2820	416	357	10-200	6	20	E,M1

Results presented on this page are in the units indicated by the "Units" column except where an alternate unit is presented to the right of the result.

REPORT OF LABORATORY ANALYSIS

This report shall not be reproduced, except in full,
without the written consent of Pace Analytical Services, LLC.

QUALITY CONTROL DATA

Project: 1690005819 FORMER ONE-HOUR VAL
Pace Project No.: 40235956

QC Batch: 1776517	Analysis Method: EPA 6020
QC Batch Method: 3015	Analysis Description: Metals (ICPMS) 6020
	Laboratory: Pace National - Mt. Juliet

Associated Lab Samples: 40235956007

METHOD BLANK: R3731692-1 Matrix: Water
Associated Lab Samples: 40235956007

Parameter	Units	Blank Result	Reporting Limit	Analyzed	Qualifiers
Iron	ug/L	<28.1	93.7	11/19/21 12:33	

LABORATORY CONTROL SAMPLE: R3731692-2

Parameter	Units	Spike Conc.	LCS Result	LCS % Rec	% Rec Limits	Qualifiers
Iron	ug/L	5000	4790	95.8	80.0-120	

MATRIX SPIKE & MATRIX SPIKE DUPLICATE: R3731692-4 R3731692-5

Parameter	Units	R3731692-4		R3731692-5		MS % Rec	MSD % Rec	% Rec Limits	RPD	Max RPD	Qual
		L1424185-11 Result	MS Spike Conc.	MSD Spike Conc.	MS Result						
Iron	ug/L	ND	5000	5000	4730	4690	94.5	93.7	75.0-125	0.852	20

Results presented on this page are in the units indicated by the "Units" column except where an alternate unit is presented to the right of the result.

REPORT OF LABORATORY ANALYSIS

This report shall not be reproduced, except in full,
without the written consent of Pace Analytical Services, LLC.

QUALITY CONTROL DATA

Project: 1690005819 FORMER ONE-HOUR VAL
Pace Project No.: 40235956

QC Batch:	400082	Analysis Method:	EPA 8260
QC Batch Method:	EPA 8260	Analysis Description:	8260 MSV
		Laboratory:	Pace Analytical Services - Green Bay

Associated Lab Samples: 40235956001, 40235956002, 40235956003, 40235956004, 40235956005, 40235956006, 40235956007, 40235956008

METHOD BLANK: 2310219 Matrix: Water
Associated Lab Samples: 40235956001, 40235956002, 40235956003, 40235956004, 40235956005, 40235956006, 40235956007, 40235956008

Parameter	Units	Blank Result	Reporting Limit	Analyzed	Qualifiers
1,1,1,2-Tetrachloroethane	ug/L	<0.36	1.0	11/01/21 09:18	
1,1,1-Trichloroethane	ug/L	<0.30	1.0	11/01/21 09:18	
1,1,2,2-Tetrachloroethane	ug/L	<0.38	1.0	11/01/21 09:18	
1,1,2-Trichloroethane	ug/L	<0.34	5.0	11/01/21 09:18	
1,1-Dichloroethane	ug/L	<0.30	1.0	11/01/21 09:18	
1,1-Dichloroethene	ug/L	<0.58	1.0	11/01/21 09:18	
1,1-Dichloropropene	ug/L	<0.41	1.0	11/01/21 09:18	
1,2,3-Trichlorobenzene	ug/L	<1.0	5.0	11/01/21 09:18	
1,2,3-Trichloropropane	ug/L	<0.56	5.0	11/01/21 09:18	
1,2,4-Trichlorobenzene	ug/L	<0.95	5.0	11/01/21 09:18	
1,2,4-Trimethylbenzene	ug/L	<0.45	1.0	11/01/21 09:18	
1,2-Dibromo-3-chloropropane	ug/L	<2.4	5.0	11/01/21 09:18	
1,2-Dibromoethane (EDB)	ug/L	<0.31	1.0	11/01/21 09:18	
1,2-Dichlorobenzene	ug/L	<0.33	1.0	11/01/21 09:18	
1,2-Dichloroethane	ug/L	<0.29	1.0	11/01/21 09:18	
1,2-Dichloropropane	ug/L	<0.45	1.0	11/01/21 09:18	
1,3,5-Trimethylbenzene	ug/L	<0.36	1.0	11/01/21 09:18	
1,3-Dichlorobenzene	ug/L	<0.35	1.0	11/01/21 09:18	
1,3-Dichloropropane	ug/L	<0.30	1.0	11/01/21 09:18	
1,4-Dichlorobenzene	ug/L	<0.89	1.0	11/01/21 09:18	
2,2-Dichloropropane	ug/L	<4.2	5.0	11/01/21 09:18	
2-Chlorotoluene	ug/L	<0.89	5.0	11/01/21 09:18	
4-Chlorotoluene	ug/L	<0.89	5.0	11/01/21 09:18	
Benzene	ug/L	<0.30	1.0	11/01/21 09:18	
Bromobenzene	ug/L	<0.36	1.0	11/01/21 09:18	
Bromochloromethane	ug/L	<0.36	5.0	11/01/21 09:18	
Bromodichloromethane	ug/L	<0.42	1.0	11/01/21 09:18	
Bromoform	ug/L	<3.8	5.0	11/01/21 09:18	
Bromomethane	ug/L	<1.2	5.0	11/01/21 09:18	
Carbon tetrachloride	ug/L	<0.37	1.0	11/01/21 09:18	
Chlorobenzene	ug/L	<0.86	1.0	11/01/21 09:18	
Chloroethane	ug/L	<1.4	5.0	11/01/21 09:18	
Chloroform	ug/L	<1.2	5.0	11/01/21 09:18	
Chloromethane	ug/L	<1.6	5.0	11/01/21 09:18	
cis-1,2-Dichloroethene	ug/L	<0.47	1.0	11/01/21 09:18	
cis-1,3-Dichloropropene	ug/L	<0.36	1.0	11/01/21 09:18	
Dibromochloromethane	ug/L	<2.6	5.0	11/01/21 09:18	
Dibromomethane	ug/L	<0.99	5.0	11/01/21 09:18	
Dichlorodifluoromethane	ug/L	<0.46	5.0	11/01/21 09:18	

Results presented on this page are in the units indicated by the "Units" column except where an alternate unit is presented to the right of the result.

REPORT OF LABORATORY ANALYSIS

This report shall not be reproduced, except in full,
without the written consent of Pace Analytical Services, LLC.

QUALITY CONTROL DATA

Project: 1690005819 FORMER ONE-HOUR VAL

Pace Project No.: 40235956

METHOD BLANK: 2310219

Matrix: Water

Associated Lab Samples: 40235956001, 40235956002, 40235956003, 40235956004, 40235956005, 40235956006, 40235956007, 40235956008

Parameter	Units	Blank Result	Reporting Limit	Analyzed	Qualifiers
Diisopropyl ether	ug/L	<1.1	5.0	11/01/21 09:18	
Ethylbenzene	ug/L	<0.33	1.0	11/01/21 09:18	
Hexachloro-1,3-butadiene	ug/L	<2.7	5.0	11/01/21 09:18	
Isopropylbenzene (Cumene)	ug/L	<1.0	5.0	11/01/21 09:18	
m&p-Xylene	ug/L	<0.70	2.0	11/01/21 09:18	
Methyl-tert-butyl ether	ug/L	<1.1	5.0	11/01/21 09:18	
Methylene Chloride	ug/L	<0.32	5.0	11/01/21 09:18	
n-Butylbenzene	ug/L	<0.86	1.0	11/01/21 09:18	
n-Propylbenzene	ug/L	<0.35	1.0	11/01/21 09:18	
Naphthalene	ug/L	<1.1	5.0	11/01/21 09:18	
o-Xylene	ug/L	<0.35	1.0	11/01/21 09:18	
p-Isopropyltoluene	ug/L	<1.0	5.0	11/01/21 09:18	
sec-Butylbenzene	ug/L	<0.42	1.0	11/01/21 09:18	
Styrene	ug/L	<0.36	1.0	11/01/21 09:18	
tert-Butylbenzene	ug/L	<0.59	1.0	11/01/21 09:18	
Tetrachloroethene	ug/L	<0.41	1.0	11/01/21 09:18	
Toluene	ug/L	<0.29	1.0	11/01/21 09:18	
trans-1,2-Dichloroethene	ug/L	<0.53	1.0	11/01/21 09:18	
trans-1,3-Dichloropropene	ug/L	<3.5	5.0	11/01/21 09:18	
Trichloroethene	ug/L	<0.32	1.0	11/01/21 09:18	
Trichlorofluoromethane	ug/L	<0.42	1.0	11/01/21 09:18	
Vinyl chloride	ug/L	<0.17	1.0	11/01/21 09:18	
Xylene (Total)	ug/L	<1.0	3.0	11/01/21 09:18	
1,2-Dichlorobenzene-d4 (S)	%	100	70-130	11/01/21 09:18	
4-Bromofluorobenzene (S)	%	87	70-130	11/01/21 09:18	
Toluene-d8 (S)	%	102	70-130	11/01/21 09:18	

LABORATORY CONTROL SAMPLE: 2310220

Parameter	Units	Spike Conc.	LCS Result	LCS % Rec	% Rec Limits	Qualifiers
1,1,1-Trichloroethane	ug/L	50	58.2	116	70-130	
1,1,2,2-Tetrachloroethane	ug/L	50	51.1	102	66-130	
1,1,2-Trichloroethane	ug/L	50	56.6	113	70-130	
1,1-Dichloroethane	ug/L	50	52.4	105	68-132	
1,1-Dichloroethene	ug/L	50	54.7	109	85-126	
1,2,4-Trichlorobenzene	ug/L	50	53.8	108	70-130	
1,2-Dibromo-3-chloropropane	ug/L	50	43.8	88	51-126	
1,2-Dibromoethane (EDB)	ug/L	50	56.6	113	70-130	
1,2-Dichlorobenzene	ug/L	50	57.4	115	70-130	
1,2-Dichloroethane	ug/L	50	46.4	93	70-130	
1,2-Dichloropropane	ug/L	50	51.3	103	78-125	
1,3-Dichlorobenzene	ug/L	50	57.0	114	70-130	
1,4-Dichlorobenzene	ug/L	50	58.5	117	70-130	

Results presented on this page are in the units indicated by the "Units" column except where an alternate unit is presented to the right of the result.

REPORT OF LABORATORY ANALYSIS

This report shall not be reproduced, except in full,
without the written consent of Pace Analytical Services, LLC.

QUALITY CONTROL DATA

Project: 1690005819 FORMER ONE-HOUR VAL
Pace Project No.: 40235956

LABORATORY CONTROL SAMPLE: 2310220

Parameter	Units	Spike Conc.	LCS Result	LCS % Rec	% Rec Limits	Qualifiers
Benzene	ug/L	50	55.3	111	70-132	
Bromodichloromethane	ug/L	50	54.8	110	70-130	
Bromoform	ug/L	50	51.9	104	65-130	
Bromomethane	ug/L	50	35.0	70	44-128	
Carbon tetrachloride	ug/L	50	55.9	112	70-130	
Chlorobenzene	ug/L	50	59.2	118	70-130	
Chloroethane	ug/L	50	53.0	106	73-137	
Chloroform	ug/L	50	56.6	113	80-122	
Chloromethane	ug/L	50	31.6	63	27-148	
cis-1,2-Dichloroethene	ug/L	50	55.1	110	70-130	
cis-1,3-Dichloropropene	ug/L	50	49.2	98	70-130	
Dibromochloromethane	ug/L	50	56.2	112	70-130	
Dichlorodifluoromethane	ug/L	50	28.9	58	22-151	
Ethylbenzene	ug/L	50	59.4	119	80-123	
Isopropylbenzene (Cumene)	ug/L	50	63.4	127	70-130	
m&p-Xylene	ug/L	100	119	119	70-130	
Methyl-tert-butyl ether	ug/L	50	48.6	97	66-130	
Methylene Chloride	ug/L	50	53.7	107	70-130	
o-Xylene	ug/L	50	60.6	121	70-130	
Styrene	ug/L	50	62.1	124	70-130	
Tetrachloroethene	ug/L	50	63.5	127	70-130	
Toluene	ug/L	50	57.5	115	80-121	
trans-1,2-Dichloroethene	ug/L	50	55.6	111	70-130	
trans-1,3-Dichloropropene	ug/L	50	49.8	100	58-125	
Trichloroethene	ug/L	50	55.8	112	70-130	
Trichlorofluoromethane	ug/L	50	49.5	99	84-148	
Vinyl chloride	ug/L	50	43.7	87	63-142	
Xylene (Total)	ug/L	150	180	120	70-130	
1,2-Dichlorobenzene-d4 (S)	%			98	70-130	
4-Bromofluorobenzene (S)	%			89	70-130	
Toluene-d8 (S)	%			102	70-130	

MATRIX SPIKE & MATRIX SPIKE DUPLICATE: 2311560 2311561

Parameter	Units	MS		MSD		MS Result	MSD Result	MS % Rec	MSD % Rec	% Rec Limits	RPD	Max RPD	Qual
		40235988002 Result	Spike Conc.	Spike Conc.	Conc.								
1,1,1-Trichloroethane	ug/L	<0.30	50	50	57.1	57.7	114	115	70-130	1	20		
1,1,2,2-Tetrachloroethane	ug/L	<0.38	50	50	50.9	52.7	102	105	66-130	3	20		
1,1,2-Trichloroethane	ug/L	<0.34	50	50	56.2	58.7	112	117	70-130	4	20		
1,1-Dichloroethane	ug/L	<0.30	50	50	51.4	53.3	103	107	68-132	4	20		
1,1-Dichloroethene	ug/L	<0.58	50	50	54.9	54.7	110	109	76-132	0	20		
1,2,4-Trichlorobenzene	ug/L	<0.95	50	50	56.3	57.8	113	116	70-130	2	20		
1,2-Dibromo-3-chloropropane	ug/L	<2.4	50	50	43.8	45.3	88	91	51-126	3	20		
1,2-Dibromoethane (EDB)	ug/L	<0.31	50	50	56.8	58.2	114	116	70-130	2	20		

Results presented on this page are in the units indicated by the "Units" column except where an alternate unit is presented to the right of the result.

REPORT OF LABORATORY ANALYSIS

This report shall not be reproduced, except in full,
without the written consent of Pace Analytical Services, LLC.

QUALITY CONTROL DATA

Project: 1690005819 FORMER ONE-HOUR VAL
Pace Project No.: 40235956

Parameter	Units	2311560		2311561		MS Result	MSD Result	MS % Rec	MSD % Rec	% Rec Limits	Max RPD	Qual
		40235988002 Result	MS Spike Conc.	MSD Spike Conc.	MS Result							
1,2-Dichlorobenzene	ug/L	<0.33	50	50	56.2	58.7	112	117	70-130	4	20	
1,2-Dichloroethane	ug/L	<0.29	50	50	51.1	48.4	102	97	70-130	6	20	
1,2-Dichloropropane	ug/L	<0.45	50	50	49.9	53.2	100	106	77-125	6	20	
1,3-Dichlorobenzene	ug/L	<0.35	50	50	53.6	58.6	107	117	70-130	9	20	
1,4-Dichlorobenzene	ug/L	<0.89	50	50	56.9	58.6	114	117	70-130	3	20	
Benzene	ug/L	<0.30	50	50	55.0	56.6	110	113	70-132	3	20	
Bromodichloromethane	ug/L	<0.42	50	50	55.1	57.5	110	115	70-130	4	20	
Bromoform	ug/L	<3.8	50	50	52.5	53.3	105	107	65-130	2	20	
Bromomethane	ug/L	<1.2	50	50	43.4	48.7	87	97	44-128	12	21	
Carbon tetrachloride	ug/L	<0.37	50	50	58.5	58.4	117	117	70-132	0	20	
Chlorobenzene	ug/L	<0.86	50	50	59.6	60.2	119	120	70-130	1	20	
Chloroethane	ug/L	<1.4	50	50	52.3	52.7	105	105	70-137	1	20	
Chloroform	ug/L	<1.2	50	50	56.2	58.3	112	117	80-122	4	20	
Chloromethane	ug/L	<1.6	50	50	31.0	31.6	62	63	17-149	2	20	
cis-1,2-Dichloroethene	ug/L	<0.47	50	50	54.9	57.2	110	114	70-130	4	20	
cis-1,3-Dichloropropene	ug/L	<0.36	50	50	50.1	52.3	100	105	70-130	4	20	
Dibromochloromethane	ug/L	<2.6	50	50	56.6	59.0	113	118	70-130	4	20	
Dichlorodifluoromethane	ug/L	<0.46	50	50	28.2	28.2	56	56	22-158	0	20	
Ethylbenzene	ug/L	<0.33	50	50	58.4	59.1	117	118	80-123	1	20	
Isopropylbenzene (Cumene)	ug/L	<1.0	50	50	63.0	63.2	126	126	70-130	0	20	
m&p-Xylene	ug/L	<0.70	100	100	120	121	120	121	70-130	1	20	
Methyl-tert-butyl ether	ug/L	<1.1	50	50	49.9	52.2	100	104	66-130	5	20	
Methylene Chloride	ug/L	<0.32	50	50	52.7	55.6	105	111	70-130	5	20	
o-Xylene	ug/L	<0.35	50	50	60.0	61.4	120	123	70-130	2	20	
Styrene	ug/L	<0.36	50	50	61.2	63.5	122	127	70-130	4	20	
Tetrachloroethene	ug/L	<0.41	50	50	62.5	63.0	125	126	70-130	1	20	
Toluene	ug/L	<0.29	50	50	58.1	58.1	116	116	80-121	0	20	
trans-1,2-Dichloroethene	ug/L	<0.53	50	50	54.4	56.8	109	114	70-134	4	20	
trans-1,3-Dichloropropene	ug/L	<3.5	50	50	49.1	50.8	98	102	58-130	3	20	
Trichloroethene	ug/L	<0.32	50	50	55.6	56.9	111	114	70-130	2	20	
Trichlorofluoromethane	ug/L	<0.42	50	50	48.3	48.9	97	98	82-151	1	20	
Vinyl chloride	ug/L	<0.17	50	50	43.0	42.6	86	85	61-143	1	20	
Xylene (Total)	ug/L	<1.0	150	150	180	182	120	121	70-130	1	20	
1,2-Dichlorobenzene-d4 (S)	%						97	98	70-130			
4-Bromofluorobenzene (S)	%						89	88	70-130			
Toluene-d8 (S)	%						102	100	70-130			

Results presented on this page are in the units indicated by the "Units" column except where an alternate unit is presented to the right of the result.

REPORT OF LABORATORY ANALYSIS

This report shall not be reproduced, except in full,
without the written consent of Pace Analytical Services, LLC.

QUALITY CONTROL DATA

Project: 1690005819 FORMER ONE-HOUR VAL
Pace Project No.: 40235956

QC Batch: 1768678	Analysis Method: SM 3500-Fe B
QC Batch Method: 3500Fe B-2011	Analysis Description: Wet Chemistry 3500Fe B-2011
	Laboratory: Pace National - Mt. Juliet

Associated Lab Samples: 40235956007

METHOD BLANK: R3725426-1 Matrix: Water
Associated Lab Samples: 40235956007

Parameter	Units	Blank Result	Reporting Limit	Analyzed	Qualifiers
Iron, Ferrous	ug/L	<15.0	50.0	11/04/21 10:31	

LABORATORY CONTROL SAMPLE: R3725426-2

Parameter	Units	Spike Conc.	LCS Result	LCS % Rec	% Rec Limits	Qualifiers
Iron, Ferrous	ug/L	1000	932	93.2	85.0-115	

MATRIX SPIKE & MATRIX SPIKE DUPLICATE: R3725426-4 R3725426-5

Parameter	Units	R3725426-4		R3725426-5		MS % Rec	MSD % Rec	% Rec Limits	RPD	Max RPD	Qual
		L1425923-07 Result	MS Spike Conc.	MSD Spike Conc.	MS Result						
Iron, Ferrous	ug/L	53.0	1000	1000	945	954	89.2	90.1	80.0-120	0.948	20

SAMPLE DUPLICATE: R3725426-3

Parameter	Units	L1425923-06 Result	Dup Result	RPD	Max RPD	Qualifiers
Iron, Ferrous	ug/L	20.0	19.0J	5.13	20 J	

SAMPLE DUPLICATE: R3725426-6

Parameter	Units	L1425996-07 Result	Dup Result	RPD	Max RPD	Qualifiers
Iron, Ferrous	ug/L	ND	<15.0	0.00	20	

Results presented on this page are in the units indicated by the "Units" column except where an alternate unit is presented to the right of the result.

REPORT OF LABORATORY ANALYSIS

This report shall not be reproduced, except in full,
without the written consent of Pace Analytical Services, LLC.

QUALITY CONTROL DATA

Project: 1690005819 FORMER ONE-HOUR VAL
Pace Project No.: 40235956

QC Batch: 400476 Analysis Method: EPA 300.0
QC Batch Method: EPA 300.0 Analysis Description: 300.0 IC Anions
Laboratory: Pace Analytical Services - Green Bay
Associated Lab Samples: 40235956007

METHOD BLANK: 2312757 Matrix: Water
Associated Lab Samples: 40235956007

Parameter	Units	Blank Result	Reporting Limit	Analyzed	Qualifiers
Sulfate	mg/L	<0.44	2.0	11/03/21 18:05	

LABORATORY CONTROL SAMPLE: 2312758

Parameter	Units	Spike Conc.	LCS Result	LCS % Rec	% Rec Limits	Qualifiers
Sulfate	mg/L	20	20.3	102	90-110	

MATRIX SPIKE & MATRIX SPIKE DUPLICATE: 2312759 2312760

Parameter	Units	40235597010		2312759		2312760		% Rec Limits	RPD	Max RPD	Qual	
		MS Result	MSD Result	MS Spike Conc.	MSD Spike Conc.	MS Result	MSD Result					MS % Rec
Sulfate	mg/L	19.4	100	100	100	120	116	101	97	90-110	3	15

MATRIX SPIKE & MATRIX SPIKE DUPLICATE: 2312761 2312762

Parameter	Units	40235667006		2312761		2312762		% Rec Limits	RPD	Max RPD	Qual	
		MS Result	MSD Result	MS Spike Conc.	MSD Spike Conc.	MS Result	MSD Result					MS % Rec
Sulfate	mg/L	63.9	100	100	100	164	173	101	109	90-110	5	15

Results presented on this page are in the units indicated by the "Units" column except where an alternate unit is presented to the right of the result.

REPORT OF LABORATORY ANALYSIS

This report shall not be reproduced, except in full,
without the written consent of Pace Analytical Services, LLC.

QUALITY CONTROL DATA

Project: 1690005819 FORMER ONE-HOUR VAL
Pace Project No.: 40235956

QC Batch: 400132 Analysis Method: SM 5310C
QC Batch Method: SM 5310C Analysis Description: 5310C Total Organic Carbon
Laboratory: Pace Analytical Services - Green Bay
Associated Lab Samples: 40235956007

METHOD BLANK: 2311281 Matrix: Water
Associated Lab Samples: 40235956007

Parameter	Units	Blank Result	Reporting Limit	Analyzed	Qualifiers
Total Organic Carbon	mg/L	<0.14	0.50	11/02/21 07:04	

LABORATORY CONTROL SAMPLE: 2311282

Parameter	Units	Spike Conc.	LCS Result	LCS % Rec	% Rec Limits	Qualifiers
Total Organic Carbon	mg/L	12.5	13.7	110	80-120	

MATRIX SPIKE & MATRIX SPIKE DUPLICATE: 2311283 2311284

Parameter	Units	40235746008		2311283		2311284		% Rec Limits	RPD	Max RPD	Qual
		MS Result	MS Spike Conc.	MS Result	MS Spike Conc.	MS Result	MS Spike Conc.				
Total Organic Carbon	mg/L	8.7	60	60	71.5	71.1	105	104	80-120	1	10

MATRIX SPIKE & MATRIX SPIKE DUPLICATE: 2311285 2311286

Parameter	Units	40235749001		2311285		2311286		% Rec Limits	RPD	Max RPD	Qual
		MS Result	MS Spike Conc.	MS Result	MS Spike Conc.	MS Result	MS Spike Conc.				
Total Organic Carbon	mg/L	4.2	6	6	10.7	10.8	108	110	80-120	2	10

Results presented on this page are in the units indicated by the "Units" column except where an alternate unit is presented to the right of the result.

REPORT OF LABORATORY ANALYSIS

This report shall not be reproduced, except in full,
without the written consent of Pace Analytical Services, LLC.

QUALIFIERS

Project: 1690005819 FORMER ONE-HOUR VAL

Pace Project No.: 40235956

DEFINITIONS

DF - Dilution Factor, if reported, represents the factor applied to the reported data due to dilution of the sample aliquot.

ND - Not Detected at or above LOD.

J - Estimated concentration at or above the LOD and below the LOQ.

LOD - Limit of Detection adjusted for dilution factor, percent moisture, initial weight and final volume.

LOQ - Limit of Quantitation adjusted for dilution factor, percent moisture, initial weight and final volume.

S - Surrogate

1,2-Diphenylhydrazine decomposes to and cannot be separated from Azobenzene using Method 8270. The result for each analyte is a combined concentration.

Consistent with EPA guidelines, unrounded data are displayed and have been used to calculate % recovery and RPD values.

LCS(D) - Laboratory Control Sample (Duplicate)

MS(D) - Matrix Spike (Duplicate)

DUP - Sample Duplicate

RPD - Relative Percent Difference

NC - Not Calculable.

SG - Silica Gel - Clean-Up

U - Indicates the compound was analyzed for, but not detected at or above the adjusted LOD.

N-Nitrosodiphenylamine decomposes and cannot be separated from Diphenylamine using Method 8270. The result reported for each analyte is a combined concentration.

Pace Analytical is TNI accredited. Contact your Pace PM for the current list of accredited analytes.

TNI - The NELAC Institute.

ANALYTE QUALIFIERS

D3 Sample was diluted due to the presence of high levels of non-target analytes or other matrix interference.

E Analyte concentration exceeded the calibration range. The reported result is estimated.

H3 Sample was received or analysis requested beyond the recognized method holding time.

J Analyte detected below the reporting limit, therefore result is an estimate. This qualifier is also used for all TICs.

M1 Matrix spike recovery exceeded QC limits. Batch accepted based on laboratory control sample (LCS) recovery.

REPORT OF LABORATORY ANALYSIS

This report shall not be reproduced, except in full,
without the written consent of Pace Analytical Services, LLC.

QUALITY CONTROL DATA CROSS REFERENCE TABLE

Project: 1690005819 FORMER ONE-HOUR VAL
Pace Project No.: 40235956

Lab ID	Sample ID	QC Batch Method	QC Batch	Analytical Method	Analytical Batch
40235956007	PZ-1R	EPA 8015B Modified	400349		
40235956007	PZ-1R	3015	1776517	EPA 6020	1776517
40235956001	PZ-2R	EPA 8260	400082		
40235956002	MW-6	EPA 8260	400082		
40235956003	MW-6DUP	EPA 8260	400082		
40235956004	PZ-4	EPA 8260	400082		
40235956005	MW-5	EPA 8260	400082		
40235956006	MW-4	EPA 8260	400082		
40235956007	PZ-1R	EPA 8260	400082		
40235956008	TRIP BLANK	EPA 8260	400082		
40235956007	PZ-1R	3500Fe B-2011	1768678	SM 3500-Fe B	1768678
40235956007	PZ-1R	Calc.	1776517	Calculated	1776517
40235956007	PZ-1R	EPA 300.0	400476		
40235956007	PZ-1R	SM 5310C	400132		

REPORT OF LABORATORY ANALYSIS

This report shall not be reproduced, except in full,
without the written consent of Pace Analytical Services, LLC.

(Please Print Clearly)

Company Name: **RAMBOLL**
 Branch/Location: **MILWAUKEE, WI**
 Project Contact: **SUSAN PETROFSKE**
 Phone: **262 901 3501**
 Project Number: **1690005819**
 Project Name: **FORMER ONE-HOUR VALET**
 Project State: **WISCONSIN**
 Sampled By (Print): **DUNCAN GLASFORD**
 Sampled By (Sign): *D Glasford*
 PO #: _____ Regulatory Program: _____



UPPER MIDWEST REGION

MN: 612-607-1700 WI: 920-469-2438

40235956

CHAIN OF CUSTODY

***Preservation Codes**
 A=None B=HCL C=H2SO4 D=HNO3 E=DI Water F=Methanol G=NaOH
 H=Sodium Bisulfate Solution I=Sodium Thiosulfate J=Other

FILTERED?
(YES/NO)
 PRESERVATION
(CODE)*

Y/N	Pick Letter	Analyses Requested
N	B	VOC 8260
N	B	MSE
N	B	ferrous Fe 3500
N	C	TDC 5310
N	A	SULFATE

Quote #: _____
 Mail To Contact: _____
 Mail To Company: _____
 Mail To Address: _____
 Invoice To Contact: **SUSAN PETROFSKE**
 Invoice To Company: **RAMBOLL**
 Invoice To Address: **234 W. FLORIDA ST
MILWAUKEE, WI 53204**
 Invoice To Phone: _____
 CLIENT COMMENTS: _____
 LAB COMMENTS (Lab Use Only): _____
 Profile #: _____

Data Package Options (billable)
 EPA Level III
 EPA Level IV

MS/MSD
 On your sample (billable)
 NOT needed on your sample

Matrix Codes
 A = Air W = Water
 B = Biota DW = Drinking Water
 C = Charcoal GW = Ground Water
 O = Oil SW = Surface Water
 S = Soil WW = Waste Water
 Sl = Sludge WP = Wipe

PACE LAB #	CLIENT FIELD ID	COLLECTION		MATRIX	Y/N	Pick Letter	Analyses Requested
		DATE	TIME				
001	PZ-2R	10-27-21	915	GW	X		
002	MW-6		950		X		
003	MW-6 DUP		950		X		
004	PZ-4		1030		X		
005	MW-5		1105		X		
006	MW-4		1145		X		
007	PZ-1R		1245		X	X	X X X
008	TRIP BLANK	-	-	-	X		

Rush Turnaround Time Requested - Prelims (Rush TAT subject to approval/surcharge)
 Date Needed: _____
 Transmit Prelim Rush Results by (complete what you want): _____

Relinquished By: <i>D Glasford</i>	Date/Time: 10-27-21 1400	Received By: CS LOGISTICS	Date/Time: 10-27-21 1400
Relinquished By: CS LOGISTICS	Date/Time: 10/27/21 0915	Received By: Allan	Date/Time: 10/27/21 0915
Relinquished By: _____	Date/Time: _____	Received By: _____	Date/Time: _____
Relinquished By: _____	Date/Time: _____	Received By: _____	Date/Time: _____
Relinquished By: _____	Date/Time: _____	Received By: _____	Date/Time: _____

PACE Project No. **40235956**
 Receipt Temp = **1** °C
 Sample Receipt pH **OK / Adjusted**
 Cooler Custody Seal Present / (Not Present) **Intact / Not Intact**

Sample Preservation Receipt Form

Pace Analytical Services, LLC
1241 Bellevue Street, Suite 9
Green Bay, WI 54302

Client Name: Ramboull

Project # 40235956

All containers needing preservation have been checked and noted below: Yes No N/A

Lab Lot# of pH paper: 1000104 Lab Std #ID of preservation (if pH adjusted):

Initial when completed: CRB Date/Time:

Pace Lab #	Glass							Plastic					Vials				Jars				General			VOA Vials (>6mm) *	H2SO4 pH ≤2	NaOH+Zn Act pH ≥9	NaOH pH ≥12	HNO3 pH ≤2	pH after adjusted	Volume (mL)					
	AG1U	BG1U	AG1H	AG4S	AG4U	AG5U	AG2S	BG3U	BP1U	BP3U	BP3B	BP3N	BP3S	VG9A	DG9T	VG9U	VG9H	VG9M	VG9D	JGFU	JG9U	WGFU	WPFU								SP5T	ZPLC	GN		
001																																			2.5 / 5 / 10
002																																			2.5 / 5 / 10
003																																			2.5 / 5 / 10
004																																			2.5 / 5 / 10
005																																			2.5 / 5 / 10
006																																			2.5 / 5 / 10
007																																			2.5 / 5 / 10
008																																			2.5 / 5 / 10
009																																			2.5 / 5 / 10
010																																			2.5 / 5 / 10
011																																			2.5 / 5 / 10
012																																			2.5 / 5 / 10
013																																			2.5 / 5 / 10
014																																			2.5 / 5 / 10
015																																			2.5 / 5 / 10
016																																			2.5 / 5 / 10
017																																			2.5 / 5 / 10
018																																			2.5 / 5 / 10
019																																			2.5 / 5 / 10
020																																			2.5 / 5 / 10

Exceptions to preservation check: VOA, Coliform, TOC, TOX, TOH, O&G, WI DRO, Phenolics, Other: _____ Headspace in VOA Vials (>6mm) : Yes No N/A *If yes look in headspace column

AG1U 1 liter amber glass	BP1U 1 liter plastic unpres	VG9A 40 mL clear ascorbic	JGFU 4 oz amber jar unpres
BG1U 1 liter clear glass	BP3U 250 mL plastic unpres	DG9T 40 mL amber Na Thio	JG9U 9 oz amber jar unpres
AG1H 1 liter amber glass HCL	BP3B 250 mL plastic NaOH	VG9U 40 mL clear vial unpres	WGFU 4 oz clear jar unpres
AG4S 125 mL amber glass H2SO4	BP3N 250 mL plastic HNO3	VG9H 40 mL clear vial HCL	WPFU 4 oz plastic jar unpres
AG4U 120 mL amber glass unpres	BP3S 250 mL plastic H2SO4	VG9M 40 mL clear vial MeOH	SP5T 120 mL plastic Na Thiosulfate
AG5U 100 mL amber glass unpres		VG9D 40 mL clear vial DI	ZPLC ziploc bag
AG2S 500 mL amber glass H2SO4			GN 250ml bag #284
BG3U 250 mL clear glass unpres			

 1241 Bellevue Street, Green Bay, WI 54302	Document Name: Sample Condition Upon Receipt (SCUR)	Document Revised: 26Mar2020
	Document No.: ENV-FRM-GBAY-0014-Rev.00	Author: Pace Green Bay Quality Office

Sample Condition Upon Receipt Form (SCUR)

Project #: _____

Client Name: Ramboll

WO# : 40235956

Courier: CS Logistics Fed Ex Speedee UPS Waltco
 Client Pace Other: _____



40235956

Tracking #: _____

Custody Seal on Cooler/Box Present: yes no Seals intact: yes no

Custody Seal on Samples Present: yes no Seals intact: yes no

Packing Material: Bubble Wrap Bubble Bags None Other

Thermometer Used SR - 110 Type of Ice: Wet Blue Dry None Samples on ice, cooling process has begun

Cooler Temperature Uncorr: 1 /Corr: 1

Temp Blank Present: yes no Biological Tissue is Frozen: yes no

Person examining contents:	
Date: <u>10/28/21</u>	Initials: <u>[Signature]</u>
Labeled By Initials: <u>[Signature]</u>	

Temp should be above freezing to 6°C.
 Biota Samples may be received at ≤ 0°C if shipped on Dry Ice.

Chain of Custody Present: <input checked="" type="checkbox"/> Yes <input type="checkbox"/> No <input type="checkbox"/> N/A	1.
Chain of Custody Filled Out: <input type="checkbox"/> Yes <input checked="" type="checkbox"/> No <input type="checkbox"/> N/A	2. <u>mail</u>
Chain of Custody Relinquished: <input checked="" type="checkbox"/> Yes <input type="checkbox"/> No <input type="checkbox"/> N/A	3.
Sampler Name & Signature on COC: <input checked="" type="checkbox"/> Yes <input type="checkbox"/> No <input type="checkbox"/> N/A	4.
Samples Arrived within Hold Time: <input checked="" type="checkbox"/> Yes <input type="checkbox"/> No	5.
- VOA Samples frozen upon receipt <input type="checkbox"/> Yes <input type="checkbox"/> No	Date/Time:
Short Hold Time Analysis (<72hr): <input type="checkbox"/> Yes <input checked="" type="checkbox"/> No	6.
Rush Turn Around Time Requested: <input type="checkbox"/> Yes <input checked="" type="checkbox"/> No	7.
Sufficient Volume:	8.
For Analysis: <input checked="" type="checkbox"/> Yes <input type="checkbox"/> No MS/MSD: <input type="checkbox"/> Yes <input checked="" type="checkbox"/> No <input type="checkbox"/> N/A	
Correct Containers Used: <input checked="" type="checkbox"/> Yes <input type="checkbox"/> No	9.
-Pace Containers Used: <input checked="" type="checkbox"/> Yes <input type="checkbox"/> No <input type="checkbox"/> N/A	
-Pace IR Containers Used: <input type="checkbox"/> Yes <input type="checkbox"/> No <input checked="" type="checkbox"/> N/A	
Containers Intact: <input checked="" type="checkbox"/> Yes <input type="checkbox"/> No	10.
Filtered volume received for Dissolved tests <input type="checkbox"/> Yes <input type="checkbox"/> No <input checked="" type="checkbox"/> N/A	11.
Sample Labels match COC: <input checked="" type="checkbox"/> Yes <input type="checkbox"/> No <input type="checkbox"/> N/A	12.
-Includes date/time/ID/Analysis Matrix: <u>W</u>	
Trip Blank Present: <input checked="" type="checkbox"/> Yes <input type="checkbox"/> No <input type="checkbox"/> N/A	13.
Trip Blank Custody Seals Present <input checked="" type="checkbox"/> Yes <input type="checkbox"/> No <input type="checkbox"/> N/A	
Pace Trip Blank Lot # (if purchased): <u>471</u>	

Client Notification/ Resolution: _____ If checked, see attached form for additional comments

Person Contacted: _____ Date/Time: _____

Comments/ Resolution: _____

PM Review is documented electronically in LIMs. By releasing the project, the PM acknowledges they have reviewed the sample logir