

Via WDNR Submittal Portal

Ms. Linda Stanek
Wisconsin Department of Natural Resources
1027 W. St. Paul Avenue
Milwaukee, WI 53233

**NR 716.14 DATA TRANSMITTAL
APRIL 2024 GROUNDWATER ANALYTICAL RESULTS
FORMER ONE-HOUR VALET DRY CLEANERS (TAXMAN)
1214 WEST WELLS STREET, MILWAUKEE, WISCONSIN
BRRTS NO. 02-41-152248**

Dear Ms. Stanek:

Ramboll Americas Engineering Solutions, Inc. (Ramboll), on behalf of Marquette University (Marquette), is providing the Wisconsin Department of Natural Resources (WDNR) with the attached analytical results for the April 2024 groundwater sampling event completed at the former Taxman/One-Hour Valet Dry Cleaner site located at 1214 West Wells Street in Milwaukee, Wisconsin (the "site"). The groundwater samples were collected from the eight existing groundwater monitoring wells (MW-3, MW-4, MW-5, MW-6, MW-7, PZ-1R, PZ-2R, and PZ-4) on April 10, 2024. A figure showing the monitoring well locations is attached along with draft cumulative results tables (Attachment A) and the laboratory analytical report (Attachment B).

All groundwater samples were submitted for analysis of volatile organic compounds (VOCs). Monitoring well PZ-1R was also sampled for monitored natural attenuation geochemical parameters (ethane, ethene, methane, dissolved iron, total organic carbon, and sulfate). The analytical results continue to document stable to decreasing groundwater conditions. Additionally, the geochemical data continue to indicate strongly reducing conditions which are promoting the dechlorination of PCE.

A progress report documenting the October 2023 and April 2024 sampling events and providing responses to several of the items outlined in your September 26, 2023, letter is anticipated to be submitted to the WDNR in July 2024.

If you have any questions, please feel free to contact us at the numbers listed below.

Yours sincerely,

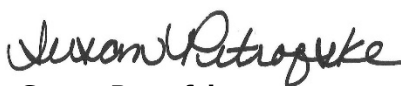

Susan Petrofske
Senior Managing Consultant

D +1 262 901 3501
spetrofske@ramboll.com



Jeanne M. Tarvin, PG, CPG
E&H Americas Country Market Director

D +1 262 901 0085
jtarkin@ramboll.com

May 8, 2024

Ramboll
234 W. Florida Street
Fifth Floor
Milwaukee, WI 53204
USA

T +1 414 837 3607
F +1 414 837 3608
www.ramboll.com

Ref. 1690005819

cc: Joel Smullen, Marquette

ATTACHMENT A

FIGURE AND TABLES

Figure 1: Site Layout

Table 1: Groundwater Analytical Results

Table 2: MNA Parameter Groundwater Sampling Results

L:\Loop Project Files\CAD\1690005819_Former 1hr Dry Cleaners\2021-01\02_Site Layout.dwg

HOSPITAL PARKING STRUCTURE



LEGEND

- PROPERTY BOUNDARY
- BUILDING FOOTPRINT
- ASPHALT
- CONCRETE
- FENCE LINE
- 1-FT ELEVATION CONTOUR
- UNDERGROUND ELECTRIC
- OVERHEAD ELECTRIC
- TELEPHONE
- WATER LINE
- GAS
- CABLE TV
- FIBER OPTIC
- STORMWATER SEWER
- SANITARY SEWER
- STEAM
- CATCH BASIN
- MANHOLE
- VALVE
- TRAFFIC LIGHT
- TRANSFORMER
- METER
- LIGHT POLE
- UTILITY POLE / GUY
- TREE
- FIRE HYDRANT
- TELEPHONE PEDESTAL
- CONTROL BOX
- MONITORING WELL
- SOIL GAS SAMPLE
- INJECTION WELL (APPROXIMATE LOCATION)
- INJECTION POINT (APPROXIMATE LOCATION)

REFERENCE: THE SITE LAYOUT, SITE FEATURES, ELEVATIONS, UTILITIES, AND OTHER FEATURES NEAR THE PROPERTY WERE OBTAINED FROM GRAEF-USA IN DECEMBER 2017. MONITORING WELLS WERE SURVEYED IN OCTOBER 2019.



SITE LAYOUT
FORMER ONE-HOUR VALET DRY CLEANERS
1214 WEST WELLS STREET
MILWAUKEE, WISCONSIN



FIGURE
1

DRAFTED BY: HJW/PDL

DATE: 1/20/2021

1690005819

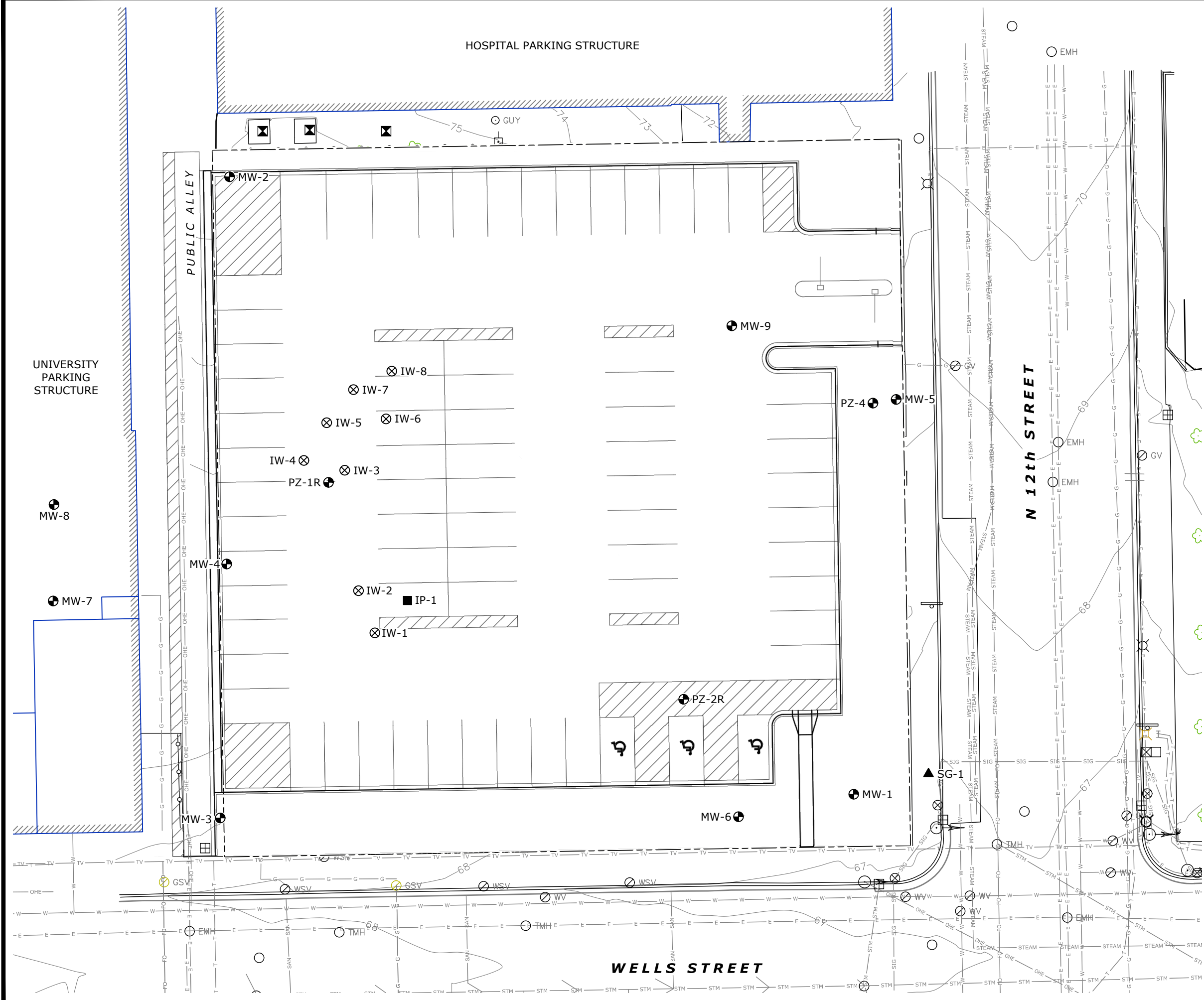

Table 1: Groundwater Analytical Results - Summary of Detected Constituents

Former One-Hour Valet Dry Cleaners
 1214 West Wells Street, Milwaukee, Wisconsin
 Ramboll Project No. 1690005819

Analyte ^{1,2}		Benzene	Chloroform	1,1-Dichloroethene	cis-1,2-Dichloroethene	trans-1,2-Dichloroethene	Ethylbenzene	Methylene chloride	Tetrachloroethene	Toluene	Trichloroethene	1,2,4-Trimethylbenzene ³	Vinyl chloride	Xylenes, total ⁴
CAS		71-43-2	67-66-3	75-35-4	156-59-2	156-60-5	100-41-4	75-09-2	127-18-4	108-88-3	79-01-6	95-63-6	75-01-4	1330-20-7
Units		ug/L	ug/L	ug/L	ug/L	ug/L	ug/L	ug/L	ug/L	ug/L	ug/L	ug/L	ug/L	ug/L
NR 140 ES		5	6	7	70	100	700	5	5	800	5	480	0.2	2000
NR 140 PAL		0.5	0.6	0.7	7	20	140	0.5	0.5	160	0.5	96	0.02	400
MW-1	1/14/2002	ND	<0.23	<0.27	<0.21	<0.25	<0.22	<0.24	<0.22	<0.41	0.46 J	<0.15	44	#N/A
	5/8/2002	ND	<0.1	<0.11	<0.11	<0.11	<0.08	<0.24	<0.15	<0.08	<0.13	<0.11	<0.16	#N/A
	8/7/2003	ND	<0.25	<0.5	<0.5	<0.5	<0.5	<1	<0.5	0.9	0.3 J	<0.25	<0.25	<0.5
	10/7/2003	ND	<0.25	<0.5	<0.5	<0.5	<0.5	<1	<0.5	<0.25	<0.25	<0.25	<0.25	<0.5
	8/25/2009	<0.2	<0.2	<0.5	<0.5	<0.5	<0.5	<1	<0.5	<0.5	<0.2	<0.2	<0.2	<0.5
MW-2	11/1/2017	<0.50	<2.5	<0.41	<0.26	<0.26	<0.50	<0.23	<0.50	<0.50	<0.33	<0.50	<0.18	<1.5
	1/14/2002	ND	<0.23	<0.21	<0.21	<0.25	<0.22	<0.22	<0.22	<0.41	<0.24	<0.26	<0.25	#N/A
	5/8/2002	ND	<0.1	<0.11	<0.11	<0.11	<0.08	<0.24	<0.15	<0.08	<0.13	<0.11	<0.16	#N/A
	8/7/2003	ND	<0.25	<0.5	<0.5	<0.5	<0.5	<1	<0.5	0.32 J	<0.25	<0.25	<0.25	<0.5
	10/7/2003	ND	<0.25	<0.5	<0.5	<0.5	<0.5	<1	<0.5	<0.25	<0.25	<0.25	<0.25	<0.5
MW-3	8/27/2009	<0.2	<0.2	<0.5	<0.5	<0.5	<0.5	<1	<0.5	<0.5	<0.2	<0.2	<0.2	<0.5
	11/1/2017	<0.50	<2.5	<0.41	<0.26	<0.26	<0.50	<0.23	<0.50	<0.50	<0.33	<0.50	<0.18	<1.5
	1/15/2002	ND	<0.23	<0.27	<0.21	<0.25	<0.22	<0.22	<0.22	<0.41	<0.24	<0.26	<0.25	#N/A
	5/8/2002	ND	<0.1	<0.11	<0.11	<0.11	<0.08	<0.24	<0.15	0.32	0.34 J	<0.11	<0.16	#N/A
	8/7/2003	ND	<0.25	<0.5	<0.5	<0.5	<0.5	<1	<0.5	0.88	0.42 J	<0.25	<0.25	<0.5
MW-4	10/7/2003	ND	<0.25	<0.5	<0.5	<0.5	<0.5	<1	<0.5	<0.25	<0.25	<0.25	<0.25	<0.5
	8/27/2009	<0.2	<0.2	<0.5	<0.5	<0.5	<0.5	<1	<0.5	<0.5	<0.2	<0.2	<0.2	<0.5
	11/1/2017	<0.50	<2.5	<0.41	<0.26	<0.26	<0.50	<0.23	<0.50	<0.50	<0.33	<0.50	<0.18	<1.5
	10/31/2023	<0.30	<0.50	<0.58	<0.47	<0.53	<0.33	<0.32	<0.41	<0.29	<0.32	<0.45	<0.17	<1.0
	4/9/2024	<0.30	<0.50	<0.58	<0.47	<0.53	<0.33	<0.32	<0.41	<0.29	<0.32	<0.45	<0.17	<1.0
	8/7/2003	ND	<0.25	<0.5	<0.5	<0.5	<0.5	<1	0.88 J	0.9	0.71 J	0.34 J	<0.25	<0.5
	10/7/2003	ND	<0.25	<0.5	<0.5	<0.5	<0.5	<1	0.57 J	<0.25	<0.25	<0.25	<0.25	<0.5
	8/25/2009	<0.2	<0.2	<0.5	<0.5	<0.5	<0.5	<1	7	<0.5	<0.2	<0.2	<0.2	<0.5
	11/2/2017	<0.50	<2.5	<0.41	<0.26	<0.26	<0.50	<0.23	7.8	<0.50	<0.33	<0.50	<0.18	<1.5
	5/2/2019	<0.49	<2.5	<0.49	23.0	<2.2	<0.44	<1.2	850	<0.34	5.0	<1.7	<0.35	<3.0
	8/14/2019	<0.25	<1.3	<0.24	0.43 J	<1.1	<0.22	<0.58	79.1	<0.17	0.99 J	<0.84	<0.17	<1.5
	3/10/2020	<0.25	<1.3	<0.24	<0.27	<1.1	<0.32	<0.58	57	<0.27	0.47 J	<0.84	<0.17	<1.5
	10/28/2020	<0.25	<1.3	<0.24	<0.27	<0.46	<0.32	<0.58	24.0	<0.27	0.26 J	<0.84	<0.17	<1.5
	4/21/2021	<0.30	<1.2	<0.58	<0.47	<0.53	<0.33	<0.32	31.8	<0.29	<0.32	<0.45	<0.17	<1.0
	10/27/2021	<0.30	<1.2	<0.58	<0.47	<0.53	<0.33	<0.32	26.8	<0.29	<0.32	<0.45	<0.17	<1.0
MW-5	4/13/2022	<0.30	<1.2	<0.58	<0.47	<0.53	<0.33	<0.32	13.7	<0.29	<0.32	<0.45	<0.17	<1.0
	10/12/2022	<0.30	<1.2	<0.58	<0.47	<0.53	<0.33	<0.32	26.8	<0.29	<0.32	<0.45	<0.17	<1.0
	4/12/2023	<0.30	<0.50	<0.58	<0.47	<0.53	<0.33	<0.32	44.5	<0.29	0.40 J	<0.45	<0.17	<1.0
	10/31/2023	<0.30	<0.50	<0.58	<0.47	<0.53	<0.33	<0.32	23.1	<0.29	<0.32	<0.45	<0.17	<1.0
	4/10/2024	<0.30	<0.50	<0.58	<0.47	<0.53	<0.33	<0.32	79.5	<0.29	0.84 J	<0.45	<0.17	<1.0
	8/7/2003	ND	<0.25	<0.5	11	<0.5	<0.5	<1	80	0.9	7.9	0.34 J	<0.25	<0.5
	10/7/2003	ND	<0.25	<0.5	150	1.2	<0.5	<1	93	<0.25	6.4	<0.25	<0.25	<0.5
	8/27/2009	<0.2	<0.2	<0.5	110	1.2	<0.5	<1	140	<0.5	<0.2	32	22	<0.5
	11/2/2017	<0.50	<2.5	<0.41	73.6	1.5	<0.50	<0.23	30.3	<0.50	3.2	<0.50	0.45 J	<1.5
	5/2/2019	<0.25	<1.3	<0.24	11.3	<1.1	<0.22	<0.58	20.5	<0.17	3.8	<0.84	2.1	<1.5
8/14/2019	<0.25	<1.3	<0.24	31.2	<1.1	<0.22	<0.58	29.1	<0.17	5.9	<0.84	0.73 J	<1.5	
3/10/2020	<0.25	<1.3	<0.24	14.1	<1.1	<0.32	<0.58	23.8	<0.27	5.0	<0.84	2.2	<1.5	
10/28/2020	<0.25	<1.3	<0.24	11.3	0.72 J	<0.32	<0.58	21.7	<0.27	5.2	<0.84	1.5	<1.5	
4/21/2021	<0.30	<1.2	<0.58	7.6	0.59 J	<0.33	<0.32	20.9	<0.29	4.2	<0.45	1.5	<1.0	
10/27/2021	<0.30	<1.2	<0.58	12.3	1.7	<0.33	<0.32	24.0	<0.29	5.6	<0.45	1.1	<1.0	
4/13/2022	<0.30	<1.2	<0.58	47.8	0.93 J	<0.33	<0.32	18.0	<0.29	3.7	<0.45	<0.17	<1.0	
10/12/2022	<0.30	<1.2	<0.58	10.6	<0.53	<0.33	<0.32	18.6	<0.29	3.6	<0.45	0.26 J	<1.0	
4/12/2023	<0.30	<0.50	<0.58	4.4	<0.53	<0.33	<0.32	10.5	<0.29	1.5	<0.45	<0.17	<1.0	
10/31/2023	<0.30	<0.50	<0.58	3.3	<0.53	<0.33	<0.32	20.4	<0.29	3.1	<0.45	<0.17	<1.0	
4/10/2024	<0.30	<0.50	<0.58	0.87 J	<0.53	<0.33	<0.32	13.8	<0.29	2.0	<0.45	<0.17	<1.0	

Table 1: Groundwater Analytical Results - Summary of Detected Constituents

Former One-Hour Valet Dry Cleaners
1214 West Wells Street, Milwaukee, Wisconsin
Ramboll Project No. 1690005819

Analyte ^{1,2}		Benzene	Chloroform	1,1-Dichloroethene	cis-1,2-Dichloroethene	trans-1,2-Dichloroethene	Ethylbenzene	Methylene chloride	Tetrachloroethene	Toluene	Trichloroethene	1,2,4-Trimethylbenzene ³	Vinyl chloride	Xylenes, total ⁴
CAS		71-43-2	67-66-3	75-35-4	156-59-2	156-60-5	100-41-4	75-09-2	127-18-4	108-88-3	79-01-6	95-63-6	75-01-4	1330-20-7
Units		ug/L	ug/L	ug/L	ug/L	ug/L	ug/L	ug/L	ug/L	ug/L	ug/L	ug/L	ug/L	ug/L
NR 140 ES		5	6	7	70	100	700	5	5	800	5	480	0.2	2000
NR 140 PAL		0.5	0.6	0.7	7	20	140	0.5	0.5	160	0.5	96	0.02	400
MW-6	8/25/2009	<0.2	<2	<5	980	<5	<5	<10	<5	<5	18	<2	57	<5
	11/9/2017	<0.50	<2.5	<0.41	4.5	<0.26	<0.50	<0.23	<0.50	<0.50	<0.33	<0.50	1.0	<1.5
	5/2/2019	<0.25	<1.3	<0.24	<0.27	<1.1	<0.22	<0.58	<0.33	<0.17	<0.26	<0.84	<0.17	<1.5
	8/14/2019	<0.25	<1.3	<0.24	14.7 MI	<1.1	<0.22	<0.58	1.3	<0.17	0.37 J	<0.84	1.6	<1.5
	3/10/2020	<0.25	<1.3	<0.24	239	6.8	<0.32	<0.58	<0.33	<0.27	13.5	<0.84	11.5	<1.5
	10/28/2020	<0.25	<1.3	<0.24	172	5.4	<0.32	<0.58	<0.33	<0.27	15.6	<0.84	8.4	<1.5
	4/21/2021	<0.30	<1.2	<0.58	1.9	<0.53	<0.33	<0.32	<0.41	<0.29	<0.32	<0.45	0.32 J	<1.0
	10/27/2021	<0.30	<1.2	<0.58	1.3	<0.53	<0.33	<0.32	<0.41	<0.29	<0.32	<0.45	0.19 J	<1.0
	4/13/2022	<0.30	<1.2	<0.58	1.5	<0.53	<0.33	<0.32	<0.41	<0.29	<0.32	<0.45	0.36 J	<1.0
	10/12/2022	<0.30	<1.2	<0.58	1.3	<0.53	<0.33	<0.32	<0.41	<0.29	<0.32	<0.45	0.42 J	<1.0
	4/12/2023	<0.30	<0.50	<0.58	9.1	<0.53	<0.33	<0.32	<0.41	<0.29	<0.32	<0.45	1.8	<1.0
	10/31/2023	<0.30	<0.50	<0.58	2.7	<0.53	<0.33	<0.32	<0.41	<0.29	<0.32	<0.45	1.1	<1.0
4/10/2024	<0.30	<0.50	<0.58	2.1	<0.53	<0.33	<0.32	<0.41	<0.29	<0.32	<0.45	1.1	<1.0	
MW-7	8/26/2009	<0.2	<0.2	<0.5	<0.5	<0.5	<0.5	<1	<0.5	<0.5	<0.2	<0.2	<0.2	<0.5
	11/9/2017	<0.50	<2.5	<0.41	<0.26	<0.26	<0.50	<0.23	<0.50	<0.50	<0.33	<0.50	<0.18	<1.5
	10/31/2023	<0.30	<0.50	<0.58	<0.47	<0.53	<0.33	<0.32	<0.41	<0.29	<0.32	<0.45	<0.17	<1.0
MW-8	4/10/2024	<0.30	<0.50	<0.58	<0.47	<0.53	<0.33	<0.32	<0.41	<0.29	<0.32	<0.45	<0.17	<1.0
MW-9	8/26/2009	<0.2	<0.2	<0.5	<0.5	<0.5	<0.5	<1	<0.5	<0.5	<0.2	<0.2	<0.2	<0.5
	8/27/2009	0.28	<0.2	<0.5	<0.5	<0.5	<0.5	<1	<0.5	0.64	<0.2	<0.2	<0.2	<0.5
MW-9	11/9/2017	<0.50	<2.5	<0.41	<0.26	<0.26	<0.50	<0.23	<0.50	0.59 J	<0.33	<0.50	<0.18	<1.5
PZ-1	1/15/2002	ND	<1.2	<1.4	400	4	J	<1.1	<1.1	<2.1	<1.2	<0.75	<1.3	#N/A
	5/8/2003	ND	<5	<5.5	3,000	22	<4	23 J	8,500	<4	2,800	<5.5	22 J	#N/A
	8/8/2003	ND	0.3	J	8.4	2,600	18.0	1.8	<1	27,000	4.8	2,500	<0.25	11
	10/7/2003	ND	<120	<250	2,600	<250	<250	<500	36,000	<120	2,600	<120	<120	<250
	8/25/2009	<32	<32	<80	2,000	<80	<80	<160	61,000	<80	1,600	<32	<32	<80
	11/2/2017	<125	<625	<103	414	<64.1	<125	<58.1	16,200	<125	435	<125	<43.9	<375
PZ-1 abandoned on 1/11/2018. PZ-1R was installed on 4/18/2019.														
PZ-1R	5/2/2019	<123	<637	<122	30,000	<545	<109	<290	60,300 M1	<86.1	3,310	<420	<87.3	<750
	8/14/2019	<123	<637	140 J	108,000	<545	<109	<290	83,700	<86.1	5,450	<420	1,110	<750
	3/10/2020	<123	<637	<122	36,400	<545	<159	<290	23,200	<135	9,060	<420	2,630	<750
	10/28/2020	<123	<637	<122	6,500	<232	<159	<290	28,800	<135	2,280	<420	822	<750
	4/21/2021	<148	<591	<291	98,200	<264	<163	<160	64,500	<144	26,000	<224	10,800	<524
	10/27/2021	<148	<591	<291	69,500	<264	<163	<160	21,800	<144	10,800	<224	14,200	<524
	4/13/2022	<148	<591	<291	47,800	<264	<163	<160	64,600	<144	11,800	<224	12,300	<524
	10/12/2022	<148	<591	<291	92,600	<264	<163	<160	20,200	<144	3,350	<224	21,900	<524
	4/12/2023	<148	<252	<291	72,100	<264	<163	<160	1,890	<144	240 J	<224	17,200	<524
10/31/2023	<148	<252	<291	66,100	<264	<163	<160	1,660	<144	289 J	<224	16,500	<524	
4/10/2024	<148	<252	<291	66,300	<264	<163	<160	460 J	<144	<160	<224	19,700	<524	
PZ-2	8/8/2003	ND	<0.25	<0.5	<0.5	<0.5	<0.5	<1	<0.5	0.43 J	<0.25	<0.25	5.8	<0.5
	10/6/2003	ND	<0.25	<0.5	<0.5	<0.5	<0.5	<1	<0.5	<0.25	<0.25	<0.25	8.9	<0.5
	8/27/2009	<0.2	<0.2	<0.5	<0.5	<0.5	<0.5	<1	<0.5	<0.5	<0.2	<0.2	14	<0.5
	11/1/2017	<0.50	<2.5	<0.41	4.1	<0.26	<0.50	<0.23	<0.50	<0.50	<0.33	<0.50	11.0	<1.5
	PZ-2 abandoned on 7/19/2019. PZ-2R was installed on 7/19/2019.													

Table 1: Groundwater Analytical Results - Summary of Detected Constituents

Former One-Hour Valet Dry Cleaners
1214 West Wells Street, Milwaukee, Wisconsin
Ramboll Project No. 1690005819

Analyte ^{1,2}		Benzene	Chloroform	1,1-Dichloroethene	cis-1,2-Dichloroethene	trans-1,2-Dichloroethene	Ethylbenzene	Methylene chloride	Tetrachloroethene	Toluene	Trichloroethene	1,2,4-Trimethylbenzene ³	Vinyl chloride	Xylenes, total ⁴
CAS		71-43-2	67-66-3	75-35-4	156-59-2	156-60-5	100-41-4	75-09-2	127-18-4	108-88-3	79-01-6	95-63-6	75-01-4	1330-20-7
Units		ug/L	ug/L	ug/L	ug/L	ug/L	ug/L	ug/L	ug/L	ug/L	ug/L	ug/L	ug/L	ug/L
NR 140 ES		5	6	7	70	100	700	5	5	800	5	480	0.2	2000
NR 140 PAL		0.5	0.6	0.7	7	20	140	0.5	0.5	160	0.5	96	0.02	400
PZ-2R	8/14/2019	<0.25	<1.3	<0.24	26.9	<1.1	<0.22	<0.58	12.7	<0.17	0.39 J	<0.84	15.5	<1.5
	3/10/2020	<0.25	<1.3	<0.24	33.9	<1.1	<0.32	<0.58	<0.33	<0.27	<0.26	<0.84	11.3	<1.5
	10/28/2020	<0.25	<1.3	<0.24	90.2	1.1 J	<0.32	<0.58	<0.33	<0.27	<0.26	<0.84	10.8	<1.5
	4/21/2021	<0.30	<1.2	<0.58	109	1.5	<0.33	<0.32	<0.41	<0.29	<0.32	<0.45	14.1	<1.0
	10/27/2021	<0.30	<1.2	<0.58	104	1.3	<0.33	<0.32	<0.41	<0.29	<0.32	<0.45	12.6	<1.0
	4/13/2022	<0.30	<1.2	<0.58	91.5	1.4	<0.33	<0.32	<0.41	<0.29	<0.32	<0.45	11.1	<1.0
	10/12/2022	<0.30	<1.2	<0.58	121	1.7	<0.33	<0.32	<0.41	<0.29	<0.32	<0.45	11.1	<1.0
	4/12/2023	<0.30	<0.50	<0.58	89.9	1.5	<0.33	<0.32	<0.41	<0.29	<0.32	<0.45	11.8	<1.0
	10/31/2023	<0.30	<0.50	<0.58	113	1.7	<0.33	<0.32	<0.41	<0.29	<0.32	<0.45	11.6	<1.0
	4/10/2024	<0.30	<0.50	<0.58	111	1.7	<0.33	<0.32	<0.41	<0.29	<0.32	<0.45	12.8	<1.0
PZ-3	8/26/2004	ND	<2	<5	440	<5	<5	<10	56	<2	<2	<2	<2	<5
	10/7/2004	ND	<1	<2.5	300	<2.5	<2.5	<5	73	<1	<1	<1	<1	<2.5
	8/25/2009	<2	<2	<5	1,100	11.0	<5	<10	5.6	<5	7.1	<2	3.9	<5
	11/2/2017	<25.0	<125	<20.5	2,060	22.4 J	<25.0	<11.6	<25.0	<25.0	144	<25.0	<8.8	<75.0
	PZ-3 abandoned on 1/11/2018.													
PZ-4	8/25/2009	<0.20	<0.2	<0.5	4.4	<0.5	<0.5	<1	0.84	<0.5	0.56	<0.2	<0.2	<0.5
	11/2/2017	<0.50	<2.5	<0.41	<0.26	<0.26	<0.50	<0.23	<0.50	<0.50	<0.33	<0.50	1.3	<1.5
	5/2/2019	<0.49	<2.5	<0.49	20.8	<2.2	<0.44	<1.2	35.1	<0.34	3	<1.7	1 J	<3.0
	8/14/2019	<0.25	<1.3	<0.24	<0.27	<1.1	<0.22	<0.58	15.8	<0.17	<0.26	<0.84	1.8	<1.5
	3/10/2020	<0.25	<1.3	<0.24	1.4	<1.1	<0.32	<0.58	16	<0.27	<0.26	<0.84	1.7	<1.5
	10/28/2020	<0.25	<1.3	<0.24	0.42 J	<0.46	<0.32	<0.58	23.5	<0.27	0.37 J	<0.84	<0.17	<1.5
	4/21/2021	<0.30	<1.2	<0.58	<0.47	<0.53	<0.33	<0.32	0.94 J	<0.29	<0.32	<0.45	3.1	<1.0
	10/27/2021	<0.30	<1.2	<0.58	<0.47	<0.53	<0.33	<0.32	<0.41	<0.29	<0.32	<0.45	3.2	<1.0
	4/13/2022	<0.30	<1.2	<0.58	<0.47	<0.53	<0.33	<0.32	0.45 J	<0.29	<0.32	<0.45	3.3	<1.0
	10/12/2022	<0.30	<1.2	<0.58	<0.47	<0.53	<0.33	<0.32	<0.41	<0.29	<0.32	<0.45	1.4	<1.0
	4/12/2023	<0.30	<0.50	<0.58	<0.47	<0.53	<0.33	<0.32	<0.41	<0.29	<0.32	<0.45	3.7	<1.0
	10/31/2023	<0.30	<0.50	<0.58	<0.47	<0.53	<0.33	<0.32	<0.41	<0.29	<0.32	<0.45	4.1	<1.0
4/10/2024	<0.30	<0.50	<0.58	<0.47	<0.53	<0.33	<0.32	<0.41	<0.29	<0.32	<0.45	4.6	<1.0	

Notes:

All results reported in micrograms per Liter (ug/L)

ES = Enforcement Standard

PAL = Preventive Action Limit

Bold value = NR 140 ES Exceedance

Italic Value = NR 140 PAL Exceedance

#N/A = Not analyzed

NS = Not sampled

J = Estimated concentration. Laboratory results reported between the limit of detection and limit of quantification.

¹ Analytical results are displayed for detected parameters only.

² All sampling results prior to 2017 obtained from a Site Investigation Report prepared by GZA GeoEnvironmental, Inc. on February 24, 2012.

³ Standards are for 1,2,4- and 1,3,5-Trimethylbenzene

⁴ Standards are for Total Xylenes (-m, -p, and -o).

⁵ MW-8 not sampled during the November 2017 groundwater sampling event because well did not recharge sufficiently.

⁶ PZ-2 was not sampled during the May 2019 groundwater sampling event because well was damaged during site redevelopment activities.

ND = Not detected at or above limit of detection.

M1 = Matrix spike recovery exceeded QC limits. Batch accepted based on laboratory control sample (LCS) recovery.

Table 2: MNA Parameter Groundwater Sampling Results

Former One-Hour Valet Dry Cleaners
1214 West Wells Street, Milwaukee, Wisconsin
Ramboll Project No. 1690005819

Well ID	Sample Date	Dissolved Oxygen (mg/L)	Ethane (µg/L)	Ethene (µg/L)	pH	Iron, Ferrous (mg/L)	Methane (µg/L)	Nitrogen, NO ₂ plus NO ₃ (mg/L)	ORP (mV)	Sulfate (mg/L)	Total Organic Carbon (mg/L)
MW-1	1/14/2002	10.39	NA	NA	NR	NA	NA	NA	-37.0	NA	NA
	5/8/2002	3.57	NA	NA	NR	NA	NA	NA	287.1	NA	NA
	8/7/2003	0.22	NA	NA	NR	NA	NA	NA	161.3	NA	NA
	10/7/2003	1.05	0.028	0.049	NR	NA	14	NA	396.8	NA	NA
	8/25/2009	0.69	<10	<10	NR	NA	<10	NA	95.0	NA	1.26
11/1/2017	1.69	<0.58	<0.52	7.31	<0.017	<1.4	<0.095	57.7	<100	<0.25	
MW-2	1/14/2002	6.42	NA	NA	NR	NA	NA	NA	168.4	NA	NA
	5/8/2002	1.07	NA	NA	NR	NA	NA	NA	256.9	NA	NA
	8/7/2003	0.10	NA	NA	NR	NA	NA	NA	2.3	NA	NA
	10/7/2003	4.43	0.018	0.021	NR	NA	22	NA	364.0	NA	NA
	8/27/2009	0.98	NA	NA	NR	NA	NA	NA	86.0	NA	NA
11/1/2017	1.71	<0.58	<0.52	7.7	1.2	<1.4	<0.095	-74.3	93.5	<0.25	
MW-3	8/7/2003	0.15	NA	NA	NR	NA	NA	NA	68.0	NA	NA
	10/7/2003	5.74	0.16	0.056	NR	NA	45	NA	327.8	NA	NA
	8/27/2009	1.01	NA	NA	NR	NA	NA	NA	16.0	NA	NA
	11/1/2017 ¹	0.73	NA	NA	7.56	NA	NA	NA	-125.6	NA	NA
	10/31/2023	5.18	NA	NA	7.13	NA	NA	NA	37.2	NA	NA
4/9/2024	0.18	NA	NA	7.17	NA	NA	NA	-128.3	NA	NA	
MW-4	8/7/2003	5.83	NA	NA	NR	NA	NA	NA	139.0	NA	NA
	10/7/2003	3.44	0.021	0.033	NR	NA	22	NA	383.4	NA	NA
	8/25/2009	2.55	NA	NA	NR	NA	NA	NA	77.0	NA	NA
	11/2/2017	0.88	NA	NA	7.80	NA	NA	NA	-19.8	NA	NA
	5/2/2019	8.40	NA	NA	7.34	NA	NA	NA	140.7	NA	NA
	8/14/2019	1.82	NA	NA	7.11	NA	NA	NA	79.4	NA	NA
	3/10/2020	8.53	NA	NA	7.15	NA	NA	NA	81.6	NA	NA
	10/28/2020	1.45	NA	NA	6.65	NA	NA	NA	116.0	NA	NA
	4/21/2021	5.40	NA	NA	7.88	NA	NA	NA	53.9	NA	NA
	10/27/2021	2.13	NA	NA	6.82	NA	NA	NA	64.6	NA	NA
	4/13/2022	0.85	NA	NA	7.14	NA	NA	NA	72.6	NA	NA
	10/12/2022	0.96	NA	NA	7.30	NA	NA	NA	74.4	NA	NA
	4/12/2023	3.61	NA	NA	7.44	NA	NA	NA	-68.1	NA	NA
	10/31/2023	2.58	NA	NA	7.16	NA	NA	NA	26.4	NA	NA
	4/10/2024	7.56	NA	NA	7.68	NA	NA	NA	57.8	NA	NA
MW-5	8/7/2003	0.86	NA	NA	NR	NA	NA	NA	190.5	NA	NA
	10/7/2003	1.05	0.041	0.0097	NR	NA	0.99	NA	396.8	NA	NA
	8/27/2009	0.99	<10	<10	NR	NA	136	NA	98.0	NA	1.82
	11/2/2017	2.04	NA	NA	8.10	NA	NA	NA	18.6	NA	NA
	5/2/2019	2.01	NA	NA	7.49	NA	NA	NA	159.1	NA	NA
	8/14/2019	0.18	NA	NA	7.53	NA	NA	NA	63.4	NA	NA
	3/10/2020	0.00	NA	NA	7.80	NA	NA	NA	21.1	NA	NA
	10/28/2020	0.29	NA	NA	7.31	NA	NA	NA	47.2	NA	NA
	4/21/2021	0.19	NA	NA	7.85	NA	NA	NA	-18.0	NA	NA
	10/27/2021	0.52	NA	NA	7.40	NA	NA	NA	15.4	NA	NA
	4/13/2022	5.55	NA	NA	7.22	NA	NA	NA	63.1	NA	NA
	10/12/2022	0.70	NA	NA	7.54	NA	NA	NA	-27.2	NA	NA
	4/12/2023	0.82	NA	NA	7.25	NA	NA	NA	-88.2	NA	NA
	10/31/2023	0.42	NA	NA	7.36	NA	NA	NA	-0.4	NA	NA
	4/10/2024	1.70	NA	NA	7.21	NA	NA	NA	50.5	NA	NA
MW-6	8/25/2009	1.0	NA	NA	NR	NA	NA	NA	-50.0	NA	NA
	11/9/2017 ¹	0.62	<0.58	<0.52	7.39	5.2	<1.4	<0.095	-112.7	82.4	<0.25
	5/2/2019	11.38	<0.58	<0.52	9.31	<0.20	<1.4	0.25	94.8	41.8	6.0
	8/14/2019	0.83	<0.58	<0.52	6.82	2.1	H <1.4	<0.0	3.1	95.6	0.57
	3/10/2020	0.01	<1.2	<1.2	7.62	7.4	H 75.2	<0.059	-154.3	87	1.8
	10/28/2020	0.26	NA	NA	7.08	NA	NA	NA	-137.5	NA	NA
	4/21/2021	0.41	NA	NA	7.36	NA	NA	NA	-98.1	NA	NA
	10/27/2021	0.44	NA	NA	6.97	NA	NA	NA	-50.4	NA	NA
	4/13/2022	0.41	NA	NA	6.89	NA	NA	NA	-65.1	NA	NA
	10/12/2022	0.59	NA	NA	5.71	NA	NA	NA	-52.3	NA	NA
	4/12/2023	0.24	NA	NA	6.82	NA	NA	NA	-193.4	NA	NA
10/31/2023	0.31	NA	NA	6.85	NA	NA	NA	-244.8	NA	NA	
4/10/2024	0.15	NA	NA	6.93	NA	NA	NA	-129.6	NA	NA	
MW-7	8/26/2009	NA	NA	NA	NR	NA	NA	NA	NA	NA	NA
	11/9/2017 ²	7.49	NA	NA	7.72	NA	NA	NA	-50.7	NA	NA
	10/31/2023	NA	NA	NA	NA	NA	NA	NA	NA	NA	NA
MW-8	4/10/2024	NA	NA	NA	NA	NA	NA	NA	NA	NA	NA
	8/26/2009	NA	NA	NA	NR	NA	NA	NA	NA	NA	NA
MW-9	11/9/2017 ³	4.03	NA	NA	7.28	NA	NA	NA	-28.7	NA	NA
	8/27/2009	NA	<10	<10	NR	NA	<10	NA	NA	NA	1.27
	11/9/2017	6.40	NA	NA	7.75	NA	NA	NA	-42.6	NA	NA

Table 2: MNA Parameter Groundwater Sampling Results

Former One-Hour Valet Dry Cleaners
1214 West Wells Street, Milwaukee, Wisconsin
Ramboll Project No. 1690005819

Well ID	Sample Date	Dissolved Oxygen (mg/L)	Ethane (µg/L)	Ethene (µg/L)	pH	Iron, Ferrous (mg/L)	Methane (µg/L)	Nitrogen, NO ₂ plus NO ₃ (mg/L)	ORP (mV)	Sulfate (mg/L)	Total Organic Carbon (mg/L)	
PZ-1	1/15/2002	0.66	NA	NA	NR	NA	NA	NA	-65.3	NA	NA	
	5/8/2003	1.31	NA	NA	NR	NA	NA	NA	-18.3	NA	NA	
	8/8/2003	0.12	NA	NA	NR	NA	NA	NA	-93.7	NA	NA	
	10/7/2003	0.09	1.7	0.48	NR	NA	7	NA	-97.1	NA	NA	
	8/25/2009	0.83	<10	<10	NR	NA	<10	NA	-73.0	NA	2.04	
11/2/2017	0.64	<0.58	<0.52	8.14	0.060	<1.4	0.33	38.5	155	0.50		
PZ-1R	5/2/2019	1.01	337	32.4	7.05	5.8 H	23.1	<0.095	-102.6	101	124	
	8/14/2019	0.21	3,060	87.2	6.97	6.5 H	129	<0.095	-138.4	93.1	184	
	3/10/2020	0.00	2,130	974	7.58	5.1 H	162	<0.059	-270.1	85.9	115	
	10/28/2020	0.21	1,560	1,320	6.47	168 H	1510	NA	-126.9	4.9 J, D3	2,440	
	4/21/2021	0.19	1,540	1,090	7.35	19.7	2,680	NA	-487.7	<2.2	499	
	10/27/2021	0.18	2.7	21.9	6.43	19.0 H	1,820	NA	-58.6	<2.2	959	
	4/13/2022	0.36	683	3,570	6.62	3.9 H, M	5,650	NA	-244.8	66.2	240	
	10/12/2022	0.48	1,040	7,090	6.47	7.2 H	13,900	NA	-312.7	<2.2	241	
	4/12/2023	0.12	135	4,270	6.16	12 H	13,300	NA	-243.9	<0.44	177	
	10/31/2023	0.04	299	6,570	6.32	10 H	17,100	NA	-430.3	<2.2	204	
	4/10/2024	0.08	283	3,720	6.51	13.9 H, M	9,410	NA	-155.7	<2.2	171	
	PZ-2	8/8/2003	0.19	NA	NA	NR	NA	NA	NA	-41.3	NA	NA
		10/6/2003	0.15	1.3	0.79	NR	NA	60	NA	-35.1	NA	NA
8/27/2009		0.78	NA	NA	NR	NA	NA	NA	-16.0	NA	NA	
11/1/2017 ¹		2.67	<0.58	<0.52	7.64	3.1	23.1	<0.095	-100.3	178	<0.25	
PZ-2R	8/14/2019	0.13	0.82	<0.52	7.15	3.6 H	22	<0.095	-36.8	164	0.40 J	
	3/10/2020	0.10	<1.2	<1.2	7.29	2.9 H, M	10.3	<0.059	-68.3	140	0.36 J M	
	10/28/2020	0.35	NA	NA	6.99	NA	NA	NA	-80.6	NA	NA	
	4/21/2021	0.47	NA	NA	7.65	NA	NA	NA	-81.7	NA	NA	
	10/27/2021	0.38	NA	NA	7.19	NA	NA	NA	-45.8	NA	NA	
	4/13/2022	0.57	NA	NA	7.11	NA	NA	NA	-40.0	NA	NA	
	10/12/2022	0.81	NA	NA	6.90	NA	NA	NA	-65.8	NA	NA	
	4/12/2023	0.37	NA	NA	7.00	NA	NA	NA	-162.9	NA	NA	
	10/31/2023	0.30	NA	NA	7.20	NA	NA	NA	-183.6	NA	NA	
	4/10/2024	0.13	NA	NA	7.22	NA	NA	NA	-94.9	NA	NA	
PZ-3	8/25/2009	0.72	NA	NA	NR	NA	NA	NA	-53.0	NA	NA	
	11/2/2017	1.34	NA	NA	7.98	NA	NA	NA	-103.8	NA	NA	
PZ-4	8/25/2009	0.72	NA	NA	NR	NA	NA	NA	-55.0	NA	NA	
	11/2/2017	1.47	NA	NA	7.76	NA	NA	NA	-111.8	NA	NA	
	5/2/2019	2.99	NA	NA	7.02	NA	NA	NA	48.2	NA	NA	
	8/14/2019	0.24	NA	NA	6.95	NA	NA	NA	-40.0	NA	NA	
	3/10/2020	0.24	NA	NA	6.98	NA	NA	NA	-61.7	NA	NA	
	10/28/2020	7.72	NA	NA	8.77	NA	NA	NA	12.4	NA	NA	
	4/21/2021	0.54	NA	NA	7.44	NA	NA	NA	-88.1	NA	NA	
	10/27/2021	0.31	NA	NA	7.09	NA	NA	NA	-36.9	NA	NA	
	4/13/2022	0.56	NA	NA	6.89	NA	NA	NA	-35.5	NA	NA	
	10/12/2022	0.98	NA	NA	6.92	NA	NA	NA	-110.9	NA	NA	
	4/12/2023	0.82	NA	NA	6.97	NA	NA	NA	-175.1	NA	NA	
	10/31/2023	0.39	NA	NA	6.95	NA	NA	NA	-107.4	NA	NA	
	4/10/2024	1.70	NA	NA	6.93	NA	NA	NA	-34.0	NA	NA	

Notes:

J = Estimated concentration at or above the level of detection and below the level of quantification.

mg/L = milligrams per liter

mV = millivolts

NA = Data was not collected or not able to be collected.

NS = Not sampled.

NR = Not reported.

ORP = Oxidation-reduction potential; measured in the field.

µg/L = micrograms per liter

All sampling results prior to 2017 obtained from a Site Investigation Report prepared by GZA GeoEnvironmental, Inc. dated February 24, 2012.

Iron, Ferrous is a calculated value from the difference of the laboratory result of Iron, Dissolved and Iron, Ferric. As such, the laboratory qualifiers of the results are applied to the calculated value.

(1) Well cap either missing or not plugged at time of inspection; potential for water and other constituents to have entered the well.

(2) Monitoring well purged dry after first stabilization parameter reading. Well sampled later in day without collecting new stabilization parameters.

(3) Monitoring well purged dry before water passed completely through flow-through cell. Stabilization parameters collected from flow-through cell approximately 4/5 of the way full.

(4) Monitoring well was damaged during site redevelopment activities and was not sampled.

1q = Dilution for calculation purposes only.

D3 = Sample was diluted due to the presence of high levels of non-target analytes or other matrix interference.

H = Sample was received or analysis requested beyond the recognized method holding time. Refer to laboratory report for more details.

M = Matrix spike recovery and/or matrix spike duplicate recovery was outside laboratory control limits. Refer to laboratory report for more details.



ATTACHMENT B
LABORATORY ANALYTICAL REPORT



April 26, 2024

Susan Petrofske
Ramboll US Consulting, Inc.
234 W. Florida Street
Fifth Floor
Milwaukee, WI 53204

RE: Project: 1690005819_Conv One-Hour Valet
Pace Project No.: 40276723

Dear Susan Petrofske:

Enclosed are the analytical results for sample(s) received by the laboratory on April 12, 2024. The results relate only to the samples included in this report. Results reported herein conform to the applicable TNI/NELAC Standards and the laboratory's Quality Manual, where applicable, unless otherwise noted in the body of the report.

The test results provided in this final report were generated by each of the following laboratories within the Pace Network:

- Pace Analytical Services - Green Bay
- Pace Analytical Services - Greensburg

If you have any questions concerning this report, please feel free to contact me.

Sincerely,

Steven Mieczko
steve.mieczko@pacelabs.com
(920)469-2436
Project Manager

Enclosures

cc: Paul Lindquist, Ramboll US Consulting, Inc.



REPORT OF LABORATORY ANALYSIS

This report shall not be reproduced, except in full,
without the written consent of Pace Analytical Services, LLC.



CERTIFICATIONS

Project: 1690005819_Conv One-Hour Valet

Pace Project No.: 40276723

Pace Analytical Services Pennsylvania

1638 Roseytown Rd Suites 2,3&4, Greensburg, PA 15601

ANAB DOD-ELAP Rad Accreditation #: L2417

ANABISO/IEC 17025:2017 Rad Cert#: L24170

Alabama Certification #: 41590

Arizona Certification #: AZ0734

Arkansas Certification

California Certification #: 2950

Colorado Certification #: PA01547

Connecticut Certification #: PH-0694

EPA Region 4 DW Rad

Florida/TNI Certification #: E87683

Georgia Certification #: C040

Guam Certification

Hawaii Certification

Idaho Certification

Illinois Certification

Indiana Certification

Iowa Certification #: 391

Kansas Certification #: E-10358

Kentucky Certification #: KY90133

KY WW Permit #: KY0098221

KY WW Permit #: KY0000221

Louisiana DHH/TNI Certification #: LA010

Louisiana DEQ/TNI Certification #: 04086

Maine Certification #: 2023021

Maryland Certification #: 308

Massachusetts Certification #: M-PA1457

Michigan/PADEP Certification #: 9991

Missouri Certification #: 235

Montana Certification #: Cert0082

Nebraska Certification #: NE-OS-29-14

Nevada Certification #: PA014572023-03

New Hampshire/TNI Certification #: 297622

New Jersey/TNI Certification #: PA051

New Mexico Certification #: PA01457

New York/TNI Certification #: 10888

North Carolina Certification #: 42706

North Dakota Certification #: R-190

Ohio EPA Rad Approval: #41249

Oregon/TNI Certification #: PA200002-015

Pennsylvania/TNI Certification #: 65-00282

Puerto Rico Certification #: PA01457

Rhode Island Certification #: 65-00282

South Dakota Certification

Tennessee Certification #: TN02867

Texas/TNI Certification #: T104704188-22-18

Utah/TNI Certification #: PA014572223-14

USDA Soil Permit #: 525-23-67-77263

Vermont Dept. of Health: ID# VT-0282

Virgin Island/PADEP Certification

Virginia/VELAP Certification #: 460198

Washington Certification #: C868

West Virginia DEP Certification #: 143

West Virginia DHHR Certification #: 9964C

Wisconsin Approve List for Rad

Pace Analytical Services Green Bay

1241 Bellevue Street, Green Bay, WI 54302

Florida/NELAP Certification #: E87948

Illinois Certification #: 200050

Kentucky UST Certification #: 82

Louisiana Certification #: 04168

Minnesota Certification #: 055-999-334

New York Certification #: 12064

North Dakota Certification #: R-150

South Carolina Certification #: 83006001

Texas Certification #: T104704529-21-8

Virginia VELAP Certification ID: 11873

Wisconsin Certification #: 405132750

Wisconsin DATCP Certification #: 105-444

USDA Soil Permit #: P330-21-00008

Federal Fish & Wildlife Permit #: 51774A

REPORT OF LABORATORY ANALYSIS

This report shall not be reproduced, except in full,
without the written consent of Pace Analytical Services, LLC.



SAMPLE SUMMARY

Project: 1690005819_Conv One-Hour Valet

Pace Project No.: 40276723

Lab ID	Sample ID	Matrix	Date Collected	Date Received
40276723001	MW-7	Water	04/10/24 08:30	04/12/24 08:00
40276723002	MW-3	Water	04/09/24 13:10	04/12/24 08:00
40276723003	MW-6	Water	04/10/24 09:20	04/12/24 08:00
40276723004	MW-6 DUP	Water	04/10/24 09:25	04/12/24 08:00
40276723005	PZ-2R	Water	04/10/24 10:05	04/12/24 08:00
40276723006	MW-5	Water	04/10/24 11:25	04/12/24 08:00
40276723007	PZ-4	Water	04/10/24 12:06	04/12/24 08:00
40276723008	MW-4	Water	04/10/24 12:52	04/12/24 08:00
40276723009	PZ-1R	Water	04/10/24 14:05	04/12/24 08:00
40276723010	TRIP BLANK	Water	04/10/24 00:00	04/12/24 08:00

REPORT OF LABORATORY ANALYSIS

This report shall not be reproduced, except in full,
without the written consent of Pace Analytical Services, LLC.



SAMPLE ANALYTE COUNT

Project: 1690005819_Conv One-Hour Valet

Pace Project No.: 40276723

Lab ID	Sample ID	Method	Analysts	Analytes Reported	Laboratory
40276723001	MW-7	EPA 8260	CXJ	65	PASI-G
40276723002	MW-3	EPA 8260	CXJ	65	PASI-G
40276723003	MW-6	EPA 8260	CXJ	65	PASI-G
40276723004	MW-6 DUP	EPA 8260	CXJ	65	PASI-G
40276723005	PZ-2R	EPA 8260	CXJ	65	PASI-G
40276723006	MW-5	EPA 8260	CXJ	65	PASI-G
40276723007	PZ-4	EPA 8260	CXJ	65	PASI-G
40276723008	MW-4	EPA 8260	CXJ	65	PASI-G
40276723009	PZ-1R	EPA 8015B Modified	KHB	3	PASI-G
		EPA 6020B	KXS	1	PASI-G
		EPA 8260	CXJ	65	PASI-G
		SM 3500-FeB-2011	PAS	1	PASI-PA
		HACH 8146	DAW	1	PASI-G
		EPA 300.0	HMB	1	PASI-G
		SM 5310C	TJJ	1	PASI-G
40276723010	TRIP BLANK	EPA 8260	CXJ	65	PASI-G

PASI-G = Pace Analytical Services - Green Bay

PASI-PA = Pace Analytical Services - Greensburg

REPORT OF LABORATORY ANALYSIS

This report shall not be reproduced, except in full, without the written consent of Pace Analytical Services, LLC.



SUMMARY OF DETECTION

Project: 1690005819_Conv One-Hour Valet

Pace Project No.: 40276723

Lab Sample ID Method	Client Sample ID Parameters	Result	Units	Report Limit	Analyzed	Qualifiers
40276723003	MW-6					
EPA 8260	cis-1,2-Dichloroethene	2.1	ug/L	1.0	04/16/24 22:00	
EPA 8260	Vinyl chloride	1.1	ug/L	1.0	04/16/24 22:00	
40276723004	MW-6 DUP					
EPA 8260	cis-1,2-Dichloroethene	2.6	ug/L	1.0	04/16/24 22:20	
EPA 8260	Vinyl chloride	0.99J	ug/L	1.0	04/16/24 22:20	
40276723005	PZ-2R					
EPA 8260	cis-1,2-Dichloroethene	111	ug/L	1.0	04/16/24 22:39	
EPA 8260	trans-1,2-Dichloroethene	1.7	ug/L	1.0	04/16/24 22:39	
EPA 8260	Vinyl chloride	12.8	ug/L	1.0	04/16/24 22:39	
40276723006	MW-5					
EPA 8260	cis-1,2-Dichloroethene	0.87J	ug/L	1.0	04/17/24 09:13	
EPA 8260	Tetrachloroethene	13.8	ug/L	1.0	04/17/24 09:13	
EPA 8260	Trichloroethene	2.0	ug/L	1.0	04/17/24 09:13	
40276723007	PZ-4					
EPA 8260	Vinyl chloride	4.6	ug/L	1.0	04/16/24 23:19	
40276723008	MW-4					
EPA 8260	Tetrachloroethene	79.5	ug/L	1.0	04/16/24 23:38	
EPA 8260	Trichloroethene	0.84J	ug/L	1.0	04/16/24 23:38	
40276723009	PZ-1R					
EPA 8015B Modified	Ethane	283	ug/L	5.6	04/19/24 12:22	
EPA 8015B Modified	Ethene	3720	ug/L	1000	04/19/24 13:10	
EPA 8015B Modified	Methane	9410	ug/L	560	04/19/24 13:10	
EPA 6020B	Iron, Dissolved	13200	ug/L	5000	04/17/24 19:59	
EPA 8260	cis-1,2-Dichloroethene	66300	ug/L	500	04/17/24 00:17	
EPA 8260	Tetrachloroethene	460J	ug/L	500	04/17/24 00:17	
EPA 8260	Vinyl chloride	19700	ug/L	500	04/17/24 00:17	
SM 3500-FeB-2011	Iron, Ferrous	13.9	mg/L	1.0	04/16/24 13:49	H3,H6,ML
SM 5310C	Total Organic Carbon	171	mg/L	30.0	04/18/24 22:46	

REPORT OF LABORATORY ANALYSIS

This report shall not be reproduced, except in full,
without the written consent of Pace Analytical Services, LLC.



ANALYTICAL RESULTS

Project: 1690005819_Conv One-Hour Valet

Pace Project No.: 40276723

Sample: MW-7 Lab ID: 40276723001 Collected: 04/10/24 08:30 Received: 04/12/24 08:00 Matrix: Water

Parameters	Results	Units	LOQ	LOD	DF	Prepared	Analyzed	CAS No.	Qual
8260 MSV									
Analytical Method: EPA 8260									
Pace Analytical Services - Green Bay									
Benzene	<0.30	ug/L	1.0	0.30	1		04/16/24 21:21	71-43-2	
Bromobenzene	<0.36	ug/L	1.0	0.36	1		04/16/24 21:21	108-86-1	
Bromochloromethane	<0.36	ug/L	1.0	0.36	1		04/16/24 21:21	74-97-5	
Bromodichloromethane	<0.42	ug/L	1.0	0.42	1		04/16/24 21:21	75-27-4	
Bromoform	<0.43	ug/L	1.0	0.43	1		04/16/24 21:21	75-25-2	
Bromomethane	<1.2	ug/L	5.0	1.2	1		04/16/24 21:21	74-83-9	
n-Butylbenzene	<0.86	ug/L	1.0	0.86	1		04/16/24 21:21	104-51-8	
sec-Butylbenzene	<0.42	ug/L	1.0	0.42	1		04/16/24 21:21	135-98-8	
tert-Butylbenzene	<0.59	ug/L	1.0	0.59	1		04/16/24 21:21	98-06-6	
Carbon tetrachloride	<0.37	ug/L	1.0	0.37	1		04/16/24 21:21	56-23-5	
Chlorobenzene	<0.86	ug/L	1.0	0.86	1		04/16/24 21:21	108-90-7	
Chloroethane	<1.4	ug/L	5.0	1.4	1		04/16/24 21:21	75-00-3	
Chloroform	<0.50	ug/L	5.0	0.50	1		04/16/24 21:21	67-66-3	
Chloromethane	<1.6	ug/L	5.0	1.6	1		04/16/24 21:21	74-87-3	
2-Chlorotoluene	<0.89	ug/L	5.0	0.89	1		04/16/24 21:21	95-49-8	
4-Chlorotoluene	<0.89	ug/L	5.0	0.89	1		04/16/24 21:21	106-43-4	
1,2-Dibromo-3-chloropropane	<2.4	ug/L	5.0	2.4	1		04/16/24 21:21	96-12-8	
Dibromochloromethane	<2.6	ug/L	5.0	2.6	1		04/16/24 21:21	124-48-1	
1,2-Dibromoethane (EDB)	<0.31	ug/L	1.0	0.31	1		04/16/24 21:21	106-93-4	
Dibromomethane	<0.99	ug/L	5.0	0.99	1		04/16/24 21:21	74-95-3	
1,2-Dichlorobenzene	<0.33	ug/L	1.0	0.33	1		04/16/24 21:21	95-50-1	
1,3-Dichlorobenzene	<0.35	ug/L	1.0	0.35	1		04/16/24 21:21	541-73-1	
1,4-Dichlorobenzene	<0.89	ug/L	1.0	0.89	1		04/16/24 21:21	106-46-7	
Dichlorodifluoromethane	<0.46	ug/L	5.0	0.46	1		04/16/24 21:21	75-71-8	
1,1-Dichloroethane	<0.30	ug/L	1.0	0.30	1		04/16/24 21:21	75-34-3	
1,2-Dichloroethane	<0.29	ug/L	1.0	0.29	1		04/16/24 21:21	107-06-2	
1,1-Dichloroethene	<0.58	ug/L	1.0	0.58	1		04/16/24 21:21	75-35-4	
cis-1,2-Dichloroethene	<0.47	ug/L	1.0	0.47	1		04/16/24 21:21	156-59-2	
trans-1,2-Dichloroethene	<0.53	ug/L	1.0	0.53	1		04/16/24 21:21	156-60-5	
1,2-Dichloropropane	<0.45	ug/L	1.0	0.45	1		04/16/24 21:21	78-87-5	
1,3-Dichloropropane	<0.30	ug/L	1.0	0.30	1		04/16/24 21:21	142-28-9	
2,2-Dichloropropane	<0.42	ug/L	1.0	0.42	1		04/16/24 21:21	594-20-7	
1,1-Dichloropropene	<0.41	ug/L	1.0	0.41	1		04/16/24 21:21	563-58-6	
cis-1,3-Dichloropropene	<0.24	ug/L	1.0	0.24	1		04/16/24 21:21	10061-01-5	
trans-1,3-Dichloropropene	<0.27	ug/L	1.0	0.27	1		04/16/24 21:21	10061-02-6	
Diisopropyl ether	<1.1	ug/L	5.0	1.1	1		04/16/24 21:21	108-20-3	
Ethylbenzene	<0.33	ug/L	1.0	0.33	1		04/16/24 21:21	100-41-4	
Hexachloro-1,3-butadiene	<2.7	ug/L	5.0	2.7	1		04/16/24 21:21	87-68-3	
Isopropylbenzene (Cumene)	<1.0	ug/L	5.0	1.0	1		04/16/24 21:21	98-82-8	
p-Isopropyltoluene	<1.0	ug/L	5.0	1.0	1		04/16/24 21:21	99-87-6	
Methylene Chloride	<0.32	ug/L	5.0	0.32	1		04/16/24 21:21	75-09-2	
Methyl-tert-butyl ether	<1.1	ug/L	5.0	1.1	1		04/16/24 21:21	1634-04-4	
Naphthalene	<1.9	ug/L	5.0	1.9	1		04/16/24 21:21	91-20-3	
n-Propylbenzene	<0.35	ug/L	1.0	0.35	1		04/16/24 21:21	103-65-1	
Styrene	<0.36	ug/L	1.0	0.36	1		04/16/24 21:21	100-42-5	

REPORT OF LABORATORY ANALYSIS

This report shall not be reproduced, except in full,
without the written consent of Pace Analytical Services, LLC.



ANALYTICAL RESULTS

Project: 1690005819_Conv One-Hour Valet

Pace Project No.: 40276723

Sample: MW-7 Lab ID: 40276723001 Collected: 04/10/24 08:30 Received: 04/12/24 08:00 Matrix: Water

Parameters	Results	Units	LOQ	LOD	DF	Prepared	Analyzed	CAS No.	Qual
8260 MSV									
Analytical Method: EPA 8260									
Pace Analytical Services - Green Bay									
1,1,1,2-Tetrachloroethane	<0.36	ug/L	1.0	0.36	1		04/16/24 21:21	630-20-6	
1,1,1,2-Tetrachloroethane	<0.38	ug/L	1.0	0.38	1		04/16/24 21:21	79-34-5	
Tetrachloroethene	<0.41	ug/L	1.0	0.41	1		04/16/24 21:21	127-18-4	
Toluene	<0.29	ug/L	1.0	0.29	1		04/16/24 21:21	108-88-3	
1,2,3-Trichlorobenzene	<1.0	ug/L	5.0	1.0	1		04/16/24 21:21	87-61-6	
1,2,4-Trichlorobenzene	<0.95	ug/L	5.0	0.95	1		04/16/24 21:21	120-82-1	
1,1,1-Trichloroethane	<0.30	ug/L	1.0	0.30	1		04/16/24 21:21	71-55-6	
1,1,2-Trichloroethane	<0.34	ug/L	1.0	0.34	1		04/16/24 21:21	79-00-5	
Trichloroethene	<0.32	ug/L	1.0	0.32	1		04/16/24 21:21	79-01-6	
Trichlorofluoromethane	<0.42	ug/L	1.0	0.42	1		04/16/24 21:21	75-69-4	
1,2,3-Trichloropropane	<0.56	ug/L	1.0	0.56	1		04/16/24 21:21	96-18-4	
1,2,4-Trimethylbenzene	<0.45	ug/L	1.0	0.45	1		04/16/24 21:21	95-63-6	
1,3,5-Trimethylbenzene	<0.36	ug/L	1.0	0.36	1		04/16/24 21:21	108-67-8	
Vinyl chloride	<0.17	ug/L	1.0	0.17	1		04/16/24 21:21	75-01-4	
Xylene (Total)	<1.0	ug/L	3.0	1.0	1		04/16/24 21:21	1330-20-7	
m&p-Xylene	<0.70	ug/L	2.0	0.70	1		04/16/24 21:21	179601-23-1	
o-Xylene	<0.35	ug/L	1.0	0.35	1		04/16/24 21:21	95-47-6	
Surrogates									
4-Bromofluorobenzene (S)	101	%	70-130		1		04/16/24 21:21	460-00-4	
1,2-Dichlorobenzene-d4 (S)	95	%	70-130		1		04/16/24 21:21	2199-69-1	
Toluene-d8 (S)	102	%	70-130		1		04/16/24 21:21	2037-26-5	

REPORT OF LABORATORY ANALYSIS

This report shall not be reproduced, except in full, without the written consent of Pace Analytical Services, LLC.



ANALYTICAL RESULTS

Project: 1690005819_Conv One-Hour Valet

Pace Project No.: 40276723

Sample: MW-3 Lab ID: 40276723002 Collected: 04/09/24 13:10 Received: 04/12/24 08:00 Matrix: Water

Parameters	Results	Units	LOQ	LOD	DF	Prepared	Analyzed	CAS No.	Qual
8260 MSV		Analytical Method: EPA 8260 Pace Analytical Services - Green Bay							
Benzene	<0.30	ug/L	1.0	0.30	1		04/16/24 21:41	71-43-2	
Bromobenzene	<0.36	ug/L	1.0	0.36	1		04/16/24 21:41	108-86-1	
Bromochloromethane	<0.36	ug/L	1.0	0.36	1		04/16/24 21:41	74-97-5	
Bromodichloromethane	<0.42	ug/L	1.0	0.42	1		04/16/24 21:41	75-27-4	
Bromoform	<0.43	ug/L	1.0	0.43	1		04/16/24 21:41	75-25-2	
Bromomethane	<1.2	ug/L	5.0	1.2	1		04/16/24 21:41	74-83-9	
n-Butylbenzene	<0.86	ug/L	1.0	0.86	1		04/16/24 21:41	104-51-8	
sec-Butylbenzene	<0.42	ug/L	1.0	0.42	1		04/16/24 21:41	135-98-8	
tert-Butylbenzene	<0.59	ug/L	1.0	0.59	1		04/16/24 21:41	98-06-6	
Carbon tetrachloride	<0.37	ug/L	1.0	0.37	1		04/16/24 21:41	56-23-5	
Chlorobenzene	<0.86	ug/L	1.0	0.86	1		04/16/24 21:41	108-90-7	
Chloroethane	<1.4	ug/L	5.0	1.4	1		04/16/24 21:41	75-00-3	
Chloroform	<0.50	ug/L	5.0	0.50	1		04/16/24 21:41	67-66-3	
Chloromethane	<1.6	ug/L	5.0	1.6	1		04/16/24 21:41	74-87-3	
2-Chlorotoluene	<0.89	ug/L	5.0	0.89	1		04/16/24 21:41	95-49-8	
4-Chlorotoluene	<0.89	ug/L	5.0	0.89	1		04/16/24 21:41	106-43-4	
1,2-Dibromo-3-chloropropane	<2.4	ug/L	5.0	2.4	1		04/16/24 21:41	96-12-8	
Dibromochloromethane	<2.6	ug/L	5.0	2.6	1		04/16/24 21:41	124-48-1	
1,2-Dibromoethane (EDB)	<0.31	ug/L	1.0	0.31	1		04/16/24 21:41	106-93-4	
Dibromomethane	<0.99	ug/L	5.0	0.99	1		04/16/24 21:41	74-95-3	
1,2-Dichlorobenzene	<0.33	ug/L	1.0	0.33	1		04/16/24 21:41	95-50-1	
1,3-Dichlorobenzene	<0.35	ug/L	1.0	0.35	1		04/16/24 21:41	541-73-1	
1,4-Dichlorobenzene	<0.89	ug/L	1.0	0.89	1		04/16/24 21:41	106-46-7	
Dichlorodifluoromethane	<0.46	ug/L	5.0	0.46	1		04/16/24 21:41	75-71-8	
1,1-Dichloroethane	<0.30	ug/L	1.0	0.30	1		04/16/24 21:41	75-34-3	
1,2-Dichloroethane	<0.29	ug/L	1.0	0.29	1		04/16/24 21:41	107-06-2	
1,1-Dichloroethene	<0.58	ug/L	1.0	0.58	1		04/16/24 21:41	75-35-4	
cis-1,2-Dichloroethene	<0.47	ug/L	1.0	0.47	1		04/16/24 21:41	156-59-2	
trans-1,2-Dichloroethene	<0.53	ug/L	1.0	0.53	1		04/16/24 21:41	156-60-5	
1,2-Dichloropropane	<0.45	ug/L	1.0	0.45	1		04/16/24 21:41	78-87-5	
1,3-Dichloropropane	<0.30	ug/L	1.0	0.30	1		04/16/24 21:41	142-28-9	
2,2-Dichloropropane	<0.42	ug/L	1.0	0.42	1		04/16/24 21:41	594-20-7	
1,1-Dichloropropene	<0.41	ug/L	1.0	0.41	1		04/16/24 21:41	563-58-6	
cis-1,3-Dichloropropene	<0.24	ug/L	1.0	0.24	1		04/16/24 21:41	10061-01-5	
trans-1,3-Dichloropropene	<0.27	ug/L	1.0	0.27	1		04/16/24 21:41	10061-02-6	
Diisopropyl ether	<1.1	ug/L	5.0	1.1	1		04/16/24 21:41	108-20-3	
Ethylbenzene	<0.33	ug/L	1.0	0.33	1		04/16/24 21:41	100-41-4	
Hexachloro-1,3-butadiene	<2.7	ug/L	5.0	2.7	1		04/16/24 21:41	87-68-3	
Isopropylbenzene (Cumene)	<1.0	ug/L	5.0	1.0	1		04/16/24 21:41	98-82-8	
p-Isopropyltoluene	<1.0	ug/L	5.0	1.0	1		04/16/24 21:41	99-87-6	
Methylene Chloride	<0.32	ug/L	5.0	0.32	1		04/16/24 21:41	75-09-2	
Methyl-tert-butyl ether	<1.1	ug/L	5.0	1.1	1		04/16/24 21:41	1634-04-4	
Naphthalene	<1.9	ug/L	5.0	1.9	1		04/16/24 21:41	91-20-3	
n-Propylbenzene	<0.35	ug/L	1.0	0.35	1		04/16/24 21:41	103-65-1	
Styrene	<0.36	ug/L	1.0	0.36	1		04/16/24 21:41	100-42-5	

REPORT OF LABORATORY ANALYSIS

This report shall not be reproduced, except in full,
without the written consent of Pace Analytical Services, LLC.



ANALYTICAL RESULTS

Project: 1690005819_Conv One-Hour Valet

Pace Project No.: 40276723

Sample: MW-3 **Lab ID: 40276723002** Collected: 04/09/24 13:10 Received: 04/12/24 08:00 Matrix: Water

Parameters	Results	Units	LOQ	LOD	DF	Prepared	Analyzed	CAS No.	Qual
8260 MSV									
Analytical Method: EPA 8260									
Pace Analytical Services - Green Bay									
1,1,1,2-Tetrachloroethane	<0.36	ug/L	1.0	0.36	1		04/16/24 21:41	630-20-6	
1,1,1,2-Tetrachloroethane	<0.38	ug/L	1.0	0.38	1		04/16/24 21:41	79-34-5	
Tetrachloroethene	<0.41	ug/L	1.0	0.41	1		04/16/24 21:41	127-18-4	
Toluene	<0.29	ug/L	1.0	0.29	1		04/16/24 21:41	108-88-3	
1,2,3-Trichlorobenzene	<1.0	ug/L	5.0	1.0	1		04/16/24 21:41	87-61-6	
1,2,4-Trichlorobenzene	<0.95	ug/L	5.0	0.95	1		04/16/24 21:41	120-82-1	
1,1,1-Trichloroethane	<0.30	ug/L	1.0	0.30	1		04/16/24 21:41	71-55-6	
1,1,2-Trichloroethane	<0.34	ug/L	1.0	0.34	1		04/16/24 21:41	79-00-5	
Trichloroethene	<0.32	ug/L	1.0	0.32	1		04/16/24 21:41	79-01-6	
Trichlorofluoromethane	<0.42	ug/L	1.0	0.42	1		04/16/24 21:41	75-69-4	
1,2,3-Trichloropropane	<0.56	ug/L	1.0	0.56	1		04/16/24 21:41	96-18-4	
1,2,4-Trimethylbenzene	<0.45	ug/L	1.0	0.45	1		04/16/24 21:41	95-63-6	
1,3,5-Trimethylbenzene	<0.36	ug/L	1.0	0.36	1		04/16/24 21:41	108-67-8	
Vinyl chloride	<0.17	ug/L	1.0	0.17	1		04/16/24 21:41	75-01-4	
Xylene (Total)	<1.0	ug/L	3.0	1.0	1		04/16/24 21:41	1330-20-7	
m&p-Xylene	<0.70	ug/L	2.0	0.70	1		04/16/24 21:41	179601-23-1	
o-Xylene	<0.35	ug/L	1.0	0.35	1		04/16/24 21:41	95-47-6	
Surrogates									
4-Bromofluorobenzene (S)	102	%	70-130		1		04/16/24 21:41	460-00-4	
1,2-Dichlorobenzene-d4 (S)	97	%	70-130		1		04/16/24 21:41	2199-69-1	
Toluene-d8 (S)	102	%	70-130		1		04/16/24 21:41	2037-26-5	

REPORT OF LABORATORY ANALYSIS

This report shall not be reproduced, except in full,
without the written consent of Pace Analytical Services, LLC.



ANALYTICAL RESULTS

Project: 1690005819_Conv One-Hour Valet

Pace Project No.: 40276723

Sample: MW-6 Lab ID: 40276723003 Collected: 04/10/24 09:20 Received: 04/12/24 08:00 Matrix: Water

Parameters	Results	Units	LOQ	LOD	DF	Prepared	Analyzed	CAS No.	Qual
8260 MSV									
Analytical Method: EPA 8260									
Pace Analytical Services - Green Bay									
Benzene	<0.30	ug/L	1.0	0.30	1		04/16/24 22:00	71-43-2	
Bromobenzene	<0.36	ug/L	1.0	0.36	1		04/16/24 22:00	108-86-1	
Bromochloromethane	<0.36	ug/L	1.0	0.36	1		04/16/24 22:00	74-97-5	
Bromodichloromethane	<0.42	ug/L	1.0	0.42	1		04/16/24 22:00	75-27-4	
Bromoform	<0.43	ug/L	1.0	0.43	1		04/16/24 22:00	75-25-2	
Bromomethane	<1.2	ug/L	5.0	1.2	1		04/16/24 22:00	74-83-9	
n-Butylbenzene	<0.86	ug/L	1.0	0.86	1		04/16/24 22:00	104-51-8	
sec-Butylbenzene	<0.42	ug/L	1.0	0.42	1		04/16/24 22:00	135-98-8	
tert-Butylbenzene	<0.59	ug/L	1.0	0.59	1		04/16/24 22:00	98-06-6	
Carbon tetrachloride	<0.37	ug/L	1.0	0.37	1		04/16/24 22:00	56-23-5	
Chlorobenzene	<0.86	ug/L	1.0	0.86	1		04/16/24 22:00	108-90-7	
Chloroethane	<1.4	ug/L	5.0	1.4	1		04/16/24 22:00	75-00-3	
Chloroform	<0.50	ug/L	5.0	0.50	1		04/16/24 22:00	67-66-3	
Chloromethane	<1.6	ug/L	5.0	1.6	1		04/16/24 22:00	74-87-3	
2-Chlorotoluene	<0.89	ug/L	5.0	0.89	1		04/16/24 22:00	95-49-8	
4-Chlorotoluene	<0.89	ug/L	5.0	0.89	1		04/16/24 22:00	106-43-4	
1,2-Dibromo-3-chloropropane	<2.4	ug/L	5.0	2.4	1		04/16/24 22:00	96-12-8	
Dibromochloromethane	<2.6	ug/L	5.0	2.6	1		04/16/24 22:00	124-48-1	
1,2-Dibromoethane (EDB)	<0.31	ug/L	1.0	0.31	1		04/16/24 22:00	106-93-4	
Dibromomethane	<0.99	ug/L	5.0	0.99	1		04/16/24 22:00	74-95-3	
1,2-Dichlorobenzene	<0.33	ug/L	1.0	0.33	1		04/16/24 22:00	95-50-1	
1,3-Dichlorobenzene	<0.35	ug/L	1.0	0.35	1		04/16/24 22:00	541-73-1	
1,4-Dichlorobenzene	<0.89	ug/L	1.0	0.89	1		04/16/24 22:00	106-46-7	
Dichlorodifluoromethane	<0.46	ug/L	5.0	0.46	1		04/16/24 22:00	75-71-8	
1,1-Dichloroethane	<0.30	ug/L	1.0	0.30	1		04/16/24 22:00	75-34-3	
1,2-Dichloroethane	<0.29	ug/L	1.0	0.29	1		04/16/24 22:00	107-06-2	
1,1-Dichloroethene	<0.58	ug/L	1.0	0.58	1		04/16/24 22:00	75-35-4	
cis-1,2-Dichloroethene	2.1	ug/L	1.0	0.47	1		04/16/24 22:00	156-59-2	
trans-1,2-Dichloroethene	<0.53	ug/L	1.0	0.53	1		04/16/24 22:00	156-60-5	
1,2-Dichloropropane	<0.45	ug/L	1.0	0.45	1		04/16/24 22:00	78-87-5	
1,3-Dichloropropane	<0.30	ug/L	1.0	0.30	1		04/16/24 22:00	142-28-9	
2,2-Dichloropropane	<0.42	ug/L	1.0	0.42	1		04/16/24 22:00	594-20-7	
1,1-Dichloropropene	<0.41	ug/L	1.0	0.41	1		04/16/24 22:00	563-58-6	
cis-1,3-Dichloropropene	<0.24	ug/L	1.0	0.24	1		04/16/24 22:00	10061-01-5	
trans-1,3-Dichloropropene	<0.27	ug/L	1.0	0.27	1		04/16/24 22:00	10061-02-6	
Diisopropyl ether	<1.1	ug/L	5.0	1.1	1		04/16/24 22:00	108-20-3	
Ethylbenzene	<0.33	ug/L	1.0	0.33	1		04/16/24 22:00	100-41-4	
Hexachloro-1,3-butadiene	<2.7	ug/L	5.0	2.7	1		04/16/24 22:00	87-68-3	
Isopropylbenzene (Cumene)	<1.0	ug/L	5.0	1.0	1		04/16/24 22:00	98-82-8	
p-Isopropyltoluene	<1.0	ug/L	5.0	1.0	1		04/16/24 22:00	99-87-6	
Methylene Chloride	<0.32	ug/L	5.0	0.32	1		04/16/24 22:00	75-09-2	
Methyl-tert-butyl ether	<1.1	ug/L	5.0	1.1	1		04/16/24 22:00	1634-04-4	
Naphthalene	<1.9	ug/L	5.0	1.9	1		04/16/24 22:00	91-20-3	
n-Propylbenzene	<0.35	ug/L	1.0	0.35	1		04/16/24 22:00	103-65-1	
Styrene	<0.36	ug/L	1.0	0.36	1		04/16/24 22:00	100-42-5	

REPORT OF LABORATORY ANALYSIS

This report shall not be reproduced, except in full,
without the written consent of Pace Analytical Services, LLC.



ANALYTICAL RESULTS

Project: 1690005819_Conv One-Hour Valet

Pace Project No.: 40276723

Sample: MW-6 Lab ID: 40276723003 Collected: 04/10/24 09:20 Received: 04/12/24 08:00 Matrix: Water

Parameters	Results	Units	LOQ	LOD	DF	Prepared	Analyzed	CAS No.	Qual
8260 MSV		Analytical Method: EPA 8260 Pace Analytical Services - Green Bay							
1,1,1,2-Tetrachloroethane	<0.36	ug/L	1.0	0.36	1		04/16/24 22:00	630-20-6	
1,1,1,2-Tetrachloroethane	<0.38	ug/L	1.0	0.38	1		04/16/24 22:00	79-34-5	
Tetrachloroethene	<0.41	ug/L	1.0	0.41	1		04/16/24 22:00	127-18-4	
Toluene	<0.29	ug/L	1.0	0.29	1		04/16/24 22:00	108-88-3	
1,2,3-Trichlorobenzene	<1.0	ug/L	5.0	1.0	1		04/16/24 22:00	87-61-6	
1,2,4-Trichlorobenzene	<0.95	ug/L	5.0	0.95	1		04/16/24 22:00	120-82-1	
1,1,1-Trichloroethane	<0.30	ug/L	1.0	0.30	1		04/16/24 22:00	71-55-6	
1,1,2-Trichloroethane	<0.34	ug/L	1.0	0.34	1		04/16/24 22:00	79-00-5	
Trichloroethene	<0.32	ug/L	1.0	0.32	1		04/16/24 22:00	79-01-6	
Trichlorofluoromethane	<0.42	ug/L	1.0	0.42	1		04/16/24 22:00	75-69-4	
1,2,3-Trichloropropane	<0.56	ug/L	1.0	0.56	1		04/16/24 22:00	96-18-4	
1,2,4-Trimethylbenzene	<0.45	ug/L	1.0	0.45	1		04/16/24 22:00	95-63-6	
1,3,5-Trimethylbenzene	<0.36	ug/L	1.0	0.36	1		04/16/24 22:00	108-67-8	
Vinyl chloride	1.1	ug/L	1.0	0.17	1		04/16/24 22:00	75-01-4	
Xylene (Total)	<1.0	ug/L	3.0	1.0	1		04/16/24 22:00	1330-20-7	
m&p-Xylene	<0.70	ug/L	2.0	0.70	1		04/16/24 22:00	179601-23-1	
o-Xylene	<0.35	ug/L	1.0	0.35	1		04/16/24 22:00	95-47-6	
Surrogates									
4-Bromofluorobenzene (S)	99	%	70-130		1		04/16/24 22:00	460-00-4	
1,2-Dichlorobenzene-d4 (S)	92	%	70-130		1		04/16/24 22:00	2199-69-1	
Toluene-d8 (S)	101	%	70-130		1		04/16/24 22:00	2037-26-5	

REPORT OF LABORATORY ANALYSIS

This report shall not be reproduced, except in full, without the written consent of Pace Analytical Services, LLC.



ANALYTICAL RESULTS

Project: 1690005819_Conv One-Hour Valet

Pace Project No.: 40276723

Sample: MW-6 DUP Lab ID: 40276723004 Collected: 04/10/24 09:25 Received: 04/12/24 08:00 Matrix: Water

Parameters	Results	Units	LOQ	LOD	DF	Prepared	Analyzed	CAS No.	Qual
8260 MSV									
Analytical Method: EPA 8260									
Pace Analytical Services - Green Bay									
Benzene	<0.30	ug/L	1.0	0.30	1		04/16/24 22:20	71-43-2	
Bromobenzene	<0.36	ug/L	1.0	0.36	1		04/16/24 22:20	108-86-1	
Bromochloromethane	<0.36	ug/L	1.0	0.36	1		04/16/24 22:20	74-97-5	
Bromodichloromethane	<0.42	ug/L	1.0	0.42	1		04/16/24 22:20	75-27-4	
Bromoform	<0.43	ug/L	1.0	0.43	1		04/16/24 22:20	75-25-2	
Bromomethane	<1.2	ug/L	5.0	1.2	1		04/16/24 22:20	74-83-9	
n-Butylbenzene	<0.86	ug/L	1.0	0.86	1		04/16/24 22:20	104-51-8	
sec-Butylbenzene	<0.42	ug/L	1.0	0.42	1		04/16/24 22:20	135-98-8	
tert-Butylbenzene	<0.59	ug/L	1.0	0.59	1		04/16/24 22:20	98-06-6	
Carbon tetrachloride	<0.37	ug/L	1.0	0.37	1		04/16/24 22:20	56-23-5	
Chlorobenzene	<0.86	ug/L	1.0	0.86	1		04/16/24 22:20	108-90-7	
Chloroethane	<1.4	ug/L	5.0	1.4	1		04/16/24 22:20	75-00-3	
Chloroform	<0.50	ug/L	5.0	0.50	1		04/16/24 22:20	67-66-3	
Chloromethane	<1.6	ug/L	5.0	1.6	1		04/16/24 22:20	74-87-3	
2-Chlorotoluene	<0.89	ug/L	5.0	0.89	1		04/16/24 22:20	95-49-8	
4-Chlorotoluene	<0.89	ug/L	5.0	0.89	1		04/16/24 22:20	106-43-4	
1,2-Dibromo-3-chloropropane	<2.4	ug/L	5.0	2.4	1		04/16/24 22:20	96-12-8	
Dibromochloromethane	<2.6	ug/L	5.0	2.6	1		04/16/24 22:20	124-48-1	
1,2-Dibromoethane (EDB)	<0.31	ug/L	1.0	0.31	1		04/16/24 22:20	106-93-4	
Dibromomethane	<0.99	ug/L	5.0	0.99	1		04/16/24 22:20	74-95-3	
1,2-Dichlorobenzene	<0.33	ug/L	1.0	0.33	1		04/16/24 22:20	95-50-1	
1,3-Dichlorobenzene	<0.35	ug/L	1.0	0.35	1		04/16/24 22:20	541-73-1	
1,4-Dichlorobenzene	<0.89	ug/L	1.0	0.89	1		04/16/24 22:20	106-46-7	
Dichlorodifluoromethane	<0.46	ug/L	5.0	0.46	1		04/16/24 22:20	75-71-8	
1,1-Dichloroethane	<0.30	ug/L	1.0	0.30	1		04/16/24 22:20	75-34-3	
1,2-Dichloroethane	<0.29	ug/L	1.0	0.29	1		04/16/24 22:20	107-06-2	
1,1-Dichloroethene	<0.58	ug/L	1.0	0.58	1		04/16/24 22:20	75-35-4	
cis-1,2-Dichloroethene	2.6	ug/L	1.0	0.47	1		04/16/24 22:20	156-59-2	
trans-1,2-Dichloroethene	<0.53	ug/L	1.0	0.53	1		04/16/24 22:20	156-60-5	
1,2-Dichloropropane	<0.45	ug/L	1.0	0.45	1		04/16/24 22:20	78-87-5	
1,3-Dichloropropane	<0.30	ug/L	1.0	0.30	1		04/16/24 22:20	142-28-9	
2,2-Dichloropropane	<0.42	ug/L	1.0	0.42	1		04/16/24 22:20	594-20-7	
1,1-Dichloropropene	<0.41	ug/L	1.0	0.41	1		04/16/24 22:20	563-58-6	
cis-1,3-Dichloropropene	<0.24	ug/L	1.0	0.24	1		04/16/24 22:20	10061-01-5	
trans-1,3-Dichloropropene	<0.27	ug/L	1.0	0.27	1		04/16/24 22:20	10061-02-6	
Diisopropyl ether	<1.1	ug/L	5.0	1.1	1		04/16/24 22:20	108-20-3	
Ethylbenzene	<0.33	ug/L	1.0	0.33	1		04/16/24 22:20	100-41-4	
Hexachloro-1,3-butadiene	<2.7	ug/L	5.0	2.7	1		04/16/24 22:20	87-68-3	
Isopropylbenzene (Cumene)	<1.0	ug/L	5.0	1.0	1		04/16/24 22:20	98-82-8	
p-Isopropyltoluene	<1.0	ug/L	5.0	1.0	1		04/16/24 22:20	99-87-6	
Methylene Chloride	<0.32	ug/L	5.0	0.32	1		04/16/24 22:20	75-09-2	
Methyl-tert-butyl ether	<1.1	ug/L	5.0	1.1	1		04/16/24 22:20	1634-04-4	
Naphthalene	<1.9	ug/L	5.0	1.9	1		04/16/24 22:20	91-20-3	
n-Propylbenzene	<0.35	ug/L	1.0	0.35	1		04/16/24 22:20	103-65-1	
Styrene	<0.36	ug/L	1.0	0.36	1		04/16/24 22:20	100-42-5	

REPORT OF LABORATORY ANALYSIS

This report shall not be reproduced, except in full,
without the written consent of Pace Analytical Services, LLC.



ANALYTICAL RESULTS

Project: 1690005819_Conv One-Hour Valet

Pace Project No.: 40276723

Sample: MW-6 DUP Lab ID: 40276723004 Collected: 04/10/24 09:25 Received: 04/12/24 08:00 Matrix: Water

Parameters	Results	Units	LOQ	LOD	DF	Prepared	Analyzed	CAS No.	Qual
8260 MSV		Analytical Method: EPA 8260 Pace Analytical Services - Green Bay							
1,1,1,2-Tetrachloroethane	<0.36	ug/L	1.0	0.36	1		04/16/24 22:20	630-20-6	
1,1,1,2-Tetrachloroethane	<0.38	ug/L	1.0	0.38	1		04/16/24 22:20	79-34-5	
Tetrachloroethene	<0.41	ug/L	1.0	0.41	1		04/16/24 22:20	127-18-4	
Toluene	<0.29	ug/L	1.0	0.29	1		04/16/24 22:20	108-88-3	
1,2,3-Trichlorobenzene	<1.0	ug/L	5.0	1.0	1		04/16/24 22:20	87-61-6	
1,2,4-Trichlorobenzene	<0.95	ug/L	5.0	0.95	1		04/16/24 22:20	120-82-1	
1,1,1-Trichloroethane	<0.30	ug/L	1.0	0.30	1		04/16/24 22:20	71-55-6	
1,1,2-Trichloroethane	<0.34	ug/L	1.0	0.34	1		04/16/24 22:20	79-00-5	
Trichloroethene	<0.32	ug/L	1.0	0.32	1		04/16/24 22:20	79-01-6	
Trichlorofluoromethane	<0.42	ug/L	1.0	0.42	1		04/16/24 22:20	75-69-4	
1,2,3-Trichloropropane	<0.56	ug/L	1.0	0.56	1		04/16/24 22:20	96-18-4	
1,2,4-Trimethylbenzene	<0.45	ug/L	1.0	0.45	1		04/16/24 22:20	95-63-6	
1,3,5-Trimethylbenzene	<0.36	ug/L	1.0	0.36	1		04/16/24 22:20	108-67-8	
Vinyl chloride	0.99J	ug/L	1.0	0.17	1		04/16/24 22:20	75-01-4	
Xylene (Total)	<1.0	ug/L	3.0	1.0	1		04/16/24 22:20	1330-20-7	
m&p-Xylene	<0.70	ug/L	2.0	0.70	1		04/16/24 22:20	179601-23-1	
o-Xylene	<0.35	ug/L	1.0	0.35	1		04/16/24 22:20	95-47-6	
Surrogates									
4-Bromofluorobenzene (S)	100	%	70-130		1		04/16/24 22:20	460-00-4	
1,2-Dichlorobenzene-d4 (S)	97	%	70-130		1		04/16/24 22:20	2199-69-1	
Toluene-d8 (S)	101	%	70-130		1		04/16/24 22:20	2037-26-5	

REPORT OF LABORATORY ANALYSIS

This report shall not be reproduced, except in full, without the written consent of Pace Analytical Services, LLC.



ANALYTICAL RESULTS

Project: 1690005819_Conv One-Hour Valet

Pace Project No.: 40276723

Sample: PZ-2R Lab ID: 40276723005 Collected: 04/10/24 10:05 Received: 04/12/24 08:00 Matrix: Water

Parameters	Results	Units	LOQ	LOD	DF	Prepared	Analyzed	CAS No.	Qual
8260 MSV		Analytical Method: EPA 8260 Pace Analytical Services - Green Bay							
Benzene	<0.30	ug/L	1.0	0.30	1		04/16/24 22:39	71-43-2	
Bromobenzene	<0.36	ug/L	1.0	0.36	1		04/16/24 22:39	108-86-1	
Bromochloromethane	<0.36	ug/L	1.0	0.36	1		04/16/24 22:39	74-97-5	
Bromodichloromethane	<0.42	ug/L	1.0	0.42	1		04/16/24 22:39	75-27-4	
Bromoform	<0.43	ug/L	1.0	0.43	1		04/16/24 22:39	75-25-2	
Bromomethane	<1.2	ug/L	5.0	1.2	1		04/16/24 22:39	74-83-9	
n-Butylbenzene	<0.86	ug/L	1.0	0.86	1		04/16/24 22:39	104-51-8	
sec-Butylbenzene	<0.42	ug/L	1.0	0.42	1		04/16/24 22:39	135-98-8	
tert-Butylbenzene	<0.59	ug/L	1.0	0.59	1		04/16/24 22:39	98-06-6	
Carbon tetrachloride	<0.37	ug/L	1.0	0.37	1		04/16/24 22:39	56-23-5	
Chlorobenzene	<0.86	ug/L	1.0	0.86	1		04/16/24 22:39	108-90-7	
Chloroethane	<1.4	ug/L	5.0	1.4	1		04/16/24 22:39	75-00-3	
Chloroform	<0.50	ug/L	5.0	0.50	1		04/16/24 22:39	67-66-3	
Chloromethane	<1.6	ug/L	5.0	1.6	1		04/16/24 22:39	74-87-3	
2-Chlorotoluene	<0.89	ug/L	5.0	0.89	1		04/16/24 22:39	95-49-8	
4-Chlorotoluene	<0.89	ug/L	5.0	0.89	1		04/16/24 22:39	106-43-4	
1,2-Dibromo-3-chloropropane	<2.4	ug/L	5.0	2.4	1		04/16/24 22:39	96-12-8	
Dibromochloromethane	<2.6	ug/L	5.0	2.6	1		04/16/24 22:39	124-48-1	
1,2-Dibromoethane (EDB)	<0.31	ug/L	1.0	0.31	1		04/16/24 22:39	106-93-4	
Dibromomethane	<0.99	ug/L	5.0	0.99	1		04/16/24 22:39	74-95-3	
1,2-Dichlorobenzene	<0.33	ug/L	1.0	0.33	1		04/16/24 22:39	95-50-1	
1,3-Dichlorobenzene	<0.35	ug/L	1.0	0.35	1		04/16/24 22:39	541-73-1	
1,4-Dichlorobenzene	<0.89	ug/L	1.0	0.89	1		04/16/24 22:39	106-46-7	
Dichlorodifluoromethane	<0.46	ug/L	5.0	0.46	1		04/16/24 22:39	75-71-8	
1,1-Dichloroethane	<0.30	ug/L	1.0	0.30	1		04/16/24 22:39	75-34-3	
1,2-Dichloroethane	<0.29	ug/L	1.0	0.29	1		04/16/24 22:39	107-06-2	
1,1-Dichloroethene	<0.58	ug/L	1.0	0.58	1		04/16/24 22:39	75-35-4	
cis-1,2-Dichloroethene	111	ug/L	1.0	0.47	1		04/16/24 22:39	156-59-2	
trans-1,2-Dichloroethene	1.7	ug/L	1.0	0.53	1		04/16/24 22:39	156-60-5	
1,2-Dichloropropane	<0.45	ug/L	1.0	0.45	1		04/16/24 22:39	78-87-5	
1,3-Dichloropropane	<0.30	ug/L	1.0	0.30	1		04/16/24 22:39	142-28-9	
2,2-Dichloropropane	<0.42	ug/L	1.0	0.42	1		04/16/24 22:39	594-20-7	
1,1-Dichloropropene	<0.41	ug/L	1.0	0.41	1		04/16/24 22:39	563-58-6	
cis-1,3-Dichloropropene	<0.24	ug/L	1.0	0.24	1		04/16/24 22:39	10061-01-5	
trans-1,3-Dichloropropene	<0.27	ug/L	1.0	0.27	1		04/16/24 22:39	10061-02-6	
Diisopropyl ether	<1.1	ug/L	5.0	1.1	1		04/16/24 22:39	108-20-3	
Ethylbenzene	<0.33	ug/L	1.0	0.33	1		04/16/24 22:39	100-41-4	
Hexachloro-1,3-butadiene	<2.7	ug/L	5.0	2.7	1		04/16/24 22:39	87-68-3	
Isopropylbenzene (Cumene)	<1.0	ug/L	5.0	1.0	1		04/16/24 22:39	98-82-8	
p-Isopropyltoluene	<1.0	ug/L	5.0	1.0	1		04/16/24 22:39	99-87-6	
Methylene Chloride	<0.32	ug/L	5.0	0.32	1		04/16/24 22:39	75-09-2	
Methyl-tert-butyl ether	<1.1	ug/L	5.0	1.1	1		04/16/24 22:39	1634-04-4	
Naphthalene	<1.9	ug/L	5.0	1.9	1		04/16/24 22:39	91-20-3	
n-Propylbenzene	<0.35	ug/L	1.0	0.35	1		04/16/24 22:39	103-65-1	
Styrene	<0.36	ug/L	1.0	0.36	1		04/16/24 22:39	100-42-5	

REPORT OF LABORATORY ANALYSIS

This report shall not be reproduced, except in full,
without the written consent of Pace Analytical Services, LLC.



ANALYTICAL RESULTS

Project: 1690005819_Conv One-Hour Valet

Pace Project No.: 40276723

Sample: PZ-2R Lab ID: 40276723005 Collected: 04/10/24 10:05 Received: 04/12/24 08:00 Matrix: Water

Parameters	Results	Units	LOQ	LOD	DF	Prepared	Analyzed	CAS No.	Qual
8260 MSV		Analytical Method: EPA 8260 Pace Analytical Services - Green Bay							
1,1,1,2-Tetrachloroethane	<0.36	ug/L	1.0	0.36	1		04/16/24 22:39	630-20-6	
1,1,2,2-Tetrachloroethane	<0.38	ug/L	1.0	0.38	1		04/16/24 22:39	79-34-5	
Tetrachloroethene	<0.41	ug/L	1.0	0.41	1		04/16/24 22:39	127-18-4	
Toluene	<0.29	ug/L	1.0	0.29	1		04/16/24 22:39	108-88-3	
1,2,3-Trichlorobenzene	<1.0	ug/L	5.0	1.0	1		04/16/24 22:39	87-61-6	
1,2,4-Trichlorobenzene	<0.95	ug/L	5.0	0.95	1		04/16/24 22:39	120-82-1	
1,1,1-Trichloroethane	<0.30	ug/L	1.0	0.30	1		04/16/24 22:39	71-55-6	
1,1,2-Trichloroethane	<0.34	ug/L	1.0	0.34	1		04/16/24 22:39	79-00-5	
Trichloroethene	<0.32	ug/L	1.0	0.32	1		04/16/24 22:39	79-01-6	
Trichlorofluoromethane	<0.42	ug/L	1.0	0.42	1		04/16/24 22:39	75-69-4	
1,2,3-Trichloropropane	<0.56	ug/L	1.0	0.56	1		04/16/24 22:39	96-18-4	
1,2,4-Trimethylbenzene	<0.45	ug/L	1.0	0.45	1		04/16/24 22:39	95-63-6	
1,3,5-Trimethylbenzene	<0.36	ug/L	1.0	0.36	1		04/16/24 22:39	108-67-8	
Vinyl chloride	12.8	ug/L	1.0	0.17	1		04/16/24 22:39	75-01-4	
Xylene (Total)	<1.0	ug/L	3.0	1.0	1		04/16/24 22:39	1330-20-7	
m&p-Xylene	<0.70	ug/L	2.0	0.70	1		04/16/24 22:39	179601-23-1	
o-Xylene	<0.35	ug/L	1.0	0.35	1		04/16/24 22:39	95-47-6	
Surrogates									
4-Bromofluorobenzene (S)	100	%	70-130		1		04/16/24 22:39	460-00-4	
1,2-Dichlorobenzene-d4 (S)	97	%	70-130		1		04/16/24 22:39	2199-69-1	
Toluene-d8 (S)	103	%	70-130		1		04/16/24 22:39	2037-26-5	

REPORT OF LABORATORY ANALYSIS

This report shall not be reproduced, except in full, without the written consent of Pace Analytical Services, LLC.



ANALYTICAL RESULTS

Project: 1690005819_Conv One-Hour Valet

Pace Project No.: 40276723

Sample: MW-5 Lab ID: 40276723006 Collected: 04/10/24 11:25 Received: 04/12/24 08:00 Matrix: Water

Parameters	Results	Units	LOQ	LOD	DF	Prepared	Analyzed	CAS No.	Qual
8260 MSV									
Analytical Method: EPA 8260									
Pace Analytical Services - Green Bay									
Benzene	<0.30	ug/L	1.0	0.30	1		04/17/24 09:13	71-43-2	
Bromobenzene	<0.36	ug/L	1.0	0.36	1		04/17/24 09:13	108-86-1	
Bromochloromethane	<0.36	ug/L	1.0	0.36	1		04/17/24 09:13	74-97-5	
Bromodichloromethane	<0.42	ug/L	1.0	0.42	1		04/17/24 09:13	75-27-4	
Bromoform	<0.43	ug/L	1.0	0.43	1		04/17/24 09:13	75-25-2	
Bromomethane	<1.2	ug/L	5.0	1.2	1		04/17/24 09:13	74-83-9	
n-Butylbenzene	<0.86	ug/L	1.0	0.86	1		04/17/24 09:13	104-51-8	
sec-Butylbenzene	<0.42	ug/L	1.0	0.42	1		04/17/24 09:13	135-98-8	
tert-Butylbenzene	<0.59	ug/L	1.0	0.59	1		04/17/24 09:13	98-06-6	
Carbon tetrachloride	<0.37	ug/L	1.0	0.37	1		04/17/24 09:13	56-23-5	
Chlorobenzene	<0.86	ug/L	1.0	0.86	1		04/17/24 09:13	108-90-7	
Chloroethane	<1.4	ug/L	5.0	1.4	1		04/17/24 09:13	75-00-3	
Chloroform	<0.50	ug/L	5.0	0.50	1		04/17/24 09:13	67-66-3	
Chloromethane	<1.6	ug/L	5.0	1.6	1		04/17/24 09:13	74-87-3	
2-Chlorotoluene	<0.89	ug/L	5.0	0.89	1		04/17/24 09:13	95-49-8	
4-Chlorotoluene	<0.89	ug/L	5.0	0.89	1		04/17/24 09:13	106-43-4	
1,2-Dibromo-3-chloropropane	<2.4	ug/L	5.0	2.4	1		04/17/24 09:13	96-12-8	
Dibromochloromethane	<2.6	ug/L	5.0	2.6	1		04/17/24 09:13	124-48-1	
1,2-Dibromoethane (EDB)	<0.31	ug/L	1.0	0.31	1		04/17/24 09:13	106-93-4	
Dibromomethane	<0.99	ug/L	5.0	0.99	1		04/17/24 09:13	74-95-3	
1,2-Dichlorobenzene	<0.33	ug/L	1.0	0.33	1		04/17/24 09:13	95-50-1	
1,3-Dichlorobenzene	<0.35	ug/L	1.0	0.35	1		04/17/24 09:13	541-73-1	
1,4-Dichlorobenzene	<0.89	ug/L	1.0	0.89	1		04/17/24 09:13	106-46-7	
Dichlorodifluoromethane	<0.46	ug/L	5.0	0.46	1		04/17/24 09:13	75-71-8	
1,1-Dichloroethane	<0.30	ug/L	1.0	0.30	1		04/17/24 09:13	75-34-3	
1,2-Dichloroethane	<0.29	ug/L	1.0	0.29	1		04/17/24 09:13	107-06-2	
1,1-Dichloroethene	<0.58	ug/L	1.0	0.58	1		04/17/24 09:13	75-35-4	
cis-1,2-Dichloroethene	0.87J	ug/L	1.0	0.47	1		04/17/24 09:13	156-59-2	
trans-1,2-Dichloroethene	<0.53	ug/L	1.0	0.53	1		04/17/24 09:13	156-60-5	
1,2-Dichloropropane	<0.45	ug/L	1.0	0.45	1		04/17/24 09:13	78-87-5	
1,3-Dichloropropane	<0.30	ug/L	1.0	0.30	1		04/17/24 09:13	142-28-9	
2,2-Dichloropropane	<0.42	ug/L	1.0	0.42	1		04/17/24 09:13	594-20-7	
1,1-Dichloropropene	<0.41	ug/L	1.0	0.41	1		04/17/24 09:13	563-58-6	
cis-1,3-Dichloropropene	<0.24	ug/L	1.0	0.24	1		04/17/24 09:13	10061-01-5	
trans-1,3-Dichloropropene	<0.27	ug/L	1.0	0.27	1		04/17/24 09:13	10061-02-6	
Diisopropyl ether	<1.1	ug/L	5.0	1.1	1		04/17/24 09:13	108-20-3	
Ethylbenzene	<0.33	ug/L	1.0	0.33	1		04/17/24 09:13	100-41-4	
Hexachloro-1,3-butadiene	<2.7	ug/L	5.0	2.7	1		04/17/24 09:13	87-68-3	
Isopropylbenzene (Cumene)	<1.0	ug/L	5.0	1.0	1		04/17/24 09:13	98-82-8	
p-Isopropyltoluene	<1.0	ug/L	5.0	1.0	1		04/17/24 09:13	99-87-6	
Methylene Chloride	<0.32	ug/L	5.0	0.32	1		04/17/24 09:13	75-09-2	
Methyl-tert-butyl ether	<1.1	ug/L	5.0	1.1	1		04/17/24 09:13	1634-04-4	
Naphthalene	<1.9	ug/L	5.0	1.9	1		04/17/24 09:13	91-20-3	
n-Propylbenzene	<0.35	ug/L	1.0	0.35	1		04/17/24 09:13	103-65-1	
Styrene	<0.36	ug/L	1.0	0.36	1		04/17/24 09:13	100-42-5	

REPORT OF LABORATORY ANALYSIS

This report shall not be reproduced, except in full,
without the written consent of Pace Analytical Services, LLC.



ANALYTICAL RESULTS

Project: 1690005819_Conv One-Hour Valet

Pace Project No.: 40276723

Sample: MW-5 Lab ID: 40276723006 Collected: 04/10/24 11:25 Received: 04/12/24 08:00 Matrix: Water

Parameters	Results	Units	LOQ	LOD	DF	Prepared	Analyzed	CAS No.	Qual
8260 MSV									
Analytical Method: EPA 8260									
Pace Analytical Services - Green Bay									
1,1,1,2-Tetrachloroethane	<0.36	ug/L	1.0	0.36	1		04/17/24 09:13	630-20-6	
1,1,1,2-Tetrachloroethane	<0.38	ug/L	1.0	0.38	1		04/17/24 09:13	79-34-5	
Tetrachloroethene	13.8	ug/L	1.0	0.41	1		04/17/24 09:13	127-18-4	
Toluene	<0.29	ug/L	1.0	0.29	1		04/17/24 09:13	108-88-3	
1,2,3-Trichlorobenzene	<1.0	ug/L	5.0	1.0	1		04/17/24 09:13	87-61-6	
1,2,4-Trichlorobenzene	<0.95	ug/L	5.0	0.95	1		04/17/24 09:13	120-82-1	
1,1,1-Trichloroethane	<0.30	ug/L	1.0	0.30	1		04/17/24 09:13	71-55-6	
1,1,2-Trichloroethane	<0.34	ug/L	1.0	0.34	1		04/17/24 09:13	79-00-5	
Trichloroethene	2.0	ug/L	1.0	0.32	1		04/17/24 09:13	79-01-6	
Trichlorofluoromethane	<0.42	ug/L	1.0	0.42	1		04/17/24 09:13	75-69-4	
1,2,3-Trichloropropane	<0.56	ug/L	1.0	0.56	1		04/17/24 09:13	96-18-4	
1,2,4-Trimethylbenzene	<0.45	ug/L	1.0	0.45	1		04/17/24 09:13	95-63-6	
1,3,5-Trimethylbenzene	<0.36	ug/L	1.0	0.36	1		04/17/24 09:13	108-67-8	
Vinyl chloride	<0.17	ug/L	1.0	0.17	1		04/17/24 09:13	75-01-4	
Xylene (Total)	<1.0	ug/L	3.0	1.0	1		04/17/24 09:13	1330-20-7	
m&p-Xylene	<0.70	ug/L	2.0	0.70	1		04/17/24 09:13	179601-23-1	
o-Xylene	<0.35	ug/L	1.0	0.35	1		04/17/24 09:13	95-47-6	
Surrogates									
4-Bromofluorobenzene (S)	105	%	70-130		1		04/17/24 09:13	460-00-4	
1,2-Dichlorobenzene-d4 (S)	95	%	70-130		1		04/17/24 09:13	2199-69-1	
Toluene-d8 (S)	102	%	70-130		1		04/17/24 09:13	2037-26-5	

REPORT OF LABORATORY ANALYSIS

This report shall not be reproduced, except in full,
without the written consent of Pace Analytical Services, LLC.



ANALYTICAL RESULTS

Project: 1690005819_Conv One-Hour Valet

Pace Project No.: 40276723

Sample: PZ-4 Lab ID: 40276723007 Collected: 04/10/24 12:06 Received: 04/12/24 08:00 Matrix: Water

Parameters	Results	Units	LOQ	LOD	DF	Prepared	Analyzed	CAS No.	Qual
8260 MSV									
Analytical Method: EPA 8260									
Pace Analytical Services - Green Bay									
Benzene	<0.30	ug/L	1.0	0.30	1		04/16/24 23:19	71-43-2	
Bromobenzene	<0.36	ug/L	1.0	0.36	1		04/16/24 23:19	108-86-1	
Bromochloromethane	<0.36	ug/L	1.0	0.36	1		04/16/24 23:19	74-97-5	
Bromodichloromethane	<0.42	ug/L	1.0	0.42	1		04/16/24 23:19	75-27-4	
Bromoform	<0.43	ug/L	1.0	0.43	1		04/16/24 23:19	75-25-2	
Bromomethane	<1.2	ug/L	5.0	1.2	1		04/16/24 23:19	74-83-9	
n-Butylbenzene	<0.86	ug/L	1.0	0.86	1		04/16/24 23:19	104-51-8	
sec-Butylbenzene	<0.42	ug/L	1.0	0.42	1		04/16/24 23:19	135-98-8	
tert-Butylbenzene	<0.59	ug/L	1.0	0.59	1		04/16/24 23:19	98-06-6	
Carbon tetrachloride	<0.37	ug/L	1.0	0.37	1		04/16/24 23:19	56-23-5	
Chlorobenzene	<0.86	ug/L	1.0	0.86	1		04/16/24 23:19	108-90-7	
Chloroethane	<1.4	ug/L	5.0	1.4	1		04/16/24 23:19	75-00-3	
Chloroform	<0.50	ug/L	5.0	0.50	1		04/16/24 23:19	67-66-3	
Chloromethane	<1.6	ug/L	5.0	1.6	1		04/16/24 23:19	74-87-3	
2-Chlorotoluene	<0.89	ug/L	5.0	0.89	1		04/16/24 23:19	95-49-8	
4-Chlorotoluene	<0.89	ug/L	5.0	0.89	1		04/16/24 23:19	106-43-4	
1,2-Dibromo-3-chloropropane	<2.4	ug/L	5.0	2.4	1		04/16/24 23:19	96-12-8	
Dibromochloromethane	<2.6	ug/L	5.0	2.6	1		04/16/24 23:19	124-48-1	
1,2-Dibromoethane (EDB)	<0.31	ug/L	1.0	0.31	1		04/16/24 23:19	106-93-4	
Dibromomethane	<0.99	ug/L	5.0	0.99	1		04/16/24 23:19	74-95-3	
1,2-Dichlorobenzene	<0.33	ug/L	1.0	0.33	1		04/16/24 23:19	95-50-1	
1,3-Dichlorobenzene	<0.35	ug/L	1.0	0.35	1		04/16/24 23:19	541-73-1	
1,4-Dichlorobenzene	<0.89	ug/L	1.0	0.89	1		04/16/24 23:19	106-46-7	
Dichlorodifluoromethane	<0.46	ug/L	5.0	0.46	1		04/16/24 23:19	75-71-8	
1,1-Dichloroethane	<0.30	ug/L	1.0	0.30	1		04/16/24 23:19	75-34-3	
1,2-Dichloroethane	<0.29	ug/L	1.0	0.29	1		04/16/24 23:19	107-06-2	
1,1-Dichloroethene	<0.58	ug/L	1.0	0.58	1		04/16/24 23:19	75-35-4	
cis-1,2-Dichloroethene	<0.47	ug/L	1.0	0.47	1		04/16/24 23:19	156-59-2	
trans-1,2-Dichloroethene	<0.53	ug/L	1.0	0.53	1		04/16/24 23:19	156-60-5	
1,2-Dichloropropane	<0.45	ug/L	1.0	0.45	1		04/16/24 23:19	78-87-5	
1,3-Dichloropropane	<0.30	ug/L	1.0	0.30	1		04/16/24 23:19	142-28-9	
2,2-Dichloropropane	<0.42	ug/L	1.0	0.42	1		04/16/24 23:19	594-20-7	
1,1-Dichloropropene	<0.41	ug/L	1.0	0.41	1		04/16/24 23:19	563-58-6	
cis-1,3-Dichloropropene	<0.24	ug/L	1.0	0.24	1		04/16/24 23:19	10061-01-5	
trans-1,3-Dichloropropene	<0.27	ug/L	1.0	0.27	1		04/16/24 23:19	10061-02-6	
Diisopropyl ether	<1.1	ug/L	5.0	1.1	1		04/16/24 23:19	108-20-3	
Ethylbenzene	<0.33	ug/L	1.0	0.33	1		04/16/24 23:19	100-41-4	
Hexachloro-1,3-butadiene	<2.7	ug/L	5.0	2.7	1		04/16/24 23:19	87-68-3	
Isopropylbenzene (Cumene)	<1.0	ug/L	5.0	1.0	1		04/16/24 23:19	98-82-8	
p-Isopropyltoluene	<1.0	ug/L	5.0	1.0	1		04/16/24 23:19	99-87-6	
Methylene Chloride	<0.32	ug/L	5.0	0.32	1		04/16/24 23:19	75-09-2	
Methyl-tert-butyl ether	<1.1	ug/L	5.0	1.1	1		04/16/24 23:19	1634-04-4	
Naphthalene	<1.9	ug/L	5.0	1.9	1		04/16/24 23:19	91-20-3	
n-Propylbenzene	<0.35	ug/L	1.0	0.35	1		04/16/24 23:19	103-65-1	
Styrene	<0.36	ug/L	1.0	0.36	1		04/16/24 23:19	100-42-5	

REPORT OF LABORATORY ANALYSIS

This report shall not be reproduced, except in full,
without the written consent of Pace Analytical Services, LLC.



ANALYTICAL RESULTS

Project: 1690005819_Conv One-Hour Valet

Pace Project No.: 40276723

Sample: PZ-4 Lab ID: 40276723007 Collected: 04/10/24 12:06 Received: 04/12/24 08:00 Matrix: Water

Parameters	Results	Units	LOQ	LOD	DF	Prepared	Analyzed	CAS No.	Qual
8260 MSV		Analytical Method: EPA 8260 Pace Analytical Services - Green Bay							
1,1,1,2-Tetrachloroethane	<0.36	ug/L	1.0	0.36	1		04/16/24 23:19	630-20-6	
1,1,1,2-Tetrachloroethane	<0.38	ug/L	1.0	0.38	1		04/16/24 23:19	79-34-5	
Tetrachloroethene	<0.41	ug/L	1.0	0.41	1		04/16/24 23:19	127-18-4	
Toluene	<0.29	ug/L	1.0	0.29	1		04/16/24 23:19	108-88-3	
1,2,3-Trichlorobenzene	<1.0	ug/L	5.0	1.0	1		04/16/24 23:19	87-61-6	
1,2,4-Trichlorobenzene	<0.95	ug/L	5.0	0.95	1		04/16/24 23:19	120-82-1	
1,1,1-Trichloroethane	<0.30	ug/L	1.0	0.30	1		04/16/24 23:19	71-55-6	
1,1,2-Trichloroethane	<0.34	ug/L	1.0	0.34	1		04/16/24 23:19	79-00-5	
Trichloroethene	<0.32	ug/L	1.0	0.32	1		04/16/24 23:19	79-01-6	
Trichlorofluoromethane	<0.42	ug/L	1.0	0.42	1		04/16/24 23:19	75-69-4	
1,2,3-Trichloropropane	<0.56	ug/L	1.0	0.56	1		04/16/24 23:19	96-18-4	
1,2,4-Trimethylbenzene	<0.45	ug/L	1.0	0.45	1		04/16/24 23:19	95-63-6	
1,3,5-Trimethylbenzene	<0.36	ug/L	1.0	0.36	1		04/16/24 23:19	108-67-8	
Vinyl chloride	4.6	ug/L	1.0	0.17	1		04/16/24 23:19	75-01-4	
Xylene (Total)	<1.0	ug/L	3.0	1.0	1		04/16/24 23:19	1330-20-7	
m&p-Xylene	<0.70	ug/L	2.0	0.70	1		04/16/24 23:19	179601-23-1	
o-Xylene	<0.35	ug/L	1.0	0.35	1		04/16/24 23:19	95-47-6	
Surrogates									
4-Bromofluorobenzene (S)	97	%	70-130		1		04/16/24 23:19	460-00-4	
1,2-Dichlorobenzene-d4 (S)	92	%	70-130		1		04/16/24 23:19	2199-69-1	
Toluene-d8 (S)	102	%	70-130		1		04/16/24 23:19	2037-26-5	

REPORT OF LABORATORY ANALYSIS

This report shall not be reproduced, except in full, without the written consent of Pace Analytical Services, LLC.



ANALYTICAL RESULTS

Project: 1690005819_Conv One-Hour Valet

Pace Project No.: 40276723

Sample: MW-4 Lab ID: 40276723008 Collected: 04/10/24 12:52 Received: 04/12/24 08:00 Matrix: Water

Parameters	Results	Units	LOQ	LOD	DF	Prepared	Analyzed	CAS No.	Qual
8260 MSV									
Analytical Method: EPA 8260									
Pace Analytical Services - Green Bay									
Benzene	<0.30	ug/L	1.0	0.30	1		04/16/24 23:38	71-43-2	
Bromobenzene	<0.36	ug/L	1.0	0.36	1		04/16/24 23:38	108-86-1	
Bromochloromethane	<0.36	ug/L	1.0	0.36	1		04/16/24 23:38	74-97-5	
Bromodichloromethane	<0.42	ug/L	1.0	0.42	1		04/16/24 23:38	75-27-4	
Bromoform	<0.43	ug/L	1.0	0.43	1		04/16/24 23:38	75-25-2	
Bromomethane	<1.2	ug/L	5.0	1.2	1		04/16/24 23:38	74-83-9	
n-Butylbenzene	<0.86	ug/L	1.0	0.86	1		04/16/24 23:38	104-51-8	
sec-Butylbenzene	<0.42	ug/L	1.0	0.42	1		04/16/24 23:38	135-98-8	
tert-Butylbenzene	<0.59	ug/L	1.0	0.59	1		04/16/24 23:38	98-06-6	
Carbon tetrachloride	<0.37	ug/L	1.0	0.37	1		04/16/24 23:38	56-23-5	
Chlorobenzene	<0.86	ug/L	1.0	0.86	1		04/16/24 23:38	108-90-7	
Chloroethane	<1.4	ug/L	5.0	1.4	1		04/16/24 23:38	75-00-3	
Chloroform	<0.50	ug/L	5.0	0.50	1		04/16/24 23:38	67-66-3	
Chloromethane	<1.6	ug/L	5.0	1.6	1		04/16/24 23:38	74-87-3	
2-Chlorotoluene	<0.89	ug/L	5.0	0.89	1		04/16/24 23:38	95-49-8	
4-Chlorotoluene	<0.89	ug/L	5.0	0.89	1		04/16/24 23:38	106-43-4	
1,2-Dibromo-3-chloropropane	<2.4	ug/L	5.0	2.4	1		04/16/24 23:38	96-12-8	
Dibromochloromethane	<2.6	ug/L	5.0	2.6	1		04/16/24 23:38	124-48-1	
1,2-Dibromoethane (EDB)	<0.31	ug/L	1.0	0.31	1		04/16/24 23:38	106-93-4	
Dibromomethane	<0.99	ug/L	5.0	0.99	1		04/16/24 23:38	74-95-3	
1,2-Dichlorobenzene	<0.33	ug/L	1.0	0.33	1		04/16/24 23:38	95-50-1	
1,3-Dichlorobenzene	<0.35	ug/L	1.0	0.35	1		04/16/24 23:38	541-73-1	
1,4-Dichlorobenzene	<0.89	ug/L	1.0	0.89	1		04/16/24 23:38	106-46-7	
Dichlorodifluoromethane	<0.46	ug/L	5.0	0.46	1		04/16/24 23:38	75-71-8	
1,1-Dichloroethane	<0.30	ug/L	1.0	0.30	1		04/16/24 23:38	75-34-3	
1,2-Dichloroethane	<0.29	ug/L	1.0	0.29	1		04/16/24 23:38	107-06-2	
1,1-Dichloroethene	<0.58	ug/L	1.0	0.58	1		04/16/24 23:38	75-35-4	
cis-1,2-Dichloroethene	<0.47	ug/L	1.0	0.47	1		04/16/24 23:38	156-59-2	
trans-1,2-Dichloroethene	<0.53	ug/L	1.0	0.53	1		04/16/24 23:38	156-60-5	
1,2-Dichloropropane	<0.45	ug/L	1.0	0.45	1		04/16/24 23:38	78-87-5	
1,3-Dichloropropane	<0.30	ug/L	1.0	0.30	1		04/16/24 23:38	142-28-9	
2,2-Dichloropropane	<0.42	ug/L	1.0	0.42	1		04/16/24 23:38	594-20-7	
1,1-Dichloropropene	<0.41	ug/L	1.0	0.41	1		04/16/24 23:38	563-58-6	
cis-1,3-Dichloropropene	<0.24	ug/L	1.0	0.24	1		04/16/24 23:38	10061-01-5	
trans-1,3-Dichloropropene	<0.27	ug/L	1.0	0.27	1		04/16/24 23:38	10061-02-6	
Diisopropyl ether	<1.1	ug/L	5.0	1.1	1		04/16/24 23:38	108-20-3	
Ethylbenzene	<0.33	ug/L	1.0	0.33	1		04/16/24 23:38	100-41-4	
Hexachloro-1,3-butadiene	<2.7	ug/L	5.0	2.7	1		04/16/24 23:38	87-68-3	
Isopropylbenzene (Cumene)	<1.0	ug/L	5.0	1.0	1		04/16/24 23:38	98-82-8	
p-Isopropyltoluene	<1.0	ug/L	5.0	1.0	1		04/16/24 23:38	99-87-6	
Methylene Chloride	<0.32	ug/L	5.0	0.32	1		04/16/24 23:38	75-09-2	
Methyl-tert-butyl ether	<1.1	ug/L	5.0	1.1	1		04/16/24 23:38	1634-04-4	
Naphthalene	<1.9	ug/L	5.0	1.9	1		04/16/24 23:38	91-20-3	
n-Propylbenzene	<0.35	ug/L	1.0	0.35	1		04/16/24 23:38	103-65-1	
Styrene	<0.36	ug/L	1.0	0.36	1		04/16/24 23:38	100-42-5	

REPORT OF LABORATORY ANALYSIS

This report shall not be reproduced, except in full,
without the written consent of Pace Analytical Services, LLC.



ANALYTICAL RESULTS

Project: 1690005819_Conv One-Hour Valet

Pace Project No.: 40276723

Sample: MW-4 Lab ID: 40276723008 Collected: 04/10/24 12:52 Received: 04/12/24 08:00 Matrix: Water

Parameters	Results	Units	LOQ	LOD	DF	Prepared	Analyzed	CAS No.	Qual
8260 MSV									
Analytical Method: EPA 8260									
Pace Analytical Services - Green Bay									
1,1,1,2-Tetrachloroethane	<0.36	ug/L	1.0	0.36	1		04/16/24 23:38	630-20-6	
1,1,2,2-Tetrachloroethane	<0.38	ug/L	1.0	0.38	1		04/16/24 23:38	79-34-5	
Tetrachloroethene	79.5	ug/L	1.0	0.41	1		04/16/24 23:38	127-18-4	
Toluene	<0.29	ug/L	1.0	0.29	1		04/16/24 23:38	108-88-3	
1,2,3-Trichlorobenzene	<1.0	ug/L	5.0	1.0	1		04/16/24 23:38	87-61-6	
1,2,4-Trichlorobenzene	<0.95	ug/L	5.0	0.95	1		04/16/24 23:38	120-82-1	
1,1,1-Trichloroethane	<0.30	ug/L	1.0	0.30	1		04/16/24 23:38	71-55-6	
1,1,2-Trichloroethane	<0.34	ug/L	1.0	0.34	1		04/16/24 23:38	79-00-5	
Trichloroethene	0.84J	ug/L	1.0	0.32	1		04/16/24 23:38	79-01-6	
Trichlorofluoromethane	<0.42	ug/L	1.0	0.42	1		04/16/24 23:38	75-69-4	
1,2,3-Trichloropropane	<0.56	ug/L	1.0	0.56	1		04/16/24 23:38	96-18-4	
1,2,4-Trimethylbenzene	<0.45	ug/L	1.0	0.45	1		04/16/24 23:38	95-63-6	
1,3,5-Trimethylbenzene	<0.36	ug/L	1.0	0.36	1		04/16/24 23:38	108-67-8	
Vinyl chloride	<0.17	ug/L	1.0	0.17	1		04/16/24 23:38	75-01-4	
Xylene (Total)	<1.0	ug/L	3.0	1.0	1		04/16/24 23:38	1330-20-7	
m&p-Xylene	<0.70	ug/L	2.0	0.70	1		04/16/24 23:38	179601-23-1	
o-Xylene	<0.35	ug/L	1.0	0.35	1		04/16/24 23:38	95-47-6	
Surrogates									
4-Bromofluorobenzene (S)	101	%	70-130		1		04/16/24 23:38	460-00-4	
1,2-Dichlorobenzene-d4 (S)	96	%	70-130		1		04/16/24 23:38	2199-69-1	
Toluene-d8 (S)	104	%	70-130		1		04/16/24 23:38	2037-26-5	

REPORT OF LABORATORY ANALYSIS

This report shall not be reproduced, except in full, without the written consent of Pace Analytical Services, LLC.



ANALYTICAL RESULTS

Project: 1690005819_Conv One-Hour Valet

Pace Project No.: 40276723

Sample: PZ-1R Lab ID: 40276723009 Collected: 04/10/24 14:05 Received: 04/12/24 08:00 Matrix: Water

Parameters	Results	Units	LOQ	LOD	DF	Prepared	Analyzed	CAS No.	Qual
Methane, Ethane, Ethene GCV									
Analytical Method: EPA 8015B Modified									
Pace Analytical Services - Green Bay									
Ethane	283	ug/L	5.6	0.39	1		04/19/24 12:22	74-84-0	
Ethene	3720	ug/L	1000	50.4	200		04/19/24 13:10	74-85-1	
Methane	9410	ug/L	560	115	200		04/19/24 13:10	74-82-8	
6020B MET ICPMS, Dissolved									
Analytical Method: EPA 6020B Preparation Method: EPA 3010A									
Pace Analytical Services - Green Bay									
Iron, Dissolved	13200	ug/L	5000	1160	20	04/15/24 06:43	04/17/24 19:59	7439-89-6	
8260 MSV									
Analytical Method: EPA 8260									
Pace Analytical Services - Green Bay									
Benzene	<148	ug/L	500	148	500		04/17/24 00:17	71-43-2	
Bromobenzene	<180	ug/L	500	180	500		04/17/24 00:17	108-86-1	
Bromochloromethane	<179	ug/L	500	179	500		04/17/24 00:17	74-97-5	
Bromodichloromethane	<208	ug/L	500	208	500		04/17/24 00:17	75-27-4	
Bromoform	<214	ug/L	500	214	500		04/17/24 00:17	75-25-2	
Bromomethane	<596	ug/L	2500	596	500		04/17/24 00:17	74-83-9	
n-Butylbenzene	<429	ug/L	500	429	500		04/17/24 00:17	104-51-8	
sec-Butylbenzene	<212	ug/L	500	212	500		04/17/24 00:17	135-98-8	
tert-Butylbenzene	<293	ug/L	500	293	500		04/17/24 00:17	98-06-6	
Carbon tetrachloride	<185	ug/L	500	185	500		04/17/24 00:17	56-23-5	
Chlorobenzene	<428	ug/L	500	428	500		04/17/24 00:17	108-90-7	
Chloroethane	<690	ug/L	2500	690	500		04/17/24 00:17	75-00-3	
Chloroform	<252	ug/L	2500	252	500		04/17/24 00:17	67-66-3	
Chloromethane	<818	ug/L	2500	818	500		04/17/24 00:17	74-87-3	
2-Chlorotoluene	<445	ug/L	2500	445	500		04/17/24 00:17	95-49-8	
4-Chlorotoluene	<447	ug/L	2500	447	500		04/17/24 00:17	106-43-4	
1,2-Dibromo-3-chloropropane	<1180	ug/L	2500	1180	500		04/17/24 00:17	96-12-8	
Dibromochloromethane	<1320	ug/L	2500	1320	500		04/17/24 00:17	124-48-1	
1,2-Dibromoethane (EDB)	<155	ug/L	500	155	500		04/17/24 00:17	106-93-4	
Dibromomethane	<495	ug/L	2500	495	500		04/17/24 00:17	74-95-3	
1,2-Dichlorobenzene	<163	ug/L	500	163	500		04/17/24 00:17	95-50-1	
1,3-Dichlorobenzene	<176	ug/L	500	176	500		04/17/24 00:17	541-73-1	
1,4-Dichlorobenzene	<446	ug/L	500	446	500		04/17/24 00:17	106-46-7	
Dichlorodifluoromethane	<228	ug/L	2500	228	500		04/17/24 00:17	75-71-8	
1,1-Dichloroethane	<148	ug/L	500	148	500		04/17/24 00:17	75-34-3	
1,2-Dichloroethane	<146	ug/L	500	146	500		04/17/24 00:17	107-06-2	
1,1-Dichloroethene	<291	ug/L	500	291	500		04/17/24 00:17	75-35-4	
cis-1,2-Dichloroethene	66300	ug/L	500	236	500		04/17/24 00:17	156-59-2	
trans-1,2-Dichloroethene	<264	ug/L	500	264	500		04/17/24 00:17	156-60-5	
1,2-Dichloropropane	<224	ug/L	500	224	500		04/17/24 00:17	78-87-5	
1,3-Dichloropropane	<152	ug/L	500	152	500		04/17/24 00:17	142-28-9	
2,2-Dichloropropane	<209	ug/L	500	209	500		04/17/24 00:17	594-20-7	
1,1-Dichloropropene	<205	ug/L	500	205	500		04/17/24 00:17	563-58-6	
cis-1,3-Dichloropropene	<119	ug/L	500	119	500		04/17/24 00:17	10061-01-5	
trans-1,3-Dichloropropene	<133	ug/L	500	133	500		04/17/24 00:17	10061-02-6	

REPORT OF LABORATORY ANALYSIS

This report shall not be reproduced, except in full,
without the written consent of Pace Analytical Services, LLC.



ANALYTICAL RESULTS

Project: 1690005819_Conv One-Hour Valet

Project No.: 40276723

Sample: PZ-1R Lab ID: 40276723009 Collected: 04/10/24 14:05 Received: 04/12/24 08:00 Matrix: Water

Parameters	Results	Units	LOQ	LOD	DF	Prepared	Analyzed	CAS No.	Qual
8260 MSV									
Analytical Method: EPA 8260									
Pace Analytical Services - Green Bay									
Diisopropyl ether	<550	ug/L	2500	550	500		04/17/24 00:17	108-20-3	
Ethylbenzene	<163	ug/L	500	163	500		04/17/24 00:17	100-41-4	
Hexachloro-1,3-butadiene	<1370	ug/L	2500	1370	500		04/17/24 00:17	87-68-3	
Isopropylbenzene (Cumene)	<500	ug/L	2500	500	500		04/17/24 00:17	98-82-8	
p-Isopropyltoluene	<522	ug/L	2500	522	500		04/17/24 00:17	99-87-6	
Methylene Chloride	<160	ug/L	2500	160	500		04/17/24 00:17	75-09-2	
Methyl-tert-butyl ether	<565	ug/L	2500	565	500		04/17/24 00:17	1634-04-4	
Naphthalene	<959	ug/L	2500	959	500		04/17/24 00:17	91-20-3	
n-Propylbenzene	<173	ug/L	500	173	500		04/17/24 00:17	103-65-1	
Styrene	<178	ug/L	500	178	500		04/17/24 00:17	100-42-5	
1,1,1,2-Tetrachloroethane	<178	ug/L	500	178	500		04/17/24 00:17	630-20-6	
1,1,2,2-Tetrachloroethane	<189	ug/L	500	189	500		04/17/24 00:17	79-34-5	
Tetrachloroethene	460J	ug/L	500	204	500		04/17/24 00:17	127-18-4	
Toluene	<144	ug/L	500	144	500		04/17/24 00:17	108-88-3	
1,2,3-Trichlorobenzene	<509	ug/L	2500	509	500		04/17/24 00:17	87-61-6	
1,2,4-Trichlorobenzene	<475	ug/L	2500	475	500		04/17/24 00:17	120-82-1	
1,1,1-Trichloroethane	<151	ug/L	500	151	500		04/17/24 00:17	71-55-6	
1,1,2-Trichloroethane	<172	ug/L	500	172	500		04/17/24 00:17	79-00-5	
Trichloroethene	<160	ug/L	500	160	500		04/17/24 00:17	79-01-6	
Trichlorofluoromethane	<209	ug/L	500	209	500		04/17/24 00:17	75-69-4	
1,2,3-Trichloropropane	<278	ug/L	500	278	500		04/17/24 00:17	96-18-4	
1,2,4-Trimethylbenzene	<224	ug/L	500	224	500		04/17/24 00:17	95-63-6	
1,3,5-Trimethylbenzene	<179	ug/L	500	179	500		04/17/24 00:17	108-67-8	
Vinyl chloride	19700	ug/L	500	87.2	500		04/17/24 00:17	75-01-4	
Xylene (Total)	<524	ug/L	1500	524	500		04/17/24 00:17	1330-20-7	
m&p-Xylene	<350	ug/L	1000	350	500		04/17/24 00:17	179601-23-1	
o-Xylene	<174	ug/L	500	174	500		04/17/24 00:17	95-47-6	
Surrogates									
4-Bromofluorobenzene (S)	101	%	70-130		500		04/17/24 00:17	460-00-4	
1,2-Dichlorobenzene-d4 (S)	101	%	70-130		500		04/17/24 00:17	2199-69-1	
Toluene-d8 (S)	101	%	70-130		500		04/17/24 00:17	2037-26-5	
Iron, Ferrous									
Analytical Method: SM 3500-FeB-2011									
Pace Analytical Services - Greensburg									
Iron, Ferrous	13.9	mg/L	1.0	0.77	10		04/16/24 13:49		H3,H6, ML
Iron, Ferric Calculation									
Analytical Method: HACH 8146									
Pace Analytical Services - Green Bay									
Iron, Ferric	<1.2	mg/L	5.0	1.2	1		04/26/24 08:38	20074-52-6	
300.0 IC Anions									
Analytical Method: EPA 300.0									
Pace Analytical Services - Green Bay									
Sulfate	<2.2	mg/L	10.0	2.2	5		04/23/24 20:32	14808-79-8	D3

REPORT OF LABORATORY ANALYSIS

This report shall not be reproduced, except in full, without the written consent of Pace Analytical Services, LLC.



ANALYTICAL RESULTS

Project: 1690005819_Conv One-Hour Valet

Pace Project No.: 40276723

Sample: PZ-1R Lab ID: 40276723009 Collected: 04/10/24 14:05 Received: 04/12/24 08:00 Matrix: Water

Parameters	Results	Units	LOQ	LOD	DF	Prepared	Analyzed	CAS No.	Qual
5310C TOC									
Analytical Method: SM 5310C									
Pace Analytical Services - Green Bay									
Total Organic Carbon	171	mg/L	30.0	11.4	60		04/18/24 22:46	7440-44-0	

REPORT OF LABORATORY ANALYSIS

This report shall not be reproduced, except in full, without the written consent of Pace Analytical Services, LLC.



ANALYTICAL RESULTS

Project: 1690005819_Conv One-Hour Valet

Pace Project No.: 40276723

Sample: TRIP BLANK Lab ID: 40276723010 Collected: 04/10/24 00:00 Received: 04/12/24 08:00 Matrix: Water

Parameters	Results	Units	LOQ	LOD	DF	Prepared	Analyzed	CAS No.	Qual
8260 MSV									
Analytical Method: EPA 8260									
Pace Analytical Services - Green Bay									
Benzene	<0.30	ug/L	1.0	0.30	1		04/16/24 18:24	71-43-2	
Bromobenzene	<0.36	ug/L	1.0	0.36	1		04/16/24 18:24	108-86-1	
Bromochloromethane	<0.36	ug/L	1.0	0.36	1		04/16/24 18:24	74-97-5	
Bromodichloromethane	<0.42	ug/L	1.0	0.42	1		04/16/24 18:24	75-27-4	
Bromoform	<0.43	ug/L	1.0	0.43	1		04/16/24 18:24	75-25-2	
Bromomethane	<1.2	ug/L	5.0	1.2	1		04/16/24 18:24	74-83-9	
n-Butylbenzene	<0.86	ug/L	1.0	0.86	1		04/16/24 18:24	104-51-8	
sec-Butylbenzene	<0.42	ug/L	1.0	0.42	1		04/16/24 18:24	135-98-8	
tert-Butylbenzene	<0.59	ug/L	1.0	0.59	1		04/16/24 18:24	98-06-6	
Carbon tetrachloride	<0.37	ug/L	1.0	0.37	1		04/16/24 18:24	56-23-5	
Chlorobenzene	<0.86	ug/L	1.0	0.86	1		04/16/24 18:24	108-90-7	
Chloroethane	<1.4	ug/L	5.0	1.4	1		04/16/24 18:24	75-00-3	
Chloroform	<0.50	ug/L	5.0	0.50	1		04/16/24 18:24	67-66-3	
Chloromethane	<1.6	ug/L	5.0	1.6	1		04/16/24 18:24	74-87-3	
2-Chlorotoluene	<0.89	ug/L	5.0	0.89	1		04/16/24 18:24	95-49-8	
4-Chlorotoluene	<0.89	ug/L	5.0	0.89	1		04/16/24 18:24	106-43-4	
1,2-Dibromo-3-chloropropane	<2.4	ug/L	5.0	2.4	1		04/16/24 18:24	96-12-8	
Dibromochloromethane	<2.6	ug/L	5.0	2.6	1		04/16/24 18:24	124-48-1	
1,2-Dibromoethane (EDB)	<0.31	ug/L	1.0	0.31	1		04/16/24 18:24	106-93-4	
Dibromomethane	<0.99	ug/L	5.0	0.99	1		04/16/24 18:24	74-95-3	
1,2-Dichlorobenzene	<0.33	ug/L	1.0	0.33	1		04/16/24 18:24	95-50-1	
1,3-Dichlorobenzene	<0.35	ug/L	1.0	0.35	1		04/16/24 18:24	541-73-1	
1,4-Dichlorobenzene	<0.89	ug/L	1.0	0.89	1		04/16/24 18:24	106-46-7	
Dichlorodifluoromethane	<0.46	ug/L	5.0	0.46	1		04/16/24 18:24	75-71-8	
1,1-Dichloroethane	<0.30	ug/L	1.0	0.30	1		04/16/24 18:24	75-34-3	
1,2-Dichloroethane	<0.29	ug/L	1.0	0.29	1		04/16/24 18:24	107-06-2	
1,1-Dichloroethene	<0.58	ug/L	1.0	0.58	1		04/16/24 18:24	75-35-4	
cis-1,2-Dichloroethene	<0.47	ug/L	1.0	0.47	1		04/16/24 18:24	156-59-2	
trans-1,2-Dichloroethene	<0.53	ug/L	1.0	0.53	1		04/16/24 18:24	156-60-5	
1,2-Dichloropropane	<0.45	ug/L	1.0	0.45	1		04/16/24 18:24	78-87-5	
1,3-Dichloropropane	<0.30	ug/L	1.0	0.30	1		04/16/24 18:24	142-28-9	
2,2-Dichloropropane	<0.42	ug/L	1.0	0.42	1		04/16/24 18:24	594-20-7	
1,1-Dichloropropene	<0.41	ug/L	1.0	0.41	1		04/16/24 18:24	563-58-6	
cis-1,3-Dichloropropene	<0.24	ug/L	1.0	0.24	1		04/16/24 18:24	10061-01-5	
trans-1,3-Dichloropropene	<0.27	ug/L	1.0	0.27	1		04/16/24 18:24	10061-02-6	
Diisopropyl ether	<1.1	ug/L	5.0	1.1	1		04/16/24 18:24	108-20-3	
Ethylbenzene	<0.33	ug/L	1.0	0.33	1		04/16/24 18:24	100-41-4	
Hexachloro-1,3-butadiene	<2.7	ug/L	5.0	2.7	1		04/16/24 18:24	87-68-3	
Isopropylbenzene (Cumene)	<1.0	ug/L	5.0	1.0	1		04/16/24 18:24	98-82-8	
p-Isopropyltoluene	<1.0	ug/L	5.0	1.0	1		04/16/24 18:24	99-87-6	
Methylene Chloride	<0.32	ug/L	5.0	0.32	1		04/16/24 18:24	75-09-2	
Methyl-tert-butyl ether	<1.1	ug/L	5.0	1.1	1		04/16/24 18:24	1634-04-4	
Naphthalene	<1.9	ug/L	5.0	1.9	1		04/16/24 18:24	91-20-3	
n-Propylbenzene	<0.35	ug/L	1.0	0.35	1		04/16/24 18:24	103-65-1	
Styrene	<0.36	ug/L	1.0	0.36	1		04/16/24 18:24	100-42-5	

REPORT OF LABORATORY ANALYSIS

This report shall not be reproduced, except in full,
without the written consent of Pace Analytical Services, LLC.



ANALYTICAL RESULTS

Project: 1690005819_Conv One-Hour Valet

Pace Project No.: 40276723

Sample: TRIP BLANK Lab ID: 40276723010 Collected: 04/10/24 00:00 Received: 04/12/24 08:00 Matrix: Water

Parameters	Results	Units	LOQ	LOD	DF	Prepared	Analyzed	CAS No.	Qual
8260 MSV		Analytical Method: EPA 8260 Pace Analytical Services - Green Bay							
1,1,1,2-Tetrachloroethane	<0.36	ug/L	1.0	0.36	1		04/16/24 18:24	630-20-6	
1,1,1,2-Tetrachloroethane	<0.38	ug/L	1.0	0.38	1		04/16/24 18:24	79-34-5	
Tetrachloroethene	<0.41	ug/L	1.0	0.41	1		04/16/24 18:24	127-18-4	
Toluene	<0.29	ug/L	1.0	0.29	1		04/16/24 18:24	108-88-3	
1,2,3-Trichlorobenzene	<1.0	ug/L	5.0	1.0	1		04/16/24 18:24	87-61-6	
1,2,4-Trichlorobenzene	<0.95	ug/L	5.0	0.95	1		04/16/24 18:24	120-82-1	
1,1,1-Trichloroethane	<0.30	ug/L	1.0	0.30	1		04/16/24 18:24	71-55-6	
1,1,2-Trichloroethane	<0.34	ug/L	1.0	0.34	1		04/16/24 18:24	79-00-5	
Trichloroethene	<0.32	ug/L	1.0	0.32	1		04/16/24 18:24	79-01-6	
Trichlorofluoromethane	<0.42	ug/L	1.0	0.42	1		04/16/24 18:24	75-69-4	
1,2,3-Trichloropropane	<0.56	ug/L	1.0	0.56	1		04/16/24 18:24	96-18-4	
1,2,4-Trimethylbenzene	<0.45	ug/L	1.0	0.45	1		04/16/24 18:24	95-63-6	
1,3,5-Trimethylbenzene	<0.36	ug/L	1.0	0.36	1		04/16/24 18:24	108-67-8	
Vinyl chloride	<0.17	ug/L	1.0	0.17	1		04/16/24 18:24	75-01-4	
Xylene (Total)	<1.0	ug/L	3.0	1.0	1		04/16/24 18:24	1330-20-7	
m&p-Xylene	<0.70	ug/L	2.0	0.70	1		04/16/24 18:24	179601-23-1	
o-Xylene	<0.35	ug/L	1.0	0.35	1		04/16/24 18:24	95-47-6	
Surrogates									
4-Bromofluorobenzene (S)	100	%	70-130		1		04/16/24 18:24	460-00-4	
1,2-Dichlorobenzene-d4 (S)	95	%	70-130		1		04/16/24 18:24	2199-69-1	
Toluene-d8 (S)	103	%	70-130		1		04/16/24 18:24	2037-26-5	

REPORT OF LABORATORY ANALYSIS

This report shall not be reproduced, except in full,
without the written consent of Pace Analytical Services, LLC.



QUALITY CONTROL DATA

Project: 1690005819_Conv One-Hour Valet

Pace Project No.: 40276723

QC Batch: 472077	Analysis Method: EPA 8015B Modified
QC Batch Method: EPA 8015B Modified	Analysis Description: Methane, Ethane, Ethene GCV
	Laboratory: Pace Analytical Services - Green Bay

Associated Lab Samples: 40276723009

METHOD BLANK: 2703600 Matrix: Water

Associated Lab Samples: 40276723009

Parameter	Units	Blank Result	Reporting Limit	Analyzed	Qualifiers
Ethane	ug/L	<0.39	5.6	04/19/24 08:32	
Ethene	ug/L	<0.25	5.0	04/19/24 08:32	
Methane	ug/L	<0.58	2.8	04/19/24 08:32	

LABORATORY CONTROL SAMPLE & LCSD: 2703601 2703602

Parameter	Units	Spike Conc.	LCS Result	LCSD Result	LCS % Rec	LCSD % Rec	% Rec Limits	RPD	Max RPD	Qualifiers
Ethane	ug/L	53.6	55.3	60.9	103	114	80-120	10	20	
Ethene	ug/L	50	51.5	56.4	103	113	80-120	9	20	
Methane	ug/L	28.6	29.6	32.8	104	115	80-120	10	20	

MATRIX SPIKE & MATRIX SPIKE DUPLICATE: 2703603 2703604

Parameter	Units	40276699015 Result	MS Spike Conc.	MSD Spike Conc.	MS Result	MSD Result	MS % Rec	MSD % Rec	% Rec Limits	RPD	Max RPD	Qual
Ethane	ug/L	<0.39	53.6	53.6	52.9	55.7	99	104	77-120	5	20	
Ethene	ug/L	<0.25	50	50	48.9	50.8	98	102	76-120	4	20	
Methane	ug/L	21.5	28.6	28.6	58.6	68.1	130	163	12-198	15	26	

Results presented on this page are in the units indicated by the "Units" column except where an alternate unit is presented to the right of the result.

REPORT OF LABORATORY ANALYSIS

This report shall not be reproduced, except in full, without the written consent of Pace Analytical Services, LLC.



QUALITY CONTROL DATA

Project: 1690005819_Conv One-Hour Valet

Pace Project No.: 40276723

QC Batch: 471637	Analysis Method: EPA 6020B
QC Batch Method: EPA 3010A	Analysis Description: 6020B MET Dissolved
	Laboratory: Pace Analytical Services - Green Bay

Associated Lab Samples: 40276723009

METHOD BLANK: 2701177 Matrix: Water

Associated Lab Samples: 40276723009

Parameter	Units	Blank Result	Reporting Limit	Analyzed	Qualifiers
Iron, Dissolved	ug/L	<58.0	250	04/16/24 13:14	

LABORATORY CONTROL SAMPLE: 2701178

Parameter	Units	Spike Conc.	LCS Result	LCS % Rec	% Rec Limits	Qualifiers
Iron, Dissolved	ug/L	10000	10300	103	80-120	

MATRIX SPIKE & MATRIX SPIKE DUPLICATE: 2701179 2701180

Parameter	Units	2701179		2701180		MS % Rec	MSD % Rec	% Rec Limits	RPD	Max RPD	Qual
		40276699015 Result	MS Spike Conc.	MSD Spike Conc.	MS Result						
Iron, Dissolved	ug/L	8040	10000	10000	19000	18300	110	102	75-125	4	20

Results presented on this page are in the units indicated by the "Units" column except where an alternate unit is presented to the right of the result.

REPORT OF LABORATORY ANALYSIS

This report shall not be reproduced, except in full, without the written consent of Pace Analytical Services, LLC.



QUALITY CONTROL DATA

Project: 1690005819_Conv One-Hour Valet

Pace Project No.: 40276723

QC Batch: 471687 Analysis Method: EPA 8260
QC Batch Method: EPA 8260 Analysis Description: 8260 MSV
Laboratory: Pace Analytical Services - Green Bay
Associated Lab Samples: 40276723001, 40276723002, 40276723003, 40276723004, 40276723005, 40276723006, 40276723007, 40276723008, 40276723009, 40276723010

METHOD BLANK: 2701357 Matrix: Water
Associated Lab Samples: 40276723001, 40276723002, 40276723003, 40276723004, 40276723005, 40276723006, 40276723007, 40276723008, 40276723009, 40276723010

Table with 6 columns: Parameter, Units, Blank Result, Reporting Limit, Analyzed, Qualifiers. Lists various chemical compounds and their detection results.

Results presented on this page are in the units indicated by the "Units" column except where an alternate unit is presented to the right of the result.

REPORT OF LABORATORY ANALYSIS

This report shall not be reproduced, except in full, without the written consent of Pace Analytical Services, LLC.



QUALITY CONTROL DATA

Project: 1690005819_Conv One-Hour Valet

Pace Project No.: 40276723

METHOD BLANK: 2701357

Matrix: Water

Associated Lab Samples: 40276723001, 40276723002, 40276723003, 40276723004, 40276723005, 40276723006, 40276723007, 40276723008, 40276723009, 40276723010

Parameter	Units	Blank Result	Reporting Limit	Analyzed	Qualifiers
Diisopropyl ether	ug/L	<1.1	5.0	04/16/24 16:26	
Ethylbenzene	ug/L	<0.33	1.0	04/16/24 16:26	
Hexachloro-1,3-butadiene	ug/L	<2.7	5.0	04/16/24 16:26	
Isopropylbenzene (Cumene)	ug/L	<1.0	5.0	04/16/24 16:26	
m&p-Xylene	ug/L	<0.70	2.0	04/16/24 16:26	
Methyl-tert-butyl ether	ug/L	<1.1	5.0	04/16/24 16:26	
Methylene Chloride	ug/L	<0.32	5.0	04/16/24 16:26	
n-Butylbenzene	ug/L	<0.86	1.0	04/16/24 16:26	
n-Propylbenzene	ug/L	<0.35	1.0	04/16/24 16:26	
Naphthalene	ug/L	<1.9	5.0	04/16/24 16:26	
o-Xylene	ug/L	<0.35	1.0	04/16/24 16:26	
p-Isopropyltoluene	ug/L	<1.0	5.0	04/16/24 16:26	
sec-Butylbenzene	ug/L	<0.42	1.0	04/16/24 16:26	
Styrene	ug/L	<0.36	1.0	04/16/24 16:26	
tert-Butylbenzene	ug/L	<0.59	1.0	04/16/24 16:26	
Tetrachloroethene	ug/L	<0.41	1.0	04/16/24 16:26	
Toluene	ug/L	<0.29	1.0	04/16/24 16:26	
trans-1,2-Dichloroethene	ug/L	<0.53	1.0	04/16/24 16:26	
trans-1,3-Dichloropropene	ug/L	<0.27	1.0	04/16/24 16:26	
Trichloroethene	ug/L	<0.32	1.0	04/16/24 16:26	
Trichlorofluoromethane	ug/L	<0.42	1.0	04/16/24 16:26	
Vinyl chloride	ug/L	<0.17	1.0	04/16/24 16:26	
Xylene (Total)	ug/L	<1.0	3.0	04/16/24 16:26	
1,2-Dichlorobenzene-d4 (S)	%	94	70-130	04/16/24 16:26	
4-Bromofluorobenzene (S)	%	99	70-130	04/16/24 16:26	
Toluene-d8 (S)	%	101	70-130	04/16/24 16:26	

LABORATORY CONTROL SAMPLE: 2701358

Parameter	Units	Spike Conc.	LCS Result	LCS % Rec	% Rec Limits	Qualifiers
1,1,1-Trichloroethane	ug/L	50	59.5	119	70-132	
1,1,2,2-Tetrachloroethane	ug/L	50	45.1	90	70-130	
1,1,2-Trichloroethane	ug/L	50	50.8	102	70-130	
1,1-Dichloroethane	ug/L	50	53.5	107	70-130	
1,1-Dichloroethene	ug/L	50	53.9	108	73-140	
1,2,4-Trichlorobenzene	ug/L	50	43.1	86	70-130	
1,2-Dibromo-3-chloropropane	ug/L	50	48.4	97	58-130	
1,2-Dibromoethane (EDB)	ug/L	50	53.0	106	70-130	
1,2-Dichlorobenzene	ug/L	50	50.1	100	70-130	
1,2-Dichloroethane	ug/L	50	57.3	115	70-130	
1,2-Dichloropropane	ug/L	50	49.5	99	77-127	
1,3-Dichlorobenzene	ug/L	50	50.9	102	70-130	
1,4-Dichlorobenzene	ug/L	50	51.0	102	70-130	

Results presented on this page are in the units indicated by the "Units" column except where an alternate unit is presented to the right of the result.

REPORT OF LABORATORY ANALYSIS

This report shall not be reproduced, except in full, without the written consent of Pace Analytical Services, LLC.



QUALITY CONTROL DATA

Project: 1690005819_Conv One-Hour Valet

Pace Project No.: 40276723

LABORATORY CONTROL SAMPLE: 2701358

Parameter	Units	Spike Conc.	LCS Result	LCS % Rec	% Rec Limits	Qualifiers
Benzene	ug/L	50	53.1	106	70-130	
Bromodichloromethane	ug/L	50	57.7	115	70-130	
Bromoform	ug/L	50	42.1	84	70-130	
Bromomethane	ug/L	50	63.1	126	22-141	
Carbon tetrachloride	ug/L	50	61.3	123	70-135	
Chlorobenzene	ug/L	50	54.0	108	70-130	
Chloroethane	ug/L	50	57.4	115	59-141	
Chloroform	ug/L	50	57.2	114	80-124	
Chloromethane	ug/L	50	55.4	111	29-150	
cis-1,2-Dichloroethene	ug/L	50	50.9	102	70-130	
cis-1,3-Dichloropropene	ug/L	50	52.7	105	70-130	
Dibromochloromethane	ug/L	50	47.5	95	70-130	
Dichlorodifluoromethane	ug/L	50	66.2	132	10-147	
Ethylbenzene	ug/L	50	56.3	113	80-125	
Isopropylbenzene (Cumene)	ug/L	50	53.2	106	70-130	
m&p-Xylene	ug/L	100	110	110	70-130	
Methyl-tert-butyl ether	ug/L	50	50.0	100	64-131	
Methylene Chloride	ug/L	50	55.4	111	70-137	
o-Xylene	ug/L	50	53.7	107	70-130	
Styrene	ug/L	50	55.4	111	70-130	
Tetrachloroethene	ug/L	50	55.1	110	70-130	
Toluene	ug/L	50	53.9	108	80-120	
trans-1,2-Dichloroethene	ug/L	50	52.2	104	70-131	
trans-1,3-Dichloropropene	ug/L	50	54.3	109	70-130	
Trichloroethene	ug/L	50	55.5	111	70-130	
Trichlorofluoromethane	ug/L	50	69.9	140	69-141	
Vinyl chloride	ug/L	50	50.1	100	51-145	
Xylene (Total)	ug/L	150	164	109	70-130	
1,2-Dichlorobenzene-d4 (S)	%			94	70-130	
4-Bromofluorobenzene (S)	%			97	70-130	
Toluene-d8 (S)	%			102	70-130	

MATRIX SPIKE & MATRIX SPIKE DUPLICATE: 2701733 2701734

Parameter	Units	MS		MSD		MS Result	MSD Result	MS % Rec	MSD % Rec	% Rec Limits	RPD	Max RPD	Qual
		40276678001 Result	Spike Conc.	Spike Conc.	Conc.								
1,1,1-Trichloroethane	ug/L	<0.30	50	50	58.5	64.4	117	129	70-132	10	20		
1,1,2,2-Tetrachloroethane	ug/L	<0.38	50	50	46.1	50.5	92	101	70-131	9	20		
1,1,2-Trichloroethane	ug/L	<0.34	50	50	49.0	55.7	98	111	70-130	13	20		
1,1-Dichloroethane	ug/L	<0.30	50	50	44.7	54.9	89	110	70-131	20	20		
1,1-Dichloroethene	ug/L	<0.58	50	50	46.7	49.7	93	99	69-146	6	20		
1,2,4-Trichlorobenzene	ug/L	<0.95	50	50	42.4	44.6	85	89	70-130	5	20		
1,2-Dibromo-3-chloropropane	ug/L	<2.4	50	50	48.8	50.5	98	101	56-130	3	20		
1,2-Dibromoethane (EDB)	ug/L	<0.31	50	50	50.9	57.9	102	116	70-130	13	20		

Results presented on this page are in the units indicated by the "Units" column except where an alternate unit is presented to the right of the result.

REPORT OF LABORATORY ANALYSIS

This report shall not be reproduced, except in full, without the written consent of Pace Analytical Services, LLC.



QUALITY CONTROL DATA

Project: 1690005819_Conv One-Hour Valet

Pace Project No.: 40276723

Parameter	Units	2701733		2701734		MS Result	MSD Result	MS % Rec	MSD % Rec	% Rec Limits	Max RPD	RPD	Qual
		40276678001 Result	MS Spike Conc.	MSD Spike Conc.	MS Result								
1,2-Dichlorobenzene	ug/L	<0.33	50	50	49.5	52.5	99	105	70-130	6	20		
1,2-Dichloroethane	ug/L	<0.29	50	50	55.2	65.4	110	131	70-130	17	20	M1	
1,2-Dichloropropane	ug/L	<0.45	50	50	48.9	52.1	98	104	77-129	6	20		
1,3-Dichlorobenzene	ug/L	<0.35	50	50	48.7	52.7	97	105	70-130	8	20		
1,4-Dichlorobenzene	ug/L	<0.89	50	50	49.9	53.2	100	106	70-130	7	20		
Benzene	ug/L	<0.30	50	50	48.6	53.2	97	106	70-130	9	20		
Bromodichloromethane	ug/L	<0.42	50	50	56.6	64.2	113	128	70-130	13	20		
Bromoform	ug/L	<0.43	50	50	42.5	47.3	85	95	70-130	11	20		
Bromomethane	ug/L	<1.2	50	50	57.8	64.3	116	129	12-159	11	26		
Carbon tetrachloride	ug/L	<0.37	50	50	57.9	62.4	116	125	70-135	8	20		
Chlorobenzene	ug/L	<0.86	50	50	51.1	57.6	102	115	70-130	12	20		
Chloroethane	ug/L	<1.4	50	50	50.6	52.7	101	105	56-143	4	20		
Chloroform	ug/L	<0.50	50	50	54.7	59.9	109	120	80-126	9	20		
Chloromethane	ug/L	<1.6	50	50	53.1	58.6	106	117	22-156	10	20		
cis-1,2-Dichloroethene	ug/L	<0.47	50	50	48.2	52.8	96	106	70-130	9	20		
cis-1,3-Dichloropropene	ug/L	<0.24	50	50	51.6	55.4	103	111	70-130	7	20		
Dibromochloromethane	ug/L	<2.6	50	50	46.5	53.5	93	107	70-130	14	20		
Dichlorodifluoromethane	ug/L	<0.46	50	50	62.9	65.2	126	130	10-147	4	20		
Ethylbenzene	ug/L	<0.33	50	50	52.5	58.5	105	117	80-126	11	20		
Isopropylbenzene (Cumene)	ug/L	<1.0	50	50	55.2	60.5	110	121	70-130	9	20		
m&p-Xylene	ug/L	<0.70	100	100	103	113	103	113	70-130	9	20		
Methyl-tert-butyl ether	ug/L	<1.1	50	50	50.4	54.4	101	109	64-136	8	20		
Methylene Chloride	ug/L	<0.32	50	50	49.4	54.2	99	108	70-137	9	20		
o-Xylene	ug/L	<0.35	50	50	50.6	56.9	101	114	70-130	12	20		
Styrene	ug/L	<0.36	50	50	53.6	57.9	107	116	70-133	8	20		
Tetrachloroethene	ug/L	<0.41	50	50	51.6	57.4	103	115	70-131	11	20		
Toluene	ug/L	<0.29	50	50	50.8	55.0	102	110	80-121	8	20		
trans-1,2-Dichloroethene	ug/L	<0.53	50	50	48.8	52.4	98	105	70-135	7	20		
trans-1,3-Dichloropropene	ug/L	<0.27	50	50	51.3	59.3	103	119	70-130	14	20		
Trichloroethene	ug/L	<0.32	50	50	52.4	57.7	105	115	70-130	10	20		
Trichlorofluoromethane	ug/L	<0.42	50	50	64.6	70.1	129	140	67-142	8	20		
Vinyl chloride	ug/L	<0.17	50	50	46.9	51.9	94	104	45-147	10	20		
Xylene (Total)	ug/L	<1.0	150	150	154	170	103	113	70-130	10	20		
1,2-Dichlorobenzene-d4 (S)	%						95	93	70-130				
4-Bromofluorobenzene (S)	%						95	95	70-130				
Toluene-d8 (S)	%						100	101	70-130				

Results presented on this page are in the units indicated by the "Units" column except where an alternate unit is presented to the right of the result.

REPORT OF LABORATORY ANALYSIS

This report shall not be reproduced, except in full,
without the written consent of Pace Analytical Services, LLC.



QUALITY CONTROL DATA

Project: 1690005819_Conv One-Hour Valet

Pace Project No.: 40276723

QC Batch: 662314

Analysis Method: SM 3500-FeB-2011

QC Batch Method: SM 3500-FeB-2011

Analysis Description: Iron, Ferrous

Laboratory: Pace Analytical Services - Greensburg

Associated Lab Samples: 40276723009

METHOD BLANK: 3225355

Matrix: Water

Associated Lab Samples: 40276723009

Parameter	Units	Blank Result	Reporting Limit	Analyzed	Qualifiers
Iron, Ferrous	mg/L	<0.077	0.10	04/16/24 13:34	H6

LABORATORY CONTROL SAMPLE: 3225356

Parameter	Units	Spike Conc.	LCS Result	LCS % Rec	% Rec Limits	Qualifiers
Iron, Ferrous	mg/L	1	1.0	101	90-110	H6

MATRIX SPIKE SAMPLE: 3225358

Parameter	Units	40276723009 Result	Spike Conc.	MS Result	MS % Rec	% Rec Limits	Qualifiers
Iron, Ferrous	mg/L	13.9	1	14.7	83	85-115	H3,H6,ML

SAMPLE DUPLICATE: 3225357

Parameter	Units	40276723009 Result	Dup Result	RPD	Max RPD	Qualifiers
Iron, Ferrous	mg/L	13.9	13.9	0	20	H3,H6

Results presented on this page are in the units indicated by the "Units" column except where an alternate unit is presented to the right of the result.

REPORT OF LABORATORY ANALYSIS

This report shall not be reproduced, except in full, without the written consent of Pace Analytical Services, LLC.



QUALITY CONTROL DATA

Project: 1690005819_Conv One-Hour Valet

Pace Project No.: 40276723

QC Batch: 472210

Analysis Method: EPA 300.0

QC Batch Method: EPA 300.0

Analysis Description: 300.0 IC Anions

Laboratory: Pace Analytical Services - Green Bay

Associated Lab Samples: 40276723009

METHOD BLANK: 2704573

Matrix: Water

Associated Lab Samples: 40276723009

Parameter	Units	Blank Result	Reporting Limit	Analyzed	Qualifiers
Sulfate	mg/L	<0.44	2.0	04/23/24 19:03	

LABORATORY CONTROL SAMPLE: 2704574

Parameter	Units	Spike Conc.	LCS Result	LCS % Rec	% Rec Limits	Qualifiers
Sulfate	mg/L	20	21.4	107	90-110	

MATRIX SPIKE & MATRIX SPIKE DUPLICATE: 2704575 2704576

Parameter	Units	40276686001		2704575		2704576		% Rec Limits	RPD	Max RPD	Qual	
		MS Result	MSD Spike Conc.	MS Result	MSD Spike Conc.	MS Result	MSD Spike Conc.					
Sulfate	mg/L	451	400	400	400	874	876	106	106	90-110	0	15

MATRIX SPIKE & MATRIX SPIKE DUPLICATE: 2704577 2704578

Parameter	Units	40276768003		2704577		2704578		% Rec Limits	RPD	Max RPD	Qual	
		MS Result	MSD Spike Conc.	MS Result	MSD Spike Conc.	MS Result	MSD Spike Conc.					
Sulfate	mg/L	<222	10000	10000	10000	10900	10900	109	109	90-110	1	15

Results presented on this page are in the units indicated by the "Units" column except where an alternate unit is presented to the right of the result.

REPORT OF LABORATORY ANALYSIS

This report shall not be reproduced, except in full, without the written consent of Pace Analytical Services, LLC.



QUALITY CONTROL DATA

Project: 1690005819_Conv One-Hour Valet

Pace Project No.: 40276723

QC Batch: 472096	Analysis Method: SM 5310C
QC Batch Method: SM 5310C	Analysis Description: 5310C Total Organic Carbon
	Laboratory: Pace Analytical Services - Green Bay

Associated Lab Samples: 40276723009

METHOD BLANK: 2703783 Matrix: Water

Associated Lab Samples: 40276723009

Parameter	Units	Blank Result	Reporting Limit	Analyzed	Qualifiers
Total Organic Carbon	mg/L	<0.19	0.50	04/18/24 21:57	

LABORATORY CONTROL SAMPLE: 2703784

Parameter	Units	Spike Conc.	LCS Result	LCS % Rec	% Rec Limits	Qualifiers
Total Organic Carbon	mg/L	12.5	12.3	99	80-120	

MATRIX SPIKE & MATRIX SPIKE DUPLICATE: 2703785 2703786

Parameter	Units	40276840001		2703785		2703786		% Rec Limits	RPD	Max RPD	Qual	
		MS Result	MSD Spike Conc.	MS Result	MSD Spike Conc.	MS % Rec	MSD % Rec					
Total Organic Carbon	mg/L	7.0	6	6	6	13.0	13.3	100	105	80-120	2	10

MATRIX SPIKE & MATRIX SPIKE DUPLICATE: 2703787 2703788

Parameter	Units	40276840002		2703787		2703788		% Rec Limits	RPD	Max RPD	Qual	
		MS Result	MSD Spike Conc.	MS Result	MSD Spike Conc.	MS % Rec	MSD % Rec					
Total Organic Carbon	mg/L	6.4	6	6	6	12.6	12.4	102	100	80-120	1	10

Results presented on this page are in the units indicated by the "Units" column except where an alternate unit is presented to the right of the result.

REPORT OF LABORATORY ANALYSIS

This report shall not be reproduced, except in full, without the written consent of Pace Analytical Services, LLC.



QUALIFIERS

Project: 1690005819_Conv One-Hour Valet

Pace Project No.: 40276723

DEFINITIONS

DF - Dilution Factor, if reported, represents the factor applied to the reported data due to dilution of the sample aliquot.

ND - Not Detected at or above LOD.

J - The reported result is an estimated value.

LOD - Limit of Detection adjusted for dilution factor, percent moisture, initial weight and final volume.

LOQ - Limit of Quantitation adjusted for dilution factor, percent moisture, initial weight and final volume.

DL - Adjusted Method Detection Limit.

S - Surrogate

1,2-Diphenylhydrazine decomposes to and cannot be separated from Azobenzene using Method 8270. The result for each analyte is a combined concentration.

Consistent with EPA guidelines, unrounded data are displayed and have been used to calculate % recovery and RPD values.

LCS(D) - Laboratory Control Sample (Duplicate)

MS(D) - Matrix Spike (Duplicate)

DUP - Sample Duplicate

RPD - Relative Percent Difference

NC - Not Calculable.

SG - Silica Gel - Clean-Up

U - Analyte was not detected and is reported as less than the LOD or as defined by the customer.

N-Nitrosodiphenylamine decomposes and cannot be separated from Diphenylamine using Method 8270. The result reported for each analyte is a combined concentration.

Pace Analytical is TNI accredited. Contact your Pace PM for the current list of accredited analytes.

TNI - The NELAC Institute.

ANALYTE QUALIFIERS

D3 Sample was diluted due to the presence of high levels of non-target analytes or other matrix interference.

H3 Sample was received or analysis requested beyond the recognized method holding time.

H6 Analysis initiated outside of the 15 minute EPA required holding time.

M1 Matrix spike recovery exceeded QC limits. Batch accepted based on laboratory control sample (LCS) recovery.

ML Matrix spike recovery and/or matrix spike duplicate recovery was below laboratory control limits. Result may be biased low.

REPORT OF LABORATORY ANALYSIS

This report shall not be reproduced, except in full,
without the written consent of Pace Analytical Services, LLC.



QUALITY CONTROL DATA CROSS REFERENCE TABLE

Project: 1690005819_Conv One-Hour Valet

Pace Project No.: 40276723

Lab ID	Sample ID	QC Batch Method	QC Batch	Analytical Method	Analytical Batch
40276723009	PZ-1R	EPA 8015B Modified	472077		
40276723009	PZ-1R	EPA 3010A	471637	EPA 6020B	471728
40276723001	MW-7	EPA 8260	471687		
40276723002	MW-3	EPA 8260	471687		
40276723003	MW-6	EPA 8260	471687		
40276723004	MW-6 DUP	EPA 8260	471687		
40276723005	PZ-2R	EPA 8260	471687		
40276723006	MW-5	EPA 8260	471687		
40276723007	PZ-4	EPA 8260	471687		
40276723008	MW-4	EPA 8260	471687		
40276723009	PZ-1R	EPA 8260	471687		
40276723010	TRIP BLANK	EPA 8260	471687		
40276723009	PZ-1R	SM 3500-FeB-2011	662314		
40276723009	PZ-1R	HACH 8146	472817		
40276723009	PZ-1R	EPA 300.0	472210		
40276723009	PZ-1R	SM 5310C	472096		

REPORT OF LABORATORY ANALYSIS

This report shall not be reproduced, except in full, without the written consent of Pace Analytical Services, LLC.

40276723

Pace
 Pace[®] Location Requested (City/State):
 Pace Analytical Green Bay
 1241 Bellevue Street, Suite 9
 Green Bay, WI 54302

CHAIN-OF-CUSTODY Analytical Request Document
 Chain-of-Custody is a LEGAL DOCUMENT - Complete all relevant fields

LAB USE ONLY- Affix Workorder/Login Label Here



Scan QR Code for instructions

Company Name: Ramboll US Consulting, Inc.
 Street Address: 234 W. Florida Street, Fifth Floor
 Milwaukee, WI 53204

Customer Project #
 Project Name: 1690005819_Conv One-Hour Valet

Site Collection Info/Facility ID (as applicable).

Contact/Report To.
 Phone #:
 E-Mail: PLINQUIST@RAMBOLL.COM
 Cc E-Mail: SPETROFSKE@RAMBOLL.COM

Invoice To: Ramboll Americas
 Invoice E-Mail: ramboll.us@pdf.basware.com

Purchase Order # (if applicable)
 Quote #.

County / State origin of sample(s): Wisconsin

Specify Container Size **

3 4 3 6 6 6

Identify Container Preservative Type***

1 3 2 4 4 4

Analysis Requested

**Container Size (1) 1L, (2) 500mL, (3) 250mL, (4) 125mL, (5) 100mL, (6) 40mL vial, (7) EnCore, (8) TerraCore, (9) 90mL, (10) Other

*** Preservative Types (1) None, (2) HNO3, (3) H2SO4, (4) HCl, (5) NaOH, (6) Zn Acetate, (7) NaHSO4, (8) Sod Thiosulfate, (9) Ascorbic Acid, (10) MeOH, (11) Other

Time Zone Collected: [] AK [] PT [] MT [] CT [] ET

Data Deliverables:

[] Level II [] Level III [] Level IV
 [] EQUIS
 [] Other

Regulatory Program (DW, RCRA, etc.) as applicable: Reportable [] Yes [] No

Rush (Pre-approval required):
 [] Same Day [] 1 Day [] 2 Day [] 3 Day [] Other

Date Results Requested: _____

Field Filtered (if applicable): Yes [] No
 Analysis: 6020B

DW PWSID # or WW Permit # as applicable

300 0 IC Anions - SO4
 5310C TOC
 6020B Iron
 8260 MSV
 Ferrous Iron by 3500
 Methane, Ethane, Ethene GCV

Proj. Mgr:
Steven Mleccko

AcctNum / Client ID:

Table #:

Profile / Template:
6153

Prelog / Bottle Ord. ID:
EZ 3092038

Sample Comment

Lab Use Only

Preservation non-conformance identified for sample

Customer Sample ID	Matrix *	Comp / Grab	Composite Start		Collected or Composite End		# Cont.	Res. Chlorine	
			Date	Time	Date	Time		Results	Units
MW-7	GW	G			4-10-24	830	3		
MW-3					4-9-24	1310	1		
MW-6					4-10-24	920	1		
MW-6 DUP						925	1		
PZ-2R						1005	1		
MW-5						1125	1		
PZ-4						1206	1		
MW-4						1252	1		
PZ-1R						1405	11		
TRIP BLANK							2		

300 0 IC Anions - SO4	5310C TOC	6020B Iron	8260 MSV	Ferrous Iron by 3500	Methane, Ethane, Ethene GCV														
			X																
			X																
			X																
			X																
			X																
			X																
			X																
			X	X															
			X																

Additional Instructions from Pace*:

Collected By: (Printed Name) D. GLASFORD
 Signature: [Signature]

Customer Remarks / Special Conditions / Possible Hazards:

Coolers Thermometer ID. Correction Factor (°C) Obs Temp. (°C) Corrected Temp. (°C) On Ice:

Relinquished by/Company (Signature) [Signature]
 Date/Time 4-10-24 1000

Relinquished by/Company (Signature) CS Logistics
 Date/Time 4/12/24 0800

Relinquished by/Company (Signature)

Relinquished by/Company (Signature)

Received by/Company (Signature)

Received by/Company (Signature)

Received by/Company (Signature)

Received by/Company (Signature) CS LOGISTICS
 Date/Time 4-11-24 1000

Received by/Company (Signature) [Signature]
 Date/Time 4/12/24 0800

Received by/Company (Signature)

Received by/Company (Signature)

Tracking Number

Delivered by. [] In-Person [] Courier
 [] FedEx [] UPS [] Other

Page: 1 of 1

Client Name: Ramboll

Sample Preservation Receipt Form
 Project # 40276723
 Yes No N/A
 Lab Lot# of pH paper. 1000134 Lab Std #ID of preservation (if pH adjusted)

Initial when completed NK Date/Time.

Pace Lab #	Glass						Plastic						Vials				Jars				General				VOA Vials (>6mm) *	H2SO4 pH ≤2	NaOH+Zn Act pH ≥9	NaOH pH ≥12	HNO3 pH ≤2	pH after adjusted	Volume (mL)					
	AG1U	BG1U	AG1H	AG4S	AG5U	AG2S	BP1U	BP3U	BP3B	BP3N	BP3S	BP2Z	VG9C	DG9T	VG9U	VG9H	VG9M	VG9D	JGFU	JG9U	WGFU	WPFU	SP5T	ZPLC								GN 1	GN 2			
001																																				2.5 / 5
002																																				2.5 / 5
003																																				2.5 / 5
004																																				2.5 / 5
005																																				2.5 / 5
006																																				2.5 / 5
007																																				2.5 / 5
008																																				2.5 / 5
009																																				2.5 / 5
010																																				2.5 / 5
011																																				2.5 / 5
012																																				2.5 / 5
013																																				2.5 / 5
014																																				2.5 / 5
015																																				2.5 / 5
016																																				2.5 / 5
017																																				2.5 / 5
018																																				2.5 / 5
019																																				2.5 / 5
020																																				2.5 / 5

Exceptions to preservation check (VOA) Coliform, TOC, TOX, TOH, O&G, WI DRO, Phenolics, Other: _____ Headspace in VOA Vials (>6mm): Yes No N/A *If yes look in headspace column

AG1U	1 liter amber glass	BP1U	1 liter plastic unpres	VG9C	40 mL clear ascorbic w/ HCl	JGFU	4 oz amber jar unpres
BG1U	1 liter clear glass	BP3U	250 mL plastic unpres	DG9T	40 mL amber Na Thio	JG9U	9 oz amber jar unpres
AG1H	1 liter amber glass HCL	BP3B	250 mL plastic NaOH	VG9U	40 mL clear vial unpres	WGFU	4 oz clear jar unpres
AG4S	125 mL amber glass H2SO4	BP3N	250 mL plastic HNO3	VG9H	40 mL clear vial HCL	WPFU	4 oz plastic jar unpres
AG5U	100 mL amber glass unpres	BP3S	250 mL plastic H2SO4	VG9M	40 mL clear vial MeOH	SP5T	120 mL plastic Na Thiosulfate
AG2S	500 mL amber glass H2SO4	BP2Z	500 mL plastic NaOH + Zn	VG9D	40 mL clear vial DI	ZPLC	ziploc bag
BG3U	250 mL clear glass unpres					GN 1	
						GN 2	

Sample Condition Upon Receipt Form (SCUR)

Project #:

Client Name: Ramboll

WO#: 40276723



40276723

Courier: CS Logistics Fed Ex Speedee UPS Waltco
 Client Pace Other: _____

Tracking #: _____

Custody Seal on Cooler/Box Present: yes no Seals intact: yes no

Custody Seal on Samples Present: yes no Seals intact: yes no

Packing Material: Bubble Wrap Bubble Bags None Other

Thermometer Used SR - 134 Type of Ice: Wet Blue Dry None Meltwater Only

Cooler Temperature Uncorr: 0.5 / Corr: 0.5

Temp Blank Present: yes no Biological Tissue is Frozen: yes no

Temp should be above freezing to 6°C.
 Biota Samples may be received at ≤ 0°C if shipped on Dry Ice.

Person examining contents:
 Date: 4/12/24 / Initials: NK
 Labeled By Initials: a

Chain of Custody Present:	<input checked="" type="checkbox"/> Yes <input type="checkbox"/> No <input type="checkbox"/> N/A	1.
Chain of Custody Filled Out:	<input type="checkbox"/> Yes <input checked="" type="checkbox"/> No <input type="checkbox"/> N/A	2. <u>Proj. #,</u> <u>4/12/24 NK</u>
Chain of Custody Relinquished:	<input checked="" type="checkbox"/> Yes <input type="checkbox"/> No <input type="checkbox"/> N/A	3.
Sampler Name & Signature on COC:	<input checked="" type="checkbox"/> Yes <input type="checkbox"/> No <input type="checkbox"/> N/A	4.
Samples Arrived within Hold Time:	<input checked="" type="checkbox"/> Yes <input type="checkbox"/> No	5.
- DI VOA Samples frozen upon receipt	<input type="checkbox"/> Yes <input type="checkbox"/> No	Date/Time:
Short Hold Time Analysis (<72hr):	<input type="checkbox"/> Yes <input checked="" type="checkbox"/> No	6.
Rush Turn Around Time Requested:	<input type="checkbox"/> Yes <input checked="" type="checkbox"/> No	7.
Sufficient Volume:		8.
For Analysis: <input checked="" type="checkbox"/> Yes <input type="checkbox"/> No MS/MSD: <input type="checkbox"/> Yes <input checked="" type="checkbox"/> No <input type="checkbox"/> N/A		
Correct Containers Used:	<input checked="" type="checkbox"/> Yes <input type="checkbox"/> No	9.
Correct Type: <u>Pace Green Bay</u> , Pace IR, Non-Pace		
Containers Intact:	<input checked="" type="checkbox"/> Yes <input type="checkbox"/> No	10.
Filtered volume received for Dissolved tests	<input type="checkbox"/> Yes <input type="checkbox"/> No <input checked="" type="checkbox"/> N/A	11.
Sample Labels match COC:	<input checked="" type="checkbox"/> Yes <input type="checkbox"/> No <input type="checkbox"/> N/A	12.
-Includes date/time/ID/Analysis Matrix: <u>W</u>		
Trip Blank Present:	<input checked="" type="checkbox"/> Yes <input type="checkbox"/> No <input type="checkbox"/> N/A	13.
Trip Blank Custody Seals Present	<input checked="" type="checkbox"/> Yes <input type="checkbox"/> No <input type="checkbox"/> N/A	
Pace Trip Blank Lot # (if purchased): <u>517</u>		

Client Notification/ Resolution: _____ If checked, see attached form for additional comments
 Person Contacted: _____ Date/Time: _____
 Comments/ Resolution: _____