

Taylor INDUSTRIAL VAC INC.

FAX

2721 W. Townsend Street

P.O. Box 16579

Milwaukee, WI 53216

Phone 414-447-4700 FAX 414-447-4990

229-0810

To	From	Date 11/17/97 Time 1:30pm
Jim Delwiche	Don Gagar	Number of Pages (including this one)

Remarks

Jim, K+W manufacturing has given the OK to conduct soil testing on their property. Enclosed is a proposed soil testing layout. If this looks ok let me know. I will schedule the geopraker and let you know so as to be present at the time of drilling. I tentatively am looking at the first week in Dec. This is all contingent upon Key products accepting the responsibility for the costs.

"Your solution to Environmental pollution" THANKS



Sheet1

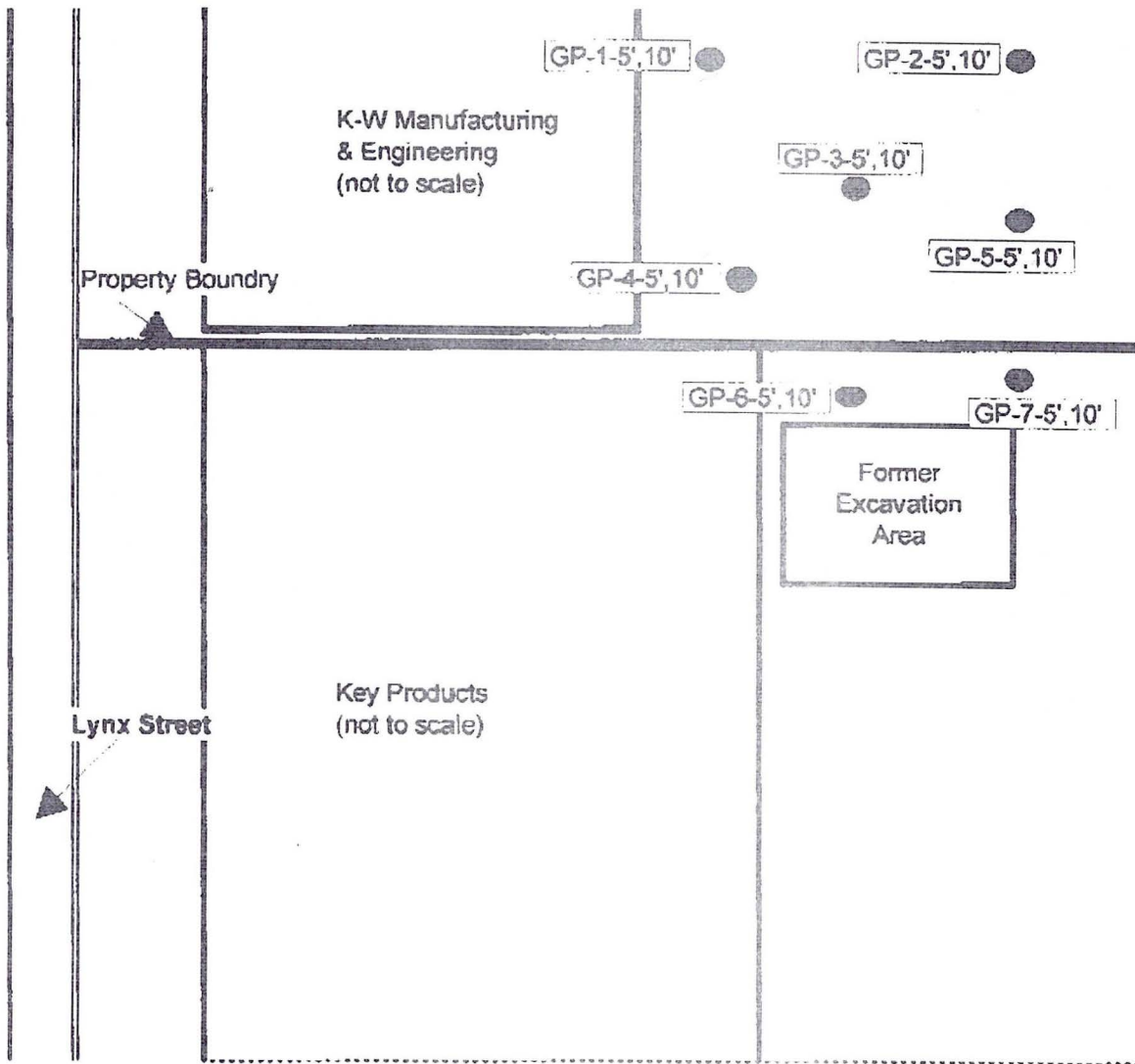

Geoprobe Locations
Key Products
 8634 W. Lynks
 Milwaukee, WI 53225

DWG: soil_key_geoprobe
 N ←
 1" = 10'
 Print By: DFG
 11/14/97