

Taylor INDUSTRIAL VAC INC.

FAX

2721 W. Townsend Street

P.O. Box 16579

Milwaukee, WI 53216

Phone 414-447-4700 FAX 414-447-4990

229-0810

To	From	Date	Time
James Delwiche	Don Gragos	11/24/97	10:00am
		Number of Pages (including this one) 11	

Remarks

Jim,

① Enclosed is letter explaining the correct addresses and information regarding the RP, Property owner, etc., for the letter.

② Copy of the off site test which I can submit now that I have access permission.

③ Also send me a copy of the letter

④ FAX # 447-4990

"Your solution to Environmental pollution"

Thanks



November 22, 1997

Mr. James Delwiche
DNR

Sent VIA FAX To: James Delwiche 229-0810

Subject: ERP FID# 241437790 Key Products Former Location at 8627 & 8633 W. Lynx.

Dear Mr. Delwiche,

I wanted to give you the correct addresses and information to clarify the letter for Mrs. Claudia Gehl.

First, Mrs. Gehl leased the property to Key Products Inc at 8627 & 8633 W. Lynx. Key Products Inc is now located at 10600 W. Glenbrook Ct., Milwaukee, WI 53224 contact person is Richard Meinberg at 355-5399. Mrs. Gehl's attorney is Mr. James Vollmar at 1535 East Racine Avenue, Post Office Box 527, Waukesha, WI 53187-0527, phone 542-4217 and FAX 542-1993.

Key Products is the responsible party and is required to conduct the off-site investigation and remediation. With the information we have there is no more work that can be conducted on the 8627/8633 property. Most of the contamination has migrated off site. See enclosed analysis of the sample taken off site in July. I now have access permission and can report this additional information. The information shows contamination at 5 feet and very little at 10-15 feet. Also, no perched water was seen at the 5 foot level which tells me that the perched water layer may be a pocket.

I hope this clears some of this confusing case. The letter indicating that no more work can be done to the property at 8627/8633 W. Lynx would give Mrs. Gehl the opportunity to sell the property and maintain the off-site responsibility with Key Products.

Any questions call me at 447-4700.

Sincerely,

Don Gagas

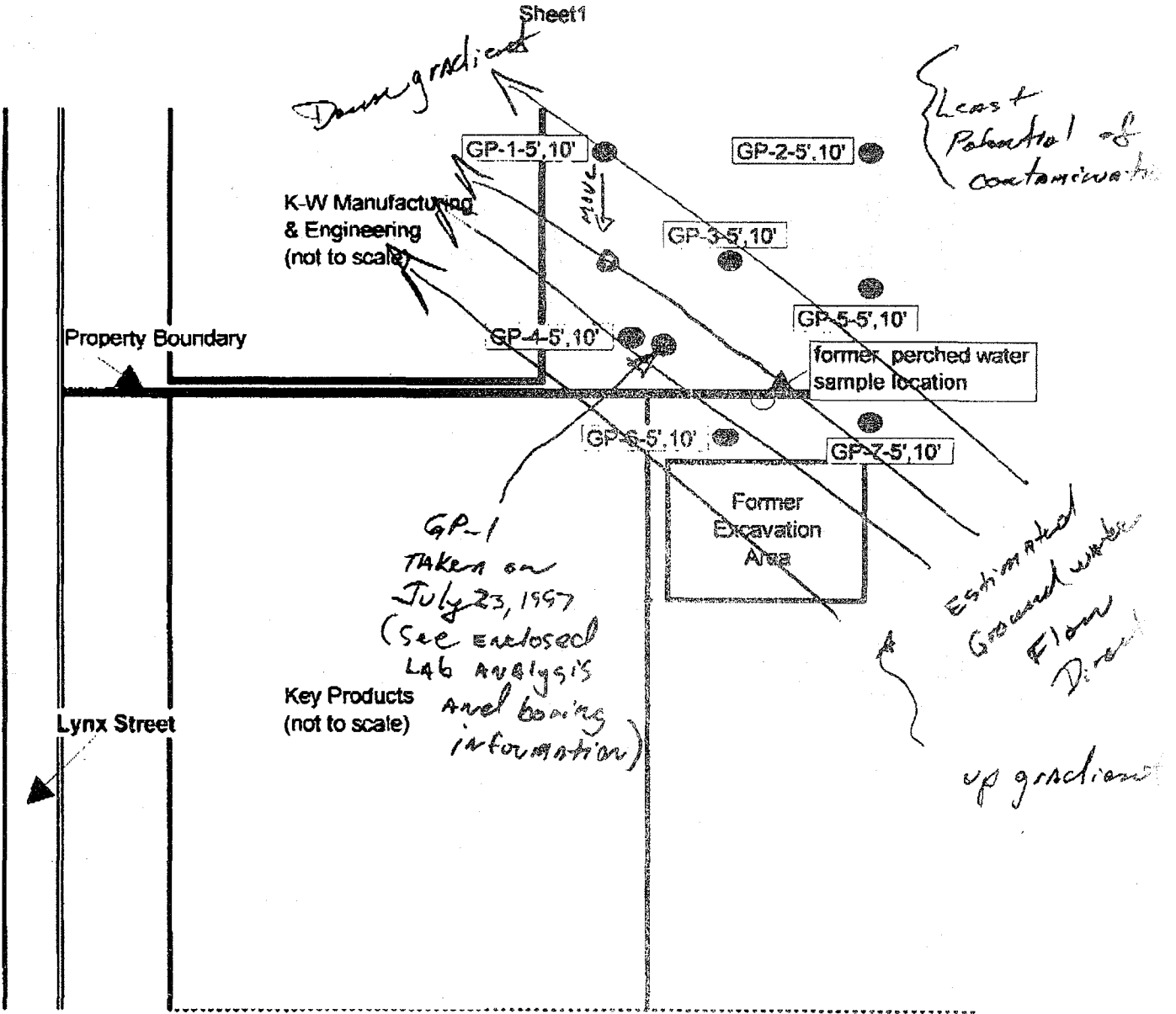

Geoprobe Locations (Per Dec 01/97)

Key Products
8627- 8633 W. Lynx
Milwaukee, WI 53225

DWG: soil_key_geoprobe

N ←

1" = 10'

Print By:DFG

11/14/97

State of Wisconsin
Department of Natural Resources

Route To:

- Solid Waste
- Emergency Response
- Wastewater
- Haz. Waste
- Underground Tanks
- Water Resources
- Other

SOIL BORING LOG INFORMATION
Form 4400-122 7-91

Page 1 of 1

Facility/Project Name <u>Key Products</u>		License/Permit/Monitoring Number		Boring Number <u>GP-1</u>	
Boring Drilled By (Firm name and name of crew chief) <u>ESP Enterprises, West Bend, WI</u>		Date Drilling Started <u>07/23/97</u> MM DD YY		Date Drilling Completed <u>07/23/97</u> MM DD YY	
DNR Facility Well No./WI Unique Well No.		Common Well Name		Final Static Water Level Feet MSL	
Boring Location State Plane _____ N. _____ E S/C/N Lat _____ _____ 1/4 of _____ 1/4 of Section _____, T _____ N. R _____ E/W Long _____		Surface Elevation Feet MSL		Borehole Diameter <u>2</u> inches	
County <u>Milwaukee</u>		DNR County Code		Civil Town/City/ or Village <u>Milwaukee</u>	

Sample Number	Length Recovered (in)	Blow Counts	Depth in Feet	Soil/Rock Description And Geologic Origin For Each Major Unit	USCS	Graphic Log	Well Diagram	PID/FID	Soil Properties				P 200	ROD/ Comments
									Standard Penetration	Moisture Content	Liquid Limit	Plastic Limit		
1				Compact stone 0.25'				ND		Dry				
				0.25' - 5' reddish brown clay gravel, sand, silt moist (near building, down tile) Sample # GP-1-5 (at 5')				77		Moist				Lab 5/20/97 GP-1
2				5' - 10' reddish brown/grey clay some sand and gravel moist to dry				ND		Moist to Dry				Lab 5/20/97 GP-1
				Sample # GP-1-10 (at 10')										
3				10' - 15' greyish clay dense, moist to dry				ND		Moist to Dry				Lab 5/20/97 GP-1
				Sample # GP-2-15 (at 15')										
				EOB										

I hereby certify that the information on this form is true and correct to the best of my knowledge.
Signature _____ Firm _____

This form is authorized by Chapters 144.147 and 162 Wis. Stats. Completion of this report is mandatory. Penalties: Forfeit not less than \$10 nor more than \$5,000 for each violation. Fined not less than \$10 or more than \$100 or imprisoned not less than 30 days, or both for each violation. Each day of continued violation is a separate offense, pursuant to ss 144.99 and 162.06, Wis. Stats.



**NATIONAL
ENVIRONMENTAL
TESTING, INC.**

Watertown Division
602 Commerce Drive
P.O. Box 288
Watertown, WI 53094
Tel: (414) 261-1660
Fax: (414) 261-8120
WDNR No. 128053530

ANALYTICAL AND QUALITY CONTROL REPORT

Mr. Don Gagas
TAYLOR INDUSTRIAL VAC, INC
2711 West Townsend
P. O. Box 16579
Milwaukee, WI 53216

07/29/1997

Job No: 97.06980

Page 1

Enclosed are the Analytical and Quality Control reports for the following samples submitted for analysis:

Sample Number	Sample Description	Date Taken	Date Received
258651	GP-1-5	07/23/1997	07/24/1997
258652	GP-1-10	07/23/1997	07/24/1997
258653	GP-1-15	07/23/1997	07/24/1997

Soil results are reported on a dry weight basis. The above sample(s) may have a result flag shown on the report. The following are the result flag definitions:

A = Analyzed/extracted past hold time	B = Blank is contaminated
C = Standard outside of control limits	D = Diluted for analysis
F = Sample filtered in lab	G = Received past hold time
H = Late eluting hydrocarbons present	I = Improperly handled sample
J = Estimated concentration	L = Common lab solvent and contaminant
M = Matrix interference	P = Improperly preserved sample
Q = Result confirmed via re-analysis	S = Sediment present
T = Does not match typical pattern	W = BOD re-set due to missed dilution
X = Unidentified compound(s) present	Z = Internal standard outside limits

Brian D. DeJong, Organic Operations Manager
Certification No. 128053530



**NATIONAL
ENVIRONMENTAL
TESTING, INC.**

Watertown Division
602 Commerce Drive
P.O. Box 288
Watertown, WI 53094
Tel: (414) 261-1660
Fax: (414) 261-8120
WDNR No. 128053530

ANALYTICAL REPORT

Mr. Don Gagas
TAYLOR INDUSTRIAL VAC, INC
2711 West Townsend
P. O. Box 16579
Milwaukee, WI 53216

07/29/1997
Job No: 97.06980
Sample No: 258651
Account No: 71290
Page 2

JOB DESCRIPTION: Key Products Sample
PROJECT DESCRIPTION: Soil Analysis
SAMPLE DESCRIPTION: GP-1-5
Recv'd 3.0 C

Date Taken: 07/23/1997 09:30

Date Received: 07/24/1997

Parameter	Results	Units	Reporting Limit	Method	Date Analyzed	Prep/Run Batch
VOC - METHANOL - 8260						
Benzene	<28	ug/kg	25	S-8260	07/25/1997	410
Bromobenzene	<28	ug/kg	25	S-8260	07/25/1997	410
Bromochloromethane	<28	ug/kg	25	S-8260	07/25/1997	410
Bromodichloromethane	<28	ug/kg	25	S-8260	07/25/1997	410
Bromoform	<28	ug/kg	25	S-8260	07/25/1997	410
Bromomethane	<110	ug/kg	100	S-8260	07/25/1997	410
n-Butylbenzene	<28	ug/kg	25	S-8260	07/25/1997	410
sec-Butylbenzene	<28	ug/kg	25	S-8260	07/25/1997	410
tert-Butylbenzene	<28	ug/kg	25	S-8260	07/25/1997	410
Carbon Tetrachloride	<28	ug/kg	25	S-8260	07/25/1997	410
Chlorobenzene	<28	ug/kg	25	S-8260	07/25/1997	410
Chlorodibromomethane	<28	ug/kg	25	S-8260	07/25/1997	410
Chloroethane	<38	ug/kg	35	S-8260	07/25/1997	410
Chloroform	<28	ug/kg	25	S-8260	07/25/1997	410
Chloromethane	<33	ug/kg	30	S-8260	07/25/1997	410
2-Chlorotoluene	<28	ug/kg	25	S-8260	07/25/1997	410
4-Chlorotoluene	<28	ug/kg	25	S-8260	07/25/1997	410
1,2-Dibromo-3-Chloropropane	<55	ug/kg	50	S-8260	07/25/1997	410
1,2-Dibromoethane (EDB)	<28	ug/kg	25	S-8260	07/25/1997	410
Dibromomethane	<28	ug/kg	25	S-8260	07/25/1997	410
1,2-Dichlorobenzene	<28	ug/kg	25	S-8260	07/25/1997	410
1,3-Dichlorobenzene	<28	ug/kg	25	S-8260	07/25/1997	410
1,4-Dichlorobenzene	<28	ug/kg	25	S-8260	07/25/1997	410
Dichlorodifluoromethane	<28	ug/kg	25	S-8260	07/25/1997	410
1,1-Dichloroethane	<28	ug/kg	25	S-8260	07/25/1997	410
1,2-Dichloroethane	<14	ug/kg	13	S-8260	07/25/1997	410
1,1-Dichloroethene	<28	ug/kg	25	S-8260	07/25/1997	410
cis-1,2-Dichloroethene	830	ug/kg	25	S-8260	07/25/1997	410
trans-1,2-Dichloroethene	<28	ug/kg	25	S-8260	07/25/1997	410
1,2-Dichloropropane	<28	ug/kg	25	S-8260	07/25/1997	410
1,3-Dichloropropane	<28	ug/kg	25	S-8260	07/25/1997	410
2,2-Dichloropropane	<28	ug/kg	25	S-8260	07/25/1997	410
1,1-Dichloropropene	<28	ug/kg	25	S-8260	07/25/1997	410
cis-1,3-Dichloropropene	<28	ug/kg	25	S-8260	07/25/1997	410
trans-1,3-Dichloropropene	<28	ug/kg	25	S-8260	07/25/1997	410
Di-isopropyl ether	<28	ug/kg	25	S-8260	07/25/1997	410
Ethylbenzene	<28	ug/kg	25	S-8260	07/25/1997	410



**NATIONAL
ENVIRONMENTAL
TESTING, INC.**

Watertown Division
602 Commerce Drive
P.O. Box 288
Watertown, WI 53094
Tel: (414) 261-1660
Fax: (414) 261-8120
WDNR No. 128053530

ANALYTICAL REPORT

Mr. Don Gagas
TAYLOR INDUSTRIAL VAC, INC
2711 West Townsend
P. O. Box 16579
Milwaukee, WI 53216

07/29/1997
Job No: 97.06980
Sample No: 258651
Account No: 71290
Page 3

JOB DESCRIPTION: Key Products Sample
PROJECT DESCRIPTION: Soil Analysis
SAMPLE DESCRIPTION: GP-1-5
Recv'd 3.0 C

Date Taken: 07/23/1997 09:30

Date Received: 07/24/1997

Parameter	Results	Units	Reporting Limit	Method	Date Analyzed	Prep/Run Batch
VOC - METHANOL - 8260						
Hexachlorobutadiene	<38	ug/kg	35	S-8260	07/25/1997	410
Isopropylbenzene	<28	ug/kg	25	S-8260	07/25/1997	410
p-Isopropyltoluene	<28	ug/kg	25	S-8260	07/25/1997	410
Methylene Chloride	L 74	ug/kg	50	S-8260	07/25/1997	410
Methyl-t-butyl ether	<28	ug/kg	25	S-8260	07/25/1997	410
Naphthalene	<28	ug/kg	25	S-8260	07/25/1997	410
n-Propylbenzene	<28	ug/kg	25	S-8260	07/25/1997	410
Styrene	<28	ug/kg	25	S-8260	07/25/1997	410
1,1,1,2-Tetrachloroethane	<28	ug/kg	25	S-8260	07/25/1997	410
1,1,2,2-Tetrachloroethane	<28	ug/kg	25	S-8260	07/25/1997	410
Tetrachloroethene	110,000	ug/kg	25	S-8260	07/28/1997	411
Toluene	<28	ug/kg	25	S-8260	07/25/1997	410
1,2,3-Trichlorobenzene	<28	ug/kg	25	S-8260	07/25/1997	410
1,2,4-Trichlorobenzene	<28	ug/kg	25	S-8260	07/25/1997	410
1,1,1-Trichloroethane	<28	ug/kg	25	S-8260	07/25/1997	410
1,1,2-Trichloroethane	<28	ug/kg	25	S-8260	07/25/1997	410
Trichloroethene	860	ug/kg	25	S-8260	07/25/1997	410
Trichlorofluoromethane	<28	ug/kg	25	S-8260	07/25/1997	410
1,2,3-Trichloropropane	<28	ug/kg	25	S-8260	07/25/1997	410
1,2,4-Trimethylbenzene	<28	ug/kg	25	S-8260	07/25/1997	410
1,3,5-Trimethylbenzene	<28	ug/kg	25	S-8260	07/25/1997	410
Vinyl Chloride	<28	ug/kg	25	S-8260	07/25/1997	410
Xylenes, Total	<38	ug/kg	35	S-8260	07/25/1997	410
Surr: Dibromofluoromethane	103.4	%	n/a	S-8260	07/25/1997	410
Surr: Toluene-d8	95.2	%	n/a	S-8260	07/25/1997	410
Surr: Bromofluorobenzene	98.6	%	n/a	S-8260	07/25/1997	410



**NATIONAL
ENVIRONMENTAL
TESTING, INC.**

Watertown Division
602 Commerce Drive
P.O. Box 288
Watertown, WI 53094
Tel: (414) 261-1860
Fax: (414) 261-8120
WDNR No. 128053530

ANALYTICAL REPORT

Mr. Don Gagas
TAYLOR INDUSTRIAL VAC, INC
2711 West Townsend
P. O. Box 16579
Milwaukee, WI 53216

07/29/1997
Job No: 97.06980
Sample No: 258652
Account No: 71290
Page 4

JOB DESCRIPTION: Key Products Sample
PROJECT DESCRIPTION: Soil Analysis
SAMPLE DESCRIPTION: GP-1-10
Recv'd 3.0 C

Date Taken: 07/23/1997 09:35

Date Received: 07/24/1997

Parameter	Results	Units	Reporting Limit	Method	Date Analyzed	Prep/Rep Batch
VOC - METHANOL - 8260						
Benzene	<25	ug/kg	25	S-8260	07/28/1997	411
Bromobenzene	<25	ug/kg	25	S-8260	07/28/1997	411
Bromochloromethane	<25	ug/kg	25	S-8260	07/28/1997	411
Bromodichloromethane	<25	ug/kg	25	S-8260	07/28/1997	411
Bromoform	<25	ug/kg	25	S-8260	07/28/1997	411
Bromomethane	<100	ug/kg	100	S-8260	07/28/1997	411
n-Butylbenzene	<25	ug/kg	25	S-8260	07/28/1997	411
sec-Butylbenzene	<25	ug/kg	25	S-8260	07/28/1997	411
tert-Butylbenzene	<25	ug/kg	25	S-8260	07/28/1997	411
Carbon Tetrachloride	<25	ug/kg	25	S-8260	07/28/1997	411
Chlorobenzene	<25	ug/kg	25	S-8260	07/28/1997	411
Chlorodibromomethane	<25	ug/kg	25	S-8260	07/28/1997	411
Chloroethane	<35	ug/kg	35	S-8260	07/28/1997	411
Chloroform	<25	ug/kg	25	S-8260	07/28/1997	411
Chloromethane	<30	ug/kg	30	S-8260	07/28/1997	411
2-Chlorotoluene	<25	ug/kg	25	S-8260	07/28/1997	411
4-Chlorotoluene	<25	ug/kg	25	S-8260	07/28/1997	411
1,2-Dibromo-3-Chloropropane	<50	ug/kg	50	S-8260	07/28/1997	411
1,2-Dibromoethane (EDB)	<25	ug/kg	25	S-8260	07/28/1997	411
Dibromomethane	<25	ug/kg	25	S-8260	07/28/1997	411
1,2-Dichlorobenzene	<25	ug/kg	25	S-8260	07/28/1997	411
1,3-Dichlorobenzene	<25	ug/kg	25	S-8260	07/28/1997	411
1,4-Dichlorobenzene	<25	ug/kg	25	S-8260	07/28/1997	411
Dichlorodifluoromethane	<25	ug/kg	25	S-8260	07/28/1997	411
1,1-Dichloroethane	<25	ug/kg	25	S-8260	07/28/1997	411
1,2-Dichloroethane	<13	ug/kg	13	S-8260	07/28/1997	411
1,1-Dichloroethene	<25	ug/kg	25	S-8260	07/28/1997	411
cis-1,2-Dichloroethene	<25	ug/kg	25	S-8260	07/28/1997	411
trans-1,2-Dichloroethene	<25	ug/kg	25	S-8260	07/28/1997	411
1,2-Dichloropropane	<25	ug/kg	25	S-8260	07/28/1997	411
1,3-Dichloropropane	<25	ug/kg	25	S-8260	07/28/1997	411
2,2-Dichloropropane	<25	ug/kg	25	S-8260	07/28/1997	411
1,1-Dichloropropene	<25	ug/kg	25	S-8260	07/28/1997	411
cis-1,3-Dichloropropene	<25	ug/kg	25	S-8260	07/28/1997	411
trans-1,3-Dichloropropene	<25	ug/kg	25	S-8260	07/28/1997	411
Di-isopropyl ether	<25	ug/kg	25	S-8260	07/28/1997	411
Ethylbenzene	<25	ug/kg	25	S-8260	07/28/1997	411



**NATIONAL
ENVIRONMENTAL
TESTING, INC.**

Watertown Division
602 Commerce Drive
P.O. Box 288
Watertown, WI 53094
Tel: (414) 261-1660
Fax: (414) 261-8120
WDNR No. 128053530

ANALYTICAL REPORT

Mr. Don Gagas
TAYLOR INDUSTRIAL VAC, INC
2711 West Townsend
P. O. Box 16579
Milwaukee, WI 53216

07/29/1997
Job No: 97.06980
Sample No: 258652
Account No: 71290
Page 5

JOB DESCRIPTION: Key Products Sample
PROJECT DESCRIPTION: Soil Analysis
SAMPLE DESCRIPTION: GP-1-10
Recv'd 3.0 C

Date Taken: 07/23/1997 09:35

Date Received: 07/24/1997

Parameter	Results	Units	Reporting Limit	Method	Date Analyzed	Prep/Run Batch
VOC - METHANOL - 8260						
Hexachlorobutadiene	<35	ug/kg	35	S-8260	07/28/1997	411
Isopropylbenzene	<25	ug/kg	25	S-8260	07/28/1997	411
p-Isopropyltoluene	<25	ug/kg	25	S-8260	07/28/1997	411
Methylene Chloride	<50	ug/kg	50	S-8260	07/28/1997	411
Methyl-t-butyl ether	<25	ug/kg	25	S-8260	07/28/1997	411
Naphthalene	<25	ug/kg	25	S-8260	07/28/1997	411
n-Propylbenzene	<25	ug/kg	25	S-8260	07/28/1997	411
Styrene	<25	ug/kg	25	S-8260	07/28/1997	411
1,1,1,2-Tetrachloroethane	<25	ug/kg	25	S-8260	07/28/1997	411
1,1,2,2-Tetrachloroethane	<25	ug/kg	25	S-8260	07/28/1997	411
Tetrachloroethene	33	ug/kg	25	S-8260	07/28/1997	411
Toluene	<25	ug/kg	25	S-8260	07/28/1997	411
1,2,3-Trichlorobenzene	<25	ug/kg	25	S-8260	07/28/1997	411
1,2,4-Trichlorobenzene	<25	ug/kg	25	S-8260	07/28/1997	411
1,1,1-Trichloroethane	<25	ug/kg	25	S-8260	07/28/1997	411
1,1,2-Trichloroethane	<25	ug/kg	25	S-8260	07/28/1997	411
Trichloroethene	<25	ug/kg	25	S-8260	07/28/1997	411
Trichlorofluoromethane	<25	ug/kg	25	S-8260	07/28/1997	411
1,2,3-Trichloropropane	<25	ug/kg	25	S-8260	07/28/1997	411
1,2,4-Trimethylbenzene	<25	ug/kg	25	S-8260	07/28/1997	411
1,3,5-Trimethylbenzene	<25	ug/kg	25	S-8260	07/28/1997	411
Vinyl Chloride	<25	ug/kg	25	S-8260	07/28/1997	411
Xylenes, Total	<35	ug/kg	35	S-8260	07/28/1997	411
Surr: Dibromofluoromethane	95.2	%	n/a	S-8260	07/28/1997	411
Surr: Toluene-d8	99.8	%	n/a	S-8260	07/28/1997	411
Surr: Bromofluorobenzene	100.2	%	n/a	S-8260	07/28/1997	411



**NATIONAL
ENVIRONMENTAL
TESTING, INC.**

Watertown Division
602 Commerce Drive
P.O. Box 288
Watertown, WI 53094
Tel: (414) 261-1660
Fax: (414) 261-8120
WDNR No. 128053530

ANALYTICAL REPORT

Mr. Don Gagas
TAYLOR INDUSTRIAL VAC, INC
2711 West Townsend
P. O. Box 16579
Milwaukee, WI 53216

07/29/1997
Job No: 97.06980
Sample No: 258653
Account No: 71290
Page 6

JOB DESCRIPTION: Key Products Sample
PROJECT DESCRIPTION: Soil Analysis
SAMPLE DESCRIPTION: GP-1-15
Recv'd 3.0 C

Date Taken: 07/23/1997 09:40

Date Received: 07/24/1997

Parameter	Results	Units	Reporting Limit	Method	Date Analyzed	Prep/Ship Batch
VOC - METHANOL - 8260		I				
Benzene	<32	ug/kg	25	S-8260	07/25/1997	410
Bromobenzene	<32	ug/kg	25	S-8260	07/25/1997	410
Bromochloromethane	<32	ug/kg	25	S-8260	07/25/1997	410
Bromodichloromethane	<32	ug/kg	25	S-8260	07/25/1997	410
Bromoform	<32	ug/kg	25	S-8260	07/25/1997	410
Bromomethane	<130	ug/kg	100	S-8260	07/25/1997	410
n-Butylbenzene	<32	ug/kg	25	S-8260	07/25/1997	410
sec-Butylbenzene	<32	ug/kg	25	S-8260	07/25/1997	410
tert-Butylbenzene	<32	ug/kg	25	S-8260	07/25/1997	410
Carbon Tetrachloride	<32	ug/kg	25	S-8260	07/25/1997	410
Chlorobenzene	<32	ug/kg	25	S-8260	07/25/1997	410
Chlorodibromomethane	<32	ug/kg	25	S-8260	07/25/1997	410
Chloroethane	<46	ug/kg	35	S-8260	07/25/1997	410
Chloroform	<32	ug/kg	25	S-8260	07/25/1997	410
Chloromethane	<39	ug/kg	30	S-8260	07/25/1997	410
2-Chlorotoluene	<32	ug/kg	25	S-8260	07/25/1997	410
4-Chlorotoluene	<32	ug/kg	25	S-8260	07/25/1997	410
1,2-Dibromo-3-Chloropropane	<65	ug/kg	50	S-8260	07/25/1997	410
1,2-Dibromoethane (EDB)	<32	ug/kg	25	S-8260	07/25/1997	410
Dibromomethane	<32	ug/kg	25	S-8260	07/25/1997	410
1,2-Dichlorobenzene	<32	ug/kg	25	S-8260	07/25/1997	410
1,3-Dichlorobenzene	<32	ug/kg	25	S-8260	07/25/1997	410
1,4-Dichlorobenzene	<32	ug/kg	25	S-8260	07/25/1997	410
Dichlorodifluoromethane	<32	ug/kg	25	S-8260	07/25/1997	410
1,1-Dichloroethane	<32	ug/kg	25	S-8260	07/25/1997	410
1,2-Dichloroethane	<17	ug/kg	13	S-8260	07/25/1997	410
1,1-Dichloroethene	<32	ug/kg	25	S-8260	07/25/1997	410
cis-1,2-Dichloroethene	<32	ug/kg	25	S-8260	07/25/1997	410
trans-1,2-Dichloroethene	<32	ug/kg	25	S-8260	07/25/1997	410
1,2-Dichloropropane	<32	ug/kg	25	S-8260	07/25/1997	410
1,3-Dichloropropane	<32	ug/kg	25	S-8260	07/25/1997	410
2,2-Dichloropropane	<32	ug/kg	25	S-8260	07/25/1997	410
1,1-Dichloropropene	<32	ug/kg	25	S-8260	07/25/1997	410
cis-1,3-Dichloropropene	<32	ug/kg	25	S-8260	07/25/1997	410
trans-1,3-Dichloropropene	<32	ug/kg	25	S-8260	07/25/1997	410
Di-isopropyl ether	<32	ug/kg	25	S-8260	07/25/1997	410
Ethylbenzene	<32	ug/kg	25	S-8260	07/25/1997	410



**NATIONAL
ENVIRONMENTAL
TESTING, INC.**

Watertown Division
602 Commerce Drive
P.O. Box 288
Watertown, WI 53094
Tel: (414) 261-1660
Fax: (414) 261-8120
WDNR No. 128053530

ANALYTICAL REPORT

Mr. Don Gagas
TAYLOR INDUSTRIAL VAC, INC
2711 West Townsend
P. O. Box 16579
Milwaukee, WI 53216

07/29/1997
Job No: 97.06980
Sample No: 258653
Account No: 71290
Page 7

JOB DESCRIPTION: Key Products Sample
PROJECT DESCRIPTION: Soil Analysis
SAMPLE DESCRIPTION: GP-1-15
Recv'd 3.0 C

Date Taken: 07/23/1997 09:40

Date Received: 07/24/1997

Parameter	Results	Units	Reporting Limit	Method	Date Analyzed	Prep/Rpt Batch
VOC - METHANOL - 8260		I				
Hexachlorobutadiene	<46	ug/kg	35	S-8260	07/25/1997	410
Isopropylbenzene	<32	ug/kg	25	S-8260	07/25/1997	410
p-Isopropyltoluene	<32	ug/kg	25	S-8260	07/25/1997	410
Methylene Chloride	<65	ug/kg	50	S-8260	07/25/1997	410
Methyl-t-butyl ether	<32	ug/kg	25	S-8260	07/25/1997	410
Naphthalene	<32	ug/kg	25	S-8260	07/25/1997	410
n-Propylbenzene	<32	ug/kg	25	S-8260	07/25/1997	410
Styrene	<32	ug/kg	25	S-8260	07/25/1997	410
1,1,1,2-Tetrachloroethane	<32	ug/kg	25	S-8260	07/25/1997	410
1,1,2,2-Tetrachloroethane	<32	ug/kg	25	S-8260	07/25/1997	410
Tetrachloroethene	76	ug/kg	25	S-8260	07/25/1997	410
Toluene	<32	ug/kg	25	S-8260	07/25/1997	410
1,2,3-Trichlorobenzene	<32	ug/kg	25	S-8260	07/25/1997	410
1,2,4-Trichlorobenzene	<32	ug/kg	25	S-8260	07/25/1997	410
1,1,1-Trichloroethane	<32	ug/kg	25	S-8260	07/25/1997	410
1,1,2-Trichloroethane	<32	ug/kg	25	S-8260	07/25/1997	410
Trichloroethene	<32	ug/kg	25	S-8260	07/25/1997	410
Trichlorofluoromethane	<32	ug/kg	25	S-8260	07/25/1997	410
1,2,3-Trichloropropane	<32	ug/kg	25	S-8260	07/25/1997	410
1,2,4-Trimethylbenzene	44	ug/kg	25	S-8260	07/25/1997	410
1,3,5-Trimethylbenzene	<32	ug/kg	25	S-8260	07/25/1997	410
Vinyl Chloride	<32	ug/kg	25	S-8260	07/25/1997	410
Xylenes, Total	57	ug/kg	35	S-8260	07/25/1997	410
Surr: Dibromofluoromethane	103.4	%	n/a	S-8260	07/25/1997	410
Surr: Toluene-d8	96.2	%	n/a	S-8260	07/25/1997	410
Surr: Bromofluorobenzene	99.4	%	n/a	S-8260	07/25/1997	410