



Excellence through experience™

709 Gillette St., Ste #3 ♦ La Crosse, WI 54603 ♦ 1-800-552-2932 ♦ Fax (608) 781-8893 Email: rona@metcohq.com ♦ www.metcohq.com

March 14, 2019

Cindy Koepke
Wisconsin Department of Natural Resources
3911 Fish Hatchery Road
Fitchburg, WI 53711

Subject: North Main Citgo (Former) – Bid Deferment request for additional investigation - (Revised). BRRTS #: 03-54-176662, PECFA #: 53534-1824-25-A

Dear Ms. Koepke,

A revised bid deferment/variance request is being submitted for additional investigation activities at the subject property located at 25 N. Main Street in Edgerton, Wisconsin. The work scope will include: [1] Geoprobe Project with two borings to ~16 feet bgs with soil (PID and geologic description) and groundwater samples (PVOC+Naphthalene analysis) to best place the proposed monitoring well. [2] Drilling Project with the installation of one monitoring well to 18 feet below ground surface with a 15-foot well screen for up-gradient contaminant definition. One soil sample will be collected and analyzed for GRO, DRO, PVOC+Naphthalene, TCLP Lead, and TCLP Benzene for waste disposal characterization, [3] Conduct two quarterly rounds of groundwater monitoring from the existing well network (9 wells) for PVOC and Naphthalene analysis. The new well (MW-9) will be sampled for VOC's in the first round, [4] Survey, [5] Investigative Waste Disposal, [6] Conduct a Sub Slab Vapor Sampling (SSVS) Project within the source property building located at 25 N. Main Street which will include installing three permanent SSVS ports and sample for TO-15 (PVOC and Naphthalene) analysis, [7] Prepare a second cross section that will include the two NR720 Direct Contact areas as requested, [8] Prepare Letter Report, and [9] Prepare a Remedial Actions Option Report (RAOR) per NR722 as requested. The cost estimate is as follows:

Access Permission	\$ 401.94
Geoprobe Project	\$ 1,743.95
Drilling Project	\$ 3,018.25
Surveying	\$ 110.15
Investigative Waste Disposal	\$ 712.01
Groundwater Monitoring (2 rounds)	\$ 2,685.94
Laboratory Analysis	\$ 1,099.48

Conduct SSVS Project	\$ 2,344.73
Prepare second cross section	\$ 690.30 (variance)
Letter Report	\$ 1,039.29
Prepare RAOR (subcontracted)	\$ 5,000.00 (variance)
Change Order Request	\$ 381.78
Total	\$19,227.82

METCO is requesting a bid deferment/variance in the amount of \$19,227.82 to complete the above work scope. Upon state and client approval of the proposed work scope and budget, METCO will proceed with the project.

Attached is a site layout map with proposed Geoprobe borings, monitoring well, and SSVS locations and U&C standardized invoice as required.

Should you have any questions, comments, or recommendations please contact me at our La Crosse office (608) 781-8879 or email at jasonp@metcohq.com.

Sincerely,



Jason T. Powell
Staff Scientist

Attachment

c: Estate of Richard P. Johnson c/o Suzanne Johnson – Client
Ed Francois – Francois Oil Co.

B.3.b GROUNDWATER
ISOCONCENTRATION (6-II-18)

NORTH MAIN CITGO

EDGERTON,
WISCONSIN
DRAWN BY: ED DATE: 10/06/09
MODIFIED BY: HW DATE: 08/08/2008

NOTE: INFORMATION BASED ON AVAILABLE
DATA. ACTUAL CONDITIONS MAY DIFFER

- - - - - PROPERTY BOUNDARY
- - - - - PRODUCT LINES (REMOVED)
- ===== OVERHEAD LINES
- - - - - SANITARY SEWER LINE
- - - - - WATER LINE
- - - - - NATURAL GAS LINE

- ⊕ - ABANDONED MONITORING WELL
HALVERSON'S 66
- - GEOPROBE BORING LOCATION
- ⊕ - MONITORING WELL LOCATION
- ▲ - UST CLOSURE SOIL SAMPLING LOCATION

KEY TO UST CLOSURE SAMPLES

- #1 - BUILDING WEST SIDE
- #2 - NORTH SIDE WALL
- #3 - WEST SIDE WALL
- #4 - SOUTH SIDEWALL WEST
- #5 - SOUTH SIDEWALL EAST
- #6 - BUILDING SOUTH

KEY TO UST SYSTEMS

- A - REMOVED 10,000 GAL. UNLEADED GASOLINE UST
(REMOVED 2015)
- B - REMOVED 10,000 GAL PREMIUM GASOLINE UST
(REMOVED 2015)
- C - REMOVED 10,000 GAL. DIESEL UST (REMOVED 2015)
- D - REMOVED 2,000 GAL. KEROSENE UST (REMOVED 2015)
- E - REMOVED 550 GAL. KEROSENE UST (REMOVED 1998)
- F - REMOVED 550 GAL. WASTE OIL UST (REMOVED 1998)

[] - UST CLOSURE EXCAVATION EXTENT
(CURRENTLY GRAVEL COVERED)

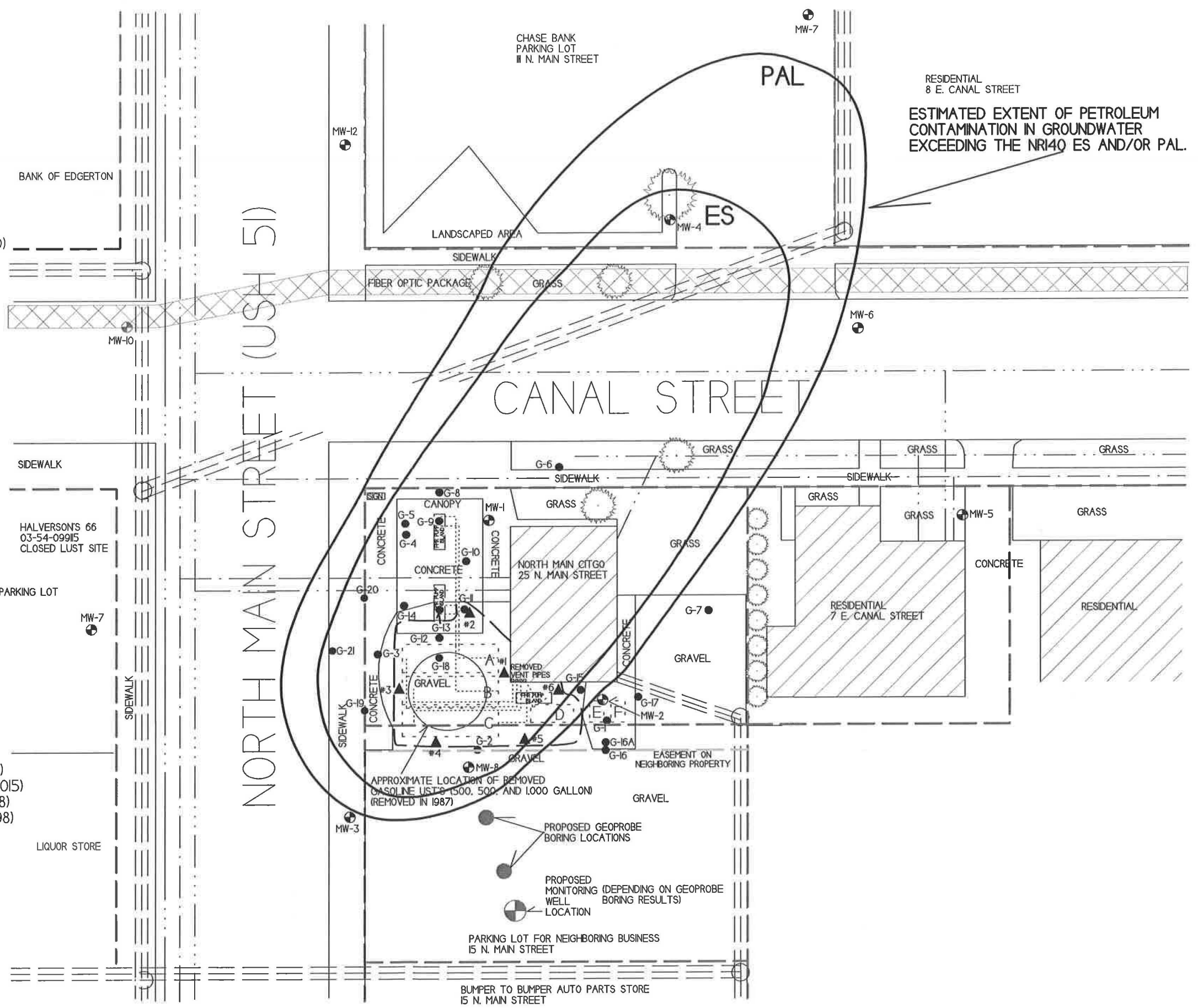
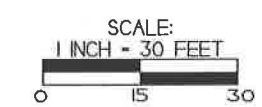

Usual and Customary Standardized Invoice #25

January 2019 - June 2019



PECFA #: 53534-1824-25
 BRRS #: 03-54-176662
 Site Name: North Main Cilgo
 Site Address: 25 N. Main St., Edgerton, WI

Vendor Name: _____
 Invoice #: _____
 Invoice Date: _____
 Check #: _____

U&C Total \$ 13,537.52
 Variance to U&C Total \$ 5,690.30
 Grand Total \$ 19,227.82

TASK	TASK DESCRIPTION	SERVICES	ACTIVITY CODE	ACTIVITY REFERENCE CODE DESCRIPTION	UNIT	MAX UNIT COST	UNITS	TOTAL MAX
1	GW Sampling		GS05	Sample Collection	Well	\$ 72.45	18	\$ 1,304.10
1	GW Sampling		GS25	Primary Mob/Demob	Site	\$ 690.92	2	\$ 1,381.84
4	Waste Disposal	Consultant	WD05	Consultant Coordination	Site	\$ 137.13	1	\$ 137.13
4	Waste Disposal	Commodity	WD10	GW Sample and/or Purge	Drum	\$ 42.11	1	\$ 42.11
4	Waste Disposal	Commodity	WD15	Drill Cuttings	Drum	\$ 108.15	2	\$ 216.30
4	Waste Disposal	Commodity	WD25	Primary Mob/Demob	Site	\$ 316.47	1	\$ 316.47
6	Letter Report/Addendum		LRA05	Letter Report/Addendum	Letter	\$ 1,039.29	1	\$ 1,039.29
10	Initial Site Survey	Consultant	IS10	Subsequent Surveys	Well	\$ 110.15	1	\$ 110.15
12	Direct Push	Consultant	DP05	0 - 24 ft bgs W/ Continuous Soil Sampling	Ft	\$ 5.36	32	\$ 171.52
12	Direct Push	Consultant	DP20	GW Sample Collection	Each	\$ 36.10	2	\$ 72.20
12	Direct Push	Consultant	DP30	Primary Mob/Demob	Site	\$ 563.31	1	\$ 563.31
12	Direct Push	Commodity	DP35	0 - 24 ft bgs W/ Continuous Soil Sampling	Ft	\$ 6.93	32	\$ 221.76
12	Direct Push	Commodity	DP50	GW Sample Collection (cost for tubing)	Ft	\$ 0.42	42	\$ 17.64
12	Direct Push	Commodity	DP60	Borehole Abandonment	Ft	\$ 1.26	32	\$ 40.32
12	Direct Push	Commodity	DP70	GW Sample Collection	Each	\$ 39.27	2	\$ 78.54
12	Direct Push	Commodity	DP80	Mob/Demob (Includes decon)	Site	\$ 578.66	1	\$ 578.66
13.a	Drilling In Unconsolidated Soils - With Soil Sampling	Consultant	DR05	0 - 25 ft bgs	Ft	\$ 5.40	19	\$ 102.60
13.a	Drilling In Unconsolidated Soils - With Soil Sampling	Consultant	DR20	Primary Mob/Demob	Site	\$ 652.34	1	\$ 652.34
13.d	Drilling In Unconsolidated Soils - With Soil Sampling	Commodity	DR45	0 - 25 ft bgs	Ft	\$ 16.70	19	\$ 317.30
14	Monitoring Well Installation	Consultant	MWI05	0 - 25 ft bgs	Ft	\$ 3.89	18	\$ 70.02
14	Monitoring Well Installation	Commodity	MWI15	2 inch PVC Casing	Ft	\$ 16.70	18	\$ 300.60
14	Monitoring Well Installation	Commodity	MWI20	Well Development	Well	\$ 147.63	1	\$ 147.63
15	Misc. Drilling Activities & Supplies		MDT05	Drill Rig Mob/Demob	Mob/Demob	\$ 1,059.72	1	\$ 1,059.72
15	Misc. Drilling Activities & Supplies		MDT10	Well Cover/flushmount	Each	\$ 202.65	1	\$ 202.65
15	Misc. Drilling Activities & Supplies		MDT21	Drum, 55 gal. DOT steel	Each	\$ 55.13	3	\$ 165.39
21	Access Agreements		AA05	Access Agreements	Property	\$ 401.94	1	\$ 401.94
33	Schedule Of Laboratory Maximums	Commodity		Laboratory (see task 33 total on Lab Schedule)	Lab Schedule			\$ 1,099.48
36	Change Order Request		COR05	Change Order Request (cost cap exceedance requests)	Change Order	\$ 381.78	1	\$ 381.78
37	Vapor Point Installation & Sampling		VIS05	Installation & Sampling (up to 5 points)	Point	\$ 510.26	3	\$ 1,530.78
37	Vapor Point Installation & Sampling		VIS10	Mob/Demob (up to 5 points)	Site	\$ 813.95	1	\$ 813.95
Variance	Prepare second cross section map as requested (10 hours @ \$69.03/hour)							\$ 690.30
Variance	Prepare Remedial Actions Option Report (RAOR) - Subcontracted							\$ 5,000.00

Usual and Customary Standardized Invoice #25

January 2019 - June 2019



RR-107a

TOTAL LAB CHARGES \$ 1,099.48 TASK 33 30 \$ 1,099.48 TASK 24 0 \$ -

MATRIX	REF CODE	REIMBURSABLE ANALYTE	UNITS	MAX COST	SAMPLES	TOTAL	MAX COST	SAMPLES	TOTAL
AIR	A1	Benzene	SAMPLE	\$ 44.94	\$	-			
AIR	A2	BETX	SAMPLE	\$ 49.46	\$	-			
AIR	A3	GRO	SAMPLE	\$ 46.10	\$	-			
AIR	A4	VOC's	SAMPLE	\$ 71.93	\$	-			
WATER	W1	GRO/PVOC	SAMPLE	\$ 29.19	\$	-			
WATER	W2	PVOC	SAMPLE	\$ 26.99	\$	-			
WATER	W3	PVOC + 1,2 DCA	SAMPLE	\$ 43.79	\$	-			
WATER	W4	PVOC + Naphthalene	SAMPLE	\$ 30.35	21 \$	637.35			
WATER	W5	VOC	SAMPLE	\$ 71.93	2 \$	143.86			
WATER	W6	PAH	SAMPLE	\$ 72.98	\$	-			
WATER	W7	Lead	SAMPLE	\$ 12.39	\$	-			
WATER	W8	Cadmium	SAMPLE	\$ 13.55	\$	-			
WATER	W9	Hardness	SAMPLE	\$ 12.39	\$	-			
WATER	W10	BOD, Total	SAMPLE	\$ 23.63	\$	-			
WATER	W11	Nitrate	SAMPLE	\$ 11.24	\$	-			
WATER	W12	Total Kjeldahl	SAMPLE	\$ 20.27	\$	-			
WATER	W13	Ammonia	SAMPLE	\$ 16.91	\$	-			
WATER	W14	Sulfate	SAMPLE	\$ 10.19	\$	-			
WATER	W15	Iron	SAMPLE	\$ 10.19	\$	-			
WATER	W16	Manganese	SAMPLE	\$ 10.19	\$	-			
WATER	W17	Alkalinity	SAMPLE	\$ 10.19	\$	-			
WATER	W18	methane	SAMPLE	\$ 46.10	\$	-			
WATER	W19	Phosphorous	SAMPLE	\$ 18.06	\$	-			
WATER	W20	VOC Method 524.2	SAMPLE	\$ 176.30	\$	-			
WATER	W21	EDB Method 504	SAMPLE	\$ 95.45	\$	-			
SOILS	S1	GRO	SAMPLE	\$ 24.78	2 \$	49.56	\$ 24.78		\$ -
SOILS	S2	DRO	SAMPLE	\$ 30.35	1 \$	30.35	\$ 30.35		\$ -
SOILS	S3	GRO/PVOC	SAMPLE	\$ 28.14	\$	-	\$ 28.14		\$ -
SOILS	S4	PVOC	SAMPLE	\$ 25.83	\$	-	\$ 25.83		\$ -
SOILS	S5	PVOC + 1,2 DCA + Naphthalene	SAMPLE	\$ 49.46	\$	-	\$ 49.46		\$ -
SOILS	S6	PVOC + Naphthalene	SAMPLE	\$ 36.02	2 \$	72.04	\$ 36.02		\$ -
SOILS	S7	VOC	SAMPLE	\$ 71.93	\$	-	\$ 71.93		\$ -
SOILS	S8	SPLP Extraction VOC only	SAMPLE	\$ 50.61	\$	-	\$ 50.61		\$ -
SOILS	S9	PAH	SAMPLE	\$ 72.98	\$	-	\$ 72.98		\$ -
SOILS	S10	Lead	SAMPLE	\$ 12.39	\$	-	\$ 12.39		\$ -
SOILS	S11	Cadmium	SAMPLE	\$ 14.60	\$	-			
SOILS	S12	Free Liquid	SAMPLE	\$ 11.24	\$	-			
SOILS	S13	Flash Point	SAMPLE	\$ 25.83	\$	-			
SOILS	S14	Grain Size - dry	SAMPLE	\$ 42.74	\$	-			
SOILS	S15	Grain Size - wet	SAMPLE	\$ 57.33	\$	-			
SOILS	S16	Bulk Density	SAMPLE	\$ 13.55	\$	-			
SOILS	S17	Permeability	SAMPLE	\$ 41.58	\$	-			
SOILS	S18	Nitrogen as Total Kjeldahl	SAMPLE	\$ 20.27	\$	-			
SOILS	S19	Nitrogen as Ammonia	SAMPLE	\$ 16.91	\$	-			
SOILS	S20	% Organic Matter	SAMPLE	\$ 29.19	\$	-			
SOILS	S21	TOC as NPOC	SAMPLE	\$ 57.33	\$	-			
SOILS	S22	Soil Moisture Content	SAMPLE	\$ 6.83	\$	-			
SOILS	S23	Air Filled Porosity	SAMPLE	\$ 25.83	\$	-			
SOILS	S24	% Total Solids	SAMPLE	\$ 6.83	\$	-			
SOILS	S25	Field Capacity	SAMPLE	\$ 28.14	\$	-			
SOILS	S26	TCLP Lead	SAMPLE	\$ 83.16	1 \$	83.16			
SOILS	S27	Cation Exchange (Ca, MG, & K)	SAMPLE	\$ 26.99	\$	-			
SOILS	S28	TCLP Cadmium	SAMPLE	\$ 83.16	\$	-			
SOILS	S29	TCLP Benzene	SAMPLE	\$ 83.16	1 \$	83.16			
		Viscosity + Density							
LNAPL	LFPS01	Interfacial tension I (LNAPL/water [dyne/cm])	SAMPLE	\$ 561.33	\$	-			
		Interfacial tension II (LNAPL/air [dyne/cm])							
		Interfacial tension III (water/air [dyne/cm])							
TASK 33 TOTAL \$						1,099.48			