

5/17/12

FID 24/08/280

ACTION: 99

COPY

May 16, 2012

Craig Environmental, LLC  
524 Hamilton Street  
Stoughton, Wisconsin 53589

**SUBJECT: Request for Site Investigation Proposal  
Queens Way Cleaners (former), aka Speedy Lube  
117 East Capital Drive, Milwaukee, Wisconsin  
BRRTS # 02-41-182420**

Dear Madam or Sir:

As representative of the Hunn Family Trust (responsible party for BRRTS case# 02-41-182420), I am requesting a proposal from your company for a site investigation of the property at 117 East Capital Drive, Milwaukee, Wisconsin. The Wisconsin Department of Natural Resources (WDNR) was notified of a tetrachloroethylene (PCE) release discovered in soil at the property on November 3, 1997. The WDNR responded in a letter dated February 24, 1998. A soil investigation was conducted in August 1998. Additional investigation of the site, which is enrolled in the Dry Cleaner Environmental Response Fund (DERF) program, is required.

#### **Background**

The property operated as a dry cleaning facility (Queens Way Cleaners) from 1962 through 1982, and as automobile service facility (Speedy Lube) from 1997 to 2002. In 1997, an investigation related to the underground storage tank (UST) at the site discovered chlorobenzene and PCE in the soil. In 1998, additional soil sampling and analysis were conducted. In 1999, a 300-gallon-capacity UST was removed from the site. PCE was detected in a soil sample (S-100) collected from near the base of the tank. Soil analytical results are summarized in **Table 1**, and sampling locations are shown on **Figure 4**. (**Table 1** and **Figure 4** are from a work plan prepared by Envirogen, dated October 22, 2002.) Additional information is available from the WDNR files.

Soils at the site consist of silts, clayey silts, and clays; depth to groundwater is estimated to be about 7 feet (Environmental Associates, Inc., work plan dated April 20, 2000). Based on the depth of the soil contamination, groundwater contamination is also likely.

#### **Proposal Requirements**

Please prepare a proposal to investigate the horizontal and vertical extent of soil and groundwater contamination at the property. Your proposal must include a work plan for the investigation, and costs to complete the investigation and prepare a site investigation report in accordance with NR 716.

All work must be performed in accordance with NR 700, NR 169, and the DERF program requirements. Your proposal should provide a detailed description of your approach and include a summary of project costs using the appropriate WDNR bid sheets (Form 4400-233).

Craig Environmental  
May 16, 2012  
Page 2

Please submit one copy of your proposal, no later than June 30, 2012, as a sealed bid to the following address:

Hunn Family Trust  
Lou Dodulik, Attorney  
PO Box 5246  
946 Elm Grove Road  
Elm Grove, Wisconsin 53122

Please send a second copy of your proposal, no later than June 30, 2012, as a sealed bid to the WDNR at the following address:

Ms. Pam Mylotta  
Wisconsin Department of Natural Resources  
2300 N. Martin Luther King Drive  
Milwaukee, WI 53122

Lastly, please assure that the envelopes containing your proposals are clearly marked as "sealed bid."

Thank you, and feel free to contact me at <sup>262</sup>(414) 782-5700, if you have any questions regarding this request for a proposal.

Sincerely,



Lou Dodulik, Attorney

cc: Pam Mylotta, WDNR

Enclosures: Table 1, Soil Sample Analytical Summary, Envirogen, October 22, 2002  
Figure 4, Supplemental Soil Investigation, Boring Locations, Envirogen,  
October 22, 2002

TABLE 1\*

**Soil Sample Analytical Summary  
Hunn Property Site  
Milwaukee, Wisconsin**

Boring	Date	Depth (Feet bgs)	PID (IU)	Chloro- benzene	1,2- Dichloro- benzene	cis-1,2- Dichloro- benzene	Tetrachloro- ethene	Trichloro- ethene	Vinyl chloride	Total Lead
B-1	08/07/98	4-6	73	26	<25	190	120,000	2,300	<25	<50
B-1	08/07/98	8-10	568	<250	<250	<250	150,000	<250	<250	<50
B-1	08/07/98	16-18	0	<25	<25	<25	2,600	<25	<25	<50
B-2	08/07/98	6-8	154	33	46	<25	140,000	100	<25	<50
B-2	08/07/98	12-14	4,528	<500	810	<500	2,100,000	<500	<500	<50
B-2	08/07/98	18-20	7	<25	<25	<25	110	<25	<25	<50
B-3	08/07/98	4-6	20	<25	<25	36	700	130	<25	<50
B-3	08/07/98	10-12	0	<25	<25	<25	240	<25	<25	<50

(Continued)

## Note:

All concentrations are in  $\mu\text{g}/\text{kg}$  unless otherwise noted.

IU: Instrument Units. Equivalent to ppm based on a 10.6 mV lamp and 100% isobutylene calibration gas.

bgs: below ground surface

ppm: parts per million

$\mu\text{g}/\text{kg}$ : Microgram per kilogram

Checked by: TM

Approved by: KMH

\* Table from Envirogen workplan dated October 22, 2002

**TABLE 1**  
**(Continued)**

**Soil Sample Analytical Summary**  
**Hunn Property Site**  
**Milwaukee, Wisconsin**

Boring	Date	Depth (Feet bgs)	PID (IU)	Chloro- benzene	1,2- Dichloro- benzene	cis-1,2- Dichloro- benzene	Tetrachloro- ethene	Trichloro- ethene	Vinyl chloride	Total Lead
B-3	08/07/98	18-20	0	<25	<25	<25	250	<25	<25	<50
B-4	08/07/98	2-4	0	<25	<25	<25	180	<25	<25	<50
B-4	08/07/98	10-12	0	<25	<25	<25	<25	<25	<25	<50
B-4	08/07/98	14-16	0	<25	<25	<25	<25	<25	<25	<50
B-5	08/07/98	10-12	0	<25	<25	<25	<25	<25	<25	12
B-6	08/07/98	6-8	0	<25	<25	<25	240	<25	<25	16
B-7	08/07/98	6-8	22	<25	<25	84	50,000	440	<25	20
S-100	11/29/99	8	1,566	53,000	36,000	50,000	1,700,000	45,000	56,000	NA

**Note:**

All concentrations are in µg/kg unless otherwise noted.

IU: Instrument Units. Equivalent to ppm based on a 10.6 mV lamp and 100% isobutylene calibration gas.

bgs: below ground surface

ppm: parts per million

µg/kg: Microgram per kilogram

S-100 is the sample collected from the former tank cavity during UST removal activities

Checked by: TMP

Approved by: KMH

E. CAPITOL DRIVE

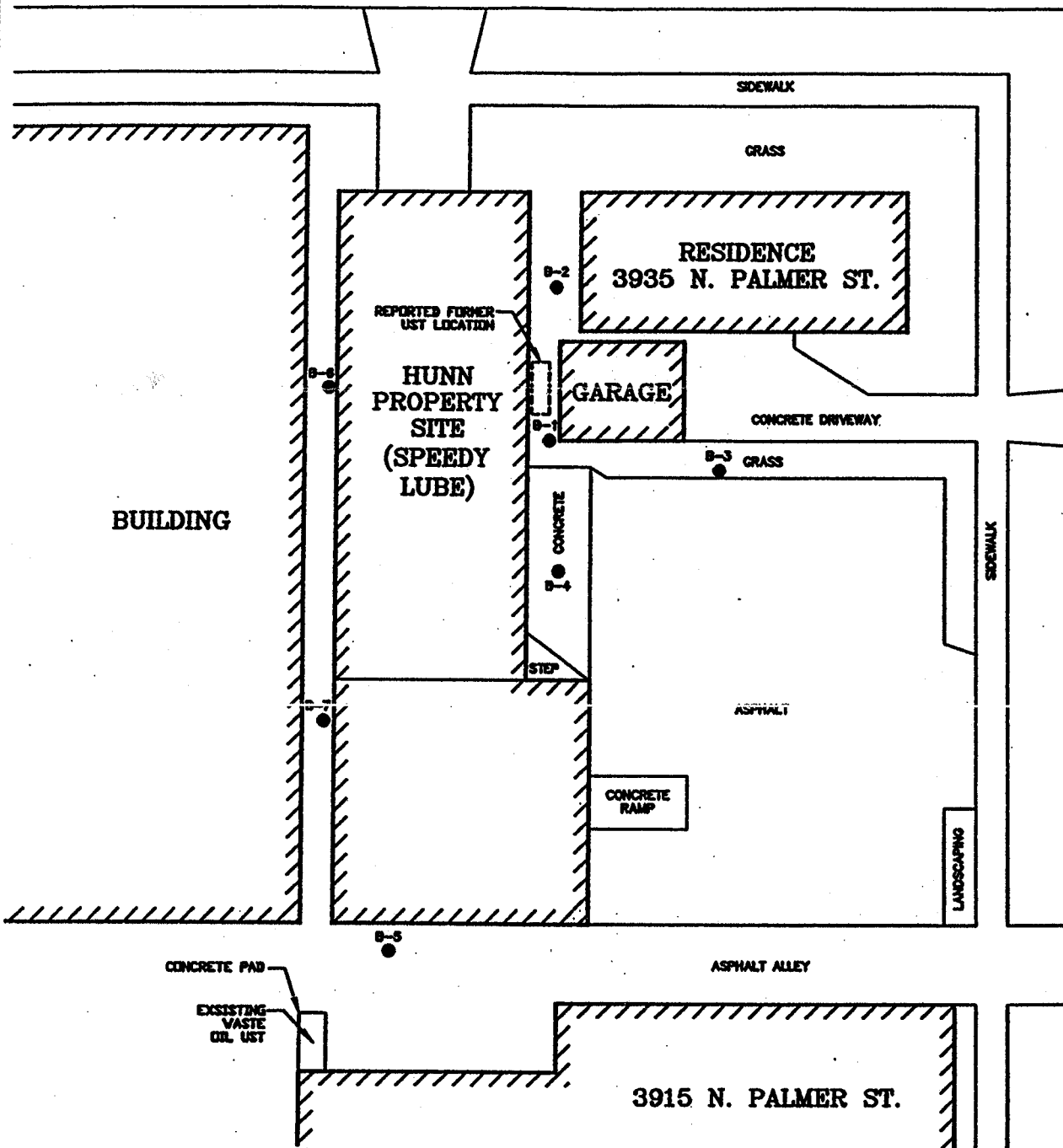

**NOTE**

● SOIL BORING LOCATION



SCALE



**ENVIROGEN**

COST EFFECTIVE LEADERSHIP FOR A CLEANER ENVIRONMENT

2635 North Grandview Blvd.  
Fellowee, Wisconsin 53072-0090

SUPPLEMENTAL SOIL INVESTIGATION  
BORING LOCATIONS  
SPEEDY LUBE 117 E. CAPITOL DRIVE  
MILWAUKEE, WISCONSIN

FIGURE NO.

4\*

N. PALMER STREET

ENGINEER	DATE
ENGINEER	DATE
REVISIONS:	
APPROVED BY: <i>L.M.H.</i>	
CHECKED BY: <i>J.M.S.</i>	
DATE: 09/18/02	
DRAWN BY: PJT	
DRAWING NO. 000158-04	

\* From a work plan dated October 22, 2002.