



790 Marvelle Lane
Green Bay, WI 54304

Tel: 920/497-8910
Fax: 920/497-8065
www.envirogen.com

SITE INVESTIGATION WORK PLAN

**Sheleski Property
221 Washington Street
Menasha, Wisconsin**

May 4, 2001

Envirogen Project #: P000189-040

May 4, 2001

Mr. Kevin McKnight
Wisconsin Department of Natural Resources
625 East County Road "Y", Suite 700
Oshkosh, WI 54901-9731

Re: Site Investigation Work Plan for the Sheleski Property
221 Washington Street, Menasha, Wisconsin
Envirogen Project Number: 000189-040
WDNR BRRTS Number: 03-71-186591
PECFA Claim # 54952-3352-21

Dear Mr. McKnight:

Envirogen, Inc. (Envirogen) is submitting this Limited Site Investigation Work Plan to complete a site investigation at the above referenced site. Figures and tables are included at the end of this report as Attachments A and B, respectively. The site assessment groundwater laboratory analytical reports for Waynes Towing are attached as Attachments C.

Site History

The site is located at 221 Washington Street, Menasha, Wisconsin. The site is located in part of Government Lot 2, Section 23, Town 20 North, Range 17 East, Outagamie, County. Figure 1 illustrates the site location.

The Washington Street site is currently owned by Mr. Skip Sheleski. The site has operated as a gasoline station from 1934 to 1975. The site since 1975, the site has been utilized as a car sales and service facility, engine rebuilding facility and is currently the site of Bodyworks Collision Center, LLC. The site configuration is shown in Figure 2. The site utilized, based upon the Wisconsin Department of Commerce Tank Database, three 10,000 gallon leaded underground tanks. The database identified that these tanks were removed on January 1, 1974. As a part of the site investigation for Waynes Towing site located at 216

Washington, one monitoring well, MW-9 was constructed on the Sheleski property. This well was installed to evaluate the potential of off-site contamination for the Waynes Towing site resulting from the activities conducted at the Sheleski property.

Groundwater samples were collected from monitoring well MW-9 on February 3, and May 19, 1999. Samples were submitted to a state-certified laboratory for analysis of petroleum volatile organic compounds + naphthalene, (PVOC + Naphthalene). NR 140 groundwater exceedances were identified for all compounds analyzed for with the exception of Methyl tert butyl ether. Groundwater analytical results are summarized in Table 2.

Proposed Site Investigation Activities

Envirogen is proposing to install eight Geoprobe® borings around the perimeter of the former underground storage tanks and dispenser system in order to define the lateral and vertical extent of petroleum and/or potential groundwater contamination. Figure 3 illustrates the proposed boring locations. Soil samples will be collected continuously from all borings to an estimated depth of 15 to 20 feet below land surface. Collected soil samples will be classified as to soil type using the Unified Soil Classification System, and then field-screened using a 10.2 eV photoionization detector. Select soil samples will be submitted to a state-certified laboratory for analysis of volatile organic compounds (VOCs) and lead (Pb).

Three of the Geoprobe® borings will be completed as temporary groundwater monitoring wells for sampling purposes. Locations are shown in Figure 3. The temporary groundwater monitoring wells and monitoring well MW-9 will be properly developed and groundwater samples will be collected from each well and submitted to a state-certified laboratory for analysis of VOCs and Pb.

The monitoring wells and site will also be surveyed. Top-of-casing (TOC) measurements will be taken and recorded at each well location. TOC elevations will later be used for determination of groundwater flow direction and hydraulic gradient.

Once all the necessary data have been obtained and reviewed, Envirogen will generate a Site Investigation Report (SIR). The SIR will summarize all investigative findings and provide recommendations for future work at the site.

If you have any questions regarding this site or require additional information, please do not hesitate to contact William R. Vachon, R.S. at (920) 497-8910.

Sincerely,
ENVIROGEN, INC.

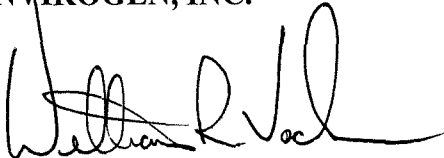
A handwritten signature in black ink, appearing to read 'William R. Vachon', written over a horizontal line.

William R. Vachon, R.S.
Senior Environmental Specialists
Report Preparer

cc(w/enc): Mr. Skip Sheleski
cc(wo/enc): Mr. Karl Roovers, WDNR

WRV/cp

ATTACHMENT A

FIGURES

LIST OF FIGURES

- 1 Site Location Map
- 2 Site Plan View
- 3 Proposed Geoprobe®Boring/Temporary Monitoring Well Locations



(USGS 1984)
NEENAH QUADRANGLE

SCALE
1:24000

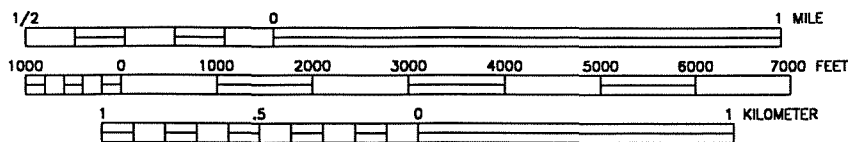

CONTOUR INTERVAL 10 FEET



LOCATION



ENVIROGEN

COST EFFECTIVE LEADERSHIP FOR A CLEANER ENVIRONMENT

790 Marvella Lane
Ashwaubenon, Wisconsin 54304

SITE LOCATION MAP

SHELESKI PROPERTY SITE
MENASHA, WISCONSIN

FIGURE NO.

1

DRAWING NO.	000189W1	DRAWN BY:	KFT	CHECKED BY:	05/07/01	APPROVED BY:	REVISIONS:	ENGINEER	DATE	ENGINEER	DATE
-------------	----------	-----------	-----	-------------	----------	--------------	------------	----------	------	----------	------

LEGEND

- GAS — NATURAL GAS LINE
- W — WATER MAIN
- — — PROPERTY BOUNDARY
- ⊕ MONITORING WELL
INSTALLED BY FISCHER
- [] FORMER TANK LOCATION

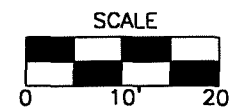
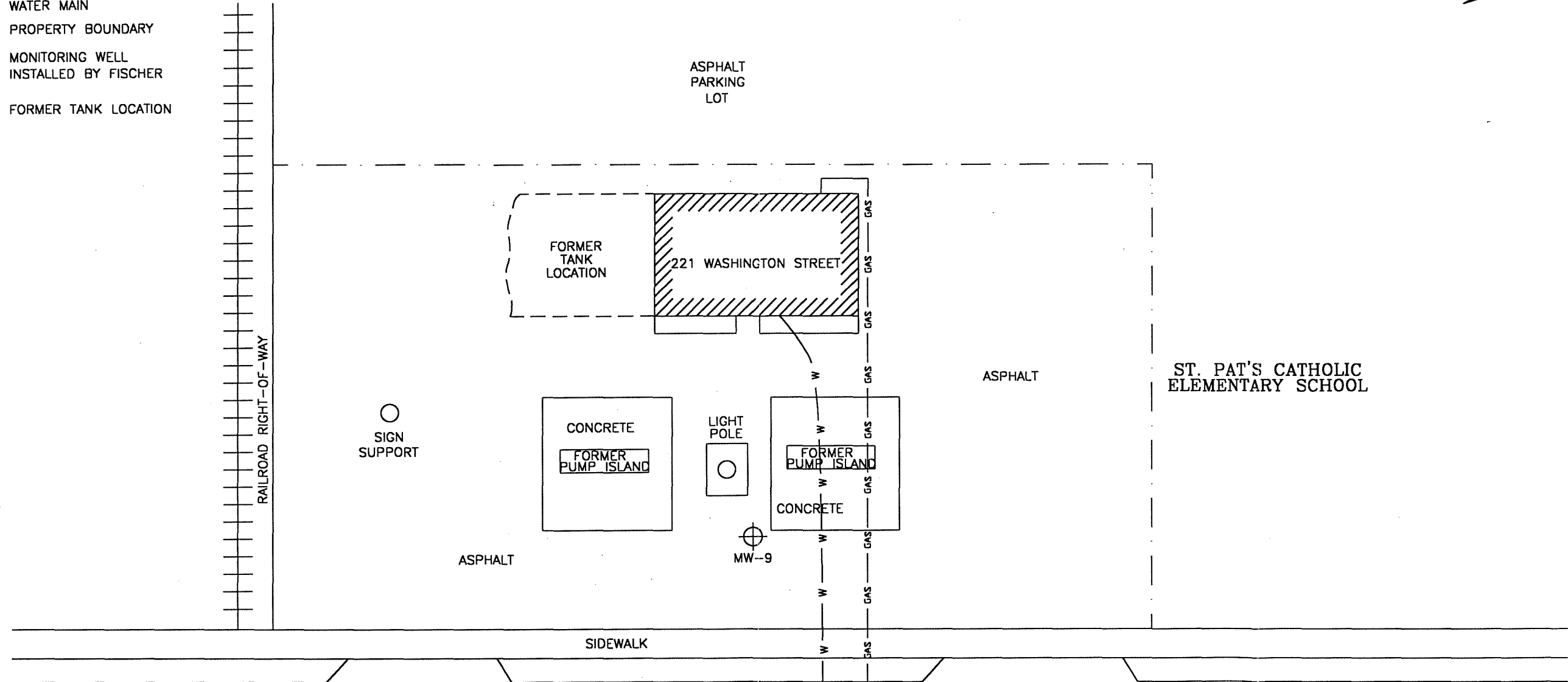
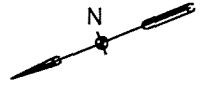

ENVIROGEN

COST EFFECTIVE LEADERSHIP FOR A CLEANER ENVIRONMENT

790 Marvelle Lane
Ashwaubenon, Wisconsin 54304

SITE PLAN VIEW	FIGURE NO. 2
SHELESKI PROPERTY SITE MENASHA, WISCONSIN	

DRAWING NO.	000189W2
DRAWN BY:	KFT
CHECKED BY:	05/07/01
APPROVED BY:	
REVISIONS:	
ENGINEER	DATE
ENGINEER	DATE

- LEGEND**
- GAS — NATURAL GAS LINE
 - W — WATER MAIN
 - — PROPERTY BOUNDARY
 - TEST BORING
 - ⊕ TEMPORARY MONITORING WELL
 - ⊕ MONITORING WELL INSTALLED BY FISCHER
 - [] FORMER TANK LOCATION

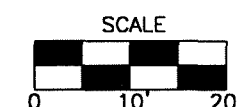
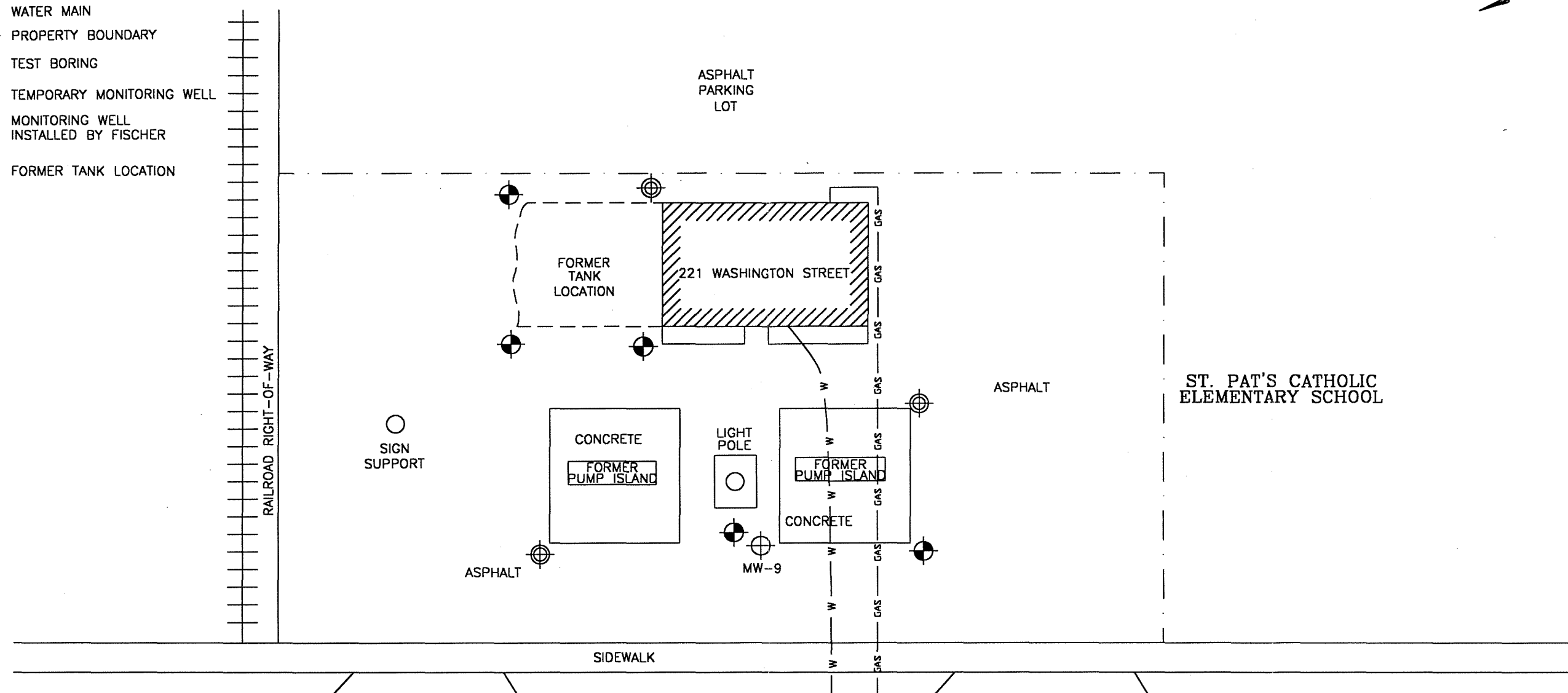
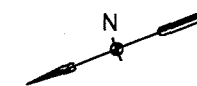

PROPOSED GEOPROBE BORING/
TEMPORARY MONITORING WELL LOCATIONS
SHELESKI PROPERTY SITE
MENASHA, WISCONSIN

FIGURE NO.

3

DRAWING NO.	000189W3	DRAWN BY:	KFT	05/07/01	CHECKED BY:	APPROVED BY:	REVISIONS:	ENGINEER	DATE	ENGINEER	DATE
-------------	----------	-----------	-----	----------	-------------	--------------	------------	----------	------	----------	------

ATTACHMENT B

TABLES

LIST OF TABLES

- 1 Waynes Towing Site Assessment Groundwater Sample Laboratory Analytical Results, (MW-9)

Table 1

**Site Assessment Groundwater Sample Laboratory Analytical Results for
Waynes Towing Property Site, Menasha, WI
Monitoring Well MW-9
February 3, and May 19, 1999**

Sample	NR 140		MW-9	
	PAL	ES	02-03-99	05-19-99
Lead			NA	NA
Benzene	0.5	5	6800	6500
Ethylbenzene	140	700	1200	1100
Methyl-tert-butyl-ether	12	60	24 Q	<22
Toluene	68.6	343	5900	6700
Naphthalene	8	40	180	240 Q
1, 2, 4-Trimethylbenzene	96	480	770	990
1, 3, 5-Trimethylbenzene			250	320
m, p -Xylene	124	620	2800	4100
O, Xylene			1000	1600

Notes:

All results are reported in ppb.

NA: Not analyzed

Q = Indicates compound detected at concentrations below the limit of Quantitation

Checked by: _____

Approved by: _____

ATTACHMENT C

**Site Assessment Groundwater
Sample Laboratory Analytical Report**

TABLE 4 (Continued)
WAYNE'S TOWING AND SERVICE, INC.
MENASHA, WISCONSIN
POST REMEDIAL EXCAVATION GROUNDWATER SAMPLE ANALYTICAL RESULTS
FISCHER PROJECT No. 395007.003

Monitoring Well	NR 140		MW-6				MW-7		MW-8				MW-9	
Sampling Date	ES	PAL	2/3/99	5/19/99	9/2/99	12/07/99	2/3/99	5/19/99	2/3/99	5/19/99	9/2/99	12/07/99	2/3/99	5/19/99
PETROLEUM VOLATILE ORGANIC COMPOUNDS (PVOCs)+ Naphthalene (µg/L)														
Lead	15	1.5	NA	12	16	16	NA	NA	NA	NA	NA	5.5	NA	NA
Benzene	5	0.5	400	120	67	120	<0.26	<0.26	110	110	47	93	6800	6500
Ethylbenzene	700	140	240	180	180	130	<0.24	<0.24	1.7	2.7	1.6	2.1	1200	1100
Methyl tert-butyl ether	60	12	6.3 Q	8.3	17	<1.6	0.24 Q	<0.22	2.4	2.2	4.5	1.1	24 Q	<22
Toluene	343	68.6	19	11	11	14	<0.21	<0.21	0.74	0.77	0.36 Q	1.4	5900	6700
Naphthalene	40	8	29	16	<3.6	9.2	<0.89	<0.89	<0.89	<0.89	NA	NA	180	240Q
1,2,4-Trimethylbenzene	480	96	770	490	600	450	<0.86	<0.86	0.94 Q	2.5Q	1.8 Q	1.1 Q	770	990
1,3,5-Trimethylbenzene			19	13	<2.2	6	<0.54	<0.54	<0.54	<0.54	0.58 Q	<0.54 Q	250	320
Xylenes, -m, -p	620	124	830	410	280	260	<0.97	<0.97	1.9 Q	3.5	1.8 Q	2.7	2800	4100
Xylenes, -o			15	12	8.8	6.5	<0.37	<0.37	<0.37	<0.37	<0.37	<0.37	1000	1600

PVOC - Petroleum Volatile Organic Compounds

NE - Not Established

NA - Not Analyzed

ES - Enforcement Standard

PAL - Preventive Action Limit

µg/L - Micrograms per Liter

Shading indicates analytical results above NR 140

Q - Indicates compound detected at concentrations below the limit of Quantitation



1795 Industrial Drive
Green Bay, WI 54302
920-469-2436
800-7-ENCHEM
Fax: 920-469-8827

- Analytical Report -

Project Name : WAYNE'S TOWING

Project Number : 395007.003

Field ID : MW-9

Lab Sample Number : 890516-007

WI ONR LAB ID : 405132750

Client : FISCHER ENVIRONMENTAL

Report Date : 2/15/99

Collection Date : 2/3/99

Matrix Type : WATER

Organic Results

VOC + NAPHT - WATER

Prep Method: SW846 5030B

Prep Date: 2/9/99

Analyst: PMS

Analyte	Result	LOD	LOQ	EQL	Units	Code	Analysis Date	Analysis Method
1,1,1-Trifluorotoluene	97				%Recov		2/12/99	MOD 8021B
Benzene	6800	13	41		ug/l		2/12/99	MOD 8021B
Ethylbenzene	1200	12	38		ug/l		2/12/99	MOD 8021B
Ethyl-tert-butyl-ether	24	11	35		ug/l	Q	2/12/99	MOD 8021B
Naphthalene	180	44	140		ug/l		2/12/99	MOD 8021B
Toluene	5900	10	32		ug/l		2/12/99	MOD 8021B
1,5-Dimethylbenzene	250	27	86		ug/l		2/12/99	MOD 8021B
1,2,4-Trimethylbenzene	770	43	140		ug/l		2/12/99	MOD 8021B
Xylenes, -m, -p	2800	48	150		ug/l		2/12/99	MOD 8021B
Xylene, -o	1000	18	57		ug/l		2/12/99	MOD 8021B

Post-it® Fax Note	7671	Date	# of pages ▶ 2
To Bill Veckon		From Tom Verstegen	
Co./Dept.		Co.	
Phone #		Phone #	
Fax # 920-497-8065		Fax #	