

GIS REGISTRY INFORMATION

SITE NAME: REXNORD PLASTICS DIV/FRMR PLYMOUTH FDRY
BRRTS #: 0246189396 FID# 246148100
COMMERCE # (if appropriate): _____
CLOSURE DATE: 01/13/2005
STREET ADDRESS: 1019 N 11TH AVE
CITY: Grafton

SOURCE PROPERTY GPS COORDINATES (meters in WTM91 projection):
 X= 685933 Y= 318706

CONTAMINATED MEDIA: Groundwater Soil Both

OFF-SOURCE GW CONTAMINATION >ES: Yes No

IF YES, STREET ADDRESS 1: _____

GPS COORDINATES (meters in WTM91 projection): X= _____ Y= _____

OFF-SOURCE SOIL CONTAMINATION >Generic or Site-Specific RCL (SSRCL): Yes No

IF YES, STREET ADDRESS 1: _____

GPS COORDINATES (meters in WTM91 projection): X= _____ Y= _____

CONTAMINATION IN RIGHT OF WAY: Yes No

DOCUMENTS NEEDED:

- Closure Letter, and any conditional closure letter issued
- Copy of most recent deed, including legal description, for all affected properties
- Certified survey map or relevant portion of the recorded plat map (if referenced in the legal description) for all affected properties
- County Parcel ID number, if used for county, for all affected properties
- Location Map which outlines all properties within contaminated site boundaries on USGS topographic map or plat map in sufficient detail to permit the parcels to be located easily (8.5x14" if paper copy). If groundwater standards are exceeded, the map must also include the location of all municipal and potable wells within 1200' of the site.
- Detailed Site Map(s) for all affected properties, showing buildings, roads, property boundaries, contaminant sources, utility lines, monitoring wells and potable wells. (8.5x14", if paper copy) This map shall also show the location of all contaminated public streets, highway and railroad rights-of-way in relation to the source property and in relation to the boundaries of groundwater contamination exceeding ch. NR 140 ESs and soil contamination exceeding ch. NR 720 generic or SSRCLs.
- Tables of Latest Groundwater Analytical Results (no shading or cross-hatching)
- Tables of Latest Soil Analytical Results (no shading or cross-hatching)
- Isoconcentration map(s), if required for site investigation (SI) (8.5x14" if paper copy). The isoconcentration map should have flow direction and extent of groundwater contamination defined. If not available, include the latest extent of contaminant plume map.
- GW: Table of water level elevations, with sampling dates, and free product noted if present
- GW: Latest groundwater flow direction/monitoring well location map (should be 2 maps if maximum variation in flow direction is greater than 20 degrees)
- SOIL: Latest horizontal extent of contamination exceeding generic or SSRCLs, with one contour
- Geologic cross-sections, if required for SI. (8.5x14' if paper copy)
- RP certified statement that legal descriptions are complete and accurate
- Copies of off-source notification letters (if applicable)
- Letter informing ROW owner of residual contamination (if applicable)(public, highway or railroad ROW)
- Copy of (soil or land use) deed restriction(s) or deed notice if any required as a condition of closure





State of Wisconsin \ DEPARTMENT OF NATURAL RESOURCES

Jim Doyle, Governor
Scott Hassett, Secretary
Gloria L. McCutcheon, Regional Director

Plymouth Service Center
1155 Pilgrim Road
P.O. Box 408
Plymouth, Wisconsin 53073-0408
Telephone 920-892-8756
FAX 920-892-6638
TTY Access via relay - 711

January 13, 2005

Estate of Richard Goldberg
C/o Ms. Kris Hughes
P.O. Box 228
Grafton, WI 53024

Subject: Final closure for the petroleum product above-ground storage tanks on the northwest corner of the property and above-ground and underground storage tanks west of the building at the former Plymouth Foundry site, 1019 N. 11th Avenue, Grafton, WI
WDNR FID#246148100 BRRTS#02-46-189401 and #02-46-189396

Dear Ms. Hughes:

The site as described above was recently reviewed for closure by the Department of Natural Resources. The Department reviews environmental remediation cases for compliance with state laws and standards to maintain consistency in the closure of these cases. In a letter dated October 1, 2004, you were notified that conditional closure was granted to this case.

The Department has received correspondence indicating that you have complied with the conditions of closure by abandoning the groundwater monitoring wells at the site which will no longer be used for environmental monitoring. Your environmental consultant has also informed us of which wells will be assumed by the adjacent site, Construction Forms. Based on the information provided, it appears that your case has been remediated to Department standards in accordance with s. NR 726.05, Wis. Adm. Code. The Department considers this case closed and no further investigation, remediation or other action is required at this time.

Each of the site activities listed above will be listed on the DNR Remediation and Redevelopment GIS Registry of Closed Remediation Sites. Information that was submitted with your closure request application will be included on the registry. To review the sites on the GIS Registry web page, visit <http://gomapout.dnr.state.wi.us/org/at/et/geo/gwur/index.htm> If your property is listed on the GIS Registry due to groundwater contamination exceeding ch. NR 140 standards at the time of closure, and you intend to construct or reconstruct a well, you will need Department approval in accordance with s. NR 812.09(4)(w). To obtain approval, Form 3300-254 needs to be completed and submitted to the DNR Drinking and Groundwater program's regional water supply specialist. This form can be obtained on-line at the web address listed above.

If this is a PECFA site, section 101.143, Wis. Stats., requires that PECFA claimants seeking reimbursement of interest costs, for sites with petroleum contamination, submit a final reimbursement claim within 120 days after they receive a closure letter on their site. For claims not received by the PECFA Program within 120 days of the date of this letter, interest costs after 60 days of the date of this letter will not be eligible for PECFA reimbursement. If there is equipment purchased with PECFA funds remaining at the site, contact the Commerce PECFA Program to determine the method for salvaging the equipment.

Please be aware that this case may be reopened pursuant to s. NR 726.09, Wis. Adm. Code, if additional information regarding site conditions indicates that contamination on or from the site poses a threat to public health, safety or welfare, or the environment.

The Department appreciates your cooperation with the adjacent environmental investigation and your efforts to restore the environment at this site. If you have any questions regarding this letter, please contact me at (920) 892-8756 ext. 3025.

Sincerely,

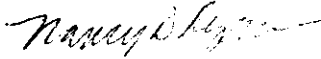

Nancy D. Ryan, Hydrogeologist
Bureau for Remediation & Redevelopment

cc: SER site file
Ken Ebbott, Alpha Terra Science



State of Wisconsin \ DEPARTMENT OF NATURAL RESOURCES

Jim Doyle, Governor
Scott Hassett, Secretary
Gloria L. McCutcheon, Regional Director

Plymouth Service Center
1155 Pilgrim Road
P.O. Box 308
Plymouth, Wisconsin 53073-0408
Telephone 920-892-8756
FAX 920-892-6638
TTY Access via relay - 711

October 1, 2004, 2004

Estate of Richard Goldberg
c/o Ms. Kris Hughes
P.O. Box 228
Grafton, WI 53024

Subject: Conditional closure of the former Plymouth Foundry site petroleum product above-ground storage tanks on the northwest corner of the property and above-ground and underground storage tanks west of the building, 1019 N. 11th Avenue, Grafton, WI **WDNR FID#246148100 BRRTS#02-46-189401 and #02-46-189396**

Dear Ms. Hughes:

The Wisconsin Department of Natural Resources (the Department) has received a request for closure of the two activities referenced above at the former Plymouth Foundry site in Grafton, Wisconsin. Based on a review of available information, the Department has determined that the petroleum contamination on the site from the above-ground and underground storage tanks appears to have been investigated and remediated to the extent practicable under site conditions. Your case has been remediated to Department standards in accordance with s. NR 726.05, Wis. Adm. Code and will be closed if the following conditions are satisfied:

- The groundwater monitoring wells at the site must be abandoned in accordance with ch. NR 141, Wis. Adm. Code. The Department understands that Construction Forms, Inc. which occupies the property adjacent to your site, would like to use some of Plymouth Foundry's groundwater monitoring wells in their chlorinated solvent groundwater investigation. Please ask your environmental consultant to contact Construction Forms' consultant, Bernard Fenelon, GZA Geoenvironmental (phone 262 754-2560) regarding which wells will be assumed by Construction Forms, and have the other wells properly abandoned. Please inform me of which wells will be maintained at the site and provide documentation of well abandonment on Form 3300-5B found at <http://www.dnr.state.wi.us/org/water/dwg/gwl>.

When the above-cited condition has been satisfied, please submit the information to me and your case will be tracked as closed.

Groundwater contamination at this site has exceeded NR 140 Wis. Adm. Code enforcement standards for naphthalene at the northwest corner of the property at monitoring wells MW-24 and TW-16 and at MW-1 located west of the building. Crysene exceeded the enforcement standard at well MW-28. This site will, therefore, be listed on the DNR Remediation and Redevelopment GIS Registry of Closed Remediation Sites. Information that was submitted with your closure request application will be included on the registry. To review the sites on the GIS Registry web page, visit <http://gomapout.dnr.state.wi.us/org/at/et/geo/gwur/index.htm>

Please also note that contaminated soil was identified in both areas where the storage tanks were formerly located. While the concentrations identified do not require remedial action, if contaminated soil is excavated in the future, it should be considered a solid waste and must be handled in accordance with State and federal rules.

If this is a PECFA site, section 101.143, Wis. Stats., requires that PECFA claimants seeking reimbursement of interest costs, for sites with petroleum contamination, submit a final reimbursement claim within 120 days after they receive a closure letter on their site. For claims not received by the PECFA Program within 120 days of the date of this letter, interest costs after 60 days of the date of this letter will not be eligible for PECFA reimbursement.

Please be aware that the case may be reopened pursuant to s. NR 726.09, Wis. Adm. Code, if additional information regarding site conditions indicates that contamination on or from the site poses a threat to public health, safety, or welfare or to the environment.

We appreciate your efforts to restore the environment at this site. If you have any questions regarding this letter, please contact me at (920) 892-8756 ext. 3025.

Sincerely,



Nancy D. Ryan, Hydrogeologist
Bureau for Remediation & Redevelopment

cc: SER site file
Ken Ebbott, Alpha Terra Science

VOL 1583 PAGE 361
RECORDED

2002 DEC -6 AM 8:30

René H. Vojt
REGISTER OF DEEDS
OZAUKEE COUNTY, WI

FEE
\$ 77.25 (15s)
EXEMPT

RETURN TO:
CASTNER LAW OFFICES
P.O. BOX 164
GRAFTON, WI 53024

\$12

PIN: 10-073-10-01-000 *

QUIT CLAIM DEED

Helen E. Goldberg, a single person ("Grantor"), quit claims to Richard J. Goldberg LLC, a Wisconsin limited liability company ("Grantee"), the following described real estate in the Village of Grafton, Ozaukee County, State of Wisconsin:

SEE ATTACHED EXHIBIT A.

Together with all appurtenant rights, title and interests.

This is not homestead property.

Dated: November 28, 2002.

By: *Helen E. Goldberg* (SEAL)
Helen E. Goldberg

AUTHENTICATION

Signature of Helen E. Goldberg authenticated _____, 200__

Stephen L. Castner

TITLE: MEMBER STATE BAR OF WISCONSIN

ACKNOWLEDGMENT

STATE OF WISCONSIN)
OZAUKEE COUNTY) ss.

Personally came before me this *26th* day of *November*, 2002, the above named Helen E. Goldberg, to me known to be the person who executed the foregoing instrument and acknowledged the same.

Kathryn J. Reinders
Notary Public *Ozaukee* County, Wis.
My Commission is permanent. (If not, state expiration date *11/2005*.)

* Names of persons signing in any capacity should be typed or printed below their signatures.

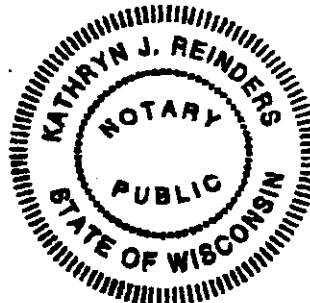

This instrument was drafted by:
Attorney Stephen L. Castner
1650 Ninth Avenue, Post Office Box 164
Grafton, Wisconsin 53024-0164
Telephone: (262) 377-9377

EXHIBIT A

Legal Description - Parcel # 10-073-10-01-000

That part of Lots One (1), Four (4), Five (5) and Eight (8) in Block Ten (10) of Johnson's Addition to the Village of Grafton, lying Easterly of the right of way of the Chicago, Milwaukee, St. Paul & Pacific Railroad.

Lots Two (2), Three (3), Six (6), Seven (7) Ten (10) and Eleven (11) in Block Ten (10) of Johnson's Addition to the Village of Grafton.

That part of Lots Nine (9) and Twelve (12) of Block Ten (10) in Johnson's Addition to the Village of Grafton, lying Easterly of the right of way of the Chicago, Milwaukee, St. Paul & Pacific Railroad.

The North Forty (40) feet of Lots Thirteen (13) and Fourteen (14) of Block Ten (10) in Johnson's Addition to the Village of Grafton, except that portion of Lot 13 owned by the Chicago, Milwaukee, St. Paul & Pacific Railroad.

(EXCEPTING TEREFROM that portion thereof heretofore conveyed to [redacted] Company.

Recorded in the Register's Office of Ozaukee County, Wisconsin, on January 9, 1970, at 8:15 A.M. and recorded in Vol. 261 of Records on pages 143-144 as document No. 232570.

Tax Key No.
10-073-10-01-000

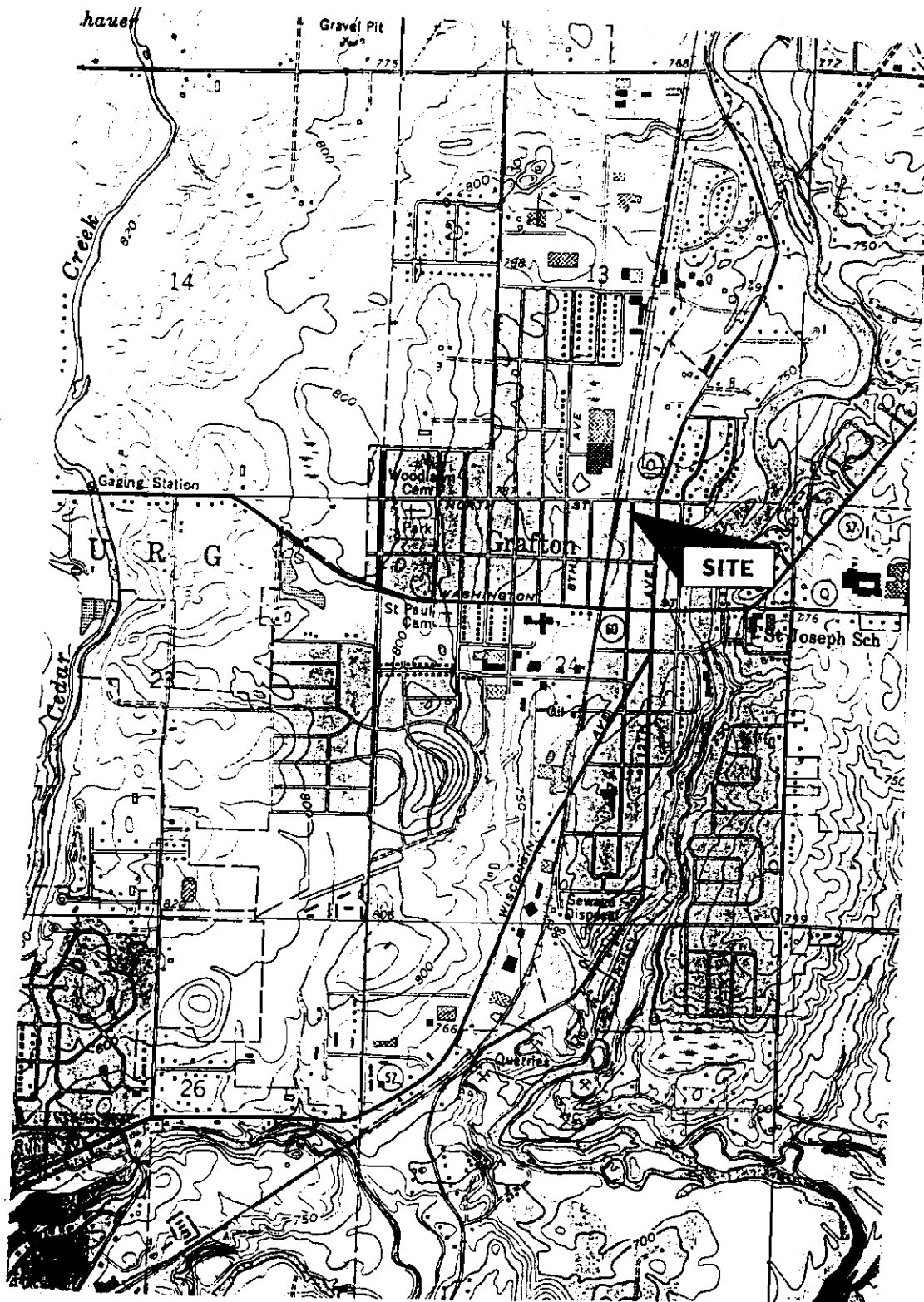

Base Map USGS 7.5' Cedarburg Quadrangle, Revised 1994

Title: **Site Location and Local Topography**

Project: **Site Investigation**

Client: **Former Plymouth Foundry Property, Grafton, WI**

ALPHA TERRA
SCIENCE

SCALE: 1 : 24,000

DWG NO: **FIGURE 1**

DRAWN BY: **KAE**

DATE: **Jan 12, 2000**

NORTH STREET

Water Main
Sanitary Sewer
Storm Sewer

CONSTR. FORMS
CHLORINATED
SOLVENT ERP SITE
#02-46-171750

LEGEND

- MW-2 Existing NR-141 Monitoring Well
- TW-29 Previously Installed Temporary Well, Decommissioned
- B-5 Soil Boring

CONSTRUCTION FORMS
(FORMER ATACO STEEL)
1040 9TH AVENUE
SEE FIGURE 5 FOR
APPROXIMATE WELL AND
BORING LOCATIONS)

CONSTR FORMS
CHLORINATED
SOLVENT ERP SITE
#02-46-171750

CONSTR
FORMS
CLOSED
LUST
SITE
#03-46-105926

N

RAILROAD

11TH AVENUE

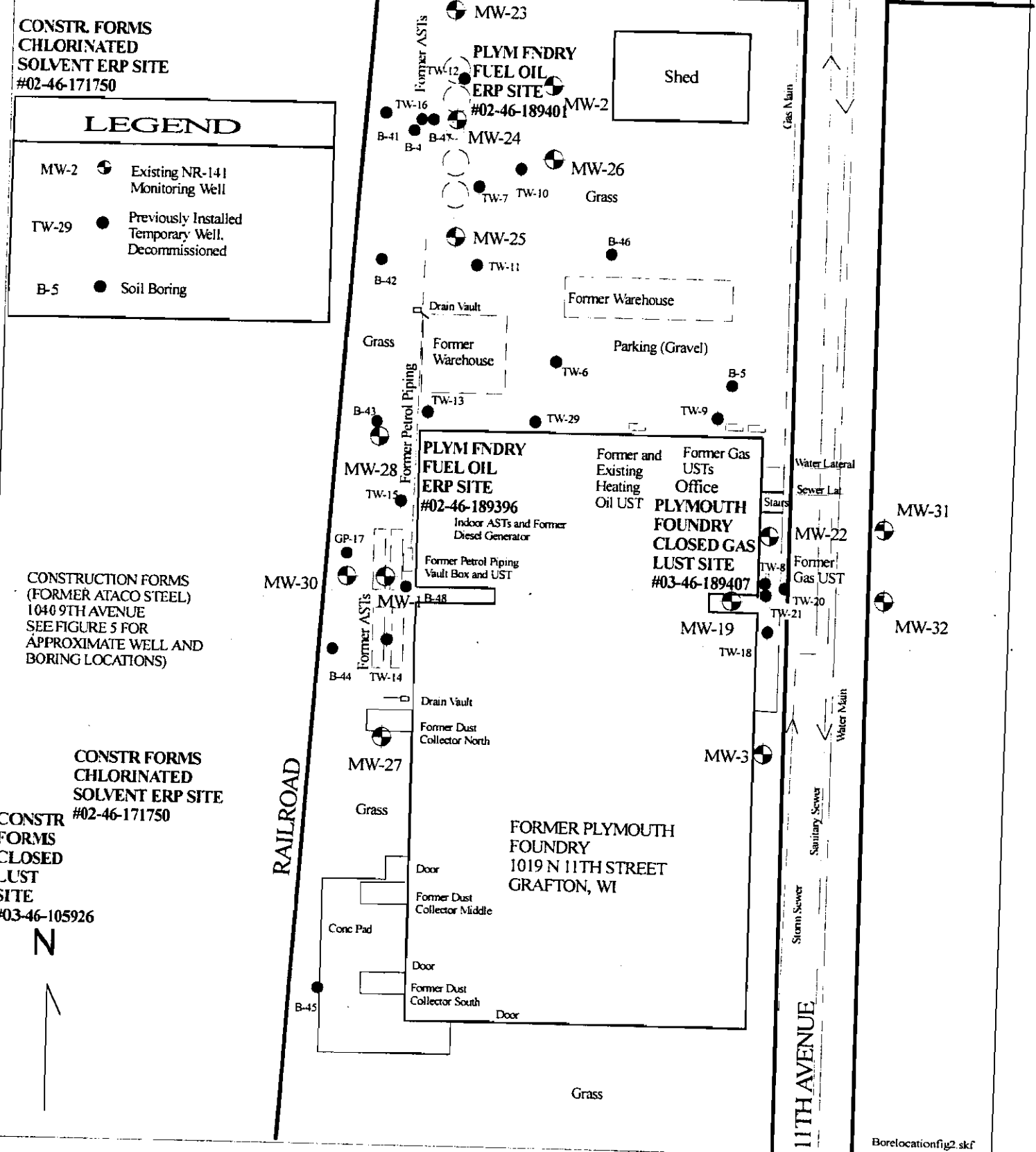

Borelocationfig2.skf

Well and Boring Locations

Site Closure

Former Plymouth Foundry Property, Grafton, WI



1" = 60'

FIGURE 2

K A E

Feb 2, 2004

TABLE 3 : GROUNDWATER CHEMISTRY RESULTS												
Former Plymouth Foundry Site, Grafton, WI												
GROUNDWATER												
SAMPLE I.D.	Date Sampled	Total Depth / Depth to Water Ft below grnd	Dissolved Lead (ug/l)	GRO (ug/l = ppb)	DRO	Petroleum Volatile Organic Compounds (ug/t = ppb)						
						Benzene	Ethylbenzene	Toluene	Xylenes	Methyl-t-butyl ether	124-Trimethyl benzene	135-Trimethyl benzene
WI ADMIN CODE NR 140 E.S. / P.A.L.			15 / 1.5	NS	NS	5.0 / 0.5	700 / 140	1000 / 200	10,000 / 1,000	60 / 12	480 / 96	
WEST OF BUILDING AT FOUR FORMER ASTs												
MW-1, West of Foundry @ ASTs	6/17/99	17.2 / 17.2	NA	NA	NA	NA : DRY						
MW-1, West of Foundry @ ASTs	4/6/99	17.2 / 16.9	NA	NA	NA	NA : DRY						
MW-1, West of Foundry @ ASTs	10/1/98	17.2 / 16.8	NA	NA	NA	NA : DRY						
MW-1, West of Foundry	1/20/98		NA	120,000	NA	<50	<100	<100	<200	<100	344	<100
MW-1, West of Foundry	5/25/93		NA	NA	NA	<5.0	<5.0	<5.0	<5.0	<5.0	13.6	<5.0
TW-14, South of MW-1	1/20/98	9.7 / 4.8	NA	<50.0	2547	<0.5	<1.0	<1.0	<2.0	<1.0	<1.0	<1.0
MW-27, South of West ASTs	6/17/99	23.8 / 12.61	NA	NA	<100	<2.7	<3.2	<2.7	<6.7	<3.2	<2.2	<2.7
MW-27, South of West ASTs	4/6/99	23.8 / 16.1	NA	NA	130	<0.27	<3.2	98	<0.67	<3.2	<2.2	<2.7
MW-27, South of West ASTs	10/1/98	23.8 / 16.9	NA	335	2570	<0.5	<1.0	<1.0	<2.0	<1.0	<1.0	<1.0
MW-30, Duplicate	6/17/99		NA	NA	13000	<0.27	<0.32	<0.27	<0.67	<0.32	<0.22	<0.27
MW-30, West of West ASTs	6/17/99	23.5 / 12.64	NA	NA	2800	<0.27	<0.32	<0.27	<0.67	<0.32	<0.22	<0.27
MW-30, West of West ASTs	4/6/99	23.5 / 16.2	NA	NA	4500	<0.27	<0.32	<0.27	<0.67	<0.32	<0.22	<0.27
MW-30DUP, West of West ASTs	4/6/99		NA	NA	7200	<0.27	<0.32	<0.27	<0.67	<0.32	<0.22	<0.27
MW-30, West of West ASTs	10/1/98	23.5 / 16.6	NA	156	31900	<0.5	<1.0	<1.0	<2.0	<1.0	<1.0	<1.0
TW-16, West of ASTs	1/20/98	17.2 / 5.9	NA	287	10811	<0.5	<1.0	<1.0	<2.0	<1.0	<1.0	<1.0
MW-28, North of West ASTs	6/17/99	23.9 / 12.21	NA	NA	1900	<0.27	17	<0.27	16.29	<0.32	0.71	0.35
MW-28, North of West ASTs	4/6/99	23.9 / 15.3	NA	NA	3400	<0.27	3.50	<0.27	2.84	<0.32	0.27	<0.27
MW-28, North of West ASTs	10/1/98	23.9 / 16.6	NA	231	67200	<0.5	1.49	<1.0	1.11	<1.0	5.17	1.44
TW-15, North of MW-1	1/20/98	19.9 / 17.2	NA	1,060	246,000	<0.5	<1.0	<1.0	<2.0	<1.0	<1.0	<1.0

* Includes Detection of Chloromethane, 2.0 ug/L. ES is 3.0, PAL is 0.3 ug/L
 NS : No Standard ; NA Not Analyzed
 Xylenes Sum of m, p, o Xylene
 BOLD Exceeds NR 140 ES
 ITALICS Exceed Preventive Action Limit Standard

TABLE 3 : GROUNDWATER CHEMISTRY RESULTS												
Former Plymouth Foundry Site, Grafton, WI												
GROUNDWATER												
SAMPLE I.D.	Date Sampled	Total Depth / Depth to Water	Dissolved Lead	GRO	DRO	Petroleum Volatile Organic Compounds (ug/l = ppb)						
						Benzene	Ethylbenzene	Toluene	Xylenes	Methyl-t-butyl ether	124-Trimethyl benzene	135-Trimethyl benzene
WI ADMIN CODE		Ft below grnd	(ug/l)	(ug/l = ppb)								
NR 140 E.S. / P.A.L.			15 / 1.5	NS	NS	5.0 / 0.5	700 / 140	1000 / 200	10,000 / 1,000	60 / 12	480 / 96	
NORTHWEST AT FIVE FORMER ASTs												
MW-2, East of NW ASTs	6/17/99	17.9 / 14.61	NA	NA	<100	<0.27	<0.32	<0.27	<0.67	<0.32	<0.22	<0.27
MW-2, East of NW ASTs	4/6/99	17.9 / 16.9	NA	NA	<100	<0.27	<0.32	<0.27	<0.67	<0.32	<0.22	<0.27
MW-2, East of NW ASTs	9/17/98	17.9 / 16.1	NA	<50.0	<100	<0.5	<1.0	<1.0	<2.0	<1.0	<1.0	<1.0
MW-2, East of NW ASTs	1/20/98		NA	<50.0	<100	<0.5	<1.0	<1.0	<2.0	<1.0	<1.0	<1.0
MW-2, East of NW ASTs	5/25/93		NA	NA	NA	<1.0	<1.0	<1.0	<1.0	<1.0	<1.0	<1.0
MW-23, North of NW ASTs	6/17/99	23.2 / 13.47	NA	NA	<100	<0.27	<0.32	<0.27	<0.67	<0.32	<0.22	<0.27
MW-23, North of NW ASTs	4/6/99	23.2 / 16.9	NA	NA	<100	<0.27	<0.32	<0.27	<0.67	<0.32	<0.22	<0.27
MW-23, North of NW ASTs	9/17/98	23.2 / 17.9	NA	<50	<100	<0.5	<1.0	<1.0	<2.0	<1.0	<1.0	<1.0
TW-12, North of ASTs	1/20/98	14.8 / 4.9	NA	291	5590	<0.5	1.49	<1.0	1.37	<1.0	7.11	1.76
MW-24, @ NW ASTs	6/17/99	22.9 / 12.88	NA	NA	23000	<0.27	6.0	<0.27	11.5	<0.32	34	14
MW-24, @ NW ASTs	4/6/99	22.9 / 16.4	NA	NA	1900	0.39	<0.32	<0.27	<0.67	<0.32	<0.22	<0.27
MW-24 DUP, @ NW ASTs	4/6/99		NA	NA	22000	0.33	<0.32	<0.27	<0.67	<0.32	<0.22	<0.27
MW-24, @ NW ASTs	9/17/98	22.9 / 17.2	NA	<50	321	<0.5	<1.0	<1.0	<2.0	<1.0	<1.0	<1.0
MW-24 Dup, @ NW ASTs	9/17/98		NA	<50	265	<0.5	<1.0	<1.0	<2.0	<1.0	<1.0	<1.0
TW-7, At Former ASTs	1/20/98	12.5 / 5.1	NA	148	159	<0.5	<1.0	<1.0	<2.0	<1.0	<1.0	<1.0
MW-25, South of NW ASTs	6/17/99	23.1 / 12.35	NA	NA	<100	<0.27	<0.32	<0.27	<0.67	<0.32	<0.22	<0.27
MW-25, South of NW ASTs	4/6/99	23.1 / 15.8	NA	NA	<100	<0.27	<0.32	<0.27	<0.67	<0.32	<0.22	<0.27
MW-25, South of NW ASTs	9/17/98	23.1 / 16.7	NA	<50	<100	<0.5	<1.0	<1.0	<2.0	<1.0	<1.0	<1.0
TW-11, South of ASTs	1/20/98	14.0 / 5.8	NA	<50.0	<100	<0.5	<1.0	<1.0	<2.0	<1.0	<1.0	<1.0
MW-26, SE of NW ASTs	6/17/99	23.1 / 11.28	NA	NA	<100	<0.27	<0.32	<0.27	<0.67	<0.32	<0.22	<0.27
MW-26, SE of NW ASTs	4/6/99	23.1 / 14.7	NA	NA	<100	<0.27	<0.32	<0.27	<0.67	<0.32	<0.22	<0.27
MW-26, SE of NW ASTs	9/17/98	23.1 / 15.5	NA	<50	<100	<0.5	<1.0	<1.0	<2.0	<1.0	<1.0	<1.0
TW-10, East of ASTs	1/20/98	14.8 / 3.9	NA	<50.0	4170	<0.5	<1.0	<1.0	<2.0	<1.0	<1.0	<1.0

* Includes Detection of Chloromethane, 2.0 ug/L. ES is 3.0, PAL is 0.3 ug/L
NS : No Standard ; NA Not Analyzed
Xylenes Sum of m, p, o Xylene
BOLD Exceeds NR 140 ES
ITALICS Exceed Preventive Action Limit Standard

TABLE 3. GROUNDWATER CHEMISTRY RESULTS												
Former Plymouth Foundry Site, Grafton, WI												
GROUNDWATER												
SAMPLE I.D.	Date Sampled	Total Depth / Depth to Water Ft below grnd	Dissolved Lead (ug/l)	GRO (ug/l = ppb)	DRO (ug/l = ppb)	Petroleum Volatile Organic Compounds (ug/l = ppb)						
						Benzene	Ethylbenzene	Toluene	Xylenes	Methyl-t-butyl ether	124-Trimethyl benzene	135-Trimethyl benzene
WI ADMIN CODE NR 140 ES / P.A.L.			15 / 1.5	NS	NS	50 / 0.5	700 / 140	1000 / 200	10,000 / 1,000	60 / 12	480 / 96	
GAS UST (EAST SIDE OF SITE)												
MW-3, East of Foundry	6/17/99	17.8 / 10.53	NA	NA	<100	<0.27	<0.32	<0.27	<0.67	<0.32	<0.22	<0.27
MW-3, East of Foundry	4/6/99	17.8 / 13.8	NA	NA	<100	<0.27	<0.32	<0.27	<0.67	<0.32	<0.22	<0.27
MW-3, East of Foundry	9/17/98	17.8 / 14.4	NA	NA	NA	<0.5	<1.0	<1.0	<2.0	<1.0	<1.0	<1.0
MW-3, East of Foundry	2/5/98		NA	<50	<100	<0.5	<1.0	<1.0	<2.0	<1.0	<1.0	<1.0
MW-3, East of Foundry	5/25/93		NA	NA	NA	<1.0	<1.0	<1.0	<1.0	<1.0	<1.0	<1.0
MW-19, West	6/17/99	20.7 / 10.76	NA	NA	660.0	1.3	0.94	<0.27	0.86	<0.32	0.38	<0.27
MW-19, West	4/6/99	20.7 / 14.1	NA	NA	480	<0.54	<0.64	<0.54	<1.34	<0.64	<0.44	<0.54
MW-19, West	9/17/98	20.7 / 14.9	<1.0	NA	756	<0.5	<1.0	<1.0	<2.0	<1.0	<1.0	<1.0
MW-22, North	6/17/99	20.5 / 10.46	NA	NA	650.0	<0.27	0.76	<0.27	6.8	<0.32	<0.22	1.0
MW-22, North	4/6/99	20.5 / 13.7	NA	NA	280	<0.27	<0.32	<0.27	<0.67	<0.32	<0.22	<0.27
MW-22, North	9/17/98	20.5 / 14.3	<1.0	NA	575	<0.5	<1.0	<1.0	<2.0	<1.0	<1.0	<1.0
TW-18, South	9/17/98	11.9 / 5.9	NA	NA	NA	<0.5	<1.0	<1.0	<2.0	<1.0	<1.0	<1.0
TW-8, At Gas Dispenser	9/17/98	14.2 / 13.7	NA	NA	NA	NA : DRY						
TW-21, At Dispenser	9/17/98	13.2 / 13.2	NA	900	NA	3.98	4.22	3.27	187	<2.1	28.7	76.0
MW-31, north across 11th Ave	6/17/99	19.01 / 10.78	NA	NA	<100	<0.27	<0.32	<0.27	<0.67	<0.32	<0.27	<0.27
MW-31, north across 11th Ave	5/17/99	19.01 / 11.11	NA	NA	240.0	<0.54	<0.64	<0.54	<1.34	<0.64	<0.44	<0.54
MW-32, south across 11th Ave.	6/17/99	20.44 / 10.35	NA	NA	380.0	<0.27	<0.32	<0.27	<0.67	<0.32	<0.22	<0.27
MW-32, south across 11th Ave.	5/17/99	20.44 / 10.85	NA	NA	100.0	<0.27	<0.32	<0.27	<0.67	<0.32	<0.22	<0.27
OTHER LOCATIONS												
B-46, Parking Lot*	12/26/01	NA / 12	NA	NA	NA	0.18	<0.16	0.33	<0.34	<0.29	<0.12	<0.14
TW-6, Parking Lot	1/20/98	18.8 / 16.7	NA	<50.0	<100	<0.5	<1.0	<1.0	<2.0	<1.0	<1.0	<1.0
TW-9, at former USTs, NE Corne	1/20/98	9.1 / 4.9	NA	<50.0	368	<0.5	<1.0	<1.0	<2.0	<1.0	<1.0	<1.0
TW-29, 60 ft E of NW Cmr of Bld	10/1/98	16.5 / 16.4	NA	NA	NA	NA : DRY						
Trip Blank	6/17/99	NA	NA	NA	NA	<0.27	<0.32	0.36	<0.67	<0.32	<0.22	<0.27
Trip Blank	9/17/98	NA	NA	NA	NA	<0.5	<1.0	<1.0	<2.0	<1.0	<1.0	<1.0
Trip Blank	10/1/98	NA	NA	<50	NA	<0.5	<1.0	<1.0	<2.0	<1.0	<1.0	<1.0
Trip Blank	1/20/98	NA	NA	NA	NA	<0.5	<1.0	<1.0	<2.0	<1.0	<1.0	<1.0

* Includes Detection of Chloromethane, 2.0 ug/L. ES is 3.0, PAL is 0.3 ug/L

NS : No Standard ; NA Not Analyzed

Xylenes Sum of m, p, o Xylene

BOLD Exceeds NR 140 ES

ITALICS Exceed Preventive Action Limit Standard

TABLE 3 : GROUNDWATER CHEMISTRY RESULTS

Former Plymouth Foundry Site, Grafton, WI

GROUNDWATER			Detected VOC's (ug/l = ppb)																	
SAMPLE I.D.	Date Sampled	Total Depth / Depth to Water	FI below grnd	N-Butylbenzene	sec-Butylbenzene	Isopropyl Benzene	1,4-Dichloro benzene	p-Isopropyl toluene	Naphthalene	Tetrachloro ethylene	Trichloro ethylene	1,1,1-Trichloro ethane	Vinyl Chloride	Bromoform	trans-1,2-Dichloroethene	1,1-Dichloro ethane	1,2-Dichloro ethane	1,1-Dichloro Ethene	cis-1,2-Dichloroethene	N-Propylbenzene
				WI ADMIN CODE NR 140 E.S. / P.A.L.			NS	NS	NS	75 / 15	NS	40 / 8	5 / 0.5	5 / 0.5	200 / 40	0.2 / 0.02	4.4 / 0.44	100 / 20	850 / 85	5 / 0.5
WEST OF BUILDING AT FOUR FORMER ASTs																				
MW-1, West of Foundry @ ASTs	6/17/99	17.2 / 17.2	NA DRY																	
MW-1, West of Foundry @ ASTs	4/6/99	17.2 / 16.9	NA DRY																	
MW-1, West of Foundry @ ASTs	10/1/98	17.2 / 16.8	NA DRY																	
MW-1, West of Foundry	1/20/98		NA	NA	NA	NA	NA	NA	NA	NA	NA	NA	NA	NA	NA	NA	NA	NA	NA	NA
MW-1, West of Foundry	5/25/93		12.6	<5.0	<5.0	<5.0	<5.0	51.8	NA	NA	NA	NA	NA	NA	NA	NA	NA	NA	NA	NA
TW-14, South of MW-1	1/20/98	9.7 / 4.8	NA	NA	NA	NA	NA	NA	NA	NA	NA	NA	NA	NA	NA	NA	NA	NA	NA	NA
MW-27, South of West ASTs	6/17/99	23.8 / 12.61	<2.9	<2.9	<2.6	<3.0	<2.4	<3.5	740	140	<3.0	<2.0	<4.4	<7.9	<3.5	<3.7	<4.3	28	<7.6	
MW-27, South of West ASTs	4/6/99	23.8 / 16.1	<2.9	<2.9	<2.6	<3.0	<2.4	<3.5	970	140	<3.0	<2.0	<4.4	<7.9	<3.5	<3.7	<4.3	110	<7.6	
MW-27, South of West ASTs	10/1/98	23.8 / 16.9	NA	NA	NA	NA	NA	<1.0	NA	NA	NA	NA	NA	NA	NA	NA	NA	NA	NA	
MW-30, Duplicate	6/17/99		0.39	0.60	<0.26	<0.30	<0.24	0.46	22	7.5	<0.30	1.6	<0.44	5.2	<0.35	<0.37	<0.43	2.0	<0.76	
MW-30, West of West ASTs	6/17/99	23.5 / 12.64	0.45	<0.29	<0.26	<0.30	<0.24	<0.35	18	4.5	<0.30	1.2	<0.44	3.3	<0.35	<0.37	<0.43	1.4	<0.76	
MW-30, West of West ASTs	4/6/99	23.5 / 16.2	<0.29	0.6	<0.26	<0.30	<0.24	<0.35	68	36	<0.30	1.2	<0.44	9.7	<0.35	<0.37	<0.43	5.5	<0.76	
MW-30DUP, West of West ASTs	4/6/99		<0.29	0.6	<0.26	<0.30	<0.24	<0.35	71	37	<0.30	0.94	<0.44	8.1	<0.35	<0.37	<0.43	5.0	<0.76	
MW-30, West of West ASTs	10/1/98	23.5 / 16.6	NA	NA	NA	NA	NA	3.67	NA	NA	NA	NA	NA	NA	NA	NA	NA	NA	NA	
TW-16, West of ASTs	1/20/98	17.2 / 5.9	4.17	1.98	<1.0	<1.0	1.71	58.3	<1.0	<0.5	<1.0	<0.2	<1.0	<1.0	<1.0	<1.0	<1.0	<1.0	<1.0	
MW-28, North of West ASTs	6/17/99	23.9 / 12.21	2.6	2.2	2.6	0.3	0.38	<0.35	<0.43	<0.37	<0.30	<0.20	<0.44	<0.79	<0.35	<0.37	<0.43	<0.28	3.7	
MW-28, North of West ASTs	4/6/99	23.9 / 15.3	0.52	0.48	0.5	<0.30	<0.24	<0.35	0.59	0.55	<0.30	0.33	<0.44	<0.79	<0.35	<0.37	<0.43	<0.28	<0.76	
MW-28, North of West ASTs	10/1/98	23.9 / 16.6	NA	NA	NA	NA	NA	6.96	NA	NA	NA	NA	NA	NA	NA	NA	NA	NA	NA	
TW-15, North of MW-1	1/20/98	19.9 / 17.2	<5.0	6.2	<5.0	<5.0	<5.0	<5.0	36.3	7.5	<5.0	4.91	<5.0	<5.0	<5.0	<5.0	<5.0	<5.0	<5.0	

* Includes Detection of Chloromethane, 2.0 ug/L ES is 3.0, PAL is 0.3 ug/L
 NS : No Standard ; NA Not Analyzed
 Xylenes Sum of m, p, o Xylene
 BOLD Exceeds NR 140 ES
 ITALICS Exceed Preventive Action Limit Standard

TABLE 3: GROUNDWATER CHEMISTRY RESULTS

Former Plymouth Foundry Site, Grafton, WI

GROUNDWATER

SAMPLE I.D.	Date Sampled	Total Depth / Depth to Water	Detected VOC's (ug/l = ppb)																	
			Ft below grnd	N-Butylbenzene	sec-Butylbenzene	Isopropyl Benzene	1,4-Dichloro benzene	p-Isopropyl toluene	Naphthalene	Tetrachloro ethylene	Trichloro ethylene	1,1,1-Trichloro ethane	Vinyl Chloride	Bromoform	trans-1,2-Dichloroethene	1,1-Dichloro ethane	1,2-Dichloro ethane	1,1-Dichloro Ethene	cis-1,2-Dichloroethene	N-Propylbenzene
WI ADMIN CODE NR 140 E.S. / P.A.L.			NS	NS	NS	75 / 15	NS	40 / 8	5 / 0.5	5 / 0.5	200 / 40	0.2 / 0.02	4.4 / 0.44	100 / 20	850 / 85	5 / 0.5	7 / 0.7	70 / 7	NS	
NORTHWEST AT FIVE FORMER ASTs																				
MW-2, East of NW ASTs	6/17/99	17.9 / 14.61	<0.29	<0.29	<0.29	<0.30	<0.24	<0.35	<0.43	<0.37	<0.37	<0.20	<0.44	<0.79	<0.35	<0.37	<0.43	<0.28	<0.76	
MW-2, East of NW ASTs	4/6/99	17.9 / 16.9	<0.29	<0.29	<0.29	<0.30	<0.24	<0.35	<0.43	<0.37	<0.37	<0.20	<0.44	<0.79	<0.35	<0.37	<0.43	<0.28	<0.76	
MW-2, East of NW ASTs	9/17/98	17.9 / 16.1	NA	NA	NA	NA	NA	NA	NA	NA	NA	NA	NA	NA	NA	NA	NA	NA	NA	
MW-2, East of NW ASTs	1/20/98		NA	NA	NA	NA	NA	NA	NA	NA	NA	NA	NA	NA	NA	NA	NA	NA	NA	
MW-2, East of NW ASTs	5/25/93		<1.0	<1.0	<1.0	<1.0	<1.0	<1.0	<1.0	<1.0	<1.0	<1.0	<1.0	<1.0	<1.0	<1.0	<1.0	<1.0	<1.0	
MW-23, North of NW ASTs	6/17/99	23.2 / 13.47	<0.29	<0.29	<0.29	<0.30	<0.24	<0.35	<0.43	<0.37	<0.37	<0.20	<0.44	<0.79	<0.35	<0.37	<0.43	<0.28	<0.76	
MW-23, North of NW ASTs	4/6/99	23.2 / 16.9	<0.29	<0.29	<0.29	<0.30	<0.24	<0.35	<0.43	<0.37	<0.37	<0.20	<0.44	<0.79	<0.35	<0.37	<0.43	<0.28	<0.76	
MW-23, North of NW ASTs	9/17/98	23.2 / 17.9	NA	NA	NA	NA	NA	NA	NA	NA	NA	NA	NA	NA	NA	NA	NA	NA	NA	
TW-12, North of ASTs	1/20/98	14.8 / 4.9	NA	NA	NA	NA	NA	NA	NA	NA	NA	NA	NA	NA	NA	NA	NA	NA	NA	
MW-24, @ NW ASTs	6/17/99	22.9 / 12.88	2.5	1.0	2.2	<0.30	2.3	75	<0.43	<0.37	<0.30	<0.20	<0.44	<0.79	<0.35	<0.37	<0.43	<0.28	3.0	
MW-24, @ NW ASTs	4/6/99	22.9 / 16.4	<0.29	<0.29	<0.29	<0.30	<0.24	<0.35	<0.43	<0.37	<0.37	<0.20	<0.44	<0.79	<0.35	<0.37	<0.43	<0.28	<0.76	
MW-24 DUP, @ NW ASTs	4/6/99		<0.29	<0.29	<0.29	<0.30	<0.24	<0.35	<0.43	<0.37	<0.37	<0.20	<0.44	<0.79	<0.35	<0.37	<0.43	<0.28	<0.76	
MW-24, @ NW ASTs	9/17/98	22.9 / 17.2	NA	NA	NA	NA	NA	NA	NA	NA	NA	NA	NA	NA	NA	NA	NA	NA	NA	
MW-24 Dup, @ NW ASTs	9/17/98		NA	NA	NA	NA	NA	NA	NA	NA	NA	NA	NA	NA	NA	NA	NA	NA	NA	
TW-7, At Former ASTs	1/20/98	12.5 / 5.1	<1.0	<1.0	<1.0	<1.0	<1.0	<1.0	<1.0	<0.5	<1.0	<0.2	<1.0	<1.0	<1.0	<1.0	<1.0	<1.0	<1.0	
MW-25, South of NW ASTs	6/17/99	23.1 / 12.35	<0.29	<0.29	<0.29	<0.30	<0.24	<0.35	<0.43	<0.37	<0.37	<0.20	<0.44	<0.79	<0.35	<0.37	<0.43	<0.28	<0.76	
MW-25, South of NW ASTs	4/6/99	23.1 / 15.8	<0.29	<0.29	<0.29	<0.30	<0.24	<0.35	<0.43	<0.37	<0.37	<0.20	<0.44	<0.79	<0.35	<0.37	<0.43	<0.28	<0.76	
MW-25, South of NW ASTs	9/17/98	23.1 / 16.7	NA	NA	NA	NA	NA	NA	NA	NA	NA	NA	NA	NA	NA	NA	NA	NA	NA	
TW-11, South of ASTs	1/20/98	14.0 / 5.8	NA	NA	NA	NA	NA	NA	NA	NA	NA	NA	NA	NA	NA	NA	NA	NA	NA	
MW-26, SE of NW ASTs	6/17/99	23.1 / 11.28	<0.32	<0.29	<0.29	<0.30	<0.24	<0.35	<0.43	<0.37	<0.37	<0.20	<0.44	<0.79	<0.35	<0.37	<0.43	<0.28	<0.76	
MW-26, SE of NW ASTs	4/6/99	23.1 / 14.7	<0.29	<0.29	<0.29	<0.30	<0.24	<0.35	<0.43	<0.37	<0.37	<0.20	<0.44	<0.79	<0.35	<0.37	<0.43	<0.28	<0.76	
MW-26, SE of NW ASTs	9/17/98	23.1 / 15.5	NA	NA	NA	NA	NA	NA	NA	NA	NA	NA	NA	NA	NA	NA	NA	NA	NA	
TW-10, East of ASTs	1/20/98	14.8 / 3.9	NA	NA	NA	NA	NA	NA	NA	NA	NA	NA	NA	NA	NA	NA	NA	NA	NA	

* Includes Detection of Chloromethane, 2.0 ug/L. ES is 3.0, PAL is 0.3 ug/L
 NS : No Standard ; NA Not Analyzed
 Xylenes Sum of m, p, o Xylene
 BOLD Exceeds NR 140 ES
 ITALICS Exceed Preventive Action Limit Standard

TABLE 3 : GROUNDWATER CHEMISTRY RESULTS

Former Plymouth Foundry Site, Grafton, WI

GROUNDWATER

SAMPLE I.D.	Date Sampled	Total Depth / Depth to Water Ft below grd	Detected VOC's (ug/l = ppb)																
			N-Butylbenzene	sec-Butylbenzene	Isopropyl Benzene	1,4-Dichloro benzene	p-Isopropyl toluene	Naphthalene	Tetrachloro ethylene	Trichloroethylene	1,1,1-Trichloroethane	Vinyl Chloride	Bromoform	trans-1,2-Dichloroethene	1,1-Dichloroethane	1,2-Dichloroethane	1,1-Dichloro Ethene	cis-1,2-Dichloroethene	N-Propylbenzene
WI ADMIN CODE NR 140 E.S. / P.A.L.			NS	NS	NS	75 / 15	NS	40 / 8	5 / 0.5	5 / 0.5	200 / 40	0.2 / 0.02	4.4 / 0.44	100 / 20	850 / 85	5 / 0.5	7 / 0.7	70 / 7	NS
GAS UST (EAST SIDE OF SITE)																			
MW-3, East of Foundry	6/17/99	17.8 / 10.53	<0.29	<0.29	<0.26	<0.30	<0.24	<0.35	130	24	<0.30	0.57	<0.44	<0.79	<0.35	<0.37	<0.43	24	<0.76
MW-3, East of Foundry	4/6/99	17.8 / 13.8	<0.29	<0.29	<0.26	<0.30	<0.24	<0.35	200	36	<0.30	<0.20	<0.44	<0.79	<0.35	<0.37	<0.43	27	<0.76
MW-3, East of Foundry	9/17/98	17.8 / 14.4	<1.0	<1.0	<1.0	<1.0	<1.0	<1.0	164	25.4	<1.0	<0.2	<1.0	<1.0	<1.0	<1.0	<1.0	41.4	<1.0
MW-3, East of Foundry	2/5/98		<1.0	<1.0	<1.0	<1.0	<1.0	<1.0	151	37.1	<1.0	<0.2	<1.0	<1.0	<1.0	<1.0	<1.0	22.9	<1.0
MW-3, East of Foundry	5/25/93		<1.0	<1.0	<1.0	<1.0	<1.0	<1.0	185	26.7	<1.0	<1.0	81.9	<1.0	<1.0	<1.0	<1.0	16.1	<1.0
MW-19, West	6/17/99	20.7 / 10.76	<0.29	0.34	<0.26	<0.30	<0.24	<0.35	1.1	2.1	<0.30	24	<0.44	7.5	<0.35	1.0	<0.43	1.8	<0.76
MW-19, West	4/6/99	20.7 / 14.1	<0.58	<0.58	<0.52	<0.60	<0.48	<0.70	11	13	<0.60	250	<0.88	58	<0.70	<0.74	<0.43	2.8	<1.5
MW-19, West	9/17/98	20.7 / 14.9	1.65	3.49	<1.0	<1.0	<1.0	<1.0	6.12	5.53	<1.0	60.5	NA	15.9	<1.0	<1.0	<1.0	6.24	<1.0
MW-22, North	6/17/99	20.5 / 10.46	<0.29	<0.29	<0.26	<0.30	<0.24	0.59	<0.43	<0.37	<0.30	<0.20	<0.44	<0.79	<0.35	0.58	<0.43	<0.28	<0.76
MW-22, North	4/6/99	20.5 / 13.7	<0.29	1.40	0.31	<0.30	<0.24	<0.35	0.44	2.30	<0.30	0.97	<0.44	1.3	1.1	<0.37	<0.43	0.52	<0.76
MW-22, North	9/17/98	20.5 / 14.3	<1.0	3.78	<1.0	<1.0	<1.0	1.19	<1.0	1.11	<1.0	0.613	NA	1.1	<1.0	<1.0	<1.0	<2.0	<1.0
TW-18, South	9/17/98	11.9 / 5.9	<1.0	<1.0	<1.0	1.07	<1.0	<1.0	<1.0	<0.5	<1.0	<0.2	NA	<1.0	<1.0	<1.0	<1.0	<2.0	<1.0
TW-8, At Gas Dispenser	9/17/98	14.2 / 13.7	NA - DRY																
TW-21, At Dispenser	9/17/98	13.2 / 13.2	NA	NA	NA	NA	NA	NA	NA	NA	NA	NA	NA	NA	NA	NA	NA	NA	NA
MW-31, north across 11th Ave	6/17/99	19.01 / 10.78	<0.29	<0.29	<0.26	<0.30	<0.24	2.2	3.5	1.3	0.71	120	<0.44	6.3	1.0	<0.37	<0.43	20	<0.76
MW-31, north across 11th Ave	5/17/99	19.01 / 11.11	<0.58	0.76	<0.52	<0.60	<0.48	<0.70	7.1	3.8	<0.60	210	<0.88	5.7	0.84	<0.74	<0.43	24	<1.5
MW-32, south across 11th Ave.	6/17/99	20.44 / 10.35	<0.29	1.00	<0.26	<0.30	<0.24	<0.35	5.5	3.8	1.4	1.5	<0.44	1.8	0.82	<0.37	<0.43	1.1	<0.76
MW-32, south across 11th Ave.	5/17/99	20.44 / 10.85	<0.29	0.81	<0.26	<0.30	<0.24	0.4	14	4.2	1.6	1.3	<0.44	1.2	0.68	<0.37	<0.43	1.1	<0.76
OTHER LOCATIONS																			
B-46, Parking Lot	12/26/01	NA / 12	<0.14	<0.14	<0.13	<0.13	<0.21	<0.29											
TW-6, Parking Lot	1/20/98	18.8 / 16.7	NA	NA	NA	NA	NA	<0.29	1.1	0.31	<0.22	<0.17	<0.36	<0.22	<0.23	<0.20	<0.16	<0.24	<0.14
TW-9, at former USTs, NE Corne	1/20/98	9.1 / 4.9	NA	NA	NA	NA	NA	NA	NA	NA	NA	NA	NA	NA	NA	NA	NA	NA	NA
TW-29, 60 ft E of NW Cmr of Bld	10/1/98	16.5 / 16.4	NA - DRY																
Trip Blank	6/17/99	NA	<0.29	<0.29	<0.26	<0.30	<0.24	<0.35	<0.43	<0.37	<0.30	<0.20	<0.44	<0.79	<0.35	<0.37	<0.43	<0.28	<0.76
Trip Blank	9/17/98	NA	<1.0	<1.0	<1.0	<1.0	<1.0	<1.0	<1.0	<0.5	<1.0	<0.2	<1.0	<1.0	<1.0	<1.0	<1.0	<2.0	<1.0
Trip Blank	10/1/98	NA	NA	NA	NA	NA	NA	<1.0	NA	NA	NA	NA	NA	NA	NA	NA	NA	NA	NA
Trip Blank	1/20/98	NA	<1.0	<1.0	<1.0	<1.0	<1.0	<1.0	<1.0	<0.5	<1.0	<0.2	<1.0	<1.0	<1.0	<1.0	<1.0	<2.0	<1.0

* Includes Detection of Chloromethane, 2.0 ug/L. ES is 3.0, PAL is 0.3 ug/L

NS : No Standard ; NA Not Analyzed

Xylenes Sum of m, p, o Xylene

BOLD Exceeds NR 140 ES

ITALICS Exceed Preventive Action Limit Standard

TABLE 3: GROUNDWATER CHEMISTRY RESULTS

Former Plymouth Foundry Site, Grafton, WI

GROUNDWATER															
SAMPLE I.D.	Date Sampled	Total Depth / Depth to Water	Polynuclear Aromatic Hydrocarbons (ug/l)												
			Ft below grnd	Acenaphthene	Anthracene	Benzo (a) Anthracene	Benzo (g,h,i) perylene	Chrysene	Fluorene	Fluoranthene	Indeno (1,2,3-cd) Pyrene	1-Methyl Naphthalene	2-Methyl Naphthalene	Naphthalene	Pyrene
WI ADMIN CODE NR 140 E.S. / P.A.L.			NS	3000/ 600	NS	NS	0.2 / 0.02	NS	400 / 80	NS	NS	NS	40 / 8	250 / 50	NS
WEST OF BUILDING AT FOUR FORMER ASTs															
MW-1, West of Foundry @ ASTs	6/17/99	17.2 / 17.2	NA : DRY	NA	NA	NA	NA	NA	NA	NA	NA	NA	NA	NA	NA
MW-1, West of Foundry @ ASTs	4/6/99	17.2 / 16.9	NA : DRY	NA	NA	NA	NA	NA	NA	NA	NA	NA	NA	NA	NA
MW-1, West of Foundry @ ASTs	10/1/98	17.2 / 16.8	76.6	<1.0	<1.3	<1.6	<1.3	287	<1.3	1.51	189	<0.07	<0.05	<1.3	245
MW-1, West of Foundry	1/20/98		NA	NA	NA	NA	NA	NA	NA	NA	NA	NA	NA	NA	NA
MW-1, West of Foundry	5/25/93		NA	NA	NA	NA	NA	NA	NA	NA	NA	NA	NA	NA	NA
TW-14, South of MW-1	1/20/98	9.7 / 4.8	NA	NA	NA	NA	NA	NA	NA	NA	NA	NA	NA	NA	NA
MW-27, South of West ASTs	6/17/99	23.8 / 12.61	<0.47	<0.021	<0.05	<0.021	<0.016	<0.058	<0.015	<0.025	<0.36	<0.36	<0.42	<0.14	<0.046
MW-27, South of West ASTs	4/6/99	23.8 / 16.1	<4.7	<0.021	<0.05	<0.021	<0.016	<0.058	<0.015	<0.025	<0.36	<0.36	<0.42	<0.14	<0.046
MW-27, South of West ASTs	10/1/98	23.8 / 16.9	<0.11	<0.03	<0.06	<0.05	<0.04	<0.04	<0.04	<0.04	<0.06	<0.06	<0.07	<0.17	0.226
MW-30, Duplicate	6/17/99		<1.4	<0.063	0.089	<0.80	0.06	<0.17	<0.045	<0.075	<1.1	<1.1	<1.3	<0.051	0.87
MW-30, West of West ASTs	6/17/99	23.5 / 12.64	<0.94	<0.042	0.051	<0.042	0.084	<0.12	<0.030	<0.050	<0.72	<0.72	<0.84	0.04	0.85
MW-30, West of West ASTs	4/6/99	23.5 / 16.2	<9.4	0.61	0.74	<0.42	1.1	<1.2	<0.030	<0.50	<7.2	<7.2	<8.4	0.50	6.7
MW-30DUP, West of West ASTs	4/6/99		<9.4	0.46	0.62	<0.42	0.79	<1.2	<0.030	<0.50	<7.2	<7.2	<8.4	<0.34	5.5
MW-30, West of West ASTs	10/1/98	23.5 / 16.6	0.437	<0.03	<0.06	<0.05	<0.04	1.32	<0.030	<0.04	<0.06	<0.07	<0.05	<0.17	<0.08
TW-16, West of ASTs	1/20/98	17.2 / 5.9	NA	NA	NA	NA	NA	NA	NA	NA	NA	NA	NA	NA	NA
MW-28, North of West ASTs	6/17/99	23.9 / 12.21	NA	NA	NA	NA	NA	NA	NA	NA	NA	NA	NA	NA	NA
MW-28, North of West ASTs	4/6/99	23.9 / 15.3	<3.8	<0.17	0.31	<0.17	0.5	<0.46	<0.12	<0.20	<2.9	<2.9	<3.4	<0.14	2.2
MW-28, North of West ASTs	10/1/98	23.9 / 16.6	3.88	<0.03	<0.06	<0.05	<0.04	8.55	<0.03	<0.04	6.69	2.67	1.78	<0.17	<0.08
TW-15, North of MW-1	1/20/98	19.9 / 17.2	NA	NA	NA	NA	NA	NA	NA	NA	NA	NA	NA	NA	NA

* Includes Detection of Chloromethane, 2.0 ug/L. ES is 3.0, PAL is 0.3 ug/L
 NS : No Standard ; NA Not Analyzed
 Xylenes Sum of m, p, o Xylene
 BOLD Exceeds NR 140 ES
 ITALICS Exceed Preventive Action Limit Standard

TABLE 3 : GROUNDWATER CHEMISTRY RESULTS																
Former Plymouth Foundry Site, Grafton, WI																
GROUNDWATER																
SAMPLE I.D.	Date Sampled	Total Depth / Depth to Water	Polynuclear Aromatic Hydrocarbons (ug/l)													
			Ft below grd	Acenaphthene	Anthracene	Benzo (a) Anthracene	Benzo (g,h,i) perylene	Chrysene	Fluorene	Fluoranthene	Indeno (1,2,3-cd) Pyrene	1-Methyl Naphthalene	2-Methyl Naphthalene	Naphthalene	Pyrene	Phenanthrene
WI ADMIN CODE NR 140 E.S. / P.A.L.			NS	3000/600	NS	NS	0.2 / 0.02	NS	400 / 80	NS	NS	NS	40 / 8	250 / 50	NS	
NORTHWEST AT FIVE FORMER ASTs																
MW-2, East of NW ASTs	6/17/99	17.9 / 14.61	NA	NA	NA	NA	NA	NA	NA	NA	NA	NA	NA	NA	NA	
MW-2, East of NW ASTs	4/6/99	17.9 / 16.9	<0.47	<0.021	<0.014	<0.021	<0.016	<0.058	<0.015	<0.025	<0.36	<0.36	<0.42	NA	NA	
MW-2, East of NW ASTs	9/17/98	17.9 / 16.1	NA	NA	NA	NA	NA	NA	NA	NA	NA	NA	NA	<0.017	<0.046	
MW-2, East of NW ASTs	1/20/98		NA	NA	NA	NA	NA	NA	NA	NA	NA	NA	NA	NA	NA	
MW-2, East of NW ASTs	5/25/93		NA	NA	NA	NA	NA	NA	NA	NA	NA	NA	NA	NA	NA	
MW-23, North of NW ASTs	6/17/99	23.2 / 13.47	NA	NA	NA	NA	NA	NA	NA	NA	NA	NA	NA	NA	NA	
MW-23, North of NW ASTs	4/6/99	23.2 / 16.9	<0.47	<0.021	<0.014	<0.021	<0.016	<0.058	<0.015	<0.025	<0.36	<0.36	<0.42	NA	NA	
MW-23, North of NW ASTs	9/17/98	23.2 / 17.9	NA	NA	NA	NA	NA	NA	NA	NA	NA	NA	NA	<0.017	<0.046	
TW-12, North of ASTs	1/20/98	14.8 / 4.9	NA	NA	NA	NA	NA	NA	NA	NA	NA	NA	NA	NA	NA	
MW-24, @ NW ASTs	6/17/99	22.9 / 12.88	<9.4	<0.42	<0.28	<0.42	<0.32	<1.2	<0.30	<0.50	24.0	10.0	9.9	<0.34	4.6	
MW-24, @ NW ASTs	4/6/99	22.9 / 16.4	<0.94	<0.042	0.043	<0.042	0.22	<0.12	<0.030	<0.050	<0.72	<0.72	<0.84	<0.034	0.280	
MW-24 DUP, @ NW ASTs	4/6/99		<4.7	<0.21	0.210	<0.21	0.71	<5.8	<0.15	<0.25	<3.6	<3.6	<4.2	<0.17	2.500	
MW-24, @ NW ASTs	9/17/98	22.9 / 17.2	<0.11	<0.03	<0.06	<0.05	<0.04	<0.04	<0.04	<0.04	0.114	0.112	<0.05	<0.17	0.089	
MW-24 Dup, @ NW ASTs	9/17/98		<0.11	<0.03	<0.06	<0.05	<0.04	<0.04	<0.04	<0.04	<0.06	<0.07	<0.05	<0.17	<0.08	
TW-7, At Former ASTs	1/20/98	12.5 / 5.1	NA	NA	NA	NA	NA	NA	NA	NA	NA	NA	NA	NA	NA	
MW-25, South of NW ASTs	6/17/99	23.1 / 12.35	NA	NA	NA	NA	NA	NA	NA	NA	NA	NA	NA	NA	NA	
MW-25, South of NW ASTs	4/6/99	23.1 / 15.8	<0.47	<0.021	<0.014	<0.021	<0.016	<0.058	<0.015	<0.025	<0.36	<0.36	<0.42	<0.017	<0.046	
MW-25, South of NW ASTs	9/17/98	23.1 / 16.7	NA	NA	NA	NA	NA	NA	NA	NA	NA	NA	NA	NA	NA	
TW-11, South of ASTs	1/20/98	14.0 / 5.8	NA	NA	NA	NA	NA	NA	NA	NA	NA	NA	NA	NA	NA	
MW-26, SE of NW ASTs	6/17/99	23.1 / 11.28	NA	NA	NA	NA	NA	NA	NA	NA	NA	NA	NA	NA	NA	
MW-26, SE of NW ASTs	4/6/99	23.1 / 14.7	<0.47	<0.021	<0.014	<0.021	<0.016	<0.058	<0.015	<0.025	<0.36	<0.36	<0.42	NA	NA	
MW-26, SE of NW ASTs	9/17/98	23.1 / 15.5	NA	NA	NA	NA	NA	NA	NA	NA	NA	NA	NA	<0.017	<0.046	
TW-10, East of ASTs	1/20/98	14.8 / 3.9	NA	NA	NA	NA	NA	NA	NA	NA	NA	NA	NA	NA	NA	

* Includes Detection of Chloromethane, 2.0 ug/L ES is 3.0, PAL is 0.3 ug/L

NS : No Standard ; NA Not Analyzed

Xylenes Sum of m, p, o Xylene

BOLD Exceeds NR 140 ES

ITALICS Exceed Preventive Action Limit Standard

TABLE 3: GROUNDWATER CHEMISTRY RESULTS

Former Plymouth Foundry Site, Grafton, WI

GROUNDWATER															
SAMPLE I.D.	Date Sampled	Total Depth / Depth to Water	Polynuclear Aromatic Hydrocarbons (ug/l)												
			Ft below grd	Acenaphthene	Anthracene	Benzo (a) Anthracene	Benzo (g,h,i) perylene	Chrysene	Fluorene	Fluoranthene	Indeno (1,2,3-cd) Pyrene	1-Methyl Naphthalene	2-Methyl Naphthalene	Naphthalene	Pyrene
WI ADMIN CODE NR 140 ES / P.A.L.			NS	3000/600	NS	NS	0.2 / 0.02	NS	400 / 80	NS	NS	NS	40 / 8	250 / 50	NS
GAS UST (EAST SIDE OF SITE)															
MW-3, East of Foundry	6/17/99	17.8 / 10.53	<0.47	<0.021	<0.014	0.021	<0.016	<0.058	<0.015	<0.025	<0.36	<0.36	<0.42	<0.017	<0.046
MW-3, East of Foundry	4/6/99	17.8 / 13.8	<0.47	<0.021	<0.014	<0.021	<0.016	<0.058	<0.015	<0.025	<0.36	<0.36	<0.42	<0.017	<0.046
MW-3, East of Foundry	9/17/98	17.8 / 14.4	NA	NA	NA	NA	NA	NA	NA	NA	NA	NA	NA	NA	NA
MW-3, East of Foundry	2/5/98		NA	NA	NA	NA	NA	NA	NA	NA	NA	NA	NA	NA	NA
MW-3, East of Foundry	5/25/93		NA	NA	NA	NA	NA	NA	NA	NA	NA	NA	NA	NA	NA
MW-19, West	6/17/99	20.7 / 10.76	1.1	0.12	<0.014	<0.021	<0.016	0.42	<0.015	<0.025	<0.36	0.55	<0.42	<0.017	1.7
MW-19, West	4/6/99	20.7 / 14.1	2.3	0.31	<0.014	<0.021	<0.016	1.10	0.032	<0.025	<0.36	0.99	<0.42	<0.017	2.6
MW-19, West	9/17/98	20.7 / 14.9	NA	NA	NA	NA	NA	NA	NA	NA	NA	NA	NA	NA	NA
MW-22, North	6/17/99	20.5 / 10.46	1.4	0.053	<0.014	<0.021	<0.016	0.98	<0.015	<0.025	<0.36	0.55	<0.42	<0.017	2.6
MW-22, North	4/6/99	20.5 / 13.7	2.1	0.230	<0.014	<0.021	<0.016	1.7	0.016	<0.025	<0.36	0.79	<0.42	<0.017	2.4
MW-22, North	9/17/98	20.5 / 14.3	NA	NA	NA	NA	NA	NA	NA	NA	NA	NA	NA	NA	NA
TW-18, South	9/17/98	11.9 / 5.9	NA	NA	NA	NA	NA	NA	NA	NA	NA	NA	NA	NA	NA
TW-8, At Gas Dispenser	9/17/98	14.2 / 13.7	NA : DRY	NA	NA	NA	NA	NA	NA	NA	NA	NA	NA	NA	NA
TW-21, At Dispenser	9/17/98	13.2 / 13.2	NA	NA	NA	NA	NA	NA	NA	NA	NA	NA	NA	NA	NA
MW-31, north across 11th Ave	6/17/99	19.01 / 10.78	<0.47	<0.021	<0.014	<0.021	<0.016	<0.058	<0.015	<0.025	<0.36	<0.36	<0.42	<0.017	0.12
MW-31, north across 11th Ave	5/17/99	19.01 / 11.11	NA	NA	NA	NA	NA	NA	NA	NA	NA	NA	NA	NA	NA
MW-32, south across 11th Ave.	6/17/99	20.44 / 10.35	0.96	0.082	<0.014	<0.021	0.019	0.39	0.017	<0.025	<0.36	0.55	<0.42	<0.017	1.4
MW-32, south across 11th Ave.	5/17/99	20.44 / 10.85	NA	NA	NA	NA	NA	NA	NA	NA	NA	NA	NA	NA	NA
OTHER LOCATIONS															
B-46, Parking Lot*	12/26/01	NA / 12													
TW-6, Parking Lot	1/20/98	18.8 / 16.7	NA	NA	NA	NA	NA	NA	NA	NA	NA	NA	NA	NA	NA
TW-9, at former USTs, NE Corner	1/20/98	9.1 / 4.9	NA	NA	NA	NA	NA	NA	NA	NA	NA	NA	NA	NA	NA
TW-29, 60 ft E of NW Crr of Bld	10/1/98	16.5 / 16.4	NA : DRY	NA	NA	NA	NA	NA	NA	NA	NA	NA	NA	NA	NA
Trip Blank	6/17/99	NA	NA	NA	NA	NA	NA	NA	NA	NA	NA	NA	NA	NA	NA
Trip Blank	9/17/98	NA	NA	NA	NA	NA	NA	NA	NA	NA	NA	NA	NA	NA	NA
Trip Blank	10/1/98	NA	NA	NA	NA	NA	NA	NA	NA	NA	NA	NA	NA	NA	NA
Trip Blank	1/20/98	NA	NA	NA	NA	NA	NA	NA	NA	NA	NA	NA	NA	NA	NA

* Includes Detection of Chloromethane, 2.0 ug/L. ES is 3.0, PAL is 0.3 ug/L.

NS : No Standard ; NA Not Analyzed

Xylenes Sum of m, p, o Xylene

BOLD Exceeds NR 140 ES

ITALICS Exceed Preventive Action Limit Standard

TABLE 3: GROUNDWATER CHEMISTRY RESULTS									
Former Plymouth Foundry Site, Grafton, WI									
GROUNDWATER									
SAMPLE I.D.	Date Sampled	Total Depth / Depth to Water	Natural Attenuation Parameters						
			Dissolved Oxygen	Sol. Sulfate	Nitrate plus Nitrite	Soluble Iron	Soluble Manganese	Methane	Alkalinity
		Ft below grd	(mg/l)	(mg/l)	(mg/l)	(mg/l)	(mg/l)	(ug/l)	(mg/l)
WI ADMIN CODE NR 140 E.S / P.A.L.			NS	250 / 125	10 / 2	0.3 / 0.15	0.05 / 0.025	NS	NS
WEST OF BUILDING AT FOUR FORMER ASTs									
MW-1, West of Foundry @ ASTs	6/17/99	17.2 / 17.2	NA : DRY	NA	NA	NA	NA	NA	NA
MW-1, West of Foundry @ ASTs	4/6/99	17.2 / 16.9	NA : DRY	NA	NA	NA	NA	NA	NA
MW-1, West of Foundry @ ASTs	10/1/98	17.2 / 16.8	NA : DRY	NA	NA	NA	NA	NA	NA
MW-1, West of Foundry	1/20/98		NA	NA	NA	NA	NA	NA	NA
MW-1, West of Foundry	5/25/93		NA	NA	NA	NA	NA	NA	NA
TW-14, South of MW-1	1/20/98	9.7 / 4.8	NA	NA	NA	NA	NA	NA	NA
MW-27, South of West ASTs	6/17/99	23.8 / 12.61	1.11	NA	NA	NA	NA	NA	NA
MW-27, South of West ASTs	4/6/99	23.8 / 16.1	2.00	46	1.2	0.057	0.015	<0.9	390
MW-27, South of West ASTs	10/1/98	23.8 / 16.9	0.63	44.1	3.24	<0.01	0.107	1.28	NA
MW-30, Duplicate	6/17/99		NA	NA	NA	NA	NA	NA	NA
MW-30, West of West ASTs	6/17/99	23.5 / 12.64	0.63	23	NA	NA	NA	NA	NA
MW-30, West of West ASTs	4/6/99	23.5 / 16.2	0.52	36	0.57	<0.047	0.041	25.0	420.0
MW-30DUP, West of West ASTs	4/6/99			100	1.1	<0.047	0.041	12.0	400.0
MW-30, West of West ASTs	10/1/98	23.5 / 16.6	NA	48.3	1.56	0.052	0.248	2.37	NA
TW-16, West of ASTs	1/20/98	17.2 / 5.9	NA	NA	NA	NA	NA	NA	NA
MW-28, North of West ASTs	6/17/99	23.9 / 12.21	0.57	NA	NA	NA	NA	NA	NA
MW-28, North of West ASTs	4/6/99	23.9 / 15.3	0.13	9.5	0.04	0.047	0.032	46.0	480
MW-28, North of West ASTs	10/1/98	23.9 / 16.6	NA	62.1	<0.3	0.42	0.273	3.88	NA
TW-15, North of MW-1	1/20/98	19.9 / 17.2	NA	NA	NA	NA	NA	NA	NA
NORTHWEST AT FIVE FORMER ASTs									
MW-2, East of NW ASTs	6/17/99	17.9 / 14.61	8.84	NA	NA	NA	NA	NA	NA
MW-2, East of NW ASTs	4/6/99	17.9 / 16.9	4.08	33.0	2.9	<0.047	0.0027	<0.9	410
MW-2, East of NW ASTs	9/17/98	17.9 / 16.1	2.97	33.0	1.04	<0.01	0.024	<1.0	382
MW-2, East of NW ASTs	1/20/98		NA	NA	NA	NA	NA	NA	NA
MW-2, East of NW ASTs	5/25/93		NA	NA	NA	NA	NA	NA	NA
MW-23, North of NW ASTs	6/17/99	23.2 / 13.47	6.69	NA	NA	NA	NA	NA	NA
MW-23, North of NW ASTs	4/6/99	23.2 / 16.9	4.14	38.0	0.17	<0.047	0.039	2.50	430
MW-23, North of NW ASTs	9/17/98	23.2 / 17.9	5.14	25.5	2.53	0.038	0.293	2.63	294
TW-12, North of ASTs	1/20/98	14.8 / 4.9	NA	NA	NA	NA	NA	NA	NA
MW-24, @ NW ASTs	6/17/99	22.9 / 12.88	0.60	NA	NA	NA	NA	NA	NA

* Includes Detection of Chloromethane, 2.0 ug/L. ES is 3.0, PAL is 0.3 ug/L

NS : No Standard ; NA Not Analyzed

Xylenes Sum of m, p, o Xylene

BOLD Exceeds NR 140 ES

ITALICS Exceed Preventive Action Limit Standard

TABLE 3 : GROUNDWATER CHEMISTRY RESULTS									
Former Plymouth Foundry Site, Grafton, WI									
GROUNDWATER									
SAMPLE I.D.	Date Sampled	Total Depth / Depth to Water	Natural Attenuation Parameters						
			Dissolved Oxygen	Sol. Sulfate	Nitrate plus Nitrite	Soluble Iron	Soluble Manganese	Methane	Alkalinity
		Ft below grd	(mg/l)	(mg/l)	(mg/l)	(mg/l)	(mg/l)	(ug/l)	(mg/l)
WI ADMIN CODE									
NR 140 E.S. / P.A.L.			NS	250 / 125	10 / 2	0.3 / 0.15	0.05 / 0.025	NS	NS
MW-24, @ NW ASTs	4/6/99	22.9 / 16.4	0.39	14.0	0.14	<0.047	0.38	7.70	510
MW-24 DUP, @ NW ASTs	4/6/99			14.0	0.17	<0.047	0.38	5.40	450
MW-24, @ NW ASTs	9/17/98	22.9 / 17.2	0.16	16.4	1.0	0.024	0.389	4.18	263
MW-24 Dup, @ NW ASTs	9/17/98		NA	17.7	0.854	0.022	0.422	4.25	268
TW-7, At Former ASTs	1/20/98	12.5 / 5.1	NA	NA	NA	NA	NA	NA	NA
MW-25, South of NW ASTs	6/17/99	23.1 / 12.35	0.85	NA	NA	NA	NA	NA	NA
MW-25, South of NW ASTs	4/6/99	23.1 / 15.8	0.80	12.0	0.37	<0.047	0.006	1.70	300
MW-25, South of NW ASTs	9/17/98	23.1 / 16.7	2.53	21.6	1.89	<0.01	0.002	<1.0	309
TW-11, South of ASTs	1/20/98	14.0 / 5.8	NA	NA	NA	NA	NA	NA	NA
MW-26, SE of NW ASTs	6/17/99	23.1 / 11.28	0.34	NA	NA	NA	NA	NA	NA
MW-26, SE of NW ASTs	4/6/99	23.1 / 14.7	0.38	52.0	0.037	<0.047	0.049	7.30	270
MW-26, SE of NW ASTs	9/17/98	23.1 / 15.5	0.20	21.3	1.65	0.072	0.051	<1.0	299
TW-10, East of ASTs	1/20/98	14.8 / 3.9	NA	NA	NA	NA	NA	NA	NA
GAS UST (EAST SIDE OF SITE)									
MW-3, East of Foundry	6/17/99	17.8 / 10.53	0.82	31.0	0.72	0.16	0.014	<10	NA
MW-3, East of Foundry	4/6/99	17.8 / 13.8	1.1	54.0	0.79	<0.047	<0.0025	<0.9	370.0
MW-3, East of Foundry	9/17/98	17.8 / 14.4	NA	NA	NA	NA	NA	NA	NA
MW-3, East of Foundry	2/5/98		0.31	NA	NA	NA	NA	NA	NA
MW-3, East of Foundry	5/25/93		NA	NA	NA	NA	NA	NA	NA
MW-19, West	6/17/99	20.7 / 10.76	0.26	31	0.72	0.16	0.014	<10	NA
MW-19, West	4/6/99	20.7 / 14.1	0.12	31	0.036	0.13	0.120	57.0	480.0
MW-19, West	9/17/98	20.7 / 14.9	NA	NA	NA	NA	NA	NA	NA
MW-22, North	6/17/99	20.5 / 10.46	0.35	19.0	2.3	1.5	0.22	53.0	NA
MW-22, North	4/6/99	20.5 / 13.7	0.38	30	0.086	<0.047	0.22	78.0	390.0
MW-22, North	9/17/98	20.5 / 14.3	0.17	24	<0.3	2.75	0.25	14.3	410.0
TW-18, South	9/17/98	11.9 / 5.9	0.13	NA	NA	NA	NA	NA	NA
TW-8, At Gas Dispenser	9/17/98	14.2 / 13.7	NA - DRY						
TW-21, At Dispenser	9/17/98	13.2 / 13.2	NA	NA	NA	NA	NA	NA	NA
MW-31, north across 11th Ave	6/17/99	19.01 / 10.78	0.46	32.0	0.056	1.0	0.42	61.0	NA
MW-31, north across 11th Ave	5/17/99	19.01 / 11.11	0.45	NA	NA	NA	NA	NA	NA

* Includes Detection of Chloromethane, 2.0 ug/L. ES is 3.0, PAL is 0.3 ug/L

NS : No Standard ; NA Not Analyzed

Xylenes Sum of m, p, o Xylene

BOLD Exceeds NR 140 ES

ITALICS Exceed Preventive Action Limit Standard

TABLE 3 : GROUNDWATER CHEMISTRY RESULTS									
Former Plymouth Foundry Site, Grafton, WI									
GROUNDWATER									
SAMPLE I.D.	Date Sampled	Total Depth / Depth to Water	Natural Attenuation Parameters						
			Ft below grnd	Dissolved Oxygen	Sol. Sulfate	Nitrate plus Nitrite	Soluble Iron	Soluble Manganese	Methane
			(mg/l)	(mg/l)	(mg/l)	(mg/l)	(mg/l)	(ug/l)	(mg/l)
WI ADMIN CODE									
NR 140 E.S. / P.A.L.			NS	250 / 125	10 / 2	0.3 / 0.15	0.05 / 0.025	NS	NS
MW-32, south across 11th Ave.	6/17/99	20.44 / 10.35	0.24	21.0	0.058	1.0	0.33	72.0	NA
MW-32, south across 11th Ave.	5/17/99	20.44 / 10.85	0.25	NA	NA	NA	NA	NA	NA
OTHER LOCATIONS									
B-46, Parking Lot	12/26/01	NA / 12							
TW-6, Parking Lot	1/20/98	18.8 / 16.7	NA	NA	NA	NA	NA	NA	NA
TW-9, at former USTs, NE Corner	1/20/98	9.1 / 4.9	NA	NA	NA	NA	NA	NA	NA
TW-29, 60 ft E of NW Corner of Bld	10/1/98	16.5 / 16.4	NA	NA	NA	NA	NA	NA	NA
Trip Blank	6/17/99	NA	NA	NA	NA	NA	NA	NA	NA
Trip Blank	9/17/98	NA	NA	NA	NA	NA	NA	NA	NA
Trip Blank	10/1/98	NA	NA	NA	NA	NA	NA	NA	NA
Trip Blank	1/20/98	NA	NA	NA	NA	NA	NA	NA	NA

* Includes Detection of Chloromethane, 2.0 ug/L. ES is 3.0, PAL is 0.3 ug/L
 NS : No Standard ; NA Not Analyzed
 Xylenes Sum of m, p, o Xylene
 BOLD Exceeds NR 140 ES
 ITALICS Exceed Preventive Action Limit Standard

Former Plymouth Foundry Site, Grafton, Wisconsin				LABORATORY RESULTS									
SOIL SAMPLE I.D.	DEPTH (feet)	FIELD PID (s.u.)	Wet ?	Lead (mg/kg)	GRO (mg/kg)	DRO (mg/kg)	Petroleum Volatile Organic Compounds (ug/kg)						
							Benzene	Ethyl benzene	Toluene	Xylenes	Methyl-t-butyl ether	124-Trimethyl benzene	135-Trimethyl benzene
WI ADMIN CODE													
NR 720 Residual Contaminant Levels (potential leach to GW)				NS	100 / 250	100 / 250	5.5	2,900	1,500	4,100	NS	NS	NS
NR 746 Soil Screening Levels (free product potential)				NS	NS	NS	8,500	4,600	38,000	42,000	NS	83,000	11,000
NR 746 Direct Contact Levels (top 4')				50/500 +	NS	NS	1,100	NS	NS	NS	NS	NS	NS
1993 Investigation Results													
MW-1, West of Building	16-17.5	225	YES***	*** See Results in Saturated Soil Section Below									
MW-2, East of ASTs	11-12.5	0.0	NO	7.5	NA	NA	<1.0	<1.0	<1.0	<1.0	<1.0	<1.0	<1.0
MW-3, East of Building	8.5-10	0.0	NO	6.3	NA	NA	<1.0	<1.0	<1.0	<1.0	<1.0	<1.0	<1.0
B-4, At ASTs	3.5-5	218	NO	NA	190	3,590	NA	NA	NA	NA	NA	NA	NA
B-5, NE Corner Building	8.5-10	0.0	NO	NA	10.1	<10	NA	NA	NA	NA	NA	NA	NA
1998-1999 Investigation Results													
NORTH NEAR FOUNDRY BUILDING													
TW-6, Parking Lot	15-16	11.2	NO	NA	<5.0	<5.0	<30	<30	<30	<30	<30	<30	<30
TW-29, By Building on North	13-14	22.7	NO	NA	40.0	67.7	<30	<30	<30	30	<30	<30	<30
TW-9, Former USTs, NE Corner	6.5-7	0.0	YES	NA	<5.0	<5.0	<30	<30	<30	<30	<30	<30	<30
NORTHWEST AST's													
TW-7, at ASTs	9-10	4	YES	*** See Results in Saturated Soil Section Below									
MW-24, at ASTs	6-8	123	NO	NA	135	2,990	<28	32	<28	162	<28	740	475
MW-24, at, ASTs	15	48	NO	NA	81	2,730	<29	31	<29	79	<29	318	435
TW-16, West of ASTs	8-10	59	YES	*** See Results in Saturated Soil Section Below									
TW-10, East of ASTs	6-8	0.9	YES	NA	<5.0	<5.0	<29	<29	<29	<29	<29	<29	<29
TW-10, East of ASTs	13-14	0.4	YES	NA	<5.0	<5.0	<28	<28	<28	<28	<28	<28	<28
MW-26, SE of ASTs	9.0	0.0	NO	NA	<5.8	<5.8	<29	<29	<29	<29	<29	<29	<29
TW-11, South of ASTs	7.8	0.4	YES	NA	<5.0	<5.0	<29	<29	<29	<29	37*	<29	<29
TW-11, South of ASTs	13-14	0.6	YES	NA	<5.0	<5.0	<28	<28	<28	<28	<28	<28	<28
MW-25, South of ASTs	9.0	1.9	NO	NA	11.0	102	<28	<28	<28	<28	<28	<28	<28
TW-12, North of ASTs	6-8	4.0	YES	*** See Results in Saturated Soil Section Below									
MW-23, North of ASTs	7-9	NA	NO	NA	<5.7	<5.7	<28	<28	<28	<28	39*	<28	<28
WEST OF FOUNDRY BUILDING : 1998													
TW-13, NW Corner Bldg	9	3.5	NO	NA	105	50.8	<30	50	<30	221	<30	<30	<30
TW-13, NW Corner Bldg	16-18	184	YES	*** See Results in Saturated Soil Section Below									
MW-28, NW Corner Bldg	6-8	9.8	NO	NA	118	383	<29	<29	<29	56	<29	<29	<29
TW-14, South of MW-1	8-10	2.0	YES	NA	<5.0	<5.0	<30	<30	<30	<30	<30	<30	<30
MW-27, South of MW-1	9-10	1.3	NO	NA	<5.7	<5.7	<29	<29	<29	<29	<29	<29	<29
TW-15, North of MW-1	8-10	31	NO	NA	211	943	<31	207	<31	180	<31	1,906	1,548
TW-15, North of MW-1	15-15.5	28	NO	NA	246	1,440	<209	<209	<209	<418	<209	2,597	1,415
TW-15, North of MW-1	20-22	89	YES	*** See Results in Saturated Soil Section Below									
1' UST Removal Under Tank	5.6'	NA	NO	NA	NA	1,200	<100	130	<100	580	<100	2800	1600
TW-17, West of MW-1	13.5-14	29	NO	NA	74.4	878	<28	39	<26	36	<26	529	421
TW-17, West of MW-1	19.5-20	42	YES	*** See Results in Saturated Soil Section Below									

Former Plymouth Foundry Site, Grafton, Wisconsin				LABORATORY RESULTS											
SOIL SAMPLE I.D.	DEPTH (feet)	FIELD PID (s.u.)	Wet ?	Lead (mg/kg)	GRO (mg/kg)	DRO (mg/kg)	Petroleum Volatile Organic Compounds (ug/kg)								
							Benzene	Ethyl benzene	Toluene	Xylenes	Methyl-t-butyl ether	124-Trimethyl benzene	135-Trimethyl benzene		
WI ADMIN CODE															
NR 720 Residual Contaminant Levels (potential leach to GW)				NS	100 / 250	100 / 250	5.5	2,900	1,500	4,100	NS	NS	NS		
NR 746 Soil Screening Levels (free product potential)				NS	NS	NS	8,500	4,600	38,000	42,000	NS	83,000	11,000		
NR 746 Direct Contact Levels (top 4')				50/500 +	NS	NS	1,100	NS	NS	NS	NS	NS	NS		
EAST OF FOUNDRY BUILDING @ GAS UST : 1998 CLOSED BY COMMERCE APRIL 2000															
TW-18, South	5-7	0.0	NO ?	3.0	<5.7	NA	<29	<29	<29	<29	34*	<29	<29		
MW-19, West	5-7	0.0	NO	2.9	<5.7	NA	<28	<28	<28	<28	39*	<28	<28		
TW-8, At Gas Dispenser	5-6	353.5	NO	NA	1340	NA	<1,190	11769	2963	60274	<1,190	100,655	32,619		
TW-8, At Gas Dispenser	12.5-13.5	1.0	NO	NA	<5.0	NA	<30	<30	<30	<30	<30	<30	<30		
TW-20, East in ROW	4.5-5	0.0	NO	2.3	<5.7	NA	<28	<28	<28	<28	29*	<28	<28		
TW-20, East in ROW	9.0	2.3	NO	3.0	6.2	NA	<28	34	41	<28	28*	<28	<28		
TW-20, East in ROW	11-12	0.0	NO	2.7	<5.6	NA	<28	35	<28	<28	39*	<28	<28		
MW-22, North	9-10	0.7	NO	3.1	<5.8	NA	<29	<29	<29	<29	42*	<29	<29		
SUMMARY OF BORINGS ALONG FORMER RAILROAD SPUR : DECEMBER 2001															
B41	4-6	0	Moist	NA	NA	NA	<15.0	<20	<21	<62	<14	<20	<11		
B41	10-12	2.4	NO	NA	NA	NA	<15.0	<20	<21	<62	<14	<20	<11		
B42	6-8	0	Moist	NA	NA	NA	<15.0	<20	<21	<62	<14	<20	<11		
B42	10-12	0	NO?	NA	NA	NA	<15.0	<20	<21	<62	<14	<20	<11		
B43	6-8	1.0	Moist	NA	NA	NA	<15.0	<20	<21	<62	<14	<20	<11		
B43	10-12	15.5	NO	NA	NA	NA	<15.0	<20	<21	<62	<14	<20	<11		
B44	4-6	112	Moist	NA	NA	NA	<15.0	<20	<21	<62	<14	<20	<11		
B44	10-12	22.4	NO?	NA	NA	NA	<15.0	<20	<21	<62	<14	<20	<11		
B45	6-8	1.0	Moist	NA	NA	NA	<15.0	<20	<21	<62	<14	<20	<11		
B45	10-12	36.2	NO?	NA	NA	NA	<15.0	<20	<21	<62	<14	<20	<11		
SUMMARY OF BORINGS TO DEFINE EXTENT OF PETROLEUM CONTAMINATION : DECEMBER 2001															
B46	10-12	2.4	Moist	NA	NA	NA	NA	NA	NA	NA	NA	NA	NA		
B47	0-2	0	Moist	NA	NA	NA	NA	NA	NA	NA	NA	NA	NA		
B47	2-4	0	Moist	NA	NA	NA	NA	NA	NA	NA	NA	NA	NA		
B48	0-2	0	Moist	NA	NA	NA	<150	<200	<210	<620	<140	<200	<110		
B48	2-4	3.1	Moist	NA	NA	NA	<150	<200	<210	<620	<140	<200	<110		
SUMMARY OF SATURATED SOIL SAMPLES INFLUENCED BY PERCHED OR PERMANENT GROUNDWATER															
MW-1, West of Building	16-17.5	225	YES	NA	261	887	<15.0	21.6	<15.0	402	<15.0	2,140	148		
TW-7, at ASTs	9-10	4	YES	NA	38.7	96.6	<29	44	<29	184	<29	253	430		
TW-12, North of ASTs	6-8	4.0	YES	NA	267	472	<233	242	<233	434	<233	2,053	1,000		
TW-13, NW Corner Bldg	16-18	184	YES	NA	1,370	8,680	<2227	5,363	<2227	2,598	<2227	25,033	<2227		
TW-15, North of MW-1	20-22	89	YES	NA	804	3,020	<219	342	<219	1,789	<219	5,256	5,897		
TW-16, West of ASTs	8-10	59	YES	NA	234	838	<231	<231	<231	<462	<231	1,160	1,148		
TW-17, West of MW-1	19.5-20	42	YES	NA	394	3,040	<221	<221	<221	<442	<221	2,031	<221		

BOLD and BOX Exceeds NR 720 Generic Soil Standard
 * : MTBE present in methanol used to preserve samples
 NA : Not Analyzed
 NS : No Standard
 Xylenes is sum of m, p, and o xylene.
 ** : Generic Standard for Soils with Hydraulic Conductivity Greater than 10⁻⁶ cm / sec (100), and less than 10⁻⁸ (250)
 † : Direct Contact at Non-Industrial Site / Industrial Site
 †† Standard for Naphthalene from 1997 WDNR PAH Guidance, See PAH Clean-up Levels

Former Plymouth Foundry Site, Grafton, Wisconsin				LABORATORY RESULTS													
SOIL SAMPLE I.D.	DEPTH (feet)	FIELD PID (S.U.)	Wet ?	Detected Volatile Organic Compounds (ug/kg)													
				Styrene	i-Propyl benzene	N-Propyl benzene	i-Butyl benzene	s-Butyl benzene	N-Butyl benzene	1,2-Dichloro benzene	Naphth alene	p-Isopropyl toluene	1,1,1,2-Tetrachloro ethane	Tetrachloro ethene	Trichloro ethene		
WI ADMIN CODE																	
NR 720 Residual Contaminant Levels (potential leach to GW)				NS	NS	NS	NS	NS	NS	NS	NS	400 ++	NS	NS	NS	NS	
NR 746 Soil Screening Levels (free product potential)				NS	NS	NS	NS	NS	NS	NS	NS	2,700	NS	NS	NS	NS	
												20000/					
												100000/					
NR 746 Direct Contact Levels (top 4')				NS	NS	NS	NS	NS	NS	NS	NS	110000++	NS	NS	NS	NS	
1993 Investigation Results																	
MW-1, West of Building	16-17.5	225	YES***	*** See Results in Saturated Soil Section Below													
MW-2, East of ASTs	11-12.5	0.0	NO	<1.0	<1.0	<1.0	<1.0	<1.0	<1.0	<1.0	<1.0	<1.0	<1.0	<1.0	<1.0	<1.0	
MW-3, East of Building	8.5-10	0.0	NO	<1.0	<1.0	<1.0	<1.0	<1.0	<1.0	<1.0	<1.0	<1.0	<1.0	<1.0	<1.0	<1.0	
B-4, At ASTs	3.5-5	218	NO	NA	NA	NA	NA	NA	NA	NA	NA	NA	NA	NA	NA	NA	
B-5, NE Corner Building	8.5-10	0.0	NO	NA	NA	NA	NA	NA	NA	NA	NA	NA	NA	NA	NA	NA	
1998-1999 Investigation Results																	
NORTH NEAR FOUNDRY BUILDING																	
TW-6, Parking Lot	15-16	11.2	NO	NA	NA	NA	NA	NA	NA	NA	NA	NA	NA	NA	NA	NA	
TW-29, By Building on North	13-14	22.7	NO	NA	NA	NA	NA	NA	NA	NA	NA	NA	NA	NA	NA	NA	
TW-9, Former USTs, NE Corner	6.5-7	0.0	YES	NA	NA	NA	NA	NA	NA	NA	NA	NA	NA	NA	NA	NA	
NORTHWEST AST's																	
TW-7, at ASTs	9-10	4	YES	*** See Results in Saturated Soil Section Below													
MW-24, at ASTs	6-8	123	NO	NA	NA	NA	NA	NA	NA	NA	NA	397	NA	NA	NA	NA	
MW-24, at, ASTs	15	48	NO	NA	NA	NA	NA	NA	NA	NA	NA	178	NA	NA	NA	NA	
TW-18, West of ASTs	8-10	59	YES	*** See Results in Saturated Soil Section Below													
TW-10, East of ASTs	6-8	0.9	YES	NA	NA	NA	NA	NA	NA	NA	NA	NA	NA	NA	NA	NA	
TW-10, East of ASTs	13-14	0.4	YES	NA	NA	NA	NA	NA	NA	NA	NA	NA	NA	NA	NA	NA	
MW-26, SE of ASTs	9.0	0.0	NO	NA	NA	NA	NA	NA	NA	NA	NA	NA	NA	NA	NA	NA	
TW-11, South of ASTs	7-8	0.4	YES	NA	NA	NA	NA	NA	NA	NA	NA	NA	NA	NA	NA	NA	
TW-11, South of ASTs	13-14	0.6	YES	NA	NA	NA	NA	NA	NA	NA	NA	NA	NA	NA	NA	NA	
MW-25, South of ASTs	9.0	1.9	NO	NA	NA	NA	NA	NA	NA	NA	NA	NA	NA	NA	NA	NA	
TW-12, North of ASTs	6-8	4.0	YES	*** See Results in Saturated Soil Section Below													
MW-23, North of ASTs	7-9	NA	NO	NA	NA	NA	NA	NA	NA	NA	NA	NA	NA	NA	NA	NA	
WEST OF FOUNDRY BUILDING : 1998																	
TW-13, NW Corner Bldg	9	3.5	NO	NA	NA	NA	NA	NA	NA	NA	NA	NA	NA	NA	NA	NA	
TW-13, NW Corner Bldg	16-18	184	YES	*** See Results in Saturated Soil Section Below													
MW-28, NW Corner Bldg	6-8	9.8	NO	NA	NA	NA	NA	NA	NA	NA	NA	NA	NA	NA	NA	NA	
TW-14, South of MW-1	8-10	2.0	YES	NA	NA	NA	NA	NA	NA	NA	NA	<2	NA	NA	NA	NA	
MW-27, South of MW-1	9-10	1.3	NO	NA	NA	NA	NA	NA	NA	NA	NA	NA	NA	NA	NA	NA	
TW-15, North of MW-1	8-10	31	NO	NA	NA	NA	NA	NA	NA	NA	NA	NA	NA	NA	NA	NA	
TW-15, North of MW-1	15-15.5	28	NO	NA	NA	NA	NA	NA	NA	NA	NA	NA	NA	NA	NA	NA	
TW-15, North of MW-1	20-22	89	YES	*** See Results in Saturated Soil Section Below													
1: UST Removal Under Tank	5-6'	NA	NO	NA	NA	NA	NA	NA	NA	NA	NA	NA	NA	NA	NA	NA	
TW-17, West of MW-1	13.5-14	29	NO	NA	NA	NA	NA	NA	NA	NA	NA	NA	NA	NA	NA	NA	
TW-17, West of MW-1	19.5-20	42	YES	*** See Results in Saturated Soil Section Below													

SOIL				LABORATORY RESULTS													
SAMPLE I.D.	DEPTH (feet)	FIELD PID (s.u.)	Wet ?	Detected Volatile Organic Compounds (ug/kg)													
				Styrene	i-Propyl benzene	N-Propyl benzene	t-Butyl benzene	s-Butyl benzene	N-Butyl benzene	1,2-Dichloro benzene	Naphth alene	p-Isopropyl toluene	1,1,1,2-Tetrachloro ethane	Tetrachloro ethene	Trichloro ethene		
WI ADMIN CODE																	
NR 720 Residual Contaminant Levels (potential leach to GW)				NS	NS	NS	NS	NS	NS	NS	NS	400 ++	NS	NS	NS	NS	
NR 746 Soil Screening Levels (free product potential)				NS	NS	NS	NS	NS	NS	NS	NS	2,700	NS	NS	NS	NS	
NR 746 Direct Contact Levels (top 4')				NS	NS	NS	NS	NS	NS	NS	NS	20000/ 100000/ 110000++	NS	NS	NS	NS	
EAST OF FOUNDRY BUILDING @ GAS UST : 1998 CLOSED BY : COMMERCE APRIL 2000																	
TW-18, South	5-7	0.0	NO ?	NA	NA	NA	NA	NA	NA	NA	NA	NA	NA	NA	NA		
MW-19, West	5-7	0.0	NO	<28	<28	<28	<28	<28	<28	<28	<28	<28	<28	<28	NA		
TW-8, At Gas Dispenser	5-6	353.5	NO	NA	NA	NA	NA	NA	NA	NA	NA	NA	NA	<28	NA		
TW-8, At Gas Dispenser	12.5-13.5	1.0	NO	NA	NA	NA	NA	NA	NA	NA	NA	NA	NA	NA	NA		
TW-20, East in ROW	4.5-5	0.0	NO	NA	NA	NA	NA	NA	NA	NA	NA	NA	NA	NA	NA		
TW-20, East in ROW	9.0	2.3	NO	<28	207	336	<28	<28	<28	<28	<28	<28	NA	NA	NA		
TW-20, East in ROW	11-12	0.0	NO	<28	<28	<28	<28	<28	<28	<28	<28	<28	<28	<28	<28		
MW-22, North	9-10	0.7	NO	NA	NA	NA	NA	NA	NA	NA	<28	<28	<28	<28	<28		
SUMMARY OF BORINGS ALONG FORMER RAILROAD SPUR : DECEMBER 2001																	
B41	4-6	0	Moist	<19	<20	<15	<12	<21	<22	<14	<25	<21	<15	<22	<23		
B41	10-12	2.4	NO	<19	<20	<15	<12	<21	<22	<14	<25	<21	<15	<22	<23		
B42	6-8	0	Moist	<19	<20	<15	<12	<21	<22	<14	<25	<21	<15	<22	<23		
B42	10-12	0	NO?	<19	<20	<15	<12	<21	<22	<14	<25	<21	<15	<22	<23		
B43	6-8	1.0	Moist	<19	<20	<15	<12	<21	<22	<14	<25	<21	<15	<22	<23		
B43	10-12	15.5	NO	<19	<20	<15	<12	<21	<22	<14	<25	<21	<15	<22	<23		
B44	4-6	112	Moist	<19	<20	<15	<12	<21	<22	<14	<25	<21	<15	<22	<23		
B44	10-12	22.4	NO?	<19	<20	<15	<12	<21	<22	<14	<25	<21	<15	<22	<23		
B45	6-8	1.0	Moist	<19	<20	<15	<12	<21	<22	<14	<25	<21	<15	330	<23		
B45	10-12	36.2	NO?	<19	<20	<15	<12	<21	<22	<14	<25	<21	<15	2500	38		
SUMMARY OF BORINGS TO DEFINE EXTENT OF PETROLEUM CONTAMINATION : DECEMBER 2001																	
B46	10-12	2.4	Moist	NA	NA	NA	NA	NA	NA	NA	<18	NA	NA	NA	NA		
B47	0-2	0	Moist	NA	NA	NA	NA	NA	NA	NA	NA	NA	NA	NA	NA		
B47	2-4	0	Moist	<190	<200	<150	<120	<210	<220	<140	<250	<210	<150	<220	<230		
B48	0-2	0	Moist	NA	NA	NA	NA	NA	NA	NA	NA	NA	NA	NA	NA		
B48	2-4	3.1	Moist	<190	<200	<150	<120	<210	<220	<140	<250	<210	<150	<220	<230		
SUMMARY OF SATURATED SOIL SAMPLES INFLUENCED BY PERCHED OR PERMANENT GROUNDWATER																	
MW-1, West of Building	16-17.5	225	YES	165	426	205	1,110	368	1,480	<100	1,810	<100	<100	<100	<15		
TW-7, at ASTs	9-10	4	YES	NA	NA	NA	NA	NA	NA	NA	NA	NA	NA	NA	NA		
TW-12, North of ASTs	6-8	4.0	YES	NA	NA	NA	NA	NA	NA	NA	NA	NA	NA	NA	NA		
TW-13, NW Corner Bldg	16-18	184	YES	<2227	<2227	6,186	<2227	5,080	9,895	<2227	20,846	3,425	<2227	<2227	<2227		
TW-15, North of MW-1	20-22	89	YES	NA	NA	NA	NA	NA	NA	NA	NA	NA	NA	NA	NA		
TW-16, West of ASTs	8-10	59	YES	NA	NA	NA	NA	NA	NA	NA	NA	NA	NA	NA	NA		
TW-17, West of MW-1	19.5-20	42	YES	<221	<221	<221	<221	2,733	<221	<221	414	<221	<221	360	<221		
BOLD and BOX Exceeds NR 720 Genec Soil Standard																	
* : MTBE present in methanol used to preserve samples																	
NA : Not Analyzed																	
NS : No Standard																	
Xylenes is sum of m, p, and o xylene.																	
** : Generic Standard for Soils with Hydraulic Conductivity Greater than 10 ⁻⁶ cm / sec (100), and less than 10 ⁻⁹ (250)																	
* : Direct Contact at Non-Industrial Site / Industrial Site																	
** : Standard for Naphthalene from 1997 WDNR PAH Guidance, See PAH Clean-up Levels																	

Former Plymouth Foundry Site, Grafton, Wisconsin						LABORATORY RESULTS						
SOIL SAMPLE I.D.	DEPTH (feet)	FIELD PID (s.u.)	Wet ?	GRO (mg/kg) 100 / 250**	DRO (mg/kg) 100 / 250**	Detected Polynuclear Aromatic Hydrocarbons (ug/kg)						
						Benzo (b) Fluoranthene	Fluoranthene	Fluorene	1-Methyl Naphthalene	2-Methyl Naphthalene	Naphthalene	Phenanthrene
Groundwater Pathway						360,000	500,000	100,000	23,000	20,000	400	1,800
NR746 Soil Screening Levels (free product potential)						NS	NS	NS	NS	NS	2,700	NS
Direct Contact - Industrial						3,900	40,000,000	40,000,000	70,000,000	40,000,000	110,000	390,000
Direct Contact - Non-Industrial						88	600,000	600,000	1,100,000	600,000	20,000	18,000
Direct Contact or Inhalation - Non-Industrial if calculate site-specific exposure values from NR720 19											100,000	
1993 Investigation Results												
MW-1, West of Building	16-17.5	225	YES***	NA	NA	*** See Results in Saturated Soil Section Below						
MW-2, East of ASTs	11-12.5	0.0	NO	NA	NA	NA	NA	NA	NA	NA	<1.0	NA
MW-3, East of Building	8.5-10	0.0	NO	NA	NA	NA	NA	NA	NA	NA	<1.0	NA
B-4, At ASTs	3.5-5	218	NO	190	3,590	NA	NA	NA	NA	NA	NA	NA
B-5, NE Corner Building	8.5-10	0.0	NO	10.1	<10	NA	NA	NA	NA	NA	NA	NA
1998-1999 Investigation Results												
NORTH NEAR FOUNDRY BUILDING												
TW-6, Parking Lot	15-16	11.2	NO	<5.0	<5.0	NA	NA	NA	NA	NA	NA	NA
TW-29, By Building on North	13-14	22.7	NO	40.0	67.7	<1.2	<1.5	63.1	<2.4	72.7	<2	79.1
TW-9, Former USTs, NE Corner	6.5-7	0.0	YES	<5.0	<5.0	NA	NA	NA	NA	NA	NA	NA
NORTHWEST AST's												
TW-7, at ASTs	9-10	4	YES			*** See Results in Saturated Soil Section Below						
MW-24, at ASTs	6-8	123	NO	135	2,990	45.2	<1.5	169	2,490	2,110	397	<3.1
MW-24, at, ASTs	15	48	NO	81	2,730	46.0	<1.5	161	1,740	2,230	178	<3.1
TW-16, West of ASTs	8-10	59	YES			*** See Results in Saturated Soil Section Below						
TW-10, East of ASTs	6-8	0.9	YES	<5.0	<5.0	NA	NA	NA	NA	NA	NA	NA
TW-10, East of ASTs	13-14	0.4	YES	<5.0	<5.0	NA	NA	NA	NA	NA	NA	NA
MW-26, SE of ASTs	9.0	0.0	NO	<5.8	<5.8	NA	NA	NA	NA	NA	NA	NA
TW-11, South of ASTs	7-8	0.4	YES	<5.0	<5.0	NA	NA	NA	NA	NA	NA	NA
TW-11, South of ASTs	13-14	0.6	YES	<5.0	<5.0	NA	NA	NA	NA	NA	NA	NA
MW-25, South of ASTs	9.0	1.9	NO	11.0	102	NA	NA	NA	NA	NA	NA	NA
TW-12, North of ASTs	6-8	4.0	YES	NA	NA	*** See Results in Saturated Soil Section Below						
MW-23, North of ASTs	7-9	NA	NO	<5.7	<5.7	NA	NA	NA	NA	NA	NA	NA
WEST OF FOUNDRY BUILDING : 1998												
TW-13, NW Corner Bldg	9	3.5	NO	105	50.8	NA	NA	NA	NA	NA	NA	NA
TW-13, NW Corner Bldg	16-18	184	YES			*** See Results in Saturated Soil Section Below						
MW-28, NW Corner Bldg	6-8	9.8	NO	118	383	<1.2	<1.5	42.3	23.4	38.7	<2	85.6
TW-14, South of MW-1	8-10	2.0	YES	<5.0	<5.0	NA	NA	NA	NA	NA	NA	NA
MW-27, South of MW-1	9-10	1.3	NO	<5.7	<5.7	NA	NA	NA	NA	NA	NA	NA
TW-15, North of MW-1	8-10	31	NO	211	943	NA	NA	NA	NA	NA	NA	NA
TW-15, North of MW-1	15-15.5	28	NO	246	1,440	NA	NA	NA	NA	NA	NA	NA
TW-15, North of MW-1	20-22	89	YES			*** See Results in Saturated Soil Section Below						
1. UST Removal Under Tank	5-6	NA	NO	NA	1,200	NA	NA	NA	NA	NA	NA	NA
TW-17, West of MW-1	13.5-14	29	NO	74.4	878	NA	NA	NA	NA	NA	NA	NA
TW-17, West of MW-1	19.5-20	42	YES			*** See Results in Saturated Soil Section Below						

Former Plymouth Foundry Site, Grafton, Wisconsin				LABORATORY RESULTS									
SOIL SAMPLE I.D.	DEPTH (feet)	FIELD PID (s.u.)	Wet ?	GRO (mg/kg) 100 / 250**	DRO (mg/kg) 100 / 250**	Detected Polynuclear Aromatic Hydrocarbons (ug/kg)							
						Benzo (b) Fluoranthene	Fluoranthene	Fluorene	1-Methyl Naphthalene	2-Methyl Naphthalene	Naphthalene	Phenanthrene	
Groundwater Pathway													
NR746 Soil Screening Levels (free product potential)						360,000	500,000	100,000	23,000	20,000	400	1,800	
Direct Contact - Industrial						NS	NS	NS	NS	NS	2,700	NS	
Direct Contact - Non-Industrial						3,900	40,000,000	40,000,000	70,000,000	40,000,000	110,000	390,000	
Direct Contact or Inhalation - Non-Industrial if calculate site-specific exposure values from NR720 19						88	600,000	600,000	1,100,000	600,000	20,000	18,000	
EAST OF FOUNDRY BUILDING @ GAS UST : 1998 CLOSED BY COMMERCE APRIL 2000													
TW-18, South	5 - 7	0.0	NO ?	<5.7	NA	NA	NA	NA	NA	NA	NA	NA	
MW-19, West	5 - 7	0.0	NO	<5.7	NA	NA	NA	NA	NA	NA	NA	NA	
TW-8, At Gas Dispenser	5 - 6	353.5	NO	1340	NA	NA	NA	NA	NA	NA	<28	NA	
TW-8, At Gas Dispenser	12.5-13.5	1.0	NO	<5.0	NA	NA	NA	NA	NA	NA	NA	NA	
TW-20, East in ROW	4.5-5	0.0	NO	<5.7	NA	NA	NA	NA	NA	NA	NA	NA	
TW-20, East in ROW	9.0	2.3	NO	6.2	NA	NA	NA	NA	NA	NA	NA	NA	
TW-20, East in ROW	11 - 12	0.0	NO	<5.6	NA	NA	NA	NA	NA	NA	<2B	NA	
MW-22, North	9 - 10	0.7	NO	<5.8	NA	NA	NA	NA	NA	NA	<2B	NA	
December 2001 Investigation													
SUMMARY OF BORINGS ALONG FORMER RAILROAD SPUR : 2001													
B41	4-6	0	Moist	NA	NA	NA	NA	NA	NA	NA	NA	NA	
B41	10-12	2.4	YES	NA	NA	NA	NA	NA	NA	NA	NA	NA	
B42	6-8	0	Moist	NA	NA	NA	NA	NA	NA	NA	NA	NA	
B42	10-12	0	YES	NA	NA	NA	NA	NA	NA	NA	NA	NA	
B43	6-8	1.0	Moist	NA	NA	NA	NA	NA	NA	NA	NA	NA	
B43	10-12	15.5	YES	NA	NA	NA	NA	NA	NA	NA	NA	NA	
B44	4-6	112.0	Moist	NA	NA	NA	NA	NA	NA	NA	NA	NA	
B44	10-12	22.4	YES	NA	NA	NA	NA	NA	NA	NA	NA	NA	
B45	6-8	1.0	Moist	NA	NA	NA	NA	NA	NA	NA	NA	NA	
B45	10-12	36.2	YES	NA	NA	NA	NA	NA	NA	NA	NA	NA	
SUMMARY OF BORINGS TO DEFINE EXTENT OF PETROLEUM CONTAMINATION : 2001													
B46	10-12	2.4	Moist	NA	NA	<14	<15	<18	<18	<19	<18	<15	
B47	0-2	0	Moist	NA	NA	<14	24	<18	<18	<19	<18	<15	
B48	2-4	0	Moist	NA	NA	<28	<30	<36	<36	<38	<36	<30	
B48	0-2	0	Moist	NA	NA	<14	<15	<18	<18	<19	<18	<15	
B48	2-4	3.1	Moist	NA	NA	<14	<15	<18	<18	<19	<18	<15	
SUMMARY OF SATURATED SOIL SAMPLES INFLUENCED BY PERCHED OR PERMANENT GROUNDWATER													
MW-1, West of Building	16-17.5	225	YES	NA	NA	NA	NA	NA	NA	NA	1,810	NA	
TW-7, at ASTs	9-10	4	YES	38.7	96.6	NA	NA	NA	NA	NA	NA	NA	
TW-12, North of ASTs	6-8	4.0	YES	267	472	NA	NA	NA	NA	NA	NA	NA	
TW-13, NW Corner Bldg	16-18	184	YES	1,370	8,580	NA	NA	NA	NA	NA	20,846	NA	
TW-15, North of MW-1	20-22	89	YES	804	3,020	NA	NA	NA	NA	NA	NA	NA	
TW-16, West of ASTs	8-10	59	YES	234	838	NA	NA	NA	NA	NA	NA	NA	
TW-17, West of MW-1	19.5-20	42	YES	394	3,040	NA	NA	NA	NA	NA	NA	NA	
Notes:													
BOLD Exceeds Soil Standards													
NA : Not Analyzed													
NS : No Standard													
** : Generic Standard for Soils with Hydraulic Conductivity Greater than 10 ⁻⁶ cm / sec (100), and less than 10 ⁻⁶ (250)													
Generic Cleanup Levels from Soil Cleanup Levels for Polycyclic Aromatic Hydrocarbons (PAH) Interim Guidance, WDNR Publication RR-519-97, April 1997 (corrected)													

NORTH STREET

CONSTR FORMS
CHLORINATED
SOLVENT ERP SITE
#02-46-171750

APPROXIMATE
GROUNDWATER
FLOW DIRECTION

LEGEND

- MW-2 Existing NR-141 Monitoring Well
- TW-29 Temporary Well, Decommissioned
- B-5 Soil Boring
- B: <0.27 Groundwater Concentration (ug/l) of Benzene (select wells)
- TMB: 48 Sum of 1,2,4 and 1,3,5 Trimethylbenzene
- N: 75+- Naphthalene
- C: <0.032 Chrysene

+- Exceeds NR 140 Preventive Action Limit
 +- Exceeds NR 140 Enforcement Standard
 N.A. Not Analyzed

Most samples obtained June 17, 1999
 except data from Temp Wells and MW-1
 Obtained 1998 and B-46 Obtained Dec 2001

CONSTRUCTION
FORMS
(Former
ATACO
STEEL)

CONSTR FORMS
CHLORINATED
SOLVENT ERP SITE
#02-46-171750

APPROXIMATE
GROUNDWATER
FLOW DIRECTION

N

RAILROAD

APPROXIMATE
GROUNDWATER
FLOW DIRECTION

11TH AVENUE

gwchempetrol.skf

MOST RECENT GROUNDWATER CHEMISTRY RESULTS: 1998 - 1999

Project: Site Closure

Client: Former Plymouth Foundry Property, Grafton, WI



Scale: 1" = 60'

Figure: FIGURE 4

Author: K A E

Date: Jan 29, 2004

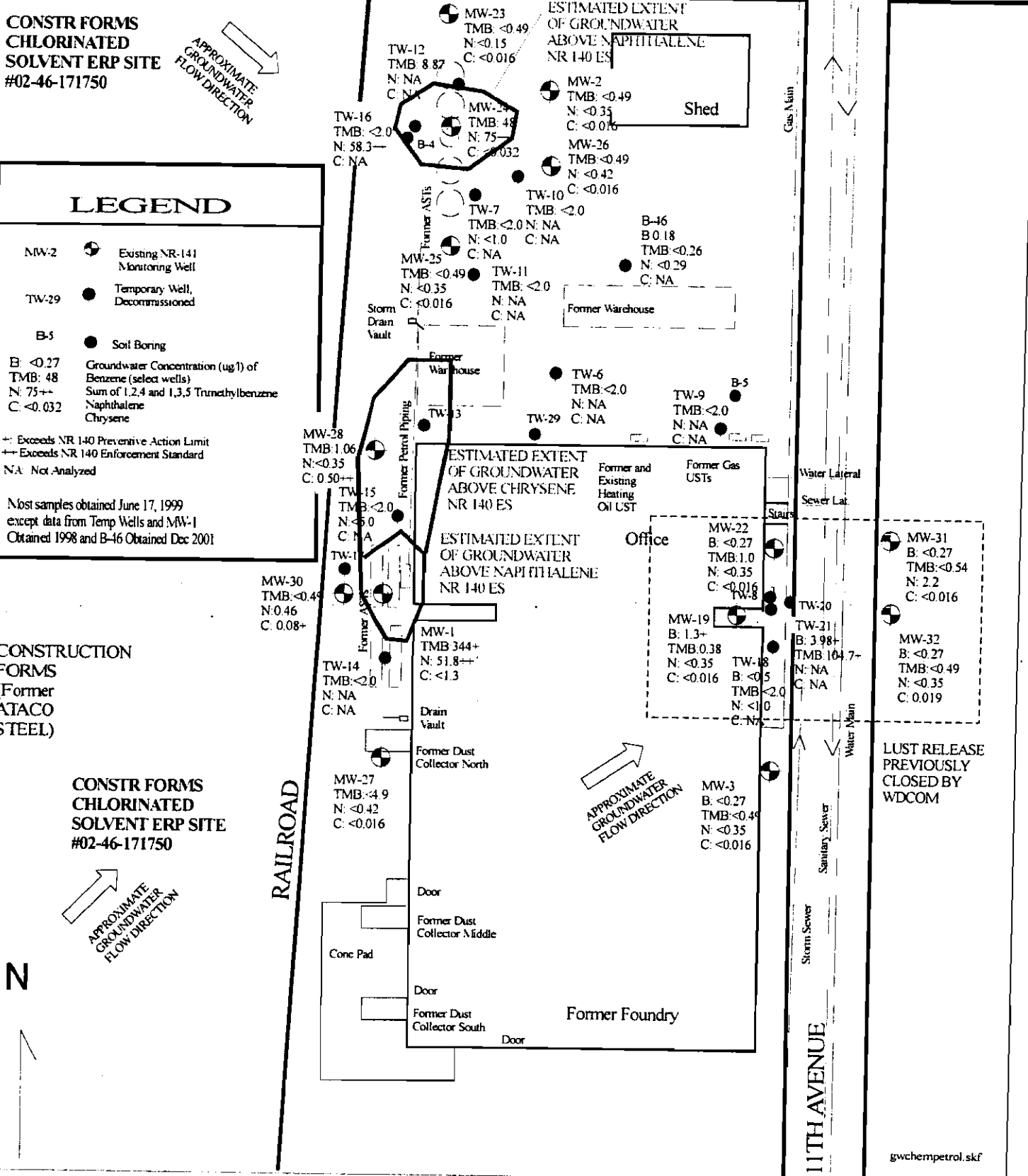

MW-31
B: <0.27
TMB: <0.54
N: 2.2
C: <0.016

MW-32
B: <0.27
TMB: <0.49
N: <0.35
C: 0.019

LUST RELEASE
PREVIOUSLY
CLOSED BY
WDCOM

TABLE 4 : SURVEY AND WATER LEVEL DATA

Former Plymouth Foundry Site, Grafton, WI

Survey Completed October 1, 1998

OBJECT	LOCATION	Instrument Reading (feet)	Datum Elevation (Ft MSL)	Eyepiece Elevation (ft MSL)	Object Elevation (ft MSL)	Well PVC Stickup (feet)	Water Level Measurements			Water Level Measurements		
							10/1/98			4/5/99		
							Ft below PVC Lip	Feet MSL	Feet below Grade	Ft below PVC Lip	Feet MSL	Feet below Grade
STATION ONE												
DATUM : Hydrant Ground	SE Corner 9th & North	2.16	766.32	768.48	766.32							
DATUM : Hydrant Top Nut	SE Corner 9th & North	5.33+	769.49	768.48								
MW-23 PVC	North of ASTs	6.24		768.48	762.24	-0.46	17.46	744.78	17.92	16.98	745.26	17.44
MW-23 Grnd		5.78		768.48	762.70							
MW-24 PVC	At ASTs	6.98		768.48	761.50	-0.35	16.81	744.69	17.16	16.46	745.04	16.81
MW-24 Grnd		6.63		768.48	761.85							
MW-25 PVC	South of ASTs	7.57		768.48	760.91	-0.49	16.26	744.65	16.75	15.85	745.06	16.34
MW-25 Grnd		7.08		768.48	761.40							
MW-26 PVC	SE of ASTs	8.87		768.48	759.61	-0.45	15.10	744.51	15.55	14.71	744.90	15.16
MW-26 Grnd		8.42		768.48	760.06							
MW-2 Grnd	NE of ASTs	5.51		768.48	762.97	2.36	18.43	744.54	16.07	17.99	744.98	15.63
MW-2 PVC		7.87		768.48	760.61							
MW-28 PVC	NW Corner Bldg	7.65		768.48	760.83	-0.42	16.20	744.63	16.62	15.29	745.54	15.71
MW-28 Grnd		7.23		768.48	761.25							
MW-1 PVC	At Fuel Pump Vault	4.63		768.48	763.85	2.42	19.21	744.64	16.79	18.81	745.04	16.39
MW-1 Grnd		7.05		768.48	761.43							
MW-30 PVC	West of Fuel Pump	7.24		768.48	761.24	-0.34	16.59	744.65	16.93	16.70	744.54	17.04
MW-30 Grnd		6.90		768.48	761.58							
MW-27 PVC	South of Fuel Pump	7.32		768.48	761.16	-0.35	16.56	744.60	16.91	16.15	745.01	16.50
MW-27 Grnd		6.97		768.48	761.51							
MW-29 PVC	By Bldg N Wall	3.88		768.48	764.60	3.55	19.94	744.66	16.39	19.84	744.76	16.29
MW-29 Grnd		7.43		768.48	761.05		DRY ?	DRY ?				
MW-9 PVC Lip	NE Corner Bldg	9.21		768.48	759.27	0.44	5.39	753.88	4.95			
MW-9 Ground		9.65		768.48	758.83		Perched					
allroad Rail at North Ave		4.03		768.48	764.45							
STATION TWO												
DATUM : Hydrant Ground	SE Corner 9th & North		769.49									
MW-2 PVC	Connect to Datum	0.80		763.77	762.97	2.38	18.43	744.54	16.05	17.99	744.98	15.61
MW-2 Grnd		3.18		763.77	760.59							
MW-26 PVC	Connect to Datum	4.14		763.77	759.63	-0.48	15.10	744.53	15.58	14.71	744.92	15.19
MW-26 Grnd		3.66		763.77	760.11							
MW-18 PVC	South of UST	2.79		763.77	760.98	2.16	8.10	752.88	5.94			
MW-18 Grnd		4.95		763.77	758.82		Perched					
MW-19 PVC	West of UST in Alley	4.86		763.77	758.91	-0.46	14.49	744.42	14.95	14.12	744.79	14.58
MW-19 Grnd		4.40		763.77	759.37							
MW-20 PVC	East of UST	5.32		763.77	758.45	0.02	13.60	744.85	13.58			
MW-20 Grnd		5.34		763.77	758.43		DRY ?					
MW-21 PVC	At UST	3.30		763.77	760.47	1.86	15.08	745.39	13.22			
MW-21 Grnd		5.16		763.77	758.61		DRY	DRY				
MW-22 PVC	North of UST	5.41		763.77	758.36	-0.24	14.10	744.26	14.34	13.74	744.62	13.98
MW-22 Grnd		5.17		763.77	758.60							
MW-3 PVC	Far South of UST	5.05		763.77	758.72	-0.17	14.28	744.44	14.45	13.84	744.88	14.01
MW-3 Grnd		4.88		763.77	758.89							
11th Street at TW-20	at Gutter	5.96		763.77	757.81							
Top of Conc Vault	At MW-19 (bldg Floor)	3.04		763.77	760.73							

Survey Eyepiece below Datum. Surveyed Ground, measured with tape to top of hydrant, corrected elevation of eyepiece using tape reading.

TABLE 4 : SURVEY AND WATER LEVEL DATA

Former Plymouth Foundry Site, Grafton, WI

OBJECT	LOCATION	Instrument Reading (feet)	Datum Elevation (ft MSL)	Eyepiece Elevation (ft MSL)	Object Elevation (ft MSL)	Well PVC Slickup (feet)	Water Level Measurements					
							1/20/98			2/5/98		
							Ft below PVC Lip	Feet MSL	Feet below Grade	Ft below PVC Lip	Feet MSL	Feet below Grade
STATION ONE												
DATUM : Ground	NE Corner Foundry Building	8.60	100.00	108.60	100.00							
TW-7 PVC Lip	At AST's	4.23		108.60	104.37	1.83						
TW-7 Ground		6.06		108.60	102.54		8.40	95.97	6.57	6.91	97.46	5.08
TW-16 PVC Lip	West of ASTs	1.93		108.60	106.67	2.78						
TW-16 Ground		4.71		108.60	103.89		9.71	96.96	6.93	8.72	97.95	5.94
TW-12 PVC Lip	North of ASTs	4.54		108.60	104.06	0.19						
TW-12 Ground		4.73		108.60	103.87		6.22	97.84	6.03	5.11	98.95	4.92
MW-2 PVC Lip	East of ASTs	4.05		108.60	104.55	2.27						
MW-2 Ground		6.32		108.60	102.28		18.95	85.60	16.68	18.89	85.66	16.62
TW-10 PVC Lip	East of ASTs	6.38		108.60	102.22	0.19						
TW-10 Ground		6.57		108.60	102.03		4.95	97.27	4.76	4.13	98.09	3.94
TW-11 PVC Lip	South of ASTs	5.33		108.60	103.27	1.01						
TW-11 Ground		6.34		108.60	102.26		7.80	95.47	6.79	6.81	96.46	5.80
TW-13 PVC Lip	NW Corner Foundry Building	2.98		108.60	105.62	2.62						
TW-13 Ground		5.60		108.60	103.00							
TW-15 PVC Lip	North of MW-1	4.65		108.60	103.95	1.05	DRY	DRY	DRY	DRY	DRY	DRY
TW-15 Ground		5.70		108.60	102.90		18.32	85.63	17.27	18.28	85.67	17.23
TW-17 Ground	West of MW-1	5.32		108.60	103.28							
MW-1 PVC Lip	West of Building	3.13		108.60	105.47	2.31						
MW-1 Ground		5.44		108.60	103.16		19.24	86.23	16.93	19.68	85.79	17.37
TW-14 PVC Lip	South of MW-1	5.35		108.60	103.25	0.12						
TW-14 Ground		5.47		108.60	103.13		6.33	96.92	6.21	4.91	98.34	4.79
TW-6 PVC Lip and Gro	Center Parking Lot	6.36		108.60	102.24		16.73	85.51	16.73			
TW-9 PVC Lip	Former USTs at NE Corner Foundry Building	7.59		108.60	101.01	0.50	5.89	95.12	5.39	16.69	85.55	16.69
										Removed		
TW-9 Ground		8.09		108.60	100.51							
STATION TWO												
DATUM	Ground at Foundry Building NE Corner	5.37		105.37								
TW-8 PVC Lip	Gas UST on East Side Building	4.96	100.00	105.37	760.00	0.20						
TW-8 Ground		5.16		105.37	100.21		14.42	85.99	14.22	13.90	86.51	13.70
				105.37			DRY	DRY	DRY	DRY	DRY	DRY
MW-3 Ground	East of Building	4.91		105.37	100.46							
MW-3 PVC Lip	East of Building	5.41	Estimated	105.37	99.96	-0.50	NA	NA	NA			
Survey Datum arbitrarily set to 100.00												
							NA	NA	NA	14.77	85.19	15.27

NORTH STREET

CONSTR FORMS
CHLORINATED
SOLVENT ERP SITE
#02-46-171750

APPROXIMATE
GROUNDWATER
FLOW DIRECTION
ON CFS SITE
OCT 29, 2002

LEGEND

- MW-1 (745.04) Existing NR-141 Monitoring Well and Groundwater Elevation (ft msl)
- TW-29 Previously Installed Temporary Well, Decommissioned
- B-5 Soil Boring
- GROUNDWATER FLOW DIRECTION
- * : Anomalous Value, Data not used for Contouring

CONSTR FORMS
CHLORINATED
SOLVENT ERP SITE
#02-46-171750

APPROXIMATE
GROUNDWATER
FLOW DIRECTION
ON CFS SITE
OCT 29, 2002

RAILROAD

11TH AVENUE

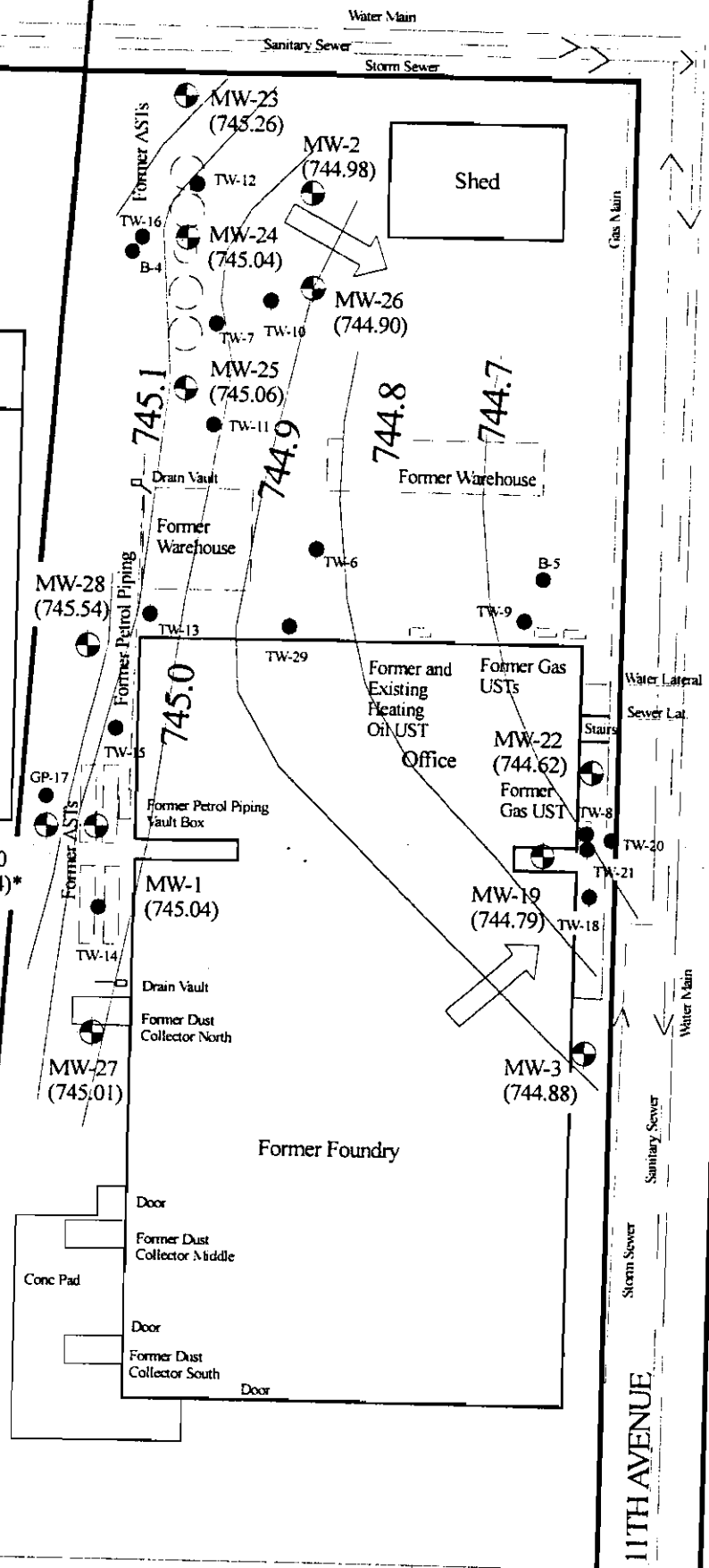

N

Gwflow499 skf

Title: Groundwater Flow Direction :
April 5, 1999

Project: Site Closure

Client: Former Plymouth Foundry Property, Grafton, WI

ALPHA TERRA
SCIENCE

1" = 60'

K A E

FIGURE 6

Feb 2, 2004

NORTH STREET

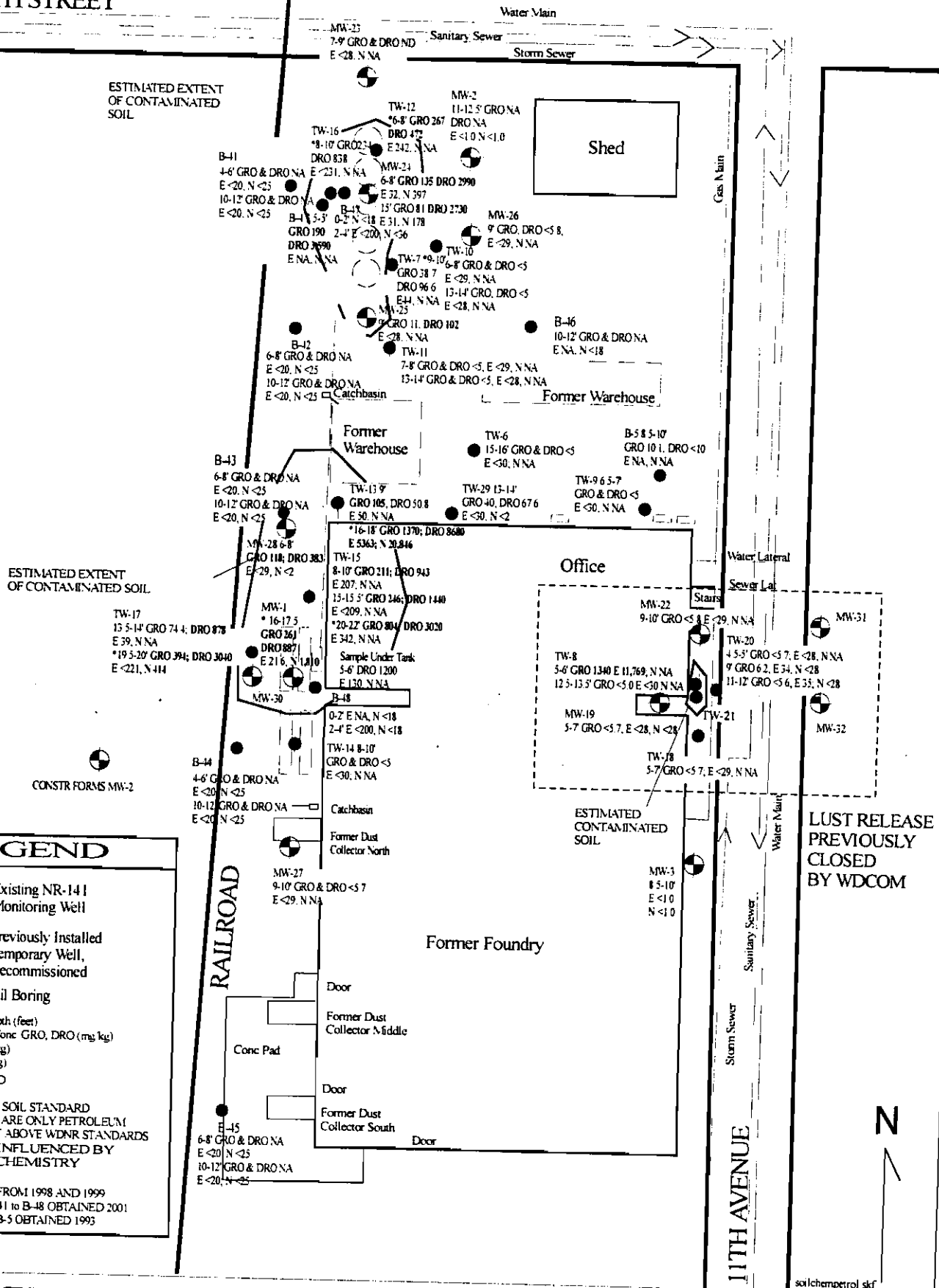

ESTIMATED EXTENT OF CONTAMINATED SOIL

ESTIMATED EXTENT OF CONTAMINATED SOIL

ESTIMATED CONTAMINATED SOIL

LUST RELEASE PREVIOUSLY CLOSED BY WDCOM

LEGEND

- MW-2 Existing NR-141 Monitoring Well
- TW-29 Previously Installed Temporary Well, Decommissioned
- B-5 Soil Boring

7.5-8' Soil Sample Depth (feet)
 GRO 98.6 DRO 25 Conc GRO, DRO (mg/kg)
 E Ethylbenzene (ug/kg)
 N Naphthalene (ug/kg)
 NA: NOT ANALYZED

BOLD EXCEEDS WDNR SOIL STANDARD
 MAPPED COMPOUNDS ARE ONLY PETROLEUM SUBSTANCES PRESENT ABOVE WDNR STANDARDS
 * SOIL SAMPLE INFLUENCED BY GROUNDWATER CHEMISTRY

CHEMISTRY RESULTS FROM 1998 AND 1999 EXCEPT SOIL FROM B-41 to B-48 OBTAINED 2001 AND MW-1 THROUGH B-5 OBTAINED 1993

SOIL CHEMISTRY RESULTS: PETROLEUM COMPOUNDS ABOVE NR 700 STANDARDS



Project: Site Closure Request

Client: Former Plymouth Foundry Property, Grafton, WI

Scale: 1" = 60'

Figure: FIGURE 3

Author: K A E

Date: January 29, 2004

NORTH STREET

CONSTR FORMS
CHLORINATED
SOLVENT ERP SITE
#02-46-171750

APPROXIMATE
GROUNDWATER
FLOW DIRECTION

LEGEND

- MW-2 Existing NR-141 Monitoring Well
 - TW-29 Previously Installed Temporary Well, Decommissioned
 - B-5 Soil Boring
- 7.5-8' Soil Sample Depth (feet)
PCE Conc. of Tetrachloroethene (ug/kg)
TCE Conc. of Trichloroethene (ug/kg)

NA NOT ANALYZED FOR
CHLORINATED VOCs

* SOIL SAMPLE LIKELY INFLUENCED
BY GROUNDWATER CHEMISTRY

CF MW-11

BORING LOCATIONS ON CF PROPERTY
ESTIMATED FROM GZA SITE PLAN

CF MW-2
11-13'
PCE 2,150
TCE 613

CFLD-10
6-8' PCE 4870 TCE <28
18-20' PCE 440000 TCE 2810

CFLD-6
10-12' PCE 1850 TCE <1390
12-15' PCE 195000 TCE <2870

CF MW-10D
4-6' PCE 514 TCE 76

CFLD-11
14-16' PCE 339 TCE 1120

CF MW-10
12-14' PCE 440000 TCE 30100

CFLD-9
14-16' PCE 3700 TCE 219
20-22' PCE 758000 TCE 15900

CFLD-7
8-10' PCE 423 TCE <32
16-18' PCE 6550 TCE 977

Various Earlier Borings Data Never Available
PCE 1360 TCE 86

CONSTR FORMS
CHLORINATED
SOLVENT ERP SITE
#02-46-171750

APPROXIMATE
GROUNDWATER
FLOW DIRECTION

RAILROAD

B-45
6-8' PCE 180 TCE <23
10-12' PCE 3800 TCE 1500

Conc Pad

Former Dust Collector South
Door
Former Dust Collector Middle
Door
Former Dust Collector North

Former Foundry

Sample Under Tank
NA

Office

MW-19 5-7' PCE <28, TCE <28
TW-8 NA
TW-21
TW-18 NA
MW-22 NA
TW-20 4-5-5' NA
9' PCE <28, TCE <28
11-12' PCE <28, TCE <28
MW-31
MW-32

Former Warehouse

Shed

Water Lateral

Sewer Lat

Starts

Water Main

Sanitary Sewer

Storm Sewer

Water Main

Sanitary Sewer

Storm Sewer

Water Main

Sanitary Sewer

Storm Sewer

Water Main

Sanitary Sewer

Storm Sewer

Water Main

Sanitary Sewer

Storm Sewer

Water Main

Sanitary Sewer

Storm Sewer

Water Main

Sanitary Sewer

Storm Sewer

LUST RELEASE
PREVIOUSLY
CLOSED
BY WDCOM

N

Soilchem VOCs.skf

SOIL CHEMISTRY RESULTS: CHLORINATED
VOLATILE ORGANIC COMPOUNDS

Project: Site Closure Request

Client: Former Plymouth Foundry Property, Grafton, WI



1" = 60'

FIGURE 5

KAE

January 29, 2004

NORTH STREET

LEGEND

- MW-2 Existing NR-141 Monitoring Well
- TW-29 Previously Installed Temporary Well, Decommissioned
- B-5 Soil Boring

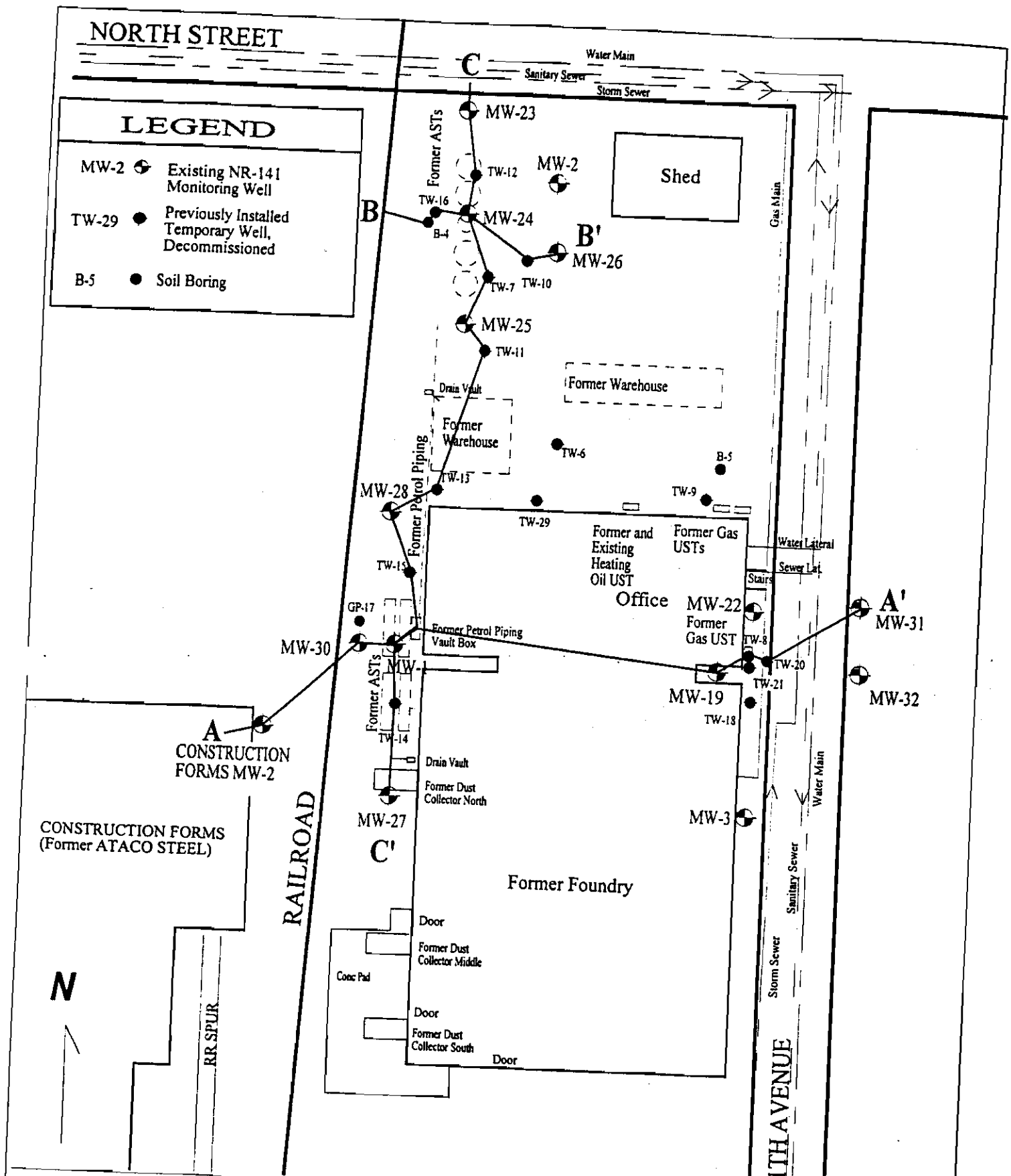

Title: **CROSS SECTION LOCATIONS**

Project: **Site Investigation**

Client: **Former Plymouth Foundry Property, Grafton, WI**



SCALE: 1" = 60'

DWG NO: **FIGURE 4A**

DRAWN BY: **KAE**

DATE: **Jan 5, 2000**

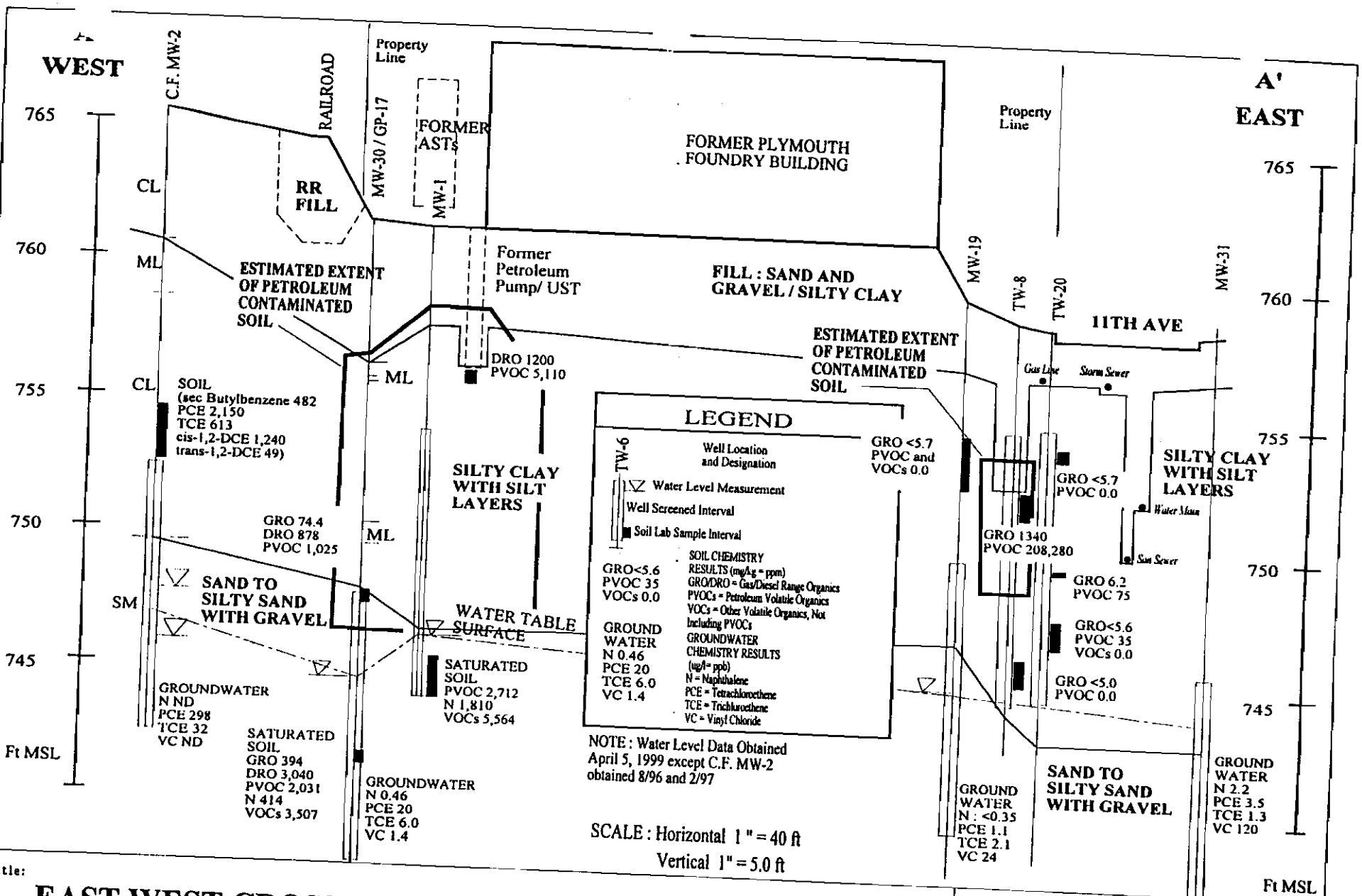

Title: **EAST WEST CROSS SECTION A-A'**

Project: **SITE INVESTIGATION**
Client: **FORMER PLYMOUTH FOUNDRY, GRAFTON, WI**



SCALE: See Figure
DRAWN BY: KAE
DATE: APR 5, 2000
DWG NO: FIGURE 5A

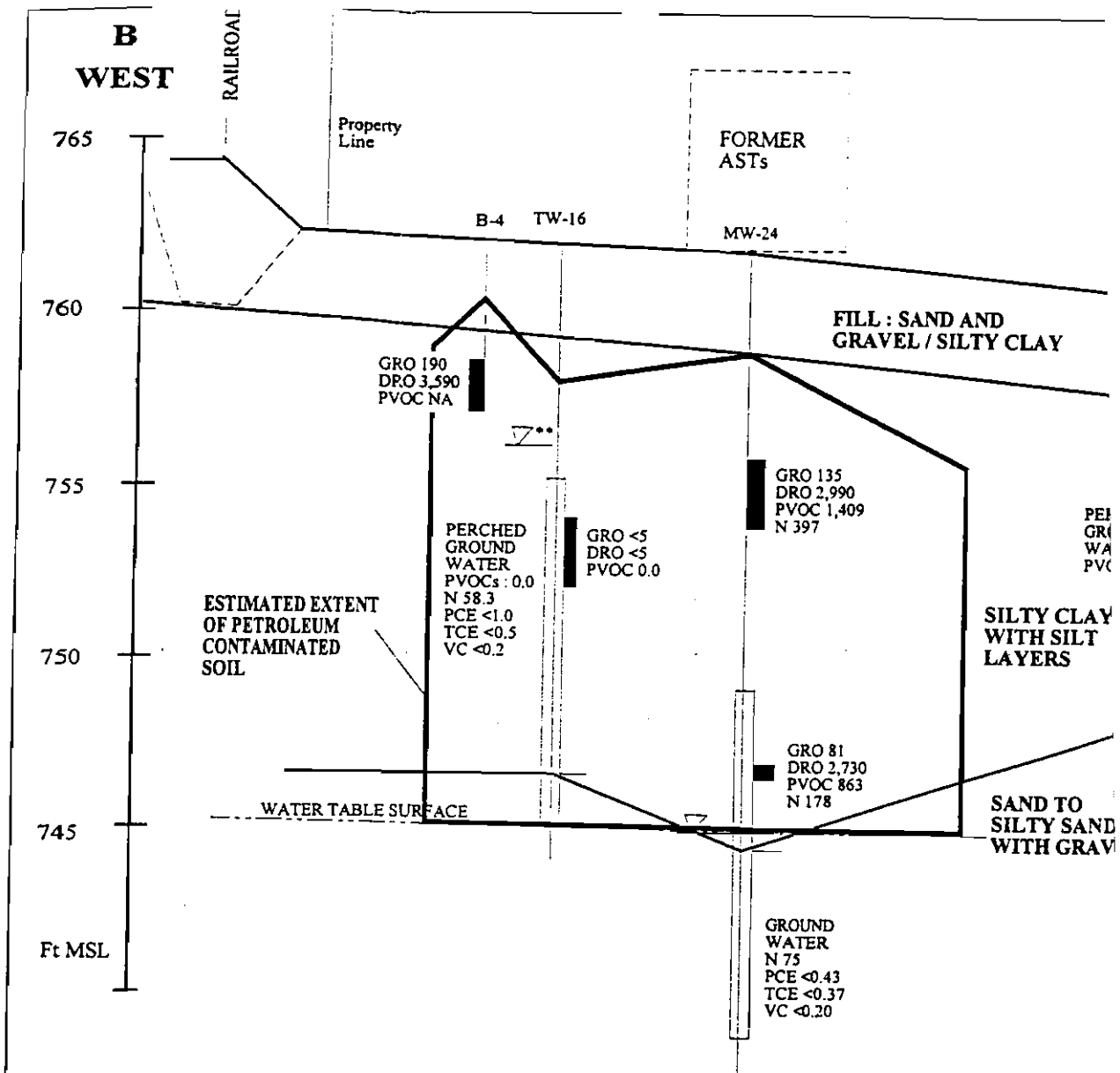

Title:

EAST WEST CROSS SECTION B-B'

Project:

SITE INVESTIGATION

Client:

FORMER PLYMOUTH FOUNDRY, GRAFTON, WI

C
NORTH

FORMER
ABOVEGROUND
TANKS

FORMER
WAREHOUSE

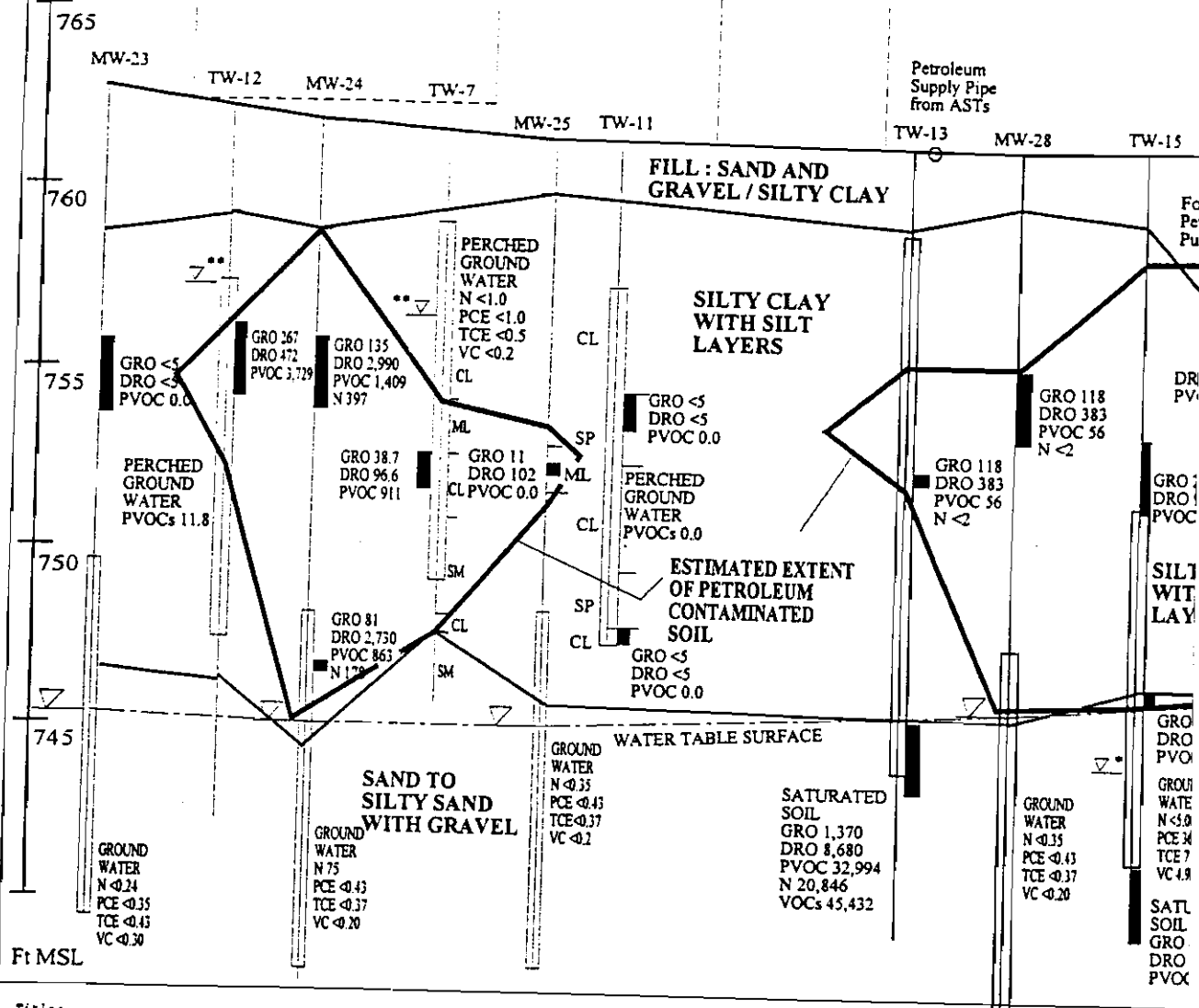

Title:
NORTH SOUTH CROSS SECTION C-C'

Project:
SITE INVESTIGATION

Client:
FORMER PLYMOUTH FOUNDRY, GRAFTON, WI

February 3, 2004

As the responsible party for the petroleum contamination at the former Plymouth Foundry property, I believe that the attached legal description for the property is within, or partially within, the contaminated site boundary.

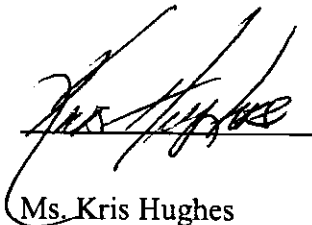
A handwritten signature in black ink, appearing to read "Kris Hughes", written over a horizontal line.

Ms. Kris Hughes

Estate of Richard Goldberg