



Excellence through experience™

709 Gillette St., Ste #3 ♦ La Crosse, WI 54603 ♦ 1-800-552-2932 ♦ Fax (608) 781-8893 Email: rona@metcohq.com ♦ www.metcohq.com

February 7, 2018

Erin Niemisto  
Wisconsin Department of Natural Resources  
3911 Fish Hatchery Road  
Fitchburg, WI 53711

**Subject:** River Bends Bar – Bid Deferment/Variance Request for excavation/disposal project, additional groundwater monitoring, and vapor assessment.  
BRRTS #: 03-23-198810, PECFA #: 53502-9519-98-A

Dear Ms. Niemisto,

At the request of the WDNR, a bid deferment/variance request (using Usual & Customary schedule of charges) is being submitted for site remediation, continued groundwater monitoring, and vapor assessment at the subject property located at N7298 County Highway X in Attica (Town of Brooklyn), Wisconsin. The cost estimate will include: [1] excavation and disposal of approximately 250 tons (see attached site layout map) of petroleum impacted soil, with up to 11 confirmation soil samples for PVOC and Naphthalene analysis, [2] abandonment of monitoring well MW-1, [3] drilling project to reinstall monitoring well MW-1, [4] surveying, [5] four rounds of post-excavation groundwater monitoring from all site monitoring wells (5) and two private wells for PVOC, Naphthalene, and Dissolved Lead analysis, [6] waste disposal (from drilling project), [7] install and sample 3 sub slab vapor sampling points from the on-site building, [8] Letter Report following Round 1, and [9] Groundwater Monitoring Report following Round 4. The cost estimate is as follows:

Soil Excavation/Disposal Project (commodity)	\$20,001.00 (variance)
Soil Excavation/Disposal Project (consulting)	\$ 1,530.00 (variance)
Soil Excavation/Disposal Mob/Demob (consulting)	\$ 831.92
Well Abandonment (MW-1)	\$ 51.14
Drilling Project (replace MW-1)	\$ 2,530.45
Surveying	\$ 110.15
Groundwater monitoring (4 quarterly events)	\$ 5,276.04
Laboratory Analysis	\$ 1,750.36
Waste Disposal (from drilling project)	\$ 683.24
Sub Slab Vapor Sampling (including analysis)	\$ 2,215.00 (variance)
Reports (2)	\$ 1,863.02
Change Order Request	\$ 381.78
Total	\$37,224.10

METCO is requesting a bid deferment/variance in the amount of \$37,224.10 to complete the above workscope. Upon state and client approval of the proposed workscope and budget, METCO will proceed with the project.

Attached are a map with proposed excavation area, excavation/disposal cost estimate (commodity), sub slab vapor sampling project cost estimate, and draft standardized invoice form for the above workscope as required. For further information regarding the site history and collected data, please see the *Site Investigation Report* dated 10/31/17 (METCO).

Should you have any questions, comments, or recommendations please contact me at our La Crosse office (608) 781-8879 or email at [jasonp@metcohq.com](mailto:jasonp@metcohq.com).

Sincerely,

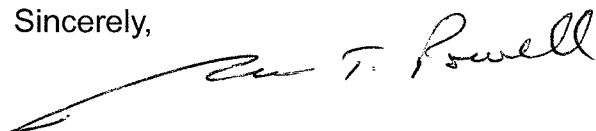
A handwritten signature in black ink that reads "Jason T. Powell". The signature is written in a cursive style with a long, sweeping underline that extends to the left.

Jason T. Powell  
Staff Scientist

Attachments

c: Tina Klitzke – Client

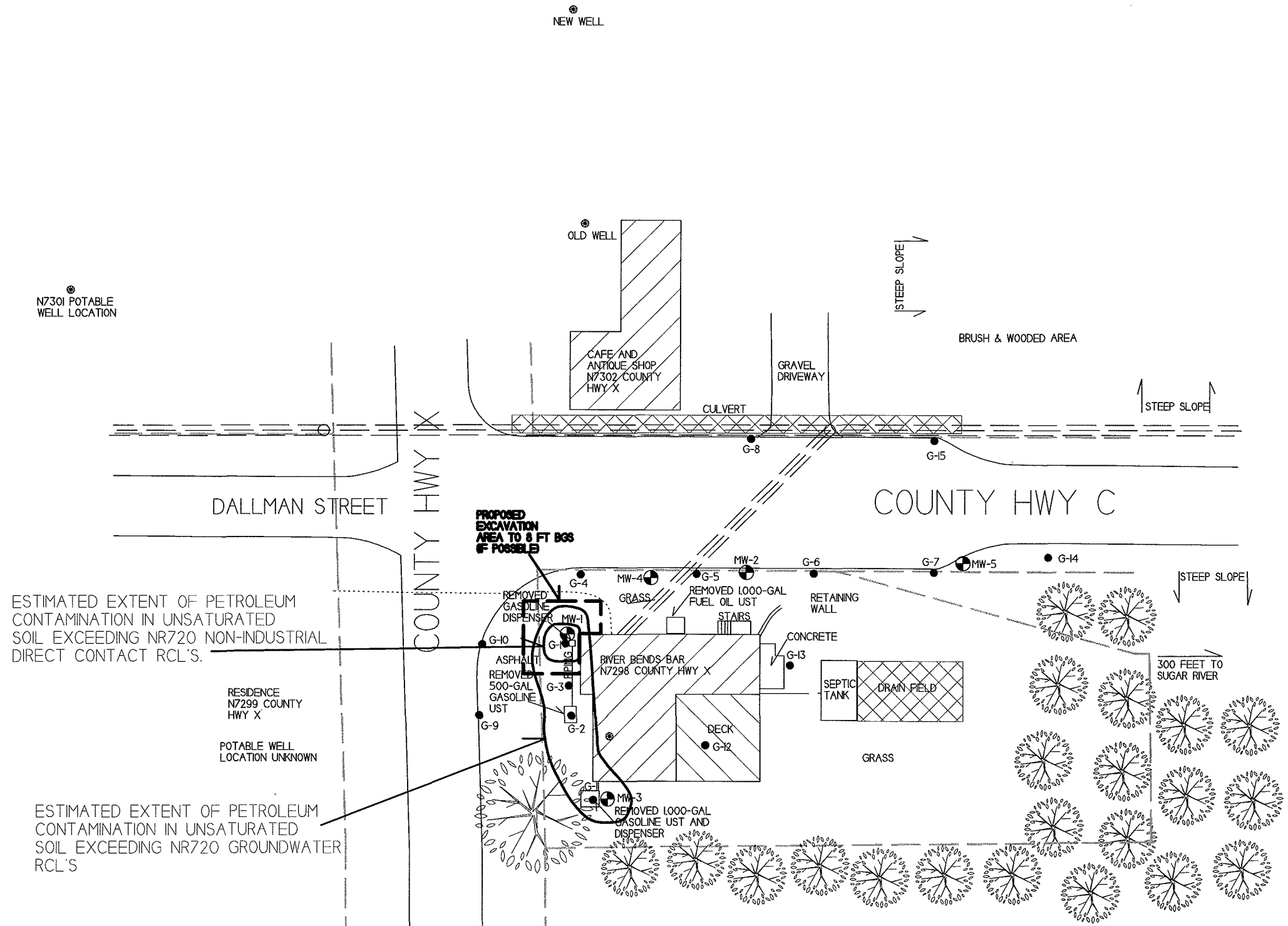

ESTIMATED EXTENT OF PETROLEUM CONTAMINATION IN UNSATURATED SOIL EXCEEDING NR720 NON-INDUSTRIAL DIRECT CONTACT RCL'S.

ESTIMATED EXTENT OF PETROLEUM CONTAMINATION IN UNSATURATED SOIL EXCEEDING NR720 GROUNDWATER RCL'S.

SOIL CONTAMINATION	
RIVER BENDS BAR	
ATTICA, WISCONSIN	
<p>709 Gillette Street, Suite 3 La Crosse, WI 54603 Tel: (608) 781-8879 Fax: (608) 781-8883</p>	<p>DRAWN BY: ED DATE: 07/17/2002</p>

NOTE: INFORMATION BASED ON AVAILABLE DATA. ACTUAL CONDITIONS MAY DIFFER

- - GEOPROBE BORING LOCATION
- ⊙ - POTABLE WELL LOCATION
- ⊕ - MONITORING WELL LOCATION

———— - OVERHEAD LINES  
 - - - - - TELEPHONE LINE  
 - · - · - SEPTIC LINE  
 - - - - - PROPERTY LINE

SCALE:  
1 INCH = 40 FEET

River Bend's Bar - Attiza, WI 250 ton

Mobilization	1	2200-	2200-
Excavate	250	5-	1250-
Haul	250	18-	4500-
Soil Disposal	250	30-	7500-
Fill	200	14	2800
Gravel	44	18	792-
Payroll & Compaction	250	3.50	875
			<hr/>
			29,001-

DKS  
2520 Wils St  
MELVILLE WI 54751  
Mark [Signature] 2-6-18

Sub-Slab Vapor Sampling Cost Estimate (Subcontracted)  
**Including TO-15 Analysis (PVOC+Naphthalene)**

Braun Intertec	\$1,963.40
SCS Engineers	\$1,875.00

METCO Project Management Costs for Sub-Slab Vapor Sampling (scheduling, preparation, coordination, and data reduction/analysis of vapor results): 4 hours @ \$85/hour = \$340

Commodity	\$1,875.00
Consulting	<u>\$ 340.00</u>
Total	\$2,215.00



# Usual and Customary Standardized Invoice #23

## January 2018- July 2018



RR-092A

TOTAL LAB CHARGES \$ 1,750.36 TASK 33 72 \$ 1,750.36 TASK 24 0 \$ -

MATRIX	REF CODE	REIMBURSABLE ANALYTE	UNITS	MAX COST	SAMPLES	TOTAL	MAX COST	SAMPLES	TOTAL
AIR	A1	Benzene	SAMPLE	\$ 44.94		\$ -			
AIR	A2	BETX	SAMPLE	\$ 49.46		\$ -			
AIR	A3	GRO	SAMPLE	\$ 46.10		\$ -			
AIR	A4	VOC's	SAMPLE	\$ 71.93		\$ -			
WATER	W1	GRO/PVOC	SAMPLE	\$ 29.19		\$ -			
WATER	W2	PVOC	SAMPLE	\$ 26.99		\$ -			
WATER	W3	PVOC + 1,2 DCA	SAMPLE	\$ 43.79		\$ -			
WATER	W4	PVOC + Naphthalene	SAMPLE	\$ 30.35	32	\$ 971.20			
WATER	W5	VOC	SAMPLE	\$ 71.93		\$ -			
WATER	W6	PAH	SAMPLE	\$ 72.98		\$ -			
WATER	W7	Lead	SAMPLE	\$ 12.39	28	\$ 346.92			
WATER	W8	Cadmium	SAMPLE	\$ 13.55		\$ -			
WATER	W9	Hardness	SAMPLE	\$ 12.39		\$ -			
WATER	W10	BOD, Total	SAMPLE	\$ 23.63		\$ -			
WATER	W11	Nitrate	SAMPLE	\$ 11.24		\$ -			
WATER	W12	Total Kjeldahl	SAMPLE	\$ 20.27		\$ -			
WATER	W13	Ammonia	SAMPLE	\$ 16.91		\$ -			
WATER	W14	Sulfate	SAMPLE	\$ 10.19		\$ -			
WATER	W15	Iron	SAMPLE	\$ 10.19		\$ -			
WATER	W16	Manganese	SAMPLE	\$ 10.19		\$ -			
WATER	W17	Alkalinity	SAMPLE	\$ 10.19		\$ -			
WATER	W18	methane	SAMPLE	\$ 46.10		\$ -			
WATER	W19	Phosphorous	SAMPLE	\$ 18.06		\$ -			
WATER	W20	VOC Method 524.2	SAMPLE	\$ 176.30		\$ -			
WATER	W21	EDB Method 504	SAMPLE	\$ 95.45		\$ -			
							MAX COST	SAMPLES	TOTAL
SOILS	S1	GRO	SAMPLE	\$ 24.78		\$ -	\$ 24.78		\$ -
SOILS	S2	DRO	SAMPLE	\$ 30.35		\$ -	\$ 30.35		\$ -
SOILS	S3	GRO/PVOC	SAMPLE	\$ 28.14		\$ -	\$ 28.14		\$ -
SOILS	S4	PVOC	SAMPLE	\$ 25.83		\$ -	\$ 25.83		\$ -
SOILS	S5	PVOC + 1,2 DCA + Naphthalene	SAMPLE	\$ 49.46		\$ -	\$ 49.46		\$ -
SOILS	S6	PVOC + Naphthalene	SAMPLE	\$ 36.02	12	\$ 432.24	\$ 36.02		\$ -
SOILS	S7	VOC	SAMPLE	\$ 71.93		\$ -	\$ 71.93		\$ -
SOILS	S8	SPLP Extraction VOC only	SAMPLE	\$ 50.61		\$ -	\$ 50.61		\$ -
SOILS	S9	PAH	SAMPLE	\$ 72.98		\$ -	\$ 72.98		\$ -
SOILS	S10	Lead	SAMPLE	\$ 12.39		\$ -	\$ 12.39		\$ -
SOILS	S11	Cadmium	SAMPLE	\$ 14.60		\$ -			
SOILS	S12	Free Liquid	SAMPLE	\$ 11.24		\$ -			
SOILS	S13	Flash Point	SAMPLE	\$ 25.83		\$ -			
SOILS	S14	Grain Size - dry	SAMPLE	\$ 42.74		\$ -			
SOILS	S15	Grain Size - wet	SAMPLE	\$ 57.33		\$ -			
SOILS	S16	Bulk Density	SAMPLE	\$ 13.55		\$ -			
SOILS	S17	Permeability	SAMPLE	\$ 41.58		\$ -			
SOILS	S18	Nitrogen as Total Kjeldahl	SAMPLE	\$ 20.27		\$ -			
SOILS	S19	Nitrogen as Ammonia	SAMPLE	\$ 16.91		\$ -			
SOILS	S20	% Organic Matter	SAMPLE	\$ 29.19		\$ -			
SOILS	S21	TOC as NPOC	SAMPLE	\$ 57.33		\$ -			
SOILS	S22	Soil Moisture Content	SAMPLE	\$ 6.83		\$ -			
SOILS	S23	Air Filled Porosity	SAMPLE	\$ 25.83		\$ -			
SOILS	S24	% Total Solids	SAMPLE	\$ 6.83		\$ -			
SOILS	S25	Field Capacity	SAMPLE	\$ 28.14		\$ -			
SOILS	S26	TCLP Lead	SAMPLE	\$ 83.16		\$ -			
SOILS	S27	Cation Exchange (Ca, MG, & K)	SAMPLE	\$ 26.99		\$ -			
SOILS	S28	TCLP Cadmium	SAMPLE	\$ 83.16		\$ -			
SOILS	S29	TCLP Benzene	SAMPLE	\$ 83.16		\$ -			
		Viscosity + Density							
LNAPL	LFPS01	Interfacial tension I (LNAPL/water [dyne/cm])	SAMPLE	\$ 561.33		\$ -			
		Interfacial tension II (LNAPL/air [dyne/cm])							
		Interfacial tension III (water/air [dyne/cm])							
<b>TASK 33 TOTAL</b>						<b>\$</b>	<b>1,750.36</b>		