

# GIS REGISTRY INFORMATION

SITE NAME: Open Pantry

BRRTS #: 03-13-000051

CLOSURE DATE: 31-May-02

STREET ADDRESS: 2022 Fordem Avenue

CITY: Madison

SOURCE PROPERTY GPS COORDINATES (meters in WTM91 projection):

X= Y=

CONTAMINATION IN RIGHT OF WAY:

☐ Yes ☒ No

## DOCUMENTS NEEDED:

Closure Letter, and any conditional closure letter issued	<input checked="" type="checkbox"/>
Copy of most recent deed, including legal description, for all affected properties	<input checked="" type="checkbox"/>
Certified survey map or relevant portion of the recorded plat map (if referenced in the legal description) for all affected properties	NA
County Parcel ID number, if used for county, for all affected properties	<input checked="" type="checkbox"/>
Location Map which outlines all properties within contaminated site boundaries in sufficient detail to permit the parcels to be located easily (8.5x14" if paper copy)	<input checked="" type="checkbox"/>
Detailed Site Map(s) for all affected properties, showing buildings, roads, property boundaries, contaminant sources, utility lines, monitoring wells and potable wells. (8.5x14", if paper copy)	<input checked="" type="checkbox"/>
Tables of Latest Groundwater Analytical Results	<input checked="" type="checkbox"/>
Isoconcentration map(s), if available from site investigation (SI) (8.5x14" if paper copy). The isoconcentration map should have flow direction and extent of contamination defined. If not available, include the following 2 types of maps:	<input checked="" type="checkbox"/>
Latest groundwater flow/monitoring well location map	NA
Latest extent of contaminant plume map	NA
Geologic cross-sections, if available from SI. (8.5x14" if paper copy)	NA
RP certified statement that legal descriptions are complete and accurate	NA
Copies of off-source notification letters (if applicable)	NA
Letter informing ROW owner of residual contamination (if applicable)	NA
Copy of (soil or land use) deed restriction(s) or deed notice if any required as a condition of closure.	NA

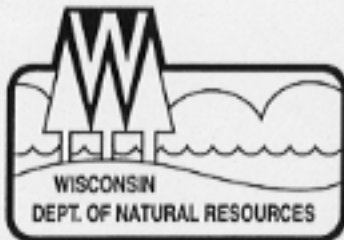

## State of Wisconsin \ DEPARTMENT OF NATURAL RESOURCES

Scott McCallum, Governor  
Darrell Bazzell, Secretary  
Ruthe E. Badger, Regional Director

South Central Region Headquarters  
3911 Fish Hatchery Road  
Fitchburg, Wisconsin 53711-5397  
Telephone 608-275-3266  
FAX 608-275-3338  
TTY 608-275-3231

May 31, 2002

File Ref.: 03-13-000051

Mr Vern Dahl  
Open Pantry Food Stores  
817 South Main Street  
Racine, WI 53403

SUBJECT: Final Case Closure By Closure Committee With Conditions Met  
Open Pantry, 2022 Fordem Avenue, Madison, WI  
WDNR BRRTS #03-13-000051

Dear Mr. Dahl:

On October 5, 1999 your site as described above was reviewed for closure by the South Central Regional Closure Committee. This committee reviews environmental remediation cases for compliance with state laws and standards to maintain consistency in the closure of these cases. On February 15, 2000, you were notified that the Closure Committee had granted conditional closure to this case.

The Department has received correspondence indicating that you have complied with the conditions of closure. Based on the correspondence and data provided, it appears that your has been remediated to Department standards in accordance with s. NR 726.05, Wis. Adm. Code. The Department considers this case closed and no further investigation, remediation or other action is required at this time.

Your site will be listed on the DNR Remediation and Redevelopment GIS Registry of Closed Remediation Sites. Information that was submitted with your closure request application will be included on the registry. To review the sites on the GIS Registry web page, visit <http://gomapout.dnr.state.wi.us/org/at/et/geo/gwur/index.htm>

If this is a PECFA site, section 101.143, Wis. Stats., requires that PECFA claimants seeking reimbursement of interest costs, for sites with petroleum contamination, submit a final reimbursement claim within 120 days after they receive a closure letter on their site. For claims not received by the PECFA Program within 120 days of the date of this letter, interest costs after 60 days of the date of this letter will not be eligible for PECFA reimbursement.

Please be aware that this case may be reopened pursuant to s. NR 726.09, Wis. Adm. Code, if additional information regarding site conditions indicates that contamination on or from the site poses a threat to public health, safety or welfare, or the environment.

The Department appreciates your efforts to restore the environment at this site. If you have any questions regarding this letter, please contact me at 608-275-3465.

Sincerely,

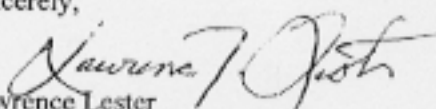
A handwritten signature in cursive script, appearing to read "Lawrence Lester".

Lawrence Lester  
Hydrogeologist  
Bureau for Remediation & Redevelopment

cc: Wright, Gannett Fleming

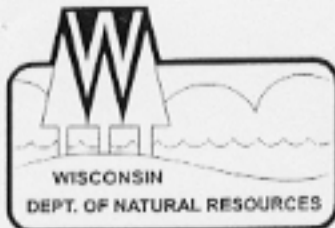

## State of Wisconsin \ DEPARTMENT OF NATURAL RESOURCES

Tommy G. Thompson, Governor  
George E. Meyer, Secretary  
Ruthe E. Badger, Regional Director

South Central Region Headquarters  
3911 Fish Hatchery Road  
Fitchburg, Wisconsin 53711-5397  
Telephone 608-275-3266  
FAX 608-275-3338  
TDD 608-275-3231

October 11, 1999

File Ref.: 03-13-000051

Mr Vern Dahl  
Open Pantry Food Stores  
817 South Main Street  
Racine, WI 53403

Subject: Conditional Site Closure, Open Pantry, 2022 Fordem Avenue, Madison

Dear Mr. Dahl:

On October 5, 1999 your request for closure of the above named site, was reviewed by the South Central Region Closure Committee. This committee reviews environmental remediation cases for compliance with state laws and standards to maintain consistency in the closure of these cases. The contamination at the site appears to have been remediated to the extent practicable under current site conditions. Your case will be granted closure under s. NR 726.05, Wis. Adm. Code, when the following conditions have been met.

MONITORING WELL ABANDONMENT The groundwater quality monitoring wells at the site must be properly abandoned in compliance with ch. NR 141, Wis. Adm. Code. Documentation of well abandonment must be submitted to us on forms provided by the Department.

GROUNDWATER USE RESTRICTION The closure committee has required that a groundwater use restriction be prepared and recorded at the county register of deeds office to address the issue of remaining groundwater contamination associated with the site. The purpose of this document is to restrict the use of groundwater that may be contaminated in the vicinity of the site.

To assist us in the preparation of the groundwater use restriction document, you must submit a copy of the property deed to me within 30 days of the date of this letter. This information will be used to prepare a draft groundwater use restriction that will be sent to you for review. If you approve of its content, you will sign it, have it recorded by the Dane County Register of Deeds, and submit a copy with the proof of filing to the Department.

The groundwater use restriction is an option that the Department can offer to you in order to close this site. If you choose not to accept this option, you may perform additional investigation and cleanup of the remaining contamination. Note that this additional work may not be eligible for reimbursement through the Petroleum Environmental Cleanup Fund Award (PECFA) Program. You should contact the Department of Commerce to determine eligibility of the additional work for reimbursement.

When the above conditions have been met, a final case closure letter will be sent to you. Please be aware that the site case may be reopened pursuant to s. NR 726.09, Wis. Adm. Code, if additional information regarding site conditions indicates that contamination on or from the sites poses a threat to public health, safety, or welfare or to the environment.



NOTICE OF REMAINING SOIL CONTAMINATION As indicated in the information submitted to the Department, residual soil contamination remains in the subsurface at the property. If site conditions change in the future and this residual contaminated soil is excavated, the property owner at that time will be required to sample and analyze the excavated soil in order to determine whether the contamination still remains. Depending upon the results of that characterization, the owner may also have to properly store, treat, or dispose of any excavated materials, and/or take special precautions during excavation activities to prevent a direct contact threat to humans.

Your efforts in the restoration of the environment are greatly appreciated. If you have any questions regarding this letter please contact me at the above address or by telephone at 608-275-3465.

Sincerely,

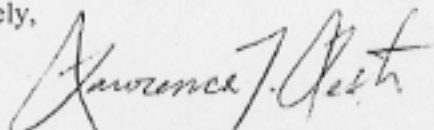
A handwritten signature in cursive script, appearing to read "Lawrence J. Lester".

Lawrence Lester, Hydrogeologist  
Remediation and Redevelopment

Cc: Wright, Gannett Fleming

DANE COUNTY  
REGISTER OF DEEDS

3212824

05-12-2000 5:19 PM

Trans. Fee

Rec. Fee 18.00  
Pages 5

001048

Recording Area

Name and Return Address

OPEN PANTRY  
VERN DAHL  
817 SO MAIN ST  
RACINE WI 53403

0709-121-9930-9  
Parcel Identification Number (PIN)

Document Number

GROUNDWATER USE RESTRICTION

Declaration of Restrictions

In Re: See attached Legal description of the property  
Labeled "Attachment A", which is incorporated by  
reference.

STATE OF WISCONSIN )  
 ) ss  
COUNTY OF DANE )

WHEREAS, Donald V. Harbort, Christ T. Harbort and Joan  
Marie Harbort Gink are the owners of the above-described  
property.

WHEREAS, one or more petroleum discharges have occurred on this property. Benzene  
and Ethylbenzene-contaminated groundwater above ch. NR 140 Wis. Adm. Code  
enforcement standards existed on this property at monitoring well MW-14 from January  
1, 1992 through August 13, 1999 (on August 13, 1999 the Benzene concentration was  
reported at 245 ppb and the Ethylbenzene concentration was reported at 1,730 ppb). The  
location of this monitoring well is depicted on "Attachment B" which is attached and  
incorporated by reference.

WHEREAS, it is the desire and intention of the property owner to impose on the property  
restrictions which will make it unnecessary to conduct further groundwater or soil  
remediation activities on the property at the present time.

WHEREAS, natural attenuation has been approved by the Department of Natural  
Resources to remediate groundwater contamination exceeding ch. NR 140 Wis. Adm.  
Code groundwater standards within the boundaries of this property.

WHEREAS, construction of wells where the water quality does not comply with drinking  
water standards in ch. NR 809 Wis. Adm. Code is restricted by chs. NR 811 and NR 812,  
Wis. Adm. Code. Special well construction standards or water treatment requirements, or  
both, or well construction prohibitions may apply.

MAR 24 2000

MAR 19 2000

5/18

NOW THEREFORE, the owner hereby declares that all of the property described above is held and shall be held, conveyed or encumbered, leased, rented, used, occupied and improved subject to the following limitation and restrictions:

Anyone who proposes to construct or reconstruct a well on this property is required to contact the Department of Natural Resources' Bureau of Drinking Water and Groundwater, or its successor agency, to determine what specific requirements are applicable, prior to constructing or reconstructing a well on this property. No well may be constructed on this property unless applicable requirements are met.

If construction is proposed on this property that will require dewatering, or if groundwater is to be otherwise extracted from this property, while this groundwater use restriction is in effect, the groundwater shall be sampled and analyzed for contaminants that were previously detected on the property and any extracted groundwater shall be managed in compliance with applicable statutes and rules.

This restriction is hereby declared to be a covenant running with the land and shall be fully binding upon all persons acquiring the above-described property whether by descent, devise, purchase or otherwise. This restriction benefits and is enforceable by the Wisconsin Department of Natural Resources, its successors or assigns. The Department, its successors or assigns, may initiate proceedings at law or in equity against any person or persons who violate or are proposing to violate this covenant, to prevent the proposed violation or to recover damages for such violation.

Any person who is or becomes owner of the property described above may request that the Wisconsin Department of Natural Resources or its successor issue a determination that one or more of the restrictions set forth in this covenant is no longer required. Upon the receipt of such a request, the Wisconsin Department of Natural Resources shall determine whether or not the restrictions contained herein can be extinguished. If the Department determines that the restrictions can be extinguished, an affidavit, attached to a copy of the Department's written determination, may be recorded to give notice that this deed restriction, or portions of this deed restriction, are no longer binding.

IN WITNESS WHEREOF, the owner of the property has executed this Declaration of Restrictions, this 6 day of MAR, 2000.

Signature: Joan Marie Harbort Gink  
 Printed Name: JOAN MARIE HARBORT GINK

Subscribed and sworn to before me  
 this 6 day of MAR, 2000.

Margaret Chase  
 Notary Public, State of WI  
 My commission 4-15-01

Signature: Donald Harbort  
 Printed Name: Donald Harbort

Subscribed and sworn to before me  
 this 9th day of March, 2000.

Nancy Hillstad  
 Notary Public, State of Wisconsin  
 My commission 12/23/03

Signature: Chris T. Harbort  
 Printed Name: CHRIS T. Harbort

Subscribed and sworn to before me  
 this 13th day of March, 2000.

Janet McCoskey  
 Notary Public, State of Wisconsin  
 My commission 3/11/2001

This document was drafted by the Wisconsin Department of Natural Resources.



"Attachment A"

001051

1st Easterly 185 feet of Part of the Southeast  $\frac{1}{4}$  of the Northeast  $\frac{1}{4}$  of Section 12, Township 7 North, Range 9 East (Town of Madison), described more fully as follows: Beginning at a point on the town line 647.8 feet North of the East quarter corner of Section 12, Township 7 North, Range 9 East, thence North  $74^{\circ}$  West 707 feet to a point in the center line of road 521.3 feet South  $25^{\circ} 30'$  West from an iron stake at the intersection of said center line and the North line of the Southeast  $\frac{1}{4}$  of the Northeast  $\frac{1}{4}$  of said Section; thence South  $25^{\circ} 30'$  West along center line of road 120.4 feet; thence South  $74^{\circ}$  East 761 Feet to the Town line, thence North on said line 123.6 feet to place of beginning, except that part described in the Warranty Deed recorded in Vol. 397 of Deeds, page 184, #622166.

001052

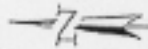

odor associated  
FIGURE 2

# "Attachment B"

## LEGEND

- Groundwater Extraction Well
- Monitoring Well
- Soil Boring
- Personnel
- Vacuum Extraction Well
- Flash-Mount Vent Pipe Cover
- Manhole Cover
- Light Standard On 24" High Base
- Storm Sewer
- Vacuum Extraction Manifold
- Vacuum Extraction Pipe in Trench
- Groundwater Treatment Line
- Pump Island
- Underground Storage Tank

MW-1 (05.01)  
 MW-2 (05.02)  
 MW-3 (05.03)  
 MW-4 (05.04)  
 MW-5 (05.05)  
 MW-6 (05.06)  
 MW-7 (05.07)  
 MW-8 (05.08)  
 MW-9 (05.09)  
 MW-10 (05.10)  
 MW-11 (05.11)  
 MW-12 (05.12)  
 MW-13 (05.13)  
 MW-14 (05.14)  
 MW-15 (05.15)  
 MW-16 (05.16)  
 MW-17 (05.17)  
 MW-18 (05.18)  
 MW-19 (05.19)  
 MW-20 (05.20)  
 MW-21 (05.21)  
 MW-22 (05.22)  
 MW-23 (05.23)  
 MW-24 (05.24)  
 MW-25 (05.25)  
 MW-26 (05.26)  
 MW-27 (05.27)  
 MW-28 (05.28)  
 MW-29 (05.29)  
 MW-30 (05.30)  
 MW-31 (05.31)  
 MW-32 (05.32)  
 MW-33 (05.33)  
 MW-34 (05.34)  
 MW-35 (05.35)  
 MW-36 (05.36)  
 MW-37 (05.37)  
 MW-38 (05.38)  
 MW-39 (05.39)  
 MW-40 (05.40)  
 MW-41 (05.41)  
 MW-42 (05.42)  
 MW-43 (05.43)  
 MW-44 (05.44)  
 MW-45 (05.45)  
 MW-46 (05.46)  
 MW-47 (05.47)  
 MW-48 (05.48)  
 MW-49 (05.49)  
 MW-50 (05.50)  
 MW-51 (05.51)  
 MW-52 (05.52)  
 MW-53 (05.53)  
 MW-54 (05.54)  
 MW-55 (05.55)  
 MW-56 (05.56)  
 MW-57 (05.57)  
 MW-58 (05.58)  
 MW-59 (05.59)  
 MW-60 (05.60)  
 MW-61 (05.61)  
 MW-62 (05.62)  
 MW-63 (05.63)  
 MW-64 (05.64)  
 MW-65 (05.65)  
 MW-66 (05.66)  
 MW-67 (05.67)  
 MW-68 (05.68)  
 MW-69 (05.69)  
 MW-70 (05.70)  
 MW-71 (05.71)  
 MW-72 (05.72)  
 MW-73 (05.73)  
 MW-74 (05.74)  
 MW-75 (05.75)  
 MW-76 (05.76)  
 MW-77 (05.77)  
 MW-78 (05.78)  
 MW-79 (05.79)  
 MW-80 (05.80)  
 MW-81 (05.81)  
 MW-82 (05.82)  
 MW-83 (05.83)  
 MW-84 (05.84)  
 MW-85 (05.85)  
 MW-86 (05.86)  
 MW-87 (05.87)  
 MW-88 (05.88)  
 MW-89 (05.89)  
 MW-90 (05.90)  
 MW-91 (05.91)  
 MW-92 (05.92)  
 MW-93 (05.93)  
 MW-94 (05.94)  
 MW-95 (05.95)  
 MW-96 (05.96)  
 MW-97 (05.97)  
 MW-98 (05.98)  
 MW-99 (05.99)  
 MW-100 (06.00)

0 20  
Scale in Feet

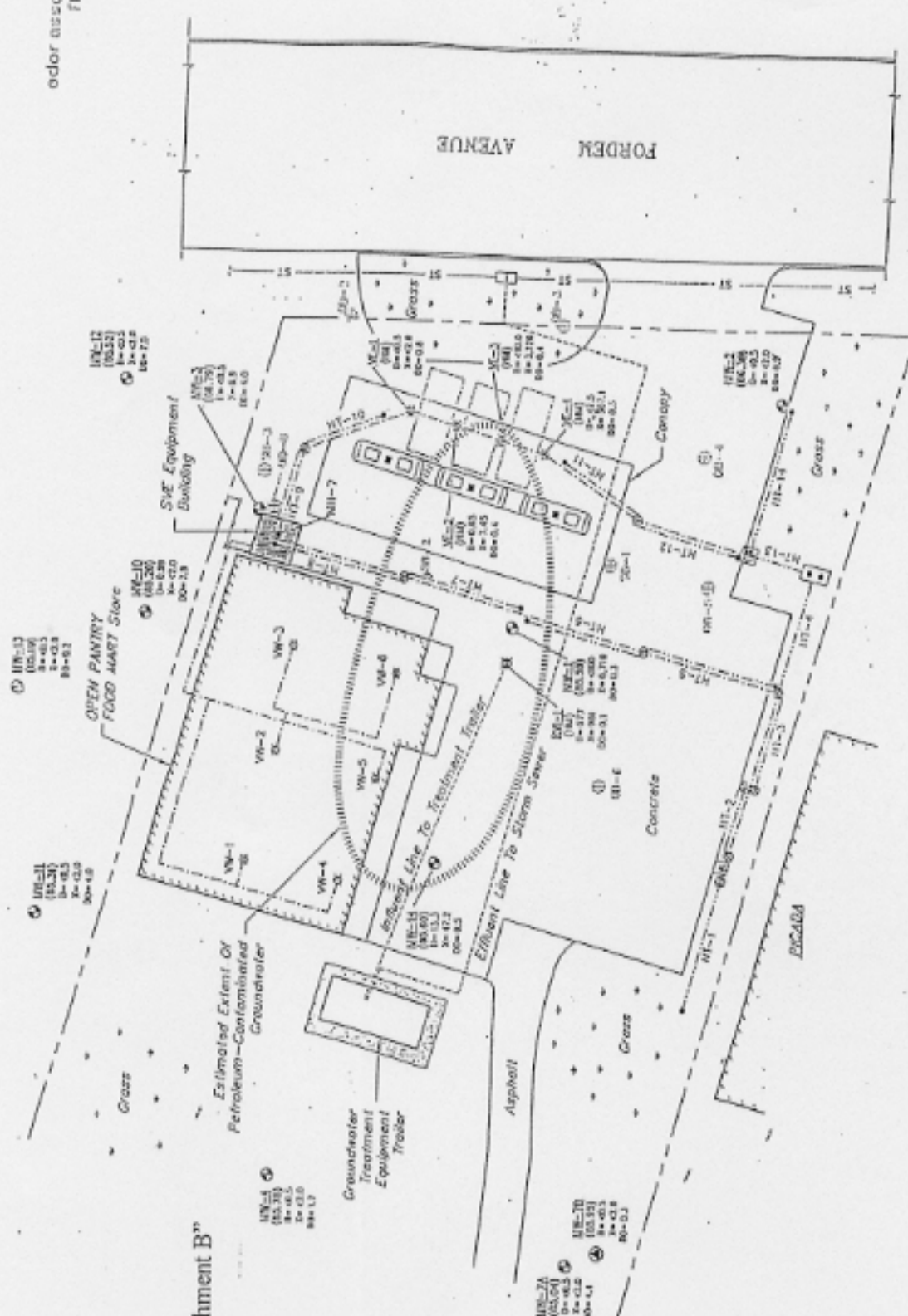

## GROUNDWATER MONITORING DATA (4/24/97)

FORDEM AVENUE-MADISON, WI. SITE  
OPEN PANTRY FOOD MARTS  
MADISON, WISCONSIN



SCALE: 1 INCH = 2000 FEET

7.5 MIN TOPOGRAPHIC MAP  
MADISON EAST, WISCONSIN  
1983



## LOCATION MAP

FORDE AVENUE-MADISON, WI. SITE  
OPEN PANTRY FOOD MARTS  
RACINE, WISCONSIN



**SITE PLAN**  
**FORDEM AVENUE—MADISON, W. SITE**  
**OPEN PANTRY FOOD MARTS**  
**RACINE, WISCONSIN**





OPEN PANTRY FOOD MARTS  
RACINE, WISCONSIN

TABLE 1

SUMMARY OF PVOC ANALYTICAL RESULTS FOR GROUNDWATER SAMPLES

Well/Sample Collection Date	Petroleum Volatile Organic Compound (PVOC) Contaminant Concentrations ( $\mu\text{g/l}$ )					
	Benzene	Ethylbenzene	MTBE	Toluene	Xylenes	Trimethylbenzenes
<b>MW-1</b>						
07/01/86	11,000	3,600	--	11,000	1,500	
10/24/90	750	1,080	<100	3,500	8,100	
07/20/93	1,400	2,300	<50	440	17,000	
09/16/93	390	650	<20	260	4,900	
10/29/93	1,300	2,300	<50	890	1,500	
01/31/94	1,700	3,800	<100	1,100	24,000	
04/21/94	1,800	2,300	<100	1,000	15,000	
10/18/94	1,200	7,300	99	900	16,300	
04/25/97	<100	870	<200	250	7,910	19,050
12/16/97	<100	<200	<200	<200	1,108	6,410
04/03/98	<2.0	18	<2.0	<2.0	130	840
07/01/98	<5.0	<7.5	<5.0	<5.0	<22.5	570
10/06/98	<4.0	140	<4.0	16	780	1,940
05/26/99	<2.0	5.10	<3.0	<5.0	26.83	965
08/13/99	4.54	296	<6.0	59.6	2,949	1,921
<b>MW-2</b>						
07/01/86	<200	<200	--	<200	<200	
11/24/86	<1.0	<1.0	--	<1.0	<15	
10/24/90	<1.0	<1.0	<1.0	<1.0	<1.0	
04/24/97	<0.5	<1.0	<1.0	<1.0	<2.0	<2.0
04/03/98	<0.20	<0.30	<0.20	<0.20	<0.90	<0.60
07/01/98	<0.20	<0.30	1.8	<0.20	<0.90	<0.60
10/06/98	<0.20	<0.30	0.40	<0.20	<0.90	<0.60

OPEN PANTRY FOOD MARTS  
RACINE, WISCONSIN

TABLE I

SUMMARY OF PVOC ANALYTICAL RESULTS FOR GROUNDWATER SAMPLES

Well/Sample Collection Date	Petroleum Volatile Organic Compound (PVOC) Contaminant Concentrations ( $\mu\text{g/l}$ )					
	Benzene	Ethylbenzene	MTBE	Toluene	Xylenes	Trimethylbenzenes
<b>MW-1</b>						
07/01/86	11,000	3,600	--	11,000	1,500	
10/24/90	750	1,080	<100	3,500	8,100	
07/20/93	1,400	2,300	<50	440	17,000	
09/16/93	390	650	<20	260	4,900	
10/29/93	1,300	2,300	<50	890	1,500	
01/31/94	1,700	3,800	<100	1,100	24,000	
04/21/94	1,800	2,300	<100	1,000	15,000	
10/18/94	1,200	7,300	99	900	16,300	
04/23/97	<100	870	<200	250	7,910	19,050
12/16/97	<100	<200	<200	<200	1,108	6,410
04/03/98	<2.0	18	<2.0	<2.0	130	840
07/01/98	<5.0	<7.5	<5.0	<5.0	<22.5	570
10/06/98	<4.0	140	<4.0	16	780	1,940
05/26/99	<2.0	5.10	<3.0	<5.0	26.83	965
08/13/99	4.54	296	<6.0	59.6	2,949	1,921
<b>MW-2</b>						
07/01/86	<200	<200	--	<200	<200	
11/24/86	<1.0	<1.0	--	<1.0	<15	
10/24/90	<1.0	<1.0	<1.0	<1.0	<1.0	
04/24/97	<0.5	<1.0	<1.0	<1.0	<2.0	<2.0
04/03/98	<0.20	<0.30	<0.20	<0.20	<0.90	<0.60
07/01/98	<0.20	<0.30	1.8	<0.20	<0.90	<0.60
10/06/98	<0.20	<0.30	0.40	<0.20	<0.90	<0.60



Table 1 Continued . . .

Well/Sample Collection Date	Petroleum Volatile Organic Compound (PVOC) Contaminant Concentrations ( $\mu\text{g/l}$ )					
	Benzene	Ethylbenzene	MTBE	Toluene	Xylenes	Trimethylbenzenes
<b>MW-3</b>						
07/01/86	10,000	2,500	--	37,000	13,000	
07/20/93	28	110	120	80	300	
09/16/93	810	1,300	<1.0	510	10,000	
10/29/93	11	46	440	22	240	
04/21/93	17	79	49	71	420	
03/28/95	12.2	43.1	<2.0	9.05	185.7	
04/25/97	<0.5	3.0	<1.0	<1.0	6.9	<22.8
07/01/98	<0.20	0.30	<0.20	0.40	<0.90	2.50
10/06/98	0.50	3.8	3.7	1.8	13.9	67
<b>MW-4</b>						
11/24/86	<1.0	<1.0	--	<1.0	<15	
10/24/90	<1.0	<1.0	<1.0	<1.0	<1.0	
07/20/93	<1.0	<1.0	<1.0	<1.0	<1.0	
03/28/95	<0.5	<1.0	<2.0	<2.0	<2.0	
12/08/95	<0.5	<1.0	<2.0	<2.0	<2.0	
04/24/97	<0.5	<1.0	<1.0	<1.0	<2.0	<2.0
12/16/97	<0.5	<1.0	<1.0	<1.0	<2.0	<2.0
04/03/98	<0.20	<0.30	<0.20	<0.20	<0.90	<0.60
07/01/98	<0.20	<0.30	<0.20	<0.20	<0.90	<0.60
10/06/98	<0.20	<0.30	<0.20	<0.20	<0.90	<0.60
05/26/99	<0.2	<0.5	<0.3	<0.5	<1.0	<1.0
08/13/99	<0.15	<0.5	<0.3	<0.4	<0.55	<0.55
<b>MW-5</b>						
11/24/86	<1.0	<1.0	--	<1.0	<15	



Table 1 Continued . . .

Well/Sample Collection Date	Petroleum Volatile Organic Compound (PVOC) Contaminant Concentrations ( $\mu\text{g/l}$ )					
	Benzene	Ethylbenzene	MTBE	Toluene	Xylenes	Trimethylbenzenes
<b>MW-6</b>						
11/24/86	<1.0	<1.0	--	<1.0	<15	
<b>MW-7A</b>						
11/24/86	<1.0	<1.0	--	<1.0	<15	
10/24/90	<1.0	<1.0	<1.0	<1.0	<1.0	
04/24/97	<0.5	<1.0	<1.0	<1.0	<2.0	<2.0
12/16/97	<0.5	<1.0	<1.0	<1.0	<2.0	<2.0
04/03/98	<0.20	<0.30	<0.20	<0.20	<0.90	<0.60
07/01/98	<0.20	<0.30	<0.20	<0.20	<0.90	<0.60
10/06/98	<0.20	<0.30	<0.20	<0.20	<0.90	<0.60
05/26/99	<0.2	<0.5	<0.3	<0.5	<1.0	<1.0
08/13/99	<0.15	<0.5	<0.3	<0.4	<0.55	<0.55
<b>MW-7B</b>						
11/24/86	<1.0	<1.0	--	<1.0	<15	
04/24/97	<0.5	<1.0	<1.0	<1.0	<2.0	<2.0
12/16/97	<0.5	<1.0	<1.0	<1.0	<2.0	<2.0
04/03/98	<0.20	<0.30	<0.20	<0.20	<0.90	<0.60
07/01/98	<0.20	<0.30	<0.20	<0.20	<0.90	<0.60
10/06/98	<0.20	<0.30	<0.20	<0.20	<0.90	<0.60
<b>MW-9</b>						
05/30/91	<1.0	<1.0	--	<1.0	<1.0	
04/03/98	<0.20	<0.30	<0.20	<0.20	<0.90	<0.60
<b>MW-10</b>						
05/30/91	<0.5	<1.0	<2.0	<1.0	<2.0	
04/24/97	0.99	2.46	<1.0	<1.0	<2.0	<2.0
12/16/97	6.66	<1.0	<1.0	<1.0	<2.0	<2.0

Table 1 Continued . . .

Well/Sample Collection Date	Petroleum Volatile Organic Compound (PVOC) Contaminant Concentrations ( $\mu\text{g/l}$ )					
	Benzene	Ethylbenzene	MTBE	Toluene	Xylenes	Trimethylbenzenes
04/03/98	1.1	<0.30	<0.20	<0.20	<0.90	<0.60
07/01/98	<0.20	<0.30	<0.20	<0.20	<0.90	<0.60
10/06/98	<0.20	<0.30	<0.20	<0.20	<0.90	<0.60
<b>MW-11</b>						
05/30/91	1.2	<1.0	--	<1.0	<1.0	
03/28/95	<0.5	<1.0	3.37	<2.0	<2.0	
09/28/95	<0.5	<1.0	2.30	<2.0	<2.0	
12/08/95	<0.5	<1.0	5.05	<2.0	<2.0	
03/19/96	<0.5	<1.0	21.10	<2.0	<2.0	
06/10/96	<0.5	<1.0	5.85	<2.0	<2.0	
09/25/96	<0.5	<1.0	3.0	<1.0	<2.0	
04/24/97	<0.5	<1.0	1.57	<1.0	<2.0	<2.0
12/16/97	<0.5	<1.0	8.93	<1.0	<2.0	<2.0
04/03/98	<0.20	<0.30	3.8	<0.20	<0.90	<0.60
07/01/98	<0.20	<0.30	1.2	<0.20	<0.90	<0.60
10/06/98	<0.20	<0.30	0.80	<0.20	<0.90	<0.60
05/26/99	<0.2	<0.5	<0.3	<0.5	<1.0	<1.0
08/13/99	<0.15	<0.5	<0.3	<0.4	<0.55	<0.55
<b>MW-12</b>						
01/08/92	<0.5	<0.5	<50	<0.5	<0.5	
04/24/97	<0.5	<1.0	<1.0	<1.0	<2.0	<2.0
<b>MW-13</b>						
01/08/92	<0.5	<0.5	<50	<0.5	<0.5	
07/20/93	<1.0	<1.0	<1.0	<1.0	<1.0	
10/18/93	<1.0	2.0	<1.0	<1.0	<1.0	
03/28/95	<0.5	<1.0	<2.0	<2.0	<2.0	

Table 1 Continued . . .

Well/Sample Collection Date	Petroleum Volatile Organic Compound (PVOC) Contaminant Concentrations ( $\mu\text{g/l}$ )					
	Benzene	Ethylbenzene	MTBE	Toluene	Xylenes	Trimethylbenzenes
12/08/95	<0.5	<1.0	<2.0	<2.0	<2.0	
06/10/96	<0.5	<1.0	<2.0	<1.0	<2.0	
04/24/97	<0.5	<1.0	<1.0	<1.0	<2.0	<2.0
<b>MW-14</b>						
01/08/92	7,900	1,500	<5,000	6,400	6,600	
09/16/93	5,700	2,600	<50	4,600	10,000	
10/29/93	7,000	2,500	<50	4,500	8,400	
01/31/94	5,400	2,700	13	2,700	3,800	
04/21/94	4,800	2,400	7.2	2,500	7,600	
10/18/94	3,100	1,900	<20	1,200	6,600	
03/28/95	2,660	1,320	<20	670	4,180	
09/28/95	1,840	1,220	<100	<100	4,280	
12/08/95	2,100	1,710	<100	345	5,000	
03/19/96	2,590	1,590	<100	252	4,750	
09/25/96	722	1,130	<10	141	1,932	
12/30/96	2,160	1,400	<25	495	3,870	
04/24/97	13.3	39.1	<20.0	<20.0	47.2	59.8
12/16/97	62.2	154	<5.0	<5.0	<10.0	<12.62
04/03/98	300	750	<2.0	20	479	210
07/01/98	430	1,600	<10	15	1,275	1,180
10/06/98	520	2,200	<4.0	20	148	162
05/26/99	280	1,230	<3.0	45.2	1,503	640.3
08/13/99	245	1,730	<6.0	15.4	474	371.87
<b>RW-1</b>						
12/30/96	2,160	1,400	<25	459	3,870	
04/24/97	677	511	<20.0	112	981	783



Table 1 Continued . . .

Well/Sample Collection Date	Petroleum Volatile Organic Compound (PVOC) Contaminant Concentrations ( $\mu\text{g/l}$ )					
	Benzene	Ethylbenzene	MTBE	Toluene	Xylenes	Trimethylbenzenes
<b>VE-1</b>						
10/24/90	<1.0	<1.0	<1.0	<1.0	<1.0	
04/24/97	<0.5	<1.0	1.61	<1.0	<2.0	<2.0
<b>VE-2</b>						
10/24/90	660	<1.0	<1.0	3,200	2,200	
04/24/97	0.65	10.6	23.0	<1.0	7.45	4.54
<b>VE-3</b>						
10/24/90	450	160	<1.0	530	720	
12/30/96	27.2	338	<25.0	78.8	7,310	
04/24/97	<10.0	230	<20.0	<20.0	3,220	2,746
<b>VE-4</b>						
10/24/90	340	8.0	<1.0	310	422	
12/30/96	12.3	239	<5.0	12.2	812	
04/24/97	<2.5	98.1	<5.0	<5.0	507.1	479.6
NR 140 ES	5	700	60	343	620	480
NR 140 PAL	0.5	140	12	68.6	124	96

**NOTES:**

Analytical results are in micrograms per liter ( $\mu\text{g/l}$ ).

Concentrations exceeding the NR 140 ES are shaded. Concentrations exceeding the NR 140 PAL are bold.

NR 140 ES = NR 140 enforcement standard ( $\mu\text{g/l}$ ).

NR 140 PAL = NR 140 preventative action limit ( $\mu\text{g/l}$ ).

MTBE = Methyl tert butyl ether.

-- = Not analyzed.



TABLE 1  
GROUNDWATER DEPTH AND ELEVATION DATA

Elevation (ft) of	MW-1	MW-2	MW-3	MW-4	MW-7A	MW-7B	MW-9	MW-10	MW-11	MW-12	MW-13	MW-14	Vertical Gradient (ft/ft)
Top of PVC	98.57	97.11	97.93	97.80	96.92	97.27	96.43	95.83	95.47	96.72	95.34	98.80	
Screen Top	93.07	94.11	94.93	92.80	91.92	76.97	85.43	84.83	84.47	89.22	87.84	91.30	
Screen Bottom	83.07	84.11	84.93	82.80	81.92	71.97	75.43	74.83	74.47	79.22	77.84	81.30	
Date													
07/20/93	8.90	6.83	7.40	7.29	8.22	6.54	5.62				4.92	8.48	
09/16/93	8.56	7.26		8.22	7.34				5.66	6.86		8.99	
10/27/93	10.91		9.57									10.67	
01/31/94	12.40		11.64									12.57	
04/21/94	11.61	9.46	10.58	10.79	9.62					9.89	8.51	11.68	
10/18/94	10.20	8.29	10.01	12.16	11.29	11.44				10.15	9.21	12.44	
03/28/95	12.62	10.52	11.66	11.50	11.70	10.56	10.56		9.70	11.20	9.60	12.70	
09/28/95			12.45	13.89					11.61		11.45	14.93	
12/08/95	13.31		12.44	12.55					10.43		10.25	13.48	
03/19/96	13.98		12.51	12.56					10.48		10.35	13.85	
06/10/96	12.52		10.36	10.64				9.36	9.02		8.98	12.28	
09/25/96	11.58		12.34	12.35	11.72	11.38		10.40	10.08	11.38	9.94	13.36	
12/30/96	13.85		12.63	12.91	12.67	12.37			11.00	12.00	11.05	14.03	
04/24/97	12.98	10.73	11.14	12.02	11.88	11.32		10.54	10.16	11.20	10.15	13.20	
Date													
07/20/93	89.67	90.28	90.53	90.51	88.70	90.73	90.81				90.42	90.32	0.163
09/16/93	90.01	89.85		89.58	89.58				89.81	89.86	89.85	89.81	
10/27/93	87.66		88.36									88.13	
01/31/94	86.17		86.29									86.23	
04/21/94	86.96	87.65	87.35	87.01	87.30					86.83	86.83	87.12	
10/18/94	88.37	88.42	87.92	85.64	85.63	85.83				86.57	86.13	86.36	0.016
03/28/95	85.95	86.59	86.27	86.30	85.22	86.71	85.87			85.77	85.74	86.10	0.120
09/28/95			85.48	83.91					83.86		83.89	83.87	
12/08/95	85.26		85.49	85.25					85.04		85.09	85.32	
03/19/96	84.59		85.42	85.24					84.99		84.99	84.95	
06/10/96	86.05		87.57	87.16				86.47	86.45		86.36	86.52	
09/25/96		85.53	85.59	85.45	85.20	85.89		85.43	85.39	85.34	85.40	85.44	0.055
12/30/96	84.72		85.30	84.89	84.25	84.90			84.47	84.72	84.29	84.77	0.052
04/24/97	85.59	86.38	86.79	85.78	85.04	85.95		85.29	85.31	85.52	85.19	85.60	0.073

NOTES:

Monitoring well MW-9 could not be found after 3/28/95.

Vertical gradient - calculated based on difference in groundwater elevations between MW-7A and MW-7B.

Groundwater elevation measurements before 3/28/95 based on data reported by Harding Lawson.