



ENVIRONMENTAL
ASSESSMENTS, INC.



May 21, 2004

Ms. Cathy Rodda
Wisconsin Department of Natural Resources
Peshtigo Service Center
101 Ogden Road
Peshtigo, WI 54157

Re: George Hannan, Excavated Soil Pile Sampling Results

Dear Ms. Rodda;

This letter serves as documentation of the successful remediation of the soils excavated during tank removal operations at the Shell Station located at 125 N. Highway 141, Coleman, WI in October of 1999. The soils were placed on plastic in a rural area and were originally covered. However, due to weather conditions, the cover deteriorated and was not replaced, but the bottom plastic barrier remains intact.

On May 5, 2004, Environmental Assessments, Inc. went to the location of the soil pile to document its location and sample the soil pile for evidence of remaining contamination by petroleum products. The soil pile general location is in a remote rural area of Marinette County in the Township of Grover. It is located in the southwest (SW) 1/4 of the SW 1/4 of Section (Sec) 15, Township (T) 30 north (N), Range (R) 21 east (E). Specifically it is located on the southeast corner of County Highway "B" and Townline Road. It is located 53 feet east of Townline Road and 586 feet north of County Highway "B".

The site is approximately 700 feet above mean sea level (MSL) and is generally flat. The Marinette County Soil Survey describes the soils of this parcel of land as Emmet fine sandy loam. They are located on 1 to 6 percent slopes and are well drained. The area surrounding the location of the soil pile is comprised of farms, farmland and forested areas.

The soil pile is approximately 75 feet in length in the north/south direction and approximately 30 feet wide in the east/west direction and is approximately 4 1/2 feet high. There is approximately 375 cubic yards of material in the soil pile. The soil pile is a mixture of sandy loam with rocks, cobbles and pieces of asphalt. Within the soil pile, there are rabbit dens and tunnels.

The soil pile was sampled according to the protocol of sampling closure excavations of one sample per every 25 feet of length. The soil pile samples were collected using a hand auger and advanced to a depth of approximately three feet into the soil pile. Samples were collected for analysis for the presence of Gasoline Range Organic Compounds (GRO) and Petroleum Volatile

Organic Compounds (PVOCs). During the course of sample collection, observations were made concerning the soil type and any visual or olfactory signs of contamination.

The results of the soil sampling revealed no detectable amount of soil contamination in the samples collected. Visual and olfactory signs of contamination by petroleum compounds were not noted. A table showing the results of the sampling, laboratory data sheets and maps showing the regional location, soil type and soil pile layout are provided as attachments to this document.

Based on the results of this sampling and the need to put the land back into productive use we are requesting that the issue of the remediated soil pile be closed. We also are requesting that upon your receipt and review of the data provided, you contact us within seven working days to indicate your agreement with our recommendation so that the pile can be thin spread on the land, incorporated into the soil and planted in time for a crop yield.

If you have any questions, please contact me at (920)749-9746.

Sincerely,

ENVIRONMENTAL ASSESSMENTS, INC.

Victoria Flowers
Hydrogeologist/Project Manager

attachments

cc: Mr. George Hannan, 125 N. Hwy 141, Coleman, WI 54112
file

Send To Printer Back To TerraServer Change to 11x17 Print Size Show Grid Lines Change to Landscape
USGS 5 km E of Coleman, Wisconsin, United States 01 Jul 1979

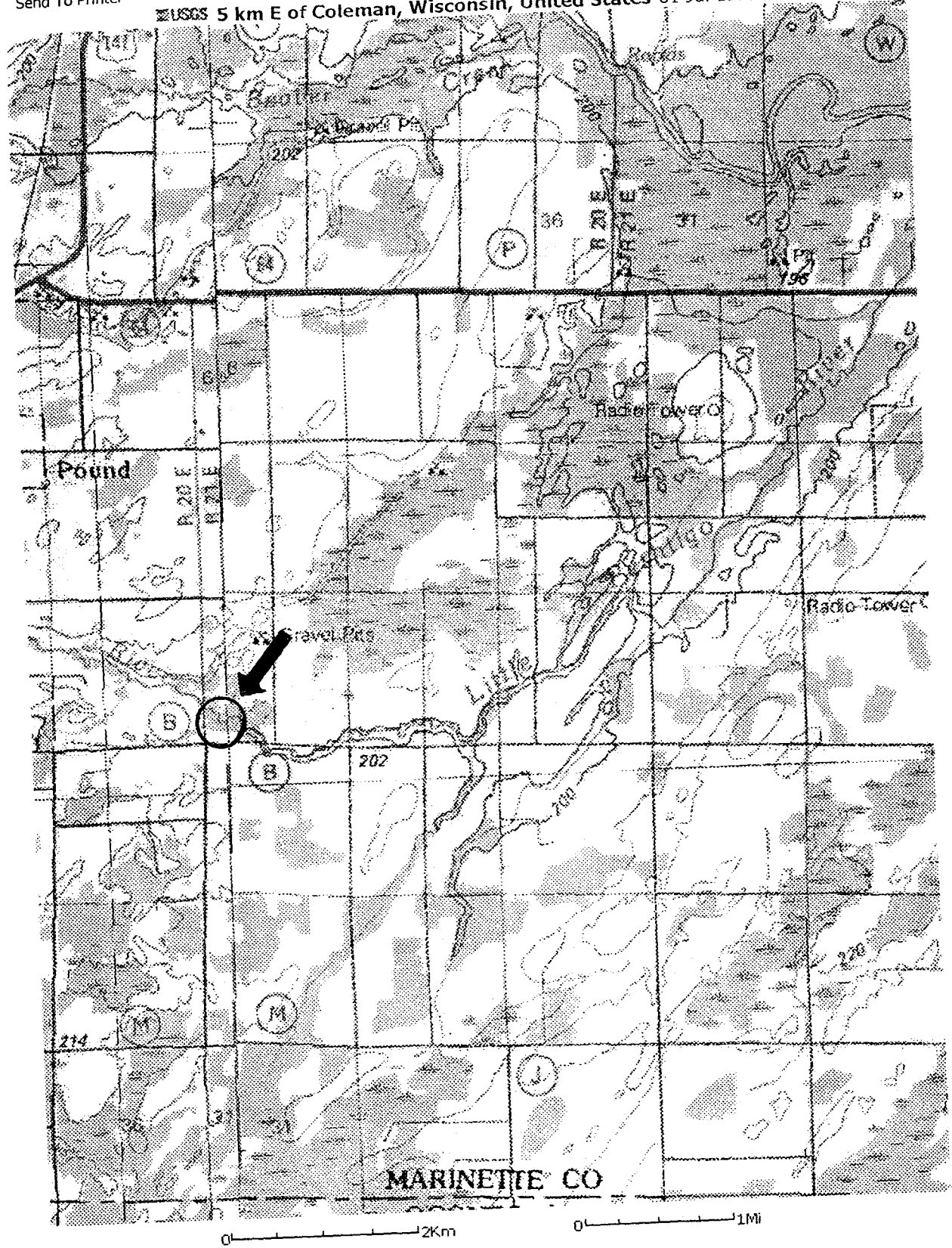
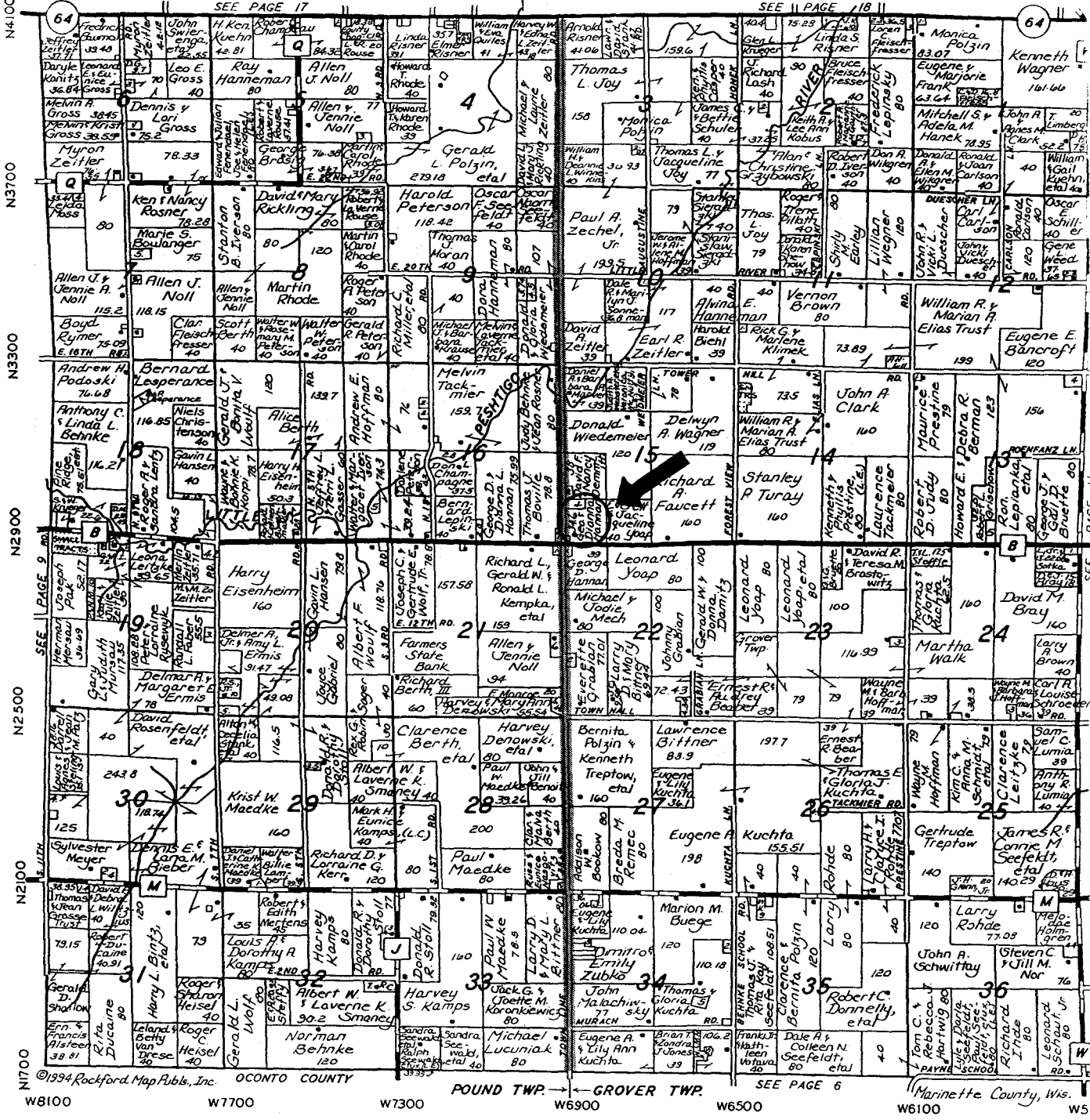

Image courtesy of the U.S. Geological Survey
© 2004 Microsoft Corporation. Terms of Use Privacy Statement

EAST PART POUND WEST CENTRAL GROVER T. 30N. - R. 21E



©1994 Rockford Map Pbls., Inc. OCONTO COUNTY POUND TWP. GROVER TWP. SEE PAGE 6
 W8100 W7700 W7300 W6900 W6500 W6100 W5700
 N4100 N3700 N3300 N2900 N2500 N2100 N1700
 SEE PAGE 17 SEE PAGE 18
 Marquette County, Wis.

JIM'S TRUCKING & EXCAVATING

TRUCKING OF ALL TYPES

Honest, Quality Work at Reasonable Prices! Call Us First - Free Estimates

FULLY INSURED

COMPLETE EXCAVATING SERVICES

Basements • Trenching • Roads • Demolition • Bulldozing
 Landscaping • Snow Removal • Ponds • Land Clearing
 Garbage Collections • Container Service
 Certified Gas and Fuel Tank Removal

ALL TYPES OF MATERIALS

Sand • Fill • Washed Stone • Gravel
 Black Dirt • Sand & Silt Mix • Limestone

Jim Kuntz, Jr. — (414) 897-3334

1038 County Q - Pound, Wisconsin 54161



2 525 000 FEET

R. 21-E

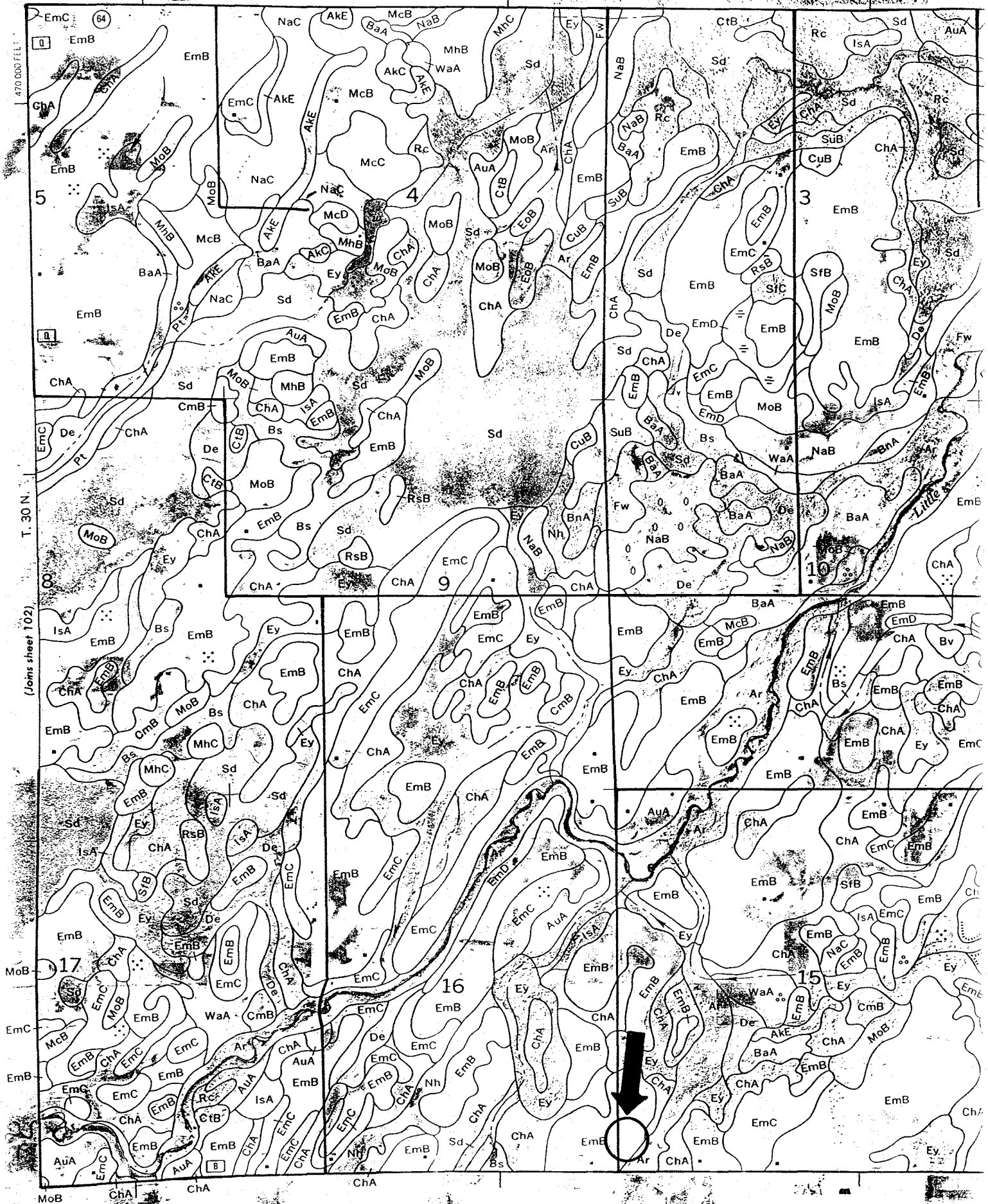

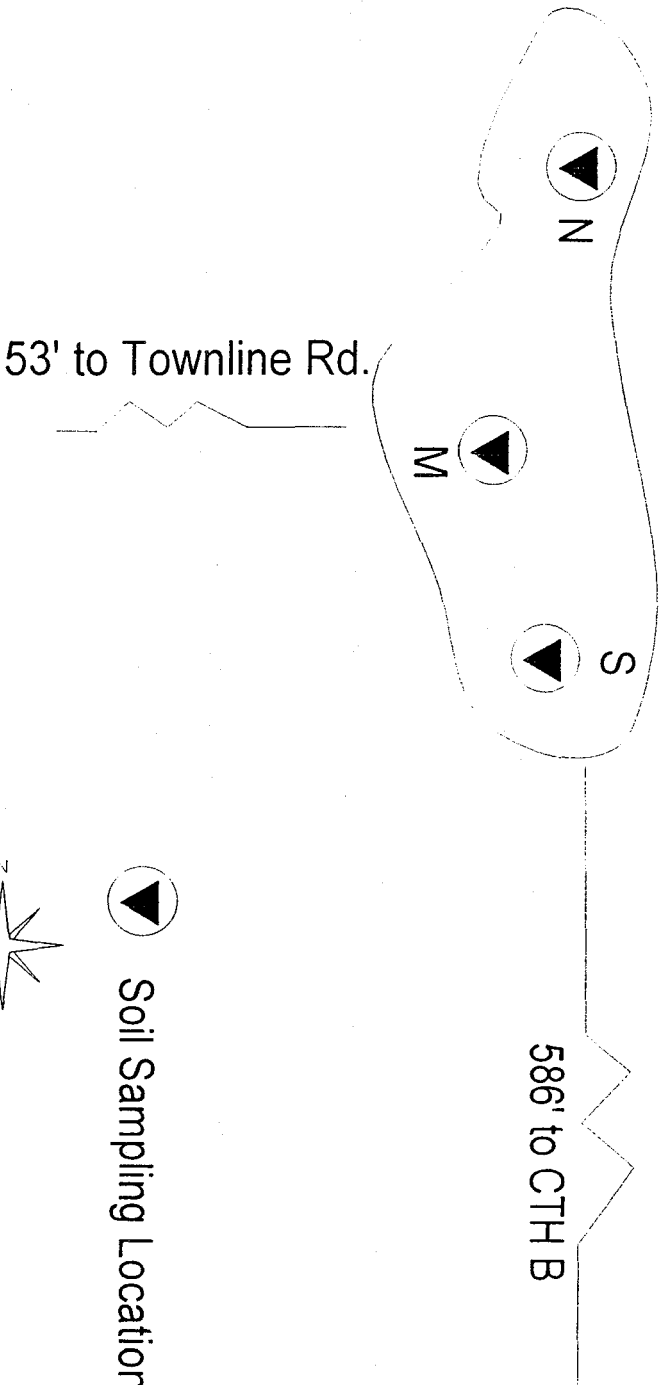

Environmental Assessments, Inc.

Title:

P.O. Box 9127

Appleton, WI 54911

(920) 749-9746

Fax (920) 749-9748

George Hannan

Soil Bio-Pile Site Map

Showing Sampling Locations

Figure #1

Scale: 1" = 20'

Drawn By: VAF

**George Hannan Soil Pile Sampling
GRO and PVOC Parameters**

Sample ID	Location	Gasoline Range Organics (ppm)	Benzene	Ethyl-benzene	Methyl-tert butyl-ether	Toluene	Trimethyl-benzenes	Total Xylenes
N	North end	<2.7	<25	<25	<25	<25	<25	<25
M	Mid-pile	<2.7	<25	<25	<25	<25	<25	<25
S	South end	<2.6	<25	<25	<25	<25	<25	<25

All results are reported in parts per billion (ppb) except Gasoline Range Organics



Corporate Office & Laboratory
1241 Bellevue Street, Suite 9, Green Bay, WI 54302
920-469-2436, Fax: 920-469-8827
www.enchem.com

Analytical Report Number: 846280

Client: ENVIRONMENTAL ASSESSMENTS

Lab Contact: Brian Basten

Project Name: GEORGE HANNAN

Project Number:

Lab Sample Number	Field ID	Matrix	Collection Date
846280-001	N	SOIL	05/05/04
846280-002	M	SOIL	05/05/04
846280-003	S	SOIL	05/05/04
846280-004	TB	METH	05/05/04

I certify that the data contained in this Final Report has been generated and reviewed in accordance with approved methods and Laboratory Standard Operating Procedure. Exceptions, if any, are discussed in the accompanying sample comments. Release of this final report is authorized by Laboratory management, as is verified by the following signature. Reported results shall not be reproduced, except in full, without the written approval of the lab. The sample results relate only to the analytes of interest tested.

Approval Signature 

Date 5-10-04

En Chem Inc.

Analytical Report Number: 846280

1241 Bellevue Street
Green Bay, WI 54302
920-469-2436

Client : ENVIRONMENTAL ASSESSMENTS
Project Name : GEORGE HANNAN
Project Number :
Field ID : N

Matrix Type : SOIL
Collection Date : 05/05/04
Report Date : 05/10/04
Lab Sample Number : 846280-001

INORGANICS

Test	Result	LOD	LOQ	EQL	Dil.	Units	Code	Anl Date	Prep Method	Anl Method
Percent Solids	92.6				1	%		05/06/04	SM 2540G M	SM 2540G M

GASOLINE RANGE ORGANICS

Prep Date: 05/07/04

Analyte	Result	LOD	LOQ	EQL	Dil.	Units	Code	Anl Date	Prep Method	Anl Method
Gasoline Range Organics	< 2.7			2.7	50	mg/kg		05/08/04	WI MOD GRO	WI MOD GRO
GRO Blank	< 2.5			2.5	50	mg/kg		05/08/04	WI MOD GRO	WI MOD GRO
GRO Blank Spike	97				1	%Recov		05/08/04	WI MOD GRO	WI MOD GRO
GRO Blank Spike Duplicate	89				1	%Recov		05/08/04	WI MOD GRO	WI MOD GRO

PVOC

Prep Date: 05/07/04

Analyte	Result	LOD	LOQ	EQL	Dil.	Units	Code	Anl Date	Prep Method	Anl Method
1,2,4-Trimethylbenzene	< 25	25	60		50	ug/kg		05/08/04	SW846 5030B	SW846 M8021
1,3,5-Trimethylbenzene	< 25	25	60		50	ug/kg		05/08/04	SW846 5030B	SW846 M8021
Benzene	< 25	25	60		50	ug/kg		05/08/04	SW846 5030B	SW846 M8021
Ethylbenzene	< 25	25	60		50	ug/kg		05/08/04	SW846 5030B	SW846 M8021
Methyl-tert-butyl-ether	< 25	25	60		50	ug/kg		05/08/04	SW846 5030B	SW846 M8021
Toluene	< 25	25	60		50	ug/kg		05/08/04	SW846 5030B	SW846 M8021
Xylene, o	< 25	25	60		50	ug/kg		05/08/04	SW846 5030B	SW846 M8021
Xylenes, m + p	< 50	50	120		50	ug/kg		05/08/04	SW846 5030B	SW846 M8021
a,a,a-Trifluorotoluene	104				1	%Recov		05/08/04	SW846 5030B	SW846 M8021

En Chem Inc.

Analytical Report Number: 846280

1241 Bellevue Street
Green Bay, WI 54302
920-469-2436

Client : ENVIRONMENTAL ASSESSMENTS
Project Name : GEORGE HANNAN
Project Number :
Field ID : M

Matrix Type : SOIL
Collection Date : 05/05/04
Report Date : 05/10/04
Lab Sample Number : 846280-002

INORGANICS

Test	Result	LOD	LOQ	EQL	Dil.	Units	Code	Anl Date	Prep Method	Anl Method
Percent Solids	93.6				1	%		05/06/04	SM 2540G M	SM 2540G M

GASOLINE RANGE ORGANICS

Prep Date: 05/07/04

Analyte	Result	LOD	LOQ	EQL	Dil.	Units	Code	Anl Date	Prep Method	Anl Method
Gasoline Range Organics	< 2.7			2.7	50	mg/kg		05/08/04	WI MOD GRO	WI MOD GRO
GRO Blank	< 2.5			2.5	50	mg/kg		05/08/04	WI MOD GRO	WI MOD GRO
GRO Blank Spike	97				1	%Recov		05/08/04	WI MOD GRO	WI MOD GRO
GRO Blank Spike Duplicate	89				1	%Recov		05/08/04	WI MOD GRO	WI MOD GRO

PVOC

Prep Date: 05/07/04

Analyte	Result	LOD	LOQ	EQL	Dil.	Units	Code	Anl Date	Prep Method	Anl Method
1,2,4-Trimethylbenzene	< 25	25	60		50	ug/kg		05/08/04	SW846 5030B	SW846 M8021
1,3,5-Trimethylbenzene	< 25	25	60		50	ug/kg		05/08/04	SW846 5030B	SW846 M8021
Benzene	< 25	25	60		50	ug/kg		05/08/04	SW846 5030B	SW846 M8021
Ethylbenzene	< 25	25	60		50	ug/kg		05/08/04	SW846 5030B	SW846 M8021
Methyl-tert-butyl-ether	< 25	25	60		50	ug/kg		05/08/04	SW846 5030B	SW846 M8021
Toluene	< 25	25	60		50	ug/kg		05/08/04	SW846 5030B	SW846 M8021
Xylene, o	< 25	25	60		50	ug/kg		05/08/04	SW846 5030B	SW846 M8021
Xylenes, m + p	< 50	50	120		50	ug/kg		05/08/04	SW846 5030B	SW846 M8021
a,a,a-Trifluorotoluene	104				1	%Recov		05/08/04	SW846 5030B	SW846 M8021

En Chem Inc.

Analytical Report Number: 846280

1241 Bellevue Street
Green Bay, WI 54302
920-469-2436

Client : ENVIRONMENTAL ASSESSMENTS

Project Name : GEORGE HANNAN

Project Number :

Field ID : S

Matrix Type : SOIL

Collection Date : 05/05/04

Report Date : 05/10/04

Lab Sample Number : 846280-003

INORGANICS

Test	Result	LOD	LOQ	EQL	Dil.	Units	Code	Anl Date	Prep Method	Anl Method
Percent Solids	94.7				1	%		05/06/04	SM 2540G M	SM 2540G M

GASOLINE RANGE ORGANICS

Prep Date: 05/07/04

Analyte	Result	LOD	LOQ	EQL	Dil.	Units	Code	Anl Date	Prep Method	Anl Method
Gasoline Range Organics	< 2.6			2.6	50	mg/kg		05/08/04	WI MOD GRO	WI MOD GRO
GRO Blank	< 2.5			2.5	50	mg/kg		05/08/04	WI MOD GRO	WI MOD GRO
GRO Blank Spike	97				1	%Recov		05/08/04	WI MOD GRO	WI MOD GRO
GRO Blank Spike Duplicate	89				1	%Recov		05/08/04	WI MOD GRO	WI MOD GRO

PVOC

Prep Date: 05/07/04

Analyte	Result	LOD	LOQ	EQL	Dil.	Units	Code	Anl Date	Prep Method	Anl Method
1,2,4-Trimethylbenzene	< 25	25	60		50	ug/kg		05/08/04	SW846 5030B	SW846 M8021
1,3,5-Trimethylbenzene	< 25	25	60		50	ug/kg		05/08/04	SW846 5030B	SW846 M8021
Benzene	< 25	25	60		50	ug/kg		05/08/04	SW846 5030B	SW846 M8021
Ethylbenzene	< 25	25	60		50	ug/kg		05/08/04	SW846 5030B	SW846 M8021
Methyl-tert-butyl-ether	< 25	25	60		50	ug/kg		05/08/04	SW846 5030B	SW846 M8021
Toluene	< 25	25	60		50	ug/kg		05/08/04	SW846 5030B	SW846 M8021
Xylene, o	< 25	25	60		50	ug/kg		05/08/04	SW846 5030B	SW846 M8021
Xylenes, m + p	< 50	50	120		50	ug/kg		05/08/04	SW846 5030B	SW846 M8021
a,a,a-Trifluorotoluene	103				1	%Recov		05/08/04	SW846 5030B	SW846 M8021

En Chem Inc.

Analytical Report Number: 846280

1241 Bellevue Street
Green Bay, WI 54302
920-469-2436

Client : ENVIRONMENTAL ASSESSMENTS

Project Name : GEORGE HANNAN

Project Number :

Field ID : TB

Matrix Type : METHANOL

Collection Date : 05/05/04

Report Date : 05/10/04

Lab Sample Number : 846280-004

GASOLINE RANGE ORGANICS

Prep Date: 05/07/04

Analyte	Result	LOD	LOQ	EQL	Dil.	Units	Code	Anl Date	Prep Method	Anl Method
Gasoline Range Organics	< 2500			2500	50	ug/L		05/08/04	WI MOD GRO	WI MOD GRO
GRO Blank	< 50			50	1	ug/L		05/08/04	WI MOD GRO	WI MOD GRO
GRO Blank Spike	97				1	%Recov		05/08/04	WI MOD GRO	WI MOD GRO
GRO Blank Spike Duplicate	89				1	%Recov		05/08/04	WI MOD GRO	WI MOD GRO

PVOC

Prep Date: 05/07/04

Analyte	Result	LOD	LOQ	EQL	Dil.	Units	Code	Anl Date	Prep Method	Anl Method
1,2,4-Trimethylbenzene	< 25	25	60		50	ug/L		05/08/04	SW846 5030B	SW846 M8021
1,3,5-Trimethylbenzene	< 25	25	60		50	ug/L		05/08/04	SW846 5030B	SW846 M8021
Benzene	< 25	25	60		50	ug/L		05/08/04	SW846 5030B	SW846 M8021
Ethylbenzene	< 25	25	60		50	ug/L		05/08/04	SW846 5030B	SW846 M8021
Methyl-tert-butyl-ether	< 25	25	60		50	ug/L		05/08/04	SW846 5030B	SW846 M8021
Toluene	< 25	25	60		50	ug/L		05/08/04	SW846 5030B	SW846 M8021
Xylene, o	< 25	25	60		50	ug/L		05/08/04	SW846 5030B	SW846 M8021
Xylenes, m + p	< 25	25	60		50	ug/L		05/08/04	SW846 5030B	SW846 M8021
a,a,a-Trifluorotoluene	104				1	%Recov		05/08/04	SW846 5030B	SW846 M8021

Qualifier Codes

Flag	Applies To	Explanation
A	Inorganic	Analyte is detected in the method blank. Method blank criteria is evaluated to the laboratory method detection limit. Additionally, method blank acceptance may be based on project specific criteria or determined from analyte concentrations in the sample and are evaluated on a sample by sample basis.
B	Inorganic	The analyte has been detected between the method detection limit and the reporting limit.
B	Organic	Analyte is present in the method blank. Method blank criteria is evaluated to the laboratory method detection limit. Additionally, method blank acceptance may be based on project specific criteria or determined from analyte concentrations in the sample and are evaluated on a sample by sample basis.
C	All	Elevated detection limit.
D	All	Analyte value from diluted analysis or surrogate result not applicable due to sample dilution.
E	Inorganic	Estimated concentration due to matrix interferences. During the metals analysis the serial dilution failed to meet the established control limits of 0-10%. The sample concentration is greater than 50 times the IDL for analysis done on the ICP or 100 times the IDL for analysis done on the ICP-MS. The result was flagged with the E qualifier to indicate that a physical interference was observed.
E	Organic	Analyte concentration exceeds calibration range.
F	Inorganic	Due to potential interferences for this analysis by Inductively Coupled Plasma techniques (SW-846 Method 6010), this analyte has been confirmed by and reported from an alternate method.
F	Organic	Surrogate results outside control criteria.
H	All	Preservation, extraction or analysis performed past holding time.
HF	Inorganic	This test is considered a field parameter, and the recommended holding time is 15 minutes from collection. The analysis was performed in the laboratory beyond the recommended holding time.
J	Inorganic	The analyte has been detected between the method detection limit and the reporting limit.
J	Organic	Concentration detected is greater than the method detection limit but less than the reporting limit.
K	Inorganic	Sample received unpreserved. Sample was either preserved at the time of receipt or at the time of sample preparation.
K	Organic	Detection limit may be elevated due to the presence of an unrequested analyte.
L	All	Elevated detection limit due to low sample volume.
M	Organic	Sample pH was greater than 2
N	All	Spiked sample recovery not within control limits.
O	Organic	Sample received overweight.
P	Organic	The relative percent difference between the two columns for detected concentrations was greater than 40%.
Q	All	The analyte has been detected between the limit of detection (LOD) and limit of quantitation (LOQ). The results are qualified due to the uncertainty of analyte concentrations within this range.
S	Organic	The relative percent difference between quantitation and confirmation columns exceeds internal quality control criteria. Because the result is unconfirmed, it has been reported as a non-detect with an elevated detection limit.
U	All	The analyte was not detected at or above the reporting limit.
V	All	Sample received with headspace.
W	All	A second aliquot of sample was analyzed from a container with headspace.
X	All	See Sample Narrative.
&	All	Laboratory Control Spike recovery not within control limits.
*	All	Precision not within control limits.
<	All	The analyte was not detected at or above the reporting limit.
1	Inorganic	Dissolved analyte or filtered analyte greater than total analyte; analyses passed QC based on precision criteria.
2	Inorganic	Dissolved analyte or filtered analyte greater than total analyte; analyses failed QC based on precision criteria.
3	Inorganic	BOD result is estimated due to the BOD blank exceeding the allowable oxygen depletion.
4	Inorganic	BOD duplicate precision not within control limits. Due to the 48 hour holding time for this test, it is not practical to reanalyze and try to correct the deficiency.
5	Inorganic	BOD result is estimated due to insufficient oxygen depletion. Due to the 48 hour holding time for this test, it is not practical to reanalyze and try to correct the deficiency.
6	Inorganic	BOD laboratory control sample not within control limits. Due to the 48 hour holding time for this test, it is not practical to reanalyze and try to correct the deficiency.
7	Inorganic	BOD result is estimated due to complete oxygen depletion. Due to the 48 hour holding time for this test, it is not practical to reanalyze and try to correct the deficiency.

En Chem Inc.

Analysis Summary by Laboratory

1241 Bellevue Street
Green Bay, WI 54302

1090 Kennedy Avenue
Kimberly, WI 54136

Test Group Name	846280-001	846280-002	846280-003	846280-004
GASOLINE RANGE ORGANICS	G	G	G	G
PERCENT SOLIDS	G	G	G	
PVOC	G	G	G	G

Wisconsin Certification

G = En Chem Green Bay	405132750 / DATCP: 105 000444
K = En Chem Kimberly	445134030
S = En Chem Superior	Not Applicable
C = Subcontracted Analysis	

En Chem, Inc. Cooler Receipt Log

Batch No. 846280

Project Name or ID George Hannan No. of Coolers: 1 Temps: ROI

A. Receipt Phase: Date cooler was opened: 5/5/04 By: KM

- 1: Were samples received on ice? (Must be ≤ 6 C.)..... YES NO² NA
- 2: Was there a Temperature Blank?..... YES NO
- 3: Were custody seals present and intact on cooler? (Record on COC)..... YES NO
- 4: Are COC documents present?..... YES NO²
- 5: Does this Project require quick turn around analysis?..... YES NO
- 6: Is there any sub-work?..... YES NO
- 7: Are there any short hold time tests?..... YES NO
- 8: Are any samples nearing expiration of hold-time? (Within 2 days)..... YES¹ NO Contacted by/Who _____
- 9: Do any samples need to be Filtered or Preserved in the lab?..... YES¹ NO Contacted by/Who _____

B. Check-in Phase: Date samples were Checked-in: 5/5/04 By: KM

- 1: Were all sample containers listed on the COC received and intact?..... YES NO² NA
- 2: Sign the COC as received by En Chem. Completed..... YES NO
- 3: Do sample labels match the COC? YES NO²
- 4: Completed pH check on preserved samples..... YES NO NA
(This statement does not apply to water: VOC, O&G, TOC, DRO, Total Rec. Phenolics)
- 5: Do samples have correct chemical preservation?..... YES NO² NA
(This statement does not apply to water: VOC, O&G, TOC, DRO, Total Rec. Phenolics)
- 6: Are dissolved parameters field filtered?..... YES NO² NA
- 7: Are sample volumes adequate for tests requested? YES NO²
- 8: Are VOC samples free of bubbles >6mm YES NO² NA
- 9: Enter samples into logbook. Completed..... YES NO
- 10: Place laboratory sample number on all containers and COC. Completed..... YES NO
- 11: Complete Laboratory Tracking Sheet (LTS). Completed..... YES NO NA
- 12: Start Nonconformance form. YES NO NA
- 13: Initiate Subcontracting procedure. Completed..... YES NO NA
- 14: Check laboratory sample number on all containers and COC. KS YES NO NA

Short Hold-time tests:

24 Hours or less	48 Hours	7 days	Footnotes 1 Notify proper lab group immediately. 2 Complete nonconformance memo.
Coliform	BOD	Ash	
Corrosivity = pH	Color	Aqueous Extractable Organics- ALL	
Dissolved Oxygen	Nitrite or Nitrate	Flashpoint	
Hexavalent Chromium	Ortho Phosphorus	Free Liquids	
HPC	Surfactants	Sulfide	
Ferrous Iron	Turbidity	TDS	
Eh	En Core Preservation	TSS	
Odor	Power stop preservation	Total Solids	
Residual Chlorine		TVS	
Sulfite		TVSS	
		Unpreserved VOC's	

Rev. 2/05/04, Attachment to 1-REC-5.
Subject to QA Audit.

Reviewed by/date bb 5-6-04

(Please Print Legibly)

Company Name: Environmental Assessments

Branch or Location:

Project Contact: Victoria Flowers

Telephone: 920 749 9746

Project Number:

Project Name: George Hannan

Project State: WI

Sampled By (Print): Victoria Flowers

PO #:

Data Package Options - (please circle if requested)

Sample Results Only (no QC)

EPA Level II (Subject to Surcharge)

EPA Level III (Subject to Surcharge)

EPA Level IV (Subject to Surcharge)

Regulatory Program: UST, RCRA, SDWA, NPDES, CERCLA

Matrix Codes: W=Water, S=Soil, A=Air, C=Charcoal, B=Biota, Sl=Sludge

LABORATORY ID (Lab Use Only)	FIELD ID	COLLECTION		MATRIX	ANALYSES REQUESTED P/OC/GRO	TOTAL # OF BOTTLES SENT	CLIENT COMMENTS	LAB COMMENTS (Lab Use Only)
		DATE	TIME					
001	N	5/5/01		S	X	2		1-4 ref, 1-2 ref
002	M				X	2		
003	S				X	2		
004	TB				X	1		1-2 ref meat blank



1241 Bellevue St., Suite 9
Green Bay, WI 54302
920-469-2436
Fax 920-469-8827

CHAIN OF CUSTODY 114800

*Preservation Codes
A=None B=HCL C=H2SO4 D=HNO3 E=EnCore F=Methanol G=NaOH
H=Sodium Bisulfate Solution I=Sodium Thiosulfate J=Other
FILTERED? (YES/NO) N
PRESERVATION (CODE)* F

Page 1 of 1

Quote #: Victoria Flowers
Mail Report To: Victoria Flowers

Company: Environmental Assessments, LLC
Address: P.O. Box 9127
Appleton, WI 54911
Invoice To:
Company:
Address:

Mail Invoice To:

Rush Turnaround Time Requested (TAT) - Prelim (Rush TAT subject to approval/surcharge)
Date Needed:
Transmit Prelim Rush Results by (circle):
Phone Fax E-Mail
Phone #:
Fax #:
E-Mail Address:
Samples on HOLD are subject to special pricing and release of liability

Relinquished By: Victoria Flowers 5/5/01
Relinquished By:
Relinquished By:
Relinquished By:

Received By: Lori Stevens 5/5/01 14:37
Received By:
Received By:
Received By:

En Chem Project No. 846280
Sample Receipt Temp. ROI
Sample Receipt pH (Wet/Metals) N/A
Cooler Custody Seal Present / **Not Present**
Intact / Not Intact