

GIS REGISTRY INFORMATION

SITE NAME: Amherst Super Service

BRRTS #: 03-50-000149

CLOSURE DATE: 9-9-03

STREET ADDRESS: 108 Main Street

CITY: Amherst

SOURCE PROPERTY GPS COORDINATES (meters in WTM91 projection): X= 576919 Y= 442217

OFF-SOURCE CONTAMINATION (>ES): Yes No

IF YES, STREET ADDRESS 1: _____

GPS COORDINATES (meters in WTM91 projection): X= _____ Y= _____

IF YES, STREET ADDRESS 2: _____

GPS COORDINATES (meters in WTM91 projection): X= _____ Y= _____

IF YES, STREET ADDRESS 3: _____

GPS COORDINATES (meters in WTM91 projection): X= _____ Y= _____

IF YES, STREET ADDRESS 4: _____

GPS COORDINATES (meters in WTM91 projection): X= _____ Y= _____

IF YES, STREET ADDRESS 5: _____

GPS COORDINATES (meters in WTM91 projection): X= _____ Y= _____

CONTAMINATION IN RIGHT OF WAY: Yes No

DOCUMENTS NEEDED:

- Closure Letter, and any conditional closure letter issued
- Copy of most recent deed, including legal description, for all affected properties
- Certified survey map or relevant portion of the recorded plat map (if referenced in the legal description) for all affected properties
- County Parcel ID number, if used for county, for all affected properties
- Location Map which outlines all properties within contaminated site boundaries in sufficient detail to permit the parcels to be located easily (8.5x14" if paper copy)
- Detailed Site Map(s) for all affected properties, showing buildings, roads, property boundaries, contaminant sources, utility lines, monitoring wells and potable wells. (8.5x14", if paper copy)
- Tables of Latest Groundwater Analytical Results (no shading or cross-hatching)
- Isoconcentration map(s), if available from site investigation (SI) (8.5x14" if paper copy). The isoconcentration map should have flow direction and extent of contamination defined. If not available, include the following 2 types of maps:
 - Latest groundwater flow/monitoring well location map
 - Latest extent of contaminant plume map

Geologic cross-sections, *if available from SI.* (8.5x14" if paper copy)
RP certified statement that legal descriptions are complete and accurate
Copies of off-source notification letters (if applicable)
Letter informing ROW owner of residual contamination (if applicable)
Copy of (soil or land use) deed restriction(s) or deed notice *if any required as a condition of closure.*

X
X
X

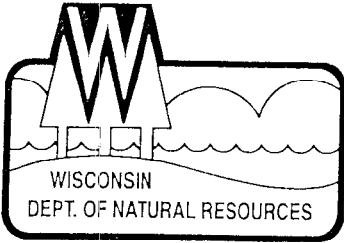

State of Wisconsin \ DEPARTMENT OF NATURAL RESOURCES

Jim Doyle, Governor
Scott Hassett, Secretary
Scott Humrickhouse, Regional Director

Wausau Service Center
5301 Rib Mountain Drive
Wausau, Wisconsin 54401
Telephone 715-359-6514
FAX 715-355-5253

September 9, 2003

BRRTS #03-50-000149

MR WILLIAM ROSZ
AMHERST SUPER SERVICE
108 MAIN STREET
AMHERST WI 54406

FILE COPY

Subject: Case Closure, Amherst Super Service, 108 Main Street, Amherst, Wisconsin

Dear Mr. Rosz:

On April 12, 2001 the Department of Natural Resources reviewed the above-referenced site for closure. The Department reviews environmental remediation cases for compliance with state laws and standards to maintain consistency in the closure of these cases. On May 9, 2001, you were notified that conditional closure was granted.

On July 15, 2003, the Department received correspondence from Villnow Law Office indicating that you have complied with the conditions of closure. Based on the correspondence and data provided, it appears that your case meets the requirements of ch. NR 726, Wis. Adm. Code. The Department considers this case closed and no further investigation, remediation or other action is required at this time.

Your site will be listed on the DNR Remediation and Redevelopment GIS Registry of Closed Remediation Sites. Information that was submitted with the closure request application will be included on the registry.

Please be aware that the case may be reopened pursuant to s. NR 726.09, Wis. Adm. Code, if additional information regarding site conditions indicates that contamination on or from the site poses a threat to public health, safety, or welfare or to the environment.

I appreciate the efforts you have taken to restore the environment at this site. If you have any questions regarding this letter, please contact me at (715) 359-6514.

Sincerely,

Lisa Gutknecht - Project Manager
Remediation & Redevelopment Program

c: Bill Evans, Eau Claire
Lynelle Caine, Northern Environmental
Marty Ringquist, Madison

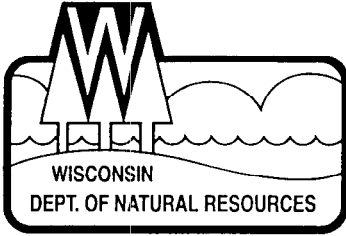

State of Wisconsin \ DEPARTMENT OF NATURAL RESOURCES

Scott McCallum, Governor
Darrell Bazzell, Secretary
Scott A. Humrickhouse, Regional Director

Wausau Office
5301 Rib Mountain Drive
Wausau, Wisconsin 54401
Telephone 715-359-4522
FAX 715-355-5253

May 9, 2001

9
BRRTS #03-50-000146

MR WILLIAM ROSZ
AMHERST SUPER SERVICE
108 MAIN STREET
AMHERST, WI 54406

FILE COPY

Subject: Case Closure, Amherst Super Service, 108 Main Street, Amherst, Wisconsin

Dear Mr. Rosz:

On April 12, 2001, the Amherst Super Service case was reviewed by the West Central Regional Close Out Committee for a determination as to whether or not the case qualified for close out under ch. NR 726, Wis. Adm. Code. Based on the information provided to date, the contamination on the site appears to have been remediated to the extent practicable under site conditions. Your case will be granted closure under s.NR726.05, Wisconsin Administrative Code when the following conditions have been met.

GROUNDWATER USE RESTRICTION A groundwater use restriction which meets the requirements of s.NR 726.05(8)(am), Wis. Adm. Code, must be provided to the Department for approval along with a **copy of the deed for all affected properties**. These properties include your property and the Amherst Telephone property. Upon approval from the Department, the restrictions must be registered with the County Registrar of Deeds within 30 days. Once the Department has received documentation that the restrictions have been recorded and all other conditions for closure have been met, the case will be considered closed. A copy of the groundwater use restriction is attached.

NOTICE OF REMAINING SOIL CONTAMINATION Residual soil contamination remains in the former northern tank location. If the soil is removed in this area, the contaminated soil should be excavated and disposed of properly.

MONITORING WELL ABANDONMENT Monitoring wells MW-200 and MW-500 at the site must be properly abandoned in compliance with s.NR141.25 Wis. Adm. Code. Documentation substantiating proper abandonment (Form 3300-5W) should be forwarded to me at the above address. The Department of Natural Resources would like to use the remainder of the wells to verify the presence of chlorinated compounds from an off site source.

RIGHT-OF-WAY SOIL AND/OR GROUNDWATER CONTAMINATION There is residual soil and/or groundwater contamination in a public street right-of-way. You should provide written notification of the presence of residual soil and/or groundwater contamination to the clerk of the village and county where the right-of-way is located and to the municipal department that maintains the right-of-way. Please provide me with a copy of the written notification.

The groundwater use restriction and the deed notice can be combined into one document. A copy of the combined documents is attached. This case may be reopened pursuant to s. NR726.05 (2)(b) 2-5 or NR726.09 Wisconsin Administrative Code, if additional information regarding site conditions indicates that natural attenuation is no longer an effective remedial action; or if contamination on the site poses a threat to public health, safety, or welfare of the environment.

If you have additional relevant information which was not formerly provided to the Department, and which you feel would significantly impact the Department's closure decision, you may submit that information for our re-evaluation of case closure. I appreciate the actions you and your consultant have undertaken to restore the environment. If you have any questions, please feel free to call me at 715/359-6514.

Sincerely,



Lisa Gutknecht - Project Manager
Remediation & Redevelopment Program

Enclosure

- c: Bill Evans, Eau Claire (w/o enclosure)
Glenn Falkowski, Wausau (w/o enclosure)
Sean Fenrich, Northern Environmental



Document Number

DEED NOTICE AND GROUNDWATER USE RESTRICTION

Register's Office
Portage County, WI
Received For Record

Date: 01/08/2002
Time: 10:00 AM

Cynthia A. Wisinski
Cynthia A. Wisinski, Register of Deeds

Pd: 13.00

Recording Area

Name and Return Address
William Rosz
Amherst Super Service
108 Main Street
Amherst, Wisconsin 54406

In re: That part of the North East Quarter of the South East Quarter of Section 21, and that part of the North West Quarter of the South West Quarter of Section 22, all in Township 23 North, Range 10 East, in the Village of Amherst, Portage County, Wisconsin, described as follows:

Commencing at a point where the north line of Mill Street intersects the east line of Main Street in said Village, thence easterly along the north line of Mill Street 105 feet, thence northerly to a point which is located 75 feet due east of a point located on the section line between Sections 21 and 22, 4 rods north of north line of Mill Street, thence westerly to a point on the east line of Main Street, which is 87 feet northerly from said corner of Mill and Main Streets, thence southerly along the east line of Main Street to the place of beginning.

Declaration of Restrictions

STATE OF WISCONSIN)
) ss
COUNTY OF PORTAGE)

102-23-1022-10.13

Parcel Identification Number (PIN)

WHEREAS, the William B. Rosz and Carol J. Rosz are the owners of the above-described property.

WHEREAS, one or more petroleum discharges have occurred on this property. Petroleum contaminated groundwater above NR 140 enforcement standards existed on this property at the following location on the following date as shown on Attachment 1, identified as Figure 1, hereby attached to and made a part of this document: Benzene concentration of 290 ug/L, toluene of 1400 ug/L, and trimethylbenzene of 700 ug/L at MW700 on September 13, 2000. Petroleum contaminated soil existed on this property at the following locations on the following dates as shown on Attachment 2, identified as Figure 2, hereby attached to and made a part of this document: Field screening results of soil samples collected on April 19, 1999 documented elevated petroleum constituents remaining in the soil near soil samples S11 and S12 collected in the former northern tank location.

WHEREAS, NOTICE IS GIVEN that if the above-described contaminated soil is excavated in the future, it will have to be sampled, analyzed, and disposed of in accordance with applicable statutes and rules, and may be considered a solid or hazardous waste.

WHEREAS, it is the desire and intention of the property owner to impose on the property restrictions which will make it unnecessary to conduct further groundwater or soil remediation activities on the property at the present time.

WHEREAS, natural attenuation has been approved by the Department of Natural Resources to remediate groundwater exceeding ch. NR 140 groundwater standards within the boundaries of this property.

WHEREAS, construction of wells where the water quality exceeds the drinking water standards in ch. NR 809 is restricted by ch. NR 811 and ch. NR 812. Special well construction standards or water treatment requirements, or both, or well construction prohibitions may apply.

NOW THEREFORE, the owner hereby declares that all of the property described above is held and shall be held, conveyed or encumbered, leased, rented, used, occupied and improved subject to the following limitation and restrictions

Anyone who proposes to construct or reconstruct a well on this property is required to contact the Department of Natural Resources' Bureau of Drinking Water and Groundwater, or its successor agency, to determine what specific prohibitions or requirements are applicable, prior to constructing or reconstructing a well on this property. No well may be constructed or reconstructed on this property unless applicable requirements are met.

If construction is proposed on this property that will require dewatering, or if ground water is to be otherwise extracted from this property, while this ground water restriction is in effect, the groundwater shall be sampled and analyzed for contaminants that were previously detected on the property and any extracted groundwater shall be managed in compliance with applicable statutes and rules.

This restriction is hereby declared to be a covenant running with the land and shall be fully binding upon all persons acquiring the above-described property whether by descent, devise, purchase or otherwise. This restriction benefits and is enforceable by, the Wisconsin Department of Natural Resources, its successors and assigns. The Department, its successors or assigns, may initiate proceedings at law or in equity against any person or persons who violate or are proposing to violate this covenant, to prevent the proposed violation or to recover damages for such violation.

Any person who is or becomes owner of the property described above may request that the Wisconsin Department of Natural Resources or its successor issue a determination that the restrictions set forth in this covenant are no longer required. Upon receipt of such a request, the Wisconsin Department of Natural Resources shall determine whether or not the restrictions contained herein can be extinguished. If the Department determines that the restrictions can be extinguished, an affidavit, with a copy of the Department's written determination, may be recorded to give notice that this deed restriction, or portions of this deed restriction are no longer binding.

IN WITNESS WHEREOF, the owners of the property have executed this Declaration of Restrictions, this 3rd day of January, 2001.

Signature: x William B Rosz
Printed Name: William B. Rosz

Signature: x Carol J. Rosz
Printed Name: Carol J. Rosz

Subscribed and sworn to before me
this 3rd day of January, 2001.
[Signature]

Notary Public, State of Wisconsin
My commission is current

This document was drafted by Northern Environmental based on Documents from the Wisconsin Department of Natural Resources.

ations:

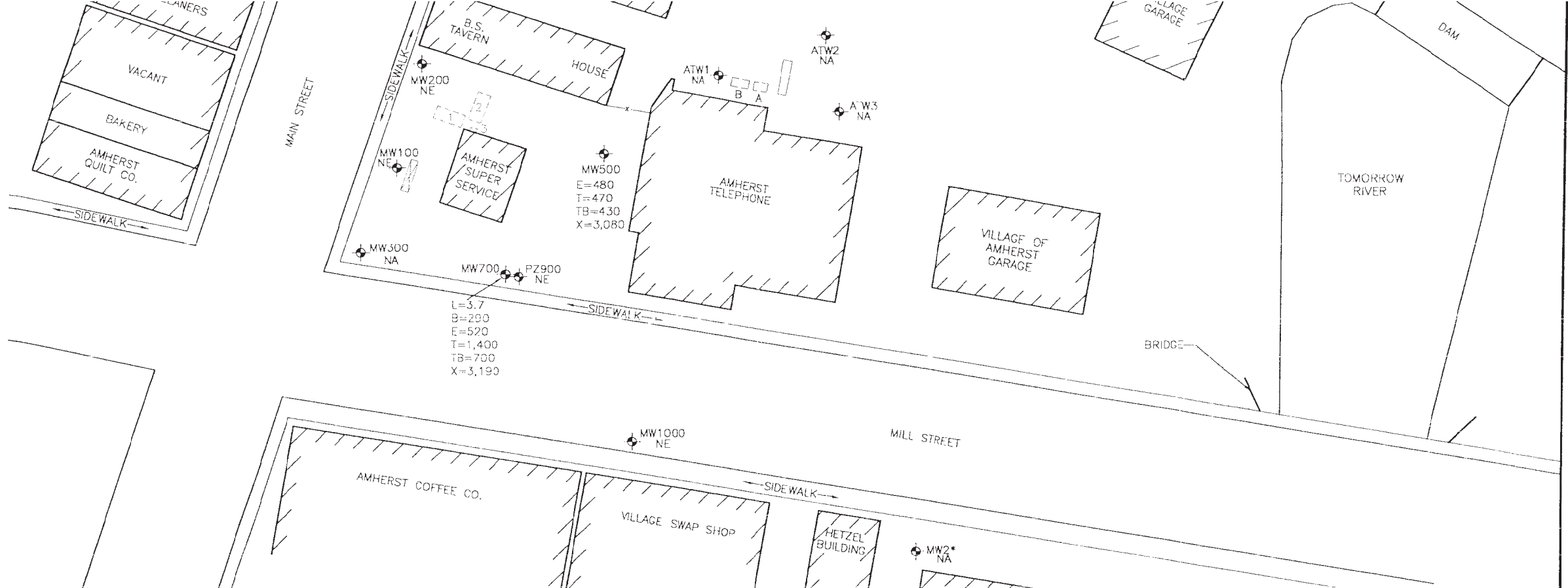

LEGEND

- x — x — FENCE
- MW100 MONITORING WELL LOCATION WITH LEAD (L), BENZENE (B), ETHYLBENZENE (E), TOLLENE (T), TRIMETHYLBENZENE (TB), AND XYLENES (X) IN MICROGRAMS PER LITER (µg/L)
 - L=3.7
 - B=290
 - E=520
 - T=1,400
 - TB=700
 - X=3,190
 - RED = ES EXCEEDANCE
 - RIUF = PAL EXCEEDANCE
 - BLACK = FOR ALL OTHERS
- ATW1 AMHERST TELEPHONE COMPANY WELL LOCATION (INSTALLED BY REMEDIAL ENGINEERING INCORPORATED)
- MW1* MUNICIPAL MONITORING WELL LOCATION (INSTALLED BY FOTH & VAN DYKE)
- ▨ FORMER DISPENSERS
- ▨ FORMER USTs
- 1-2,000 GALLON GASOLINE
- 2-2,000 GALLON GASOLINE
- 3--100 GALLON KEROSENE
- ▨ FORMER AMHERST TELEPHONE COMPANY DISPENSER ISLAND
- ▨ FORMER AMHERST TELEPHONE COMPANY USTs
- A--550 GALLON UNLEADED GASOLINE UST
- B--450 GALLON LEADED GASOLINE UST

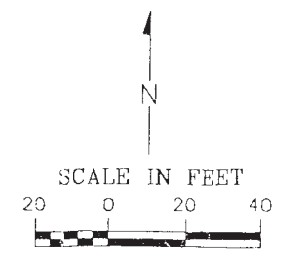

DRAWN BY: KRE	PROJECT: AMH-0669	DATE: 10/05/00
REV. DATE 10/11/00	THIS DRAWING AND ALL INFORMATION CONTAINED THEREON IS THE PROPERTY OF NORTHERN ENVIRONMENTAL INCORPORATED AND SHALL NOT BE COPIED OR USED EXCEPT FOR THE PURPOSE FOR WHICH IT IS EXPRESSLY FURNISHED.	
 Northern Environmental TM Hydrologists • Engineers • Geologists		

MONITORING WELL AND PIEZOMETER LOCATIONS
WITH CONTAMINANT CONCENTRATIONS (9/13/00)
AMHERST SUPER SERVICE
AMHERST, WISCONSIN

FOR: AMHERST SUPER SERVICE

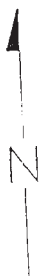
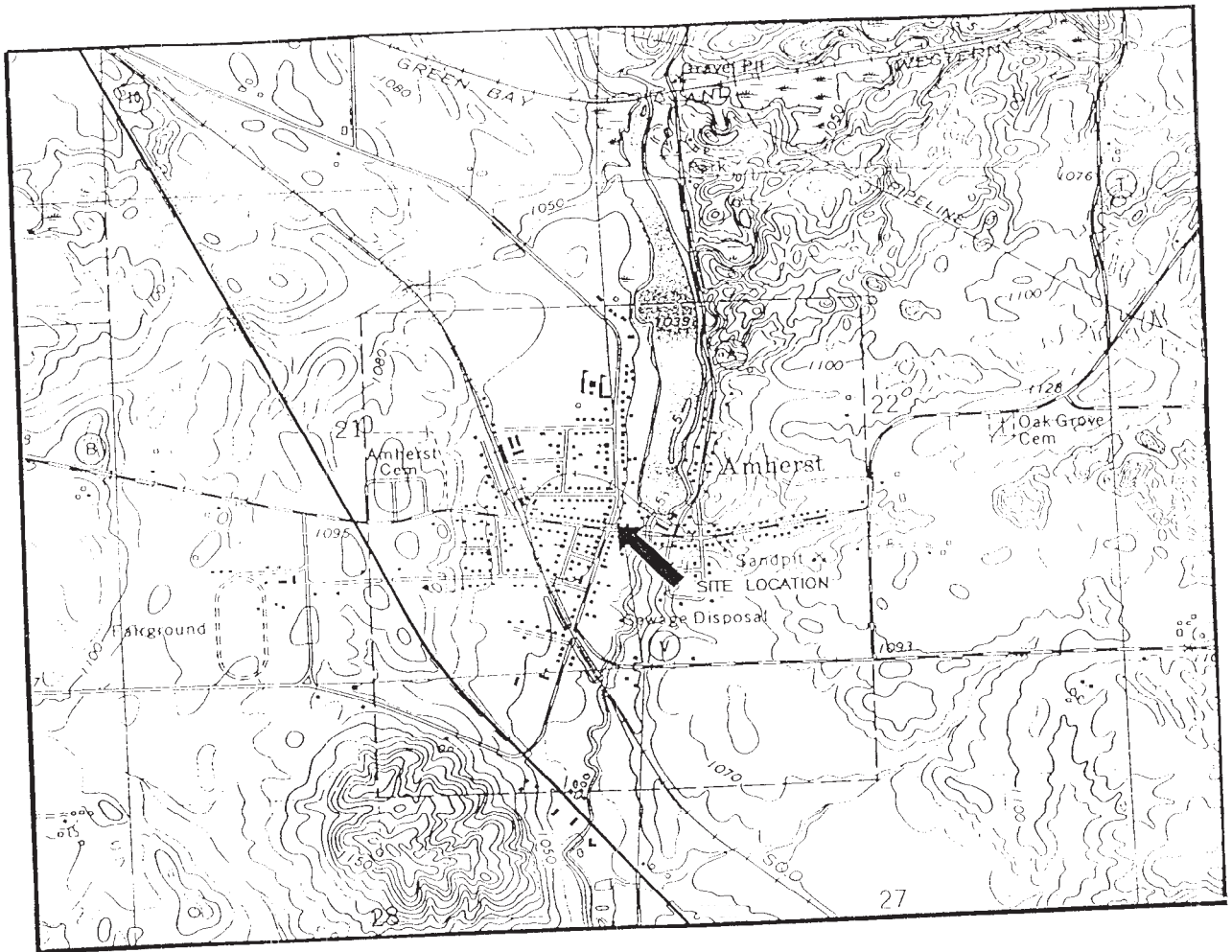

SCALE IN FEET

1" = 2000'



CONTOUR INTERVAL 10 FEET
NATIONAL GEODETIC VERTICAL DATUM OF 1929



QUADRANGLE LOCATION

BASE MAP SOURCE: USGS AMHERST, WISCONSIN 7.5 MINUTE QUADRANGLE (REVISED 1982)

DRAWN BY: TGH PROJECT: AMH330669 DATE: 1/26/98

REV. DATE THIS DRAWING AND ALL INFORMATION CONTAINED THEREON IS THE PROPERTY OF NORTHERN ENVIRONMENTAL INCORPORATED AND SHALL NOT BE COPIED OR USED EXCEPT FOR THE PURPOSE FOR WHICH IT IS EXPRESSLY FURNISHED.

Northern Environmental
Hydrologists • Engineers • Geologists

FIGURE 1
SITE LOCATION AND LOCAL TOPOGRAPHY
AMHERST SUPER STATION
AMHERST, WISCONSIN

FOR: AMHERST SUPER STATION

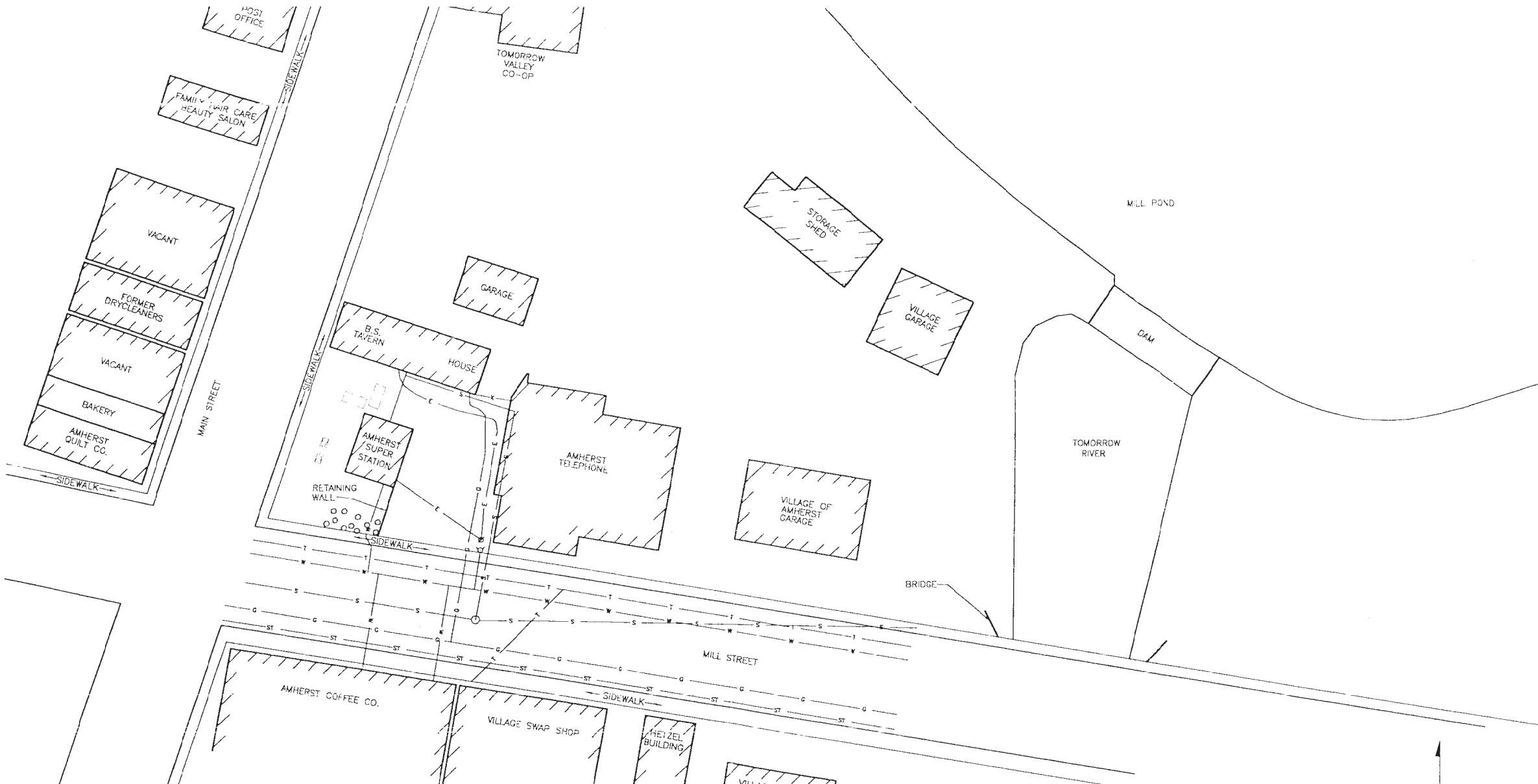

- LEGEND**
- e — OVERHEAD ELECTRIC
 - x - FENCE
 - g - NATURAL GAS LINE
 - s - SANITARY SEWER
 - st - STORM SEWER
 - t - BURIED TELEPHONE LINES
 - w - WATERMAIN
 - ⊙ POWER POLE
 - ⊕ HYDRANT
 - BUSHES
 - FORMER UST LOCATION
 - ▨ FORMER DISPENSER ISLAND LOCATION

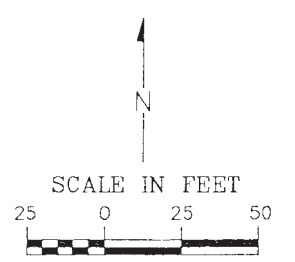

DRAWN BY: JAW	PROJECT: AMH-0669	DATE: 06/23/98
REV. DATE 10/11/00	THIS DRAWING AND ALL INFORMATION CONTAINED THEREON IS THE PROPERTY OF NORTHERN ENVIRONMENTAL INCORPORATED AND SHALL NOT BE COPIED OR USED EXCEPT FOR THE PURPOSE FOR WHICH IT IS EXPRESSLY FURNISHED.	
Northern Environmental TM Hydrologists • Engineers • Geologists		

SITE LAYOUT
AMHERST SUPER SERVICE
AMHERST, WISCONSIN

FOR: AMHERST SUPER SERVICE

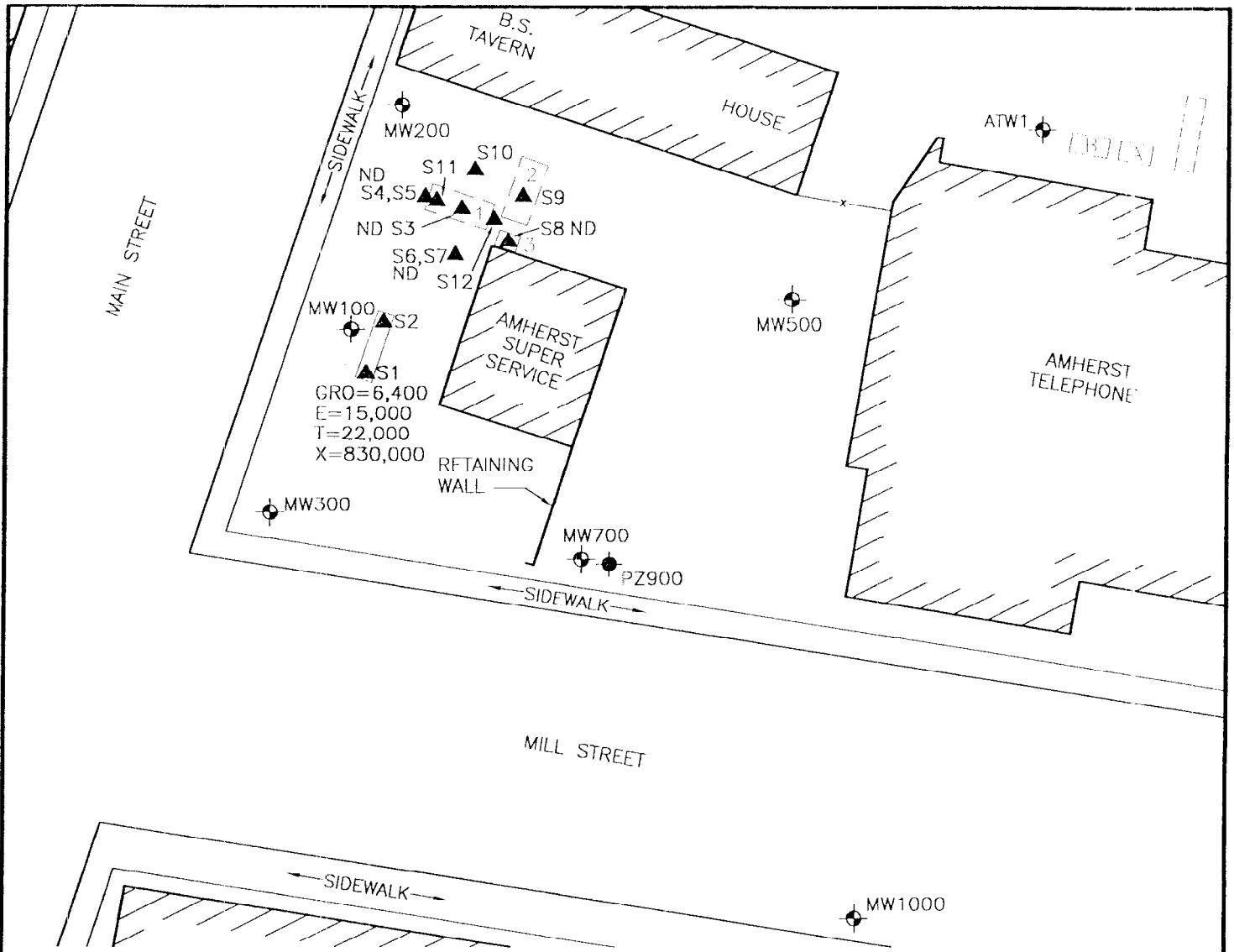

LEGEND

▲S1 GRO=6,400
E=15,000
T=22,000
X=830,000

SOIL SAMPLE LOCATION WITH GRO, ETHYLBENZENE (E), TOLUENE (T), AND XYLENE (X) CONCENTRATIONS
ND = NO PETROLEUM COMPOUNDS DETECTED ABOVE NR720 RCLS OR NR746.06 TABLE 1 OR TABLE 2 VALUES

NOTE: CONTAMINANT CONCENTRATIONS ARE MEASURED IN MICROGRAMS PER KILOGRAM ($\mu\text{g}/\text{kg}$) EXCEPT FOR GRO WHICH IS MEASURED IN MILLIGRAMS PER KILOGRAM (mg/kg)

●PZ900

PIEZOMETER LOCATION

●MW100

MONITORING WELL LOCATION (INSTALLED BY NORTHERN ENVIRONMENTAL)



FORMER AMHERST TELEPHONE COMPANY DISPENSER ISLAND



FORMER AMHERST TELEPHONE COMPANY UST LOCATION
UST A: 550 GALLON UNLEADED GASOLINE
UST B: 450 GALLON LEADED GASOLINE



FENCE



FORMER DISPENSER ISLAND LOCATION



FORMER UST LOCATION
UST 1: 2,000 GALLON GASOLINE
UST 2: 2,000 GALLON GASOLINE
UST 3: 200 GALLON KEROSENE

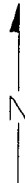

SCALE IN FEET

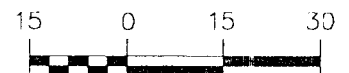

DRAWN BY: KRE PROJECT: AMH-0669 DATE: 10/03/00

REV. DATE

THIS DRAWING AND ALL INFORMATION CONTAINED THEREON IS THE PROPERTY OF NORTHERN ENVIRONMENTAL INCORPORATED AND SHALL NOT BE COPIED OR USED EXCEPT FOR THE PURPOSE FOR WHICH IT IS EXPRESSLY FURNISHED.

SOIL SAMPLE LOCATIONS COLLECTED FOLLOWING REMOVAL OF THE UST SYSTEM
AMHERST SUPER SERVICE
AMHERST, WISCONSIN

Northern EnvironmentalSM
Hydrologists • Engineers • Geologists

FOR: AMHERST SUPER SERVICE

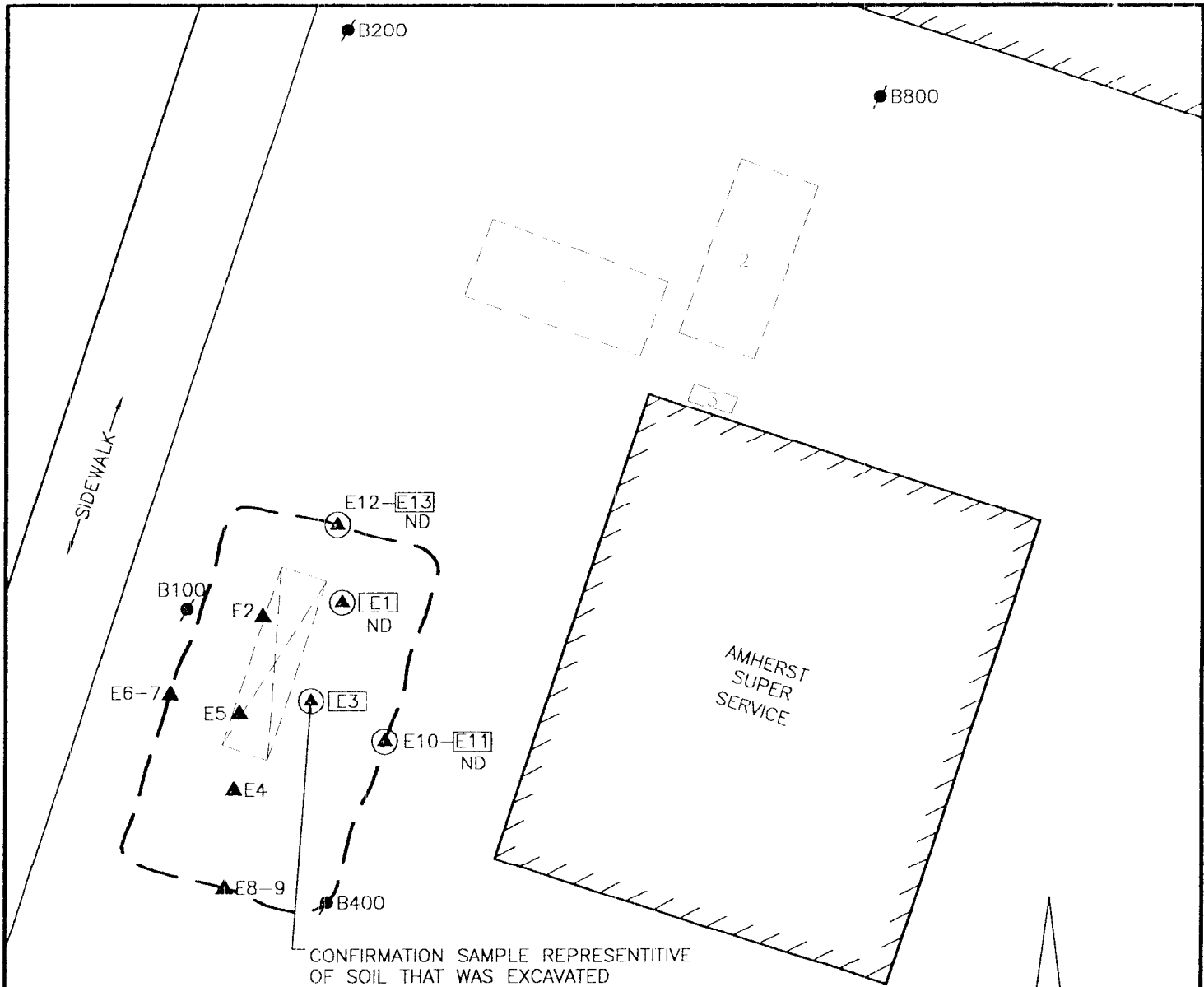

CONFIRMATION SAMPLE REPRESENTATIVE
 OF SOIL THAT WAS EXCAVATED
 ETHYLBENZENE=110,000
 TOLUENE=190,000
 XYLENES=1,109,000

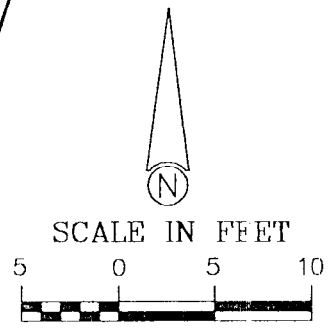

LEGEND

- B300
- ▲ S1 SOIL SAMPLE LOCATION COLLECTED FOR FIELD SCREENING
- ⊙ S92 SOIL SAMPLE LOCATION COLLECTED FOR FIELD SCREENING AND LAB ANALYSIS (ONLY BOXED IN NUMBERS HAVE BEEN SUBMITTED FOR LAB ANALYSIS)
- EXTENT OF REMEDIAL EXCAVATION
- ⊠ FORMER DISPENSER ISLAND LOCATION

ND = NO PETROLEUM COMPOUNDS DETECTED ABOVE NR720 RCLs OR NR746.06 TABLE 1 OR TABLE 2 VALUES
 NOTE: CONTAMINANT CONCENTRATIONS ARE MEASURED IN MICROGRAMS PER KILOGRAMS (µg/kg)
 # FORMER UST LOCATION

S:\PROJ\AMH\14080669\100300-2.DWG

DRAWN BY: KRE PROJECT: AMH-0669 DATE: 10/05/00

REV. DATE
10/10/00

THIS DRAWING AND ALL INFORMATION CONTAINED THEREON IS THE PROPERTY OF NORTHERN ENVIRONMENTAL INCORPORATED AND SHALL NOT BE COPIED OR USED EXCEPT FOR THE PURPOSE FOR WHICH IT IS EXPRESSLY FURNISHED.

Northern EnvironmentalSM
 Hydrologists · Engineers · Geologists

AMHERST SUPER SERVICE
 AMHERST, WISCONSIN

EXTENT OF REMEDIAL EXCAVATION
 AND SOIL SAMPLE LOCATIONS

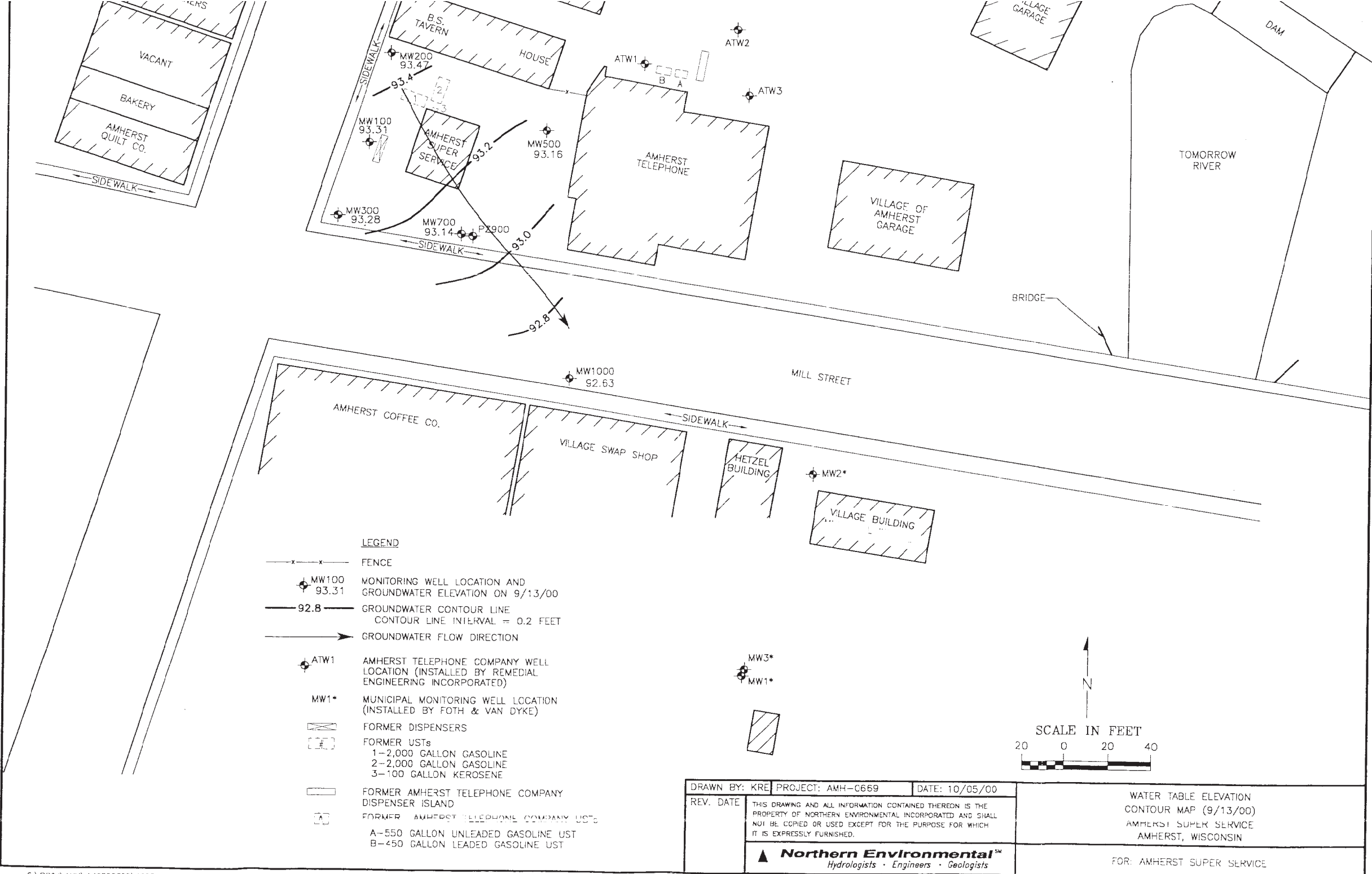

LEGEND

- x — x — FENCE
- ⊕ MW100 93.31 MONITORING WELL LOCATION AND GROUNDWATER ELEVATION ON 9/13/00
- 92.8 — GROUNDWATER CONTOUR LINE
CONTOUR LINE INTERVAL = 0.2 FEET
- GROUNDWATER FLOW DIRECTION
- ⊕ ATW1 AMHERST TELEPHONE COMPANY WELL LOCATION (INSTALLED BY REMEDIAL ENGINEERING INCORPORATED)
- ⊕ MW1* MUNICIPAL MONITORING WELL LOCATION (INSTALLED BY FOTH & VAN DYKE)
- ▨ FORMER DISPENSERS
- ▩ FORMER USTs
1-2,000 GALLON GASOLINE
2-2,000 GALLON GASOLINE
3-100 GALLON KEROSENE
- ▭ FORMER AMHERST TELEPHONE COMPANY DISPENSER ISLAND
- ⊕ A FORMER AMHERST TELEPHONE COMPANY USTs
A-550 GALLON UNLEADED GASOLINE UST
B-450 GALLON LEADED GASOLINE UST

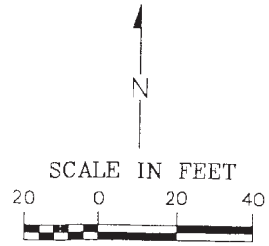

DRAWN BY: KRE	PROJECT: AMH-C669	DATE: 10/05/00	<p>WATER TABLE ELEVATION CONTOUR MAP (9/13/00) AMHERST SUPER SERVICE AMHERST, WISCONSIN</p>
REV. DATE	<p>THIS DRAWING AND ALL INFORMATION CONTAINED THEREON IS THE PROPERTY OF NORTHERN ENVIRONMENTAL INCORPORATED AND SHALL NOT BE COPIED OR USED EXCEPT FOR THE PURPOSE FOR WHICH IT IS EXPRESSLY FURNISHED.</p>		
<p>Northern EnvironmentalSM Hydrologists • Engineers • Geologists</p>			<p>FOR: AMHERST SUPER SERVICE</p>

A
 MW100
 GE: 102.65
 RE: 102.15
 WE: 93.75

MW700/PZ900
 GE: 99.99
 RE: 103.17 RE: 102.51
 WE: 93.42

A'
 MW1000
 GE: 97.42
 RE: 97.42
 WE: 92.96

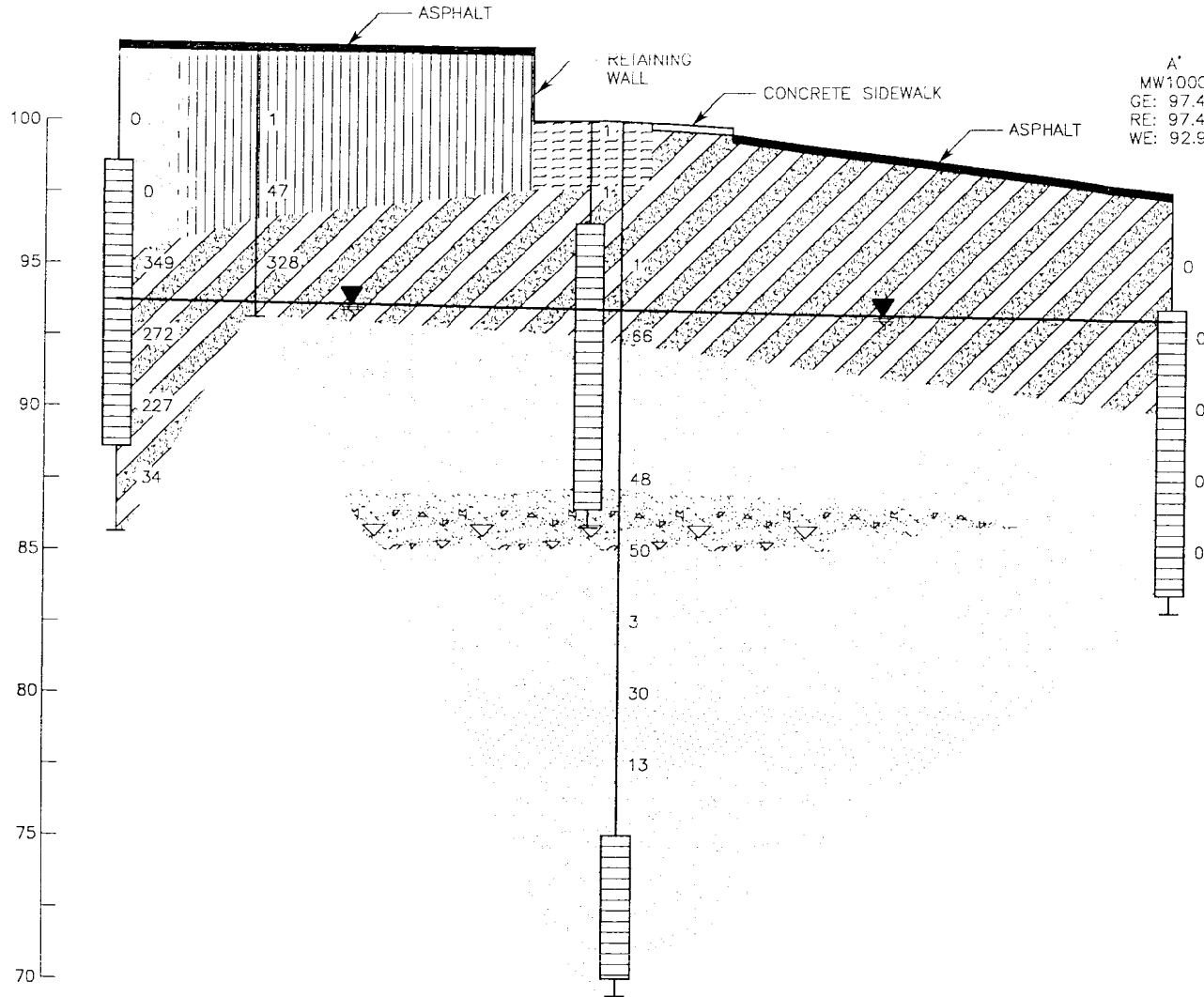

CROSS SECTION KEY

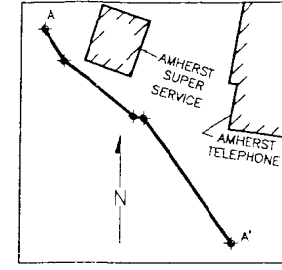

LEGEND

- 66 PID RESULT
 PID = PHOTOIONIZATION DETECTOR READING
 MEASURED IN INSTRUMENT UNITS AS
 ISOBUTYLENE (iw)
 GE = GROUND ELEVATION (IN FEET)
 RE = RISER ELEVATION (IN FEET)
 WE = GROUND WATER ELEVATION (IN FEET)
 ▽ WATER TABLE ELEVATION (8/13/98)
- TOPSOIL
 - SP = POORLY GRADED SANDS
 - SM = SILTY SANDS
 - GW = WELL GRADED GRAVELS
 - ML = INORGANIC SILTS
 - SW = WELL GRADED SANDS

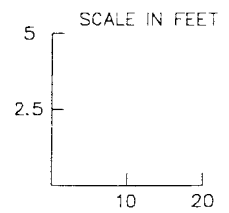

NOTE:
 *ELEVATIONS REFERENCE TO SITE DATUM
 *COLUMN WIDTHS ARE NOT TO SCALE

DRAWN BY: SXM	PROJECT: AMH-0669	DATE:	GEOLOGIC CROSS SECTION A-A' AMHERST SUPER SERVICE AMHERST, WISCONSIN
REV. DATE 10/05/00	THIS DRAWING AND ALL INFORMATION CONTAINED THEREON IS THE PROPERTY OF NORTHERN ENVIRONMENTAL INCORPORATED AND SHALL NOT BE COPIED OR USED EXCEPT FOR THE PURPOSE FOR WHICH IT IS EXPRESSLY FURNISHED.		
Northern Environmental Hydrologists · Engineers · Geologists			FGR: AMHERST SUPER SERVICE

Site Investigation Soil Field Screening Results, Amherst Super Service, Amherst, Wisconsin

Boring Number	Sample Label	Depth (feet)	Petroleum Odor	Sample Description	Date Collected	PID Headspace Analysis		
						Time Collected	Time Analyzed	PID Response (iui)
	S1*	3.5	Strong	Sand	04/19/99	1250	1359	799
	S2	2	None	Sand	04/19/99	1300	1400	24
	S3*	8	Strong	Sand	04/19/99	1340	1456	349
	S4*	3.5	None	Sand	04/19/99	1341	1456	30
	S5	6	None	Sand	04/19/99	1342	1456	28
	S6*	3.5	None	Sand	04/19/99	1343	1457	11
	S7	6	None	Sand	04/19/99	1344	1457	10
	S8*	4	None	Sand	04/19/99	1412	1457	1
	S9	8	None	Sand	04/19/99	1524	1631	16
	S10	3	None	Sand	04/19/99	1540	1631	0
	S11	9	Strong	Sand	04/19/99	1346	1458	623
	S12	3	Strong	Sand	04/19/99	1600	1631	235

Note:

- PID = photoionization detector
- iui = instrument units as isobutylene
- * = submitted for laboratory analysis
- = not analyzed

Water Level Data, Amherst Super Service, Amherst, Wisconsin

Well I.D.	Ground Surface Elevation (feet)	Reference Point Elevation (feet)	Date	Depth to Water (feet)		Water Table Elevation (feet)
				Below Riser	Below Grade	
MW100	102.65	102.15	02/17/98	8.83	9.33	93.32
			03/06/98	8.42	8.92	93.73
			04/20/98	8.22	8.72	93.93
			05/06/98	8.65	9.15	93.50
			05/27/98	8.67	9.17	93.48
			08/13/98	8.40	8.90	93.75
			02/16/99	8.85	9.35	93.30
			06/29/99	9.04	9.54	93.11
			04/05/00	9.34	9.84	92.81
			09/13/00	8.84	9.34	93.31
MW200	102.61	102.36	02/17/98	8.95	9.20	93.41
			03/06/98	8.54	8.79	93.82
			04/20/98	8.36	8.61	94.00
			05/06/98	8.80	9.05	93.56
			05/27/98	8.81	9.06	93.55
			08/13/98	8.51	8.76	93.85
			02/16/99	8.98	9.23	93.38
			06/29/99	9.15	9.40	93.21
			04/05/00	9.45	9.70	92.91
			09/13/00	8.89	9.14	93.47
MW300	102.50	101.97	02/17/98	8.64	9.17	93.33
			03/06/98	8.36	8.89	93.61
			04/20/98	8.16	8.69	93.81
			05/06/98	8.59	9.12	93.38
			05/27/98	8.60	9.13	93.37
			08/13/98	8.34	8.87	93.63
			02/16/99	8.78	9.31	93.19
			06/29/99	8.98	9.51	92.99
			04/05/00	9.24	9.77	92.73
			09/13/00	8.69	9.22	93.28

Water Level Data, Amherst Super Service, Amherst, Wisconsin

Well I.D.	Ground Surface Elevation (feet)	Reference Point Elevation (feet)	Date	Depth to Water (feet)		Water Table Elevation (feet)
				Below Riser	Below Grade	
MW500	99.50	102.05	02/17/98	8.88	6.33	93.17
			03/06/98	8.58	6.03	93.47
			04/20/98	8.38	5.83	93.67
			05/06/98	8.85	6.30	93.20
			05/27/98	8.85	6.30	93.20
			08/13/98	8.58	6.03	93.47
			02/16/99	8.97	6.42	93.08
			06/29/99	9.16	6.61	92.89
			04/05/00	9.46	6.91	92.59
			09/13/00	8.89	6.34	93.16
MW700	99.99	103.17	02/17/98	9.92	6.74	93.25
			03/06/98	9.73	6.55	93.44
			04/20/98	9.58	6.40	93.59
			05/06/98	10.05	6.87	93.12
			05/27/98	10.03	6.85	93.14
			08/13/98	9.75	6.57	93.42
			02/16/99	10.16	6.98	93.01
			06/29/99	10.36	7.18	92.81
			04/05/00	10.64	7.46	92.53
			09/13/00	10.03	6.85	93.14
PZ900	99.99	102.51	05/06/98	9.17	6.65	93.34
			05/27/98	9.37	6.85	93.14
			08/13/98	9.10	6.58	93.41
			02/16/99	9.53	7.01	92.98
			06/29/99	9.72	7.20	92.79
			04/05/00	9.98	7.46	92.53
			09/13/00	9.42	6.90	93.09

Water Level Data, Amherst Super Service, Amherst, Wisconsin

Well I.D.	Ground Surface Elevation (feet)	Reference Point Elevation (feet)	Date	Depth to Water (feet)		Water Table Elevation (feet)
				Below Riser	Below Grade	
MW1000	97.42	97.17	05/06/98	4.24	4.49	92.93
			05/27/98	4.45	4.70	92.72
			08/13/98	4.21	4.46	92.96
			02/16/99	4.78	5.03	92.39
			06/29/99	4.90	5.15	92.27
			04/05/00	5.15	5.40	92.02
			09/13/00	4.54	4.79	92.63
MW1	94.53	97.26	05/06/98	5.19	2.46	92.07
			05/27/98	5.40	2.67	91.86
			08/13/98	5.20	2.47	92.06
MW2	95.17	96.84	05/06/98	4.69	3.02	92.15
			05/27/98	5.88	4.21	90.96
			08/13/98	4.69	3.02	92.15
MW3	94.53	97.13	05/06/98	5.05	2.45	92.08
			05/27/98	6.27	3.67	90.86
			08/13/98	5.05	2.45	92.08
ATW1	98.45	98.37	05/06/98	5.04	5.12	93.33
			08/13/98	4.91	4.99	93.46
ATW2	98.10	97.92	05/06/98	4.66	4.84	93.26
ATW3	97.72	97.50	05/06/98	4.40	4.62	93.10

Ground-Water Analytical Results, Amherst Super Service, Amherst, Wisconsin

Well ID	Date Sampled	Relevant and Significant Analytical Results (µg/l)															
		DRO	GRO	Lead	Benzene	n-Butylbenzene	sec-Butylbenzene	Ethylbenzene	Isopropylbenzene	p-Isopropyltoluene	MTBE	Naphthalene	n-Propylbenzene	Tetrachloroethene	Toluene	Trimethylbenzenes	Xylenes
WAC PAL (µg/l)		NE	NE	1.5	0.5	NE	NE	140	NE	NE	12	8	NE	0.5	200	96	1000
WAC ES (µg/l)		NE	NE	15	5	NE	NE	700	NE	NE	60	40	NE	5	1000	480	10000
MW100	02/17/98	---	3000	< 1	0.22 "J"	170	9.3	10	5	< 0.37	< 0.21	27	20	7.4	4.4	690	392
	05/06/98	---	---	---	< 0.32	---	---	0.35 "J"	---	---	< 0.31	< 0.88	---	---	< 0.35	13	5.2
	08/13/98	---	---	---	< 0.32	---	---	0.35 "J"	---	---	< 0.31	< 0.88	---	---	< 0.35	4.2	< 1
	11/19/98	---	---	---	< 0.32	---	---	< 0.34	---	---	< 0.31	< 0.88	---	---	< 0.35	< 0.99	< 1
	02/16/99	---	---	---	< 0.32	---	---	< 0.34	---	---	< 0.31	< 0.88	---	---	< 0.35	< 0.99	< 1
	06/29/99	---	---	---	< 0.32	---	---	< 0.34	---	---	< 0.31	< 0.88	---	---	< 0.35	< 0.99	< 1
	04/05/00	---	---	---	< 0.39	---	---	< 0.4	---	---	< 0.47	---	---	---	< 0.37	< 0.1.03	< 1.4
	09/13/00	---	---	---	< 0.50	---	---	< 0.50	---	---	< 0.40	---	---	---	< 0.50	< 1	< 1.50
MW200	02/17/98	< 100	< 100	< 1	< 0.21	< 0.38	< 0.6	< 0.68	< 0.38	< 0.37	< 0.21	< 1	< 0.4	< 0.13	< 1.5	< 1.86	< 1.78
	05/06/98	---	---	---	< 0.32	---	---	< 0.34	---	---	< 0.31	< 0.88	---	---	< 0.35	< 0.99	< 1
	08/13/98	---	---	---	< 0.32	---	---	< 0.34	---	---	< 0.31	< 0.88	---	---	< 0.35	< 0.99	< 1
	11/19/98	---	---	---	< 0.32	---	---	< 0.34	---	---	< 0.31	< 0.88	---	---	< 0.35	< 0.99	< 1
	02/16/99	---	---	---	< 0.32	---	---	< 0.34	---	---	< 0.31	< 0.88	---	---	< 0.35	< 0.99	< 1
	06/29/99	---	---	---	< 0.32	---	---	< 0.34	---	---	< 0.31	< 0.88	---	---	< 0.35	< 0.99	< 1
	04/05/00	---	---	---	< 0.39	---	---	< 0.4	---	---	< 0.47	---	---	---	< 0.37	< 0.1.03	< 1.4
	09/13/00	---	---	---	< 0.50	---	---	< 0.50	---	---	< 0.40	---	---	---	< 0.50	< 1	< 1.50
MW300	02/17/98	---	< 100	< 1	< 0.21	< 0.38	< 0.6	< 0.68	< 0.38	< 0.37	< 0.21	< 1	< 0.4	0.33 "J"	< 1.5	< 1.86	< 1.78
	05/06/98	---	---	---	< 0.32	---	---	< 0.34	---	---	< 0.31	< 0.88	---	---	< 0.35	< 0.99	< 1
	08/13/98	---	---	---	< 0.32	---	---	< 0.34	---	---	< 0.31	< 0.88	---	---	< 0.35	< 0.99	< 1
MW500	02/17/98	1400	13000	2 "J"	67	78	20	700	30	20	< 4.2	120	43	< 2.6	1200	780	5500
	05/06/98	---	---	---	35	---	---	650	---	---	< 3.1	110	---	---	540	690	4200
	08/13/98	---	---	---	63	---	---	480	---	---	< 3.1	100	---	---	1100	470	3600
	11/19/98	---	---	---	130	---	---	620	---	---	< 3.1	120	---	---	2600	650	4500
	02/16/99	---	---	---	55	---	---	640	---	---	< 6.2	120	---	---	2500	560	4200
	06/29/99	---	---	---	70	---	---	800	---	---	< 3.1	120	---	---	2600	610	5500
	04/05/00	---	---	---	50	---	---	690	---	---	< 4.7	140	---	---	1100	550	4200
	09/13/00	---	---	---	< 25	---	---	480	---	---	< 20	< 50	---	---	470	430	5080
MW700	02/17/98	1400	8600	26	270	75	< 30	490	33	< 19	< 11	110 "J"	100	< 6.5	1200	1050	3800
	05/06/98	---	---	---	290	---	---	690	---	---	< 3.1	110	---	---	1600	1220	3700
	08/13/98	---	---	---	35	750	---	780	---	---	< 3.1	160	---	---	2500	1570	4200
	11/19/98	---	---	---	19	800	---	900	---	---	< 3.1	210	---	---	2200	2060	3100
	02/16/99	---	---	---	---	540	---	600	---	---	< 6.2	170	---	---	1700	1540	3400
	06/29/99	---	---	---	12	250	---	470	---	---	< 3.1	120	---	---	1100	1060	4400
	04/05/00	---	---	---	---	490	---	910	---	---	< 4.7	200	---	---	2800	1490	4500
	09/13/00	---	---	---	37	290	---	620	---	---	< 20	< 50	---	---	1400	790	3100

Key:
 GRO = Gasoline Range Organics
 DRO = Diesel Range Organics
 MTBE = Methyl-Tertiary-Butyl-Ether
 µg/l = micrograms per liter
 WAC = Wisconsin Administrative Code
 PAL = Preventive Action Limit
 ES = Enforcement Standard
 NE = Not established by WAC
 "J" = Analyte detected between Limit of Detection and Limit of Quantitation
 --- = Not analyzed
 ND = Not detected
 132 = WAC Preventive Action Limit Exceeded
 32 = WAC Enforcement Standard Exceeded

Ground-Water Analytical Results, Amherst Super Service, Amherst, Wisconsin

Well ID	Date Sampled	Relevant and Significant Analytical Results (µg/l)															
		DRO	CRO	Lead	Benzene	n-Butylbenzene	sec-Butylbenzene	Ethylbenzene	Isopropylbenzene	p-Isopropyltoluene	MTBE	Naphthalene	n-Propylbenzene	Tetrachloroethene	Toluene	Trimehylbenzenes	Xylenes
WAC PAL (µg/l)		NE	NE	1.5	0.5	NE	NE	140	NE	NE	12	8	NE	0.5	200	96	1000
WAC ES (µg/l)		NE	NE	15	5	NE	NE	700	NE	NE	60	40	NE	5	1000	480	10000
PZ900	05/06/98	<100	<100	<1.0	<0.32	<0.23	<0.34	<0.34	<0.34	<0.31	<0.31	<0.88	<0.3	<0.35	<0.35	0.64 "J"	1.7 "J"
	09/13/98	---	---	---	<0.32	---	---	<0.34	---	---	<0.31	<0.88	---	---	<0.35	<0.99	<1
	09/13/00	---	---	---	<0.50	---	---	<0.50	---	---	<0.40	---	---	---	<0.50	<1	<1.50
MW1000	05/06/98	<100	<100	<1.0	<0.32	<0.23	<0.34	<0.34	<0.34	<0.31	<0.31	<0.88	<0.3	8.9	<0.35	0.43 "J"	<0.98
	03/13/98	---	---	---	<0.32	---	---	<0.34	---	---	<0.31	<0.88	---	---	<0.35	<0.99	<1
	11/19/98	---	---	---	<0.32	---	---	<0.34	---	---	<0.31	<0.88	---	---	<0.35	<0.99	<1
	02/16/99	---	---	---	<0.32	---	---	<0.34	---	---	<0.31	<0.88	---	---	<0.35	<0.99	<1
	06/29/99	---	---	---	<0.32	---	---	<0.34	---	---	<0.31	<0.88	---	---	<0.35	<0.99	<1
	04/05/00	---	---	---	<0.39	---	---	<0.4	---	---	<0.47	---	---	---	<0.37	<0.1.03	<1.4
	09/13/00	---	---	---	<0.50	---	---	<0.50	---	---	<0.40	---	---	---	<0.50	<1	<1.50
MW1	05/06/98	---	---	---	3.6	---	---	<0.34	---	---	<0.31	---	---	---	<0.35	<0.99	<1
	08/13/98	---	---	---	<0.32	---	---	<0.34	---	---	<0.31	<0.88	---	---	<0.35	<0.99	<1
MW2	05/06/98	---	---	---	<0.32	---	---	<0.34	---	---	<0.31	---	---	---	<0.35	<0.99	<1
MW3	05/06/98	---	---	---	<0.32	---	---	<0.34	---	---	<0.31	---	---	---	<0.35	<0.99	<1
	08/13/98	---	---	---	<0.32	---	---	<0.34	---	---	<0.31	<0.88	---	---	<0.35	<0.99	<1
ATW1	05/06/98	---	---	---	ND	---	---	ND	---	---	ND	---	---	---	ND	ND	ND
	08/13/98	---	---	---	<0.32	---	---	<0.34	---	---	<0.31	<0.88	---	---	<0.35	0.48 "J"	<1
ATW2	05/06/98	---	---	---	ND	---	---	ND	---	110	---	---	---	---	ND	ND	ND
ATW3	05/06/98	---	---	---	ND	---	---	ND	---	14	---	---	---	---	ND	ND	ND
Municipal Well #2	08/13/98	---	---	---	<0.32	<0.23	<0.34	<0.34	<0.34	<0.31	<0.31	<0.88	<0.3	<0.35	<0.35	<0.99	<0.98



954 Circle Drive
Green Bay, WI 54304
920-592-8400
1-800-854-0606
Fax • 920-592-8444
E-mail • netigb@admin.itol.com

August 7, 2001
(AMH-03-1408-0669)

Mr. Bill Weronke
Portage County Highway Commissioner
800 Plover Road
Plover, Wisconsin 54467

RECEIVED

AUG 08 2001

WAUSAU DNR

RE: Notification of Potential for Remaining Petroleum Contamination in Mill Street (CTY HWY B)
Right-of-way, adjacent to 108 Main Street, Amherst, Wisconsin 54406;
WDNR BRRTS # 03-50-000149

Dear Mr. Weronke:

Per the request of the Wisconsin Department of Natural Resources (WDNR), Northern Environmental Technologies, Incorporated (Northern Environmental) is submitting a notification to the Village of Amherst that petroleum contaminated soil and/or ground water may exist beneath Mill Street (County Highway B), adjacent to 108 Main Street, Amherst, Wisconsin (the Site).

Based on results of a remedial investigation completed at the Site, petroleum impacted ground water may have migrated beneath Mill Street (County Highway B) with ground-water flow. Precautions may need to be taken when excavating or dewatering this area in the future. Soil and monitoring well location maps, tables summarizing soil and ground-water sampling results, and a copy of the WDNR case closure letter are included with this notification.

Per WDNR requirements to indicate that you are aware of the potential of petroleum impacted soil and/or ground water beneath Mill Street (County Highway B) and that precautions may need to be taken when excavating or exposing this area in the future, please sign and date the attached statement. Please return the signed statement to Northern Environmental in the enclosed envelope. We trust this information meets your needs. If you have any questions or concerns regarding the remaining petroleum contamination, please feel free to call Northern Environmental at (920) 592-8400.

Sincerely,
**Northern Environmental
Technologies, Incorporated**

Lynelle Caine
Project Manager

Michael B. Roznowski
District Director

LPC/hmo
Enclosures

c: Ms. Marcy Peterson, Village Clerk, 161 Mill Street, P.O. Box 36, Amherst, WI 54406
Mr. Roger Wrycza, County Clerk, 1516 Church Street, Stevens Point, WI 54481
Ms. Lisa Gutknecht, WDNR