

This Adobe Fillable form is intended to provide a list of information that is required for evaluation for case closure. It is to be used in conjunction with Form 4400-202, Case Closure Request. The closure of a case means that the Department has determined that no further response is required at that time based on the information that has been submitted to the Department.

NOTICE: Completion of this form is mandatory for applications for case closure pursuant to ch. 292, Wis. Stats. and ch. NR 726, Wis. Adm. Code, including cases closed under ch. NR 746 and ch. NR 726. The Department will not consider, or act upon your application, unless all applicable sections are completed on this form and the closure fee and any other applicable fees, required under ch. NR 749, Wis. Adm. Code, Table 1 are included. It is not the Department's intention to use any personally identifiable information from this form for any purpose other than reviewing closure requests and determining the need for additional response action. The Department may provide this information to requesters as required by Wisconsin's Open Records law [ss. 19.31 - 19.39, Wis. Stats.].

BRRTS #:	03-03-000273 (No Dashes)	PARCEL ID #:	
ACTIVITY NAME:	DAVIS AUTO BODY	WTM COORDINATES: X:	352144 Y: 549462

CLOSURE DOCUMENTS (the Department adds these items to the final GIS packet for posting on the Registry)

- Closure Letter**
- Maintenance Plan** (if activity is closed with a land use limitation or condition (land use control) under s. 292.12, Wis. Stats.)
- Continuing Obligation Cover Letter** (for property owners affected by residual contamination and/or continuing obligations)
- Conditional Closure Letter**
- Certificate of Completion (COC)** (for VPLE sites)

SOURCE LEGAL DOCUMENTS

- Deed:** The most recent deed as well as legal descriptions, for the **Source Property** (where the contamination originated). Deeds for other, off-source (off-site) properties are located in the **Notification** section.
Note: If a property has been purchased with a land contract and the purchaser has not yet received a deed, a copy of the land contract which includes the legal description shall be submitted instead of the most recent deed. If the property has been inherited, written documentation of the property transfer should be submitted along with the most recent deed.
- Certified Survey Map:** A copy of the certified survey map or the relevant section of the recorded plat map for those properties where the legal description in the most recent deed refers to a certified survey map or a recorded plat map. (lots on subdivided or platted property (e.g. lot 2 of xyz subdivision)).
Figure #: **Title:**
- Signed Statement:** A statement signed by the Responsible Party (RP), which states that he or she believes that the attached legal description accurately describes the correct contaminated property.

MAPS (meeting the visual aid requirements of s. NR 716.15(2)(h))

- Maps must be no larger than 11 x 17 inches unless the map is submitted electronically.
- Location Map:** A map outlining all properties within the contaminated site boundaries on a U.S.G.S. topographic map or plat map in sufficient detail to permit easy location of all parcels. If groundwater standards are exceeded, include the location of all potable wells within 1200 feet of the site.
Note: Due to security reasons municipal wells are not identified on GIS Packet maps. However, the locations of these municipal wells must be identified on Case Closure Request maps.
Figure #: **Title:**
 - Detailed Site Map:** A map that shows all relevant features (buildings, roads, individual property boundaries, contaminant sources, utility lines, monitoring wells and potable wells) within the contaminated area. This map is to show the location of all contaminated public streets, and highway and railroad rights-of-way in relation to the source property and in relation to the boundaries of groundwater contamination exceeding a ch. NR 140 Enforcement Standard (ES), and/or in relation to the boundaries of soil contamination exceeding a Residual Contaminant Level (RCL) or a Site Specific Residual Contaminant Levels (SSRCL) as determined under s. NR 720.09, 720.11 and 720.19.
Figure #: **Title:**
 - Soil Contamination Contour Map:** For sites closing with residual soil contamination, this map is to show the location of all contaminated soil and a single contour showing the horizontal extent of each area of contiguous residual soil contamination that exceeds a Residual Contaminant Level (RCL) or a Site Specific Residual Contaminant Level (SSRCL) as determined under s. NR 720.09, 720.11 and 720.19.
Figure #: **Title:**

BRRTS #: 03-03-000273

ACTIVITY NAME: DAVIS AUTO BODY

MAPS (continued)

- Geologic Cross-Section Map:** A map showing the source location and vertical extent of residual soil contamination exceeding a Residual Contaminant Level (RCL) or a Site Specific Residual Contaminant Level (SSRCL). If groundwater contamination exceeds a ch. NR 140 Enforcement Standard (ES) when closure is requested, show the source location and vertical extent, water table and piezometric elevations, and locations and elevations of geologic units, bedrock and confining units, if any.

Figure #: **Title:**

Figure #: **Title:**

- Groundwater Isoconcentration Map:** For sites closing with residual groundwater contamination, this map shows the horizontal extent of all groundwater contamination exceeding a ch. NR140 Preventive Action Limit (PAL) and an Enforcement Standard (ES). Indicate the direction and date of groundwater flow, based on the most recent sampling data.

Note: This is intended to show the total area of contaminated groundwater.

Figure #: **Title:**

- Groundwater Flow Direction Map:** A map that represents groundwater movement at the site. If the flow direction varies by more than 20° over the history of the site, submit 2 groundwater flow maps showing the maximum variation in flow direction.

Figure #: **Title:**

Figure #: **Title:**

TABLES (meeting the requirements of s. NR 716.15(2)(h)(3))

Tables must be no larger than 11 x 17 inches unless the table is submitted electronically. Tables must not contain shading and/or cross-hatching. The use of **BOLD** or *ITALICS* is acceptable.

- Soil Analytical Table:** A table showing remaining soil contamination with analytical results and collection dates.
Note: This is one table of results for the contaminants of concern. Contaminants of concern are those that were found during the site investigation, that remain after remediation. It may be necessary to create a new table to meet this requirement.

Table #: **Title:**

- Groundwater Analytical Table:** Table(s) that show the most recent analytical results and collection dates, for all monitoring wells and any potable wells for which samples have been collected.

Table #: **Title:**

- Water Level Elevations:** Table(s) that show the previous four (at minimum) water level elevation measurements/dates from all monitoring wells. If present, free product is to be noted on the table.

Table #: **Title:**

IMPROPERLY ABANDONED MONITORING WELLS

For each monitoring well not properly abandoned according to requirements of s. NR 141.25 include the following documents.

Note: If the site is being listed on the GIS Registry for only an improperly abandoned monitoring well you will only need to submit the documents in this section for the GIS Registry Packet.

- Not Applicable**

- Site Location Map:** A map showing all surveyed monitoring wells with specific identification of the monitoring wells which have not been properly abandoned.

Note: If the applicable monitoring wells are distinctly identified on the Detailed Site Map this Site Location Map is not needed.

Figure #: **Title:**

- Well Construction Report:** Form 4440-113A for the applicable monitoring wells.

- Deed:** The most recent deed as well as legal descriptions for each property where a monitoring well was not properly abandoned.

- Notification Letter:** Copy of the notification letter to the affected property owner(s).

BRRTS #: 03-03-000273

ACTIVITY NAME: DAVIS AUTO BODY

NOTIFICATIONS

Source Property

Not Applicable

Letter To Current Source Property Owner: If the source property is owned by someone other than the person who is applying for case closure, include a copy of the letter notifying the current owner of the source property that case closure has been requested.

Return Receipt/Signature Confirmation: Written proof of date on which confirmation was received for notifying current source property owner.

Off-Source Property

Group the following information per individual property and label each group according to alphabetic listing on the "Impacted Off-Source Property" attachment.

Not Applicable

Letter To "Off-Source" Property Owners: Copies of all letters sent by the Responsible Party (RP) to owners of properties with groundwater exceeding an Enforcement Standard (ES), and to owners of properties that will be affected by a land use control under s. 292.12, Wis. Stats.

Note: Letters sent to off-source properties regarding residual contamination must contain standard provisions in Appendix A of ch. NR 726.

Number of "Off-Source" Letters:

Return Receipt/Signature Confirmation: Written proof of date on which confirmation was received for notifying any off-source property owner.

Deed of "Off-Source" Property: The most recent deed(s) as well as legal descriptions, for all affected deeded **off-source property(ies)**. This does not apply to right-of-ways.

Note: If a property has been purchased with a land contract and the purchaser has not yet received a deed, a copy of the land contract which includes the legal description shall be submitted instead of the most recent deed. If the property has been inherited, written documentation of the property transfer should be submitted along with the most recent deed.

Certified Survey Map: A copy of the certified survey map or the relevant section of the recorded plat map *for those properties where the legal description in the most recent deed refers to a certified survey map or a recorded plat map.* (lots on subdivided or platted property (e.g. lot 2 of xyz subdivision)).

Figure #: **Title:**

Letter To "Governmental Unit/Right-Of-Way" Owners: Copies of all letters sent by the Responsible Party (RP) to a city, village, municipality, state agency or any other entity responsible for maintenance of a public street, highway, or railroad right-of-way, within or partially within the contaminated area, for contamination exceeding a groundwater Enforcement Standard (ES) and/or soil exceeding a Residual Contaminant Level (RCL) or a Site Specific Residual Contaminant Level (SSRCL).

Number of "Governmental Unit/Right-Of-Way Owner" Letters:



ENVIRONMENTAL & REGULATORY SERVICES DIVISION
BUREAU OF PECFA
P.O. Box 8044
Madison, Wisconsin 53708-8044
TDD #: (608) 264-8777
Fax #: (608) 267-1381
<http://www.commerce.state.wi.us>
<http://www.wisconsin.gov>
Jim Doyle, Governor
Cory L. Nettles, Secretary

September 03, 2003

Bruce Davis
200 US Hwy 8 & 63 & Pine Street
Turtle Lake, WI 54889

RE: **Final Closure**

Commerce # 54889-9999-12 **WDNR BRRTS # 03-03-000273**
Bruce F Davis, Pine St & Hwy 8, Turtle Lake

Dear Mr. Davis:

The Wisconsin Department of Commerce (Commerce) has received all items required as conditions for closure of the site referenced above. This case is now listed as "closed" on the Commerce database. It is in your best interest to keep all documentation related to the environmental activities that were conducted.

If residual contamination is encountered in the future, it must be managed in accordance with all applicable regulations. If it is determined that any remaining contamination poses a threat, the case may be reopened and further investigation or remediation may be required. If applicable, the PECFA claim for this site would also be reopened and you may apply for assistance to the extent of remaining eligibility.

Thank you for your efforts to bring this case to closure. If you have any questions, please contact me in writing at the letterhead address or by telephone at (608) 261-7718.

Sincerely,

COPY

Woody Myers
Geologist
Site Review Section



ENVIRONMENTAL & REGULATORY SERVICES DIVISION
BUREAU OF PECFA
P.O. Box 8044
Madison, Wisconsin 53708-8044
TDD #: (608) 264-8777
Fax #: (608) 267-1381
<http://www.commerce.state.wi.us>
<http://www.wisconsin.gov>
Scott McCallum, Governor
Philip Edw. Albert, Secretary

November 06, 2002

Bruce Davis
Route 2 Box 324
Turtle Lake, WI 54889

RE: **Conditional Case Closure**

Commerce # 54889-9999-12 WDNR BRRS # 03-03-000273
Bruce F Davis, Pine St & Hwy 8, Turtle Lake

Dear Mr. Davis:

The Wisconsin Department of Commerce (Commerce) has reviewed the request for case closure prepared by your consultant, Cedar Corporation, for the site referenced above. It is understood that residual soil contamination remains on-site. Commerce has determined that this site does not pose a significant threat to the environment and human health. No further investigation or remedial action is necessary.

The following condition must be satisfied to obtain final closure:

- A notification must be placed on the property deed addressing residual petroleum impacts to the soil. For case closure we will need a copy of the deed notification that contains the County Register of Deeds' recording information. **Commerce requires site map indicating where the remaining contamination exists.** Enclosed is an example of a "Notice of Contamination to Property" for your use. If you wish to modify the language, submit a copy to this office for approval prior to recording. If an electronic copy of the "Notice of Contamination to Property" is desired, you may contact Commerce and a copy will be forwarded to you.

Please note: As of August 1, 2002, you may have this site listed on the Wisconsin Department of Natural Resources' (WDNR) Geographic Information System (GIS) Registry of Closed Remediation Sites in lieu of filing a soil deed affidavit. The GIS Registry database lists sites closed with contamination above regulatory standards. For more information regarding the registration process, including fee and documentation requirements, refer to the enclosed GIS Registry information.

This letter serves as your written notice of "no further action". Timely filing of your final PECFA claim (if applicable) is encouraged. If your claim is not received within 120 days of the date of

No Owner or contact was found
Commerce # 54889-9999-12 WDNR BRRTS # 03-03-000273
Bruce F Davis, Pine St & Hwy 8, Turtle Lake
November 06, 2002
Page 2

this letter, interest costs incurred after 60 days of the date of this letter will not be eligible for PECFA reimbursement. Costs associated with recording deed notices or other restrictions are not eligible for PECFA reimbursement, and the recording of these notices should not delay the claim submittal process.

Thank you for your efforts to protect Wisconsin's environment. If you have any questions, please contact me in writing at the letterhead address or by telephone at (608) 261-7718.

Sincerely,

COPY

Will M. Myers
Geologist
Site Review Section

Enclosure

cc: Scott McCurdy, Cedar Corporation

AFFIDAVIT OF CORRECTION

In Re: Part of the Southeast Quarter of the Southwest Quarter of Section 30, Township 34 North, Range 14 West (in the Village of Turtle Lake) described as: Beginning at a point 396 feet North and 183 feet West of quarter post of Section 30 and 31; thence North 656 feet to place of beginning; thence North 97 feet; thence Northeasterly 179.9 feet; thence South 200 feet; thence West 150 feet to the place of beginning.

STATE OF WISCONSIN)
) ss
COUNTY OF BARRON

Name and Return Address

Bruce F. and Janet E. Davis
215 Pine Street
Turtle Lake, WI 54889

Bruce F. Davis and Janet E. Davis, being first duly sworn, on oath depose and say:

1. That he and she are the owners of the above-described property.

2. That approval has been given by the successor agency, the Wisconsin Department of Natural Resources, for the closure of an environmental contamination case involving the above-described property on the condition that a notification of the existence of residual petroleum contamination on the property is recorded at the Office of the Register of Deeds in the county where the above-described property is located. 186-8023-39-000
Parcel Identification Number (PIN)

3. That this corrected affidavit is being recorded to correct and replace the previous deed (Volume 1048, Page 456, Document # 675593) recorded on 05-27-2003 with the Barron County Register of Deeds for the purpose of notifying prospective purchasers and other interested parties that soil contaminated with petroleum from a underground storage tank leak remains on this property in the following location:

On the North side of the former tank cavity at 7 to 9 feet below ground surface (see attachment). If this contaminated soil is excavated in the future, the soil must be sampled and analyzed, and may be considered solid or hazardous waste, and will need to be disposed in accordance with applicable statutes and rules.

Bruce F. Davis *Janet E. Davis*
Bruce F. Davis Janet E. Davis



Subscribed and sworn to before me this 21st day of NOVEMBER 2017

[Signature]

Notary Public, State of Wisconsin
My commission 5/31/2019



This document was drafted by the Wisconsin Department of Natural Resources.

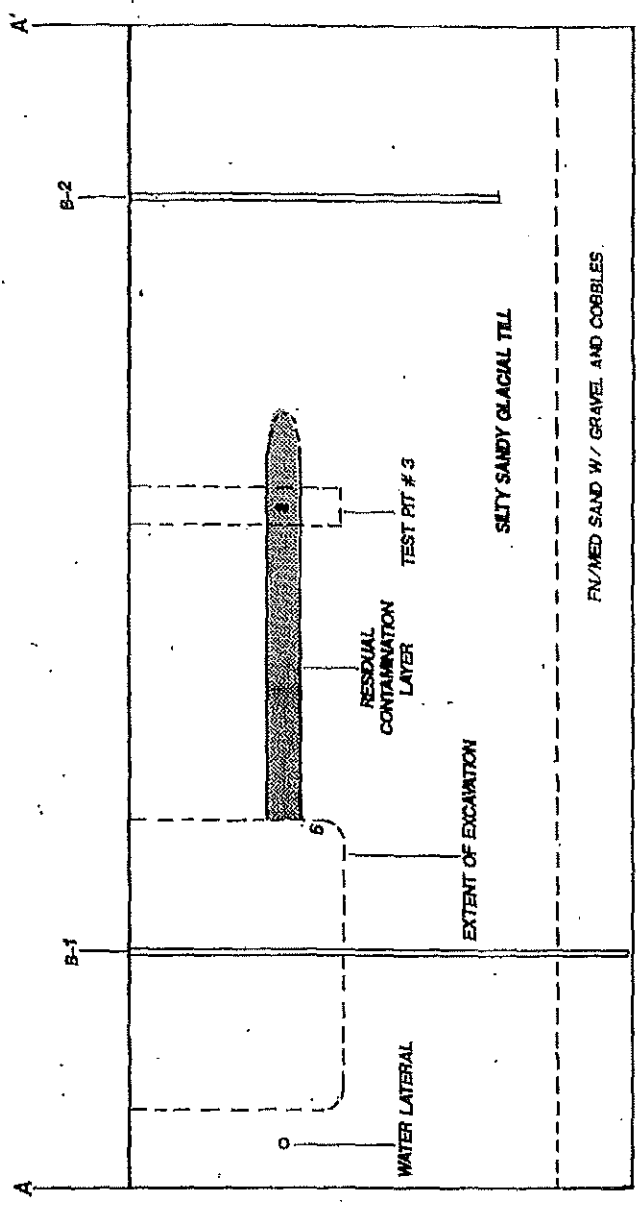

 = RESIDUAL CONTAMINATION LAYER

1" = 10'

VERTICAL CROSS SECTION MAP

FIGURE 3

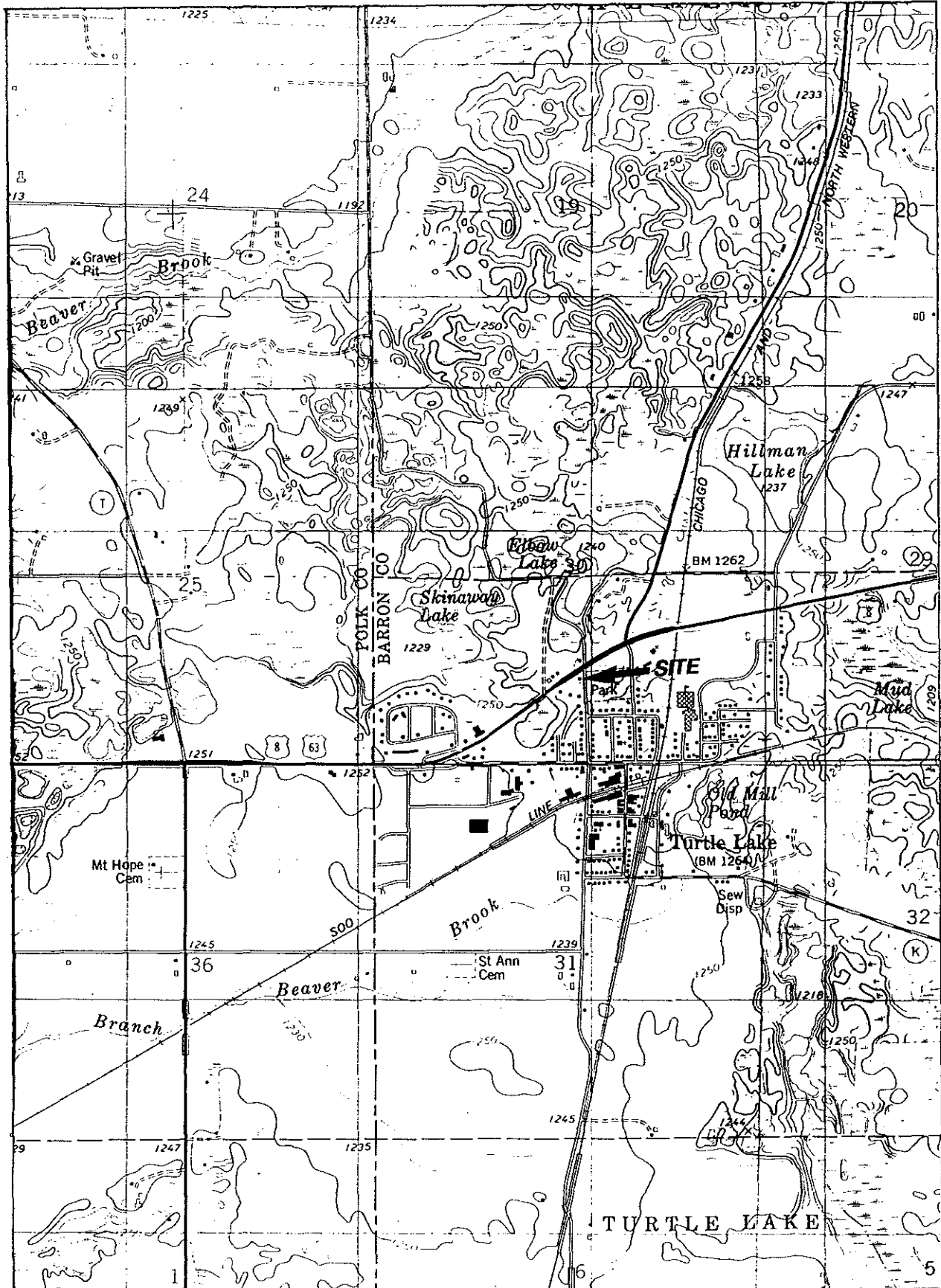
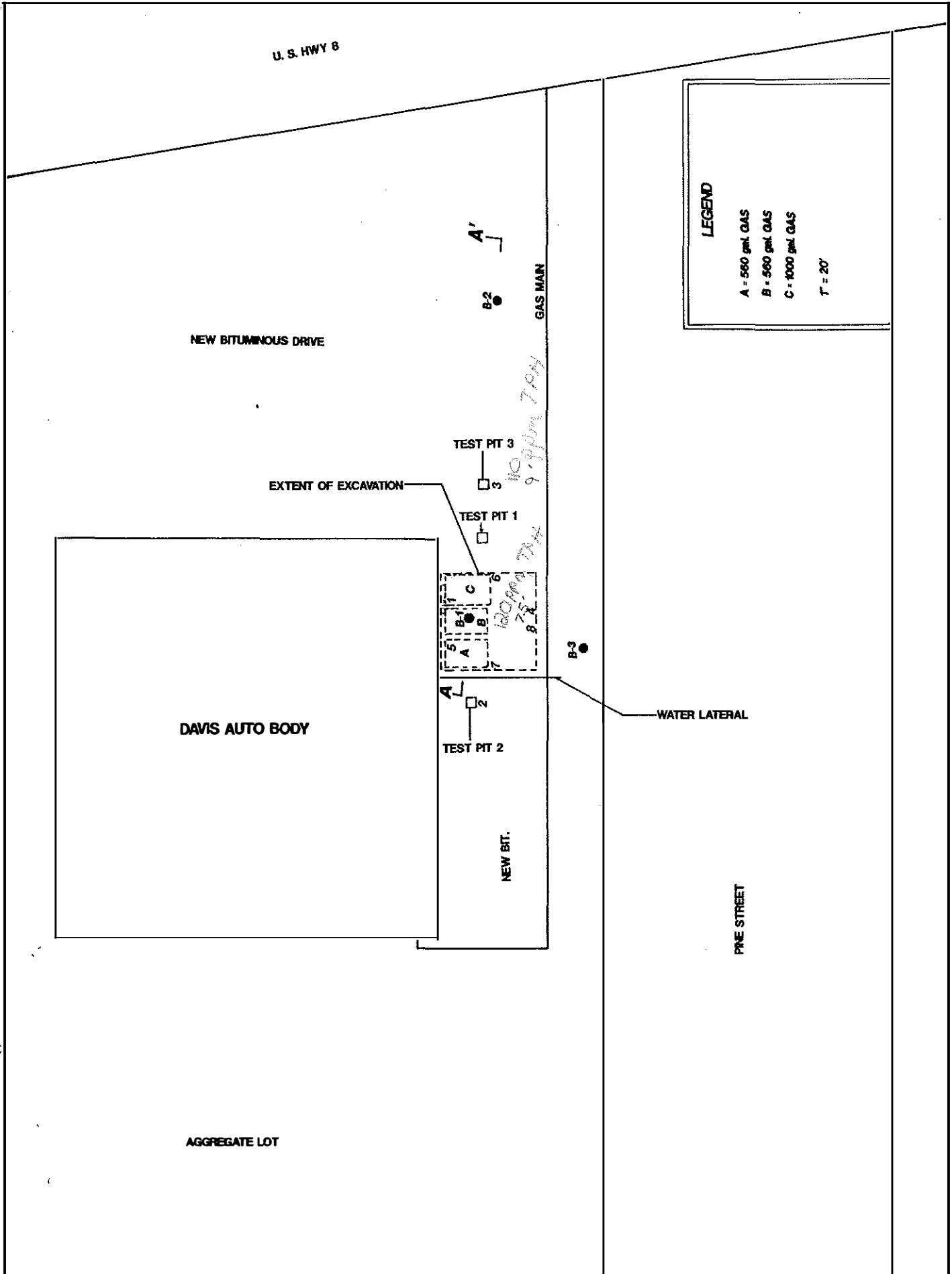

FIGURE 1

SITE LOCATION MAP



LEGEND

A = 560 gmL GAS
 B = 560 gmL GAS
 C = 1000 gmL GAS
 T' = 20'



SITE FEATURES AND SAMPLE LOCATIONS MAP

FIGURE 2

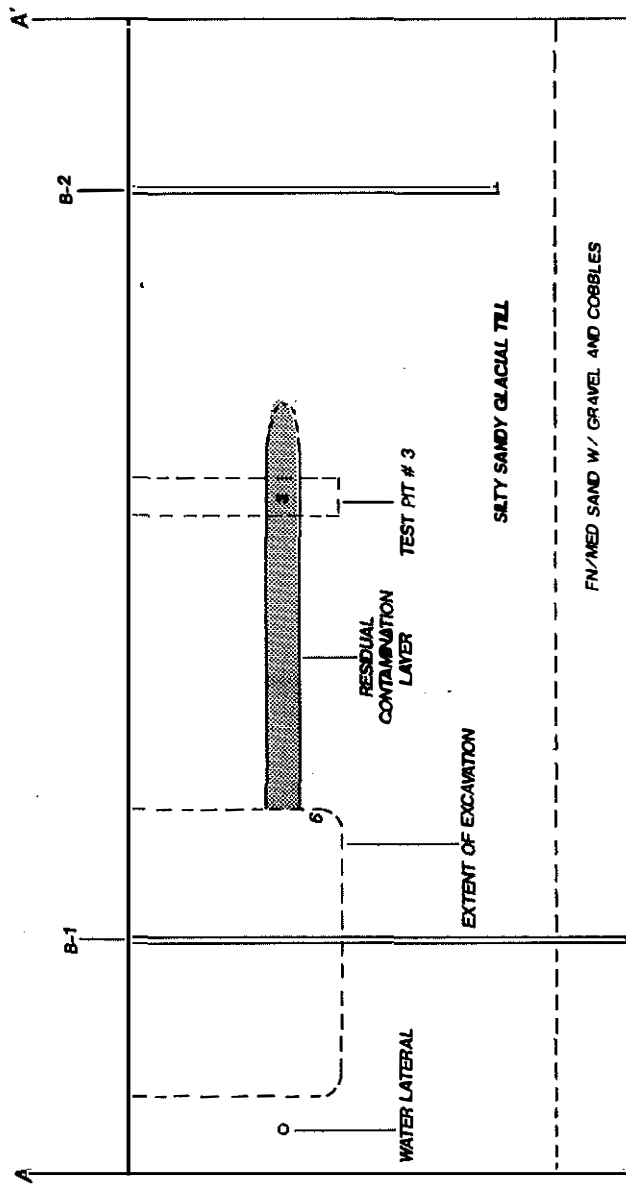

 = RESIDUAL CONTAMINATION LAYER

1" = 10'

VERTICAL CROSS SECTION MAP

FIGURE 3

DAVIS AUTO
TABLE 1

SAMPLE NUMBER	LAB ID NUMBER	FIELD HEADSPACE READINGS ppm	TOTAL PETROLEUM HYDROCARBONS ppm	SAMPLE DEPTH (ft.)	SAMPLE LOCATION
1	9-20-S-2	4549	120 as gas	7.5	W Wall Exc.
2	9-20-S-3	7	≤10	9	Test pit #2
3	9-20-S-4	446	110 as gas	9	Test pit #3
4	9-20-S-6	6	≤10	11	E Wall Exc.
5		9	N/A	11	W Wall Exc.
6		5	N/A	11	N Wall Exc.
7		7	N/A	11	S Wall Exc.
8		8	N/A	8	E Wall Exc.

N/A = Not laboratory analyzed.

For complete analytical reports, see Appendix D.

Results calculated on a dry weight basis.

DAVIS AUTO
BTEX COMPOUNDS

SAMPLE NUMBER	LAB ID NUMBER	BENZENE ppm	TOLUENE ppm	ETHYL-BENZENE ppm	XYLENES ppm
1	9-20-S-2	≤0.5	16	10	85
4	9-20-S-6	≤0.02	≤0.079	≤0.093	≤0.55

DAVIS AUTO
TABLE 2

BORING : B-1		BORING: B-2		BORING: B-3	
DEPTH	PID	DEPTH	PID	DEPTH	PID
7-9	280	7-9	50	4-6	0
9-11	320	9-11	53	6-8	0
15-17	-	13-15	62	8-10	0
17-19	100	15-17	10	12-14	2
22-24	-	17-19	280	14-16	19
24-26	4			16-18	22

DAVIS AUTO

SAMPLE NUMBER	LAB ID NUMBER	FIELD HEADSPACE READINGS ppm	TOTAL PETROLEUM HYDROCARBONS ppm	SAMPLE DEPTH (ft.)	SAMPLE LOCATION
11-29-S-2	84287	4	≤10	25-26	B-1
11-29-S-3	84288	280	≤10	18-19	B-2
11-30-S-4	84289	22	≤10	17-18	B-3

SAMPLE NUMBER	LAB ID NUMBER	BENZENE ppm	TOLUENE ppm	ETHYL-BENZENE ppm	XYLENES ppm
11-29-S-3	84288	≤0.005	0.0079	≤0.005	≤0.005

For complete analytical reports, see Appendix D.
Results calculated on a dry weight basis.