

GIS REGISTRY INFORMATION

SITE NAME: Deering Property

BRRTS #: 03-45-217425 **FID # (if appropriate):** _____

COMMERCE # (if appropriate): 54165-1308-20

CLOSURE DATE: 11/25/2005

STREET ADDRESS: 120 N. Main St

CITY: Seymour

SOURCE PROPERTY GPS COORDINATES (meters in WTM91 projection): X= 652738 Y= 450163

CONTAMINATED MEDIA: Groundwater Soil Both

OFF-SOURCE GW CONTAMINATION >ES: Yes No

IF YES, STREET ADDRESS 1: 126 N Main St

GPS COORDINATES (meters in WTM91 projection): X= 652734 Y= 450181

OFF-SOURCE SOIL CONTAMINATION >Generic or Site-Specific RCL (SSRCL): Yes No

IF YES, STREET ADDRESS 1: _____

GPS COORDINATES (meters in WTM91 projection): X= _____ Y= _____

CONTAMINATION IN RIGHT OF WAY: Yes No

DOCUMENTS NEEDED:

Closure Letter, and any conditional closure letter or denial letter issued	x
Copy of most recent deed, including legal description, for all affected properties	x
Certified survey map or relevant portion of the recorded plat map (if referenced in the legal description) for all affected properties	
County Parcel ID number, if used for county, for all affected properties <u>34-0-0162-00-4 and 34-0-0162-01-4</u>	x
Location Map which outlines all properties within contaminated site boundaries on USGS topographic map or plat map in sufficient detail to permit the parcels to be located easily (8.5x14" if paper copy). If groundwater standards are exceeded, the map must also include the location of all municipal and potable wells within 1200' of the site.	x
Detailed Site Map(s) for all affected properties , showing buildings, roads, property boundaries, contaminant sources, utility lines, monitoring wells and potable wells. (8.5x14", if paper copy) This map shall also show the location of all contaminated public streets, highway and railroad rights-of-way in relation to the source property and in relation to the boundaries of groundwater contamination exceeding ch. NR 140 ESs and soil contamination exceeding ch. NR 720 generic or SSRCLs.	x
Tables of Latest Groundwater Analytical Results (no shading or cross-hatching)	x
Tables of Latest Soil Analytical Results (no shading or cross-hatching)	x
Isoconcentration map(s), if required for site investigation (SI) (8.5x14" if paper copy). The isoconcentration map should have flow direction and extent of groundwater contamination defined. If not available, include the latest extent of contaminant plume map.	x
GW: Table of water level elevations, with sampling dates, and free product noted if present	x
GW: Latest groundwater flow direction/monitoring well location map (should be 2 maps if maximum variation in flow direction is greater than 20 degrees)	x
SOIL: Latest horizontal extent of contamination exceeding generic or SSRCLs, with one contour	x
Geologic cross-sections, if required for SI. (8.5x14" if paper copy)	x
RP certified statement that legal descriptions are complete and accurate	x
Copies of off-source notification letters (if applicable)	x
Letter informing ROW owner of residual contamination (if applicable)(public, highway or railroad ROW)	x
Copy of (soil or land use) deed restriction(s) or deed notice if any required as a condition of closure	x
Copy of any maintenance plan referenced in the deed restriction.	x



State of Wisconsin \ DEPARTMENT OF NATURAL RESOURCES

Jim Doyle, Governor
Scott Hassett, Secretary
Ronald W. Kazmierczak, Regional Director

Shawano Field Office
647 Lakeland Rd.
Shawano, Wisconsin 54166
Telephone 715-524-2183
FAX 715-524-3214
TTY Access via relay - 711

November 25, 2005

Ms. Sue Garsow
City of Seymour
328 N. Main St.
Seymour, WI 54165

Subject: Final Closure—Former Deering Property, 120 N. Main St., Seymour, WI; DNR
Case # 03-45-217425

Dear Sue:

On September 19, 2005, the Northeast Region Closure Committee reviewed the above referenced case for closure. This committee reviews environmental remediation cases for compliance with state laws and standards to maintain consistency in the closure of these cases.

On November 25, 2005 the Department received correspondence indicating that you have complied with the requirements of closure - specifically a copy of the deed restriction that was filed to address the contaminated soil remaining at the site. Based on the correspondence and data provided, it appears that your case has been remediated to Department standards in accordance with s. NR 726.05, Wis. Adm. Code. The Department considers this case closed and no further investigation, remediation or other action is required at this time.

Your site will be listed on the DNR Remediation and Redevelopment GIS Registry of Closed Remediation Sites. Information that was submitted with your closure request application will be included on the GIS Registry. To review the sites on the GIS Registry web page, visit <http://dnr.wi.gov/org/aw/rr/gis/index.htm>. If your property is listed on the GIS Registry and you intend to construct or reconstruct a well, you will need Department approval. Department approval is required before construction or reconstruction of a well on a property listed on the GIS Registry, in accordance with s. NR 812.09(4)(w). To obtain approval, Form 3300-254 needs to be completed and submitted to the DNR Drinking and Groundwater program's regional water supply specialist. This form can be obtained on-line <http://www.dnr.state.wi.us/org/water/dwg/3300254.pdf> or at the web address listed above for the GIS Registry.

If this is a PECFA site, section 101.143, Wis. Stats., requires that PECFA claimants seeking reimbursement of interest costs, for sites with petroleum contamination, submit a final reimbursement claim within 120 days after they receive a closure letter on their site. For claims not received by the PECFA Program within 120 days of the date of this letter, interest costs after 60 days of the date of this letter will not be eligible for PECFA reimbursement.

If there is equipment purchased with PECFA funds remaining at the site, contact the Commerce PECFA Program to determine the method for salvaging the equipment.

Please be aware that this case may be reopened pursuant to s. NR 726.09, Wis. Adm. Code, if additional information regarding site conditions indicates that contamination on or from the site poses a threat to public health, safety or welfare, or the environment.

The Department appreciates your efforts to restore the environment at this site. I also applaud the City of Seymour's efforts in transforming this "brownfield" into a "green space" that will further enhance your community. Feel free to contact me if you have any questions about this letter or other cleanup and brownfield issues.

Sincerely,



Tom Sturm

Hydrogeologist

Remediation & Redevelopment Program

715-526-4230

Thomas.Sturm@dnr.state.wi.us

C: Beth Erdman – DCOMM (via email)



State of Wisconsin \ DEPARTMENT OF NATURAL RESOURCES

Jim Doyle, Governor
Scott Hassett, Secretary
Ronald W. Kazmierczak, Regional Director

Shawano Field Office
647 Lakeland Rd.
Shawano, Wisconsin 54166
Telephone 715-524-2183
FAX 715-524-3214
TTY Access via relay - 711

October 12, 2005

Ms. Sue Garsow
City of Seymour
328 N. Main St.
Seymour, WI 54165

Dear Sue:

Enclosed is the deed restriction that needs to be filed at the Register of Deeds office for the Deering site; please review it and let me know if there are any errors. After it has been filed, return a copy of the filed document to me.

I will send you a final closure letter after I receive this document and the monitoring well abandonment forms for the remaining wells. I will also need to double check the information that will be put on the GIS registry, but I believe that is complete.

Call or email if you have any questions.

Sincerely,

Tom Sturm
Hydrogeologist
Remediation & Redevelopment Program
715-526-4230
Thomas.Sturm@dnr.state.wi.us

remains and must be stored, treated and disposed in compliance with applicable statutes and rules.

In addition, the following activities are prohibited on any portion of the above-described property where the soil cover is required, as shown on Exhibit 2, unless prior written approval has been obtained from the Wisconsin Department of Natural Resources or its successor or assign: (1) Replacement with another barrier; (2) Excavating or grading of the land surface; (3) Filling on capped or paved areas; (4) Plowing for agricultural cultivation; and (5) Construction or placement of a building or other structure in an area where a soil cover is required.

This restriction is hereby declared to be a covenant running with the land and shall be fully binding upon all persons acquiring the above-described property whether by descent, devise, purchase or otherwise. This restriction inures to the benefit of and is enforceable by the Wisconsin Department of Natural Resources, its successors or assigns. The Department, its successors or assigns, may initiate proceedings at law or in equity against any person or persons who violate or are proposing to violate this covenant, to prevent the proposed violation or to recover damages for such violation.

Any person who is or becomes owner of the property described above may request that the Wisconsin Department of Natural Resources or its successor issue a determination that one or more of the restrictions set forth in this covenant is no longer required. Upon the receipt of such a request, the Wisconsin Department of Natural Resources shall determine whether or not the restrictions contained herein can be extinguished. If the Department determines that the restrictions can be extinguished, an affidavit, attached to a copy of the Department's written determination, may be recorded by the property owner or other interested party to give notice that this deed restriction, or portions of this deed restriction, are no longer binding.

By signing this document, _____ asserts that he or she is duly authorized to sign this document on behalf of the City of Seymour.

IN WITNESS WHEREOF, the owner of the property has executed this Declaration of Restrictions, this _____ day of _____, 20____.

Signature: _____

Printed Name: _____

Title: _____

Subscribed and sworn to before me

this ____ day of _____, 20__.

Notary Public, State of _____
My commission _____

This document was drafted by the Wisconsin Department of Natural Resources based on information provided by Northern Environmental Inc.

3P12

1402102

DOCUMENT NO.

STATE BAR OF WISCONSIN FORM 3 - 1982
QUIT CLAIM DEED

I. #1

OUTAGAMIE COUNTY, a municipal corporation,

quit-claims to CITY OF SEYMOUR,
a municipal corporation,

the following described real estate in Outagamie County,
State of Wisconsin:

Exhibit 1

OUTAGAMIE COUNTY
RECEIVED FOR RECORD

APR 11 2001

AT 10:30 O'CLOCK A.M. P.M.
JANICE FLENZ
REGISTER OF DEEDS

THIS SPACE RESERVED FOR RECORDING DATA

NAME AND RETURN ADDRESS
CORPORATION COUNSEL OFFICE
OUTAGAMIE CO ADMIN BLDG
410 S WALNUT ST
APPLETON WI 54911

pd
1000

PARCEL IDENTIFICATION NUMBER

All of Lot Thirteen (13), less the North 30 feet thereof, subject to a perpetual easement in a strip of land 10 feet in width lying South and adjacent to the North 30 feet of said Lot 13, the same to be used in common for the purpose of light, air, travel or driveway and other uses, except the construction or erection of buildings thereon. All of Lot Fourteen (14) and Lot Fifteen (15), less the North 12.2 feet of Lot 15, and less the East 40 feet of the South 80 feet of Lot 15, subject to a perpetual easement in a strip of land 10 feet wide on the West and 10 feet wide on the North and adjacent to a tract of land described in Volume 114 of Deeds page 509, Outagamie County Records, all of the foregoing being in Block Seventeen (17) City of Seymour, Outagamie County, Wisconsin, according to the Recorded Assessors Map of said City. LESS AND EXCEPTING Lot One (1) of Certified Survey Map No. 499 as Document No. 944709 being a part of Lot 15, Block 17, Assessor's Plat, City of Seymour, Outagamie County, Wisconsin. ALSO LESS AND EXCEPTING lands described in Quit Claim Deed recorded on December 12, 1989, in Jacket 9932, Image 41, as Document No. 971844.

Tax Parcel Identification No. 34-0-0162-00-4 and 34-0-0162-01-4

(Exempt from Transfer Fee per 77.25(2))

FEE
2
EXEMPT

This is not homestead property.
(is) (is not)

Dated this 20th day of March, 2001.

OUTAGAMIE COUNTY

By: Robert N. Paltzer, Jr. (SEAL)

Robert N. Paltzer, Jr./County Executive

By: Sally J. Mielke (SEAL)

Sally Mielke/County Board Chair

By: Nancy J. Christensen (SEAL)

Nancy Christensen/County Clerk

AUTHENTICATION

Signature(s) of Robert N. Paltzer, Jr.,
Sally Mielke and Nancy Christensen

authenticated this 20th day of March, 2001

Joseph P. Guidote, Jr.

TITLE: MEMBER STATE BAR OF WISCONSIN

(If not, authorized by §706.06, Wis. Stats.)

THIS INSTRUMENT WAS DRAFTED BY
Joseph P. Guidote, Jr.
Outagamie County
Corporation Counsel

(Signatures may be authenticated or acknowledged. Both are not necessary.)

ACKNOWLEDGMENT

State of Wisconsin,

} ss.
County:

Personally came before me this _____ day of _____, 19____, the above named

to me known to be the person _____ who executed the foregoing instrument and acknowledge the same.

Notary Public, _____ County, Wis.
My commission is permanent. (If not, state expiration date: _____, 19____.)

* Names of persons signing in any capacity should be typed or printed below their signatures.

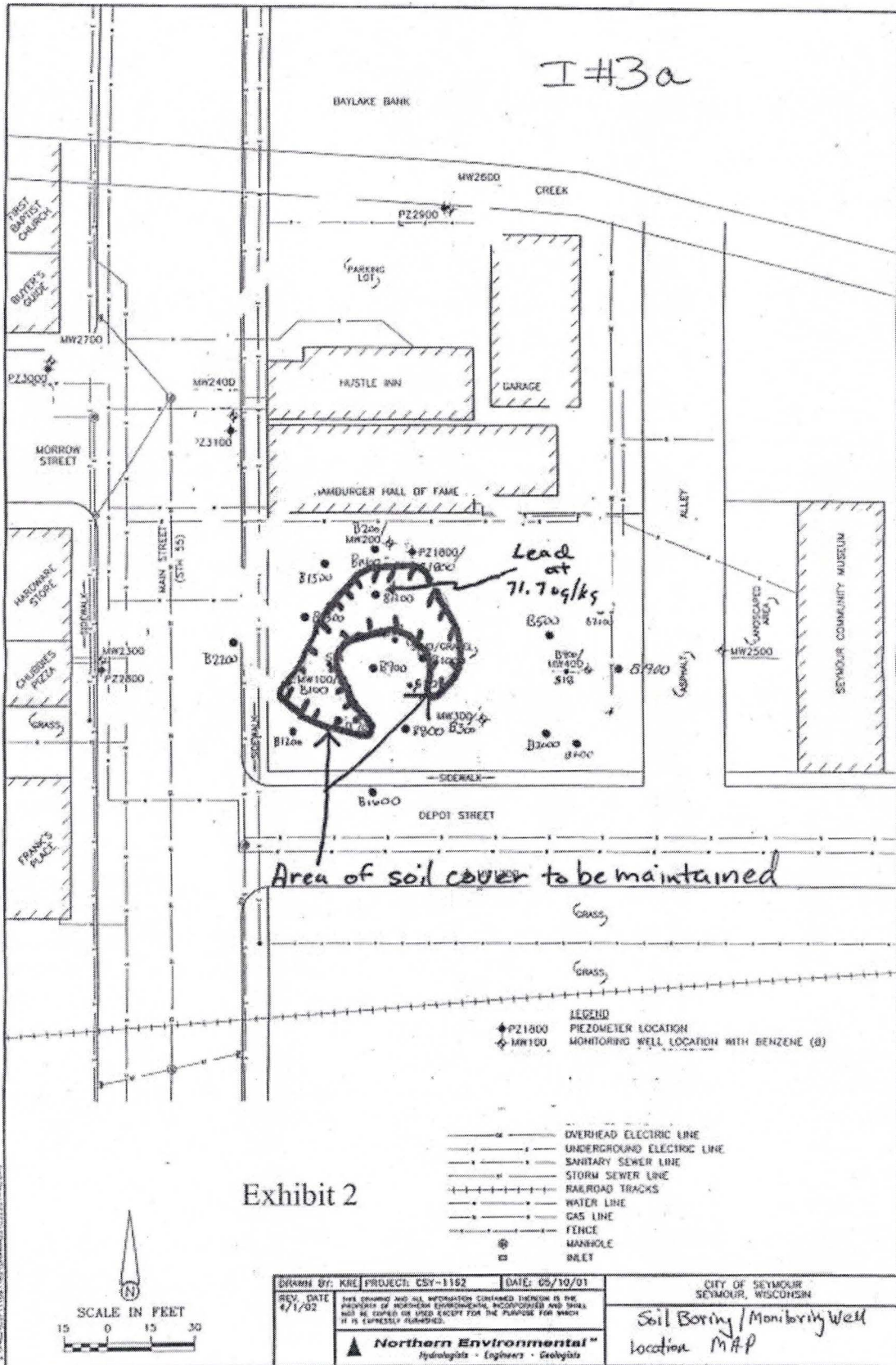

EXHIBIT 3

SOIL COVER MAINTENANCE PLAN

September 20, 2005

Property Located at:

120 N. Main St., Seymour, WI

WDNR BRRTS/Activity # 03-45-217425

Parcel ID 34-0-0162-00-4 and 34-0-0162-01-4, Outagamie County, Wisconsin

Introduction

This document is the Maintenance Plan for the soil cover barrier at the above-referenced property in accordance with the requirements of s. NR 724.13(2), Wisconsin Administrative Code. The maintenance activities relate to the existing soil cover occupying the area over the contaminated soil on-site. The contaminated soil is impacted by lead. The locations of the soil cover to be maintained in accordance with this Maintenance Plan, as well as the impacted soil are identified in the attached map (Exhibit A).

Cover and Building Barrier Purpose

The soil cover over the contaminated soil serves as a barrier to prevent direct human contact with residual soil contamination that might otherwise pose a threat to human health. Based on the current and future use of the property, the barrier should function as intended unless disturbed.

Annual Inspection

The soil cover overlying the soil and as depicted in Exhibit A will be inspected once a year, normally in the spring after all snow and ice is gone, for deterioration and other potential problems that can cause or exposure to underlying soils. The inspections will be performed to evaluate damage due to settling, exposure to the weather, wear from traffic, increasing age and other factors. Any area where soils have become or are likely to become exposed will be documented. A log of the inspections and any repairs will be maintained by the property owner and is included as Exhibit B, Cap Inspection Log. The log will include recommendations for necessary repair of any areas where underlying soils are exposed. Once repairs are completed, they will be documented in the inspection log. A copy of the inspection log will be kept at the Seymour City Hall and made available to all interested parties including the Wisconsin Department of Natural Resources upon request.

Maintenance Activities

If problems are noted during the annual inspections or at any other time during the year, repairs will be scheduled as soon as practical. Repairs can include filling the area of exposed contaminated soil with clean soil or fill. In the event that necessary maintenance activities expose the underlying soil, the owner must inform maintenance workers of the direct contact exposure hazard and provide them with appropriate personal protection equipment ("PPE"). The owner must also sample any soil that is excavated from the site prior to disposal to ascertain if contamination remains. The soil must be treated, stored and disposed of by the owner in accordance with applicable local, state and federal law.

In the event the soil overlying the contaminated soil is removed or replaced, the replacement material must be equivalent in thickness. Any replacement barrier will be subject to the same maintenance and inspection guidelines as outlined in this Maintenance Plan unless indicated otherwise by the WDNR or its successor.

The property owner, in order to maintain the integrity of the paved surfaces and/or the building, will maintain a copy of this Maintenance Plan at the Seymour City Hall and make it available to all interested parties (i.e. on-site employees, contractors, future property owners, etc.) for viewing.

Amendment or Withdrawal of Maintenance Plan

This Maintenance Plan can be amended or withdrawn by the property owner and its successors with the written approval of WDNR.

Contact Information

Site Owner and Operator:
City of Seymour
328 North Main St.
Seymour, WI 54165
920-833-2209

WDNR:
Tom Sturm
WDNR
647 Lakeland Rd.
Shawano, WI 54166
715-526-4230

Exhibit B
Barrier INSPECTION LOG

Inspection Date	Inspector	Condition of Cap	Recommendations	Have Recommendations from previous inspection been implemented?

City of Seymour

328 North Main Street, Seymour, WI 54165
Phone (920) 833-2209 Fax (920) 833-7221

I # 10

December 27, 2004

To Whom It May Concern:

Enclosed is a quit claim deed describing parcel no. 34-0-0162-00-4 and 34-0-0162-01-4 which is the former Deering property. The land was conveyed from Outagamie County to the City of Seymour. To the best of my knowledge this is the legal description of the property.

Sincerely,



Harold J. Pingel
Mayor

3P12

1402102

STATE BAR OF WISCONSIN FORM 3 - 1982
QUIT CLAIM DEED

DOCUMENT NO.

I. #1

OUTAGAMIE COUNTY, a municipal corporation,

quit-claims to CITY OF SEYMOUR,
a municipal corporation,

the following described real estate in Outagamie County,
State of Wisconsin:

Exhibit 1

OUTAGAMIE COUNTY
RECEIVED FOR RECORD

APR 11 2001

AT 10:30 O'CLOCK A.M. P.M.
JANICE FLENZ
REGISTER OF DEEDS

THIS SPACE RESERVED FOR RECORDING DATA

NAME AND RETURN ADDRESS
CORPORATION COUNSEL OFFICE
OUTAGAMIE CO ADMIN BLDG
410 S WALNUT ST
APPLETON WI 54911

pd
10:00

PARCEL IDENTIFICATION NUMBER

All of Lot Thirteen (13), less the North 30 feet thereof, subject to a perpetual easement in a strip of land 10 feet in width lying South and adjacent to the North 30 feet of said Lot 13, the same to be used in common for the purpose of light, air, travel or driveway and other uses, except the construction or erection of buildings thereon. All of Lot Fourteen (14) and Lot Fifteen (15), less the North 12.2 feet of Lot 15, and less the East 40 feet of the South 80 feet of Lot 15, subject to a perpetual easement in a strip of land 10 feet wide on the West and 10 feet wide on the North and adjacent to a tract of land described in Volume 114 of Deeds page 509, Outagamie County Records, all of the foregoing being in Block Seventeen (17) City of Seymour, Outagamie County, Wisconsin, according to the Recorded Assessors Map of said City. LESS AND EXCEPTING Lot One (1) of Certified Survey Map No. 499 as Document No. 944709 being a part of Lot 15, Block 17, Assessor's Plat, City of Seymour, Outagamie County, Wisconsin. ALSO LESS AND EXCEPTING lands described in Quit Claim Deed recorded on December 12, 1989, in Jacket 9932, Image 41, as Document No. 971844.

Tax Parcel Identification No. 34-0-0162-00-4 and 34-0-0162-01-4

(Exempt from Transfer Fee per 77.25(2))

FEE
2
EXEMPT

This is not homestead property.
(is) (is not)

Dated this 20th day of March, 2001.

OUTAGAMIE COUNTY

By: Robert N. Paltzer, Jr. (SEAL) _____ (SEAL)

• Robert N. Paltzer, Jr./County Executive

By: Sally J. Mielke (SEAL) _____ (SEAL)

• Sally Mielke/County Board Chair • Nancy Christensen/County Clerk

AUTHENTICATION

Signature(s) of Robert N. Paltzer, Jr., Sally Mielke and Nancy Christensen

authenticated this 20th day of March, 2001

• Joseph P. Guidote, Jr.

TITLE: MEMBER STATE BAR OF WISCONSIN

(If not, _____
authorized by 8706.06, Wis. Stats.)

THIS INSTRUMENT WAS DRAFTED BY

Joseph P. Guidote, Jr.

Outagamie County Corporation Counsel

(Signatures may be authenticated or acknowledged. Both are not necessary.)

ACKNOWLEDGMENT

State of Wisconsin, _____ } ss.
County, _____ }

Personally came before me this _____ day of _____, 19____, the above named

to me known to be the person _____ who executed the foregoing instrument and acknowledge the same.

• _____
Notary Public, _____ County, Wis.
My commission is permanent. (If not, state expiration date: _____, 19____.)

* Names of persons signing in any capacity should be typed or printed below their signatures.

Part of
City of Seymour

123 -- ADDRESS
P 123 -- PROPOSED ADDRESS
0123 -- PARCEL NUMBER

PAGE 11

SCALE 1" = 200'
0 200'

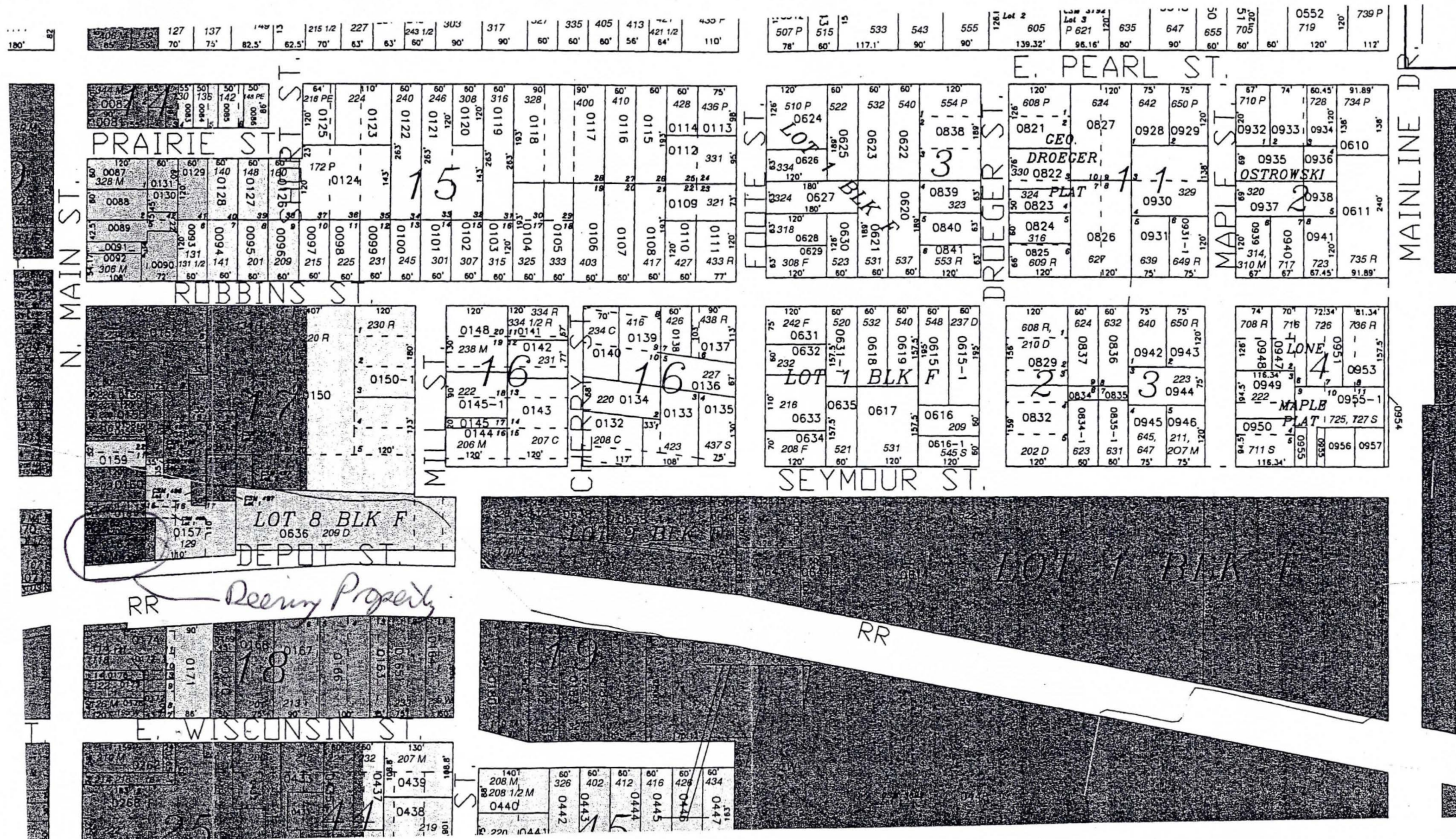

I#2

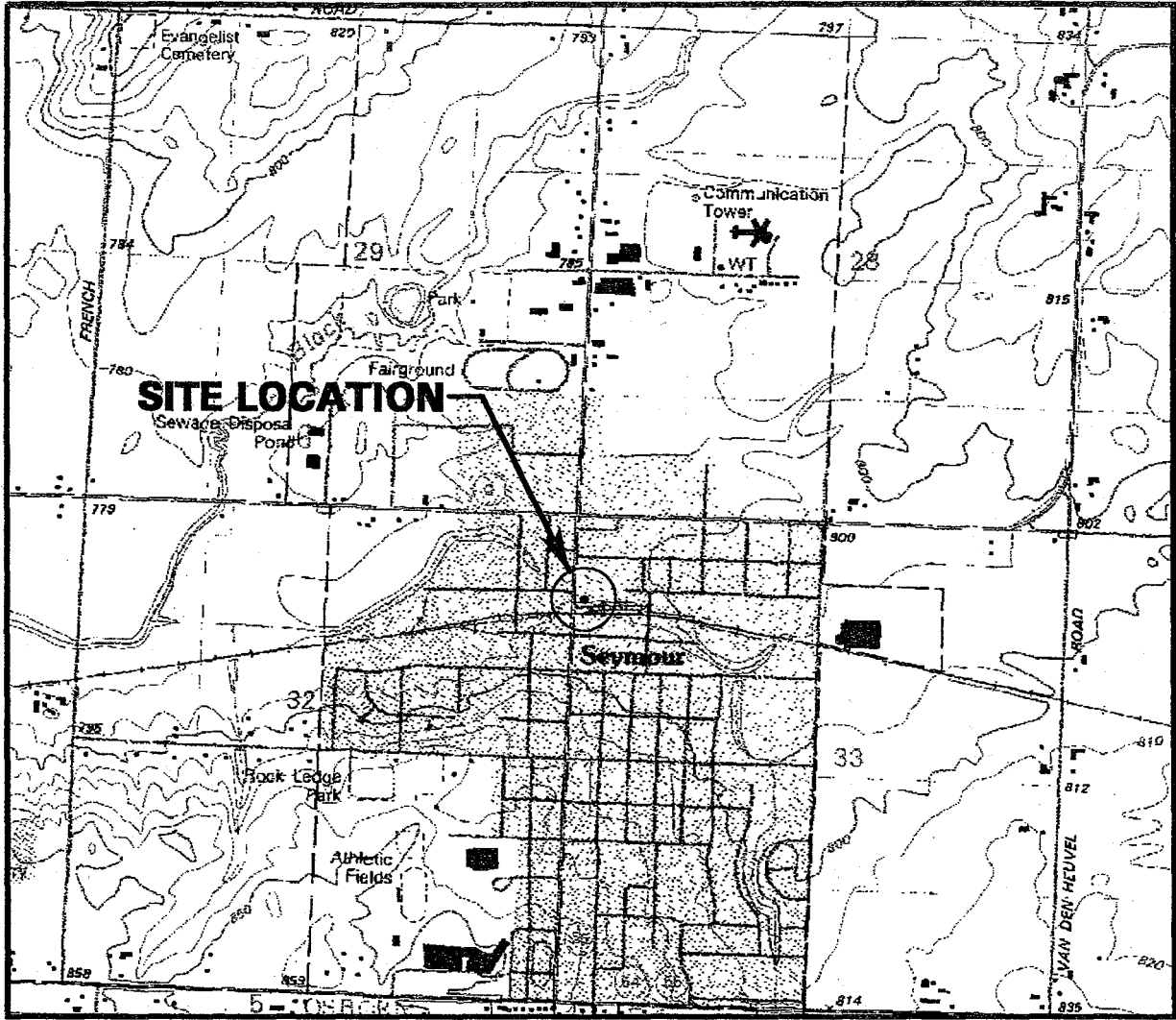

SCALE IN FEET

1" = 2000'



CONTOUR INTERVAL 10 FEET
NATIONAL GEODETIC VERTICAL DATUM OF 1929



QUADRANGLE LOCATION

BASE MAP SOURCE: USGS SEYMOUR, WISCONSIN 7.5 MINUTE QUADRANGLE, 1992

DRAWN BY: KRE PROJECT: CSY-1162 DATE: 03/12/01

REV. DATE THIS DRAWING AND ALL INFORMATION CONTAINED THEREON IS THE PROPERTY OF NORTHERN ENVIRONMENTAL INCORPORATED AND SHALL NOT BE COPIED OR USED EXCEPT FOR THE PURPOSE FOR WHICH IT IS EXPRESSLY FURNISHED.

Northern EnvironmentalSM
Hydrologists • Engineers • Geologists

CITY OF SEYMOUR
DORIS DEERING PROPERTY
SEYMOUR, WISCONSIN

SITE LOCATION AND
LOCAL TOPOGRAPHY



S:\PROJ\CSY\11091162\DRAWINGS\031201-1.DWG

FIGURE A1

S:\PROJ\CSY\1109\1162\DRAWINGS\03\1001-2.DWG

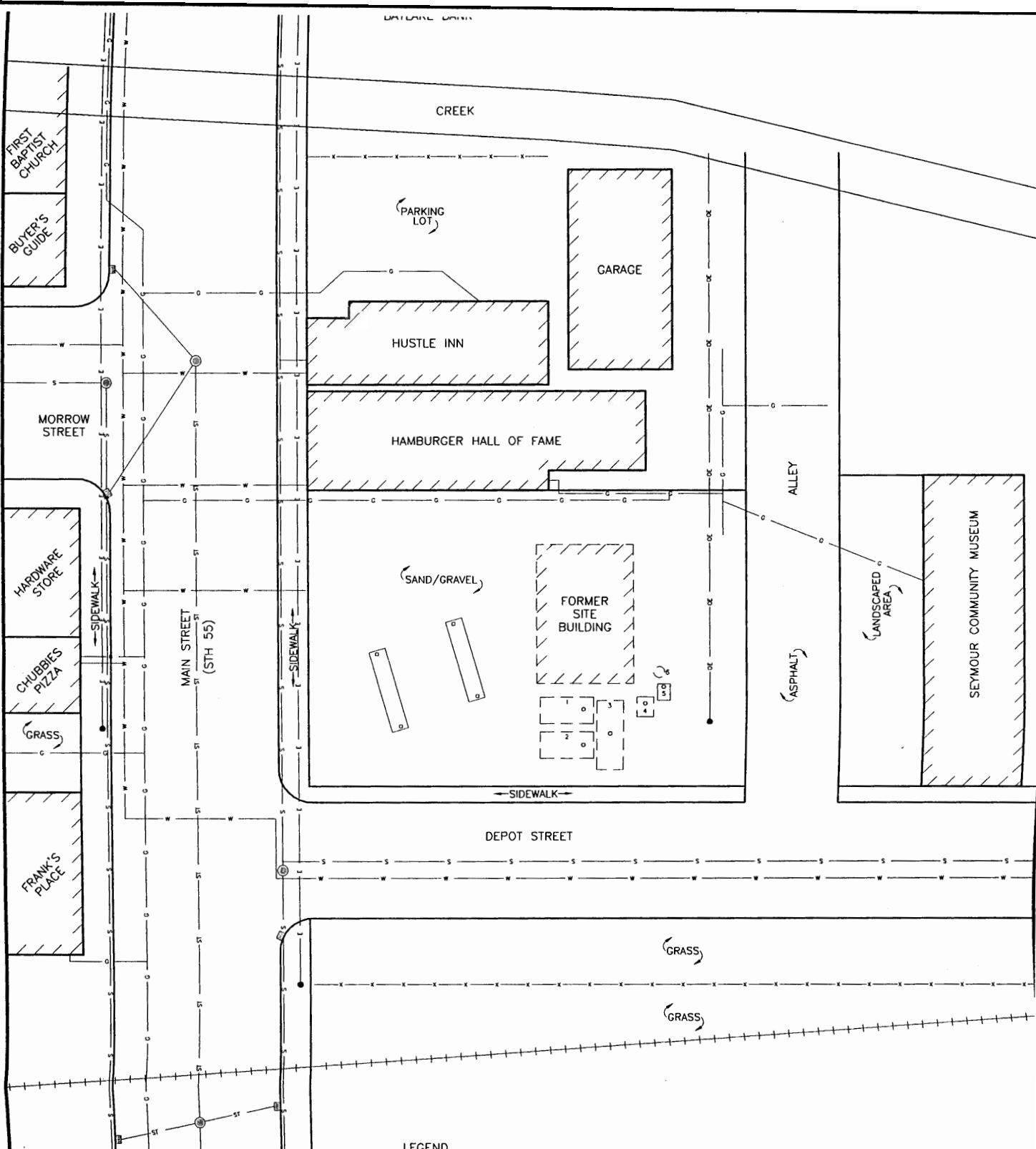

- LEGEND**
- E— UNDERGROUND ELECTRIC LINE
 - OC— OVERHEAD ELECTRIC LINE
 - S— SANITARY SEWER LINE
 - ST— STORM SEWER LINE
 - +—+—+— RAILROAD TRACKS
 - W— WATER LINE
 - G— GAS LINE
 - X—X—X— FENCE
 - ⊙ MANHOLE
 - ⊞ INLET
- ☐ # FORMER UST LOCATION
 - 1 = 6,000 GALLON UNLEADED GASOLINE
 - 2 = 6,000 GALLON LEADED GASOLINE
 - 3 = 8,000 GALLON UNLEADED GASOLINE
 - 4 = 1,000 GALLON FUEL OIL
 - 5 = 500 GALLON WASTE OIL
 - 6 = 200 GALLON KEROSENE
 - ☐ FORMER DISPENSER ISLAND LOCATION

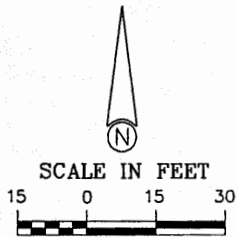

DRAWN BY: KRE PROJECT: CSY-1162 DATE: 05/10/01

REV. DATE 3/25/02

THIS DRAWING AND ALL INFORMATION CONTAINED THEREON IS THE PROPERTY OF NORTHERN ENVIRONMENTAL INCORPORATED AND SHALL NOT BE COPIED OR USED EXCEPT FOR THE PURPOSE FOR WHICH IT IS EXPRESSLY FURNISHED.

CITY OF SEYMOUR
SEYMOUR, WISCONSIN

Northern EnvironmentalSM
Hydrologists • Engineers • Geologists

SITE LAYOUT

FIGURE

I#4

Table 3
 Summary of Groundwater Analytical Results
 Detected Compounds in Exceedence of NR 140 Groundwater Quality Standards
 Former Deering Property
 Seymour, Wisconsin

Well Number	Date Sampled	Benzene	Ethylbenzene	MTBE	Naphthalene	Toluene	TMB	Total xylenes
MW100	05/08/01	9,900	ND(<50)	2,900	ND(<350)	940	ND	420
	02/27/02	9,800	2,400	ND(<200)	ND(<650)	13,000	2,990	13,500
	12/31/03	13,500	4,670	180	1,180	23,300	5,570	22,600
	03/26/04	10,500	3,080	193	476	11,500	3,230	14,300
	06/29/04	10,200	3,140	145	34	15,300	4,370	19,000
	09/23/04	10,800	2,980	ND(<256)	512	9,810	3,790	15,900
MW200	05/08/01	160	920	ND(<55)	390	ND(<5.0)	3,200	4,140
	02/27/02	580	350	74	150	24	1,570	1,460
	12/31/03	371	70.9	118	64.1	ND(<250)	448	191
	03/26/04	170	165	29.8	191	34.6	1,940	689
	06/29/04	897	102	174	26.6	79.8	768	632
	09/23/04	268	ND(<25)	102	ND(<40)	ND(<25)	102	57.2
MW300	05/08/01	610	1,500	ND(<55)	390	90	1,570	4,030
	02/27/02	240	550	ND(<20)	ND(<65)	ND(<20)	534	590
	01/09/04	151	984	ND(<7.30)	221	30.8	1,266	1,670
	03/26/04	287	1,080	7.74	154	99.0	1,036	1,850
	06/29/04	264	1,480	7.39	146	47.4	1,519	2,860
	09/23/04	218	1,050	ND(<25.6)	173	ND(<250)	1,400	2,310
MW400	05/08/01	9.2	33	ND(<1.1)	30	4.0	198	285
	02/27/02	37	28	3.7	7.6	ND(<2.0)	237	290
	01/09/04	4.65	ND(<5.00)	1.41	ND(<8.00)	ND(<5.00)	23.7	24.7
	03/26/04	7.12	ND(<5.00)	1.54	ND(<8.00)	ND(<5.00)	34.0	34.3
	06/29/04	11.7	39	1.37	30.6	ND(<5.00)	351.8	565
	09/23/04	7.58	ND(<5.00)	1.61	8.71	ND(<5.00)	76.2	118
MW1700	05/08/01	ND(<0.10)	ND(<0.10)	ND(<1.1)	ND(<0.70)	ND(<0.10)	ND(<0.50)	ND(<0.30)
	02/27/02	ND(<0.40)	ND(<0.40)	ND(<0.40)	ND(<1.3)	ND(<0.40)	ND(<0.90)	ND(<1.4)
	12/31/03	ND(<0.500)	ND(<5.00)	ND(<0.146)	ND(<8.00)	ND(<5.00)	ND(<5.00)	ND(<5.00)
	03/26/04	ND(<0.500)	ND(<5.00)	ND(<0.511)	ND(<8.00)	ND(<5.00)	ND(<5.00)	ND(<5.00)
	06/29/04	ND(<0.500)	ND(<5.00)	ND(<0.511)	ND(<8.00)	ND(<5.00)	ND(<5.00)	ND(<5.00)
	09/23/04	ND(<0.500)	ND(<5.00)	ND(<0.511)	ND(<8.00)	ND(<5.00)	ND(<5.00)	ND(<5.00)
NR 140 Enforcement Standard*		5	700	60	40	1,000	480	10,000
NR140 Preventive Action Limit*		0.5	140	12	8	200	96	1,000

Notes:
 all concentrations reported in ug/L unless noted
 ND() = Not detected above limit of detection (detection limit)
 * = Groundwater Standards from s. NR 140, Wis. Adm. Code, June 2003
 MTBE = methyl-tert-butyl-ether
 TMB = Trimethylbenzene
 7.58 = Enforcement Standard Exceedence
 8.71 = Preventive Action Limit Exceedence

Table 3, continued
 Summary of Groundwater Analytical Results
 Detected Compounds in Exceedence of NR 140 Groundwater Quality Standards
 Former Deering Property
 Seymour, Wisconsin

Well Number	Date Sampled	Benzene	Ethyl-benzene	MTBE	Naphthalene	Toluene	TMB	Total xylenes
PZ1800	06/05/01	2,200	24	240	ND(<70)	27	330	2,819
	01/26/02	1,400	38	290	ND(<65)	33	165	1,300
	02/27/02	1,200	ND(<20)	160	ND(<65)	ND(<20)	130	1,100
	12/31/03	20	ND(<5.00)	19.5	ND(<8.00)	ND(<5.00)	ND(<5.00)	ND(<5.00)
	03/26/04	179	ND(<5.00)	60.8	12.4	ND(<5.00)	18.3	132
	06/29/04	587	12.0	130	10.3	11	78.7	556
	09/23/04	3.30	ND(<5.00)	63.0	ND(<8.00)	ND(<5.00)	ND(<5.00)	ND(<5.00)
MW2300	06/05/01	ND(<0.10)	ND(<0.10)	ND(<1.1)	ND(<0.70)	ND(<0.10)	ND(<0.50)	ND(<0.30)
	02/27/02	ND(<0.40)	ND(<0.40)	ND(<0.40)	ND(<1.3)	ND(<0.40)	ND(<0.90)	ND(<1.4)
	12/31/03	ND(<0.500)	ND(<5.00)	ND(<0.146)	ND(<8.00)	ND(<5.00)	ND(<5.00)	ND(<5.00)
	03/26/04	ND(<0.500)	ND(<5.00)	ND(<0.511)	ND(<8.00)	ND(<5.00)	ND(<5.00)	ND(<5.00)
	06/29/04	ND(<0.500)	ND(<5.00)	ND(<0.511)	ND(<8.00)	ND(<5.00)	ND(<5.00)	ND(<5.00)
	09/23/04	ND(<0.500)	ND(<5.00)	ND(<0.511)	ND(<8.00)	ND(<5.00)	ND(<5.00)	ND(<5.00)
MW2400	06/05/01	0.33	1.4	12	ND(<0.70)	ND(<0.10)	ND(<0.50)	2.8
	02/27/02	ND(<0.40)	ND(<0.40)	ND(<0.40)	ND(<1.3)	ND(<0.40)	ND(<0.90)	ND(<1.4)
	12/31/03	ND(<0.500)	ND(<5.00)	5.27	ND(<8.00)	ND(<5.00)	ND(<5.00)	ND(<5.00)
	03/26/04	ND(<0.500)	7.48	1.78	ND(<8.00)	ND(<5.00)	7.23	13.2
	06/29/04	ND(<0.500)	ND(<5.00)	1.52	ND(<8.00)	ND(<5.00)	ND(<5.00)	ND(<5.00)
	09/23/04	ND(<0.500)	ND(<5.00)	2.35	ND(<8.00)	ND(<5.00)	ND(<5.00)	ND(<5.00)
MW2500	06/05/01	ND(<0.10)	ND(<0.10)	ND(<1.1)	ND(<0.70)	ND(<0.10)	ND(<0.50)	ND(<0.30)
	02/27/02	ND(<0.40)	ND(<0.40)	ND(<0.40)	ND(<1.3)	ND(<0.40)	ND(<0.90)	ND(<1.4)
	12/31/03	ND(<0.500)	ND(<5.00)	ND(<0.146)	ND(<8.00)	ND(<5.00)	ND(<5.00)	ND(<5.00)
	03/26/04	ND(<0.500)	ND(<5.00)	ND(<0.511)	ND(<8.00)	ND(<5.00)	ND(<5.00)	ND(<5.00)
	06/29/04	ND(<0.500)	ND(<5.00)	ND(<0.511)	ND(<8.00)	ND(<5.00)	ND(<5.00)	ND(<5.00)
	09/23/04	ND(<0.500)	ND(<5.00)	ND(<0.511)	ND(<8.00)	ND(<5.00)	ND(<5.00)	ND(<5.00)
MW2600	06/05/01	ND(<0.10)	ND(<0.10)	6.3	ND(<0.70)	ND(<0.10)	ND(<0.50)	ND(<0.30)
	02/27/02	ND(<0.40)	ND(<0.40)	4.6	ND(<1.3)	ND(<0.40)	ND(<0.90)	ND(<1.4)
	12/31/03	ND(<0.500)	ND(<5.00)	2.50	ND(<8.00)	ND(<5.00)	ND(<5.00)	ND(<5.00)
	03/26/04	ND(<0.500)	ND(<5.00)	2.78	ND(<8.00)	ND(<5.00)	ND(<5.00)	ND(<5.00)
	06/29/04	ND(<0.500)	ND(<5.00)	2.42	ND(<8.00)	ND(<5.00)	ND(<5.00)	ND(<5.00)
	09/23/04	ND(<0.500)	ND(<5.00)	3.33	ND(<8.00)	ND(<5.00)	ND(<5.00)	ND(<5.00)
NR 140 Enforcement Standard*		5	700	60	40	1,000	480	10,000
NR140 Preventive Action Limit*		0.5	140	12	8	200	96	1,000

Notes: all concentrations reported in ug/L unless noted
 ND() = Not detected above limit of detection (detection limit)
 * = Groundwater Standards from s. NR 140, Wis. Adm. Code, June 2003
 Based on previous reports, blanks indicate no detections
 MTBE = methyl-tert-butyl-ether
 TMB = Trimethylbenzene
7.58 = Enforcement Standard Exceedence
8.71 = Preventive Action Limit Exceedence

Table 3, continued
 Summary of Groundwater Analytical Results
 Detected Compounds in Exceedence of NR 140 Groundwater Quality Standards
 Former Deering Property
 Seymour, Wisconsin

Well Number	Date Sampled	Benzene	Ethyl-benzene	MTBE	Naphthalene	Toluene	TMB	Total xylenes
MW2700	06/05/01	ND(<0.10)	ND(<0.10)	ND(<1.1)	ND(<0.70)	ND(<0.10)	ND(<0.50)	ND(<0.30)
	02/27/02	ND(<0.40)	ND(<0.40)	ND(<0.40)	ND(<1.3)	ND(<0.40)	ND(<0.90)	ND(<1.4)
	12/31/03	ND(<0.500)	ND(<5.00)	ND(<0.146)	ND(<8.00)	ND(<5.00)	ND(<5.00)	ND(<5.00)
	03/26/04	ND(<0.500)	ND(<5.00)	ND(<0.511)	ND(<8.00)	ND(<5.00)	ND(<5.00)	ND(<5.00)
	06/29/04	ND(<0.500)	ND(<5.00)	ND(<0.511)	ND(<8.00)	ND(<5.00)	ND(<5.00)	ND(<5.00)
	09/23/04	ND(<0.500)	ND(<5.00)	ND(<0.511)	ND(<8.00)	ND(<5.00)	ND(<5.00)	ND(<5.00)
PZ2800	03/04/02	ND(<0.10)	ND(<0.10)	ND(<1.1)	ND(<0.70)	ND(<0.10)	ND(<0.50)	ND(<0.30)
	12/31/03	ND(<0.500)	ND(<5.00)	ND(<0.146)	ND(<8.00)	ND(<5.00)	ND(<5.00)	ND(<5.00)
	03/26/04	ND(<0.500)	ND(<5.00)	ND(<0.511)	ND(<8.00)	ND(<5.00)	ND(<5.00)	ND(<5.00)
	06/29/04	ND(<0.500)	ND(<5.00)	ND(<0.511)	ND(<8.00)	ND(<5.00)	ND(<5.00)	ND(<5.00)
	09/23/04	ND(<0.500)	ND(<5.00)	ND(<0.511)	ND(<8.00)	ND(<5.00)	ND(<5.00)	ND(<5.00)
PZ2900	03/04/02	ND(<0.10)	ND(<0.10)	ND(<1.1)	ND(<0.70)	ND(<0.10)	ND(<0.50)	ND(<0.30)
	12/31/03	ND(<0.500)	ND(<5.00)	ND(<0.146)	ND(<8.00)	ND(<5.00)	ND(<5.00)	ND(<5.00)
	03/26/04	ND(<0.500)	ND(<5.00)	ND(<0.511)	ND(<8.00)	ND(<5.00)	ND(<5.00)	ND(<5.00)
	06/29/04	ND(<0.500)	ND(<5.00)	ND(<0.511)	ND(<8.00)	ND(<5.00)	ND(<5.00)	ND(<5.00)
	09/23/04	ND(<0.500)	ND(<5.00)	ND(<0.511)	ND(<8.00)	ND(<5.00)	ND(<5.00)	ND(<5.00)
PZ3000	03/04/02	ND(<0.10)	ND(<0.10)	ND(<1.1)	ND(<0.70)	ND(<0.10)	ND(<0.50)	ND(<0.30)
	12/31/03	ND(<0.500)	ND(<5.00)	ND(<0.146)	ND(<8.00)	ND(<5.00)	ND(<5.00)	ND(<5.00)
	03/26/04	ND(<0.500)	ND(<5.00)	ND(<0.511)	ND(<8.00)	ND(<5.00)	ND(<5.00)	ND(<5.00)
	06/29/04	ND(<0.500)	ND(<5.00)	ND(<0.511)	ND(<8.00)	ND(<5.00)	ND(<5.00)	ND(<5.00)
	09/23/04	ND(<0.500)	ND(<5.00)	ND(<0.511)	ND(<8.00)	ND(<5.00)	ND(<5.00)	ND(<5.00)
PZ3100	03/04/02	ND(<0.10)	ND(<0.10)	ND(<1.1)	ND(<0.70)	ND(<0.10)	ND(<0.50)	ND(<0.30)
	12/31/03	ND(<0.500)	ND(<5.00)	ND(<0.146)	ND(<8.00)	ND(<5.00)	ND(<5.00)	ND(<5.00)
	03/26/04	ND(<0.500)	ND(<5.00)	ND(<0.511)	ND(<8.00)	ND(<5.00)	ND(<5.00)	ND(<5.00)
	06/29/04	ND(<0.500)	ND(<5.00)	ND(<0.511)	ND(<8.00)	ND(<5.00)	ND(<5.00)	ND(<5.00)
	09/23/04	ND(<0.500)	ND(<5.00)	ND(<0.511)	ND(<8.00)	ND(<5.00)	ND(<5.00)	ND(<5.00)
NR 140 Enforcement Standard*		5	700	60	40	1,000	480	10,000
NR140 Preventive Action Limit*		0.5	140	12	8	200	96	1,000
<p>Notes: all concentrations reported in ug/L unless noted ND() = Not detected above limit of detection (detection limit) * = Groundwater Standards from s. NR 140, Wis. Adm. Code, June 2003 Based on previous reports, blanks indicate no detections MTBE = methyl-tert-butyl-ether TMB = Trimethylbenzene <u>7.58</u> = Enforcement Standard Exceedence <u>8.71</u> = Preventive Action Limit Exceedence</p>								

Table C2

Table 2 Soil Analytical Results, UST Closure Assessment, Former Deering Property, Seymour, WI

Sample Number	Sample Depth (feet)	Date Sampled	DRO (mg/kg)	GRO (mg/kg)	Lead (mg/kg)	Lube Oil (mg/kg)	PCBs (µg/kg)	Relevant and Significant Analytical Results (µg/kg)											
								Benzene	n-Butylbenzene	sec-Butylbenzene	Ethylbenzene	Isopropylbenzene	p-Isopropyltoluene	Naphthalene	n-Propylbenzene	Toluene	1,2,4-Trimethylbenzene	1,3,5-Trimethylbenzene	Xylenes
WAC Residual Contaminant Level			250	250	50	NE	NE	5.5	NE	NE	2900	NE	NE	NE	NE	1500	NE	NE	4100
NR 746.06 Table 1 Values								8500	NE	NE	4600	NE	NE	2700	NE	38000	83000	11000	42000
NR 746.06 Table 2 Values								1100	NE	NE	NE	NE	NE	NE	NE	NE	NE	NE	NE
S2	4	01/10/01	---	< 10	< 6	---	---	< 25	---	---	< 25	---	---	---	< 25	43	< 25	< 75	
S3	3	01/10/01	---	< 10	6.8 J	---	---	< 25	---	---	< 25	---	---	---	< 25	< 25	< 25	< 75	
S6	8.5	01/10/01	290	---	---	550	---	---	---	---	---	---	---	---	---	---	---	---	
S7	8.5	01/10/01	47	---	---	120	---	---	---	---	---	---	---	---	---	---	---	---	
S8	3	01/10/01	---	< 10	120	---	---	< 25	---	---	< 25	---	---	---	< 25	32	< 25	< 75	
S11	6	01/10/01	---	13	< 6	---	---	< 25	---	---	130	---	---	---	< 25	3300	1000	140	
S13	3.5	01/11/01	16	---	6.5 J	---	< 3.2	< 25	56	< 25	---	< 25	< 25	< 25	< 25	188	---	460	
S15	2	01/11/01	9300	190	---	---	---	< 250	---	---	1300	---	---	---	1900	21000	7800	19600	
S16	8	01/11/01	230	---	---	---	---	---	---	---	---	---	---	---	---	---	---	---	
S17	8	01/11/01	< 10	---	---	---	---	---	---	---	---	---	---	---	---	---	---	---	
S18	5	01/11/01	---	---	---	---	---	< 250	120000	11000	57000 ¹	11000	4900	23000 ¹	41000	10000	240000 ¹	100000 ¹	460000 ¹
S20	2.5	01/15/01	---	11000	166	---	---	< 5000	---	---	12000 ¹	---	---	---	< 5000	770000 ¹	400000 ¹	500000 ¹	
S21	2.5	01/15/01	---	< 10	22	---	---	< 25	---	---	25	---	---	---	.55	150	65	270	
S23	2.5	01/15/01	---	280	426	---	---	< 1250	---	---	11000 ¹	---	---	---	5400	240000 ¹	130000 ¹	230000 ¹	

Key:

- DRO = Diesel Range Organics
- GRO = Gasoline Range Organics
- mg/kg = milligrams per kilogram
- µg/kg = micrograms per kilogram
-
- NE = Not Established by Wisconsin Administrative Code (WAC)
- J = Value in between Limit of Detection and Limit of Quantification
- RCL = Residual Contaminant Level
- 120 = Residual Contaminant Level Exceeded
- xxx 1 = Table 1 Value Exceeded

Table 5 Soil Laboratory Analytical Results, Former Deering Property, Seymour, WI

Boring Number	Sample Number	Sample Depth (feet)	Date Sampled	DRO (mg/kg)	GRO (mg/kg)	Lead (mg/kg)	Cadmium (mg/kg)	Relevant and Significant VOC Analytical Results (µg/kg)							
								Benzene	1,2-Dichloroethane	Ethylbenzene	MTBE	Toluene	1,2,4-Trimethylbenzene	1,3,5-Trimethylbenzene	Xylenes
WAC Residual Contaminant Level				250	250	50	50	5.5	4.9	2900	NE	1500	NE	NE	4100
NR 746.06 Table 1 Values								8500	NE	4600	NE	38000	83000	11000	42000
NR 746.06 Table 2 Values								1100	NE	NE	NE	NE	NE	NE	NE
B100	S101	2.5-4.5	05/01/01	--	3300	5.6	--	< 1800 (1020)	< 4800	88000 ¹	< 4800	37000	370000 ¹	160000 ¹	510000 ¹
B200	S201	2.5-4.5	05/01/01	< 1.8	15	8.2	--	< 25	< 25	< 25	< 25	< 25	150	310	41 J
B400	S401	2.5-4.5	05/01/01	< 1.7	< 1.3	7.5	--	< 25	< 25	< 25	< 25	< 25	< 25	< 25	< 50
B500	S501	0-2	05/01/01	2.4	< 1.3	25.3	--	< 25	< 25	< 25	< 25	< 25	< 25	< 25	< 50
B600	S602	2.5-4.5	05/01/01	--	< 1.4	3.2	--	< 25	< 25	< 25	< 25	< 25	< 25	< 25	< 50
B700	S702	2.5-4.5	05/01/01	--	300	20.2	--	< 140	< 380	1800	< 380	< 260	9500	7700	7000
B800	S802	2.5-4.5	05/01/01	--	3300	6.6	--	1600 J ²	< 1900	74000 ¹	< 1900	6800	110000 ¹	55000 ¹	195200 J ¹
B900	S902	2.5-4.5	05/01/01	--	1100	3.9	--	< 1800 (1330) ²	< 4800	45000 ¹	< 4800	82000 ¹	98000 ¹	91000 ¹	223000 ¹
B1000	S1002	2.5-4.5	05/01/01	--	490	13.1	--	< 350	< 950	< 700	< 950	< 650	35000	30000 ¹	30000
B1100	S1102	2.5-4.5	05/01/01	--	13	71.7	--	30	< 25	290	< 25	78	2300	430	1010
B1200	S1201	0-2	05/01/01	--	< 1.3	19.2	--	< 25	< 25	< 25	< 25	< 25	< 25	< 25	30 J
B1300	S1301	0-2	05/01/01	--	6800	50.1	--	< 1800 (<60)	< 9500	19000 ¹	< 9500	< 6500	740000 ¹	340000 ¹	700000 ¹
B1500	S1502	2.5-4.5	05/01/01	--	21	5.8	--	< 25	< 25	100	< 25	34	1300	340	226
B1600	S1601	2.5-4.5	05/01/01	--	< 1.2	3.1	--	< 25	< 25	< 25	< 25	< 25	< 25	< 25	< 50

Table 5 Soil Laboratory Analytical Results, Former Deering Property, Seymour, WI

Boring Number	Sample Number	Sample Depth (feet)	Date Sampled	DRO (mg/kg)	GRO (mg/kg)	Lead (mg/kg)	Cadmium (mg/kg)	Relevant and Significant VOC Analytical Results (µg/kg)							
								Benzene	1,2-Dichloroethane	Ethylbenzene	MTBE	Toluene	1,2,4-Trimethylbenzene	1,3,5-Trimethylbenzene	Xylenes
WAC Residual Contaminant Level				250	250	50	50	5.5	4.9	2900	NE	1500	NE	NE	4100
NR 746.06 Table 1 Values								8500	NE	4600	NE	38000	83000	11000	42000
NR 746.06 Table 2 Values								1100	NE	NE	NE	NE	NE	NE	
B1700	S1701	2.5-4.5	05/01/01	---	< 1.3	4.9	---	< 25	< 25	< 25	< 25	< 25	< 25	< 25	< 50
B1900	S1901	0-2	05/30/01	---	---	---	---	---	---	---	---	---	---	---	---
B2000	S2001	0-2	05/30/01	---	---	36.8	0.39	---	---	---	---	---	---	---	---
B2100	S2101	0-2	05/30/01	---	---	---	---	---	---	---	---	---	---	---	---
B2200	S2201	2.5-4.5	05/30/01	---	---	---	---	< 25	< 25	< 25	< 25	< 25	< 25	< 25	< 50
B2300	S2301	2.5-4.5	05/30/01	---	---	---	---	< 25	< 25	< 25	< 25	< 25	< 25	< 25	< 50
B2400	S2401	2.5-4.5	05/30/01	---	---	---	---	< 25	< 25	< 25	< 25	< 25	< 25	< 25	< 50
B2500	S2501	2.5-4.5	05/31/01	---	---	---	---	< 25	< 25	< 25	< 25	< 25	< 25	< 25	< 50
B2600	S2601	2.5-4.5	05/31/01	---	---	---	---	< 25	< 25	< 25	< 25	< 25	< 25	< 25	< 50
B2700	S2701	2.5-4.5	05/31/01	---	---	---	---	< 25	< 25	< 25	< 25	< 25	< 25	< 25	< 50

- Key:
- WAC = Wisconsin Administrative Code
 - DRO = Diesel Range Organics
 - GRO = Gasoline Range Organics
 - MTBE = Methyl-Tertiary-Butyl-Ether
 - mg/kg = milligrams per kilogram
 - µg/kg = micrograms per kilogram
 -
 -
 -
 - NE = Not Established by Wisconsin Administrative Code
 - J = Value in between Limit of Detection and Limit of Quantitation
 - 120 = Residual Contaminant Level Exceeded
 - (1020) = Estimated benzene concentration from lower dilution factor
 - xxx 1 = Table 1 Values Exceeded
 - xxx 2 = Table 2 Values Exceeded

Table 5 Soil Laboratory Analytical Results, Former Deering Property, Seymour, WI

Boring Number	Sample Number	Sample Depth (feet)	Date Sampled	Relevant and Significant PAH Analytical Results (mg/kg)																
				2-Methylnaphthalene	Acenaphthene	Acenaphthylene	Anthracene	Benzo(A)Anthracene	Benzo(A)Pyrene	Benzo(B)Fluoranthene	Benzo(K)Fluoranthene	Benzo(G,H,I)Perylene	Chrysene	Fluoranthene	Fluorene	Indeno(1,2,3-CD)Pyrene	Naphthalene	Phenanthrene	Pyrene	Dibenz(a,h)anthracene
Suggested Generic RCLs - Ground-water Pathway				20	38	0.7	3000	17	48	360	870	6800	37	500	100	680	0.4	1.8	8700	38
Suggested Generic RCLs - Direct Contact Pathway for Non-Industrial Sites				600	900	18	5000	0.088	0.0088	0.088	0.88	1.8	8.8	600	600	0.088	20	18	500	0.0088
B100	S101	2.5-4.5	05/01/01	---	---	---	---	---	---	---	---	---	---	---	---	---	---	---	---	---
B200	S201	2.5-4.5	05/01/01	---	---	---	---	---	---	---	---	---	---	---	---	---	---	---	---	---
B400	S401	2.5-4.5	05/01/01	< 0.018	< 0.021	0.28	< 0.0031	0.0038	0.019	0.03	0.0029	0.014	< 0.0046	0.074	< 0.0097	0.02	< 0.018	0.0057	0.013	< 0.0048
B500	S501	0-2	05/01/01	3.1	2.5	0.7	0.11	0.095	0.11	0.13	0.051	0.1	0.27	0.71	3.4	0.16	< 0.018	0.21	0.25	0.033
B600	S602	2.5-4.5	05/01/01	---	---	---	---	---	---	---	---	---	---	---	---	---	---	---	---	---
B700	S702	2.5-4.5	05/01/01	---	---	---	---	---	---	---	---	---	---	---	---	---	---	---	---	---
B800	S802	2.5-4.5	05/01/01	---	---	---	---	---	---	---	---	---	---	---	---	---	---	---	---	---
B900	S902	2.5-4.5	05/01/01	---	---	---	---	---	---	---	---	---	---	---	---	---	---	---	---	---
B1000	S1002	2.5-4.5	05/01/01	---	---	---	---	---	---	---	---	---	---	---	---	---	---	---	---	---
B1100	S1102	2.5-4.5	05/01/01	---	---	---	---	---	---	---	---	---	---	---	---	---	---	---	---	---
B1200	S1201	0-2	05/01/01	---	---	---	---	---	---	---	---	---	---	---	---	---	---	---	---	---
B1300	S1301	0-2	05/01/01	---	---	---	---	---	---	---	---	---	---	---	---	---	---	---	---	---
B1500	S1502	2.5-4.5	05/01/01	---	---	---	---	---	---	---	---	---	---	---	---	---	---	---	---	---
B1600	S1601	2.5-4.5	05/01/01	---	---	---	---	---	---	---	---	---	---	---	---	---	---	---	---	---

Table 5 Soil Laboratory Analytical Results, Former Deering Property, Seymour, WI

Boring Number	Sample Number	Sample Depth (feet)	Date Sampled	Relevant and Significant PAH Analytical Results (mg/kg)																
				2-Methylnaphthalene	Acenaphthene	Acenaphylene	Anthracene	Benzo(a)Anthracene	Benzo(a)Pyrene	Benzo(b)Fluoranthene	Benzo(k)Fluoranthene	Benzo(g,h,i)Perylene	Chrysene	Fluorethene	Fluorene	Indeno(1,2,3-CD)Pyrene	Naphthalene	Phenanthrene	Pyrene	Dibenz(a,h)anthracene
Suggested Generic RCLs - Ground-water Pathway				20	38	0.7	3000	17	48	360	870	6800	37	500	100	.680	0.4	1.8	8700	38
Suggested Generic RCLs - Direct Contact Pathway for Non-Industrial Sites				600	900	18	5000	0.088	0.0088	0.088	0.88	1.8	8.8	600	600	0.088	20	18	500	0.0088
B1700	S1701	2.5-4.5	05/01/01	---	---	---	---	---	---	---	---	---	---	---	---	---	---	---	---	---
B1900	S1901	0-2	05/30/01	< 0.16	< 0.18	< 0.16	< 0.028	0.16	0.27	0.31	0.11	0.32	1.8	0.51	< 0.086	0.24	< 0.16	0.25	0.49	0.21
B2000	S2001	0-2	05/30/01	---	---	---	---	---	---	---	---	---	---	---	---	---	---	---	---	---
B2100	S2101	0-2	05/30/01	0.46	1.1	< 0.080	< 0.014	0.34	0.48	0.62	0.22	0.54	0.5	1.1	< 0.043	0.45	< 0.080	0.51	0.92	0.45
B2200	S2201	2.5-4.5	05/30/01	---	---	---	---	---	---	---	---	---	---	---	---	---	---	---	---	---
B2300	S2301	2.5-4.5	05/30/01	---	---	---	---	---	---	---	---	---	---	---	---	---	---	---	---	---
B2400	S2401	2.5-4.5	05/30/01	---	---	---	---	---	---	---	---	---	---	---	---	---	---	---	---	---
B2500	S2501	2.5-4.5	05/31/01	---	---	---	---	---	---	---	---	---	---	---	---	---	---	---	---	---
B2600	S2601	2.5-4.5	05/31/01	---	---	---	---	---	---	---	---	---	---	---	---	---	---	---	---	---
B2700	S2701	2.5-4.5	05/31/01	---	---	---	---	---	---	---	---	---	---	---	---	---	---	---	---	---

- Key:
- PAH = Polynuclear Aromatic Hydrocarbons
 - mg/kg = milligrams per kilogram
 -
 - NE = Not Analyzed
 - NE = Not Established by Wisconsin Administrative Code (WAC)
 - J = Value in between Limit of Detection and Limit of Quantitation
- | | |
|----|------------------------------------------------------------------------|
| 32 | = Exceeds Suggested Generic RCL for Protection of Ground-water Quality |
| 32 | = Exceeds Suggested Generic RCL for Direct Contact Exposure |

Table **e1**
 Excavation Closure Soil Analytical Results
 Former Deering Property
 Seymour, Wisconsin

Excavation ID	Sample ID Number	Sampling Depth, ft bgs	Field OVM Readings, i.u.	PVOCs, ug/kg							Total Xylene
				Benzene	Ethylbenzene	MTBE	Naphthalene	Toluene	1,2,4 TMB	1,3,5 TMB	
A	EXA-1	4	110	ND(<25)	ND(<25)	ND(<25)	28.1	ND(<25)	55.9	28.7	79.8
	EXA-2	4	117	33.7	212	ND(<25)	309	145	1,270	371	819
	EXA-3	4	29.4	ND(<25)	112	ND(<25)	87.4	111	191	107	340
	EXA-4	4	338	29.7	5,120	ND(<25)	37,000	1,830	260	49,000	23,900
	EXA-Base	8	1279	2,890	21,700	1,020	13,700	35,100	53,800	18,800	99,000
B	EXB-E	4	392	323	42,000	255	35,800	12,300	177,000	85,100	217,000
	EXB-W	4	63.9	ND(<25)	ND(<25)	ND(<25)	81.4	ND(<25)	90.8	55.5	91.7
	EXB-N	4	174	ND(<25)	441	ND(<25)	230	66.3	2,810	342	1,920
	EXB-S	4	171	ND(<25)	1,680	ND(<25)	2,080	613	9,580	3,860	10,000
	EXB-Base	7	87.9	59.0	1,210	149	1,500	766	6,840	2,460	8,420
C	EXC-E	4	181	107	149	ND(<25)	42.8	269	154	67.8	571
	EXC-W	4	9.1	ND(<25)	28.2	ND(<25)	ND(<25)	ND(<25)	ND(<25)	ND(<25)	ND(<25)
	EXC-N	4	51.2	28.8	182	ND(<25)	153	209	420	144	931
	EXC-S	4	10.3	42.4	249	ND(<25)	68.4	419	433	154	1,220
	EXC-Base	7	17.5	37.2	739	ND(<25)	742	473	2,870	1,110	3,150
D	EXD-E	4	25.8	43.2	225	ND(<25)	84.3	315	557	191	1170
	EXD-W	4	10.2	90.9	429	ND(<25)	202	529	878	322	2110
	EXD-N	4	12.0	ND(<25)	70.8	ND(<25)	58.6	102	209	88.3	364
	EXD-S	4	12.5	ND(<25)	71.8	ND(<25)	41.7	62.7	170	57.4	447
	EXD-Base	7	18.8	ND(<25)	31.2	ND(<25)	ND(<25)	56.8	113	50.1	217
NR 720 GRCL (blank = no standard)				5.5*	2,900			1,500			4,100
NR 746 Table 1 - Soil Porosity (blank = no standard)				8,500	4,600			38,000	83,000	11,000	42,000
NR 746 Table 2 - Direct Contact (blank = no standard)				1,100							

Notes: ND() = Not detected above quantification limit (detection limit)
 All samples collected on August 18, 2003
 GRCL = NR 720 generic residual contaminant level
 * = The GRCL for benzene is 5.5 ug/kg unless the sample is preserved with methanol then accepted GRCL is the detection limit of 25 ug/kg
90.6 = Standard Exceedance

I#3a

BAYLAKE BANK

MW2600 CREEK

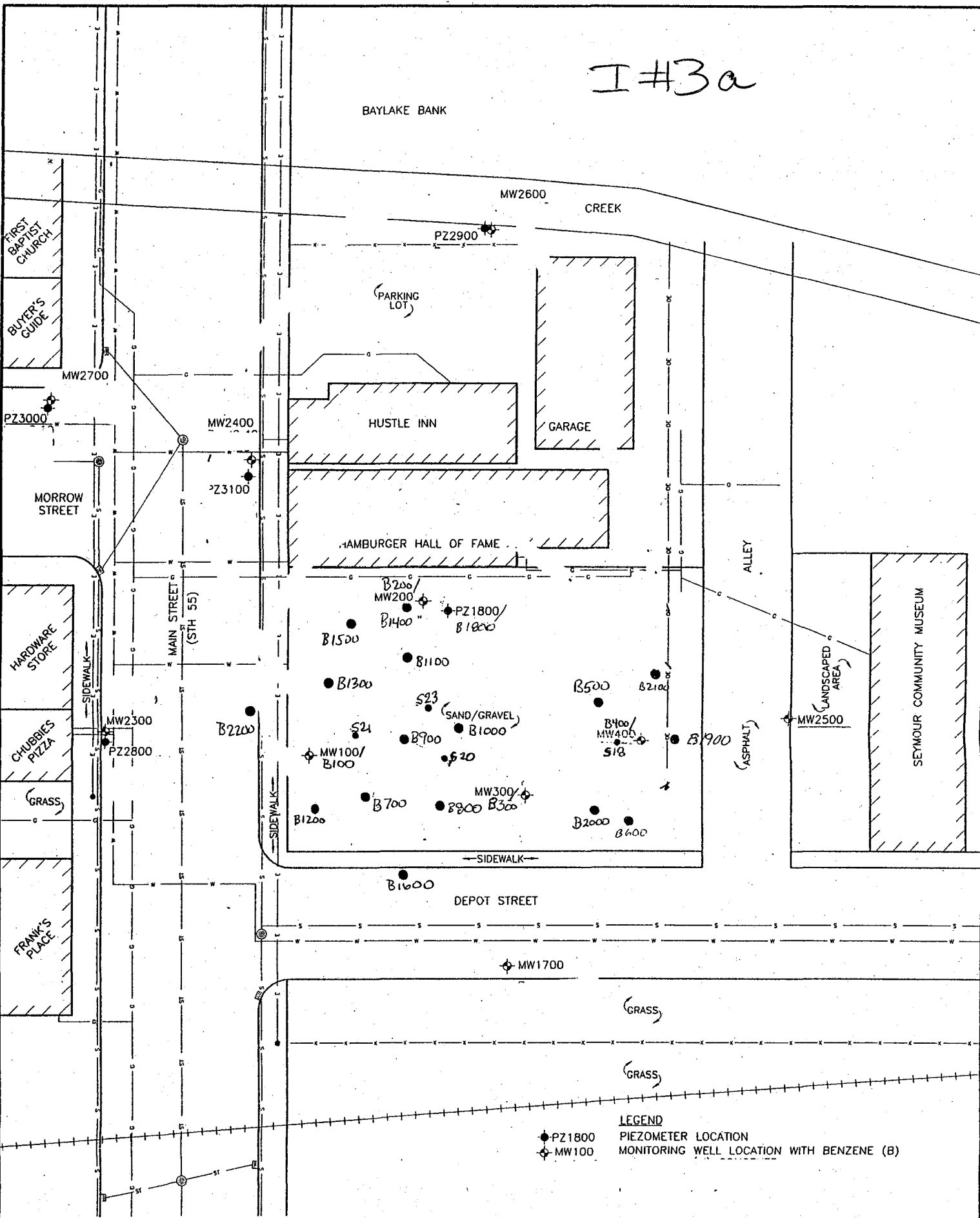

LEGEND
 ● PZ1800 PIEZOMETER LOCATION
 ◊ MW100 PIEZOMETER LOCATION WITH BENZENE (B)

- OVERHEAD ELECTRIC LINE
- E— UNDERGROUND ELECTRIC LINE
- S— SANITARY SEWER LINE
- ST— STORM SEWER LINE
- +— RAILROAD TRACKS
- W— WATER LINE
- G— GAS LINE
- X— FENCE
- ⊙ MANHOLE
- ⊠ INLET

DRAWN BY: KRE PROJECT: CSY-1162 DATE: 05/10/01

REV. DATE 4/1/02
 THIS DRAWING AND ALL INFORMATION CONTAINED THEREON IS THE PROPERTY OF NORTHERN ENVIRONMENTAL INCORPORATED AND SHALL NOT BE COPIED OR USED EXCEPT FOR THE PURPOSE FOR WHICH IT IS EXPRESSLY FURNISHED.

Northern Environmental
 Hydrologists • Engineers • Geologists

CITY OF SEYMOUR
 SEYMOUR, WISCONSIN
 Soil Boring / Monitoring Well
 location MAP

Rev. E2M Environmental and Engineering Mgt. 01/15/05

FIGURE

S:\PROJ\CSY\11081162\DRAWINGS\052201-4B.DWG

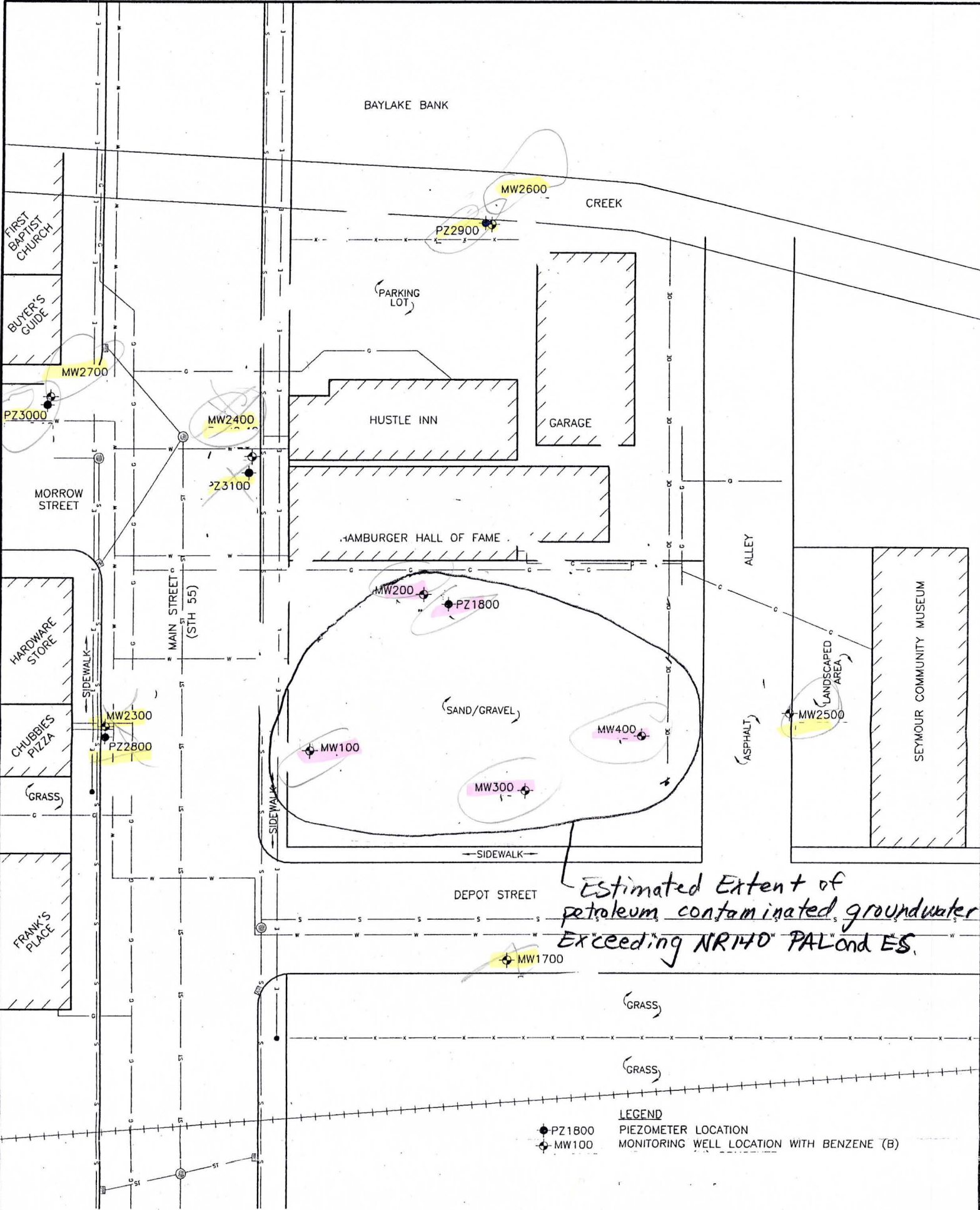

S:\PROJ\CSY\11091162\DRAWINGS\052201-4E.DWG

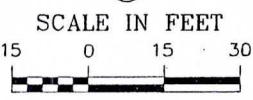

- LEGEND**
- PZ1800 PIEZOMETER LOCATION
 - ◆ MW100 MONITORING WELL LOCATION WITH BENZENE (B)
 - DE — OVERHEAD ELECTRIC LINE
 - E — UNDERGROUND ELECTRIC LINE
 - S — SANITARY SEWER LINE
 - ST — STORM SEWER LINE
 - + + + — RAILROAD TRACKS
 - W — WATER LINE
 - G — GAS LINE
 - X — FENCE
 - ⊙ MANHOLE
 - ⊠ INLET

DRAWN BY: KRE	PROJECT: CSY-1162	DATE: 05/10/01
REV. DATE: 4/1/02	THIS DRAWING AND ALL INFORMATION CONTAINED THEREON IS THE PROPERTY OF NORTHERN ENVIRONMENTAL INCORPORATED AND SHALL NOT BE COPIED OR USED EXCEPT FOR THE PURPOSE FOR WHICH IT IS EXPRESSLY FURNISHED.	
Northern Environmental Hydrologists • Engineers • Geologists		

CITY OF SEYMOUR
SEYMOUR, WISCONSIN

Extent of Groundwater CONTAMINATION (Remaining)
09/23/04

Revised: E2M ENV. and ENGR. MGT. 01/17/05

I#6

Table 2
 Groundwater Elevation Summary
 Former Deering Property
 Seymour, Wisconsin

Well ID Number	Sample Date	Depth to Groundwater (ft)	Elevation of Groundwater (ft. MSL)	Elevation Ground (ft. MSL)	Top of Riser (ft MSL)
MW100	05/08/01	4.02	785.60	790.07	789.62
	05/18/01	5.14	784.48		
	06/19/01	4.57	785.05		
	01/11/02	6.56	783.06		
	02/27/02	4.89	784.73		
	12/31/03	6.20	783.42		
	03/26/04	6.41	783.21		
	06/29/04	6.30	783.32		
09/23/04	7.03	782.59			
MW200	05/08/01	4.93	784.86	790.10	789.79
	05/18/01	5.39	784.40		
	06/19/01	3.46	786.33		
	01/11/02	6.65	783.14		
	02/27/02	4.70	785.09		
	12/31/03	5.86	783.93		
	03/26/04	5.26	784.53		
	06/29/04	5.75	784.04		
09/23/04	7.08	782.71			
MW300	05/08/01	2.21	787.65	790.35	789.86
	05/18/01	2.77	787.09		
	06/19/01	1.95	787.91		
	01/11/02	4.39	785.47		
	02/27/02	2.78	787.08		
	01/09/04	6.94	782.92		
	03/26/04	3.10	786.76		
	06/29/04	3.35	786.51		
09/23/04	5.69	784.17			
MW400	05/08/01	2.85	786.95	790.45	789.80
	05/18/01	3.43	786.37		
	06/19/01	2.36	787.44		
	01/11/02	5.03	784.77		
	02/27/02	3.43	786.37		
	01/09/04	5.82	783.98		
	03/26/04	3.35	786.45		
	06/29/04	4.25	785.55		
09/23/04	6.02	783.78			

Note: - Depth to groundwater measured from top of PVC (riser) elevation
 ft. MSL = Elevation in feet referenced to Mean Sea Level
 - Riser elevations obtained from previous data reports

Table 2, continued
 Groundwater Elevation Summary
 Former Deering Property
 Seymour, Wisconsin

Well ID Number	Sample Date	Depth to Groundwater (ft)	Elevation of Groundwater (ft. MSL)	Elevation Ground (ft. MSL)	Top of Riser (ft MSL)
MW1700	05/08/01	1.80	788.33	790.66	790.13
	05/18/01	2.68	787.45		
	06/19/01	1.40	788.73		
	01/11/02	5.11	785.02		
	02/27/02	2.11	788.02		
	12/31/03	3.52	786.61		
	03/26/04	2.39	787.74		
	06/29/04	2.85	787.28		
09/23/04	5.89	784.24			
PZ1800	06/19/01	23.66	766.22	790.06	789.88
	01/11/02	25.55	764.33		
	02/27/02	25.12	764.76		
	12/31/03	25.56	764.32		
	03/26/04	25.92	763.96		
	06/29/04	24.72	765.16		
	09/23/04	27.31	762.57		
MW2300	06/19/01	5.49	784.15	790.28	789.64
	01/11/02	7.42	782.22		
	02/27/02	7.21	782.43		
	12/31/03	7.83	781.81		
	03/26/04	7.82	781.82		
	06/29/04	7.90	781.74		
	09/23/04	7.84	781.80		
MW2400	06/19/01	6.49	782.34	789.33	788.83
	01/11/02	7.39	781.44		
	02/27/02	7.05	781.78		
	12/31/03	7.02	781.81		
	03/26/04	6.83	782.00		
	06/29/04	6.73	782.10		
	09/23/04	7.51	781.32		
MW2500	06/19/01	3.70	786.29	790.51	789.99
	01/11/02	5.69	784.30		
	02/27/02	4.12	785.87		
	12/31/03	5.14	784.85		
	03/26/04	3.92	786.07		
	06/29/04	5.01	784.98		
	09/23/04	6.44	783.55		

Note: - Depth to groundwater measured from top of PVC (riser) elevation
 ft. MSL = Elevation in feet referenced to Mean Sea Level
 - Riser elevations obtained from previous data reports

Table 2, continued
 Groundwater Elevation Summary
 Former Deering Property
 Seymour, Wisconsin

Well ID Number	Sample Date	Depth to Groundwater (ft)	Elevation of Groundwater (ft. MSL)	Elevation Ground (ft. MSL)	Top of Riser (ft MSL)
MW2600	06/19/01	5.30	783.49	789.17	788.79
	01/11/02	6.57	782.22		
	02/27/02	5.98	782.81		
	12/31/03	6.15	782.64		
	03/26/04	5.44	783.35		
	06/29/04	6.14	782.65		
	09/23/04	6.50	782.29		
MW2700	06/19/01	4.98	783.57	788.89	788.55
	01/11/02	6.54	782.01		
	02/27/02	5.54	783.01		
	12/31/03	5.79	782.76		
	03/26/04	5.21	783.34		
	06/29/04	5.64	782.91		
	09/23/04	6.14	782.41		
PZ2800	02/27/02	24.65	765.04	790.20	789.69
	12/31/03	24.88	764.81		
	03/26/04	25.72	763.97		
	06/29/04	28.27	761.42		
	09/23/04	27.01	762.68		
PZ2900	02/27/02	31.33	757.55	789.16	788.88
	12/31/03	17.56	771.32		
	03/26/04	18.06	770.82		
	06/29/04	16.82	772.06		
	09/23/04	17.57	771.31		
PZ3000	02/27/02	29.28	759.24	789.04	788.52
	12/31/03	13.16	775.36		
	03/26/04	14.14	774.38		
	06/29/04	13.14	775.38		
	09/23/04	12.83	775.69		
PZ3100	02/27/02	24.32	764.70	789.40	789.02
	12/31/03	25.92	763.10		
	03/26/04	24.99	764.03		
	06/29/04	23.91	765.11		
	09/23/04	26.88	762.14		

Note: - Depth to groundwater measured from top of PVC (riser) elevation
 ft. MSL = Elevation in feet referenced to Mean Sea Level
 - Riser elevations obtained from previous data reports

I # 76

BAYLAKE BANK

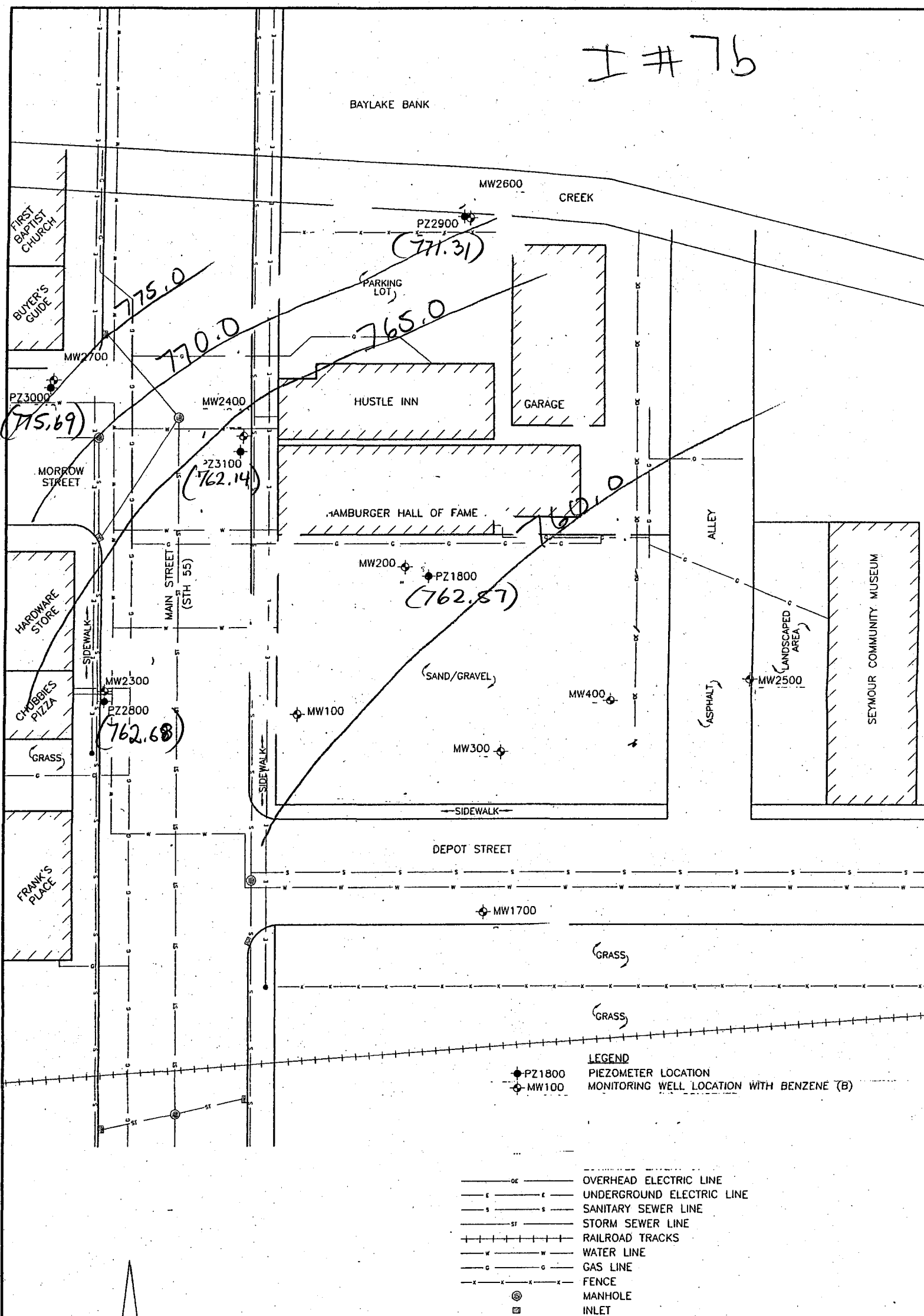

LEGEND
 ● PZ1800 PIEZOMETER LOCATION
 ○ MW100 MONITORING WELL LOCATION WITH BENZENE (B)

- OVERHEAD ELECTRIC LINE
- E— UNDERGROUND ELECTRIC LINE
- S— SANITARY SEWER LINE
- ST— STORM SEWER LINE
- +—+—+ RAILROAD TRACKS
- W— WATER LINE
- G— GAS LINE
- X—X—X FENCE
- ⊙ MANHOLE
- ⊠ INLET

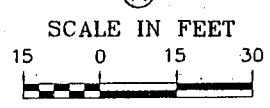

DRAWN BY: KRE PROJECT: CSY-1162 DATE: 05/10/01
 REV. DATE 4/1/02

THIS DRAWING AND ALL INFORMATION CONTAINED THEREON IS THE PROPERTY OF NORTHERN ENVIRONMENTAL INCORPORATED AND SHALL NOT BE COPIED OR USED EXCEPT FOR THE PURPOSE FOR WHICH IT IS EXPRESSLY FURNISHED.

Northern Environmental
 Hydrologists • Engineers • Geologists

CITY OF SEYMOUR
 SEYMOUR, WISCONSIN
**GROUNDWATER FLOW
 CONTOUR (QSEP)**
 09/23/04

S:\PROJ\CSY\11091162\DRAWINGS\052201-4B.DWG

I#7a

BAYLAKE BANK

182.0

MW2600 (782.29) CREEK

FIRST BAPTIST CHURCH

BUYER'S GUIDE

(PARKING LOT)

MW2700 (782.41)

PZ3000

HUSTLE INN

GARAGE

MORROW STREET

MW2400 (781.32)

PZ3100

HAMBURGER HALL OF FAME

ALLEY

HARDWARE STORE

MW200 (782.71)

PZ1800

183.0

CHUBBIES PIZZA

MW2300 (781.30)

PZ2800

(SAND/GRAVEL)

MW100 (782.59)

MW400 (783.78)

MW2500 (783.55)

GRASS

MAIN STREET (STH 55)

MW300 (784.17)

784.0

FRANK'S PLACE

DEPOT STREET

MW1700 (784.24)

(GRASS)

(GRASS)

LEGEND

- PZ1800 PIEZOMETER LOCATION
- MW100 MONITORING WELL LOCATION WITH BENZENE (B)

- OVERHEAD ELECTRIC LINE
- E— UNDERGROUND ELECTRIC LINE
- S— SANITARY SEWER LINE
- ST— STORM SEWER LINE
- +—+ RAILROAD TRACKS
- W— WATER LINE
- G— GAS LINE
- X—X FENCE
- ⊙ MANHOLE
- ⊞ INLET



SCALE IN FEET

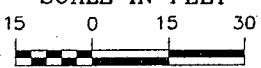

DRAWN BY: KRE PROJECT: CSY-1162 DATE: 05/10/01

REV. DATE 4/1/02

THIS DRAWING AND ALL INFORMATION CONTAINED THEREON IS THE PROPERTY OF NORTHERN ENVIRONMENTAL INCORPORATED AND SHALL NOT BE COPIED OR USED EXCEPT FOR THE PURPOSE FOR WHICH IT IS EXPRESSLY FURNISHED.

CITY OF SEYMOUR SEYMOUR, WISCONSIN

GROUNDWATER FLOW CONTOURS 09/23/04 (SHALLOW)

Northern Environmental SM Hydrologists • Engineers • Geologists

Rev. E2M BNV, and ENGR. MGT. 01/17/05

FIGURE

S:\PROJ\CSY\11091162\DRAWINGS\052201-4B.DWG

I#8

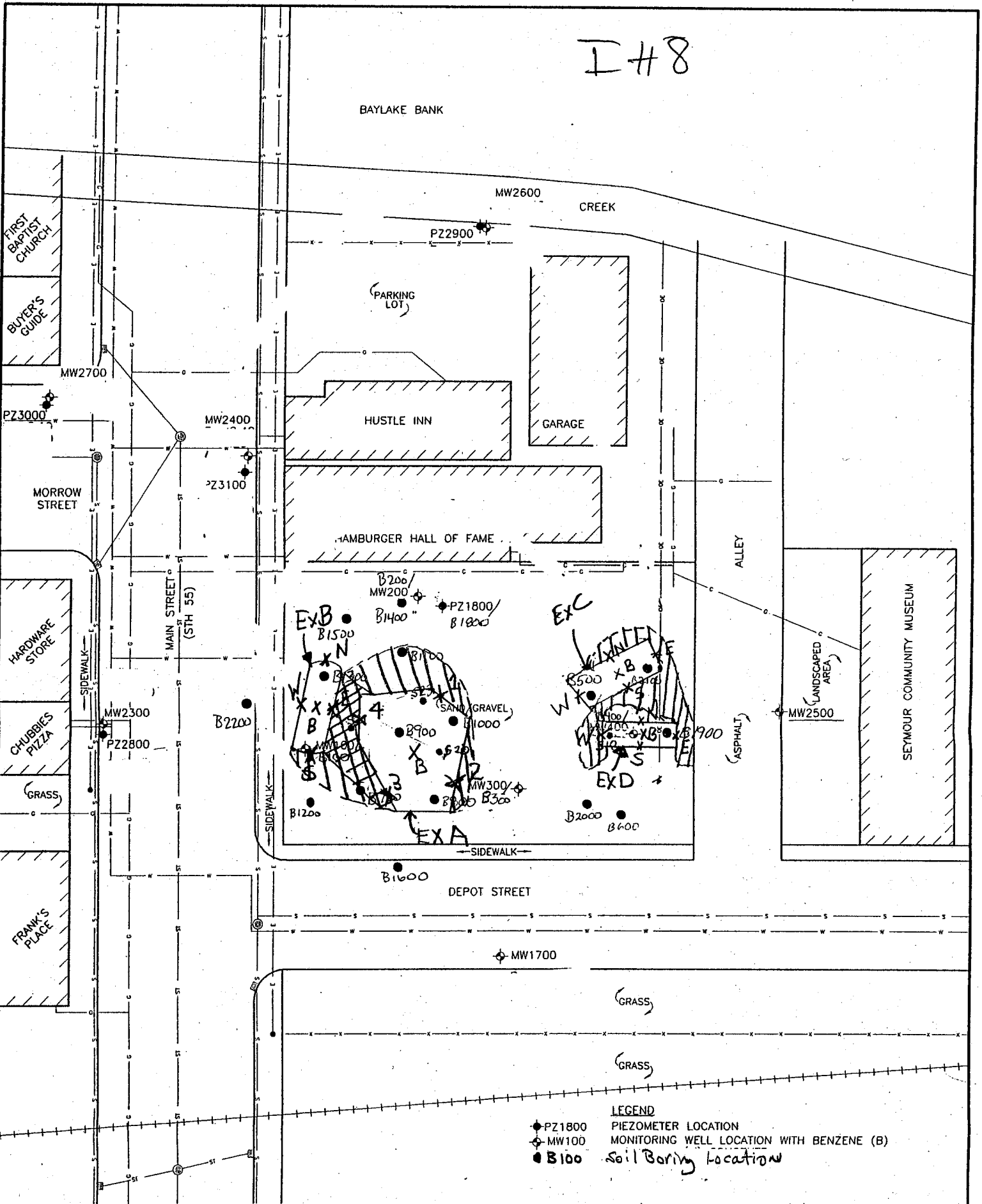

- LEGEND**
- ◆ PZ1800 PIEZOMETER LOCATION
 - ◆ MW100 MONITORING WELL LOCATION WITH BENZENE (B)
 - B100 Soil Boring Location

X = Excavation Sample location

- [Hatched Box] = NR720 GRCL EXCEEDANCE
- [Cross-hatched Box] = NR 746 Table 1 EXCEEDANCE

- OVERHEAD ELECTRIC LINE
- e— UNDERGROUND ELECTRIC LINE
- s— SANITARY SEWER LINE
- st— STORM SEWER LINE
- +— RAILROAD TRACKS
- w— WATER LINE
- o— GAS LINE
- x— FENCE
- ⊙ MANHOLE
- ⊠ INLET

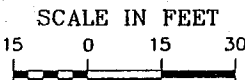

DRAWN BY: KRE REV. DATE: 4/1/02	PROJECT: CSY-1162 THIS DRAWING AND ALL INFORMATION CONTAINED THEREON IS THE PROPERTY OF NORTHERN ENVIRONMENTAL INCORPORATED AND SHALL NOT BE COPIED OR USED EXCEPT FOR THE PURPOSE FOR WHICH IT IS EXPRESSLY FURNISHED.	DATE: 05/10/01	CITY OF SEYMOUR SEYMOUR, WISCONSIN
Northern Environmental™ Hydrologists • Engineers • Geologists			ESTIMATED EXTENT OF SOIL EXCEEDING NR 720 GRCL

Rev. E2M Environmental and Engineering Mgt. 01/17/05

FIGURE

S:\PROJ\CSY\1109\1162\DRAWINGS\052201-4E.DWG

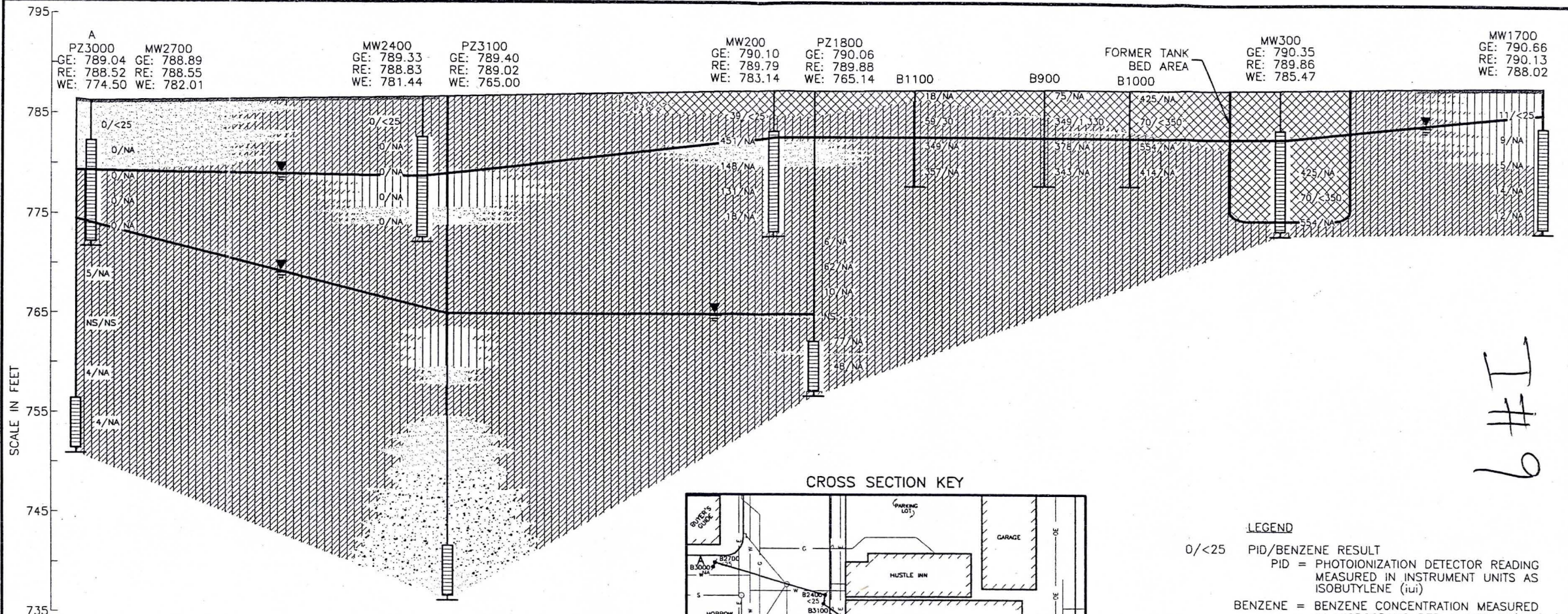

6#I
9

CROSS SECTION KEY

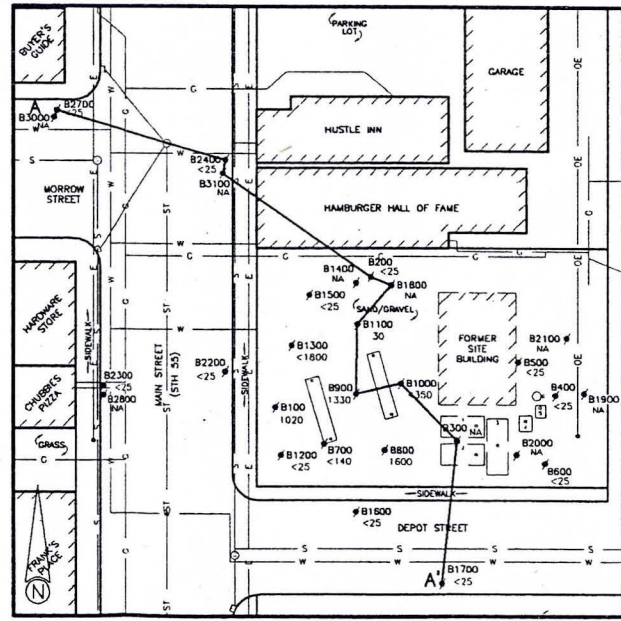

- LEGEND**
- 0/<25 PID/BENZENE RESULT
 - PID = PHOTOIONIZATION DETECTOR READING MEASURED IN INSTRUMENT UNITS AS ISOBUTYLENE (iui)
 - BENZENE = BENZENE CONCENTRATION MEASURED IN MICROGRAMS PER KILOGRAM (µg/kg)
 - NA = NOT ANALYZED
 - NS = NOT SAMPLED
 - GE = GROUND ELEVATION (IN FEET)
 - RE = RISER ELEVATION (IN FEET)
 - WE = GROUND WATER ELEVATION (IN FEET)
 - WATER TABLE
 - SP = POORLY GRADED SANDS
 - ASPHALT
 - SAND FILL
 - CL-ML = SILTY CLAY
 - GRAVEL
 - ML = SILT
- VERTICAL EXAGGERATION 2X

S:\PROJ\CSY\11091162\DRAWINGS\040102-6.DWG

NOTE:
 *WATER MEASUREMENTS TAKEN 1/11/02 FROM MONITORING WELLS, 3/26/02 FROM PIEZOMETERS
 *ELEVATIONS REFERENCED TO MEAN SEA LEVEL
 *COLUMN WIDTHS ARE NOT TO SCALE
 *SOIL BORING ELEVATIONS ARE INFERRED

DRAWN BY: KRE	PROJECT: CSY-1162	DATE: 4/1/02
REV. DATE	THIS DRAWING AND ALL INFORMATION CONTAINED THEREON IS THE PROPERTY OF NORTHERN ENVIRONMENTAL INCORPORATED AND SHALL NOT BE COPIED OR USED EXCEPT FOR THE PURPOSE FOR WHICH IT IS EXPRESSLY FURNISHED.	
 Northern Environmental SM Hydrologists • Engineers • Geologists		

CITY OF SEYMOUR SEYMOUR, WISCONSIN
GEOLOGIC CROSS SECTION A-A'



Engineering & Management Consulting

August 4, 2005

Ms. Sharlene TeBeest
DOT - BEES
Wisconsin Department of Transportation
4802 Sheboygan Ave
PO Box 7965, Room 451
Madison, WI 53707-7965

Ecometrica Project #20062

**Subject: Notice of Residual Contamination Within Public Street Right-of Way
Former Deering Property, 120 N. Main Street, Seymour, WI
COMM # 54165-1808-20, BRRTS # 03-45-217425**

Dear Ms. TeBeest:

On behalf of the City of Seymour, Ecometrica, Inc. is notifying the Wisconsin Department of Transportation regarding the potential presence of residual petroleum hydrocarbons within the Public Street Right-of-Way at the referenced site. We are in the process of obtaining site closure by the Wisconsin Department of Natural Resources (WDNR) upon the condition of filing GIS registry information and notifying the municipal authorities of residual contamination in the publicly owned property and adjacent right-of-ways.

Pursuant to Wisconsin Administrative Code (WAC) NR 726.05(2)(b)(4), Ecometrica is notifying your department of the potential presence of soil and groundwater impact beneath Main Street (STH 55) right-of-ways, which may exceed applicable WAC NR 746 standard for soil.

Soil and groundwater contamination that appears to have originated on the property located at 120 N. Main Street (STH 55), Seymour, Wisconsin and may have migrated onto the adjacent road right of way. The levels of PVOCs in soil exceeded NR 720 RCLs. Soil remediation conducted at the site removed much of the soil exceeding 746 Table 1 values. There is a potential of contaminant migration following the utility backfill. We have conducted three rounds of monitoring of manholes located at the intersections of Depot Street and Main Street and Morrow Street and Main Street. Based on the monitoring of manholes, it does not appear that contaminants have migrated to the utility backfill. We believe that allowing natural attenuation to complete the cleanup at this site will meet the requirements for case closure that are found in WAC chapters NR 726 and NR 746, and we will be requesting that the Department of Natural Resources accept natural attenuation as the final remedy for this site

Sharlene TeBeest
Page 2 of 2



and grant case closure. Closure means that the Department will not be requiring any further investigation or cleanup action to be taken, other than the reliance on natural attenuation.

The WDNR will not review my closure request for at least 30 days after the date of this letter. As an affected property owner, you have a right to contact the Department to provide any technical information that you may have that indicates that closure should not be granted for this site. If you would like to submit any information to the WDNR that is relevant to this closure request, you should mail that information to:

Mr. Tom Sturm
Hydrogeologist
NER Remediation & Redevelopment Program, Shawano Office
Wisconsin Department of Natural Resources
647 Lakeland Road
Shawano, WI 54166
Phone: 715/ 526- 4230
Fax: 715/ 524- 3214
e-mail: Thomas. Sturm@ dnr. state. wi. us

Once the Department makes a decision on my closure request, it will be documented in a letter. If the Department grants closure, you may obtain a copy of this letter by requesting a copy from us, by writing to the WDNR or by accessing the DNR GIS Registry of Closed Remediation Sites on the internet at www.dnr.state.wi.us/org/at/et/geo/gwur. A copy of the closure letter is included as part of the site file on the GIS Registry of Closed Remediation Sites.

If you need more information, you may contact us or you may contact Mr. Tom Sturm at the address and phone number given above.

Sincerely,

ECOMETRICA, INC.

A handwritten signature in black ink, appearing to read "Dilip K. Singh".

Dilip K. Singh, Ph.D., P.E.
Principal Engineer

cc: Beth Erdman/DCOMM
Mayor Pingel/City of Seymour



Engineering & Management Consulting

August 4, 2005

Mr. Mike Helmrick
Wisconsin Department of Transportation
Northeast Region
944 Vanderperren Way
Green Bay, WI 54304-5344

Ecometrica Project #20062

**Subject: Notice of Residual Contamination Within Public Street Right-of Way
Former Deering Property, 120 N. Main Street, Seymour, WI
COMM # 54165-1808-20, BRRTS # 03-45-217425**

Dear Mr. Helmrick:

On behalf of the City of Seymour, Ecometrica, Inc. is notifying the Wisconsin Department of Transportation regarding the potential presence of residual petroleum hydrocarbons within the Public Street Right-of-Way at the referenced site. We are in the process of obtaining site closure by the Wisconsin Department of Natural Resources (WDNR) upon the condition of filing GIS registry information and notifying the municipal authorities of residual contamination in the publicly owned property and adjacent right-of-ways.

Pursuant to Wisconsin Administrative Code (WAC) NR 726.05(2)(b)(4), Ecometrica is notifying your department of the potential presence of soil and groundwater impact beneath Main Street (STH 55) right-of-ways, which may exceed applicable WAC NR 746 standard for soil.

Soil and groundwater contamination that appears to have originated on the property located at 120 N. Main Street (STH 55), Seymour, Wisconsin and may have migrated onto the adjacent road right of way. The levels of PVOCs in soil exceeded NR 720 RCLs. Soil remediation conducted at the site removed much of the soil exceeding 746 Table 1 values. There is a potential of contaminant migration following the utility backfill. We have conducted three rounds of monitoring of manholes located at the intersections of Depot Street and Main Street and Morrow Street and Main Street. Based on the monitoring of manholes, it does not appear that contaminants have migrated to the utility backfill. We believe that allowing natural attenuation to complete the cleanup at this site will meet the requirements for case closure that are found in WAC chapters NR 726 and NR 746, and we will be requesting that the Department of Natural Resources accept natural attenuation as the final remedy for this site and grant case closure. Closure means that the Department will not be requiring any further investigation or cleanup action to be taken, other than the reliance on natural attenuation.

Mike Helmrick
Page 2 of 2



The WDNR will not review my closure request for at least 30 days after the date of this letter. As an affected property owner, you have a right to contact the Department to provide any technical information that you may have that indicates that closure should not be granted for this site. If you would like to submit any information to the WDNR that is relevant to this closure request, you should mail that information to:

Mr. Tom Sturm
Hydrogeologist
NER Remediation & Redevelopment Program, Shawano Office
Wisconsin Department of Natural Resources
647 Lakeland Road
Shawano, WI 54166
Phone: 715/ 526- 4230
Fax: 715/ 524- 3214
e-mail: Thomas. Sturm@ dnr. state. wi. us

Once the Department makes a decision on my closure request, it will be documented in a letter. If the Department grants closure, you may obtain a copy of this letter by requesting a copy from us, by writing to the WDNR or by accessing the DNR GIS Registry of Closed Remediation Sites on the internet at www.dnr.state.wi.us/org/at/et/geo/gwur. A copy of the closure letter is included as part of the site file on the GIS Registry of Closed Remediation Sites.

If you need more information, you may contact us or you may contact Mr. Tom Sturm at the address and phone number given above.

Sincerely,

ECOMETRICA, INC.

A handwritten signature in black ink, appearing to read "Dilip Singh". The signature is fluid and cursive.

Dilip K. Singh, Ph.D., P.E.
Principal Engineer

cc: Beth Erdman/DCOMM
Mayor Pingel/City of Seymour

7005 0390 0002 3840 8238

U.S. Postal Service[™]
CERTIFIED MAIL[™] RECEIPT
(Domestic Mail Only; No Insurance Coverage Provided)

For delivery information visit our website at www.usps.com

GREEN BAY WI 54304-5344

Postage	\$	\$0.37
Certified Fee		\$2.30
Return Receipt Fee (Endorsement Required)		\$0.00
Restricted Delivery Fee (Endorsement Required)		\$0.00
Total Postage & Fees	\$	\$2.67

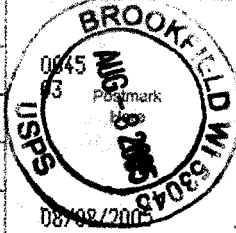

Sent To Mr. Mike Helmrick, WI's DOT
 Street, Apt. No.,
 or PO Box No. 944 Vanderperren Way
 City, State, ZIP+4[®] Green Bay, WI 54304



August 10, 2005

Mr. Clifford Murphy
3026 Glendale Avenue
Green Bay, WI 54313

Ecometrica Project #20062

**Subject: Notice of Petroleum Impacted Groundwater
Former Deering Property, 120 N. Main Street, Seymour, WI
COMM # 54165-1808-20, BRRTS # 03-45-217425**

Dear Mr. Murphy:

On behalf of the City of Seymour, this letter is prepared to inform you that petroleum hydrocarbon compounds exceeding the current Wisconsin Department of Natural Resources NR 140 groundwater quality enforcement standards (ES) exist beneath the former Deering Property located at 120 N. Main Street, Seymour, WI. The contamination may have impacted your property (former Hamburger Hall of Fame property) located at 126 N. Main Street, Seymour, WI. This letter is prepared in accordance with the requirements of the Wisconsin Department of Natural Resources (WDNR) to advise you of the impacts. We are in the process of obtaining site closure by the WDNR upon the condition of filing GIS registry information and notifying the owners of the affected properties of residual contamination.

Groundwater contamination that appears to have originated on the former Deering property located at 120 N. Main Street, Seymour, Wisconsin may have potentially migrated onto your property at 126 Main Street, Seymour, Wisconsin. The level of petroleum volatile organic compounds (PVOCs) contamination in groundwater detected in some wells a well along your property boundary is above the state groundwater enforcement standards found in Chapter 140, Wisconsin Administrative Code. However, it appears that the groundwater plume is stable or receding and will naturally degrade over time. We believe that by allowing natural attenuation to complete the cleanup, this site will meet the requirements for case closure that are found in Chapter NR 726 and Chapter NR 746, Wisconsin Administrative Code. Also, we are requesting that the WDNR accept natural attenuation as the final remedy for this site and grant closure. Closure means that the Department will not be requiring any further investigation or cleanup action to be taken, other than the reliance on natural attenuation.

Since the source of the groundwater contamination is not on your property, neither you nor any subsequent owner of your property will be held responsible for investigation or cleanup of this groundwater contamination, as long as you and any subsequent owners comply with the requirements of section 292.13. Wisconsin Statutes, including allowing access to your property for environmental investigation or cleanup if access is required. For further information on the requirements of section 292.13, Wisconsin Statutes, you may call 1-800-367-6076 for calls originating in Wisconsin, or 608-264-6020, if you are calling from out of state or within the Madison Area, to obtain a copy of the Department of Natural Resources' publication #RR-589, Fact Sheet 10: Guidance for Dealing with Properties Affected by Off-Site Contamination.



As an affected property owner, you have the right to contact the Department to provide any technical information that you may have that closure should not be granted for this site. If you would like to submit any information to the WDNR that is relevant to the closure request, you should send the information to:

Mr. Tom Sturm
Hydrogeologist
NER Remediation & Redevelopment Program, Shawano Office
Wisconsin Department of Natural Resources
647 Lakeland Road
Shawano, WI 54166
Phone: 715/ 526- 4230
Fax: 715/ 524- 3214
e-mail: Thomas.Sturm@dnr.state.wi.us

Once the Department makes a decision on the closure request, it will be documented in a letter. If the Department grants closure, you may obtain a copy of this letter by requesting a copy from us, by writing to the WDNR or by accessing the DNR GIS Registry of Closed Remediation Sites on the internet at www.dnr.state.wi.us/org/at/et/geo/gwur. A copy of the closure letter is included as part of the site file on the GIS Registry of Closed Remediation Sites.

Should you or any subsequent property owner wish to construct or reconstruct a well on your property, special well construction standards may be necessary to protect the well from the residual groundwater contamination. Any well driller who proposes to construct a well on your property in the future will first need to contact the Drinking Water program within the Department of Natural Resources because your property is located within the designated service area of a municipally owned water system, to determine if there is a need for special well construction standards.

If you need more information, you may contact us or you may contact Mr. Tom Sturm at the address and phone number given above.

Sincerely,

ECOMETRICA, INC.

Dilip K. Singh, Ph.D., P.E.
Principal Engineer

cc: Beth Erdman/DCOMM
Mayor Pingel/City of Seymour

City of Seymour

328 North Main Street, Seymour, WI 54165
Phone (920) 833-2209 Fax (920) 833-7221

August 22, 2005

Mr. Tom Strum
Hydrogeologist
NER Remediation & Redevelopment Program, Shawano Office
Wisconsin Department of Natural Resources
647 Lakeland Road
Shawano, WI 54166

Dear Mr. Strum:

I am in receipt of a letter from Dilip K. Singh, PhD., PE, Principal Engineer, of Ecometrica dated August 10, 2005 informing me of the notice of petroleum impacted groundwater on the former Deering Property, 120 N. Main Street Seymour, WI.

Upon reading the notice I do not object to closure of the property at 120 N. Main Street, Seymour WI Comm #54165-1808-20, BRRTS #03-45-217425. I understand the property is going to be used as a veterans memorial and would like to see the project move along as soon as possible.

Sincerely,

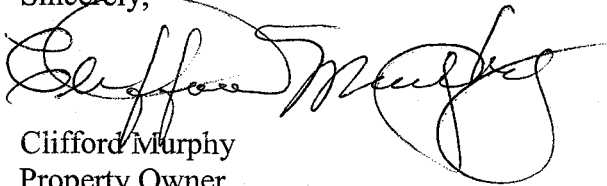

Clifford Murphy
Property Owner

Recorded
NOV. 04, 2005 AT 11:46:25AM
OUTAGAMIE COUNTY
JANICE FLENZ
REGISTER OF DEEDS
Fee Amount: \$27.00



Document Number

DEED RESTRICTION

Declaration of Restrictions

In Re: Property described on the attached deed hereby made a part of this restriction labeled as Exhibit 1, previously filed as, Document Number 1402102, Outagamie County Register of Deeds.

STATE OF WISCONSIN)
) ss
COUNTY OF Outagamie

WHEREAS, The City of Seymour, is the owner of the above-described property.

WHEREAS, one or more petroleum discharges have occurred on this property. Lead-contaminated soil remains on this property at B-1100 at a concentration of 71.7 micrograms per kilogram (ug/kg) when soil samples were collected on May 1, 2001 Location of B- 1100 is presented on Exhibit 2, attached and incorporated into this restriction.

WHEREAS, it is the desire and intention of the property owner to impose on the property restrictions which will make it unnecessary to conduct further soil remediation activities on the property at the present time.

NOW THEREFORE, the owner hereby declares that all of the property described above is held and shall be held, conveyed or encumbered, leased, rented, used, occupied and improved subject to the following limitation and restrictions:

The soil cover that existed on the above described property in the location shown on the attached map, labeled Exhibit 2 on the date that this restriction was signed shall be maintained in compliance with the Soil Cover Maintenance Plan dated January 11, 2005 that was submitted to the Wisconsin Department of Natural Resources by the City of Seymour as required by section NR 724.13 (2), Wis. Adm. Code (October 1999). A copy of the maintenance plan is attached as Exhibit 3.

This soil cover must be maintained in order to prevent direct contact with residual soil contamination that might otherwise pose a threat to human health. If soil that remains on the property in the location or locations described above where there is residual contamination is excavated in the future, the soil must be sampled and analyzed, may be considered solid or hazardous waste if residual contamination

Recording Area

Name and Return Address

Susan M. Garsow
Clerk-Treasurer
City of Seymour
328 N. Main Street
Seymour, WI 54165

27.00
(a)

Parcel Identification number
34-0-0162-00-4 and 34-0-0162-01-4

remains and must be stored, treated and disposed in compliance with applicable statutes and rules.

In addition, the following activities are prohibited on any portion of the above-described property where the soil cover is required, as shown on Exhibit 2, unless prior written approval has been obtained from the Wisconsin Department of Natural Resources or its successor or assign: (1) Replacement with another barrier; (2) Excavating or grading of the land surface; (3) Filling on capped or paved areas; (4) Plowing for agricultural cultivation; and (5) Construction or placement of a building or other structure in an area where a soil cover is required.

This restriction is hereby declared to be a covenant running with the land and shall be fully binding upon all persons acquiring the above-described property whether by descent, devise, purchase or otherwise. This restriction inures to the benefit of and is enforceable by the Wisconsin Department of Natural Resources, its successors or assigns. The Department, its successors or assigns, may initiate proceedings at law or in equity against any person or persons who violate or are proposing to violate this covenant, to prevent the proposed violation or to recover damages for such violation.

Any person who is or becomes owner of the property described above may request that the Wisconsin Department of Natural Resources or its successor issue a determination that one or more of the restrictions set forth in this covenant is no longer required. Upon the receipt of such a request, the Wisconsin Department of Natural Resources shall determine whether or not the restrictions contained herein can be extinguished. If the Department determines that the restrictions can be extinguished, an affidavit, attached to a copy of the Department's written determination, may be recorded by the property owner or other interested party to give notice that this deed restriction, or portions of this deed restriction, are no longer binding.

By signing this document, Harold J. Prigel asserts that he or she is duly authorized to sign this document on behalf of the City of Seymour.

IN WITNESS WHEREOF, the owner of the property has executed this Declaration of Restrictions, this 4th day of November, 2005.

Signature: Harold J. Prigel, Mayor

Printed Name: Harold J. Pingel

Title: MAYOR

Subscribed and sworn to before me

this 4 day of Nov., 2005.

Susan M. Larson
Notary Public, State of WI
My commission 9-02-2007

This document was drafted by the Wisconsin Department of Natural Resources based on information provided by Northern Environmental Inc.

3812
1402102
DOCUMENT NO.

STATE BAR OF WISCONSIN FORM 3 - 1982
QUIT CLAIM DEED

Exhibit 1

OUTAGAMIE COUNTY, a municipal corporation,
quit-claims to CITY OF SEYMOUR,
a municipal corporation,
the following described real estate in Outagamie County,
State of Wisconsin:

OUTAGAMIE COUNTY
RECEIVED FOR RECORD

APR 11 2001
AT 10:30 O'CLOCK A.M. P.M.
JANICE FLENZ
REGISTER OF DEEDS

THIS SPACE RESERVED FOR RECORDING DATA
NAME AND RETURN ADDRESS
CORPORATION COUNSEL OFFICE
OUTAGAMIE CO ADMIN BLDG
410 S WALNUT ST
APPLETON WI 54911
pd
100.00

PARCEL IDENTIFICATION NUMBER

All of Lot Thirteen (13), less the North 30 feet thereof, subject to a perpetual easement in a strip of land 10 feet in width lying South and adjacent to the North 30 feet of said Lot 13, the same to be used in common for the purpose of light, air, travel or driveway and other uses, except the construction or erection of buildings thereon. All of Lot Fourteen (14) and Lot Fifteen (15), less the North 12.2 feet of Lot 15, and less the East 40 feet of the South 80 feet of Lot 15, subject to a perpetual easement in a strip of land 10 feet wide on the West and 10 feet wide on the North and adjacent to a tract of land described in Volume 114 of Deeds page 509, Outagamie County Records, all of the foregoing being in Block Seventeen (17) City of Seymour, Outagamie County, Wisconsin, according to the Recorded Assessors Map of said City. LESS AND EXCEPTING Lot One (1) of Certified Survey Map No. 499 as Document No. 944709 being a part of Lot 15, Block 17, Assessor's Plat, City of Seymour, Outagamie County, Wisconsin. ALSO LESS AND EXCEPTING lands described in Quit Claim Deed recorded on December 12, 1989, in Jacket 9932, Image 41, as Document No. 971844.

Tax Parcel Identification No. 34-0-0162-00-4 and 34-0-0162-01-4

(Exempt from Transfer Fee per 77.25(2))

FEE
2
EXEMPT

This is not homestead property.
(is) (is not)

Dated this 20th day of March, 2001.

OUTAGAMIE COUNTY
By: Robert N. Paltzer, Jr. (SEAL) _____ (SEAL)
• Robert N. Paltzer, Jr./County Executive
By: Sally J. Mielke (SEAL) _____ (SEAL)
• Sally Mielke/County Board Chair
By: Nancy J. Christensen (SEAL) _____ (SEAL)
• Nancy Christensen/County Clerk

AUTHENTICATION

Signature(s) of Robert N. Paltzer, Jr.,
Sally Mielke and Nancy Christensen
authenticated this 20th day of March, 2001
Joseph P. Guidote, Jr.

ACKNOWLEDGMENT

State of Wisconsin, }
County, } ss.
Personally came before me this _____ day of _____, 19____, the above named
_____ to me known to be the person _____ who executed the foregoing instrument and acknowledge the same.
Notary Public, _____ County, Wis.
My commission is permanent. (If not, state expiration date: _____, 19____)

TITLE: MEMBER STATE BAR OF WISCONSIN
(If not, authorized by 8706.06, Wis. Stats.)
THIS INSTRUMENT WAS DRAFTED BY
Joseph P. Guidote, Jr.
Outagamie County
Corporation Counsel
(Signatures may be authenticated or acknowledged. Both are not necessary.)

EXHIBIT 3

SOIL COVER MAINTENANCE PLAN

September 20, 2005

Property Located at:

120 N. Main St., Seymour, WI

WDNR BRRTS/Activity # 03-45-217425

Parcel ID 34-0-0162-00-4 and 34-0-0162-01-4, Outagamie County, Wisconsin

Introduction

This document is the Maintenance Plan for the soil cover barrier at the above-referenced property in accordance with the requirements of s. NR 724.13(2), Wisconsin Administrative Code. The maintenance activities relate to the existing soil cover occupying the area over the contaminated soil on-site. The contaminated soil is impacted by lead. The locations of the soil cover to be maintained in accordance with this Maintenance Plan, as well as the impacted soil are identified in the attached map (Exhibit A).

Cover and Building Barrier Purpose

The soil cover over the contaminated soil serves as a barrier to prevent direct human contact with residual soil contamination that might otherwise pose a threat to human health. Based on the current and future use of the property, the barrier should function as intended unless disturbed.

Annual Inspection

The soil cover overlying the soil and as depicted in Exhibit A will be inspected once a year, normally in the spring after all snow and ice is gone, for deterioration and other potential problems that can cause or exposure to underlying soils. The inspections will be performed to evaluate damage due to settling, exposure to the weather, wear from traffic, increasing age and other factors. Any area where soils have become or are likely to become exposed will be documented. A log of the inspections and any repairs will be maintained by the property owner and is included as Exhibit B, Cap Inspection Log. The log will include recommendations for necessary repair of any areas where underlying soils are exposed. Once repairs are completed, they will be documented in the inspection log. A copy of the inspection log will be kept at the Seymour City Hall and made available to all interested parties including the Wisconsin Department of Natural Resources upon request.

Maintenance Activities

If problems are noted during the annual inspections or at any other time during the year, repairs will be scheduled as soon as practical. Repairs can include filling the area of exposed contaminated soil with clean soil or fill. In the event that necessary maintenance activities expose the underlying soil, the owner must inform maintenance workers of the direct contact exposure hazard and provide them with appropriate personal protection equipment ("PPE"). The owner must also sample any soil that is excavated from the site prior to disposal to ascertain if contamination remains. The soil must be treated, stored and disposed of by the owner in accordance with applicable local, state and federal law.

In the event the soil overlying the contaminated soil is removed or replaced, the replacement material must be equivalent in thickness. Any replacement barrier will be subject to the same maintenance and inspection guidelines as outlined in this Maintenance Plan unless indicated otherwise by the WDNR or its successor.

The property owner, in order to maintain the integrity of the paved surfaces and/or the building, will maintain a copy of this Maintenance Plan at the Seymour City Hall and make it available to all interested parties (i.e. on-site employees, contractors, future property owners, etc.) for viewing.

Amendment or Withdrawal of Maintenance Plan

This Maintenance Plan can be amended or withdrawn by the property owner and its successors with the written approval of WDNR.

Contact Information

Site Owner and Operator:
City of Seymour
328 North Main St.
Seymour, WI 54165
920-833-2209

WDNR:
Tom Sturm
WDNR
647 Lakeland Rd.
Shawano, WI 54166
715-526-4230

Exhibit B
Barrier INSPECTION LOG

Inspection Date	Inspector	Condition of Cap	Recommendations	Have Recommendations from previous inspection been implemented?