

GIS REGISTRY
Cover Sheet

March, 2010
(RR 5367)

Source Property Information

BRRTS #:

ACTIVITY NAME:

PROPERTY ADDRESS:

MUNICIPALITY:

PARCEL ID #:

CLOSURE DATE:

FID #:

DATCP #:

COMM #:

***WTM COORDINATES:**

X: **Y:**

**Coordinates are in
WTM83, NAD83 (1991)*

WTM COORDINATES REPRESENT:

- Approximate Center Of Contaminant Source
- Approximate Source Parcel Center

Please check as appropriate: (BRRTS Action Code)

Contaminated Media:

- Groundwater Contamination > ES (236)**
- Contamination in ROW
- Off-Source Contamination
(note: for list of off-source properties see "Impacted Off-Source Property" form)
- Soil Contamination > *RCL or **SSRCL (232)**
- Contamination in ROW
- Off-Source Contamination
(note: for list of off-source properties see "Impacted Off-Source Property" form)

Land Use Controls:

- N/A (Not Applicable)
- Soil: maintain industrial zoning (220)
(note: soil contamination concentrations between non-industrial and industrial levels)
- Structural Impediment (224)
- Site Specific Condition (228)
- Cover or Barrier (222)**
(note: maintenance plan for groundwater or direct contact)
- Vapor Mitigation (226)
- Maintain Liability Exemption (230)
(note: local government unit or economic development corporation was directed to take a response action)

Monitoring Wells:

Are all monitoring wells properly abandoned per NR 141? (234)

- Yes No N/A

**Residual Contaminant Level
**Site Specific Residual Contaminant Level*

This Adobe Fillable form is intended to provide a list of information that is required for evaluation for case closure. It is to be used in conjunction with Form 4400-202, Case Closure Request. The closure of a case means that the Department has determined that no further response is required at that time based on the information that has been submitted to the Department.

NOTICE: Completion of this form is mandatory for applications for case closure pursuant to ch. 292, Wis. Stats. and ch. NR 726, Wis. Adm. Code, including cases closed under ch. NR 746 and ch. NR 726. The Department will not consider, or act upon your application, unless all applicable sections are completed on this form and the closure fee and any other applicable fees, required under ch. NR 749, Wis. Adm. Code, Table 1 are included. It is not the Department's intention to use any personally identifiable information from this form for any purpose other than reviewing closure requests and determining the need for additional response action. The Department may provide this information to requesters as required by Wisconsin's Open Records law [ss. 19.31 - 19.39, Wis. Stats.].

BRRTS #: PARCEL ID #:
ACTIVITY NAME: WTM COORDINATES: X: Y:

CLOSURE DOCUMENTS (the Department adds these items to the final GIS packet for posting on the Registry)

- Closure Letter**
- Maintenance Plan** (if activity is closed with a land use limitation or condition (land use control) under s. 292.12, Wis. Stats.)
- Continuing Obligation Cover Letter** (for property owners affected by residual contamination and/or continuing obligations)
- Conditional Closure Letter**
- Certificate of Completion (COC)** (for VPLE sites)

SOURCE LEGAL DOCUMENTS

- Deed:** The most recent deed as well as legal descriptions, for the **Source Property** (where the contamination originated). Deeds for other, off-source (off-site) properties are located in the **Notification** section.
Note: If a property has been purchased with a land contract and the purchaser has not yet received a deed, a copy of the land contract which includes the legal description shall be submitted instead of the most recent deed. If the property has been inherited, written documentation of the property transfer should be submitted along with the most recent deed.
- Certified Survey Map:** A copy of the certified survey map or the relevant section of the recorded plat map for those properties where the legal description in the most recent deed refers to a certified survey map or a recorded plat map. (lots on subdivided or platted property (e.g. lot 2 of xyz subdivision)).
Figure #: **Title:**
- Signed Statement:** A statement signed by the Responsible Party (RP), which states that he or she believes that the attached legal description accurately describes the correct contaminated property.

MAPS (meeting the visual aid requirements of s. NR 716.15(2)(h))

Maps must be no larger than 11 x 17 inches unless the map is submitted electronically.

- Location Map:** A map outlining all properties within the contaminated site boundaries on a U.S.G.S. topographic map or plat map in sufficient detail to permit easy location of all parcels. If groundwater standards are exceeded, include the location of all potable wells within 1200 feet of the site.
Note: Due to security reasons municipal wells are not identified on GIS Packet maps. However, the locations of these municipal wells must be identified on Case Closure Request maps.
Figure #: 1 **Title: Site Location Map**
- Detailed Site Map:** A map that shows all relevant features (buildings, roads, individual property boundaries, contaminant sources, utility lines, monitoring wells and potable wells) within the contaminated area. This map is to show the location of all contaminated public streets, and highway and railroad rights-of-way in relation to the source property and in relation to the boundaries of groundwater contamination exceeding a ch. NR 140 Enforcement Standard (ES), and/or in relation to the boundaries of soil contamination exceeding a Residual Contaminant Level (RCL) or a Site Specific Residual Contaminant Levels (SSRCL) as determined under s. NR 720.09, 720.11 and 720.19.
Figure #: 2 **Title: Site Layout**
- Soil Contamination Contour Map:** For sites closing with residual soil contamination, this map is to show the location of all contaminated soil and a single contour showing the horizontal extent of each area of contiguous residual soil contamination that exceeds a Residual Contaminant Level (RCL) or a Site Specific Residual Contaminant Level (SSRCL) as determined under s. NR 720.09, 720.11 and 720.19.
Figure #: 4-1 **Title: Location of Excavation and Post-Remedial Soil Sample Results**

BRRTS #: 02-68-218476

ACTIVITY NAME: ONE HOUR MARTINIZING

MAPS (continued)

- Geologic Cross-Section Map:** A map showing the source location and vertical extent of residual soil contamination exceeding a Residual Contaminant Level (RCL) or a Site Specific Residual Contaminant Level (SSRCL). If groundwater contamination exceeds a ch. NR 140 Enforcement Standard (ES) when closure is requested, show the source location and vertical extent, water table and piezometric elevations, and locations and elevations of geologic units, bedrock and confining units, if any.

Figure #: **Title:**

Figure #: **Title:**

- Groundwater Isoconcentration Map:** For sites closing with residual groundwater contamination, this map shows the horizontal extent of all groundwater contamination exceeding a ch. NR140 Preventive Action Limit (PAL) and an Enforcement Standard (ES). Indicate the direction and date of groundwater flow, based on the most recent sampling data.

Note: This is intended to show the total area of contaminated groundwater.

Figure #: **Title:**

- Groundwater Flow Direction Map:** A map that represents groundwater movement at the site. If the flow direction varies by more than 20° over the history of the site, submit 2 groundwater flow maps showing the maximum variation in flow direction.

Figure #: 3-5 **Title: Groundwater Elevation Map**

Figure #: 5 **Title: Groundwater Elevation Map**

TABLES (meeting the requirements of s. NR 716.15(2)(h)(3))

Tables must be no larger than 11 x 17 inches unless the table is submitted electronically. Tables must not contain shading and/or cross-hatching. The use of **BOLD** or *ITALICS* is acceptable.

- Soil Analytical Table:** A table showing remaining soil contamination with analytical results and collection dates.
Note: This is one table of results for the contaminants of concern. Contaminants of concern are those that were found during the site investigation, that remain after remediation. It may be necessary to create a new table to meet this requirement.

Table #: 1 **Title: Historical Soil Analytical Results**

- Groundwater Analytical Table:** Table(s) that show the most recent analytical results and collection dates, for all monitoring wells and any potable wells for which samples have been collected.

Table #: 2 **Title: Groundwater Analytical Results**

- Water Level Elevations:** Table(s) that show the previous four (at minimum) water level elevation measurements/dates from all monitoring wells. If present, free product is to be noted on the table.

Table #: 3 **Title: Summary of Groundwater Elevations**

IMPROPERLY ABANDONED MONITORING WELLS

For each monitoring well not properly abandoned according to requirements of s. NR 141.25 include the following documents.

Note: If the site is being listed on the GIS Registry for only an improperly abandoned monitoring well you will only need to submit the documents in this section for the GIS Registry Packet.

- Not Applicable**

- Site Location Map:** A map showing all surveyed monitoring wells with specific identification of the monitoring wells which have not been properly abandoned.

Note: If the applicable monitoring wells are distinctly identified on the Detailed Site Map this Site Location Map is not needed.

Figure #: **Title:**

- Well Construction Report:** Form 4440-113A for the applicable monitoring wells.

- Deed:** The most recent deed as well as legal descriptions for each property where a monitoring well was not properly abandoned.

- Notification Letter:** Copy of the notification letter to the affected property owner(s).

BRRTS #: 02-68-218476

ACTIVITY NAME: ONE HOUR MARTINIZING

NOTIFICATIONS

Source Property

Not Applicable

Letter To Current Source Property Owner: If the source property is owned by someone other than the person who is applying for case closure, include a copy of the letter notifying the current owner of the source property that case closure has been requested.

Return Receipt/Signature Confirmation: Written proof of date on which confirmation was received for notifying current source property owner.

Off-Source Property

Group the following information per individual property and label each group according to alphabetic listing on the "Impacted Off-Source Property" attachment.

Not Applicable

Letter To "Off-Source" Property Owners: Copies of all letters sent by the Responsible Party (RP) to owners of properties with groundwater exceeding an Enforcement Standard (ES), and to owners of properties that will be affected by a land use control under s. 292.12, Wis. Stats.

Note: Letters sent to off-source properties regarding residual contamination must contain standard provisions in Appendix A of ch. NR 726.

Number of "Off-Source" Letters:

Return Receipt/Signature Confirmation: Written proof of date on which confirmation was received for notifying any off-source property owner.

Deed of "Off-Source" Property: The most recent deed(s) as well as legal descriptions, for all affected deeded **off-source property(ies)**. This does not apply to right-of-ways.

Note: If a property has been purchased with a land contract and the purchaser has not yet received a deed, a copy of the land contract which includes the legal description shall be submitted instead of the most recent deed. If the property has been inherited, written documentation of the property transfer should be submitted along with the most recent deed.

Letter To "Governmental Unit/Right-Of-Way" Owners: Copies of all letters sent by the Responsible Party (RP) to a city, village, municipality, state agency or any other entity responsible for maintenance of a public street, highway, or railroad right-of-way, within or partially within the contaminated area, for contamination exceeding a groundwater Enforcement Standard (ES) and/or soil exceeding a Residual Contaminant Level (RCL) or a Site Specific Residual Contaminant Level (SSRCL).

Number of "Governmental Unit/Right-Of-Way Owner" Letters:

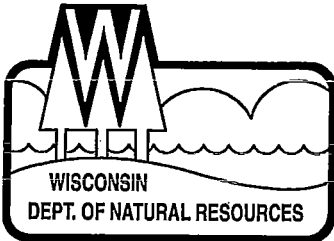

State of Wisconsin \ DEPARTMENT OF NATURAL RESOURCES

Jim Doyle, Governor
Scott Hassett, Secretary
Gloria L. McCutcheon, Regional Director

Waukesha Service Center
141 NW Barstow St., Room 180
Waukesha, Wisconsin 53188
Telephone 262-574-2100
FAX 262-574-2117

August 29, 2007

Mr. Charlie Cass
N42 W27251
County Highway JJ
Pewaukee, WI 53072

Subject: Final Case Closure
OHM Plaza, 1410-1422 South Calhoun, New Berlin WI
FID# 268094970 BRRTS# 02-68-218476

Dear Mr. Cass:

The Department of Natural Resources (the Department) has reviewed the above referenced case for closure. The Department reviews environmental remediation cases for compliance with state laws and standards to maintain consistency in the closure of these cases. Based on the correspondence and data provided, it appears that your case meets the requirements of ch. NR 726, Wisconsin Administrative Code. The Department considers this case closed and no further investigation or remediation is required at this time.

Please be aware that pursuant to s. 292.12 Wisconsin Statutes, compliance with the requirements of this letter is a responsibility to which you and any subsequent property owners must adhere. If these requirements are not followed or if additional information regarding site conditions indicates that contamination on or from the site poses a threat to public health, safety, welfare, or the environment, the Department may take enforcement action under s. 292.11 Wisconsin Statutes to ensure compliance with the specified requirements, limitations or other conditions related to the property or this case may be reopened pursuant to s. NR 726.09, Wis. Adm. Code. It is the Department's intent to conduct inspections in the future to ensure that the conditions included in this letter including compliance with referenced maintenance plans are met.

Pursuant to s. 292.12(2)(a), Wis. Stats., the pavement and building foundation that currently exists in the location shown on the attached map shall be maintained in compliance with the attached maintenance plan in order to prevent direct contact with residual soil contamination that might otherwise pose a threat to human health. If soil in the specific locations illustrated on the attached map is excavated in the future, the property owner at the time of excavation must sample and analyze the excavated soil to determine if residual contamination remains. If sampling confirms that contamination is present the property owner at the time of excavation will need to determine whether the material would be considered solid or hazardous waste and ensure that any storage, treatment or disposal is in compliance with applicable statutes and rules. In addition, all current and future owners and occupants of the property need to be aware that excavation of the contaminated soil may pose an inhalation or other direct contact hazard and as

a result special precautions may need to be taken during excavation activities to prevent a health threat to humans.

The following activities are prohibited on any portion of the property where an engineered cap is required as shown on the attached map, unless prior written approval has been obtained from the Wisconsin Department of Natural Resources: 1) removal of the existing barrier; 2) replacement with another barrier; 3) excavating or grading of the land surface; 4) filling on capped or paved areas; 5) plowing for agricultural cultivation; or 6) construction or placement of a building or other structure.

In addition, depending on site-specific conditions, construction over contaminated materials may result in vapor migration into enclosed structures or migration along newly placed underground utility lines. The potential for vapor inhalation and mitigation should be evaluated when planning any future redevelopment, and measures should be taken to ensure the continued protection of public health, safety, welfare and the environment at the site.

Your site will be listed on the DNR Remediation and Redevelopment GIS Registry of Closed Remediation Sites. Information that was submitted with your closure request application will be included on the GIS Registry. To review the sites on the GIS Registry web page, visit <http://dnr.wi.gov/org/aw/rr/gis/index.htm>. If your property is listed on the GIS Registry because of remaining contamination and you intend to construct or reconstruct a well, you will need prior Department approval in accordance with s. NR 812.09(4)(w), Wis. Adm. Code. To obtain approval, Form 3300-254 needs to be completed and submitted to the DNR Drinking and Groundwater program's regional water supply specialist. This form can be obtained on-line <http://www.dnr.state.wi.us/org/water/dwg/3300254.pdf> or at the web address listed above for the GIS Registry.

The Department appreciates your efforts to restore the environment at this site. If you have any questions regarding this letter, please contact project manager Jim Delwiche at the letterhead address or (262) 574-2145.

Sincerely,



Frances Koonce
Sub Team Supervisor
Bureau for Remediation & Redevelopment

Attachments: 1) Maintenance Plan 2) Site Map

cc: Jennine Cota Trask – Arcadis U.S., Inc.
SER Case File

ARCADIS

One Hour Martinizing Cap Maintenance Plan

May 31, 2007

Property Located at:

One Hour Martinizing
1420 South Calhoun Road
New Berlin, WI 53151

BRRTS #02-68-218476

PIN #NBC 1162-997

Introduction

This Cap Maintenance Plan, in accordance with the requirements of s. NR 724.13(2), Wis. Adm. Code, shall be applicable to the site, which is depicted on Exhibit A, which is attached hereto and made a part hereof (Property). A copy of this Cap Maintenance Plan shall at all times be kept on file in the offices of: (1) the Wisconsin Department of Natural Resources, Southeast Region; (2) the owner of the Property, its successors and assigns (hereinafter identified collectively as the Owner); (3) the Property manager, if any; and (4) the Property. Owner shall make the Cap Maintenance Plan available to contractors, utilities, and maintenance personnel and any other public or private persons or entities authorized to perform work at the Property.

The Cap, which is the subject of this Cap Maintenance Plan, is the approved barrier placed over the residual soil contamination in the "Cap Area" shown on Exhibit A. The Cap consists of 1) the building floor slab for the Cap Area within the building footprint and 2) for the Cap Area outside of the building footprint, at least 18 inches of clean backfill material or existing grass and other vegetation. Based on the current and future use of the Property, the barrier should function as intended unless disturbed.

The purpose of this Cap Maintenance Plan is to ensure the continued effectiveness of the Cap constructed at the Property. The plan will ensure that the Cap continues to function as a barrier to direct contact exposure and subsurface vapor migration into the on-site buildings.

The Wisconsin Department of Natural Resources and its successor and assigns (hereinafter identified collectively as the Department) shall be notified of any activity, which is not in accordance with this Cap Maintenance Plan.

Required Activities

Annual Inspections. Not less than annually, the Owner shall inspect the building floor slab and backfill material (restricted area depicted in Exhibit A) for deterioration, cracks, erosion, and other potential problems that can cause exposure to underlying soils and/or soil vapor. The inspections will be performed to evaluate damage due to settling, exposure to the weather, increasing age and other factors. Any disturbances of the Cap where contaminated soils have become or are likely to become exposed will be documented. A log of the inspections and any repairs will be maintained by the property owner and is included as Exhibit B, Barrier Inspection Log. The log will include recommendations for necessary repair of any areas where underlying contaminated soils are exposed. The inspection logs shall be kept on-site and available for Department review at any time.

ARCADIS

Repairs to Capped Area. If, during the annual inspection or other routine inspections of the Property, the Cap is observed to have been disturbed or significant fissures, cracks, or erosion are observed, the Owner shall arrange to have repairs made to such areas in a manner consistent with this Cap Maintenance Plan. Such repairs shall be carried out within a reasonable period of time, not to exceed 120 days, subject to weather and seasonal considerations. Once repairs are completed, they will be documented in the inspection log kept on-site and available for Department review.

Restricted Activities

The following activities must comply with all listed requirements, and may require prior approval from the Department:

1. **Replacement, Improvement, and Repair of Cap.** If it becomes necessary or desirable to replace, improve, or repair the building floor slab or backfill material, the repair or replacement shall be undertaken in the following manner:
 - A) The contractor performing the work shall be provided with a copy of this Cap Maintenance Plan by Owner and shall prepare a health and safety plan, appropriate to the work being performed. All contractor personnel conducting or participating in work must be trained in hazardous site work as required by OSHA 29 CFR 1910.120 or its successor regulation.
 - B) All materials used in the floor slab, foundation, or backfill shall not contain any hazardous substances which are leachable. Any underlying soils or granular layer materials which are excavated shall be managed in accordance with state law and the health and safety plan.
 - C) Upon completion of the work, clean soil or granular layered material shall be used to bring the excavation back to grade as needed. The area of the excavation shall be restored in a manner consistent with the original Cap condition. Any replacement barrier must be equally impervious or better. All excavated soils and groundwater shall be properly characterized and managed in accordance with state law with notice to the Department.
 - D) All tools and equipment that comes in contact (directly or indirectly) with the subsurface soils and groundwater shall be steam cleaned on-site before leaving the Property following completion of work. Steam cleaning shall be conducted in such a manner as to collect and contain residuals (water and soil) to prevent surface soil contamination. Residuals shall be managed in accordance with state law.
 - E) A memorandum report shall be prepared describing the work performed, identifying the person(s) performing the work and the date of the work, and confirming that the Cap Maintenance Plan was adhered to in completion of the work. A copy of the report shall be kept on file by the Owner, the Property manager, if any, and at the property, and shall be made available for Department review.

3. **Utility Installations or Repairs.** No utility repairs or installation of new or replacement utilities shall be conducted on the Property until after the utility and any contractor(s) for the utility have acknowledged receipt of a copy of this Cap Maintenance Plan. The utility repairs or installation(s) shall be conducted in strict conformance with the standards set forth below with respect to excavations into and/or beneath the Cap, such excavations are to be undertaken in the following manner:

ARCADIS

- A) The contractor performing the work shall be provided with a copy of this Cap Maintenance Plan by Owner and shall prepare a health and safety plan, appropriate to the work being performed. All contractor personnel conducting or participating in work must be trained in hazardous site work as required by OSHA 29 CFR 1910.120 or its successor regulation.
 - B) Any underlying soils or granular layer materials, which are excavated, shall be managed in accordance with state law and the health and safety plan.
 - C) Upon completion of the work, clean soil or granular layered material shall be used as needed to bring the excavation back to grade. All materials used in backfill shall not contain any hazardous substances which are leachable. The area of the excavation shall be restored in a manner consistent with the original Cap condition. All excavated soils and groundwater affected by such activities shall be properly characterized and managed in accordance with state law with notice to the Department.
 - D) All tools and equipment that comes in contact (directly or indirectly) with the subsurface soils and groundwater shall be steam cleaned on-site before leaving the Property following completion of work. Steam cleaning shall be conducted in such a manner as to collect and contain residuals (water and soil) to prevent surface soil contamination. Residuals shall be managed in accordance with state law.
 - E) A memorandum report shall be prepared describing the work performed, identifying the person(s) performing the work and the date of the work, and confirming that the Cap Maintenance Plan was adhered to in completion of the work. A copy of the report shall be kept on file by the Owner, the Property manager, if any, and at the property, and shall be made available for Department review.
4. **Subsurface Drilling Procedures and Requirements.** During subsurface drilling activities at the Property, drilling contractors shall at all times maintain compliance with the following requirements to ensure the integrity of the Cap and to avoid any potential cross contamination of soils and groundwater:
- A) The contractor performing the work shall be provided with a copy of this Cap Maintenance Plan by Owner and shall prepare a health and safety plan, appropriate to the work being performed. The work shall be supervised on-site by a qualified engineer or geologist.
 - B) All contractor personnel conducting or participating in work must be trained in hazardous site work as required by OSHA 29 CFR 1910.120 or its successor regulation. All soil sampling and drilling activities shall be conducted in accordance with ASTM D1586-99 or its successor standard, and the specified environmental requirements contained in this document.
 - C) All drill cuttings and water/drilling mud generated during completion of the boring shall be managed in accordance with state law.
 - D) Following completion of the boring and sample collection, the borehole shall be properly abandoned, in accordance with state law.
 - E) All drill casings, rods, samplers, tools, rig, and any equipment that comes in contact (directly or indirectly) with the subsurface soils and groundwater shall be steam cleaned on-site prior to set up for drilling. The same steam cleaning protocols shall be followed before leaving the Property following completion of work. Steam cleaning shall be

ARCADIS

conducted in such a manner as to collect and contain residuals (water and soil) to prevent surface soil contamination. Residuals shall be managed in accordance with state law.

- F) A memorandum report shall be prepared describing the work performed, identifying the person(s) performing the work and the date of the work, and confirming that the Cap Maintenance Plan was adhered to in completion of the work. A copy of the report shall be kept on file by the Owner, the Property manager, if any, and at the property, and shall be made available for Department review.
5. **Surface Grading and Filling.** During surface grading and filling activities at the Property, grading contractors shall at all times maintain compliance with the following requirements to ensure the integrity of the Cap and to avoid any potential cross contamination of soils and groundwater:
- A) The contractor performing the work shall be provided with a copy of this Cap Maintenance Plan by Owner and shall prepare a health and safety plan, appropriate to the work being performed. All contractor personnel conducting or participating in work must be trained in hazardous site work as required by OSHA 29 CFR 1910.120 or its successor regulation.
- B) Any underlying soils or granular layer materials, which are excavated, shall be managed in accordance with state law and the health and safety plan.
- C) All tools and equipment that comes in contact (directly or indirectly) with the subsurface soils and groundwater shall be steam cleaned on-site prior to set up for grading or filling. The same steam cleaning protocols shall be followed before leaving the Property following completion of work. Steam cleaning shall be conducted in such a manner as to collect and contain residuals (water and soil) to prevent surface soil contamination. Residuals shall be managed in accordance with state law.
- D) A memorandum report shall be prepared describing the work performed, identifying the person(s) performing the work and the date of the work, and confirming that the Cap Maintenance Plan was adhered to in completion of the work. A copy of the report shall be kept on file by the Owner, the Property manager, if any, and at the property, and shall be made available for Department review.
6. **Amendment or Withdrawal of Cap Maintenance Plan.** This Cap Maintenance Plan can be amended or withdrawn by the property owner and its successors with the written approval of the Department.

Contact Information

May 2007

Site Contact: Wendy Bacon
One Hour Martinizing
1420 South Calhoun Road
New Berlin, WI 53151
(262) 784-8432

ARCADIS

Consultant:

Jennine Cota Trask, P.E.
ARCADIS
126 N Jefferson Street, Suite 400
Milwaukee, WI 53202
(414) 276-7742

Department:

Jim Delwiche
Wisconsin Department of Natural Resources
Waukesha Service Center
141 NW Barstol Street, Room 180
Waukesha, WI 53188
(262) 574-2145

DWG DATE: 09MAY07

PN: ONEHRMARIW0707INVESTIG

FILE NO.: GRAPHICS

DRAWING: RES_AREA.AI

CHECKED: MMV

APPROVED:

DRAFTER: LMB

LEGEND

 CAP AREA

GREENFIELD AVENUE

JIFFY STOP GASOLINE

CALHOUN ROAD

171ST STREET

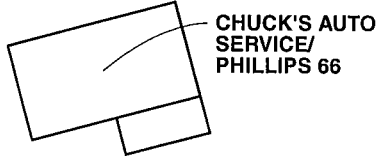

CHUCK'S AUTO SERVICE/ PHILLIPS 66

SUBJECT PROPERTY

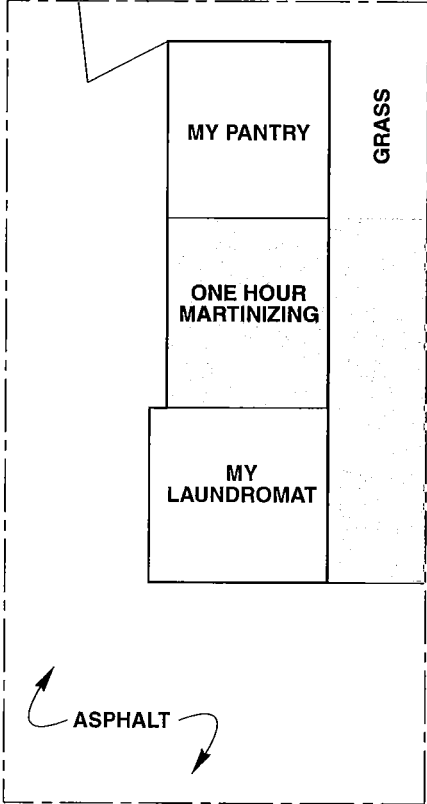

ELECTRICAL TRANSFORMER

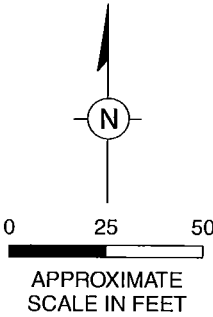

GRASS
RESIDENTIAL



CAP AREA

ONE HOUR MARTINIZING
NEW BERLIN, WISCONSIN

EXHIBIT

A

Exhibit B
Barrier INSPECTION LOG

Inspection Date	Inspector	Condition of Cap	Recommendations	Have Recommendations from previous inspection been implemented?

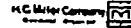

This Indenture, Made the 9th day of February

in the year one thousand nine hundred and ninety-eight between William

Kruzicki, Sheriff of the County of Waukesha, party of the first part,

and O.H.M. Properties, LLC, a Wisconsin limited liability company

of the second part,

WITNESSETH, THAT WHEREAS, at the _____ Term of the Circuit Court, State

of Wisconsin, held in and for the County of Waukesha, at the Court House in the City of

Waukesha, in said County, on the 7th day of July

one thousand nine hundred and ninety-seven, It was among other things, ordered and adjudged

by the said Court, in a certain then pending in the said Court, between Waukesha State Bank, as plaintiff, versus, Russel Stewart, et al., as defendants, Case No. 97 CV 400

(O.H.M. Properties, LLC has been substituted for Waukesha State Bank as plaintiff in said action)

That all and singular the mortgaged premises mentioned in the complaint in said action, and in said judgment described, or so much thereof as might be sufficient to raise the amount due to the plaintiff for principal, interest and costs in said action, and which might be sold separately without material injury to the parties interested, be sold at public auction by or under the direction of the Sheriff of the County of Waukesha, at any time ~~after the expiration of the period of redemption, unless previous to such sale said premises and said judgment shall be redeemed in the manner provided by law; that the said sale be made in the County of~~

Waukesha, where the premises are situate;

that the said Sheriff give public notice of the time and place of such sale, in the manner provided by law; that either or any of the parties in said action might purchase at such sale; that the said Sheriff, upon compliance by the purchaser with the terms of such sale, execute and deliver to the purchaser or purchasers a deed of the premises so sold, setting forth each tract or parcel so sold, the sum paid therefor;

AND WHEREAS, neither said premises, nor any part thereof, had been redeemed, and neither said judgment, nor any part thereof had been paid, and one year from the date of said judgment had expired (or the period of redemption had expired):

AND WHEREAS, the said Sheriff, in pursuance of the said judgment of the said Court, did on the 9th day of February, 1998, sell at public auction, in the City of Waukesha

at the hour of 9:00 o'clock A. M. of that day, the premises in the said judgment mentioned, due notice of the time and place of such sale being first given, agreeably to the said judgment, at which sale the premises hereinafter described were struck off to the said party y of the second part for the sum of Two Hundred Fifty Thousand Dollars

being the highest and best bidder, therefor, and that being the highest sum bid for the same.

NOW, THEREFORE, know ye, that I, the said William Kruzicki Sheriff aforesaid, by virtue of the said judgment, and of the statute in such case made and provided, and in consideration of the said sum of money, so bidden as aforesaid, being first duly paid by the said party y of the second part, the receipt whereof is hereby acknowledged, have granted, bargained, sold, aliened and conveyed, and by these presents do grant, bargain, sell, alien and convey unto the said O.H.M. Properties, LLC, a Wisconsin limited liability company,

and to its heirs and assigns forever, all the following described real estate:

That part of the Northwest One-quarter (1/4) of Section Three, in Township Six (6) North, Range Twenty(20) East, in the City of New Berlin, County of Waukesha, State of Wisconsin, described as follows: Commencing at the Northwest corner of the Northwest 1/4 of Section 3, in Township 6 North, Range 20 East, City of New Berlin, thence South on Section line, 16 rods (264 feet) to the point of commencement of lands to be described; thence East on a line parallel with the North line of Section 3, 10 rods (165 feet); thence North on a line parallel with the West line of said Section 3, 84 feet; thence West on a line parallel with the North line of Section 3, 10 rods (165 feet); thence South on West line of Section 3, 84 feet to the place of beginning. ALSO, Lots One (1), Two (2) and Three (3) in Block One (1) in BUENA PARK, being a Subdivision of part of the Northwest One-quarter (1/4) of Section Three (3), Township Six (6) North, Range Twenty (20) East, in the City of New Berlin, Waukesha County, Wisconsin.
Together with the West 1/2 of the vacated alley adjoining on the East.

TO HAVE AND TO HOLD, all and singular the premises above mentioned and described, and hereby conveyed, or intended to be, unto the said part of the second part, its heirs and assigns, to its only proper use, benefit and behoof. FOREVER.

IN WITNESS WHEREOF, The said William Kruzicki Sheriff as aforesaid, hath hereunto set his hand and seal the day and year first above written.

Signed, Sealed and Delivered in Presence of

William Kruzicki by: CPT S. L. H. (SEAL) Sheriff Waukesha County, Wis.

STATE OF WISCONSIN, WAUKESHA COUNTY. On the 11th day of February 19 98, before me came the above named William Kruzicki Sheriff of Waukesha County, to me known to be the person and officer who executed the foregoing instrument, and acknowledged that he executed the same as such Sheriff for the uses and purposes therein set forth.

Notary Public J. W. AUKESHA County, Wisconsin My Commission expires 6-3-00 26 19 00

2296436

Sheriff's Deed on Foreclosure

2296436

REGISTRY SERVICE
WALDEN, WISCONSIN 53091

98 MAR 10 AM 8:35
REF 2614 MAR 0093

[Signature]
REGISTER OF DEEDS

Thomas P. Shannon, Esq.
Fox, O'Neill & Shannon, S.C.
622 N. Water Street, suite 500
Milw., WI 53202

*rec
16/4*

Tax Key No. 1162-997

FEE
17.25 (14)
EXEMPT

Chuck Cass
O.H.M. of New Berlin, Inc.
1420 S. Calhoun Road
New Berlin, Wisconsin 53151

Subject:
Deed Certification for Geographic Information System (GIS) Registry, One Hour Martinizing, New Berlin, Wisconsin.
BRRTS No. 02-68-218476

Dear Mr. Delwiche:

I Chuck Cass, Responsible Party (RP) for O.H.M. New Berlin, Inc., do hereby certify that to the best of my knowledge, the legal description included for Parcel Identification Number 1162-997 is complete and accurate for the purpose of registering this site onto the Wisconsin GIS Registry of Closed Remediation Sites.

Sincerely,

Signed: Chuck Cass
Title:

Date: 11-9-06

DWG DATE: 5AUG03 | PN: ONEHRMARTINIZING0707INVESTIG | FILE NO.: GRAPHICS | DRAWING: SITE_LOC.A1 | CHECKED: WM | APPROVED: | DRAFTER: ELP/JAK

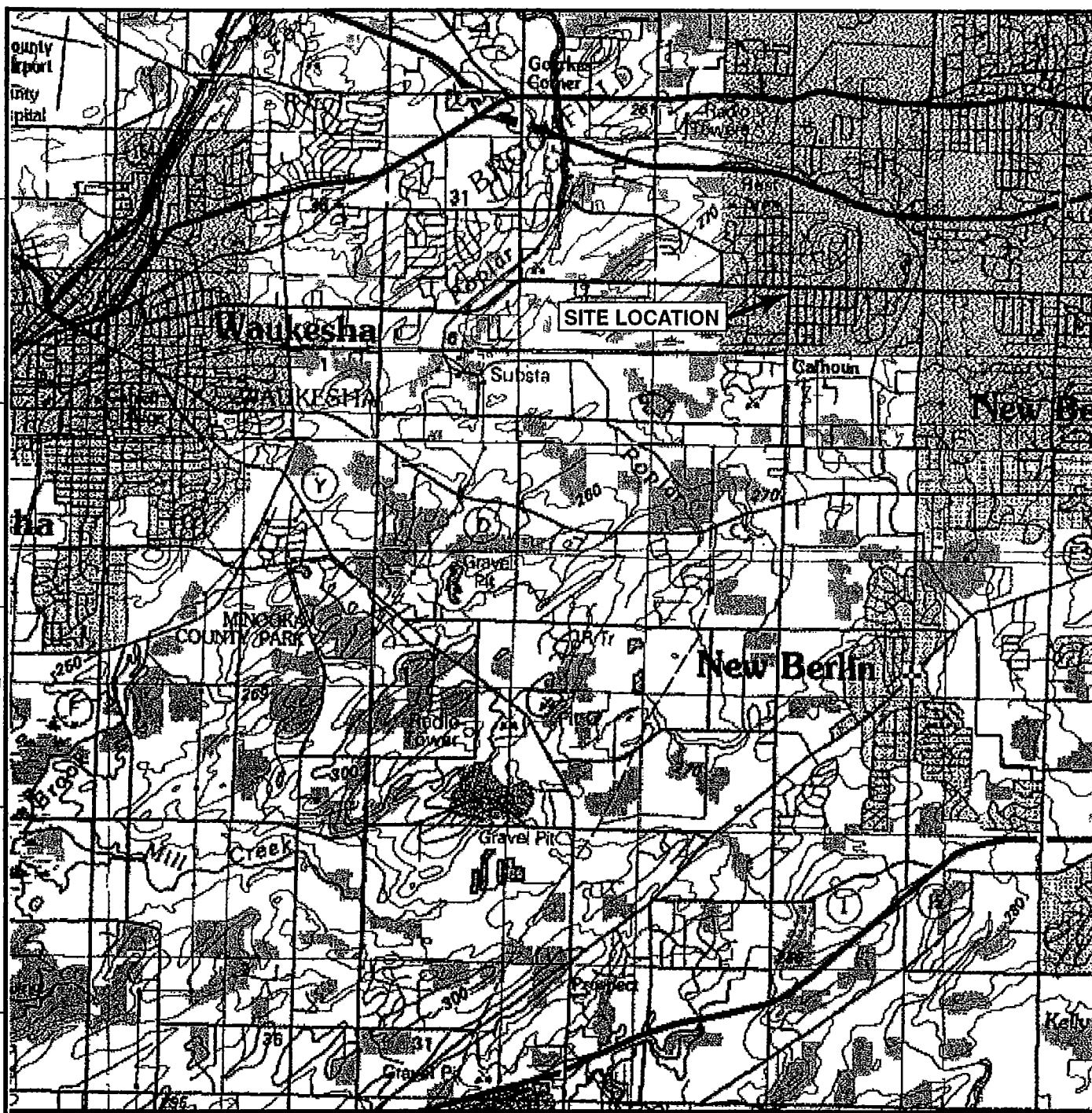

SOURCE: USGS 7.5 Minute Topographic Map, HALES CORNERS, WISCONSIN Quadrangle

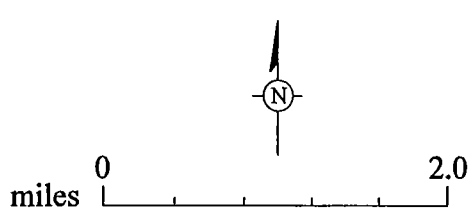

SITE LOCATION MAP

ONE HOUR MARTINIZING
NEW BERLIN, WISCONSIN

FIGURE

1

DRAFTER: LMB

APPROVED:

CHECKED: MMV

DRAWING: SITE LAYOUT_0906.AI

FILE NO.: GRAPHICS

PN: ONEHRMARW10707INVESTIG

DWG DATE: 19SEP06

LEGEND

MW-1 ● MONITORING WELL LOCATION

MW-3 ☒ ABANDONED MONITORING WELL

PZ-1 ● PIEZOMETER LOCATION

HA-1 ⊕ HAND AUGER LOCATION

VP-1 ⊕ VAPOR PROBE LOCATION

SB-2 ⊕ SOIL BORING LOCATION (Natural Resources Technology, Inc.)

GP-2 ⊕ SOIL BORING LOCATION (ARCADIS)

— WATER MAIN

— SANITARY SEWER

Note: There is no city storm sewer installed in the area surrounding the Site.



SUBJECT PROPERTY

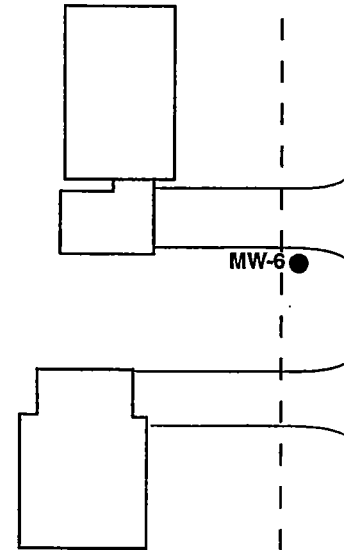
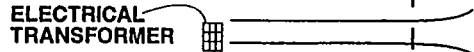
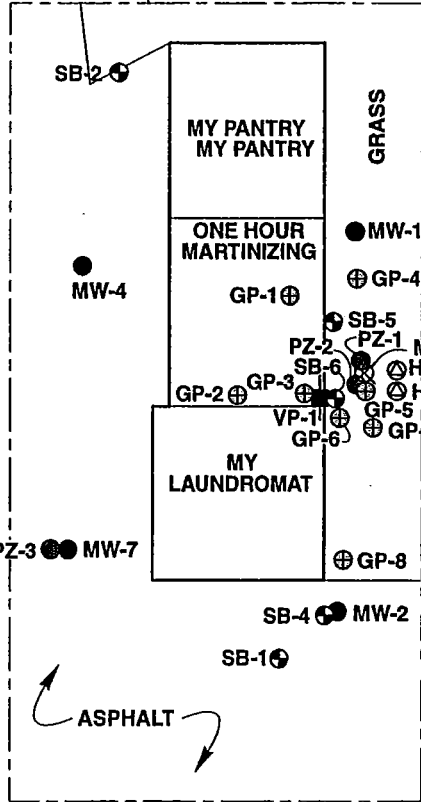

CALHOUN ROAD

171ST STREET



0 25 50

APPROXIMATE SCALE IN FEET

GRASS
RESIDENTIAL

60' ROW



SITE LAYOUT

ONE HOUR MARTINIZING
NEW BERLIN, WISCONSIN

FIGURE

2

DWG DATE: 19OCT06 | PN: ONEHRMARW10707REMEDATION | FILE NO.: GRAPHICS | DRAWING: EXCAVATIONS AI | CHECKED: MMV | APPROVED: | DRAFTER: LMB

LEGEND

- MW-1 ● MONITORING WELL LOCATION
- MW-3 ☒ ABANDONED MONITORING WELL
- PZ-1 ● PIEZOMETER LOCATION
- HA-1 ⊕ HAND AUGER LOCATION
- GP-2 ⊕ SOIL BORING LOCATION (ARCADIS)
- SS-N SIDEWALL SAMPLE LOCATION
- (18") DEPTH OF SOIL SAMPLE BELOW GROUND SURFACE
- ▭ CONSTITUENT EXCEEDS CHAPTER NR720 RESIDUAL CONTAMINANT LEVEL
- - - APPROXIMATE AREA OF EXCAVATION
- ⊖ APPROXIMATE LOCATION OF SOIL EXCEEDING DIRECT CONTACT
- BOLD** CONSTITUENT EXCEEDS U.S. EPA DIRECT CONTACT SOIL SCREENING LEVEL

VOCs	Volatile Organic Compounds
cis-1,2-DCE	cis-1,2-Dichloroethylene
trans-1,2-DCE	trans-1,2-Dichloroethylene
PCE	Tetrachlorethylene
TCE	Trichloroethylene
VC	Vinyl Chloride
B	Benzene
E	Ethylbenzene
T	Toluene
X	Xylene
1,2,4-TMB	1,2,4-Trimethylbenzene
TOC	Total Organic Carbon
NA	Not Analyzed
ND	Not Detected

Results are presented in micrograms per kilogram (µg/kg)
 TOC presented in milligrams per kilogram (mg/kg)

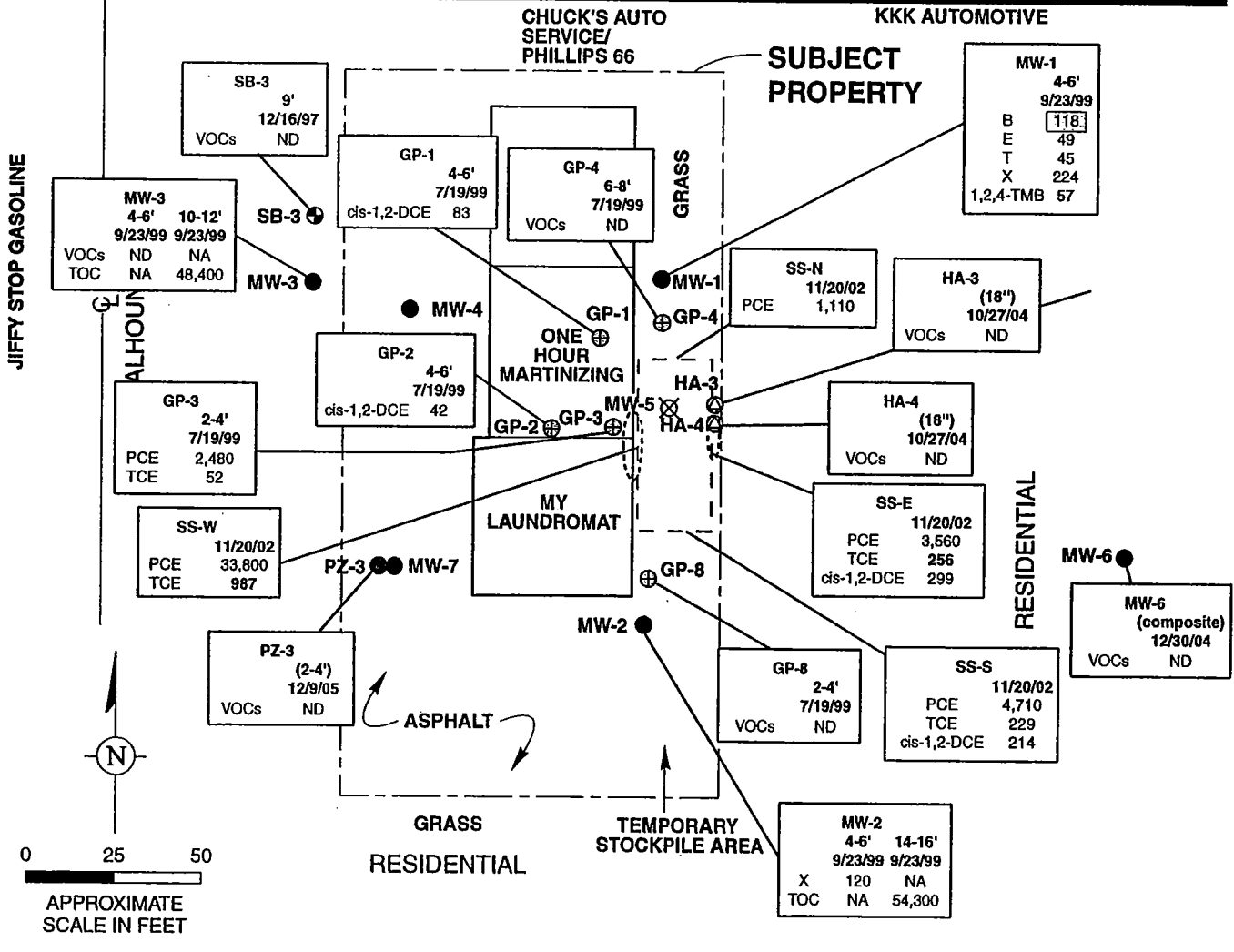

LOCATION OF EXCAVATION AND POST-REMEDIAL SOIL SAMPLE RESULTS

ONE HOUR MARTINIZING
 NEW BERLIN, WISCONSIN

FIGURE
4-1

DWG DATE: 07AUG03 | PN: ONEHRMARW10707INVESTIG | FILE NO.: GRAPHICS | DRAWING: GWTR FLOW 0603.AI | CHECKED: JHE | APPROVED: | DRAFTER: ELSLMBJAK

LEGEND

- MW-1 ● MONITORING WELL LOCATION
- PZ-1 ● PIEZOMETER LOCATION
- (865.31) WATER TABLE ELEVATION (MEAN SEA LEVEL)
- 865 — WATER TABLE CONTOUR (dashed where inferred)
- ← GENERALIZED DIRECTION OF GROUNDWATER FLOW

GREENFIELD AVENUE

CHUCK'S AUTO SERVICE/ PHILLIPS 66

KKK AUTOMOTIVE

SUBJECT PROPERTY

JIFFY STOP GASOLINE
 CALHOUN ROAD

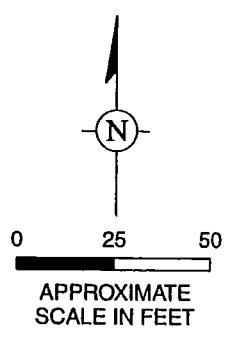
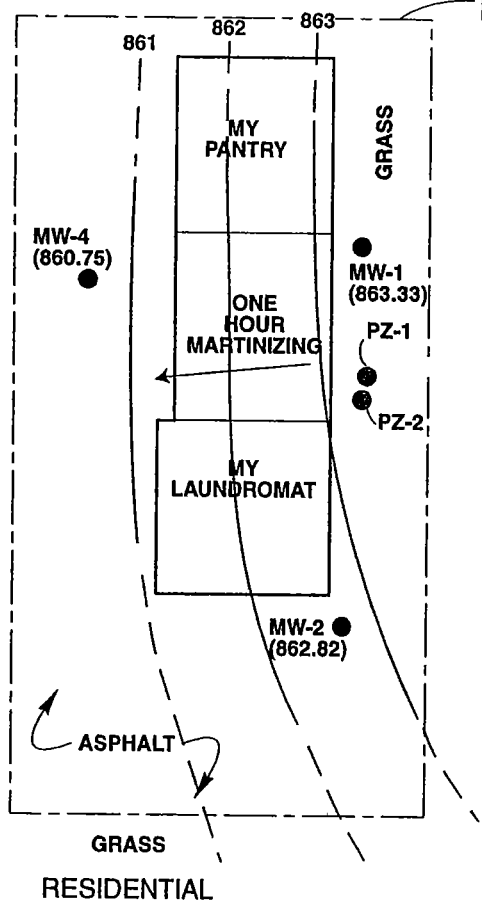

GROUNDWATER ELEVATION MAP
JUNE 4, 2003
 ONE HOUR MARTINIZING
 NEW BERLIN, WISCONSIN

FIGURE
3-5

DWG DATE: 190CT06 | PN: ONEHRMARIW0707INVESTIG | FILE NO.: GRAPHICS | DRAWING: GW ELEVATION 0405.A1 | CHECKED: MMV | APPROVED: | DRAFTER: LMB

LEGEND

- MW-1 ● MONITORING WELL LOCATION
- MW-3 ☒ ABANDONED MONITORING WELL
- PZ-1 ● PIEZOMETER LOCATION
- HA-1 ⊕ HAND AUGER LOCATION
- VP-1 ⊕ VAPOR PROBE LOCATION
- (863.99) WATER TABLE ELEVATION
(feet above mean sea level)
- 864 — GROUNDWATER CONTOUR
(dashed where inferred)
- ← GENERALIZED DIRECTION OF GROUNDWATER FLOW

GREENFIELD AVENUE

171ST STREET

CHUCK'S AUTO SERVICE/ PHILLIPS 66

KKK AUTOMOTIVE

SUBJECT PROPERTY

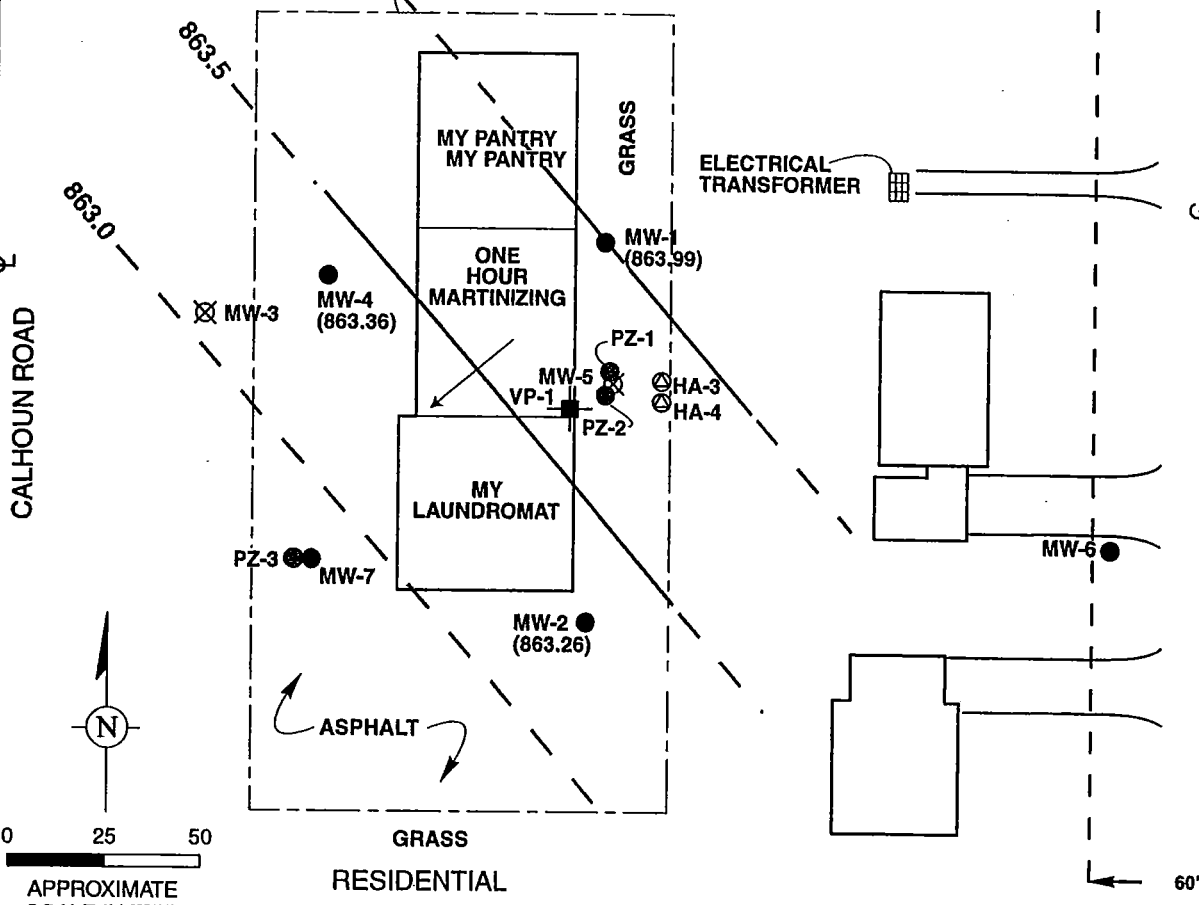

0 25 50
APPROXIMATE SCALE IN FEET

60' ROW



**GROUNDWATER ELEVATION MAP
APRIL 2005**

ONE HOUR MARTINIZING
NEW BERLIN, WISCONSIN

FIGURE

5

Table 1. Historical Soil Analytical Results, One Hour Martinizing, New Berlin, Wisconsin.

Name	GP-1	GP-2	GP-3	GP-4	GP-5	GP-6	GP-7	GP-8	HA-3
Sample Depth (ft bls)	(4-6)	(4-6)	(2-4)	(6-8)	(2-4)	(6-8)	(6-8)	(2-4)	(1.5)
Sample Date	07/19/99	07/19/99	07/19/99	07/19/99	07/19/99	07/19/99	07/19/99	07/19/99	10/27/04
VOCs (µg/kg)									
1,1-Dichloroethene	<35	<39	<37	<33	<33	<32	<35	<36	<25
1,2,4-Trimethylbenzene	<35	<39	<37	<33	<33	<32	<35	<36	<25
Benzene	<35	<39	<37	<33	<33	<32	<35	<36	<25
cis-1,2-Dichloroethene	83	42	<37	<33	<33	2,180	6340	<36	<25
Ethylbenzene	<35	<39	<37	<33	<33	<32	<35	<36	<25
Methylene Chloride	151 L	239 L	144 L	119 L	110 L	128 L	110 L	129 L	<25
Tetrachloroethene	<35	<39	2,480	<33	<33	1,540	1,860	<36	<25
Toluene	<35	<39	<37	<33	<33	<32	<35	<36	<25
trans-1,2-Dichloroethene	<35	<39	<37	<33	<33	53	199	<36	<25
Trichloroethene	<35	<39	52	<33	<33	1,050	484	<36	<25
Vinyl Chloride	<35	<39	<37	<33	<33	37	124	<36	<25
Xylenes, Total	<48	<53	<50	<45	<46	<45	<47	<49	NA
TCLP (mg/L)									
Tetrachloroethene	NA	NA	NA	NA	NA	NA	NA	NA	NA
Trichloroethene	NA	NA	NA	NA	NA	NA	NA	NA	NA
TOC (mg/kg)									
TOC (mg/kg)	NA	NA	NA	NA	NA	NA	NA	NA	NA

Footnotes on Page 5.

Table 1. Historical Soil Analytical Results, One Hour Martinizing, New Berlin, Wisconsin.

Name	HA-4	MW-1	MW-2		MW-3		MW-5		MW-6	PZ-3	
Sample Depth (ft bls)	(1.5)	(4-6)	(14-16)	(16-18)	(4-6)	(10-12)	(4-6)	(2-4)	(6-8)	(Composite)	(2-4)
Sample Date	10/27/04	09/23/99	09/23/99	09/23/99	09/23/99	09/23/99	09/23/99	06/14/01	06/14/01	12/30/04	12/09/05
VOCs ($\mu\text{g}/\text{kg}$)											
1,1-Dichloroethene	<25	<35	NA	NA	<31	NA	<30	<25	73	<25	<25
1,2,4-Trimethylbenzene	<25	57	NA	NA	<31	NA	<30	<25	<50	<25	<25
Benzene	<25	118	NA	NA	<31	NA	<30	<25	<50	<25	<25
cis-1,2-Dichloroethene	<25	<35	NA	NA	<31	NA	<30	4,000	7,800	<25	<25
Ethylbenzene	<25	49	NA	NA	<31	NA	<30	<25	<50	<25	<25
Methylene Chloride	<25	<71	NA	NA	<62	NA	<60	<25	<50	<25	<25
Tetrachloroethene	<25	<35	NA	NA	<31	NA	<30	140,000	18,000	<25	<25
Toluene	<25	45	NA	NA	<31	NA	<30	<25	<50	<25	<25
trans-1,2-Dichloroethene	<25	<35	NA	NA	<31	NA	<30	<25	470	<25	<25
Trichloroethene	<25	<35	NA	NA	<31	NA	<30	4,800	4,100	<25	<25
Vinyl Chloride	<25	<35	NA	NA	<31	NA	<30	<25	760	<25	<25
Xylenes, Total	NA	224	NA	NA	120	NA	<42	<75	<150	NA	NA
TCLP (mg/L)											
Tetrachloroethene	NA	NA	NA	NA	NA	NA	NA	NA	NA	NA	NA
Trichloroethene	NA	NA	NA	NA	NA	NA	NA	NA	NA	NA	NA
TOC (mg/kg)	NA	NA	54,300	NA	NA	48,400	NA	NA	NA	NA	NA

Footnotes on Page 5.

Table 1. Historical Soil Analytical Results, One Hour Martinizing, New Berlin, Wisconsin.

Name	SP-1	SP-2	SP-3	SP-4	SS-E	SS-N	SS-S	SS-W	WDNR RCL ⁽¹⁾
Sample Depth (ft bls)									
Sample Date	11/20/02	11/20/02	11/20/02	11/20/02	11/20/02	11/20/02	11/20/02	11/20/02	
VOCs (µg/kg)									
1,1-Dichloroethene	<33	<1810	<36	<33	<71	<32	<36	<364	NE
1,2,4-Trimethylbenzene	<33	<1810	<36	<33	<71	<32	<36	<364	NE
Benzene	<33	<1810	<36	<33	<71	<32	<36	<364	5.5
cis-1,2-Dichloroethene	293	<1810	120	897	299	<32	214	<364	NE
Ethylbenzene	<33	<1810	<36	<33	<71	<32	<36	<364	2,900
Methylene Chloride	79 L	<3,780	120 L	<67	<142	<65	157 L	<714	NE
Tetrachloroethene	18,700 J	1,960,000 J	2810	7,760	3,560	1,110	4,710	33,800	NE
Toluene	<33	<1810	<36	<33	<71	<32	<36	<364	1,500
trans-1,2-Dichloroethene	<33	<1810	<36	<33	<71	<32	<36	<364	NE
Trichloroethene	627	12,100	<36	308	256	<32	229	987	NE
Vinyl Chloride	<33	<1810	<36	<33	<71	<32	<36	<494	NE
Xylenes, Total	<47	<2,720	<49	<47	<100	<45	<50	<494	4,100
TCLP (mg/L)									
Tetrachloroethene	0.27	15	0.04	0.17	NA	NA	NA	NA	NE
Trichloroethene	<0.020	0.12	<0.020	<0.020	NA	NA	NA	NA	NE
TOC (mg/kg)	NA	NA	NA	NA	NA	NA	NA	NA	NE

Footnotes on Page 5.

Table 1. Historical Soil Analytical Results, One Hour Martinizing, New Berlin, Wisconsin.

Name Sample Depth (ft bls) Sample Date	U.S. EPA Industrial SSLs ⁽²⁾			
	Ingestion	Inhalation of Dust	Inhalation of Volatiles	Soil to Groundwater
<u>VOCs (µg/kg)</u>				
1,1-Dichloroethene	51,100,000	226,000,000,000	820,000	5
1,2,4-Trimethylbenzene	NE	NE	NE	NE
Benzene	NE	NE	NE	NE
cis-1,2-Dichloroethene	10,200,000	NE	NE	27
Ethylbenzene	NE	NE	NE	NE
Methylene Chloride	382,000	6,740,000,000	46,000	1.6
Tetrachloroethene	55,000	5,460,000,000	35,000	4.1
Toluene	NE	NE	NE	NE
trans-1,2-Dichloroethene	20,400,000	NE	NE	98
Trichloroethene	7,150	28,800,000	240	3.7
Vinyl Chloride	1,910	360,000,000	940	0.13
Xylenes, Total	NE	NE	NE	NE
<u>TCLP (mg/L)</u>				
Tetrachloroethene	NE	NE	NE	NE
Trichloroethene	NE	NE	NE	NE
<u>TOC (mg/kg)</u>				
	NE	NE	NE	NE

Footnotes on Page 5.

Table 1. Historical Soil Analytical Results, One Hour Martinizing, New Berlin, Wisconsin.

(1)	WDNR ch. NR720 Wis. Adm. Code Table 1 RCL based on protection of groundwater.
(2)	Values calculated using the WDNR guidance document "Determining Residual Contaminant Levels using the U.S. EPA Soil Screening Level Web Site, PUB-RR-682, January, 11, 2002".
<	Constituent not present above laboratory method detection limit, which is the value following the "<" sign.
<input type="checkbox"/>	Constituent concentration exceeds the U.S. EPA SSL for direct contact (ingestion and inhalation).
bold	Constituent concentration exceeds the U.S. EPA SSL for soil to groundwater.
ft bls	Feet below land surface.
<i>italic</i>	Constituent concentration exceeds WDNR RCL.
J	Estimated concentration.
L	Common lab solvent and contaminant.
µg/kg	Micrograms per kilogram.
mg/kg	Milligrams per kilogram.
mg/L	Milligrams per liter.
NA	Not analyzed.
NE	Constituent standard or limit not established.
Q	Constituent was detected between the limit of detection and the limit of quantitation.
RCL	Residual Contaminant Level.
SP-1	Stockpile Sample.
SS-N	Sidewall Sample.
SSL	Soil Screening Level.
TCLP	Toxicity Characteristic Leaching Procedure.
U.S. EPA	United States Environmental Protection Agency
VOCs	Volatile organic compounds.
WDNR	Wisconsin Department of Natural Resources.

ARCADIS

Table 2. Groundwater Analytical Results, 2005 Supplemental Investigation Activities, One Hour Martinizing, New Berlin, Wisconsin.

Name	MW-1									MW-2		
	10/01/99	06/21/01	01/02/03	04/07/03	04/06/04	01/03/05	07/21/05	12/15/05	10/01/99	06/21/01	01/02/03	
VOCs (µg/L)												
1,1-Dichloroethene	<0.25	<0.85	<0.25	<0.50	<0.57	<0.57	<0.57	<0.57	<0.25	<0.85	<0.25	
Chloromethane	<0.25	<0.62	<0.25	<0.25	<0.24	<0.24	<0.24	<0.24	<0.25	<0.62	<0.25	
cis-1,2-Dichloroethene	<0.25	<0.73	<0.25	<0.50	<0.83	<0.83	<0.83	<0.83	<0.25	<0.73	<0.25	
Methylene Chloride	<0.25	<0.85	4.9 L	<1.0	<0.43	<0.43	<0.43	<0.43	<0.25	<0.85	<0.25	
Naphthalene	<0.10	<0.59	<0.25	<0.25	<0.74	<0.74	<0.74	<0.74	<0.10	<0.59	0.25	
Tetrachloroethene	0.3	<0.57	<0.25	<0.50	<0.45	<0.45	<0.45	<0.45	<0.25	<0.57	<0.25	
Toluene	<0.10	<0.47	<0.10	<0.25	<0.67	<0.67	<0.67	<0.67	<0.10	<0.47	<0.10	
trans-1,2-Dichloroethene	<0.25	<0.79	<0.25	<0.50	<0.89	<0.89	<0.89	<0.89	<0.25	<0.79	<0.25	
Trichloroethene	<0.25	<0.89	<0.25	<0.25	<0.48	<0.48	<0.48	<0.48	<0.25	<0.89	<0.25	
Vinyl Chloride	<0.25	<0.18	<0.25	<0.50	<0.18	<0.18	<0.18	<0.18	<0.25	<0.18	<0.25	
Gases (µg/L)												
Ethane	0.62	0.02	<0.005	NA	NA	NA	NA	NA	<0.2	0.01	<0.005	
Ethene	<0.3	<0.01	<0.005	NA	NA	NA	NA	NA	<0.3	<0.01	<0.005	
Methane	240	180	0.58	NA	NA	NA	NA	NA	0.54	5.9	1	
MISC												
Total Organic Carbon (mg/L)	NA	6.3	4.6	NA	NA	NA	NA	NA	NA	3.3	2.4	

Bold Constituent concentration exceeds NR140 ES.

Constituent concentration exceeds NR140 PAL.

< Constituent was not present at or above the method detection limit, which is the value following the "<" sign.

(1) MW-3 was abandoned on December 22, 1999 due to street construction activities.

(2) MW-5 was abandoned on November 20, 2002 due to interim action activities.

ES Enforcement Standard as established in Chapter NR 140 Wisconsin Administrative Code Groundwater Quality Criteria.

L Elevated detection limit due to low sample volume.

µg/L Micrograms per liter.

mg/L Milligrams per liter.

M Sample pH was greater than 2.

NA Not analyzed.

NE Not established.

PAL Preventive Action Limit as established in Chapter NR 140 Wisconsin Administrative Code Groundwater Quality Criteria.

Q Analyte detected between the limit of detection and limit of quantitation.

ARCADIS

Table 2. Groundwater Analytical Results, 2005 Supplemental Investigation Activities, One Hour Martinizing, New Berlin, Wisconsin.

Name Sample Date	MW-2 (continued)					MW-3 ⁽¹⁾	MW-4			
	04/07/03	04/06/04	01/03/05	07/21/05	12/16/05	10/01/99	10/01/99	01/31/00	06/21/01	01/03/03
VOCs (µg/L)										
1,1-Dichloroethene	<0.50	<0.57	<0.57	<0.57	<0.57	<0.25	<0.25	<0.25	<0.85	<0.25
Chloromethane	<0.25	<0.24	<0.24	<0.24	<0.24	<0.25	<0.25	3	<0.62	<0.25
cis-1,2-Dichloroethene	<0.50	<0.83	<0.83	<0.83	<0.83	<0.25	<0.25	0.36	24	6.7
Methylene Chloride	<1.0	<0.43	<0.43	<0.43	<0.43	<0.25	<0.25	<0.25	<0.85	<0.25
Naphthalene	<0.25	<0.74	0.92 Q	<0.74	<0.74	<0.10	<0.10	<0.25	<0.59	<0.25
Tetrachloroethene	<0.50	<0.45	<0.45	<0.45	<0.45	<0.25	0.5	<0.25	<0.57	<0.25
Toluene	<0.25	<0.67	<0.67	<0.67	<0.67	<0.10	<0.10	0.16	<0.47	<0.10
trans-1,2-Dichloroethene	<0.50	<0.89	<0.89	<0.89	<0.89	<0.25	<0.25	<0.25	1.7 Q	0.59
Trichloroethene	<0.25	<0.48	<0.48	<0.48	<0.48	<0.25	<0.25	<0.25	<0.89	<0.25
Vinyl Chloride	<0.50	<0.18	<0.18	<0.18	<0.18	<0.25	<0.25	<0.25	7.2	2.9
Gases (µg/L)										
Ethane	NA	NA	NA	NA	NA	0.59	NA	<0.2	0.52	<0.005
Ethene	NA	NA	NA	NA	NA	<0.3	NA	<0.3	0.03	<0.005
Methane	NA	NA	NA	NA	NA	21	NA	9.4	662	0.48
MISC										
Total Organic Carbon (mg/L)	NA	NA	NA	NA	NA	NA	NA	NA	6.3	6.3

Bold Constituent concentration exceeds NR140 ES.

Constituent concentration exceeds NR140 PAL.

< Constituent was not present at or above the method detection limit, which is the value following the "<" sign.

(1) MW-3 was abandoned on December 22, 1999 due to street construction activities.

(2) MW-5 was abandoned on November 20, 2002 due to interim action activities.

ES Enforcement Standard as established in Chapter NR 140 Wisconsin Administrative Code Groundwater Quality Criteria.

L Elevated detection limit due to low sample volume.

µg/L Micrograms per liter.

mg/L Milligrams per liter.

M Sample pH was greater than 2.

NA Not analyzed.

NE Not established.

PAL Preventive Action Limit as established in Chapter NR 140 Wisconsin Administrative Code Groundwater Quality Criteria.

Q Analyte detected between the limit of detection and limit of quantitation.

ARCADIS

Table 2. Groundwater Analytical Results, 2005 Supplemental Investigation Activities, One Hour Martinizing, New Berlin, Wisconsin.

Name Sample Date	MW-4 (continued)					MW-5 ⁽²⁾	MW-6		
	04/07/03	04/07/04	01/03/05	07/22/05	12/16/05	06/22/01	01/04/05	07/21/05	12/15/05
VOCs (µg/L)									
1,1-Dichloroethene	<0.50	<0.57	<0.57	<0.57	<0.57	230 Q	<0.57	<0.57	<0.57
Chloromethane	<0.25	<0.24	<0.24	<0.24	<0.24	<62	<0.24	<0.24	<0.24
cis-1,2-Dichloroethene	5.1	2.6 Q	8.7	6.9	7.9	17,000	<0.83	<0.83	0.96 Q
Methylene Chloride	<1.0	<0.43	<0.43	<0.43	<0.43	<85	<0.43	<0.43	<0.43
Naphthalene	<0.25	<0.74	<0.74	<0.74	<0.74	<59	<0.74	<0.74	<0.74
Tetrachloroethene	<0.50	<0.45	<0.45	<0.45	<0.45	5,300	<0.45	<0.45	<0.45
Toluene	<0.25	<0.67	<0.67	<0.67	<0.67	<47	<0.67	<0.67	<0.67
trans-1,2-Dichloroethene	<0.50	<0.89	<0.89	<0.89	<0.89	1,000	<0.89	<0.89	<0.89
Trichloroethene	<0.25	<0.48	<0.48	<0.48	<0.48	5,700	<0.48	<0.48	<0.48
Vinyl Chloride	0.73	1.1	4	7.4	4.5	2,800	<0.18	<0.18	<0.18
Gases (µg/L)									
Ethane	NA	NA	NA	NA	NA	2.7	NA	NA	NA
Ethene	NA	NA	NA	NA	NA	130	NA	NA	NA
Methane	NA	NA	NA	NA	NA	11.4	NA	NA	NA
MISC									
Total Organic Carbon (mg/L)	NA	NA	NA	NA	NA	12	NA	NA	NA

- Bold** Constituent concentration exceeds NR140 ES.
- 8.7** Constituent concentration exceeds NR140 PAL.
- < Constituent was not present at or above the method detection limit, which is the value following the "<" sign.
- (1) MW-3 was abandoned on December 22, 1999 due to street construction activities.
- (2) MW-5 was abandoned on November 20, 2002 due to interim action activities.
- ES Enforcement Standard as established in Chapter NR 140 Wisconsin Administrative Code Groundwater Quality Criteria.
- L Elevated detection limit due to low sample volume.
- µg/L Micrograms per liter.
- mg/L Milligrams per liter.
- M Sample pH was greater than 2.
- NA Not analyzed.
- NE Not established.
- PAL Preventive Action Limit as established in Chapter NR 140 Wisconsin Administrative Code Groundwater Quality Criteria.
- Q Analyte detected between the limit of detection and limit of quantitation.

ARCADIS

Table 2. Groundwater Analytical Results, 2005 Supplemental Investigation Activities, One Hour Martinizing, New Berlin, Wisconsin.

Name Sample Date	MW-7	PZ-1							PZ-2		
	01/06/06	01/03/03	04/07/03	04/07/04	01/03/05	04/19/05	07/22/05	12/16/05	01/03/03	04/07/03	01/03/03
VOCs (µg/L)											
1,1-Dichloroethene	<0.57	<2.5	<2.0	<0.57	<0.57	<0.57 M	<0.57	<0.57	6.7	12	6.7
Chloromethane	<0.24	<2.5	<1.0	<0.24	<0.24	<0.24 M	<0.24	<0.24	<2.5	<4.0	<2.5
cis-1,2-Dichloroethene	<0.83	270	170	110	82	72 M	69	52	620	1600	620
Methylene Chloride	<0.43	24 L	<4.0	<0.43	<0.43	<0.43 M	<0.43	<0.43	28 L	<16	28 L
Naphthalene	<0.74	<2.5	<1.0	<0.74	<0.74	<0.74 M	<0.74	<0.74	<2.5	<4.0	<2.5
Tetrachloroethene	<0.45	7.9	3.5	3.2	2	1.2 QM	1.4 Q	1.7	870	<8.0	870
Toluene	<0.67	<1.0	<1.0	<0.67	<0.67	<0.67 M	<0.67	<0.67	<1.0	<4.0	<1.0
trans-1,2-Dichloroethene	<0.89	<2.5	7.2	2.1 Q	1.9 Q	2.1 QM	1.6 Q	1.2 Q	35	62	35
Trichloroethene	<0.48	400	150	52	38	23 M	24	25	530	<4.0	530
Vinyl Chloride	<0.18	<2.5	<2.0	<0.18	1.9	3.9 M	<0.18	<0.18	140	230	140
Gases (µg/L)											
Ethane	NA	0.67	0.35	0.31	0.018	0.03	0.02	0.051	0.84	1.2	0.84
Ethene	NA	0.78	0.65	0.4	0.01	0.039	0.017	0.038	11	22	11
Methane	NA	3.3	3.9	13	0.7	0.5	0.90	1.6	19	6,000	19
MISC											
Total Organic Carbon (mg/L)	NA	11	3.7	1.2 Q	2.3 Q	18	2.3 Q	2 Q	960	700	960

Bold Constituent concentration exceeds NR140 ES.

6.7 Constituent concentration exceeds NR140 PAL.

< Constituent was not present at or above the method detection limit, which is the value following the "<" sign.

(1) MW-3 was abandoned on December 22, 1999 due to street construction activities.

(2) MW-5 was abandoned on November 20, 2002 due to interim action activities.

ES Enforcement Standard as established in Chapter NR 140 Wisconsin Administrative Code Groundwater Quality Criteria.

L Elevated detection limit due to low sample volume.

µg/L Micrograms per liter.

mg/L Milligrams per liter.

M Sample pH was greater than 2.

NA Not analyzed.

NE Not established.

PAL Preventive Action Limit as established in Chapter NR 140 Wisconsin Administrative Code Groundwater Quality Criteria.

Q Analyte detected between the limit of detection and limit of quantitation.

ARCADIS

Table 2. Groundwater Analytical Results, 2005 Supplemental Investigation Activities, One Hour Martinizing, New Berlin, Wisconsin.

Name	PZ-2 (continued)						PZ-3	ES	PAL
	04/07/03	04/07/04	01/03/05	04/19/05	07/22/05	12/16/05	01/06/06		
VOCs (µg/L)									
1,1-Dichloroethene	12	<0.57	<1.4	<1.4 M	1.2 Q	<2.8	<0.57	7	0.7
Chloromethane	<4.0	<0.24	<0.6	<0.6 M	<0.48	<1.2	<0.24	3	0.3
cis-1,2-Dichloroethene	1600	28	260	430 M	290	310	<0.83	70	7
Methylene Chloride	<16	<0.43	<1.1	<1.1 M	<0.86	<2.2	<0.43	5	0.5
Naphthalene	<4.0	<0.74	<1.8	<1.8 M	<1.5	<3.7	<0.74	40	8
Tetrachloroethene	<8.0	<0.45	<1.1	<1.1 M	<0.9	<2.2	<0.45	5	0.5
Toluene	<4.0	<0.67	<1.7	<1.7 M	<1.3	<3.4	<0.67	1,000	200
trans-1,2-Dichloroethene	62	<0.89	3.2 Q	5.6 QM	5.1 Q	<4.4	<0.89	100	20
Trichloroethene	<4.0	0.90 Q	<1.2	1.5 QM	2.0 Q	<2.4	<0.48	5	0.5
Vinyl Chloride	230	58	300	300 M	220	460	<0.18	0.2	0.02
Gases (µg/L)									
Ethane	1.2	230	78	79	80.002	43	NA	NE	NE
Ethene	22	48	230	110	126.358	110	NA	NE	NE
Methane	6,000	5,600	2,700	2,800	1,989.3	1,100	NA	NE	NE
MISC									
Total Organic Carbon (mg/L)	700	18	29	14	20	14	NA	NE	NE

Bold Constituent concentration exceeds NR140 ES.

Constituent concentration exceeds NR140 PAL.

< Constituent was not present at or above the method detection limit, which is the value following the "<" sign.

(1) MW-3 was abandoned on December 22, 1999 due to street construction activities.

(2) MW-5 was abandoned on November 20, 2002 due to interim action activities.

ES Enforcement Standard as established in Chapter NR 140 Wisconsin Administrative Code Groundwater Quality Criteria.

L Elevated detection limit due to low sample volume.

µg/L Micrograms per liter.

mg/L Milligrams per liter.

M Sample pH was greater than 2.

NA Not analyzed.

NE Not established.

PAL Preventive Action Limit as established in Chapter NR 140 Wisconsin Administrative Code Groundwater Quality Criteria.

Q Analyte detected between the limit of detection and limit of quantitation.

ARCADIS

Table 3. Summary of Groundwater Elevations, 2005 Supplemental Investigation Activities, One Hour Martinizing, New Berlin, Wisconsin.

Well Name	Date Measured	Top of Casing Elevation	Depth To Water	Water Elevation
MW-1	02/20/01	869.46	4.70	864.76
MW-1	06/21/01	869.46	4.15	865.31
MW-1	06/04/03	869.46	6.13	863.33
MW-1	04/06/04	869.46	5.95	863.51
MW-1	01/03/05	869.46	9.01	860.45
MW-1	04/19/05	869.46	5.47	863.99
MW-1	07/21/05	869.46	10.02	859.44
MW-1	12/15/05	869.46	10.44	859.02
MW-2	02/20/01	869.05	5.02	864.03
MW-2	06/21/01	869.05	5.07	863.98
MW-2	06/04/03	869.05	6.23	862.82
MW-2	04/06/04	869.05	5.65	863.40
MW-2	01/03/05	869.05	9.37	859.68
MW-2	04/19/05	869.05	5.79	863.26
MW-2	07/21/05	869.05	10.02	859.03
MW-2	12/15/05	869.05	9.03	860.02
MW-4	02/20/01	869.47	9.21	860.26
MW-4	06/21/01	869.47	7.12	862.35
MW-4	06/04/03	869.47	8.72	860.75
MW-4	04/06/04	869.47	4.46	865.01
MW-4	01/03/05	869.47	10.05	859.42
MW-4	04/19/05	869.47	6.11	863.36
MW-4	07/21/05	869.47	--	--
MW-4	12/15/05	869.47	10.40	859.07
MW-6	01/03/05	--	9.54	--
MW-6	04/19/05	--	4.90	--
MW-6	07/21/05	--	11.10	--
MW-6	12/15/05	--	11.71	--
MW-7	12/15/05	868.58	18.09	850.49
MW-7	01/06/06	868.58	12.77	855.81
PZ-1	06/04/03	869.36	11.70	857.66
PZ-1	04/06/04	869.36	14.02	855.34
PZ-1	01/03/05	869.36	14.71	854.65
PZ-1	04/19/05	869.36	13.22	856.14
PZ-1	07/21/05	869.36	16.64	852.72
PZ-1	12/15/05	869.36	17.74	851.62
PZ-2	06/04/03	869.30	1.86	867.44
PZ-2	04/06/04	869.30	2.26	867.04
PZ-2	01/03/05	869.30	2.79	866.51
PZ-2	04/19/05	869.30	2.23	867.07
PZ-2	07/21/05	869.30	2.34	866.96
PZ-2	12/15/05	869.30	1.89	867.41
PZ-3	12/15/05	868.73	19.76	848.97
PZ-3	1/6/2006	868.73	20.04	848.69

Elevation data presented in feet relative to mean sea level (ft msl).

Depth to water presented in feet.

-- Data not available.