



## Meridian Environmental Consulting, LLC

---

October 9, 2013

Pat Collins  
Wisconsin Department of Natural Resources  
890 Spruce St.  
Baldwin, Wisconsin 54002



Subject: **Change Order: Replace MW-6 and Quarterly Sampling (3X)**  
Corner Store  
100 Tonnar St (Hwy. 25)  
Ridgeland, Wisconsin  
BRRTS No. 03-17-223007  
PECFA No. 54763-9623-02  
Meridian No. 05F761

Dear Pat:

This Change Order follows our Ground Water Monitoring Report dated September 20, 2013. DNR staff requested additional ground water sampling. MW-6 will be replaced as well. This letter is a Change Order for the requested work.

### Replace MW-6

MW-6 was abandoned in August 2013 because its installation caused damage to the Amundsen sewer lateral. We will install a replacement well (MW-6R) between the Amundsen well and the site (see Figure 1). The well will be 15 feet deep.

After the well is installed, it will be developed. Its location and elevation will be surveyed relative to the current monitoring well network.

### Ground Water Sampling

The monitoring well network will be sampled quarterly for three times. Wells TWM-1, -2R, -3, -4, -6R, PZ-1, and the Amundsen well will be sampled three times and the remaining wells (MW-1, MW-5, MW-7, MW-8, Store well) sampled during the last event. The samples will be analyzed for PVOC+Naphthalene.

Water levels will be measured in all wells during each sampling event.

Report

The results of the drilling and the sampling will be documented in a Letter Report. This report will include our recommendations regarding Closure with GIS Registry for Soil and Ground Water.

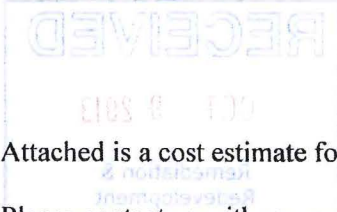

**COST ESTIMATE**

Attached is a cost estimate for the proposed work.

Please contact us with any comments or questions.

Sincerely,  
**MERIDIAN ENVIRONMENTAL CONSULTING, LLC**

  
Kenneth Shimko, PG  
Project Manager

C: Tim Zeichert

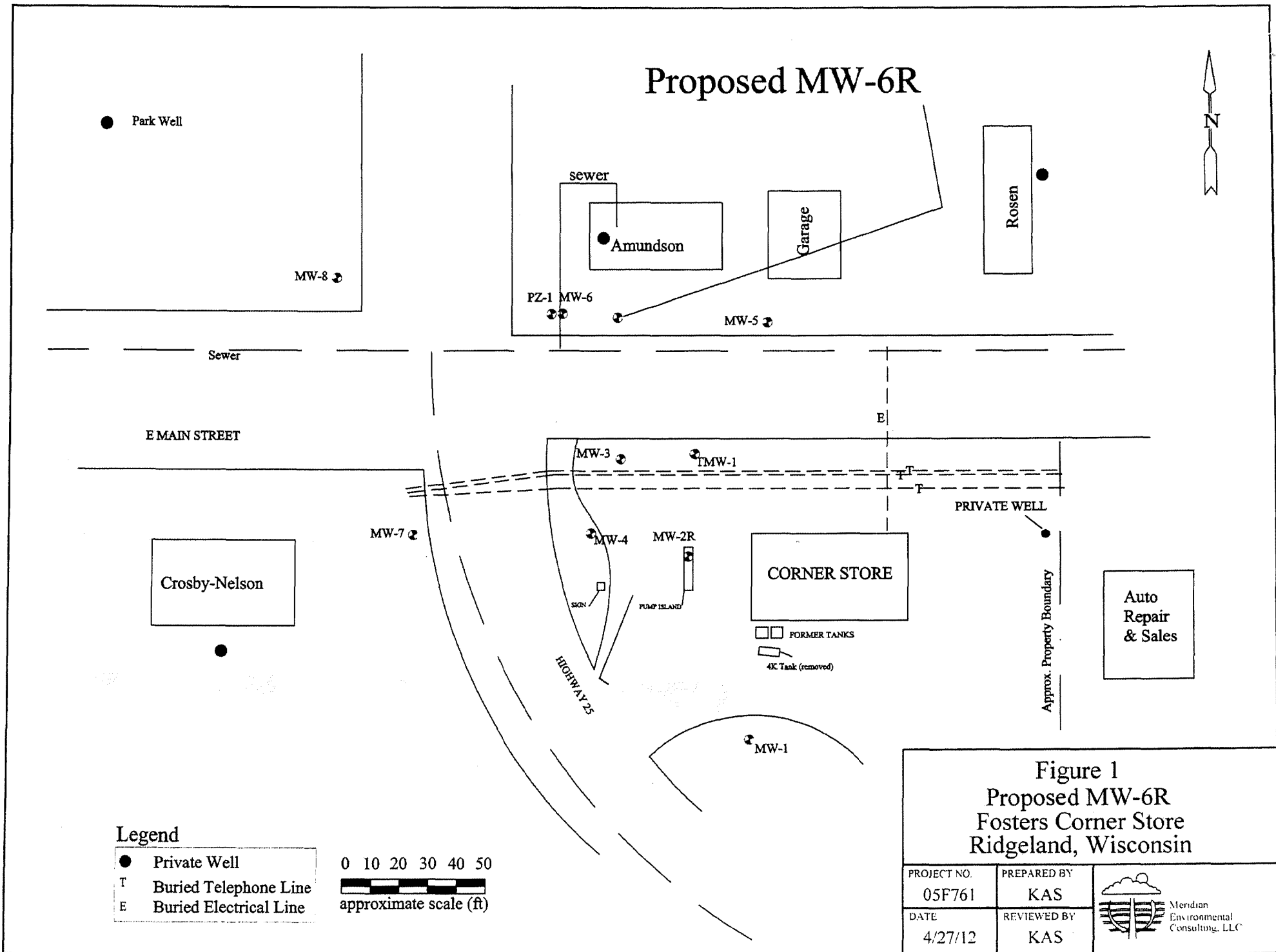

# Proposed MW-6R



● Park Well

sewer

● Amundson

Garage

● Rosen

MW-8 ↻

PZ-1 MW-6

MW-5 ↻

Sewer

E MAIN STREET

E

MW-3

MW-1

PRIVATE WELL

MW-7 ↻

MW-4

MW-2R

CORNER STORE

Crosby-Nelson

Auto Repair & Sales

HIGHWAY 25

SIGN

PUMP ISLAND

FORMER TANKS

4K Tank (removed)

Approx. Property Boundary

MW-1

### Legend

- Private Well
- T Buried Telephone Line
- E Buried Electrical Line

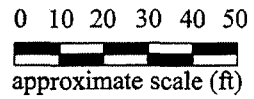



Figure 1  
Proposed MW-6R  
Fosters Corner Store  
Ridgeland, Wisconsin

PROJECT NO. 05F761	PREPARED BY KAS	 Mendian Environmental Consulting, LLC
DATE 4/27/12	REVIEWED BY KAS	

# Usual and Customary Standardized Invoice #14

## July 2013 - December 2013



RR-952A

PECFA #: 54763-9623-02  
 BRRT's #: 03-17-223007  
 Site Name: Corner Store  
 Site Address: 100 Tonnar St., Ridgeland

Vendor Name: Change Order  
 Invoice #: Change Order  
 Invoice Date: October 2013  
 Check #: Change Order

9476.40

U&C Total \$ 8,486.60  
 Variance to U&C Total \$ -  
 Grand Total \$ 8,486.60

TASK	TASK DESCRIPTION	SERVICES	ACTIVITY CODE	ACTIVITY REFERENCE CODE DESCRIPTION	UNIT	MAX UNIT COST	UNITS	TOTAL MAX
1	GW Sampling		GS05	Sample Collection	Well	\$ 69.00	26	\$ 1,794.00
1	GW Sampling		GS10	Incremental Sample Collection (natural attenuation)	Well	\$ 45.40		\$ -
1	GW Sampling		GS15	Incremental Sample Collection (cadmium & lead)	Well	\$ 25.00		\$ -
1	GW Sampling		GS20	Measure Water Levels (for wells not being sampled)	Well	\$ 14.00	10	\$ 140.00
1	GW Sampling		GS25	Primary Mob/Demob	Site	\$ 598.20	3	\$ 1,794.60
1	GW Sampling		GS30	Temporary Well Abandonment	Well	\$ 25.70		\$ -
4	Waste Disposal	Consultant	WD05	Consultant Coordination	Site	\$ 130.60	1	\$ 130.60
4	Waste Disposal	Commodity	WD10	GW Sample and/or Purge	Drum	\$ 40.10	2	\$ 80.20
4	Waste Disposal	Commodity	WD15	Drill Cuttings	Drum	\$ 103.00	2	\$ 206.00
4	Waste Disposal	Commodity	WD17	Landfill Environmental Fee (provide documentation)	ACTUAL COST	ACTUAL COST		
4	Waste Disposal	Commodity	WD20	Free Product	Drum	\$ 113.10		\$ -
4	Waste Disposal	Commodity	WD25	Primary Mob/Demob (Mob 1: water, Mob 2: soil)	Site	\$ 274.00	2	\$ 548.00
6	Letter Report/Addendum		LRA05	Letter Report/Addendum	Letter	\$ 989.80		\$ → 989.90
10	Initial Site Survey	Consultant	IS10	Subsequent Surveys	Well	\$ 104.90	1	\$ 104.90
13.b	Drilling In Unconsolidated Soils - Without Soil And/Or GW Sampling	Consultant	DR25	Consultant Oversight	Ft	\$ 1.50	15	\$ 22.50
13.b	Drilling In Unconsolidated Soils - Without Soil And/Or GW Sampling	Consultant	DR30	Primary Mob/Demob	Site	\$ 481.10	1	\$ 481.10
13.e	Drilling In Unconsolidated Soils - Without Soil And/Or GW Sampling	Commodity	DR60	Drilling in Unconsolidated Soils	Ft	\$ 11.40	15	\$ 171.00
14	Monitoring Well Installation	Consultant	MWI05	0 - 25 ft bgs	Ft	\$ 3.70	15	\$ 55.50
14	Monitoring Well Installation	Commodity	MWI15	2 inch PVC Casing	Ft	\$ 15.90	15	\$ 238.50
14	Monitoring Well Installation	Commodity	MWI20	Well Development	Well	\$ 140.60	1	\$ 140.60
15	Misc. Drilling Activities & Supplies		MDT05	Drill Rig Mob/Demob	Mob/Demob	\$ 917.50	1	\$ 917.50
15	Misc. Drilling Activities & Supplies		MDT10	Well Cover/flushmount	Each	\$ 193.00	1	\$ 193.00
15	Misc. Drilling Activities & Supplies		MDT41	Private Utility Locate	Each	\$ 111.60	1	\$ 111.60
15	Misc. Drilling Activities & Supplies		MDT45	Padlocks	Each	\$ 7.60	1	\$ 7.60
20	Soil Boring/Monitoring Well Permits		SBMWP05	Soil Boring/Monitoring Well Permit - Village	Permit	\$ 234.40	1	\$ 234.40
20	Soil Boring/Monitoring Well Permits		SBMWP10	Permit Fee (copy of permit & fee receipt required)	Permit Fee	Permit Fee		
33	Schedule Of Laboratory Maximums	Commodity		Laboratory (see task 33 total on Lab Schedule)	Lab Schedule		26	\$ 751.40
36	Change Order Request		COR05	Change Order Request (cost cap exceedance requests)	Change Order	\$ 363.60	1	\$ 363.60

Variance  
 Variance

# Usual and Customary Standardized Invoice #14

## July 2013 - December 2013



RR-952A

MATRIX	REF CODE	REIMBURSABLE ANALYTE	UNITS	MAX COST	SAMPLES	TOTAL			
AIR	A1	Benzene	SAMPLE	\$ 42.80		\$ -			
AIR	A2	BETX	SAMPLE	\$ 47.10		\$ -			
AIR	A3	GRO	SAMPLE	\$ 43.90		\$ -			
AIR	A4	VOC's	SAMPLE	\$ 68.50		\$ -			
WATER	W1	GRO/PVOC	SAMPLE	\$ 27.80		\$ -			
WATER	W2	PVOC	SAMPLE	\$ 25.70		\$ -			
WATER	W3	PVOC + 1,2 DCA	SAMPLE	\$ 41.70		\$ -			
WATER	W4	PVOC + Naphthalene	SAMPLE	\$ 28.90	26	\$ 751.40			
WATER	W5	VOC	SAMPLE	\$ 68.50		\$ -			
WATER	W6	PAH	SAMPLE	\$ 69.50		\$ -			
WATER	W7	Lead	SAMPLE	\$ 11.80		\$ -			
WATER	W8	Cadmium	SAMPLE	\$ 12.90		\$ -			
WATER	W9	Hardness	SAMPLE	\$ 11.80		\$ -			
WATER	W10	BOD, Total	SAMPLE	\$ 22.50		\$ -			
WATER	W11	Nitrate	SAMPLE	\$ 10.70		\$ -			
WATER	W12	Total Kjeldahl	SAMPLE	\$ 19.30		\$ -			
WATER	W13	Ammonia	SAMPLE	\$ 16.10		\$ -			
WATER	W14	Sulfate	SAMPLE	\$ 9.70		\$ -			
WATER	W15	Iron	SAMPLE	\$ 9.70		\$ -			
WATER	W16	Manganese	SAMPLE	\$ 9.70		\$ -			
WATER	W17	Alkalinity	SAMPLE	\$ 9.70		\$ -			
WATER	W18	methane	SAMPLE	\$ 43.90		\$ -			
WATER	W19	Phosphorous	SAMPLE	\$ 17.20		\$ -			
WATER	W20	VOC Method 524.2	SAMPLE	\$ 167.90		\$ -			
WATER	W21	EDB Method 504	SAMPLE	\$ 90.90		\$ -	MAX COST	SAMPLES	TOTAL
SOILS	S1	GRO	SAMPLE	\$ 23.60		\$ -	\$ 23.60		\$ -
SOILS	S2	DRO	SAMPLE	\$ 28.90		\$ -	\$ 28.90		\$ -
SOILS	S3	GRO/PVOC	SAMPLE	\$ 26.80		\$ -	\$ 26.80		\$ -
SOILS	S4	PVOC	SAMPLE	\$ 24.60		\$ -	\$ 24.60		\$ -
SOILS	S5	PVOC + 1,2 DCA + Naphthalene	SAMPLE	\$ 47.10		\$ -	\$ 47.10		\$ -
SOILS	S6	PVOC + Naphthalene	SAMPLE	\$ 34.30		\$ -	\$ 34.30		\$ -
SOILS	S7	VOC	SAMPLE	\$ 68.50		\$ -	\$ 68.50		\$ -
SOILS	S8	SPLP Extraction VOC only	SAMPLE	\$ 48.20		\$ -	\$ 48.20		\$ -
SOILS	S9	PAH	SAMPLE	\$ 69.50		\$ -	\$ 69.50		\$ -
SOILS	S10	Lead	SAMPLE	\$ 11.80		\$ -	\$ 11.80		\$ -
SOILS	S11	Cadmium	SAMPLE	\$ 13.90		\$ -			
SOILS	S12	Free Liquid	SAMPLE	\$ 10.70		\$ -			
SOILS	S13	Flash Point	SAMPLE	\$ 24.60		\$ -			
SOILS	S14	Grain Size - dry	SAMPLE	\$ 40.70		\$ -			
SOILS	S15	Grain Size - wet	SAMPLE	\$ 54.60		\$ -			
SOILS	S16	Bulk Density	SAMPLE	\$ 12.90		\$ -			
SOILS	S17	Permeability	SAMPLE	\$ 39.60		\$ -			
SOILS	S18	Nitrogen as Total Kjeldahl	SAMPLE	\$ 19.30		\$ -			
SOILS	S19	Nitrogen as Ammonia	SAMPLE	\$ 16.10		\$ -			
SOILS	S20	% Organic Matter	SAMPLE	\$ 27.80		\$ -			
SOILS	S21	TOC as NPOC	SAMPLE	\$ 54.60		\$ -			
SOILS	S22	Soil Moisture Content	SAMPLE	\$ 6.50		\$ -			
SOILS	S23	Air Filled Porosity	SAMPLE	\$ 24.60		\$ -			
SOILS	S24	% Total Solids	SAMPLE	\$ 6.50		\$ -			
SOILS	S25	Field Capacity	SAMPLE	\$ 26.80		\$ -			
SOILS	S26	TCLP Lead	SAMPLE	\$ 79.20		\$ -			
SOILS	S27	Cation Exchange (Ca, MG, & K)	SAMPLE	\$ 25.70		\$ -			
SOILS	S28	TCLP Cadmium	SAMPLE	\$ 79.20		\$ -			
SOILS	S29	TCLP Benzene	SAMPLE	\$ 79.20		\$ -			
		Viscosity + Density							
LNAPL	LFPS01	Interfacial tension I (LNAPL/water [dyne/cm])	SAMPLE	\$ 534.60		\$ -			
		Interfacial tension II (LNAPL/air [dyne/cm])							
		Interfacial tension III (water/air [dyne/cm])							