

## Meridian Environmental Consulting, LLC

---

---

April 19, 2019

Pat Collins  
Wisconsin Department of Natural Resources  
890 Spruce St.  
Baldwin, Wisconsin 54002

Subject:       **Change Order: Monitoring Well Abandonment**  
Gerry's Corner Store  
100 Tonnar St (Hwy. 25)  
Ridgeland, Wisconsin  
BRRTS No. 03-17-223007  
PECFA No. 54763-9623-02  
Meridian No. 05F761

### Scope of Work:

Abandon monitoring wells (see enclosed figure).

<u>Well</u>	<u>Depth (ft)</u>
MW-1	15
MW-2R	14
MW-3	15
MW-4	15
MW-5	14
MW-6R	14
MW-8	14
PZ-1	30
TMW-1	15
<u>Total:</u>	131 (TMW-1 footage not included – use GS30)

**Usual & Customary Spreadsheet attached.**

Sincerely,  
**MERIDIAN ENVIRONMENTAL CONSULTING, LLC**

  
Kenneth Shimko, PG  
Project Manager

# Usual and Customary Standardized Invoice #25

## January 2019 - June 2019 (updated 2/25/19)



RR-107a

PECFA #: 54763-9623-02  
 BRRTS #: 03-17-223007  
 Site Name: Gerry's Corner Store  
 Site Address: Ridgeland

Vendor Name: Change Order  
 Invoice #: Change Order  
 Invoice Date: April 2019  
 Check #: Change Order

U&C Total \$ 1,354.33  
 Variance to U&C Total \$ -  
 Grand Total \$ 1,354.33

TASK	TASK DESCRIPTION	SERVICES	ACTIVITY CODE	ACTIVITY REFERENCE CODE DESCRIPTION	UNIT	MAX UNIT COST	UNITS	TOTAL MAX
1	GW Sampling		GS30	Temporary Well Abandonment	Well	\$ 26.99	1	\$ 26.99
8	Well Abandonment	Consultant	WAB05	Coordination	Site	\$ 162.86	1	\$ 162.86
8	Well Abandonment	Consultant	WAB10	Water column < 30 ft	Ft	\$ 2.52	131	\$ 330.12
8	Well Abandonment	Consultant	WAB20	Bentonite Pellets (50lb bag - 1/4" pellet)	Bag	\$ 10.82	5	\$ 54.10
8	Well Abandonment	Consultant	WAB30	Primary Mob/Demob	Site	\$ 398.48	1	\$ 398.48
36	Change Order Request		COR05	Change Order Request (cost cap exceedance requests)	Change Order	\$ 381.78	1	\$ 381.78

Variance  
 Variance

# All Monitoring Wells will be abandoned

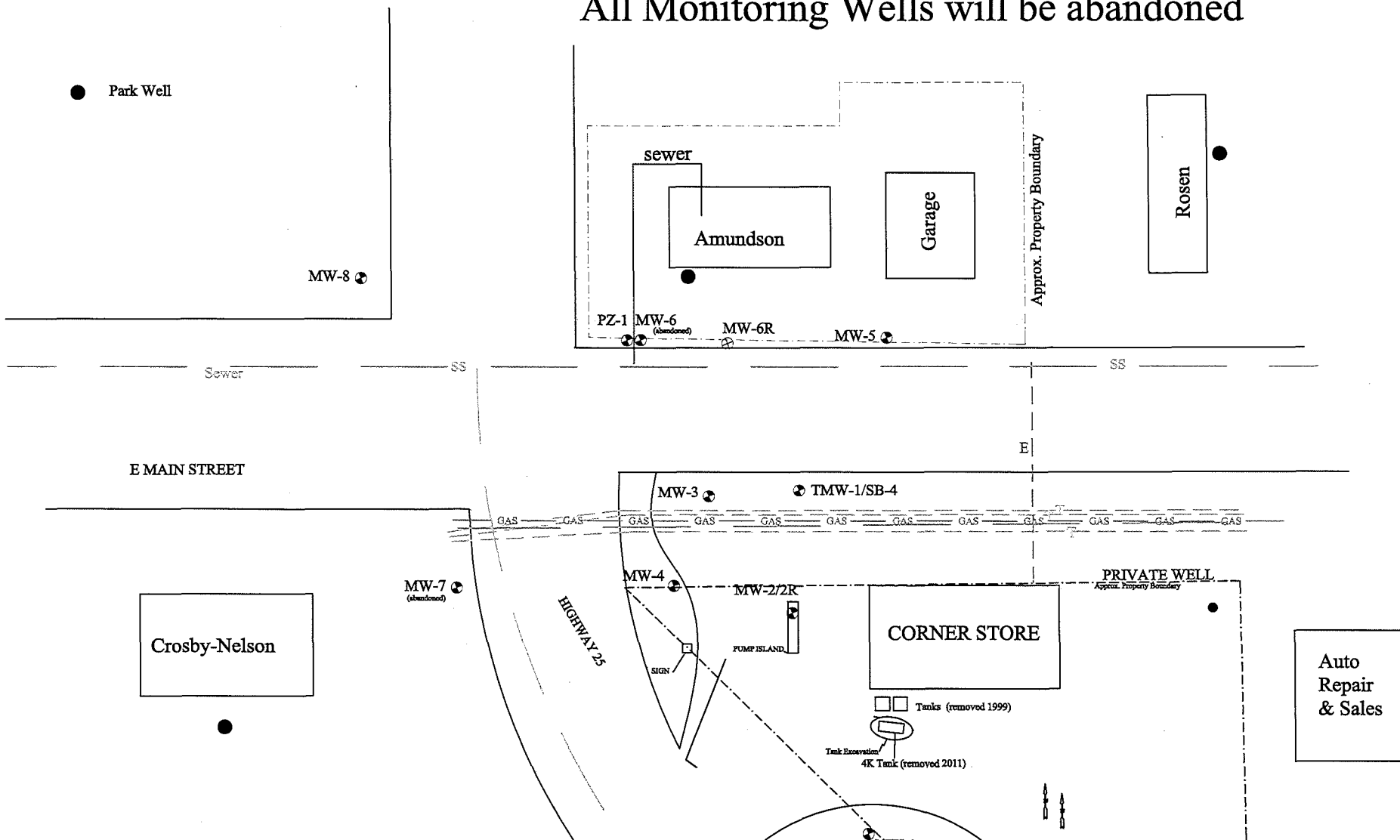

### Legend

- Private Well
- T Buried Telephone Line
- E Buried Electrical Line
- GAS Buried GAS Line

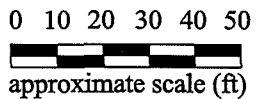



Figure B.3.d  
Monitoring Wells  
Gerry's Corner Store  
Ridgeland, Wisconsin

PROJECT NO. 05F761	PREPARED BY KAS	 Meridian Environmental Consulting, LLC
DATE 2/15/18	REVIEWED BY KAS	