

GRCRS Package Cover Sheet

Site Name FOOD TREE

Site Address 1759 Greenfield Ave., WI RAPIDS

BRRTS # 03-72-000555 Date of Closure Decision 4/8/99

Closure letter(s)

Groundwater Use Restriction/Warranty Deed

Yes/No Off-site contamination present? (Include related documents)

Yes/No Right-of-way contamination present? (Include related documents)

General location map

535116.0000000 GPS x-coordinate

440175.2500000 GPS y-coordinate

Detailed site map(s)

Groundwater flow map(s)

____ Latest map(s) showing extent or outline of plume

Latest table(s) of analytical results (soil results included only if soil deed restriction is incorporated into groundwater use restriction document)

If available:

____ Legal description

17 0058 2 AE Wood
County and Parcel I.D./Tax Parcel No.

Geologic cross sections

____ Isoconcentrations map(s)

Handwritten notes:
17 0058 2 AE
Parcel 17 0058 2 AE
posted to

GROUNDWATER USE RESTRICTION AND DEED RESTRICTION

LOT 1 CSM 1333

859165

Document No.

REGISTER OF DEEDS WOOD COUNTY RECORDED ON

02-21-2000 1:47 PM

RENE' L KRAUSE REGISTER OF DEEDS

Rene L Krause

REC. FEE 16.00
TRAN. FEE:
PAGES: 4

Declaration of Restrictions

In Re: Lot 1 of Wood County Certified Survey Map No. 1333, as recorded in Volume 5 of Surveys, page 133, being part of the Northeast 1/4 of the Northeast 1/4 of Section 32, Township 23 North, Range 6 East, in the Town of Rudolph, Wood County, Wisconsin.

This Space Reserved for Recording Data

STATE OF WISCONSIN)
) ss
COUNTY OF WOOD)

Name and Return Address
James C. Noonan, Atty at Law
5541 Highway 10 East, Suite C
Stevens Point, WI 54481

1600P

17-00582AE

PARCEL IDENTIFICATION NUMBER

WHEREAS, one or more petroleum compound discharges have occurred at this property. Benzene contaminated groundwater above ch. NR 140, Wis. Adm. Code, enforcement standards may exist on this property at the following location: Potable well located on the above-described property located 35 feet east of Greenfield Avenue (that portion of Greenfield Avenue that runs northeast to southwest) and 90 feet south of Greenfield Avenue (that portion of Greenfield Avenue that runs west to east). Benzene was detected in the potable well at concentrations of 180 micrograms per liter (ug/l) on November 8, 1994, <0.70 ug/l on August 16, 1995, and 0.46 ug/l on June 16, 1998. Attached to this groundwater use restriction is Exhibit 1, hereby made a part of this document, which shows the groundwater benzene distribution.

WHEREAS, benzene contaminated soil remained on the property described above as shown on Exhibit 2, hereby made a part of this document, at the end of 1999.

WHEREAS, it is the desire and intention of the property owners to impose on the property restrictions which will make it unnecessary to conduct additional soil or groundwater remediation activities on the property at the present time.

WHEREAS, natural attenuation has been approved by the Wisconsin Department of Natural Resources to remediate groundwater exceeding ch. NR 140, Wis. Adm. Code, groundwater standards within the boundaries of this property.

WHEREAS, construction of wells where the water quality exceeds the drinking water standards in ch. NR 809, Wis. Adm. Code, is restricted by ch. NR 811 and ch. NR 812, Wis. Adm. Code. Special well construction standards or water treatment requirements, or both, or well construction prohibitions may apply.

NOW, THEREFORE, the owner hereby declares that all of the property described above is held and shall be held, conveyed or encumbered, lease, rented, used, occupied and improved subject to the following limitations and restrictions:

- a. Anyone who proposes to construct or reconstruct a well on this property is required to contact the Wisconsin Department of Natural Resources' Bureau of Drinking Water and Groundwater, or its successor agency, to determine what specific requirements are applicable, prior to constructing or reconstructing a well on this property. No well may be constructed or reconstructed on this property unless applicable requirements are met.

- b. If construction is proposed on this property that will require dewatering, or if groundwater is to be otherwise extracted from this property, while this groundwater use restriction is in effect, the groundwater shall be sampled and analyzed for contaminants that were previously detected on the property and any extracted groundwater shall be managed in compliance with applicable statutes and rules.
- c. Existing pavement on the property described above serves as a cap or cover to address residual soil contamination. Exhibit 2, which is attached to, and hereby made a part of this document, shows the location of residual soil contamination. The owner of this property shall maintain and repair, as needed, the existing pavement on this property, unless the Wisconsin Department of Natural Resources or its successor or assign grants prior written approval for another proposed cap or cover to replace the pavement, or determines that a cap or cover is no longer necessary.
- d. The following activities are prohibited on that portion of the property that has residual soil contamination, as shown on Exhibit 2, unless prior written approval has been obtained from the Wisconsin Department of Natural Resources or its successor or assign: (1) Excavating or grading of the land surface; (2) Filling on the paved or capped area; (3) Plowing for agricultural cultivation; and (4) Construction or installation of a building or other structure with a foundation that would sit on or be placed within the pavement, cap or cover.

This restriction is hereby declared to be a covenant running with the land and shall be fully binding upon all persons acquiring the above-described property whether by descent, devise, purchase or otherwise. This restriction inures to the benefit of and is enforceable by the Wisconsin Department of Natural Resources, its successors and assigns. The Department, its successors or assigns, may initiate proceedings at law or in equity against any person or persons who violate or are proposing to violate this covenant, to prevent the proposed violation or to recover damages for such violation.

Any person who is or becomes owner of the property described above may request that the Wisconsin Department of Natural Resources or its successor issue a determination that the restrictions set forth in this covenant are no longer required. Upon receipt of such a request, the Wisconsin Department of Natural Resources shall determine whether or not the restrictions contained herein can be extinguished. If the Department determines that the restriction can be extinguished, an affidavit, with a copy of the Department's written determination, may be recorded to give notice that this groundwater use restriction is no longer binding.

IN WITNESS WHEREOF, the owners of the property have executed this Groundwater Use Restriction and Deed Restriction this 21st day of February, 2000.

Allen R. Weiland
Allen R. Weiland

Eva A. Weiland
Eva A. Weiland

Personally came before me this 21st day of February, 2000, the above-named Allen R. Weiland and Eva A. Weiland, to me known to be the persons who executed the foregoing instrument and acknowledged the same.

James C. Noonan JAMES C. NOONAN
Notary Public, Portage County, Wisconsin
My Commission is permanent

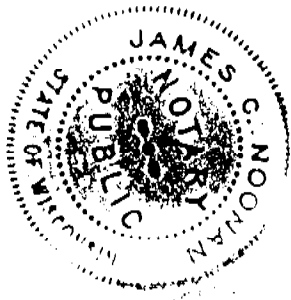

This document was drafted by the following person, based on comments from the Wisconsin Department of Natural Resources:

James C. Noonan, Atty. At Law
5541 Hwy. 10 East, Suite C
Stevens Point, WI 54481

STATE OF WISCONSIN

County of Wood } ss.

JUDY SCHILL

being duly sworn says that s/he is LEGAL CLERK of THE DAILY TRIBUNE, a public newspaper published in the city of Wisconsin Rapids, in said county; that a notice, of which the annexed is a copy, taken from said paper, has been regularly published in such newspaper, once in each week for one successive week(s).

First publication commencing on the 22nd day of February, 2000. The last publication being February 22, 2000

Judy Schill

Subscribed and sworn to this 22nd day of

February, A.D. 2000 before me.

Korinna Lindt

Commission expires October 27, 2002

Fee for Publication 67 lines \$35.27

Affidavit \$1.00 total \$36.27

PUBLIC NOTICE OF REMEDIAL ACTION

The Food Tree
1759 Greenfield Avenue
Wisc. Rapids, WI 54494

A performance standard has been selected to complete a remedial action at the Food Tree site located at 1759 Greenfield Avenue, Wisconsin Rapids, Wisconsin 54494. Soil contamination was identified during an underground storage tank upgrade. Remedial activities included the excavation of approximately 1,400 tons of petroleum contaminated soil and the operation of a soil vapor extraction system to address residual soil contamination remaining in place after excavation activities. Following these remedial activities, a small amount of residual soil contamination (<500 cubic yards) remains on-site. A health risk assessment performed on the residual contaminated soils determined that the surface soils do not pose a human health risk through direct contact. However, the Wisconsin Department of Natural Resources is requiring a performance standard be implemented to prevent the possibility of soil contaminants migrating into the groundwater. The selected performance standard is the asphalt paving of the land surface above the location of the residual soil contamination.

Responsible Party: Mr. Al Weiland
Contact Person: Mr. Jay Diebold, Envirogen, Inc.
P.O. Box 90, Pewaukee, WI 53072 (262) 549-6898

A copy of the remedial action plan can be reviewed at the Wisconsin Department of Natural Resources Wisconsin Rapids office located at 473 Griffith Avenue, Wisconsin Rapids, Wisconsin 54494. Phone (715) 421-7800.

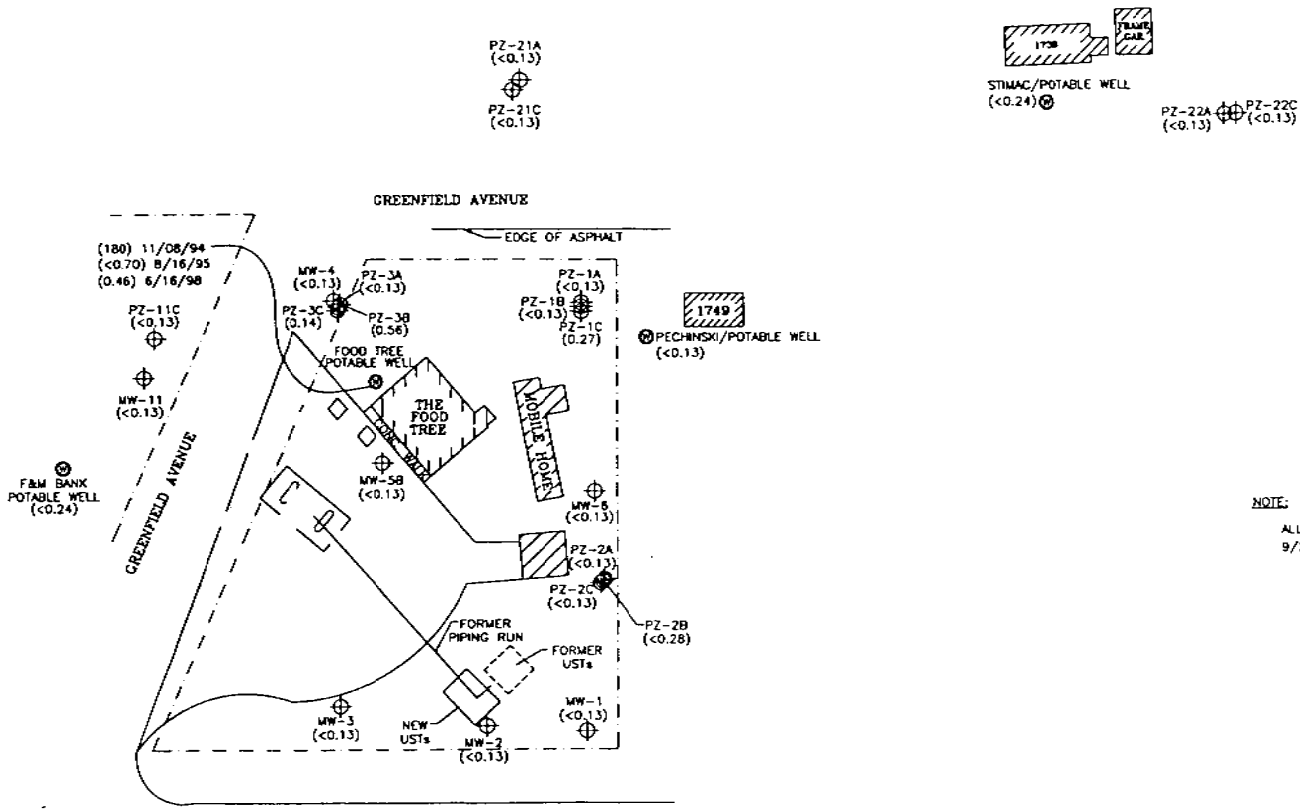
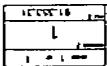

DATE PLOTTED: 11/11/99
 DRAWN BY: J. H. HENNING
 CHECKED BY: J. H. HENNING
 APPROVED BY: J. H. HENNING
 TITLE: GROUNDWATER BENZENE DISTRIBUTION

THE DATA DISCLOSED HEREIN IS NOT TO BE REPRODUCED OR DISCLOSED IN PART OR WHOLE TO ANYONE, WITHOUT THE PRIOR WRITTEN PERMISSION OF ENVIROGEN, INC.
 THIS DRAWING IS A VISUAL REPRESENTATION OF THE EQUIPMENT AND/OR SYSTEM PROPOSED. IT IS NOT INTENDED FOR CONSTRUCTION PURPOSES.

EXHIBIT 1



REV	DATE	DESCRIPTION OF REVISION	BY	CHKD
1	11/18/99			
2	11/23/99			
3	11/23/99			

THIS IS A COMPUTER GENERATED DRAWING AND ONLY EXIST CONSTRUCTION AND DIMENSIONS SHOWN. CAD FORMATS SHALL BE CONSIDERED VALID COPIES.

THE FOOD TREE SITE	
WISCONSIN RAPIDS, WISCONSIN	
Scale	1" = 1'
Sheet	1
Project	81-353-37

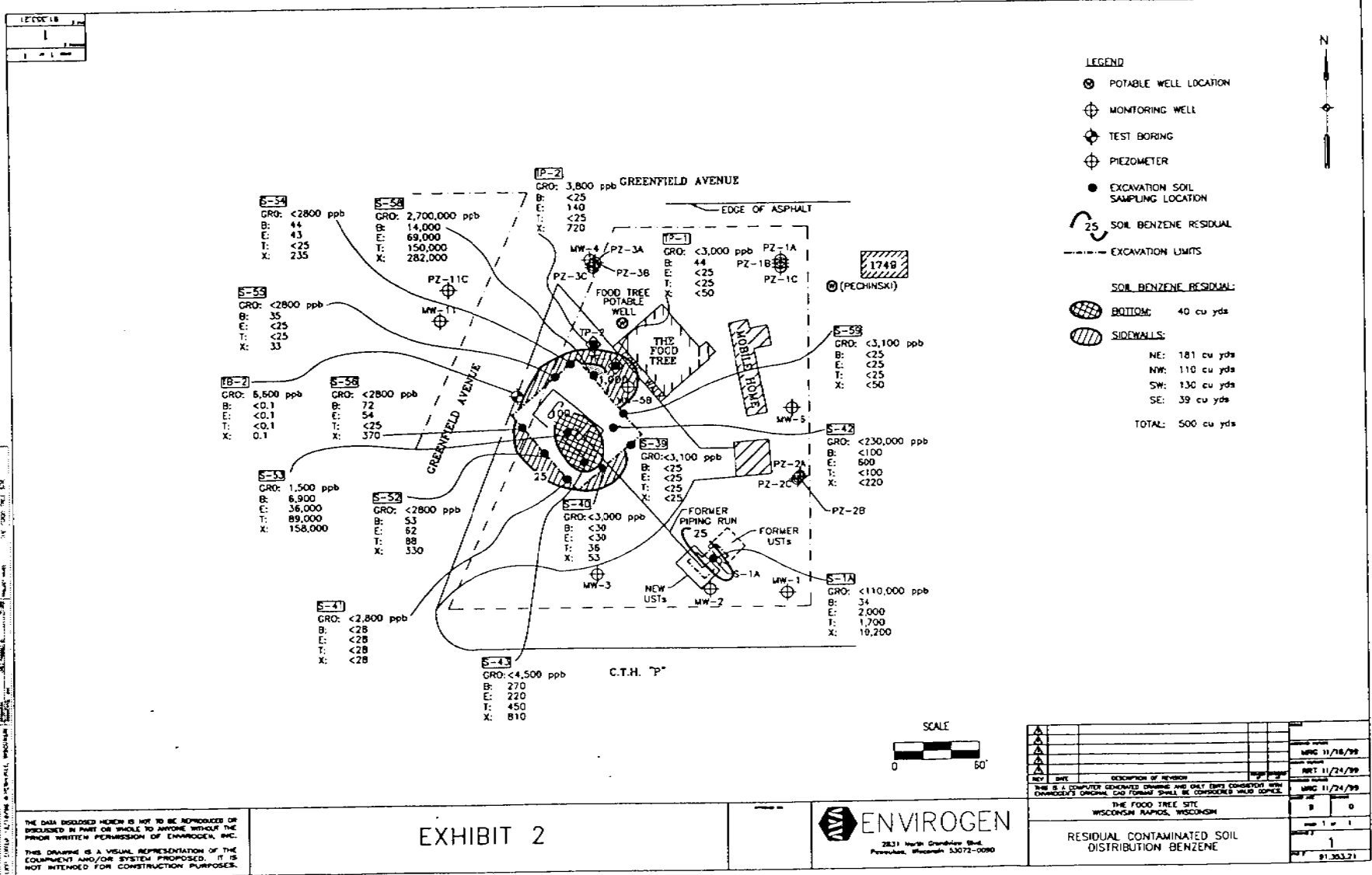

THE DATA DISCLOSED HEREIN IS NOT TO BE REPRODUCED OR DISCLOSED IN PART OR WHOLE TO ANYONE WITHOUT THE PRIOR WRITTEN PERMISSION OF ENVIROGEN, INC. THIS DRAWING IS A VISUAL REPRESENTATION OF THE EQUIPMENT AND/OR SYSTEM PROPOSED. IT IS NOT INTENDED FOR CONSTRUCTION PURPOSES.

EXHIBIT 2



REV	DATE	DESCRIPTION OF REVISION	BY	CHKD
1	11/16/99			
2	11/24/99			

NO. OF SHEETS	1
TOTAL SHEETS	1
DATE	11/24/99
PROJECT NO.	91-303-21

RESIDUAL CONTAMINATED SOIL DISTRIBUTION BENZENE

DRAWING NO. 91.353R21
 DRAWN BY: SAJ 8/12/93
 CHECKED BY: TMF 8/13/93
 APPROVED BY: J.S. M...
 M...

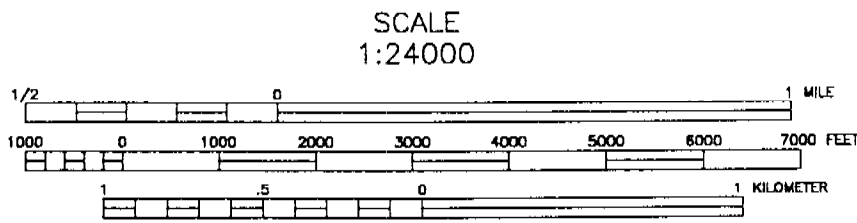
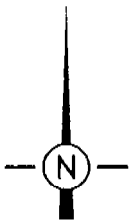
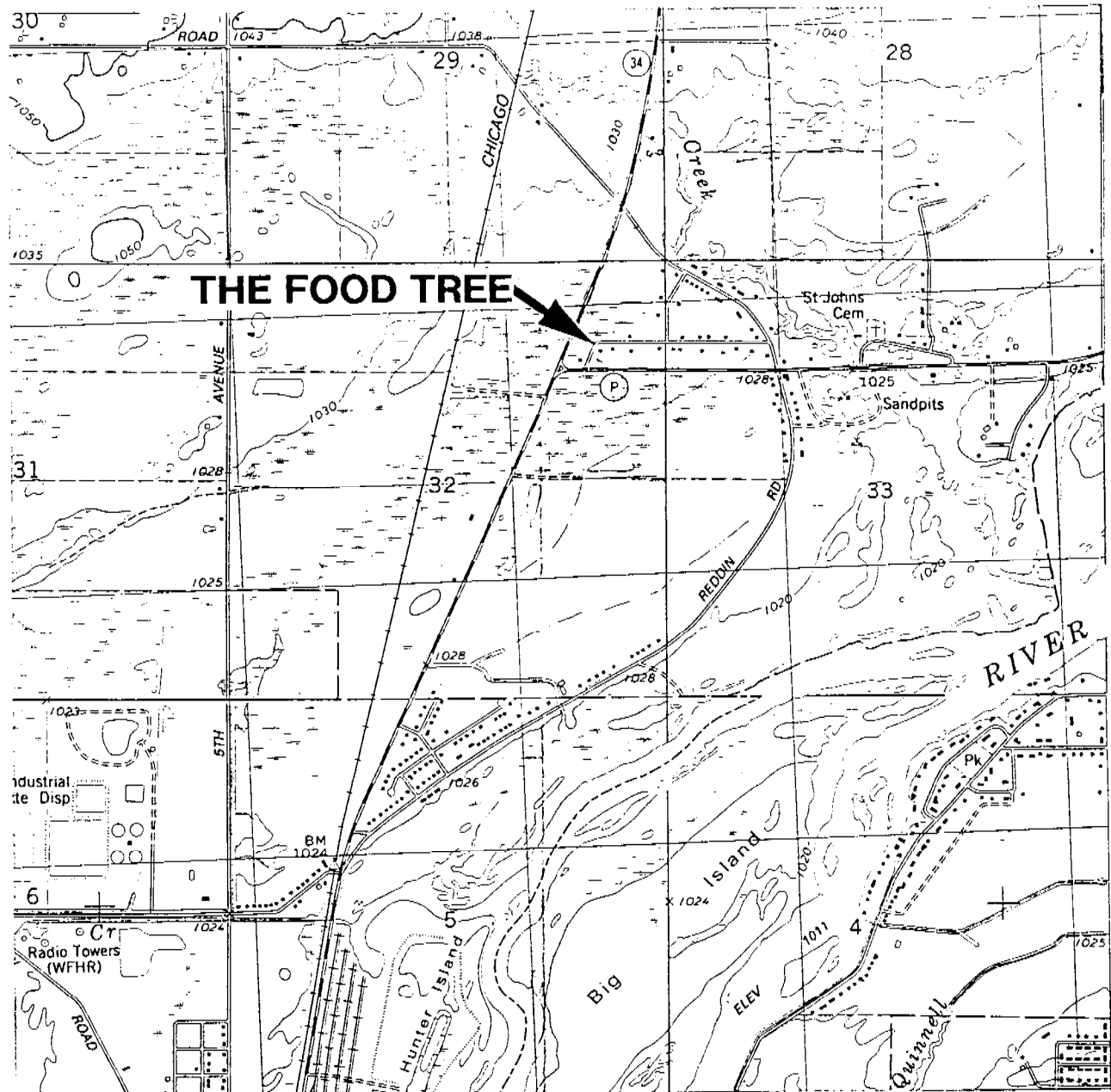

THE INTERPRETATIONS IN THIS FIGURE ARE BASED ON KNOWN POINTS IN TIME AND SPACE AND ARE INTEGRAL TO A WRITTEN REPORT AND SHOULD BE REVIEWED IN THAT CONTEXT.

CONTOUR INTERVAL 10 FEET

LOCATION

FIGURE 2.1
SITE LOCATION MAP
THE FOOD TREE
WISCONSIN RAPIDS, WISCONSIN



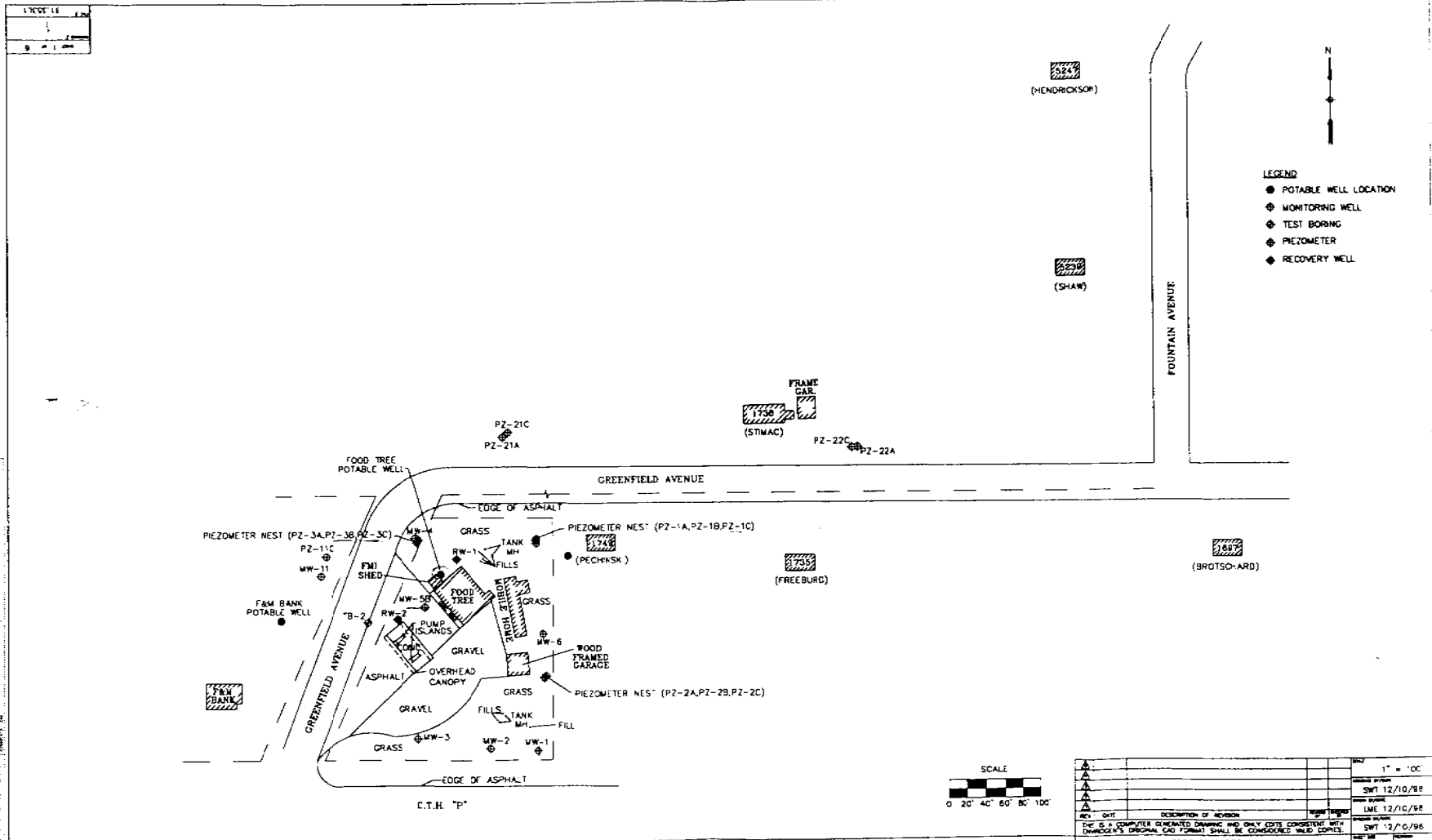

THE DATA DISCLOSED HEREIN IS NOT TO BE REPRODUCED OR DISCUSSED IN PART OR WHOLE TO ANYONE WITHOUT THE PRIOR WRITTEN PERMISSION OF ENVIROGEN, INC.
 THIS DRAWING IS A VISUAL REPRESENTATION OF THE EQUIPMENT AND/OR SYSTEM PROPOSED. IT IS NOT INTENDED FOR CONSTRUCTION PURPOSES.

ENVIROGEN
 2831 North Greenview Blvd.
 Pewaukee, Wisconsin 53072-5080

DATE	12/10/98	SCALE	1" = 100'
PROJECT	FOOD TREE SITE		
CLIENT	WISCONSIN RAPIDS, WISCONSIN		
DESIGNER	ENVIROGEN		
CHECKED BY	SWT 12/10/98		
APPROVED BY	SWT 12/10/98		
DATE	12/10/98		
PROJECT	FOOD TREE SITE		
CLIENT	WISCONSIN RAPIDS, WISCONSIN		
DESIGNER	ENVIROGEN		
CHECKED BY	SWT 12/10/98		
APPROVED BY	SWT 12/10/98		
DATE	12/10/98		
PROJECT	FOOD TREE SITE		
CLIENT	WISCONSIN RAPIDS, WISCONSIN		
DESIGNER	ENVIROGEN		
CHECKED BY	SWT 12/10/98		
APPROVED BY	SWT 12/10/98		
DATE	12/10/98		

SITE PLAN VIEW

1

PROJECT	NO.
2	
DATE	
12/10/98	

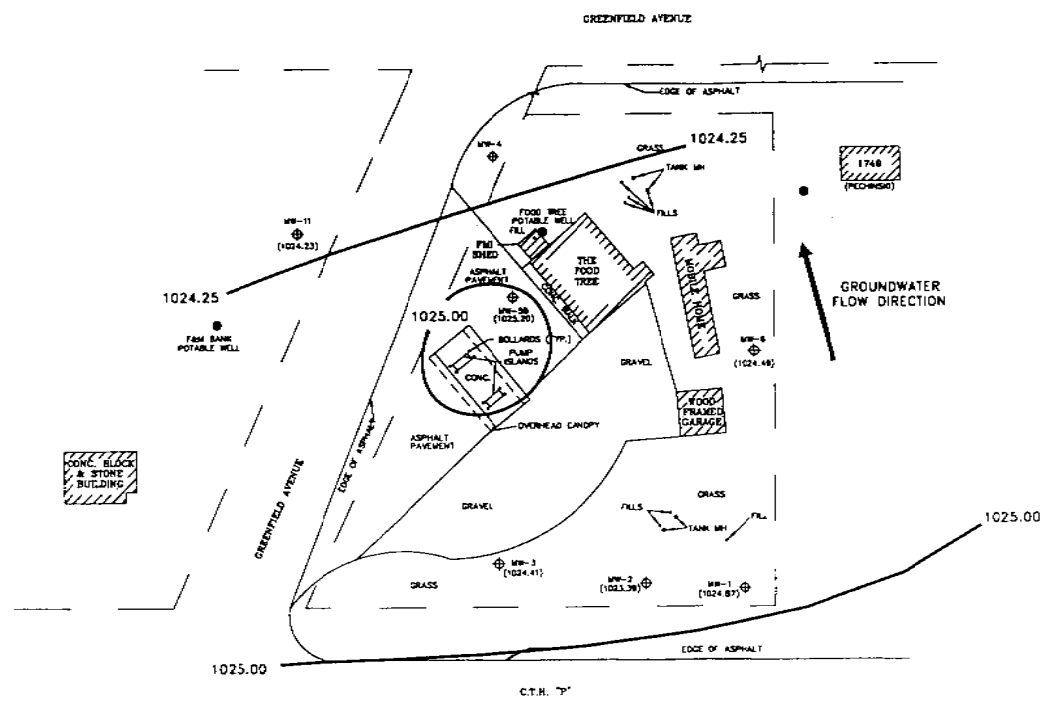

- LEGEND
- POTABLE WELL LOCATION
 - ⊕ MONITORING WELL
 - () ELEVATION IN FEET ABOVE MSL
 - 1025.00 ELEVATION CONTOUR

ALL RIGHTS RESERVED BY ENVIROGEN, INC. NO PART OF THIS DRAWING IS TO BE REPRODUCED OR TRANSMITTED IN ANY FORM OR BY ANY MEANS, ELECTRONIC OR MECHANICAL, INCLUDING PHOTOCOPYING, RECORDING, OR BY ANY INFORMATION STORAGE AND RETRIEVAL SYSTEM.

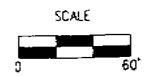

DATE	DESCRIPTION OF REVISION	BY	CHKD	DATE
THE B.C. COMPUTER GENERATED DRAWING AND ONLY EXIST CONFORMANCE WITH ENVIROGEN'S ORIGINAL CAD FORMAT SHALL BE CONSIDERED VALID.				
FOOD TREE SITE WISCONSIN RAPIDS, WISCONSIN				SHEET NO. 2 OF 6
POTENTIOMETRIC SURFACE MAP				DATE 91.353.2

THE DATA DISCLOSED HEREIN IS NOT TO BE REPRODUCED OR DISCLOSED IN PART OR WHOLE TO ANYONE WITHOUT THE PRIOR WRITTEN PERMISSION OF ENVIROGEN, INC.
 THIS DRAWING IS A VISUAL REPRESENTATION OF THE EQUIPMENT AND/OR SYSTEM PROPOSED. IT IS NOT INTENDED FOR CONSTRUCTION PURPOSES.

ENVIROGEN
 2831 North Cranmore Blvd.
 Pewaukee, Wisconsin 53072-0000

WEST 18
G
0 = 0

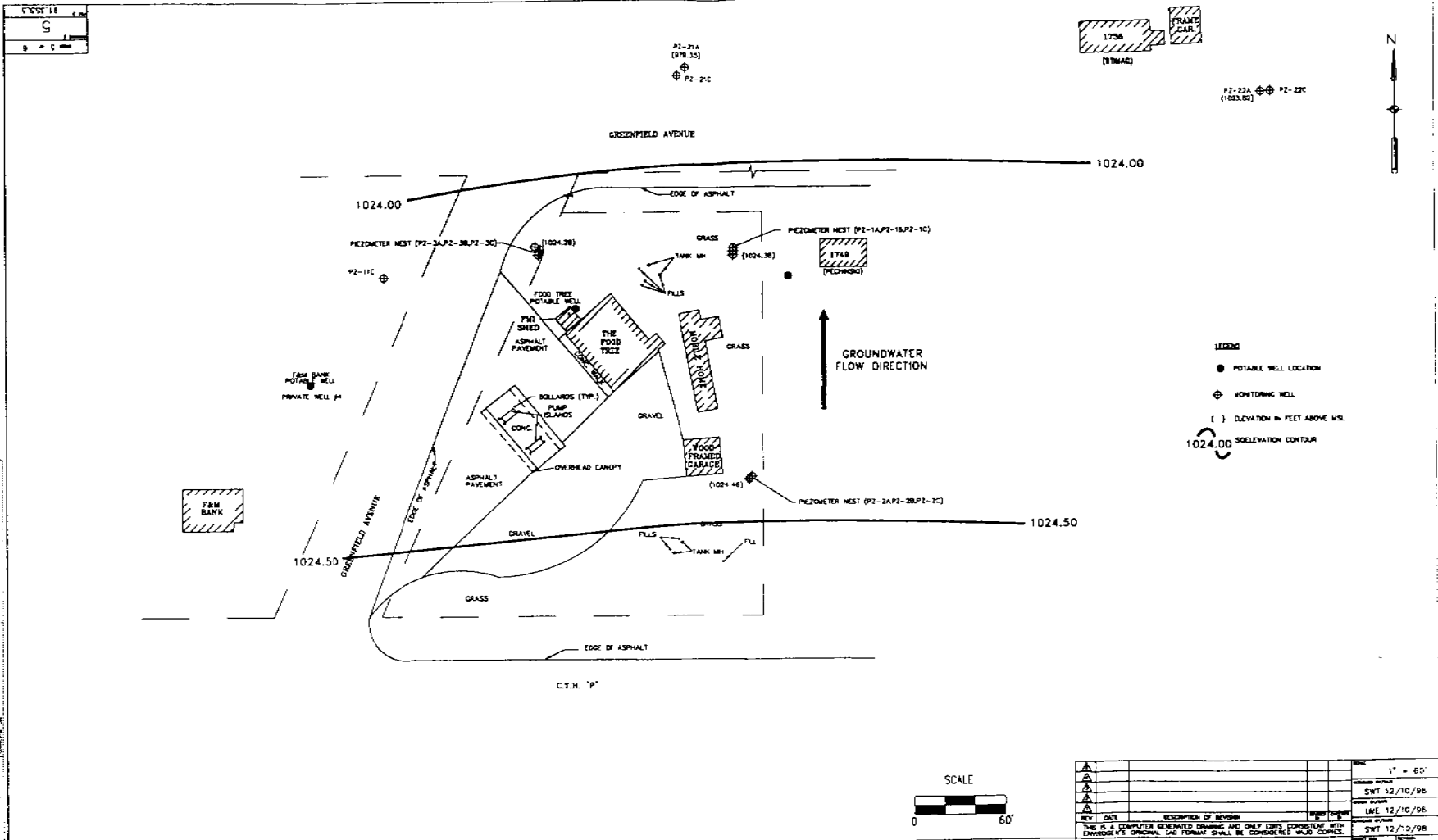

LAST REVISED 12/10/98 BY M.H.A. WISCONSIN PROJECT NO. 001000177
 FOOD TRUCK SITE

THE DATA DISCLOSED HEREIN IS NOT TO BE REPRODUCED OR DISCLOSED IN PART OR WHOLE TO ANYONE WITHOUT THE PRIOR WRITTEN PERMISSION OF ENVIROGEN, INC. THIS DRAWING IS A VISUAL REPRESENTATION OF THE EQUIPMENT AND/OR SYSTEM PROPOSED. IT IS NOT INTENDED FOR CONSTRUCTION PURPOSES.



ENVIROGEN
 283 North Granville Blvd.
 Pewaukee, Wisconsin 53072-0090

1				DATE	12/10/98
2				DATE	12/10/98
3				DATE	12/10/98
4				DATE	12/10/98
5				DATE	12/10/98
6				DATE	12/10/98
7				DATE	12/10/98
8				DATE	12/10/98
9				DATE	12/10/98
10				DATE	12/10/98
11				DATE	12/10/98
12				DATE	12/10/98
13				DATE	12/10/98
14				DATE	12/10/98
15				DATE	12/10/98
16				DATE	12/10/98
17				DATE	12/10/98
18				DATE	12/10/98
19				DATE	12/10/98
20				DATE	12/10/98
21				DATE	12/10/98
22				DATE	12/10/98
23				DATE	12/10/98
24				DATE	12/10/98
25				DATE	12/10/98
26				DATE	12/10/98
27				DATE	12/10/98
28				DATE	12/10/98
29				DATE	12/10/98
30				DATE	12/10/98

FOOD TREE SITE
 WISCONSIN RAPIDS, WISCONSIN
 POTENTIOMETRIC SURFACE MAP
 ("A" PIEZOMETERS 50-55 FEET)
 1" = 60'
 SWT 12/10/98
 LWE 12/10/98
 SWT 12/10/98
 5
 553.5

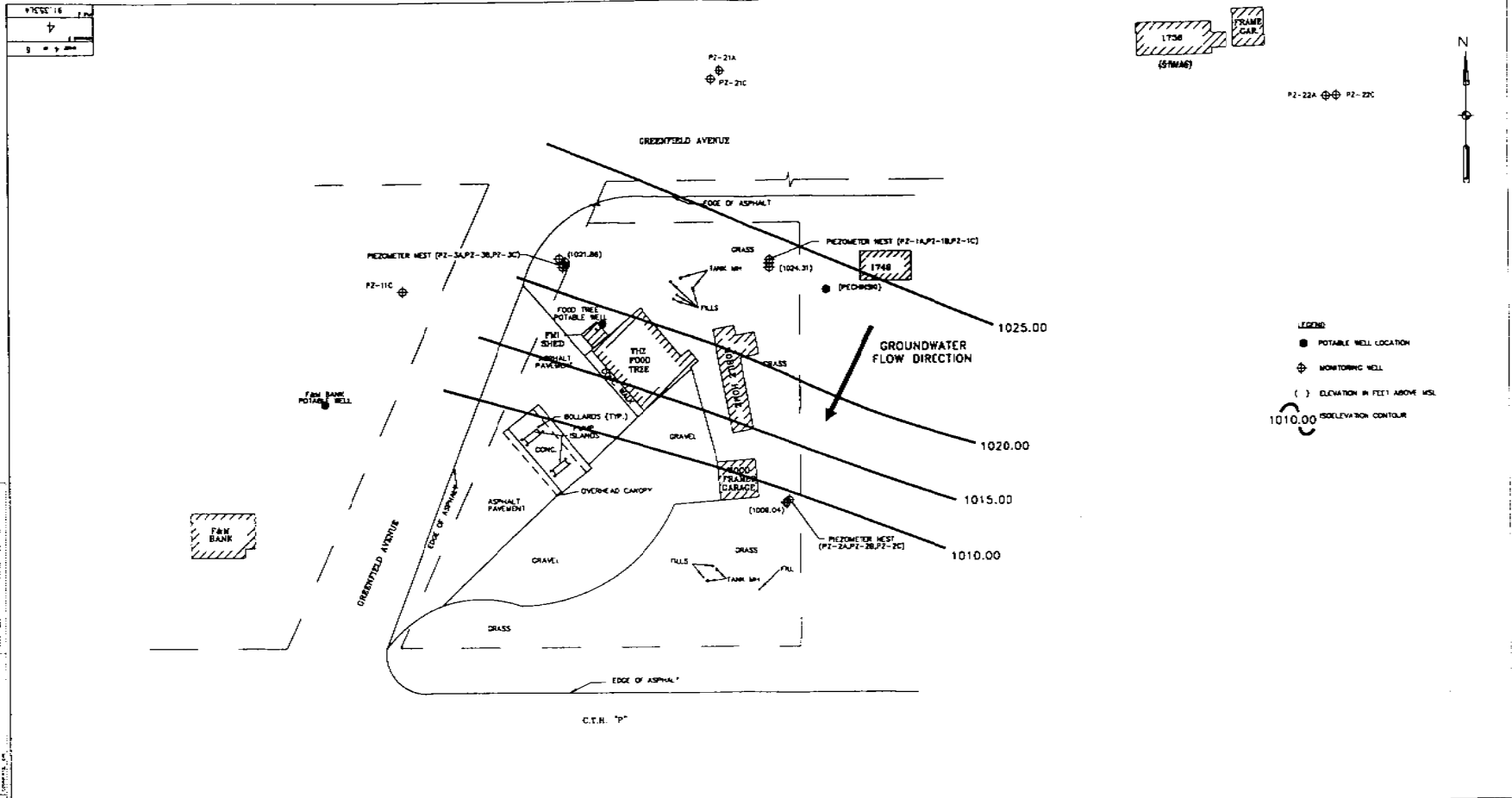
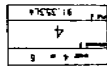

- LEGEND**
- POTABLE WELL LOCATION
 - ⊕ MONITORING WELL
 - () ELEVATION IN FEET ABOVE MSL
 - SOLE ELEVATION CONTOUR

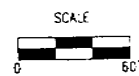

DATE	DESCRIPTION OF REVISION	BY	CHKD
12/10/98	SWT		
12/10/98	LWC		
12/10/98	SWT		
FOOD TREE SITE WISCONSIN RAPIDS, WISCONSIN			
POTENTIOMETRIC SURFACE MAP (7" PIEZOMETERS 35-40 FEET)		91.35314	

THE DATA DISCLOSED HEREIN IS NOT TO BE REPRODUCED OR DISCLOSED IN PART OR WHOLE TO ANYONE WITHOUT THE PRIOR WRITTEN PERMISSION OF ENVIROGEN, INC. THIS DRAWING IS A VISUAL REPRESENTATION OF THE EQUIPMENT AND/OR SYSTEM PROPOSED. IT IS NOT INTENDED FOR CONSTRUCTION PURPOSES.

ENVIROGEN
2831 North Grandview Blvd
Pewaukee, Wisconsin 53072-0090

SHEET NO.	3
DRAWING NO.	
DATE	12/10/98

1738
(STWAC)
FARM BUILDING

PZ-22A ⊕ PZ-22C
(1024.47)

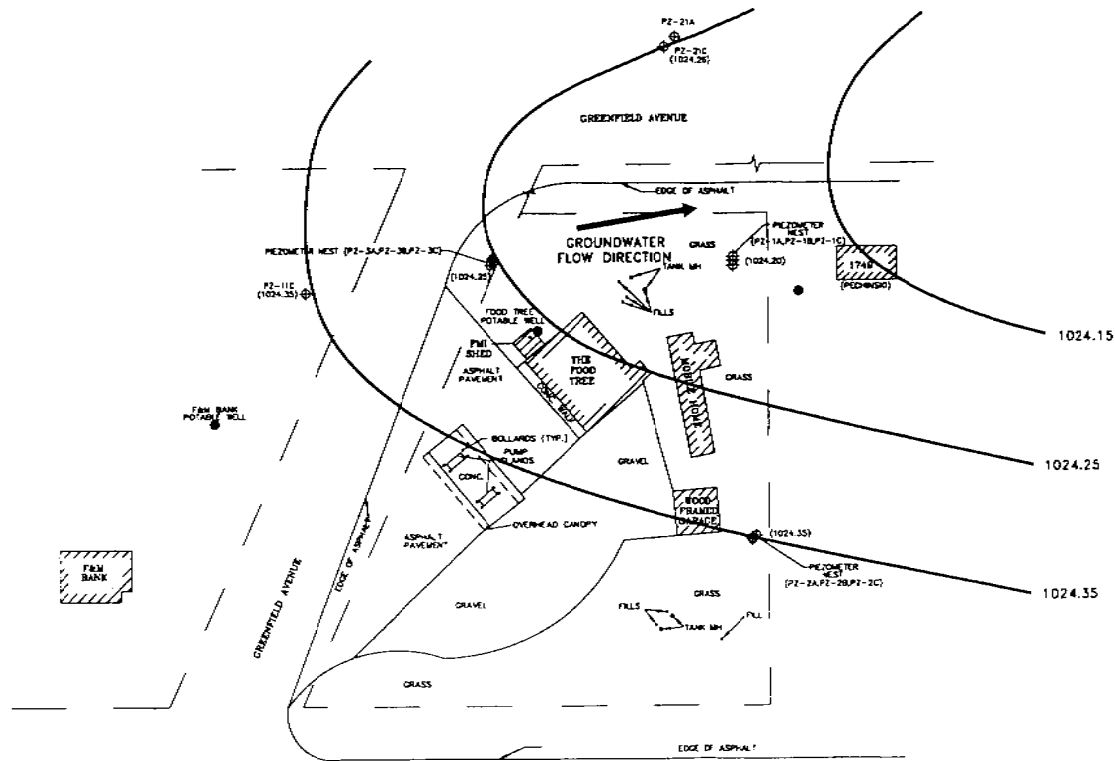

- LEGEND
- POTABLE WELL LOCATION
 - ⊕ PIEZOMETER
 - () ELEVATION IN FEET ABOVE MSL
 - ISOLELEVATION CONTOUR

C.T.H. 'P'

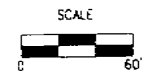

DATE	12/10/98	SCALE	1" = 60'
DRAWN BY	LME	DATE	12/10/98
CHECKED BY	LME	DATE	12/10/98
THIS IS A COMPUTER GENERATED DRAWING AND ONLY EXIST IN CONJUNCTION WITH DOWNSON'S ORIGINAL CAD FORMAT SHALL BE CONSIDERED VALID COPIES			
FOOD TREE SITE			
WISCONSIN RAPIDS WISCONSIN			
NO. OF SHEETS	3	TOTAL SHEETS	6
POTENTIOMETRIC SURFACE MAP ("C" PIEZOMETERS 20-25 FEET)			
DATE	12/10/98		
DRAWN BY	LME		
CHECKED BY	LME		
DATE	12/10/98		

THE DATA DISCLOSED HEREIN IS NOT TO BE REPRODUCED OR DISSEMINATED IN PART OR WHOLE TO ANYONE WITHOUT THE PRIOR WRITTEN PERMISSION OF ENVIROGEN, INC.
THIS DRAWING IS A VISUAL REPRESENTATION OF THE EQUIPMENT AND/OR SYSTEM PROPOSED. IT IS NOT INTENDED FOR CONSTRUCTION PURPOSES.



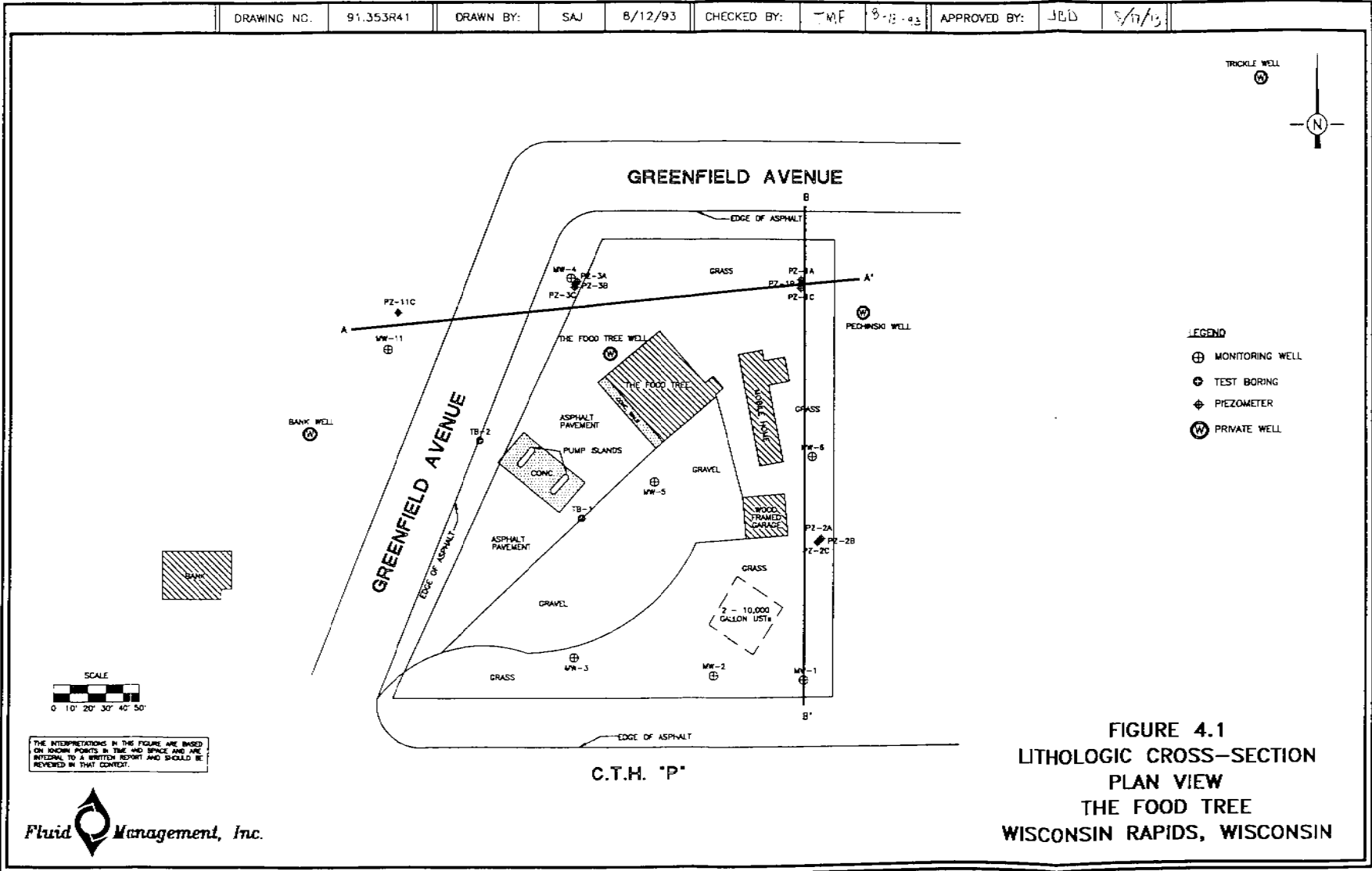

DRAWING NO.	91.353R42	DRAWN BY:	SAJ	8/13/93	CHECKED BY:	TSA	APPROVED BY:	JED	8/27/93
-------------	-----------	-----------	-----	---------	-------------	-----	--------------	-----	---------

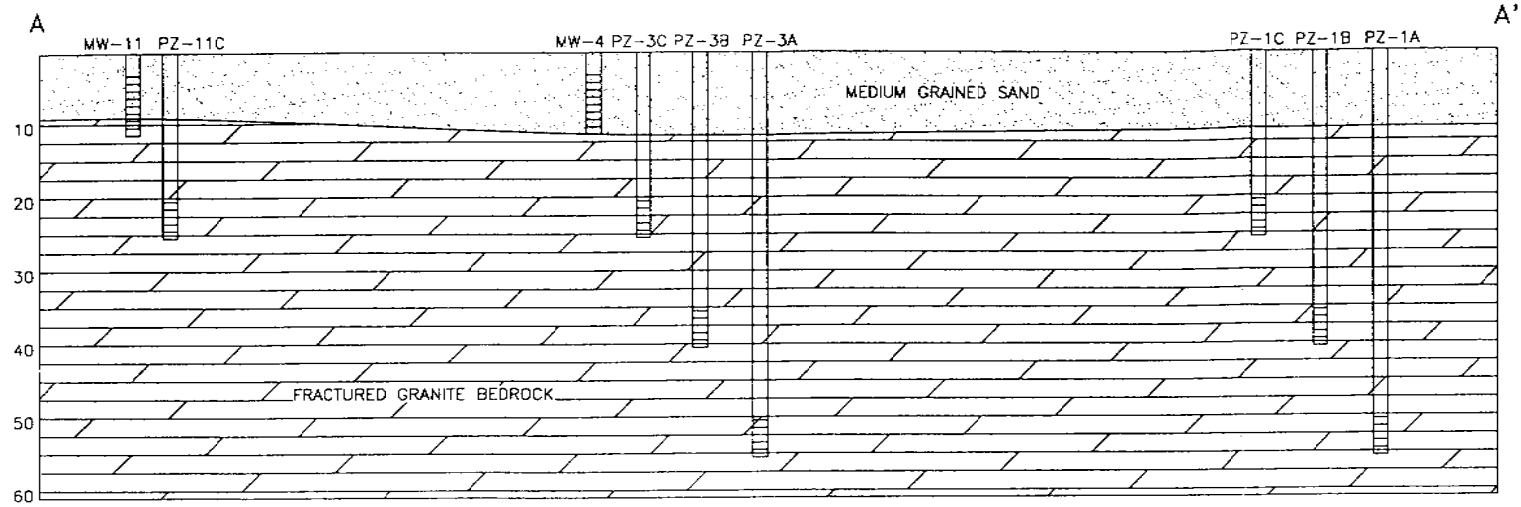

THE INTERPRETATIONS IN THIS FIGURE ARE BASED ON KNOWN POINTS IN THIS SPACE AND ARE INTEGRAL TO A WRITTEN REPORT AND SHOULD BE REVIEWED IN THAT CONTEXT.



FIGURE 4.2
LITHOLOGIC
CROSS-SECTION A-A'
THE FOOD TREE
WISCONSIN RAPIDS, WISCONSIN

DRAWING NO.	91.353R43	DRAWN BY	SAJ	8/13/93	CHECKED BY:		APPROVED BY:	
-------------	-----------	----------	-----	---------	-------------	--	--------------	--

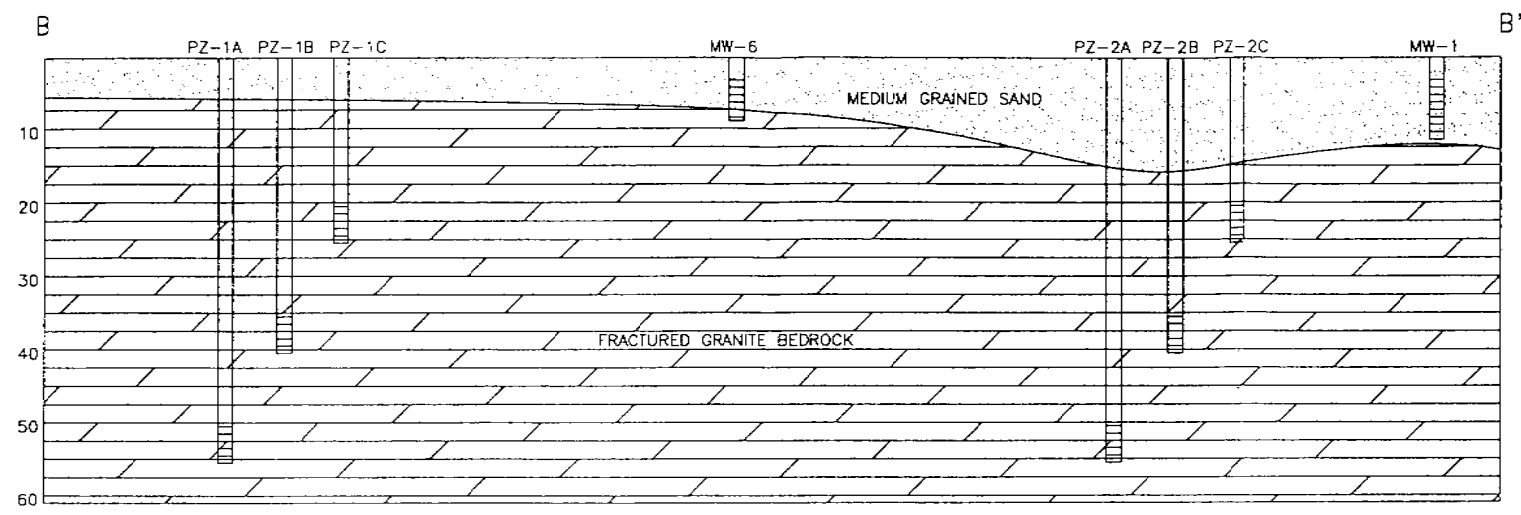

THE INTERPRETATIONS IN THIS FIGURE ARE BASED ON KNOWN POINTS IN TIME AND SPACE AND ARE INTEGRAL TO A WRITTEN REPORT AND SHOULD BE REVIEWED IN THAT CONTEXT.



FIGURE 4.3
LITHOLOGIC
CROSS-SECTION B-B'
THE FOOD TREE
WISCONSIN RAPIDS, WISCONSIN

TABLE 2

Residual Soil Sampling Analytical Results
The Food Tree Site
Wisconsin Rapids, Wisconsin
June 1996

Sample ID	Depth (feet)	Sampling Location	GRO (ppm)	Benzene	Toluene	Ethylbenzene	Total Xylenes	MTBE	Total TMB
S-39	4	East Wall Limit	3.1	<25	<25	<25	<25	<25	<25
S-40	4	East Wall Limit	<3.0	<30	36	<30	53	<30	52
S-41	4	SE Wall Limit	<2.8	<28	<28	<28	<28	<28	<28
S-42	5.5	Bottom Limit	230	<100	<100	600	2,200	<100	3,580
S-43	5.5	Bottom Limit	4.5	270	450	220	810	<30	332
S-52	4	South Wall Limit	<2.8	53	88	62	330	<28	138
S-53	5.5	Bottom Limit	1,500	6,900	89,000	36,000	158,000	<500	107,000
S-54	4	West Wall Limit	<2.8	44	<25	43	235	<25	80
S-55	4	West Wall Limit	<2.8	35	<25	<25	33	<25	<50
S-56	3	South Wall Limit	<2.8	72	<25	54	370	<25	120
S-58	5.5	North Wall Limit	2,700	14,000	150,000	69,000	282,000	<1,300	161,000
S-59	3.5	North Wall Limit	<3.1	<25	<25	<25	<50	<25	<50
TP-1	5	North of Excavation Limit	<3.0	44	<25	<25	<50	<25	<50
TP-2	5	North of Excavation Limit	3.8	<25	<25	140	720	<25	590
S-1A	3	Gravel Between Old and New Tanks	110	34	1,700	2,000	10,200	<25	10,700
NR 720 Soil Cleanup Standard			100	5.5*	1,500	2,900	4,100	NS	NS

Notes: All analytical values are expressed as ppb unless otherwise indicated

Shading indicates value exceeds the NR 720 soil cleanup standard

* The official WDNR reporting limit for methanol-preserved samples is 25 ppb
 MTBE: Methyl t-butyl ether
 TMB: Trimethylbenzene
 GRO: Gasoline range organics

Checked by: SWT
 1/27/96

Approved by: [Signature]

NA: Not analyzed
 WDNR: Wisconsin Department of Natural Resources
 NS: No Standard

TABLE 3

Historical Groundwater Quality Results
The Food Tree Site
Wisconsin Rapids, Wisconsin

Well I.D.	Sample Date	Benzene	Ethylbenzene	MTBE	Toluene	1,2,4-TMB	1,3,5-TMB	Xylenes
MW-1	12/13/91	1.1	1.4	<1.0	1.8	2.5	1.2	4.4
	4/28/92	<1.0	<1.0	<5.0	<1.0	<1.0	<1.0	<1.0
	11/10/92	<1.0	<1.0	<1.0	<1.0	<1.0	<1.0	<3.0
	1/27/93	<1.0	<1.0	<1.0	<1.0	<1.0	<1.0	<3.0
	5/4/93	<1.0	<1.0	<1.0	<1.0	<1.0	<1.0	<3.0
	11/10/94	<1.0	<1.0	<1.0	<1.0	<1.0	<1.0	<3.0
	8/16/95	<1.0	<1.0	<1.0	<1.0	<1.0	<1.0	<3.0
	10/11/95	NA	NA	NA	NA	NA	NA	NA
	7/16/96	<0.50	<1.0	<1.0	<1.0	<1.0	<1.0	<3.0
	11/12/96	NA	NA	NA	NA	NA	NA	NA
	3/5/97	1.0	<0.22	<0.16	<0.20	<0.22	<0.29	1.1
	6/16/97	<0.13	<0.22	<0.16	<0.20	<0.22	<0.29	<0.23
	9/4/97	NA	NA	NA	NA	NA	NA	NA
	11/19/97	NA	NA	NA	NA	NA	NA	NA
	3/31/98	<0.13	<0.22	<0.16	<0.20	<0.22	<0.29	<0.23
6/16/98	<0.13	<0.22	<0.16	<0.20	<0.22	<0.29	<0.23	
9/23/98	<0.13	<0.22	<0.16	<0.20	<0.22	<0.29	<0.23	
NR 140 ES		5	700	60	343	NS	NS	620
NR 140 PAL		0.5	140	12	68.6	NS	NS	124

(Continued)

Notes: All results in µg/l

- Shading indicates value exceeds the NR 140 enforcement standard
- Shading indicates value exceeds the NR 140 preventative action limit
- (<): Indicates not detected above method detection limit
- MTBE: Methyl t-butyl ether
- ES: Enforcement standard
- NS: No standard
- TMB: Trimethylbenzene

BY: [Signature] IM

TABLE 3
(Continued)

Historical Groundwater Quality Results
The Food Tree Site
Wisconsin Rapids, Wisconsin

Well ID	Sample Date	Benzene	Ethylbenzene	MTBE	Toluene	1,2,4-TMB	1,3,5-TMB	Xylenes
MW-2	12/13/91	<2.0	<2.0	<5.0	<2.0	<2.0	<2.0	4.0
	4/28/92	<1.0	<1.0	<5.0	<1.0	<1.0	<1.0	<1.0
	11/10/92	<1.0	<1.0	<1.0	<1.0	<1.0	<1.0	<3.0
	1/27/93	<1.0	<1.0	<1.0	<1.0	<1.0	<1.0	<3.0
	5/4/93	<1.0	<1.0	<1.0	<1.0	<1.0	<1.0	<3.0
	11/10/94	<1.0	<1.0	<1.0	<1.0	<1.0	<1.0	<3.0
	8/16/95	<1.0	<1.0	<1.0	<1.0	<1.0	<1.0	<3.0
	10/11/95	NA	NA	NA	NA	NA	NA	NA
	7/16/96	<1.0	<1.0	<1.0	<1.0	<1.0	<1.0	<3.0
	11/12/96	NA	NA	NA	NA	NA	NA	NA
	3/5/97	NA	NA	NA	NA	NA	NA	NA
	6/16/97	0.15	<0.22	<0.16	<0.20	<0.22	<0.29	<0.23
	9/4/97	<0.13	<0.22	<0.16	<0.20	<0.22	<0.29	<0.23
	11/19/97	NA	NA	NA	NA	NA	NA	NA
	3/31/98	NA	NA	NA	NA	NA	NA	NA
	6/16/98	NA	NA	NA	NA	NA	NA	NA
9/23/98	<0.13	0.27	<0.16	0.31	0.33	<0.29	0.93	
ES		5	700	60	343	NS	NS	620
PAL		0.5	140	12	68.6	NS	NS	124

(Continued)

Notes: All results in $\mu\text{g/l}$



Shading indicates value exceeds the NR 140 enforcement standard

Shading indicates value exceeds the NR 140 preventative action limit

(<): Indicates not detected above method detection limit

MTBE: Methyl t-butyl ether

ES: Enforcement standard

TMB: Trimethylbenzene

PAL: Preventive action limit

NS: No standard
NA: Not sampled

Checked by: SWT Approved by: JED
1/27/99

TABLE 3
(Continued)

Historical Groundwater Quality Results
The Food Tree Site
Wisconsin Rapids, Wisconsin

Well I.D.	Sample Date	Benzene	Ethylbenzene	MTBE	Toluene	1,2,4-TMB	1,3,5-TMB	Xylenes
MW-3	12/13/91	<2.0	<2.0	<5.0	<2.0	<2.0	<2.0	<2.0
	4/28/92	<1.0	<1.0	<5.0	<1.0	<1.0	<1.0	<1.0
	11/10/92	<1.0	<1.0	<1.0	<1.0	<1.0	<1.0	<3.0
	1/27/93	<1.0	<1.0	<1.0	<1.0	<1.0	<1.0	<3.0
	5/4/93	<1.0	<1.0	<1.0	<1.0	<1.0	<1.0	<3.0
	11/10/94	<1.0	<1.0	<1.0	<1.0	<1.0	<1.0	<3.0
	8/16/95	<1.0	<1.0	<1.0	<1.0	<1.0	<1.0	<3.0
	10/11/95	NA	NA	NA	NA	NA	NA	NA
	7/16/96	<0.50	<1.0	<1.0	<1.0	<1.0	<1.0	<3.0
	11/12/96	NA	NA	NA	NA	NA	NA	NA
	3/5/97	NA	NA	NA	NA	NA	NA	NA
	6/16/97	<0.13	<0.22	<0.20	<0.23	<0.22	<0.29	<0.16
	9/4/97	NA	NA	NA	NA	NA	NA	NA
	11/19/97	NA	NA	NA	NA	NA	NA	NA
	3/31/98	NA	NA	NA	NA	NA	NA	NA
6/16/98	NA	NA	NA	NA	NA	NA	NA	
9/23/98	<0.13	<0.22	<0.16	0.28	<0.22	<0.29	0.37	
ES		5	700	60	343	NS	NS	620
PAL		0.5	140	12	68.6	NS	NS	124

(Continued)

Notes: All results in $\mu\text{g/l}$

- Shading indicates value exceeds the NR 140 enforcement standard
- Shading indicates value exceeds the NR 140 preventative action limit
- (<): Indicates not detected above method detection limit
- MTBE: Methyl t-butyl ether
- ES: Enforcement standard
- TMB: Trimethylbenzene
- PAL: Preventive action limit

NS: No standard
NA: Not sampled

Checked by: SWT Approved by: JAD
1/27/99

TABLE 3
(Continued)

Historical Groundwater Quality Results
The Food Tree Site
Wisconsin Rapids, Wisconsin

Well I.D.	Sample Date	Benzene	Ethylbenzene	MTBE	Toluene	1,2,4-TMB	1,3,5-TMB	Xylenes
MW-4	12/13/91	<2.0	<2.0	<2.0	<2.0	3.0	2.0	5.0
	4/28/92	34	18	<50	<10	20	<10	67
	11/10/92	230	140	<10	29	130	49	550
	1/27/93	120	29	<1.0	9.8	20	4	67
	5/4/93	<54	36	4.6	7.3	58	16	150
	11/10/94	78	70	<20	<20	97	25	380
	8/16/95	4.6	<1.0	<1.0	<1.0	3.8	<1.0	6.7
	10/11/95	NA	NA	NA	NA	NA	NA	NA
	7/16/96	79	68	<1.0	79	88	26	270
	11/12/96	NA	NA	NA	NA	NA	NA	NA
	3/5/97	<0.13	<0.22	<0.16	<0.20	<0.22	<0.29	<0.23
	6/16/97	<0.13	<0.22	<0.16	<0.20	<0.22	<0.29	<0.23
	9/4/97	<0.13	<0.22	<0.16	<0.20	<0.22	<0.29	<0.23
	11/19/97	<0.13	<0.22	<0.16	<0.20	<0.22	<0.29	<0.23
	3/31/98	<0.13	<0.22	<0.16	<0.20	<0.22	<0.29	<0.23
	6/16/98	<0.13	<0.22	<0.16	<0.20	<0.22	<0.29	<0.23
9/23/98	<0.13	<0.22	<0.16	<0.20	<0.22	<0.29	<0.23	
ES		5	700	60	343	NS	NS	620
PAL		0.5	140	12	68.6	NS	NS	124

(Continued)

Notes: All results in $\mu\text{g/l}$

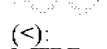
-  Shading indicates value exceeds the NR 140 enforcement standard
-  Shading indicates value exceeds the NR 140 preventative action limit
- (<): Indicates not detected above method detection limit
- MTBE: Methyl t-butyl ether
- ES: Enforcement standard
- TMB: Trimethylbenzene
- PAL: Preventive action limit

NS: No standard
NA: Not sampled

Checked by: SWT Approved by: JAD
1/27/99

TABLE 3
(Continued)

Historical Groundwater Quality Results
The Food Tree Site
Wisconsin Rapids, Wisconsin

Well I.D.	Sample Date	Benzene	Ethylbenzene	MTBE	Toluene	1,2,4-TMB	1,3,5-TMB	Xylenes
MW-5	12/13/91	<4.0	<4.0	<10	<4.0	<4.0	<4.0	<4.0
	4/28/92	<2.0	<1.0	<5.0	<1.0	<1.0	<1.0	<1.0
	11/10/92	<1.0	<1.0	<1.0	<1.0	<1.0	<1.0	<3.0
	1/27/93	<1.0	<1.0	<1.0	<1.0	<1.0	<1.0	<3.0
	5/4/93	NA	NA	NA	NA	NA	NA	NA
	11/10/94	<1.0	<1.0	<1.0	<1.0	<1.0	<1.0	<3.0
	8/16/95	<1.0	<1.0	<1.0	<1.0	<1.0	<1.0	<3.0
	10/11/95	NA	NA	NA	NA	NA	NA	NA
MW-5B ⁽¹⁾	7/16/96	0.66	<1.0	<1.0	<1.0	<1.0	<1.0	<3.0
	11/12/96	NA	NA	NA	NA	NA	NA	NA
	3/5/97	NA	NA	NA	NA	NA	NA	NA
	6/16/97	5.3	3	0.49	3.1	0.53	<0.29	<0.16
	9/4/97	0.42	<0.22	<0.20	<2.3	0.29	<0.29	<0.16
	11/19/97	NA	NA	NA	NA	NA	NA	NA
	3/31/98	<0.13	<0.22	<0.16	<0.20	<0.22	<0.29	<0.23
	6/16/98	<0.13	<0.22	<0.16	<0.20	<0.22	<0.29	<0.23
	9/23/98	<0.13	<0.22	<0.16	<0.20	<0.22	<0.29	<0.23
ES	5	700	60	343	NS	NS	620	
PAL	0.5	140	12	68.6	NS	NS	124	

(Continued)

Notes: All results in $\mu\text{g/l}$
(1): MW-5B was a replacement well for MW-5 which was removed during the soil excavation activities in June 1996.

 Shading indicates value exceeds the NR 140 enforcement standard

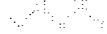
 Shading indicates value exceeds the NR 140 preventative action limit

(<): Indicates not detected above method detection limit

MTBE: Methyl t-butyl ether
ES: Enforcement standard
TMB: Trimethylbenzene
PAL: Preventive action limit

NS: No standard
NA: Not sampled

Checked by: SWT Approved by: JAS
1/27/99

TABLE 3
(Continued)

Historical Groundwater Quality Results
The Food Tree Site
Wisconsin Rapids, Wisconsin

Well I.D.	Sample Date	Benzene	Ethylbenzene	MTBE	Toluene	1,2,4-TMB	1,3,5-TMB	Xylenes
MW-6	12/13/91	<2.0	<2.0	<5.0	<2.0	<2.0	<2.0	4.0
	4/28/92	<1.0	<1.0	<5.0	<1.0	<1.0	<1.0	<1.0
	11/10/92	<1.0	1.4	<1.0	<1.0	<1.0	<1.0	7.0
	1/27/93	<1.0	<1.0	<1.0	<1.0	<1.0	<1.0	5.2
	5/4/93	<1.0	<1.0	<1.0	<1.0	<1.0	<1.0	<3.0
	11/10/94	<1.0	<1.0	<1.0	<1.0	<1.0	<1.0	<3.0
	8/16/95	<1.0	<1.0	<1.0	<1.0	<1.0	<1.0	5.7
	10/11/95	NA	NA	NA	NA	NA	NA	NA
	7/16/96	<0.50	<1.0	<1.0	<1.0	<1.0	<1.0	<3.0
	11/12/96	<0.50	<1.0	<1.0	<1.0	<1.0	<1.0	<1.0
	3/5/97	<0.15	<0.22	<0.16	<0.22	<0.22	<0.29	<0.23
	6/16/97	<0.13	<0.22	<0.16	<0.20	<0.22	<0.29	0.28
	9/4/97	<0.13	<0.22	<0.16	<0.20	<0.22	<0.29	0.83
	11/19/97	<0.13	<0.22	<0.16	<0.20	<0.22	<0.29	<0.23
	3/31/98	<0.13	<0.22	<0.16	<0.20	<0.22	<0.29	<0.23
6/16/98	NA	NA	NA	NA	NA	NA	NA	
9/23/98	<0.13	<0.22	<0.16	0.35	<0.22	<0.29	1.1	
ES		5	700	60	343	NS	NS	620
PAL		0.5	140	12	68.6	NS	NS	124

(Continued)

Notes: All results in $\mu\text{g/l}$

- Shading indicates value exceeds the NR 140 enforcement standard
- Shading indicates value exceeds the NR 140 preventative action limit
- (<): Indicates not detected above method detection limit
- MTBE: Methyl t-butyl ether
- ES: Enforcement standard
- TMB: Trimethylbenzene
- PAL: Preventive action limit

NS: No standard
NA: Not sampled

Checked by: SWT Approved by: JAD
1/27/99

TABLE 3
(Continued)

Historical Groundwater Quality Results
The Food Tree Site
Wisconsin Rapids, Wisconsin

Well I.D.	Sample Date	Benzene	Ethylbenzene	MTBE	Toluene	1,2,4-TMB	1,3,5-TMB	Xylenes
MW-11	3/5/93	<1.0	<1.0	<1.0	<1.0	<1.0	<1.0	<3.0
	5/4/93	<1.0	<1.0	<1.0	<1.0	<1.0	<1.0	<3.0
	11/10/94	<1.0	<1.0	<1.0	<1.0	<1.0	<1.0	<3.0
	8/16/95	<1.0	<1.0	<1.0	<1.0	<1.0	<1.0	<3.0
	10/11/95	NA	NA	NA	NA	NA	NA	NA
	7/16/96	<0.50	<1.0	<1.0	<1.0	<1.0	<1.0	<3.0
	11/12/96	<0.50	<1.0	<1.0	<3.0	<1.0	<1.0	<1.0
	3/5/97	<0.13	<0.22	<0.16	<0.20	<0.22	<0.29	<0.23
	6/16/97	<0.13	<0.22	<0.16	<0.20	<0.22	<0.29	<0.23
	9/4/97	<0.13	<0.22	<0.16	<0.20	<0.22	<0.29	<0.23
	11/19/97	<0.13	<0.22	<0.16	<0.20	<0.22	<0.29	<0.23
	3/31/98	<0.13	<0.22	<0.16	<0.20	<0.22	<0.29	<0.23
	6/16/98	<0.13	<0.22	<0.16	<0.20	<0.22	<0.29	<0.23
	9/23/98	<0.13	<0.22	<0.16	<0.20	<0.22	<0.29	<0.23
ES		5	700	60	343	NS	NS	620
PAL		0.5	140	12	68.6	NS	NS	124

(Continued)

Notes: All results in $\mu\text{g/l}$

Shading indicates value exceeds the NR 140 enforcement standard
 Shading indicates value exceeds the NR 140 preventative action limit
 (<): Indicates not detected above method detection limit
 MTBE: Methyl t-butyl ether
 ES: Enforcement standard
 TMB: Trimethylbenzene
 PAL: Preventive action limit

NS: No standard
 NA: Not sampled

Checked by: SWJ Approved by: JAD
 1/27/99



TABLE 3
(Continued)

Historical Groundwater Quality Results
The Food Tree Site
Wisconsin Rapids, Wisconsin

Well I.D.	Sample Date	Benzene	Ethylbenzene	MTBE	Toluene	1,2,4-TMB	1,3,5-TMB	Xylenes
PZ-1A	11/10/92	25	73	<1.0	6.3	36	6.4	160
	1/27/93	110	<1.0	<1.0	<1.0	<1.0	<1.0	<3.0
	5/4/93	2.0	<1.0	<1.0	<1.0	<1.0	<1.0	<3.0
	11/10/94	9.9	2.7	<1.0	1.5	1.1	<1.0	<3.0
	8/16/95	<1.0	<1.0	<1.0	<1.0	<1.0	<1.0	<3.0
	10/11/95	<0.50	<1.0	<1.0	<1.0	<1.0	<1.0	<3.0
	7/16/96	<0.50	<1.0	<1.0	<1.0	<1.0	<1.0	<3.0
	11/12/96	NA	NA	NA	NA	NA	NA	NA
	3/5/97	<0.13	<0.22	<0.16	<0.20	<0.22	<0.29	<0.23
	6/16/97	<0.13	<0.22	<0.16	<0.20	<0.22	<0.29	<0.23
	9/4/97	NA	NA	NA	NA	NA	NA	NA
	11/19/97	NA	NA	NA	NA	NA	NA	NA
	3/31/98	<0.13	<0.22	<0.16	<0.20	<0.22	<0.29	<0.23
	6/16/98	0.64	<0.22	<0.16	<0.20	<0.22	<0.29	<0.23
9/23/98	<0.13	<0.22	<0.16	<0.20	<0.22	<0.29	<0.23	
ES		5	700	60	343	NS	NS	620
PAL		0.5	140	12	68.6	NS	NS	124

(Continued)

Notes: All results in $\mu\text{g/l}$

-  Shading indicates value exceeds the NR 140 enforcement standard
-  Shading indicates value exceeds the NR 140 preventative action limit
- (<): Indicates not detected above method detection limit
- MTBE: Methyl t-butyl ether
- ES: Enforcement standard
- TMB: Trimethylbenzene
- PAL: Preventive action limit

NS: No standard
NA: Not sampled

Checked by: BWT Approved by: [Signature]
1/27/99

TABLE 3
(Continued)

Historical Groundwater Quality Results
The Food Tree Site
Wisconsin Rapids, Wisconsin

Well ID.	Sample Date	Benzene	Ethylbenzene	MTBE	Toluene	1,2,4-TMB	1,3,5-TMB	Xylenes
PZ-1B	11/10/92	120	31	<1.0	2.3	19	3.7	80
	1/27/93	42	8.4	<1.0	<1.0	<1.0	<1.0	<3.0
	5/4/93	93	14	<2.0	51	6.3	<2.0	45
	11/10/94	<1.0	<1.0	<1.0	<1.0	<1.0	<1.0	<3.0
	8/16/95	<1.0	<1.0	<1.0	<1.0	<1.0	<1.0	<3.0
	10/11/95	<0.50	<1.0	<1.0	<1.0	<1.0	<1.0	<3.0
	7/16/96	<0.50	<1.0	<1.0	<1.0	<1.0	<1.0	<3.0
	11/12/96	NA	NA	NA	NA	NA	NA	NA
	3/5/97	<0.13	<0.22	<0.20	<0.20	<0.22	<0.29	<0.13
	6/16/97	<0.13	<0.22	<0.20	<0.20	<0.22	<0.29	<0.23
	9/4/97	NA	NA	NA	NA	NA	NA	NA
	11/19/97	NA	NA	NA	NA	NA	NA	NA
	3/31/98	<0.13	<0.22	<0.20	<0.20	<0.22	<0.29	<0.23
	6/16/98	<0.13	<0.22	<0.20	<0.20	<0.22	<0.29	<0.23
9/23/98	<0.13	<0.22	<0.20	<0.20	<0.22	<0.29	<0.23	
ES		5	700	60	343	NS	NS	620
PAL		0.5	140	12	68.6	NS	NS	124

(Continued)

Notes: All results in µg/l

Shading indicates value exceeds the NR 140 enforcement standard

Shading indicates value exceeds the NR 140 preventative action limit

(<): Indicates not detected above method detection limit

MTBE: Methyl t-butyl ether

ES: Enforcement standard

TMB: Trimethylbenzene

PAL: Preventive action limit

NS: No standard

NA: Not sampled

Checked by: SWT Approved by: JBA
1/27/99

TABLE 3
(Continued)

Historical Groundwater Quality Results
The Food Tree Site
Wisconsin Rapids, Wisconsin

Well I.D.	Sample Date	Benzene	Ethylbenzene	MTBE	Toluene	1,2,4-TMB	1,3,5-TMB	Xylenes
PZ-1C	11/10/92	310	110	<100	<100	<100	<100	320
	1/27/93	42	25	<1.0	<1.0	3.8	<1.0	8.2
	5/4/93	1,400	360	<50	1,300	230	<50	1,300
	11/10/94	9.5	52	<1.0	<1.0	<1.0	<1.0	<3.0
	8/16/95	320	100	<5.0	8.5	69	15	310
	10/11/95	130	<5.0	<5.0	<5.0	16	<5.0	90
	7/16/96	720	280	<5.0	950	240	55	1,200
	11/12/96	NA	NA	NA	NA	NA	NA	NA
	3/5/97	7.3	4.7	<0.16	1.5	0.87	<0.29	8.5
	6/16/97	<0.13	<0.22	<0.16	<0.20	<0.22	<0.29	<0.23
	9/4/97	NA	NA	NA	NA	NA	NA	NA
	11/19/97	NA	NA	NA	NA	NA	NA	NA
	3/31/98	1.2	2.3	<0.16	<0.20	1.9	<0.29	1.9
	6/16/98	0.96	1.5	<0.16	<0.20	2.9	<0.29	1.5
	9/23/98	0.27	<0.22	<0.16	<0.20	0.34	<0.29	0.31
ES		5	700	60	343	NS	NS	620
PAL		0.5	140	12	68.6	NS	NS	124

(Continued)

Notes: All results in µg/l

- Shading indicates value exceeds the NR 140 enforcement standard
- Shading indicates value exceeds the NR 140 preventative action limit
- (<): Indicates not detected above method detection limit
- MTBE: Methyl t-butyl ether
- ES: Enforcement standard
- TMB: Trimethylbenzene
- PAL: Preventive action limit

NS: No standard
NA: Not sampled

Checked by: SWT Approved by: JBD
1/27/99

TABLE 3
(Continued)

Historical Groundwater Quality Results
The Food Tree Site
Wisconsin Rapids, Wisconsin

Well I.D.	Sample Date	Benzene	Ethylbenzene	MTBE	Toluene	1,2,4-TMB	1,3,5-TMB	Xylenes
PZ-2A	11/10/92	<1.0	<1.0	<1.0	<1.0	<1.0	<1.0	<3.0
	1/27/93	<1.0	<1.0	<1.0	<1.0	<1.0	<1.0	<3.0
	5/4/93	<1.0	<1.0	<1.0	<1.0	<1.0	<1.0	<3.0
	11/10/94	<1.0	<1.0	<1.0	<1.0	<1.0	<1.0	<3.0
	8/16/95	<1.0	<1.0	<1.0	<1.0	<1.0	<1.0	<3.0
	10/11/95	<0.50	<1.0	<1.0	<1.0	<1.0	<1.0	<3.0
	7/16/96	<0.50	<1.0	<1.0	<1.0	<1.0	<1.0	<3.0
	11/12/96	NA	NA	NA	NA	NA	NA	NA
	3/5/97	<0.13	<0.22	<0.16	<0.20	<0.22	<0.29	<0.23
	6/16/97	<0.13	<0.22	<0.16	<0.20	<0.22	<0.29	<0.23
	9/4/97	NA	NA	NA	NA	NA	NA	NA
	11/19/97	NA	NA	NA	NA	NA	NA	NA
	3/31/98	NA	NA	NA	NA	NA	NA	NA
	6/16/98	NA	NA	NA	NA	NA	NA	NA
9/23/98	<0.13	<0.22	<0.16	<0.20	<0.22	<0.29	<0.23	
ES		5	700	60	343	NS	NS	620
PAL		0.5	140	12	68.6	NS	NS	124

(Continued)

Notes: All results in $\mu\text{g/l}$

- Shading indicates value exceeds the NR 140 enforcement standard
- Shading indicates value exceeds the NR 140 preventative action limit
- (<): Indicates not detected above method detection limit
- MTBE: Methyl t-butyl ether
- ES: Enforcement standard
- TMB: Trimethylbenzene
- PAL: Preventive action limit
- NS: No standard
- NA: Not sampled

Checked by: SWJ Approved by: JTB
1/27/99

TABLE 3
(Continued)

Historical Groundwater Quality Results
The Food Tree Site
Wisconsin Rapids, Wisconsin

Well I.D.	Sample Date	Benzene	Ethylbenzene	MTBE	Toluene	1,2,4-TMB	1,3,5-TMB	Xylenes
PZ-2B	11/10/92	<1.0	<1.0	<1.0	<1.0	<1.0	<1.0	<3.0
	1/27/93	<1.0	<1.0	<1.0	<1.0	<1.0	<1.0	<3.0
	5/4/93	<1.0	<1.0	<1.0	<1.0	<1.0	<1.0	<3.0
	11/10/94	<1.0	<1.0	<1.0	<1.0	<1.0	<1.0	<3.0
	8/16/95	<1.0	<1.0	<1.0	<1.0	<1.0	<1.0	<3.0
	10/11/95	<0.50	<1.0	<1.0	<1.0	<1.0	<1.0	<3.0
	7/16/96	<0.50	<1.0	<1.0	1.2	<1.0	<1.0	<3.0
	11/12/96	NA	NA	NA	NA	NA	NA	NA
	3/5/97	0.25	<0.22	<0.16	<0.20	<0.22	<0.29	<0.23
	6/16/97	<0.13	<0.22	<0.16	<0.20	<0.22	<0.29	<0.23
	9/4/97	NA	NA	NA	NA	NA	NA	NA
	11/19/97	NA	NA	NA	NA	NA	NA	NA
	3/31/98	NA	NA	NA	NA	NA	NA	NA
	6/16/98	NA	NA	NA	NA	NA	NA	NA
9/23/98	<0.28	<0.22	<0.16	<0.20	<0.22	<0.29	0.23	
ES		5	700	60	343	NS	NS	620
PAL		0.5	140	12	68.6	NS	NS	124

(Continued)

Notes: All results in µg/l

- Shading indicates value exceeds the NR 140 enforcement standard
- Shading indicates value exceeds the NR 140 preventative action limit
- (<): Indicates not detected above method detection limit
- MTBE: Methyl t-butyl ether
- ES: Enforcement standard
- TMB: Trimethylbenzene
- PAL: Preventive action limit
- NS: No standard
- NA: Not sampled

Checked by: SWT Approved by: 
1/27/99



TABLE 3
(Continued)

Historical Groundwater Quality Results
The Food Tree Site
Wisconsin Rapids, Wisconsin

Well I.D.	Sample Date	Benzene	Ethylbenzene	MTBE	Toluene	1,2,4-TMB	1,3,5-TMB	Xylenes
PZ-2C	11/10/92	<1.0	<1.0	<1.0	<1.0	<1.0	<1.0	<3.0
	1/27/93	<1.0	<1.0	<1.0	<1.0	<1.0	<1.0	<3.0
	5/4/93	4.8	1.1	<1.0	10	2.5	<1.0	14
	11/10/94	<1.0	<1.0	<1.0	<1.0	<1.0	<1.0	<3.0
	8/16/95	<1.0	<1.0	<1.0	<1.0	<1.0	<1.0	<3.0
	10/11/95	<0.50	<1.0	<1.0	<1.0	<1.0	<1.0	<3.0
	7/16/96	<0.50	<1.0	<1.0	<1.0	<1.0	<1.0	<3.0
	11/12/96	<0.50	<1.0	<1.0	<3.0	<1.0	<1.0	<1.0
	3/5/97	<0.13	<0.22	<0.16	<0.20	<0.22	<0.29	<0.23
	6/16/97	<0.13	<0.22	<0.16	<0.20	<0.22	<0.29	<0.23
	9/4/97	<0.13	<0.22	<0.16	<0.20	<0.22	<0.29	<0.23
	11/19/97	0.24	<0.22	<0.16	<0.20	<0.22	<0.29	<0.23
	3/31/98	<0.13	<0.22	<0.16	<0.20	<0.22	<0.29	<0.23
	6/16/98	NA	NA	NA	NA	NA	NA	NA
9/23/98	<0.13	0.24	<0.16	0.42	0.54	<0.29	0.86	
ES		5	700	60	343	NS	NS	620
PAL		0.5	140	12	68.6	NS	NS	124

(Continued)

Notes: All results in $\mu\text{g/l}$

-  Shading indicates value exceeds the NR 140 enforcement standard
-  Shading indicates value exceeds the NR 140 preventative action limit
- (<): Indicates not detected above method detection limit
- MTBE: Methyl t-butyl ether
- ES: Enforcement standard
- TMB: Trimethylbenzene
- PAL: Preventive action limit

NS: No standard
NA: Not sampled

Checked by: SWT Approved by: 
1/27/99

TABLE 3
(Continued)

Historical Groundwater Quality Results
The Food Tree Site
Wisconsin Rapids, Wisconsin

Well I.D.	Sample Date	Benzene	Ethylbenzene	MTBE	Toluene	1,2,4-TMB	1,3,5-TMB	Xylenes
PZ-3A	11/10/92	<1.0	<1.0	<1.0	<1.0	<1.0	<1.0	<3.0
	1/27/93	16	3.4	<1.0	<1.0	<1.0	<1.0	3.9
	5/4/93	11	<1.0	<1.0	<1.0	<1.0	<1.0	<3.0
	11/10/94	10	3.6	<1.0	<1.0	2.8	3.0	7.4
	8/16/95	5.8	<1.0	<1.0	<1.0	<1.0	<1.0	<1.0
	10/11/95	11	<1.0	<1.0	<1.0	<1.0	<1.0	<3.0
	7/16/96	1,800	560	<50	<50	450	110	2,600
	11/12/96	<0.50	<1.0	<1.0	<1.0	<1.0	<1.0	<3.0
	3/5/97	0.45	<0.22	<0.16	<0.20	<0.22	<0.29	0.31
	6/16/97	5.1	0.3	<0.16	<0.20	0.63	0.31	0.85
	9/4/97	2.8	<0.22	<0.16	<0.20	<0.22	<0.29	0.36
	11/19/97	<0.13	<0.22	<0.16	<0.20	<0.22	<0.29	<0.23
	3/31/98	<0.13	<0.22	<0.16	<0.20	<0.22	<0.29	<0.23
	6/16/98	NA	NA	NA	NA	NA	NA	NA
9/23/98	<0.13	<0.22	<0.16	<0.20	<0.22	<0.29	<0.23	
ES		5	700	60	343	NS	NS	620
PAL		0.5	140	12	68.6	NS	NS	124

(Continued)

Notes: All results in µg/l

- Shading indicates value exceeds the NR 140 enforcement standard
- Shading indicates value exceeds the NR 140 preventative action limit
- (<): Indicates not detected above method detection limit
- MTBE: Methyl t-butyl ether
- ES: Enforcement standard
- TMB: Trimethylbenzene
- PAL: Preventive action limit

NS: No standard
NA: Not sampled

Checked by: SWT Approved by: [Signature]
1/27/99



TABLE 3
(Continued)

Historical Groundwater Quality Results
The Food Tree Site
Wisconsin Rapids, Wisconsin

Well I.D.	Sample Date	Benzene	Ethylbenzene	MTBE	Toluene	1,2,4-TMB	1,3,5-TMB	Xylenes
PZ-3B	11/10/92	2.1	15	<1.0	<1.0	7.9	4.0	49
	1/27/93	350	31	<1.0	2.3	13	1.9	41
	5/4/93	370	4.0	<1.0	<1.0	<1.0	<1.0	<3.0
	11/10/94	41	<1.0	<1.0	<1.0	<1.0	<1.0	<3.0
	8/16/95	3.9	<1.0	<1.0	<1.0	<1.0	<1.0	<3.0
	10/11/95	2.4	<1.0	<1.0	<1.0	<1.0	<1.0	<3.0
	7/16/96	240	2.5	<1.0	<1.0	<1.0	<1.0	<3.0
	11/12/96	NA	NA	NA	NA	NA	NA	NA
	3/5/97	0.54	0.25	<0.16	<0.20	<0.22	<0.29	<0.23
	6/16/97	0.13	<0.22	<0.16	<0.20	<0.22	<0.29	<0.23
	9/4/97	NA	NA	NA	NA	NA	NA	NA
	11/19/97	NA	NA	NA	NA	NA	NA	NA
	3/31/98	3.0	<0.22	<0.16	<0.20	<0.22	<0.29	<0.23
	6/16/98	0.95	<0.22	<0.16	<0.20	<0.22	<0.29	<0.23
9/23/98	0.56	<0.22	<0.16	<0.20	<0.22	<0.29	<0.23	
ES		5	700	60	343	NS	NS	620
PAL		0.5	140	12	68.6	NS	NS	124

(Continued)

Notes: All results in $\mu\text{g/l}$

-  Shading indicates value exceeds the NR 140 enforcement standard
-  Shading indicates value exceeds the NR 140 preventative action limit
- (<): Indicates not detected above method detection limit
- MTBE: Methyl t-butyl ether
- ES: Enforcement standard
- TMB: Trimethylbenzene
- PAL: Preventive action limit

NS: No standard
NA: Not sampled

Checked by: SWT Approved by: 
1/21/99

TABLE 3
(Continued)

Historical Groundwater Quality Results
The Food Tree Site
Wisconsin Rapids, Wisconsin

Well I.D.	Sample Date	Benzene	Ethylbenzene	MTBE	Toluene	1,2,4-TMB	1,3,5-TMB	Xylenes
PZ-3C	11/10/92	500	60	<50	83	<50	<50	215
	1/27/93	74	16	<1.0	<1.0	8.4	1.0	28
	5/4/93	1,100	240	<10	1,500	150	34	990
	11/10/94	<1.0	<1.0	<1.0	<1.0	<1.0	<1.0	<3.0
	8/16/95	3.3	1.3	<1.0	<1.0	<1.0	<1.0	<3.0
	10/11/95	26	12	<1.0	<1.0	<1.0	1.2	<3.0
	7/16/96	5.6	<1.0	<1.0	<1.0	<1.0	<1.0	<3.0
	11/12/96	NA	NA	NA	NA	NA	NA	NA
	3/5/97	4.6	3.0	<0.16	4.6	1.7	0.39	11
	6/16/97	<0.13	<0.22	<0.16	<0.20	<0.22	<0.29	<0.23
	9/4/97	NA	NA	NA	NA	NA	NA	NA
	11/19/97	NA	NA	NA	NA	NA	NA	NA
	3/31/98	0.51	<0.22	<0.16	<0.20	<0.22	<0.29	0.24
	6/16/98	1.0	<0.22	<0.16	<0.20	<0.22	<0.29	<0.23
9/23/98	0.14	<0.22	<0.16	<0.20	<0.22	<0.29	<0.23	
ES		5	700	60	343	NS	NS	620
PAL		0.5	140	12	68.6	NS	NS	124

(Continued)

Notes: All results in µg/l

- Shading indicates value exceeds the NR 140 enforcement standard
- Shading indicates value exceeds the NR 140 preventative action limit
- (<): Indicates not detected above method detection limit
- MTBE: Methyl t-butyl ether
- ES: Enforcement standard
- TMB: Trimethylbenzene
- PAL: Preventive action limit

NS: No standard
NA: Not sampled

Checked by: SWT Approved by: JAD
1/27/99

TABLE 3
(Continued)

Historical Groundwater Quality Results
The Food Tree Site
Wisconsin Rapids, Wisconsin

Well I.D.	Sample Date	Benzene	Ethylbenzene	MTBE	Toluene	1,2,4-TMB	1,3,5-TMB	Xylenes
PZ-11C	3/5/93	<1.0	<1.0	<1.0	<1.0	<1.0	<1.0	<3.0
	5/4/93	<1.0	<1.0	<1.0	<1.0	<1.0	<1.0	<3.0
	11/10/94	<1.0	<1.0	<1.0	<1.0	<1.0	<1.0	<3.0
	8/16/95	<1.0	<1.0	<1.0	<1.0	<1.0	<1.0	<3.0
	10/11/95	<0.50	<1.0	<1.0	<1.0	<1.0	<1.0	<3.0
	7/16/96	<0.50	<1.0	<1.0	<1.0	<1.0	<1.0	<3.0
	11/12/96	<0.50	<1.0	<1.0	<1.0	<1.0	<1.0	<3.0
	3/5/97	<0.13	<0.22	<0.16	<0.20	<0.22	<0.29	<0.23
	6/16/97	<0.13	<0.22	<0.16	<0.20	<0.22	<0.29	<0.23
	9/4/97	<0.13	<0.22	<0.16	<0.20	<0.22	<0.29	<3.0
	11/19/97	<0.13	<0.22	<0.16	<0.20	<0.22	<0.29	<0.23
	3/31/98	<0.13	<0.22	<0.16	<0.20	<0.22	<0.29	<0.23
	6/16/98	NA	NA	NA	NA	NA	NA	NA
	9/23/98	<0.13	<0.22	<0.16	<0.20	<0.22	<0.29	<0.23
ES		5	700	60	343	NS	NS	620
PAL		0.5	140	12	68.6	NS	NS	124

(Continued)

Notes: All results in µg/l

- Shading indicates value exceeds the NR 140 enforcement standard
- Shading indicates value exceeds the NR 140 preventative action limit
- (<): Indicates not detected above method detection limit
- MTBE: Methyl t-butyl ether
- ES: Enforcement standard
- TMB: Trimethylbenzene
- PAL: Preventive action limit

NS: No standard
NA: Not sampled

Checked by: SJT Approved by: JBO
1/27/99

TABLE 3
(Continued)

Historical Groundwater Quality Results
The Food Tree Site
Wisconsin Rapids, Wisconsin

Well I.D.	Sample Date	Benzene	Ethylbenzene	MTBE	Toluene	1,2,4-TMB	1,3,5-TMB	Xylenes
PZ-21A	11/10/94	3.5	5.3	<1.0	14	2.8	2.5	12
	8/16/95	<1.0	<1.0	<1.0	<1.0	<1.0	<1.0	<3.0
	10/11/95	<0.50	<1.0	<1.0	<1.0	<1.0	<1.0	<3.0
	7/16/96	<0.50	<1.0	<1.0	<1.0	<1.0	<1.0	<3.0
	11/12/96	<0.50	<1.0	<1.0	<1.0	<1.0	<1.0	<3.0
	3/5/97	0.45	<0.22	<0.16	<0.20	<0.22	<0.29	<0.23
	6/16/97	0.38	<0.22	<0.16	<0.20	<0.22	<0.29	<0.23
	9/4/97	<0.13	<0.22	<0.16	<0.20	<0.22	<0.29	<0.23
	11/19/97	<0.13	<0.22	<0.16	<0.20	<0.22	<0.29	<0.23
	3/31/98	0.26	<0.22	<0.16	<0.20	<0.22	<0.29	<0.23
	6/16/98	NA	NA	NA	NA	NA	NA	NA
9/23/98	<0.13	<0.22	<0.16	<0.20	<0.22	<0.29	<0.23	
ES		5	700	60	343	NS	NS	620
PAL		0.5	140	12	68.6	NS	NS	124

(Continued)

Notes: All results in µg/l



Shading indicates value exceeds the NR 140 enforcement standard

Shading indicates value exceeds the NR 140 preventative action limit

(<): Indicates not detected above method detection limit

MTBE: Methyl t-butyl ether

ES: Enforcement standard

TMB: Trimethylbenzene

PAL: Preventive action limit

NS: No standard

NA: Not sampled

Checked by: SWT Approved by: 
1/27/99

TABLE 3
(Continued)

Historical Groundwater Quality Results
The Food Tree Site
Wisconsin Rapids, Wisconsin

Well ID.	Sample Date	Benzene	Ethylbenzene	MTBE	Toluene	1,2,4-TMB	1,3,5-TMB	Xylenes
PZ-21C	11/10/94	2.4	3.1	<1.0	5.9	1.2	<1.0	<3.0
	8/16/95	23	13	<1.0	<1.0	2.0	<1.0	<3.0
	10/11/95	27	7.2	<1.0	<1.0	13	<1.0	<3.0
	7/16/96	41	82	<1.0	2.4	7.5	<1.0	50
	11/12/96	<0.50	<1.0	<1.0	<1.0	<1.0	<1.0	<3.0
	3/5/97	0.22	<0.22	<0.16	<0.20	<0.22	<0.29	<0.23
	6/16/97	<0.13	<0.22	<0.16	<0.20	<0.22	<0.29	0.35
	9/4/97	0.18	<0.22	<0.16	<0.20	<0.22	<0.29	<0.23
	11/19/97	<0.13	<0.22	<0.16	<0.20	<0.22	<0.29	<0.23
	3/31/98	<0.13	<0.22	<0.16	<0.20	<0.22	<0.29	<0.23
	6/16/98	<0.13	<0.22	<0.16	<0.20	<0.22	<0.29	<0.23
9/23/98	<0.13	<0.22	<0.16	<0.20	<0.22	<0.29	<0.23	
ES		5	700	60	343	NS	NS	620
PAL		0.5	140	12	68.6	NS	NS	124

(Continued)

Notes: All results in $\mu\text{g/l}$

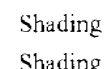
-  Shading indicates value exceeds the NR 140 enforcement standard
-  Shading indicates value exceeds the NR 140 preventative action limit
- (<): Indicates not detected above method detection limit
- MTBE: Methyl t-butyl ether
- ES: Enforcement standard
- TMB: Trimethylbenzene
- PAL: Preventive action limit

NS: No standard
NA: Not sampled

Checked by: SWT Approved by: [Signature]
1/27/99

TABLE 3
(Continued)

Historical Groundwater Quality Results
The Food Tree Site
Wisconsin Rapids, Wisconsin

Well I.D.	Sample Date	Benzene	Ethylbenzene	MTBE	Toluene	1,2,4-TMB	1,3,5-TMB	Xylenes
PZ-22A	11/10/94	<1.0	<1.0	<1.0	62	<1.0	<1.0	<3.0
	8/16/95	<1.0	<1.0	<1.0	<1.0	<1.0	<1.0	<3.0
	10/11/95	<0.5	<1.0	<1.0	<1.0	<1.0	<1.0	<3.0
	7/16/96	<0.5	<1.0	<1.0	<1.0	<1.0	<1.0	<3.0
	11/12/96	<0.5	<1.0	<1.0	<1.0	<1.0	<1.0	<3.0
	3/5/97	NA	NA	NA	NA	NA	NA	NA
	6/16/97	<0.13	<0.22	<0.16	<0.20	<0.22	<0.29	<0.23
	9/4/97	<0.13	<0.22	<0.16	<0.20	<0.22	<0.29	<0.23
	11/19/97	<0.13	<0.22	<0.16	<0.20	<0.22	<0.29	<0.23
	3/31/98	<0.13	<0.22	<0.16	<0.20	<0.22	<0.29	<0.23
	6/16/98	NA	NA	NA	NA	NA	NA	NA
9/23/98	<0.13	<0.22	<0.16	<0.20	<0.22	<0.29	<0.23	
ES		5	700	60	343	NS	NS	620
PAL		0.5	140	12	68.6	NS	NS	124

(Continued)

Notes: All results in $\mu\text{g/l}$



Shading indicates value exceeds the NR 140 enforcement standard

Shading indicates value exceeds the NR 140 preventative action limit

(<): Indicates not detected above method detection limit

MTBE: Methyl t-butyl ether

ES: Enforcement standard

TMB: Trimethylbenzene

PAL: Preventive action limit

NS: No standard

NA: Not sampled

Checked by: scw
1/27/99



Approved by: [Signature]

TABLE 3
(Continued)

Historical Groundwater Quality Results
The Food Tree Site
Wisconsin Rapids, Wisconsin

Well I.D.	Sample Date	Benzene	Ethylbenzene	MTBE	Toluene	1,2,4-TMB	1,3,5-TMB	Xylenes
PZ-22C	11/10/94	<1.0	<1.0	<1.0	<1.0	<1.0	<1.0	<3.0
	8/16/95	<1.0	<1.0	<1.0	<1.0	<1.0	<1.0	<3.0
	10/11/95	<0.5	<1.0	<1.0	<1.0	<1.0	<1.0	<3.0
	7/16/95	<0.5	<1.0	<1.0	<1.0	<1.0	<1.0	<3.0
	11/12/96	<0.5	<1.0	<1.0	<1.0	<1.0	<1.0	<3.0
	3/5/97	NA	NA	NA	NA	NA	NA	NA
	6/16/97	<0.13	<0.22	<0.16	<0.20	<0.22	<0.29	<0.23
	9/4/97	<0.13	<0.22	<0.16	<0.20	<0.22	<0.29	<0.23
	11/19/97	<0.13	<0.22	<0.16	<0.20	<0.22	<0.29	<0.23
	3/31/98	<0.13	<0.22	<0.16	<0.20	<0.22	<0.29	<0.23
	6/16/98	NA	NA	NA	NA	NA	NA	NA
	9/23/98	<0.13	<0.22	<0.16	<0.20	<0.22	<0.29	<0.23
ES		5	700	60	343	NS	NS	620
PAL		0.5	140	12	68.6	NS	NS	124

Notes: All results in $\mu\text{g/l}$

-  Shading indicates value exceeds the NR 140 enforcement standard
-  Shading indicates value exceeds the NR 140 preventative action limit
- (<): Indicates not detected above method detection limit
- MTBE: Methyl t-butyl ether
- ES: Enforcement standard
- TMB: Trimethylbenzene
- PAL: Preventive action limit

NS: No standard
NA: Not sampled

Checked by: SWT Approved by: [Signature]
1/27/99

TABLE 4

Historical Potable Well Water Quality Results
The Food Tree Site
Wisconsin Rapids, Wisconsin

Potable Well I.D.	Sample Date	Benzene	Ethylbenzene	Toluene	Xylenes
1697 Greenfield (Brotshard)	4/28/92	<1.0	<1.0	<1.0	<2.0
	3/31/98	<0.09	<0.15	<0.13	<0.38
	6/16/98	<0.24	<0.18	<0.21	<0.53
	9/23/98	<0.24	<0.18	<0.21	<0.53
ES		5	700	343	620
PAL		0.5	140	68.6	124

(Continued)

Notes: All results in µg/l

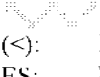
-  Shading indicates value exceeds the NR 140 enforcement standard
-  Shading indicates value exceeds the NR 140 preventative action limit
- (<): Indicates not detected above method detection limit
- ES: Enforcement standard
- PAL: Preventive action limit

Checked by: SWT 1/27/99

Approved by: 



**TABLE 4
(Continued)**

**Historical Potable Well Water Quality Results
The Food Tree Site
Wisconsin Rapids, Wisconsin**

Potable well I.D.	Sample Date	Benzene	Ethylbenzene	Toluene	Xylenes
1735 Greenfield (Freeburg)	5/13/92	<1.0	<1.0	<1.0	<2.0
	11/10/94	<0.5	<0.5	<0.5	<1.0
	8/16/95	<0.70	<0.20	<0.17	<0.28
	7/15/96	<0.5	<0.5	<0.5	<1.0
	11/12/96	<0.50	<1.0	<1.0	<2.0
	3/6/97	<0.18	<0.22	<0.19	<0.60
	9/4/97	<0.09	<0.15	<0.13	<0.38
ES		5	700	343	620
PAL		0.5	140	68.6	124

(Continued)

Notes: All results in µg/l

-  Shading indicates value exceeds the NR 140 enforcement standard
-  Shading indicates value exceeds the NR 140 preventative action limit
- (<): Indicates not detected above method detection limit
- ES: Enforcement standard
- PAL: Preventive action limit

Checked by: SUT 1/27/99

Approved by: 



TABLE 4
(Continued)

Historical Potable Well Water Quality Results
The Food Tree Site
Wisconsin Rapids, Wisconsin

Potable well I.D.	Sample Date	Benzene	Ethylbenzene	Toluene	Xylenes
1736 Greenfield (Stimac)	4/28/92	<1.0	<1.0	<1.0	<2.0
	11/10/94	35	<0.5	<0.5	10
	8/16/95	0.85	0.64	<0.11	2.5
	7/15/96	<0.5	<0.5	<0.5	<1.0
	11/12/96	<0.5	<1.0	<1.0	<2.0
	3/6/97	<0.18	<0.22	<0.19	<0.60
	9/4/97	<0.09	<0.15	<0.13	<0.38
	3/31/98	<0.09	<0.15	<0.13	<0.38
	6/16/98	<0.24	<0.18	<0.21	<0.53
	9/23/98	<0.24	<0.18	<0.21	<0.53
ES		5	700	343	620
PAL		0.5	140	68.6	124

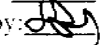
(Continued)

Notes: All results in $\mu\text{g/l}$

-  Shading indicates value exceeds the NR 140 enforcement standard
-  Shading indicates value exceeds the NR 140 preventative action limit
- (<): Indicates not detected above method detection limit
- ES: Enforcement standard
- PAL: Preventive action limit

Checked by: *SQT 1/27/99*

Approved by: *[Signature]*

**TABLE 4
(Continued)**

**Historical Potable Well Water Quality Results
The Food Tree Site
Wisconsin Rapids, Wisconsin**

Potable well I.D.	Sample Date	Benzene	Ethylbenzene	Toluene	Xylenes
1749 Greenfield (Pechinski)	4/28/92	2.0	<1.0	<1.0	<2.0
	11/10/94	<0.5	<0.5	<0.5	<1.0
	8/16/95	1.7	0.27	<0.11	0.67
	7/15/96	3.4	1.3	1.3	2.5
	11/12/96	<0.5	<1.0	<1.0	<2.0
	3/6/97	1.1	0.95	<0.19	1.5
	9/4/97	<0.09	<0.15	<0.13	<0.38
	3/31/98	<0.09	0.44	<0.13	0.42
	6/16/98	<0.24	<0.18	<0.21	<0.53
	9/23/98	0.66	<0.18	<0.21	<0.53
	1/14/99	<0.13	<0.12	<0.13	<0.25
ES		5	700	343	620
PAL		0.5	140	68.6	124

Notes: All results in $\mu\text{g/l}$

-  Shading indicates value exceeds the NR 140 preventative action limit
- (<): Indicates not detected above method detection limit
- ES: Enforcement standard
- PAL: Preventive action limit

Checked by: *SUT 1/27/99*
 Approved by: *[Signature]*



**TABLE 4
(Continued)**

**Historical Potable Well Water Quality Results
The Food Tree Site
Wisconsin Rapids, Wisconsin**

Potable well I.D.	Sample Date	Benzene	Ethylbenzene	Toluene	Xylenes
1759 Greenfield (Food Tree)	4/22/91	270	52	73	110
	6/3/91	640	120	520	380
	12/5/91	150	59	1.4	16
	4/28/92	85	32	6.0	31
	11/8/94	180	39	6.4	120
	8/16/95	<0.70	<0.20	<0.11	<0.28
	6/16/98	0.46	0.36	<0.21	1.44
ES		5	700	343	620
PAL		0.5	140	68.6	124

(Continued)

Notes: All results in µg/l

-  Shading indicates value exceeds the NR 140 enforcement standard
-  Shading indicates value exceeds the NR 140 preventative action limit
- (<): Indicates not detected above method detection limit
- ES: Enforcement standard
- PAL: Preventive action limit

Checked by: SWT 1/27/99

Approved by: [Signature]



**TABLE 4
(Continued)**

**Historical Potable Well Water Quality Results
The Food Tree Site
Wisconsin Rapids, Wisconsin**

Potable well I.D.	Sample Date	Benzene	Ethylbenzene	Toluene	Xylenes
5239 Fountain (Shaw)	11/10/94	<0.5	<0.5	<0.5	<1.0
	1/7/97	<0.5	<0.5	<0.5	<0.5
ES		5	700	343	620
PAL		0.5	140	68.6	124

(Continued)

Notes: All results in $\mu\text{g/l}$

-  Shading indicates value exceeds the NR 140 enforcement standard
-  Shading indicates value exceeds the NR 140 preventative action limit
- (<): Indicates not detected above method detection limit
- ES: Enforcement standard
- PAL: Preventive action limit

Checked by: SWT 1/27/99

Approved by: 

**TABLE 4
(Continued)**

**Historical Potable Well Water Quality Results
The Food Tree Site
Wisconsin Rapids, Wisconsin**

Potable well I.D.	Sample Date	Benzene	Ethylbenzene	Toluene	Xylenes
5247 Fountain (Hendrickson)	1/7/97	<0.5	<0.5	<0.5	<1.0
	3/31/98	<0.09	<0.15	<0.13	<0.38
	6/16/98	<0.24	<0.18	<0.21	<0.53
	9/23/98	<0.24	<0.18	<0.21	<0.53
ES		5	700	343	620
PAL		0.5	140	68.6	124

(Continued)

Notes: All results in µg/l

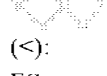
-  Shading indicates value exceeds the NR 140 enforcement standard
-  Shading indicates value exceeds the NR 140 preventative action limit
- (<): Indicates not detected above method detection limit
- ES: Enforcement standard
- PAL: Preventive action limit

Checked by: *scw* 1/27/99

Approved by: 



**TABLE 4
(Continued)**

**Historical Potable Well Water Quality Results
The Food Tree Site
Wisconsin Rapids, Wisconsin**

Potable well I.D.	Sample Date	Benzene	Ethylbenzene	Toluene	Xylenes
1717 CTH P (F&M Bank)	11/10/94	<0.5	<0.5	<0.5	<1.0
	8/16/95	0.076	<0.20	<0.11	<0.56
	7/15/96	<0.5	<0.5	<0.5	<1.0
	3/6/97	0.21	1.1	<0.19	<0.60
	9/4/97	<0.09	<0.15	<0.13	<0.38
	3/31/98	<0.09	<0.15	<0.13	<0.38
	6/16/98	<0.24	<0.18	<0.21	<0.53
	9/23/98	<0.24	<0.18	<0.21	<0.53
ES		5	700	343	620
PAL		0.5	140	68.6	124

Notes:

All results in $\mu\text{g/l}$

-  Shading indicates value exceeds the NR 140 enforcement standard
-  Shading indicates value exceeds the NR 140 preventative action limit
- (<): Indicates not detected above method detection limit
- ES: Enforcement standard
- PAL: Preventive action limit

Checked by: *SJG 1/27/99*

Approved by: 

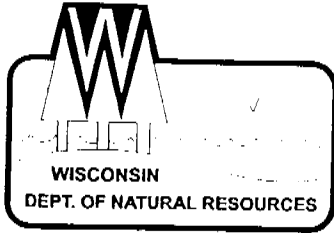

State of Wisconsin \ DEPARTMENT OF NATURAL RESOURCES

Tommy G. Thompson, Governor
George E. Meyer, Secretary
Scott A. Humrickhouse, Regional Director

Wisconsin Rapids Office
473 Griffith Avenue
Wisconsin Rapids, Wisconsin 54494-7859
Telephone 715-421-7800
FAX 715-421-7830

August 8, 2000

BRRTS #03-72-000555

FILE COPY

Mr. Al Weiland
W7035 Countryside Circle
Merril, WI 54452

SUBJECT: Case Closure with Groundwater Use Restriction and Soil Performance Standard,
The Food Tree Site, 1759 Greenfield Avenue, Wisconsin Rapids, Wisconsin.

Dear Mr. Weiland:

The Wisconsin Department of Natural Resources (WDNR) west central region has received the monitoring well abandonment forms for the monitoring wells associated with the subsurface environmental assessment conducted by your consultant for the above referenced site, as well as a copy of the groundwater use restriction and deed restriction affidavits (with the recording information stamped on it) recorded with the Wood County Register of Deeds, a written engineering control maintenance plan outlining how the paved area over the impacted area will be inspected and maintained in the long-term, and a copy of the published class I public notice in accordance with s. NR 714.07(5)(a-e), Wis. Adm. Code, as required by WDNR west central closure committee as conditions for closure of this site. The investigative and remediation documentation provided to the Department, indicates that the extent of the petroleum contamination at the above-named site has been investigated and remediated to the extent practicable, and that natural attenuation will be effective in reducing the mass of residual contamination at this site. Therefore, based on all information contained in the site file and the information included in the well abandonment form and deed affidavit submitted by you, it is the decision of the DNR that, **no further investigatory or clean-up action is needed at the above referenced site at this time and that this site is considered closed.**

You should note that this letter does not constitute Department "certification" under s. 292.15(2)(a)3, Stats., as created by 1993 Wisconsin Act 453 (May 12, 1994). Also, in 1997 Wisconsin Act 27, the legislature amended s. 292.15, Wis. Stats., creating the new "Voluntary Party Remediation and Exemption from Liability" statute. This statute provides liability protection for persons who did not intentionally or recklessly cause the release of a hazardous substance and who conducts an environmental investigation and cleans up property by restoring the environment to the extent practicable and in accordance with rules promulgated by the Department. Upon completion of the cleanup, the person receives a "certificate of completion"

August 8, 2000
Mr. Al Weiland
Page 2

BRRTS #03-72-000555

that provides an exemption from the "Hazardous Substance Spills" statute and protection from future liability for the past releases. You must apply for the program by filling out an application form and fees are charged to cover administrative costs associated with the program. If you are interested in more information about the program or would like an application package, please call Loren Brumberg at the West Central Region Office in Eau Claire at 715-839-3770.

The Department appreciates the actions you have undertaken to restore the environment. If you have any questions, please feel free to call me at (715) 421-7850.

Sincerely,



Tom Hvizdak
Hydrogeologist

c: James Noonan, 5541 Hwy. 10 E., Suite C, Stevens Point, WI 54481
Jay Diebold, Envirogen, P.O. Box 90, Pewaukee, WI 53072

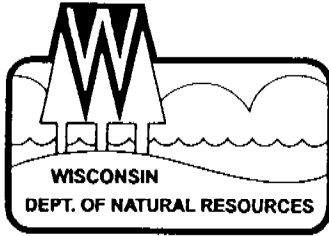

State of Wisconsin \ DEPARTMENT OF NATURAL RESOURCES

Tommy G. Thompson, Governor
George E. Meyer, Secretary
Scott A. Humrickhouse, Regional Director

5301 Rib Mountain Drive
Wausau, Wisconsin 54401
Telephone 715-359-1777
FAX 715-355-5253

April 19, 1999

BRRTS: 03-72-000555

Mr. Al Weiland
The Food Tree
1759 Greenfield, Ave.
Wisconsin Rapids, WI 54494

FILE COPY

SUBJECT: Case Closure
The Food Tree
1759 Greenfield Ave., Wisconsin Rapids, WI

Dear Mr. Weiland:

On June 7, 1991, the Department of Natural Resources provided a notice to you that the degree and extent of petroleum contamination at the above-named site was required to be investigated and remedied. We have since been informed that the required investigation and remediation has been accomplished. On April 8, 1999, the site was reviewed by the West Central Regional Close Out Committee for a determination as to whether or not the case qualified for close out under ch. NR 726, Wis. Adm. Code.

Based on the investigative and remedial documentation provided to the Department, there is soil contamination remaining at the site. Closure for the site was requested using Soil Performance Standards NR 720.19(2) and the closure committee has approved this closure. NR 720.19(2) requires the following conditions:

The responsible party shall conduct public participation activities in compliance with s. NR 714.07(5) as required by s. NR 720.19(2) and NR 722.09(2).

Provide to the Department, an operations and maintenance (O & M) plan that meets the requirements of s. NR 724.13(2) and (4). Long term monitoring and progress reports will not be necessary, however the O & M plan must detail the installation of the standard and the long term maintenance of the chosen performance standard. Any change in the status of the performance standard will require that the Department be notified. The approval by the Department is necessary prior to the change.

A deed restriction must be placed on the property that fulfills the requirements of s. NR 726.05(8)(a). The restriction must be approved by the Department prior to recording it at the County Registrar of Deeds. After the restriction has been approved by the

Department and recorded with the county, a copy of the final restriction must be provided to the Department.

The Department requires that the monitoring wells that were installed during the investigation and remedial activities be properly abandoned in accordance with Administrative Code NR 141.25. Documentation substantiating proper abandonment (Form 3300-5W) should be forwarded to Mr. Tom Hvizdak at the Department's Wisconsin Rapids Office (473 Griffith Ave. Wisconsin Rapids, WI 54494-7859).

The case may be reopened pursuant to s. NR 726.05(2)(b)2-5 or NR 726.09, Wis. Adm. Code, if additional information regarding site conditions indicates that natural attenuation is no longer an effective remedial action; or if contamination on the site poses a threat to public health, safety, or welfare of the environment.

If you have additional relevant information which was not formerly provided to the Department, and which you feel would significantly impact the Department's closure decision, you may submit that information for our re-evaluation of case closure. The Department appreciates the actions you have undertaken to restore the environment. If you have any questions, please feel free to call me at (715) 359-1777 or Mr. Hvizdak at (715) 421-7850.

Sincerely,

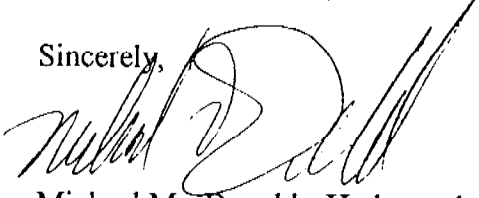
A handwritten signature in black ink, appearing to read "Michael MacDonald", written over a large, stylized circular flourish.

Michael MacDonald - Hydrogeologist
Remediation and Redevelopment Program

cc: Scott Tarmann - Envirogen Inc. - P.O. Box 90, Pewaukee, WI 53072