

GIS Registry Disclaimer

This case was closed by the DNR prior to August 1, 2002, when DNR began adding approved cleanups with residual soil contamination into the GIS Registry. Certain documents that are currently required by ch. NR 726, Wis. Adm. Code may therefore not be included in this packet as they were unavailable at the time the original case was closed.

The information contained in this document was assembled by DNR from a previously closed case file, and added to the GIS Registry to provide the public with information on closed sites with residual soil and/or groundwater contamination remaining above applicable state standards.

GIS REGISTRY

Cover Sheet

May, 2009
(RR 5367)

Source Property Information

BRRTS #: 03-09-000619

ACTIVITY NAME: PDM Bridge

PROPERTY ADDRESS: 2800 Melby Road

MUNICIPALITY: Eau Claire

PARCEL ID #:

CLOSURE DATE: Sep 3, 1993

FID #: 609077590

DATCP #:

COMM #: 54703057000

*WTM COORDINATES:

X: 403769 Y: 488830

** Coordinates are in
WTM83, NAD83 (1991)*

WTM COORDINATES REPRESENT:

Approximate Center Of Contaminant Source

Approximate Source Parcel Center

Please check as appropriate: (BRRTS Action Code)

Contaminated Media:

Groundwater Contamination > ES (236)

Contamination in ROW

Off-Source Contamination

*(note: for list of off-source properties
see "Impacted Off-Source Property")*

Soil Contamination > *RCL or **SSRCL (232)

Contamination in ROW

Off-Source Contamination

*(note: for list of off-source properties
see "Impacted Off-Source Property")*

Land Use Controls:

N/A (Not Applicable)

Soil: maintain industrial zoning (220)

*(note: soil contamination concentrations
between non-industrial and industrial levels)*

Structural Impediment (224)

Site Specific Condition (228)

Cover or Barrier (222)

*(note: maintenance plan for
groundwater or direct contact)*

Vapor Mitigation (226)

Maintain Liability Exemption (230)

*(note: local government or economic
development corporation)*

Monitoring Wells:

Are all monitoring wells properly abandoned per NR 141? (234)

Yes No N/A

** Residual Contaminant Level*

***Site Specific Residual Contaminant Level*

This Adobe Fillable form is intended to provide a list of information that is required for evaluation for case closure. It is to be used in conjunction with Form 4400-202, Case Closure Request. The closure of a case means that the Department has determined that no further response is required at that time based on the information that has been submitted to the Department.

NOTICE: Completion of this form is mandatory for applications for case closure pursuant to ch. 292, Wis. Stats. and ch. NR 726, Wis. Adm. Code, including cases closed under ch. NR 746 and ch. NR 726. The Department will not consider, or act upon your application, unless all applicable sections are completed on this form and the closure fee and any other applicable fees, required under ch. NR 749, Wis. Adm. Code, Table 1 are included. It is not the Department's intention to use any personally identifiable information from this form for any purpose other than reviewing closure requests and determining the need for additional response action. The Department may provide this information to requesters as required by Wisconsin's Open Records law [ss. 19.31 - 19.39, Wis. Stats.].

BRRTS #: PARCEL ID #:

ACTIVITY NAME: WTM COORDINATES: X: Y:

CLOSURE DOCUMENTS (the Department adds these items to the final GIS packet for posting on the Registry)

- Closure Letter**
- Maintenance Plan** (if activity is closed with a land use limitation or condition (land use control) under s. 292.12, Wis. Stats.)
- Conditional Closure Letter**
- Certificate of Completion (COC)** for VPLE sites

SOURCE LEGAL DOCUMENTS

- Deed:** The most recent deed as well as legal descriptions, for the **Source Property** (where the contamination originated). Deeds for other, off-source (off-site) properties are located in the **Notification** section.
Note: If a property has been purchased with a land contract and the purchaser has not yet received a deed, a copy of the land contract which includes the legal description shall be submitted instead of the most recent deed. If the property has been inherited, written documentation of the property transfer should be submitted along with the most recent deed.
- Certified Survey Map:** A copy of the certified survey map or the relevant section of the recorded plat map for those properties where the legal description in the most recent deed refers to a certified survey map or a recorded plat map. (lots on subdivided or platted property (e.g. lot 2 of xyz subdivision)).
Figure #: **Title:**
- Signed Statement:** A statement signed by the Responsible Party (RP), which states that he or she believes that the attached legal description accurately describes the correct contaminated property.

MAPS (meeting the visual aid requirements of s. NR 716.15(2)(h))

- Maps must be no larger than 8.5 x 14 inches unless the map is submitted electronically.
- Location Map:** A map outlining all properties within the contaminated site boundaries on a U.S.G.S. topographic map or plat map in sufficient detail to permit easy location of all parcels. If groundwater standards are exceeded, include the location of all potable wells within 1200 feet of the site.
Note: Due to security reasons municipal wells are not identified on GIS Packet maps. However, the locations of these municipal wells must be identified on Case Closure Request maps.
Figure #: 1 **Title: Location Map**
 - Detailed Site Map:** A map that shows all relevant features (buildings, roads, individual property boundaries, contaminant sources, utility lines, monitoring wells and potable wells) within the contaminated area. This map is to show the location of all contaminated public streets, and highway and railroad rights-of-way in relation to the source property and in relation to the boundaries of groundwater contamination exceeding a ch. NR 140 Enforcement Standard (ES), and/or in relation to the boundaries of soil contamination exceeding a Residual Contaminant Level (RCL) or a Site Specific Residual Contaminant Levels (SSRCL) as determined under s. NR 720.09, 720.11 and 720.19.
Figure #: 2 **Title: Site Plan**
 - Soil Contamination Contour Map:** For sites closing with residual soil contamination, this map is to show the location of all contaminated soil and a single contour showing the horizontal extent of each area of contiguous residual soil contamination that exceeds a Residual Contaminant Level (RCL) or a Site Specific Residual Contaminant Level (SSRCL) as determined under s. NR 720.09, 720.11 and 720.19.
Figure #: 2 **Title: Site Plan**

BRRTS #: 03-09-000619

ACTIVITY NAME: PDM Bridge

MAPS (continued)

- Geologic Cross-Section Map:** A map showing the source location and vertical extent of residual soil contamination exceeding a Residual Contaminant Level (RCL) or a Site Specific Residual Contaminant Level (SSRCL). If groundwater contamination exceeds a ch. NR 140 Enforcement Standard (ES) when closure is requested, show the source location and vertical extent, water table and piezometric elevations, and locations and elevations of geologic units, bedrock and confining units, if any.

Figure #: 3 Title: Cross Section A-A'

Figure #: Title:

- Groundwater Isoconcentration Map:** For sites closing with residual groundwater contamination, this map shows the horizontal extent of all groundwater contamination exceeding a ch. NR140 Preventive Action Limit (PAL) and an Enforcement Standard (ES). Indicate the direction and date of groundwater flow, based on the most recent sampling data.

Note: This is intended to show the total area of contaminated groundwater.

Figure #: Title:

- Groundwater Flow Direction Map:** A map that represents groundwater movement at the site. If the flow direction varies by more than 20° over the history of the site, submit 2 groundwater flow maps showing the maximum variation in flow direction.

Figure #: Title:

Figure #: Title:

TABLES (meeting the requirements of s. NR 716.15(2)(h)(3))

Tables must be no larger than 8.5 x 14 inches unless the table is submitted electronically. Tables must not contain shading and/or cross-hatching. The use of **BOLD** or *ITALICS* is acceptable.

- Soil Analytical Table:** A table showing remaining soil contamination with analytical results and collection dates.
Note: This is one table of results for the contaminants of concern. Contaminants of concern are those that were found during the site investigation, that remain after remediation. It may be necessary to create a new table to meet this requirement.

Table #: 1, 2 Title: Soil Analytical Results; Sample Summary Tank Closure Assessment

- Groundwater Analytical Table:** Table(s) that show the most recent analytical results and collection dates, for all monitoring wells and any potable wells for which samples have been collected.

Table #: Title:

- Water Level Elevations:** Table(s) that show the previous four (at minimum) water level elevation measurements/dates from all monitoring wells. If present, free product is to be noted on the table.

Table #: Title:

IMPROPERLY ABANDONED MONITORING WELLS

For each monitoring well not properly abandoned according to requirements of s. NR 141.25 include the following documents.

Note: If the site is being listed on the GIS Registry for only an improperly abandoned monitoring well you will only need to submit the documents in this section for the GIS Registry Packet.

- Not Applicable**

- Site Location Map:** A map showing all surveyed monitoring wells with specific identification of the monitoring wells which have not been properly abandoned.

Note: If the applicable monitoring wells are distinctly identified on the Detailed Site Map this Site Location Map is not needed.

Figure #: Title:

- Well Construction Report:** Form 4440-113A for the applicable monitoring wells.

- Deed:** The most recent deed as well as legal descriptions for each property where a monitoring well was not properly abandoned.

- Notification Letter:** Copy of the notification letter to the affected property owner(s).

BRRTS #: 03-09-000619

ACTIVITY NAME: PDM Bridge

NOTIFICATIONS

Source Property

- Letter To Current Source Property Owner:** If the source property is owned by someone other than the person who is applying for case closure, include a copy of the letter notifying the current owner of the source property that case closure has been requested.
- Return Receipt/Signature Confirmation:** Written proof of date on which confirmation was received for notifying current source property owner.

Off-Source Property

Group the following information per individual property and label each group according to alphabetic listing on the "Impacted Off-Source Property" attachment.

- Letter To "Off-Source" Property Owners:** Copies of all letters sent by the Responsible Party (RP) to owners of properties with groundwater exceeding an Enforcement Standard (ES), and to owners of properties that will be affected by a land use control under s. 292.12, Wis. Stats.

Note: Letters sent to off-source properties regarding residual contamination must contain standard provisions in Appendix A of ch. NR 726.

Number of "Off-Source" Letters:

- Return Receipt/Signature Confirmation:** Written proof of date on which confirmation was received for notifying any off-source property owner.
- Deed of "Off-Source" Property:** The most recent deed(s) as well as legal descriptions, for all affected deeded **off-source property(ies)**. This does not apply to right-of-ways.
Note: If a property has been purchased with a land contract and the purchaser has not yet received a deed, a copy of the land contract which includes the legal description shall be submitted instead of the most recent deed. If the property has been inherited, written documentation of the property transfer should be submitted along with the most recent deed.

- Letter To "Governmental Unit/Right-Of-Way" Owners:** Copies of all letters sent by the Responsible Party (RP) to a city, village, municipality, state agency or any other entity responsible for maintenance of a public street, highway, or railroad right-of-way, within or partially within the contaminated area, for contamination exceeding a groundwater Enforcement Standard (ES) and/or soil exceeding a Residual Contaminant Level (RCL) or a Site Specific Residual Contaminant Level (SSRCL).

Number of "Governmental Unit/Right-Of-Way Owner" Letters:

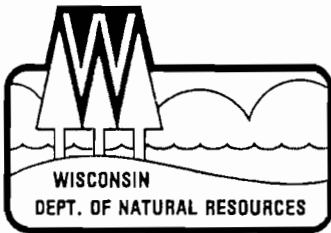

George E. Meyer
Secretary

File

State of Wisconsin \ DEPARTMENT OF NATURAL RESOURCES

2004 Highland Avenue
Eau Claire, WI 54701-4346
TELEPHONE 715-839-3777
TELEFAX 715-839-1605

September 3, 1993

File Ref: 4440
Chippewa County

Mr. Phil Hoilien
Phoenix Steel, Inc.
2800 Melby Rd.
Eau Claire, WI 54703

SUBJECT: Site Closure for Phoenix Steel, Inc. Located at 2800 Melby
Rd., Eau Claire, WI

Dear Mr. Hoilien:

I have received a recorded copy of the appropriate Deed Restriction for the above-captioned site. Based on that receipt, we are now closing the site.

Closure is intended to mean that currently available information indicates that this site does not pose a threat to the environment. Be aware that if future data indicates that current or pre-existing activities on this site have created a threat to the environment, this Department reserves the right to request additional information and remediation.

If you have any questions concerning this letter, please contact me at (715) 839-3775.

Sincerely,

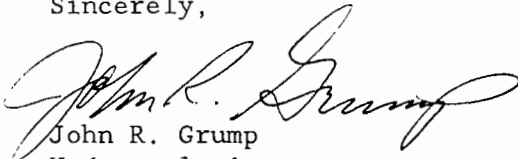

John R. Grump
Hydrogeologist

JRG/ah

c: Bill Evans
Christopher Goodwin, Ayres

file



George E. Meyer
Secretary

State of Wisconsin \ DEPARTMENT OF NATURAL RESOURCES

2004 Highland Avenue
Eau Claire, WI 54701-4346
TELEPHONE 715-839-3777
TELEFAX 715-839-1605

July 6, 1993

File Ref: 4440
Chippewa County

Mr. Phil Hoilien
Phoenix Steel, Inc.
2800 Melby Road
Eau Claire, WI 54703

SUBJECT: Site Closure for the Three Areas of Underground Storage Tank
Contamination Located at 2800 Melby Road, Eau Claire, WI

Dear Mr. Hoilien:

I have submitted a site closure request to our District Close-Out Committee for the above-captioned site. Based on the data submitted by Christopher Goodwin of Ayres Associates, the committee recommended that this site undergo closure. This closure is granted pending the submittal of a registered deed restriction for the contaminated soil that remains in the area of Tanks 4 and 5. This area is adjacent to your Bridge Plant Building. Due to concerns for the building's integrity, contaminated soil beneath this building could not be removed.

The aforementioned deed restriction allows you to receive closure but stipulates that in the event that this building is ever razed, the contamination that remains under the building must be remediated. I am enclosing a model "Deed Restriction" prepared by our Legal Council. Please have your attorney draft a deed restriction that is specific to the Bridge Plant Building.

Upon completion of the draft, a copy must be sent to this office for review. Subsequent to my review a copy of the final restriction must be registered with the Chippewa County Register of Deeds. Proof of registration must be forwarded for my records.

Closure is intended to mean that currently available information indicates that this site does not pose a threat to the environment. Be aware that if future data indicates that current or pre-existing activities on this site have created a threat to the environment, this Department reserves the right to request additional information and remediation.

Mr. Phil Hoilien - July 6, 1993

2

If you have any questions concerning this letter, please contact me at
(715) 839-3775.

Sincerely,

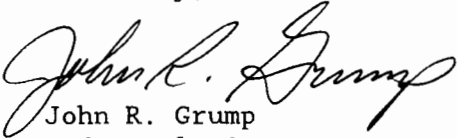
A handwritten signature in cursive script that reads "John R. Grump". The signature is written in black ink and is positioned above the printed name and title.

John R. Grump
Hydrogeologist

JRG/ah

Enclosure

c: Bill Evans
Christopher Goodwin, Ayres

Executed this 17 day of August, 1993.

PHOENIX STEEL, INC.

By: Milton A. Lunda
President

Attested: R. L. Ridley
Secretary

AUTHENTICATION

Signatures of Milton A. Lunda, President,
Robert L. Ridley, Secretary, of Phoenix
Steel, Inc., a Wisconsin corporation,
authenticated this 17th day of
August, 1993.

[Signature]
Jack A. Postlewaite
Member of the State Bar of Wisconsin

This document was drafted by Jack A. Postlewaite.

Registers Office }
Chippewa County, WI } 98
Received for Record
the 19 day of Aug
A.D. 19 93 at 9:30 o'clock a m.
and recorded in vol. 754
of Records Page 621-622
Beatrice M. Koppeck
Register

Carrick, Parsons, Postlewaite
P.O. Box 1207
Earl Clark, Wis 1207

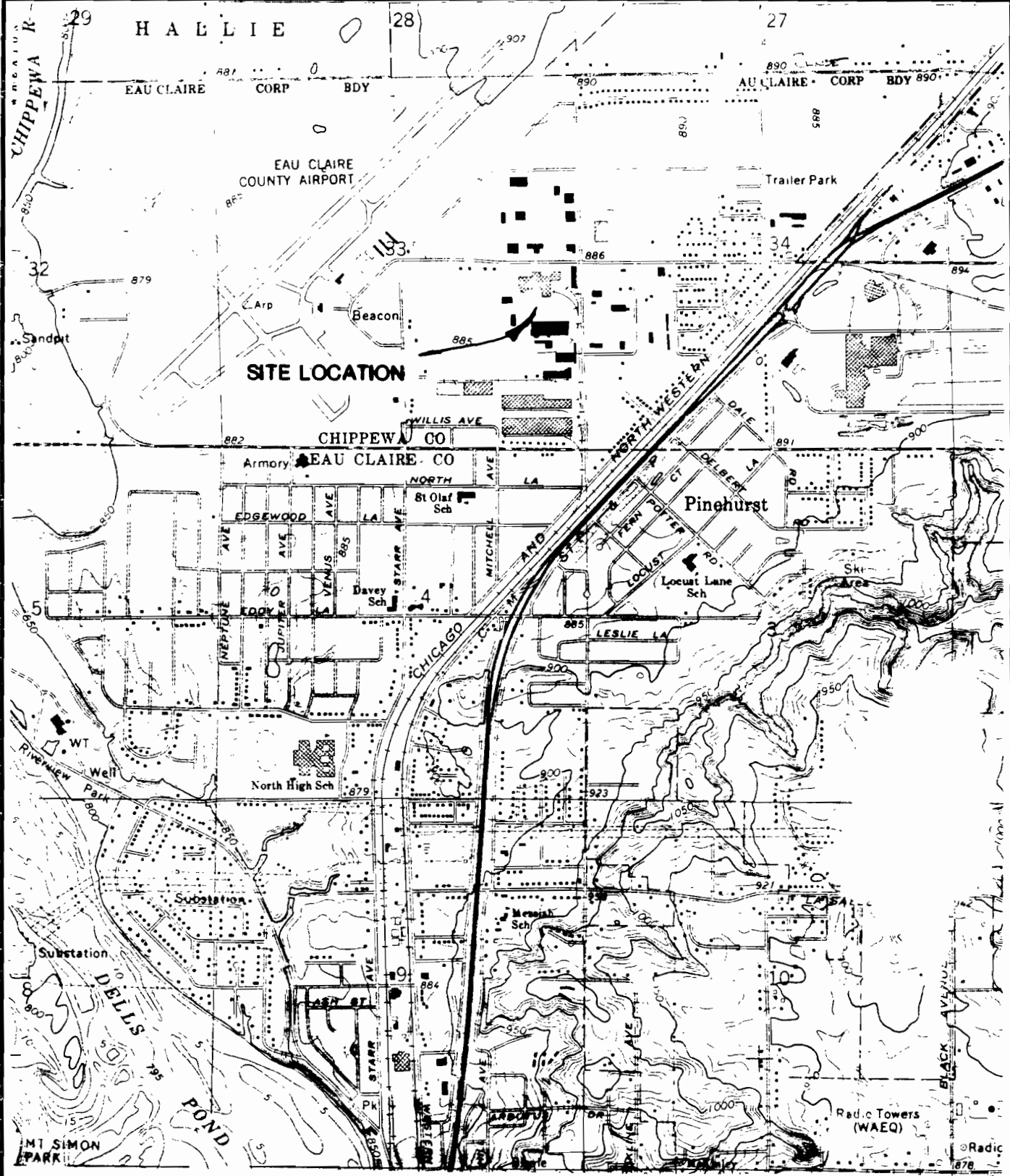

SCALE 1:24 000

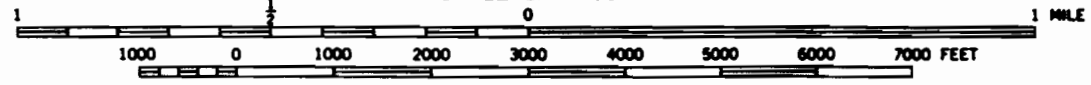

<p>TANK CLOSURE SITE ASSESSMENT PHOENIX STEEL, INC. EAU CLAIRE, WISCONSIN</p>	<p>DRN. BY: MLE NLD</p>	<p>LOCATION MAP</p>	<p>FIGURE 1</p>
	<p>CHK. BY: DJ 0x</p>		
	<p>DATE: SEP 1991</p>		
<p>AYRES ASSOCIATES</p>			

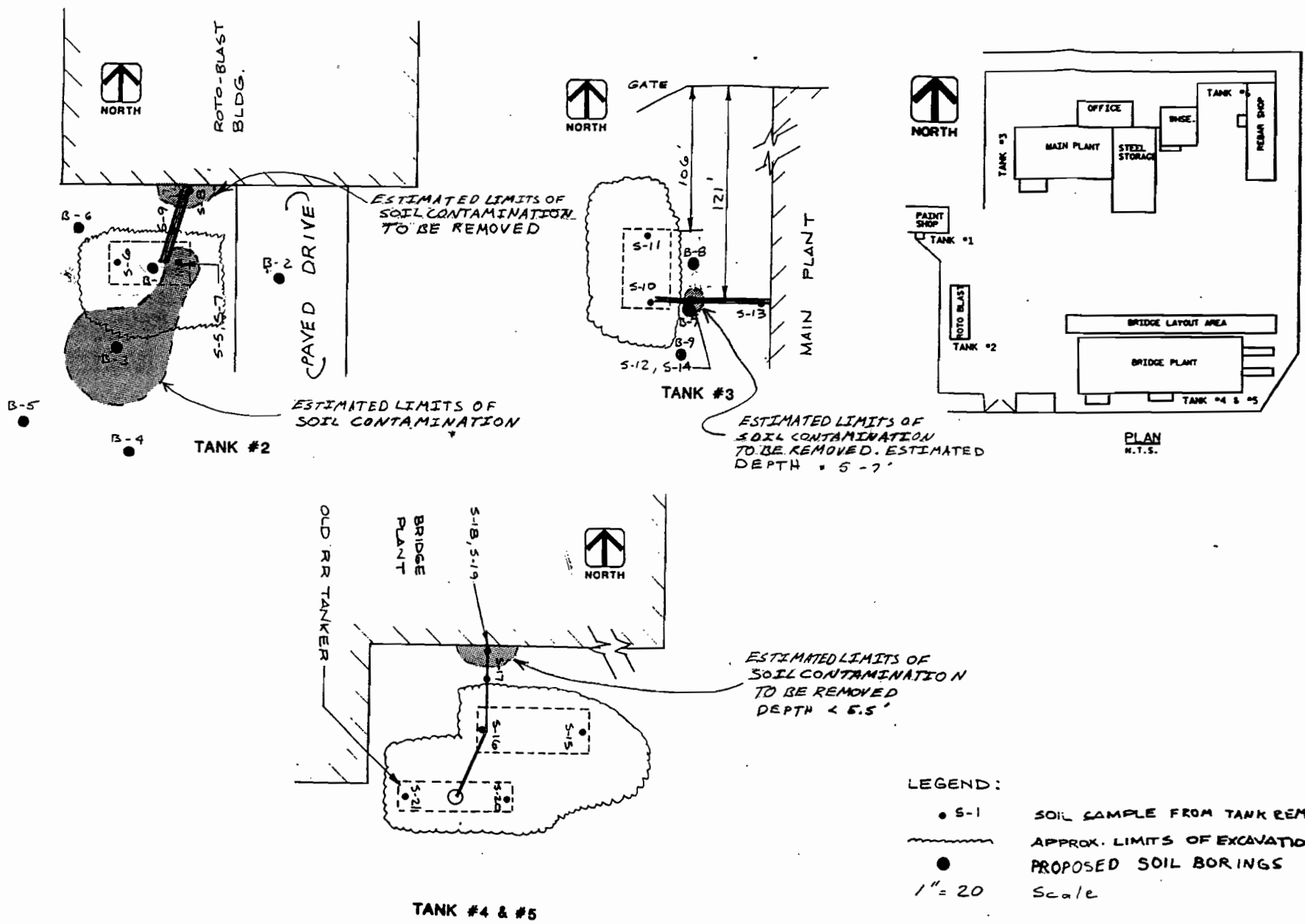

SITE PLAN

DRG. BY: JLE JULY
 CHK. BY: CGS
 DATE: JULY 1992
ARES ASSOCIATES

REMEDIAL INVESTIGATION
 PHOENIX STEEL, INC.
 EAU CLAIRE, WISCONSIN

FIGURE
 2

TABLE 1
SOIL ANALYTICAL RESULTS

TANK AREA	SAMPLE LOCATION	DEPTH (FEET)	FID SCREENING	BENZENE (MG/KG)	ETHYL-BENZENE (MG/KG)	TOLUENE (MG/KG)	XYLENES (MG/KG)	DRO (MG/KG)	SAMPLE ID. NO.
TANK # 2	B-1, S-4	17.5-20	0	ND	ND	0.080	0.089	<0.50	1267
TANK # 2	B-1, S-8	28-30	0	ND	ND	0.050	0.072	<0.50	1268
TANK # 2	B-2, S-6	23-25	0	ND	ND	0.068	0.072	<0.50	1269
TANK # 2	B-3, S-6	23-25	24	ND	ND	0.190	0.157	397.9	1270
TANK # 2	B-3, S-9	30-32	0	ND	ND	0.079	0.066	<0.50	1271
TANK # 2	B-4, S-6	23-25	0	0.092	ND	0.078	0.077	<0.50	1272
TANK # 2	B-5, S-6	23-25	0	ND	ND	0.094	0.074	<0.50	1273
TANK # 2	B-6, S-6	23-25	0	0.124	ND	0.083	0.068	<0.50	1274
TANK # 3	B-7, S-1	2.5-4.5	0	0.100	ND	0.081	0.068	<0.50	1275
TANK # 3	B-7, S-3	7.5-9.5	0	0.100	ND	0.081	0.073	<0.50	1276
TANK # 3	B-8, S-3	7.5-9.5	0	ND	ND	0.075	0.055	<0.50	1277
TANK # 3	B-9, S-3	7.5-9.5	0	0.083	ND	0.169	0.047	<0.50	1278
TANK # 2	QC	----	----	0.100	ND	0.356	0.135	197.0	1279

Method Detection Limits – DRO = 0.5 mg/kg BETX Compounds = 0.01 mg/kg

QC = Quality Control

TABLE 2
SAMPLE SUMMARY
TANK CLOSURE ASSESSMENT

AYRES SAMPLE NO.	TWIN CITY TESTING CORP. SAMPLE NO.	SAMPLE LOCATION	SAMPLE DEPTH (FEET)	FID RESPONSE FIELD/LAB	TPH AS NO. 2 FUEL OIL (PPM)
S-1		Tank No. 1, Piping	4	0/0	
S-2	339	Tank No. 1, East End	14	0/0	ND
S-3	340	Tank No. 1 West End	14	0/0	ND
S-4	341	Tank No. 1 Piping	4	0/0	ND
S-5		Tank No. 2 East End	13	71/44	
S-6	342	Tank No. 2 West End	13	0.4/0	ND
S-7	343	Tank No. 2 East End	16	61/32.2	99
S-8	344	Tank No. 2 Piping	3	86/20	690
S-9		Tank No. 2 Piping	3	32/8.5	
S-10	345	Tank No. 3 South End	16	0/0.3	ND
S-11	346	Tank No. 3 North End	16	0/0	ND
S-12	347	Tank No. 3 Piping	2.5	116/54	70
S-13		Tank No. 3 Piping	2.5	0/0	
S-14	348	Tank No. 3 Piping	4	24/8	84
S-15	349	Tank No. 4 East End	14	0/0	ND
S-16		Tank No. 4 West End	14	0/0	
S-17		Tank No. 4 & 5 Piping	2.5	0/0	
S-18	350	Tank No. 4 & 5 Piping	3.5	8/6	110
S-19	351	Tank No. 4 & 5 Piping	5.5	5/0	ND
S-20		Tank No. 5 East End	10	0/0	
S-21	352	Tank No. 5 West End	10	0/0	ND
S-22		Tank No. 6 Piping	4	0/0	
S-23	353	Tank No. 6 Piping	4	0/0	ND
S-24	354	Tank No. 6 West End	14	0/0	ND
S-25	355	Tank No. 6 East End	14	0/0	ND

ND - No Detect at a Method Detection Limit of 2 PPM