



Meridian Environmental Consulting, LLC

January 19, 2018

Carrie Stoltz
Wisconsin Department of Natural Resources
107 Sutliff Avenue
Rhineland, WI 54501

Subject: **Change Order: Two quarters of Ground Water Monitoring**
Gilman, Wisconsin
PECFA No. 54433-9429-94
DNR BRRTS Nos. 03-61-000650
Meridian No. 05F784

Dear Carrie:

This Change Order follows our email and telephone conversations regarding the above referenced site.

Attached is a summary table of the ground water monitoring completed in 2017. A site map is provided for reference.

As we discussed, the data is consistent with earlier results and Closure is warranted. However, the benzene concentration in PZ-400 is higher than previous results. Although this concentration remains low, the location of PZ-400 relative to the replacement well prompted our suggestion that two more quarters of ground water sampling be completed as a precaution. If the results are similar or lower, than the site should be submitted for Closure with GIS Registry.

Attached is a Change Order using the Usual & Customary Cost Schedule.

Sincerely,
MERIDIAN ENVIRONMENTAL CONSULTING, LLC

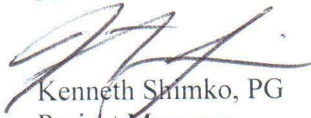
Kenneth Shimko, PG
Project Manager

Usual and Customary Standardized Invoice #22

July 2017 - December 2017



RR-083A

PECFA #: 54433-9429-94
 BRRT's #: 03-61-000650
 Site Name: Webster Pig Farm
 Site Address: Gilman (Donald)

Vendor Name: Change Order
 Invoice #: Change Order
 Invoice Date: January 2018
 Check #: Change Order

U&C Total \$ 5,107.55
 Variance to U&C Total \$ -
 Grand Total \$ 5,107.55

TASK	TASK DESCRIPTION	SERVICES	ACTIVITY CODE	ACTIVITY REFERENCE CODE DESCRIPTION	UNIT	MAX UNIT COST	UNITS	TOTAL MAX
------	------------------	----------	---------------	-------------------------------------	------	---------------	-------	-----------

Two quarters of ground water sampling: MW-200, -300, -400, -500, -600, -900, PZ-100, -200, -300, -400, -600, -900, House water supply. Total = 13 samples x 2 qtrs = 26 samples. PVOC+Naphthalene. Dispose purge water.

1	GW Sampling		GS05	Sample Collection	Well	\$ 72.45	26	\$ 1,883.70
1	GW Sampling		GS25	Primary Mob/Demob	Site	\$ 628.11	2	\$ 1,256.22
4	Waste Disposal	Consultant	WD05	Consultant Coordination	Site	\$ 137.13	1	\$ 137.13
4	Waste Disposal	Commodity	WD10	GW Sample and/or Purge	Drum	\$ 42.11	2	\$ 84.22
4	Waste Disposal	Commodity	WD25	Primary Mob/Demob	Site	\$ 287.70	2	\$ 575.40
33	Schedule Of Laboratory Maximums	Commodity		Laboratory (see task 33 total on Lab Schedule)	Lab Schedule		26	\$ 789.10
36	Change Order Request		COR05	Change Order Request (cost cap exceedance requests)	Change Order	\$ 381.78	1	\$ 381.78

Variance
 Variance

Usual and Customary Standardized Invoice #22

July 2017 - December 2017

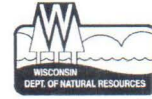

RR-083A

TOTAL LAB CHARGES \$789.10 TASK 33 26 \$789.10 TASK 24 0 \$ -

MATRIX	REF CODE	REIMBURSABLE ANALYTE	UNITS	MAX COST	SAMPLES	TOTAL	MAX COST	SAMPLES	TOTAL
AIR	A1	Benzene	SAMPLE	\$ 44.94		\$ -			
AIR	A2	BETX	SAMPLE	\$ 49.46		\$ -			
AIR	A3	GRO	SAMPLE	\$ 46.10		\$ -			
AIR	A4	VOC's	SAMPLE	\$ 71.93		\$ -			
WATER	W1	GRO/PVOC	SAMPLE	\$ 29.19		\$ -			
WATER	W2	PVOC	SAMPLE	\$ 26.99		\$ -			
WATER	W3	PVOC + 1,2 DCA	SAMPLE	\$ 43.79		\$ -			
WATER	W4	PVOC + Naphthalene	SAMPLE	\$ 30.35	26	\$ 789.10			
WATER	W5	VOC	SAMPLE	\$ 71.93		\$ -			
WATER	W6	PAH	SAMPLE	\$ 72.98		\$ -			
WATER	W7	Lead	SAMPLE	\$ 12.39		\$ -			
WATER	W8	Cadmium	SAMPLE	\$ 13.55		\$ -			
WATER	W9	Hardness	SAMPLE	\$ 12.39		\$ -			
WATER	W10	BOD, Total	SAMPLE	\$ 23.63		\$ -			
WATER	W11	Nitrate	SAMPLE	\$ 11.24		\$ -			
WATER	W12	Total Kjeldahl	SAMPLE	\$ 20.27		\$ -			
WATER	W13	Ammonia	SAMPLE	\$ 16.91		\$ -			
WATER	W14	Sulfate	SAMPLE	\$ 10.19		\$ -			
WATER	W15	Iron	SAMPLE	\$ 10.19		\$ -			
WATER	W16	Manganese	SAMPLE	\$ 10.19		\$ -			
WATER	W17	Alkalinity	SAMPLE	\$ 10.19		\$ -			
WATER	W18	methane	SAMPLE	\$ 46.10		\$ -			
WATER	W19	Phosphorous	SAMPLE	\$ 18.06		\$ -			
WATER	W20	VOC Method 524.2	SAMPLE	\$ 176.30		\$ -			
WATER	W21	EDB Method 504	SAMPLE	\$ 95.45		\$ -			
SOILS	S1	GRO	SAMPLE	\$ 24.78		\$ -	\$ 24.78		\$ -
SOILS	S2	DRO	SAMPLE	\$ 30.35		\$ -	\$ 30.35		\$ -
SOILS	S3	GRO/PVOC	SAMPLE	\$ 28.14		\$ -	\$ 28.14		\$ -
SOILS	S4	PVOC	SAMPLE	\$ 25.83		\$ -	\$ 25.83		\$ -
SOILS	S5	PVOC + 1,2 DCA + Naphthalene	SAMPLE	\$ 49.46		\$ -	\$ 49.46		\$ -
SOILS	S6	PVOC + Naphthalene	SAMPLE	\$ 36.02		\$ -	\$ 36.02		\$ -
SOILS	S7	VOC	SAMPLE	\$ 71.93		\$ -	\$ 71.93		\$ -
SOILS	S8	SPLP Extraction VOC only	SAMPLE	\$ 50.61		\$ -	\$ 50.61		\$ -
SOILS	S9	PAH	SAMPLE	\$ 72.98		\$ -	\$ 72.98		\$ -
SOILS	S10	Lead	SAMPLE	\$ 12.39		\$ -	\$ 12.39		\$ -
SOILS	S11	Cadmium	SAMPLE	\$ 14.60		\$ -			
SOILS	S12	Free Liquid	SAMPLE	\$ 11.24		\$ -			
SOILS	S13	Flash Point	SAMPLE	\$ 25.83		\$ -			
SOILS	S14	Grain Size - dry	SAMPLE	\$ 42.74		\$ -			
SOILS	S15	Grain Size - wet	SAMPLE	\$ 57.33		\$ -			
SOILS	S16	Bulk Density	SAMPLE	\$ 13.55		\$ -			
SOILS	S17	Permeability	SAMPLE	\$ 41.58		\$ -			
SOILS	S18	Nitrogen as Total Kjeldahl	SAMPLE	\$ 20.27		\$ -			
SOILS	S19	Nitrogen as Ammonia	SAMPLE	\$ 16.91		\$ -			
SOILS	S20	% Organic Matter	SAMPLE	\$ 29.19		\$ -			
SOILS	S21	TOC as NPOC	SAMPLE	\$ 57.33		\$ -			
SOILS	S22	Soil Moisture Content	SAMPLE	\$ 6.83		\$ -			
SOILS	S23	Air Filled Porosity	SAMPLE	\$ 25.83		\$ -			
SOILS	S24	% Total Solids	SAMPLE	\$ 6.83		\$ -			
SOILS	S25	Field Capacity	SAMPLE	\$ 28.14		\$ -			
SOILS	S26	TCLP Lead	SAMPLE	\$ 83.16		\$ -			
SOILS	S27	Cation Exchange (Ca, MG, & K)	SAMPLE	\$ 26.99		\$ -			
SOILS	S28	TCLP Cadmium	SAMPLE	\$ 83.16		\$ -			
SOILS	S29	TCLP Benzene	SAMPLE	\$ 83.16		\$ -			
		Viscosity + Density							
LNAPL	LFPS01	Interfacial tension I (LNAPL/water [dyne/cm])	SAMPLE	\$ 561.33		\$ -			
		Interfacial tension II (LNAPL/air [dyne/cm])							
		Interfacial tension III (water/air [dyne/cm])							
						TASK 33 TOTAL	\$	789.10	

MAX COST	SAMPLES	TOTAL
\$ 24.78		\$ -
\$ 30.35		\$ -
\$ 28.14		\$ -
\$ 25.83		\$ -
\$ 49.46		\$ -
\$ 36.02		\$ -
\$ 71.93		\$ -
\$ 50.61		\$ -
\$ 72.98		\$ -
\$ 12.39		\$ -
TASK 24 TOTAL		
		\$ -

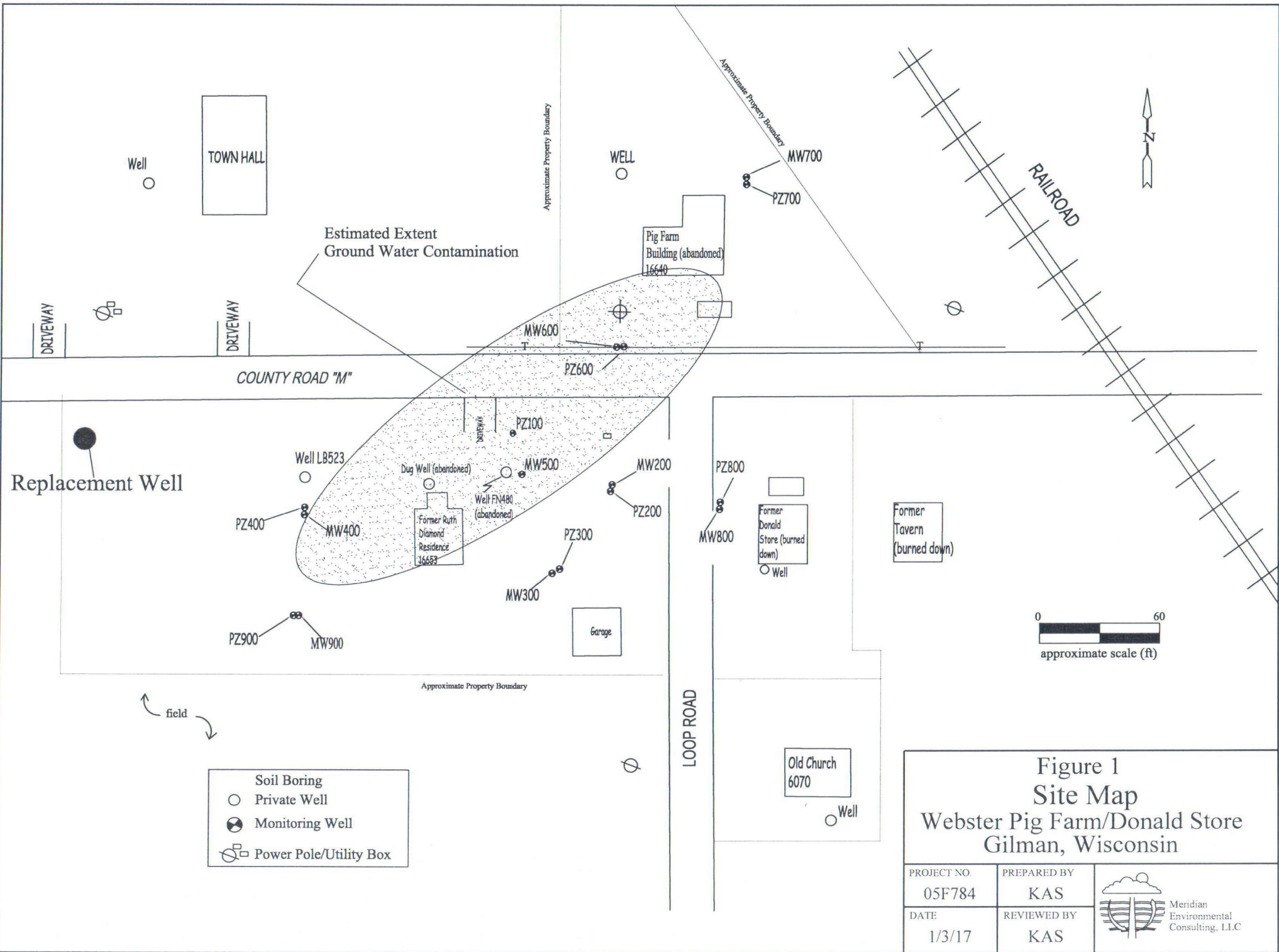

Figure 1
Site Map
Webster Pig Farm/Donald Store
Gilman, Wisconsin

PROJECT NO. 05F784	PREPARED BY KAS	 Meridian Environmental Consulting, L.L.C.
DATE 1/3/17	REVIEWED BY KAS	

Table 1: Ground Water Analytical
 Webster Pig Farm
 Meridian No. 05F784
 Page 1 of 3

Well	Date	Benzene	Ethyl Benzene	Toluene	Total Xylenes	1,2,4 - TMB	1,3,5 - TMB	Total TMBs	MTBE	Naphthalene
NR140 ES		5	700	800	2000	-	-	480	60	100
NR140 PAL		0.5	140	160	400	-	-	96	12	10
Units		ug/l	ug/l	ug/l	ug/l	ug/l	ug/l	ug/l	UG/L	ug/h
MW-100	Installed December 6, 1996									
	1/9/1997	<2	<3	<2	<1	<4	<3	<4	<1	<4
	4/18/1997	<4	<5	<4	<1.2	<5	<5	<5	<1	-
	6/20/1997	<1	<1	<1	<2	-	-	-	-	-
	August 2000	Well Abandoned								
MW-200	Installed December 5, 1996									
	1/9/1997	<2	<3	<2	<1	<4	<3	<4	<1	<4
	4/18/1997	13	1.1	11	3.4	<5	<5	<5	<1	-
	6/20/1997	<1	<1	<1	<2	-	-	-	-	-
	12/20/2006	<2	<5	<2	<5	<2	<2	<2	<5	<25
	4/11/2007	<2	<5	<2	<5	<2	<2	<2	<5	<25
	7/25/2007	<2	<5	<2	<5	<2	<2	<2	<5	<25
	10/23/2007	<2	<5	<2	<5	<2	<2	<2	<5	<25
	1/9/2008	<2	<5	<2	<5	<2	<2	<2	<5	<25
	5/6/2008	<2	<5	<2	<5	<2	<2	<2	<5	<25
	7/29/2008	<25	<22	<25	<39	<25	<19	<25	<23	<25
	8/29/2012	<39	<41	<42	<1.3	<43	<4	<43	<38	<4
	9/9/2015	<4	<39	<39	<1.2	<42	<42	<42	<48	<42
	12/9/2015	<4	<39	<39	<1.2	<42	<42	<42	<48	<42
	3/31/2016	<4	<39	<39	<1.2	<42	<42	<42	<48	<42
	6/21/2016	<4	<39	<39	<1.2	<42	<42	<42	<48	<42
	4/28/2017	<4	<39	<39	<1.2	<42	<42	<42	<48	<42
	10/30/2017	<4	<39	<39	<1.2	<42	<42	<42	<48	<42
MW-300	Installed December 5, 1996									
	1/9/1997	<2	<3	<2	<1	<4	<3	<4	<1	<4
	4/18/1997	<4	<5	<4	<1.2	<5	<5	<5	<1	-
	6/20/1997	<1	<1	<1	0.2	-	-	-	-	-
	12/20/2006	<2	<5	<2	<5	<2	<2	<2	33	<25
	4/11/2007	<2	<5	<2	<5	<2	<2	<2	<5	<25
	5/6/2008	<2	<5	<2	<5	<2	<2	<2	<5	<25
	7/29/2008	<25	<22	<25	<39	<25	<19	<25	<23	<25
	8/29/2012	<39	<41	<42	<1.3	<43	<4	<43	<38	<4
	9/9/2015	<4	<39	<39	<1.2	<42	<42	<42	<48	<42
	12/9/2015	<4	<39	<39	<1.2	<42	<42	<42	<48	<42
	3/31/2016	<4	<39	<39	<1.2	<42	<42	<42	<48	<42
	6/21/2016	<4	<39	<39	<1.2	<42	<42	<42	<48	<42
	4/28/2017	<4	<39	<39	<1.2	<42	<42	<42	<48	<42
	10/30/2017	<4	<39	<39	<1.2	<42	<42	<42	<48	<42
MW-400	Installed December 4, 1996									
	1/9/1997	<2	<3	<2	<1	<4	<3	<4	<1	<4
	4/18/1997	0.8	<5	<4	1.2	<5	0.7	0.7	0.9	-
	6/20/1997	<1	<1	<1	<2	-	-	-	-	-
	12/20/2006	<2	<5	<2	<5	<2	<2	<2	<5	0.67
	4/11/2007	<2	<5	<2	<5	<2	<2	<2	<5	<25
	7/25/2007	<2	<5	<2	<5	<2	<2	<2	<5	<25
	10/23/2007	<2	<5	<2	<5	<2	<2	<2	<5	<25
	1/9/2008	<2	<5	<2	<5	<2	<2	<2	<5	<25
	5/6/2008	<2	<5	<2	<5	<2	<2	<2	<5	<25
	7/29/2008	<25	<22	<25	<39	<25	<19	<25	<23	<25
	8/29/2012	<39	<41	<42	<1.3	<43	<4	<43	<38	<4
	9/9/2015	<4	<39	<39	<1.2	<42	<42	<42	<48	<42
	12/9/2015	<4	<39	<39	<1.2	<42	<42	<42	<48	<42
	3/31/2016	<4	<39	<39	<1.2	<42	<42	<42	<48	<42
	6/21/2016	<4	<39	<39	<1.2	<42	<42	<42	<48	<42
	4/28/2017	<4	<39	<39	<1.2	<42	<42	<42	<48	<42
	10/30/2017	<4	<39	<39	<1.2	<42	<42	<42	<48	<42
MW-500	Installed December 6, 1996									
	1/9/1997	<2	<3	0.3	<1	<4	<3	<4	<1	<4
	4/18/1997	<4	<5	<4	<1.2	<5	<5	<5	<1	-
	6/20/1997	<1	<1	<1	<2	-	-	-	-	-
	12/20/2006	4	<5	<2	<5	<2	<2	<2	<5	0.31
	4/11/2007	<2	<5	<2	<5	<2	<2	<2	<5	<25
	7/25/2007	<2	<5	<2	<5	<2	<2	<2	<5	<25
	5/6/2008	<2	<5	<2	<5	<2	<2	<2	<5	<25
	7/29/2008	<25	<22	<25	<39	<25	<19	<25	<23	<25
	8/29/2012	<39	<41	<42	<1.3	<43	<4	<43	<38	<4
	9/9/2015	<4	<39	<39	<1.2	<42	<42	<42	<48	<42
	12/9/2015	<4	<39	<39	<1.2	<42	<42	<42	<48	<42
	3/31/2016	<4	<39	<39	<1.2	<42	<42	<42	<48	<42
	6/21/2016	<4	<39	<39	<1.2	<42	<42	<42	<48	<42
	4/28/2017	<4	<39	<39	<1.2	<42	<42	<42	<48	<42
	10/30/2017	<4	<39	<39	<1.2	<42	<42	<42	<48	<42
MW-600	Installed April 14, 1997									
	4/18/1997	3090	554	2900	2066	293	82	375	<3.6	130
	6/20/1997	1200	1330	8290	6730	-	-	-	-	-
	5/6/2008	2100	1100	1500	3400	950	270	1220	<20	360
	7/29/2008	790	670	1000	2600	930	330	1260	<23	390
	8/29/2012	111	118	117	354	196	170	366	6.2	130
	8/8/2014	181	237	179	446	180	91.7	271.7	7.8	154
	11/18/2014	107	135	67.3	306	127	83.5	210.5	12.4	102
	9/9/2015	71	100	46.5	292	116	120	236	8.4	107
	12/9/2015	75.7	93.5	39.3	259	74.2	65.2	139.4	3	121
	3/31/2016	85.6	144	67.5	482	122	181	303	5.2	195
	6/21/2016	55.7	85.5	61.8	372	81	137	218	6.1	162
	4/28/2017	22.1	71.1	52.7	399	41.7	116	157.7	8.5	179
	10/30/2017	63.2	505	9.3	860	375	201	576	9.3	334

Table 1: Ground Water Analytical
 Webster Pig Farm
 Meridian No. 05F784
 Page 3 of 3

Well	Date	Benzene	Ethyl Benzene	Toluene	Total Xylenes	1,2,4 - TMB	1,3,5 - TMB	Total TMBs	MTBE	Naphthalene
NR140 ES		5	700	800	2000	-	-	480	60	100
NR140 PAL		0.5	140	160	400			96	12	10
Units		ug/l	ug/l	ug/l	ug/l	ug/l	ug/l	ug/l	UG/L	ug/l
PZ-600 Installed April 14, 1997										
	4/18/1997	< 3	< 4	< 5	< 1.4	< 5	< 4	< 4	< 2	< 4
	6/20/1997	114	< 1	2.1	12.4	-	-	-	-	-
	5/6/2008	6300	37	200	920	160	46	206	< 10	40
	7/29/2008	520	17	60	220	60	18	78	< 2.3	17
	8/29/2012	175	126	223	489	177	87.1	264.1	18	156
	8/8/2014	190	156	323	583	217	137	354	< 2.4	198
	11/18/2014	6.1	< 39	3.8	7.5	1.8	0.87	2.67	< 4.8	2.7
	9/9/2015	98.2	131	230	346	129	120	249	16.6	200
	12/9/2015	110	133	269	417	126	131	257	< 1.9	203
	3/31/2016	240	32.7	290	395	93.6	124	217.6	< 2.4	104
	6/21/2016	434	104	384	534	172	158	330	< 4.8	232
	4/28/2017	215	5.9	102	68.4	11.4	15.6	27	< 4.8	10
	10/30/2017	544	98.8	241	403	128	136	264	12.5	204
PZ-700 Installed April 15, 1997										
	4/19/1997	< 3	< 4	< 5	< 1.4	< 5	< 4	< 5	< 2	< 4
	6/20/1997	< 1	< 1	< 1	< 2	-	-	-	-	-
	5/6/2008	< 2	< 5	< 2	< 5	< 2	< 2	< 2	< 5	< 25
	7/29/2008	< 25	< 22	< 25	< 39	< 25	< 19	< 25	< 23	< 25
	8/29/2012	< 39	< 41	< 42	< 1.3	< 4.3	< 4	< 4.3	< 3.8	< 4
	9/9/2015	Not Sampled								
	12/9/2015	Not Sampled								
	4/28/2017	Not Sampled								
	10/30/2017	Not Sampled								
PZ-800 Installed June 10, 1997 (this well is now sampled as part of Donald Store work)										
	6/20/1997	0.3	< 4	< 5	< 1.4	< 5	< 4	< 5	< 2	< 4
	8/29/2012	< 39	< 41	< 42	< 1.3	< 4.3	< 4	< 4.3	< 3.8	< 4
	9/9/2015	Not Sampled								
	12/9/2015	Not Sampled								
	4/28/2017	Well sampled as part of Donald Store site								
	10/30/2017	Well sampled as part of Donald Store site								
PZ-900 Installed June 11, 1997										
	6/20/1997	1.3	< 4	< 5	< 1.4	< 5	< 4	< 5	< 2	< 4
	5/6/2008	< 2	< 5	< 2	< 5	< 2	< 2	< 2	< 5	< 25
	7/29/2008	< 25	< 22	< 25	< 39	< 25	< 19	< 25	< 23	< 25
	8/29/2012	< 39	< 41	< 42	< 1.3	< 4.3	< 4	< 4.3	< 3.8	< 4
	9/9/2015	< 4	< 39	< 39	< 1.2	< 4.2	< 4.2	< 4.2	< 4.8	< 4.2
	12/9/2015	< 4	< 39	< 39	< 1.2	< 4.2	< 4.2	< 4.2	< 4.8	< 4.2
	3/31/2016	< 4	< 39	< 39	< 1.2	< 4.2	< 4.2	< 4.2	< 4.8	< 4.2
	6/21/2016	< 4	< 39	< 39	< 1.2	< 4.2	< 4.2	< 4.2	< 4.8	< 4.2
	4/28/2017	< 4	< 39	< 39	< 1.2	< 4.2	< 4.2	< 4.2	< 4.8	< 4.2
	10/30/2017	< 4	< 39	< 39	< 1.2	< 4.2	< 4.2	< 4.2	< 4.8	< 4.2
Krizan (Ika Ruth Diamond property) (W16653 CTH M) (installed 1998)										
	7/25/2007	< 2	< 5	< 2	< 5	< 2	< 2	< 2	< 5	< 25
	1/9/2008	< 2	< 5	< 2	< 5	< 2	< 2	< 2	< 5	< 25
	7/29/2008	< 2	< 5	< 2	< 5	< 2	< 2	< 2	< 5	< 25
	8/29/2012	< 39	< 41	< 42	< 1.3	< 4.3	< 4	< 4.3	< 3.8	< 4
	3/8/2014	< 4	< 39	< 39	< 1.2	< 4.2	< 4.2	< 4.2	< 4.8	< 4.2
	11/18/2014	< 4	< 39	< 39	< 1.2	< 4.2	< 4.2	< 4.2	< 4.8	< 4.2
	9/9/2015	< 4	< 39	< 39	< 1.2	< 4.2	< 4.2	< 4.2	< 4.8	< 4.2
	12/9/2015	< 4	< 39	< 39	< 1.2	< 4.2	< 4.2	< 4.2	< 4.8	< 4.2
	3/31/2016	< 4	< 39	< 39	< 1.2	< 4.2	< 4.2	< 4.2	< 4.8	< 4.2
	6/21/2016	< 4	< 39	< 39	< 1.2	< 4.2	< 4.2	< 4.2	< 4.8	< 4.2
Replacement Well Installed October 2016										
	10/7/2016	< 5	< 5	< 5	< 1	< 5	< 5	< 1	< 17	< 2.5
	10/8/2016	< 5	< 5	< 5	< 1	< 5	< 5	< 1	< 17	< 2.5
	1/24/2017	< 4	< 39	< 39	< 1.2	< 4.2	< 4.2	< 4.2	< 4.8	< 4.2
	4/28/2017	< 4	< 39	< 39	< 1.2	< 4.2	< 4.2	< 4.2	< 4.8	< 4.2
	7/19/2017	< 4	< 39	< 39	< 1.2	< 4.2	< 4.2	< 4.2	< 4.8	< 4.2
	10/30/2017	< 4	< 39	< 39	< 1.2	< 4.2	< 4.2	< 4.2	< 4.8	< 4.2
Pig Farm well (grab sample from top of water column due to pipe in well)										
	8/6/2014	< 4	< 39	< 39	< 1.2	< 4.2	< 4.2	< 4.2	< 4.8	< 4.2
	11/18/2014	< 4	< 39	< 39	< 1.2	< 4.2	< 4.2	< 4.2	< 4.8	< 4.2
	(yield test) 2/18/2016	< 4	< 39	< 39	< 1.2	< 4.2	< 4.2	< 4.2	< 4.8	< 4.2
Old Church Well										
	8/29/2012	< 39	< 41	< 42	< 1.3	< 4.3	< 4	< 4.3	< 3.8	< 4
	(yield test) 2/16/2016	< 4	< 39	98J	< 1.2	< 4.2	< 4.2	< 4.2	< 4.8	< 4.2
Town Hall well (outside faucet)										
	10/28/2012	< 39	< 41	< 42	< 1.3	< 4.3	< 4	< 4.3	< 3.8	< 4
	(yield test) 2/16/2016	< 4	< 39	< 39	< 1.2	< 4.2	< 4.2	< 4.2	< 4.8	< 4.2
T-1 Installed 10/18/12										
	10/26/2012	6.1	322	< 2.1	1130	654	205	859	18.4	168
	Abandoned 8/4/14 due to excavation									
T-2 Installed 10/18/12										
	10/26/2012	2990	1740	5820	6950	875	257	1132	38	349
	Abandoned 8/4/14 due to excavation									
T-3 Installed 10/18/12										
	10/26/2012	10.2	< 41	1.6	< 1.3	< 4.3	0.85	0.85	< 3.8	4

12 Concentration exceeds NR140 Enforcement Standard
 12 Concentration exceeds PAL