



## Meridian Environmental Consulting, LLC

---

March 31, 2019

Carrie Stoltz  
Wisconsin Department of Natural Resources  
107 Sutliff Avenue  
Rhineland, WI 54501

Subject:       **Change Order:**

- **Vapor Intrusion**
- **Ground Water Sampling**

Webster Pig Farm  
Gilman, Wisconsin  
PECFA No. 54433-9429-94  
DNR BRRTS Nos. 03-61-000650  
Meridian No. 05F784

Dear Carrie:

This Change Order is to complete Vapor Intrusion and Ground Water Sampling at the above referenced site.

### **Assess Vapor Intrusion Potential at W16653 (former Diamond residence)**

The ground water contamination extends under the residence known as W16653 CTH M, Gilman (Donald)(see Figure). The potential for petroleum vapors from this plume entering the residence will need to be assessed for Closure.

Meridian will install two vapor sampling points (Cox Colvin) in the basement of the residence. A sample of the subslab soil vapor will be collected from each sample port using standard vapor intrusion air sampling techniques. The air samples will be collected in a 6 liter Summa Canister and analyzed for PVOC+Naphthalene using method TO-15. The sample points will be sampled twice: April and July 2019 (representing winter and summer conditions). This data will be used to quantify the potential (if any) for petroleum vapors to impact the residence.

### **Ground Water Sampling**

The project is nearing Closure. Two rounds of ground water samples should be collected from all of the monitoring wells (MW-200, -300, -400, -500, -600, -700, -900, PZ-100, -200, -300, -400, -600, -700, and PZ-900)(wells MW-800, PZ-800 are sampled as part of Donald Store site) as well as from the onsite water supply and from the Town Hall. Monitoring wells MW-700 & PZ-700 are damaged and will require some modification/repair to be sampled. We will forward pictures from the field documenting the work to be completed for prior DNR approval.

**Letter Report**

A letter report will be prepared documenting the work and include our recommendations to achieve Closure.

We will proceed upon receipt of authorization.

Sincerely,  
**MERIDIAN ENVIRONMENTAL CONSULTING, LLC**

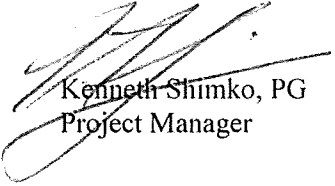

Kenneth Shimko, PG  
Project Manager

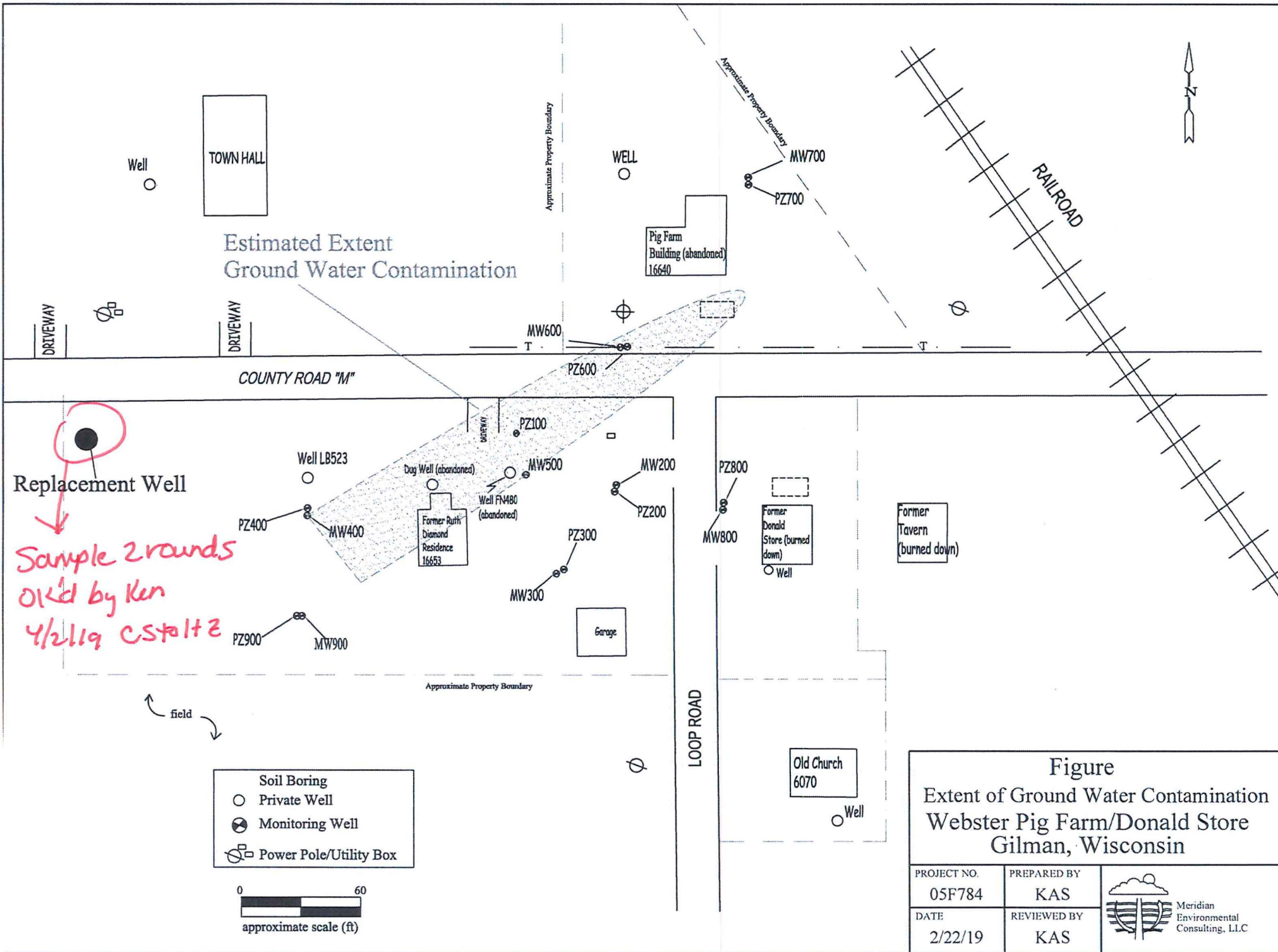



# Usual and Customary Standardized Invoice #25

## January 2019 - June 2019 (updated 2/25/19)



PECFA #: 54433942994  
 BRRTS #: 361000650  
 Site Name: Webster Pig Farm  
 Site Address: Gilman (Donald)

Vendor Name: Change Order  
 Invoice #: Change Order  
 Invoice Date: April 2019  
 Check #: Change Order

U&C Total \$ 10,703.95  
 Variance to U&C Total \$ 880.00  
 Grand Total \$ 11,583.95

TASK	TASK DESCRIPTION	SERVICES	ACTIVITY CODE	ACTIVITY REFERENCE CODE DESCRIPTION	UNIT	MAX UNIT COST	UNITS	TOTAL MAX
<b>Sample monitoring wells (MW-200, 300,400,500,600,700,900, PZ-100,200,300,400,600,700,900, onsite well, Town Hall well) - 2 events. 16 wells x 2 events = 32 samples. (PVOC+Naph). Dispose purge water.</b>								
1	GW Sampling		GS05	Sample Collection	Well	\$ 72.45	<del>32</del> 34	\$ 2,318.40
1	GW Sampling		GS25	Primary Mob/Demob	Site	\$ 690.92	2	\$ 1,381.84
4	Waste Disposal	Commodity	WD10	GW Sample and/or Purge	Drum	\$ 42.11	2	\$ 84.22
4	Waste Disposal	Commodity	WD25	Primary Mob/Demob	Site	\$ 316.47	2	\$ 632.94
6	Letter Report/Addendum		LRA05	Letter Report/Addendum	Letter	\$1,039.29	<del>2</del> 1	\$ 2,078.58
33	Schedule Of Laboratory Maximums	Commodity		Laboratory (see task 33 total on Lab Schedule)	Lab Schedule			\$ 971.20
36	Change Order Request		COR05	Change Order Request (cost cap exceedance requests)	Change Order	\$ 381.78	1	\$ 381.78
<b>Install two vapor pins in basement. Sample 2X. TO-15 (PVOC+Naph).</b>								
37	Vapor Point Installation & Sampling		VIS05	Installation & Sampling (up to 5 points)	Point	\$ 510.26	4	\$ 2,041.04
37	Vapor Point Installation & Sampling		VIS10	Mob/Demob (up to 5 points)	Site	\$ 813.95	1	\$ 813.95
Variance				Vapor Intrusion Sampling (6L Summa - To-15) (PVOC+N) (2 points x 2 events = 4 samples)	Sample	\$ 220.00	4	\$ 880.00
Variance								

\* changes ok'd  
 by Ken 4/2/19  
 -CStoltz

# Usual and Customary Standardized Invoice #25

## January 2019 - June 2019 (updated 2/25/19)



RR-107a

TOTAL LAB CHARGES \$ 971.20 TASK 33 32 \$ 971.20 TASK 24 0 \$ -

MATRIX	REF CODE	REIMBURSABLE ANALYTE	UNITS	MAX COST	SAMPLES	TOTAL	MAX COST	SAMPLES	TOTAL
AIR	A1	Benzene	SAMPLE	\$ 44.94		\$ -			
AIR	A2	BETX	SAMPLE	\$ 49.46		\$ -			
AIR	A3	GRO	SAMPLE	\$ 46.10		\$ -			
AIR	A4	VOC's	SAMPLE	\$ 71.93		\$ -			
WATER	W1	GRO/PVOC	SAMPLE	\$ 29.19		\$ -			
WATER	W2	PVOC	SAMPLE	\$ 26.99		\$ -			
WATER	W3	PVOC + 1,2 DCA	SAMPLE	\$ 43.79		\$ -			
WATER	W4	PVOC + Naphthalene	SAMPLE	\$ 30.35	32	971.20			
WATER	W5	VOC	SAMPLE	\$ 71.93		\$ -			
WATER	W6	PAH	SAMPLE	\$ 72.98		\$ -			
WATER	W7	Lead	SAMPLE	\$ 12.39		\$ -			
WATER	W8	Cadmium	SAMPLE	\$ 13.55		\$ -			
WATER	W9	Hardness	SAMPLE	\$ 12.39		\$ -			
WATER	W10	BOD, Total	SAMPLE	\$ 23.63		\$ -			
WATER	W11	Nitrate	SAMPLE	\$ 11.24		\$ -			
WATER	W12	Total Kjeldahl	SAMPLE	\$ 20.27		\$ -			
WATER	W13	Ammonia	SAMPLE	\$ 16.91		\$ -			
WATER	W14	Sulfate	SAMPLE	\$ 10.19		\$ -			
WATER	W15	Iron	SAMPLE	\$ 10.19		\$ -			
WATER	W16	Manganese	SAMPLE	\$ 10.19		\$ -			
WATER	W17	Alkalinity	SAMPLE	\$ 10.19		\$ -			
WATER	W18	methane	SAMPLE	\$ 46.10		\$ -			
WATER	W19	Phosphorous	SAMPLE	\$ 18.06		\$ -			
WATER	W20	VOC Method 524.2	SAMPLE	\$ 176.30		\$ -			
WATER	W21	EDB Method 504	SAMPLE	\$ 95.45		\$ -			
SOILS	S1	GRO	SAMPLE	\$ 24.78		\$ -	\$ 24.78		\$ -
SOILS	S2	DRO	SAMPLE	\$ 30.35		\$ -	\$ 30.35		\$ -
SOILS	S3	GRO/PVOC	SAMPLE	\$ 28.14		\$ -	\$ 28.14		\$ -
SOILS	S4	PVOC	SAMPLE	\$ 25.83		\$ -	\$ 25.83		\$ -
SOILS	S5	PVOC + 1,2 DCA + Naphthalene	SAMPLE	\$ 49.46		\$ -	\$ 49.46		\$ -
SOILS	S6	PVOC + Naphthalene	SAMPLE	\$ 36.02		\$ -	\$ 36.02		\$ -
SOILS	S7	VOC	SAMPLE	\$ 71.93		\$ -	\$ 71.93		\$ -
SOILS	S8	SPLP Extraction VOC only	SAMPLE	\$ 50.61		\$ -	\$ 50.61		\$ -
SOILS	S9	PAH	SAMPLE	\$ 72.98		\$ -	\$ 72.98		\$ -
SOILS	S10	Lead	SAMPLE	\$ 12.39		\$ -	\$ 12.39		\$ -
SOILS	S11	Cadmium	SAMPLE	\$ 14.60		\$ -			
SOILS	S12	Free Liquid	SAMPLE	\$ 11.24		\$ -			
SOILS	S13	Flash Point	SAMPLE	\$ 25.83		\$ -			
SOILS	S14	Grain Size - dry	SAMPLE	\$ 42.74		\$ -			
SOILS	S15	Grain Size - wet	SAMPLE	\$ 57.33		\$ -			
SOILS	S16	Bulk Density	SAMPLE	\$ 13.55		\$ -			
SOILS	S17	Permeability	SAMPLE	\$ 41.58		\$ -			
SOILS	S18	Nitrogen as Total Kjeldahl	SAMPLE	\$ 20.27		\$ -			
SOILS	S19	Nitrogen as Ammonia	SAMPLE	\$ 16.91		\$ -			
SOILS	S20	% Organic Matter	SAMPLE	\$ 29.19		\$ -			
SOILS	S21	TOC as NPOC	SAMPLE	\$ 57.33		\$ -			
SOILS	S22	Soil Moisture Content	SAMPLE	\$ 6.83		\$ -			
SOILS	S23	Air Filled Porosity	SAMPLE	\$ 25.83		\$ -			
SOILS	S24	% Total Solids	SAMPLE	\$ 6.83		\$ -			
SOILS	S25	Field Capacity	SAMPLE	\$ 28.14		\$ -			
SOILS	S26	TCLP Lead	SAMPLE	\$ 83.16		\$ -			
SOILS	S27	Cation Exchange (Ca, MG, & K)	SAMPLE	\$ 26.99		\$ -			
SOILS	S28	TCLP Cadmium	SAMPLE	\$ 83.16		\$ -			
SOILS	S29	TCLP Benzene	SAMPLE	\$ 83.16		\$ -			
		Viscosity + Density							
LNAPL	LFPS01	Interfacial tension I (LNAPL/water [dyne/cm])	SAMPLE	\$ 561.33		\$ -			
		Interfacial tension II (LNAPL/air [dyne/cm])							
		Interfacial tension III (water/air) [dyne/cm])							
						TASK 33 TOTAL \$	971.20		

34  
4/2/19  
order by Ken  
-C51012

MAX COST	SAMPLES	TOTAL
\$ 24.78		\$ -
\$ 30.35		\$ -
\$ 28.14		\$ -
\$ 25.83		\$ -
\$ 49.46		\$ -
\$ 36.02		\$ -
\$ 71.93		\$ -
\$ 50.61		\$ -
\$ 72.98		\$ -
\$ 12.39		\$ -
<b>TASK 24 TOTAL</b>		<b>\$ -</b>