



## Meridian Environmental Consulting, LLC

---

April 8, 2019

Carrie Stoltz  
Wisconsin Department of Natural Resources  
107 Sutliff Avenue  
Rhineland, WI 54501

Subject: **Change Order: Proposed Well Nest**  
Webster Pig Farm  
Gilman, Wisconsin  
PECFA No. 54433-9429-94  
DNR BRRTS Nos. 03-61-000650  
Meridian No. 05F784

Dear Carrie:

This Change Order is for the installation and sampling of a well nest to confirm the northern extent of impacted ground water. Please refer to our most recent report (dated February 28, 2019) for data tables and figures.

We recommend a monitoring well nest similar to the current monitoring well nests. That is, a water table well (15 ft deep) adjacent to a piezometer (35 feet deep). The wells will be sampled twice with the current monitoring program.

Sincerely,  
**MERIDIAN ENVIRONMENTAL CONSULTING, LLC**

  
Kenneth Shimko, PG  
Project Manager

Proposed well nest



DISCLAIMER: This map is not guaranteed to be accurate, correct, current, or complete and conclusions drawn are the responsibility of the user.

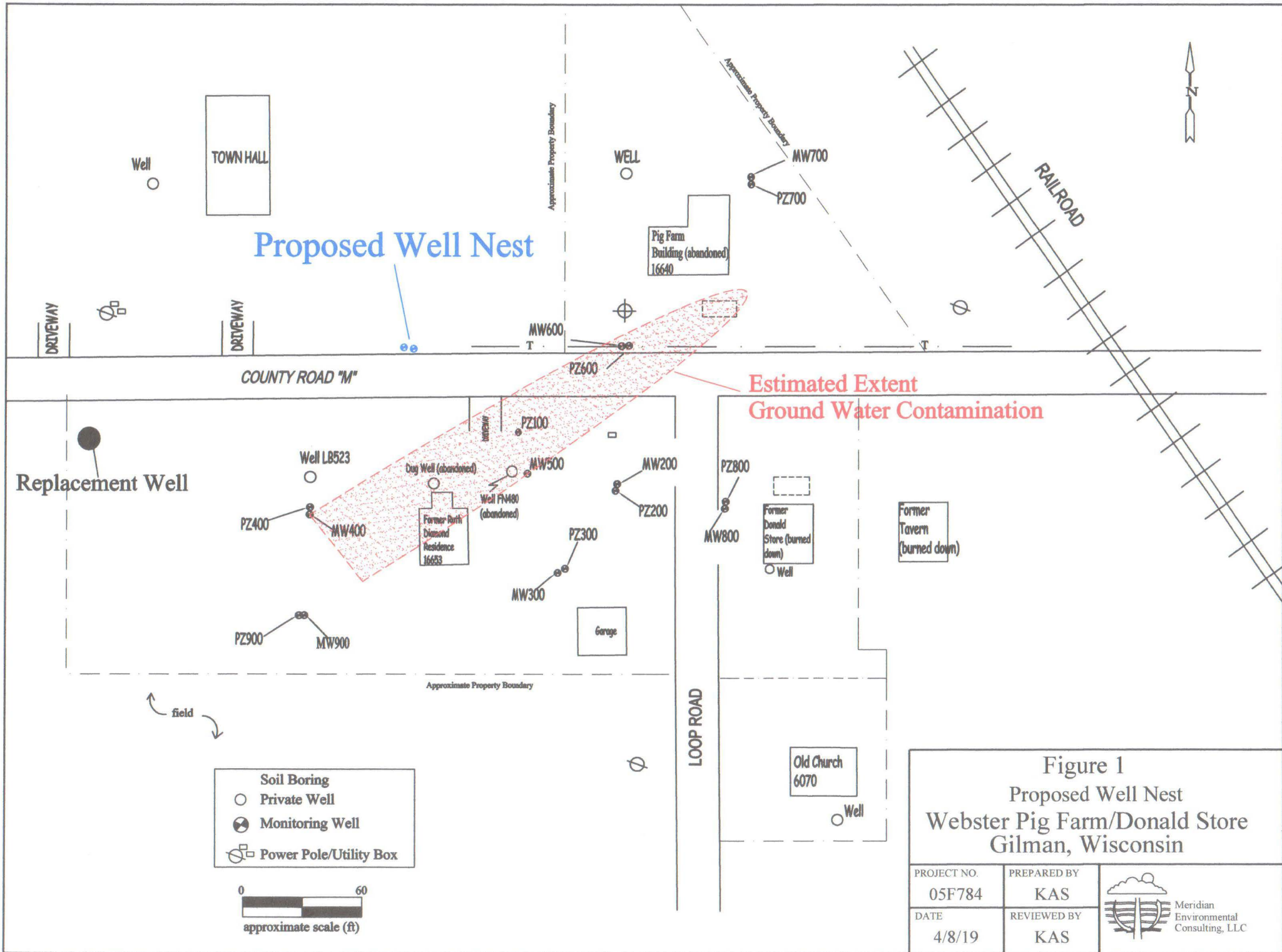

- Soil Boring
- Private Well
- ⊗ Monitoring Well
- ⊗ Power Pole/Utility Box

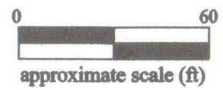



Figure 1  
Proposed Well Nest  
Webster Pig Farm/Donald Store  
Gilman, Wisconsin

PROJECT NO. 05F784	PREPARED BY KAS	 Meridian Environmental Consulting, LLC
DATE 4/8/19	REVIEWED BY KAS	

# Usual and Customary Standardized Invoice #25

## January 2019 - June 2019 (updated 2/25/19)



RR-107a

PECFA #: 54433-9429-94  
 BRRTS #: 361000650  
 Site Name: Webster Pig Farm  
 Site Address: Gilman (Donald)

Vendor Name: Change Order  
 Invoice #: Change Order  
 Invoice Date: April 2019  
 Check #: Change Order

U&C Total \$ 7,311.88  
 Variance to U&C Total \$ -  
 Grand Total \$ 7,311.88

**Install monitoring well nest (15 ft deep water table well + 35 ft deep piezometer). Collect soil samples (continuous) from piezometer but earth drill adjacent water table well. Analyze (PVOC+N) soil sample from smear zone (7 ft). Develop. Survey. Sample 2x (with current sampling program). Dispose soil cuttings (estimate 4 drums).**

TASK	TASK DESCRIPTION	SERVICES	ACTIVITY CODE	ACTIVITY REFERENCE CODE DESCRIPTION	UNIT	MAX UNIT COST	UNITS	TOTAL MAX
1	GW Sampling		GS05	Sample Collection	Well	\$ 72.45	4	\$ 289.80
4	Waste Disposal	Consultant	WD05	Consultant Coordination	Site	\$ 137.13	1	\$ 137.13
4	Waste Disposal	Commodity	WD15	Drill Cuttings	Drum	\$ 108.15	4	\$ 432.60
4	Waste Disposal	Commodity	WD17	Landfill Environmental Fee (provide documentation)	ACTUAL COST			\$ 100.00
4	Waste Disposal	Commodity	WD25	Primary Mob/Demob	Site	\$ 316.47	1	\$ 316.47
10	Initial Site Survey	Consultant	IS10	Subsequent Surveys	Well	\$ 110.15	2	\$ 220.30
13.a	Drilling In Unconsolidated Soils - With Soil Sampling	Consultant	DR05	0 - 25 ft bgs	Ft	\$ 5.40	25	\$ 135.00
13.a	Drilling In Unconsolidated Soils - With Soil Sampling	Consultant	DR10	26 - 50 ft bgs	Ft	\$ 5.67	10	\$ 56.70
13.a	Drilling In Unconsolidated Soils - With Soil Sampling	Consultant	DR20	Primary Mob/Demob	Site	\$ 652.34	1	\$ 652.34
13.b	Drilling In Unconsolidated Soils - Without Soil And/Or GW Sampling	Consultant	DR25	Consultant Oversight	Ft	\$ 1.58	15	\$ 23.70
13.d	Drilling In Unconsolidated Soils - With Soil Sampling	Commodity	DR45	0 - 25 ft bgs	Ft	\$ 16.70	25	\$ 417.50
13.d	Drilling In Unconsolidated Soils - With Soil Sampling	Commodity	DR50	26 - 50 ft bgs	Ft	\$ 18.38	10	\$ 183.80
13.e	Drilling In Unconsolidated Soils - Without Soil And/Or GW Sampling	Commodity	DR60	Drilling in Unconsolidated Soils	Ft	\$ 11.97	15	\$ 179.55
14	Monitoring Well Installation	Consultant	MWI05	0 - 25 ft bgs	Ft	\$ 3.89	40	\$ 155.60
14	Monitoring Well Installation	Consultant	MWI10	26 - 75 ft bgs	Ft	\$ 2.73	10	\$ 27.30
14	Monitoring Well Installation	Commodity	MWI15	2 inch PVC Casing	Ft	\$ 16.70	50	\$ 835.00
14	Monitoring Well Installation	Commodity	MWI20	Well Development	Well	\$ 147.63	2	\$ 295.26
14	Monitoring Well Installation	Commodity	MWI25	Mob/Demob (For development of grout or slurry sealed wells)	Site	\$ 603.49	1	\$ 603.49
15	Misc. Drilling Activities & Supplies		MDT05	Drill Rig Mob/Demob	Mob/Demob	\$ 1,059.72	1	\$ 1,059.72
15	Misc. Drilling Activities & Supplies		MDT10	Well Cover/flushmount	Each	\$ 202.65	2	\$ 405.30
20	Soil Boring/Monitoring Well Permits		SBMWP05	Soil Boring/Monitoring Well Permit	Permit	\$ 246.12	1	\$ 246.12
33	Schedule Of Laboratory Maximums	Commodity		Laboratory (see task 33 total on Lab Schedule)	Lab Schedule			\$ 157.42
36	Change Order Request		COR05	Change Order Request (cost cap exceedance requests)	Change Order	\$ 381.78	1	\$ 381.78

Variance  
 Variance

# Usual and Customary Standardized Invoice #25

## January 2019 - June 2019 (updated 2/25/19)



RR-107a

TOTAL LAB CHARGES \$ 157.42 TASK 33 5 \$ 157.42 TASK 24 0 \$ -

MATRIX	REF CODE	REIMBURSABLE ANALYTE	UNITS	MAX COST	SAMPLES	TOTAL	MAX COST	SAMPLES	TOTAL
AIR	A1	Benzene	SAMPLE	\$ 44.94		\$ -			
AIR	A2	BETX	SAMPLE	\$ 49.46		\$ -			
AIR	A3	GRO	SAMPLE	\$ 46.10		\$ -			
AIR	A4	VOC's	SAMPLE	\$ 71.93		\$ -			
WATER	W1	GRO/PVOC	SAMPLE	\$ 29.19		\$ -			
WATER	W2	PVOC	SAMPLE	\$ 26.99		\$ -			
WATER	W3	PVOC + 1,2 DCA	SAMPLE	\$ 43.79		\$ -			
WATER	W4	PVOC + Naphthalene	SAMPLE	\$ 30.35	4	\$ 121.40			
WATER	W5	VOC	SAMPLE	\$ 71.93		\$ -			
WATER	W6	PAH	SAMPLE	\$ 72.98		\$ -			
WATER	W7	Lead	SAMPLE	\$ 12.39		\$ -			
WATER	W8	Cadmium	SAMPLE	\$ 13.55		\$ -			
WATER	W9	Hardness	SAMPLE	\$ 12.39		\$ -			
WATER	W10	BOD, Total	SAMPLE	\$ 23.63		\$ -			
WATER	W11	Nitrate	SAMPLE	\$ 11.24		\$ -			
WATER	W12	Total Kjeldahl	SAMPLE	\$ 20.27		\$ -			
WATER	W13	Ammonia	SAMPLE	\$ 16.91		\$ -			
WATER	W14	Sulfate	SAMPLE	\$ 10.19		\$ -			
WATER	W15	Iron	SAMPLE	\$ 10.19		\$ -			
WATER	W16	Manganese	SAMPLE	\$ 10.19		\$ -			
WATER	W17	Alkalinity	SAMPLE	\$ 10.19		\$ -			
WATER	W18	methane	SAMPLE	\$ 46.10		\$ -			
WATER	W19	Phosphorous	SAMPLE	\$ 18.06		\$ -			
WATER	W20	VOC Method 524.2	SAMPLE	\$ 176.30		\$ -			
WATER	W21	EDB Method 504	SAMPLE	\$ 95.45		\$ -			
SOILS	S1	GRO	SAMPLE	\$ 24.78		\$ -	\$ 24.78		\$ -
SOILS	S2	DRO	SAMPLE	\$ 30.35		\$ -	\$ 30.35		\$ -
SOILS	S3	GRO/PVOC	SAMPLE	\$ 28.14		\$ -	\$ 28.14		\$ -
SOILS	S4	PVOC	SAMPLE	\$ 25.83		\$ -	\$ 25.83		\$ -
SOILS	S5	PVOC + 1,2 DCA + Naphthalene	SAMPLE	\$ 49.46		\$ -	\$ 49.46		\$ -
SOILS	S6	PVOC + Naphthalene	SAMPLE	\$ 36.02	1	\$ 36.02	\$ 36.02		\$ -
SOILS	S7	VOC	SAMPLE	\$ 71.93		\$ -	\$ 71.93		\$ -
SOILS	S8	SPLP Extraction VOC only	SAMPLE	\$ 50.61		\$ -	\$ 50.61		\$ -
SOILS	S9	PAH	SAMPLE	\$ 72.98		\$ -	\$ 72.98		\$ -
SOILS	S10	Lead	SAMPLE	\$ 12.39		\$ -	\$ 12.39		\$ -
SOILS	S11	Cadmium	SAMPLE	\$ 14.60		\$ -			
SOILS	S12	Free Liquid	SAMPLE	\$ 11.24		\$ -			
SOILS	S13	Flash Point	SAMPLE	\$ 25.83		\$ -			
SOILS	S14	Grain Size - dry	SAMPLE	\$ 42.74		\$ -			
SOILS	S15	Grain Size - wet	SAMPLE	\$ 57.33		\$ -			
SOILS	S16	Bulk Density	SAMPLE	\$ 13.55		\$ -			
SOILS	S17	Permeability	SAMPLE	\$ 41.58		\$ -			
SOILS	S18	Nitrogen as Total Kjeldahl	SAMPLE	\$ 20.27		\$ -			
SOILS	S19	Nitrogen as Ammonia	SAMPLE	\$ 16.91		\$ -			
SOILS	S20	% Organic Matter	SAMPLE	\$ 29.19		\$ -			
SOILS	S21	TOC as NPOC	SAMPLE	\$ 57.33		\$ -			
SOILS	S22	Soil Moisture Content	SAMPLE	\$ 6.83		\$ -			
SOILS	S23	Air Filled Porosity	SAMPLE	\$ 25.83		\$ -			
SOILS	S24	% Total Solids	SAMPLE	\$ 6.83		\$ -			
SOILS	S25	Field Capacity	SAMPLE	\$ 28.14		\$ -			
SOILS	S26	TCLP Lead	SAMPLE	\$ 83.16		\$ -			
SOILS	S27	Cation Exchange (Ca, MG, & K)	SAMPLE	\$ 26.99		\$ -			
SOILS	S28	TCLP Cadmium	SAMPLE	\$ 83.16		\$ -			
SOILS	S29	TCLP Benzene	SAMPLE	\$ 83.16		\$ -			
		Viscosity + Density							
LNAPL	LFPS01	Interfacial tension I (LNAPL/water [dyne/cm])	SAMPLE	\$ 561.33		\$ -			
		Interfacial tension II (LNAPL/air [dyne/cm])							
		Interfacial tension III (water/air) [dyne/cm])							
						TASK 33 TOTAL	\$	157.42	

MAX COST	SAMPLES	TOTAL
\$ 24.78		\$ -
\$ 30.35		\$ -
\$ 28.14		\$ -
\$ 25.83		\$ -
\$ 49.46		\$ -
\$ 36.02		\$ -
\$ 71.93		\$ -
\$ 50.61		\$ -
\$ 72.98		\$ -
\$ 12.39		\$ -
<b>TASK 24 TOTAL</b>		
\$ -		\$ -