

From: Ken Shimko <kshimko.meridianenv@gmail.com>
Sent: Tuesday, July 16, 2019 1:16 PM
To: Stoltz, Carrie R - DNR
Subject: Webster Pig Farm - Proposed Wells
Attachments: Change Order - MWs - July 2019.pdf

Here is Change Order for proposed wells.

I designed wells to match the other wells in the network for consistency.

Kenneth Shimko, PG
Meridian Environmental Consulting, LLC
2711 North Elco Road
Fall Creek, Wisconsin 54742
(715)832-6608 (office)
(715)579-0723 (cell)
Email: kshimko.meridianenv@gmail.com

From: Stoltz, Carrie R - DNR [<mailto:Carrie.Stoltz@wisconsin.gov>]
Sent: Tuesday, July 02, 2019 3:00 PM
To: Ken Shimko <kshimko.meridianenv@gmail.com>
Subject: RE: Webster Pig Farm data table

Hi Ken, this email serves to reiterate our phone call from this PM. Chris & I reviewed this site and feel a well nest is needed to act as a sentinel to protect the town hall well. 2 deeper wells + 1 shallow well (see map attached). I would recommend 2 rounds of sampling from the new wells + town and Krizan PWs. You can supply raw labs after the 1st round. Maybe sample all wells for the final round. If you have any questions, let me know. Thanks, Carrie

We are committed to service excellence.

Visit our survey at <http://dnr.wi.gov/customersurvey> to evaluate how I did.

Carrie Stoltz
Phone (715)365-8942
Carrie.Stoltz@Wisconsin.gov

From: Ken Shimko <kshimko.meridianenv@gmail.com>
Sent: Tuesday, June 25, 2019 10:17 AM
To: Stoltz, Carrie R - DNR <Carrie.Stoltz@wisconsin.gov>
Subject: Webster Pig Farm data table

Kenneth Shimko, PG
Meridian Environmental Consulting, LLC

2711 North Elco Road
Fall Creek, Wisconsin 54742
(715)832-6608 (office)
(715)579-0723 (cell)
Email: kshimko.meridianenv@gmail.com



Meridian Environmental Consulting, LLC

July 16, 2019

Carrie Stoltz
Wisconsin Department of Natural Resources
107 Sutliff Avenue
Rhineland, WI 54501

Subject: **Change Order: Proposed Well Nests (2)**
Webster Pig Farm
Gilman, Wisconsin
PECFA No. 54433-9429-94
DNR BRRTS Nos. 03-61-000650
Meridian No. 05F784

Dear Carrie:

This Change Order is for the installation and sampling of two well nests to confirm the northern and western extent of impacted ground water. Table 1 and Figure 1 are provided for reference. An aerial sketch is also enclosed.

We recommend each monitoring well nest be constructed similar to the current monitoring well nests. That is, a water table well (15 ft deep) adjacent to a piezometer (35 feet deep). The wells will be sampled twice with the current monitoring program.

Sincerely,
MERIDIAN ENVIRONMENTAL CONSULTING, LLC

Kenneth Shimko, PG
Project Manager

Usual and Customary Standardized Invoice #25

January 2019 - June 2019 (updated 2/25/19)



RR-107a

PECFA #: 54433-9429-94
 BRRS #: 361000650
 Site Name: Webster Pig Farm
 Site Address: Gilman (Donald)

Vendor Name: Change Order
 Invoice #: Change Order
 Invoice Date: July 2019
 Check #: Change Order

U&C Total \$ 11,674.19
 Variance to U&C Total \$ -
 Grand Total \$ 11,674.19

Install two monitoring well nests (15 ft deep water table well + 35 ft deep piezometer). Collect soil samples (continuous) from piezometer but earth drill adjacent water table well. Analyze (PVOC+N) soil sample from smear zone (7 ft). Develop. Survey. Sample 2x (with current sampling program). Dispose soil cuttings (estimate 7 drums). Permit (Taylor County) + Access Agreement (Pershing Township). Private well locate.

TASK	TASK DESCRIPTION	SERVICES	ACTIVITY CODE	ACTIVITY REFERENCE CODE DESCRIPTION	UNIT	MAX UNIT COST	UNITS	TOTAL MAX
1	GW Sampling		GS05	Sample Collection	Well	\$ 72.45	8	\$ 579.60
4	Waste Disposal	Consultant	WD05	Consultant Coordination	Site	\$ 137.13	1	\$ 137.13
4	Waste Disposal	Commodity	WD15	Drill Cuttings	Drum	\$ 108.15	7	\$ 757.05
4	Waste Disposal	Commodity	WD17	Landfill Environmental Fee (provide documentation)	ACTUAL COST			\$ 100.00
4	Waste Disposal	Commodity	WD25	Primary Mob/Demob	Site	\$ 316.47	1	\$ 316.47
10	Initial Site Survey	Consultant	IS10	Subsequent Surveys	Well	\$ 110.15	4	\$ 440.60
13.a	Drilling In Unconsolidated Soils - With Soil Sampling	Consultant	DR05	0 - 25 ft bgs	Ft	\$ 5.40	50	\$ 270.00
13.a	Drilling In Unconsolidated Soils - With Soil Sampling	Consultant	DR10	26 - 50 ft bgs	Ft	\$ 5.67	20	\$ 113.40
13.a	Drilling In Unconsolidated Soils - With Soil Sampling	Consultant	DR20	Primary Mob/Demob	Site	\$ 652.34	1	\$ 652.34
13.b	Drilling In Unconsolidated Soils - Without Soil And/Or GW Sampling	Consultant	DR25	Consultant Oversight	Ft	\$ 1.58	30	\$ 47.40
13.d	Drilling In Unconsolidated Soils - With Soil Sampling	Commodity	DR45	0 - 25 ft bgs	Ft	\$ 16.70	50	\$ 835.00
13.d	Drilling In Unconsolidated Soils - With Soil Sampling	Commodity	DR50	26 - 50 ft bgs	Ft	\$ 18.38	20	\$ 367.60
13.e	Drilling In Unconsolidated Soils - Without Soil And/Or GW Sampling	Commodity	DR60	Drilling in Unconsolidated Soils	Ft	\$ 11.97	30	\$ 359.10
14	Monitoring Well Installation	Consultant	MWI05	0 - 25 ft bgs	Ft	\$ 3.89	80	\$ 311.20
14	Monitoring Well Installation	Consultant	MWI10	26 - 75 ft bgs	Ft	\$ 2.73	20	\$ 54.60
14	Monitoring Well Installation	Commodity	MWI15	2 inch PVC Casing	Ft	\$ 16.70	100	\$ 1,670.00
14	Monitoring Well Installation	Commodity	MWI20	Well Development	Well	\$ 147.63	4	\$ 590.52
14	Monitoring Well Installation	Commodity	MWI25	Mob/Demob (For development of grout or slurry sealed wells)	Site	\$ 603.49	1	\$ 603.49
15	Misc. Drilling Activities & Supplies		MDT05	Drill Rig Mob/Demob	Mob/Demob	\$ 1,059.72	1	\$ 1,059.72
15	Misc. Drilling Activities & Supplies		MDT10	Well Cover/flushmount	Each	\$ 202.65	4	\$ 810.60
15	Misc. Drilling Activities & Supplies		MDT41	Private Utility Locate (estimate \$250)	ACTUAL COST			\$ 250.00
20	Soil Boring/Monitoring Well Permits		SBMWP05	Soil Boring/Monitoring Well Permit CTH D	Permit	\$ 246.12	1	\$ 246.12
21	Access Agreements		AA05	Access Agreements	Property	\$ 401.94	1	\$ 401.94
31	Consultant Overnight Per Diem		COPD05	Overnight	Night	\$ 125.09	1	\$ 125.09
33	Schedule Of Laboratory Maximums	Commodity		Laboratory (see task 33 total on Lab Schedule)	Lab Schedule			\$ 193.44
36	Change Order Request		COR05	Change Order Request (cost cap exceedance requests)	Change Order	\$ 381.78	1	\$ 381.78
	Variance							
	Variance							

Usual and Customary Standardized Invoice #25

January 2019 - June 2019 (updated 2/25/19)



RR-107a

TOTAL LAB CHARGES \$ 193.44 TASK 33 6 \$ 193.44 TASK 24 0 \$ -

MATRIX	REF CODE	REIMBURSABLE ANALYTE	UNITS	MAX COST	SAMPLES	TOTAL	MAX COST	SAMPLES	TOTAL
AIR	A1	Benzene	SAMPLE	\$ 44.94		\$ -			
AIR	A2	BETX	SAMPLE	\$ 49.46		\$ -			
AIR	A3	GRO	SAMPLE	\$ 46.10		\$ -			
AIR	A4	VOC's	SAMPLE	\$ 71.93		\$ -			
WATER	W1	GRO/PVOC	SAMPLE	\$ 29.19		\$ -			
WATER	W2	PVOC	SAMPLE	\$ 26.99		\$ -			
WATER	W3	PVOC + 1,2 DCA	SAMPLE	\$ 43.79		\$ -			
WATER	W4	PVOC + Naphthalene	SAMPLE	\$ 30.35	4	\$ 121.40			
WATER	W5	VOC	SAMPLE	\$ 71.93		\$ -			
WATER	W6	PAH	SAMPLE	\$ 72.98		\$ -			
WATER	W7	Lead	SAMPLE	\$ 12.39		\$ -			
WATER	W8	Cadmium	SAMPLE	\$ 13.55		\$ -			
WATER	W9	Hardness	SAMPLE	\$ 12.39		\$ -			
WATER	W10	BOD, Total	SAMPLE	\$ 23.63		\$ -			
WATER	W11	Nitrate	SAMPLE	\$ 11.24		\$ -			
WATER	W12	Total Kjeldahl	SAMPLE	\$ 20.27		\$ -			
WATER	W13	Ammonia	SAMPLE	\$ 16.91		\$ -			
WATER	W14	Sulfate	SAMPLE	\$ 10.19		\$ -			
WATER	W15	Iron	SAMPLE	\$ 10.19		\$ -			
WATER	W16	Manganese	SAMPLE	\$ 10.19		\$ -			
WATER	W17	Alkalinity	SAMPLE	\$ 10.19		\$ -			
WATER	W18	methane	SAMPLE	\$ 46.10		\$ -			
WATER	W19	Phosphorous	SAMPLE	\$ 18.06		\$ -			
WATER	W20	VOC Method 524.2	SAMPLE	\$ 176.30		\$ -			
WATER	W21	EDB Method 504	SAMPLE	\$ 95.45		\$ -			
SOILS	S1	GRO	SAMPLE	\$ 24.78		\$ -	\$ 24.78		\$ -
SOILS	S2	DRO	SAMPLE	\$ 30.35		\$ -	\$ 30.35		\$ -
SOILS	S3	GRO/PVOC	SAMPLE	\$ 28.14		\$ -	\$ 28.14		\$ -
SOILS	S4	PVOC	SAMPLE	\$ 25.83		\$ -	\$ 25.83		\$ -
SOILS	S5	PVOC + 1,2 DCA + Naphthalene	SAMPLE	\$ 49.46		\$ -	\$ 49.46		\$ -
SOILS	S6	PVOC + Naphthalene	SAMPLE	\$ 36.02	2	\$ 72.04	\$ 36.02		\$ -
SOILS	S7	VOC	SAMPLE	\$ 71.93		\$ -	\$ 71.93		\$ -
SOILS	S8	SPLP Extraction VOC only	SAMPLE	\$ 50.61		\$ -	\$ 50.61		\$ -
SOILS	S9	PAH	SAMPLE	\$ 72.98		\$ -	\$ 72.98		\$ -
SOILS	S10	Lead	SAMPLE	\$ 12.39		\$ -	\$ 12.39		\$ -
SOILS	S11	Cadmium	SAMPLE	\$ 14.60		\$ -			
SOILS	S12	Free Liquid	SAMPLE	\$ 11.24		\$ -			
SOILS	S13	Flash Point	SAMPLE	\$ 25.83		\$ -			
SOILS	S14	Grain Size - dry	SAMPLE	\$ 42.74		\$ -			
SOILS	S15	Grain Size - wet	SAMPLE	\$ 57.33		\$ -			
SOILS	S16	Bulk Density	SAMPLE	\$ 13.55		\$ -			
SOILS	S17	Permeability	SAMPLE	\$ 41.58		\$ -			
SOILS	S18	Nitrogen as Total Kjeldahl	SAMPLE	\$ 20.27		\$ -			
SOILS	S19	Nitrogen as Ammonia	SAMPLE	\$ 16.91		\$ -			
SOILS	S20	% Organic Matter	SAMPLE	\$ 29.19		\$ -			
SOILS	S21	TOC as NPOC	SAMPLE	\$ 57.33		\$ -			
SOILS	S22	Soil Moisture Content	SAMPLE	\$ 6.83		\$ -			
SOILS	S23	Air Filled Porosity	SAMPLE	\$ 25.83		\$ -			
SOILS	S24	% Total Solids	SAMPLE	\$ 6.83		\$ -			
SOILS	S25	Field Capacity	SAMPLE	\$ 28.14		\$ -			
SOILS	S26	TCLP Lead	SAMPLE	\$ 83.16		\$ -			
SOILS	S27	Cation Exchange (Ca, MG, & K)	SAMPLE	\$ 26.99		\$ -			
SOILS	S28	TCLP Cadmium	SAMPLE	\$ 83.16		\$ -			
SOILS	S29	TCLP Benzene	SAMPLE	\$ 83.16		\$ -			
		Viscosity + Density							
LNAPL	LFPS01	Interfacial tension I (LNAPL/water [dyne/cm])	SAMPLE	\$ 561.33		\$ -			
		Interfacial tension II (LNAPL/air [dyne/cm])							
		Interfacial tension III (water/air) [dyne/cm])							
						TASK 24 TOTAL	\$ -		
						TASK 33 TOTAL	\$ 193.44		

Proposed Well Nests

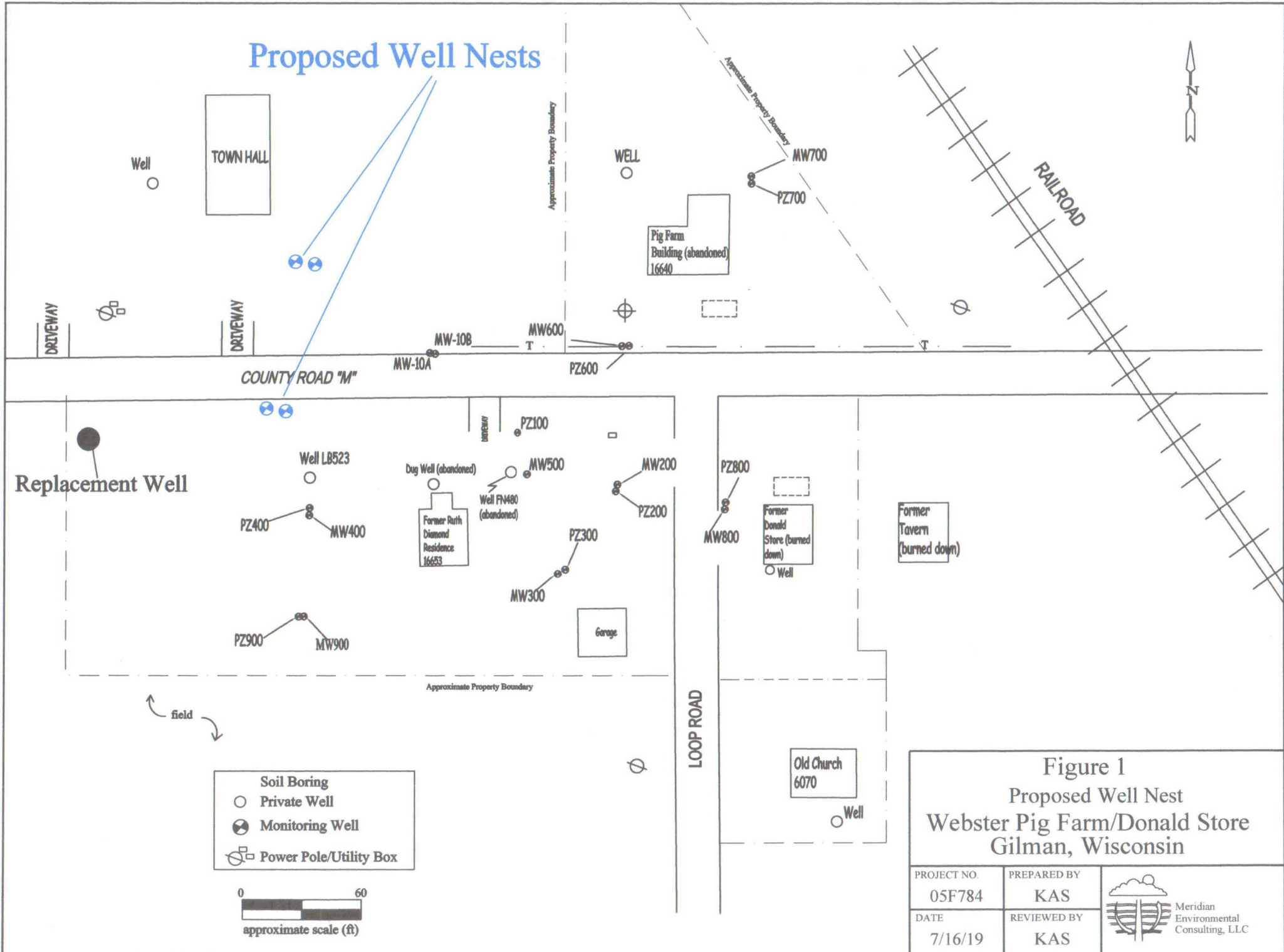



Figure 1
Proposed Well Nest
Webster Pig Farm/Donald Store
Gilman, Wisconsin

PROJECT NO. 05F784	PREPARED BY KAS	 Meridian Environmental Consulting, LLC
DATE 7/16/19	REVIEWED BY KAS	



Proposed well nests

10
00
AB

pw

pw

000000

036002990000

036003000000

000000

PERSHING

036003000000

036003000000

SLOOP RD

03600

17



DISCLAIMER: This map is not guaranteed to be accurate, correct, current, or complete and conclusions drawn are the responsibility of the user.

Table 1: Ground Water Analytical

Webster Pig Farm
Meridian No. 05F784

Well	Date	Benzene	Ethyl Benzene	Toluene	Total Xylenes	1,2,4 - TMB	1,3,5 - TMB	Total TMBs	MTBE	Naphthalene
NR140 ES		5	700	800	2000	-	-	480	60	100
NR140 PAL		0.5	140	160	400			96	12	10
Units		ug/l	ug/l	ug/l	ug/l	ug/l	ug/l	ug/l	UG/L	ug/l
MW-100	Installed December 6, 1996									
	1/9/1997	<2	<3	<2	<1	<4	<3	<4	<1	<4
	4/18/1997	<4	<5	<4	<1.2	<5	<5	<5	<1	-
	6/20/1997	<1	<1	<1	<2	-	-	-	-	-
	August 2000	Well Abandoned								
MW-200	Installed December 5, 1996									
	1/9/1997	<2	<3	<2	<1	<4	<3	<4	<1	<4
	4/18/1997	13	1.1	11	3.4	<5	<5	<5	<1	-
	6/20/1997	<1	<1	<1	<2	-	-	-	-	-
	12/20/2006	<2	<5	<2	<5	<2	<2	<2	<5	<25
	4/11/2007	<2	<5	<2	<5	<2	<2	<2	<5	<25
	7/25/2007	<2	<5	<2	<5	<2	<2	<2	<5	<25
	10/23/2007	<2	<5	<2	<5	<2	<2	<2	<5	<25
	1/9/2008	<2	<5	<2	<5	<2	<2	<2	<5	<25
	5/6/2008	<2	<5	<2	<5	<2	<2	<2	<5	<25
	7/29/2008	<25	<22	<25	<39	<25	<19	<25	<23	<25
	8/29/2012	<39	<41	<42	<1.3	<43	<4	<43	<38	<4
	9/9/2015	<4	<39	<39	<1.2	<42	<42	<42	<48	<42
	12/9/2015	<4	<39	<39	<1.2	<42	<42	<42	<48	<42
	3/31/2016	<4	<39	<39	<1.2	<42	<42	<42	<48	<42
	6/21/2016	<4	<39	<39	<1.2	<42	<42	<42	<48	<42
	4/28/2017	<4	<39	<39	<1.2	<42	<42	<42	<48	<42
	10/30/2017	<4	<39	<39	<1.2	<42	<42	<42	<48	<42
	3/29/2018	<4	<39	<39	<1.2	<42	<42	<42	<48	<42
	6/22/2018	<31	<33	<49	<97	<34	<33	<67	<32	<51
	9/26/2018	<31	<33	<49	<97	<34	<33	<67	<32	<51
	12/5/2018	<31	<33	<49	<97	<34	<33	<67	<32	<51
	5/23/2019	<25	<22	<17	<71	<84	<87	<1.71	<1.2	<1.2
MW-300	Installed December 5, 1996									
	1/9/1997	<2	<3	<2	<1	<4	<3	<4	<1	<4
	4/18/1997	<4	<5	<4	<1.2	<5	<5	<5	<1	-
	6/20/1997	<1	<1	<1	0.2	-	-	-	-	-
	12/20/2006	<2	<5	<2	<5	<2	<2	<2	33	<25
	4/11/2007	<2	<5	<2	<5	<2	<2	<2	<5	<25
	5/6/2008	<2	<5	<2	<5	<2	<2	<2	<5	<25
	7/29/2008	<25	<22	<25	<39	<25	<19	<25	<23	<25
	8/29/2012	<39	<41	<42	<1.3	<43	<4	<43	<38	<4
	9/9/2015	<4	<39	<39	<1.2	<42	<42	<42	<48	<42
	12/9/2015	<4	<39	<39	<1.2	<42	<42	<42	<48	<42
	3/31/2016	<4	<39	<39	<1.2	<42	<42	<42	<48	<42
	6/21/2016	<4	<39	<39	<1.2	<42	<42	<42	<48	<42
	4/28/2017	<4	<39	<39	<1.2	<42	<42	<42	<48	<42
	10/30/2017	<4	<39	<39	<1.2	<42	<42	<42	<48	<42
	3/29/2018	<4	<39	<39	<1.2	<42	<42	<42	<48	<42
	6/22/2018	<31	<33	<49	<97	<34	<33	<67	<32	<51
	9/26/2018	<31	<33	<49	<97	<34	<33	<67	<32	<51
	12/5/2018	<31	<33	<49	<97	<34	<33	<67	<32	<51
	5/23/2019	<25	<22	<17	<71	<84	<87	<1.71	<1.2	<1.2
MW-400	Installed December 4, 1996									
	1/9/1997	<2	<3	<2	<1	<4	<3	<4	<1	<4
	4/18/1997	0.8	<5	<4	1.2	<5	0.7	0.7	0.9	-
	6/20/1997	<1	<1	<1	<2	-	-	-	-	-
	12/20/2006	<2	<5	<2	<5	<2	<2	<2	<5	0.67
	4/11/2007	<2	<5	<2	<5	<2	<2	<2	<5	<25
	7/25/2007	<2	<5	<2	<5	<2	<2	<2	<5	<25
	10/23/2007	<2	<5	<2	<5	<2	<2	<2	<5	<25
	1/9/2008	<2	<5	<2	<5	<2	<2	<2	<5	<25
	5/6/2008	<2	<5	<2	<5	<2	<2	<2	<5	<25
	7/29/2008	<25	<22	<25	<39	<25	<19	<25	<23	<25
	8/29/2012	<39	<41	<42	<1.3	<43	<4	<43	<38	<4
	9/9/2015	<4	<39	<39	<1.2	<42	<42	<42	<48	<42
	12/9/2015	<4	<39	<39	<1.2	<42	<42	<42	<48	<42
	3/31/2016	<4	<39	<39	<1.2	<42	<42	<42	<48	<42
	6/21/2016	<4	<39	<39	<1.2	<42	<42	<42	<48	<42
	4/28/2017	<4	<39	<39	<1.2	<42	<42	<42	<48	<42
	10/30/2017	<4	<39	<39	<1.2	<42	<42	<42	<48	<42
	3/29/2018	<4	<39	<39	<1.2	<42	<42	<42	<48	<42
	6/22/2018	<31	<33	<49	<97	<34	<33	<67	<32	<51
	9/26/2018	<31	<33	<49	<97	<34	<33	<67	<32	<51
	12/5/2018	<31	<33	<49	<97	<34	<33	<67	<32	<51
	5/23/2019	<25	<22	<17	<71	<84	<87	<1.71	<1.2	<1.2

12 BOLD - Concentration exceeds NR140 Enforcement Standard (ES)
12 *Italic* - Concentration exceeds NR140 Preventative Action Limit (PAL)

Table 1: Ground Water Analytical

Webster Pig Farm
Meridian No. 05F784

Well	Date	Benzene	Ethyl Benzene	Toluene	Total Xylenes	1,2,4 - TMB	1,3,5 - TMB	Total TMBs	MTBE	Naphthalene
NR140 ES		5	700	800	2000	-	-	480	60	100
NR140 PAL		0.5	140	160	400	-	-	96	12	10
Units		ug/l	ug/l	ug/l	ug/l	ug/l	ug/l	ug/l	UG/L	ug/l
MW-500	Installed December 6, 1996									
	1/9/1997	<2	<3	0.3	<1	<4	<3	<4	<1	<4
	4/18/1997	<4	<5	<4	<1.2	<5	<5	<5	<1	-
	6/20/1997	<1	<1	<1	<2	-	-	-	-	-
	12/20/2006	4	<5	<2	<5	<2	<2	<2	<5	0.31
	4/11/2007	<2	<5	<2	<5	<2	<2	<2	<5	<25
	7/25/2007	<2	<5	<2	<5	<2	<2	<2	<5	<25
	5/6/2008	<2	<5	<2	<5	<2	<2	<2	<5	<25
	7/29/2008	<25	<22	<25	<39	<25	<19	<25	<23	<25
	8/29/2012	<39	<41	<42	<1.3	<43	<4	<43	<38	<4
	9/9/2015	<4	<39	<39	<1.2	<42	<42	<42	<48	<42
	12/9/2015	<4	<39	<39	<1.2	<42	<42	<42	<48	<42
	3/31/2016	<4	<39	<39	<1.2	<42	<42	<42	<48	<42
	6/21/2016	<4	<39	<39	<1.2	<42	<42	<42	<48	<42
	4/28/2017	<4	<39	<39	<1.2	<42	<42	<42	<48	<42
	10/30/2017	<4	<39	<39	<1.2	<42	<42	<42	<48	<42
	3/29/2018	<4	<39	<39	<1.2	<42	<42	<42	<48	<42
	6/22/2018	<31	<33	<49	<97	<34	<33	<67	<32	<51
	9/26/2018	<31	<33	<49	<97	<34	<33	<67	<32	<51
	12/5/2018	<31	<33	<49	<97	<34	<33	<67	<32	<51
	5/23/2019	<25	<22	<17	<71	<84	<87	<1.71	<1.2	<1.2
MW-600	Installed April 14, 1997									
	4/18/1997	3090	554	2900	2066	293	82	375	<3.6	130
	6/20/1997	1200	1330	8290	6730	-	-	-	-	-
	5/6/2008	2100	1100	1500	3400	950	270	1220	<20	360
	7/29/2008	790	670	1000	2600	930	330	1260	<23	390
	8/29/2012	111	118	117	354	196	170	366	6.2	130
	8/8/2014	181	237	179	446	180	91.7	271.7	7.8	154
	11/18/2014	107	135	67.3	306	127	83.5	210.5	12.4	102
	9/9/2015	71	100	46.5	292	116	120	236	8.4	107
	12/9/2015	75.7	93.5	39.3	259	74.2	65.2	139.4	3	121
	3/31/2016	85.6	144	87.5	482	122	181	303	5.2	195
	6/21/2016	55.7	85.5	61.8	372	81	137	218	6.1	162
	4/28/2017	22.1	71.1	52.7	399	41.7	116	157.7	8.5	179
	10/30/2017	63.2	505	9.3	860	375	201	576	9.3	334
	3/29/2018	74.1	584	180	891	318	158	476	12.8	315
	6/22/2018	27.5	351	151	676	213	133	346	7.1	247
	9/26/2018	4.6J	47.1	17	188	47	72.8	119.8	3.3J	83.2
	12/5/2018	5	34.3	12.6	175	28.9	60.8	89.7	1.9J	89
	5/23/2019	.77J	15.1	6.7	192.71	11.9	113	124.9	<1.2	66.6
MW-700	Installed April 15, 1997									
	4/18/1997	<3	<4	1.2	<1.4	<5	<4	<5	<2	<4
	6/20/1997	<1	<1	<1	<2	-	-	-	-	-
	12/20/2006	<2	<5	<2	<5	<2	<2	<2	<5	<25
	4/11/2007	<2	<5	<2	<5	<2	<2	<2	<5	<25
	7/25/2007	<2	<5	<2	<5	<2	<2	<2	<5	<25
	10/23/2007	<2	<5	<2	<5	<2	<2	<2	<5	<25
	5/6/2008	<2	<5	<2	<5	<2	<2	<2	<5	<25
	7/29/2008	<25	<22	<25	<39	<25	<19	<25	<23	<25
	8/29/2012	<39	<41	<42	<1.3	<43	<4	<43	<38	<4
	9/9/2015	Not Sampled								
	12/9/2015	Not Sampled								
	4/28/2017	Not Sampled								
	10/30/2017	Not Sampled								
	5/23/2019	<25	<22	<17	<71	<84	<87	<1.71	<1.2	<1.2
MW-800	Installed June 10, 1997 (this well is now sampled as part of Donald Store work)									
	6/20/1997	<2	<4	<5	<1.4	<5	<4	<5	<2	<4
	4/11/2007	<2	<5	<2	<5	<5	<4	<5	<5	<25
	7/25/2007	<2	<5	<2	<5	<2	<2	<2	<5	<25
	10/23/2007	<2	<5	<2	<5	<2	<2	<2	<5	<25
	5/6/2008	<2	<5	<2	<5	<2	<2	<2	<5	<25
	7/29/2008	<25	<22	<25	<39	<25	<19	<25	<23	<25
	8/29/2012	<39	<41	<42	<1.3	<43	<4	<43	<38	<4
	9/9/2015	Not Sampled								
	12/9/2015	Not Sampled								
	4/28/2017	Well sampled as part of Donald Store site								
	10/30/2017	Well sampled as part of Donald Store site								
	5/23/2019	Well sampled as part of Donald Store site								
MW-900	Installed June 10, 1997									
	6/20/1997	<2	<4	<5	<1.4	<5	<4	<5	<2	<4
	12/20/2006	<8	<2	<8	<2	<8	<8	<8	<2	<1
	4/11/2007	<2	<5	<2	<5	<2	<2	<2	<5	<25
	7/25/2007	<2	<5	<2	<5	<2	<2	<2	<5	<25
	5/6/2008	<2	<5	<2	<5	<2	<2	<2	<5	<25
	7/29/2008	<25	<22	<25	<39	<25	<19	<25	<23	<25
	8/29/2012	<39	<41	<42	<1.3	<43	<4	<43	<38	<4
	9/9/2015	<4	<39	<39	<1.2	<42	<42	<42	<48	<42
	12/9/2015	<4	<39	<39	<1.2	<42	<42	<42	<48	<42
	3/31/2016	<4	<39	<39	<1.2	<42	<42	<42	<48	<42
	6/21/2016	<4	<39	<39	<1.2	<42	<42	<42	<48	<42
	4/28/2017	<4	<39	<39	<1.2	<42	<42	<42	<48	<42
	10/30/2017	<4	<39	<39	<1.2	<42	<42	<42	<48	<42
	3/29/2018	<4	<39	<39	<1.2	<42	<42	<42	<48	<42
	6/22/2018	<31	<33	<49	<97	<34	<33	<67	<32	<51
	9/26/2018	<31	<33	<49	<97	<34	<33	<67	<32	<51
	12/5/2018	<31	<33	<49	<97	<34	<33	<67	<32	<51
	5/23/2019	<25	<22	<17	<71	<84	<87	<1.71	<1.2	<1.2

12 **BOLD** - Concentration exceeds NR140 Enforcement Standard (ES)
12 *italic* - Concentration exceeds NR140 Preventative Action Limit (PAL)

Table 1: Ground Water Analytical
 Webster Pig Farm
 Meridian No. 05F784

Well	Date	Benzene	Ethyl Benzene	Toluene	Total Xylenes	1,2,4 - TMB	1,3,5 - TMB	Total TMBs	MTBE	Naphthalene
NR140 ES		5	700	800	2000	-	-	480	60	100
NR140 PAL		0.5	140	160	400			96	12	10
Units		ug/l	ug/l	ug/l	ug/l	ug/l	ug/l	ug/l	UG/L	ug/l
MW-10A	Installed 5/8/19									
	5/23/2019	<.25	<.22	<.17	<.71	<.84	<.87	<1.71	<1.2	<1.2
PZ-100	Installed December 18, 1996									
	1/9/1997	3840	<7.4	169	809	95	34	129	<3.1	38
	4/18/1997	3500	<9.8	118	430	43	12	55	<4.5	25
	6/20/1997	3660	<1	97	410	-	-	-	-	-
	12/20/2006	3300	<2	17	50	22	3.8	25.8	<2	28
	4/11/2007	<i>0.64</i>	<.5	<.2	<.5	<.2	<.2	<.2	<.5	<.25
	7/25/2007	1000	21	9	16	9.8	12	21.8	<10	27
	10/23/2007	<i>7.8</i>	<.2	<.8	<.2	<.8	<.8	<.8	<.2	<.1
	1/9/2008	330	<.5	5.7	10	2.6	<.2	2.6	<.5	5.6
	5/6/2008	280	<.5	6.2	5.9	2.2	0.5	2.7	<.5	6.1
	7/29/2008	1100	0	14	12	1.5	0.4	1.9	<4.6	<.5
	8/29/2012	849	<2.1	4.7	<6.3	<2.2	<.2	<2.2	<1.9	2.3
	8/8/2014	<i>1.3</i>	<.39	<.39	<1.2	<.42	<.42	<.42	<.48	<.42
	11/18/2014	<i>6.5</i>	<.39	<.39	<1.2	<.42	<.42	<.42	<.48	<.42
	9/9/2015	6380	<19.8	52.7	<62.4	<20.9	<20.8	<20.9	<24.2	123
	12/9/2015	7810	<19.6	56.4	<62.4	<20.9	<20.8	<20.9	<24.2	71.2
	3/31/2016	5470	<19.6	30.7	<62.4	<20.9	<20.8	<20.9	<24.2	<21.2
	6/21/2016	4100	<15.7	29.7	<49.9	<16.7	<16.6	<16.7	<19.4	<17
	4/28/2017	2350	<9.8	27.3	<31.2	<10.4	<10.4	<10.4	<12.1	<10.6
	10/30/2017	122	<.79	1.8J	<2.5	<.84	<.83	<.84	<.97	2.3
	3/29/2018	1510	<.39	22.5	<12.5	<.42	<.42	<.42	<.48	6.1J
	6/22/2018	2680	<8.2	46	26.3J	<8.6	<8.2	<16.8	<.8	44.9
	9/26/2018	3220	<16.4	72.1J	51.0J	<17.1	<16.4	<33.5	<16	73.9J
	12/5/2018	2710	<8.2	65	56.9J	<8.6	<8.2	<16.8	<.8	82.8
	5/23/2019	572	<5.5	15.8J	<18.1	<21	<21.8	<42.8	<31.1	<29.4
PZ-200	Installed December 17, 1996									
	1/9/1997	<i>0.5</i>	<.3	0.5	<.1	<.4	<.3	<.4	<.1	<.4
	4/18/1997	<i>3</i>	<.4	<.5	<1.4	<.5	<.4	<.5	<.2	0.7
	6/20/1997	<.1	<.1	<.1	<.2	-	-	-	-	-
	5/6/2008	<.2	<.5	<.2	<.5	<.2	<.2	<.2	0.5	<.25
	7/29/2008	<.25	<.22	<.25	<.39	<.25	<.19	<.25	<.23	<.25
	8/29/2012	<.39	<.41	<.42	<1.3	<.43	<.4	<.43	<.38	<.4
	9/9/2015	<.4	<.39	<.39	<1.2	<.42	<.42	<.42	<.48	<.42
	12/9/2015	<.4	<.39	<.39	<1.2	<.42	<.42	<.42	<.48	<.42
	3/31/2016	<.4	<.39	<.39	<1.2	<.42	<.42	<.42	<.48	<.42
	6/21/2016	<.4	<.39	<.39	<1.2	<.42	<.42	<.42	<.48	<.42
	4/28/2017	<.4	<.39	<.39	<1.2	<.42	<.42	<.42	<.48	<.42
	10/30/2017	<.4	<.39	<.39	<1.2	<.42	<.42	<.42	<.48	<.42
	3/29/2018	<.4	<.39	<.39	<1.2	<.42	<.42	<.42	<.48	<.42
	6/22/2018	<.31	<.33	<.49	<.97	<.34	<.33	<.67	<.32	<.51
	9/26/2018	<.31	<.33	<.49	<.97	<.34	<.33	<.67	<.32	<.51
	12/5/2018	<.31	<.33	<.49	<.97	<.34	<.33	<.67	<.32	<.51
	5/23/2019	<.25	<.22	<.17	<.71	<.84	<.87	<1.71	<1.2	<1.2
PZ-300	Installed December 17, 1996									
	1/9/1997	12	<.3	1.9	<.1	<.4	<.3	<.4	<.1	<.4
	4/18/1997	<i>3</i>	<.4	<.5	<1.4	<.5	<.4	<.5	<.2	<.4
	6/20/1997	5.3	<.1	<.1	<.2	-	-	-	-	-
	5/6/2008	<.2	<.5	<.2	<.5	<.2	<.2	<.2	24	<.25
	7/29/2008	<.25	<.22	<.25	<.39	<.25	<.19	<.25	21	<.25
	8/29/2012	<.39	<.41	<.42	<1.3	<.43	<.4	<.43	1.6	<.4
	9/9/2015	<.4	<.39	<.39	<1.2	<.42	<.42	<.42	0.57	<.42
	12/9/2015	<.4	<.39	<.39	<1.2	<.42	<.42	<.42	<.48	<.42
	3/31/2016	<.4	<.39	<.39	<1.2	<.42	<.42	<.42	<.48	<.42
	6/21/2016	<.4	<.39	<.39	<1.2	<.42	<.42	<.42	0.67	<.42
	4/28/2017	<.4	<.39	<.39	<1.2	<.42	<.42	<.42	<.48	<.42
	10/30/2017	<.4	<.39	<.39	<1.2	<.42	<.42	<.42	<.48	<.42
	3/29/2018	<.4	<.39	<.39	<1.2	<.42	<.42	<.42	<.48	<.42
	6/22/2018	<.31	<.33	<.49	<.97	<.34	<.33	<.67	<.32	<.51
	9/26/2018	<.31	<.33	<.49	<.97	<.34	<.33	<.67	<.32	<.51
	12/5/2018	<.31	<.33	<.49	<.97	<.34	<.33	<.67	<.32	<.51
	5/23/2019	<.25	<.22	<.17	<.71	<.84	<.87	<1.71	<1.2	<1.2
PZ-400	Installed December 3, 1996									
	1/9/1997	<.2	<.3	1.1	<.1	<.4	<.3	<.4	<.1	<.4
	4/18/1997	<.3	<.4	<.5	<1.4	<.5	<.4	<.5	<.2	<.4
	6/20/1997	<.1	<.1	<.1	<.2	-	-	-	-	-
	5/6/2008	<.2	<.5	<.2	<.5	<.2	<.2	<.2	<.5	<.25
	7/29/2008	<.25	<.22	<.25	<.39	<.25	<.19	<.25	<.23	<.25
	8/29/2012	7.6	<.41	0.93	<1.3	<.43	<.4	<.43	<.38	<.4
	8/8/2014	0.5	<.39	<.39	<1.2	<.42	<.42	<.42	<.48	<.42
	11/18/2014	<.4	<.39	<.39	<1.2	<.42	<.42	<.42	<.48	<.42
	9/9/2015	<.4	<.39	<.39	<1.2	<.42	<.42	<.42	<.48	<.42
	12/9/2015	0.92	<.39	<.39	<1.2	<.42	<.42	<.42	<.48	<.42
	3/31/2016	<.4	<.39	<.39	<1.2	<.42	<.42	<.42	<.48	<.42
	6/21/2016	3.3	0.5	<.39	<1.2	<.42	<.42	<.42	<.48	<.42
	4/28/2017	<.4	<.39	<.39	<1.2	<.42	<.42	<.42	<.48	<.42
	10/30/2017	28.6	<.39	.79J	<1.2	<.42	<.42	<.42	<.48	<.42
	3/29/2018	3	<.33	<.49	<.97	<.34	<.33	<.67	<.32	<.51
	6/22/2018	3	<.33	<.49	<.97	<.34	<.33	<.67	<.32	<.51
	9/26/2018	<.31	<.33	<.49	<.97	<.34	<.33	<.67	<.32	<.51
	12/5/2018	<.31	<.33	<.49	<.97	<.34	<.33	<.67	<.32	<.51
	5/23/2019	<.25	<.22	<.17	<.71	<.84	<.87	<1.71	<1.2	<1.2

12 BOLD - Concentration exceeds NR140 Enforcement Standard (ES)
 12 *Italic* - Concentration exceeds NR140 Preventative Action Limit (PAL)

Table 1: Ground Water Analytical

Webster Pig Farm
Meridian No. 05F784

Well	Date	Benzene	Ethyl Benzene	Toluene	Total Xylenes	1,2,4 - TMB	1,3,5 - TMB	Total TMBs	MTBE	Naphthalene
NR140 ES NR140 PAL Units		5	700	800	2000	-	-	480	60	100
		0.5	140	160	400			96	12	10
		ug/l	ug/l	ug/l	ug/l	ug/l	ug/l	ug/l	UG/L	ug/l
PZ-600	Installed April 14, 1997									
	4/18/1997	<3	<4	<5	<1.4	<5	<4	<4	<2	<4
	6/20/1997	114	<1	2.1	12.4	-	-	-	-	-
	5/6/2008	6300	37	200	920	160	46	206	<10	40
	7/29/2008	520	17	60	220	60	18	78	<2.3	17
	8/29/2012	175	126	223	489	177	87.1	264.1	18	156
	8/8/2014	190	156	323	583	217	137	354	<2.4	198
	11/18/2014	6.1	<.39	3.8	7.5	1.8	0.87	2.67	<.48	2.7
	9/9/2015	98.2	131	230	346	129	120	249	16.6	200
	12/9/2015	110	133	269	417	126	131	257	<1.9	203
	3/31/2016	240	32.7	290	395	93.6	124	217.6	<2.4	104
	6/21/2016	434	104	384	534	172	158	330	<4.8	232
	4/28/2017	215	5.9	102	68.4	11.4	15.6	27	<.48	10
	10/30/2017	544	98.8	241	403	128	136	264	12.5	204
	3/29/2018	434	97.2	146	167	30.5	118	148.5	<2.4	223
	6/22/2018	349	102	116	194	48.1	119	167.1	<1.3	161
	9/26/2018	68.7	25.4	18.3	37.5	9.7	31.3	41	1.9	51.4
	12/5/2018	314	99.1	121	195	46.2	140	186.2	10.9	273
	5/23/2019	41.1	20.4	13.3J	25	<8.4	37.5	37.5	<12.5	90
PZ-700	Installed April 15, 1997									
	4/18/1997	<3	<4	<5	<1.4	<5	<4	<5	<2	<4
	6/20/1997	<1	<1	<1	<2	-	-	-	-	-
	5/6/2008	<2	<5	<2	<5	<2	<2	<2	<5	<25
	7/29/2008	<.25	<.22	<.25	<.39	<.25	<.19	<.25	<.23	<.25
	8/29/2012	<.39	<.41	<.42	<1.3	<.43	<.4	<.43	<.38	<.4
	9/9/2015	Not Sampled								
	12/9/2015	Not Sampled								
	4/28/2017	Not Sampled								
	10/30/2017	Not Sampled								
	5/23/2019	<.25	<.22	<.17	<.71	<.84	<.87	<1.71	<1.2	<1.2
PZ-800	Installed June 10, 1997 (this well is now sampled as part of Donald Store work)									
	6/20/1997	0.3	<.4	<.5	<1.4	<.5	<.4	<.5	<.2	<.4
	8/29/2012	<.39	<.41	<.42	<1.3	<.43	<.4	<.43	<.38	<.4
	9/9/2015	Not Sampled								
	12/9/2015	Not Sampled								
	4/28/2017	Well sampled as part of Donald Store site								
	10/30/2017	Well sampled as part of Donald Store site								
	5/23/2019	Well sampled as part of Donald Store site								
PZ-900	Installed June 11, 1997									
	6/20/1997	1.3	<.4	<.5	<1.4	<.5	<.4	<.5	<.2	<.4
	5/6/2008	<.2	<.5	<.2	<.5	<.2	<.2	<.2	<.5	<.25
	7/29/2008	<.25	<.22	<.25	<.39	<.25	<.19	<.25	<.23	<.25
	8/29/2012	<.39	<.41	<.42	<1.3	<.43	<.4	<.43	<.38	<.4
	9/9/2015	<.4	<.39	<.39	<1.2	<.42	<.42	<.42	<.48	<.42
	12/9/2015	<.4	<.39	<.39	<1.2	<.42	<.42	<.42	<.48	<.42
	3/31/2016	<.4	<.39	<.39	<1.2	<.42	<.42	<.42	<.48	<.42
	6/21/2016	<.4	<.39	<.39	<1.2	<.42	<.42	<.42	<.48	<.42
	4/28/2017	<.4	<.39	<.39	<1.2	<.42	<.42	<.42	<.48	<.42
	10/30/2017	<.4	<.39	<.39	<1.2	<.42	<.42	<.42	<.48	<.42
	3/29/2018	<.4	<.39	<.39	<1.2	<.42	<.42	<.42	<.48	<.42
	6/22/2018	<.31	<.33	<.49	<.97	<.34	<.33	<.67	<.32	<.51
	9/26/2018	<.31	<.33	<.49	<.97	<.34	<.33	<.67	<.32	<.51
	12/5/2018	<.31	<.33	<.49	<.97	<.34	<.33	<.67	<.32	<.51
	5/23/2019	<.25	<.22	<.17	<.71	<.84	<.87	<1.71	<1.2	<1.2
MW-10B	Installed 5/8/19									
	5/23/2019	130	<.22	94J	39.59	<.84	<.87	<1.71	<1.2	<1.2
Krizan (fka Ruth Diamond property) (W16653 CTH M)(installed 1998)										
	7/25/2007	<.2	<.5	<.2	<.5	<.2	<.2	<.2	<.5	<.25
	1/9/2008	<.2	<.5	<.2	<.5	<.2	<.2	<.2	<.5	<.25
	7/29/2008	<.2	<.5	<.2	<.5	<.2	<.2	<.2	<.5	<.25
	8/29/2012	<.39	<.41	<.42	<1.3	<.43	<.4	<.43	<.38	<.4
	8/8/2014	<.4	<.39	<.39	<1.2	<.42	<.42	<.42	<.48	<.42
	11/18/2014	<.4	<.39	<.39	<1.2	<.42	<.42	<.42	<.48	<.42
	9/9/2015	<.4	<.39	<.39	<1.2	<.42	<.42	<.42	<.48	<.42
	12/9/2015	<.4	<.39	<.39	<1.2	<.42	<.42	<.42	<.48	<.42
	3/31/2016	<.4	<.39	<.39	<1.2	<.42	<.42	<.42	<.48	<.42
	6/21/2016	<.4	<.39	<.39	<1.2	<.42	<.42	<.42	<.48	<.42
grab sample	5/23/2019	<.25	<.22	<.17	<.71	<.84	<.87	<1.71	<1.2	<1.2
Replacement Well Installed October 2016										
	10/7/2016	<.5	<.5	<.5	<1	<.5	<.5	<1	<.17	<.25
	10/8/2016	<.5	<.5	<.5	<1	<.5	<.5	<1	<.17	<.25
	1/24/2017	<.4	<.39	<.39	<1.2	<.42	<.42	<.42	<.48	<.42
	4/28/2017	<.4	<.39	<.39	<1.2	<.42	<.42	<.42	<.48	<.42
	7/19/2017	<.4	<.39	<.39	<1.2	<.42	<.42	<.42	<.48	<.42
	10/30/2017	<.4	<.39	<.39	<1.2	<.42	<.42	<.42	<.48	<.42
	3/29/2018	<.4	<.39	<.39	<1.2	<.42	<.42	<.42	<.48	<.42
	6/22/2018	<.31	<.33	<.49	<.97	<.34	<.33	<.67	<.32	<.51
	9/26/2018	<.31	<.33	<.49	<.97	<.34	<.33	<.67	<.32	<.51
	12/5/2018	<.31	<.33	<.49	<.97	<.34	<.33	<.67	<.32	<.51
	5/23/2019	<.12	<.11	<.078	<.3	<.23	<.15	<.38	<.17	<.18

12 BOLD - Concentration exceeds NR140 Enforcement Standard (ES)
12 *Italic* - Concentration exceeds NR140 Preventative Action Limit (PAL)

Table 1: Ground Water Analytical

Webster Pig Farm
Meridian No. 05F784

Well	Date	Benzene	Ethyl Benzene	Toluene	Total Xylenes	1,2,4 - TMB	1,3,5 - TMB	Total TMBs	MTBE	Naphthalene
NR140 ES		5	700	800	2000	-	-	480	60	100
NR140 PAL		0.5	140	160	400			96	12	10
Units		ug/l	ug/l	ug/l	ug/l	ug/l	ug/l	ug/l	UG/L	ug/l
Pig Farm well										
	8/8/2014	<.4	<.39	<.39	<1.2	<.42	<.42	<.42	<.48	<.42
	11/18/2014	<.4	<.39	<.39	<1.2	<.42	<.42	<.42	<.48	<.42
(yield test)	2/16/2016	<.4	<.39	<.39	<1.2	<.42	<.42	<.42	<.48	<.42
	5/23/2019	<.25	<.22	<.17	<.71	<.84	<.87	<1.71	<1.2	<1.2
Old Church Well										
	8/29/2012	<.39	<.41	<.42	<1.3	<.43	<.4	<.43	<.38	<.4
(yield test)	2/16/2016	<.4	<.39	.98J	<1.2	<.42	<.42	<.42	<.48	<.42
Town Hall well (outside faucet)										
	10/26/2012	<.39	<.41	<.42	<1.3	<.43	<.4	<.43	<.38	<.4
(yield test)	2/16/2016	<.4	<.39	<.39	<1.2	<.42	<.42	<.42	<.48	<.42
	5/23/2019	<.12	<.11	<.078	<.3	<.23	<.15	<.38	<.17	<.18
T-1										
	Installed 10/18/12									
	10/26/2012	6.1	322	<2.1	1130	654	205	859	18.4	168
	Abandoned 8/4/14 due to excavation									
T-2										
	Installed 10/18/12									
	10/26/2012	2990	1740	5820	6950	875	257	1132	38	349
	Abandoned 8/4/14 due to excavation									
T-3										
	Installed 10/18/12									
	10/26/2012	10.2	<.41	1.6	<1.3	<.43	0.85	0.85	<.38	4

12 BOLD - Concentration exceeds NR140 Enforcement Standard (ES)
12 *Italic* - Concentration exceeds NR140 Preventative Action Limit (PAL)