

GIS REGISTRY INFORMATION

SITE NAME:	Mobil SS # 05-PED/Shell		
BRRTS #:	03-41-000748	FID #	
COMMERCE # (if appropriate):	53221-2103-91	(if appropriate):	
CLOSURE DATE:	January 7, 2003		
STREET ADDRESS:	4691 S. 27th St.		
CITY:	Greenfield		
SOURCE PROPERTY GPS COORDINATES (meters in WTM91 projection):	X = 687270	Y = 278384	
CONTAMINATED MEDIA:	Groundwater <input checked="" type="checkbox"/>	Soil <input type="checkbox"/>	Both <input type="checkbox"/>
OFF-SOURCE GW CONTAMINATION >ES:	Yes <input checked="" type="checkbox"/>	No <input type="checkbox"/>	X <input checked="" type="checkbox"/>
• IF YES, STREET ADDRESS:			
• GPS COORDINATES X = Y =			
(meters in WTM91 projection):			
OFF-SOURCE SOIL CONTAMINATION	Yes <input type="checkbox"/>	No <input checked="" type="checkbox"/>	X <input checked="" type="checkbox"/>
>Generic or Site-Specific RCL (SSRCL):			
• IF YES, STREET ADDRESS 1:			
• GPS COORDINATES X = Y =			
(meters in WTM91 projection):			
CONTAMINATION IN RIGHT OF WAY:	Yes <input checked="" type="checkbox"/>	No <input type="checkbox"/>	
DOCUMENTS NEEDED			
Closure Letter, and any conditional closure letter issued			X
Copy of most recent deed, including legal description, for all affected properties			X
Certified survey map or relevant portion of the recorded plat map (if referenced in the legal description) for all affected properties			
County Parcel ID number, if used for county, for all affected properties			X
Location Map which outlines all properties within contaminated site boundaries on USGS topographic map or plat map in sufficient detail to permit the parcels to be located easily (8.5x14" if paper copy). If groundwater standards are exceeded, the map must also include the location of all municipal and potable wells within 1200' of the site.			X
Detailed Site Map(s) for all affected properties, showing buildings, roads, property boundaries, contaminant sources, utility lines, monitoring wells and potable wells. (8.5x14", if paper copy) This map shall also show the location of all contaminated public streets, highway and railroad rights-of-way in relation to the source property and in relation to the boundaries of groundwater contamination exceeding ch. NR 140 ESs and soil contamination exceeding ch. NR 720 generic or SSRCLs.			X
Tables of Latest Groundwater Analytical Results (no shading or cross-hatching)			X
Tables of Latest Soil Analytical Results (no shading or cross-hatching)			
Isoconcentration map(s), if required for site investigation (SI) (8.5x14" if paper copy). The isoconcentration map should have flow direction and extent of groundwater contamination defined. If not available, include the latest extent of contaminant plume map.			X
GW: Table of water level elevations, with sampling dates, and free product noted if present			
GW: Latest groundwater flow direction/monitoring well location map (should be 2 maps if maximum variation in flow direction is greater than 20 degrees)			X
SOIL: Latest horizontal extent of contamination exceeding generic or SSRCLs, with one contour			
Geologic cross-sections, if required for SI. (8.5x14" if paper copy)			X
RP certified statement that legal descriptions are complete and accurate			X
Copies of off-source notification letters (if applicable)			
Letter informing ROW owner of residual contamination (if applicable)(public, highway or railroad ROW)			X
Copy of (soil or land use) deed restriction(s) or deed notice if any required as a condition of closure			



ENVIRONMENTAL & REGULATORY SERVICES DIVISION
BUREAU OF PECFA
101 West Pleasant Street, Suite 100A
Milwaukee, Wisconsin 53212-3963
TDD #: (608) 264-8777
Fax #: (414) 220-5374
<http://www.commerce.state.wi.us>
<http://www.wisconsin.gov>
James E. Doyle, Governor

January 7, 2003

Mr. Jeff Johnson
ExxonMobil Refining and Supply Company
P.O. Box 874
Joliet, IL 60434

RE: **Final Closure**

Commerce # 53221-2103-91 WDNR BRRTS # 03-41-000748
Mobil SS # 05-PED/Shell, 4691 South 27th Street, Greenfield

One fuel oil underground storage tank (UST) removed in 1992; three upgraded gasoline USTs in use

Dear Mr. Johnson:

The Wisconsin Department of Commerce (Commerce) has received all items required for closure of the site referenced above. This site is now listed as "closed" on the Commerce database and will be included on the Wisconsin Department of Natural Resources (WDNR) Geographic Information System (GIS) Registry of Closed Remediation Sites to address residual groundwater contamination.

It is in your best interest to keep all documentation related to the environmental activities at your site. If residual contamination is encountered in the future, appropriate measures must be implemented to assure that it is managed following all applicable regulations. If future site conditions indicate that any remaining contamination poses a threat, and subsequent information indicates a need to reopen this case, any original claim under the PECFA fund would also reopen and you may apply for assistance to the extent of remaining eligibility.

Thank you for your efforts to protect Wisconsin's environment. If you have any questions, please contact me in writing at the letterhead address or by telephone at (414) 220-5376.

Sincerely,

A handwritten signature in black ink, appearing to read 'Linda M. Michalets', with a long horizontal flourish extending to the right.

Linda M. Michalets
Hydrogeologist
Site Review Section

cc: Ms. Tammi Nagel, Handex of Wisconsin
Case file

OS-PEO

7036020

This Indenture, Made this _____ day of OCTOBER A. D. 19 94, Between Mobil Oil Corporation, a New York corporation part Y of the first part, and Klein Enterprises, Inc. 4691 South 27th Street, Greenfield, Wisconsin 53221 part Y of the second part

REGISTER'S OFFICE Milwaukee County, WI } RECORDED AT - 3:50 PM

DEC 15 1994

REEL 3438 IMAGE 1315 TO 1317

REGISTER OF DEEDS

Witnesseth, That the said part _____ of the first part, for and in consideration of the sum of one dollar and other good and valuable consideration to _____ in hand paid by the said part _____ of the second part, the receipt whereof is hereby confessed and acknowledged, has given, granted, bargained, sold, released, conveyed, confirmed and confirmed, and by these presents do give, grant, bargain, sell, release, convey and confirm unto the said part _____ of the second part _____ heirs and assigns forever, the following described real estate situated in the County of Milwaukee and State of Wisconsin, to-wit:

John Klein 4691 S 27th St. Greenfield WI 53221

That part of the Southeast 1/4 of Section 24, in Township 6 North, Range 21 East, in the City of Greenfield, County of Milwaukee and State of Wisconsin, as follows: Commencing at the Southeast corner of said 1/4 Section; running thence West along the South line of said 1/4 Section 220 feet to a point; thence North on a line parallel to the East line of said 1/4 Section 160 feet to a point; thence East on a line parallel to the South line of said 1/4 Section 220 feet to the East line of said 1/4 Section; thence South along the East line of said 1/4 Section 160 feet to the point of beginning, excepting therefrom the South 60 feet and the East 80 feet thereof.

Part of the first part hereby retains Repurchase Rights and a Right of First Refusal as set forth on Exhibit A attached hereto. Parties of the second part, by acceptance of this Deed hereby grant such Repurchase Rights and Right of First Refusal to party of the first part.

7036020 #

RECORD 14.00

Tax Key No. 009-6666

Together with all and singular the hereditaments and appurtenances thereto belonging or in any wise appertaining, and all the estate, right, title, interest, claim or demand whatsoever, of the said part _____ of the first part, either in law or equity either in possession or expectancy of, in and to the above bargained premises, and their hereditaments and appurtenances

To have and to hold the said premises as above described, with the hereditaments and appurtenances, unto the said part _____ of the second part, and to _____ heirs and assigns FOREVER

RTX 796.50

And the said Mobil Oil Corporation

for _____ heirs, executors and administrators, do covenant, grant, bargain and sell unto with the said part _____ of the second part _____ heirs and assigns, that the above bargained premises, in the quiet and peaceable possession of the said part _____ of the second part, _____ heirs and assigns, against all and every person or persons lawfully claiming the whole or any part thereof, by, through or under said Mobil Oil Corporation _____ part _____ of the first part and none other, _____ WARRANT and DEFEND

In Witness Whereof, the said part _____ of the first part _____ hereunto set _____ hand and seal _____ this _____ day of _____ October _____ A. D. 19 94

MOBIL OIL CORPORATION

SIGNED AND SEALED IN PRESENCE OF

P. D. Thomson

By: P.D. THOMSON ASSISTANT TREASURER

TRANSFER

Attest: P.A. STEVENSON JR. ASST. SECRETARY

E. Q. Landry

\$ 716.50 FEE

STATE OF WISCONSIN

FILED IN

28th

NOV 28 1994

94

Personally appeared before me, this _____ day of _____

the _____ named P.D. THOMSON ASSISTANT TREASURER P.A. STEVENSON JR. ASST. SECRETARY

whose names and addresses are given in the foregoing, and acknowledged the contents of this instrument to be true and correct

Walter H. H. H. H.

Handwritten mark

Repurchase Rights As additional consideration for Seller's Agreement to sell the Premises as provided herein, Purchaser gives to Seller the following rights to repurchase the Premises:

(a) For the 10 year period following closing, should Purchaser terminate the Motor Fuel Franchise Agreement for N Dealers for any reason, or should such Franchise Agreement be terminated by Seller due to Purchaser's default, Seller shall have the right, but not the obligation, to repurchase the Premises. Seller may exercise this right to repurchase by written notice to Purchaser within 60 days of Seller's receipt of notice of termination from Purchaser or of Seller's giving notice of

termination to Purchaser, as applicable. The price to Seller under this right of repurchase shall be the lower of:

(i) The fair market value of the Premises as established by an independent appraisal conducted by a jointly selected MAI (Member of Appraisal Institute) qualified commercial real estate appraiser following MAI endorsed appraisal procedures. The cost of the appraisal shall be split by the parties; or

(ii) The original purchase price as set out in paragraph 3(a) above, plus the unamortized cost of improvements, if any, made by Purchaser subsequent to closing.

(b) For a 10 year period following closing, Seller shall have the right of first refusal to purchase the Premises under the same terms and conditions as Purchaser is willing to accept in the sale or other transfer of the Premises to any other party, as follows:

(i) No later than ninety (90) days prior to the proposed sale or closing of the Premises to a third party, Purchaser shall present to Seller a written copy of the third party's offer. Such offer must be bona fide, in writing and contain all terms and conditions of the proposed sale or other transfer of the Premises. Purchaser shall also provide Seller with all qualifications of the third party if Purchaser is seeking to assign to the third party the franchise agreement between Seller and Purchaser. Seller shall have sixty (60) days after receipt of all required information within which to evaluate the offer, and to advise Purchaser whether Seller wishes to exercise its right of first refusal. If Seller chooses to exercise the right of first refusal, closing and the effective date of the sale shall be as set forth in the third party offer, unless Seller and Purchaser shall agree otherwise.

(ii) This right of first refusal shall not apply to the sale or other transfer of the Premises to a corporation owned or controlled by Purchaser which does not result in any change in the operation of the Premises by Purchaser as a Mobil brand retail motor fuel facility; or,

(iii) The right of first refusal shall not apply to the sale or other transfer of the Premises to any third party, acceptable to Seller, who agrees to continue operation of the Premises as a Mobil brand retail motor fuel facility and assume Purchaser's obligations under any Franchise Agreement applicable to the Premises; and,

(iv) The right of first refusal shall apply to any subsequent sale or other transfer of the Premises; and,

(v) The waiver or release by Seller of its right of first refusal as provided herein shall not affect Seller's right to repurchase as set out in paragraph 11(a) above.

(c) In the event the right to repurchase under paragraph 11(a) above is held to be invalid or unenforceable, Purchaser shall be obligated to pay Seller an amount equal to the following sum:

(i) The reduction of the appraised value of improvements and equipment given by Seller as consideration for the right to repurchase (See paragraph 3(a) above) plus 8% interest compounded annually from the date of closing to the date such right to repurchase is found invalid or unenforceable.

(ii) The cost to Seller of any new underground tanks, overflow/overflow protection, monitoring wells, remote in-tank gauging or monitoring systems and Stage II vapor recovery installed by Seller after execution of the Contract of Sale, not otherwise included in the amount under (i) above, plus 8% interest compounded annually from the date of installation until such right of repurchase is found invalid or unenforceable.

d. Seller may offset from the price to be paid Purchaser under Seller's exercise of its right to repurchase or its right of first refusal any debt then owing from Purchaser to Seller, however such debt arose.

NO.	REVISIONS		DATE	BY	CHKD

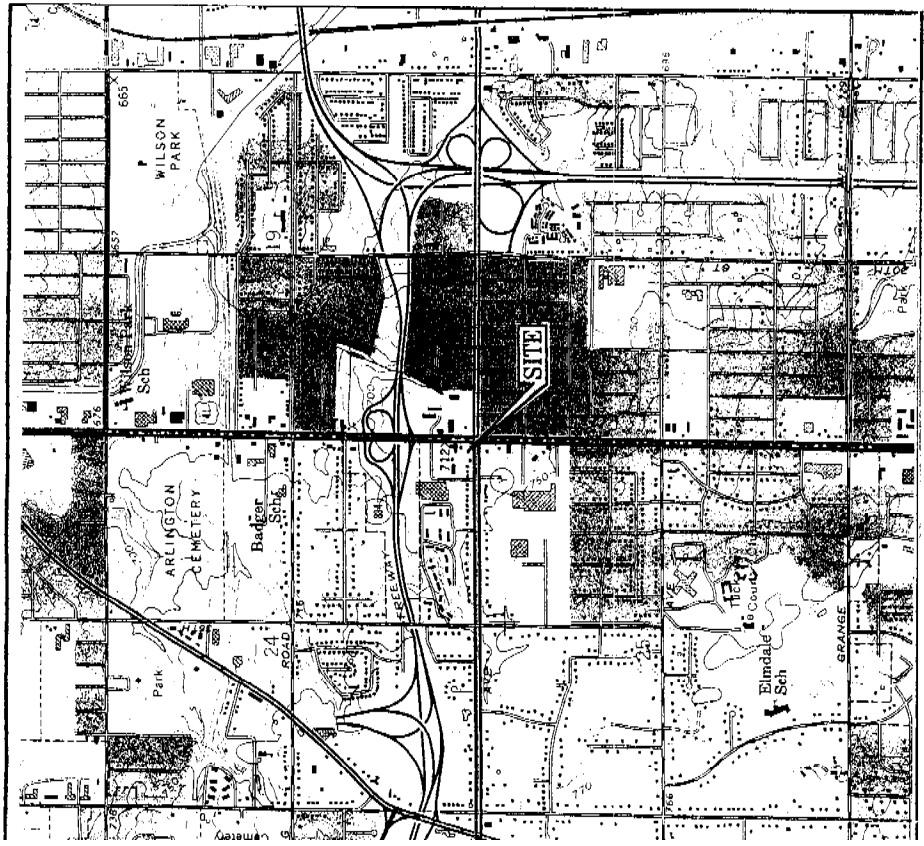

SCALE 1:24000

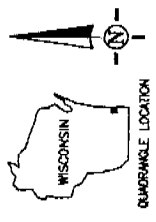
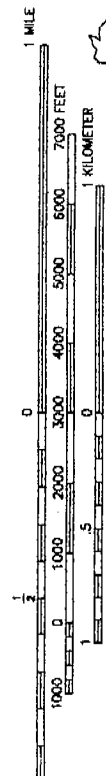

GREENDALE QUADRANGLE
MILWAUKEE COUNTY, WISCONSIN
7.5 MINUTE SERIES (TOPOGRAPHIC)

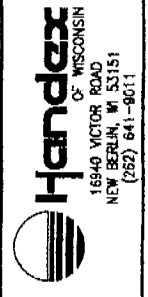

EXXON MOBIL CORPORATION
Refining and Supply
Fairfax, Virginia 22037

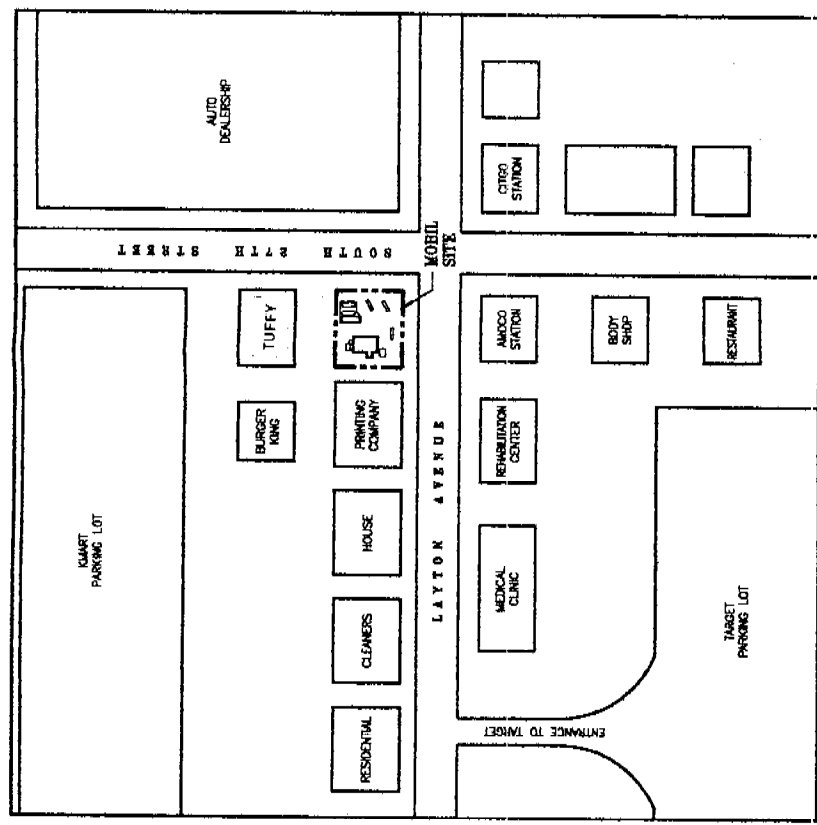

SCHEMATIC OF SURROUNDING AREA
NOT TO SCALE

DRAWN BY:	M. SMITH
CHECKED BY:	ALN - 10/1/01
SCALE:	AS NOTED
DATE:	10/3/01
DRAWING FILE:	114123

SITE LOCATION MAP
MOBIL SERVICE STATION # 05-PED
4691 SOUTH 27TH STREET
GREENFIELD, MILWAUKEE COUNTY, WISCONSIN

FIGURE
1

NO.	REVISIONS	DATE	BY	CHKD

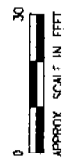
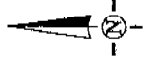

- LEGEND**
- PROPERTY BOUNDARY
 - MONITORING WELL LOCATION
 - RECOVERY WELL LOCATION
 - ⊕ FORMER MONITORING WELL LOCATION

DRAWN BY:	M. SMITH
CHECKED BY:	T. N. - 1/15/02
SCALE:	1" = 30'
DATE:	1/19/02
DRAWING FILE:	114123

SITE MAP
 MOBIL SERVICE STATION # 05-PED
 4691 SOUTH 27TH STREET
 GREENFIELD, MILWAUKEE COUNTY, WISCONSIN

EXXON MOBIL CORPORATION
 Refining and Supply
 Fairfax, Virginia 22037

Handlex
 OF WISCONSIN
 16940 VICTOR ROAD
 NEW BERLIN, WI 53151
 (262) 641-9011

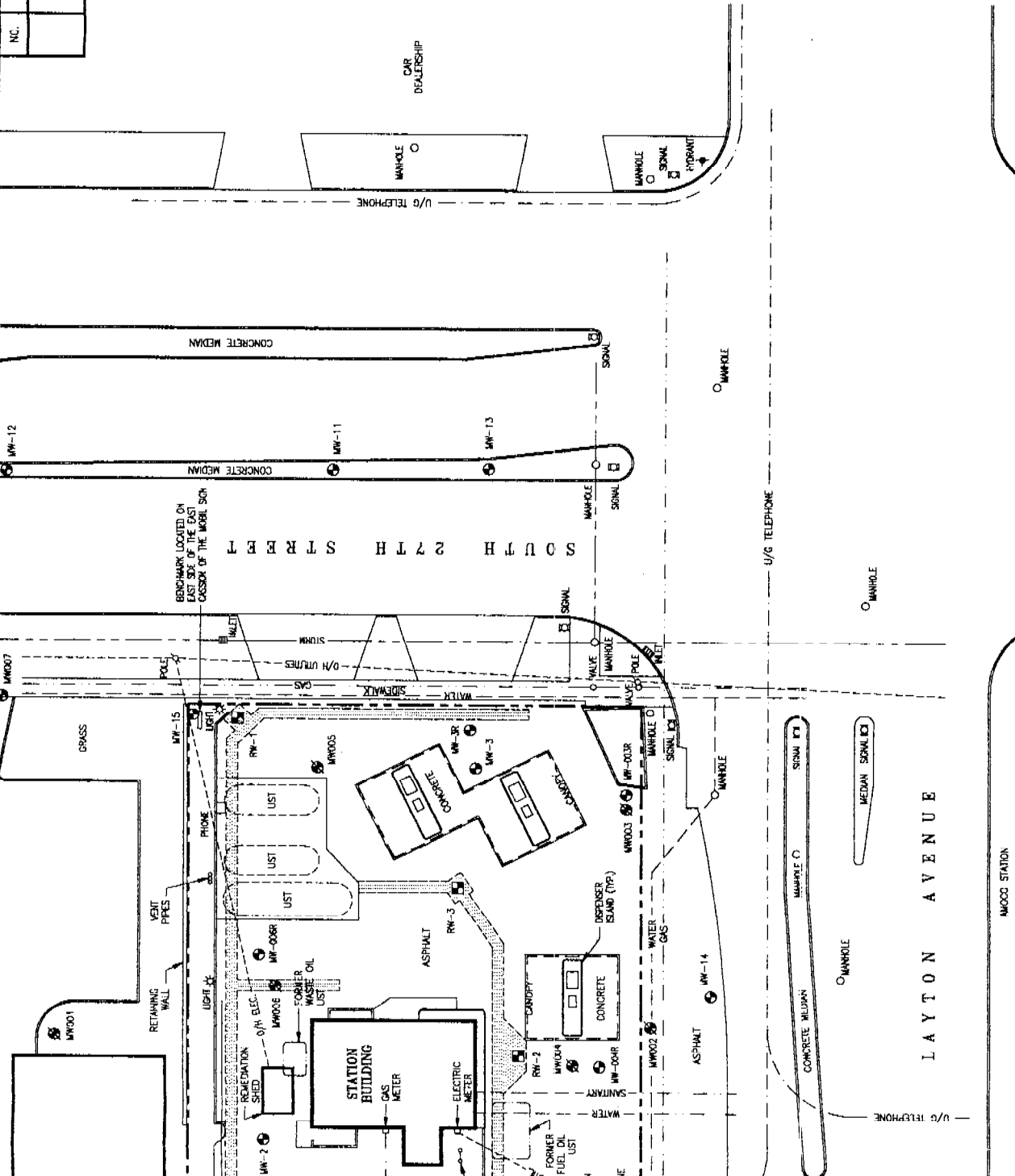

FIGURE 2

Groundwater Laboratory Analytical Results
 Mobil Service Station No. 05-PED
 Greenfield, Wisconsin

Well Number	Sample Date	Benzene	Toluene	Ethylbenzene	Total Xylenes	MTBE	Trimethylbenzenes	Naphthalene	GRO	Dissolved Lead (Filtered)	Total Lead	Water Level (feet)	
MW-1		Top of Well Screen (feet): <93.5											
	12/17/91	ND	ND	ND	ND	ND	ND	ND	ND	<3	ND	97.96*	
	3/24/93	ND	ND	ND	ND	ND	ND	ND	ND	<6	ND	98.09*	
	10/6/93	ND	ND	ND	ND	ND	ND	<1	ND	ND	ND	97.77*	
	10/27/94	ND	ND	ND	ND	ND	ND	ND	ND	ND	<1.5	70	
	3/20/95	ND	ND	ND	ND	ND	ND	ND	ND	ND	ND	95.91*	
	6/27/95	ND	ND	ND	ND	ND	ND	ND	ND	ND	ND	96.1*	
	10/2/95	ND	ND	ND	ND	ND	ND	ND	ND	ND	ND	97.48*	
	3/13/96	ND	ND	ND	ND	ND	ND	ND	ND	ND	ND	95.41*	
	8/12/96	ND	ND	ND	ND	ND	ND	ND	ND	ND	ND	95.78*	
	8/14/96	5	ND	3	8	ND	5	ND	ND	ND	ND	97.7*	
	1/13/96	ND	ND	ND	ND	ND	ND	ND	ND	ND	ND	96.63*	
	3/6/97	ND	ND	ND	ND	ND	ND	ND	ND	ND	ND	97.97*	
9/13/97	<0.13	<0.20	<0.22	<0.23	<0.16	<0.51	<1.1	ND	ND	ND	97.14*		
6/2/99	<0.13	<0.20	<0.22	<0.23	<0.16	<0.51	<1.1	ND	ND	ND	97.14*		
12/14/00													
MW-2		Top of Well Screen (feet): <91.4											
	12/17/91	ND	ND	ND	ND	ND	ND	ND	ND	ND	ND	97.74*	
	3/24/93	ND	ND	ND	ND	ND	ND	ND	ND	<6	ND	97.62*	
	10/6/93	ND	ND	ND	ND	ND	ND	<1	ND	ND	ND	94.70*	
	10/27/94	ND	ND	ND	ND	ND	ND	ND	ND	ND	<1.5	39	
	3/20/95	ND	ND	ND	ND	ND	ND	ND	ND	ND	ND	95.85*	
	6/27/95	ND	ND	ND	ND	ND	ND	ND	ND	ND	ND	96.18*	
	10/2/95	ND	ND	ND	ND	ND	ND	ND	ND	ND	ND	97.77*	
	3/13/96	ND	ND	ND	ND	ND	ND	ND	ND	ND	ND	24	
	8/12/96	ND	ND	ND	ND	ND	ND	ND	ND	ND	ND	35	
	8/14/96	ND	ND	ND	ND	ND	ND	ND	ND	ND	ND	95.58*	
	11/13/96	ND	2	ND	10	ND	12	ND	ND	ND	ND	95.85*	
	3/6/97	ND	ND	ND	ND	ND	ND	ND	ND	ND	ND	97.71*	
9/10/97	ND	ND	ND	ND	ND	ND	ND	ND	ND	ND	96.09*		
3/10/99	<0.41	<0.38	<0.43	<1.4	<0.41	<1.0	<1.1	ND	ND	ND	96.89*		
6/2/99	<0.13	<0.20	<0.22	<0.23	<0.16	<0.51	<1.1	ND	ND	ND	97.52*		
12/14/00													
MW-3		Top of Well Screen (feet): <91.7											
	12/17/91	1600	520	710	4300	ND	ND	ND	ND	ND	ND	97.72*	
	3/24/93	1600	1400	1200	2320	220	1820	210	1400	<6	ND	98.56*	
	10/6/93	2000	400	2000	4400	170	1730	ND	18000	ND	ND	96.49*	
	10/27/94	2100	400	2000	5660	140	2390	ND	19000	ND	ND	93	
	3/20/95	1900	360	1800	4200	380	2280	ND	21000	ND	ND	46	
	6/27/95	2200	400	2300	4320	410	2660	ND	27000	ND	ND	56	
	10/2/95	1900	290	1600	3900	380	2540	ND	34000	ND	ND	66	
	3/13/96	2100	390	2200	4350	540	2550	ND	21000	ND	ND	27	
	6/12/96	1400	230	1400	2970	340	1730	ND	15000	ND	ND	80	
	8/14/96	2000	380	2300	4900	440	3450	ND	29000	ND	ND	320	
	11/13/96	1300	250	1000	3310	260	9600	ND	23000	ND	ND	97.13*	
	3/6/97	1900	310	2400	5400	520	3560	ND	31000	ND	ND	97.22*	
	9/10/97	1200	180	1700	3700	360	2320	ND	ND	ND	ND	97.08*	
	12/28/98	1500	250	1800	4000	260	2830	ND	ND	ND	ND	97.08*	
	3/10/99	1400	230	1700	3900	300	2700	ND	ND	ND	ND	97.65*	
	DUP	1500	230	1500	3500	<16	2030	ND	ND	ND	ND	97.65*	
	DUP	1800	240	1600	3700	<16	2260	200	ND	ND	ND	97.61*	
	DUP	1200	140	1400	2500	180	2020	230	ND	ND	ND	97.61*	
	9/20/00	1300	170	1700	3300	<38M	2600	ND	ND	ND	ND	98.16*	
	12/14/00	1500	230	1600	3500	<47M	2600	ND	ND	ND	ND	96.75*	
	3/27/01	1600	210	1500	3400	100	1980	ND	ND	ND	ND	97.54*	
	6/25/01	1200	130	1400	3000	<20 M	2140	ND	ND	ND	ND	97.97*	
10/15/01												97.39*	
MR 140 Standards	ES	5	1000	700	10000	60	480	40	NA	15	NA	NA	
	PAL	0.5	200	740	10000	12	96	8	NA	1.5	NA	NA	

Groundwater Laboratory Analytical Results
 Mobil Service Station No. 05-PED
 Greenfield, Wisconsin

Well Number	Sample Date	Benzene	Toluene	Ethylbenzene	Total Xylenes	MTBE	Total Trimethylbenzenes	Naphthalene	GRO	Dissolved Lead (Filtered)	Total Lead	Water Level* (feet)
MW-3R												
		Top of Well Screen (feet): 98.5										
	9/20/00	7.0	<0.40	0.78	4.1	120	11.2	97.1
	9/20/00 DUP	6.6	<0.40	0.69	3.6	120	10.3	97.1
	12/14/00	2.7	<0.20	<0.22	<0.23	160	0.22	98.07
	12/14/00 DUP	2.9	<0.20	<0.22	<0.23	150	0.23	98.07
	3/27/01	8.6	<0.20	<0.22	0.43	140	1.4	97.28
	DUP	9.0	<0.20	<0.22	0.51	150	1.7	97.28
	6/25/01	17	0.34	0.35	0.52	170	2.3	97.41
	6/25/01 Dup	16	0.30	0.28	0.50	170	2.0	97.41
	10/15/01	2.0	<0.23	<0.22	<0.23	150	0.73	97.62
	10/15/2001 Dup	1.8	<0.20	<0.22	<0.23	150	0.63	97.62
MW-001												
		Top of Well Screen (feet): Unknown										
	10/6/93	ND	ND	ND	ND	ND	ND	<1	ND	<6	...	94.24
	10/27/94	ND	ND	ND	ND	ND	ND	...	ND
	3/20/95	ND	ND	ND	ND	ND	ND	...	ND	...	<1.5	90.47
	6/27/95	ND	ND	ND	ND	ND	ND	...	ND	...	100	...
	10/2/95	ND	ND	ND	ND	ND	ND	...	ND	...	<3	90.05
	3/13/96	ND	ND	ND	ND	ND	ND	...	ND	...	490	90.73
	6/12/96	ND	ND	ND	ND	ND	ND	...	ND	...	<3.3	90.78
	8/14/96	ND	ND	ND	ND	ND	ND	...	ND	...	260	88.1
	11/13/96	ND	ND	ND	ND	ND	ND	...	ND	...	37	96.19
	3/6/97	97.4
	9/10/97	93.06
MW-003R												
		Top of Well Screen (feet): 99.1										
	9/20/00	<0.13	<0.20	<0.22	<0.23	4.3	<0.51	98.39
	3/27/01	0.33	<0.20	0.44	0.69	2.9	0.91	97.28
	6/25/01	<0.13	<0.20	<0.22	<0.23	2.4	<0.51	96.63
	10/15/01	<0.13	<0.20	<0.22	<0.23	<0.26 M	<0.51	99.14*
MW-004R												
		Top of Well Screen (feet): 99.3										
	9/20/00	5200	48	1100	1700	4.7	980	98.48
	12/14/00	1600	<8.0	420	210	<7.0M	196	97.79
	3/27/01	1200	7.2	400	100	<4.8M	96	98.34
	6/25/01	1100	4.9	350	87	<1.6	86	98.61
	10/15/01	1200	5.6	450	95	<1.6	88	98.51
MW-006R												
		Top of Well Screen (feet): 98.3										
	9/20/00	11	<0.40	3.5	5.1	40	3.88	96.77
	12/14/00	150	0.53	46	42	<3.7M	10.9	96.71
	3/27/01	3.0	<0.40	2.0	1.2	15	0.64	97
	6/25/01	8.7	<0.20	3.6	0.59	17	0.58	97.13
	10/15/01	46	<0.20	4.0	0.47	18	0.57	97.11
MW-007												
		Top of Well Screen (feet): <88.5										
	10/6/93	ND	ND	ND	ND	2.7	ND	<1	ND	<6	...	92.76*
	10/27/94	ND	ND	ND	ND	ND	ND	...	ND	...	7	...
	3/20/95	ND	ND	ND	ND	ND	ND	...	ND	...	<1.5	92.29*
	6/27/95	ND	ND	ND	ND	ND	ND	...	ND
	10/2/95	ND	ND	ND	ND	ND	ND	...	ND	...	<3	92.63*
	3/13/96	ND	ND	ND	ND	ND	ND	...	ND	...	7	91.10*
	6/12/96	ND	ND	ND	ND	ND	ND	...	ND	...	<3.3	92.94*
	8/14/96	ND	ND	ND	ND	ND	ND	...	ND	...	3.5	92.67*
	11/13/96	ND	ND	ND	ND	ND	ND	...	ND	...	54	92.04*
	3/6/97	92.15*
	9/10/97	92.49*
	9/20/00	<0.13	<0.20	<0.22	<0.23	<0.37	<0.51	92.57*
	12/14/00	<0.13	<0.20	<0.22	<0.23	<0.16	<0.51	91.28*
	3/27/01	<0.13	<0.20	<0.22	<0.23	<0.16	<0.51	91.74*
	6/25/01	<0.13	<0.20	<0.22	<0.23	<0.16	<0.51	92.14*
	10/15/01	<0.13	<0.20	<0.22	<0.23	<0.16	<0.51	92.30*
NR 140 Standards												
ES		5	1000	700	10000	60	480	40	NA	15	NA	NA
PAL		0.5	200	140	1000	12	96	8	NA	7.5	NA	NA

Groundwater Laboratory Analytical Results
 Mobil Service Station No. 05-PED
 Greenfield, Wisconsin

Well Number	Sample Date	Benzene	Toluene	Ethylbenzene	Total Xylenes	MTBE	Total Trimethylbenzenes	Naphthalene	GRO	Dissolved Lead (Filtered)	Total Lead	Water Level (feet)
MW-11	Length of Well Screen (feet): 15											
		Top of Well Screen (feet): 95.4										
	3/24/93	1.8	6.7	ND	2.3	ND	ND	<1	ND	<3	ND	---
	10/27/94	ND	ND	ND	ND	ND	ND	---	ND	---	6	90.53
	3/20/95	ND	ND	ND	ND	ND	ND	---	ND	---	11	---
	6/27/95	ND	ND	ND	ND	ND	ND	---	ND	---	10	90.35
	10/2/95	ND	ND	ND	ND	ND	ND	---	ND	---	46	90.73
	3/13/96	ND	ND	ND	ND	ND	ND	---	ND	---	<3.3	90.79
	8/12/96	ND	ND	ND	ND	ND	ND	---	ND	---	4.6	88.1
	8/14/96	ND	ND	ND	ND	ND	ND	---	ND	---	53	90.76
	11/13/96	2	ND	ND	ND	ND	ND	---	ND	---	47	91.23
	3/6/97	ND	ND	ND	ND	ND	ND	---	ND	---	ND	90.19
	9/10/97	ND	ND	ND	ND	ND	ND	---	ND	---	ND	88.42
	12/29/98	<0.13	<0.22	<0.16	<0.23	<0.16	<0.51	<1.1	---	<1.2	---	88.71
	6/2/99	<0.13	<0.20	<0.22	<0.23	<0.16	<0.51	---	---	---	---	88.97
9/20/00	<0.13	<0.20	<0.22	<0.23	<0.16	<0.51	---	---	---	---	89.07	
3/27/01	<0.13	<0.20	<0.22	<0.23	<0.16	<0.51	---	---	---	---	88.73	
6/25/01	<0.13	<0.20	<0.22	<0.23	<0.16	<0.51	---	---	---	---	88.32	
10/15/01	<0.13	<0.20	<0.22	<0.23	<0.16	<0.51	---	---	---	---	---	
MW-12	Length of Well Screen (feet): 15											
		Top of Well Screen (feet): 93.1										
	3/24/93	ND	ND	ND	ND	ND	ND	<1	ND	<3	ND	---
	10/27/94	ND	ND	ND	ND	ND	ND	---	ND	---	ND	85.18
	3/20/95	ND	ND	ND	ND	ND	ND	---	ND	---	<1.5	---
	6/27/95	ND	ND	ND	ND	ND	ND	---	ND	---	3.2	86.86
	10/2/95	ND	ND	ND	ND	ND	ND	---	ND	---	9.4	87.14
	3/13/96	ND	ND	ND	ND	ND	ND	---	ND	---	4.3	85.02
	6/12/96	ND	ND	ND	ND	ND	ND	---	ND	---	<3.3	85.17
	8/14/96	ND	ND	ND	ND	ND	ND	---	ND	---	3.7	92.09
	11/13/96	ND	ND	ND	ND	ND	ND	---	ND	---	45	91.72
	3/6/97	---	---	---	---	---	---	---	---	---	---	91.8
	9/10/97	---	---	---	---	---	---	---	---	---	---	91.21
	3/10/99	<0.41	<0.38	<0.43	<1.4	<0.41	<1.0	---	---	---	---	91.76
	9/26/00	<0.13	<0.20	<0.22	<0.23	<0.16	<0.51	---	---	---	---	90.91
3/27/01	<0.13	<0.20	<0.22	<0.23	<0.16	<0.51	---	---	---	---	85.71	
6/25/01	<0.13	<0.20	<0.22	<0.23	<0.16	<0.51	---	---	---	---	86.71	
10/15/01	<0.13	<0.20	<0.22	<0.23	<0.16	<0.51	---	---	---	---	---	
MW-13	Length of Well Screen (feet): 15											
		Top of Well Screen (feet): 96.1										
	12/29/98	---	---	---	---	---	---	---	---	---	---	81.93
	3/10/99	<0.41	<0.38	<0.43	<1.4	<0.41	<1.0	---	---	---	---	88.85
	6/2/99	<0.13	<0.20	<0.22	<0.23	<0.16	<0.51	<1.1	---	<1.2	---	90.32
9/20/00	<0.13	<0.20	<0.22	<0.23	<0.16	<0.51	---	---	---	---	93.93	
3/27/01	<0.13	<0.20	<0.22	<0.23	<0.16	<0.51	---	---	---	---	92.94	
6/25/01	<0.13	<0.20	<0.22	<0.23	<0.16	<0.51	---	---	---	---	93.3	
10/15/01	<0.13	<0.20	<0.22	<0.23	<0.16	<0.51	---	---	---	---	93.81	
NR 140 Standards												
	ES	5	1000	700	10000	60	480	40	NA	15	NA	NA
PAL	0.5	200	140	1000	12	96	8	NA	1.5	NA	NA	

Groundwater Laboratory Analytical Results
 Mobil Service Station No. 05-PED
 Greenfield, Wisconsin

Well Number	Sample Date	Benzene	Toluene	Ethylbenzene	Total Xylenes	MTBE	Total Trimethylbenzenes	Naphthalene	GRO	Dissolved Lead (Filtered)	Total Lead	Water Level* (feet)
MW-14 Top of Well Screen (feet): 97.9												
	12/29/98	0.28	<0.20	0.27	0.99	<0.16	0.64	83.35
	3/10/99	<0.41	<0.38	<0.43	<1.4	<0.41	<1.0	93.4
	6/2/99	<0.13	<0.20	<0.22	<0.23	<0.16	<0.51	<1.1	<1.2	93.34
	9/20/00	<0.13	<0.20	<0.22	<0.23	<0.16	<0.51	97.41
	12/14/00	<0.13	<0.20	<0.22	<0.23	<0.16	<0.51	95.2
	3/27/01	<0.13	<0.20	<0.22	<0.23	<0.16	<0.51	94.96
	6/25/01	<0.13	<0.20	<0.22	<0.23	<0.16	<0.51	95.87
	10/15/01	<0.13	<0.20	<0.22	<0.23	<0.16	<0.51	96.2
MW-15 Top of Well Screen (feet): 95.5												
	10/28/01	<0.13	<0.20	<0.22	<0.23	14	<0.51	87.35
RW-1 Top of Well Screen (feet): 98.8												
	8/2/00	120	43	890	2100	150	1080
	12/14/00	180	39	860	1700	<30M	840	96.88*
	3/27/01	240	220	1100	3400	<24M	1380	97.1*
	6/25/01	30	16	140	320	<3.2	171	97.15*
NR 140 Standards												
ES		5	1000	700	10000	60	480	40	NA	15	NA	NA
PAL		0.5	200	140	1000	12	96	8	NA	1.5	NA	NA

Analytical results in micrograms per liter (µg/L) or parts per billion (ppb).

Notes:

ND - Not detected above the laboratory method detection limit.

.... Parameter not analyzed.

MTBE - Methyl tert-butyl ether.

GRO - Gasoline Range Organics.

Total Trimethylbenzene - 1,3,5- and 1,2,4-trimethylbenzene.

M - Matrix interference

ES - Enforcement Standard

PAL - Preventive Action Limit

NA - No established ES or PAL

* - Asterisk indicates well screen submerged below water table.

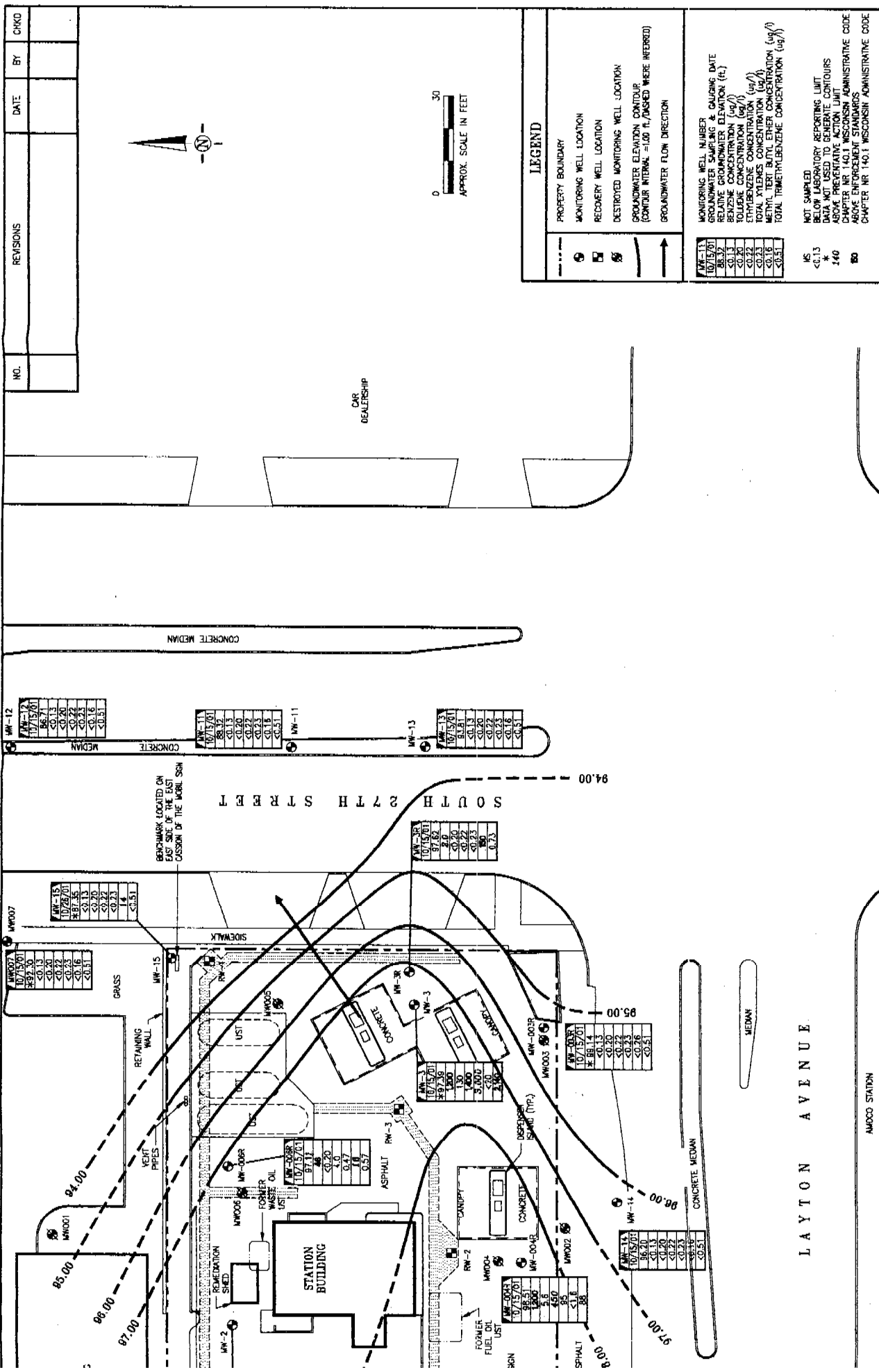

GROUNDWATER ELEVATION & ANALYTICAL RESULTS MAP (OCTOBER 2001)
MOBIL SERVICE STATION # 05-PED
4691 SOUTH 27TH STREET
GREENFIELD, MILWAUKEE COUNTY, WISCONSIN

EXXON MOBIL CORPORATION
 Refining and Supply
 Fairfax, Virginia 22037

Handlex
 OF WISCONSIN
 16940 VICTOR ROAD
 NEW BERLIN, WI 53151
 (262) 641-9011

DRAWN BY: M. SMITH
CHECKED BY: ~~SM~~ - ~~11/02~~
SCALE: 1" = 30'
DATE: 1/19/02
DRAWING FILE: 114:23

FIGURE 4

NO.	REVISIONS	DATE	BY	CHKD

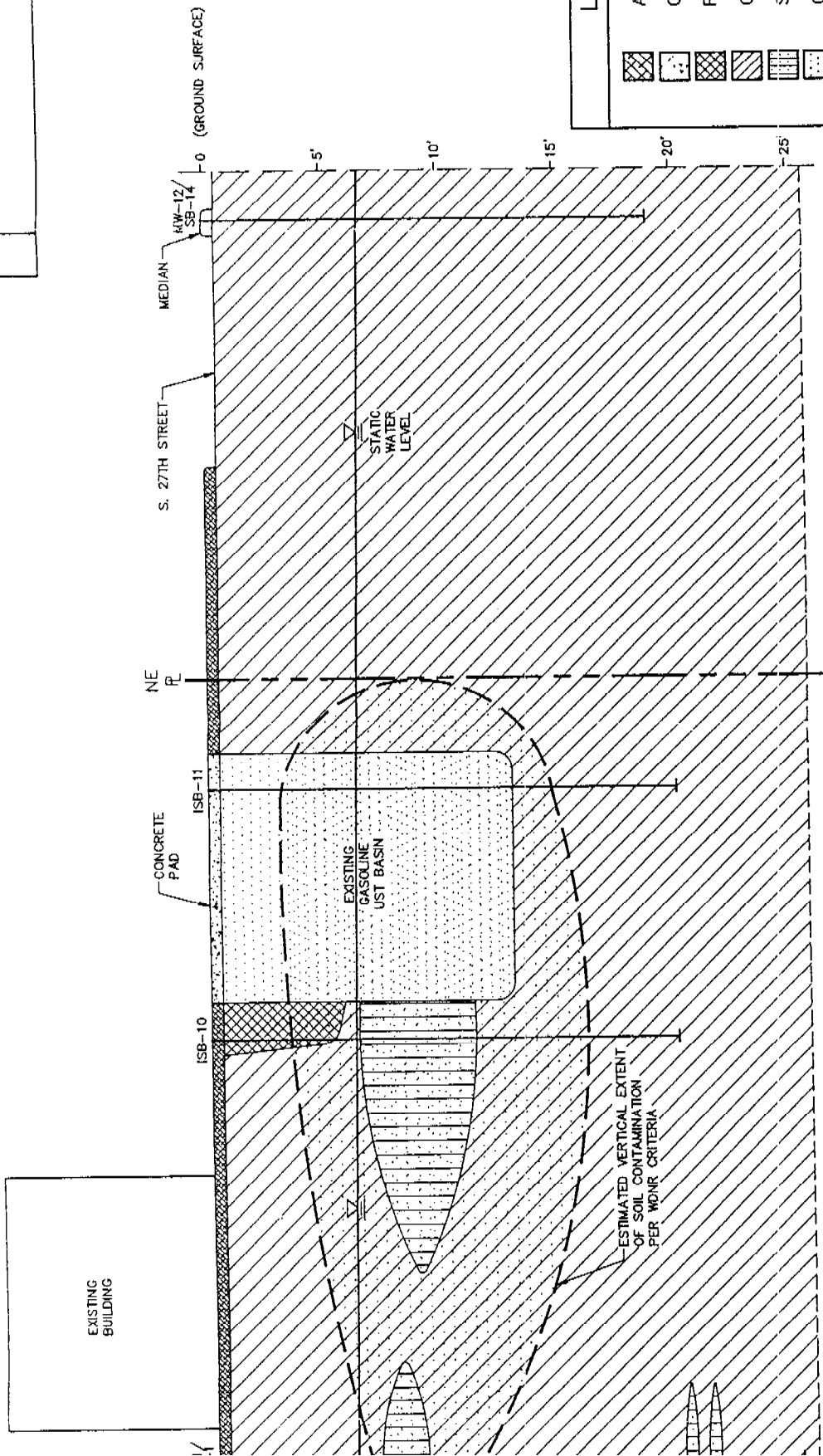

LEGEND

- ASPHALT
- CONCRETE
- FILL
- CLAY
- SILTY SAND
- GRAVEL

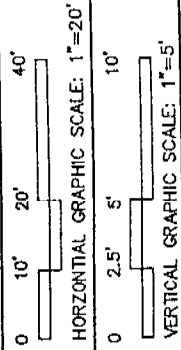

A CROSS SECTION

DRAWING NUMBER	05-PED
SHEET NUMBER	5-OF-13
REVISION	

DRAWN BY KRZ.
CHECKED BY RPK
SCALE AS NOTED
DATE JULY 1993

SITE CROSS SECTION
4691 SOUTH 27TH STREET
GREENFIELD, WI

MOBIL OIL CORPORATION
Marketing & Refining Division - U.S.
Marketing Operations Department
Environmental Engineering Group
Fairfax, Virginia 22037

Certified Mail # 7001 2510 0007 5649 3723

May 24, 2002

ExxonMobil
Refining & Supply

Klein Enterprises, Inc
Mr. John Klein
4691 South 27th Street
Greenfield, Wisconsin 53221

Re: GIS Registry
Mobil Service Station 05-PED (Former Shell Oil)
4691 South 27th Street
Greenfield, Wisconsin

Dear Mr. Klein:

On behalf of Shell Oil Products US, I am writing to notify you of recent revisions to the NR 700 rule series of the Wisconsin Administrative Code (WAC). Changes to the WAC became effective November 1, 2001 requiring certain properties to be listed on a geographic information system (GIS) Registry maintained by the Wisconsin Department of Natural Resources (WDNR). This recent rule change allows for closure of environmental remediation sites where natural attenuation is being used to complete groundwater cleanup without requiring groundwater use restrictions to be recorded with the property deed.

Groundwater at the property at 4691 South 27th Street, Greenfield, Wisconsin (the Property) has been tested by ExxonMobil's consultants on a frequent basis, and has exhibited levels of benzene, ethylbenzene, total trimethylbenzenes, and methyl tert-butyl ether above the state groundwater enforcement standards found in chapter NR 140 of the WAC. However, the environmental consultants who have investigated this property have informed me that the area of dissolved-phase petroleum impacts to groundwater is stable or receding and will naturally degrade over time. Allowing natural attenuation to complete the cleanup at this site will meet the requirements for case closure that are found in chapter NR 726, WAC, and my consultant has requested that the Department of Commerce (the Department) accept natural attenuation as the final remedy for this site and grant case closure. Closure means that the Department will not be requiring any further investigation or cleanup action to be taken, other than the reliance on natural attenuation. Included as an attachment to this letter is a copy of the WDNR's fact sheet describing the use of natural attenuation as a final remedy (Publication #RR-671).

The Department will not review my closure request for at least 30 days after the date of this letter. As the owner of the Property, you may contact the Department to provide any technical information that indicates closure should not be granted for this site. If you would like to submit any information relevant to this closure request to the Department, you should mail that information to: Ms. Linda Michalets, Hydrogeologist, Wisconsin Department of Commerce, Environmental and Regulatory Services Division, 101 West Pleasant Street, Suite 100A, Milwaukee, Wisconsin 53212.

If this case is closed, all properties within the area where groundwater quality exceeds NR 140 groundwater enforcement standards will be listed on the WDNR's GIS Registry of Closed Remediation Sites. The information on the GIS Registry includes maps showing the location of properties in Wisconsin where groundwater quality above chapter NR 140 standards was found at the time that the case was closed. This GIS Registry will be available to the general public on the

WDNR's internal web site. I have enclosed with this letter the legal description of the property. Please review this legal description and notify me within the next 30 days if the legal description is incorrect.

The GIS registry will be used by the WDNR to make sure wells are properly installed in Wisconsin. Should you or any subsequent property owner wish to construct or reconstruct a well, special well construction standards may be necessary to protect the well from groundwater above NR 140 enforcement standards. Any well driller who proposes to construct a well on the Property in the future will first need to call the Digger's Hotline (1-800-242-8511) if the Property is located outside of the service area of a municipally owned water system. If the Property is located within the designated service area of a municipally owned water system, the driller will need to contact the Drinking Water program within the WDNR. Either way, the WDNR will then contact the well driller to advise if there is a need for special well construction standards.

It is my understanding that Klein Enterprises, Inc purchased the Property from Mobil Oil Corporation during October 1994. Neither you nor any subsequent owner of the Property will be held responsible for investigation or cleanup of impacts to groundwater caused by activities that occurred at the property prior to 1994, as long as you and any subsequent owners comply with the requirement of section 292.13, Wisconsin Statutes, including allowing access to you property for environmental investigation or cleanup if access is required. For further information on the requirements of Section 292.13, Wisconsin Statutes, you may call 1-800-367-6076 to obtain a copy of the WDNR's publication #RR-589, Fact Sheet 10: Guidance for Dealing with Properties Affected by Off-Site Contamination. There are no costs to you for the closure or for the GIS Registry.

Once the Department makes a decision on my closure request, it will be documented in a letter. I will forward you a copy of the closure letter for your information. You may also obtain a copy of this letter by writing to the agency address given above, or by accessing the DNR GIS Registry of Closed Remediation Sites on the internet at www.dnr.state.wi.us/org/at/ct/geo/gwur. A copy of the closure letter will be included as part of the site file on the GIS Registry of Closed Remediation Sites.

Should you have any questions regarding this correspondence, please do not hesitate to contact me at (815) 521-7369, or you may contact Ms. Linda Michalets of the Wisconsin Department of Commerce at (414)-220-5376.

Sincerely,



Jeffrey A. Johnson
Territory Manager
ExxonMobil Oil Corporation

Attachments:

1. WDNR Factsheet (Publication #RR-671)
2. Legal Description of the Property

cc: Tammi Nagel, Handex of Wisconsin
John Robbins, Shell Oil Products US
Linda Michalets, Wisconsin Department of Commerce



Certified Mail # 7002 0510 0000 2287 9454

November 22, 2002

City Clerk of Greenfield
7325 West Forest Home Avenue
Greenfield, Wisconsin 53220

Re: Notification of Potential Petroleum Impacts within ROW Adjacent to:

Mobil Service Station 05-PED
4691 South 27th Street
Greenfield, Wisconsin
Commerce #53221-2103-91
WDNR BRRTS # 03-41-000748

Dear Sir or Madam:

Handex of Wisconsin (Handex) has prepared this letter on behalf of ExxonMobil Refining and Supply Company (ExxonMobil) to notify the City of Greenfield (the City) that residual petroleum impacts to groundwater may be present within the right-of-ways (ROWs) located adjacent to the above-referenced property. This notification is required by the State of Wisconsin as a condition of final closure for the environmental case file associated with the service station.

In a letter dated June 27, 2002, the Wisconsin Department of Commerce (COMM - Environmental and Regulatory Services) granted conditional closure of the environmental case file opened for the referenced property in 1991. In the June 2001 letter COMM states that "no further investigation or remedial action is necessary" for the former service station. Although COMM has determined that no further action is necessary at the site, residual groundwater impacts may be present within the South 27th Street (US Highway 41) and Layton Avenue (County Highway Y) ROWs located adjacent and to the east and south, respectively, of the service station. Handex understands that the Wisconsin Department of Transportation (WDOT) maintains South 27th Street in the vicinity of the referenced property. Milwaukee County maintains Layton Avenue.

As of October 2001, benzene and methyl tert-butyl ether (MTBE) were reported at concentrations of 2.0 and 150 micrograms per liter ($\mu\text{g/L}$), respectively in a monitoring well (MW-3R) located west of the South 27th Street ROW. Benzene and MTBE were not reported in wells located within the South 27th Street ROW (MW-11, MW-12, and MW-13). Benzene, toluene, ethylbenzene, total xylenes, and total trimethylbenzenes were reported at concentrations of 1200 $\mu\text{g/L}$, 5.6 $\mu\text{g/L}$, 450 $\mu\text{g/L}$, 95 $\mu\text{g/L}$, and 88 $\mu\text{g/L}$, respectively in a monitoring well (MW-004R) located north of the Layton Avenue ROW. Petroleum compounds were not reported within the Layton Avenue ROW at MW-14. A site map with groundwater concentrations is included for your reference.

Should you have any questions, or require additional information, please feel free to contact the undersigned in writing at the letterhead address, or by telephone at (262) 641-9011, extension 110.

Sincerely,

Handex of Wisconsin

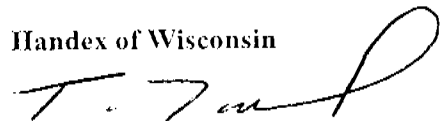

Tammi L. Nagel
Project Manager

cc: Jeff Johnson, ExxonMobil Refining and Supply Company
Gary Mick, Milwaukee County (DPW) (Certified Mail 7002 0510 0000 2287 9447)
Keith Ponath, Milwaukee County (Highway Operations)

el, Tammi

From: TeBeest, Sharlene [sharlene.tebeest@dot.state.wi.us]
Sent: Wednesday, November 13, 2002 10:10 AM
Subject: RE: Notice of Potential Impact to Groundwater in the ROW, Mobil 05 -PED , 4691 South 27th Street (Highway 41), Greenfield, WI

Hi Tammi,
I received your notification.

It was a great week!

Sharlene TeBeest
Groundwater Materials Specialist
Environmental Department of Transportation
Division of Environment
Phone (608) 266-1476; Fax (608) 266-7818
Email: sharlene.tebeest@dot.state.wi.us

Original Message-----

From: Nagel, Tammi [mailto:TNagel@handexmail.com]
Sent: Wednesday, November 13, 2002 10:04 AM
Subject: 'TeBeest, Sharlene'
Subject: Notice of Potential Impact to Groundwater in the ROW, Mobil 05 -PED , 4691 South 27th Street (Highway 41), Greenfield, WI

The above-referenced site was granted conditional closure by the Wisconsin Department of Commerce (the Department) in a letter dated June 27, 2002. As a condition of closure, the Department requested that the agency responsible for maintaining the 27th Street (Highway 41) ROW adjacent to the site be notified of petroleum impacted groundwater that may extend beneath the ROW adjacent to the site. As requested, I'm providing this notification via e-mail. Attached you will find a groundwater figure in pdf format, and a completed notification document.

OBILPED.PDF>> <<ROWNOT.DOC>>

Please feel free to give me a call if you have any questions regarding this email or the attachments.

Sincerely,

Tammi Nagel
District Manager

Division of Wisconsin
100 West Victor Road
Berlin, Wisconsin 53151
Phone: 262-641-9011, ext. 110
262-641-9987
Email: tnagel@handexmail.com

Notification of Potential Contamination within the Right of Way

County: Milwaukee County

Highway: 41

Site Name: Mobil Service Station 05-PED/Former Shell

Site Address: 4691 South 27th Street (Highway 41)

BRRTS Number: 03-41-000748

PECFA Number: 53221-2103-91

FID Number: 241129570

Responsible Party's Name: Shell Oil Products US c/o ExxonMobil Oil Corporation

Responsible Party's Address: Joliet Refinery, PO Box 874, Joliet, IL 60434

Consulting Firm: Handex of Wisconsin

Consultant Contact: Tammi L. Nagel

Consultant Address: 16940 West Victor Road, New Berlin, WI 53151

Consultant Phone, Fax and E-mail: 262-641-9011; ext. 110, 262-641-9987;

tnagel@handexmail.com

Soil contamination? Yes/no: No

Depth to contaminated soil: NA

Vertical extent of contaminated soil: NA

Groundwater contamination? Yes/no: On-property yes, potentially in ROW

Depth to water table: Approximately 5-13 feet

Describe the type(s) of contamination present: Petroleum Volatile Organic Compounds (PVOCs)

Brief summary of cleanup activity: Liquid-phase petroleum hydrocarbon recovery, excavation, and natural attenuation.

Attach a current plume map for groundwater contamination: See attached.

Attach a current plume map for soil contamination: NA