



March 15, 2017

Maqsood Ahmad
18210 Prairie Falcon Ln.
Brookfield, WI 53045

RE: Agreement to Provide Access for Sampling Activities
2200 South 108th Street, West Allis, WI
BRRTS# 02-41-246246

FID 241 287 530

Dear Mr. Ahmad:

In accordance with the executed Access Agreement and in accordance with Wisconsin Department of Natural Resources (WDNR) regulation NR 716.14, Environmental Forensic Investigations, Inc. (EnviroForensics) is providing the results of environmental samples collected from your property located at 2200 South 108th Street in West Allis, Wisconsin. The samples were collected March 7, 2017. The sampling activities are part of an environmental investigation being performed for the One Hour Martinizing facility located at 2262 S 108th Street in West Allis at the direction of the WDNR pursuant to the authority granted to it under State and Federal law. The chemicals of concern for the investigation are the dry cleaning solvent tetrachloroethene (PCE) and its associated breakdown products.

The Responsible Party is:

Mr. Brian Cass
OHM Holdings, Inc.
W229 N2494 Hwy F
Waukesha, WI 53186
Telephone: 262-521-9710

Sampling Results

Two (2) grab-groundwater samples (designated 6406-DP-3w and 6406-DP-4w) were collected from temporary wells installed within your property boundary. The sample locations are depicted on **Figure 1**. As shown on **Table 1**, chemicals of concern were not detected in either of the grab-groundwater samples. The laboratory reports that relate to the grab-groundwater samples are attached.

Upon conclusion of the soil boring activities, the boreholes were abandoned with hydrated bentonite and the property was restored to substantially the same condition as it existed prior to access.

Document: 6406-0314
Environmental Forensic Investigations, Inc.
N16 W23390 Stone Ridge Drive, Suite G, Waukesha, WI 53188
Phone: 262-290-4001 • Fax 317-972-7875



Thank you for cooperating with our investigation. We do not anticipate any additional work to be performed at your property. If you have any questions or concerns, please contact me at 414-982-3988 or by email at wfassbender@enviroforensics.com. The WDNR project manager, John Hnat, can be reached at 414-263-8644. We greatly appreciate your help and patience with this matter.

Sincerely,
Environmental Forensic Investigations, Inc.

A handwritten signature in black ink, appearing to read "Wayne Fassbender".

Wayne Fassbender, PG, PMP
Senior Project Manager

Attachments:

- Figure 1: Grab-Groundwater Sample Locations
- Table 1: Groundwater Results
- Laboratory Reports

Legend

- VTR — Underground water utility line
- SAN — Underground sanitary utility line
- STM — Underground storm utility line
- DP-3w ● Grab-groundwater location

- Note:
1. Samples analyzed using EPA SW-846 Method 8260
 2. All results reported in units of micrograms per liter (µg/L)

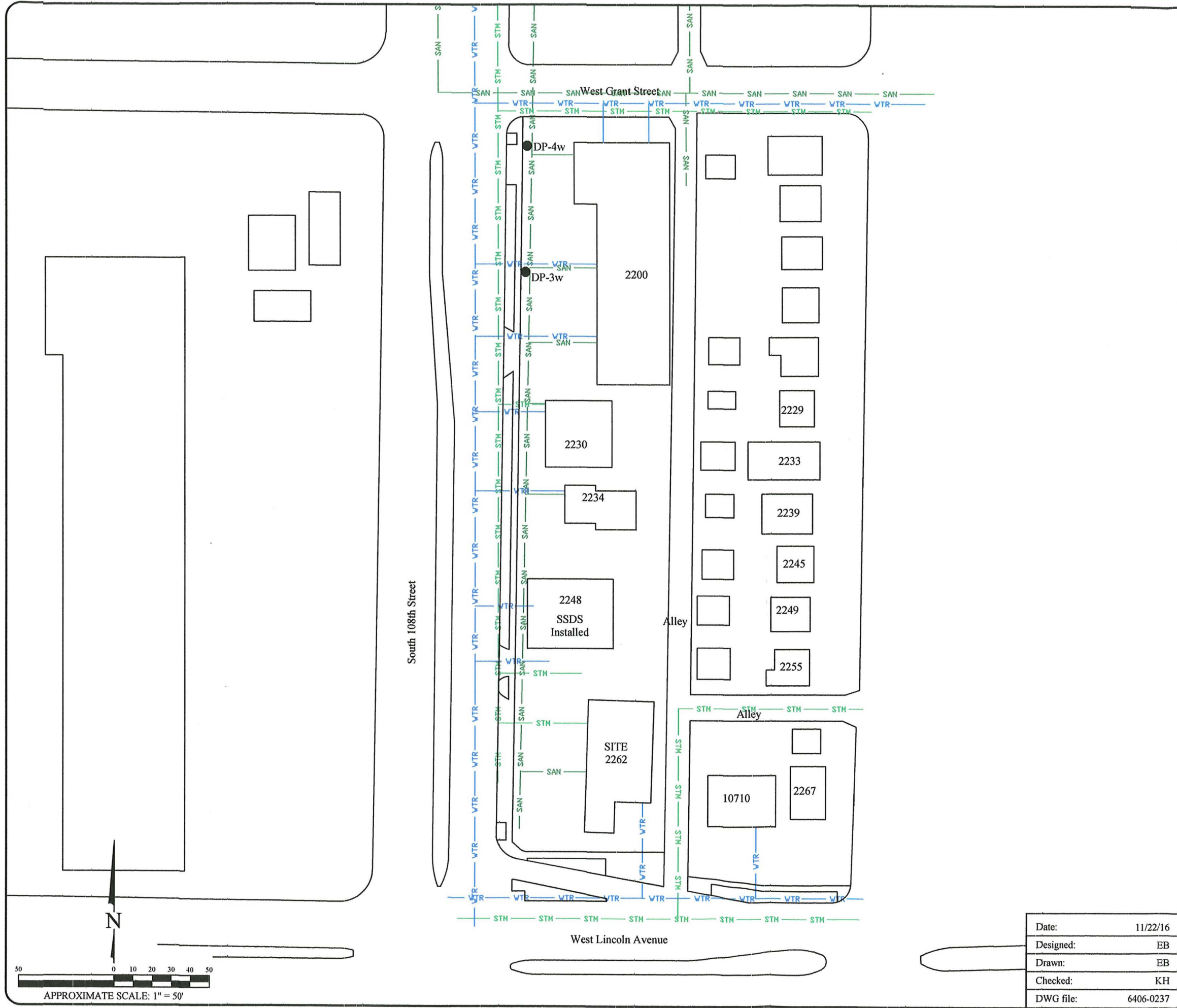

GRAB-GROUNDWATER SAMPLE LOCATIONS

OHM - Lincoln
 2262 South 108th Street
 West Allis, Wisconsin

Date:	11/22/16
Designed:	EB
Drawn:	EB
Checked:	KH
DWG file:	6406-0237

ENVIROforensics
 ENVIRONMENTAL FORENSIC INVESTIGATIONS, INC.
 825 North Capitol Avenue • Indianapolis, IN 46204
 EnviroForensics.com

Figure	1
Project	6406

TABLE 1
GROUNDWATER RESULTS

One Hour Martinizing
2262 South 108th Street, West Allis, Wisconsin

Monitoring Well Identification	Sample Date	Tetrachloroethene	Trichloroethene	cis-1,2-Dichloroethene	trans-1,2-Dichloroethene	Vinyl Chloride
Public Health Enforcement Standard		5	5	70	100	0.2
Public Health Preventive Action Limit		0.5	0.5	7	20	0.02
DP-3W	3/7/2017	<0.48	<0.45	<0.41	<0.35	<0.19
DP-4W	3/7/2017	<0.48	<0.45	<0.41	<0.35	<0.19

Notes:

All concentrations reported in micrograms per liter µg/l
Samples analyzed using EPA SW-846 Method 8260

Synergy Environmental Lab, INC.

1990 Prospect Ct., Appleton, WI 54914 *P 920-830-2455 * F 920-733-0631

WAYNE FASSBENDER
ENVIROFORENSICS
825 N. CAPITOL AVENUE
INDIANAPOLIS, IN 46204

Report Date 14-Mar-17

Project Name OHM-LINCOLN
Project # 6406 PO2017-0362

Invoice # E32585

Lab Code 5032585A
Sample ID 6406-DP-3W
Sample Matrix Water
Sample Date 3/7/2017

	Result	Unit	LOD	LOQ	Dil	Method	Ext Date	Run Date	Analyst	Code
Organic										
VOC's										
Benzene	< 0.17	ug/l	0.17	0.55	1	8260B		3/13/2017	CJR	1
Bromobenzene	< 0.43	ug/l	0.43	1.37	1	8260B		3/13/2017	CJR	1
Bromodichloromethane	< 0.31	ug/l	0.31	1	1	8260B		3/13/2017	CJR	1
Bromoform	< 0.49	ug/l	0.49	1.56	1	8260B		3/13/2017	CJR	1
tert-Butylbenzene	< 0.39	ug/l	0.39	1.23	1	8260B		3/13/2017	CJR	1
sec-Butylbenzene	< 0.24	ug/l	0.24	0.76	1	8260B		3/13/2017	CJR	1
n-Butylbenzene	< 0.34	ug/l	0.34	1.08	1	8260B		3/13/2017	CJR	1
Carbon Tetrachloride	< 0.21	ug/l	0.21	0.68	1	8260B		3/13/2017	CJR	1
Chlorobenzene	< 0.27	ug/l	0.27	0.86	1	8260B		3/13/2017	CJR	1
Chloroethane	< 0.5	ug/l	0.5	1.6	1	8260B		3/13/2017	CJR	1
Chloroform	< 0.96	ug/l	0.96	3.04	1	8260B		3/13/2017	CJR	1
Chloromethane	< 1.3	ug/l	1.3	4.15	1	8260B		3/13/2017	CJR	1
2-Chlorotoluene	< 0.36	ug/l	0.36	1.15	1	8260B		3/13/2017	CJR	1
4-Chlorotoluene	< 0.35	ug/l	0.35	1.11	1	8260B		3/13/2017	CJR	1
1,2-Dibromo-3-chloropropane	< 1.88	ug/l	1.88	5.98	1	8260B		3/13/2017	CJR	1
Dibromochloromethane	< 0.45	ug/l	0.45	1.44	1	8260B		3/13/2017	CJR	1
1,4-Dichlorobenzene	< 0.42	ug/l	0.42	1.34	1	8260B		3/13/2017	CJR	1
1,3-Dichlorobenzene	< 0.45	ug/l	0.45	1.43	1	8260B		3/13/2017	CJR	1
1,2-Dichlorobenzene	< 0.34	ug/l	0.34	1.09	1	8260B		3/13/2017	CJR	1
Dichlorodifluoromethane	< 0.38	ug/l	0.38	1.2	1	8260B		3/13/2017	CJR	1
1,2-Dichloroethane	< 0.45	ug/l	0.45	1.43	1	8260B		3/13/2017	CJR	1
1,1-Dichloroethane	< 0.42	ug/l	0.42	1.34	1	8260B		3/13/2017	CJR	1
1,1-Dichloroethene	< 0.46	ug/l	0.46	1.47	1	8260B		3/13/2017	CJR	1
cis-1,2-Dichloroethene	< 0.41	ug/l	0.41	1.29	1	8260B		3/13/2017	CJR	1
trans-1,2-Dichloroethene	< 0.35	ug/l	0.35	1.12	1	8260B		3/13/2017	CJR	1
1,2-Dichloropropane	< 0.39	ug/l	0.39	1.24	1	8260B		3/13/2017	CJR	1
1,3-Dichloropropane	< 0.49	ug/l	0.49	1.55	1	8260B		3/13/2017	CJR	1
trans-1,3-Dichloropropene	< 0.42	ug/l	0.42	1.33	1	8260B		3/13/2017	CJR	1
cis-1,3-Dichloropropene	< 0.21	ug/l	0.21	0.65	1	8260B		3/13/2017	CJR	1

Project Name OHM-LINCOLN
 Project # 6406 PO2017-0362

Invoice # E32585

Lab Code 5032585A
 Sample ID 6406-DP-3W
 Sample Matrix Water
 Sample Date 3/7/2017

	Result	Unit	LOD	LOQ	Dil	Method	Ext Date	Run Date	Analyst	Code
Di-isopropyl ether	< 0.26	ug/l	0.26	0.83	1	8260B		3/13/2017	CJR	1
EDB (1,2-Dibromoethane)	< 0.34	ug/l	0.34	1.09	1	8260B		3/13/2017	CJR	1
Ethylbenzene	< 0.2	ug/l	0.2	0.63	1	8260B		3/13/2017	CJR	1
Hexachlorobutadiene	< 1.47	ug/l	1.47	4.68	1	8260B		3/13/2017	CJR	1
Isopropylbenzene	< 0.29	ug/l	0.29	0.93	1	8260B		3/13/2017	CJR	1
p-Isopropyltoluene	< 0.28	ug/l	0.28	0.91	1	8260B		3/13/2017	CJR	1
Methylene chloride	< 0.94	ug/l	0.94	2.98	1	8260B		3/13/2017	CJR	1
Methyl tert-butyl ether (MTBE)	< 0.82	ug/l	0.82	2.6	1	8260B		3/13/2017	CJR	1
Naphthalene	< 2.17	ug/l	2.17	6.9	1	8260B		3/13/2017	CJR	1
n-Propylbenzene	< 0.19	ug/l	0.19	0.62	1	8260B		3/13/2017	CJR	1
1,1,2,2-Tetrachloroethane	< 0.69	ug/l	0.69	2.21	1	8260B		3/13/2017	CJR	1
1,1,1,2-Tetrachloroethane	< 0.47	ug/l	0.47	1.48	1	8260B		3/13/2017	CJR	1
Tetrachloroethene	< 0.48	ug/l	0.48	1.52	1	8260B		3/13/2017	CJR	1
Toluene	< 0.67	ug/l	0.67	2.13	1	8260B		3/13/2017	CJR	1
1,2,4-Trichlorobenzene	< 1.29	ug/l	1.29	4.1	1	8260B		3/13/2017	CJR	1
1,2,3-Trichlorobenzene	< 0.83	ug/l	0.83	2.63	1	8260B		3/13/2017	CJR	1
1,1,1-Trichloroethane	< 0.35	ug/l	0.35	1.11	1	8260B		3/13/2017	CJR	1
1,1,2-Trichloroethane	< 0.65	ug/l	0.65	2.06	1	8260B		3/13/2017	CJR	1
Trichloroethene (TCE)	< 0.45	ug/l	0.45	1.43	1	8260B		3/13/2017	CJR	1
Trichlorofluoromethane	< 0.64	ug/l	0.64	2.04	1	8260B		3/13/2017	CJR	1
1,2,4-Trimethylbenzene	< 1.14	ug/l	1.14	3.63	1	8260B		3/13/2017	CJR	1
1,3,5-Trimethylbenzene	< 0.91	ug/l	0.91	2.9	1	8260B		3/13/2017	CJR	1
Vinyl Chloride	< 0.19	ug/l	0.19	0.62	1	8260B		3/13/2017	CJR	1
m&p-Xylene	< 1.56	ug/l	1.56	4.95	1	8260B		3/13/2017	CJR	1
o-Xylene	< 0.39	ug/l	0.39	1.25	1	8260B		3/13/2017	CJR	1
SUR - Toluene-d8	98	REC %			1	8260B		3/13/2017	CJR	1
SUR - 1,2-Dichloroethane-d4	106	REC %			1	8260B		3/13/2017	CJR	1
SUR - 4-Bromofluorobenzene	102	REC %			1	8260B		3/13/2017	CJR	1
SUR - Dibromofluoromethane	98	REC %			1	8260B		3/13/2017	CJR	1

Project Name OHM-LINCOLN
 Project # 6406 PO2017-0362

Invoice # E32585

Lab Code 5032585B
 Sample ID 6406-DP-4W
 Sample Matrix Water
 Sample Date 3/7/2017

	Result	Unit	LOD	LOQ	Dil	Method	Ext Date	Run Date	Analyst	Code
Organic										
VOC's										
Benzene	< 0.17	ug/l	0.17	0.55	1	8260B		3/13/2017	CJR	1
Bromobenzene	< 0.43	ug/l	0.43	1.37	1	8260B		3/13/2017	CJR	1
Bromodichloromethane	< 0.31	ug/l	0.31	1	1	8260B		3/13/2017	CJR	1
Bromoform	< 0.49	ug/l	0.49	1.56	1	8260B		3/13/2017	CJR	1
tert-Butylbenzene	< 0.39	ug/l	0.39	1.23	1	8260B		3/13/2017	CJR	1
sec-Butylbenzene	< 0.24	ug/l	0.24	0.76	1	8260B		3/13/2017	CJR	1
n-Butylbenzene	< 0.34	ug/l	0.34	1.08	1	8260B		3/13/2017	CJR	1
Carbon Tetrachloride	< 0.21	ug/l	0.21	0.68	1	8260B		3/13/2017	CJR	1
Chlorobenzene	< 0.27	ug/l	0.27	0.86	1	8260B		3/13/2017	CJR	1
Chloroethane	< 0.5	ug/l	0.5	1.6	1	8260B		3/13/2017	CJR	1
Chloroform	< 0.96	ug/l	0.96	3.04	1	8260B		3/13/2017	CJR	1
Chloromethane	< 1.3	ug/l	1.3	4.15	1	8260B		3/13/2017	CJR	1
2-Chlorotoluene	< 0.36	ug/l	0.36	1.15	1	8260B		3/13/2017	CJR	1
4-Chlorotoluene	< 0.35	ug/l	0.35	1.11	1	8260B		3/13/2017	CJR	1
1,2-Dibromo-3-chloropropane	< 1.88	ug/l	1.88	5.98	1	8260B		3/13/2017	CJR	1
Dibromochloromethane	< 0.45	ug/l	0.45	1.44	1	8260B		3/13/2017	CJR	1
1,4-Dichlorobenzene	< 0.42	ug/l	0.42	1.34	1	8260B		3/13/2017	CJR	1
1,3-Dichlorobenzene	< 0.45	ug/l	0.45	1.43	1	8260B		3/13/2017	CJR	1
1,2-Dichlorobenzene	< 0.34	ug/l	0.34	1.09	1	8260B		3/13/2017	CJR	1
Dichlorodifluoromethane	< 0.38	ug/l	0.38	1.2	1	8260B		3/13/2017	CJR	1
1,2-Dichloroethane	< 0.45	ug/l	0.45	1.43	1	8260B		3/13/2017	CJR	1
1,1-Dichloroethane	< 0.42	ug/l	0.42	1.34	1	8260B		3/13/2017	CJR	1
1,1-Dichloroethene	< 0.46	ug/l	0.46	1.47	1	8260B		3/13/2017	CJR	1
cis-1,2-Dichloroethene	< 0.41	ug/l	0.41	1.29	1	8260B		3/13/2017	CJR	1
trans-1,2-Dichloroethene	< 0.35	ug/l	0.35	1.12	1	8260B		3/13/2017	CJR	1
1,2-Dichloropropane	< 0.39	ug/l	0.39	1.24	1	8260B		3/13/2017	CJR	1
1,3-Dichloropropane	< 0.49	ug/l	0.49	1.55	1	8260B		3/13/2017	CJR	1
trans-1,3-Dichloropropene	< 0.42	ug/l	0.42	1.33	1	8260B		3/13/2017	CJR	1
cis-1,3-Dichloropropene	< 0.21	ug/l	0.21	0.65	1	8260B		3/13/2017	CJR	1
Di-isopropyl ether	< 0.26	ug/l	0.26	0.83	1	8260B		3/13/2017	CJR	1
EDB (1,2-Dibromoethane)	< 0.34	ug/l	0.34	1.09	1	8260B		3/13/2017	CJR	1
Ethylbenzene	< 0.2	ug/l	0.2	0.63	1	8260B		3/13/2017	CJR	1
Hexachlorobutadiene	< 1.47	ug/l	1.47	4.68	1	8260B		3/13/2017	CJR	1
Isopropylbenzene	< 0.29	ug/l	0.29	0.93	1	8260B		3/13/2017	CJR	1
p-Isopropyltoluene	< 0.28	ug/l	0.28	0.91	1	8260B		3/13/2017	CJR	1
Methylene chloride	< 0.94	ug/l	0.94	2.98	1	8260B		3/13/2017	CJR	1
Methyl tert-butyl ether (MTBE)	< 0.82	ug/l	0.82	2.6	1	8260B		3/13/2017	CJR	1
Naphthalene	< 2.17	ug/l	2.17	6.9	1	8260B		3/13/2017	CJR	1
n-Propylbenzene	< 0.19	ug/l	0.19	0.62	1	8260B		3/13/2017	CJR	1
1,1,2,2-Tetrachloroethane	< 0.69	ug/l	0.69	2.21	1	8260B		3/13/2017	CJR	1
1,1,1,2-Tetrachloroethane	< 0.47	ug/l	0.47	1.48	1	8260B		3/13/2017	CJR	1
Tetrachloroethene	< 0.48	ug/l	0.48	1.52	1	8260B		3/13/2017	CJR	1
Toluene	< 0.67	ug/l	0.67	2.13	1	8260B		3/13/2017	CJR	1
1,2,4-Trichlorobenzene	< 1.29	ug/l	1.29	4.1	1	8260B		3/13/2017	CJR	1
1,2,3-Trichlorobenzene	< 0.83	ug/l	0.83	2.63	1	8260B		3/13/2017	CJR	1
1,1,1-Trichloroethane	< 0.35	ug/l	0.35	1.11	1	8260B		3/13/2017	CJR	1
1,1,2-Trichloroethane	< 0.65	ug/l	0.65	2.06	1	8260B		3/13/2017	CJR	1
Trichloroethene (TCE)	< 0.45	ug/l	0.45	1.43	1	8260B		3/13/2017	CJR	1
Trichlorofluoromethane	< 0.64	ug/l	0.64	2.04	1	8260B		3/13/2017	CJR	1
1,2,4-Trimethylbenzene	< 1.14	ug/l	1.14	3.63	1	8260B		3/13/2017	CJR	1

Project Name OHM-LINCOLN
Project # 6406 PO2017-0362

Invoice # E32585

Lab Code 5032585B
Sample ID 6406-DP-4W
Sample Matrix Water
Sample Date 3/7/2017

	Result	Unit	LOD	LOQ	Dil	Method	Ext Date	Run Date	Analyst	Code
1,3,5-Trimethylbenzene	< 0.91	ug/l	0.91	2.9	1	8260B		3/13/2017	CJR	1
Vinyl Chloride	< 0.19	ug/l	0.19	0.62	1	8260B		3/13/2017	CJR	1
m&p-Xylene	< 1.56	ug/l	1.56	4.95	1	8260B		3/13/2017	CJR	1
o-Xylene	< 0.39	ug/l	0.39	1.25	1	8260B		3/13/2017	CJR	1
SUR - Dibromofluoromethane	100	REC %				1 8260B		3/13/2017	CJR	1
SUR - 1,2-Dichloroethane-d4	101	REC %				1 8260B		3/13/2017	CJR	1
SUR - 4-Bromofluorobenzene	101	REC %				1 8260B		3/13/2017	CJR	1
SUR - Toluene-d8	101	REC %				1 8260B		3/13/2017	CJR	1

Project Name OHM-LINCOLN
 Project # 6406 PO2017-0362

Invoice # E32585

Lab Code 5032585C
 Sample ID 6406-DUP-1
 Sample Matrix Water
 Sample Date 3/7/2017

	Result	Unit	LOD	LOQ	Dil	Method	Ext Date	Run Date	Analyst	Code
Organic										
VOC's										
Benzene	< 0.17	ug/l	0.17	0.55	1	8260B		3/13/2017	CJR	1
Bromobenzene	< 0.43	ug/l	0.43	1.37	1	8260B		3/13/2017	CJR	1
Bromodichloromethane	< 0.31	ug/l	0.31	1	1	8260B		3/13/2017	CJR	1
Bromoform	< 0.49	ug/l	0.49	1.56	1	8260B		3/13/2017	CJR	1
tert-Butylbenzene	< 0.39	ug/l	0.39	1.23	1	8260B		3/13/2017	CJR	1
sec-Butylbenzene	< 0.24	ug/l	0.24	0.76	1	8260B		3/13/2017	CJR	1
n-Butylbenzene	< 0.34	ug/l	0.34	1.08	1	8260B		3/13/2017	CJR	1
Carbon Tetrachloride	< 0.21	ug/l	0.21	0.68	1	8260B		3/13/2017	CJR	1
Chlorobenzene	< 0.27	ug/l	0.27	0.86	1	8260B		3/13/2017	CJR	1
Chloroethane	< 0.5	ug/l	0.5	1.6	1	8260B		3/13/2017	CJR	1
Chloroform	< 0.96	ug/l	0.96	3.04	1	8260B		3/13/2017	CJR	1
Chloromethane	< 1.3	ug/l	1.3	4.15	1	8260B		3/13/2017	CJR	1
2-Chlorotoluene	< 0.36	ug/l	0.36	1.15	1	8260B		3/13/2017	CJR	1
4-Chlorotoluene	< 0.35	ug/l	0.35	1.11	1	8260B		3/13/2017	CJR	1
1,2-Dibromo-3-chloropropane	< 1.88	ug/l	1.88	5.98	1	8260B		3/13/2017	CJR	1
Dibromochloromethane	< 0.45	ug/l	0.45	1.44	1	8260B		3/13/2017	CJR	1
1,4-Dichlorobenzene	< 0.42	ug/l	0.42	1.34	1	8260B		3/13/2017	CJR	1
1,3-Dichlorobenzene	< 0.45	ug/l	0.45	1.43	1	8260B		3/13/2017	CJR	1
1,2-Dichlorobenzene	< 0.34	ug/l	0.34	1.09	1	8260B		3/13/2017	CJR	1
Dichlorodifluoromethane	< 0.38	ug/l	0.38	1.2	1	8260B		3/13/2017	CJR	1
1,2-Dichloroethane	< 0.45	ug/l	0.45	1.43	1	8260B		3/13/2017	CJR	1
1,1-Dichloroethane	< 0.42	ug/l	0.42	1.34	1	8260B		3/13/2017	CJR	1
1,1-Dichloroethene	< 0.46	ug/l	0.46	1.47	1	8260B		3/13/2017	CJR	1
cis-1,2-Dichloroethene	< 0.41	ug/l	0.41	1.29	1	8260B		3/13/2017	CJR	1
trans-1,2-Dichloroethene	< 0.35	ug/l	0.35	1.12	1	8260B		3/13/2017	CJR	1
1,2-Dichloropropane	< 0.39	ug/l	0.39	1.24	1	8260B		3/13/2017	CJR	1
1,3-Dichloropropane	< 0.49	ug/l	0.49	1.55	1	8260B		3/13/2017	CJR	1
trans-1,3-Dichloropropene	< 0.42	ug/l	0.42	1.33	1	8260B		3/13/2017	CJR	1
cis-1,3-Dichloropropene	< 0.21	ug/l	0.21	0.65	1	8260B		3/13/2017	CJR	1
Di-isopropyl ether	< 0.26	ug/l	0.26	0.83	1	8260B		3/13/2017	CJR	1
EDB (1,2-Dibromoethane)	< 0.34	ug/l	0.34	1.09	1	8260B		3/13/2017	CJR	1
Ethylbenzene	< 0.2	ug/l	0.2	0.63	1	8260B		3/13/2017	CJR	1
Hexachlorobutadiene	< 1.47	ug/l	1.47	4.68	1	8260B		3/13/2017	CJR	1
Isopropylbenzene	< 0.29	ug/l	0.29	0.93	1	8260B		3/13/2017	CJR	1
p-Isopropyltoluene	< 0.28	ug/l	0.28	0.91	1	8260B		3/13/2017	CJR	1
Methylene chloride	< 0.94	ug/l	0.94	2.98	1	8260B		3/13/2017	CJR	1
Methyl tert-butyl ether (MTBE)	< 0.82	ug/l	0.82	2.6	1	8260B		3/13/2017	CJR	1
Naphthalene	< 2.17	ug/l	2.17	6.9	1	8260B		3/13/2017	CJR	1
n-Propylbenzene	< 0.19	ug/l	0.19	0.62	1	8260B		3/13/2017	CJR	1
1,1,2,2-Tetrachloroethane	< 0.69	ug/l	0.69	2.21	1	8260B		3/13/2017	CJR	1
1,1,1,2-Tetrachloroethane	< 0.47	ug/l	0.47	1.48	1	8260B		3/13/2017	CJR	1
Tetrachloroethene	< 0.48	ug/l	0.48	1.52	1	8260B		3/13/2017	CJR	1
Toluene	< 0.67	ug/l	0.67	2.13	1	8260B		3/13/2017	CJR	1
1,2,4-Trichlorobenzene	< 1.29	ug/l	1.29	4.1	1	8260B		3/13/2017	CJR	1
1,2,3-Trichlorobenzene	< 0.83	ug/l	0.83	2.63	1	8260B		3/13/2017	CJR	1
1,1,1-Trichloroethane	< 0.35	ug/l	0.35	1.11	1	8260B		3/13/2017	CJR	1
1,1,2-Trichloroethane	< 0.65	ug/l	0.65	2.06	1	8260B		3/13/2017	CJR	1
Trichloroethene (TCE)	< 0.45	ug/l	0.45	1.43	1	8260B		3/13/2017	CJR	1
Trichlorofluoromethane	< 0.64	ug/l	0.64	2.04	1	8260B		3/13/2017	CJR	1
1,2,4-Trimethylbenzene	< 1.14	ug/l	1.14	3.63	1	8260B		3/13/2017	CJR	1

Project Name OHM-LINCOLN
Project # 6406 PO2017-0362

Invoice # E32585

Lab Code 5032585C
Sample ID 6406-DUP-1
Sample Matrix Water
Sample Date 3/7/2017

	Result	Unit	LOD	LOQ	Dil	Method	Ext Date	Run Date	Analyst	Code
1,3,5-Trimethylbenzene	< 0.91	ug/l	0.91	2.9	1	8260B		3/13/2017	CJR	1
Vinyl Chloride	< 0.19	ug/l	0.19	0.62	1	8260B		3/13/2017	CJR	1
m&p-Xylene	< 1.56	ug/l	1.56	4.95	1	8260B		3/13/2017	CJR	1
o-Xylene	< 0.39	ug/l	0.39	1.25	1	8260B		3/13/2017	CJR	1
SUR - Toluene-d8	100	REC %			1	8260B		3/13/2017	CJR	1
SUR - 1,2-Dichloroethane-d4	92	REC %			1	8260B		3/13/2017	CJR	1
SUR - 4-Bromofluorobenzene	101	REC %			1	8260B		3/13/2017	CJR	1
SUR - Dibromofluoromethane	102	REC %			1	8260B		3/13/2017	CJR	1

Project Name OHM-LINCOLN
 Project # 6406 PO2017-0362

Invoice # E32585

Lab Code 5032585D
 Sample ID TRIP BLANK
 Sample Matrix Water
 Sample Date 3/7/2017

	Result	Unit	LOD	LOQ	Dil	Method	Ext Date	Run Date	Analyst	Code
Organic										
VOC's										
Benzene	< 0.17	ug/l	0.17	0.55	1	8260B		3/13/2017	CJR	1
Bromobenzene	< 0.43	ug/l	0.43	1.37	1	8260B		3/13/2017	CJR	1
Bromodichloromethane	< 0.31	ug/l	0.31	1	1	8260B		3/13/2017	CJR	1
Bromoform	< 0.49	ug/l	0.49	1.56	1	8260B		3/13/2017	CJR	1
tert-Butylbenzene	< 0.39	ug/l	0.39	1.23	1	8260B		3/13/2017	CJR	1
sec-Butylbenzene	< 0.24	ug/l	0.24	0.76	1	8260B		3/13/2017	CJR	1
n-Butylbenzene	< 0.34	ug/l	0.34	1.08	1	8260B		3/13/2017	CJR	1
Carbon Tetrachloride	< 0.21	ug/l	0.21	0.68	1	8260B		3/13/2017	CJR	1
Chlorobenzene	< 0.27	ug/l	0.27	0.86	1	8260B		3/13/2017	CJR	1
Chloroethane	< 0.5	ug/l	0.5	1.6	1	8260B		3/13/2017	CJR	1
Chloroform	< 0.96	ug/l	0.96	3.04	1	8260B		3/13/2017	CJR	1
Chloromethane	< 1.3	ug/l	1.3	4.15	1	8260B		3/13/2017	CJR	1
2-Chlorotoluene	< 0.36	ug/l	0.36	1.15	1	8260B		3/13/2017	CJR	1
4-Chlorotoluene	< 0.35	ug/l	0.35	1.11	1	8260B		3/13/2017	CJR	1
1,2-Dibromo-3-chloropropane	< 1.88	ug/l	1.88	5.98	1	8260B		3/13/2017	CJR	1
Dibromochloromethane	< 0.45	ug/l	0.45	1.44	1	8260B		3/13/2017	CJR	1
1,4-Dichlorobenzene	< 0.42	ug/l	0.42	1.34	1	8260B		3/13/2017	CJR	1
1,3-Dichlorobenzene	< 0.45	ug/l	0.45	1.43	1	8260B		3/13/2017	CJR	1
1,2-Dichlorobenzene	< 0.34	ug/l	0.34	1.09	1	8260B		3/13/2017	CJR	1
Dichlorodifluoromethane	< 0.38	ug/l	0.38	1.2	1	8260B		3/13/2017	CJR	1
1,2-Dichloroethane	< 0.45	ug/l	0.45	1.43	1	8260B		3/13/2017	CJR	1
1,1-Dichloroethane	< 0.42	ug/l	0.42	1.34	1	8260B		3/13/2017	CJR	1
1,1-Dichloroethene	< 0.46	ug/l	0.46	1.47	1	8260B		3/13/2017	CJR	1
cis-1,2-Dichloroethene	< 0.41	ug/l	0.41	1.29	1	8260B		3/13/2017	CJR	1
trans-1,2-Dichloroethene	< 0.35	ug/l	0.35	1.12	1	8260B		3/13/2017	CJR	1
1,2-Dichloropropane	< 0.39	ug/l	0.39	1.24	1	8260B		3/13/2017	CJR	1
1,3-Dichloropropane	< 0.49	ug/l	0.49	1.55	1	8260B		3/13/2017	CJR	1
trans-1,3-Dichloropropene	< 0.42	ug/l	0.42	1.33	1	8260B		3/13/2017	CJR	1
cis-1,3-Dichloropropene	< 0.21	ug/l	0.21	0.65	1	8260B		3/13/2017	CJR	1
Di-isopropyl ether	< 0.26	ug/l	0.26	0.83	1	8260B		3/13/2017	CJR	1
EDB (1,2-Dibromoethane)	< 0.34	ug/l	0.34	1.09	1	8260B		3/13/2017	CJR	1
Ethylbenzene	< 0.2	ug/l	0.2	0.63	1	8260B		3/13/2017	CJR	1
Hexachlorobutadiene	< 1.47	ug/l	1.47	4.68	1	8260B		3/13/2017	CJR	1
Isopropylbenzene	< 0.29	ug/l	0.29	0.93	1	8260B		3/13/2017	CJR	1
p-Isopropyltoluene	< 0.28	ug/l	0.28	0.91	1	8260B		3/13/2017	CJR	1
Methylene chloride	< 0.94	ug/l	0.94	2.98	1	8260B		3/13/2017	CJR	1
Methyl tert-butyl ether (MTBE)	< 0.82	ug/l	0.82	2.6	1	8260B		3/13/2017	CJR	1
Naphthalene	< 2.17	ug/l	2.17	6.9	1	8260B		3/13/2017	CJR	1
n-Propylbenzene	< 0.19	ug/l	0.19	0.62	1	8260B		3/13/2017	CJR	1
1,1,2,2-Tetrachloroethane	< 0.69	ug/l	0.69	2.21	1	8260B		3/13/2017	CJR	1
1,1,1,2-Tetrachloroethane	< 0.47	ug/l	0.47	1.48	1	8260B		3/13/2017	CJR	1
Tetrachloroethene	< 0.48	ug/l	0.48	1.52	1	8260B		3/13/2017	CJR	1
Toluene	< 0.67	ug/l	0.67	2.13	1	8260B		3/13/2017	CJR	1
1,2,4-Trichlorobenzene	< 1.29	ug/l	1.29	4.1	1	8260B		3/13/2017	CJR	1
1,2,3-Trichlorobenzene	< 0.83	ug/l	0.83	2.63	1	8260B		3/13/2017	CJR	1
1,1,1-Trichloroethane	< 0.35	ug/l	0.35	1.11	1	8260B		3/13/2017	CJR	1
1,1,2-Trichloroethane	< 0.65	ug/l	0.65	2.06	1	8260B		3/13/2017	CJR	1
Trichloroethene (TCE)	< 0.45	ug/l	0.45	1.43	1	8260B		3/13/2017	CJR	1
Trichlorofluoromethane	< 0.64	ug/l	0.64	2.04	1	8260B		3/13/2017	CJR	1
1,2,4-Trimethylbenzene	< 1.14	ug/l	1.14	3.63	1	8260B		3/13/2017	CJR	1

Project Name OHM-LINCOLN
 Project # 6406 PO2017-0362

Invoice # E32585

Lab Code 5032585D
 Sample ID TRIP BLANK
 Sample Matrix Water
 Sample Date 3/7/2017

	Result	Unit	LOD	LOQ	Dil	Method	Ext Date	Run Date	Analyst	Code
1,3,5-Trimethylbenzene	< 0.91	ug/l	0.91	2.9	1	8260B		3/13/2017	CJR	1
Vinyl Chloride	< 0.19	ug/l	0.19	0.62	1	8260B		3/13/2017	CJR	1
m&p-Xylene	< 1.56	ug/l	1.56	4.95	1	8260B		3/13/2017	CJR	1
o-Xylene	< 0.39	ug/l	0.39	1.25	1	8260B		3/13/2017	CJR	1
SUR - Toluene-d8	101	REC %			1	8260B		3/13/2017	CJR	1
SUR - 1,2-Dichloroethane-d4	97	REC %			1	8260B		3/13/2017	CJR	1
SUR - 4-Bromofluorobenzene	106	REC %			1	8260B		3/13/2017	CJR	1
SUR - Dibromofluoromethane	96	REC %			1	8260B		3/13/2017	CJR	1

"J" Flag: Analyte detected between LOD and LOQ

LOD Limit of Detection

LOQ Limit of Quantitation

Code	Comment
1	Laboratory QC within limits.

All solid sample results reported on a dry weight basis unless otherwise indicated. All LOD's and LOQ's are adjusted for dilutions but not dry weight. Subcontracted results are denoted by SUB in the analyst field.

Authorized Signature

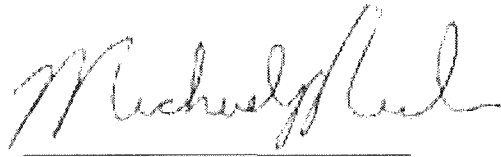

CHAIN OF STUDY RECORD

Synergy

Chain # 315F

Page 1 of 1

Environmental Lab, Inc.

Lab I.D. # _____
 Account No. : _____ Quote No.: _____
 Project #: 6406
 Sampler (signature): [Signature]

1990 Prospect Ct. • Appleton, WI 54914
 920-830-2455 • FAX 920-733-0631

Sample Handling Request
 Rush Analysis Date Required _____
 (Rushes accepted only with prior authorization)
 Normal Turn Around

Project (Name / Location): OHM-Lincoln / West Allis, WI
 Reports To: W. Fassbender / K. Heinstead Invoice To: _____
 Company: EnviroForensics Company: _____
 Address: 216 W2330 Skunk Ridge Dr. Ste G Address: _____
 City State Zip: Waukesha WI 53188 City State Zip: _____
 Phone: 262-390-9814 Phone: _____
 FAX: _____ FAX: _____

Analysis Requested										Other Analysis					
DRO (Mod DRO Sep 95)	GRO (Mod GRO Sep 95)	LEAD	NITRATE/NITRITE	OIL & GREASE	PAH (EPA 8270)	PCB	PVOC (EPA 8021)	PVOC + NAPHTHALENE	SULFATE	TOTAL SUSPENDED SOLIDS	VOC DW (EPA 542.2)	VOC (EPA 8260)	8-PCRA METALS	PID	FID

Lab I.D.	Sample I.D.	Collection Date	Time	Comp	Grab	Filtered Y/N	No. of Containers	Sample Type (Matrix)*	Preservation
5022595A	<u>6406-PP-3w</u>	<u>3-7-17</u>	<u>9:40</u>		<u>X</u>	<u>N</u>	<u>3</u>	<u>GW</u>	<u>HCL</u>
<u>B</u>	<u>6406-PP-4w</u>	<u>3-7-17</u>	<u>8:10</u>		<u>X</u>	<u>N</u>	<u>3</u>	<u>GW</u>	<u>HCL</u>
	<u>6406-PP-1</u>	<u>3-7-17</u>	<u>-</u>		<u>X</u>	<u>N</u>	<u>3</u>	<u>GW</u>	<u>HCL</u>
<u>D</u>	<u>TRIP BLANK</u>						<u>1</u>		

Comments/Special Instructions (*Specify groundwater "GW", Drinking Water "DW", Waste Water "WW", Soil "S", Air "A", Oil, Sludge etc.)
FO # 2017-0362

Sample Integrity - To be completed by receiving lab.
 Method of Shipment: SM
 Temp. of Temp. Blank _____ °C On Ice:
 Cooler seal intact upon receipt: Yes No

Relinquished By: (sign) [Signature] Time: 10:27 Date: 3/8/17
 Received By: (sign) [Signature] Time: 10:27 Date: 3-2-17

Received in Laboratory By: [Signature] Time: 8:00 Date: 3/9/17