

West Central Region GRCRS Package Cover Sheet

Site Name Former Spur Station # 2370

Site Address 820 8th St. South

BRRTS # 03-72-001029 Date of Closure Decision 4/13/00

NR 726.05(2)(am) and 726.05(3)(a)4. require the following **in order**:

1. Most recent Warranty Deed, including legal description
2. Certified Survey Map or recorded Plat Map (if referenced in legal description)
3. County Parcel I.D. Number, if used
4. Regional location map
5. Detailed site map(s)
6. Latest table(s) of analytical results (No shading allowed)
7. Isoconcentrations map(s) **if available from site investigation**
8. Geologic cross sections **if available from site investigation**
9. Statement signed by the RP that legal description is complete and accurate
10. Yes No Off-site contamination present? (If yes, include a copy of letter(s) sent by the RP to all affected property owners)
11. Yes No Right-of-way contamination present? (If yes, include a copy of notification to muni/state agency responsible for maintenance of ROW)

Project managers should also include:

Closure letter(s)

534532 GPS x-coordinate

434494 GPS y-coordinate

Groundwater flow map(s)

Latest map(s) showing extent of plume

NOW THEREFORE, the owner hereby declares that all of the property described above is held and shall be held, conveyed or encumbered, leased, rented, used, occupied and improved subject to the following limitation and restrictions:

Anyone who proposes to construct or reconstruct a well on this property is required to contact the Department of Natural Resources' Bureau of Drinking Water and Groundwater, or its successor, to determine what specific prohibitions or requirements are applicable prior to constructing or reconstructing a well on this property. No well may be constructed or reconstructed on this property unless applicable requirements are met.

If construction is proposed on this property that will require dewatering, or if groundwater is to be otherwise extracted from this property, while this groundwater use restriction is in effect, the groundwater shall be sampled and analyzed for contaminants that were previously detected on the property and any extracted groundwater shall be managed in compliance with applicable statutes and rules.

This restriction is hereby declared to be a covenant running with the land and shall be fully binding upon all persons acquiring the above-described property whether by descent, devise, purchase or otherwise. This restriction benefits and is enforceable by, the Wisconsin Department of Natural Resources, its successors and assigns. The Department, its successors or assigns, may initiate proceedings at law or in equity against any person or persons who violate or are proposing to violate this covenant, to prevent the proposed violation or to recover damages for such violation.

Any person who is or becomes owner of the property described above may request that the Wisconsin Department of Natural Resources or its successor issue a determination that one or more of the restrictions set forth in this covenant is no longer required. Upon the receipt of such a request, the Wisconsin Department of Natural Resources shall determine whether or not the restrictions contained herein can be extinguished. If the Department determines that the restrictions can be extinguished, an affidavit, attached to a copy of the Department's written determination, may be recorded to give notice that this deed restriction, or portions of this deed restriction, are no longer binding.

By signing this document, K.A. Hoogland asserts that he is duly authorized to sign this document on behalf of Kieth Hoogland Limited Partnership.

IN WITNESS WHEREOF, the owner of the property has executed this Declaration of Restrictions, this 14th day of May, 2001.

Signature: K.A. Hoogland
Printed Name: K.A. Hoogland
Title: President

Subscribed and sworn to before me this 14th day of May, 2001.

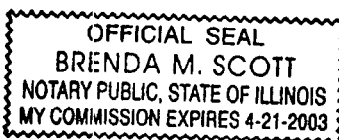

Notary Public, State of IL
My commission April 21, 2003

Brenda M. Scott

This document was drafted by DPRA Incorporated.



LEGEND

- TRAFFIC LIGHT
- TREES/BUSHES
- FORMER PUMP ISLAND
- CATCH BASIN
- FORMER UNDERGROUND STORAGE TANK
- MONITORING WELL
- VAPOR MONITORING POINT
- DEMARCATION WELL
- PIEZOMETER
- UTILITY POLE
- GAS
- ELECTRIC
- WATER
- TELEPHONE
- EXCAVATION LIMITS

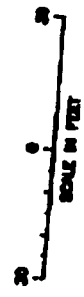

200 WEST WISCONSIN STREET, MILWAUKEE, WISCONSIN 53202

FORMER UNDERGROUND STORAGE TANK IDENTIFICATION

SPUR # 2370
200 8TH STREET SOUTH
WISCONSIN RAPIDS, WISCONSIN

PROJECT NUMBER 002

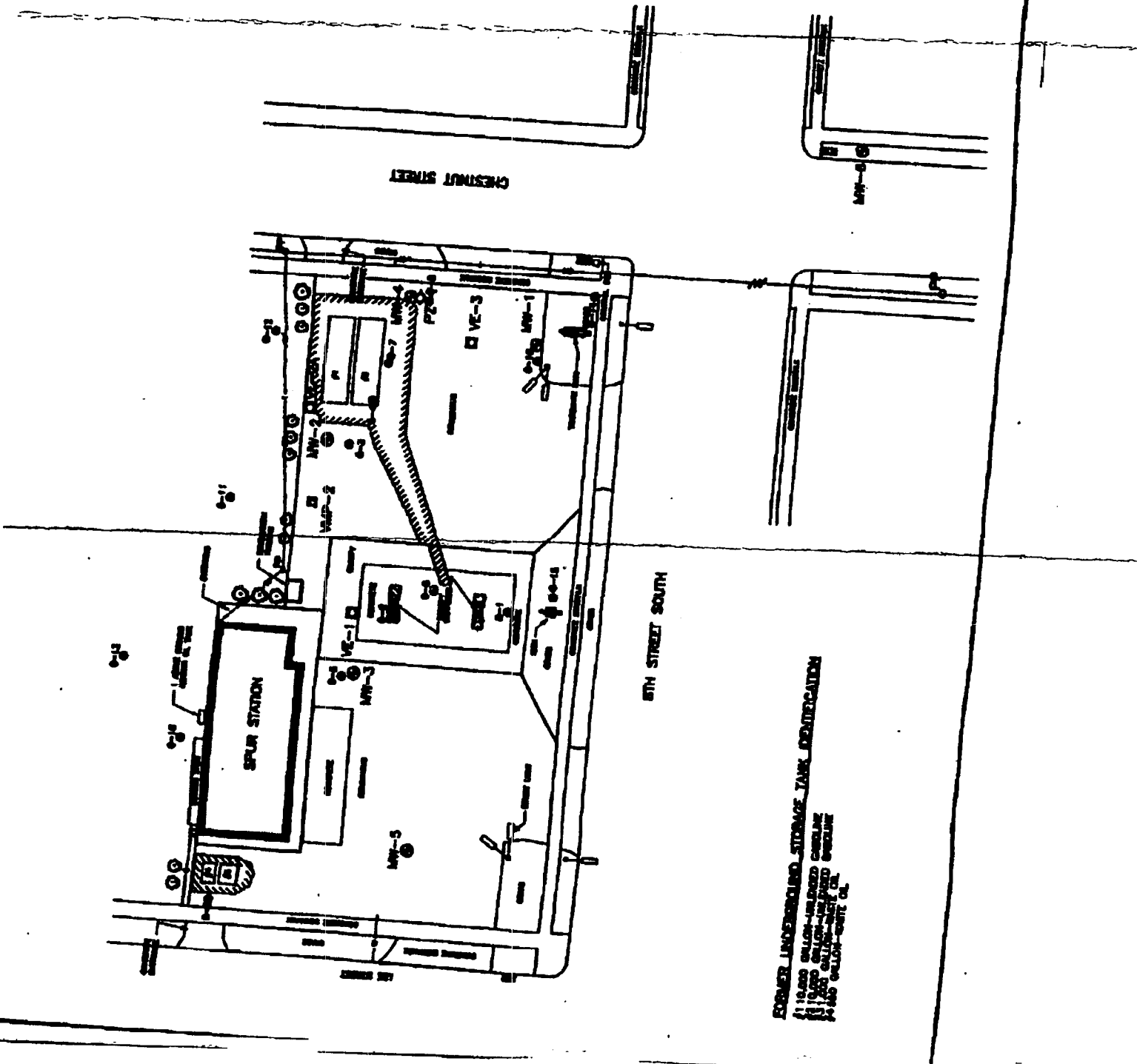

FORMER UNDERGROUND STORAGE TANK IDENTIFICATION

11,000 GALLON UNLINED COBBLER

11,000 GALLON UNLINED COBBLER

11,000 GALLON UNLINED COBBLER

11,000 GALLON UNLINED COBBLER

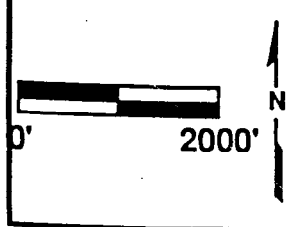
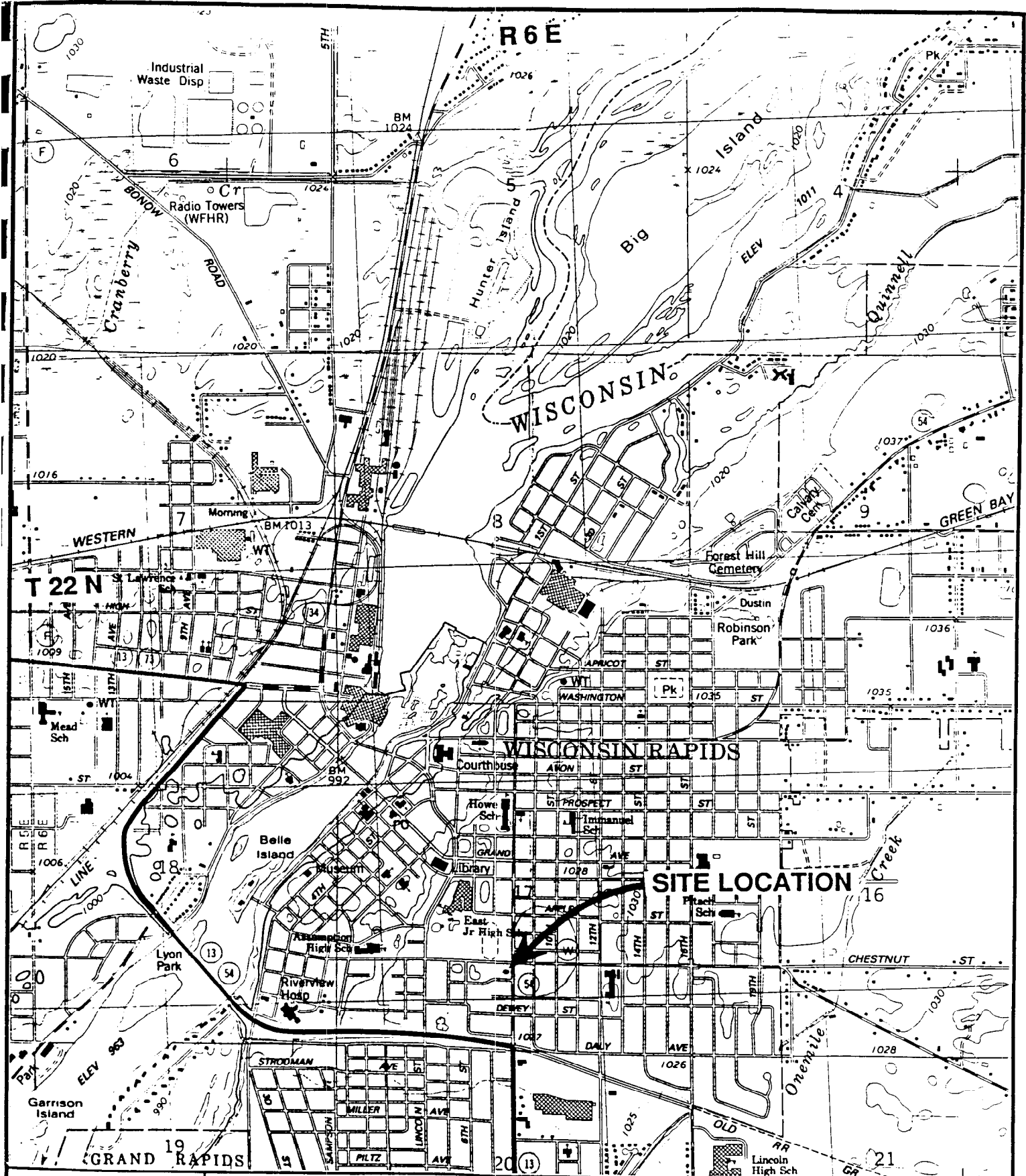

FIGURE 1
SITE LOCATION MAP

SPUR #2370
820 8TH STREET SOUTH
WISCONSIN RAPIDS, WISCONSIN

DPRA

PROJECT NO. 5902.04H



LEGEND

- TRAFFIC LIGHT
- TREES/BUSHES
- FORMER PUMP ISLAND
- CATCH BASIN
- FORMER UNDERGROUND STORAGE TANK
- MONITORING WELL
- VAPOR MONITORING PORT
- MICROTRENCH WELL
- PIEZOMETER
- UTILITY POLE
- GAS
- ELECTRIC
- WATER
- TELEPHONE
- EXCAVATION LIMITS

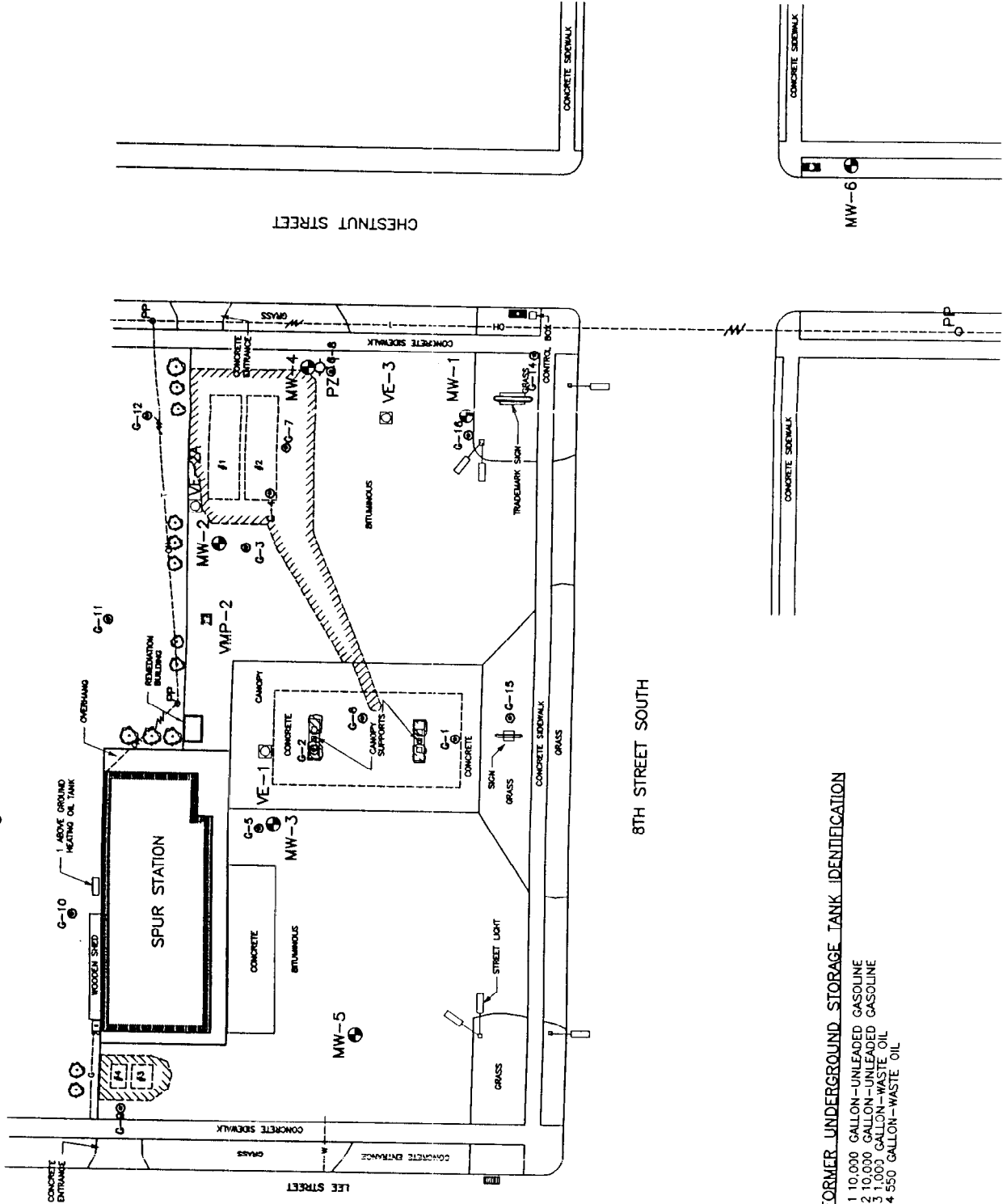

FORMER UNDERGROUND STORAGE TANK IDENTIFICATION

- #1 10,000 GALLON-UNLEADED GASOLINE
- #2 10,000 GALLON-UNLEADED GASOLINE
- #3 1,000 GALLON-WASTE OIL
- #4 550 GALLON-WASTE OIL

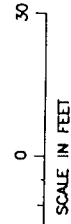

FIGURE 1
SITE MAP

SPUR # 2370
820 8TH STREET SOUTH
WISCONSIN RAPIDS, WISCONSIN

59024RN1.DWG
5902.041



NOTE: APPROXIMATE BUILDING AND UTILITY LOCATIONS. CALL LOCAL UTILITY OPERATOR TO VERIFY UTILITIES BEFORE STARTING ANY SUBSURFACE WORK.

Table 2

AQUEOUS ANALYTICAL RESULTS - MONITORING WELLS
PVOC, Napthalene, TCE, PCE, GRO, DRO, Lead

Former Spur 2370
 820 8th Street South
 Wisconsin Rapids, Wisconsin
 DPRA #5902.04H

ES		5	700	1,000	10,000	60	450	70	5	5			15
Well I.D	Date Sampled	Benzene μg/l	Ethyl- benzene μg/l	Toluene μg/l	Total Xylenes μg/l	MTBE μg/l	TMB μg/l	Naph- thalene μg/l	Tetra- chloro- ethylene μg/l	Tri- chloro- ethylene μg/l	GRO μg/l	DRO μg/l	Dissolved Lead μg/l
MW-1	04/27/94	98.3	6.8	ND	11.9	ND	8.9	7.5	ND	---	282	---	9.59 ⁽²⁾
	07/20/94	21.8	ND	ND	ND	ND	2.0	5.3	0.6	---	69.0	---	---
	10/21/94	310	8.74	ND	25.93	ND	20.8	9.89	ND	---	1,060	---	---
	01/11/95	158	15.8	35.4	62.3	ND	29.1	15.9	0.7	---	709	---	---
	01/11/95 ⁽¹⁾	190	18.6	41.8	66.6	ND	31.6	16.8	0.9	---	578	---	---
	02/21/95	27.2	ND	ND	2.0	ND	ND	ND	---	---	55.5	---	---
	04/18/95	0.399	ND	ND	ND	ND	ND	ND	ND	---	ND	---	---
	07/25/95	38.6	1.4	ND	6.7	ND	1.9	5.6	ND	---	112	---	ND
	07/25/95 ⁽¹⁾	32.0	1.4	ND	10.3	ND	1.3	---	---	---	106	---	---
	10/16/95	1,110	227	1,370	763	40.3	271.4	93.8	---	---	5,240	---	---
	01/29/96	---	---	---	---	---	---	---	---	---	---	---	---
	05/21/96	75.8	62.0	ND	114.4	ND	102	37.3	---	---	1,310	---	---
	07/17/96	33.5	20.7	ND	33.2	ND	45.4	11.7	---	---	379	---	---
	10/18/96	479	209	920	1,482	ND	484.3	123	---	---	4,290	---	---
	01/16/97	72.3	41.1	ND	69.8	ND	91.8	32.6	---	---	566	---	---
	01/16/97 ⁽¹⁾	84.5	55.5	ND	86.7	ND	148.0	---	---	---	307	---	---
	04/15/97	28.4	19.0	ND	34.2	3.2	58.5	18.2	---	---	263	---	---
	04/15/97 ⁽¹⁾	35.7	23.5	ND	41.63	4.44	68.8	---	---	---	326	---	---
	10/28/97	80.9	64.4	131	268	ND	164	75.0	---	---	1,450	---	---
	01/15/98	1.05	ND	ND	90.17	ND	1.51	22.0	---	---	289	---	---
	04/30/98	ND	ND	ND	ND	ND	ND	ND	---	---	ND	---	---
	07/08/98	ND	ND	ND	ND	ND	ND	---	---	---	ND	---	---

Table 2

AQUEOUS ANALYTICAL RESULTS - MONITORING WELLS
PVOC, Napthalene, TCE, PCE, GRO, DRO, Lead
 (continued)
 Former Spur 2370
 820 8th Street South
 Wisconsin Rapids, Wisconsin
 DPRA #5902.04H

Well I.D.	Date Sampled	Benzene µg/l	Ethyl- benzene µg/l	Toluene µg/l	Total Xylenes µg/l	MTBE µg/l	TMB µg/l	Naph- thalene µg/l	Tetra- chloro- ethylene µg/l	Tri- chloro- ethylene µg/l	GRO µg/l	DRO µg/l	Dissolved Lead µg/l
ES MW-1	10/07/98	5	700	1,000	10,100	00	480	40	5	5			15
	05/18/99	ND	ND	ND	ND	ND	ND	---	ND	---	ND	---	---
	07/27/99	0.206	ND	ND	1.213	ND	1.27	1.02	0.859	0.253	ND	173	---
MW-2	04/27/94	324	ND	ND	10	ND	ND	ND	7.3	---	491	---	4.7 ⁽²⁾
	07/20/94	ND	ND	ND	ND	ND	ND	ND	3.8	---	ND	---	---
	07/20/94 ⁽¹⁾	ND	ND	ND	ND	ND	ND	ND	3.7	---	ND	---	---
	10/21/94	ND	ND	ND	ND	ND	ND	1.24	ND	---	ND	---	---
	01/11/95	ND	ND	ND	ND	ND	ND	ND	1.7	---	ND	---	---
	04/18/95	ND	ND	ND	ND	ND	ND	ND	2.62	---	ND	---	---
	04/18/95 ⁽¹⁾	ND	ND	ND	ND	ND	ND	---	---	---	ND	---	---
	07/25/95	ND	ND	ND	ND	ND	ND	ND	0.6	---	ND	---	ND
	10/16/95	ND	ND	ND	ND	ND	ND	---	0.715	---	ND	---	---
	01/29/96	ND	ND	ND	ND	ND	ND	---	1.05	---	ND	---	---
	05/21/96	ND	ND	ND	ND	ND	ND	---	1.13	---	ND	---	---
	05/21/96 ⁽¹⁾	ND	ND	ND	ND	ND	ND	---	---	---	ND	---	---
07/17/96	ND	ND	ND	ND	ND	ND	---	---	---	ND	---	---	
10/18/96	12.8	ND	ND	17.5	ND	ND	---	---	---	125	---	---	

Table 2

AQUEOUS ANALYTICAL RESULTS - MONITORING WELLS
PVOC, Napthalene, TCE, PCE, GRO, DRO, Lead
 (continued)
 Former Spur 2370
 820 8th Street South
 Wisconsin Rapids, Wisconsin
 DPRA #5902.04H

Well I.D	Date Sampled	Benzene μg/l	Ethyl- benzene μg/l	Toluene μg/l	Total Xylenes μg/l	MTBE μg/l	TMB μg/l	Naph- thalene μg/l	Tetra- chloro- ethylene μg/l	Tri- chloro- ethylene μg/l	GRO μg/l	DRO μg/l	Dissolved Lead μg/l
		5 ⁻	700	1,622	16,672	60	1780	40	5 ⁻	5 ⁻			15 ⁻
MW-2	01/16/97	---	---	---	---	---	---	---	---	---	---	---	---
	04/15/97	ND	ND	ND	ND	ND	ND	---	---	---	ND	---	---
	8/13/97	ND	ND	ND	ND	4.43	ND	---	---	---	ND	---	---
	10/28/97	ND	ND	ND	ND	ND	ND	---	---	---	ND	---	---
	01/15/98	ND	ND	ND	ND	ND	ND	---	---	---	ND	---	---
	04/30/98	ND	ND	ND	ND	ND	ND	---	---	---	ND	---	---
	07/08/98	ND	ND	ND	ND	ND	ND	---	---	---	ND	---	---
	10/07/98	ND	ND	ND	ND	ND	ND	---	2.27	---	ND	---	---
	05/18/99	ND	ND	ND	ND	ND	ND	ND	1.56	ND	ND	100	---
	07/27/99	ND	ND	ND	ND	ND	ND	ND	0.427	ND	ND	ND	---
MW-3	04/27/94	ND	227	822	2,693	ND	1,230	164	ND	---	9,710	---	6.9 ⁽²⁾
	04/27/94 ⁽¹⁾	ND	89.4	258	968	ND	502	69.8	ND	---	10,400	---	5.02 ⁽²⁾
	07/20/94	18.5	ND	1,410	4,000	ND	1,315	259	ND	---	8,860	---	---
	10/21/94	ND	183	914	2,035	ND	516.3	135	ND	---	6,350	---	---
	10/21/94 ⁽¹⁾	ND	105	511	988	ND	301.6	66.5	ND	---	7,980	---	---
	01/11/95	ND	33.7	116	277	ND	206.4	23.0	---	---	1,080	---	---
	04/18/95	ND	1.20	3.30	6.68	ND	2.44	1.37	---	---	56.4	---	---

Table 2

AQUEOUS ANALYTICAL RESULTS - MONITORING WELLS
PVOC, Napthalene, TCE, PCE, GRO, DRO, Lead

(continued)
 Former Spur 2370
 820 8th Street South
 Wisconsin Rapids, Wisconsin
 DPRA #5902.04H

ES

Well I.D	Date Sampled	Benzene µg/l	Ethyl- benzene µg/l	Toluene µg/l	Total Xylenes µg/l	MTBE µg/l	TMB µg/l	Naph- thalene µg/l	Tetra- chloro- ethylene µg/l	Tri- chloro- ethylene µg/l	GRO µg/l	DRO µg/l	Dissolved Lead µg/l
	07/25/95	ND	21.6	123	192.5	ND	44.3	ND	0.8	---	1,140	---	41.8
	10/16/95	ND	76.2	333	693	ND	130.7	---	ND	---	1,060	---	75.5
MW-3	01/29/96	2.81	215	636	1711	ND	516	---	---	---	4,990	---	---
	05/21/96	ND	192	484	1,624	ND	476.2	---	---	---	4,900	---	---
	07/17/96	ND	89.3	235	716	ND	241	---	---	---	1,980	---	---
	10/18/96	ND	199	323	1,494	ND	471.1	128	---	---	3,750	---	5.07
	01/16/97	ND	3.0	2.3	19.8	ND	5.0	ND	---	---	ND	---	2.1
	04/15/97	ND	4.31	6.83	36.53	ND	11.37	1.71	---	---	72.4	---	7.83
	8/13/97	ND	ND	ND	2.52	ND	ND	ND	---	---	ND	---	---
	10/28/97	ND	42.0	49.8	315.7	ND	104.6	24.5	---	---	1,030	---	ND
	10/28/97 ⁽¹⁾	ND	72.4	87.0	531	ND	183.1	---	---	---	1,280	---	---
	01/15/98	ND	1.87	2.08	16.84	ND	3.74	ND	---	---	62.1	---	---
	01/15/98 ⁽¹⁾	ND	3.79	4.52	33.9	ND	10.00	---	---	---	94.5	---	---
	04/30/98	ND	ND	ND	2.93	ND	2.61	ND	---	---	ND	---	---
	04/30/98 ⁽¹⁾	ND	2.23	2.00	22.86	ND	25.22	---	---	---	166	---	---
	07/08/98	ND	ND	ND	1.93	ND	ND	---	---	---	ND	---	---
	10/07/98	ND	171	118	1,196	ND	379.0	---	ND	---	2,500	---	---
	10/07/98 ⁽¹⁾	ND	1.70	1.13	12.16	ND	2.71	---	---	---	ND	---	---

Table 2

AQUEOUS ANALYTICAL RESULTS - MONITORING WELLS
PVOC, Napthalene, TCE, PCE, GRO, DRO, Lead

(continued)

Former Spur 2370

820 8th Street South

Wisconsin Rapids, Wisconsin

DPR # 5902.04H

Well ID	Date Sampled	Benzene µg/l	Ethyl- benzene µg/l	Toluene µg/l	Total Xylenes µg/l	MTBE µg/l	TMB µg/l	Naph- thalene µg/l	Tetra- chloro- ethylene µg/l	Tri- chloro- ethylene µg/l	GRO µg/l	DRO µg/l	Dissolved Lead µg/l
	05/18/99	ND	0.954	ND	4.96	ND	0.905	ND	ND	ND	ND	335	---
	07/27/99	ND	26.2	9.54	253.8	ND	70.7	12.7	ND	0.721	606	527	---
MW-4	05/21/96	1,240	115	603	424	ND	114	ND	ND	---	3,280	---	ND
	07/17/96	289	51.2	1.1	59.7	20.8	79.9	---	---	---	1,290	---	---
	07/17/96 ⁽¹⁾	284	53.5	ND	54.7	ND	72.2	---	---	---	1,000	---	---
	10/18/96	3,200	259	1,230	765	ND	345.5	---	---	---	7,970	---	---
	01/16/97	2,830	280	536	496	ND	317.4	---	---	---	5,630	---	---
	04/15/97	452	22.3	57.0	81.7	ND	22.59	---	---	---	835	---	---
	08/13/97	549	36.0	ND	32.1	ND	37.8	---	---	---	1,260	---	---
	08/13/97 ⁽¹⁾	648	45.3	ND	41.2	ND	46.4	---	---	---	1,520	---	---
	10/28/97	1,560	267	493	481	356	273.9	---	---	---	4,450	---	---
	01/15/98	143	19.7	4.26	99.0	ND	81.2	---	---	---	909	---	---
	04/30/98	17.2	14.9	ND	53.42	ND	61.0	---	---	---	387	---	---
	07/08/98	6.27	4.66	ND	6.47	ND	12.64	---	---	---	113	---	---
	07/08/98 ⁽¹⁾	6.36	3.76	ND	7.45	ND	13.79	---	---	---	122	---	---
	10/07/98	109	ND	ND	ND	897	ND	---	3.37	---	473	---	---
	01/14/99	2.49	ND	ND	ND	5.36	ND	1.10	1.28	0.78	---	---	---
	05/18/99	35.0	7.32	ND	31.34	65.5	8.83	5.94	8.40	ND	386	303	---

Table 2

AQUEOUS ANALYTICAL RESULTS - MONITORING WELLS
 PVOC, Napthalene, TCE, PCE, GRO, DRO, Lead

(continued)

Former Spur 2370
 820 8th Street South
 Wisconsin Rapids, Wisconsin
 DPRA # 5902.04H

ES

Well I.D	Date Sampled	Benzene µg/l	Ethyl- benzene µg/l	Toluene µg/l	Total Xylenes µg/l	MTBE µg/l	TMB µg/l	Naph- thalene µg/l	Tetra- chloro- ethylene µg/l	Tri- chloro- ethylene µg/l	GRO µg/l	DRO µg/l	Dissolved Lead µg/l
	07/27/99	2.38	ND	ND	ND	10.8	ND	ND	ND	ND	99.4	254	---
	07/27/99 ⁽¹⁾	11.6	ND	ND	1.74	50.8	ND	---	---	---	77.6	---	---
MW-5	05/21/96	ND	ND	ND	ND	ND	ND	ND	ND	---	ND	---	ND
	07/17/96	ND	ND	ND	ND	ND	ND	---	---	---	ND	---	---
	10/18/96	ND	ND	ND	ND	ND	ND	---	---	---	ND	---	---
	01/16/97	ND	ND	ND	ND	ND	ND	---	---	---	ND	---	---
	04/15/97	ND	ND	ND	ND	ND	ND	---	---	---	ND	---	---
	08/13/97	ND	ND	ND	ND	ND	ND	---	---	---	ND	---	---
	01/28/97	ND	ND	ND	ND	ND	ND	---	---	---	ND	---	---
	01/15/98	ND	ND	ND	ND	ND	ND	---	---	---	ND	---	---
	04/30/98	ND	ND	ND	ND	ND	ND	---	---	---	ND	---	---
	07/08/98	ND	ND	ND	ND	ND	ND	---	---	---	ND	---	---
	07/27/99	ND	ND	ND	ND	ND	ND	ND	ND	ND	ND	---	---
MW-6	05/20/98	168	331	3,430	3,146	ND	1,316	215	ND	---	---	---	ND
	07/08/98	6.76	7.87	74.0	69.0	3.75	15.7	3.79	6.16	---	---	---	ND

Table 2

AQUEOUS ANALYTICAL RESULTS - MONITORING WELLS
PVOC, Naphthalene, TCE, PCE, GRO, DRO, Lead

(continued)

Former Spur 2370
 820 8th Street South
 Wisconsin Rapids, Wisconsin
 DPRA #5902.04H

Well I.D.	Date Sampled	Benzene μg/l	Ethyl- benzene μg/l	Toluene μg/l	Total Xylenes μg/l	MTBE μg/l	TMB μg/l	Naph- thalene μg/l	Tetra- chloro- ethylene μg/l	Tri- chloro- ethylene μg/l	GRO μg/l	DRO μg/l	Dissolved Lead μg/l
	10/07/98	7.80	6.22	80.7	50.8	27.5	15.65	2.54	2.88	---	203	---	---
	01/14/99	651	1,630	14,900	13,760	ND	6,290	1,560	ND	ND	---	---	---
	01/14/99 ⁽¹⁾	1,230	2,150	24,600	18,790	773	7,310	---	---	---	73,200	---	---
	05/18/99	ND	185	564	793	ND	451	ND	ND	ND	12,300	25,000	---
	07/27/99	170	672	3,920	3,426	ND	2,203	71.3	ND	ND	20,600	9,070	---
PZ-1	04/30/98	36.1	11.9	ND	5.80	ND	4.36	5.18	2,360	ND---	---	---	ND
	07/08/98	ND	ND	ND	ND	ND	ND	ND	1,550	---	---	---	ND
	10/07/98	29.4	ND	ND	31.2	ND	ND	19.3	1,770	---	492	---	---
	01/14/99	27.9	15.0	1.14	1.68	4.08	1.58	15.2	2,760	18.6	---	---	---
	05/18/99	ND	ND	ND	ND	ND	ND	0.777	2,860	ND	923	201	---
	05/18/99 ⁽¹⁾	5.61	ND	ND	ND	5.68	ND	---	---	---	774	---	---
	07/27/99	ND	ND	ND	ND	ND	ND	ND	3,520	ND	831	229	---
Field Blank	04/27/94	ND	ND	ND	1.8	ND	ND	ND	ND	---	ND	---	---
	07/20/94	ND	ND	ND	1.5	ND	ND	ND	ND	---	ND	---	---
	10/21/94	ND	ND	ND	ND	ND	ND	---	---	---	ND	---	---
	01/11/95	ND	ND	ND	ND	ND	ND	---	---	---	ND	---	---
	02/21/95*	ND	ND	ND	ND	ND	ND	---	---	---	ND	---	---

ES

5

700

6,622

10,028

66

456

40

5

5

15

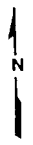

LEGEND

- TRAFFIC LIGHT
- TREES/BUSHES
- FORMER PUMP ISLAND
- CATCH BASIN
- FORMER UNDERGROUND STORAGE TANK
- MONITORING WELL
- VAPOR PORT
- GEOPROBE
- LINE OF CROSS SECTION

EXCAVATION LIMITS

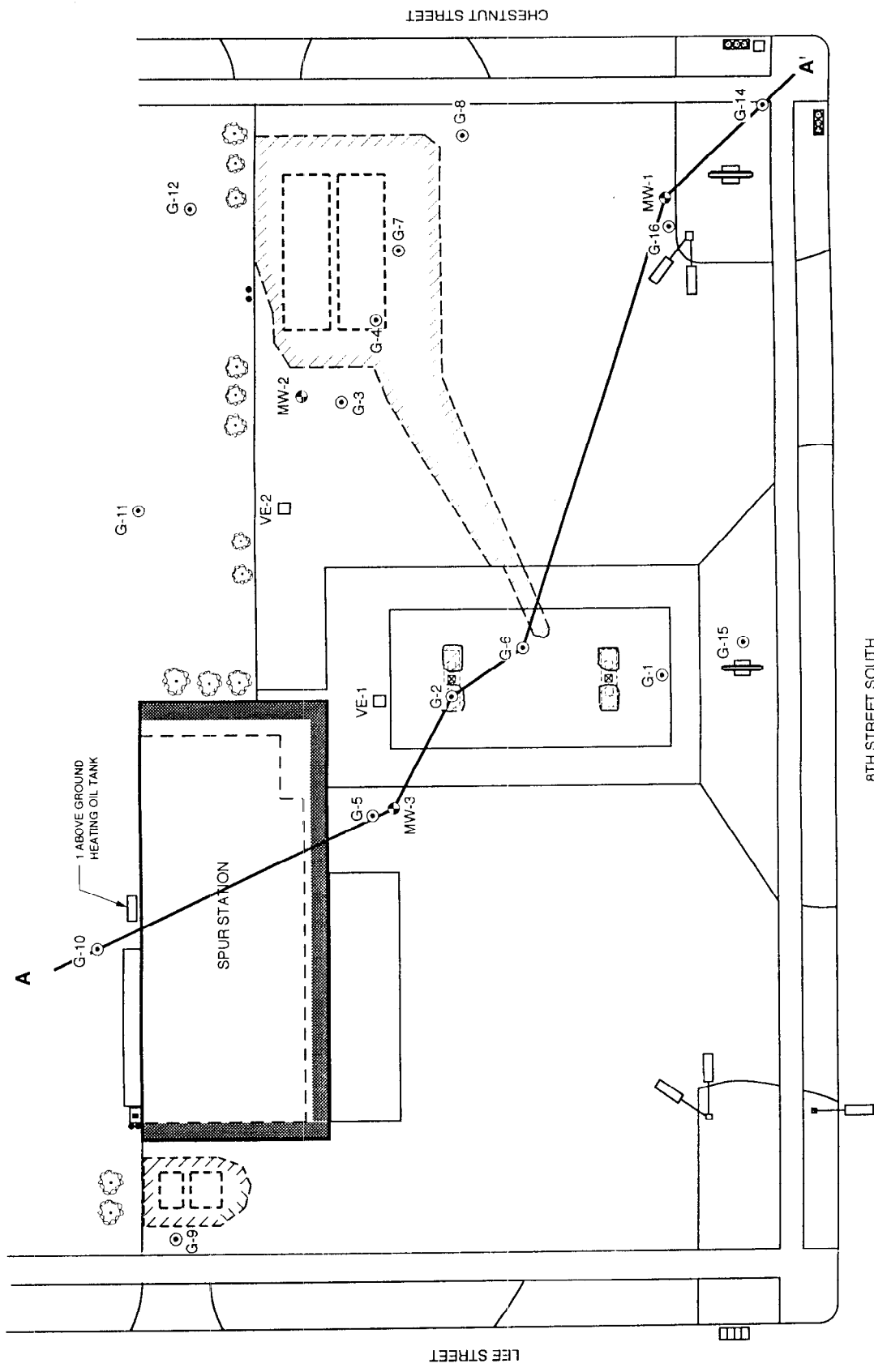

NOTE: APPROXIMATE BUILDING AND UTILITY LOCATIONS. NOTIFY LOCAL UTILITY OPERATORS TO VERIFY UTILITY LOCATIONS BEFORE BEGINNING ANY SUBSURFACE CONSTRUCTION.

**FIGURE 3
CROSS SECTION A-A' LOCATION
MAP**

SPUR NO. 2370
820 8TH STREET SOUTH
WISCONSIN RAPIDS, WISCONSIN



PROJECT NO. 5902.041

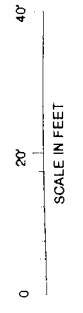

8TH STREET SOUTH

LEE STREET

CHESTNUT STREET

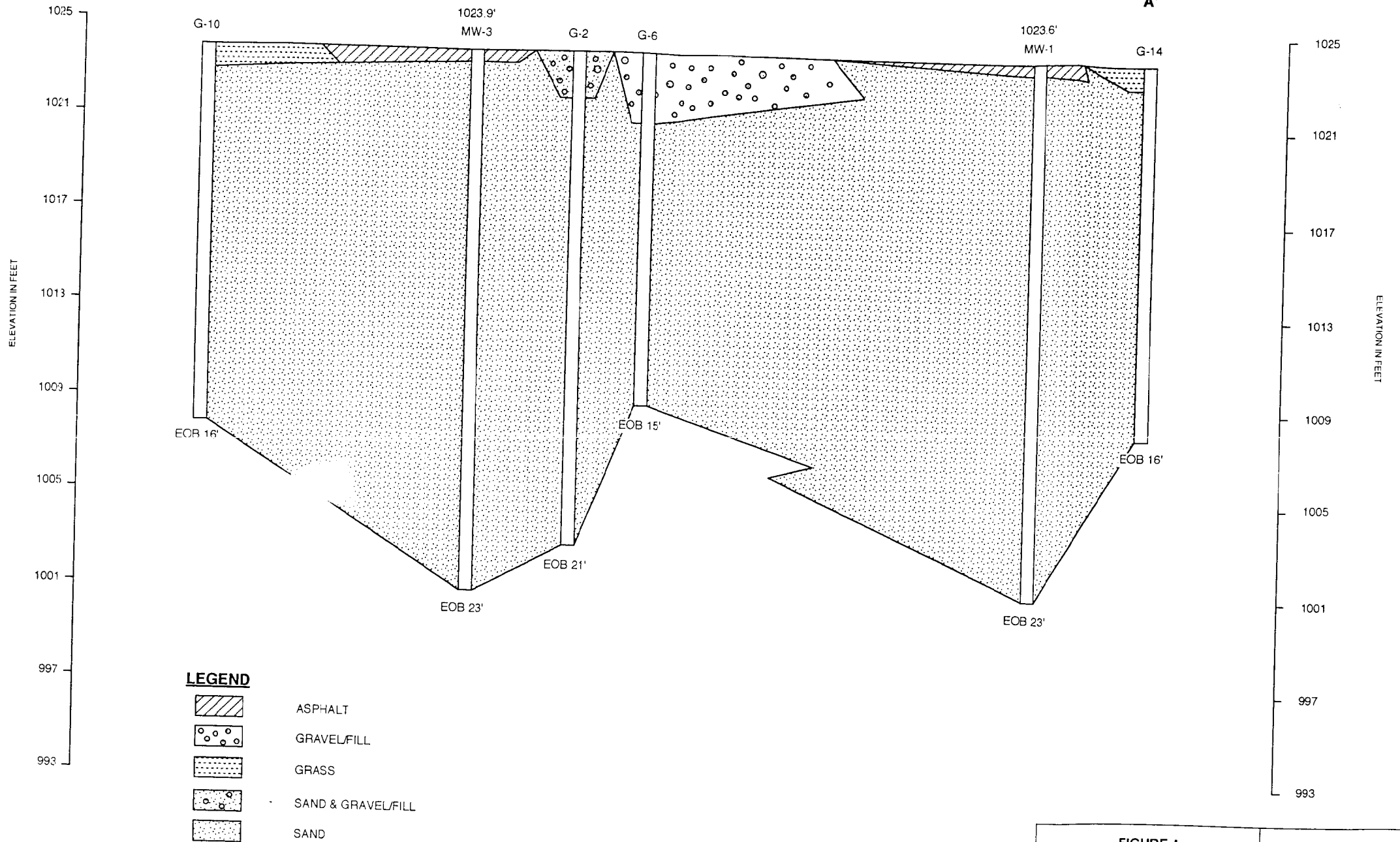

NOTE: GEOPROBES G-2, G-6, G-10 & G-14 NOT SURVEYED.

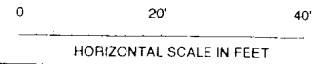

**FIGURE 4
CROSS SECTION A-A'**

SPUR NO. 2370
820 8TH STREET SOUTH
WISCONSIN RAPIDS, WISCONSIN

PROJECT NO. 5902.04H

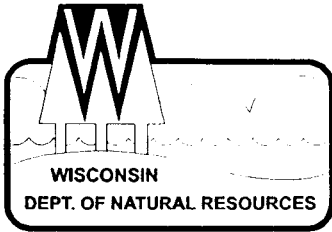

State of Wisconsin \ DEPARTMENT OF NATURAL RESOURCES

Tommy G. Thompson, Governor
George E. Meyer, Secretary
Scott A. Humrickhouse, Regional Director

Wisconsin Rapids Office
473 Griffith Avenue
Wisconsin Rapids, Wisconsin 54494-7859
Telephone 715-421-7800
FAX 715-421-7830

April 19, 2000

BRRTS #03-72-001029

Mr. C.L. Russell
Murphy Oil USA, Inc.
200 Peach Street
El Dorado, AR 71730

FILE COPY

SUBJECT: Conditional Closure, Former Spur Store #2370, 820 Eighth Street,
Wisconsin Rapids, Wisconsin.

Dear Mr. Russell:

On April 13, 2000, the above named site was reviewed by the Wisconsin Department of Natural Resources (DNR) westcentral region closeout committee for a determination as to whether or not the case qualified for close out under Wis. Adm. Code (WAC) ch. NR 726. The pre and post-remediation groundwater samples indicate WAC ch. 140 groundwater quality enforcement standard (ES) exceedence for benzene (at MW-4 & PZ-1), MTBE (at MW-4) and tetrachloroethylene (at PZ-1) is present in the groundwater at the site. Also, no post remediation soil samples were ever collected to confirm that no residual soil contamination remains at this site. However, based on the investigative and remediation documentation provided to the Department, it appears that the extent of the petroleum-related contamination at the above-named site has been investigated and remediated to the extent practicable, the location of any potential residual petroleum-related soil contamination does not pose a threat to direct contact under current site conditions, and that natural attenuation will be effective in reducing the mass of petroleum-related residual contamination at this site. **Therefore, the Department considers the case "closed," having determined pursuant to WAC NR 726, that no further action is necessary on the site at this time, providing the following two conditions are met.**

The first condition of the closeout for this case is that the current property owner is required to sign and record a groundwater use restriction describing the type, location, and extent of the residual groundwater contamination, on the deed for the property and requiring that Department (or successor agency) approval must be obtained before any water supply wells are installed on the property. The deed restriction document must be



April 18, 2000
Mr. C.L. Russell - Murphy Oil USA, Inc.
Page 2

BRRTS #03-72-001029

submitted to the Department for approval within 30 days after receipt of this letter, and the deed documents must be registered with the County Register of Deeds fifteen days after receiving Department approval of the draft deed restriction. To document that this condition has been complied with, the property owner must submit to the Department a copy of the recorded deed restriction, with the recording information stamped on it, within 15 days after the County Register of Deeds returns the deed restriction to the property owner. The deed restriction may be amended in the future with the approval of Department if conditions change at the site such that the residual contamination is completely remediated (if deemed necessary).

The second condition of the closeout of this case is the proper abandonment of the monitoring wells and remediation system currently at the site (pursuant of WAC NR 141). However, because some of the monitoring wells installed as part of investigation at this site may be useful as part of the site investigation associated with the Colonial Standard site (particularly monitoring wells MW-1, MW-4, MW-6 and PZ-1), the Department is requesting that you please contact the owner of the Colonial Standard Site (Mr. Kevin Hutchausen; 715/421-5112) or his consultant, Carl Ham at REI (715/675-9784), and offer them the opportunity of assuming ownership of any of these monitoring wells for use in their site investigation and cleanup. Documents regarding well abandonment (Form 3300-5B) and/or a letter indicating that ownership of select monitoring wells has been transferred to the Colonial Standard site should be forwarded to me at the WDNR Wisconsin Rapids office.

In addition, please note that if any residual contaminated soil is excavated in the future, it may be considered solid waste and will need to be handled and disposed in accordance with applicable statutes and rules.

If you have additional relevant information which was not formerly provided to the Department, and which you feel would significantly impact the Department's closure decision, you may submit that information for our re-evaluation of case closure.

You should note that this letter does not constitute Department "certification" under s. 292.15(2)(a)3, Stats., as created by 1993 Wisconsin Act 453 (May 12, 1994). Also, in 1997 Wisconsin Act 27, the legislature amended s. 292.15, Wis. Stats., creating the new "Voluntary Party Remediation and Exemption from Liability" statute. This statute provides liability protection for persons who did not intentionally or recklessly cause the release of a hazardous substance and who conducts an environmental investigation and cleans up property by restoring the environment to the extent practicable and in accordance with rules promulgated by the Department. Upon completion of the

April 18, 2000
Mr. C.L. Russell - Murphy Oil USA, Inc.
Page 3

BRRTS #03-72-001029

cleanup, the person receives a "certificate of completion" that provides an exemption from the "Hazardous Substance Spills" statute and protection from future liability for the past releases. You must apply for the program by filling out an application form and fees are charged to cover administrative costs associated with the program. If you are interested in more information about the program or would like an application package, please call Loren Brumberg at the West Central Region Office in Eau Claire at 715-839-3770.

Once the deed restriction and the monitoring well abandonment forms and/or letter to transfer ownership of the selected monitoring wells have been properly submitted to this office we will issue the final closure letter for this site.

Thank you for your efforts to cleanup Wisconsin's environment. If you should have any questions regarding this letter please contact me at (715) 421-7850.

Sincerely,

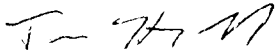

Tom Hvizdak
Hydrogeologist

c: Robert Wahlstrom, DPRA, E-1500 First National Bank Bldg., St. Paul, MN
Kevin Hutchausen, Colonial Standard, 811 Chestnut St., Wisconsin Rapids, WI
Carl Ham, REI, 4080 N. 20th Ave., Wausau, WI 54401
Dee Zoellner, Wis. Dept. of Commerce



COPY

Transportation • Municipal • Site Development • GPS
Remediation • Environmental Assessments • Emergency Response • Safety

December 13, 2001

C.L. Russell
Murphy Oil USA, Inc.
P.O. Box 7000
El Dorado, AR 71731-7000

Subject: Monitoring Wells, Former Spur Site #2370 (Family Video Site), 820 8th Street South, Wisconsin Rapids, WI

Dear Mr. Russell:

This letter serves as a follow-up to our telephone conversation with Sara Remus of DPRA. According to Sara Remus, we understand that Murphy Oil has agreed to accept REI's offer to assume ownership of selected monitoring wells that were part of DPRA's environmental investigation associated with the former Spur site #2370 (currently the Family Video Site), located down gradient of the Colonial Standard Service Station being investigated by REI. The Wisconsin Department of Natural Resources (WDNR) has requested that REI sample these selected wells as part of the remedial investigation at the Colonial Standard Service Station. The selected monitoring wells that REI will assume ownership are DPRA MW-1, DPRA MW-4, DPRA MW-6, and DPRA PZ-1. REI will take ownership of these wells on December 24, 2001. As of December 24, 2001, these monitoring wells will be used and maintained by REI until the Colonial Standard site receives closure. At that point, REI will have the responsibility for abandoning all of the wells according to Wisconsin Administrative Code NR 141. REI will notify Murphy Oil in writing when the wells have been abandoned. We understand the other monitoring wells and vapor ports at the former Spur site will be abandoned by DPRA within the first two (2) weeks of January 2002.

Please contact me at (715) 675-9784 at your earliest convenience if you have any questions about REI taking ownership and using these monitoring wells.

Sincerely,
REI

Ray deLong, CHMM
Principal

cc: Ms. Kim Marth, c/o Colonial Standard, 4911 Rosemary Circle, Wisconsin Rapids, WI 54494
Mr. Tom Hvizdak, c/o Wisconsin Department of Natural Resources, 473 Griffith Avenue,
Wisconsin Rapids, WI 54494
Mr. Robert Wahlstrom, c/o DPRA Incorporated, 332 Minnesota Street, Suite E-1500,
St. Paul, MN 55101
Keith Hoogland Ltd., c/o Family Video Movie Club Inc., 820 Eighth Street, Wisconsin Rapids, WI 54494

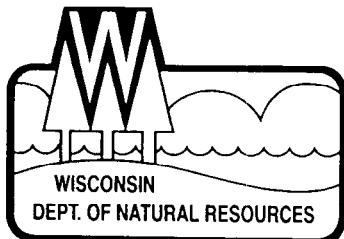

State of Wisconsin \ DEPARTMENT OF NATURAL RESOURCES

Scott McCallum, Governor
Darrell Bazzell, Secretary
Scott A. Humrickhouse, Regional Director

Wisconsin Rapids Service Center
473 Griffith Avenue
Wisconsin Rapids, Wisconsin 54494
Telephone 715-421-7800
FAX 715-421-7830

March 11, 2002

BRRTS #03-72-001029

FILE COPY

Mr. C.L. Russell
Murphy Oil USA, Inc.
200 Peach Street
P.O. Box 7000
El Dorado, AR 71731-7000

Subject: Final Case Closure By Closure Committee With Conditions Met,
Former Spur Station #2370
820 Eighth Street, Wisconsin Rapids, Wisconsin

Dear Mr. Russell:

On April 13, 2000, your site as described above was reviewed for closure by the Wisconsin Department of Natural Resources Westcentral Region Closure Committee. This committee reviews environmental remediation cases for compliance with state laws and standards to maintain consistency in the closure of these cases. On April 19, 2000, you were notified that the Closure Committee had granted conditional closure to this case.

On March 11, 2002, the Department received the final correspondence indicating that you have complied with all conditions of closure. The conditions for closure required by the West Central Region Closure Committee included filing a groundwater use restriction for residual groundwater contamination and abandonment of all monitoring wells used in the investigation and cleanup of this site. However, REI has submitted subsequent correspondence indicating that they will be assuming ownership of monitoring wells DPRA MW-1, DPRA MW-4, DPRA MW-6 and DPRA PZ-1 for the investigation at the Colonial Standard site (BRRTS #03-72-190720). Based on the correspondence and data provided, it appears that your case has been remediated to Department standards in accordance with s. NR 726.05, Wis. Adm. Code. The Department considers this case closed and no further investigation, remediation or other action is required at this time.

Your site will be listed on the DNR Remediation and Redevelopment GIS Registry of Closed Remediation Sites. Information that was submitted with your closure request application will be included on the registry. To review the sites on the GIS Registry web page, visit <http://gomapout.dnr.state.wi.us/org/at/et/geo/gwur/index.htm>

If this is a PECFA site, section 101.143, Wis. Stats., requires that PECFA claimants seeking reimbursement of interest costs, for sites with petroleum contamination, submit a final reimbursement claim within 120 days after they receive a closure letter on their site. For claims not received by the PECFA Program within 120 days of the date of this letter, interest costs after 60 days of the date of this letter will not be eligible for PECFA reimbursement.

March 11, 2002
Mr. C.L. Russell - Murphy Oil USA, Inc.
Page 2

BRRTS #03-72-001029

Please be aware that this case may be reopened pursuant to s. NR 726.09, Wis. Adm. Code, if additional information regarding site conditions indicates that contamination on or from the site poses a threat to public health, safety or welfare, or the environment.

The Department appreciates your efforts to restore the environment at this site. If you have any questions regarding this letter, please contact me at 715/421-7850.

Sincerely,



Tom Hvizdak
Hydrogeologist
Bureau for Remediation & Redevelopment

c: Rob Heimbach, DPRA, E-1500 First National Bank Building, St. Paul, MN 55101-1314

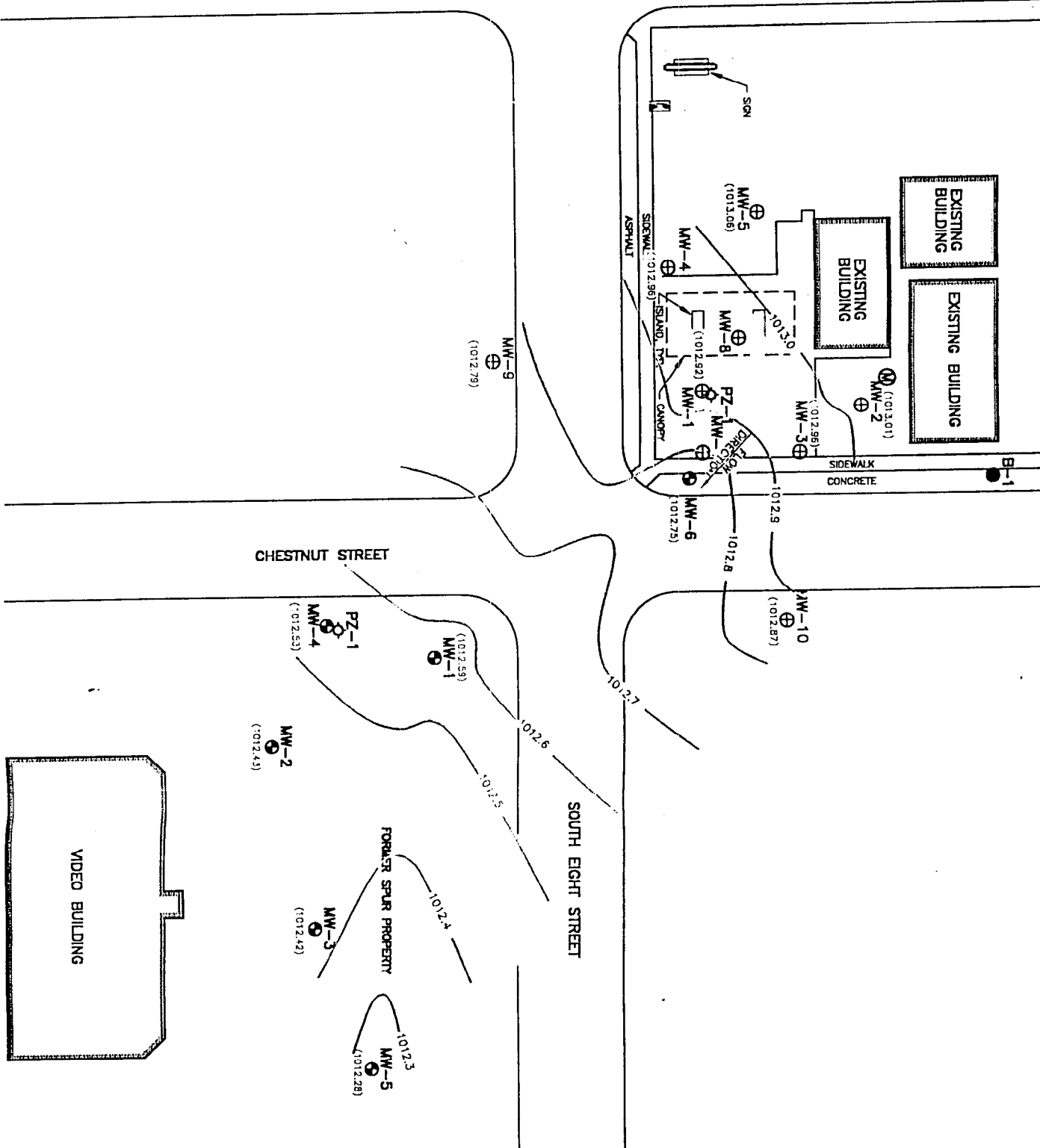

LEGEND

- ⊕ MANHOLE
- ☎ TELEPHONE
- ⬠ PIEZOMETER
- ⊕ MONITORING WELL (OPRA)
- ⊕ MONITORING WELL (RE)
- SOIL BORING
- GROUNDWATER ELEVATION (1012.87)
- 1012.8 — GROUNDWATER CONTOUR

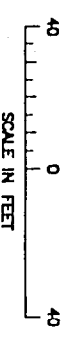

CONTOURS CALCULATED FROM ONLY THOSE ELEVATIONS RECORDED AT THE TIME AND LOCATIONS ON THIS MAP.
 NOTE: APPROXIMATE BUILDING AND UTILITY LOCATIONS. CALL LOCAL UTILITY OPERATOR TO VERIFY UTILITIES BEFORE STARTING ANY SUBSURFACE WORK.

FIGURE 3
WATER TABLE CONTOUR
MAP (07/27/89)

FORMER SPUR #2370
 820 EIGHTH STREET SOUTH
 WISCONSIN RAPIDS, WISCONSIN

DATE: JULY 1, 1989
 PROJECT NUMBER: 5402-D

04-790.SCR
 54020045.DWG

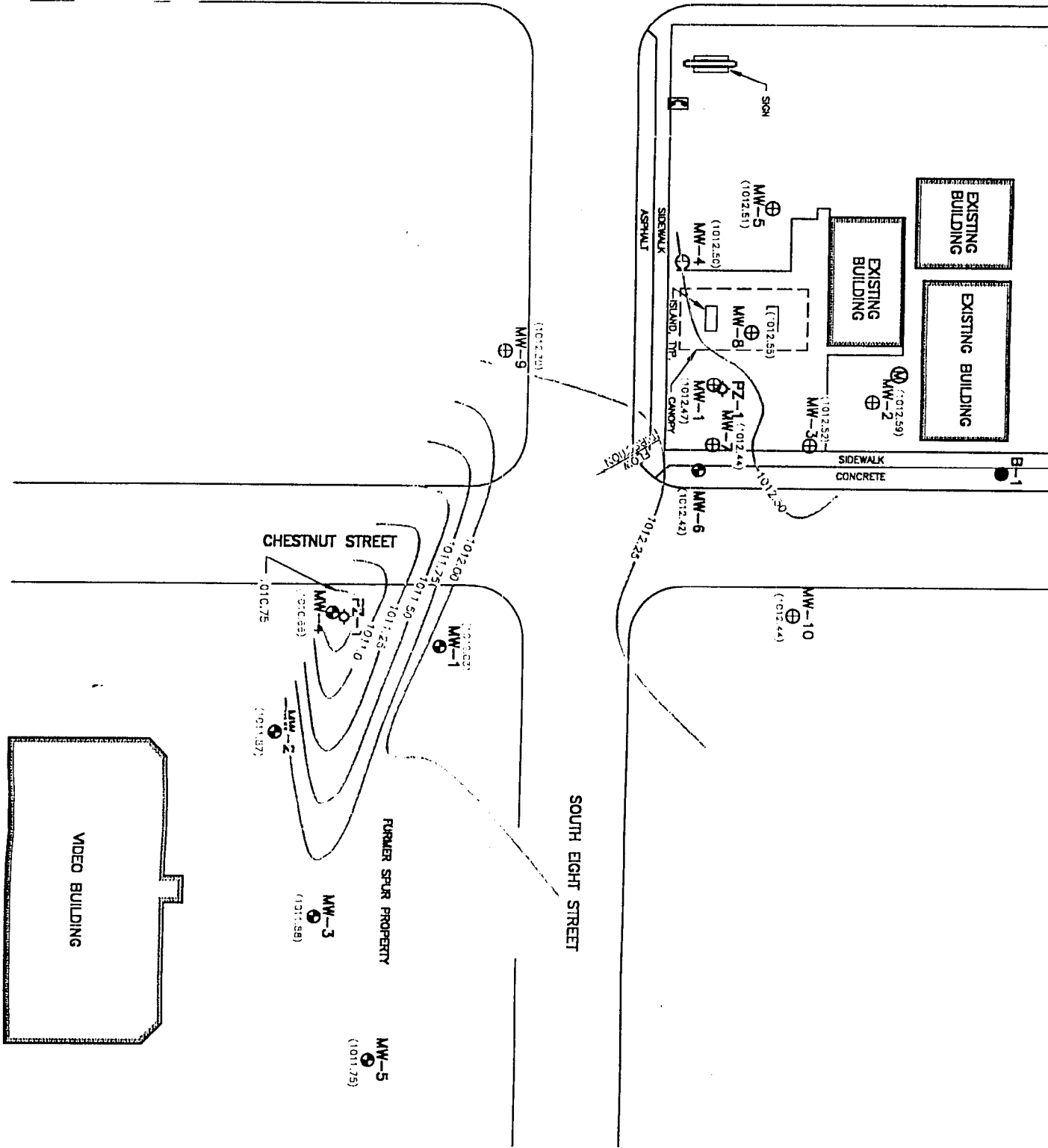

LEGEND

- ⊕ MANHOLE
- ⊕ TELEPHONE
- ◇ PIEZOMETER
- ⊕ MONITORING WELL (DPRA)
- ⊕ MONITORING WELL (RE)
- SOIL BORING
- (1012.44) GROUNDWATER ELEVATION
- 1012.25 — GROUNDWATER CONTOUR

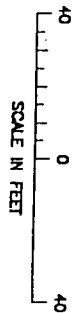

CONTOURS CALCULATED FROM ONLY THOSE ELEVATIONS RECORDED AT THE TIME AND LOCATIONS ON THIS MAP.
 NOTE: APPROXIMATE BUILDING AND UTILITY LOCATIONS. CALL LOCAL UTILITY OPERATOR TO VERIFY UTILITIES BEFORE STARTING ANY SUBSURFACE WORK.

FIGURE 2
WATER TABLE CONTOUR
MAP (05/18/89)

FORMER SPUR #2370-...
 820 EIGHTH STREET SOUTH
 WISCONSIN DARING WISCONSIN

DPRA
 ENVIRONMENTAL
 DATE: JULY 1, 1988
 PROJECT