

August 15, 2000

Mr. Robert Pearson
Wisconsin Department of Transportation
4802 Sheboygan Avenue, Room 451
P.O. Box 7965
Madison, WI 53707

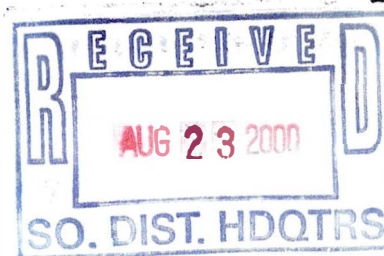

SUBJECT: Phase 2 Environmental Site Assessments
WIDOT S.T.H. 123, Baraboo, Wisconsin
-Dick's Car Care, 620 Broadway, Baraboo, Wisconsin (5971-01-01)
-NAPA Auto Parts, 104 Broadway, Baraboo, Wisconsin (5971-01-03)
BT² Project #1770 and #1771

Dear Mr. Pearson:

This letter presents the results of two Phase 2 Environmental Site Assessments (ESAs), conducted on S.T.H. 123 (Broadway Street), in Baraboo, Wisconsin. The specific sites investigated were Dick's Car Care, 620 Broadway, and NAPA Auto Parts, 104 Broadway, Baraboo, Wisconsin. The work was conducted in accordance with Work Order 5971-01-01 dated May 30, 2000 and Work Order 5971-01-03 also dated May 30, 2000 to investigate the properties due to the **historical presence of underground storage tanks (USTs) on the sites**. The focus of the assessment was to identify potential soil and groundwater contamination which may be encountered during proposed improvements to S.T.H. 123.

To investigate if contamination is present in the right-of-way near 104 and 620 Broadway Street, Geoprobe™ (geoprobe) borings were drilled at the properties on June 30, 2000. The locations of the properties are shown on **Figure 1**. The property details and geoprobe boring locations are shown on **Figures 2 and 3**, respectively.

Selected soil samples were prepared and shipped to TestAmerica laboratories in Watertown, Wisconsin. Chain of custody forms and laboratory analytical reports are attached. The laboratory analytical results for soil samples are summarized in **Table 1** and **Table 2**. Groundwater was not encountered in any of the geoprobe borings.

Background

Dick's Car Care is located at 620 Broadway Street in Baraboo, Wisconsin. Revisions to Sanborn maps dated 1941 indicated the presence of USTs on the site. According to the current owner, the USTs were removed in 1987. No USTs are listed under this address in the Wisconsin Department of Commerce tracking database. A small strip of pavement approximately 15 feet wide had been previously stripped away extending between the two service drives on Broadway Street. This may have been the area in which the USTs were removed from.

NAPA Auto Parts is located at 104 Broadway Street in Baraboo, Wisconsin. According to the current owner, three USTs were removed from the site in the early to mid-1980s. The exact locations of the USTs are unknown. No USTs are listed under this address in the Wisconsin Department of Commerce tracking database. Three 55-gallon drums were present along the west wall of the building at 110 Broadway Street. Obvious soil staining was present around the drums. Two vent pipes were observed on the north side of the building at 110 Broadway Street. It is unknown if these vent pipes service or have serviced USTs.

Field Methods and Observations

Dicks Car Care

Per phone conversations with Wisconsin Department of Transportation (WI DOT) personnel, the number of borings installed at Dicks Car Care was increased from two to four. The geoprobe borings (GP1 through GP4) were installed within the WIDOT right-of-way between the sidewalk and Broadway Street. In accordance with the work order, geoprobe borings were installed to the depth of groundwater, bedrock, or 20 feet below ground surface (bgs). The total depths of the borings ranged from 11.5 to 20 feet bgs. Refusal was encountered while installing borings GP1, GP2, and GP4 at depths of 18 feet, 12 feet, and 11.5 feet, respectively. Refusal was likely due to the tight till layers with large cobbles encountered rather than bedrock. At each geoprobe boring, soil samples were collected at 2-foot intervals. The headspace of soil samples was field-screened using a photo-ionization detector (PID). The soil headspace PID readings were entered on the boring log, along with a description of the soil samples. The soils encountered by the borings were typically 4 to 5 feet of fill, underlain by varying thicknesses of fine to medium sand with gravel. The fine to medium sand and gravel was further underlain by silty sand with gravel (till). No groundwater was encountered. Boring logs and borehole abandonment forms for the borings are included as **Attachment A**.

Soil samples were collected at 2-foot intervals for field screening with a PID. Field screening results ranged from less than 3 ppm to 360 ppm. Petroleum odors were noted in the sample collected from boring GP2. A total of eight soil samples (two from each boring) were collected and preserved for submittal to TestAmerica, Inc., of Watertown, Wisconsin (WDNR Certification No. 128053530), for laboratory analysis. The samples were analyzed for gasoline range organics (GRO), diesel range organics (DRO), and petroleum volatile organic compounds (PVOCs). Soil sample analytical results are summarized in **Table 1**. Laboratory analytical reports and chain of custody forms are included in **Attachment C**.

NAPA Auto Parts

The number of borings installed at NAPA Auto Parts was also increased from two to four to allow for the additional investigation of 110 Broadway. These two properties are both owned by the same party. The geoprobe borings (GP1 through GP4) were all installed within the WI DOT right-of-way. Groundwater and bedrock were not encountered. Therefore, each borings was installed to a total depth of 20 feet bgs. At each geoprobe boring, soil samples were collected at 2-foot intervals. The headspace of soil samples was field-screened using a PID. The soil headspace PID readings were entered on the boring log, along with a description of the soil samples. The soils encountered by the borings were typically 15 to 20 feet of fill, underlain by silty clay. Boring logs and borehole abandonment forms for the borings are included as **Attachment B**.

Soil samples were collected at 2-foot intervals for field screening with a PID. Field screening results ranged from less than 3 ppm to 272 ppm. Petroleum odors were noted in samples collected from borings GP1, GP2, and GP3. A total of eight soil samples (two from each boring) were collected and preserved for submittal to TestAmerica for laboratory analysis. The samples were analyzed GRO, DRO, and PVOCs.

Analytical Results

Dick's Car Care

Analytical results of the soil indicate that significant petroleum impacts are present in soil in the right-of-way. Soil samples collected from boring GP2, GP3, and GP4 contained detectable concentrations of GRO, DRO, and PVOCs. The sample collected from boring GP2 at a depth of 12 feet contained concentrations of DRO, GRO, benzene, ethylbenzene, toluene, and xylenes which exceed Wisconsin Administrative Code NR 720 cleanup standards. Soil sample analytical results are summarized in **Table 1**. Laboratory analytical reports and chain of custody forms are included as **Attachment C**.

NAPA Auto Parts

Analytical results of the soil indicate that significant petroleum impacts are also present in soil in the right-of-way at both 104 and 110 Broadway Street. Soil samples collected from all borings (GP1, GP2, GP3, and GP4) contained detectable concentrations of GRO, DRO, and PVOCs. The samples collected from borings GP1, GP2, and GP3 contained concentrations of benzene which exceed Wisconsin Administrative Code NR 720 cleanup standards. NR 720 cleanup standards were also exceeded in samples collected from GP2 for GRO, DRO, ethylbenzene, toluene, and xylenes and from GP3 for GRO and xylenes. Soil sample analytical results are summarized in **Table 2**. Laboratory analytical reports and chain of custody forms are included as **Attachment C**.

Conclusions and Recommendations

Dick's Car Care

The soil at the site appears to have been impacted by petroleum constituents in an area which is likely near the location of the former USTs, indicating a release may have occurred on the site. Four of the eight soil samples collected contained detectable concentrations of petroleum compounds. The soil sample collected from boring GP2 at a depth of 12 feet bgs contained concentrations of DRO, GRO, benzene, ethylbenzene, toluene, and xylenes above the NR 720 generic soil cleanup standards. Based on field screening performed at the site using a PID, it appears the petroleum impacts in the right-of-way are confined to a depth of 7 feet or more bgs. For the planned WI DOT activities, it does not appear that impacted soil will be encountered. However, we understand the City of Baraboo has not yet decided whether or not to make improvements to sewer and water lines along Broadway Street during the highway reconstruction. If sewer or water mains are proposed in the vicinity of the site and at depths greater than 7 feet bgs, petroleum-impacted soil may be encountered.

NAPA Auto Parts

The soil at the NAPA Auto Parts site also appears to have been impacted by petroleum constituents in all areas investigated. Seven of the eight soil samples collected contained detectable concentrations of petroleum compounds. The soil samples collected from borings GP1, GP2, and GP3 contained concentrations of petroleum compounds above the NR 720 generic soil cleanup standards. Based on field screening performed at the site using a PID, it appears the petroleum impacts in the right-of-way are confined to a depth of 10 feet or more bgs. For the planned WI DOT activities, it does not appear that impacted soil will be encountered. However, we understand improvements will be made to the storm

sewer located along the western boundary of the property. However, the design of the storm sewer has not been completed. Depending on the depth and location of the storm sewer, impacted soil may be encountered.

Qualifications and Limitations

This report is presented for use by our client alone, and is not to be used by or relied upon by others who have not entered into a contract with BT² for these services. Conclusions in this report represent our professional judgement and are limited to those site conditions and potential soil impacts from neighboring properties that could be discovered under the work outlined in the Work Authorizations dated May 30, 2000.

The conclusions and interpretations of this report do not collectively define all the risks associated with purchase or other use of the property. In particular, the conclusions were based on collection and analysis of sixteen soil samples from areas potentially impacted by former land use practices. Should you, our client, or other interested parties, wish to further reduce the risks associated with undiscovered or unquantified environmental impacts, you may want to consider having additional assessment activities performed, such as collecting and analyzing additional soil, groundwater, or other appropriate samples for compounds of relevant and particular concern, or complete other investigation activities as appropriate.

The assessment was prepared in accordance with the generally accepted industry standards at the time the work was performed. No other warranty is expressed or implied.

If you have any questions regarding this letter please call us at (608) 224-2830.

Sincerely,
BT², Inc.



Tim Ryan
Project Engineer

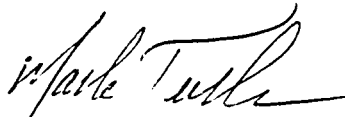

Mark Tusler, P.E.
Project Manager

Attachments: Table 1: Soil Analytical Results Summary - Dick's Car Care
Table 2: Soil Analytical Results Summary - NAPA Auto Parts
Figure 1: Site Location Map
Figure 2: Site Plan with geoprobe locations - Dick's Car Care
Figure 3: Site Plan with geoprobe locations - NAPA Auto Parts
Attachment A: Soil Boring Logs and Borehole Abandonment Forms - Dick's Car Care
Attachment B: Soil Boring Logs and Borehole Abandonment Forms - NAPA Auto Parts
Attachment C: Laboratory Analytical Reports and Chain-of-Custody Forms

cc: Michele Brokaw - WI DOT
Linda Olver - WI DOT
Troy Clausen - WDNR
Dick Christian - Dick's Car Care
Bob Schrieber - NAPA Auto Parts

TABLES

- 1 Soil Analytical Results Summary - Dick's Car Care
- 2 Soil Analytical Results Summary - NAPA Auto Parts

Table 1
Soil Analytical Results Summary
WI DOT - Dick's Car Care (5971-01-01)
(Results are in µg/kg, except where noted otherwise)

Sample	Date	Depth (feet)	FID (IU)	Lab Notes	DRO (mg/kg)	GRO (mg/kg)	Benzene	Ethylbenzene	Toluene	Xylenes	1,2,4-TMB	1,3,5-TMB	MTBE	Other VOCs
GP1-S5	6/30/00	9	--	(1)	<5.3	<5.8	<30	<30	<30	<87	<30	<30	<30	NA
GP1-S9	6/30/00	18	--	(1)	<5.3	<5.3	<26	<26	<26	<79	<26	<26	<26	NA
GP2-S5	6/30/00	9	--	(1)	7.7	<5.8	<30	39	117	286	191	90	<30	NA
GP2-S6	6/30/00	12	360	(2)	1,510	3,240	23,800	73,500	178,000	397,000	176,000	56,200	<1,300	NA
GP3-S7	6/30/00	9	--	(1)	<5.3	<5.9	<30	<30	128	<87	<30	<30	<30	NA
GP3-S10	6/30/00	20	--	(1)	<5.3	<6.4	<32	<32	<32	<96	<32	<32	<32	NA
GP4-S4	6/30/00	7	--	(1)	<5.1	<5.1	<26	<26	44	<77	<26	<26	<26	NA
GP4-S6	6/30/00	11	--	(1)	<5.3	<5.3	<27	<27	<27	<80	<27	<27	<27	NA
MeOH Blank	6/30/00	--	--	--	NA	<5.0	<25	<25	<25	<75	<25	<25	<25	NA
NR 720 Generic Soil Cleanup Standards					100	100	5.5	2,900	1,500	4,100	NE	NE	NE	

NOTE: Detections are in bold. NR 720 Generic Soil Cleanup Standards exceedances are shaded.

ABBREVIATIONS:

FID = Flame-ionization Detector
MTBE = Methyl-tert-butyl ether

DRO = Diesel Range Organics
VOCs = Volatile Organic Compounds

GRO = Gasoline Range Organics
NE = No Standard Established

TMB = Trimethylbenzene
NA = Not Analyzed

LABORATORY NOTES:

- (1) DRO analysis - Received past hold time.
(2) DRO analysis - Received past hold time. GRO analysis - Late eluting hydrocarbons present.

Table 2
Soil Analytical Results Summary
WI DOT - NAPA Auto Parts (5971-01-03)
(Results are in µg/kg, except where noted otherwise)

Sample	Date	Depth (feet)	PID (IU)	Lab Notes	DRO (mg/kg)	GRO (mg/kg)	Benzene	Ethylbenzene	Toluene	Xylenes	1,2,4-TMB	1,3,5-TMB	MTBE	Other VOCs
GP1-S8	6/30/00	15	--	(1)	25	13	332	86	130	180	53	<39	<39	NA
GP1-S10	6/30/00	20	--	(1)	<6.0	<7.2	49	<36	<36	<110	<36	<36	<36	NA
GP2-S8	6/30/00	14	--	--	7.3	110	1,890	1,350	1,080	5,280	3,650	1,890	<68	NA
GP2-S10	6/30/00	20	--	--	<5.9	<5.9	48	<29	<29	552	141	40	<29	NA
GP3-S8	6/30/00	15	243	(2)	309	392	3,560	7,130	3,330	33,300	17,800	5,580	<143	NA
GP3-S10	6/30/00	20	272	(3)	<6.1	77	1,160	784	<31	7,840	1,960	895	<31	NA
GP4-S4	6/30/00	8	--	--	<20	<20	<98	<98	<98	<300	<98	<98	140	NA
GP4-S8	6/30/00	16	--	--	<6.2	<6.2	<31	<31	<31	<93	<31	<31	<31	NA
MeOH Blank	6/30/00	--	--	--	NA	<5.0	<25	<25	<25	<75	<25	<25	<25	NA
NR 720 Generic Soil Cleanup Standards					100	100	5.5	2,900	1,500	4,100	NE	NE	NE	

NOTE: Detections are in bold. NR 720 Generic Soil Cleanup Standards exceedances are shaded.

ABBREVIATIONS:

PID = Photo-ionization Detector
MTBE = Methyl-tert-butyl ether

DRO = Diesel Range Organics
VOCs = Volatile Organic Compounds

GRO = Gasoline Range Organics
NE = No Standard Established

TMB = Trimethylbenzene
NA = Not Analyzed

LABORATORY NOTES:

- (1) DRO analysis - Received past hold time.
- (2) DRO and GRO analyses - Late eluting hydrocarbons present.
- (3) GRO analysis - Late eluting hydrocarbons present.

FIGURES

- 1 Site Location Map
- 2 Site Plan with geoprobe locations - Dick's Car Care
- 3 Site Plan with geoprobe locations - NAPA Auto Parts

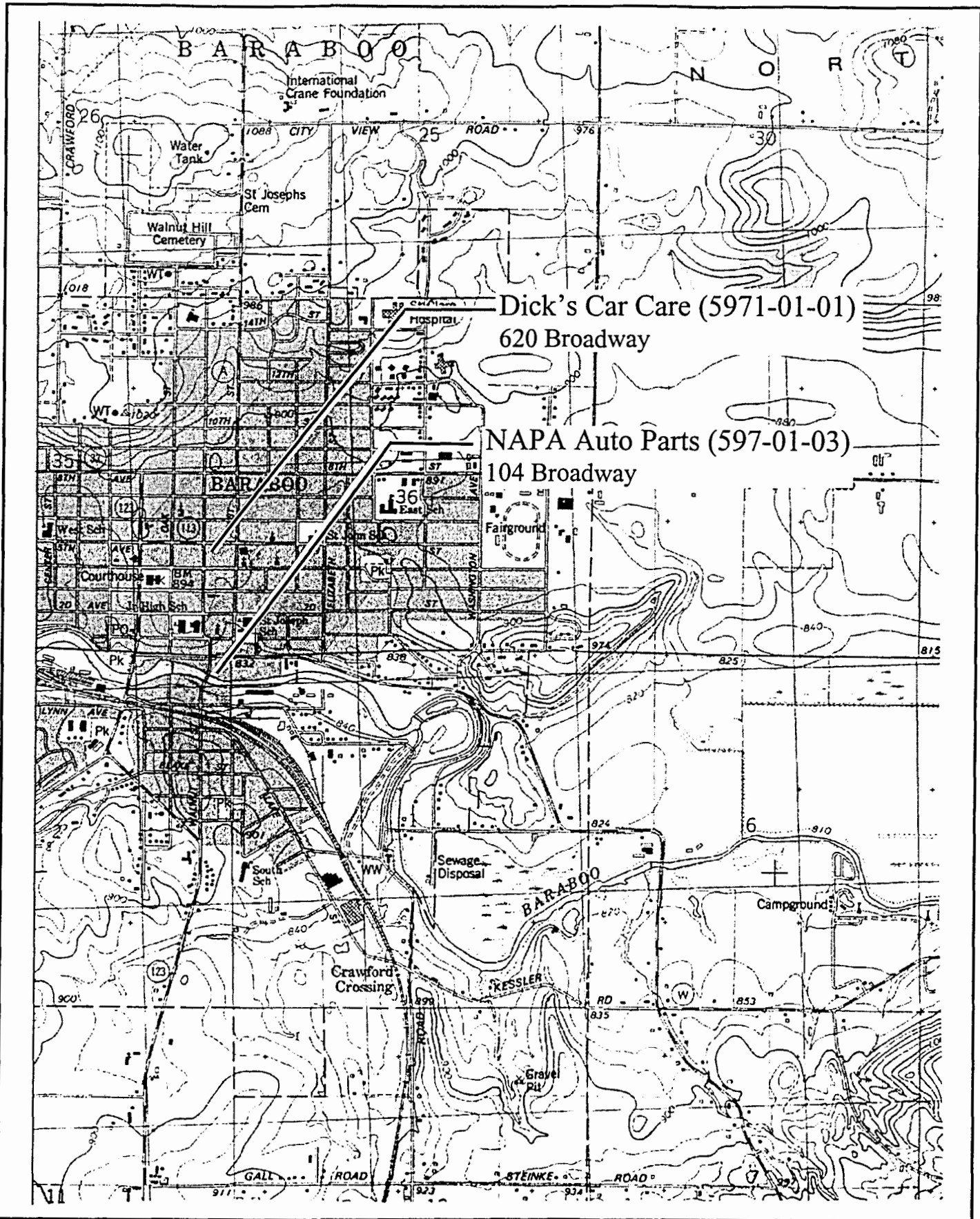

Dick's Car Care (5971-01-01)
620 Broadway

NAPA Auto Parts (597-01-03)
104 Broadway

PROJECT NO. 1770/1771
DRAWN BY: TR
CHECKED BY: MT
DRAWN: 08/15/00
REVISED:

FIGURE 1
SITE LOCATION MAP
DICK'S CAR CARE & NAPA AUTO PARTS
104 & 620 BROADWAY
BARABOO, WISCONSIN



N

5TH AVENUE (STH 113)

BROADWAY STREET (STH 123)

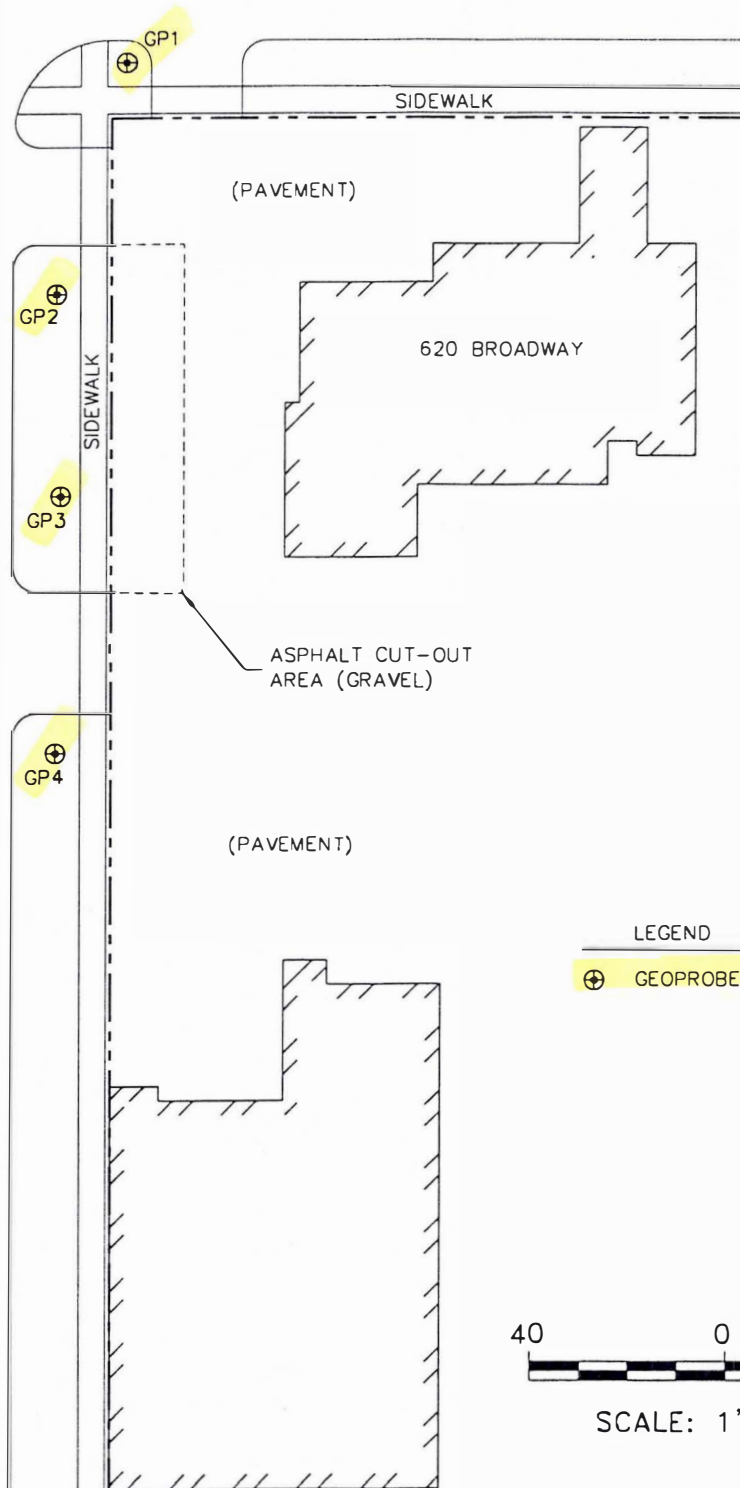

LEGEND

⊕ GEOPROBE SOIL BORING

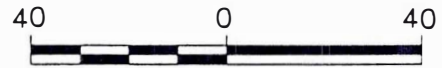

SCALE: 1" = 40'

PROJECT NO. 1770

DRAWN BY: KP

CHECKED BY: NH

DRAWN: 07/05/00

REVISED: 07/05/00

FIGURE 2
 SITE PLAN
 WDOT - DICKS CAR CARE (5971-01-01)
 620 BROADWAY STREET
 BARABOO, WISCONSIN



N

WATER STREET

BROADWAY STREET (STH 123)

⊕ GP3

FORMER BUILDING

55-GALLON DRUMS (3)

VENT PIPES (2)

⊕ GP2

110 BROADWAY STREET

⊕ GP1

⊕ GP4

104 BROADWAY ST.

LEGEND

⊕ GEOPROBE SOIL BORING

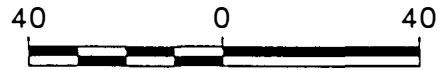

SCALE: 1" = 40'

PROJECT NO. 1771

DRAWN BY: KP

CHECKED BY: NH

DRAWN: 07/05/00

REVISED: 07/05/00

FIGURE 3
 SITE PLAN
 WDOT - NAPA AUTO PARTS (5971-01-03)
 104 BROADWAY STREET
 BARABOO, WISCONSIN

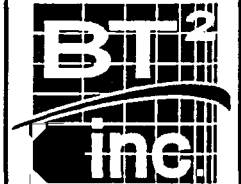

ATTACHMENT A

Soil Boring Logs and Borehole Abandonment Forms - Dick's Car Care

Route To:

- Solid Waste
- Emergency Response
- Wastewater
- Haz. Waste
- Underground Tanks
- Water Resources
- Other _____

Facility/Project Name WDOT SH123 Dick's Car Care		BT ² # 1770	License/Permit/Monitoring Number		Boring Number GP1
Boring Drilled By (Firm name and name of crew chief) On-Site Environmental Tony Kapugi			Drilling Started 06/30/2000	Drilling Completed 06/30/2000	Drilling Method Geoprobe
DNR Facility Well No.	WI Unique Well No.	Common Well Name	Static Water Level Feet	Surface Elevation Feet	Borehole Diam. 2 Inches
Boring Location State Plane N, E NW 1/4 of SE 1/4 of Section 35, T. 12 N., R. 6 E.			Lat. Long.	Local Grid Location (If applicable) Feet N., Feet E.	
County Sauk		DNR County Code 57	Civil Town/City/or Village Baraboo		

Sample Number	Length Recovered	Blow Counts	Depth in Feet	Soil/Rock Description And Geologic Origin For Each Major Unit	USCS	Graphic Log	Well Diagram	Max. PID/FID	Soil Properties			RQD/ Comments
									Standard Penetration	Moisture Content	P200	
S1	12			2" CONCRETE PAVEMENT; SAND, brown, medium (fill).				0		M		no odor
S2	12				SP			0		M		no odor
S3	18		5					0		M		no odor
S4	18							0		M		no odor
S5	20			SAND, fine to medium, light brown, with gravel.				0		M		no odor
S6	20		10		SP			0		M		no odor
S7	18							0		M		no odor
S8	18		15	SILTY SAND, brown, with gravel (till).				0		M		no odor
S9	16				SM			0		M		no odor; refusal @ 18'
				End of boring @ 18'.								

I hereby certify that the information on this form is true and correct to the best of my knowledge.

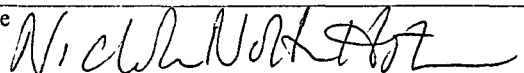
Signature 	Firm BT ² , Inc. Nichole North Hester
--	---

This form is authorized by Chapters 144, 147 and 162, Wis. Stats. Completion of this form is mandatory. Penalties: Forfeit not less than \$10 nor more than \$5,000 for each violation. Fined not less than \$10 or more than \$100 or imprisoned not less than 30 days, or both for each violation. Each day of continued violation is a separate offense, pursuant to ss 144.99 and 162.06 Wis. Stats.

Route To:

- Solid Waste
 Emergency Response
 Wastewater
 Haz. Waste
 Underground Tanks
 Water Resources
 Other _____

Facility/Project Name WDOT SH123 Dick's Car Care		BT ² # 1770	License/Permit/Monitoring Number		Boring Number GP2
Boring Drilled By (Firm name and name of crew chief) On-Site Environmental Tony Kapugi			Drilling Started 06/30/2000	Drilling Completed 06/30/2000	Drilling Method Geoprobe
DNR Facility Well No.	WI Unique Well No.	Common Well Name	Static Water Level Feet	Surface Elevation Feet	Borehole Diam. 2 Inches
Boring Location State Plane N, E NW 1/4 of SE 1/4 of Section 35, T. 12 N., R. 6 E.			Lat. Long.	Local Grid Location (If applicable) Feet N., Feet E.	
County Sauk		DNR County Code 57	Civil Town/City/or Village Baraboo		

Sample Number	Length Recovered	Blow Counts	Depth in Feet	Soil/Rock Description And Geologic Origin For Each Major Unit	USCS	Graphic Log	Well Diagram	Max. PID/FID	Soil Properties			RQD/ Comments
									Standard Penetration	Moisture Content	P200	
S1	20			SILT, black (topsoil) (fill). SAND, brown, medium (fill).	ML			1.1		M		no odor
S2	20				SP			0		M		no odor
S3	20		5	SAND, fine to medium, light brown, with gravel; scattered cobbles.				0		M		no odor
S4	20				SP			9.7		M		no odor
S5	20				SP			15.3		M		no odor
S6	20		10	SILTY SAND, brown, with gravel (till). End of boring @ 12'. abandoned with bentonite.	SM			360		M		diesel odor; refusal @ 12'

I hereby certify that the information on this form is true and correct to the best of my knowledge.

Signature Firm BT², Inc. Nichole North Hester

This form is authorized by Chapters 144, 147 and 162, Wis. Stats. Completion of this form is mandatory. Penalties: Forfeit not less than \$10 nor more than \$5,000 for each violation. Fined not less than \$10 or more than \$100 or imprisoned not less than 30 days, or both for each violation. Each day of continued violation is a separate offense, pursuant to ss 144.99 and 162.06 Wis. Stats.

Route To:

- Solid Waste
- Emergency Response
- Wastewater

- Haz. Waste
- Underground Tanks
- Water Resources
- Other _____

Facility/Project Name WDOT SH123 Dick's Car Care		BT ² # 1770	License/Permit/Monitoring Number		Boring Number GP3
Boring Drilled By (Firm name and name of crew chief) On-Site Environmental Tony Kapugi			Drilling Started 06/30/2000	Drilling Completed 06/30/2000	Drilling Method Geoprobe
DNR Facility Well No.	WI Unique Well No.	Common Well Name	Static Water Level Feet	Surface Elevation Feet	Borehole Diam. 2 Inches
Boring Location State Plane N, E NW 1/4 of SE 1/4 of Section 35, T. 12 N., R. 6 E.			Lat. Long.	Local Grid Location (If applicable) Feet N., Feet E.	
County Sauk		DNR County Code 57	Civil Town/City/or Village Baraboo		

Sample Number	Length Recovered	Blow Counts	Depth in Feet	Soil/Rock Description And Geologic Origin For Each Major Unit	USCS	Graphic Log	Well Diagram	Soil Properties				
								Max. PID/FID	Standard Penetration	Moisture Content	P200	RQD/ Comments
S1	18			SILT, black (topsoil) (fill).	ML			1.1		M		no odor
S2	18			SAND, brown, medium (fill).				1.4		M		no odor
S3	20		5		SP			0		M		no odor
S4	20			SAND, medium to coarse, brown, with gravel.	SP			0		M		no odor
S5	22							0		M		no odor
S6	22		10	SILTY CLAY, brown, with gravel.	CL-ML			0		M		no odor
S7	24			SILTY SAND, with gravel (till).				1.9		M		no odor
S8	24		15		SM			.8		M		no odor
S9	24							1.3		M		no odor
S10	24		20	End of boring @ 20'. abandoned with bentonite.				1.6		M		no odor

I hereby certify that the information on this form is true and correct to the best of my knowledge.

Signature <i>Nichole North Hester</i>	Firm BT ² , Inc.	Nichole North Hester
--	--------------------------------	----------------------

This form is authorized by Chapters 144, 147 and 162, Wis. Stats. Completion of this form is mandatory. Penalties: Forfeit not less than \$10 nor more than \$5,000 for each violation. Fined not less than \$10 or more than \$100 or imprisoned not less than 30 days, or both for each violation. Each day of continued violation is a separate offense, pursuant to ss 144.99 and 162.06 Wis. Stats.

Route To:

- Solid Waste
- Emergency Response
- Wastewater
- Haz. Waste
- Underground Tanks
- Water Resources
- Other _____

Facility/Project Name WDOT SH123 Dick's Car Care		BT ² # 1770	License/Permit/Monitoring Number	Boring Number GP4
Boring Drilled By (Firm name and name of crew chief) On-Site Environmental Tony Kapugi		Drilling Started 06/30/2000	Drilling Completed 06/30/2000	Drilling Method Geoprobe
DNR Facility Well No.	WI Unique Well No.	Common Well Name	Static Water Level Feet	Surface Elevation Feet
Boring Location State Plane N, E NW 1/4 of SE 1/4 of Section 35, T. 12 N., R. 6 E.		Lat. Long.	Local Grid Location (If applicable) Feet N., Feet E.	

County Sauk	DNR County Code 57	Civil Town/City/or Village Baraboo
----------------	-----------------------	---------------------------------------

Sample Number	Length Recovered	Blow Counts	Depth in Feet	Soil/Rock Description And Geologic Origin For Each Major Unit	USCS	Graphic Log	Well Diagram	Max. PID/FID	Soil Properties			RQD/ Comments
									Standard Penetration	Moisture Content	P200	
S1	16			SILT, black (topsoil) (fill). SAND, brown, medium (fill).	ML			1.1		M		no odor
S2	16							1.1		M		no odor
S3	22		5					1.1		M		no odor
S4	22			SILTY SAND, brown, with gravel (till).				1.3		M		no odor
S5	20		10		SM			0.8		M		no odor
S6	14			End of boring @ 11.5'. abandoned with bentonite.				0.8		M		no odor; refusal @ 11.5'

I hereby certify that the information on this form is true and correct to the best of my knowledge.

Signature 	Firm BT ² , Inc.	Nichole North Hester
--	--------------------------------	----------------------

This form is authorized by Chapters 144, 147 and 162, Wis. Stats. Completion of this form is mandatory. Penalties: Forfeit not less than \$10 nor more than \$5,000 for each violation. Fined not less than \$100 or more than \$1000 or imprisoned not less than 30 days, or both for each violation. Each day of continued violation is a separate offense, pursuant to ss 144.99 and 162.06 Wis. Stats.

All abandonment work shall be performed in accordance with the provisions of Chapters NR 111, NR 112, or NR 141, Wis. Admin. Code, whichever is applicable. Also, see instructions included with this form.

(1) GENERAL INFORMATION		(2) FACILITY NAME	
Well/Drillhole/Borehole Location	County Sauk	Original Well Owner (If Known) DOT SH 123-Dicks Care Care	
NW 1/4 of SE 1/4 of Sec. 35 ; T. 12 N; R. 6 <input checked="" type="checkbox"/> E. <input type="checkbox"/> W.		Present Well Owner DOT	
(If applicable) Gov't Lot _____ Grid Number _____		Street or Route 4802 Sheboygan Ave. Rm 451	
Grid Location _____ ft. <input type="checkbox"/> N. <input type="checkbox"/> S. _____ ft. <input type="checkbox"/> E. <input type="checkbox"/> W.		City, State, Zip Code Madison, WI 53707	
Civil Town Name Baraboo		Facility Well No. and/or Name (If Applicable) GPI	WI Unique Well No. _____
Street Address of Well 620 Broadway		Reason For Abandonment Geoprobe Boring	
City, Village Baraboo, WI		Date of Abandonment 06/30/2000	

WELL/DRILLHOLE/BOREHOLE INFORMATION

3) Original Well/Drill/Borehole Construction Completed On
(Date) 06/30/2000

<input type="checkbox"/> Monitoring Well <input type="checkbox"/> Water Well <input type="checkbox"/> Drillhole <input checked="" type="checkbox"/> Borehole	Construction Report Available? <input checked="" type="checkbox"/> Yes <input type="checkbox"/> No
---	---

Construction Type:
 Drilled Driven (Sandpoint) Dug
 Other (Specify) Geoprobe

Formation Type:
 Unconsolidated Formation Bedrock

Total Well Depth (ft.) 18 Casing Diameter (ins.) 2
 (From ground surface) Casing Depth (ft.) 18

Lower Drillhole Diameter (in.) NA

Was Well Annular Space Grouted? Yes No Unknown
 If Yes, To What Depth? _____ Feet

4) Depth to Water (Feet) >18

Pump & Piping Removed?	<input type="checkbox"/> Yes	<input type="checkbox"/> No	<input checked="" type="checkbox"/> Not Applicable
Liner(s) Removed?	<input type="checkbox"/> Yes	<input type="checkbox"/> No	<input checked="" type="checkbox"/> Not Applicable
Screen Removed?	<input type="checkbox"/> Yes	<input type="checkbox"/> No	<input checked="" type="checkbox"/> Not Applicable
Casing Left in Place? If No, Explain	<input type="checkbox"/> Yes	<input type="checkbox"/> No	<input checked="" type="checkbox"/> Not Applicable

Was Casing Cut Off Below Surface? Yes No
 Did Sealing Material Rise to Surface? Yes No
 Did Material Settle After 24 Hours? Yes No
 If Yes, Was Hole Retopped? Yes No

5) Required Method of Placing Sealing Material
 Conductor Pipe-Gravity Conductor Pipe-Pumped
 Dump Bailer Other(Explain) Gravity

6) Sealing Materials For monitoring wells and monitoring well boreholes only

<input type="checkbox"/> Neat Cement Grout <input type="checkbox"/> Sand-Cement (Concrete) Grout <input type="checkbox"/> Concrete <input type="checkbox"/> Clay-Sand Slurry <input type="checkbox"/> Bentonite-Sand Slurry <input type="checkbox"/> Chipped Bentonite	<input type="checkbox"/> Bentonite Pellets <input checked="" type="checkbox"/> Granular Bentonite <input type="checkbox"/> Bentonite -Cement Grout
---	--

(7) Sealing Material Used	From (Ft.)	To (Ft.)	No. Yards, Sacks Sealant or Volume	Mix Ratio or Mud Weight
Concrete Patch	Surface	0.5		
Granular Bentonite	0.5	18	0.25 ft ³	dry mix

8) Comments:

9) Name of Person or Firm Doing Sealing
Nichole North Hester, BT², Inc.

Signature of Person Doing Work <i>Nichole North Hester</i>	Date Signed 7-11-00
Street or Route 2830 Dairy Drive	Telephone Number (608) 224-2830
City, State, Zip Code Madison, WI 53718	

(10) FOR DNR OR COUNTY USE ONLY	
Date Received/Inspected	District/County
Reviewer/Inspector	<input type="checkbox"/> Complying Work <input type="checkbox"/> Non-complying Work
Follow-up Necessary	

All abandonment work shall be performed in accordance with the provisions of Chapters NR 111, NR 112, or NR 141, Wis. Admin. Code, whichever is applicable. Also, see instructions included with this form.

(1) GENERAL INFORMATION		(2) FACILITY NAME	
Well/Drillhole/Borehole Location	County Sauk	Original Well Owner (If Known) DOT SH 123-Dicks Care Care	
NW 1/4 of SE 1/4 of Sec. 35 ; T. 12 N; R 6	<input checked="" type="checkbox"/> E. <input type="checkbox"/> W.	Present Well Owner DOT	
(If applicable) Gov't Lot	Grid Number	Street or Route 4802 Sheboygan Ave. Rm 451	
Grid Location ft. <input type="checkbox"/> N. <input type="checkbox"/> S. <input type="checkbox"/> E. <input type="checkbox"/> W.		City, State, Zip Code Madison, WI 53707	
Civil Town Name Baraboo		Facility Well No. and/or Name (If Applicable) GP2	WI Unique Well No. _____
Street Address of Well 620 Broadway		Reason For Abandonment Geoprobe Boring	
City, Village Baraboo, WI		Date of Abandonment 06/30/2000	

WELL/DRILLHOLE/BOREHOLE INFORMATION

3) Original Well/Drill/Borehole Construction Completed On
(Date) 06/30/2000

Monitoring Well
 Water Well
 Drillhole
 Borehole

Construction Report Available?
 Yes No

Construction Type:
 Drilled Driven (Sandpoint) Dug
 Other (Specify) Geoprobe

Formation Type:
 Unconsolidated Formation Bedrock

Total Well Depth (ft.) 12 Casing Diameter (ins.) 2
 (From ground surface) Casing Depth (ft.) 12

Lower Drillhole Diameter (in.) NA

Was Well Annular Space Grouted? Yes No Unknown
 If Yes, To What Depth? _____ Feet

(4) Depth to Water (Feet) >12

Pump & Piping Removed? Yes No Not Applicable
 Liner(s) Removed? Yes No Not Applicable
 Screen Removed? Yes No Not Applicable
 Casing Left in Place? Yes No Not Applicable
 If No, Explain _____

Was Casing Cut Off Below Surface? Yes No

Did Sealing Material Rise to Surface? Yes No

Did Material Settle After 24 Hours? Yes No

If Yes, Was Hole Retopped? Yes No

(5) Required Method of Placing Sealing Material

Conductor Pipe-Gravity
 Dump Bailer
 Conductor Pipe-Pumped
 Other(Explain) Gravity

(6) Sealing Materials

Neat Cement Grout
 Sand-Cement (Concrete) Grout
 Concrete
 Clay-Sand Slurry
 Bentonite-Sand Slurry
 Chipped Bentonite

For monitoring wells and monitoring well boreholes only

Bentonite Pellets
 Granular Bentonite
 Bentonite -Cement Grout

(7) Sealing Material Used	From (Ft.)	To (Ft.)	No. Yards, Sacks Sealant or Volume	Mix Ratio or Mud Weight
Topsoil	Surface	0.5		
Granular Bentonite	0.5	12	0.17 ft3	dry mix

(8) Comments:

(9) Name of Person or Firm Doing Sealing
Nichole North Hester, BT2, Inc.

Signature of Person Doing Work: *Nichole North Hester* Date Signed: 7.11.00

Street or Route: 2830 Dairy Drive Telephone Number: (608) 224-2830

City, State, Zip Code: Madison, WI 53718

(10) FOR DNR OR COUNTY USE ONLY

Date Received/Inspected	District/County
Reviewer/Inspector	<input type="checkbox"/> Complying Work <input type="checkbox"/> Non-complying Work
Follow-up Necessary	

All abandonment work shall be performed in accordance with the provisions of Chapters NR 111, NR 112, or NR 141, Wis. Admin. Code, whichever is applicable. Also, see instructions included with this form.

(1) GENERAL INFORMATION		(2) FACILITY NAME	
Well/Drillhole/Borehole Location	County Sauk	Original Well Owner (If Known) DOT SH 123-Dicks Care Care	
NW 1/4 of SE 1/4 of Sec. 35 ; T. 12 N; R 6 <input checked="" type="checkbox"/> E. <input type="checkbox"/> W.		Present Well Owner DOT	
(If applicable) Gov't Lot _____ Grid Number _____		Street or Route 4802 Sheboygan Ave. Rm 451	
Grid Location _____ ft. <input type="checkbox"/> N. <input type="checkbox"/> S. _____ ft. <input type="checkbox"/> E. <input type="checkbox"/> W.		City, State, Zip Code Madison, WI 53707	
Civil Town Name Baraboo		Facility Well No. and/or Name (If Applicable) GP3	WI Unique Well No. _____
Street Address of Well 620 Broadway		Reason For Abandonment Geoprobe Boring	
City, Village Baraboo, WI		Date of Abandonment 06/30/2000	

WELL/DRILLHOLE/BOREHOLE INFORMATION			
(3) Original Well/Drill/Borehole Construction Completed On (Date) 06/30/2000 <input type="checkbox"/> Monitoring Well Construction Report Available? <input type="checkbox"/> Water Well <input checked="" type="checkbox"/> Yes <input type="checkbox"/> No <input type="checkbox"/> Drillhole <input checked="" type="checkbox"/> Borehole Construction Type: <input type="checkbox"/> Drilled <input type="checkbox"/> Driven (Sandpoint) <input type="checkbox"/> Dug <input checked="" type="checkbox"/> Other (Specify) <u>Geoprobe</u> Formation Type: <input checked="" type="checkbox"/> Unconsolidated Formation <input type="checkbox"/> Bedrock Total Well Depth (ft.) <u>20</u> Casing Diameter (ins.) <u>2</u> (From ground surface) Casing Depth (ft.) <u>20</u> Lower Drillhole Diameter (in.) <u>NA</u> Was Well Annular Space Grouted? <input type="checkbox"/> Yes <input checked="" type="checkbox"/> No <input type="checkbox"/> Unknown If Yes, To What Depth? _____ Feet		(4) Depth to Water (Feet) >20 Pump & Piping Removed? <input type="checkbox"/> Yes <input type="checkbox"/> No <input checked="" type="checkbox"/> Not Applicable Liner(s) Removed? <input type="checkbox"/> Yes <input type="checkbox"/> No <input checked="" type="checkbox"/> Not Applicable Screen Removed? <input type="checkbox"/> Yes <input type="checkbox"/> No <input checked="" type="checkbox"/> Not Applicable Casing Left in Place? <input type="checkbox"/> Yes <input type="checkbox"/> No <input checked="" type="checkbox"/> Not Applicable If No, Explain _____ Was Casing Cut Off Below Surface? <input type="checkbox"/> Yes <input checked="" type="checkbox"/> No Did Sealing Material Rise to Surface? <input checked="" type="checkbox"/> Yes <input type="checkbox"/> No Did Material Settle After 24 Hours? <input type="checkbox"/> Yes <input checked="" type="checkbox"/> No If Yes, Was Hole Retopped? <input type="checkbox"/> Yes <input type="checkbox"/> No	
(5) Required Method of Placing Sealing Material <input type="checkbox"/> Conductor Pipe-Gravity <input checked="" type="checkbox"/> Conductor Pipe-Pumped <input type="checkbox"/> Dump Bailer <input checked="" type="checkbox"/> Other(Explain) Gravity		(6) Sealing Materials For monitoring wells and monitoring well boreholes only <input type="checkbox"/> Neat Cement Grout <input type="checkbox"/> Sand-Cement (Concrete) Grout <input type="checkbox"/> Concrete <input type="checkbox"/> Clay-Sand Slurry <input type="checkbox"/> Bentonite-Sand Slurry <input type="checkbox"/> Chipped Bentonite <input type="checkbox"/> Bentonite Pellets <input checked="" type="checkbox"/> Granular Bentonite <input type="checkbox"/> Bentonite -Cement Grout	

(7) Sealing Material Used	From (Ft.)	To (Ft.)	No. Yards, Sacks Sealant or Volume	Mix Ratio or Mud Weight
Topsoil	Surface	0.5		
Granular Bentonite	0.5	20	0.28 ft3	dry mix

(8) Comments:

(9) Name of Person or Firm Doing Sealing
Nichole North Hester, BT2, Inc.

Signature of Person Doing Work <i>Nichole North Hester</i>	Date Signed 7-11-00
Street or Route 2830 Dairy Drive	Telephone Number (608) 224-2830
City, State, Zip Code Madison, WI 53718	

(10) FOR DNR OR COUNTY USE ONLY	
Date Received/Inspected	District/County
Reviewer/Inspector	<input type="checkbox"/> Complying Work <input type="checkbox"/> Non-complying Work
Follow-up Necessary	

All abandonment work shall be performed in accordance with the provisions of Chapters NR 111, NR 112, or NR 141, Wis. Admin. Code, whichever is applicable. Also, see instructions included with this form.

(1) GENERAL INFORMATION		(2) FACILITY NAME	
Well/Drillhole/Borehole Location	County Sauk	Original Well Owner (If Known) DOT SH 123-Dicks Care Care	
NW 1/4 of SE 1/4 of Sec. 35 ; T. 12 N; R. 6	<input checked="" type="checkbox"/> E. <input type="checkbox"/> W.	Present Well Owner DOT	
(If applicable) Gov't Lot	Grid Number	Street or Route 4802 Sheboygan Ave. Rm 451	
Grid Location ft. <input type="checkbox"/> N. <input type="checkbox"/> S. ft. <input type="checkbox"/> E. <input type="checkbox"/> W.		City, State, Zip Code Madison, WI 53707	
Civil Town Name Baraboo		Facility Well No. and/or Name (If Applicable) GP4	WI Unique Well No. _____
Street Address of Well 620 Broadway		Reason For Abandonment Geoprobe Boring	
City, Village Baraboo, WI		Date of Abandonment 06/30/2000	

WELL/DRILLHOLE/BOREHOLE INFORMATION			
<p>(3) Original Well/Drill/Borehole Construction Completed On (Date) 06/30/2000</p> <p>Monitoring Well <input type="checkbox"/> Construction Report Available? <input checked="" type="checkbox"/> Yes <input type="checkbox"/> No</p> <p>Water Well <input type="checkbox"/></p> <p>Drillhole <input type="checkbox"/></p> <p><input checked="" type="checkbox"/> Borehole</p> <p>Construction Type: <input type="checkbox"/> Drilled <input type="checkbox"/> Driven (Sandpoint) <input type="checkbox"/> Dug <input checked="" type="checkbox"/> Other (Specify) Geoprobe</p> <p>Formation Type: <input checked="" type="checkbox"/> Unconsolidated Formation <input type="checkbox"/> Bedrock</p> <p>Total Well Depth (ft.) 11.5 Casing Diameter (ins.) 2 (From ground surface) Casing Depth (ft.) 11.5</p> <p>Lower Drillhole Diameter (in.) NA</p> <p>Was Well Annular Space Grouted? <input type="checkbox"/> Yes <input checked="" type="checkbox"/> No <input type="checkbox"/> Unknown If Yes, To What Depth? _____ Feet</p>	<p>(4) Depth to Water (Feet) >11.5</p> <p>Pump & Piping Removed? <input type="checkbox"/> Yes <input type="checkbox"/> No <input checked="" type="checkbox"/> Not Applicable</p> <p>Liner(s) Removed? <input type="checkbox"/> Yes <input type="checkbox"/> No <input checked="" type="checkbox"/> Not Applicable</p> <p>Screen Removed? <input type="checkbox"/> Yes <input type="checkbox"/> No <input checked="" type="checkbox"/> Not Applicable</p> <p>Casing Left in Place? <input type="checkbox"/> Yes <input type="checkbox"/> No <input checked="" type="checkbox"/> Not Applicable</p> <p>If No, Explain _____</p> <p>Was Casing Cut Off Below Surface? <input type="checkbox"/> Yes <input checked="" type="checkbox"/> No</p> <p>Did Sealing Material Rise to Surface? <input checked="" type="checkbox"/> Yes <input type="checkbox"/> No</p> <p>Did Material Settle After 24 Hours? <input type="checkbox"/> Yes <input checked="" type="checkbox"/> No</p> <p>If Yes, Was Hole Retopped? <input type="checkbox"/> Yes <input type="checkbox"/> No</p> <p>(5) Required Method of Placing Sealing Material <input type="checkbox"/> Conductor Pipe-Gravity <input checked="" type="checkbox"/> Conductor Pipe-Pumped <input type="checkbox"/> Dump Bailer <input type="checkbox"/> Other(Explain) Gravity</p> <p>(6) Sealing Materials</p> <table style="width:100%;"> <tr> <td style="width:70%;"> <input type="checkbox"/> Neat Cement Grout <input type="checkbox"/> Sand-Cement (Concrete) Grout <input type="checkbox"/> Concrete <input type="checkbox"/> Clay-Sand Slurry <input type="checkbox"/> Bentonite-Sand Slurry <input type="checkbox"/> Chipped Bentonite </td> <td style="width:30%; border-left: 1px dashed black;"> For monitoring wells and monitoring well boreholes only <input type="checkbox"/> Bentonite Pellets <input checked="" type="checkbox"/> Granular Bentonite <input type="checkbox"/> Bentonite -Cement Grout </td> </tr> </table>	<input type="checkbox"/> Neat Cement Grout <input type="checkbox"/> Sand-Cement (Concrete) Grout <input type="checkbox"/> Concrete <input type="checkbox"/> Clay-Sand Slurry <input type="checkbox"/> Bentonite-Sand Slurry <input type="checkbox"/> Chipped Bentonite	For monitoring wells and monitoring well boreholes only <input type="checkbox"/> Bentonite Pellets <input checked="" type="checkbox"/> Granular Bentonite <input type="checkbox"/> Bentonite -Cement Grout
<input type="checkbox"/> Neat Cement Grout <input type="checkbox"/> Sand-Cement (Concrete) Grout <input type="checkbox"/> Concrete <input type="checkbox"/> Clay-Sand Slurry <input type="checkbox"/> Bentonite-Sand Slurry <input type="checkbox"/> Chipped Bentonite	For monitoring wells and monitoring well boreholes only <input type="checkbox"/> Bentonite Pellets <input checked="" type="checkbox"/> Granular Bentonite <input type="checkbox"/> Bentonite -Cement Grout		

(7) Sealing Material Used	From (Ft.)	To (Ft.)	No. Yards, Sacks Sealant or Volume	Mix Ratio or Mud Weight
Topsoil	Surface	0.5		
Granular Bentonite	0.5	11.5	0.16 ft3	dry mix

(8) Comments:

(9) Name of Person or Firm Doing Sealing
Nichole North Hester, BT2, Inc.

Signature of Person Doing Work <i>Nichole North Hester</i>	Date Signed 7.11.00
Street or Route 2830 Dairy Drive	Telephone Number (608) 224-2830
City, State, Zip Code Madison, WI 53718	

(10) FOR DNR OR COUNTY USE ONLY	
Date Received/Inspected	District/County
Reviewer/Inspector	<input type="checkbox"/> Complying Work <input type="checkbox"/> Non-complying Work
Follow-up Necessary	

ATTACHMENT B

Soil Boring Logs and Borehole Abandonment Forms - NAPA Auto Parts

Route To:

- Solid Waste
 Emergency Response
 Wastewater

- Haz. Waste
 Underground Tanks
 Water Resources
 Other _____

Facility/Project Name DOT S.H. 123-NAPA		BT ² # 1771		License/Permit/Monitoring Number		Boring Number GP1	
Boring Drilled By (Firm name and name of crew chief) On-Site Environmental Tony Kapugi				Drilling Started 06/30/2000		Drilling Completed 06/30/2000	
DNR Facility Well No.		WI Unique Well No.		Common Well Name		Static Water Level Feet	
Surface Elevation Feet		Borehole Diam. 2 Inches		Boring Location State Plane N, E SW 1/4 of SE 1/4 of Section 35, T. 12 N., R. 6 E.			
Lat.		Long.		Local Grid Location (If applicable) Feet N., Feet E.			
County Sauk		DNR County Code 57		Civil Town/City/or Village Baraboo			

Sample Number	Length Recovered	Blow Counts	Depth in Feet	Soil/Rock Description And Geologic Origin For Each Major Unit	USCS	Graphic Log	Well Diagram	Soil Properties				
								Max. PID/FID	Standard Penetration	Moisture Content	P200	RQD/ Comments
S1	12			3" ASPHALT PAVEMENT over 4" CONCRETE.	GP			1.1	M			no odor
S2	18			SAND, brown (fill).	SP			0.8	M			no odor
S3	16		5	SILTY CLAY, brown, mottled (fill).	CL-ML			1.1	M			no odor
S4	16			SAND, fine to coarse, brown (fill).	SW			0.5	M			no odor
S5	18			SILTY CLAY, green, with fine sand; 3 sand seams each 4" thick (fill).	CL-ML			0.8	M			no odor
S6	18		10	SILTY CLAY, black; some green mottles (fill).	CL-ML			2.5	M			no odor
S7	0				CL-ML			-	-			-
S8	14		15	SANDY GRAVEL, dark brown; glass, wood chips, tire fragments (fill).	GP			3.6	MW			slight stagnant petroleum smell
S9	0			SILTY CLAY, black with sand.	ML-CL			-	-			-
S10	4		20	End of boring @ 20'; abandoned with bentonite.				1.9	W			no odor

I hereby certify that the information on this form is true and correct to the best of my knowledge.

Signature Nichole North Hester Firm BT², Inc. Nichole North Hester

This form is authorized by Chapters 144, 147 and 162, Wis. Stats. Completion of this form is mandatory. Penalties: Forfeit not less than \$10 nor more than \$5,000 for each violation. Fined not less than \$10 or more than \$100 or imprisoned not less than 30 days, or both for each violation. Each day of continued violation is a separate offense, pursuant to ss 144.99 and 162.06 Wis. Stats.

Route To:

- Solid Waste
- Emergency Response
- Wastewater

- Haz. Waste
- Underground Tanks
- Water Resources
- Other _____

Facility/Project Name DOT S.H. 123-NAPA		BT ² # 1771		License/Permit/Monitoring Number		Boring Number GP2	
Boring Drilled By (Firm name and name of crew chief) On-Site Environmental Tony Kapugi				Drilling Started 06/30/2000		Drilling Completed 06/30/2000	
DNR Facility Well No.		WI Unique Well No.		Common Well Name		Static Water Level Feet	
						Surface Elevation Feet	
						Borehole Diam. 2 Inches	
Boring Location State Plane SW 1/4 of SE 1/4 of Section 35, T. 12 N., R. 6 E.				Lat. Long.		Local Grid Location (If applicable) Feet N., Feet E.	
County Sauk				DNR County Code 57		Civil Town/City/or Village Baraboo	

Sample Number	Length Recovered	Blow Counts	Depth in Feet	Soil/Rock Description And Geologic Origin For Each Major Unit	USCS	Graphic Log	Well Diagram	Max. PID/FID	Soil Properties			RQD/ Comments
									Standard Penetration	Moisture Content	P200	
S1	10			3" ASPHALT PAVEMENT over 4" CONCRETE. SANDY GRAVEL, brown (fill).	GP			1.6		M		no odor
S2	14			SILTY CLAY, brown, (fill).	GP			1.6		M		no odor
S3	18		5	SILTY CLAY, brown, (fill).	CL-ML			1.6		M		no odor
S4	18			SILTY CLAY, brown; mottled (fill).	CL-ML			1.9		M		no odor
S5	22			SILTY CLAY, brown (fill).	CL-ML			1.1		M		no odor
S6	22		10	SILTY CLAY, brown (fill).	CL-ML			1.6		M		no odor
S7	20			SANDY GRAVEL, gray (fill).	GP			0.2		W/M		no odor
S8	20		15	SANDY GRAVEL, gray (fill). SILTY CLAY, dark gray, with fine sand.	GP			63.2		M		petroleum odor
S9	22			SILTY CLAY, black (old topsoil).	CL-ML			11.1		M		no odor
S10	22			SILTY CLAY, green, with sand.	CL-ML			27.9		M		slight petroleum odor
			20	End of boring @ 20'; abandoned with bentonite.								
			25									

I hereby certify that the information on this form is true and correct to the best of my knowledge.

Signature 	Firm BT ² , Inc. Nichole North Hester
---------------	---

This form is authorized by Chapters 144, 147 and 162, Wis. Stats. Completion of this form is mandatory. Penalties: Forfeit not less than \$10 nor more than \$5,000 for each violation. Fined not less than \$10 or more than \$100 or imprisoned not less than 30 days, or both for each violation. Each day of continued violation is a separate offense, pursuant to ss 144.99 and 162.06 Wis. Stats.

Route To:

- Solid Waste
 Emergency Response
 Wastewater

- Haz. Waste
 Underground Tanks
 Water Resources
 Other _____

Facility/Project Name DOT S.H. 123-NAPA		BT# 1771	License/Permit/Monitoring Number	Boring Number GP3
Boring Drilled By (Firm name and name of crew chief) On-Site Environmental Tony Kapugi		Drilling Started 06/30/2000	Drilling Completed 06/30/2000	Drilling Method Geoprobe
DNR Facility Well No.	WI Unique Well No.	Common Well Name	Static Water Level Feet	Surface Elevation Feet
Boring Location State Plane SW 1/4 of SE 1/4 of Section 35, T. 12 N., R. 6 E.		Lat. N, E	Local Grid Location (If applicable) Feet N., Feet E.	
County Sauk	DNR County Code 57	Civil Town/City/or Village Baraboo		

Sample Number	Length Recovered	Blow Counts	Depth in Feet	Soil/Rock Description And Geologic Origin For Each Major Unit	USCS	Graphic Log	Well Diagram	Max. PID/FID	Soil Properties			RQD/ Comments
									Standard Penetration	Moisture Content	P200	
S1	16			3" ASPHALT PAVEMENT over 4" CONCRETE. SAND, light brown (fill).	GP			1.9	M		no odor	
S2	16			SAND, black, with gravel (fill).	SP			11.7	M		no odor	
S3	12		5		SP			6.4	M		no odor	
S4	12							8.6	M		no odor	
S5	20			CLAYEY SAND, gray/brown (fill).	SC			2.5	M		no odor	
S6	20		10	SILTY CLAY, brown, mottled, with sand (fill).	CL-ML			57.3	M		no odor	
S7	22				CL-ML			2.2	M		no odor	
S8	22		15	SILTY CLAY, brown and gray, with sand; black stains, rubber, coal chunks (fill).	CL-ML			243	M		petroleum odor	
S9	20			SILTY SAND, dark gray.	SM			241	M/W		petroleum odor	
S10	20		20	SILTY CLAY, gray.	CL-ML			272	M		petroleum odor	
			20	End of boring @ 20'; abandoned with bentonite.								
			25									

I hereby certify that the information on this form is true and correct to the best of my knowledge.

Signature <i>Nichole North Hester</i>	Firm BT ² , Inc. Nichole North Hester
--	---

This form is authorized by Chapters 144, 147 and 162, Wis. Stats. Completion of this form is mandatory. Penalties: Forfeit not less than \$10 nor more than \$5,000 for each violation. Fined not less than \$100 or more than \$1000 or imprisoned not less than 30 days, or both for each violation. Each day of continued violation is a separate offense, pursuant to ss 144.99 and 162.06 Wis. Stats.

Route To:

- Solid Waste
- Emergency Response
- Wastewater

- Haz. Waste
- Underground Tanks
- Water Resources
- Other _____

Facility Project Name DOT S.H. 123-NAPA		BT ² # 1771	License Permit Monitoring Number	Boring Number GP4
Boring Drilled By (Firm name and name of crew chief) On-Site Environmental Tony Kapugi		Drilling Started 06/30/2000	Drilling Completed 06/30/2000	Drilling Method Geoprobe
DNR Facility Well No.	WI Unique Well No.	Common Well Name	Static Water Level Feet	Surface Elevation Feet
Boring Location State Plane		Lat.	Local Grid Location (If applicable)	
SW 1/4 of SE 1/4 of Section 35, T. 12 N., R. 6 E.		Long.	Feet	Feet

County Sauk	DNR County Code 57	Civil Town/City/or Village Baraboo
----------------	-----------------------	---------------------------------------

Sample Number	Length Recovered	Blow Counts	Depth in Feet	Soil Rock Description And Geologic Origin For Each Major Unit	USCS	Graphic Log	Well Diagram	Max. PID/FID	Soil Properties			RQD/ Comments
									Standard Penetration	Moisture Content	P200	
S1	10			3" ASPHALT PAVEMENT. SANDY GRAVEL, brown (fill).	SM			6.7	M		no odor	
S2	10			SAND, brown, fine to medium (fill).	SP			5.5	M		no odor	
S3	18		5	SILTY CLAY, brown (fill).	CL-ML			5.3	M		no odor	
S4	18			SILTY CLAY, gray, mottled, with fine sand (fill).	CL-ML			5.0	M		no odor	
S5	16			GRAVELLY SAND, brown (fill).	SP			3.0	M		no odor	
S6	16		10	SILTY CLAY, black (fill).	CL-ML			3.9	M		no odor	
S7	12			SAND, black, glass, brick, organics (fill).	SP			3.9	M		no odor	
S8	10			CLAYEY SAND, dark gray (fill).	SC			3.9	M		no odor	
S9	0		15	SANDY SILT, dark gray (fill).	ML			7	M		no odor	
S10	0		20	End of boring @ 20'; abandoned with bentonite.				-	-		-	

I hereby certify that the information on this form is true and correct to the best of my knowledge.

Signature Nichole North Hester Firm BT², Inc. Nichole North Hester

This form is authorized by Chapters 144, 147 and 162, Wis. Stats. Completion of this form is mandatory. Penalties: Forfeit not less than \$10 nor more than \$5,000 for each violation. Fined not less than \$10 or more than \$100 or imprisoned not less than 30 days, or both for each violation. Each day of continued violation is a separate offense, pursuant to ss 144.99 and 162.06 Wis. Stats.

All abandonment work shall be performed in accordance with the provisions of Chapters NR 111, NR 112, or NR 141, Wis. Admin. Code, whichever is applicable. Also, see instructions included with this form.

(1) GENERAL INFORMATION		(2) FACILITY NAME	
Well/Drillhole/Borehole Location	County Sauk	Original Well Owner (If Known) WI DOT	
SW 1/4 of SE 1/4 of Sec. 35 ; T. 12 N; R. 6 <input checked="" type="checkbox"/> E. <input type="checkbox"/> W.		Present Well Owner WI DOT	
(If applicable) Gov't Lot _____ Grid Number _____		Street or Route 4802 Sheboygan Ave. Rm 451	
Grid Location _____ ft. _____ N. _____ S. _____ ft. _____ E. _____ W.		City, State, Zip Code Madison, WI 53707	
Civil Town Name Baraboo		Facility Well No. and/or Name (If Applicable) GP1	WI Unique Well No. _____
Street Address of Well 104 Broadway		Reason For Abandonment Geoprobe Boring	
City, Village Baraboo, WI		Date of Abandonment 06/30/2000	

WELL/DRILLHOLE/BOREHOLE INFORMATION

<p>(3) Original Well/Drill/Borehole Construction Completed On (Date) 06/30/2000</p> <p>Monitoring Well <input type="checkbox"/> Construction Report Available? <input checked="" type="checkbox"/> Yes <input type="checkbox"/> No</p> <p>Water Well <input type="checkbox"/></p> <p>Drillhole <input type="checkbox"/></p> <p><input checked="" type="checkbox"/> Borehole</p> <p>Construction Type: <input type="checkbox"/> Drilled <input type="checkbox"/> Driven (Sandpoint) <input type="checkbox"/> Dug <input checked="" type="checkbox"/> Other (Specify) Geoprobe</p> <p>Formation Type: <input checked="" type="checkbox"/> Unconsolidated Formation <input type="checkbox"/> Bedrock</p> <p>Total Well Depth (ft.) 20 Casing Diameter (ins.) 2 (From ground surface) Casing Depth (ft.) 20</p> <p>Lower Drillhole Diameter (in.) NA</p> <p>Was Well Annular Space Grouted? <input type="checkbox"/> Yes <input checked="" type="checkbox"/> No <input type="checkbox"/> Unknown If Yes, To What Depth? _____ Feet</p>	<p>(4) Depth to Water (Feet) >20</p> <p>Pump & Piping Removed? <input type="checkbox"/> Yes <input type="checkbox"/> No <input checked="" type="checkbox"/> Not Applicable Liner(s) Removed? <input type="checkbox"/> Yes <input type="checkbox"/> No <input checked="" type="checkbox"/> Not Applicable Screen Removed? <input type="checkbox"/> Yes <input type="checkbox"/> No <input checked="" type="checkbox"/> Not Applicable Casing Left in Place? <input type="checkbox"/> Yes <input type="checkbox"/> No <input checked="" type="checkbox"/> Not Applicable If No, Explain _____</p> <p>Was Casing Cut Off Below Surface? <input type="checkbox"/> Yes <input checked="" type="checkbox"/> No Did Sealing Material Rise to Surface? <input checked="" type="checkbox"/> Yes <input type="checkbox"/> No Did Material Settle After 24 Hours? <input type="checkbox"/> Yes <input checked="" type="checkbox"/> No If Yes, Was Hole Retopped? <input type="checkbox"/> Yes <input type="checkbox"/> No</p> <p>(5) Required Method of Placing Sealing Material <input type="checkbox"/> Conductor Pipe-Gravity <input type="checkbox"/> Conductor Pipe-Pumped <input type="checkbox"/> Dump Bailer <input checked="" type="checkbox"/> Other(Explain) Gravity</p> <p>(6) Sealing Materials For monitoring wells and monitoring well boreholes only</p> <p><input type="checkbox"/> Neat Cement Grout <input type="checkbox"/> Bentonite Pellets <input type="checkbox"/> Sand-Cement (Concrete) Grout <input checked="" type="checkbox"/> Granular Bentonite <input type="checkbox"/> Concrete <input type="checkbox"/> Bentonite -Cement Grout <input type="checkbox"/> Clay-Sand Slurry <input type="checkbox"/> Bentonite-Sand Slurry <input type="checkbox"/> Chipped Bentonite</p>
---	---

(7) Sealing Material Used	From (Ft.)	To (Ft.)	No. Yards, Sacks Sealant or Volume	Mix Ratio or Mud Weight
Concrete	Surface	.5		
Granular Bentonite	.5	20	0.28 ft3	dry mix

(8) Comments: _____

(9) Name of Person or Firm Doing Sealing
Nichole North Hester, BT2, Inc.

Signature of Person Doing Work <i>Nichole North Hester</i>	Date Signed 7.7.00
Street or Route 2830 Dairy Drive	Telephone Number (608) 224-2830
City, State, Zip Code Madison, WI 53718-6751	

(10) FOR DNR OR COUNTY USE ONLY	
Date Received/Inspected	District/County
Reviewer/Inspector	<input type="checkbox"/> Complying Work <input type="checkbox"/> Non-complying Work
Follow-up Necessary	

All abandonment work shall be performed in accordance with the provisions of Chapters NR 111, NR 112, or NR 141, Wis. Admin. Code, whichever is applicable. Also, see instructions included with this form.

(1) GENERAL INFORMATION		(2) FACILITY NAME	
Well/Drillhole/Borehole Location	County <u>Sauk</u>	Original Well Owner (If Known) <u>WI DOT</u>	
(If applicable) <u>SW 1/4 of SE 1/4 of Sec. 35 ; T. 12 N; R 6</u> <input checked="" type="checkbox"/> E. <input type="checkbox"/> W. Gov't Lot _____ Grid Number _____		Present Well Owner <u>WI DOT</u>	
Grid Location _____ ft. <input type="checkbox"/> N. <input type="checkbox"/> S. _____ ft. <input type="checkbox"/> E. <input type="checkbox"/> W.		Street or Route <u>4802 Sheboygan Ave. Rm 451</u>	
Civil Town Name <u>Baraboo</u>		City, State, Zip Code <u>Madison, WI 53707</u>	
Street Address of Well <u>104 Broadway</u>		Facility Well No. and/or Name (If Applicable) <u>GP2</u>	WI Unique Well No. _____
City, Village <u>Baraboo, WI</u>		Reason For Abandonment <u>Geoprobe Boring</u>	
		Date of Abandonment <u>06/30/2000</u>	

WELL/DRILLHOLE/BOREHOLE INFORMATION

3) Original Well/Drill/Borehole Construction Completed On
(Date) 06/30/2000

Monitoring Well
 Water Well
 Drillhole
 Borehole

Construction Report Available?
 Yes No

Construction Type:
 Drilled Driven (Sandpoint) Dug
 Other (Specify) Geoprobe

Formation Type:
 Unconsolidated Formation Bedrock

Total Well Depth (ft.) 20 Casing Diameter (ins.) 2
 (From ground surface) Casing Depth (ft.) 20

Lower Drillhole Diameter (in.) NA

Was Well Annular Space Grouted? Yes No Unknown
 If Yes, To What Depth? _____ Feet

(4) Depth to Water (Feet) >20

Pump & Piping Removed? Yes No Not Applicable
 Liner(s) Removed? Yes No Not Applicable
 Screen Removed? Yes No Not Applicable
 Casing Left in Place? Yes No Not Applicable
 If No, Explain _____

Was Casing Cut Off Below Surface? Yes No
 Did Sealing Material Rise to Surface? Yes No
 Did Material Settle After 24 Hours? Yes No
 If Yes, Was Hole Retopped? Yes No

(5) Required Method of Placing Sealing Material

Conductor Pipe-Gravity Conductor Pipe-Pumped
 Dump Bailer Other(Explain) Gravity

(6) Sealing Materials

Neat Cement Grout
 Sand-Cement (Concrete) Grout
 Concrete
 Clay-Sand Slurry
 Bentonite-Sand Slurry
 Chipped Bentonite

For monitoring wells and monitoring well boreholes only

Bentonite Pellets
 Granular Bentonite
 Bentonite -Cement Grout

(7) Sealing Material Used	From (Ft.)	To (Ft.)	No. Yards, Sacks Sealant or Volume	Mix Ratio or Mud Weight
Concrete Patch	Surface	0.5		
Granular Bentonite	0.5	20	0.28 ft3	dry mix

8) Comments: _____

(9) Name of Person or Firm Doing Sealing
Nichole North Hester, BT2, Inc.

Signature of Person Doing Work <u>Nichole North Hester</u>	Date Signed <u>7/7/00</u>
Street or Route <u>2830 Dairy Drive</u>	Telephone Number <u>(608) 224-2830</u>
City, State, Zip Code <u>Madison, WI 53718-6751</u>	

(10) FOR DNR OR COUNTY USE ONLY

Date Received/Inspected	District/County
Reviewer/Inspector	<input type="checkbox"/> Complying Work <input type="checkbox"/> Non-complying Work
Follow-up Necessary	

All abandonment work shall be performed in accordance with the provisions of Chapters NR 111, NR 112, or NR 141, Wis. Admin. Code, whichever is applicable. Also, see instructions included with this form.

(1) GENERAL INFORMATION		(2) FACILITY NAME	
Well/Drillhole/Borehole Location	County Sauk	Original Well Owner (If Known) WI DOT	
SW 1/4 of SE 1/4 of Sec. 35 ; T. 12 N; R. 6 <input checked="" type="checkbox"/> E. <input type="checkbox"/> W.		Present Well Owner WI DOT	
(If applicable) Gov't Lot _____ Grid Number _____		Street or Route 4802 Sheboygan Ave. Rm 451	
Grid Location _____ ft. <input type="checkbox"/> N. <input type="checkbox"/> S. _____ ft. <input type="checkbox"/> E. <input type="checkbox"/> W.		City, State, Zip Code Madison, WI 53707	
Civil Town Name Baraboo		Facility Well No. and/or Name (If Applicable) GP3	WI Unique Well No. _____
Street Address of Well 104 Broadway		Reason For Abandonment Geoprobe Boring	
City, Village Baraboo, WI		Date of Abandonment 06/30/2000	

WELL/DRILLHOLE/BOREHOLE INFORMATION

(3) Original Well/Drill/Borehole Construction Completed On
(Date) 06/30/2000

<input type="checkbox"/> Monitoring Well <input type="checkbox"/> Water Well <input type="checkbox"/> Drillhole <input checked="" type="checkbox"/> Borehole	Construction Report Available? <input checked="" type="checkbox"/> Yes <input type="checkbox"/> No
---	---

Construction Type:
 Drilled Driven (Sandpoint) Dug
 Other (Specify) Geoprobe

Formation Type:
 Unconsolidated Formation Bedrock

Total Well Depth (ft.) 20 Casing Diameter (ins.) 2
 (From ground surface) Casing Depth (ft.) 20

Lower Drillhole Diameter (in.) NA

Was Well Annular Space Grouted? Yes No Unknown
 If Yes, To What Depth? _____ Feet

(4) Depth to Water (Feet) >20

Pump & Piping Removed?	<input type="checkbox"/> Yes <input type="checkbox"/> No <input checked="" type="checkbox"/> Not Applicable
Liner(s) Removed?	<input type="checkbox"/> Yes <input type="checkbox"/> No <input checked="" type="checkbox"/> Not Applicable
Screen Removed?	<input type="checkbox"/> Yes <input type="checkbox"/> No <input checked="" type="checkbox"/> Not Applicable
Casing Left in Place?	<input type="checkbox"/> Yes <input type="checkbox"/> No <input checked="" type="checkbox"/> Not Applicable

If No, Explain _____

Was Casing Cut Off Below Surface? Yes No
 Did Sealing Material Rise to Surface? Yes No
 Did Material Settle After 24 Hours? Yes No
 If Yes, Was Hole Retopped? Yes No

(5) Required Method of Placing Sealing Material

<input type="checkbox"/> Conductor Pipe-Gravity	<input type="checkbox"/> Conductor Pipe-Pumped
<input type="checkbox"/> Dump Bailer	<input checked="" type="checkbox"/> Other(Explain) Gravity

(6) Sealing Materials

<input type="checkbox"/> Neat Cement Grout <input type="checkbox"/> Sand-Cement (Concrete) Grout <input type="checkbox"/> Concrete <input type="checkbox"/> Clay-Sand Slurry <input type="checkbox"/> Bentonite-Sand Slurry <input type="checkbox"/> Chipped Bentonite	For monitoring wells and monitoring well boreholes only <input type="checkbox"/> Bentonite Pellets <input checked="" type="checkbox"/> Granular Bentonite <input type="checkbox"/> Bentonite -Cement Grout
---	---

(7) Sealing Material Used	From (Ft.)	To (Ft.)	No. Yards, Sacks Sealant or Volume	Mix Ratio or Mud Weight
Concrete Patch	Surface	0.5		
Granular Bentonite	0.5	20	0.28 ft3	dry mix

(8) Comments: _____

(9) Name of Person or Firm Doing Sealing
Nichole North Hester, BT2, Inc.

Signature of Person Doing Work <i>Nichole North Hester</i>	Date Signed 7-7-00
Street or Route 2830 Dairy Drive	Telephone Number (608) 224-2830
City, State, Zip Code Madison, WI 53718-6751	

(10) FOR DNR OR COUNTY USE ONLY

Date Received/Inspected	District/County
Reviewer/Inspector	<input type="checkbox"/> Complying Work <input type="checkbox"/> Non-complying Work
Follow-up Necessary	

All abandonment work shall be performed in accordance with the provisions of Chapters NR 111, NR 112, or NR 141, Wis. Admin. Code, whichever is applicable. Also, see instructions included with this form.

(1) GENERAL INFORMATION		(2) FACILITY NAME	
Well/Drillhole/Borehole Location	County Sauk	Original Well Owner (If Known) WI DOT	
SW 1/4 of SE 1/4 of Sec. 35 ; T. 12 N; R. 6 <input checked="" type="checkbox"/> E. <input type="checkbox"/> W.		Present Well Owner WI DOT	
(If applicable) Gov't Lot	Grid Number	Street or Route 4802 Sheboygan Ave. Rm 451	
Grid Location ft. <input type="checkbox"/> N. <input type="checkbox"/> S. ft. <input type="checkbox"/> E. <input type="checkbox"/> W.		City, State, Zip Code Madison, WI 53707	
Civil Town Name Baraboo		Facility Well No. and/or Name (If Applicable) GP4	WI Unique Well No. _____
Street Address of Well 104 Broadway		Reason For Abandonment Geoprobe Boring	
City, Village Baraboo, WI		Date of Abandonment 06/30/2000	

WELL/DRILLHOLE/BOREHOLE INFORMATION

(3) Original Well/Drill/Borehole Construction Completed On (Date) 06/30/2000		(4) Depth to Water (Feet) >20	
<input type="checkbox"/> Monitoring Well <input type="checkbox"/> Water Well <input type="checkbox"/> Drillhole <input checked="" type="checkbox"/> Borehole	Construction Report Available? <input checked="" type="checkbox"/> Yes <input type="checkbox"/> No	Pump & Piping Removed? <input type="checkbox"/> Yes <input type="checkbox"/> No <input checked="" type="checkbox"/> Not Applicable Liner(s) Removed? <input type="checkbox"/> Yes <input type="checkbox"/> No <input checked="" type="checkbox"/> Not Applicable Screen Removed? <input type="checkbox"/> Yes <input type="checkbox"/> No <input checked="" type="checkbox"/> Not Applicable Casing Left in Place? <input type="checkbox"/> Yes <input type="checkbox"/> No <input checked="" type="checkbox"/> Not Applicable If No, Explain _____	
Construction Type: <input type="checkbox"/> Drilled <input type="checkbox"/> Driven (Sandpoint) <input type="checkbox"/> Dug <input checked="" type="checkbox"/> Other (Specify) Geoprobe		Was Casing Cut Off Below Surface? <input type="checkbox"/> Yes <input checked="" type="checkbox"/> No Did Sealing Material Rise to Surface? <input checked="" type="checkbox"/> Yes <input type="checkbox"/> No Did Material Settle After 24 Hours? <input type="checkbox"/> Yes <input checked="" type="checkbox"/> No If Yes, Was Hole Retopped? <input type="checkbox"/> Yes <input type="checkbox"/> No	
Formation Type: <input checked="" type="checkbox"/> Unconsolidated Formation <input type="checkbox"/> Bedrock		(5) Required Method of Placing Sealing Material	
Total Well Depth (ft.) 20 Casing Diameter (ins.) 2 (From ground surface) Casing Depth (ft.) 20 Lower Drillhole Diameter (in.) NA Was Well Annular Space Grouted? <input type="checkbox"/> Yes <input checked="" type="checkbox"/> No <input type="checkbox"/> Unknown If Yes, To What Depth? _____ Feet		<input type="checkbox"/> Conductor Pipe-Gravity <input type="checkbox"/> Conductor Pipe-Pumped <input type="checkbox"/> Dump Bailer <input checked="" type="checkbox"/> Other(Explain) Gravity	
		(6) Sealing Materials	For monitoring wells and monitoring well boreholes only
		<input type="checkbox"/> Neat Cement Grout <input type="checkbox"/> Sand-Cement (Concrete) Grout <input type="checkbox"/> Concrete <input type="checkbox"/> Clay-Sand Slurry <input type="checkbox"/> Bentonite-Sand Slurry <input type="checkbox"/> Chipped Bentonite	<input type="checkbox"/> Bentonite Pellets <input checked="" type="checkbox"/> Granular Bentonite <input type="checkbox"/> Bentonite -Cement Grout

(7) Sealing Material Used	From (Ft.)	To (Ft.)	No. Yards, Sacks Sealant or Volume	Mix Ratio or Mud Weight
Concrete Patch	Surface	0.5		
Granular Bentonite	0.5	20	0.28 ft3	dry mix

(8) Comments:

(9) Name of Person or Firm Doing Sealing
Nichole North Hester, BT2, Inc.

Signature of Person Doing Work <i>Nichole North Hester</i>	Date Signed 7-7-00
Street or Route 2830 Dairy Drive	Telephone Number (608) 224-2830
City, State, Zip Code Madison, WI 53718-6751	

(10) FOR DNR OR COUNTY USE ONLY	
Date Received/Inspected	District/County
Reviewer/Inspector	<input type="checkbox"/> Complying Work <input type="checkbox"/> Non-complying Work
Follow-up Necessary	

ATTACHMENT C

Laboratory Analytical Reports and Chain of Custody Forms

202 Commerce Drive / Watertown, WI 53094
Phone: (920) 261-1660 / Fax: (920) 261-8120

COMPANY BT², Inc
ADDRESS 2830 Dairy Dr, Madison, WI 53718
PHONE 608 221-2830 FAX 608 224-2839
PROJECT DESCRIPTION/NO. DOT SH123 Dicks Carcass #1770
PROJECT MANAGER MARK TUSLEK

REPORT TO: Tim Ryan
INVOICE TO: _____
P.O. NO.: _____
QUOTE NO.: _____

SAMPLED BY: Nichole North Hester
NAME
Tony Kollasch
NAME

DATE	TIME	SAMPLE ID/DESCRIPTION	FILTERED	MATRIX	GRAB	COMP	# and Type of Containers											ANALYSES					
							HCl	NaOH	HNO ₃	H ₂ SO ₄	NONE	METHANOL	OTHER	GRO/AOC	DRO	% Solids							
6-30	0830	GP1, S5 9'	N	SOL	X										1	2	X	X	X				
	0855	GP1, S9 18'		SOL	X										1	2	X	X	X				
	0915	GP2, S5 9'		SOL	X										1	2	X	X	X				
	0925	GP2, S6 12'		SOL	X										1	2	X	X	X				
	1000	GP3, S7 9' (13' jar)		SOL	X										1	2	X	X	X				
	1010	GP3, S10 20'		SOL	X										1	2	X	X	X				
	1030	GP4, S4 7'		SOL	X										1	2	X	X	X				
Y	1040	GP4, S6 11'	Y	SOL	X										1	2	X	X	X				
Y	1050	MEDIA BLANK	Y	MEDIA											1		X						

Fax Results _____
Which regulations apply?
HPCES/Wastewater _____ PCPA _____
Drinking Water _____ Other _____
COMMENT:
FID=360
NOTEBOOK COPY
JUL 14 2000

CONDITION OF SAMPLE: _____ BOTTLES INTACT? YES / NO _____ VOLATILES FREE OF HEADSPACE? YES / NO _____ BOTTLES SUPPLIED BY LAB? YES / NO _____ TEMPERATURE UPON RECEIPT: on ice

RETRIEVED BY: K. Lone DATE: 7/3 TIME: 8:40 RECEIVED BY: Neil Hirsch REINQUIRED BY: Neil Hirsch DATE: 9:30 RECEIVED FOR LAB BY: Cynth Stute 7-3-00 1:25 pm

METHOD OF SHIPMENT:
TestAmerica Courier _____
Client _____
Common Carrier _____

REMARKS:
shabby looking 71510

ANALYTICAL AND QUALITY CONTROL REPORT

Mr. Tim Ryan
BT2, INC.
2830 Dairy Drive
Madison, WI 53704-6751

07/10/2000

Job No: 00.05676

Page 1 of 10

Enclosed are the Analytical and Quality Control reports for the following samples submitted for analysis:

Sample Number	Sample Description	Date Taken	Date Received
402044	GP1,S5 9' 1770 WDOT Dick's Car	06/30/2000	07/03/2000
402045	GP1,S9 18' 1770 WDOT Dick's Car	06/30/2000	07/03/2000
402046	GP2,S5 9' 1770 WDOT Dick's Car	06/30/2000	07/03/2000
402047	GP2,S6 12' 1770 WDOT Dick's Car	06/30/2000	07/03/2000
402048	GP3,S7 9' 1770 WDOT Dick's Car	06/30/2000	07/03/2000
402049	GP3,S10 20' 1770 WDOT Dick's Ca	06/30/2000	07/03/2000
402050	GP4,S4 7' 1770 WDOT Dick's Car	06/30/2000	07/03/2000
402051	GP4,S6 11' 1770 WDOT Dick's Car	06/30/2000	07/03/2000
402052	MeOH Blank 1770 WDOT Dick's Car	06/30/2000	07/03/2000

Soil results are reported on a dry weight basis. The above sample(s) may have a result flag shown on the report. The following are the result flag definitions:

A = Analyzed/extracted past hold time	B = Blank is contaminated
C = Standard outside of control limits	D = Diluted for analysis
F = Sample filtered in lab	G = Received past hold time
H = Late eluting hydrocarbons present	I = Improperly handled sample
J = Estimated concentration	L = Common lab solvent and contaminant
M = Matrix interference	P = Improperly preserved sample
Q = Result confirmed via re-analysis	S = Sediment present
T = Does not match typical pattern	W = BOD re-set due to missed dilution
X = Unidentified compound(s) present	Z = Internal standard outside limits

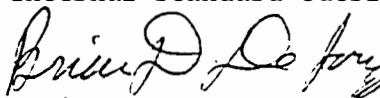

Brian D. DeJong
Organic Operations Manager

ANALYTICAL REPORT

Mr. Tim Ryan
 BT2, INC.
 2830 Dairy Drive
 Madison, WI 53704-6751

07/10/2000
 Job No: 00.05676
 Sample No: 402044
 Account No: 10100
 Page 2 of 10

JOB DESCRIPTION: 1770 WDOT Dick's Car Care
 PROJECT DESCRIPTION: Soil Analysis
 SAMPLE DESCRIPTION: GP1,S5 9' 1770 WDOT Dick's Car Care
 Rec'd on Ice

Date/Time Taken: 06/30/2000 08:30

Date Received: 07/03/2000

Parameter	Results	Units	Reporting Limit	Method	Date Analyzed	Prep/Run Batch
Solids, Total	94.7	%	n/a	SW 5030	07/07/2000	3278
TO Extraction	G 07/03/2000			WDNR	07/03/2000	1476
TOC - NONAQUEOUS						
Benzene	<30	ug/kg	25	SW 8020	07/07/2000	2650
Ethylbenzene	<30	ug/kg	25	SW 8020	07/07/2000	2650
methyl-t-butyl ether	<30	ug/kg	25	SW 8020	07/07/2000	2650
Styrene	<30	ug/kg	25	SW 8020	07/07/2000	2650
1,4-Trimethylbenzene	<30	ug/kg	25	SW 8020	07/07/2000	2650
1,3,5-Trimethylbenzene	<30	ug/kg	25	SW 8020	07/07/2000	2650
Arenes, Total	<87	ug/kg	75	SW 8020	07/07/2000	2650
Surr: Bromofluorobenzene	<5.8	mg/kg	5.0	WDNR	07/07/2000	2650
Surr: - NONAQUEOUS	99.0	%	n/a	SW 8020	07/07/2000	2650
	<5.3	mg/kg	5.0	WDNR	07/07/2000	1476 2499

ANALYTICAL REPORT

Mr. Tim Ryan
 BT2, INC.
 2830 Dairy Drive
 Madison, WI 53704-6751

07/10/2000
 Job No: 00.05676
 Sample No: 402045
 Account No: 10100
 Page 3 of 10

JOB DESCRIPTION: 1770 WDOT Dick's Car Care
 PROJECT DESCRIPTION: Soil Analysis
 SAMPLE DESCRIPTION: GP1,S9 18' 1770 WDOT Dick's Car Care
 Rec'd on Ice

Date/Time Taken: 06/30/2000 08:55

Date Received: 07/03/2000

Parameter	Results	Units	Reporting Limit	Method	Date Analyzed	Prep/Run Batch
Solids, Total	94.5	%	n/a	SW 5030	07/07/2000	3278
Extraction	G 07/03/2000			WDNR	07/03/2000	1476
DC - NONAQUEOUS						
Benzene	<26	ug/kg	25	SW 8020	07/08/2000	2650
Ethylbenzene	<26	ug/kg	25	SW 8020	07/08/2000	2650
Methyl-t-butyl ether	<26	ug/kg	25	SW 8020	07/08/2000	2650
Toluene	<26	ug/kg	25	SW 8020	07/08/2000	2650
1,4-Trimethylbenzene	<26	ug/kg	25	SW 8020	07/08/2000	2650
1,3,5-Trimethylbenzene	<26	ug/kg	25	SW 8020	07/08/2000	2650
Arenes, Total	<79	ug/kg	75	SW 8020	07/08/2000	2650
	<5.3	mg/kg	5.0	WDNR	07/08/2000	2650
Surr: Bromofluorobenzene	98.5	%	n/a	SW 8020	07/08/2000	2650
- NONAQUEOUS	<5.3	mg/kg	5.0	WDNR	07/07/2000	1476 2499

ANALYTICAL REPORT

Mr. Tim Ryan
 BT2, INC.
 2830 Dairy Drive
 Madison, WI 53704-6751

07/10/2000
 Job No: 00.05676
 Sample No: 402046
 Account No: 10100
 Page 4 of 10

JOB DESCRIPTION: 1770 WDOT Dick's Car Care
 PROJECT DESCRIPTION: Soil Analysis
 SAMPLE DESCRIPTION: GP2,S5 9' 1770 WDOT Dick's Car Care
 Rec'd on Ice

Date/Time Taken: 06/30/2000 09:15

Date Received: 07/03/2000

Parameter	Results	Units	Reporting Limit	Method	Date Analyzed	Prep/Run Batch
Solids, Total	94.4	%	n/a	SW 5030	07/07/2000	3278
Extraction	G			WDNR	07/03/2000	1476
OC - NONAQUEOUS						
Benzene	<30	ug/kg	25	SW 8020	07/08/2000	2650
Ethylbenzene	39	ug/kg	25	SW 8020	07/08/2000	2650
Methyl-t-butyl ether	<30	ug/kg	25	SW 8020	07/08/2000	2650
Xylene	117	ug/kg	25	SW 8020	07/08/2000	2650
1,4-Trimethylbenzene	191	ug/kg	25	SW 8020	07/08/2000	2650
1,3,5-Trimethylbenzene	90	ug/kg	25	SW 8020	07/08/2000	2650
Arenes, Total	286	ug/kg	75	SW 8020	07/08/2000	2650
Surr: Bromofluorobenzene	<5.8	mg/kg	5.0	WDNR	07/08/2000	2650
Surr: Bromofluorobenzene	102.0	%	n/a	SW 8020	07/08/2000	2650
OC - NONAQUEOUS	7.7	mg/kg	5.0	WDNR	07/07/2000	1476 2499

ANALYTICAL REPORT

Mr. Tim Ryan
 BT2, INC.
 2830 Dairy Drive
 Madison, WI 53704-6751

07/10/2000
 Job No: 00.05676
 Sample No: 402047
 Account No: 10100
 Page 5 of 10

JOB DESCRIPTION: 1770 WDOT Dick's Car Care
 PROJECT DESCRIPTION: Soil Analysis
 SAMPLE DESCRIPTION: GP2,S6 12' 1770 WDOT Dick's Car Care
 Rec'd on Ice

Date/Time Taken: 06/30/2000 09:25

Date Received: 07/03/2000

Parameter	Results	Units	Reporting Limit	Method	Date Analyzed	Prep/Run Batch
Solids, Total	92.5	%	n/a	SW 5030	07/07/2000	3278
RO Extraction	G 07/03/2000			WDNR	07/03/2000	1476
VOC - NONAQUEOUS						
Benzene	23,800	ug/kg	25	SW 8020	07/08/2000	2650
Ethylbenzene	73,500	ug/kg	25	SW 8020	07/08/2000	2650
Methyl-t-butyl ether	<1,300	ug/kg	25	SW 8020	07/08/2000	2650
Styrene	178,000	ug/kg	25	SW 8020	07/08/2000	2650
1,4-Trimethylbenzene	176,000	ug/kg	25	SW 8020	07/08/2000	2650
1,3,5-Trimethylbenzene	56,200	ug/kg	25	SW 8020	07/08/2000	2650
Aromatics, Total	397,000	ug/kg	75	SW 8020	07/08/2000	2650
RO	H 3,240	mg/kg	5.0	WDNR	07/08/2000	2650
Surr: Bromofluorobenzene	90.0	%	n/a	SW 8020	07/08/2000	2650
RO - NONAQUEOUS	1,510	mg/kg	5.0	WDNR	07/07/2000	1476 2500

ANALYTICAL REPORT

Mr. Tim Ryan
 BT2, INC.
 2830 Dairy Drive
 Madison, WI 53704-6751

07/10/2000
 Job No: 00.05676
 Sample No: 402048
 Account No: 10100
 Page 6 of 10

JOB DESCRIPTION: 1770 WDOT Dick's Car Care
 PROJECT DESCRIPTION: Soil Analysis
 SAMPLE DESCRIPTION: GP3,S7 9' 1770 WDOT Dick's Car Care
 Rec'd on Ice

Date/Time Taken: 06/30/2000 10:00

Date Received: 07/03/2000

Parameter	Results	Units	Reporting Limit	Method	Date Analyzed	Prep/Run Batch
Solids, Total	94.0	%	n/a	SW 5030	07/07/2000	3278
TO Extraction	G 07/03/2000			WDNR	07/03/2000	1476
TOC - NONAQUEOUS						
Benzene	<30	ug/kg	25	SW 8020	07/08/2000	2650
Ethylbenzene	<30	ug/kg	25	SW 8020	07/08/2000	2650
n-ethyl-t-butyl ether	<30	ug/kg	25	SW 8020	07/08/2000	2650
o-xylene	128	ug/kg	25	SW 8020	07/08/2000	2650
m,p-4-Trimethylbenzene	<30	ug/kg	25	SW 8020	07/08/2000	2650
1,3,5-Trimethylbenzene	<30	ug/kg	25	SW 8020	07/08/2000	2650
Arenes, Total	<87	ug/kg	75	SW 8020	07/08/2000	2650
	<5.9	mg/kg	5.0	WDNR	07/08/2000	2650
Surr: Bromofluorobenzene	101.0	%	n/a	SW 8020	07/08/2000	2650
TOC - NONAQUEOUS	<5.3	mg/kg	5.0	WDNR	07/07/2000	1476 2499

ANALYTICAL REPORT

Mr. Tim Ryan
 BT2, INC.
 2830 Dairy Drive
 Madison, WI 53704-6751

07/10/2000
 Job No: 00.05676
 Sample No: 402049
 Account No: 10100
 Page 7 of 10

JOB DESCRIPTION: 1770 WDOT Dick's Car Care
 PROJECT DESCRIPTION: Soil Analysis
 SAMPLE DESCRIPTION: GP3,S10 20' 1770 WDOT Dick's Car Car
 Rec'd on Ice

Date/Time Taken: 06/30/2000 10:10

Date Received: 07/03/2000

Parameter	Results	Units	Reporting Limit	Method	Date Analyzed	Prep/Run Batch
Solids, Total	94.0	%	n/a	SW 5030	07/07/2000	3278
OC Extraction	G 07/03/2000			WDNR	07/03/2000	1476
OC - NONAQUEOUS						
Benzene	<32	ug/kg	25	SW 8020	07/08/2000	2650
Ethylbenzene	<32	ug/kg	25	SW 8020	07/08/2000	2650
1,2-dimethyl-t-butyl ether	<32	ug/kg	25	SW 8020	07/08/2000	2650
1,2,4-trimethylbenzene	<32	ug/kg	25	SW 8020	07/08/2000	2650
1,3,5-Trimethylbenzene	<32	ug/kg	25	SW 8020	07/08/2000	2650
Xylenes, Total	<96	ug/kg	75	SW 8020	07/08/2000	2650
Chloro	<6.4	mg/kg	5.0	WDNR	07/08/2000	2650
Surr: Bromofluorobenzene	100.0	%	n/a	SW 8020	07/08/2000	2650
OC - NONAQUEOUS	<5.3	mg/kg	5.0	WDNR	07/07/2000	1476 2499

ANALYTICAL REPORT

Mr. Tim Ryan
 BT2, INC.
 2830 Dairy Drive
 Madison, WI 53704-6751

07/10/2000
 Job No: 00.05676
 Sample No: 402050
 Account No: 10100
 Page 8 of 10

JOB DESCRIPTION: 1770 WDOT Dick's Car Care
 PROJECT DESCRIPTION: Soil Analysis
 SAMPLE DESCRIPTION: GP4,S4 7' 1770 WDOT Dick's Car Care
 Rec'd on Ice

Date/Time Taken: 06/30/2000 10:30

Date Received: 07/03/2000

Parameter	Results	Units	Reporting Limit	Method	Date Analyzed	Prep/Run Batch
Solids, Total	97.7	%	n/a	SW 5030	07/07/2000	3278
OC Extraction	G 07/03/2000			WDNR	07/03/2000	1476
OC - NONAQUEOUS						
Benzene	<26	ug/kg	25	SW 8020	07/08/2000	2650
Ethylbenzene	<26	ug/kg	25	SW 8020	07/08/2000	2650
n-Propyl-t-butyl ether	<26	ug/kg	25	SW 8020	07/08/2000	2650
Toluene	44	ug/kg	25	SW 8020	07/08/2000	2650
1,4-Dimethylbenzene	<26	ug/kg	25	SW 8020	07/08/2000	2650
1,3,5-Trimethylbenzene	<26	ug/kg	25	SW 8020	07/08/2000	2650
Aromatics, Total	<77	ug/kg	75	SW 8020	07/08/2000	2650
Chlorides	<5.1	mg/kg	5.0	WDNR	07/08/2000	2650
Surr: Bromofluorobenzene	98.5	%	n/a	SW 8020	07/08/2000	2650
OC - NONAQUEOUS	<5.1	mg/kg	5.0	WDNR	07/07/2000	1476 2499

ANALYTICAL REPORT

Mr. Tim Ryan
 BT2, INC.
 2830 Dairy Drive
 Madison, WI 53704-6751

07/10/2000
 Job No: 00.05676
 Sample No: 402051
 Account No: 10100
 Page 9 of 10

JOB DESCRIPTION: 1770 WDOT Dick's Car Care
 PROJECT DESCRIPTION: Soil Analysis
 SAMPLE DESCRIPTION: GP4,S6 11' 1770 WDOT Dick's Car Care
 Rec'd on Ice

Date/Time Taken: 06/30/2000 10:40

Date Received: 07/03/2000

Parameter	Results	Units	Reporting Limit	Method	Date Analyzed	Prep/Run Batch
Solids, Total	93.9	%	n/a	SW 5030	07/07/2000	3278
DDO Extraction	G 07/03/2000			WDNR	07/03/2000	1476
DDC - NONAQUEOUS						
Benzene	<27	ug/kg	25	SW 8020	07/08/2000	2650
Ethylbenzene	<27	ug/kg	25	SW 8020	07/08/2000	2650
n-ethyl-t-butyl ether	<27	ug/kg	25	SW 8020	07/08/2000	2650
Toluene	<27	ug/kg	25	SW 8020	07/08/2000	2650
1,4-Trimethylbenzene	<27	ug/kg	25	SW 8020	07/08/2000	2650
1,3,5-Trimethylbenzene	<27	ug/kg	25	SW 8020	07/08/2000	2650
Xylenes, Total	<80	ug/kg	75	SW 8020	07/08/2000	2650
	<5.3	mg/kg	5.0	WDNR	07/08/2000	2650
Surr: Bromofluorobenzene	100.5	%	n/a	SW 8020	07/08/2000	2650
DDO - NONAQUEOUS	<5.3	mg/kg	5.0	WDNR	07/07/2000	1476 2499

ANALYTICAL REPORT

Mr. Tim Ryan
 BT2, INC.
 2830 Dairy Drive
 Madison, WI 53704-6751

07/10/2000
 Job No: 00.05676
 Sample No: 402052
 Account No: 10100
 Page 10 of 10

JOB DESCRIPTION: 1770 WDOT Dick's Car Care
 PROJECT DESCRIPTION: Soil Analysis
 SAMPLE DESCRIPTION: MeOH Blank 1770 WDOT Dick's Car Care
 Rec'd on Ice

Date/Time Taken: 06/30/2000 10:50

Date Received: 07/03/2000

Parameter	Results	Units	Reporting Limit	Method	Date Analyzed	Prep/Run Batch
PVOC - NONAQUEOUS						
Benzene	<25	ug/kg	25	SW 8020	07/08/2000	2650
Toluene	<25	ug/kg	25	SW 8020	07/08/2000	2650
o-xylbenzene	<25	ug/kg	25	SW 8020	07/08/2000	2650
m-xyl-t-butyl ether	<25	ug/kg	25	SW 8020	07/08/2000	2650
Toluene	<25	ug/kg	25	SW 8020	07/08/2000	2650
1,2,4-Trimethylbenzene	<25	ug/kg	25	SW 8020	07/08/2000	2650
1,3,5-Trimethylbenzene	<25	ug/kg	25	SW 8020	07/08/2000	2650
Arenes, Total	<75	ug/kg	75	SW 8020	07/08/2000	2650
GrO	<5.0	mg/kg	5.0	WDNR	07/08/2000	2650
Er: Bromofluorobenzene	99.5	%	n/a	SW 8020	07/08/2000	2650

602 Commerce Drive / Watertown, WI 53094
 Phone: (920) 261-1660 / Fax: (920) 261-8120

COMPANY BT², Inc
 ADDRESS 2230 Dairy Dr, Madison WI 53718
 PHONE 608 224-2830 FAX 608 224-2837
 PROJECT DESCRIPTION/NO. WDOT SH 123 NAPA #1771
 PROJECT MANAGER Mark Tusler

00-05675
 REPORT TO: Tim Ryan
 INVOICE TO: _____

P.O. NO.: _____
 QUOTE NO.: _____

SHIP TO:
Nichole North Hester
 NAME:
Tony Kollasch
 PHONE:

For Results: _____
 Lab Results:
 Which regulations apply?
 NPDES/Wastewater: _____
 Drinking Water: _____ Other: _____

DATE	TIME	SAMPLE ID/DESCRIPTION	FILTERED	MATRIX	GRAB	COMP	# and Type of Containers							GRO/PVOL	DRO	% SOLIDS	PVOL	ANALYSES													
							HCl	NaOH	HNO ₃	H ₂ SO ₄	NONE	METHANOL	OTHER																		
7-30	1220	MEOH Blank	N	SW	X										X																
	1240	GP1, S8 15'	1	SW	X										1	2	X	X	X												
	1245	GP1, S10 20'	1	SW	X										1	2	X	X	X	#											
	1250	GP1		SW	X																										
	1255	inob blank		SW	X																										
	1350	GP2, S8 14'	N	SW	X										1	2	X	X	X												
	1400	GP2, S10 20'	1	SW	X										1	2	X	X	X												
	1425	GP3, S8 15'	1	SW	X										1	2	X	X	X												
	1440	GP3, S10 20'	1	SW	X										1	2	X	X	X												
	1500	GP4, S8 8'	1	SW	X										1	2	X	X	X												
	155	GP4, S8 15'	1	SW	X										1	2	X	X	X												

NO samples

PID = 248
 PID = 272

NOTEBOOK COPY

JUL 14 2000

LAB USE ONLY

CONDITION OF SAMPLE: _____ BOTTLES INTACT? YES/NO _____ VOLATILES FREE OF HEADSPACE? YES/NO _____ BOTTLES SUPPLIED BY LAB? YES/NO _____ TEMPERATURE UPON RECEIPT: 60.00 °C

RELINQUISHED BY: [Signature] DATE: 7/3 TIME: 8:40 RECEIVED BY: [Signature] RELINQUISHED BY: [Signature] DATE: _____ TIME: _____ RECEIVED FOR LAB BY: [Signature] 7-3-00 13:10P

METHOD OF SHIPMENT: _____
 TestAmerica Courier _____
 Client _____
 Critical Courier _____

REMARKS: _____
Shelby Womis 7/5/00

ANALYTICAL AND QUALITY CONTROL REPORT

Mr. Tim Ryan
BT2, INC.
2830 Dairy Drive
Madison, WI 53704-6751

07/11/2000
Job No: 00.05675
Page 1 of 10

Enclosed are the Analytical and Quality Control reports for the following samples submitted for analysis:

Sample Number	Sample Description	Date Taken	Date Received
402035	MeOH Blank 1771 WDOT NAPA	06/30/2000	07/03/2000
402036	GP1,S8 15' 1771 WDOT NAPA	06/30/2000	07/03/2000
402037	GP1,S10 20' 1771 WDOT NAPA	06/30/2000	07/03/2000
402038	GP2,S8 14' 1771 WDOT NAPA	06/30/2000	07/03/2000
402039	GP2,S10 20' 1771 WDOT NAPA	06/30/2000	07/03/2000
402040	GP3,S8 15' 1771 WDOT NAPA	06/30/2000	07/03/2000
402041	GP3,S10 20' 1771 WDOT NAPA	06/30/2000	07/03/2000
402042	GP4,S4 8' 1771 WDOT NAPA	06/30/2000	07/03/2000
402043	GP4,S8 16' 1771 WDOT NAPA	06/30/2000	07/03/2000

CASE NARRATIVE

The DRO results for this project are flagged as having been extracted past hold. These samples were extracted more than 3 days after sample collection. WDNR has extended the hold time for extraction to 10 days, but this has not yet been Codified.

Soil results are reported on a dry weight basis. The above sample(s) may have a result flag shown on the report. The following are the result flag definitions:

A = Analyzed/extracted past hold time	B = Blank is contaminated
C = Standard outside of control limits	D = Diluted for analysis
F = Sample filtered in lab	G = Received past hold time
H = Late eluting hydrocarbons present	I = Improperly handled sample
J = Estimated concentration	L = Common lab solvent and contaminant
M = Matrix interference	P = Improperly preserved sample
Q = Result confirmed via re-analysis	S = Sediment present
T = Does not match typical pattern	W = BOD re-set due to missed dilution
X = Unidentified compound(s) present	Z = Internal standard outside limits

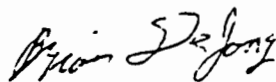

Brian D. DeJong
Organic Operations Manager

ANALYTICAL REPORT

Mr. Tim Ryan
 BT2, INC.
 2830 Dairy Drive
 Madison, WI 53704-6751

07/11/2000
 Job No: 00.05675
 Sample No: 402035
 Account No: 10100
 Page 2 of 10

JOB DESCRIPTION: 1771 WDOT NAPA
 PROJECT DESCRIPTION: Soil Analysis
 SAMPLE DESCRIPTION: MeOH Blank 1771 WDOT NAPA
 Rec'd on Ice

Date/Time Taken: 06/30/2000 12:20

Date Received: 07/03/2000

Parameter	Results	Units	Reporting Limit	Method	Date Analyzed	Prep/Run Batch
PVOC - NONAQUEOUS						
Benzene	<25	ug/kg	25	SW 8020	07/07/2000	2650
Ethylbenzene	<25	ug/kg	25	SW 8020	07/07/2000	2650
Methyl-t-butyl ether	<25	ug/kg	25	SW 8020	07/07/2000	2650
Toluene	<25	ug/kg	25	SW 8020	07/07/2000	2650
1,2,4-Trimethylbenzene	<25	ug/kg	25	SW 8020	07/10/2000	2651
1,3,5-Trimethylbenzene	<25	ug/kg	25	SW 8020	07/07/2000	2650
Xylenes, Total	<75	ug/kg	75	SW 8020	07/07/2000	2650
Chloroform	<5.0	mg/kg	5.0	WDNR	07/07/2000	2650
Surf: Bromofluorobenzene	102.5	%	n/a	SW 8020	07/07/2000	2650

ANALYTICAL REPORT

Mr. Tim Ryan
 BT2, INC.
 2830 Dairy Drive
 Madison, WI 53704-6751

07/11/2000
 Job No: 00.05675
 Sample No: 402036
 Account No: 10100
 Page 3 of 10

JOB DESCRIPTION: 1771 WDOT NAPA
 PROJECT DESCRIPTION: Soil Analysis
 SAMPLE DESCRIPTION: GP1,S8 15' 1771 WDOT NAPA
 Rec'd on Ice

Date/Time Taken: 06/30/2000 12:40

Date Received: 07/03/2000

Parameter	Results	Units	Reporting Limit	Method	Date Analyzed	Prep/Run Batch
Solids, Total	72.3	%	n/a	SW 5030	07/07/2000	3278
Extraction	G 07/03/2000			WDNR	07/03/2000	1476
C - NONAQUEOUS						
Benzene	332	ug/kg	25	SW 8020	07/07/2000	2650
Ethylbenzene	86	ug/kg	25	SW 8020	07/07/2000	2650
Methyl-t-butyl ether	<39	ug/kg	25	SW 8020	07/07/2000	2650
Toluene	130	ug/kg	25	SW 8020	07/07/2000	2650
1,4-Trimethylbenzene	53	ug/kg	25	SW 8020	07/07/2000	2650
1,5-Trimethylbenzene	<39	ug/kg	25	SW 8020	07/07/2000	2650
Xylenes, Total	180	ug/kg	75	SW 8020	07/07/2000	2650
GHU	13	mg/kg	5.0	WDNR	07/07/2000	2650
Surr: Bromofluorobenzene	90.0	%	n/a	SW 8020	07/07/2000	2650
D - NONAQUEOUS	25	mg/kg	5.0	WDNR	07/07/2000	1476 2499

ANALYTICAL REPORT

Mr. Tim Ryan
 BT2, INC.
 2830 Dairy Drive
 Madison, WI 53704-6751

07/11/2000
 Job No: 00.05675
 Sample No: 402037
 Account No: 10100
 Page 4 of 10

JOB DESCRIPTION: 1771 WDOT NAPA
 PROJECT DESCRIPTION: Soil Analysis
 SAMPLE DESCRIPTION: GP1,S10 20' 1771 WDOT NAPA
 Rec'd on Ice

Date/Time Taken: 06/30/2000 12:45

Date Received: 07/03/2000

Parameter	Results	Units	Reporting Limit	Method	Date Analyzed	Prep/Run Batch
Solids, Total	83.5	%	n/a	SW 5030	07/07/2000	3278
Extraction	G 07/03/2000			WDNR	07/03/2000	1476
DC - NONAQUEOUS						
Benzene	49	ug/kg	25	SW 8020	07/07/2000	2650
Ethylbenzene	<36	ug/kg	25	SW 8020	07/07/2000	2650
Methyl-t-butyl ether	<36	ug/kg	25	SW 8020	07/07/2000	2650
Toluene	<36	ug/kg	25	SW 8020	07/07/2000	2650
1,4-Trimethylbenzene	<36	ug/kg	25	SW 8020	07/07/2000	2650
1,5-Trimethylbenzene	<36	ug/kg	25	SW 8020	07/07/2000	2650
Xylenes, Total	<110	ug/kg	75	SW 8020	07/07/2000	2650
G-	<7.2	mg/kg	5.0	WDNR	07/07/2000	2650
Surr: Bromofluorobenzene	92.0	%	n/a	SW 8020	07/07/2000	2650
DC - NONAQUEOUS	<6.0	mg/kg	5.0	WDNR	07/07/2000	1476 2499

ANALYTICAL REPORT

Mr. Tim Ryan
 BT2, INC.
 2830 Dairy Drive
 Madison, WI 53704-6751

07/11/2000
 Job No: 00.05675
 Sample No: 402038
 Account No: 10100
 Page 5 of 10

JOB DESCRIPTION: 1771 WDOT NAPA
 PROJECT DESCRIPTION: Soil Analysis
 SAMPLE DESCRIPTION: GP2,S8 14' 1771 WDOT NAPA
 Rec'd on Ice

Date/Time Taken: 06/30/2000 13:50

Date Received: 07/03/2000

Parameter	Results	Units	Reporting Limit	Method	Date Analyzed	Prep/Run Batch
Solids, Total	73.9	%	n/a	SW 5030	07/07/2000	3278
O Extraction	07/03/2000			WDNR	07/03/2000	1476
OC - NONAQUEOUS						
Benzene	1,890	ug/kg	25	SW 8020	07/10/2000	2651
Ethylbenzene	1,350	ug/kg	25	SW 8020	07/10/2000	2651
n-Propyl-t-butyl ether	<68	ug/kg	25	SW 8020	07/10/2000	2651
Styrene	1,080	ug/kg	25	SW 8020	07/10/2000	2651
1,2,4-Trimethylbenzene	3,650	ug/kg	25	SW 8020	07/10/2000	2651
1,3,5-Trimethylbenzene	1,890	ug/kg	25	SW 8020	07/10/2000	2651
Arenes, Total	5,280	ug/kg	75	SW 8020	07/10/2000	2651
Surr: Bromofluorobenzene	110	mg/kg	5.0	WDNR	07/10/2000	2651
OC - NONAQUEOUS	107.5	%	n/a	SW 8020	07/10/2000	2651
OC - NONAQUEOUS	7.3	mg/kg	5.0	WDNR	07/07/2000	1476 2499

ANALYTICAL REPORT

Mr. Tim Ryan
 BT2, INC.
 2830 Dairy Drive
 Madison, WI 53704-6751

07/11/2000
 Job No: 00.05675
 Sample No: 402039
 Account No: 10100
 Page 6 of 10

JOB DESCRIPTION: 1771 WDOT NAPA
 PROJECT DESCRIPTION: Soil Analysis
 SAMPLE DESCRIPTION: GP2,S10 20' 1771 WDOT NAPA
 Rec'd on Ice

Date/Time Taken: 06/30/2000 14:00

Date Received: 07/03/2000

Parameter	Results	Units	Reporting Limit	Method	Date Analyzed	Prep/Run Batch
Solids, Total	85.2	%	n/a	SW 5030	07/07/2000	3278
±20 Extraction	07/03/2000			WDNR	07/03/2000	1476
±100 - NONAQUEOUS						
Benzene	48	ug/kg	25	SW 8020	07/07/2000	2650
Ethylbenzene	<29	ug/kg	25	SW 8020	07/07/2000	2650
±100 Ethyl-t-butyl ether	<29	ug/kg	25	SW 8020	07/07/2000	2650
±100 Toluene	<29	ug/kg	25	SW 8020	07/07/2000	2650
±100 1,2,4-Trimethylbenzene	141	ug/kg	25	SW 8020	07/07/2000	2650
±100 1,3,5-Trimethylbenzene	40	ug/kg	25	SW 8020	07/07/2000	2650
±100 Aromatics, Total	552	ug/kg	75	SW 8020	07/07/2000	2650
±100 Chloroform	<5.9	mg/kg	5.0	WDNR	07/07/2000	2650
Surr: Bromofluorobenzene	99.0	%	n/a	SW 8020	07/07/2000	2650
±100 - NONAQUEOUS	<5.9	mg/kg	5.0	WDNR	07/07/2000	1476 2499

ANALYTICAL REPORT

Mr. Tim Ryan
 BT2, INC.
 2830 Dairy Drive
 Madison, WI 53704-6751

07/11/2000
 Job No: 00.05675
 Sample No: 402040
 Account No: 10100
 Page 7 of 10

JOB DESCRIPTION: 1771 WDOT NAPA
 PROJECT DESCRIPTION: Soil Analysis
 SAMPLE DESCRIPTION: GP3,S8 15' 1771 WDOT NAPA
 Rec'd on Ice

Date/Time Taken: 06/30/2000 14:25

Date Received: 07/03/2000

Parameter	Results	Units	Reporting Limit	Method	Date Analyzed	Prep/Run Batch
Solids, Total	84.2	%	n/a	SW 5030	07/07/2000	3278
Extraction	07/03/2000			WDNR	07/03/2000	1476
OC - NONAQUEOUS						
Benzene	3,560	ug/kg	25	SW 8020	07/07/2000	2650
Ethylbenzene	7,130	ug/kg	25	SW 8020	07/07/2000	2650
n-Propyl-t-butyl ether	<143	ug/kg	25	SW 8020	07/07/2000	2650
Styrene	3,330	ug/kg	25	SW 8020	07/07/2000	2650
1,4-Dimethylbenzene	17,800	ug/kg	25	SW 8020	07/07/2000	2650
1,3,5-Trimethylbenzene	5,580	ug/kg	25	SW 8020	07/07/2000	2650
Aromatics, Total	33,300	ug/kg	75	SW 8020	07/07/2000	2650
H	392	mg/kg	5.0	WDNR	07/07/2000	2650
Surr: Bromofluorobenzene	98.5	%	n/a	SW 8020	07/07/2000	2650
H	309	mg/kg	5.0	WDNR	07/07/2000	1476 2500

ANALYTICAL REPORT

Mr. Tim Ryan
 BT2, INC.
 2830 Dairy Drive
 Madison, WI 53704-6751

07/11/2000
 Job No: 00.05675
 Sample No: 402041
 Account No: 10100
 Page 8 of 10

JOB DESCRIPTION: 1771 WDOT NAPA
 PROJECT DESCRIPTION: Soil Analysis
 SAMPLE DESCRIPTION: GP3,S10 20' 1771 WDOT NAPA
 Rec'd on Ice

Date/Time Taken: 06/30/2000 14:40

Date Received: 07/03/2000

Parameter	Results	Units	Reporting Limit	Method	Date Analyzed	Prep/Run Batch
Solids, Total	81.6	%	n/a	SW 5030	07/07/2000	3278
Extraction	07/03/2000			WDNR	07/03/2000	1476
DOC - NONAQUEOUS						
Benzene	1,160	ug/kg	25	SW 8020	07/07/2000	2650
Ethylbenzene	784	ug/kg	25	SW 8020	07/07/2000	2650
Methyl-t-butyl ether	<31	ug/kg	25	SW 8020	07/07/2000	2650
Toluene	<31	ug/kg	25	SW 8020	07/07/2000	2650
1,4-Trimethylbenzene	1,960	ug/kg	25	SW 8020	07/07/2000	2650
1,3,5-Trimethylbenzene	895	ug/kg	25	SW 8020	07/07/2000	2650
Arenes, Total	7,840	ug/kg	75	SW 8020	07/07/2000	2650
H	77	mg/kg	5.0	WDNR	07/07/2000	2650
Surr: Bromofluorobenzene	112.5	%	n/a	SW 8020	07/07/2000	2650
DOC - NONAQUEOUS	<6.1	mg/kg	5.0	WDNR	07/07/2000	1476 2499

ANALYTICAL REPORT

Mr. Tim Ryan
 BT2, INC.
 2830 Dairy Drive
 Madison, WI 53704-6751

07/11/2000
 Job No: 00.05675
 Sample No: 402042
 Account No: 10100
 Page 9 of 10

JOB DESCRIPTION: 1771 WDOT NAPA
 PROJECT DESCRIPTION: Soil Analysis
 SAMPLE DESCRIPTION: GP4,S4 8' 1771 WDOT NAPA
 Rec'd on Ice

Date/Time Taken: 06/30/2000 15:00

Date Received: 07/03/2000

Parameter	Results	Units	Reporting Limit	Method	Date Analyzed	Prep/Run Batch
Solids, Total	25.4	%	n/a	SW 5030	07/07/2000	3278
H ₂ O Extraction	07/03/2000			WDNR	07/03/2000	1476
OC - NONAQUEOUS						
Benzene	<98	ug/kg	25	SW 8020	07/07/2000	2650
Ethylbenzene	<98	ug/kg	25	SW 8020	07/07/2000	2650
n-Propyl-t-butyl ether	140	ug/kg	25	SW 8020	07/07/2000	2650
Toluene	<98	ug/kg	25	SW 8020	07/07/2000	2650
1,4-Trimethylbenzene	<98	ug/kg	25	SW 8020	07/07/2000	2650
1,3,5-Trimethylbenzene	<98	ug/kg	25	SW 8020	07/07/2000	2650
Arenes, Total	<300	ug/kg	75	SW 8020	07/07/2000	2650
Chloroform	<20	mg/kg	5.0	WDNR	07/07/2000	2650
Surr: Bromofluorobenzene	97.5	%	n/a	SW 8020	07/07/2000	2650
H ₂ O - NONAQUEOUS	<20	mg/kg	5.0	WDNR	07/07/2000	1476 2499

ANALYTICAL REPORT

Mr. Tim Ryan
 BT2, INC.
 2830 Dairy Drive
 Madison, WI 53704-6751

07/11/2000
 Job No: 00.05675
 Sample No: 402043
 Account No: 10100
 Page 10 of 10

JOB DESCRIPTION: 1771 WDOT NAPA
 PROJECT DESCRIPTION: Soil Analysis
 SAMPLE DESCRIPTION: GP4,S8 16' 1771 WDOT NAPA
 Rec'd on Ice

Date/Time Taken: 06/30/2000 15:15

Date Received: 07/03/2000

Parameter	Results	Units	Reporting Limit	Method	Date Analyzed	Prep/Run Batch
Solids, Total	80.8	%	n/a	SW 5030	07/07/2000	3278
OC Extraction	07/03/2000			WDNR	07/03/2000	1476
OC - NONAQUEOUS						
Benzene	<31	ug/kg	25	SW 8020	07/07/2000	2650
Ethylbenzene	<31	ug/kg	25	SW 8020	07/07/2000	2650
methyl-t-butyl ether	<31	ug/kg	25	SW 8020	07/07/2000	2650
o-xylene	<31	ug/kg	25	SW 8020	07/07/2000	2650
p-xylene	<31	ug/kg	25	SW 8020	07/07/2000	2650
1,3,5-Trimethylbenzene	<31	ug/kg	25	SW 8020	07/07/2000	2650
1,3,4-Trimethylbenzene	<31	ug/kg	25	SW 8020	07/07/2000	2650
Arenes, Total	<93	ug/kg	75	SW 8020	07/07/2000	2650
Surr: Bromofluorobenzene	<6.2	mg/kg	5.0	WDNR	07/07/2000	2650
OC - NONAQUEOUS	98.5	%	n/a	SW 8020	07/07/2000	2650
OC - NONAQUEOUS	<6.2	mg/kg	5.0	WDNR	07/07/2000	1476 2499

1