

FID 246148100



rec'd 11/16/01
NR

November 14, 2001

Alpha Terra Science, Inc.
1237 S. Pilgrim Road, Plymouth, WI 53073
TEL 920/892-2444 FAX 920/892-2620
E-mail-alphaterra@alphaterra.net

Ms. Nancy Ryan
Wisconsin Department of Natural Resources
4041 North Richards Street
Milwaukee, WI 53212

**Re: Scope of Work for Response to WDNR Case Closure Letter
Former Plymouth Foundry, 1019 North 11th Avenue, Grafton, WI
BRRTS # 02-46-189401**

Dear Nancy:

To address the additional information needed to achieve closure, Alpha Terra Science is proposing the following scope of work. The work is being performed to further delineate the extent of petroleum contamination and assess risk to human health via direct contact. Also included in the scope are five soil borings to verify the source of regional chlorinated compounds in groundwater is not associated with the past practices at this foundry.

Assess Potential Risk to Human Health Via Direct Contact

Soil samples will be obtained from two borings near the former petroleum aboveground storage tanks, one located near soil sample B-4 and one adjacent to MW-1. The soil samples will be obtained from 0 to 4 feet using a Geoprobe. Four samples will be submitted for laboratory analysis, one from 0 to 2 feet and one from 2 to 4 feet from each boring. The samples will be submitted for laboratory analysis of polycyclic aromatic hydrocarbons (PAHs) per WDNR request. A map of proposed boring locations is shown as Figure 2.

The results will be compared to WDNR standards for soil. If necessary, calculations using site specific values will be performed to calculate potential risk posed by direct contact with the soil.

Groundwater Flow Direction

Additional maps of the groundwater flow will be completed. Data from October 1998 is available, and partial rounds of data from other sample events could be used. Two additional rounds of water elevation data from all site wells will be obtained, reduced, and mapped.

Groundwater Contamination Extent Downgradient from TW-13

One groundwater sample will be obtained from a screened sampler at a location in the center of the north parking lot. The groundwater sample will be retained for analysis of VOCs and PAHs. If the water at this location appears obviously contaminated, a second screened sampler will be advanced near the eastern property boundary and tested for VOCs and PAHs. Upon obtaining the water samples, the boreholes will be abandoned.

Solvent Evaluation

Solvents are known to be present in both soil and groundwater at the Construction Forms property that is adjacent to the west of the Plymouth Foundry, across the railroad tracks. Based on personal interviews, STS, the consultant for Construction Forms has reported a release of solvent-like substances along the railroad at the Plymouth Foundry. To investigate this allegation, Alpha Terra will install 5 borings along the rail spur and main tracks and obtain 10 soil samples for VOC analysis. The borings would extend to a depth of 16 feet, and soil samples would be obtained from two depths in each boring. A map of proposed boring locations is shown as Figure 2. If a source of chlorinated compounds is not identified on the Plymouth Foundry site an off-site determination letter will be requested.

Alpha Terra Science will be completing these activities in early December. Should you have any questions or comments regarding the scope of work, please feel free to call me at (920) 892-2444.

Sincerely,

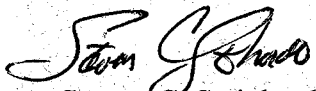

Steven C. Steinhardt
Environmental Specialist

Attachment: Map of Potential Boring Locations

cc : Ms. Kris Hughes , County Road NN, Cascade, WI 53011
Mr. Steve Castner, 1650 Ninth Avenue, Grafton, WI 53024-0164 w/ attachment

NORTH STREET

Water Main

Sanitary Sewer

Storm Sewer

LEGEND

MW-1  Existing NR-141 Monitoring Well and Groundwater Elevation (ft msl)

TW-29  Previously Installed Temporary Well, Decommissioned

B-5  Soil Boring

 GROUNDWATER FLOW DIRECTION

* : Anomalous Value, Data not used for Contouring

 PROPOSED BORING

 PROPOSED GRAB GROUNDWATER SAMPLE

Approximate Flow Direction as Determined on this portion of Construction Forms Property

N

RAILROAD

11TH AVENUE

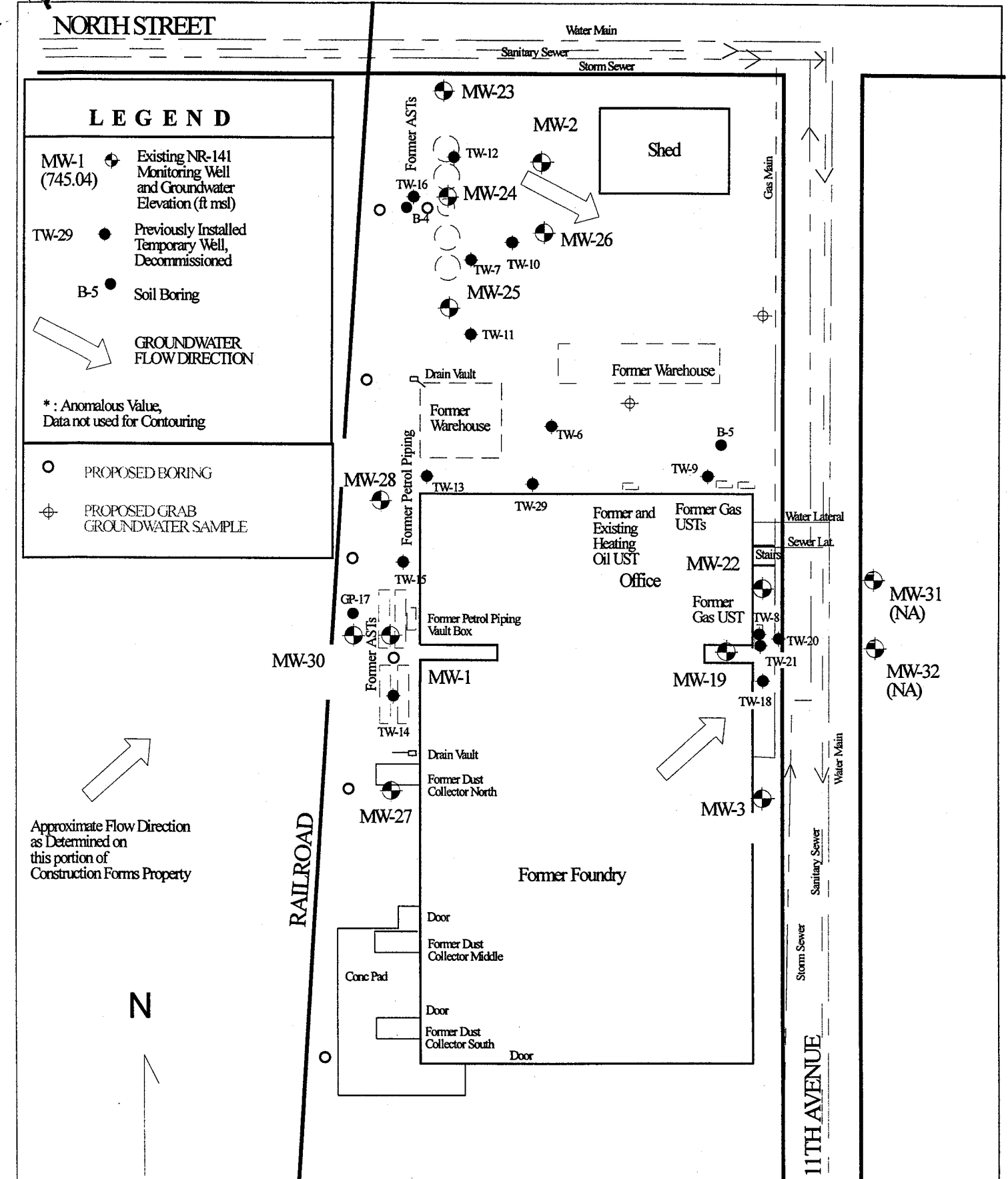

Title: **PROPOSED ADDITIONAL INVESTIGATION BORINGS TO ADDRESS CLOSURE ISSUES**

Project: **Site Investigation**

Client: **Former Plymouth Foundry Property, Grafton, WI**



SCALE: **1" = 60'**

FIG. NO: **FIGURE 2**

DRAWN BY: **K A E**

DATE: **Sept 21, 2000**