

State of Wisconsin \ DEPARTMENT OF NATURAL RESOURCES

Tommy G. Thompson, Governor
George E. Meyer, Secretary
Scott A. Humrickhouse, Regional
Director

West Central Region Headquarters
1300 W. Clairemont Avenue
PO Box 4001
Eau Claire, Wisconsin 54702-4001
Telephone 715-839-3700
FAX 715-839-6076
TDD 715-839-2786

October 19, 1998

BRRTS #03-42-001376
Monroe County

Mr. Michael Moen
Mr. Dan Lily
Walter & Mae Wittig Trust
First Bank Place, Suite 700
201 Main Street, P.O. Box 786
La Crosse, WI 54602

SUBJECT: *No Further Action - Fuel Oil UST Site Located at the former Wittig Oil
Company Motel, Wyeville, WI*

Dear Sirs:

On September 6, 1994, Tim Melka of Mid State Associates notified the Department of Natural Resources of a petroleum discharge near the 550 gallon buried fuel oil tank at the Wittig Oil Company Motel in Wyeville. One soil sample was collected. Based on the analytical results from this soil boring, the levels do not exceed department guidelines for action.

Consequently, no further response action is needed with respect to the 550 gallon fuel oil UST at this site pursuant to section NR 708.09, Wisconsin Administrative Code. The Department may require additional response actions if further information indicates that residual contamination in this area poses a threat to public health, safety, welfare or the environment.

If you have any questions concerning this letter, please contact me at (715) 839-1604.

Sincerely,

Wendy Anderson
Engineer

c: FILE
Brad Kramer, MSA, 1230 South Boulevard, Baraboo, WI 53913-2791



Quality Natural Resources Management
Through Excellent Customer Service



Moen Sheehan Meyer, Ltd.

Established 1853

Attorneys and Counselors

U.S. Bank Place, Suite 700
Post Office Box 786
La Crosse, WI
54602-0786

Telephone (608) 784-8310
Facsimile (608) 782-6611
E-mail
msm_ltd@centuryinter.net

William E. Meyer
Leon E. Sheehan
Paul W. Henke, Jr.
Michael S. Moen
Michael E. Ehrsam
James Naugler
G. Jeffrey George*†
David F. Stickler
James L. Kroner, Jr.*
Joseph J. Skemp, Jr.*
Kara M. Burgos
Daniel J. Lilly, C.P.A.*
Michelle M. Guillien**

Krin E. Krause-Paralegal
Betty J. Haas-Paralegal
Daniel L. Mitley-Paralegal/
Investigator

RECEIVED

OCT 12 1998

1998-10-12

*also licensed in Minnesota
licensed in Minnesota only
†also licensed in Iowa

October 8, 1998

Ms. Wendy Anderson
Wisconsin Department of Natural Resources
West Central Region
P.O. Box 4001
Eau Claire, WI 54702-4001

Re: **Follow-up to WDNR Letters Dated July 6 and September 15, 1998**
Former Wittig Oil General Office - Tomah, WI - BRRTS# 03- 2-1379
Former Wittig Oil Motel - Wyeville, WI - BRRTS# 03-42-1376
Former Wittig Residence - Wyeville, WI - BRRTS# 03- 2-1381
Former Wittig Bulk/Spur Station UST Site - Wyeville, WI - BRRTS # 03-42-1380
(Bulk Site) and 03-42-154098 (Spur Station)

Dear Ms. Anderson:

In response to your requests for further information dated July 6 and September 15, 1998, and subsequent telephone conversation with MSA Professional Services, Inc. (MSA) on September 17, 1998, we, with the aid of MSA, are submitting the following information for your review and file. This information is intended to supplement the information submitted to you by MSA in their letter to you dated June 12, 1998 which presented specific information regarding the three sites which was collected on July 25, 1994 and presented in a Phase II Environmental Site Assessment dated September 1994.

In the June 12, 1998 MSA letter, it was stated that there were no UST closure site assessments completed at the time the underground storage tanks (USTs) were removed by METCO, Inc. on May 22, 1995 (Wittig Oil General Office - Tomah) or on January 2, 1996 (for the Wittig Oil Motel and Wittig Residence -Wyeville). Based on further review of MSA files, they were able to locate a UST Closure and Site Assessment Report completed by MSA in July 1995 for the Wittig Oil General Office - Tomah UST closure and site assessment completed on May 22, 1995. Although this report was originally submitted

to the former DILHR (now Commerce) and WDNR, an additional copy of this report is attached for your review and file.

It appears that based on the conclusions and recommendations presented in the July 1995 report for the Wittig General Office - Tomah site, MSA recommended no further action or investigation be completed due to the low concentrations (3.0 to 6.0 mg/Kg) of diesel range organics (DRO) found in the soil below the 2,000 gallon heating oil UST location. This information supported the earlier Phase II ESA data which indicated non detectable levels of DRO (< 5.5 to < 5.6 mg/Kg) and low DRO concentration (150 μ g/L) which currently has no Wisconsin Administrative Code (WAC) NR-140 standards. Based on these former recommendations already submitted, we request this site be closed by the WDNR.

As for the Wittig Oil Motel and Wittig Residence, the UST removal/closure was completed on December 4, 1995, not January 2, 1996 as previously indicated in MSA's June 12, 1998 letter. The January 2, 1996 date was the date the UST forms were signed by Don Waltemath, former administrator of Wittig Oil. Because both sites were residential fuel oil, site assessments were not completed by the UST removal contractor, METCO, Inc., and MSA was not present during the removal. Copies of the "Checklist for Underground Tank Closure" and "Underground Petroleum Product Tank Inventory" are attached for your review and file.

In regards to the Wittig Oil Motel, the earlier July 1994 Phase II ESA soil data collected from the direct push soil boring CB-1 completed adjacent to the 550 gallon fuel oil UST, indicated non detectable concentrations of DRO (< 5.6 mg/Kg) and a low DRO concentration in groundwater (160 μ g/L) for which there are no current WAC NR-140 standards. Based on this information, combined with the fact the UST has been removed, we recommend the WDNR officially close this site.

In regards to the Wittig Residence, based on the July 1994 Phase II ESA, 450 mg/Kg DRO was found in soil collected from the 3-5 feet below ground surface interval in direct push soil boring DB-2 and DRO in groundwater (also collected from DB-2) was slightly higher than the Motel or General Office at 450 μ g/L. Although this UST (source of contamination) has been removed, we acknowledge further work may be required by the WDNR to be completed. However, the estate has been focusing their efforts on the sites that need more immediate attention. Since we believe this tank is eligible under the Petroleum Environmental Clean-up Fund Assistance (PECFA) program, we will seek an eligibility determination from Commerce before proceeding.

With regard to the ongoing work at the Former Wittig Bulk/Spur Station UST Sites (BRRTS # 03-42-001380 and 03-42-154098), we are and have been in the process of applying for a PECFA Loan. We have all information assembled except for a Letter of Credit which is to be issued by the beneficiary of the Wittig estate. We have been waiting for this Letter

Page 3

of Credit from the beneficiary of the estate since mid March 1998. This is the only piece of information necessary in order to process the PECFA loan. We have attempted nearly everything to process this Letter of Credit through the counsel of the beneficiary, short of holding their hand all the way to the bank. We too are growing frustrated with the waiting. The PECFA loans are absolutely necessary since the estate is insolvent and has no funds in which to conduct the necessary work at the sites. The estate was able to cover the PECFA deductible only. Once we obtain this Letter of Credit, the loan can be processed and the work can commence as planned. Based on recent conversations with the bank, this will be resolved by the end of October so work can proceed.

Also, please note that on July 7, 1998, the Department of Commerce combined the Former Wittig Bulk and Spur Station UST Sites together and will be tracking both sites under one Commerce # 54660-3231-18A. Please note that the WDNR needs to combine these sites into one BRRS # as well. Please let us know which BRRS number the WDNR will assign so future correspondence submittals will be filed at the WDNR appropriately.

We hope this information will aid in your overall evaluation of these sites. If you have any questions or comments, please call either of us at (608) 784-8310.

Sincerely,

Moen Sheehan Meyer, Ltd.



Daniel J. Lilly, Attorney/CPA



Michael Moen, Attorney

Representing:

Walter Wittig Estate
Frederick Freking, Personal Representative
US Bank, Suite 700
201 Main Street, PO Box 0786
La Crosse, WI 54602

Enc.

cc: Brad Kraemer, MSA

CHECKLIST FOR UNDERGROUND TANK CLOSURE

RETURN COMPLETED CHECKLIST TO:
Safety & Buildings Division
Fire Prevention & Underground
Storage Tank Section
P. O. Box 7969, Madison, WI 53707

**Complete one form for
each site closure.**

The information you provide may be used by other
government agency programs (Privacy Law, s. 15.04 (1) (m)).

2-95-1217

A. IDENTIFICATION: (Please Print) Indicate whether closure is for: Tank System Tank Only Piping Only

1. Site Name <u>Wittig Motel</u>		2. Owner Name <u>Walter & Mary Trust</u>	
Site Street Address (not P.O. Box) <u>Hwy 21</u>		Owner Street Address <u>Michael M. M. Atty. 201 Main 1st Bank Place</u>	
<input checked="" type="checkbox"/> City <u>Wyeville</u>	<input type="checkbox"/> Village	<input checked="" type="checkbox"/> City <u>La Crosse</u>	<input type="checkbox"/> Village
State <u>WI</u>	Zip Code <u>54602</u>	County <u>Monroe</u>	Telephone No. (include area code) <u>1608 174-8310</u>
3. Closure Company Name (Print) <u>METCO</u>		Closure Company Street Address <u>102 Enterprise Dr.</u>	
Closure Company Telephone No. (include area code) <u>(608) 489-2198</u>		Closure Company City/State, Zip Code <u>Hillsboro WI 54634</u>	
4. Name of Company Performing Closure Assessment		Assessment Company Street Address, City, State, Zip Code	
Telephone # (include area code) ()	Certified Assessor Name (Print)	Assessor Signature	Assessor Certification No.

Tank ID #	Closure	Temp. Closure	Closure In Place	Tank Capacity	Contents *	Closure Assessment
1. <u>4105 00146</u>	<input checked="" type="checkbox"/>	<input type="checkbox"/>	<input type="checkbox"/>	<u>550</u>	<u>04</u>	<input type="checkbox"/> Y <input checked="" type="checkbox"/> N
2.	<input type="checkbox"/>	<input type="checkbox"/>	<input type="checkbox"/>			<input type="checkbox"/> Y <input type="checkbox"/> N
3.	<input type="checkbox"/>	<input type="checkbox"/>	<input type="checkbox"/>			<input type="checkbox"/> Y <input type="checkbox"/> N
4.	<input type="checkbox"/>	<input type="checkbox"/>	<input type="checkbox"/>			<input type="checkbox"/> Y <input type="checkbox"/> N
5.	<input type="checkbox"/>	<input type="checkbox"/>	<input type="checkbox"/>			<input type="checkbox"/> Y <input type="checkbox"/> N
6.	<input type="checkbox"/>	<input type="checkbox"/>	<input type="checkbox"/>			<input type="checkbox"/> Y <input type="checkbox"/> N

* Indicate which product by numeric code: 01-Diesel; 02-Leaded; 03-Unleaded; 04-Fuel Oil; 05-Gasohol; 06-Other; 09-Unknown; 10-Premix; 11-Waste oil; 13-Chemical (indicate the chemical name(s) or numbers(s)); 14-Kerosene; 15-Aviation.

Written notification was provided to the local agent 15 days in advance of closure date. Y N NA
All local permits were obtained before beginning closure. Y N NA

B. TEMPORARILY OUT OF SERVICE

Check applicable box at right in response to all statements in Sections B - E.	Remove Verified	Inspector Verified	NA
Written inspector approval of temporary closure obtained, which is effective until (provide date) _____	<input type="checkbox"/> Y <input type="checkbox"/> N	<input type="checkbox"/>	<input checked="" type="checkbox"/>
1. Product Removed			
a. Product lines drained into tank (or other container) and resulting liquid removed, AND	<input type="checkbox"/> Y <input type="checkbox"/> N	<input type="checkbox"/>	<input type="checkbox"/>
b. All product removed to bottom of suction line, OR	<input type="checkbox"/> Y <input type="checkbox"/> N	<input type="checkbox"/>	<input type="checkbox"/>
c. All product removed to within 1" of bottom.	<input type="checkbox"/> Y <input type="checkbox"/> N	<input type="checkbox"/>	<input type="checkbox"/>
2. Fill pipe, gauge pipe, tank truck vapor recovery fittings, and vapor return lines capped.	<input type="checkbox"/> Y <input type="checkbox"/> N	<input type="checkbox"/>	<input type="checkbox"/>
3. All product lines at the islands or pumps located elsewhere are removed and capped, OR	<input type="checkbox"/> Y <input type="checkbox"/> N	<input type="checkbox"/>	<input type="checkbox"/>
4. Dispensers/pumps left in place but locked and power disconnected.	<input type="checkbox"/> Y <input type="checkbox"/> N	<input type="checkbox"/>	<input type="checkbox"/>
5. Vent lines left open	<input type="checkbox"/> Y <input type="checkbox"/> N	<input type="checkbox"/>	<input type="checkbox"/>
6. Inventory form filed indicating temporary closure	<input type="checkbox"/> Y <input type="checkbox"/> N	<input type="checkbox"/>	<input checked="" type="checkbox"/>

C. CLOSURE BY REMOVAL

1. Product from piping drained into tank (or other container).	<input checked="" type="checkbox"/> Y <input type="checkbox"/> N	<input type="checkbox"/>	<input type="checkbox"/>
2. Piping disconnected from tank and removed	<input checked="" type="checkbox"/> Y <input type="checkbox"/> N	<input type="checkbox"/>	<input type="checkbox"/>
3. All liquid and residue removed from tank using explosion proof pumps or hand pumps.	<input checked="" type="checkbox"/> Y <input type="checkbox"/> N	<input type="checkbox"/>	<input type="checkbox"/>
4. All pump motors and suction hoses bonded to tank or otherwise grounded.	<input checked="" type="checkbox"/> Y <input type="checkbox"/> N	<input type="checkbox"/>	<input type="checkbox"/>
5. Fill pipes, gauge pipes, vapor recovery connections, submersible pumps and other fixtures removed.	<input checked="" type="checkbox"/> Y <input type="checkbox"/> N	<input type="checkbox"/>	<input type="checkbox"/>
NOTE: DROP TUBE SHOULD NOT BE REMOVED IF THE TANK IS TO BE PURGED THROUGH THE USE OF AN EDUCTOR.			
6. Vent lines left connected until tanks purged.	<input checked="" type="checkbox"/> Y <input type="checkbox"/> N	<input type="checkbox"/>	<input type="checkbox"/>
7. Tank openings temporarily plugged so vapors exit through vent.	<input checked="" type="checkbox"/> Y <input type="checkbox"/> N	<input type="checkbox"/>	<input type="checkbox"/>
8. Tank atmosphere reduced to 10% of the lower flammable range (LEL) - see Section F.	<input checked="" type="checkbox"/> Y <input type="checkbox"/> N	<input type="checkbox"/>	<input type="checkbox"/>
9. Tank removed from excavation after PURGING/INERTING, placed on level ground and blocked to prevent movement.	<input checked="" type="checkbox"/> Y <input type="checkbox"/> N	<input type="checkbox"/>	<input type="checkbox"/>
10. Tank cleaned before being removed from site.	<input checked="" type="checkbox"/> Y <input type="checkbox"/> N	<input type="checkbox"/>	<input type="checkbox"/>

C. CLOSURE BY REMOVAL (continued)

- | | Remover
Verified | Inspector
Verified | NA |
|---|--|--------------------------|--------------------------|
| 11. Tank labeled in 2" high letters after removal but before being moved from site.
NOTE: COMPLETE TANK LABELING SHOULD INCLUDE WARNING AGAINST REUSE;
FORMER CONTENTS; VAPOR STATE; VAPOR FREEING TREATMENT; DATE. | <input checked="" type="checkbox"/> Y <input type="checkbox"/> N | <input type="checkbox"/> | <input type="checkbox"/> |
| 12. Tank vent hole (1/8 in. in uppermost part of tank) installed prior to moving the tank from site. | <input checked="" type="checkbox"/> Y <input type="checkbox"/> N | <input type="checkbox"/> | <input type="checkbox"/> |
| 13. Inventory form filed by owner with Safety and Buildings Division indicating closure by removal. | <input checked="" type="checkbox"/> Y <input type="checkbox"/> N | <input type="checkbox"/> | <input type="checkbox"/> |
| 14. Site security is provided while the excavation is open. | <input checked="" type="checkbox"/> Y <input type="checkbox"/> N | <input type="checkbox"/> | <input type="checkbox"/> |

D. CLOSURE IN PLACE

NOTE: CLOSURES IN PLACE ARE ONLY ALLOWED WITH THE PRIOR WRITTEN APPROVAL OF THE DEPARTMENT OF INDUSTRY, LABOR AND HUMAN RELATIONS OR LOCAL AGENT.

- | | | | |
|---|---|--------------------------|-------------------------------------|
| 1. Product from piping drained into tank (or other container). | <input type="checkbox"/> Y <input type="checkbox"/> N | <input type="checkbox"/> | <input type="checkbox"/> |
| 2. Piping disconnected from tank and removed. | <input type="checkbox"/> Y <input type="checkbox"/> N | <input type="checkbox"/> | <input checked="" type="checkbox"/> |
| 3. All liquid and residue removed from tank using explosion proof pumps or hand pumps. | <input type="checkbox"/> Y <input type="checkbox"/> N | <input type="checkbox"/> | <input type="checkbox"/> |
| 4. All pump motors and suction hoses bonded to tank or otherwise grounded. | <input type="checkbox"/> Y <input type="checkbox"/> N | <input type="checkbox"/> | <input type="checkbox"/> |
| 5. Fill pipes, gauge pipes, vapor recovery connections, submersible pumps and other fixtures removed.
NOTE: DROP TUBE SHOULD NOT BE REMOVED IF THE TANK IS TO BE PURGED THROUGH THE USE OF AN EDUCTOR - EDUCTOR OUTPUT 12 FT ABOVE GRADE. | <input type="checkbox"/> Y <input type="checkbox"/> N | <input type="checkbox"/> | <input type="checkbox"/> |
| 6. Vent lines left connected until tanks purged. | <input type="checkbox"/> Y <input type="checkbox"/> N | <input type="checkbox"/> | <input type="checkbox"/> |
| 7. Tank openings temporarily plugged so vapors exit through vent. | <input type="checkbox"/> Y <input type="checkbox"/> N | <input type="checkbox"/> | <input type="checkbox"/> |
| 8. Tank atmosphere reduced to 10% of the lower flammable range (LEL) - see Section F. | <input type="checkbox"/> Y <input type="checkbox"/> N | <input type="checkbox"/> | <input type="checkbox"/> |
| 9. Tank properly cleaned to remove all sludge and residue. | <input type="checkbox"/> Y <input type="checkbox"/> N | <input type="checkbox"/> | <input type="checkbox"/> |
| 10. Solid inert material (sand, cyclone boiler slag, pea gravel recommended) introduced and tank filled. | <input type="checkbox"/> Y <input type="checkbox"/> N | <input type="checkbox"/> | <input type="checkbox"/> |
| 11. Vent line disconnected or removed. | <input type="checkbox"/> Y <input type="checkbox"/> N | <input type="checkbox"/> | <input type="checkbox"/> |
| 12. Inventory form filed by owner with Safety and Buildings Division indicating closure in place. | <input type="checkbox"/> Y <input type="checkbox"/> N | <input type="checkbox"/> | <input checked="" type="checkbox"/> |

E. CLOSURE ASSESSMENTS

NOTE: DETERMINE IF A CLOSURE ASSESSMENT IS REQUIRED BY REFERRING TO ILHR 10.

- | | | | |
|--|---|--------------------------|--------------------------|
| 1. Individual conducting the assessment has a closure assessment plan (written) which is used as the basis for their work on the site. | <input type="checkbox"/> Y <input type="checkbox"/> N | <input type="checkbox"/> | <input type="checkbox"/> |
| 2. Do points of obvious contamination exist? | <input type="checkbox"/> Y <input type="checkbox"/> N | <input type="checkbox"/> | <input type="checkbox"/> |
| 3. Are there strong odors in the soils? | <input type="checkbox"/> Y <input type="checkbox"/> N | <input type="checkbox"/> | <input type="checkbox"/> |
| 4. Was a field screening instrument used to pre-screen soil sample locations? | <input type="checkbox"/> Y <input type="checkbox"/> N | <input type="checkbox"/> | <input type="checkbox"/> |
| 5. Was a closure assessment omitted because of obvious contamination? | <input type="checkbox"/> Y <input type="checkbox"/> N | <input type="checkbox"/> | <input type="checkbox"/> |
| 6. Was the DNR notified of suspected or obvious contamination?
Agency, office and person contacted: | <input type="checkbox"/> Y <input type="checkbox"/> N | <input type="checkbox"/> | <input type="checkbox"/> |
| 7. Contamination suspected because of: <input type="checkbox"/> Odor <input type="checkbox"/> Soil Staining <input type="checkbox"/> Free Product <input type="checkbox"/> Sheen On Groundwater <input type="checkbox"/> Field Instrument Test | | | |

F. METHOD OF ACHIEVING 10% LEVEL DESCRIPTION

- Educator Or Diffused Air Blower
Eductor driven by compressed air, bonded and drop tube left in place; vapors discharged minimum of 12 feet above ground. Diffused air blower bonded and drop tube removed. Air pressure not exceeding 5 psig.
- Dry Ice
Dry ice introduced at 1.5 pounds per 100 gallons of tank capacity. Dry ice crushed and distributed over the greatest possible tank area. Dry ice evaporated before proceeding.
- Inert Gas (CO₂ or N₂) **NOTE: INERT GASSES PRODUCE AN OXYGEN DEFICIENT ATMOSPHERE. THE TANK MAY NOT BE ENTERED IN THIS STATE WITHOUT SPECIAL EQUIPMENT**
Gas introduced through a single opening at a point near the bottom of the tank at the end of the tank opposite the vent. Gas introduced under low pressure not to exceed 5 psig to reduce static electricity. Gas introducing device grounded.
- Tank atmosphere monitored for flammable or combustible vapor levels.
Calibrate combustible gas indicator. Drop tube removed prior to checking atmosphere. Tank space monitored at bottom, middle and upper portion of tank. Readings of 10% or less of the lower flammable range (LEL) obtained before removing tank from ground.

G. NOTE SPECIFIC PROBLEMS OR NONCOMPLIANCE ISSUES BELOW

H. REMOVER/CLEANER INFORMATION

Michael Miller [Signature] 20375 12/10/95
Remover Name (print) Remover Signature Remover Certification No. Date Signed

I. INSPECTOR INFORMATION

Peter Augustyniak [Signature] 00084
Inspector Name (print) Inspector Signature Inspector Certification No.
FDID # For Location Where Inspection Performed [Number] [Date]
Inspector Telephone Number Date Signed

REMOVER

C-95-1217

Wisconsin Department of Industry,
Labor and Human Relations

UNDERGROUND PETROLEUM PRODUCT TANK INVENTORY

Send Completed Form To:
Safety & Buildings Division
P.O. Box 7969
Madison, WI 53707
Telephone: (608) 267-5280

For Office Use Only:
Tank ID # 410500146

Information Required By Sec. 102.142, Wis. Stats.

Underground tanks in Wisconsin that have stored or currently store petroleum or regulated substances must be registered. Please see the reverse side for additional information on this program. An underground storage tank is defined as any tank with at least 10 percent of its total volume (included piping) located below ground level. A separate form is needed for each tank. Send each completed form to the agency designated in the top right corner. Have you previously registered this tank by submitting a form? YES NO If yes, are you correcting/updating information only? Yes No The information you provide may be used by other government agency programs (Privacy Law, s. 15.04 (1) (m)).

This registration applies to a tank that is (check one):			Fire Department Providing Fire Coverage Where Tank Located:	
1A. <input type="checkbox"/> In Use or 1B. <input type="checkbox"/> Newly Installed	4. <input checked="" type="checkbox"/> Closed - Tank Removed	8. <input type="checkbox"/> Changed Ownership	<u>Oakdale</u>	
2. <input type="checkbox"/> Abandoned With Product	6. <input type="checkbox"/> Closed - Filled With Inert Material	(Indicate new owner below)		
3. <input type="checkbox"/> Abandoned No Product (empty) or With Water	7. <input type="checkbox"/> Out of Service - Provide Date: _____			

A. IDENTIFICATION: (Please Print)

1. Tank Site Name: Wittig Motel Site Address: Hwy 21 Site Telephone No.: ()

City Wyal Village Town of: _____ State: WI Zip Code: 54671 County: Monroe

2. Owner Name (mail sent here unless indicated otherwise in #3 below): Walter & Mary Wittig Trust Owner Mailing Address (mail sent here unless indicated otherwise in #3): Michael Moen, Attny. 201 Main 1st Bank Place P.O. Box: 78

City La Crosse Village Town of: _____ State: WI Zip Code: 54602 County: La Crosse

3. Alternate Mailing Name If Different Than #2 _____ Alternate Mailing Street Address If Different From #2 _____

City Village Town of: _____ State _____ Zip Code _____ County _____

4. Tank Age (date installed, if known: or years old) UNKNOWN 5. Tank Capacity (gallons) 550 6. Tank Manufacturer's Name (if known) _____

B. TYPE OF USER (check one):

1. Gas Station 2. Bulk Storage 3. Utility 4. Mercantile
 5. Industrial 6. Government 7. School 8. Residential
 9. Agricultural 10. Other (specify): motel

TANK CONSTRUCTION:

1. Bare Steel 2. Cathodically Protected and Coated Steel (A. Sacrificial Anodes or B. Impressed Current)
 3. Coated Steel 4. Fiberglass 5. Other (specify): _____
 6. Relined - Date _____ 7. Steel - Fiberglass Reinforced Plastic Composite 9. Unknown

Approval: 1. Nat'l Std. 2. UL 3. Other: _____ Is Tank Double Walled? Yes No

Overfill Protection Provided? Yes No If yes, identify type: _____ Spill Containment? Yes No

Tank leak detection method: 1. Automatic tank gauging 2. Vapor monitoring 3. Groundwater monitoring 4. Inventory control and tightness testing 5. Interstitial monitoring 6. Not required at present 7. Manual Tank Gauging (only for tanks of 1,000 gallons or less)

D. PIPING CONSTRUCTION

1. Bare Steel 2. Cathodically Protected and Coated or Wrapped Steel (A. Sacrificial Anodes or B. Impressed Current) 3. Coated Steel
 4. Fiberglass 5. Other (specify): _____ 9. Unknown

Piping System Type: 1. Pressurized piping with: A. auto shutoff; B. alarm; or C. flow restrictor 2. Suction piping with check valve at tank
 3. Suction piping with check valve at pump and inspectable

Piping leak detection method: used if pressurized or check valve at tank: 1. Vapor monitoring 2. Interstitial monitoring
 3. Groundwater monitoring 4. Tightness testing 5. Line Leak Detector 6. Not Required

Approval: 1. Nat'l Std. 2. UL 3. Other: _____ Double Walled: Yes No

E. TANK CONTENTS

1. Diesel 2. Leaded 3. Unleaded 4. Fuel Oil
 5. Gasohol 6. Other 7. Empty 8. Sand/Gravel/Slurry
 9. Unknown 10. Premix 11. Waste Oil 12. Propane
 13. Chemical * _____ 14. Kerosene 15. Aviation

* If # 13 is checked, indicate the chemical name(s) or number(s) of the chemical or waste.

If Tank Closed, Give Date (mo/day/yr): 12-4-95 Has a site assessment been completed? (see reverse side for details) Yes No

If installation of a new tank is being reported, indicate who performed the installation inspection:
 1. Fire Department 2. DILHR 3. Other (identify) _____

Name of Owner or Operator (please print): _____ Indicate Whether: Owner or Operator

Signature of Owner or Operator: Donald Waltemath Date Signed: 1-2-96

9/17/98

Wittig Sites

Brad Kramer, MSA
called to say:

Frederick Frecking in old age home in
LaCrosse. He is personal representative
US Bank - LaCrosse is Bank for Diocese

Birnbaum is attorney for Diocese

Dan Lily is attorney for estate - accounting

Mike Moen " " " real estate

Kurt Lambert - property renter - died 7/27/98
his fiance Debbie _____ is co-renter.

MSA has not been paid for any work done
at gas station or bulk facility.

likely no more work will be done.

I told Brad, that if I didn't hear from them
in writing by Oct 15 - I would issue
NOVs for all 5 sites and the attorneys
can explain everything in an enforcement
conference here in Eau Claire.

Wendy Amb

C: all 5 sites.

608-784-8310

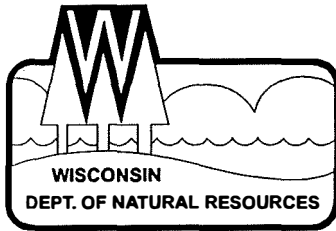

State of Wisconsin \ DEPARTMENT OF NATURAL RESOURCES

Tommy G. Thompson, Governor
George E. Meyer, Secretary
Scott A. Humrickhouse, Regional
Director

West Central Region Headquarters
1300 W. Clairemont Avenue
PO Box 4001
Eau Claire, Wisconsin 54702-4001
Telephone 715-839-3700
FAX 715-839-6076
TDD 715-839-2786

CERTIFIED MAIL
RETURN RECEIPT REQUESTED

BRRTS #03-42-1376
Monroe County

September 15, 1998

Mr. Michael Moen
Mr. Dan Lilly
Walter & Mae Wittig Trust
First Bank Place, Suite 700
201 Main Street, P.O. Box 786
La Crosse, WI 54602

SUBJECT: **Notice of Non-Compliance**
Wittig Oil Motel, Wyeville, WI

Dear Sirs:

The purpose of this letter is to notify you that you have failed to comply with the Hazardous Substances Spills Law (section 292.11(3), Wisconsin Statutes). In a letter dated September 9, 1994, the Department informed the Wittig Oil Company of its obligation to clean up the petroleum that leaked from the motel 550 gallon buried fuel oil tank located in Wyeville. In a letter dated July 6, 1998, the Department requested that you inform us of all work that had been completed since September 1994. The Department has received no response to that letter and has no documentation indicating that you have initiated a site investigation to define the degree and extent of the contamination. To date, no cleanup efforts have been made at this site.

Wisconsin Statute 292.11(3) states:

"A person who possesses or controls a hazardous substance which is discharged or who causes the discharge of a hazardous substance shall take the actions necessary to restore the environment to the extent practicable and minimize the harmful effects from the discharge to the air, lands, or waters of the state."

Under the Spills Law (section 292.11, Wisconsin Statutes), you have a legal responsibility to clean up all contamination. Although the Department cannot review your case at every stage in the project, you are still required to restore the environment to the extent practicable.

The Department must take steps to enforce Wisconsin's cleanup laws. This Notice of Noncompliance is the first step in this enforcement action. The following steps will be taken:

- 1) From issuance of this Notice of Noncompliance, you have 30 calendar days to submit the following:



Quality Natural Resources Management
Through Excellent Customer Service



- a) written proof that you have a contract with an environmental consultant to investigate and remediate your contamination problem.
 - b) a schedule for completion of the site investigation as required in NR 716, Wisconsin Administrative Code.
 - c) documentation of all work completed since September 9, 1994. If you feel you have completed the cleanup at this site, please submit a final report and request a closure review of your file.
- 2) If you either do not respond or you do not provide an adequate response of the activities you have undertaken, you will receive Notification of an Enforcement Conference to discuss your case. You will be notified of the time and location of the conference. You will have 30 days to respond to the enforcement conference notice.

You will be notified of the time and location of the conference. You will have 30 days to respond to the enforcement conference notice.

- 3) If you do not respond within 30 days or fail to attend the scheduled Enforcement Conference, I will proceed to record an affidavit at the county register of deeds office. This affidavit will give notice to potential purchasers of the property that environmental contamination exists on this site.

I await your response before October 15, 1998. If you have any questions about this letter and your responsibilities, please feel free to contact me at (715) 839-1604.

Sincerely,

Wendy Anderson
Engineer

- c: Bill Evans, WCR
Tom Lovejoy, WCR
Brad Kramer, MSA, 1230 South Boulevard, Baraboo, WI 53913-2791

Is your RETURN ADDRESS completed on the reverse side?

SENDER:
 ■ Complete items 1 and/or 2 for additional services.
 ■ Complete items 3, 4a, and 4b.
 ■ Print your name and address on the reverse of this form so that we can return this card to you.
 ■ Attach this form to the front of the mailpiece, or on the back if space does not permit.
 ■ Write "Return Receipt Requested" on the mailpiece below the article number.
 ■ The Return Receipt will show to whom the article was delivered and the date delivered.

I also wish to receive the following services (for an extra fee):
 1. Addressee's Address
 2. Restricted Delivery
 Consult postmaster for fee.

3. Article Addressed to:
 Michael Meen's Dan Lilly
 P.O. Box 786
 Lacrosse, WI
 54602

4a. Article Number
 Z 383-958-196

4b. Service Type
 Registered Certified
 Express Mail Insured
 Return Receipt for Merchandise COD

7. Date of Delivery

5. Received By: (Print Name)

6. Signature: (Addressee or Agent)

8. Addressee's Address (Only if requested and fee is paid)



PS Form 3811, December 1994 702595-98-B-1229 Domestic Return Receipt

Thank you for using Return Receipt Service.

Z 383 958 196

US Postal Service
Receipt for Certified Mail
 No Insurance Coverage Provided.
 Do not use for International Mail (See reverse)

Sent to Dan Lilly: Michael Meen	
Street & Number P.O. Box 786	
Post Office, State, & ZIP Code Lacrosse WI 54602	
Postage	\$ 1.32
Certified Fee	1.35
Special Delivery Fee	
Restricted Delivery Fee	
Return Receipt Showing to Whom & Date Delivered	1.60
Return Receipt Showing to Whom, Date, & Addressee's Address	
TOTAL Postage & Fees	\$ 2.77
Postmark or Date	9-15-98 83

PS Form 3800, April 1995

UNITED STATES POSTAL SERVICE

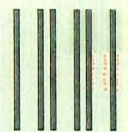

First-Class Mail
 Postage & Fees Paid
 USPS
 Permit No. G-10

• Print your name, address, and ZIP Code in this box •

Department of Natural Resources
 West Central Region
 1300 W. Clairemont Avenue
 P.O. Box 4001
 Eau Claire, WI 54702-4001

RECEIVED
 SEP 17 1998
 DAN LILLY

Metel - WPA

Stick postage stamps to article to cover First-Class postage, certified mail fee, and charges for any selected optional services (See front).

1. If you want this receipt postmarked, stick the gummed stub to the right of the return address leaving the receipt attached, and present the article at a post office service window or hand it to your rural carrier (no extra charge).
2. If you do not want this receipt postmarked, stick the gummed stub to the right of the return address of the article, date, detach, and retain the receipt, and mail the article.
3. If you want a return receipt, write the certified mail number and your name and address on a return receipt card, Form 3811, and attach it to the front of the article by means of the gummed ends if space permits. Otherwise, affix to back of article. Endorse front of article **RETURN RECEIPT REQUESTED** adjacent to the number.
4. If you want delivery restricted to the addressee, or to an authorized agent of the addressee, endorse **RESTRICTED DELIVERY** on the front of the article.
5. Enter fees for the services requested in the appropriate spaces on the front of this receipt. If return receipt is requested, check the applicable blocks in item 1 of Form 3811.
6. Save this receipt and present it if you make an inquiry.

102595-97-B-0145

PS Form 3800, April 1995 (Reverse)



State of Wisconsin \ DEPARTMENT OF NATURAL RESOURCES

Tommy G. Thompson, Governor
George E. Meyer, Secretary
Scott A. Humrickhouse, Regional
Director

West Central Region Headquarters
1300 W. Clairemont Avenue
PO Box 4001
Eau Claire, Wisconsin 54702-4001
Telephone 715-839-3700
FAX 715-839-6076
TDD 715-839-2786

July 6, 1998

BRTTS #03-42-001376
Monroe County

Mr. Michael Moen
Walter & Mae Wittig Trust
First Bank Place, Suite 700
201 Main Street, P.O. Box 786
La Crosse, WI 54602

Subject: **Wittig Oil Motel - Wyeville**
Status of Petroleum Cleanup

Dear Mr. Moen:

During a recent review of your file, I noted that no work has been done since September 6, 1994, when a site assessment was conducted by Mid-State Associates, Inc. The letter issued to Wittig Oil Company by the Department on September 9, 1994, required the Wittig Oil Company to secure an environmental consultant and provide the Department with written verification, within thirty (30) days. The Department has received no such documentation. Please bring this office up to date on the status of your clean-up project. I request a brief written description of the current project status by August 6, 1998. I am sending this letter at this time, because I am aware that your consultant for the gas station and bulk sites, may be performing additional work soon.

If work has been done, relative to the 550 gallon fuel oil release, since September 6, 1994, please submit a report documenting the work.

If you feel you have completed the cleanup at this site, please submit a final report and request a review of your file. Please be aware that the Department has a significant backlog of cases similar to yours. Your case will be reviewed as time permits.

If work has been temporarily discontinued or if you are planning further investigative work, please submit a written statement of the current status of your case.

Please be advised that under the Spills Law (Wisconsin Statute 292:11), you have a legal responsibility to clean up all contamination. Although the Department of Natural Resources cannot review your case at every stage in the project, you are still required to take the steps necessary to restore the environment to the extent practicable. Please ask your environmental consultant for guidance on meeting Wisconsin's cleanup standards.



Quality Natural Resources Management
Through Excellent Customer Service



In any case, please provide this office with written notice of your case status by August 6, 1998. If you have any questions concerning this letter, you may call me at (715) 839-1604.

Sincerely,

Wendy Anderson
Engineer

c: Brad Kramer, MSA Professional Services, Inc., 1230 South Boulevard,
Baraboo, WI 53913-2791
FILE

C.W. 6.5 FT

Wittig Estate

RCRD 796
5/31/96

Bulk - 8,000 Fuel oil
12,000 Fuel oil
6,000 UNLEADED
14,000 LEADED

Leathers COMPANY

GAS - 500 Fuel oil
500 LEADED GAS
2 - 800 UNLEADED
400 LEADED

GENERAL OFFICE

HEATING oil 150 mg/l DRO C.W. CB-1
2,000 gal. SOIL 5-7' ND CB-2

MORE CB-1 < 5.6 mg/kg SOIL 3-5 FT
550 gal 160 mg/l DRO
FUEL OIL

RESIDENTIAL DB-1 DRO 270 mg/kg 3-5 FT
550 gal DB-2 DRO 450 mg/l
FUEL OIL

Dave McDaniel SEIT
Hubing & Kuhl.

Eric Hansen ^{City's} TC Eng mn.
Helman dist. in Sparta
602-789-705

Tim Melka. (MISA ^{midstate Assoc.})
Walt Whittle ^{state}
608-356-2771

- ① Wyeville
- Wyeville - La. ^{state}
- Oil ^{state}
- Motel
- House
- Gas Station
- Bus ^{state} - Tomah



PROFESSIONAL SERVICES
 TRANSPORTATION • MUNICIPAL • REMEDIATION
 DEVELOPMENT • ENVIRONMENTAL

RECEIVED

JUN 15 1998

DNR - WED

June 12, 1998

Ms. Wendy Anderson
 Wisconsin Department of Natural Resources
 West Central Region
 P.O. Box 4001
 Eau Claire, WI 54702-4001

Re: Former Wittig UST Sites: Wittig Residence and Wittig Motel in Wyeville, WI and
 Former Wittig Company General Offices in Tomah, WI

Dear Wendy:

This letter is in reference to your verbal request of June 4, and our telephone discussions of June 5 and June 11, 1998, in which you inquired about the status of the three above referenced former Wittig underground storage tank (UST) sites. For your information, enclosed are copies of tables, analytical reports and site layout/soil boring location maps for the three sites. This work was completed as part of a Phase II Environmental Site Assessment (ESA) of ^{NINE} eight former Wittig UST sites, completed the week of July 25, 1994 and reported in September 1994. During the Phase II ESA, there was no subsurface work completed at the, then active, Wittig Spur Gasoline Station site.

We have not performed any further work at the referenced sites since the underground storage tanks were removed. Other than the pre-UST removal Phase II ESA direct-push boring soil and groundwater assessment completed by MSA, there were no UST closure site assessments completed at the time the USTs were removed by METCO, Inc. on May 22, 1995 (Wittig General Office) and on ~~January 2, 1996~~ ^{DECEMBER 5, 1995} (Wittig residence and motel).

If you have additional questions regarding this information, or about the sites in general, please call me at (608)356-2771 or Michael Moen, Attorney for the Walter Wittig Estate, at (608)784-3810.

Sincerely,

MSA Professional Services, Inc.

Brad R. Kraemer, P.G.
 Senior Hydrogeologist

BRK:vk

Enc.

cc: Michael Moen and Daniel Lilly, Moen Sheehan Meyer, Ltd.

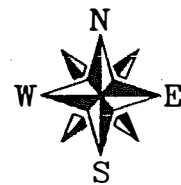
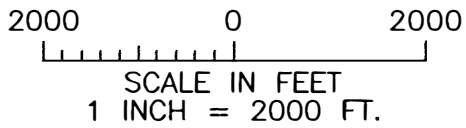
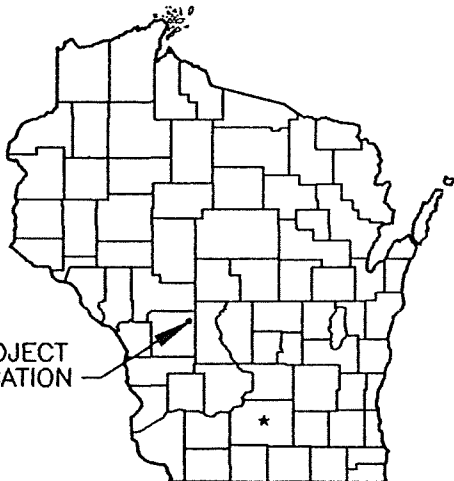
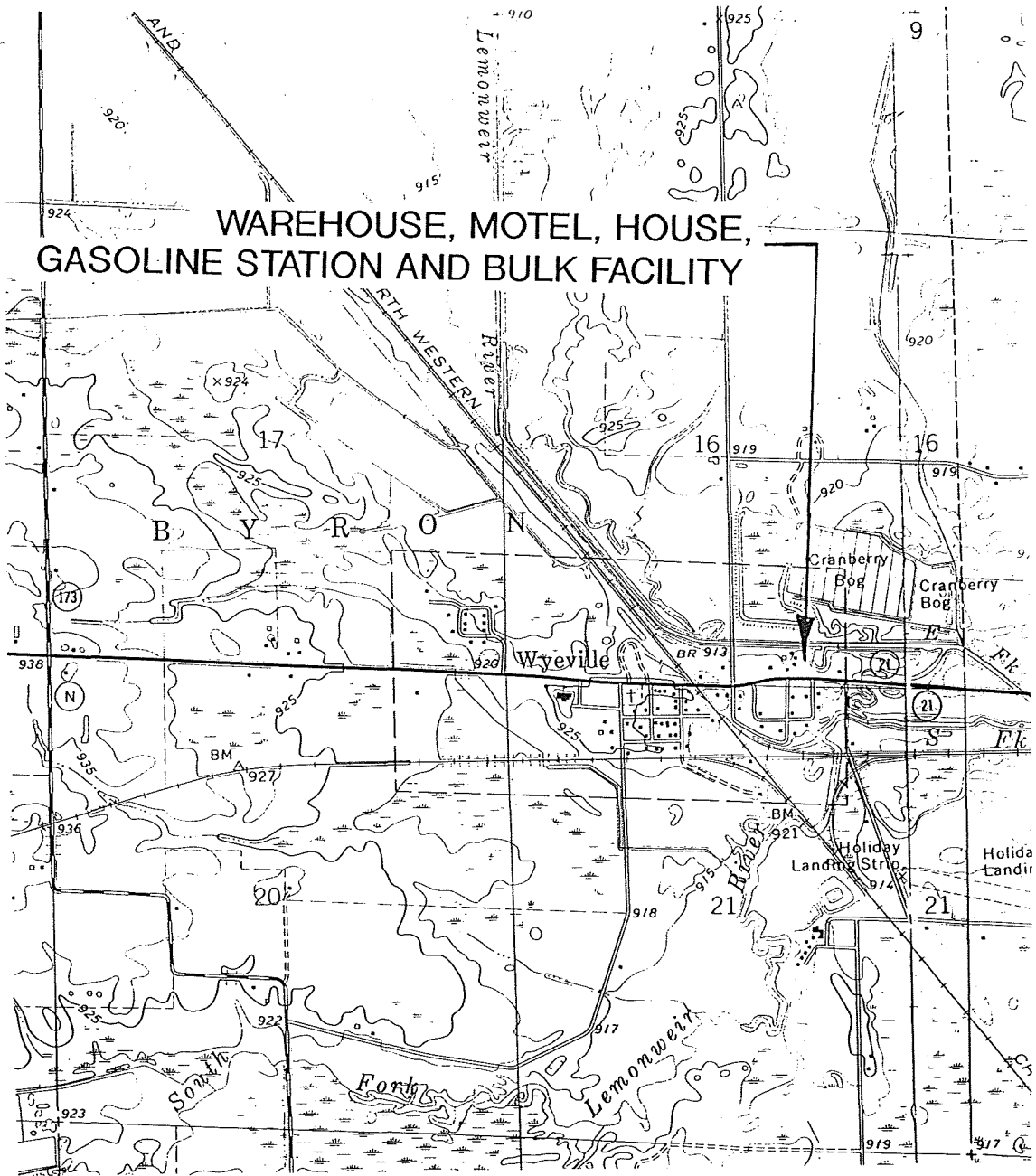

Shennington/Wyeville Quadrangle
 Wisconsin—Monroe Co.
 7.5 Minute Series (Topographic)

FIGURE 2
SITE LOCATION MAP
WAREHOUSE, MOTEL, HOUSE, GASOLINE STATION
AND BULK FACILITY IN THE VILLAGE OF WYEVILLE

WITTIG OIL CO. PROPERTIES
 TOWN OF BYRON, WISCONSIN



EAST BR. LEMONWEIR RIVER

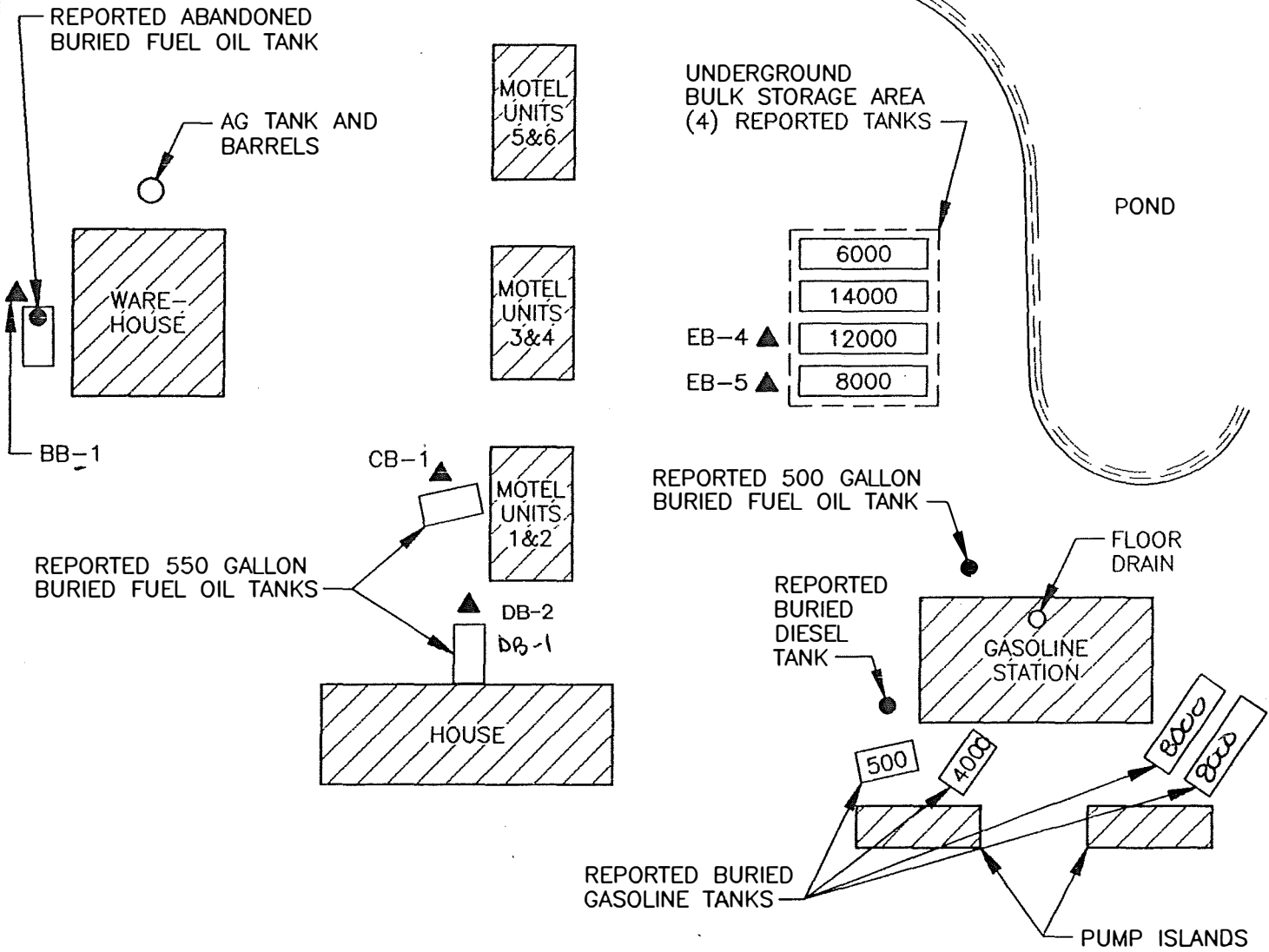

HWY 21



NO SCALE

FIGURE 6A
SITE LAYOUT AND BORING LOCATION MAP
FOR THE WAREHOUSE, MOTEL, HOUSE,
GASOLINE STATION AND BULK FACILITY
IN THE VILLAGE OF WYVILLE

WITTIG OIL CO. PROPERTIES
VILLAGE OF WYVILLE, WISCONSIN



Modified by MSA (1998)

EAST BR. LEMONWEIR RIVER

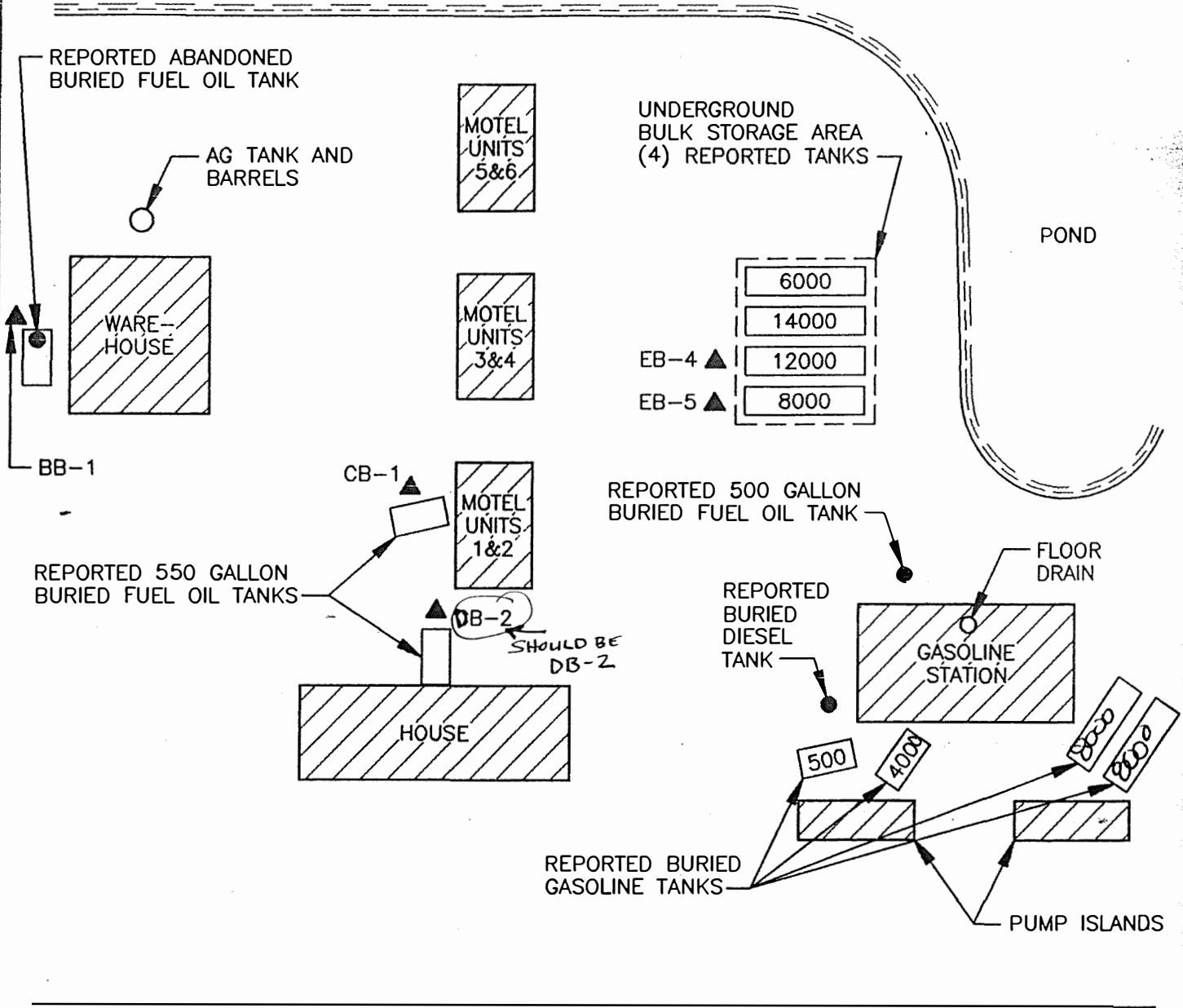

HWY 21



NO SCALE

FIGURE 6
SITE LAYOUT AND BORING LOCATION MAP
FOR THE WAREHOUSE, MOTEL, HOUSE,
GASOLINE STATION AND BULK FACILITY
IN THE VILLAGE OF WYVILLE

WITTIG OIL CO. PROPERTIES
VILLAGE OF WYVILLE, WISCONSIN



FORMER WITTIG BULK UST CHART
(REMOVED 12/95)

- A - 6,000 GALLON LEADED GASOLINE
- B - 14,000 GALLON UNLEADED GASOLINE
- C - 12,000 GALLON FUEL OIL
- D - 8,000 GALLON FUEL OIL
- *E - 500 GALLON HEATING OIL

*UST PART OF SPUR STATION BUT REMOVED AS PART OF BULK SITE UST CLOSURE.

FORMER WITTIG SPUR STATION UST CHART
(REMOVED 10/96)

- 1 - 8,000 GALLON UNLEADED GASOLINE
- 2 - 8,000 GALLON UNLEADED GASOLINE
- 3 - 4,000 GALLON UNLEADED GASOLINE
- 4 - 500 GALLON FUEL OIL
- 5 - 500 GALLON LEADED GASOLINE

LEGEND

- WW6 BULK SITE UST CLOSURE SOIL SAMPLE LOCATION
- D1 SPUR STATION UST CLOSURE SOIL SAMPLE LOCATION
- POWER POLE
- SIGN
- WATER SUPPLY WELL LOCATION
- MANHOLE
- GRINDER STATION
- OHE- OVERHEAD ELECTRIC
- T- UNDERGROUND TELEPHONE
- SAN- SANITARY SEWER

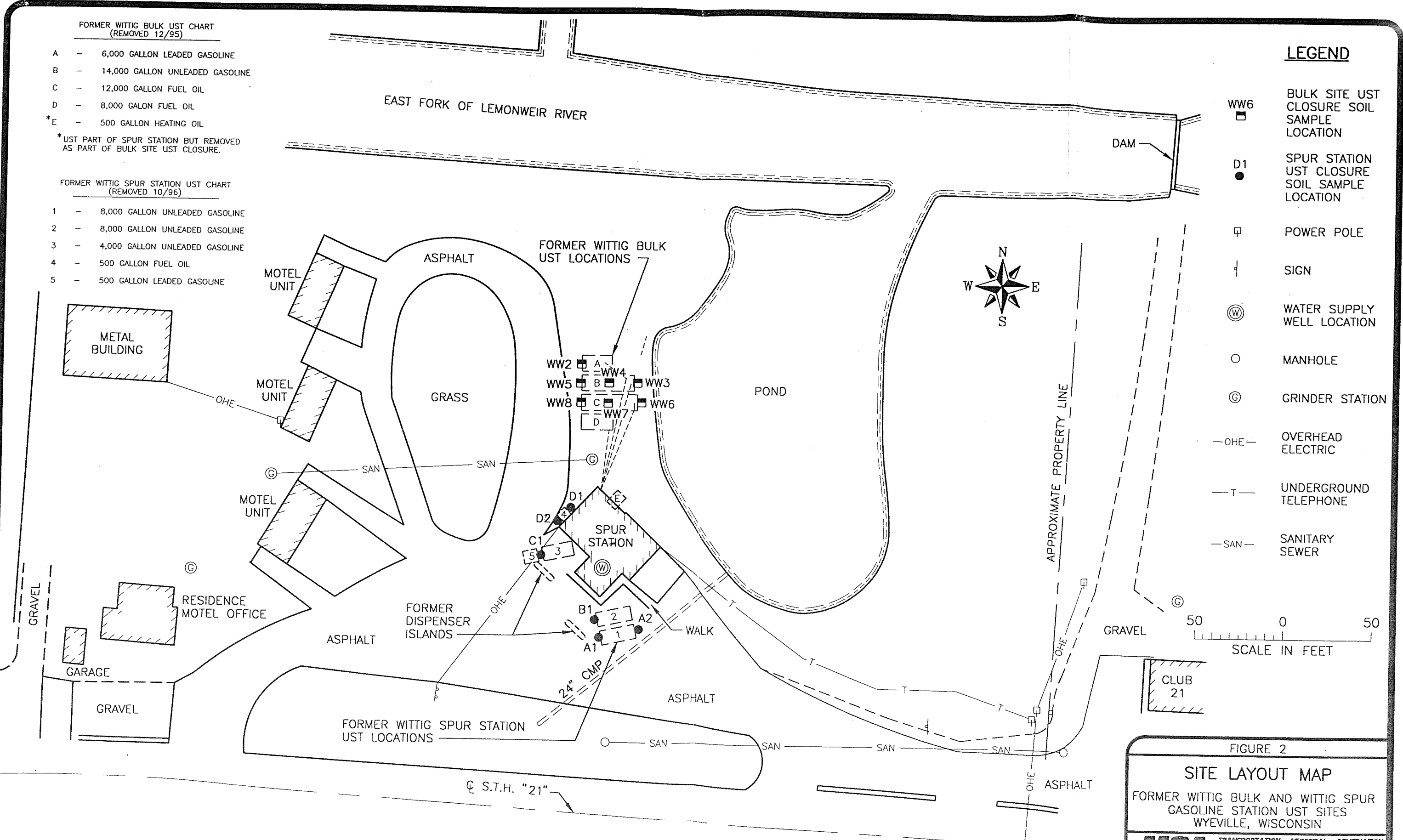

FIGURE 2
SITE LAYOUT MAP
FORMER WITTIG BULK AND WITTIG SPUR
GASOLINE STATION UST SITES
WYEVILLE, WISCONSIN

MSA TRANSPORTATION • MUNICIPAL • REMEDIATION
DEVELOPMENT • ENVIRONMENTAL
1230 South Boulevard Baraboo, WI 53913
608-356-2771 1-800-362-4505 Fax: 608-356-2770

PROFESSIONAL SERVICES

DRAWN BY RHM DATE 5-15-98 SHEET _____ of _____
CHECKED BY _____ SCALE AS NOTED FILE NO. 212537DB

FORMER WITTIG BULK UST CHART
(REMOVED 12/95)

- A - 6,000 GALLON LEADED GASOLINE
- B - 14,000 GALLON UNLEADED GASOLINE
- C - 12,000 GALLON FUEL OIL
- D - 8,000 GALON FUEL OIL
- E - 500 GALLON HEATING OIL

FORMER WITTIG SPUR STATION UST CHART
(REMOVED 10/96)

- 1 - 8,000 GALLON UNLEADED GASOLINE
- 2 - 8,000 GALLON UNLEADED GASOLINE
- 3 - 4,000 GALLON UNLEADED GASOLINE
- 4 - 500 GALLON FUEL OIL
- 5 - 500 GALLON LEADED GASOLINE

LEGEND

- B1 ● SOIL BORING
- MW1 ⊕ MONITORING WELL
- GP1 ▲ GEOPROBE SOIL BORING - SEPT. 1996
- EB2 ● GEOPROBE SOIL BORING - PHASE 2 ESA JULY 1994

NOTE:
FOR ADDITIONAL NOTES AND LEGEND, REFER TO FIGURE 2.

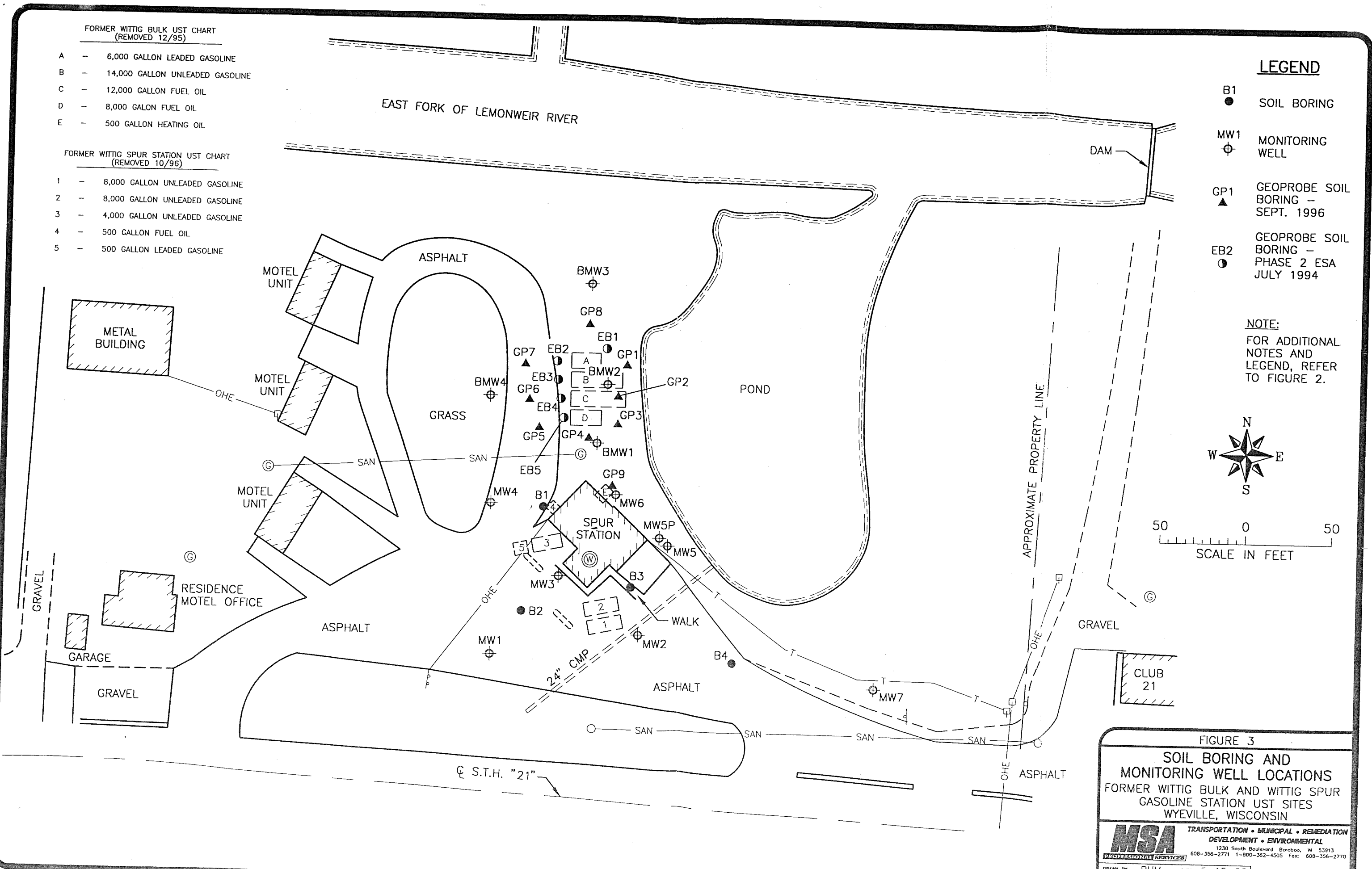
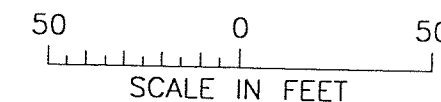
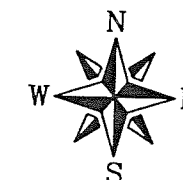

FIGURE 3
SOIL BORING AND MONITORING WELL LOCATIONS
FORMER WITTIG BULK AND WITTIG SPUR GASOLINE STATION UST SITES
WYEVILLE, WISCONSIN

MSA TRANSPORTATION • MUNICIPAL • REMEDIATION
DEVELOPMENT • ENVIRONMENTAL
1230 South Boulevard Baraboo, WI 53913
608-356-2771 1-800-362-4505 Fax: 608-356-2770

DRAWN BY RHM DATE 5-15-98 SHEET _____ of _____
CHECKED BY _____ SCALE AS NOTED FILE NO. 212537CC

TABLE 2a

Summary of Chemical Analysis^a
 Wittig Oil Company Warehouse, Motel, House, Bulk Plant, and Gasoline
 Station on Highway 21 in Wyeville

	Warehouse		Motel		House		Gasoline Station and Bulk Facility		
Location/Name	BB-1	BB-1	CB-1	CB-1	DB-2	DB-2	EB-4	EB-5	EB-5
Depth		1' - 3'	5' - 7'		3' - 5'		5' - 7'	5' - 7'	
Material	Groundwater	Soil	Soil	Groundwater	Soil	Groundwater	Soil	Soil	Groundwater
Methyl t-Butyl Ether	---	---	---	---	---	---	<.055	<.056	
Benzene	---	---	---	---	---	---	<.055	<.056	
Toluene	---	---	---	---	---	---	<.055	<.056	
Ethylbenzene	---	---	---	---	---	---	<.055	<.056	
m & p-Xylene	---	---	---	---	---	---	0.21	<.056	
o-Xylene	---	---	---	---	---	---	0.097	<.056	
1,3,5-Trimethylbenzene	---	---	---	---	---	---	0.079	<.056	
1,2,4-Trimethylbenzene	---	---	---	---	---	---	0.23	<.056	
Gasoline Range Organics	---	---	---	---	---	---	14	<1.1	
Diesel Range Organics	18,000	2,900	<5.6	160	270	450	400	240	5,200
Extraction Date GRO/PVOC	---	---	---	---	---	---	7/29/94	---	---
Analysis Date GRO/PVOC	---	---	---	---	---	---	7/31/94		
Extraction Date DRO	8/1/94	7/27/94	7/27/94	7/28/94	7/27/94	8/1/94	7/27/94	7/27/94	8/1/94
Analysis Date DRO	8/8/94	8/10/94	8/9/94	8/3/94	8/10/94	8/7/94	8/11/94	8/11/94	8/8/94

Soil sample results are in mg/Kg.
 Groundwater sample results are in ug/L.
 --- Parameter not analyzed.

Modified by MSA (1998) from Table 2 in 1994 Phase II ESA

TABLE 2

Summary of Chemical Analysis ,
Wittig Oil Company Warehouse, Motel, House, Bulk Plant, and Gasoline
Station on Highway 21 in Wyeville

	Warehouse		Motel		House		Gasoline Station and Bulk Facility		
Location/Name	BB-1	BB-2 ^{BB-1}	CB-1	CB-1	DB-2	DB-2	EB-4 ^{EB-4} BE-4	EB-5 ^{EB-5} BE-5	EB-5 ^{EB-5} BE-5
Depth		1' - 3'	5' - 7'		3' - 5'		5' - 7'	5' - 7'	
Material	Groundwater	Soil	Soil	Groundwater	Soil	Groundwater	Soil	Soil	Groundwater
Methyl t-Butyl Ether	---	---	---	---	---	---	<.055	<.056	
Benzene	---	---	---	---	---	---	<.055	<.056	
Toluene	---	---	---	---	---	---	<.055	<.056	
Ethylbenzene	---	---	---	---	---	---	<.055	<.056	
m & p-Xylene	---	---	---	---	---	---	0.21	<.056	
o-Xylene	---	---	---	---	---	---	0.097	<.056	
1,3,5-Trimethylbenzene	---	---	---	---	---	---	0.079	<.056	
1,2,4-Trimethylbenzene	---	---	---	---	---	---	0.23	<.056	
Gasoline Range Organics	---	---	---	---	---	---	14	<1.1	
Diesel Range Organics	18,000	2,900	<5.6	160	270	450	400	240	5,200
Extraction Date GRO/PVOC	---	---	---	---	---	---	7/29/94	---	---
Analysis Date GRO/PVOC	---	---	---	---	---	---	7/31/94		
Extraction Date DRO	8/1/94	7/27/94	7/27/94	7/28/94	7/27/94	8/1/94	7/27/94	7/27/94	8/1/94
Analysis Date DRO	8/8/94	8/10/94	8/9/94	8/3/94	8/10/94	8/7/94	8/11/94	8/11/94	8/8/94

Soil sample results are in mg/Kg.
Groundwater sample results are in ug/L.
--- Parameter not analyzed.

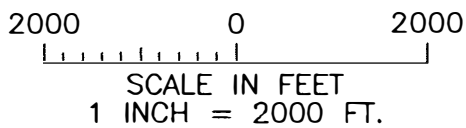
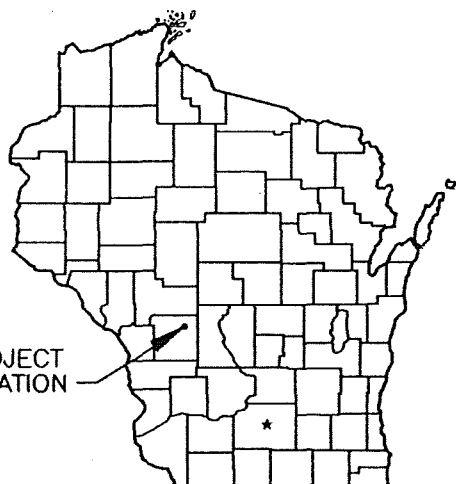
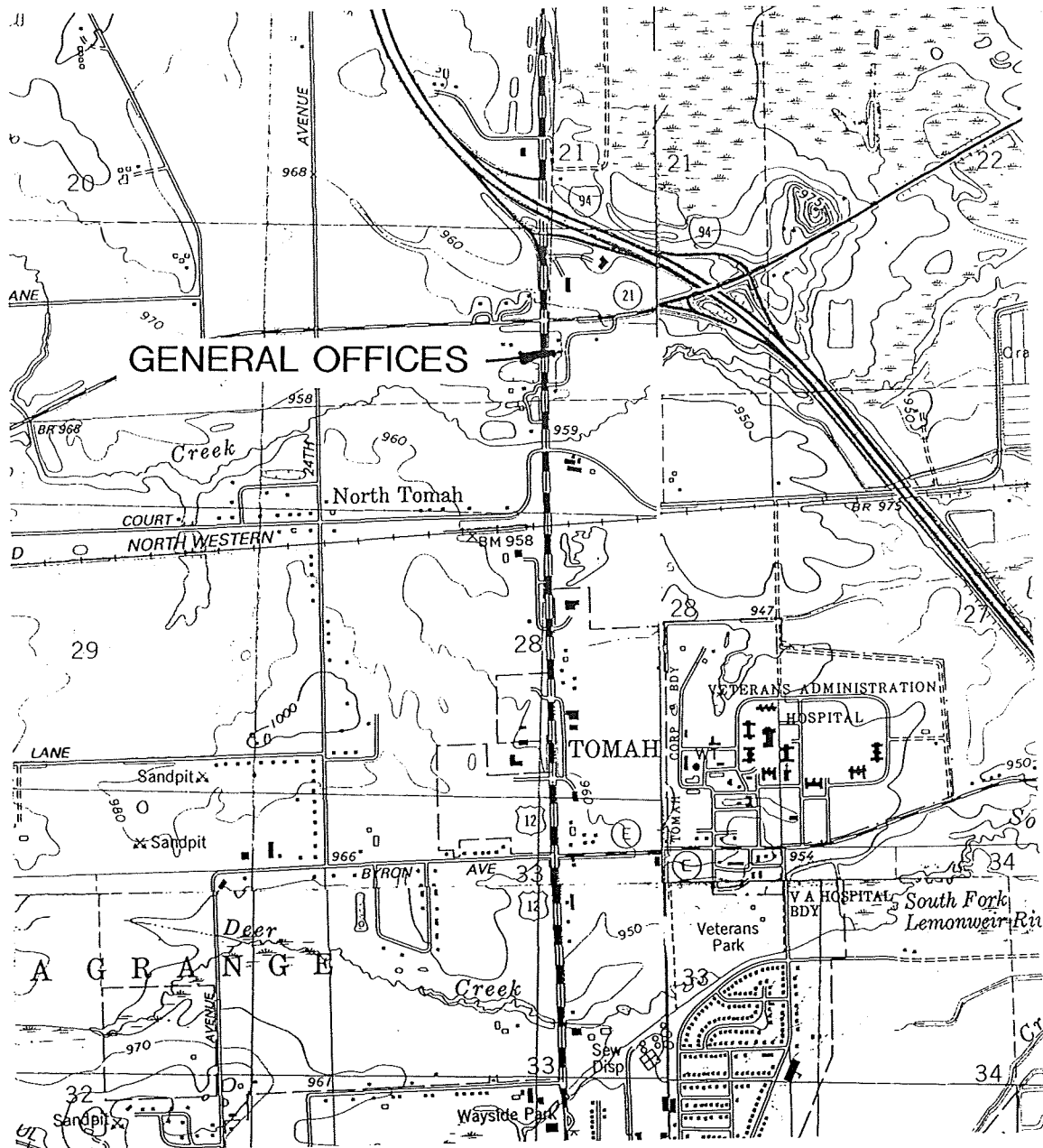

Tunnel City, Wyeville,
 Tomah and Oakdale Quadrangles
 Wisconsin—Monroe Co.
 7.5 Minute Series (Topographic)

FIGURE 3
SITE LOCATION MAP
GENERAL OFFICES IN THE CITY OF TOMAH

WITTIG OIL CO. PROPERTIES
 TOWN OF BYRON, WISCONSIN



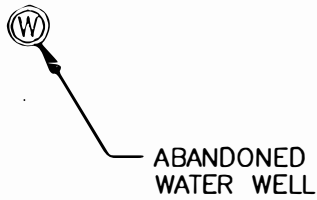
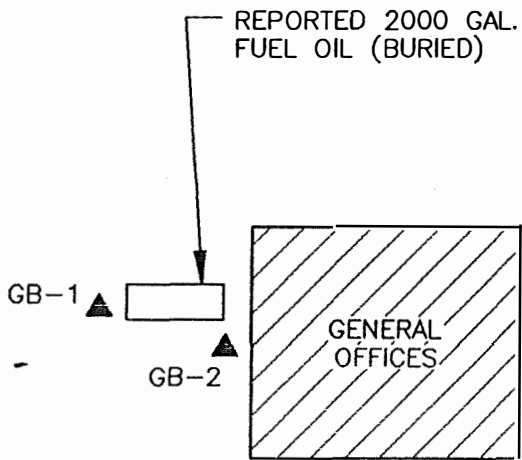

WITTIG ROAD



NO SCALE

FIGURE 7
SITE LAYOUT AND BORING LOCATION MAP
FOR THE GENERAL OFFICE PROPERTY
IN TOMAH

WITTIG OIL CO. PROPERTIES
TOMAH, WISCONSIN



TABLE 3

**Summary of Chemical Analysis
Wittig Oil Company General Offices
On
Wittig Road in Tomah**

Location/Name	GB-1	GB1	GB2
Depth	5' -7'	---	5' - 7'
Material	Soil	Groundwater	---
Methyl t-Butyl Ether	---	---	---
Benzene	---	---	---
Toluene	---	---	---
Ethylbenzene	---	---	---
m & p-Xylene	---	---	---
o-Xylene	---	---	---
1,3,5-Trimethylbenzene	---	---	---
1,2,4-Trimethylbenzene	---	---	---
Gasoline Range Organics	---	---	---
Diesel Range Organics	<5.5	150	<5.6
Extraction Date GRO/PVOC	7/27/94	8/1/94	7/27/94
Analysis Date GRO/PVOC	8/9/94	8/7/94	8/9/94
Extraction Date DRO	---	---	---
Analysis Date DRO	---	---	---

Soil sample results are in mg/Kg.
Groundwater sample results are in ug/L.
--- Parameter not analyzed.



Laboratory Services
 1230 Lange Ct.
 Baraboo, WI 53913
 608-356-2760

ANALYTICAL REPORT

MID-STATE ASSOCIATES

1230 SOUTH BLVD.
 BARABOO, WI 53913

Client I.D. No.:2904
 Work Order No.:9407000642
 Project Name:WITTIG OIL
 Project Number:212063
 Report Date: 08/26/94
 Date Recieved: 07/27/94
 Arrival Temperature:ON ICE

Sample I.D. #:78220 **Sample Description:**TRIP BLANK

Date Sampled:07/25/94

<u>Analyte</u>	<u>Result</u>	<u>Units</u>
Methyl t-Butyl Ether	<1.0	ug/L
Benzene	<1.0	ug/L
Toluene	<1.0	ug/L
Ethylbenzene	<1.0	ug/L
m & p- Xylene	<1.0	ug/L
o-Xylene	<1.0	ug/L
1,3,5-Trimethylbenzene	<1.0	ug/L
1,2,4-Trimethylbenzene	<1.0	ug/L
Gasoline Range Organics	<100	ug/L
Analysis Date GRO/PVOC	07/28/94	

Sample I.D. #:78221 **Sample Description:**MeOH BLANK

Date Sampled:07/25/94

<u>Analyte</u>	<u>Result</u>	<u>Units</u>
Methyl t-Butyl Ether	<0.050	mg/Kg
Benzene	<0.050	mg/Kg
Toluene	<0.050	mg/Kg
Ethylbenzene	<0.050	mg/Kg
m & p- Xylene	<0.050	mg/Kg
o-Xylene	<0.050	mg/Kg
1,3,5-Trimethylbenzene	<0.050	mg/Kg
1,2,4-Trimethylbenzene	<0.050	mg/Kg
Gasoline Range Organics	<1.0	mg/Kg
Extraction Date GRO/PVOC	08/01/94	
Analysis Date -- WDNR Modified GRO/PVOC	08/02/94	

Sample I.D. #:78222 **Sample Description:**EB-4 5',7'

Date Sampled:07/25/94

<u>Analyte</u>	<u>Result</u>	<u>Units</u>
Diesel Range Organics- WDNR Modified DRO	400	mg/Kg
Extraction Date DRO	07/27/94	
Analysis Date DRO	08/11/94	
Methyl t-Butyl Ether	<0.055	mg/Kg
Benzene	<0.055	mg/Kg
Toluene	<0.055	mg/Kg
Ethylbenzene	<0.055	mg/Kg
m & p- Xylene	0.21	mg/Kg
o-Xylene	0.097	mg/Kg
1,3,5-Trimethylbenzene	0.079	mg/Kg
1,2,4-Trimethylbenzene	0.23	mg/Kg
Gasoline Range Organics	14	mg/Kg

Sample contains fractions heavier than gasoline range organic hydrocarbons.

Submitted By: _____



Laboratory Services
1230 Lange Ct.
Baraboo, WI 53913
608-356-2760

ANALYTICAL REPORT

MID-STATE ASSOCIATES

1230 SOUTH BLVD.
BARABOO, WI 53913

Client I.D. No.:2904
Work Order No.:9407000642
Project Name:WITTIG OIL
Project Number:212063
Report Date: 08/26/94
Date Recieved: 07/27/94
Arrival Temperature:ON ICE

Sample I.D. #:78222 **Sample Description:EB-4 5',7'** **Date Sampled:07/25/94**

<u>Analyte</u>	<u>Result</u>	<u>Units</u>
Extraction Date GRO/PVOC	07/29/94	
Analysis Date GRO/PVOC	07/31/94	
LUST Total Percent Solids--EPA 5030	90.4	%

Sample I.D. #:78223 **Sample Description:CB-1 5',7'** **Date Sampled:07/25/94**

<u>Analyte</u>	<u>Result</u>	<u>Units</u>
Diesel Range Organics- WDNR Modified DRO	< 5.6	mg/Kg
Extraction Date DRO	07/27/94	
Analysis Date DRO	08/09/94	
LUST Total Percent Solids--EPA 5030	90.0	%

Sample I.D. #:78224 **Sample Description:DB-2 3',5'** **Date Sampled:07/25/94**

<u>Analyte</u>	<u>Result</u>	<u>Units</u>
Diesel Range Organics- WDNR Modified DRO	270	mg/Kg
Extraction Date DRO	07/27/94	
Analysis Date DRO	08/10/94	
LUST Total Percent Solids--EPA 5030	88.0	%

Sample I.D. #:78225 **Sample Description:BB-1 1',3'** **Date Sampled:07/25/94**

<u>Analyte</u>	<u>Result</u>	<u>Units</u>
Diesel Range Organics- WDNR Modified DRO	2900	mg/Kg
Extraction Date DRO	07/27/94	
Analysis Date DRO	08/10/94	
LUST Total Percent Solids--EPA 5030	88.0	%

Sample I.D. #:78226 **Sample Description:CB-1 GROUNDWATER** **Date Sampled:07/25/94**

<u>Analyte</u>	<u>Result</u>	<u>Units</u>
Diesel Range Organics-WDNR Modified DRO	160	ug/L
Extraction Date DRO	07/28/94	
Analysis Date DRO	08/03/94	

Submitted By: _____



Laboratory Services
 1230 Lange Ct.
 Baraboo, WI 53913
 608-356-2760

ANALYTICAL REPORT

MID-STATE ASSOCIATES

1230 SOUTH BLVD.
 BARABOO, I 53913

Client I.D. No.:2904
 Work Order No.:9407000642
 Project Name:WITTIG OIL
 Project Number:212063
 Report Date: 08/26/94
 Date Recieved: 07/27/94
 Arrival Temperature:ON ICE

Sample I.D. #:78227 **Sample Description:DB-2 GROUNDWATER** **Date Sampled:07/25/94**

<u>Analyte</u>	<u>Result</u>	<u>Units</u>
Diesel Range Organics-WDNR Modified DRO	450	ug/L
Extraction Date DRO	08/01/94	
Analysis Date DRO	08/07/94	

Sample I.D. #:78228 **Sample Description:BB-1 GROUNDWATER** **Date Sampled:07/25/94**

<u>Analyte</u>	<u>Result</u>	<u>Units</u>
Diesel Range Organics-WDNR Modified DRO	18000	ug/L
Extraction Date DRO	08/01/94	
Analysis Date DRO	08/08/94	

Sample I.D. #:78229 **Sample Description:EB-5 5',7'** **Date Sampled:07/25/94**

<u>Analyte</u>	<u>Result</u>	<u>Units</u>
Diesel Range Organics- WDNR Modified DRO	240	mg/Kg
Extraction Date DRO	07/27/94	
Analysis Date DRO	08/11/94	
Methyl t-Butyl Ether	< 0.056	mg/Kg
Benzene	< 0.056	mg/Kg
Toluene	< 0.056	mg/Kg
Ethylbenzene	< 0.056	mg/Kg
m & p- Xylene	< 0.056	mg/Kg
o-Xylene	< 0.056	mg/Kg
1,3,5-Trimethylbenzene	< 0.056	mg/Kg
1,2,4-Trimethylbenzene	< 0.056	mg/Kg
Gasoline Range Organics	< 1.1	mg/Kg
Sample contains fractions heavier than gasoline range organic hydrocarbons.		
Extraction Date GRO/PVOC	07/29/94	
Analysis Date GRO/PVOC	07/30/94	
LUST Total Percent Solids--EPA 5030	89.3	%

Sample I.D. #:78230 **Sample Description:EB-5 GROUNDWATER** **Date Sampled:07/25/94**

<u>Analyte</u>	<u>Result</u>	<u>Units</u>
Diesel Range Organics-WDNR Modified DRO	5200	ug/L
Extraction Date DRO	08/01/94	
Analysis Date DRO	08/08/94	
Methyl t-Butyl Ether	4.0	ug/L
Benzene	< 1.0	ug/L
Toluene	< 1.0	ug/L

Submitted By: _____



Laboratory Services
 1230 Lange Ct.
 Baraboo, WI 53913
 608-356-2760

ANALYTICAL REPORT

MID-STATE ASSOCIATES
 1230 SOUTH BLVD.
 BARABOO, WI 53913

Client I.D. No.:2904
 Work Order No.:9407000642
 Project Name:WITTIG OIL
 Project Number:212063
 Report Date: 08/26/94
 Date Recieved: 07/27/94
 Arrival Temperature:ON ICE

Sample I.D. #: 78230	Sample Description: EB-5 GROUNDWATER	Date Sampled: 07/25/94
Analyte	Result	Units
Ethylbenzene	<1.0	ug/L
m & p- Xylene	<1.0	ug/L
o-Xylene	<1.0	ug/L
1,3,5-Trimethylbenzene	<1.0	ug/L
1,2,4-Trimethylbenzene	<1.0	ug/L
Gasoline Range Organics	<100	ug/L
Analysis Date--WDNR Modified GRO/PVOC	07/29/94	

Sample I.D. #: 78231	Sample Description: AB-1 7',9'	Date Sampled: 07/26/94
Analyte	Result	Units
Methyl t-Butyl Ether	<0.052	mg/Kg
Benzene	<0.052	mg/Kg
Toluene	<0.052	mg/Kg
Ethylbenzene	<0.052	mg/Kg
m & p- Xylene	<0.052	mg/Kg
o-Xylene	<0.052	mg/Kg
1,3,5-Trimethylbenzene	<0.052	mg/Kg
1,2,4-Trimethylbenzene	<0.052	mg/Kg
Gasoline Range Organics	<1.0	mg/Kg
Extraction Date GRO/PVOC	07/29/94	
Analysis Date GRO/PVOC	07/30/94	
LUST Total Percent Solids--EPA 5030	96.2	%

Sample I.D. #: 78232	Sample Description: AB-2 7',7.5'	Date Sampled: 07/26/94
Analyte	Result	Units
Methyl t-Butyl Ether	<0.053	mg/Kg
Benzene	<0.053	mg/Kg
Toluene	<0.053	mg/Kg
Ethylbenzene	<0.053	mg/Kg
m & p- Xylene	<0.053	mg/Kg
o-Xylene	<0.053	mg/Kg
1,3,5-Trimethylbenzene	<0.053	mg/Kg
1,2,4-Trimethylbenzene	<0.053	mg/Kg
Gasoline Range Organics	<1.1	mg/Kg
Extraction Date GRO/PVOC	07/29/94	
Analysis Date GRO/PVOC	07/30/94	
LUST Total Percent Solids--EPA 5030	95.2	%

Submitted By: _____



Laboratory Services
1230 Lange Ct.
Baraboo, WI 53913
608-356-2760

ANALYTICAL REPORT

MID-STATE ASSOCIATES

1230 SOUTH BLVD.
BARABOO, WI 53913

Client I.D. No.:2904
Work Order No.:9407000642
Project Name:WITTIG OIL
Project Number:212063
Report Date: 08/26/94
Date Recieved: 07/27/94
Arrival Temperature:ON ICE

Sample I.D. #:78233 **Sample Description:AB-3 7',9'** **Date Sampled:07/26/94**

<u>Analyte</u>	<u>Result</u>	<u>Units</u>
Diesel Range Organics- WDNR Modified DRO	< 5.2	mg/Kg
Extraction Date DRO	07/27/94	
Analysis Date DRO	08/09/94	
LUST Total Percent Solids--EPA 5030	96.6	%

Sample I.D. #:78234 **Sample Description:AB-4 7',8.5'** **Date Sampled:07/26/94**

<u>Analyte</u>	<u>Result</u>	<u>Units</u>
Diesel Range Organics- WDNR Modified DRO	< 5.6	mg/Kg
Extraction Date DRO	07/27/94	
Analysis Date DRO	08/09/94	
LUST Total Percent Solids--EPA 5030	89.9	%

Sample I.D. #:78235 **Sample Description:AB-5 7',9'** **Date Sampled:07/26/94**

<u>Analyte</u>	<u>Result</u>	<u>Units</u>
Diesel Range Organics- WDNR Modified DRO	< 5.3	mg/Kg
Extraction Date DRO	07/27/94	
Analysis Date DRO	08/09/94	
LUST Total Percent Solids--EPA 5030	94.9	%

Sample I.D. #:78236 **Sample Description:AB-6 7',8'** **Date Sampled:07/26/94**

<u>Analyte</u>	<u>Result</u>	<u>Units</u>
Diesel Range Organics- WDNR Modified DRO	< 5.2	mg/Kg
Extraction Date DRO	07/27/94	
Analysis Date DRO	08/09/94	
LUST Total Percent Solids--EPA 5030	95.5	%

Sample I.D. #:78237 **Sample Description:GB-1 5',7'** **Date Sampled:07/26/94**

<u>Analyte</u>	<u>Result</u>	<u>Units</u>
Diesel Range Organics- WDNR Modified DRO	< 5.5	mg/Kg
Extraction Date DRO	07/27/94	
Analysis Date DRO	08/09/94	
LUST Total Percent Solids--EPA 5030	91.6	%

Submitted By: _____



Laboratory Services
 1230 Lange Ct.
 Baraboo, WI 53913
 608-356-2760

ANALYTICAL REPORT

MID-STATE ASSOCIATES

1230 SOUTH BLVD.
 BARABOO, W 53913

Client I.D. No.:2904
 Work Order No.:9407000642
 Project Name:W TTIG OIL
 Project Number:212063
 Report Date: 08/26/94
 Date Recieved: 07/27/94
 Arrival Temperature:ON ICE

Sample I.D. #:78238 **Sample Description:GB-1 GROUNDWATER** **Date Sampled:07/26/94**

<u>Analyte</u>	<u>Result</u>	<u>Units</u>
Diesel Range Organics-WDNR Modified DRO	150	ug/L
Extraction Date DRO	08/01/94	
Analysis Date DRO	08/07/94	

Sample I.D. #:78239 **Sample Description:GB-2 5',7'** **Date Sampled:07/26/94**

<u>Analyte</u>	<u>Result</u>	<u>Units</u>
Diesel Range Organics- WDNR Modified DRO	< 5.6	mg/Kg
Extraction Date DRO	07/27/94	
Analysis Date DRO	08/09/94	
LUST Total Percent Solids--EPA 5030	88.9	%

Sample I.D. #:78240 **Sample Description:HB-5 3',5'** **Date Sampled:07/27/94**

<u>Analyte</u>	<u>Result</u>	<u>Units</u>
Diesel Range Organics- WDNR Modified DRO	7100	mg/Kg
Sample contains fractions lighter than diesel range organic hydrocarbons.		
Extraction Date DRO	07/27/94	
Analysis Date DRO	08/10/94	
LUST Total Percent Solids--EPA 5030	86.7	%

Sample I.D. #:78241 **Sample Description:HB-5 GROUNDWATER** **Date Sampled:07/27/94**

<u>Analyte</u>	<u>Result</u>	<u>Units</u>
Diesel Range Organics-WDNR Modified DRO	57000	ug/
Sample contains fractions lighter than diesel range organic hydrocarbons.		
Extraction Date DRO	08/01/94	
Analysis Date DRO	08/08/94	

Comments for entire Work Order: None

Submitted By: _____



Chain of Custody:
 MID-STATE ASSOCIATES, INC.
 1-800-228-3012

1250 Lange Court 642
 Baraboo, WI 53913
 (608) 356-2760
 FAX: (608) 356-2766

SAMPLE COLLECTOR: <u>PAT TOOMEY</u>			COMPANY: <u>MSA</u>			TELEPHONE NUMBER (INCLUDE AREA CODE):					
PROJECT NUMBER: <u>212063</u>			PROJECT NAME: <u>Wittig Oil Co.</u>								
I HEREBY CERTIFY THAT I RECEIVED, PROPERLY HANDLED, AND DISPOSED OF THESE SAMPLES AS NOTED BELOW.											
INVOICE ADDRESS (MUST BE COMPLETED): <u>Tim Melka</u>					REPORT ADDRESS (MUST BE COMPLETED):						
DATE & TIME OF RELINQUISHMENT: <u>7-22-94 2:07</u>		RELINQUISHED BY (SIGNATURE): <u>[Signature]</u>				RECEIVED BY (SIGNATURE):			DATE & TIME OF RECEPTION:		
DATE & TIME OF RELINQUISHMENT:		RELINQUISHED BY (SIGNATURE):				RECEIVED BY LABORATORY (SIGNATURE): <u>[Signature]</u>			DATE & TIME OF RECEPTION: <u>7/27/94 3:00</u>		
FIELD ID NUMBER	DATE COLLECTED	TIME COLLECTED	SAMPLE		PRESERV. TYPE	LOCATION/DESCRIPTION	ANALYSIS TYPE	LAB ID.	NO. TYPE OF CONTAINERS	SAMPLE CONDITION	
			TYPE	DEVICE							
	7-25-94	9:30	H ₂ O		HCL	TRIP Blank	GR0/PuOC	78220			
	7-25-94	9:45	meoh		meoh	meoh Blank	GR0/PuOC	78221			
		10:10	soil		meoh	EB-1 5'7'	GR0/PuOC		5		
		11:00	soil		meoh	EB-2 5'7'	GR0/PuOC		5		
		11:45	soil		meoh	EB-3 5'7'	GR0/PuOC		5		
		12:30	soil		meoh	EB-4 5'7'	GR0/PuOC DRO	78222	5		
		1:46	soil			CB-1 5'7'	DRO	78223	3		
		2:00	H ₂ O		HCL	CB-1 Groundwater	DRO	78226	2		
		3:00	soil			DB-2 3'5'	DRO	78224	3		
	7-25-94	3:30	H ₂ O			DD-2 Groundwater	DRO	78227	2		
LABORATORY USE											
LABORATORY SHOULD DISPOSE OF UNUSED PORTION OF SAMPLE:					SPLIT SAMPLES:					SAMPLE CONDITION KEY C=CRACKED G=GOOD B=BROKEN L=LEAKING IS=IMPROPERLY SEALED AB=AIR BUBBLES	
DISPOSE <input type="checkbox"/> RETURN <input type="checkbox"/>					OFFERED: YES <input type="checkbox"/> NO <input type="checkbox"/> ACCEPTED: YES <input type="checkbox"/> NO <input type="checkbox"/> ARRIVAL TEMPERATURE OF TEMPERATURE BLANK: <u>5</u> DEG. C						
RETAIN FOR _____ DAYS OTHER _____					ACCEPTED BY: _____						



Chain of Custody:
 MID-STATE ASSOCIATES, INC.
 1-800-228-3012

1230 Lange Court
 Baraboo, WI 53913
 (608) 356-2760
 FAX: (608) 356-2766

SAMPLE COLLECTOR: PAT TOOMEY COMPANY: MSA TELEPHONE NUMBER (INCLUDE AREA CODE):

PROJECT NUMBER: 212063 PROJECT NAME: WITTYG OIL CO.

I HEREBY CERTIFY THAT I RECEIVED, PROPERLY HANDLED, AND DISPOSED OF THESE SAMPLES AS NOTED BELOW.

INVOICE ADDRESS (MUST BE COMPLETED): Tim malke REPORT ADDRESS (MUST BE COMPLETED):

DATE & TIME OF RELINQUISHMENT: 7-27-94 2:07 RELINQUISHED BY (SIGNATURE): [Signature] RECEIVED BY (SIGNATURE): DATE & TIME OF RECEPTION:

DATE & TIME OF RELINQUISHMENT: RELINQUISHED BY (SIGNATURE): RECEIVED BY LABORATORY (SIGNATURE): [Signature] DATE & TIME OF RECEPTION: 7/27/94 3:00

FIELD ID NUMBER	DATE COLLECTED	TIME COLLECTED	SAMPLE		PRESERV. TYPE	LOCATION/DESCRIPTION	ANALYSIS TYPE	LAB ID.	NO/TYPER OF CONTAINERS	SAMPLE CONDITION
			TYPE	DEVICE						
	7-25-94	3:35	soil			BB-1-1-3'-4'	DRO	78225	3	
	7-25-94	3:40	H ₂ O		HCL	BB-1 groundwater	DRO	78228	2	
	7-25-94	4:30	soil		meoc	EB-5 5, 7'	GRO/PVOC DRO	78229	5	
	7-25-94	4:40	H ₂ O		HCL	EB-5 Groundwater	GRO/PVOC DRO	78230	5	
	7-26-94	9:45	soil		meoh	AB-1 7, 9'	GRO/PVOC	78231	3	
	7-26-94	10:25	soil		meoh	AB-2 7, 7.5'	GRO/PVOC	78232	3	
	7-26-94	11:10	soil			AB-3 7, 9'	DRO	78233	5	
	7-26-94	11:35	soil			AB-4 7, 8.5'	DRO	78234	3	
	7-26-94	12:30	soil			AB-5 7, 9'	DRO	78235	3	
	7-26-94	1:10	soil			AB-6 7-8'	DRO	78236	3	

LABORATORY USE

LABORATORY SHOULD DISPOSE OF UNUSED PORTION OF SAMPLE:

DISPOSE RETURN

RETAIN FOR _____ DAYS OTHER

SPLIT SAMPLES:
 OFFERED: YES NO
 ACCEPTED: YES NO

ACCEPTED BY: _____

ARRIVAL TEMPERATURE OF TEMPERATURE BLANK: 5 DEG. C

SAMPLE CONDITION KEY:
 C=CRACKED G=GOOD
 B=BROKEN L=LEAKING
 IS=IMPROPERLY SEALED
 AB=AIR BUBBLES



Chain of Custody:
 MID-STATE ASSOCIATES, INC.
 1-800-228-3012

1230 Lange Court
 Baraboo, WI 53913
 (608) 356-2760
 FAX: (608) 356-2766

SAMPLE COLLECTOR: PAT TOOMEY COMPANY: MSA TELEPHONE NUMBER (INCLUDE AREA CODE):

PROJECT NUMBER: 212063 PROJECT NAME: Wittig oil CO.

I HEREBY CERTIFY THAT I RECEIVED, PROPERLY HANDLED, AND DISPOSED OF THESE SAMPLES AS NOTED BELOW:

INVOICE ADDRESS (MUST BE COMPLETED): Tim melka REPORT ADDRESS (MUST BE COMPLETED):

DATE & TIME OF RELINQUISHMENT: 7-27-94 2:07 RELINQUISHED BY (SIGNATURE): [Signature] RECEIVED BY (SIGNATURE): DATE & TIME OF RECEPTION:

DATE & TIME OF RELINQUISHMENT: RELINQUISHED BY (SIGNATURE): RECEIVED BY LABORATORY (SIGNATURE): [Signature] DATE & TIME OF RECEPTION: 7/27/94 3:00

FIELD ID NUMBER	DATE COLLECTED	TIME COLLECTED	SAMPLE		PRESERV. TYPE	LOCATION/DESCRIPTION	ANALYSIS TYPE	LAB I.D.	NO./TYPE OF CONTAINERS	SAMPLE CONDITION
			TYPE	DEVICE						
	7-26-94	2:35	SOIL			GB-1 5', 7'	DRC	78237	3	
	7-26-94	2:45	H ₂ O		HCL	GB-1 groundwater	DRC	78238	2	
	7-26-94	3:30	SOIL			GB-2 5', 7'	DRC	78239	3	
	7-27-94	8:00	SOIL		mech	HB-1 3', 5'	GRD/Arc		3	
	7-27-94	8:30	SOIL			HB-2 3', 5'	DRC		3	
	7-27-94	8:50	SOIL		mech	HB-3 3', 5'	GRD/Arc		3	
	7-27-94	9:15	SOIL			HB-4 3', 5'	DRC		3	
	7-27-94	9:40	SOIL			HB-5 3', 5'	DRC	78240	3	
	7-27-94	11:10	H ₂ O			HB-5 groundwater	DRC	78241	2	

LABORATORY USE

LABORATORY SHOULD DISPOSE OF UNUSED PORTION OF SAMPLE: DISPOSE RETURN

RETAIN FOR _____ DAYS OTHER

SPLIT SAMPLES: OFFERED: YES NO ACCEPTED: ES NO

ARRIVAL TEMPERATURE OF TEMPERATURE BLANK _____ DEG. C ACCEPTED BY: [Signature]

SAMPLE CONDITION KEY: C=CRACKED G=GOOD B=BROKEN L=LEAKING IS=IMPROPERLY SEALED AB=AIR BUBBLES



Chain of Custody:
 MID-STATE ASSOCIATES, INC.
 1-800-228-3012

1230 Lange Court 642
 Baraboo, WI 53913
 (608) 356-2760
 FAX: (608) 356-2766

SAMPLE COLLECTOR: <u>PAT TOOMEY</u>			COMPANY: <u>MSA</u>			TELEPHONE NUMBER (INCLUDE AREA CODE):				
PROJECT NUMBER: <u>212063</u>			PROJECT NAME: <u>WITTIG OIL CO.</u>							
I HEREBY CERTIFY THAT I RECEIVED, PROPERLY HANDLED, AND DISPOSED OF THESE SAMPLES AS NOTED BELOW:										
INVOICE ADDRESS (MUST BE COMPLETED): <u>TIM MELKA</u>					REPORT ADDRESS (MUST BE COMPLETED):					
DATE & TIME OF RELINQUISHMENT: <u>7-27-94 2:07</u>		RELINQUISHED BY (SIGNATURE): <u>[Signature]</u>			RECEIVED BY (SIGNATURE):		DATE & TIME OF RECEPTION:			
DATE & TIME OF RELINQUISHMENT:		RELINQUISHED BY (SIGNATURE):			RECEIVED BY LABORATORY (SIGNATURE): <u>[Signature]</u>		DATE & TIME OF RECEPTION: <u>7/27/94 3:00</u>			
LABORATORY USE										
FIELD ID NUMBER	DATE COLLECTED	TIME COLLECTED	SAMPLE		PRESERV. TYPE	LOCATION/DESCRIPTION	ANALYSIS TYPE	LAB I.D.	NO./TYPE OF CONTAINERS	SAMPLE CONDITION
	7-25-94	9:30	H ₂ O		HCL	TRIP Blank	GC/PUOC	78220		
	7-25-94	9:45	meoh		meoh	meoh Blank	GC/PUOC	78221		
	10:10	soil	meoh		meoh	EB-1 5' 7'	GC/PUOC	78222	5	
	11:00	soil	meoh		meoh	EB-2 5' 7'	GC/PUOC	78223	5	
	11:45	soil	meoh		meoh	EB-3 5' 7'	GC/PUOC	78224	5	
		12:30	soil		meoh	EB-4 5' 7'	GC/PUOC DRO	78222	5	
		1:40	soil			CB-1 5' 7'	DRO	78223	3	
		2:00	H ₂ O		HCL	CB-1 Groundwater	DRO	78226	2	
	✓	3:00	soil			DB-2 3' 5'	DRO	78224	3	
	7-25-94	3:30	H ₂ O			DB-2 Groundwater PAT	DRO	78227	2	
LABORATORY SHOULD DISPOSE OF UNUSED PORTION OF SAMPLE:									SAMPLE CONDITION KEY	
DISPOSE <input type="checkbox"/>			RETAIN FOR _____ DAYS			ACCEPTED BY: _____			C=CRACKED G=GOOD	
RETURN <input type="checkbox"/>			OTHER _____			ARRIVAL TEMPERATURE OF TEMPERATURE BLANK: <u>20</u> DEG. C			B=BROKEN L=LEAKING	
									IS=IMPROPERLY SEALED	
									AB=AIR BUBBLES	



Chain of Custody:
 MID-STATE ASSOCIATES, INC.
 1-800-228-3012

1230 Lange Court
 Baraboo, WI 53913
 (608) 356-2760
 FAX: (608) 356-2766

SAMPLE COLLECTOR: PAT TOOMEY COMPANY: MSA TELEPHONE NUMBER (INCLUDE AREA CODE):

PROJECT NUMBER: 212063 PROJECT NAME: Wittig oil CO.

HEREBY CERTIFY THAT I RECEIVED, PROPERLY HANDLED, AND DISPOSED OF THESE SAMPLES AS NOTED BELOW:

INVOICE ADDRESS (MUST BE COMPLETED): Tim melka REPORT ADDRESS (MUST BE COMPLETED):

DATE & TIME OF RELINQUISHMENT: 7-27-94 2:07 RELINQUISHED BY (SIGNATURE): [Signature] RECEIVED BY (SIGNATURE): [Signature] DATE & TIME OF RECEPTION:

DATE & TIME OF RELINQUISHMENT: RELINQUISHED BY (SIGNATURE): RECEIVED BY LABORATORY (SIGNATURE): [Signature] DATE & TIME OF RECEPTION: 7/27/94 3:00

FIELD ID NUMBER	DATE COLLECTED	TIME COLLECTED	SAMPLE		PRESERV. TYPE	LOCATION/DESCRIPTION	ANALYSIS TYPE	LAB I.D.	NO./TYPE OF CONTAINERS	SAMPLE CONDITION
			TYPE	DEVICE						
	7-26-94	2:35	SOIL			GB-1 5', 7'	DRO	78237	3	
	7-26-94	2:45	H ₂ O		HCL	GB-1 groundwater	DRO	78238	2	
	7-26-94	3:30	SOIL			GB-2 5', 7'	DRO	78239	3	
7-27-94	8:00	8:00	SOIL		meoh	HB-1 3', 5'	GRG/ARC		3	
7-27-94	8:50	8:50	SOIL			HB-2 3', 5'	DRO		3	
7-27-94	8:50	8:50	SOIL		meoh	HB-3 3', 5'	GRG/ARC		3	
7-27-94	9:15	9:15	SOIL			HB-4 3', 5'	DRO		3	
7-27-94	9:40	9:40	SOIL			HB-5 3', 5'	DRO	78240	3	
7-27-94	11:10	11:10	H ₂ O			HB-5 groundwater	DRO	78241	2	

LABORATORY USE

LABORATORY SHOULD DISPOSE OF UNUSED PORTION OF SAMPLE:

DISPOSE RETURN

RETAIN FOR _____ DAYS OTHER

SPLIT SAMPLES:

OFFERED: YES _____ NO _____

ACCEPTED: YES _____ NO _____

ARRIVAL TEMPERATURE OF TEMPERATURE BLANK _____ DEG. C

ACCEPTED BY: [Signature]

SAMPLE CONDITION KEY

C=CRACKED G=GOOD

B=BROKEN L=LEAKING

IS=IMPROPERLY SEALED

AB=AIR BUBBLES



Chain of Custody:
 MID-STATE ASSOCIATES, INC.
 1-800-228-3012

1230 Lange Court
 Baraboo, WI 53913
 (608) 356-2760
 FAX: (608) 356-2766

SAMPLE COLLECTOR: PAT TOOMEY COMPANY: MSA TELEPHONE NUMBER (INCLUDE AREA CODE):
 PROJECT NUMBER: 212063 PROJECT NAME: WITTYG OIL CO.

I HEREBY CERTIFY THAT I RECEIVED, PROPERLY HANDLED, AND DISPOSED OF THESE SAMPLES AS NOTED BELOW:

INVOICE ADDRESS (MUST BE COMPLETED): Tim melka REPORT ADDRESS (MUST BE COMPLETED):

DATE & TIME OF RELINQUISHMENT: 7-27-94 2:07 RELINQUISHED BY (SIGNATURE): [Signature] RECEIVED BY (SIGNATURE): DATE & TIME OF RECEPTION:

DATE & TIME OF RELINQUISHMENT: RELINQUISHED BY (SIGNATURE): RECEIVED BY LABORATORY (SIGNATURE): [Signature] DATE & TIME OF RECEPTION: 7/27/94 3:00

FIELD ID NUMBER	DATE COLLECTED	TIME COLLECTED	SAMPLE		PRESERV. TYPE	LOCATION/DESCRIPTION	ANALYSIS TYPE	LAB I.D.	NO/TYPER OF CONTAINERS	SAMPLE CONDITION
			TYPE	DEVICE						
	7-25-94	3:35	soil			BB-1-3'- 4'	DRO	78225	3	
	7-25-94	3:40	H ₂ O		HCL	BB-1 groundwater	DRO	78228	2	
	7-25-94	4:30	soil		mech	EB-5 5, 7'	GRO/PJOC DRO	78229	5	
	7-25-94	4:40	H ₂ O		HCL	EB-5 groundwater	GRO/PJOC DRO	78230	5	
	7-26-94	9:45	soil		mech	AB-1 7, 9'	GRO/PJOC	78231	3	
	7-26-94	10:25	soil		mech	AB-2 7, 7.5'	GRO/PJOC	78232	3	
	7-26-94	11:10	soil			AB-3 7, 9'	DRO	78233	3	
	7-26-94	11:35	soil			AB-4 7, 8.5'	DRO	78234	3	
	7-26-94	12:30	soil			AB-5 7, 9'	DRO	78235	3	
	7-26-94	1:10	soil			AB-6 7-8'	DRO	78236	3	

LABORATORY USE

LABORATORY SHOULD DISPOSE OF UNUSED PORTION OF SAMPLE:		RETAIN FOR _____ DAYS		SPLIT SAMPLES:		ACCEPTED BY: <u>[Signature]</u>	ARRIVAL TEMPERATURE OF TEMPERATURE BLANK: <u>21</u> DEG. C	SAMPLE CONDITION KEY C=CRACKED G=GOOD B=BROKEN L=LEAKING IS=IMPROPERLY SEALED AB=AIR BUBBLES
DISPOSE	RETURN	OTHER		OFFERED: YES _____ NO _____	ACCEPTED: YES _____ NO _____			

1376

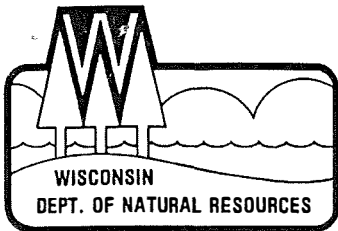

George E. Meyer
Secretary

State of Wisconsin \ DEPARTMENT OF NATURAL RESOURCES

910 Highway 54 East
Black River Falls, WI 54615
TELEPHONE 715-284-1400
TELEFAX 715-284-1737

September 9, 1994

File Ref: WD
Monroe County

Wittig Oil Company
Attn: Mr. Don Waldemath
P.O. Box 30
Tomah, WI 54660

CERTIFIED MAIL
RETURN RECEIPT REQUESTED

SUBJECT: Reported Soil Contamination at *Wittig Oil - Motel, Wyeville, WI*

Dear Mr. Waldemath:

On September 6, 1994, we were notified by Tim Melka of Mid-State Associates that contamination was found during a site assessment investigation at this site.

The purpose of this letter is threefold: 1) to inform you of your legal responsibilities under section 144.76, Wisconsin Statutes; 2) to inform you of what you need to do to investigate and clean up the contamination; and 3) to provide you with information about environmental cleanups, environmental consultants, and working cooperatively with the Department of Natural Resources.

Legal Responsibilities:

The Hazardous Substances Spills Law, section 144.76 (3), Wisconsin Statute, states:

RESPONSIBILITY. A person who possesses or controls a hazardous substance which is discharged or who causes the discharge of a hazardous substance shall take the actions necessary to restore the environment to the extent practicable and minimize the harmful effects from the discharge to the air, lands, or waters of the state.

Based on the information we have received, the Department believes that you are responsible for restoring the environment. This will include investigating the nature and extent of soil and groundwater contamination. Then you must clean up the contaminated soils and groundwater.

Steps to Take:

Because petroleum contamination may spread in the environment, your quick response is important. Quick action may lessen damage to your property and reduce your costs of investigating and cleaning up the contamination. To ensure that your cleanup complies with

Mr. Don Waldemath
September 9, 1994
Page 2

Wisconsin's laws and regulations, you should hire a professional environmental consultant who understands what needs to be done. These are the first four steps you need to take:

1. In 30 days, please submit written verification (such as a letter from the consultant) that you have hired an environmental consultant. You will need to work quickly to meet this time line.
2. In 45 days, your consultant must submit a work plan and schedule for conducting the investigation. Your consultant must follow the Department's administrative rules and technical guidance documents. Please include a summary of all work done at the site, such as tank removals, soil sampling or soil excavation.
3. Please keep us informed of what is being done. You or your consultant must provide us with a brief report at least every 90 days. These quarterly reports should summarize the work completed since the last report. Quarterly reports need only be one or two pages long, plus any relevant maps and/or tables. However, based on conditions at your site, you may receive a letter requiring more frequent contacts with the Department. Keeping us informed of what has been done will help us all work together to get your site cleaned up.
4. When the site investigation is complete, your consultant must submit a full report on the extent and degree of soil and/or groundwater contamination and a proposal for cleaning it up.

Because of the number of contaminated sites and our staffing levels, I will not be able to review and respond to each report. To comply with the Spills Law, however, the investigation and cleanup must not be delayed while you wait for DNR responses. We have written detailed technical guidance for environmental consultants. They are expected to be familiar with our procedures and should be able to answer your questions on meeting Wisconsin's cleanup requirements.

PECFA Reimbursement:

The Department of Industry, Labor, and Human Relations (DILHR) administers the Petroleum Environmental Cleanup Fund (PECFA). This fund may reimburse you for eligible costs associated with the remedial investigation and cleanup. A handout on how to choose an environmental consultant is enclosed, along with a list of consultants. The PECFA program now requires that you solicit and review at least three proposals from different consultants before you choose the one that best fits your needs. The consultant you choose must be registered with DILHR. Please call Joan Schmaus, DILHR, at (608) 267-3753 with questions on consultant registration. Please give a copy of this letter to the consultants you contact.

Mr. Don Waldemath
September 9, 1994
Page 3

Section 144.765, Wisconsin Statutes, establishes the Contaminated Lands Recycling Program. If you are interested in obtaining the protection of limited liability under s. 144.765, Stats., please contact Mark Giesfeldt at (608) 267-7562 or Darsi Foss at (608) 267-6713, in the Department of Natural Resources' Madison office for more information. The liability exemption under s. 144.765, Stats., is available to persons who meet the definition of "purchaser" in s. 144.765(1)(c) and receive Department approval for the response actions taken at the property undergoing cleanup. The Department will determine eligibility for this program on a case-by-case basis, prior to the "purchaser" developing a scope of work for conducting a ch. NR 716 site investigation at the property.

If you have any questions about this letter or your responsibilities, please call me at (715) 284-1418 or Project Manager Tim Baker at (715) 284-1428.

Thank you for your cooperation.

Sincerely,



Thomas J. Reininger
Waste Management Specialist

Enclosures

cc **Tim Baker/FILE**
Bill Evans - WD
John Paddock - WD
James Daniels - DILHR, 2226 Rose St., La Crosse, WI 54603

Is your RETURN ADDRESS completed on the reverse side?

SENDER:

- Complete items 1 and/or 2 for additional services.
- Complete items 3, and 4a & b.
- Print your name and address on the reverse of this form so that we can return this card to you.
- Attach this form to the front of the mailpiece, or on the back if space does not permit.
- Write "Return Receipt Requested" on the mailpiece below the article number.
- The Return Receipt will show to whom the article was delivered and the date delivered.

I also wish to receive the following services (for an extra fee):

- Addressee's Address
- Restricted Delivery

Consult postmaster for fee.

3. Article Addressed to: Wittig Oil Co. Mr. Don Waldemath P.O. Box 30 Tomah, WI 54660	4a. Article Number P 394 131 059
	4b. Service Type <input type="checkbox"/> Registered <input type="checkbox"/> Insured <input checked="" type="checkbox"/> Certified <input type="checkbox"/> COD <input type="checkbox"/> Express Mail <input checked="" type="checkbox"/> Return Receipt for Merchandise
	7. Date of Delivery 9-12-94
5. Signature (Addressee)	8. Addressee's Address (Only if requested and fee is paid)
6. Signature (Agent) <i>Donald Waldemath</i>	

PS Form 3811, December 1991 ★U.S. GPO: 1993-352-714 **DOMESTIC RETURN RECEIPT**

Thank you for using Return Receipt Service

P 394 131 059



Receipt for Certified Mail
No Insurance Coverage Provided
Do not use for International Mail
(See Reverse)

Sent to <i>Donald Waldemath</i>	
Street and No <i>P.O. Box 30</i>	
P.O., State and ZIP Code <i>Tomah, WI 54660</i>	
Postage	\$
Certified Fee	
Special Delivery Fee	
Restricted Delivery Fee	
Return Receipt Showing to Whom & Date Delivered	
Return Receipt Showing to Whom, Date, and Addressee's Address	
TOTAL Postage & Fees	\$
Postmark or Date	<i>9-2-94</i>

PS Form 3800, June 1991

UNITED STATES POSTAL SERVICE

Official Business



PENALTY FOR PRIVATE USE TO AVOID PAYMENT OF POSTAGE, \$300



Print your name, address and ZIP Code here

• DEPARTMENT OF NATURAL RESOURCES
Area Headquarters
910 Highway 54 East
Black River Falls, WI 54615

Baker

STICK POSTAGE STAMPS TO ARTICLE TO COVER FIRST CLASS POSTAGE, CERTIFIED MAIL FEE, AND CHARGES FOR ANY SELECTED OPTIONAL SERVICES (see front).

1. If you want this receipt postmarked, stick the gummed stub to the right of the return address leaving the receipt attached and present the article at a post office service window or hand it to your rural carrier (no extra charge).
2. If you do not want this receipt postmarked, stick the gummed stub to the right of the return address of the article, date, detach and retain the receipt; and mail the article.
3. If you want a return receipt, write the certified mail number and your name and address on a return receipt card, Form 3811, and attach it to the front of the article by means of the gummed ends if space permits. Otherwise, affix to back of article. Endorse front of article **RETURN RECEIPT REQUESTED** adjacent to the number.
4. If you want delivery restricted to the addressee, or to an authorized agent of the addressee, endorse **RESTRICTED DELIVERY** on the front of the article.
5. Enter fees for the services requested in the appropriate spaces on the front of this receipt. If return receipt is requested, check the applicable blocks in item 1 of Form 3811.
6. Save this receipt and present it if you make inquiry.

105603-92-B-0226

PS Form 3800, June 1991 (Reverse)

UID Number:		FID Number:		PMN Number:	
County: <u>MONROE</u>		Initial Contact Date: <u>9, 6, 94</u>			
Site Name: <u>WITTIG OIL - MOTEL</u>		Date RPLetter Sent: <u>9, 9, 94</u>			
Address: <u>HYW 21</u>		Date Closure Approved: <u> </u>			
<u>WYEVILLE, WI 54671</u>					
Municipality: <u>WYEVILLE</u>		Person/Firm Reporting: <u>TIM MELKA</u>			
Legal Descript: <u>1/4 1/4 sec T NR (E/W)</u>		<u>MID-STATE ASSOCIATES</u>			
<u>LOT 7, BLK 1, STENHOLT NELSON'S FIRST ADDITION</u>		Phone Number: <u>(608) 356-2771</u>			
Lat.: <u> </u>		Long.: <u> </u>			

Priority Screening	Scoring Criteria	Funding Source	Effective Date	LUST Trust Eligible
<u>X</u> 1 = High	1. <u> </u>	<u>X</u> 1 = RP	<u>9, 6, 94</u>	<u>X</u> 1 = Federal
<u> </u> 2 = Medium	2. <u> </u>	<u> </u> 2 = LTF	<u> </u>	<u> </u> 2 = Non-Federal
<u> </u> 3 = Low	3. <u> </u>	<u> </u> 3 = EF	<u> </u>	
<u> </u> 4 = Unknown	4. <u> </u>	<u> </u> 4 = Other	<u> </u>	
	5. <u> </u>			
Score: <u> </u> Init.: <u> </u> Date: <u> </u>				

Case Status

	Start Date	End Date
<u> </u> (F) Free Product Removal	<u> </u>	<u> </u>
<u> </u> (E) RP Emergency Response	<u> </u>	<u> </u>
<u> </u> (R) LTF Emergency Response	<u> </u>	<u> </u>
<u> </u> (L) Long Term Monitoring	<u> </u>	<u> </u>

<p>Responsible Party</p> <p>Contact Person: <u>DON WALDEMATH (GEN. FOREMAN)</u></p> <p>Company Name: <u>WITTIG OIL COMPANY</u></p> <p>Address: <u>P.O. Box 30</u> <u>TOMAH, WI 54660</u></p> <p>Phone Number: <u>800 236-7780</u> <u>(608) 372-2421</u></p>	<p>Impacts</p> <p>Enter "P" for potential and "K" for known</p> <p><u> </u> (1) Fire/Explosion Threat</p> <p><u> </u> (2) Contaminated Private Well(s) <u> </u> # of Wells</p> <p><u> </u> (3) Contaminated Public Well</p> <p><u>K</u> (4) Groundwater Contamination</p> <p><u>K</u> (5) Soil Contamination</p> <p><u> </u> (6) Other: <u> </u></p> <p><u> </u> (7) Surface Water Impacts</p> <p><u> </u> (9) Floating Product</p>
--	--

<p>Consultant</p> <p>Contact Name: <u>TIM MELKA</u></p> <p>Company Name: <u>MIDSTATE ASSOCIATES</u></p> <p>Address: <u> </u></p> <p>Telephone: <u>(608) 356-2771</u></p>	<table border="1" style="width:100%; border-collapse: collapse;"> <thead> <tr> <th style="width:60%;">Substances</th> <th style="width:15%;"># Tank(s)</th> <th style="width:25%;">Size</th> </tr> </thead> <tbody> <tr> <td><u> </u> (1) Leaded Gas</td> <td><u> </u></td> <td><u> </u></td> </tr> <tr> <td><u> </u> (2) Unleaded Gas</td> <td><u> </u></td> <td><u> </u></td> </tr> <tr> <td><u> </u> (3) Diesel</td> <td><u> </u></td> <td><u> </u></td> </tr> <tr> <td><u>X</u> (4) Fuel Oil</td> <td><u>1</u></td> <td><u>550</u></td> </tr> <tr> <td><u> </u> (5) Unkwn Hydrocrbn</td> <td><u> </u></td> <td><u> </u></td> </tr> <tr> <td><u> </u> (8) Other</td> <td><u> </u></td> <td><u> </u></td> </tr> <tr> <td><u> </u> (12) Waste Oil</td> <td><u> </u></td> <td><u> </u></td> </tr> </tbody> </table>	Substances	# Tank(s)	Size	<u> </u> (1) Leaded Gas	<u> </u>	<u> </u>	<u> </u> (2) Unleaded Gas	<u> </u>	<u> </u>	<u> </u> (3) Diesel	<u> </u>	<u> </u>	<u>X</u> (4) Fuel Oil	<u>1</u>	<u>550</u>	<u> </u> (5) Unkwn Hydrocrbn	<u> </u>	<u> </u>	<u> </u> (8) Other	<u> </u>	<u> </u>	<u> </u> (12) Waste Oil	<u> </u>	<u> </u>
Substances	# Tank(s)	Size																							
<u> </u> (1) Leaded Gas	<u> </u>	<u> </u>																							
<u> </u> (2) Unleaded Gas	<u> </u>	<u> </u>																							
<u> </u> (3) Diesel	<u> </u>	<u> </u>																							
<u>X</u> (4) Fuel Oil	<u>1</u>	<u>550</u>																							
<u> </u> (5) Unkwn Hydrocrbn	<u> </u>	<u> </u>																							
<u> </u> (8) Other	<u> </u>	<u> </u>																							
<u> </u> (12) Waste Oil	<u> </u>	<u> </u>																							

CC's: MICHAEL S. MOAN
MOEN, BEEHAN MEYER & HENKE LTD
FIRST BANK PLAZA, SUITE 700
201 MAIN ST
P.O. Box 0786
LA CROSSE WI 54602

CASE STATUS SUMMARY

UID: _____

SITE NAME: WITTING OIL - MOTEL

- | | | | | |
|----------------------------|----------------------------|----------------------------|-----------------------------|-------------------------------|
| 03 = NTC of Non Compliance | 21 = Contest Case Hearing | 34 = Tnk Cls/SA Rpt Appv'd | 40 = RA Work Plan Appv'd | 46 = Form 4 Denied |
| 04 = Enf. Conference | 23 = Referral to DOJ | 35 = SI Work Plan Recv'd | 41 = RA Report Recv'd | 47 = PECFA Reimbursement |
| 14 = Notice of Violation | 30 = Notice to Proceed | 36 = SI Work Plan Appv'd | 42 = RA Report Appv'd | 48 = Free Product Recovery |
| 18 = Admin. Order Issued | 31 = Tnk Cls/SA Work Plan | 37 = SI Report Recv'd | 43 = Qrtly/Mthly Status Rpt | 49 = Alternate Water Supplied |
| 19 = Admin. Order Modified | 32 = Tnk Cls/SA WP Appv'd | 38 = SI Report Appv'd | 44 = Form 4 Received | |
| 20 = Admin. Order Canceled | 33 = Tnk Cls/SA Rpt Recv'd | 39 = RA Work Plan Recv'd | 45 = Form 4 Approved | |
-
- | | | | | |
|------------|------------|------------|------------|------------|
| 60 = _____ | 68 = _____ | 76 = _____ | 84 = _____ | 92 = _____ |
| 61 = _____ | 69 = _____ | 77 = _____ | 85 = _____ | 93 = _____ |
| 62 = _____ | 70 = _____ | 78 = _____ | 86 = _____ | 94 = _____ |
| 63 = _____ | 71 = _____ | 79 = _____ | 87 = _____ | 95 = _____ |
| 64 = _____ | 72 = _____ | 80 = _____ | 88 = _____ | 96 = _____ |
| 65 = _____ | 73 = _____ | 81 = _____ | 89 = _____ | 97 = _____ |
| 66 = _____ | 74 = _____ | 82 = _____ | 90 = _____ | 98 = _____ |
| 67 = _____ | 75 = _____ | 83 = _____ | 91 = _____ | 99 = _____ |

CASE STATUS UPDATES:

Action Code	Date Received/Sent	Compliance Due Date	Compliance Achieved	Date Entered In Tracking
01	9 / 6 / 94 (R/S)	____/____/____	____/____/____	____/____/____
02	9 / 9 / 94 (R/S)	____/____/____	____/____/____	____/____/____
	____/____/____ (R/S)	____/____/____	____/____/____	____/____/____
	____/____/____ (R/S)	____/____/____	____/____/____	____/____/____
	____/____/____ (R/S)	____/____/____	____/____/____	____/____/____
	____/____/____ (R/S)	____/____/____	____/____/____	____/____/____
	____/____/____ (R/S)	____/____/____	____/____/____	____/____/____
	____/____/____ (R/S)	____/____/____	____/____/____	____/____/____
	____/____/____ (R/S)	____/____/____	____/____/____	____/____/____
	____/____/____ (R/S)	____/____/____	____/____/____	____/____/____
	____/____/____ (R/S)	____/____/____	____/____/____	____/____/____
	____/____/____ (R/S)	____/____/____	____/____/____	____/____/____
	____/____/____ (R/S)	____/____/____	____/____/____	____/____/____
	____/____/____ (R/S)	____/____/____	____/____/____	____/____/____
	____/____/____ (R/S)	____/____/____	____/____/____	____/____/____
	____/____/____ (R/S)	____/____/____	____/____/____	____/____/____
	____/____/____ (R/S)	____/____/____	____/____/____	____/____/____
	____/____/____ (R/S)	____/____/____	____/____/____	____/____/____
	____/____/____ (R/S)	____/____/____	____/____/____	____/____/____
	____/____/____ (R/S)	____/____/____	____/____/____	____/____/____
	____/____/____ (R/S)	____/____/____	____/____/____	____/____/____
	____/____/____ (R/S)	____/____/____	____/____/____	____/____/____
	____/____/____ (R/S)	____/____/____	____/____/____	____/____/____
	____/____/____ (R/S)	____/____/____	____/____/____	____/____/____
	____/____/____ (R/S)	____/____/____	____/____/____	____/____/____
	____/____/____ (R/S)	____/____/____	____/____/____	____/____/____
	____/____/____ (R/S)	____/____/____	____/____/____	____/____/____
	____/____/____ (R/S)	____/____/____	____/____/____	____/____/____
	____/____/____ (R/S)	____/____/____	____/____/____	____/____/____
	____/____/____ (R/S)	____/____/____	____/____/____	____/____/____
	____/____/____ (R/S)	____/____/____	____/____/____	____/____/____
	____/____/____ (R/S)	____/____/____	____/____/____	____/____/____
	____/____/____ (R/S)	____/____/____	____/____/____	____/____/____
	____/____/____ (R/S)	____/____/____	____/____/____	____/____/____
	____/____/____ (R/S)	____/____/____	____/____/____	____/____/____

EAST BR. LEMONWEIR RIVER

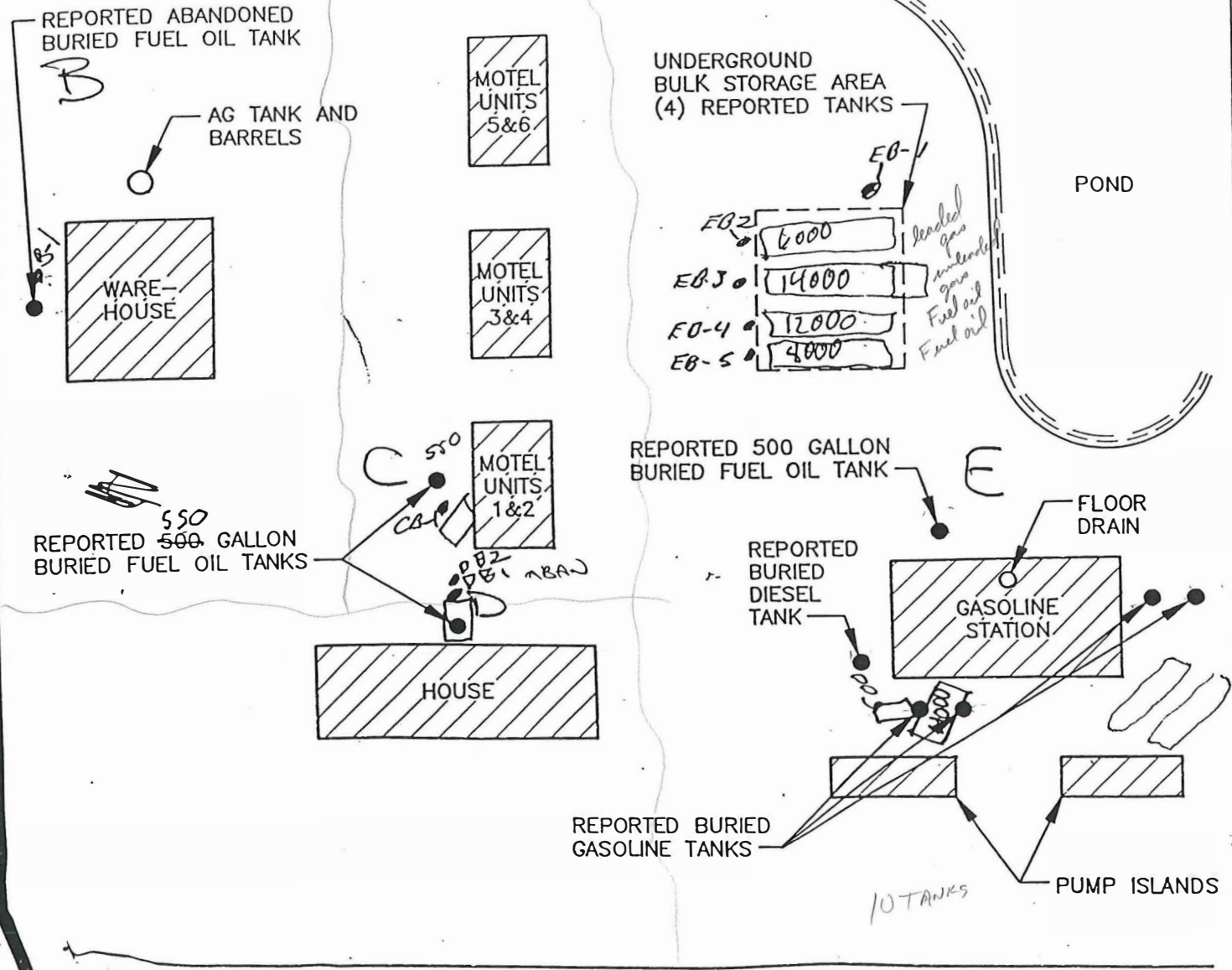

HWY 21



NO SCALE

**FIGURE 7
PARCELS B, C, D AND E
SITE SKETCH**

WITTIG OIL CO. PROPERTIES
VILLAGE OF WYEVILLE, WISCONSIN

1376

- 21. USEMCO, Inc.
1730 Resin Road
- 22. USVA Medical Center
Veterans Drive
- 23. Vander Meer Chev. Buick
1231 N Superior Street
- 24. WDNR Tomah Ranger Station
310 Superior Avenue
- 25. WDOT Tomah Exit Hwy 131

- According to the DILHR On Line Underground Storage Tank Inventory Database on January 14, 1994, the following registered underground storage tanks were listed in the Town of Byron, Village of Wyeville, Village of Necedah, and the City of Tomah for Walter Wittig or the Wittig Oil Co.

In the Town of Byron (Parcel A):

<u>Tank No.</u>	<u>Capacity</u>	<u>Contents</u>	<u>Year Inst.</u>
410500135	1000 gal.	fuel oil	1970
410500136	1000 gal.	fuel oil	1970
410500137	1000 gal.	fuel oil	1970

In the Village of Wyeville (Parcels B, C, D, & E):

<u>Tank No.</u>	<u>Capacity</u>	<u>Contents</u>	<u>Year Inst.</u>	
410500140	550 gal.	fuel oil	1967] GAS STATION
410500142	550 gal.	leaded gas	aban. 1990	
410500143	4000 gal.	unleaded gas	1972	
410500144	8000 gal.	unleaded gas	1972	
410500145	8000 gal.	leaded gas	1972] METAL RESIDUAL
410500146	550 gal.	fuel oil	unknown	
410500147	550 gal.	fuel oil	1972	
410500148	8000 gal.	fuel oil	1970	GAS STATION BULK
410500149	12000 gal.	fuel oil	1970	GAS STATION BULK
410500150	14000 gal.	unleaded gas	970	GAS STATION - BULK
410500151	6000 gal.	leaded gas	1970	GAS STATION - BULK