

February 8, 2019

Mr. Donald M. Fritzke, Sr.
Revocable Trust 12/21/00
C/o Mr. Donald M. Fritzke, Trustee
N161W20772 Kami Lane
Jackson, Wisconsin 53037

Subject: Change Order Request for Sub-Slab
Vapor Sampling and Analysis
Former Colony Dry Cleaners
10003 W. Carmen Avenue
Milwaukee, Wisconsin 53225
UEC Proposal No. 19-011
BRRTS No. 02-41-278106

Dear Mr. Fritzke:

United Engineering Consultants, Inc. (United) has prepared this change order request to perform additional sub-slab vapor sampling and analysis at the above referenced property. United intends to perform these services under Dry Cleaner Environmental Response Program (DERF) guidelines to recoup applicable, refundable costs incurred.

PROJECT INFORMATION

The results of the site investigation performed by Sigma Environmental Services, Inc. (Sigma) and United indicates the presence of Tetrachloroethene (PCE) and Trichloroethene (TCE) impacted soil at the above referenced property. The lateral extent of the contaminant plume extends to the United P&H Supply Co. property to the west and the Suburban Car Wash property to the southeast. The vertical extent of the contaminant plume in the soil extends from the near surface to ten (10) to twelve (12) feet below the existing grade.

Water collected from the above referenced depths also indicates the presence of PCE and TCE. Groundwater has been encountered at depths in excess of thirty (30) feet and has not been impacted based on three (3) previous rounds of sampling and analysis.

Sub-slab vapor sampling in the site building indicate the presence of PCE in the front office area and the former equipment room at concentrations in exceedance of its small commercial Vapor Risk Screening Level (VRSL). TCE is also present in the sub-slab vapor in the equipment room at a concentration in exceedance of its small commercial VRSL.

The results of the investigation have been summarized in United's revised Phase II Environmental Site Investigation (SI) report dated December 5, 2014. The SI report was revised to include additions requested by Mr. John Hnat of the Wisconsin Department of Natural Resources (WDNR) subsequent to his initial review.

Due to the presence of PCE and TCE at concentrations in exceedance of their respective small commercial VRSLs, a sub-slab depressurization system will be required to mitigate the PCE and TCE concentrations in the sub-slab vapor. United recently performed a building walk through with a sub-slab depressurization system contractor who indicated that two (2) depressurization systems would most likely be necessary to adequately mitigate the PCE and TCE vapors due to the construction of an initial structure in 1962 and a subsequent addition in 1965.

Based on the potential for two (2) sub-slab depressurization systems to mitigate the PCE and TCE concentrations in the vapor and the age of the previous sub-slab vapor sampling and analysis (approximately ten (10) years), United recommends additional sub-slab vapor sampling and analysis to include the previously sampled front office area, the former equipment room and warehouse area as well as the former dry cleaning room.

SCOPE OF SERVICES

The scope of services will consist of the installation of five (5) vapor pins and the subsequent sampling and analysis of the sub-slab vapor at five (5) locations in the building. The samples will be analyzed for the presence of Volatile Organic Compounds (VOCs) utilizing method TO-15. The previous sampled locations as well as the proposed locations are indicated on the attached Figure – Existing and Proposed Sub-Slab Vapor Sample Location Map. Table 4 – VOC Analysis – Indoor and Sub-Slab Air is also attached.

United will act as the owner's consultant for performing and/or coordinating the various aspects of this project, related to field activities and as liaison to appropriate state agencies, as allowed in Chapter NR 169 Dry Cleaner Environmental Response Program. In addition, all consultant and contract services will comply with applicable requirements of NR169 and NR700 through 728.

COST

The Wisconsin Department of Natural Resources (WDNR) approved a total cost of \$63,589.00 for consulting services requested by Sigma and United to complete the site investigation of the chlorinated solvent release at the subject property. Subsequent to the WDNR review of the submitted SI report and expense claim, the WDNR approved \$60,186.61 as DERF eligible expenses for the site in their August 1, 2014 correspondence. A payment of \$50,186.61 was subsequently issued to the Donald M. Fritzke Sr. Revocable Trust 12/21/00.

United requested and received approval from the WDNR to utilize the remaining \$3402.39 of the approved budget to prepare the WDNR requested revisions to the SI and perform a third round of groundwater monitoring of the existing NR 141 compliant wells. The third round of groundwater sampling and analysis did not indicate the presence of any VOC at concentrations at or above their respective detection limits in any of the sampled monitoring wells. The WDNR approved an additional \$4560.00 on January 13, 2015 for a total cost of \$68,149.00 to complete the revised SI report and prepare the Case Closure and GIS Registry submittals.

United proposes to install five (5) vapor pins, subsequently sample for the presence of VOCs and report the results at an additional cost of \$3300.00. United's costs will be incurred at the rates listed on the attached Dry Cleaner Environmental Response Program Reimbursement Cost Detail Linking Spreadsheet Form 4400-214D.

The terms of this proposal are in effect for sixty (60) days as of the date of this proposal. If acceptance is not received prior to the sixty (60) days from the date of this proposal, this proposal will be null and void. If services are required after the sixty (60) days, a new proposal will be issued.

Invoices will be rendered monthly and shall be paid within fifteen (15) days of the invoice date for services performed during that month. Final payment will be due and payable upon completion of the work or termination of services.

TERMS AND CONDITIONS:

Enclosed with this proposal is United's General Conditions which are expressly incorporated into, and are an integral part of, our contract for professional services. They will be enforced throughout the term of this proposal.

United employees will be covered on the above referenced site by Workmen's Compensation and General Liability Insurance. Proof of insurance is attached. United represents it maintains general liability and property damage insurance coverage in the amount of One Million Dollars (1,000,000). In addition, United represents it maintains coverage for errors and omissions and professional liability coverage, including pollution impairment liability, of no less than \$1,000,000 per claim and a minimum of \$1,000,000 in annual aggregate claims. A deductible of \$5,000.00 for each occurrence, claim, pollution condition or wrongful act will apply.

United agrees to indemnify the Client from and save Client harmless against any loss, damage, or liability stemming from acts of negligence by United. Loss shall be deemed to include any claims, suits, or liability including, but not limited to Attorney's fees, cost of settlement and/or other incidental costs for personal injury, death, illness, property damage, or any other loss allegedly arising from or relating to the negligent performance of work by United or its subcontractors.

United shall hold confidential the business and technical information obtained or generated in performance of services under this Agreement and shall identify all such materials as "confidential." United shall not disclose such information except if such disclosure is required by government statute, ordinance, or regulation. United affirmatively states that it is a professional environmental testing organization and shall use that standard of care normally provided by a professional environmental testing organization in all of its procedures, processes, selection of sub-contractors, and testing and care of samples.

Please indicate your acceptance of this proposal by signing and returning a copy to our office for our files. The signed proposal will serve as our authorization to perform the work. If you have any questions, please feel free to contact us.

Sincerely,
United Engineering Consultants, Inc.

Timothy J. Anderson

Timothy J. Anderson, P.E.
Principal

Signature:

John J. Steet

Title:

Project Manager / Hydrogeologist

Date:

2/20/2019

Attachments: Figure – Existing and Proposed Sub-Slab Vapor Sample Location Map
Table 4 – VOC Analysis – Indoor and Sub-Slab Air

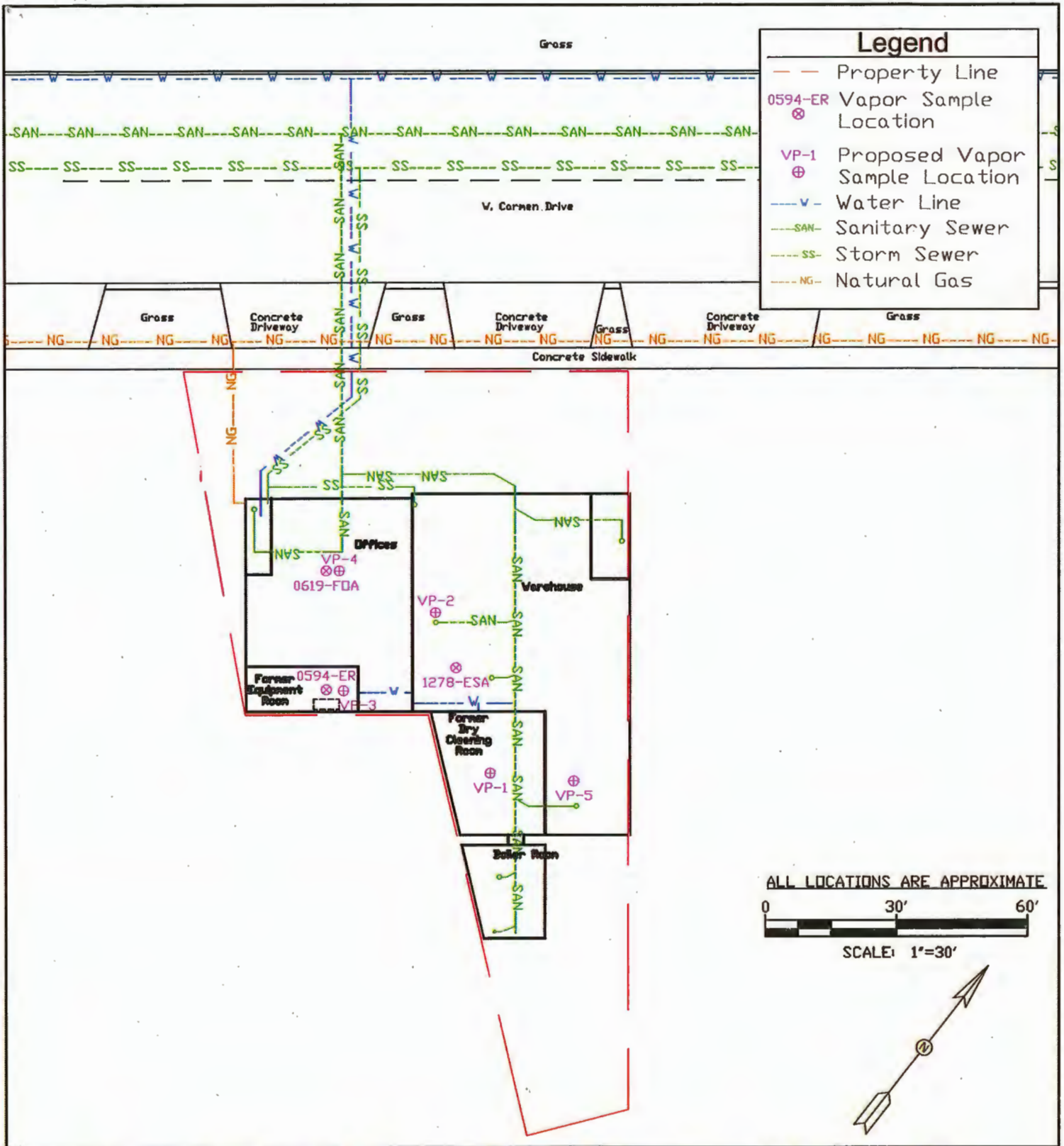

Figure: Existing and Proposed Sub-Slab Vapor Sample Location Map

United Engineering Consultants, Inc.

16237 W. Ryerson Road
 New Berlin, WI 53151
 Tel. (262) 785-1447
 Fax (262) 706-4400

#19-011
 #06004
 DRAWN BY: NJA
 DATE: 02/08/2019

Phase II Environmental Site Assessment
Former Colony Dry Cleaners
 10003 W. Carmen Avenue
 Milwaukee, WI 53225

Table 4
VOC Analysis - Indoor and Sub-Slab Air
Former Colony Dry Cleaners
10003 W. Carmen Avenue
Milwaukee, Wisconsin 53225
June 2 and 5, 2009

Location	1203FO-24HR	0594-ER	0619-FOA	1278-ESA	Small Commercial	Residential	Small Commercial	Residential
	<i>Indoor Air</i>	<i>Form Equip. Room</i>	<i>office</i>	<i>Warehouse</i>	Indoor VAL	Indoor VAL	Sub-Slab VRSL	Sub-Slab VRSL
Volatile Organic Compounds (VOC) (Method: TO-15)								
Acetone	11.4	21.8	6.0	ND	-	-	-	-
Benzene	8.8	3.2	9.6	18.6	16	3.6	120	530
Bromodichloromethane	ND	ND	ND	ND	-	-	-	-
Bromoform	ND	ND	ND	ND	-	-	-	-
Bromomethane	ND	ND	ND	ND	-	-	-	-
1,3-Butadiene	ND	ND	ND	ND	-	-	-	-
2-Butanone (MEK)	ND	ND	ND	ND	-	-	-	-
Carbon disulfide	ND	ND	ND	ND	-	-	-	-
Carbon tetrachloride	ND	ND	ND	ND	20	4.7	670	160
Chlorobenzene	ND	ND	ND	ND	-	-	-	-
Chloroethane	ND	ND	ND	ND	-	-	-	-
Chloroform	ND	ND	ND	ND	5.3	1.2	180	40
Chloromethane	ND	ND	ND	ND	390	94	15000	3100
Cyclohexane	14.6	23.8	14.7	39.3	-	-	-	-
Dibromochloromethane	ND	ND	ND	ND	-	-	-	-
1,2-Dibromoethane (EDB)	ND	ND	ND	ND	-	-	-	-
1,2-Dichlorobenzene	ND	ND	ND	ND	-	-	-	-
1,3-Dichlorobenzene	ND	ND	ND	ND	-	-	-	-
1,4-Dichlorobenzene	2.9	3.9	ND	ND	-	-	-	-
Dichlorodifluoromethane	2.7	2.8	2.7	ND	440	100	15000	3300
1,1-Dichloroethane	ND	ND	ND	ND	77	18	2600	600
1,2-Dichloroethane	ND	ND	ND	ND	4.7	1.1	160	37
1,1-Dichloroethene	ND	ND	ND	ND	880	210	29000	7000
cis-1,2-Dichloroethene	1.6	210E	2.1	70.7	-	-	-	-
trans-1,2-Dichloroethene	ND	ND	ND	2.2	-	-	-	-
1,2-Dichloropropane	ND	ND	ND	ND	-	-	-	-
cis-1,3-Dichloropropene	ND	ND	ND	ND	-	-	-	-
trans-1,3-Dichloropropene	ND	ND	ND	ND	-	-	-	-
Dichlorotetrafluoroethane	ND	ND	ND	ND	-	-	-	-
Ethyl acetate	ND	8.6	ND	ND	-	-	-	-
Ethylbenzene	3.7	1.5	4.3	9.7	49	11	1600	370
4-Ethyltoluene	3.4	ND	3.7	ND	-	-	-	-
n-Heptane	7.3	29.4	7.3	26.2	-	-	-	-
Hexachloro-1,3-butadiene	ND	ND	ND	ND	-	-	-	-
n-Hexane	32.1	17.4	32.2	46.6	-	-	-	-
2-Hexanone	ND	ND	ND	ND	-	-	-	-
Methylene Chloride	3.7	156E	5.0	ND	2600	630	87000	21000
4-Methyl-2-pentanone (MIBK)	ND	ND	ND	ND	-	-	-	-
Methyl-tert-butyl ether	ND	ND	ND	ND	470	110	16000	3700
Propylene	ND	ND	ND	ND	-	-	-	-
Styrene	ND	2.9	ND	ND	-	-	-	-
1,1,2,2-Tetrachloroethane	ND	ND	ND	ND	-	-	-	-
Tetrachloroethene	25.2	57600	176000	38.2	180	42	6000	1400
Tetrahydrofuran	ND	ND	ND	ND	-	-	-	-
Toluene	47.5	59.6	57.0	32.2	22000	5200	730000	170000
1,2,4-Trichlorobenzene	ND	ND	ND	ND	-	-	-	-
1,1,1-Trichloroethane	ND	ND	ND	ND	22000	5200	730000	170000

Table 4
VOC Analysis - Indoor and Sub-Slab Air
Former Colony Dry Cleaners
10003 W. Carmen Avenue
Milwaukee, Wisconsin 53225
June 2 and 5, 2009

Location	1203FO-24HR	0594-ER	0619-FOA	1278-ESA	Commercial	Residential	Commercial	Residential
					Indoor VAL	Indoor VAL	Sub-Slab VRSL	Sub-Slab VRSL
Volatile Organic Compounds (VOC) (Method: TO-15)								
1,1,2 - Trichloroethane	ND	ND	ND	ND	-	-	-	-
Trichloroethene	2.8	814E	13.3	122	8.8	2.1	290	70
Trichlorofluoromethane	ND	ND	1.5	3.6	-	-	-	-
1,1,2-Trichlorotrifluoroethane	ND	ND	ND	ND	-	-	-	-
1,2,4-Trimethylbenzene	5.5	3.5	6.2	7.4	31	7.3	1000	240
1,3,5-Trimethylbenzene	ND	ND	ND	ND	-	-	-	-
Vinyl acetate	ND	ND	ND	ND	-	-	-	-
Vinyl chloride	ND	ND	ND	ND	28	1.7	930	57
m&p-Xylene	13.0	7.9	13.4	22.2	440	100	15000	3300
o-Xylene	4.3	2.4	4.5	5.0	440	100	15000	3300

Notes: All results expressed as ug/m3

Residential Indoor Vapor Action Level (VAL) exceedance in *italics*

Small commercial Indoor VAL exceedance in *italics and shaded*

Residential Vapor Risk Screening Level (VRSL) exceedance in **bold**

Small Commercial VRSL exceedance in **bold and shaded**

- Indoor Vapor Action Level or Sub-Slab Vapor Risk Screening Level not established for this compound

E Analyte concentration exceeded the calibration range. The reported result is estimated

ND Compound not detected at or above the Method Detection Limit

Site Name: Former Colony Dry Cleaners

BRRTS #: 02-41-278106

Type of Action: Sub-Slab Vapor Sampling

Dry Cleaner Environmental Resp
Reimbursement Cost Detail Link

TASKS	BUDGET			Previous Claims (If applicable)	INVOICES						DERF COST BREAKOUT (this claim)					
	Bid / Budgeted Amount	INSERT	Total Approved Budget		Provider Name, Invoice #, Billing Date	Provider Name, Invoice #, Billing Date	Provider Name, Invoice #, Billing Date	Provider Name, Invoice #, Billing Date	INSERT	Total Invoiced Costs	A Soil Investigation	B Soil Remediation	C Groundwater Investigation	D Groundwater Remediation	E Air/Vapor Investigation	F Air/Vapor Remediation
Consultant Costs																
Task	\$ -	\$ -	\$ -							\$ -						
Field Engineer/Geologist	\$ 900.00		\$ 900.00							\$ -				\$ 900.00		
Project Engineer	\$ 600.00		\$ 600.00							\$ -				\$ 600.00		
			\$ -							\$ -						
			\$ -							\$ -						
			\$ -							\$ -						
			\$ -							\$ -						
			\$ -							\$ -						
			\$ -							\$ -						
			\$ -							\$ -						
Consultant Cost Total	\$ 1,500.00	\$ -	\$ 1,500.00	\$ -						\$ -						
Sub-Contractor Costs																
Service	\$ -	\$ -	\$ -							\$ -						
Vapor Pin Installation (Five (5) Pins)	\$ 750.00		\$ 750.00							\$ -				\$ 750.00		
Laboratory Analysis (VOC)	\$ 1,050.00		\$ 1,050.00							\$ -				\$ 1,050.00		
			\$ -							\$ -						
			\$ -							\$ -						
			\$ -							\$ -						
			\$ -							\$ -						
Sub-Contractor Cost Total	\$ 1,800.00	\$ -	\$ 1,800.00	\$ -						\$ -						
DERF ELIGIBLE SUB-TOTALS	\$ 3,300.00	\$ -	\$ 3,300.00	\$ -	\$ -	\$ -	\$ -	\$ -	\$ -	\$ -	\$ -	\$ -	\$ -	\$ 3,300.00	\$ -	

Non-DERF Eligible Expenses																
Non-DERF Cost Total			\$ -	\$ -	\$ -	\$ -	\$ -	\$ -	\$ -	\$ -						
INVOICE GRAND TOTAL			\$ -	\$ -	\$ -	\$ -	\$ -	\$ -	##	\$ -						

Total DERF Eligible Costs This Claim \$ 3,300.00
WARNING - Double Check Total Invoiced Costs c

Check Numbers

Response Program
 Budgeting Spreadsheet Form 4400-214D (R 08/12)

G Lab & Other Analysis	H Miscellaneous Costs	Budget Remaining Use (-) to indicate cost over-run	% Task Complete, Remarks
		\$ -	Task % Complete
		\$ 900.00	
		\$ 600.00	
		\$ -	
		\$ -	
		\$ -	
		\$ -	
		\$ -	
		\$ -	
		\$ -	
		\$ -	
		\$ 1,500.00	
		\$ -	
		\$ 750.00	
		\$ 1,050.00	
		\$ -	
		\$ -	
		\$ -	
		\$ -	
		\$ 1,800.00	
\$ -	\$ -	\$ 3,300.00	

Return to DERF Cost Breakout figures - possible errors found!

Site Name: Former Colony Dry Cleaners

BRRTS #: 02-41-278106

Type of Action: Site Investigation

TASKS	BUDGET							INVOICES								
	Sigma 10/2/01	Sigma 3/3/03	Sigma 11/14/03	UEC 1/13/06	UEC 4/24/09	UEC 11/26/10	INSERT	Total Approved Budget	Previous Claims (If applicable)	Sigma, #88210, 11/27/01	Sigma, #88441, 12/20/01	Sigma, #88633, 01/16/02	Sigma, #88924, 2/18/02	Sigma, #89195, 3/25/02	Sigma, #89483, 04/25/02	Sigma, #89718, 4/24/02
Consultant Costs																
Task	\$ -						\$ -	\$ -								
DERF Eligibility	\$ 510.00							\$ 510.00			\$ 138.75	\$ 191.25	\$ 170.00			
Workplan Preparation	\$ 780.00							\$ 780.00		\$ 500.00	\$ 225.00					
Boring/Monitoring Well/Vapor Probe Installation	\$ 4,015.00	\$ 2,366.00	\$ 1,013.00	\$ 1,560.00	\$ 1,500.00			\$ 10,454.00								
Project Coordination	\$ 2,500.00	\$ 3,700.00				\$ 520.00		\$ 6,720.00					\$ 395.72	\$ 447.50	\$ 170.00	\$ 103.75
Remedial Action Option/SI Report Preparation	\$ 6,005.00			\$ 8,800.00		\$ 8,560.00		\$ 23,365.00								
Soil Disposal Coordination		\$ 1,480.00						\$ 1,480.00								
UST Abandonment				\$ 500.00				\$ 500.00								
								\$ -								
								\$ -								
								\$ -								
Consultant Cost Total	\$ 13,810.00	\$ 7,546.00	\$ 1,013.00	\$ 10,860.00	\$ 1,500.00	\$ 9,080.00	\$ -	\$ 43,809.00	\$ -							
Sub-Contractor Costs																
Service	\$ -						\$ -	\$ -								
Drilling Services/Surveying	\$ 4,900.00	\$ 640.00	\$ 500.00	\$ 1,700.00	\$ 1,550.00			\$ 9,290.00								
Laboratory Services	\$ 1,275.00	\$ 1,045.00	\$ 330.00	\$ 1,265.00	\$ 1,215.00			\$ 5,130.00								
Soil Disposal		\$ 1,650.00		\$ 2,210.00				\$ 3,860.00								
UST Abandonment				\$ 1,500.00				\$ 1,500.00								
								\$ -								
								\$ -								
Sub-Contractor Cost Total	\$ 6,175.00	\$ 3,335.00	\$ 830.00	\$ 6,675.00	\$ 2,765.00	\$ -	\$ -	\$ 19,780.00	\$ -							
DERF ELIGIBLE SUB-TOTALS	\$ 19,985.00	\$ 10,881.00	\$ 1,843.00	\$ 17,535.00	\$ 4,265.00	\$ 9,080.00	\$ -	\$ 63,589.00	\$ -	\$ 500.00	\$ 363.75	\$ 191.25	\$ 565.72	\$ 447.50	\$ 170.00	\$ 103.75
Non-DERF Eligible Expenses																
Non-DERF Cost Total																
INVOICE GRAND TOTAL										\$ 500.00	\$ 363.75	\$ 191.25	\$ 565.72	\$ 447.50	\$ 170.00	\$ 103.75

Check Numbers										1008	2679	2089	1043	2113	2126	2142
----------------------	--	--	--	--	--	--	--	--	--	------	------	------	------	------	------	------

Longyear, #3410-4092, 7/12/02	Surveying Associates, #29287, 7/22/02	Sigma, #90352, 07/29/02	Sigma, #90573, 08/23/02	Sigma, #91208, 10/24/02	Sigma, #91602, 11/25/02	Sigma, #94272, 09/25/03	Sigma, #94487, 10/24/03	Sigma, #94888, 11/30/03	Sigma, #95613, 2/29/04	Clearwater Technologies, #100398, 5/7/04	UEC, #06004.1, 1/31/06	UEC, #06004.2, 2/28/06	UEC, #06004.3, 3/31/06	UEC, #06004.4, 6/30/06	UEC, #06004.5, 7/31/06	UEC, #06004.6, 8/31/06	UEC, #06004.7, 8/31/07
		\$ 4,163.25	\$ 377.50	\$ 570.00		\$ 3,104.50	\$ 1,069.50					\$ 438.75	\$ 422.50		\$ 812.50		
		\$ 937.50	\$ 975.00		\$ 995.00	\$ 1,284.75	\$ 425.00	\$ 680.00			\$ 350.00						
			\$ 150.00		\$ 461.25	\$ 637.50	\$ 1,255.00	\$ 1,942.50	\$ 2,333.50		\$ 1,550.00						\$ 910.00
				\$ 615.00								\$ 500.00					
	\$ 815.00					\$ 552.00		\$ 666.00			\$ 490.00				\$ 1,070.00		
		\$ 330.00			\$ 1,125.00	\$ 325.00	\$ 1,120.00	\$ 330.00				\$ 220.00	\$ 55.00		\$ 550.00		
									\$ 2,210.00				\$ 500.00	\$ 1,000.00			
\$ -	\$ 815.00	\$ 5,430.75	\$ 1,502.50	\$ 1,185.00	\$ 2,581.25	\$ 5,351.75	\$ 4,421.50	\$ 2,622.50	\$ 3,329.50	\$ 2,210.00	\$ 1,900.00	\$ 1,428.75	\$ 1,142.50	\$ 1,055.00	\$ 1,882.50	\$ 550.00	\$ 910.00

\$ 4,553.00		\$ 169.00		\$ 20.00	\$ 2.50	\$ 38.00	\$ 21.50										
\$ 4,553.00	\$ 815.00	\$ 5,599.75	\$ 1,502.50	\$ 1,205.00	\$ 2,583.75	\$ 5,389.75	\$ 4,443.00	\$ 2,622.50	\$ 3,329.50	\$ 2,210.00	\$ 1,900.00	\$ 1,428.75	\$ 1,142.50	\$ 1,055.00	\$ 1,882.50	\$ 550.00	\$ 910.00

2171	2172	2169	2196	2207	2216	2377	1011	2408	2408	2406	2540	2555	2547	2561	2561	2567	2589
------	------	------	------	------	------	------	------	------	------	------	------	------	------	------	------	------	------

**Dry Cleaner Environmental Res
Reimbursement Cost Detail Link**

												DERF COST BREAKOUT (this claim)							
UEC, #06004.8, 9/28/07	UEC, #06004.09 6/30/08	UEC, #06004.10, 1/31/09	UEC, #06004.11, 2/27/09	UEC, #06004.12, 5/29/09	UEC, #06004.13, 6/30/09	UEC, #06004.14, 07/31/09	UEC, #06004.15, 1/31/11	UEC, #06004.16, 2/28/11	UEC, #06004.17, 7/31/12	UEC, #06004.18, 8/17/12	INSERT	Total Invoiced Costs	A Soil Investigation	B Soil Remediation	C Groundwater Investigation	D Groundwater Remediation	E Air/Vapor Investigation	F Air/Vapor Remediation	
												\$ -							
												\$ 500.00							
												\$ 725.00	\$ 362.50		\$ 362.50				
\$ 650.00		\$ 552.50		\$ 520.00	\$ 1,650.64				\$ 260.00	\$ 260.00		\$ 14,851.64	\$ 8,811.58		\$ 4,519.42		\$ 1,520.64		
												\$ 6,764.22	\$ 4,301.13		\$ 1,793.57		\$ 669.52		
	\$ 500.00			\$ 800.00			\$ 2,000.00	\$ 2,075.00	\$ 2,590.00	\$ 1,895.00		\$ 19,099.75	\$ 13,306.38		\$ 3,916.80		\$ 1,876.57		
												\$ 615.00	\$ 615.00						
												\$ 500.00							
												\$ -							
												\$ -							
												\$ -							
												\$ 43,055.61							
												\$ -							
\$ 1,050.00		\$ 900.00			\$ 1,200.00							\$ 6,743.00	\$ 5,918.00		\$ 400.00		\$ 425.00		
\$ 660.00			\$ 335.00		\$ 1,028.00	\$ 380.00						\$ 6,458.00							
												\$ 2,210.00	\$ 2,210.00						
												\$ 1,500.00							
												\$ -							
												\$ -							
												\$ 16,911.00							
\$ 2,360.00	\$ 500.00	\$ 1,452.50	\$ 335.00	\$ 1,320.00	\$ 3,878.64	\$ 380.00	\$ 2,000.00	\$ 2,075.00	\$ 2,850.00	\$ 2,155.00	\$-	\$ 59,966.61	\$ 35,524.59	\$ -	\$ 10,992.29	\$ -	\$ 4,491.73	\$ -	

												\$ -							
												\$ -							
												\$ 4,804.00							
\$ 2,360.00	\$ 500.00	\$ 1,452.50	\$ 335.00	\$ 1,320.00	\$ 3,878.64	\$ 380.00	\$ 2,000.00	\$ 2,075.00	\$ 2,850.00	\$ 2,155.00	##	\$ 64,770.61							

Total DERF Eligible Costs This Claim \$ 60,186.61
WARNING - Double Check Total Invoiced Costs

2642	2642	2594	2594	2594	2594	2594	2606	2606	2606	2606	
------	------	------	------	------	------	------	------	------	------	------	--

Response Program
 Reporting Spreadsheet Form 4400-214D (R 08/12)

G Lab & Other Analysis	H Miscellaneous Costs	Budget Remaining Use (-) to indicate cost over-run	% Task Complete, Remarks
		\$ -	Task % Complete
	\$ 500.00	\$ 10.00	100
		\$ 55.00	100
		\$ (4,397.64)	100
		\$ (44.22)	100
		\$ 4,265.25	100
		\$ 865.00	100
	\$ 500.00	\$ -	100
		\$ -	
		\$ -	
		\$ -	
		\$ 753.39	
		\$ -	
		\$ 2,547.00	100
\$ 6,678.00		\$ (1,328.00)	100
		\$ 1,650.00	100
	\$ 1,500.00	\$ -	100
		\$ -	
		\$ -	
		\$ 2,869.00	
\$ 6,678.00	\$ 2,500.00	\$ 3,622.39	

Column to DERF Cost Breakout figures - possible errors found!