

**From:** United Engineering Tim Anderson <tauec@sbcglobal.net>  
**Sent:** Tuesday, August 22, 2023 9:05 AM  
**To:** Michalets, Linda M - DNR  
**Subject:** Updated Figure 2 : Site Plan Map - Former Colony Dry Cleaners - 10003 W. Carmen Avenue  
**Attachments:** Figure 2 - Site Plan Map - 2023.08.22.pdf

**CAUTION: This email originated from outside the organization.  
Do not click links or open attachments unless you recognize the sender and know the content is safe.**

Linda,

Ground penetrating radar testing was recently performed inside the building with the results indicated on the attached updated Site Plan Map. Please see the apparent storm sewer lateral extending from the main in W. Carmen Avenue to the offices at the western corner of the structure to immediately adjacent to the former equipment room. Are you available this afternoon or tomorrow afternoon to discuss?

Thanks!

Tim

**Timothy J. Anderson, P.E.**  
**Principal**

**UNITED ENGINEERING CONSULTANTS, INC**  
2938 S. 166th Street, New Berlin, WI 53151  
Office (262)-785-1447 - Fax (262)-706-4400

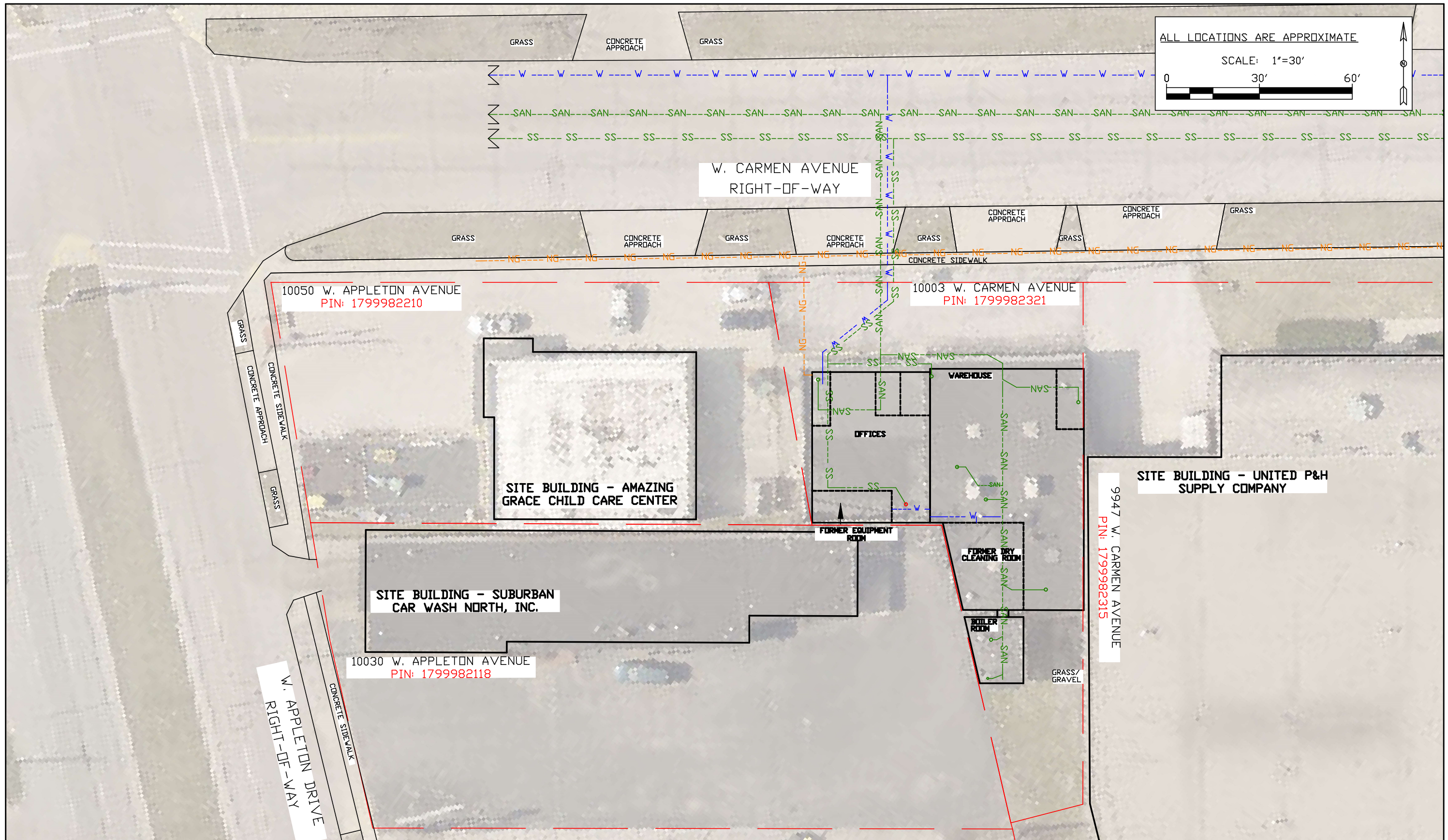

**Figure 2: Site Plan Map**

**United Engineering Consultants, Inc.**  
 2938 S. 166th Street  
 New Berlin, WI 53151  
 Tel. (262) 785-1447  
 Fax (262) 706-4400

#06004  
 DRAWN BY: NJA  
 DATE: 08/22/2023

Site Investigation Report  
 Former Colony Dry Cleaners  
 10003 W. Carmen Avenue  
 Milwaukee, WI 53225

**Legend**

- Property Line
- - - NG - Underground Natural Gas Line
- - - W - Underground Water Line
- - - SAN - Combined Sewer Line
- - - SS - Underground Storm Sewer Line
- Existing or Former Floor Drain