





State of Wisconsin \ DEPARTMENT OF NATURAL RESOURCES

Jim Doyle, Governor  
Scott Hassett, Secretary  
Gloria L. McCutcheon, Regional Director

Southeast Region Headquarters  
2300 N. Dr. Martin Luther King, Jr. Drive  
PO Box 12436  
Milwaukee, Wisconsin 53212-0436  
Telephone 414-263-8500  
FAX 414-263-8606  
TTY 711

December 9, 2003

Gerald and Karen Butz  
Post Office Box 955  
West Bend, WI 53095

**SUBJECT: Final Case Closure By Project Manager Clothes Clinic, 17-31  
Lone Oak Lane, Hartford, WI WDNR FID# 267087370, BRRTS # 02-67-278113**

Dear Mr. And Mrs. Butz:

On December 9, 2003 your site as described above was reviewed for closure by the Department of Natural Resources. The Department reviews environmental remediation cases for compliance with state laws and standards to maintain consistency in the closure of these cases. On November 3, 2003, you were notified that conditional closure was granted to this case.

On December 1, 2003, the Department received correspondence indicating that you have complied with the conditions of closure. All of the monitoring wells have been properly abandoned to comply with Wis Adm Code ch. NR141. Based on the correspondence and data provided, it appears that your case has been remediated to Department standards in accordance with s. NR 726.05, Wis. Adm. Code. The Department considers this case closed and no further investigation, remediation or other action is required at this time.

Your site will be listed on the DNR Remediation and Redevelopment GIS Registry of Closed Remediation Sites. Information that was submitted with your closure request application will be included on the registry. To review the sites on the GIS Registry web page, visit <http://gomapout.dnr.state.wi.us/org/at/et/geo/gwur/index.htm>

Please be aware that this case may be reopened pursuant to s. NR 726.09, Wis. Adm. Code, if additional information regarding site conditions indicates that contamination on or from the site poses a threat to public health, safety or welfare, or the environment.

The Department appreciates your efforts to restore the environment at this site. If you have any questions regarding this letter, please contact me at (414)263-8564.

Sincerely,

Michelle Williams, Hydrogeologist  
Bureau for Remediation & Redevelopment

cc: Richard Gnat, KPR & Associates, inc.  
Don Gallo, Reinhart, Boerner, & Van Deuren, S.C.

DOC#: 926906

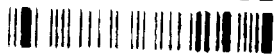

STATE BAR OF WISCONSIN FORM 7 - 1998  
TRUSTEE'S DEED

Document Number:

Recorded  
MAR. 26, 2002 AT 10:45AM  
DOROTHY C. GONNERING  
REGISTER OF DEEDS  
WASHINGTON COUNTY, WI  
Fee Amount: \$11.00  
Transfer fee: \$1800.00

Gerald A. Butz and Karen M. Butz  
as Trustees  
v/a dated March 14, 1995.

for a valuable consideration conveys without warranty to Lone Oak Development, LLC,  
a Wisconsin limited liability company.

Recording Area

Name and Return Address

11-1  
Scott L. Langlois, Esq.  
Quarles & Brady  
411 E. Wisconsin Ave.  
Milwaukee WI 53202

Grantee,  
the following described real estate in Washington County,  
State of Wisconsin: Lot Two (2), of CERTIFIED SURVEY MAP NO. 3130, being a division of  
part of the Southeast One-quarter (1/4) and Southwest One-quarter (1/4) of the Northern One-  
quarter (1/4) of Section Twenty-two (22), in Township Ten (10) North, Range Eighteen (18) East,  
in the City of Hanford, County of Washington, State of Wisconsin, recorded in the office of the  
Register of Deeds for Washington County on October 12, 1987, in Volume 18 of Certified Survey  
Maps, on Pages 120 to 123 inclusive, as Document No. 519016.

36-2202-001-018  
Parcel Identification Number (PIN)

Said lands are now a part of Lot 2 Certified Survey Map No. 5397, recorded on September 25,  
2001, in Volume 38 of Certified Survey Map at page 185 as Document No. 901742.

TRANSFER  
\$ 1,800.00  
FEE

Dated this 11 day of JAN., 2002.

*Gerald A. Butz* (SEAL)

*Karen M. Butz* (SEAL)

\* Gerald A. Butz  
Trustee

\* Karen M. Butz  
Trustee

AUTHENTICATION

ACKNOWLEDGMENT

Signature(s) \_\_\_\_\_

State of Wisconsin, )  
) ss

Washington Co County )

authenticated this \_\_\_\_\_ day of \_\_\_\_\_

Personally came before me this 11<sup>th</sup> day of  
JANUARY, 2002, the above named

TITLE: MEMBER STATE BAR OF WISCONSIN  
(If not, \_\_\_\_\_  
authorized by § 706.06, Wis. Stats.)

GERALD A. BUTZ + KAREN M. BUTZ

me known to be the person \_\_\_\_\_ who executed the foregoing  
instrument and acknowledge the same.

THIS INSTRUMENT WAS DRAFTED BY

*Richard T. Dierker*

Scott L. Langlois, Esq.

Quarles & Brady

(Signatures may be authenticated or acknowledged. Both are not necessary.)

Richard J. Ditzler

Notary Public, State of Wisconsin

My Commission is permanent. (If not, state expiration date: 4-12-2003)

\*Names of persons signing in any capacity must be typed or printed below their signature.

WITNESSES DEED

STATE BAR OF WISCONSIN  
FORM No. 7 - 1998

**CERTIFIED SURVEY MAP No. 5397**

BEING A CONSOLIDATION OF LOT 2 OF CSM NO. 2130, LOT 3 OF CSM NO. 3782 AND PART OF THE SW 1/4 OF THE NW 1/4 OF SECTION 22, TOWN 10 NORTH, RANGE 18 EAST, CITY OF HARTFORD, WASHINGTON COUNTY, WISCONSIN.

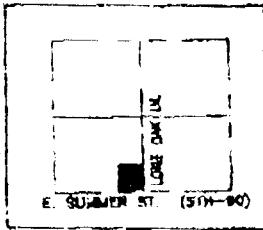

LOCATION MAP  
 NW 1/4 SECTION 22  
 T 10 N, R 18 E  
 1" = 1000'

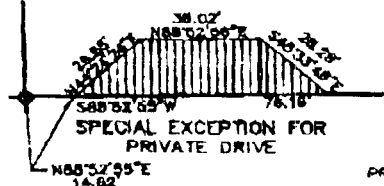

**SPECIAL EXCEPTION FOR PRIVATE DRIVE**



STS Consultants Ltd.  
 Consulting Engineers  
 1428 W. Lake Park Dr.  
 Waukegan, WI 53226  
 414.303.3030

PREPARED FOR:

LONE OAK DEVELOPMENT LLC  
 4232 57830 Big Bend Drive  
 Big Bend, Wis. 53103  
 262-882-6851

RONALD AND PAMELA FISCHER  
 341 N. State Street  
 Hartford, Wis. 53027  
 262-873-3523

GERALD A. AND KAREN M. BUTZ  
 1826 Lang St.  
 West Bend, Wis. 53090  
 262-338-5225

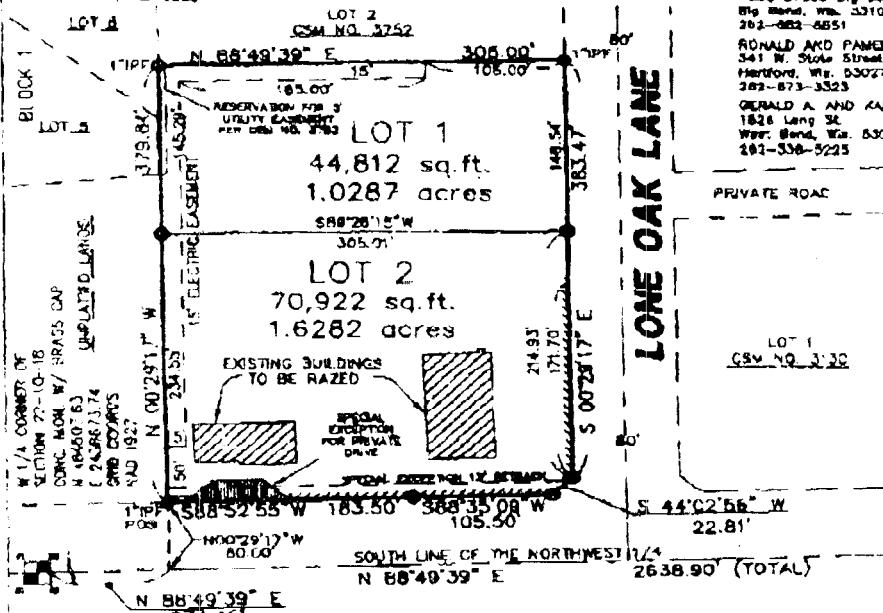

OWNER IN SECTION 22-10-18 CONG. MON. W/ BRACK. CAP

MAX. NO. 5107 WITH 38' DAVEL 105'

**LEGEND:**

○ INDICATED 1 1/2" 30" IRON PIPE  
 WITH 300 1.13 LBS. PER LINEAL FOOT.

////// INDICATES RESTRICTED ACCESS

TRANS233 APPROVAL No

66-60-0572-01

**BEARING BASIS:**

ALL BEARINGS ARE REFERENCED TO ONE POINT OF THE WISCONSIN STATE PLANE COORDINATE SYSTEM. SOUTH ZONE. THE SOUTH LINE OF THE NW 1/4 OF SECTION 22-10-18 WAS USED AS N 88°44'39" E

PROJECT CONVERSION FACTOR 0.999999974 - GROUND SUBJECT TO ELEVATIONS OF RECORD.

ALL MEASUREMENTS HAVE BEEN MADE TO THE NEAREST ONE HUNDREDTH OF A FOOT.

ALL ANGULAR MEASUREMENTS HAVE BEEN MADE TO THE NEAREST ONE MINUTE.

DATED THIS 28TH DAY OF APRIL, 2001. REVISED SEPTEMBER 21, 2001  
 THIS INSTRUMENT WAS DRAFTED BY ROBERT C. BELFUS, S-2072. SHEET 1 OF 3

**E. SUMMER STREET (15TH-60)**



*Robert C. Belfuss*  
 ROBERT C. BELFUS  
 REGISTERED LAND SURVEYOR  
 S-2072

SCALE IN FEET

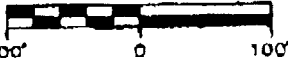



**CERTIFIED SURVEY MAP NO. 5397**

Being a consolidation of Lot 2 of CSM No. 3130, Lot 3 of CSM No. 3752 and part of the Southwest 1/4 of the Northwest 1/4 of Section 22, Township 10 North, Range 18 East, City of Hartford, Washington County, Wisconsin

**OWNER'S CERTIFICATE**

Lone Oak Development LLC, a corporation duly organized and existing under and by virtue of the Laws of the State of Wisconsin, and Ronald and Pamela Fischer as owners and Gerald A. Butz and Karen M. Butz as trustees, do hereby certify that said corporation caused the land described in the foregoing affidavit of Robert C. Beilfuss, to be surveyed, divided, and mapped as represented on this map, in accordance with the provisions of Chapter 236 of the Wisconsin Statutes and Chapter 12 of the City of Hartford Subdivision Control Ordinances.

This Agreement shall be binding on the undersigned and assigns.

In Witness whereof, the said Lone Oak Development LLC, Ronald and Pamela Fischer and Gerald A. Butz and Karen M. Butz, have caused these presents to be signed by Peter Schwabe its Managing Member and countersigned by \_\_\_\_\_, this 21<sup>st</sup> day of September, 2001.

Lone Oak Development LLC:  
  
 Peter Schwabe

State of Wisconsin )  
 ) SS  
 ( Washington County )

Personally came before me this 21<sup>st</sup> day of Sept, 2001, the above named Peter Schwabe, managing member of the above named corporation, to me known to be such managing member of said corporation, and acknowledged that they executed the foregoing instrument as such officer as the deed of said corporation by its authority.

John A. Dumb  
 Notary Public, Washington County, WI  
 My Commission Expires July 21, 2002

  
 Ronald Fischer

  
 Pamela Fischer

State of Wisconsin )  
 ) SS  
 ( Washington County )

Personally came before me this 21<sup>st</sup> day of Sept, 2001, the above named Ronald and Pamela Fischer acknowledged that they executed the foregoing instrument as owners of the land described therein.

John A. Dumb  
 Notary Public, Washington County, WI  
 My Commission Expires July 21, 2002

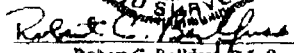

  
 Robert C. Beilfuss, R.L.S.  
 Registered Land Surveyor, S-2072

REVISED SEPTEMBER 21, 2001  
 DATED THIS 2<sup>nd</sup> DAY OF MAY, 2001  
 THIS INSTRUMENT WAS DRAFTED BY ROBERT C. BEILFUSS, S-2072  
 JOB NO. 86686

SHEET 3 OF 5

**CERTIFIED SURVEY MAP NO. 5397**

Being a consolidation of Lot 2 of CSM No. 3130, Lot 3 of CSM No. 3752 and part of the Southwest 1/4 of the Northwest 1/4 of Section 22, Township 10 North, Range 18 East, City of Hartford, Washington County, Wisconsin

Gerald A. Butz  
Gerald A. Butz

Karen M. Butz  
Karen M. Butz

State of Wisconsin )  
) SS  
Washington County )

Personally came before me this 21 day of September, 2001, the above named Gerald A. Butz and Karen M. Butz acknowledged that they executed the foregoing instrument as owners by their authority.

Richard J. Ditzler  
Notary Public, Washington County, Wis.  
My Commission Expires 4-12-02

**TRANS233 RESTRICTIONS:**

As Owner I hereby restrict all lots and blocks so that no owner, possessor, user, licensee or other person may have any right of direct vehicular ingress from or egress to any highway lying within the right-of-way of East Summer Street (S.T.H. 60), as shown on the land division map. It is expressly intended that this restriction constitute a restriction for the benefit of the public as provided in s. 236.293, Stat., and shall be enforceable by the department or its assigns.

No improvements or structures are allowed between the right-of-way line and the highway setback line. Improvements and structures include, but are not limited to, signs, parking areas, driveways, wells, septic systems, drainage facilities, buildings and retaining walls. It is expressly intended that this restriction is for the benefit of the public as provided in s. 236.293, Wisconsin Statutes, and shall be enforceable by the Wisconsin Department of Transportation or its assigns. Contact the Wisconsin Department of Transportation for more information. The phone number may be obtained by contacting the County Highway Department.

The lots of this land division may experience noise at levels exceeding the levels in s. Trans 405.04, Table 1. These levels are based on federal standards. The Department of Transportation is not responsible for abating noise from existing state trunk highways or connecting highways, in the absence of any increase by the department to the highway's through-traffic capacity.

REVISED SEPTEMBER 21, 2001  
DATED THIS 7<sup>th</sup> DAY OF MAY, 2001



Robert C. Beilfuss  
Robert C. Beilfuss, R.L.S.  
Registered Land Surveyor, S-2072

(THIS INSTRUMENT WAS DRAFTED BY ROBERT C. BEILFUSS, S-2072  
JOB NO. 86696

SHEET 4 OF 5

MAP FILED IN VOL 28 PAGE 109



**CERTIFIED SURVEY MAP NO. 5397**

Being a consolidation of Lot 2 of CSM No. 3130, Lot 3 of CSM No. 3752 and part of the Southwest 1/4 of the Northwest 1/4 of Section 22, Township 10 North, Range 18 East, City of Hartford, Washington County, Wisconsin

**CITY OF HARTFORD PLAN COMMISSION RESOLUTION**

Resolved, that this Certified Survey Map in the City of Hartford, Ronald and Pamela Fischer, and Lone Oak Development LLC, owners, is hereby approved by the Plan Commission.

*Scott M. Henke*

Scott M. Henke, Chairman

9/21/01

Date

I hereby certify that the foregoing is a copy of a resolution adopted by the Common Council of the City of Hartford.

*William G. Ripp*

William G. Ripp, Secretary

9/21/01

Date

**COMMON COUNCIL RESOLUTION**

Resolved, that this Certified Survey Map in the City of Hartford, Ronald and Pamela Fischer, and Lone Oak Development LLC, owners, is hereby approved by the Common Council.

*Scott M. Henke*

Scott M. Henke, Mayor

9/21/01

Date

I hereby certify that the foregoing is a copy of a resolution adopted by the Common Council of the City of Hartford.

*Marjorie C. Savana*

Marjorie C. Savana, City Clerk

9-21-01

Date

DCCL: 501762



Recorded  
15,2841 9/21/01  
PROB. C. JEROME  
RECEIVED 9/21/01  
WASHINGTON COUNTY, WI  
Fee Received: 115.00



*Robert C. Beilfuss*  
Robert C. Beilfuss, R.L.S.  
Registered Land Surveyor, 5-2072

DCCL: 401772

DATED THIS 2<sup>ND</sup> DAY OF MAY, 2001. Revised 29<sup>TH</sup> DAY OF MAY, 2001  
THIS INSTRUMENT WAS DRAFTED BY ROBERT C. BEILFUSS, S-2072  
JOB NO 46686

SHEET 5 OF 5

**(B3)**

**Parcel Identification Information**

Parcel ID Number: 36-2202-001-053

Address: 17-31 Lone Oak Drive, Hartford, WI

Certified Survey Map Number: 5397-Lot 1 (See Attachment B2)

Geographic Position (WTM83/91): 653430, 317434

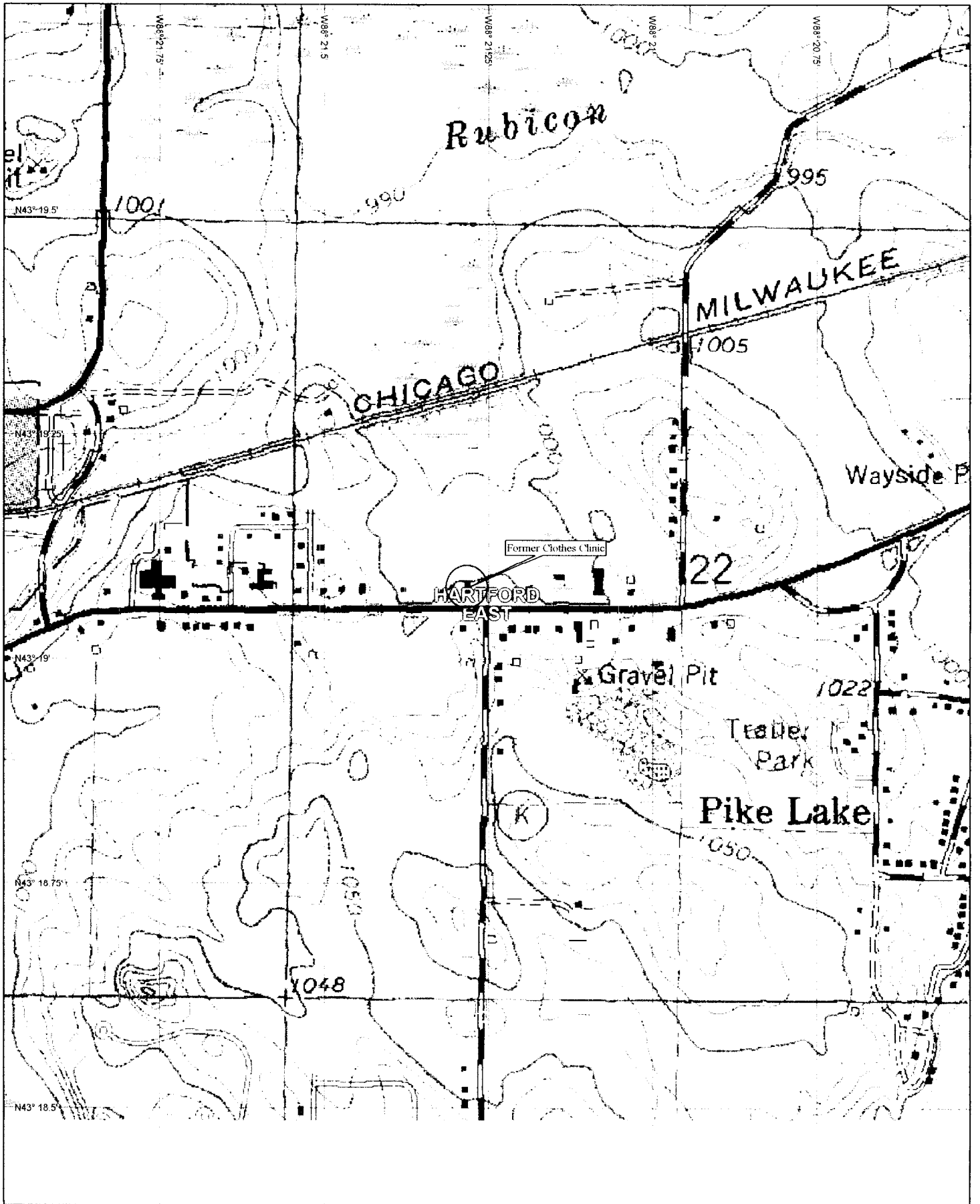

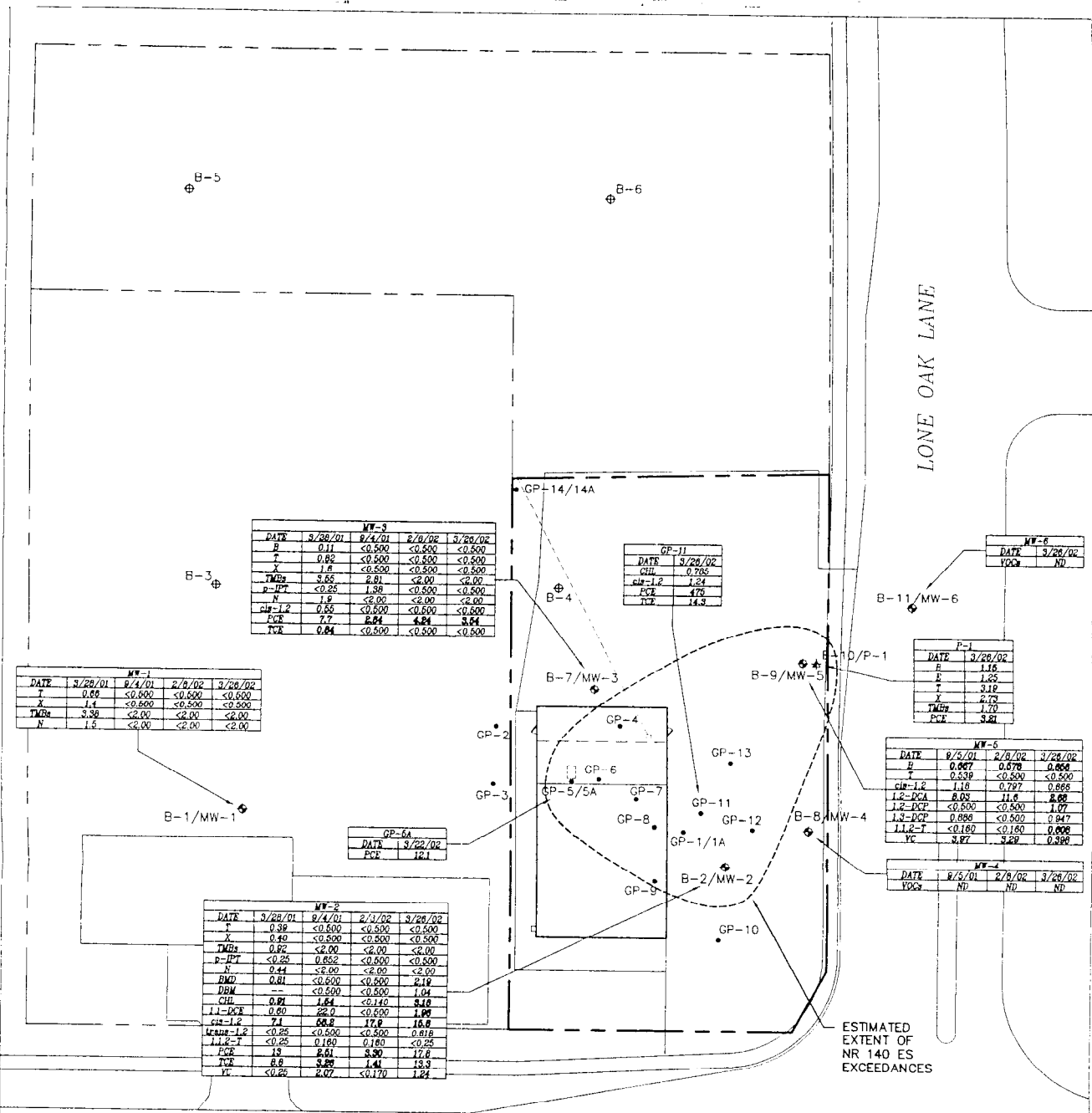

MW-1				
DATE	3/28/01	8/4/01	2/9/02	3/26/02
B	0.09	<0.500	<0.500	<0.500
T	1.4	<0.500	<0.500	<0.500
TMBs	3.38	<2.00	<2.00	<2.00
N	1.5	<2.00	<2.00	<2.00

MW-3				
DATE	3/28/01	8/4/01	2/9/02	3/26/02
B	0.11	<0.500	<0.500	<0.500
T	0.82	<0.500	<0.500	<0.500
X	1.8	<0.500	<0.500	<0.500
TMBs	3.65	2.81	<2.00	<2.00
p-IPT	<0.25	1.39	<0.500	<0.500
N	1.8	<2.00	<2.00	<2.00
chl-1,2	0.55	<0.500	<0.500	<0.500
PCE	7.7	8.84	4.84	5.84
TCE	0.84	<0.500	<0.500	<0.500

GP-11	
DATE	3/26/02
chl	0.785
chl-1,2	1.24
PCE	476
TCE	14.3

MW-6	
DATE	3/26/02
YOCs	ND

P-1				
DATE	3/26/02			
B	1.16			
T	1.55			
X	3.19			
TMBs	4.73			
N	1.79			
PCE	3.81			

MW-5				
DATE	8/5/01	2/9/02	3/26/02	
B	0.667	0.678	0.666	
T	0.539	<0.500	<0.500	
chl-1,2	1.18	0.797	0.886	
1,2-DCA	8.08	11.6	8.88	
1,2-DCE	<0.500	<0.500	1.07	
1,3-DCE	0.886	<0.500	0.847	
1,1,1-T	<0.160	<0.160	0.808	
VC	3.87	5.28	0.598	

MW-4				
DATE	8/5/01	2/9/02	3/26/02	
YOCs	ND	ND	ND	

MW-2				
DATE	3/28/01	8/4/01	2/9/02	3/26/02
B	0.39	<0.500	<0.500	<0.500
T	0.40	<0.500	<0.500	<0.500
X	0.92	<2.00	<2.00	<2.00
TMBs	<0.25	0.852	<0.500	<0.500
N	0.44	<2.00	<2.00	<2.00
BND	0.81	<0.500	<0.500	2.19
DBM	<0.500	<0.500	1.04	
chl	0.81	1.84	<0.140	3.18
1,1-DCE	0.80	22.0	<0.600	1.89
chl-1,2	7.1	68.8	17.8	16.6
1,1,1-T	<0.25	<0.500	<0.500	0.818
1,1,2-T	<0.25	0.180	0.180	<0.25
PCE	19	8.61	8.80	17.6
TCE	8.8	3.89	1.41	13.3
VC	<0.25	2.07	<0.170	1.24

EAST SUMNER STREET  
(STATE HWY. 60)

LEGEND

- ⊕ MONITORING WELL LOCATION
- ⊕ PIEZOMETER LOCATION
- ⊕ SOIL BORING LOCATION
- SOIL PROBE LOCATION
- / DOOR
- [ ] LOCATION OF FORMER DRY CLEANING MACHINE
- SANITARY SEWER
- APPROXIMATE LOCATION OF SUMP PUMP DISCHARGE PIPE
- NATURAL GAS UTILITY
- APPROXIMATE LOCATION OF WATER UTILITY
- WATER VALVE
- BURIED ELECTRIC UTILITY
- BURIED TELEPHONE UTILITY
- 0.01 CONCENTRATION EXCEEDS NR 140 PAL
- 0.01 CONCENTRATION EXCEEDS NR 140 ES

- NOTES:
- YOCs: VOLATILE ORGANIC COMPOUNDS ug/L
  - B: BENZENE ug/L
  - T: TOLUENE ug/L
  - X: TOTAL XYLENES ug/L
  - TMBs: TOTAL TRIMETHYLBENZENES ug/L
  - N: NAPHTHALENE ug/L
  - p-IPT: p-ISOPROPYLBENZENE ug/L
  - chl: CHLOROPHANE ug/L
  - DBM: DIBROMOCHLOROBENZENE ug/L
  - PCE: TETRACHLOROETHYLENE ug/L
  - TCE: TRICHLOROETHYLENE ug/L
  - 1,1-DCE: 1,1-DICHLOROETHYLENE ug/L
  - 1,2-DCE: 1,2-DICHLOROETHYLENE ug/L
  - 1,2-DCP: 1,2-DICHLOROPROPANE ug/L
  - 1,3-DCE: 1,3-DICHLOROETHYLENE ug/L
  - 1,1,1-T: 1,1,1-TRICHLOROETHANE ug/L
  - chl-1,2: 1,2-DICHLOROETHYLENE ug/L
  - 1,1,2-T: 1,1,2-TRICHLOROETHYLENE ug/L
  - 1,2,3-T: 1,2,3-TRICHLOROETHYLENE ug/L
  - BND: BROMODIBROMOETHYLENE ug/L
  - ug/L: MICROGRAMS PER LITER
  - < : LESS THAN
  - ND: NOT DETECTED ABOVE LABORATORY METHOD DETECTION LIMITS
  - PAL: PREVENTIVE ACTION LIMIT
  - ES: ENFORCEMENT STANDARD

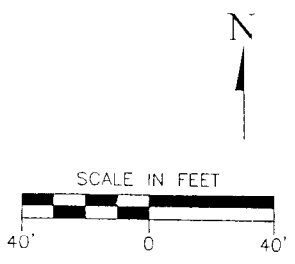

DESIGNED BY	DATE
CMH	04/25/02
DRAWN BY	PROJECT
CS	1106005
APPROVED BY	SHEET NO.
GLJ	B
CAPFILE @ LACAD:\1106005\1106005.dwg	
SCALE	

FIGURE 7  
SUMMARY OF GROUNDWATER SAMPLE ANALYTICAL RESULTS  
SITE INVESTIGATION AND REMEDIAL ACTION OPTIONS REPORT  
CLOTHES CLINIC  
17-31 LONE OAK LANE  
HARTFORD, WISCONSIN

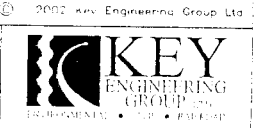

© 2002 Key Engineering Group Ltd.

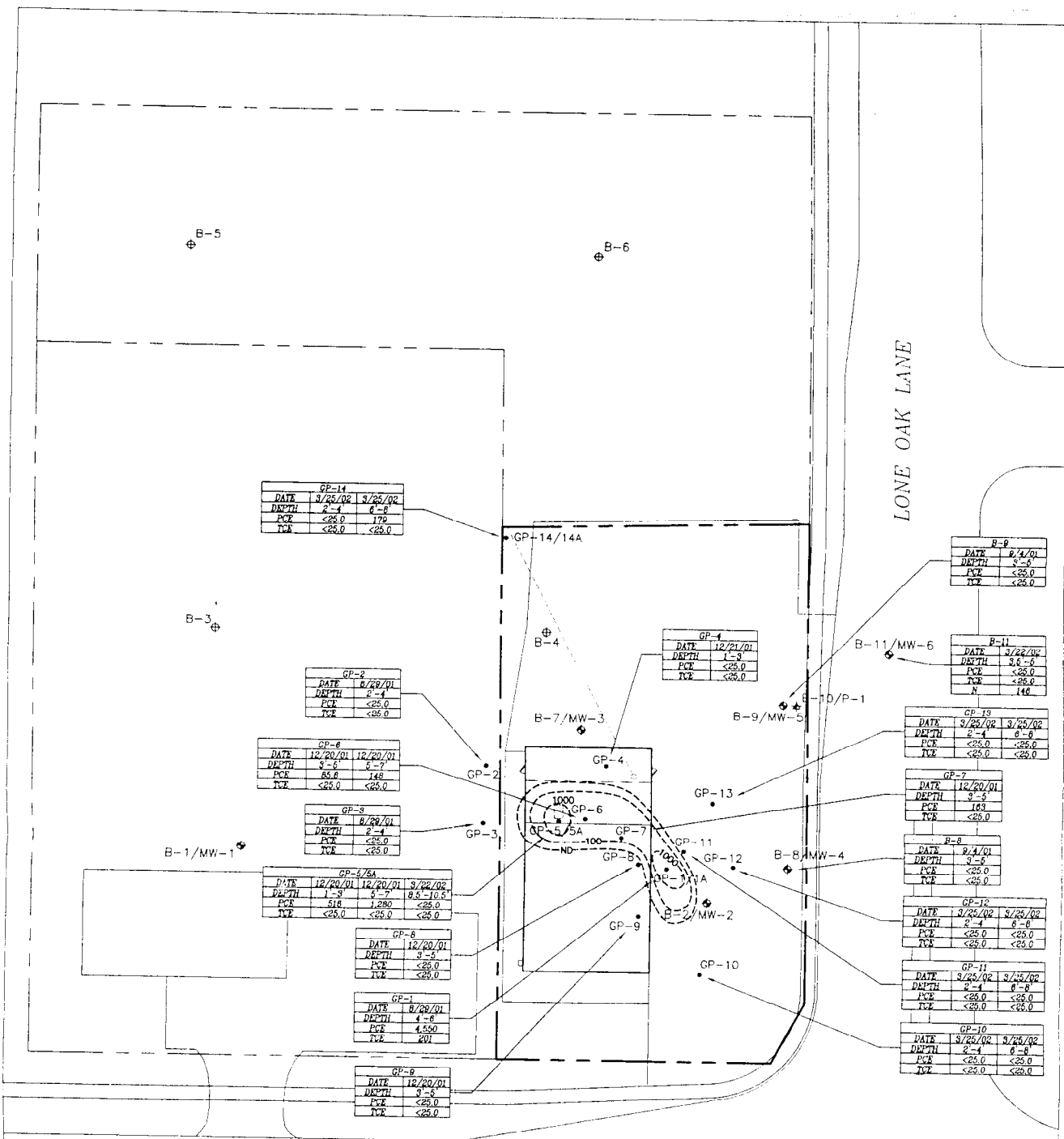

EAST SUMNER STREET  
(STATE HWY. 60)

- LEGEND**
- ⊕ MONITORING WELL LOCATION
  - ⊕ PIEZOMETER LOCATION
  - ⊕ SOIL BORING LOCATION
  - SOIL PROBE LOCATION
  - 100— PCE ISOCONCENTRATION CONTOUR
  - > DOOR
  - [ ] LOCATION OF FORMER DRY CLEANING MACHINE
  - SANITARY SEWER
  - APPROXIMATE LOCATION OF SUMP PUMP DISCHARGE PIPE
  - NATURAL GAS UTILITY
  - APPROXIMATE LOCATION OF WATER UTILITY
  - WATER VALVE
  - BURIED ELECTRIC UTILITY
  - BURIED TELEPHONE UTILITY

**NOTES:**  
 PCE = VOLATILE ORGANIC COMPOUND, ug/kg  
 TCE = TETRACHLOROETHYLENE, ug/kg  
 TCE = TRICHLOROETHYLENE, ug/kg  
 N = NAPHTHALENE, ug/kg  
 ug/kg = MICROGRAMS PER KILOGRAM  
 < = LESS THAN

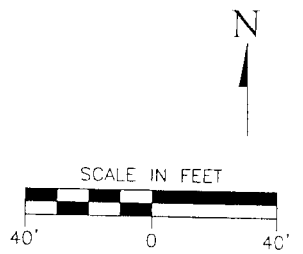

DESIGNED BY CMH	DATE 04/25/02
DRAWN BY CS	PROJECT 1106005
APPROVED BY C.J.J.	SHEET NO. 7
<small>TABLE G: VADOC\1106005\1106005.dwg          1/8/02 1:54PM</small>	

FIGURE 6  
 SUMMARY OF SOIL SAMPLE ANALYTICAL RESULTS  
 SITE INVESTIGATION AND REMEDIAL ACTION OPTIONS REPORT  
 CLOTHES CLINIC  
 17-31 LONE OAK LANE  
 HARTFORD, WISCONSIN



Table 1. Summary of Ground Water Monitoring Results - Clothes Clinic, Inc., Hartford, WI  
 All values in ug/l unless otherwise noted.

Well No.	WDNR NR 140 Standards		MW-2R			MW-3R			MW-5R			P-1R			MW-7		
	PAL	ES	1/22/03	5/2/03	8/8/03	1/22/03	5/2/03	8/8/03	1/22/03	5/2/03	8/8/03	1/22/03	5/2/03	8/8/03	1/22/03	5/2/03	8/8/03
Sample Date																	
Benzene	0.5	5	<0.10	<0.25	<0.25	<0.10	<0.25	<0.25	<0.10	<0.25	<0.25	0.31	0.55	0.71	0.32	<0.25	<0.25
Bromodichloromethane	0.06	0.6	<b>0.74</b>	<b>0.83</b>	0.5	<0.25	<0.25	<0.25	<0.25	<0.25	<0.25	<0.25	<0.25	<0.25	<0.25	<0.25	<0.25
Chloroform	0.6	6	1.1	1	0.69	<0.25	<0.25	<0.25	<0.25	<0.25	<0.25	<0.25	<0.25	<0.25	<0.25	<0.25	<0.25
Chloromethane	0.3	3	<0.25	<0.25	<0.25	<0.25	<0.25	<0.25	<0.25	<0.25	<0.25	<0.25	0.79	<0.25	<0.25	<0.25	<0.25
Ethylbenzene	140	700	<0.50	<0.50	<0.50	<0.50	<0.50	<0.50	<0.50	<0.50	<0.50	0.99	<0.50	<0.50	0.6	<0.50	<0.50
Naphthalene	8	40	<0.25	<0.25	<0.25	<0.25	<0.25	<0.25	<0.25	<0.25	<0.25	<0.25	<0.25	<0.25	1	<0.25	<0.25
Tetrachloroethene	0.5	5	4.6	1.9	3.4	<0.50	<0.50	<0.50	<0.50	<0.25	<0.25	0.84	<0.50	<0.50	<0.50	<0.50	<0.50
Trichloroethene	0.5	5	0.3	<0.25	<0.25	<0.25	<0.25	<0.25	<0.25	<0.25	<0.25	<0.25	<0.25	<0.25	<0.25	<0.25	<0.25
Toluene	200	1,000	<0.10	<0.25	<0.25	0.68	<0.25	<0.25	<0.10	<0.25	<0.25	0.74	0.86	0.71	5.8	<0.25	<0.25
1,2,4-Trimethylbenzene	96	480	<0.10	<0.25	<0.25	0.59	<0.25	<0.25	<0.10	<0.25	<0.25	0.65	0.35	0.49	2.1	<0.25	<0.25
1,3,5-Trimethylbenzene	96	480	<0.10	<0.25	<0.25	0.18	<0.25	<0.25	0.45	<0.25	<0.25	0.13	<0.25	<0.25	0.43	<0.25	<0.25
Xylenes	1,000	10,000	<0.50	<0.50	<0.50	0.79	<0.50	<0.50	<0.50	<0.50	<0.50	2.2	<0.50	0.77	3.2	<0.50	<0.50
Chloride (mg/l)	125	250	87	240	<b>300</b>	<b>350</b>	<b>500</b>	<b>330</b>	<b>2120</b>	<b>1790</b>	<b>2350</b>	<b>300</b>	220	<b>920</b>	250	240	<b>280</b>
Total Organic Carbon (mg/l)	NE	NE	4.9	79	5.3	16	70	11	23	120	10	7.1	46	15	14	67	14

PAL - Preventative Action Limit  
 ES - Enforcement Standard  
 NE - Not Established

Italics - Exceeds Preventative Action Limit  
 Bold - Exceeds Enforcement Standard



MW-3R  
 BENZENE: <0.25  
 BROMODICHLOROMETHANE: <0.25  
 CHLOROFORM: <0.25  
 TETRACHLOROETHENE: <0.50  
 TOLUENE: <0.25  
 1,2,4-TRIMETHYLBENZENE: <0.25  
 1,3,5-TRIMETHYLBENZENE: <0.25  
 XYLENES: <0.50  
 CHLORIDE (mg/l): **330**

MW-7  
 BENZENE: <0.25  
 BROMODICHLOROMETHANE: <0.25  
 CHLOROFORM: <0.25  
 TETRACHLOROETHENE: <0.50  
 TOLUENE: <0.25  
 1,2,4-TRIMETHYLBENZENE: <0.25  
 1,3,5-TRIMETHYLBENZENE: <0.25  
 XYLENES: <0.50  
 CHLORIDE (mg/l): **280**

P-1R  
 BENZENE: *0.71*  
 BROMODICHLOROMETHANE: <0.25  
 CHLOROFORM: <0.25  
 TETRACHLOROETHENE: <0.50  
 TOLUENE: *0.71*  
 1,2,4-TRIMETHYLBENZENE: *0.49*  
 1,3,5-TRIMETHYLBENZENE: <0.25  
 XYLENES: *0.77*  
 CHLORIDE (mg/l): **820**

MW-5R  
 BENZENE: <0.25  
 BROMODICHLOROMETHANE: <0.25  
 CHLOROFORM: <0.25  
 TETRACHLOROETHENE: <0.25  
 TOLUENE: <0.25  
 1,2,4-TRIMETHYLBENZENE: <0.25  
 1,3,5-TRIMETHYLBENZENE: <0.25  
 XYLENES: <0.50  
 CHLORIDE (mg/l): **2350**

MW-2R  
 BENZENE: <0.25  
 BROMODICHLOROMETHANE: *0.5*  
 CHLOROFORM: *0.69*  
 TETRACHLOROETHENE: *3.4*  
 TOLUENE: <0.25  
 1,2,4-TRIMETHYLBENZENE: <0.25  
 1,3,5-TRIMETHYLBENZENE: <0.25  
 XYLENES: <0.50  
 CHLORIDE (mg/l): **300**

FORMER STRIP  
 MALL WITH  
 CLOTHES CLINIC

NEW WALGREENS

ASPHALT DRIVE

ASPHALT  
 PARKING

SHRUBS

ASPHALT  
 PARKING

SHRUBS

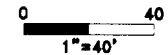

REINSTALLED MONITORING WELL

ALL VALUES ARE IN  $\mu\text{g/l}$  UNLESS OTHERWISE NOTED. ITALICS INDICATES PAL EXCEEDANCE. BOLD INDICATES ES EXCEEDANCE.

K E I M A U P Y G E S R Y S I E W E C Z AND ASSOCIATES, INC.

14005 W. Lisbon Rd., Suite 201 Brookfield, Wisconsin Telephone 262-791-0475 Facsimile 262-791-0476  
 1020 Kildare Drive, Deer, Indiana 46311 Telephone 219-945-8946 Facsimile 219-945-8947  
 444 Plaza Drive, Suite 102 Westmont, Illinois 60090 Telephone 630-328-1200 Facsimile 630-328-1883

SUMMARY OF GROUND WATER  
 MONITORING DATA (8-8-03)

CLOTHES CLINIC, INC.  
 HARTFORD, WISCONSIN

Scale: 1"=40'

Date: September 30, 2003

KPR Project No. 15102

FIGURE B7-1

TABLE 2  
SUMMARY OF SOIL SAMPLE ANALYTICAL RESULTS  
SITE INVESTIGATION AND REMEDIAL ACTION OPTIONS REPORT

CLOTHES CLINIC  
17-31 Lone Oak Lane  
Hartford, Wisconsin

PARAMETERS	SAMPLE IDENTIFICATION																										
	GP-1	GP-2	GP-3	B-8	B-9	GP-4	GP-5		GP-6		GP-7	GP-8	GP-9	B-11	GP-5A	GP-10		GP-11		GP-12		GP-13		GP-14			
Date Collected	8/29/01	8/29/01	8/29/01	9/4/01	9/4/01	12/20/01	12/20/01	12/20/01	12/20/01	12/20/01	12/20/01	12/20/01	12/20/01	3/22/02	3/22/02	3/25/02	3/25/02	3/25/02	3/25/02	3/25/02	3/25/02	3/25/02	3/25/02	3/25/02	3/25/02	3/25/02	
Depth (feet bgs)	4-6	2-4	2-4	3-5	3-5	1-3	1-3	5-7	3-5	5-7	3-5	3-5	3-5	3.5-5	8.5-10.5	2-4	6-8	2-4	6-8	2-4	6-8	2-4	6-8	2-4	6-8	2-4	6-8
PID (i.u.)	<1	<1	<1	<1	2	12	2	22	3	6	6	3	3	<1	<1	<1	<1	<1	<1	<1	<1	<1	<1	<1	<1	<1	
Detected VOC (µg/kg)																											
Tetrachloroethene	4,550	<25.0	<25.0	<25.0	<25.0	<25.0	518	1,280	85.6	148	163	<25.0	<25.0	<25.0	<25.0	<25.0	<25.0	<25.0	<25.0	<25.0	<25.0	<25.0	<25.0	<25.0	<25.0	<25.0	<25.0
Trichloroethene	201	<25.0	<25.0	<25.0	<25.0	<25.0	<25.0	<25.0	<25.0	<25.0	<25.0	<25.0	<25.0	<25.0	<25.0	<25.0	<25.0	<25.0	<25.0	<25.0	<25.0	<25.0	<25.0	<25.0	<25.0	<25.0	179
Naphthalene	<25.0	<25.0	<25.0	<25.0	<25.0	<25.0	<25.0	<25.0	<25.0	<25.0	<25.0	<25.0	<25.0	146	<25.0	<25.0	<25.0	<25.0	<25.0	<25.0	<25.0	<25.0	<25.0	<25.0	<25.0	<25.0	<25.0

Notes:

- bgs - below ground surface
- i.u. - instrument units
- PID - photoionization detector
- µg/kg - micrograms per kilogram
- VOCs - volatile organic compounds



# POST REMEDIAL

Table 3-1. Excavation No. 1 - Summary of Verification Sampling Data

Sample No.	Depth (ft)	Detected Compounds in UG/KG			
		Tetrachloroethene	Trichloroethene	1,1-Dichloroethene	cis-1,2-Dichloroethene
E1-B1-1	9	ND	ND	ND	ND
E1-B2-1	9	87	ND	ND	ND
E1-B2-2	11	64	ND	ND	ND
E1-B3-1	9	ND	ND	ND	ND
E1-B4-1	9	ND	ND	ND	ND
E1-B5-1	9	133	ND	ND	ND
E1-B5-2	12	2,340	1,670	41	412
E1-SW1-1	6 to 7	937	ND	ND	ND
E1-SW1-2	6 to 7	ND	ND	ND	ND
E1-SW3-1	6 to 7	ND	ND	ND	ND
E1-SW4-1	6 to 7	1,660	93	ND	ND
E1-SW4-2	6 to 7	ND	ND	ND	ND
E1-SW5-1	6 to 7	ND	ND	ND	ND
E1-SW6-1	6 to 7	92	ND	ND	ND
E1-SW6-2	6 to 7	ND	ND	ND	ND
E1-SW7-1	6 to 7	ND	ND	ND	ND
E1-SW8-1	6 to 7	ND	ND	ND	ND
E1-SW9-1	6 to 7	ND	ND	ND	ND
E1-SW10-1	6 to 7	922	ND	ND	ND
E1-SW10-2	6 to 7	325	ND	ND	ND
E1-SW10-3	6 to 7	ND	ND	ND	ND

Notes:

- 1) ND - Not Detected
- 2) B - Base of Excavation Sample
- 3) SW - Sidewall Sample (collected 6 to 7 feet below ground surface).
- 4) Sample E1-SW-2 was not collected since the excavation extended to a concrete wall in this area.
- 5) Site specific cleanup standard for Tetrachloroethene was 4 ug/kg.

# POST REMEDIAL

Table 3-2. Excavation No. 2 - Summary of Verification Sampling Data

Sample No.	Depth (ft)	Detected Compounds in UG/KG		
		Tetrachloroethene	Trichloroethene	Naphthalene
E2-B1-1	9	ND	ND	ND
E2-SWN-1	6 to 7	ND	ND	ND
E2-SWS-1	6 to 7	ND	ND	ND
E2-SWW-1	6 to 7	ND	ND	ND
E2-SWE-1	6 to 7	314	ND	ND
E2-SWE-2	6 to 7	44	ND	49
E2-SWE-3	6 to 7	ND	ND	ND

Notes:

- 1) ND - Not Detected
- 2) B - Base of Excavation Sample
- 3) SW - Sidewall Sample (North, South, West, East)
- 4) Site specific cleanup standard for Tetrachloroethene was 4 ug/kg.

# POST REMEDIAL

Table 3-3. Excavation No. 3 - Summary of Verification Sampling Data

Sample No.	Depth (ft)	Detected Compounds in MG/KG	
		DRO	GRO
E3-B1-1	12.5	ND	ND
E3-SWN-1	9 to 10	151	54
E3-SWS-1	9 to 10	ND	ND
E3-SWW-1	9 to 10	ND	ND
E3-SWE-1	9 to 10	21	154

Notes:

- 1) DRO - Diesel Range Organics
- 2) GRO - Gasoline Range Organics
- 3) SW - Sidewall Sample (North, South, West, East) from stained area at 9 to 10 feet bgs.
- 4) B - Base of Excavation Sample
- 5) NR 720 RCL for both GRO and DRO is 250 mg/kg with an underlying clay.

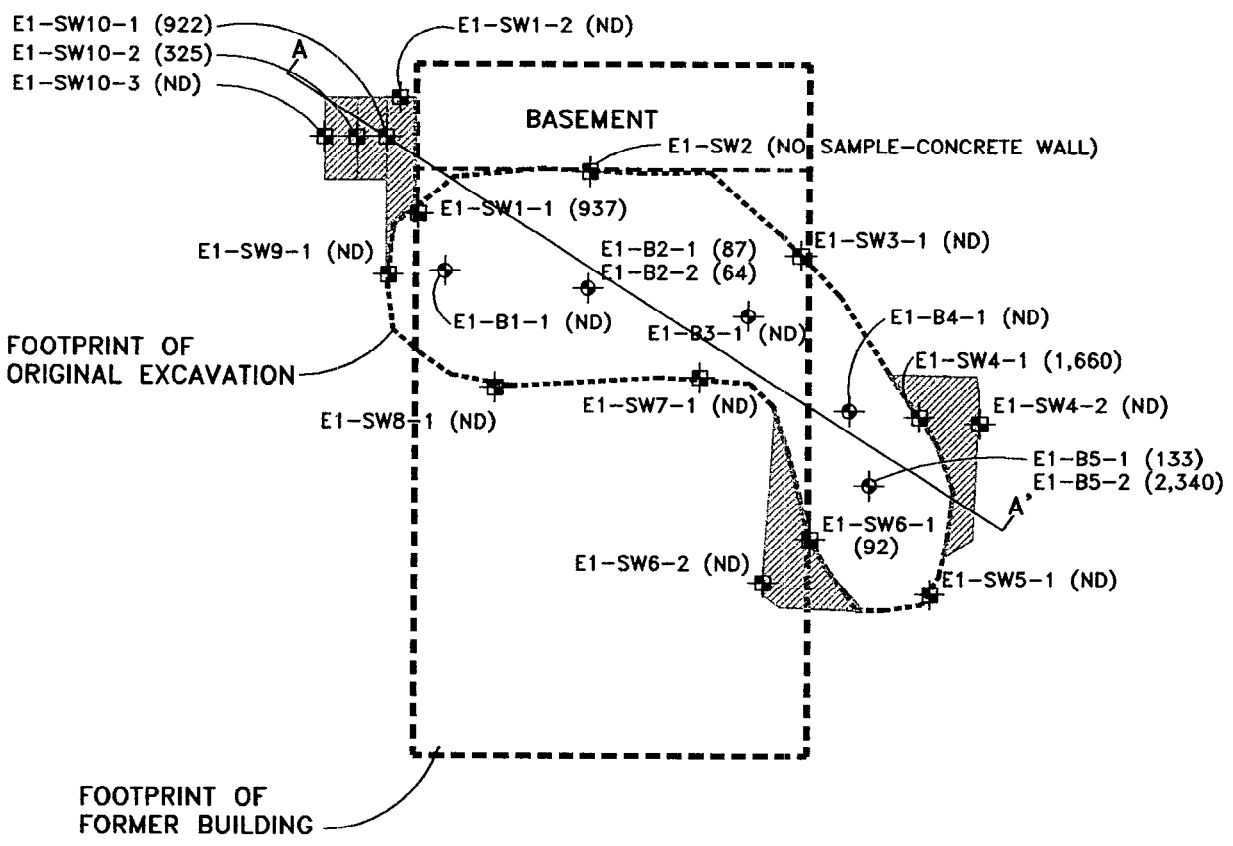

**LEGEND**

- ⊕ E1-B1-1 (99) SOIL SAMPLE LOCATION (BOTTOM OF EXCAVATION)
  - ⊕ E1-SW1-1 (99) SOIL SAMPLE LOCATION (SIDEWALL OF EXCAVATION)
- VALUE IN PARENTHESES PROVIDE PCE CONCENTRATION IN  $\mu\text{g}/\text{kg}$ .

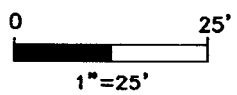

AREAS OF ADDITIONAL EXCAVATION BASED ON VERIFICATION SAMPLING RESULTS.

A — A' LINE OF CROSS-SECTION

**NOTE:** Depth of overall excavation extended to approximately 9 feet below ground surface (bgs) except in the vicinity of base sample locations B2-2 and B5-2 where the excavation was extended to approximately 11 feet and 12 feet bgs respectively.

ENVIRONMENTAL CONSULTATION & REMEDIATION

**K P R**  
KRZYWIAK PYLES RYSIEWICZ AND ASSOCIATES, INC.

414 Plaza Drive, Suite 106 Westmont Illinois 60559 Telephone 630-325-1300 Facsimile 630-325-1593

1056 Killarney Drive Dyer, Indiana 46311 Telephone 219-865-6848 Facsimile 219-865-8587

**AREA OF PCE IMPACTED SOIL REMOVAL - EXCAVATION No. 1**

17-31 Lone Oak Lane  
Hartford, Wisconsin

Scale: 1" = 25'

Date: August 13, 2002

KPR Project No. 15102

FIGURE B6-1

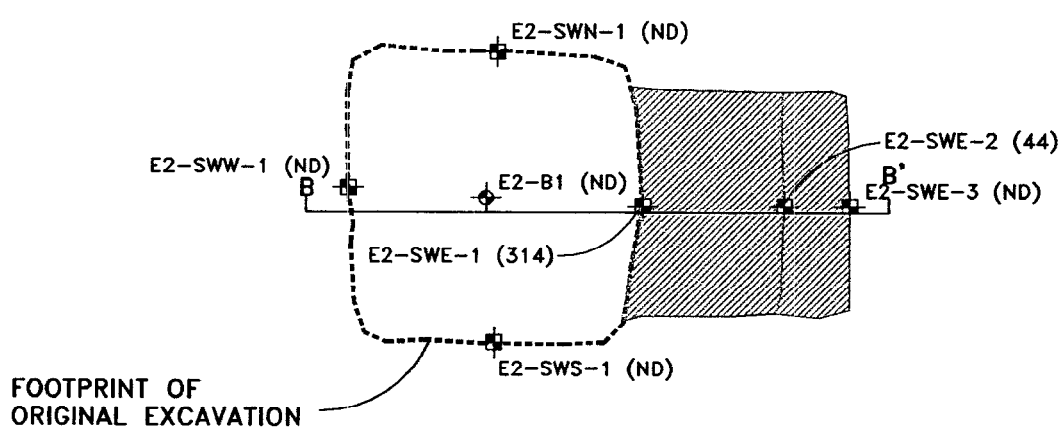

**LEGEND**

- ◆ E2-B1 (99) SOIL SAMPLE LOCATION (BOTTOM OF EXCAVATION)
  - E2-SW1-1 (99) SOIL SAMPLE LOCATION (SIDEWALL OF EXCAVATION)
- VALUE IN PARENTHESES PROVIDE PCE CONCENTRATION IN ug/kg.

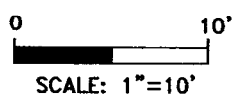

▨ AREAS OF ADDITIONAL EXCAVATION BASED ON VERIFICATION SAMPLING RESULTS.

B B' LINE OF CROSS-SECTION

NOTE: Depths of overall excavation extended to approximately 9 feet below ground surface (bgs).

ENVIRONMENTAL CONSULTATION & REMEDIATION <b>K P R</b> KRILIAU PYLES RYSIEWICZ AND ASSOCIATES, INC. 414 Plaza Drive, Suite 106 Westmont Illinois 60559 Telephone 630-325-1300 Facsimile 630-325-1593 1056 Killarney Drive Dyer, Indiana 46311 Telephone 219-865-6848 Facsimile 219-865-8587	<b>AREA OF PCE IMPACTED SOIL REMOVAL - EXCAVATION No. 2</b> 17-31 Lone Oak Lane Hartford, Wisconsin	
	Scale: 1" = 10'	Date: August 13, 2002
KPR Project No. 15102		FIGURE B6-2

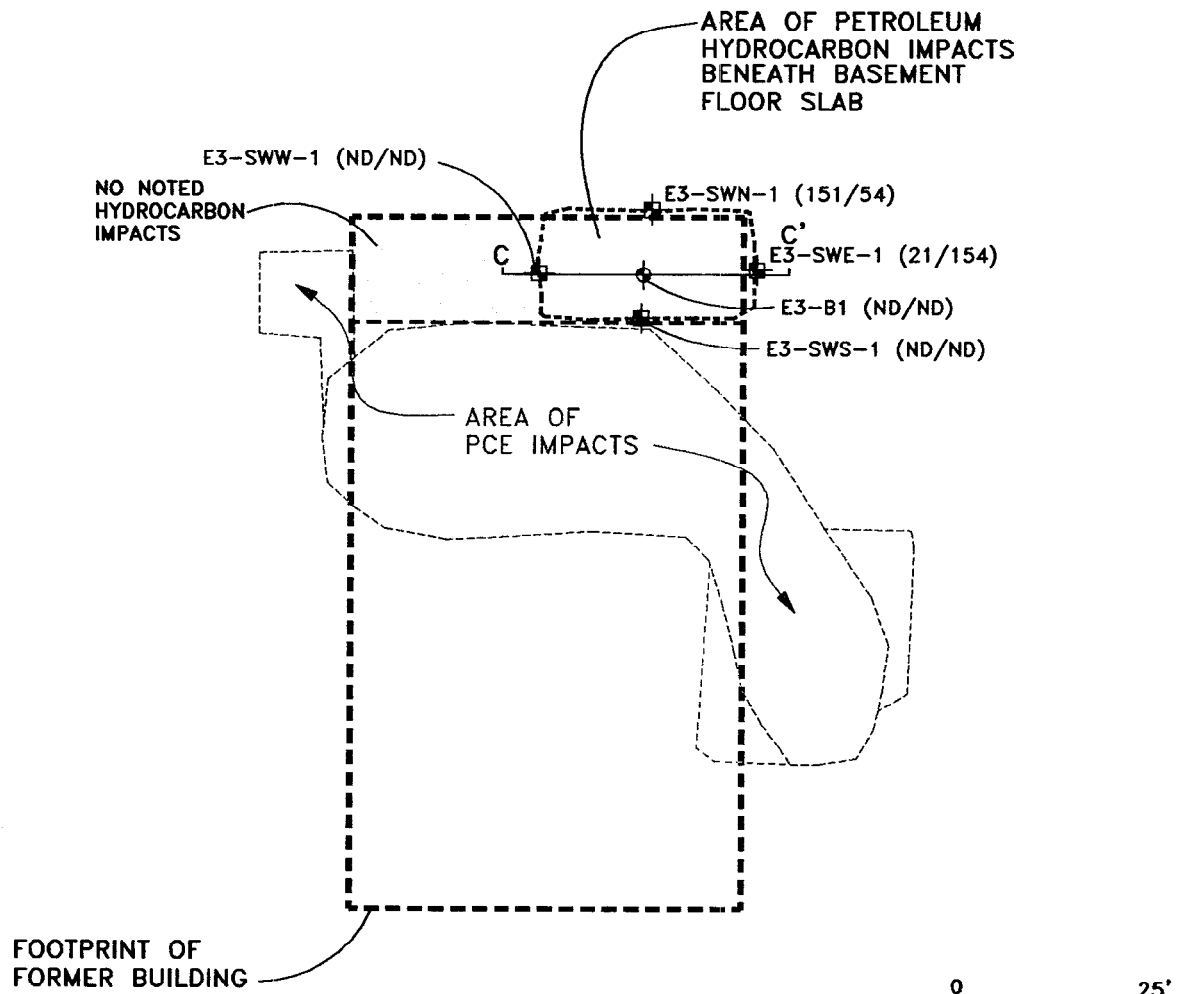

**LEGEND**

- E3-B1 SOIL SAMPLE LOCATION (BOTTOM OF EXCAVATION)
- E3-SW1-1 SOIL SAMPLE LOCATION (SIDEWALL OF EXCAVATION)
- LINE OF CROSS-SECTION

ENVIRONMENTAL CONSULTATION & REMEDIATION

**K P R**

KRZYSZTOF PYLES RYSIEWICZ AND ASSOCIATES, INC.

414 Plaza Drive, Suite 106 Westmont Illinois 60559 Telephone 630-325-1300 Facsimile 630-325-1593

1056 Killarney Drive Dyer, Indiana 46311 Telephone 219-865-6848 Facsimile 219-865-8587

**AREA OF HYDROCARBON IMPACTED SOIL REMOVAL-EXCAVATION No. 3**

17-31 Lone Oak Lane  
Hartford, Wisconsin

Scale: 1" = 25'      Date: August 13, 2002

KPR Project No. 15102      FIGURE B6-3

**TABLE 1**  
**SUMMARY OF GROUNDWATER ELEVATION DATA**  
**SITE INVESTIGATION AND REMEDIAL ACTION OPTIONS REPORT**

CLOTHES CLINIC  
17-31 Lone Oak Lane  
Hartford, Wisconsin

WELL NO.	TOP OF PVC ELEVATION (FEET MSL)	DATE	DEPTH TO GROUNDWATER (FEET)	GROUNDWATER ELEVATION (FEET MSL)
MW-1	1,002.17	9/4/01	7.19	994.98
		2/8/02	7.50	994.67
		3/26/02	6.87	995.30
		4/8/02	6.43	995.74
MW-2	1,004.56	9/4/01	10.15	994.41
		2/8/02	10.76	993.80
		3/26/02	9.93	994.63
		4/8/02	9.76	994.80
MW-3	1,004.83	9/4/01	10.37	994.46
		2/8/02	11.08	993.75
		3/26/02	10.91	993.92
		4/8/02	11.21	993.62
MW-4	1,003.96	9/4/01	9.64	994.32
		2/8/02	10.23	993.73
		3/26/02	9.18	994.78
		4/8/02	8.95	995.01
MW-5	1,003.00	9/4/01	8.77	994.23
		2/8/02	9.33	993.67
		3/26/02	8.25	994.75
		4/8/02	8.06	994.94
MW-6	1,002.52	3/26/02	8.63	993.89
		4/8/02	8.36	994.16
P-1	1,002.45	3/26/02	17.38	985.07
		4/8/02	11.73	990.72

*Notes:*

Top of PVC elevations were surveyed relative to the northeast bolt of the the fire hydrant on the east side of Lone Oak Lane.

MSL - mean sea level

PVC - polyvinyl chloride

Table C4-1. Post-Remediation Monitoring Water Level Summary

Well No.	Date	Ground Elev.	Top Of Casing Elev.	DTW (Ft)	Water Level
MW-2R	1/22/03	1002.1	1001.63	7.61	994.02
	5/2/03	1002.1	1001.63	8.6	993.03
	8/8/03	1002.1	1001.63	9.12	992.51
MW-3R	1/22/03	1002.45	1002.08	8.15	993.93
	5/2/03	1002.45	1002.08	8.91	993.17
	8/8/03	1002.45	1002.08	9.45	992.63
MW-5R	1/22/03	1002.38	1001.84	8.34	993.5
	5/2/03	1002.38	1001.84	8.81	993.03
	8/8/03	1002.38	1001.84	9.28	992.56
P-1R	1/22/03	1002.27	1001.83	10.31	991.52
	5/2/03	1002.27	1001.83	9.33	992.5
	8/8/03	1002.27	1001.83	10.04	991.79
MW-7	1/22/03	1000.83	1000.38	8.06	992.32
	5/2/03	1000.83	1000.38	7.94	992.44
	8/8/03	1000.83	1000.38	8.25	992.13

DTW - Depth to Water From Top of PVC Casing.  
Elevations are relative to Mean Sea Level



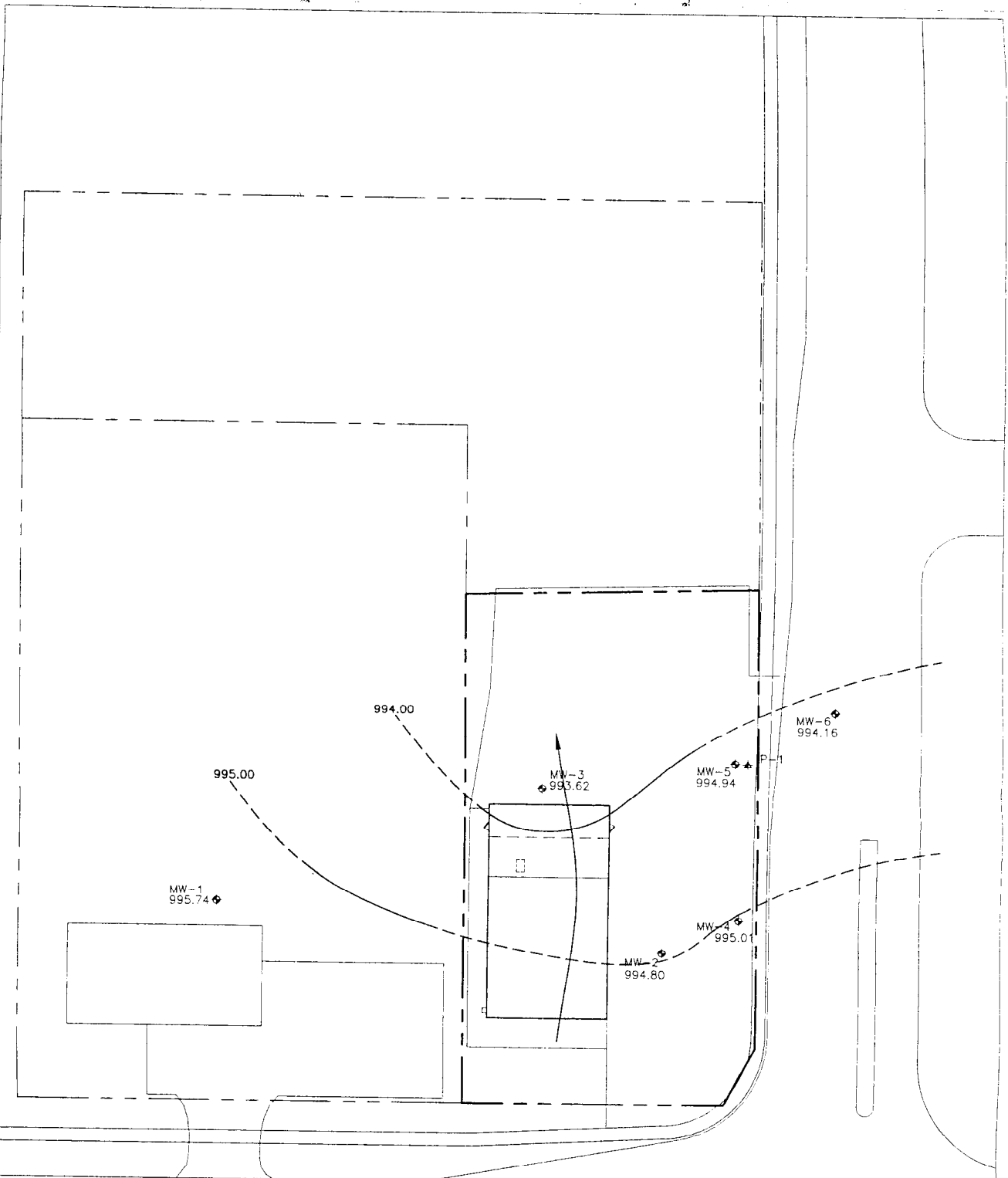

**LEGEND**

- ⊕ MONITORING WELL LOCATION
- 995.74 GROUNDWATER ELEVATION (APRIL 8, 2002)
- GROUNDWATER FLOW DIRECTION

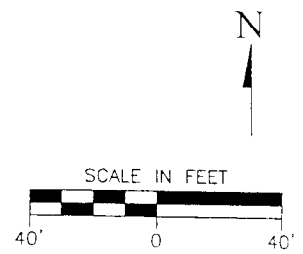

DESIGNED BY	DATE
CMH	04/25/02
GRABED BY	PROJECT
CS	1106005
APPROVED BY	SHEET NO
GLJ	6
CALSCALE & VACADY1106005(1106005.dwg)	
PLOT	
.MAN	

**FIGURE 5B**  
 GROUNDWATER ELEVATION CONTOUR MAP (APRIL 8, 2002)  
 SITE INVESTIGATION AND REMEDIAL ACTION OPTIONS REPORT  
 CLOTHES CLINIC  
 17-31 LONE OAK LANE  
 HARTFORD, WISCONSIN

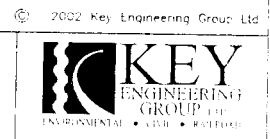

© 2002 Key Engineering Group, Ltd

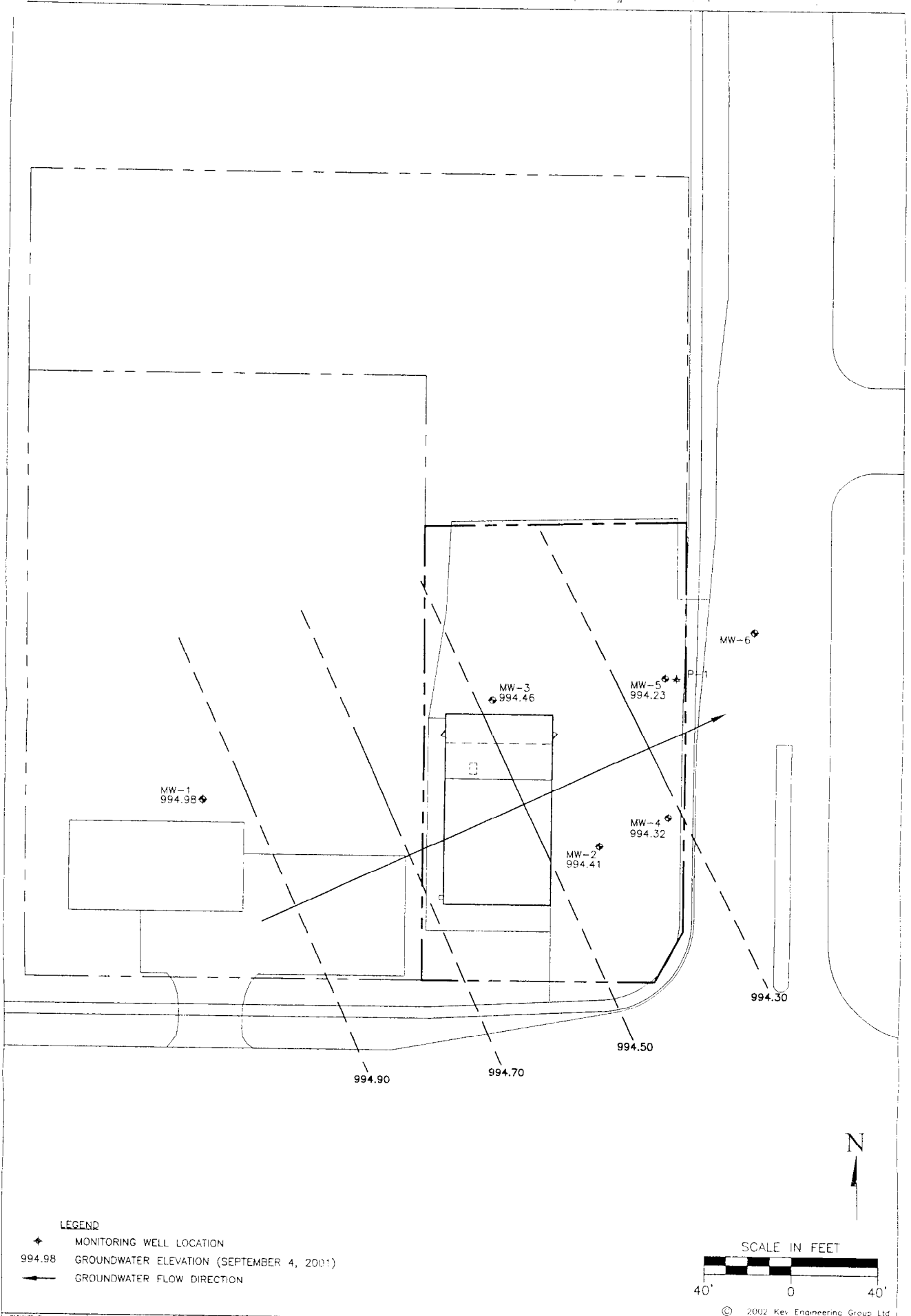

**LEGEND**

- ✦ MONITORING WELL LOCATION
- 994.98 GROUNDWATER ELEVATION (SEPTEMBER 4, 2001)
- GROUNDWATER FLOW DIRECTION

DESIGNED BY CMH	DATE 04/25/02
DRAWN BY CS	PROJECT 1106005
APPROVED BY GLJ	SHEET NO. 5
LADFILE G:\ACAD\1106005\1106005.dwg	
LMAN	

**FIGURE 5A**  
 GROUNDWATER ELEVATION CONTOUR MAP (SEPTEMBER 4, 2001)  
 SITE INVESTIGATION AND REMEDIAL ACTION OPTIONS REPORT  
 CLOTHES CLINIC  
 17-31 LONE OAK LANE  
 HARTFORD, WISCONSIN

© 2002 Key Engineering Group Ltd



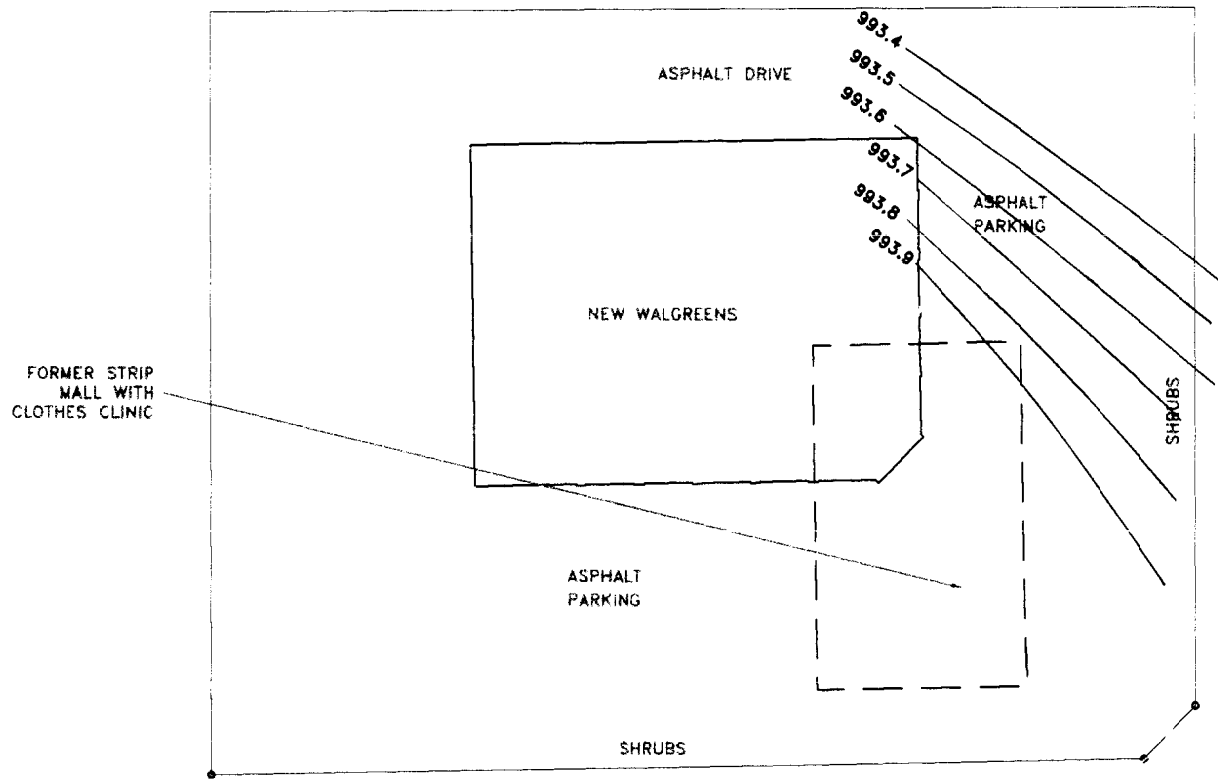

FORMER STRIP MALL WITH CLOTHES CLINIC

NEW WALGREENS

ASPHALT PARKING

SHRUBS

ASPHALT DRIVE

ASPHALT PARKING

SHRUBS

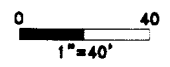

REPLACEMENT WELL

WATER LEVEL CONTOUR

993.9

 KRIMAU PYLES RYSIEWICZ AND ASSOCIATES, INC.	<b>GROUND WATER ELEVATION CONTOUR MAP (1/22/03)</b>	
	<b>CLOTHES CLINIC, INC. HARTFORD, WISCONSIN</b>	
<small>14888 W. Lisbon Rd., Suite 20 Brookfield, Wisconsin Telephone 262-781-0476 Facsimile 262-781-0478</small>	<small>Scale: 1"=40'</small>	<small>Date: October 6, 2003</small>
<small>1028 Hillway Drive Oyer, Indiana 46311 Telephone 219-945-8846 Facsimile 219-945-8847</small>	<b>KPR Project No. 15102</b>	
<small>414 Plaza Drive, Suite 106 Westmont, Illinois 60090 Telephone 630-336-1300 Facsimile 630-336-1883</small>	<b>FIGURE B9-1</b>	

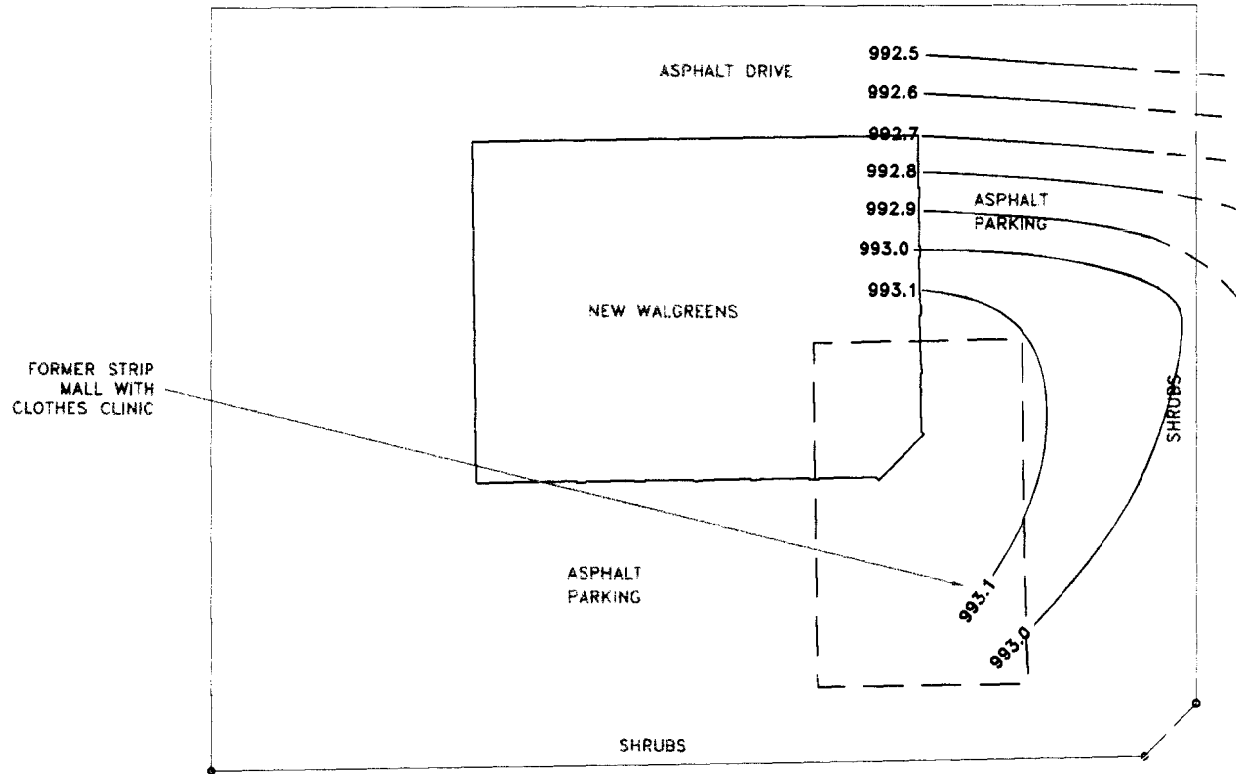

FORMER STRIP  
MALL WITH  
CLOTHES CLINIC

NEW WALGREENS

ASPHALT  
PARKING

SHRUBS

993.1

993.0

SHRUBS

ASPHALT DRIVE

992.5

992.6

992.7

992.8

992.9

993.0

993.1

ASPHALT  
PARKING

REPLACEMENT WELL  
WATER LEVEL CONTOUR

993.9

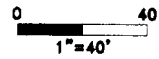

K R I M A U P Y E S R Y S I E W I C Z AND ASSOCIATES, INC. <b>K R P R</b>	GROUND WATER ELEVATION CONTOUR MAP (5/2/03)	
	CLOTHES CLINIC, INC. HARTFORD, WISCONSIN	
14885 N. Lusk Rd., Suite 20 Brookfield, Wisconsin Telephone 262-781-0475 Facsimile 262-781-0476	Scale: 1"=40'	Date: October 6, 2003
1026 Kilmeray Drive Dyer, Indiana 46311 Telephone 219-936-8848 Facsimile 219-936-8887	KPR Project No. 15102	
414 Plaza Drive, Suite 108 Westmont, Illinois 60090 Telephone 630-328-1200 Facsimile 630-328-1883	FIGURE B9-2	

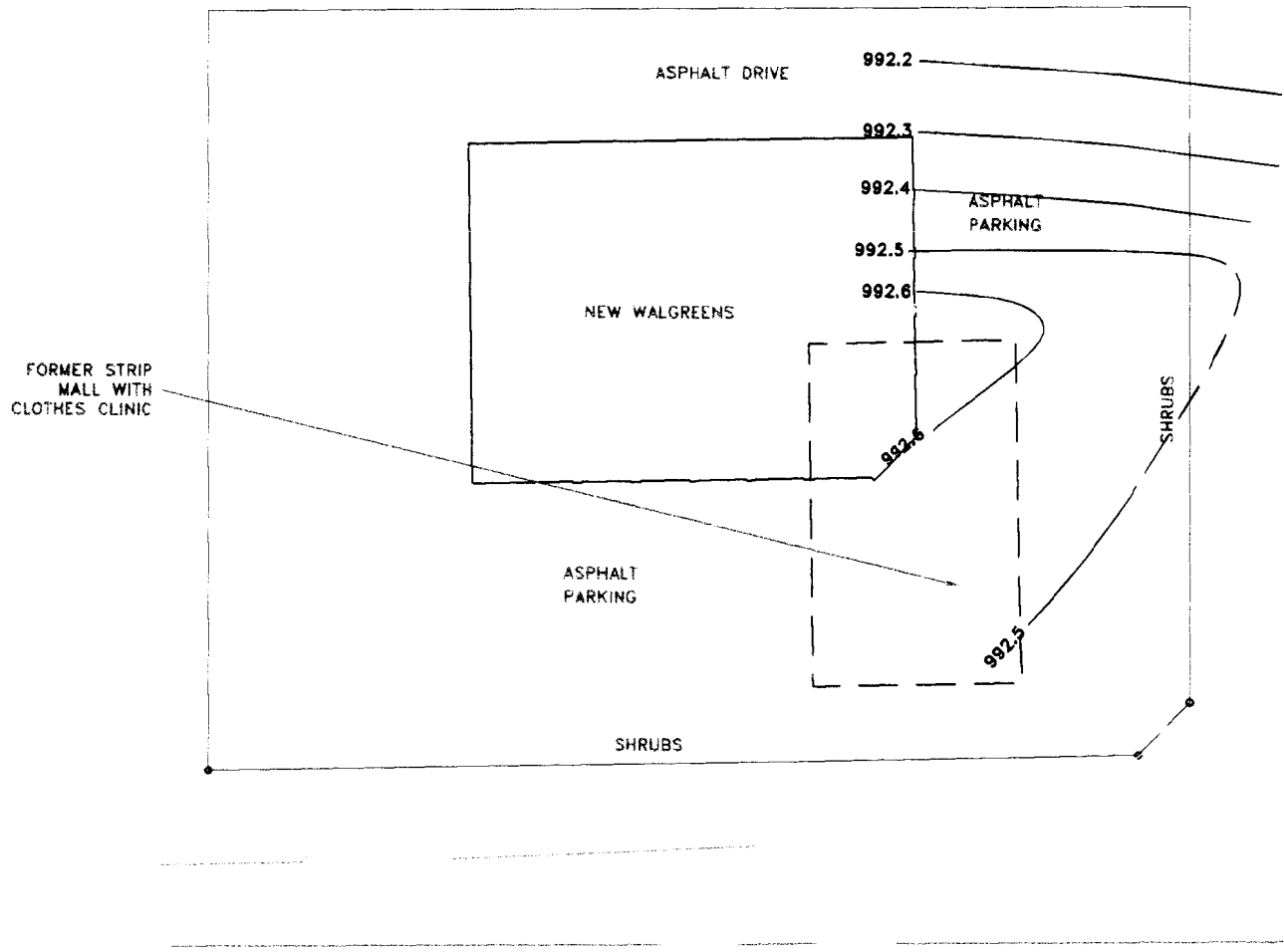

993.9 ——— REPLACEMENT WELL  
————— WATER LEVEL CONTOUR

<b>K P R</b> KIMUO PYDES RYSIEWCZ AND ASSOCIATES, INC. <small>14888 W. Lisbon Rd., Suite 28 Brookfield, Wisconsin Telephone 262-781-0476 Facsimile 262-781-0478 1028 Killebrew Drive Dyer, Indiana 46311 Telephone 219-485-8846 Facsimile 219-485-8887 444 Plaza Drive, Suite 106 Eastman, Illinois 60120 Telephone 830-326-1300 Facsimile 830-326-1883</small>	<b>GROUND WATER ELEVATION CONTOUR MAP (8/8/03)</b>	
	<b>CLOTHES CLINIC, INC. HARTFORD, WISCONSIN</b>	
Scale: 1"=40'	Date: October 6, 2003	
KPR Project No. 15102	FIGURE B9-3	

SCHEMATIC CROSS SECTION

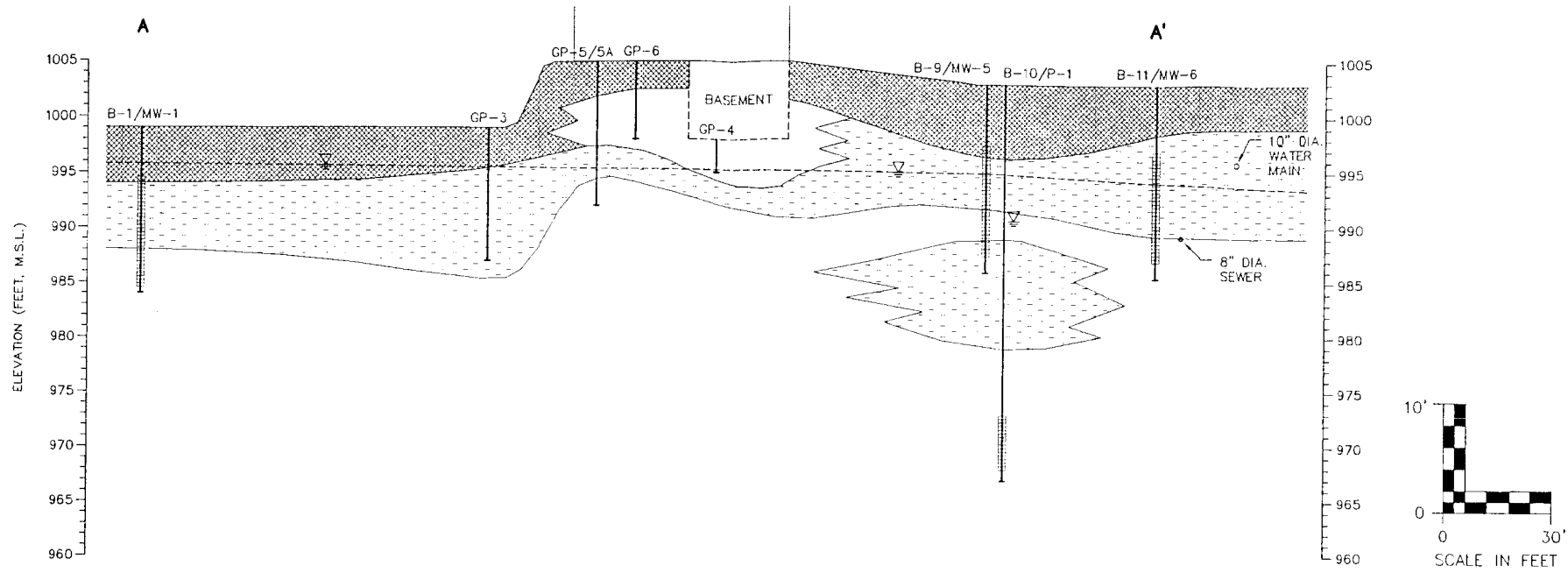

LEGEND

- GROUNDWATER ELEVATION (4/8/02)
- SCREENED INTERVAL
- FILL/POSSIBLE FILL
- ORGANIC CLAY AND SILT
- SILTY CLAY, CLAYEY SILT, SANDY SILT
- SILTY SAND

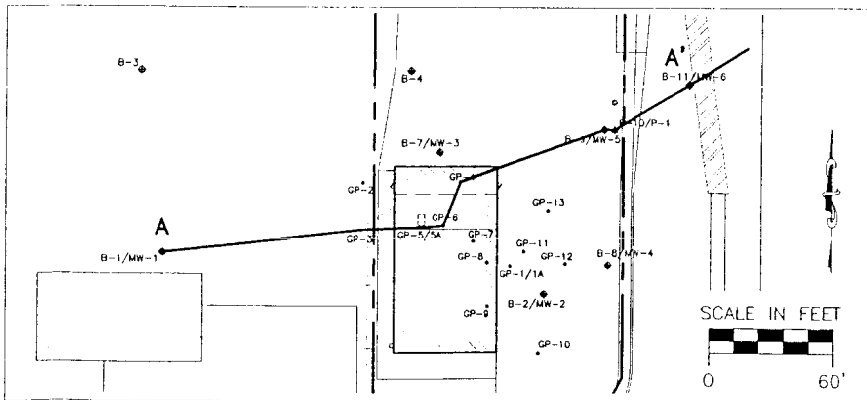

CROSS SECTION LOCATION MAP

© 2002 Key Engineering Group Ltd

DESIGNED BY DMH	DATE 04/25/02
DRAWN BY ES	PROJECT 1106005
APPROVED BY GLJ	SHEET NO 4
CAD FILE Q:\ACAD\1106005\1106005.dwg PLOT .DWG	

FIGURE 4  
SCHEMATIC CROSS SECTION A-A'  
SITE INVESTIGATION AND REMEDIAL ACTION OPTIONS REPORT  
CLOTHES CLINIC  
17-31 LONE OAK LANE  
HARTFORD, WISCONSIN



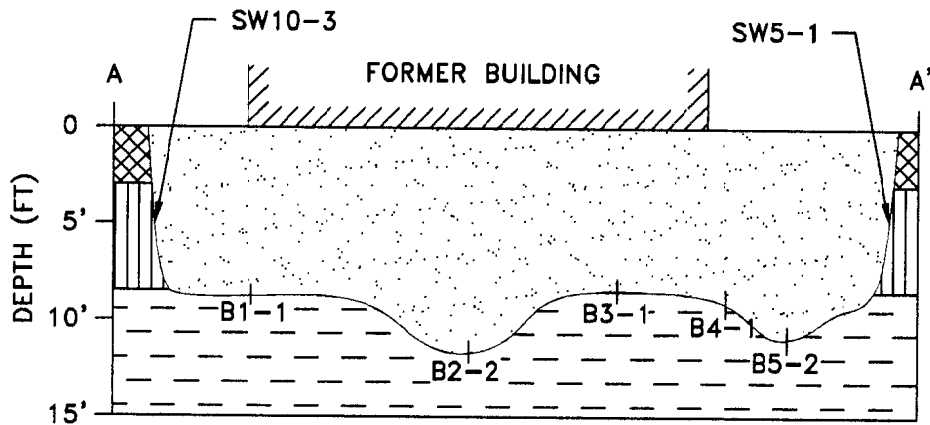

**EXCAVATION NO. 1 (E1)**

HORIZONTAL SCALE 1"=25'

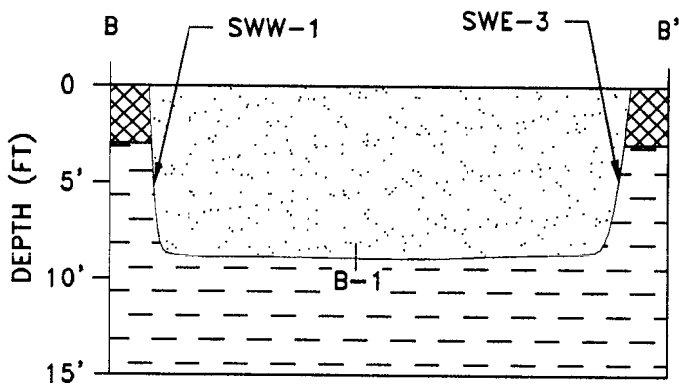

**EXCAVATION NO. 2 (E2)**

HORIZONTAL SCALE 1"=10'

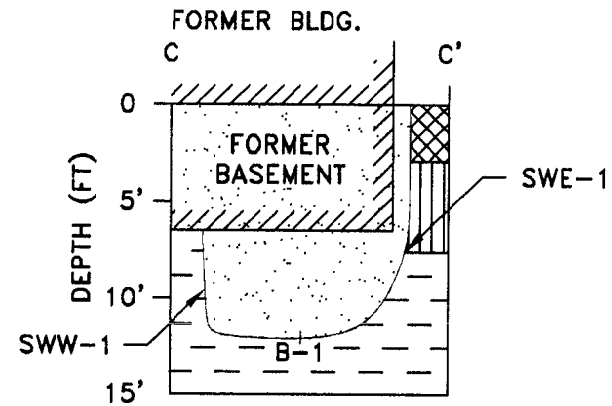

**EXCAVATION NO. 3 (E3)**

HORIZONTAL SCALE 1"=25'

**LEGEND**

- FILL
- ORGANIC CLAY AND SILT
- SILTY CLAY
- POST-REMEDIATION BACKFILL

ENVIRONMENTAL CONSULTATION & REMEDIATION

**K P R**  
 KRILAU PYLES RYSIEWICZ AND ASSOCIATES, INC.

14665 West Lisbon Road, Suite 2B Brookfield, Wisconsin 53005 Telephone 262-781-0475

Westmont, Illinois 630-325-1300 • Dyer, Indiana 219-885-8848

**POST-REMEDIATION CROSS-SECTION**

**CLOTHES CLINIC  
 HARTFORD, WISCONSIN**

Scale: NOTED

Date: October 6, 2003

KPR Project No. 15102

FIGURE E-1

**(B12)**

**Signed Statement by Responsible Party**

I hereby certify that the legal descriptions of all properties within or partially within the site boundaries provided in Attachment (B1), (B2) and (B3) above are correct to the best of my knowledge.

Karen But Corp. Pres.  
Clothes Clinic, Inc.