

Source Property Information

CLOSURE DATE: 03/21/2013

BRRTS #:

02-32-279690

ACTIVITY NAME:

One Hour Cleaners-La Crosse Street

PROPERTY ADDRESS:

1227 La Crosse Street

MUNICIPALITY:

La Crosse

PARCEL ID #:

172013990

FID #:

632002470

DATCP #:

PECFA#:

***WTM COORDINATES:**

X: 420413

Y: 372362

** Coordinates are in
WTM83, NAD83 (1991)*

WTM COORDINATES REPRESENT:

Approximate Center Of Contaminant Source

Approximate Source Parcel Center

Please check as appropriate: (BRRTS Action Code)

CONTINUING OBLIGATIONS

Contaminated Media for Residual Contamination:

Groundwater Contamination > ES (236)

Contamination in ROW

Off-Source Contamination

*(note: for list of off-source properties
see "Impacted Off-Source Property Information,
Form 4400-246")*

Soil Contamination > *RCL or **SSRCL (232)

Contamination in ROW

Off-Source Contamination

*(note: for list of off-source properties
see "Impacted Off-Source Property Information,
Form 4400-246")*

Site Specific Obligations:

Soil: maintain industrial zoning (220)

*(note: soil contamination concentrations
between non-industrial and industrial levels)*

Structural Impediment (224)

Site Specific Condition (228)

Cover or Barrier (222)

Direct Contact

Soil to GW Pathway

Vapor Mitigation (226)

Maintain Liability Exemption (230)

*(note: local government unit or economic
development corporation was directed to
take a response action)*

Monitoring Wells:

Are all monitoring wells properly abandoned per NR 141? (234)

Yes No N/A

** Residual Contaminant Level*

***Site Specific Residual Contaminant Level*

This Adobe Fillable form is intended to provide a list of information that is required for evaluation for case closure. It is to be used in conjunction with Form 4400-202, Case Closure Request. The closure of a case means that the Department has determined that no further response is required at that time based on the information that has been submitted to the Department.

NOTICE: Completion of this form is mandatory for applications for case closure pursuant to ch. 292, Wis. Stats. and ch. NR 726, Wis. Adm. Code, including cases closed under ch. NR 746 and ch. NR 726. The Department will not consider, or act upon your application, unless all applicable sections are completed on this form and the closure fee and any other applicable fees, required under ch. NR 749, Wis. Adm. Code, Table 1 are included. It is not the Department's intention to use any personally identifiable information from this form for any purpose other than reviewing closure requests and determining the need for additional response action. The Department may provide this information to requesters as required by Wisconsin's Open Records law [ss. 19.31 - 19.39, Wis. Stats.].

BRRTS #:	02-32-279690 (No Dashes)	PARCEL ID #:	17-20139-90
ACTIVITY NAME:	One Hour Cleaners - La Crosse ST	WTM COORDINATES: X:	420413 Y: 372362

CLOSURE DOCUMENTS (the Department adds these items to the final GIS packet for posting on the Registry)

- Closure Letter**
- Maintenance Plan** (if activity is closed with a land use limitation or condition (land use control) under s. 292.12, Wis. Stats.)
- Continuing Obligation Cover Letter** (for property owners affected by residual contamination and/or continuing obligations)
- Conditional Closure Letter**
- Certificate of Completion (COC)** (for VPLE sites)

SOURCE LEGAL DOCUMENTS

- Deed:** The most recent deed as well as legal descriptions, for the **Source Property** (where the contamination originated). Deeds for other, off-source (off-site) properties are located in the **Notification** section.
Note: If a property has been purchased with a land contract and the purchaser has not yet received a deed, a copy of the land contract which includes the legal description shall be submitted instead of the most recent deed. If the property has been inherited, written documentation of the property transfer should be submitted along with the most recent deed.
- Certified Survey Map:** A copy of the certified survey map or the relevant section of the recorded plat map for those properties where the legal description in the most recent deed refers to a certified survey map or a recorded plat map. (lots on subdivided or platted property (e.g. lot 2 of xyz subdivision)).
Figure #: **Title:**
- Signed Statement:** A statement signed by the Responsible Party (RP), which states that he or she believes that the attached legal description accurately describes the correct contaminated property.

MAPS (meeting the visual aid requirements of s. NR 716.15(2)(h))

- Maps must be no larger than 11 x 17 inches unless the map is submitted electronically.
- Location Map:** A map outlining all properties within the contaminated site boundaries on a U.S.G.S. topographic map or plat map in sufficient detail to permit easy location of all parcels. If groundwater standards are exceeded, include the location of all potable wells within 1200 feet of the site.
Note: Due to security reasons municipal wells are not identified on GIS Packet maps. However, the locations of these municipal wells must be identified on Case Closure Request maps.
Figure #: 1 **Title: Site Location Map**
 - Detailed Site Map:** A map that shows all relevant features (buildings, roads, individual property boundaries, contaminant sources, utility lines, monitoring wells and potable wells) within the contaminated area. This map is to show the location of all contaminated public streets, and highway and railroad rights-of-way in relation to the source property and in relation to the boundaries of groundwater contamination exceeding a ch. NR 140 Enforcement Standard (ES), and/or in relation to the boundaries of soil contamination exceeding a Residual Contaminant Level (RCL) or a Site Specific Residual Contaminant Levels (SSRCL) as determined under s. NR 720.09, 720.11 and 720.19.
Figure #: 2 **Title: Project Area Map / Site Map**
 - Soil Contamination Contour Map:** For sites closing with residual soil contamination, this map is to show the location of all contaminated soil and a single contour showing the horizontal extent of each area of contiguous residual soil contamination that exceeds a Residual Contaminant Level (RCL) or a Site Specific Residual Contaminant Level (SSRCL) as determined under s. NR 720.09, 720.11 and 720.19.
Figure #: 5 **Title: Soil Analytical Results**

BRRTS #: 02-32-279690

ACTIVITY NAME: One Hour Cleaners - La Crosse ST

MAPS (continued)

Geologic Cross-Section Map: A map showing the source location and vertical extent of residual soil contamination exceeding a Residual Contaminant Level (RCL) or a Site Specific Residual Contaminant Level (SSRCL). If groundwater contamination exceeds a ch. NR 140 Enforcement Standard (ES) when closure is requested, show the source location and vertical extent, water table and piezometric elevations, and locations and elevations of geologic units, bedrock and confining units, if any.

Figure #: Title:

Figure #: Title:

Groundwater Isoconcentration Map: For sites closing with residual groundwater contamination, this map shows the horizontal extent of all groundwater contamination exceeding a ch. NR140 Preventive Action Limit (PAL) and an Enforcement Standard (ES). Indicate the direction and date of groundwater flow, based on the most recent sampling data.

Note: This is intended to show the total area of contaminated groundwater.

Figure #: 1 Title: Groundwater Concentration Map

Groundwater Flow Direction Map: A map that represents groundwater movement at the site. If the flow direction varies by more than 20° over the history of the site, submit 2 groundwater flow maps showing the maximum variation in flow direction.

Figure #: Title: Estimated Groundwater Contour Map

Figure #: Title:

TABLES (meeting the requirements of s. NR 716.15(2)(h)(3))

Tables must be no larger than 11 x 17 inches unless the table is submitted electronically. Tables must not contain shading and/or cross-hatching. The use of **BOLD** or *ITALICS* is acceptable.

Soil Analytical Table: A table showing remaining soil contamination with analytical results and collection dates.

Note: This is one table of results for the contaminants of concern. Contaminants of concern are those that were found during the site investigation, that remain after remediation. It may be necessary to create a new table to meet this requirement.

Table #: Title: multiple soil analytical results tables

Groundwater Analytical Table: Table(s) that show the most recent analytical results and collection dates, for all monitoring wells and any potable wells for which samples have been collected.

Table #: Title: multiple groundwater analytical results tables

Water Level Elevations: Table(s) that show the previous four (at minimum) water level elevation measurements/dates from all monitoring wells. If present, free product is to be noted on the table.

Table #: 1 Title: Groundwater Elevation Data

IMPROPERLY ABANDONED MONITORING WELLS

For each monitoring well not properly abandoned according to requirements of s. NR 141.25 include the following documents.

Note: If the site is being listed on the GIS Registry for only an improperly abandoned monitoring well you will only need to submit the documents in this section for the GIS Registry Packet.

Not Applicable

Site Location Map: A map showing all surveyed monitoring wells with specific identification of the monitoring wells which have not been properly abandoned.

Note: If the applicable monitoring wells are distinctly identified on the Detailed Site Map this Site Location Map is not needed.

Figure #: Title:

Well Construction Report: Form 4440-113A for the applicable monitoring wells.

Deed: The most recent deed as well as legal descriptions for each property where a monitoring well was not properly abandoned.

Notification Letter: Copy of the notification letter to the affected property owner(s).

BRRTS #: 02-32-279690

ACTIVITY NAME: One Hour Cleaners - La Crosse ST

NOTIFICATIONS

Source Property

Not Applicable

Letter To Current Source Property Owner: If the source property is owned by someone other than the person who is applying for case closure, include a copy of the letter notifying the current owner of the source property that case closure has been requested.

Return Receipt/Signature Confirmation: Written proof of date on which confirmation was received for notifying current source property owner.

Off-Source Property

Group the following information per individual property and label each group according to alphabetic listing on the "Impacted Off-Source Property" attachment.

Not Applicable

Letter To "Off-Source" Property Owners: Copies of all letters sent by the Responsible Party (RP) to owners of properties with groundwater exceeding an Enforcement Standard (ES), and to owners of properties that will be affected by a land use control under s. 292.12, Wis. Stats.

Note: Letters sent to off-source properties regarding residual contamination must contain standard provisions in Appendix A of ch. NR 726.

The Off-Source Property documents have been removed from the GIS packet due to the resulting large file size.

Number of "Off-Source" Letters: 5

Return Receipt/Signature Confirmation: Written proof of date on which confirmation was received for notifying any off-source property owner.

Deed of "Off-Source" Property: The most recent deed(s) as well as legal descriptions, for all affected deeded **off-source property(ies)**. This does not apply to right-of-ways.

Note: If a property has been purchased with a land contract and the purchaser has not yet received a deed, a copy of the land contract which includes the legal description shall be submitted instead of the most recent deed. If the property has been inherited, written documentation of the property transfer should be submitted along with the most recent deed.

Certified Survey Map: A copy of the certified survey map or the relevant section of the recorded plat map for those properties where the legal description in the most recent deed refers to a certified survey map or a recorded plat map. (lots on subdivided or platted property (e.g. lot 2 of xyz subdivision)).

Figure #: **Title:**

Letter To "Governmental Unit/Right-Of-Way" Owners: Copies of all letters sent by the Responsible Party (RP) to a city, village, municipality, state agency or any other entity responsible for maintenance of a public street, highway, or railroad right-of-way, within or partially within the contaminated area, for contamination exceeding a groundwater Enforcement Standard (ES) and/or soil exceeding a Residual Contaminant Level (RCL) or a Site Specific Residual Contaminant Level (SSRCL).

Number of "Governmental Unit/Right-Of-Way Owner" Letters: 2

Impacted Off-Source Property Information

Form 4400-246 (R 3/08)

This fillable form is intended to provide a list of information that must be submitted for evaluation for case closure. It is to be used in conjunction with Form 4400-202, Case Closure Request (Section H). The closure of a case means that the Department has determined that no further response is required at that time based on the information that has been submitted to the Department.

NOTICE: Completion of this form is mandatory for applications for case closure pursuant to ch. 292, Wis. Stats. and ch. NR 726, Wis. Adm. Code, including cases closed under ch. NR 746 and ch. NR 726. The Department will not consider, or act upon your application, unless all applicable sections are completed on this form and the closure fee and any other applicable fees, required under ch. NR 749, Wis. Adm. Code, Table 1 are included. It is not the Department's intention to use any personally identifiable information from this form for any purpose other than reviewing closure requests and determining the need for additional response action. The Department may provide this information to requesters as required by Wisconsin's Open Records law [ss. 19.31 - 19.39, Wis. Stats.].

BRRTS #:

ACTIVITY NAME:

ID	Off-Source Property Address	Parcel Number	WTM X	WTM Y
<input type="text" value="A"/>	<input type="text" value="1228 La Crosse ST"/>	<input type="text" value="17-20140-80"/>	<input type="text" value="420418"/>	<input type="text" value="372325"/>
<input type="text" value="B"/>	<input type="text" value="1234 La Crosse ST"/>	<input type="text" value="17-20140-70"/>	<input type="text" value="420432"/>	<input type="text" value="372326"/>
<input type="text" value="C"/>	<input type="text" value="1240 La Crosse ST"/>	<input type="text" value="17-20140-65"/>	<input type="text" value="420447"/>	<input type="text" value="372332"/>
<input type="text" value="D"/>	<input type="text" value="1242 La Crosse ST"/>	<input type="text" value="17-20140-60"/>	<input type="text" value="420456"/>	<input type="text" value="372333"/>
<input type="text" value="E"/>	<input type="text" value="1246 La Crosse ST"/>	<input type="text" value="17-20140-50"/>	<input type="text" value="420469"/>	<input type="text" value="372335"/>
<input type="text" value="F"/>	<input type="text" value="1224 La Crosse ST"/>	<input type="text" value="17-20140-100"/>	<input type="text" value="420400"/>	<input type="text" value="372322"/>
<input type="text" value="G"/>	<input type="text"/>	<input type="text"/>	<input type="text"/>	<input type="text"/>
<input type="text" value="H"/>	<input type="text"/>	<input type="text"/>	<input type="text"/>	<input type="text"/>
<input type="text" value="I"/>	<input type="text"/>	<input type="text"/>	<input type="text"/>	<input type="text"/>



March 21, 2013

Ms. Phyllis Miletto
Dorprop LLC
1817 Jackson Street
La Crosse, Wisconsin 54601

KEEP THIS DOCUMENT WITH YOUR PROPERTY RECORDS

SUBJECT: Final Case Closure with Continuing Obligations, Dorprop, LLC, One Hour Cleaners-La Crosse Street, 1227 La Crosse Street, La Crosse, WI. WDNR BRRTS Activity #: 02-32-279690

Dear Ms. Miletto:

The Department of Natural Resources (DNR) considers One Hour Cleaners closed, with continuing obligations. No further investigation or remediation is required at this time. However, you and future property owners must comply with the continuing obligations as explained in the conditions of closure in this letter. Please read over this letter closely to ensure that you comply with all conditions and other on-going requirements. Provide this letter and any attached maintenance plan to anyone who purchases this property from you.

This final closure decision is based on the correspondence and data provided, and is issued under ch. NR 726, Wisconsin Administrative Code. The West Central Region Closure committee reviewed the request for closure on November 11, 2013. The Closure Committee reviews environmental remediation cases for compliance with state laws and standards to maintain consistency in the closure of these cases. A conditional closure letter was issued by the DNR on December 26, 2012, and documentation that the conditions in that letter were met was received on January 23, 2013.

This former drycleaner site had soil, groundwater and indoor air contaminated with chlorinated volatile organic compounds (VOC's) on an off-site property. Responses included soil excavation, soil vapor extraction and a vapor mitigation system installed on the off-site property. The conditions of closure and continuing obligations required were based on the property being used for commercial uses.

Continuing Obligations

The continuing obligations for this site are summarized below. Further details on actions required are found in the section Closure Conditions.

- Groundwater contamination is present above ch. NR 140, Wis. Adm. Code enforcement standards.
- Residual soil contamination exists that must be properly managed should it be excavated or removed.
- A vapor mitigation system must be operated and maintained at a neighboring property, and inspections must be documented.
- Remaining soil contamination could result in vapor intrusion if future construction activities occur. If new building construction is planned, **vapor control technologies will be required for occupied buildings**, unless the property owner assesses the potential for vapor intrusion, and the DNR agrees that conditions are protective of the new use.

GIS Registry

This site will be listed on the Remediation and Redevelopment Program's internet accessible Geographic Information System (GIS) Registry, to provide notice of residual contamination and of any continuing obligations. DNR approval prior to well construction or reconstruction is required for all sites shown on the GIS Registry, in accordance with s. NR 812.09(4) (w), Wis. Adm. Code. To obtain approval, complete and submit Form 3300-254 to the DNR Drinking and Groundwater program's regional water supply specialist. This form can be obtained on-line at <http://dnr.wi.gov/topic/wells/documents/3300254.pdf> or at the web address listed below for the GIS Registry.

All site information is also on file at the Eau Claire Regional DNR office, at 1300 West Clairemont Ave, Eau Claire, WI 54701. This letter and information that was submitted with your closure request application, including the maintenance plan, will be included on the GIS Registry in a PDF attachment. To review the site on the GIS Registry web page, visit the RR Sites Map page at <http://dnrmaps.wi.gov/imf/imf.jsp?site=brrts2>.

Prohibited Activities

Certain activities are prohibited at closed sites because maintenance of a barrier is intended to prevent contact with any remaining contamination. When a barrier is required, the condition of closure requires notification of the DNR before making a change, in order to determine if further action is needed to maintain the protectiveness of the remedy employed. The following activities are prohibited on any portion of the property where: a vapor mitigation system is required in the future, as shown on the **attached map**, unless prior written approval has been obtained from the DNR:

- construction or placement of a building or other structure;
- changing the use or occupancy of the property to a residential exposure setting, which may include certain uses, such as single or multiple family residences, a school, day care, senior center, hospital, or similar residential exposure settings;
- changing the construction of a building that has either a passive or active vapor mitigation system in place.

Closure Conditions

Compliance with the requirements of this letter is a responsibility to which you, and any subsequent property owners must adhere. DNR staff will conduct periodic prearranged inspections to ensure that the conditions included in this letter and the attached maintenance plans are met. If these requirements are not followed, the DNR may take enforcement action under s. 292.11, Wisconsin Statutes to ensure compliance with the specified requirements, limitations or other conditions related to the property.

Residual Groundwater Contamination (ch. NR 140, 812, Wis. Adm. Code)

Groundwater contamination greater than enforcement standards is present both on this contaminated property and off this contaminated property, as shown on the **attached map**. Affected property owners were notified of the presence of groundwater contamination. If you intend to construct a new well, or reconstruct an existing well, you'll need prior DNR approval.

Residual Soil Contamination (ch. NR 718, chs. 500 to 536, Wis. Adm. Code or ch. 289, Wis. Stats.)

Soil contamination remains as indicated on the **attached map**. If soil in the specific locations described above is excavated in the future, the property owner at the time of excavation must sample and analyze the excavated soil to determine if contamination remains. If sampling confirms that contamination is present, the property owner at the time of excavation will need to determine whether the material is considered solid or hazardous waste and ensure that any storage, treatment or disposal is in compliance with applicable standards and rules. In addition, all current and future owners and occupants of the property need to be aware that excavation of the contaminated soil

may pose an inhalation or other direct contact hazard and as a result special precautions may need to be taken to prevent a direct contact health threat to humans.

Vapor Mitigation and Evaluation (s. 292.12 (2), Wis. Stats.)

Vapor intrusion is the movement of vapors coming from volatile chemicals in the soil or groundwater, into buildings where people may breathe air contaminated by the vapors. Vapor mitigation systems are used to interrupt the pathway, thereby reducing or preventing vapors from moving into the building.

Soil vapor within the soils at a neighboring site (1228 La Crosse Street, La Crosse, Wisconsin) have the potential to contain chlorinated VOCs at levels that would pose a long-term risk to human health, if allowed to migrate into an occupied building on the property. The vapor mitigation system, installed at this site must be operated, maintained and inspected in accordance with the **attached** maintenance plan. System components must be repaired or replaced immediately upon discovery of a malfunction. Annual inspections and any system repairs must be documented in the inspection log. The inspection log shall be kept up-to-date and on-site. Submit the inspection log to the DNR annually, starting one year after the date of this letter.

The integrity of the building that exists on the property (1228 La Crosse Street, La Crosse, Wisconsin), shown on the **attached map**, must be maintained in compliance with the **attached maintenance plan**. This will help ensure proper functioning of the vapor mitigation system, limiting vapor intrusion to indoor air spaces.

A copy of the maintenance plan must be provided to the property owner. The property owner must notify occupants, and provide the maintenance plan to any occupant that is responsible for continued operation of the vapor mitigation system.

Chlorinated VOCs remain in the soil and groundwater at 1227 La Crosse Street, La Crosse, Wisconsin, as shown on the **attached map**, at levels that may be of concern for vapor intrusion in the future, depending on construction and occupancy of a building. **At the time of closure, no building existed on the property; therefore, before a building is constructed, the property owner must notify the DNR.** Vapor control technologies are required for construction of occupied buildings unless the property owner assesses the vapor pathway and DNR concurs that conditions at the property are protective of the new use.

In addition, depending on site-specific conditions, construction over contaminated materials may result in vapor migration of contaminants into enclosed structures or migration along newly placed underground utility lines. The potential for vapor inhalation and means of mitigation should be evaluated when planning any future redevelopment, and measures should be taken to ensure the continued protection of public health, safety, welfare and the environment at the site.

General Wastewater Permits for Construction Related Dewatering Activities

The DNR's Water Quality Program regulates point source discharges of contaminated water, including discharges to surface waters, storm sewers, pits, or to the ground surface. This includes discharges from construction related dewatering activities, including utility and building construction.

If you or any other person plan to conduct such activities, you or that person must contact that program, and if necessary, apply for the necessary discharge permit. Additional information regarding discharge permits is available at <http://dnr.wi.gov/topic/wastewater/GeneralPermits.html>. If residual soil or groundwater contamination is likely to affect water collected in a pit/trench that requires dewatering, a general permit for Discharge of Contaminated Groundwater from Remedial Action Operations may be needed. If water collecting in a pit/trench that requires dewatering is expected to be free of pollutants other than suspended solids and oil and grease, a general permit for Pit/Trench Dewatering may be needed.

Operating Dry Cleaners

In order to remain eligible for future reimbursement of cleanup costs from the Dry Cleaner Environmental Response Fund (DERF), the owner or operator of the dry cleaning facility must implement enhanced pollution prevention measures within 90 days of the date of this letter. These measures are found in Section 292.65 (5) (a) 2, Wis. Statutes, and NR 169.11 (2), Wis Adm. Code. In accordance with Section 292.65 (8) (f), Wis. Stats., the maximum amount of money that DERF can reimburse to any facility is \$500,000. The enhanced pollution prevention measures include:

- all wastes must be managed in accordance with federal and state hazardous waste rules;
- dry cleaning product or wastewater may not be discharged into any sanitary sewers, septic tanks, or any waters of the State;
- a containment structure must entirely surround and be capable of containing any spill or release of a dry cleaning product from a dry cleaning machine or other equipment;
- the floor within any containment structure must be sealed and be impervious to dry cleaning product;
- perchloroethene must be delivered to the dry cleaning facility by means of a closed, direct coupled delivery system.

In order to retain eligibility, you will need to verify that you have implemented these pollution prevention measures. Additional documentation, such as invoices and photographs of any enhanced pollution prevention measures you implement, can be used to provide verification.

The following DNR fact sheet, "Continuing Obligations for Environmental Protection", RR-819 explains a property owner's responsibility for continuing obligations on their property. If the fact sheet is lost, you may obtain a copy at <http://dnr.wi.gov/files/PDF/pubs/rr/RR819.pdf>.

Please send written notifications in accordance with the above requirements to DNR Eau Claire Regional Office, to the attention of Gina Keenan at the address cited in the letterhead. Please be aware that the case may be reopened pursuant to s. NR 726.09, Wis. Adm. Code, if additional information regarding site conditions indicates that contamination on or from the site poses a threat to public health, safety, or welfare or to the environment.

The DNR appreciates your efforts to restore the environment at this site. If you have any questions regarding this closure decision or anything outlined in this letter, please contact me at 715.839.3765 or at gina.keenan@wisconsin.gov

Sincerely,

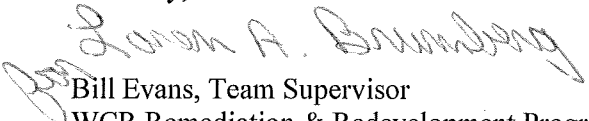
Bill Evans, Team Supervisor
WCR Remediation & Redevelopment Program

Attachments:

- Figure #1 Groundwater Concentration Map
- Figure #2 Soil Analytical Results (July 2002 & November 2003)
- Vapor Mitigation System Maintenance Plan
- RR 819

cc: Kevin Nestingen, Braun Intertec, 2309 Palace Street, La Crosse, WI 54603
Dave Wise, 2914 Heather Court, Onalaska, WI 54650
WCR case file

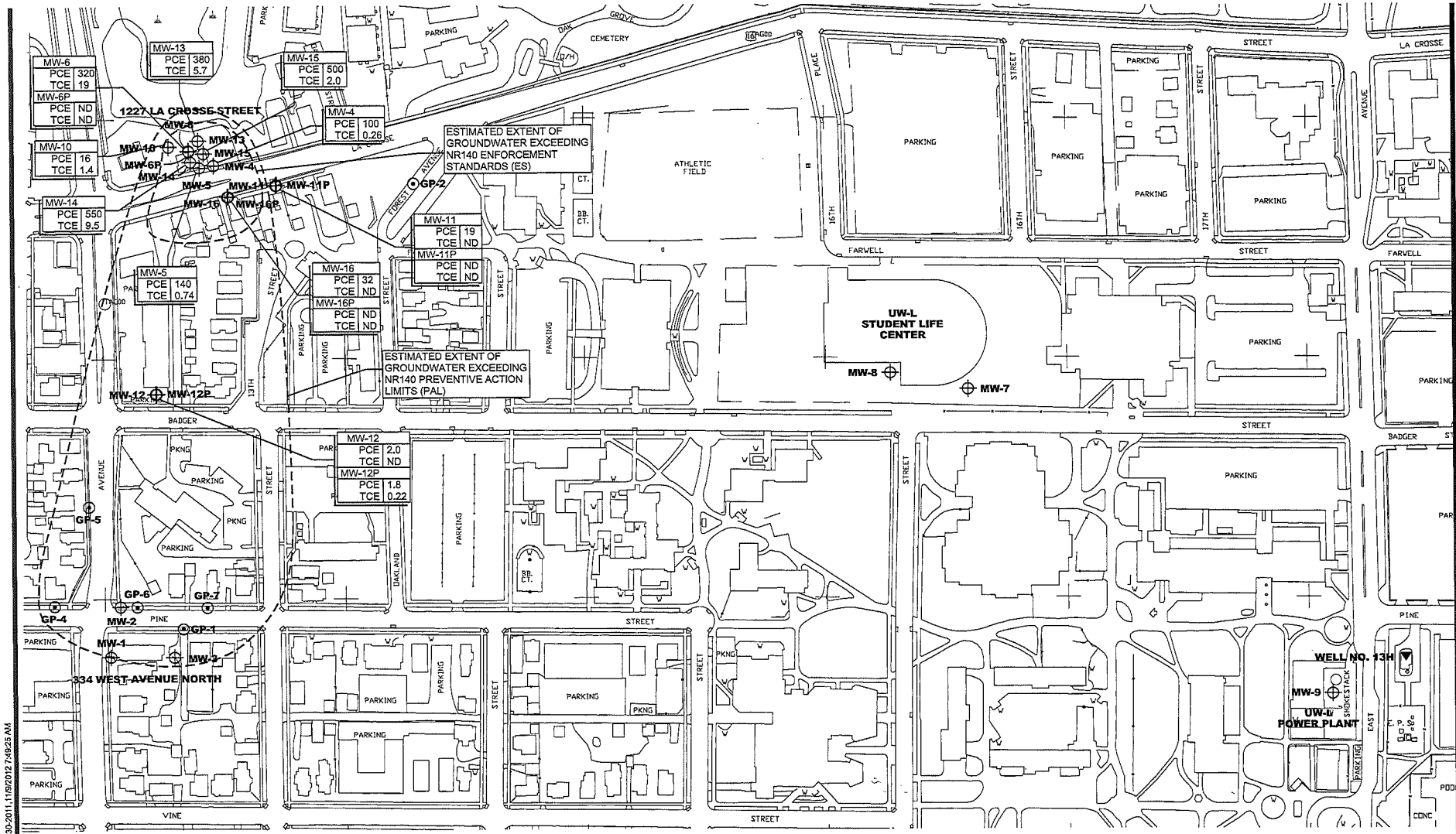





Figure # | GROUNDWATER CONCENTRATION MAP (6/30/2011)
DORPROP, LLC - ONE HOUR CLEANERS
1227 LACROSSE STREET
LACROSSE, WISCONSIN

F:\DEPT\NE\ne2125a.dwg, GW CONTAM 6-30-2011, 11:07:01Z, 7:48:25 AM

	MONITORING WELL	PCE	TETRACHLOROETHYLENE
		TCE	TRICHLOROETHYLENE
	LACROSSE WELL NO. 13H	ND	COMPOUND WAS NOT DETECTED ABOVE THE LABORATORY METHOD DETECTION LIMIT
	SOIL PROBE LOCATION	NOTE:	CONCENTRATIONS ARE REPORTED IN µg/L



100' 0 200'
SCALE: 1"= 200'

Project No:	ONEX-02-125A
Drawing No:	NE2125A
Scale:	1"= 200'
Drawn By:	BJB
Date Drawn:	4/19/02
Checked By:	KEM
Last Modified:	11/9/12
Sheet:	Fig:
of	

Figure # 2 SOIL ANALYTICAL RESULTS (JULY, 2002 & NOVEMBER, 2003)
DORPROP I.L.C. - ONE HOUR CLEANERS
1227 LA CROSSE STREET
LACROSSE, WISCONSIN

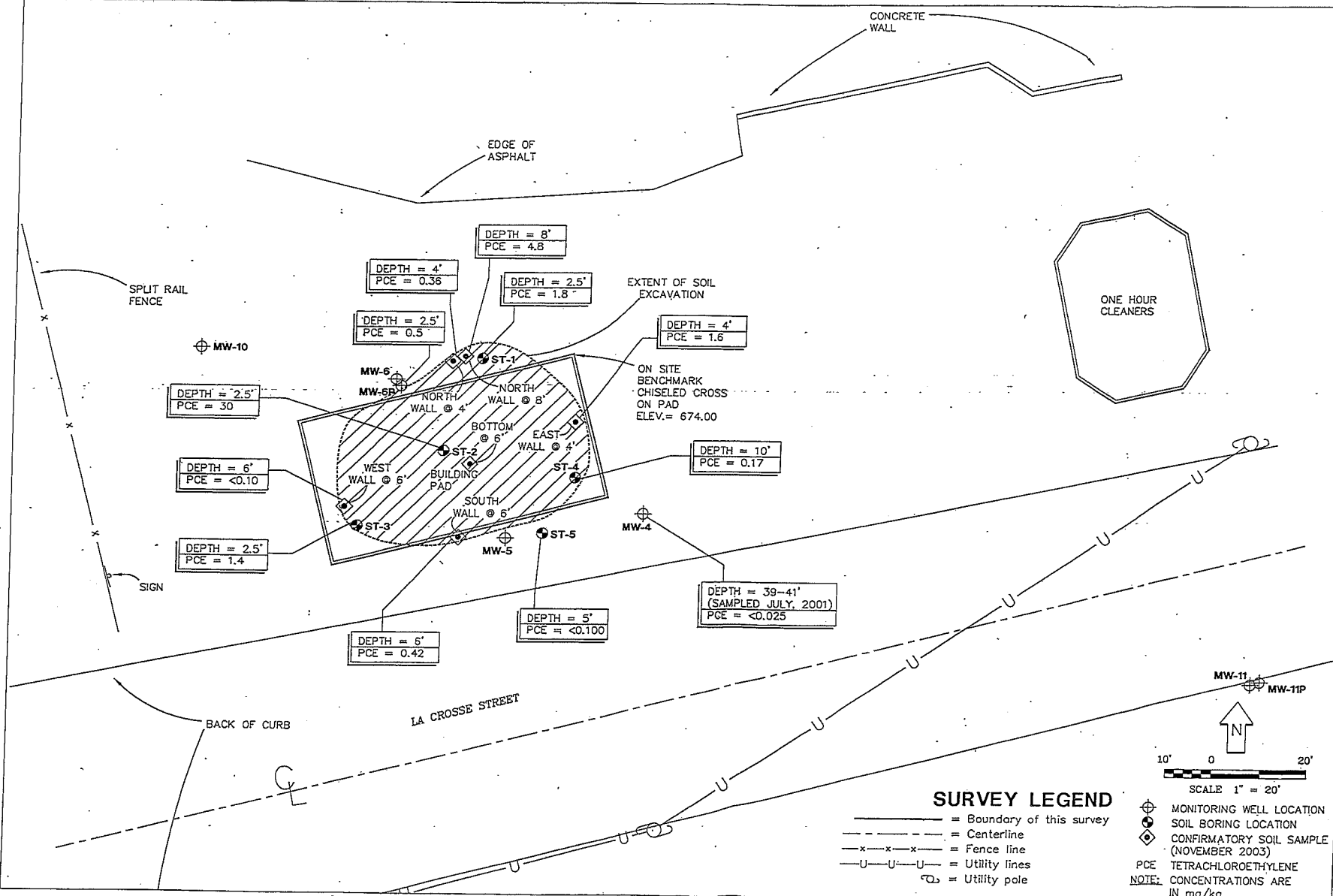

SURVEY LEGEND

- = Boundary of this survey
- - - = Centerline
- x-x-x- = Fence line
- U-U-U- = Utility lines
- ⊕ = Utility pole
- ⊕ = MONITORING WELL LOCATION
- ⊕ = SOIL BORING LOCATION
- ⊕ = CONFIRMATORY SOIL SAMPLE (NOVEMBER 2003)
- PCE = TETRACHLOROETHYLENE
- NOTE: CONCENTRATIONS ARE IN mg/kg

INT	DATE
DRAWN BY: BJB	3-6-03
APP'D BY: KLH	4-11-05
JOB NO.: CNEX-02-T25A	
DWG. NO. NE2125A1	SHEET OF
SCALE 1" = 20'	

FIGURE NO. 5

Vapor Mitigation System Maintenance Plan

One Hour Cleaners Site
1227 La Crosse Street
La Crosse, Wisconsin

WDNR BRRTS #02-32-279690

FID # 632002470

Parcel ID #17-20140-80

Date: November 9, 2012

System Description, Purpose and Location

This document is the Maintenance Plan for the sub-slab depressurization system (SSDS) at the 1228 La Crosse Street property (Parcel ID # 17-20140-80). On October 10, 2012, a SSDS was installed to actively vent sub-slab vapors from beneath the residential basement slab. Sub-slab vapor impacts were related to the chlorinated solvent release (tetrachloroethene, PCE, PERC) at the One Hour Cleaners site located north of this property. The system suction point and fan locations are shown on the attached Sub-Slab Depressurization System Layout map and photographs.

System Design

The SSDS was installed by Healthy Homes of St. Paul, Minnesota. The contact for Healthy Homes is Mr. Robert Carlson, who can be reached at (952) 220-9409. According to Healthy Homes, the system installation was completed in accordance with ASTM standard E2121-09, Standard Practice for Installing Radon Mitigation Systems in Existing Low-Rise Residential Buildings.

The SSDS consists of one Radon Away RP265 suction fan and one three-inch diameter suction point to vent beneath the basement slab. The system piping is routed out the east side of the building where the fan is mounted. The fan is hard wired directly into a power source and the exhaust pipe extends at least twelve inches above the building roof. An on-off switch is also located next to the fan.

A U-tube monometer was applied to the system to evaluate continued function and is located above the suction drop point in the basement. The attached photograph shows an initial monometer reading of 2", indicating proper system operation.

System Maintenance

The structural integrity of the floor must be maintained and kept as impermeable as at the time

of closure. Any system components requiring repair or replacement must be completed immediately upon discovery of a malfunction. Log the repair activities in the attached inspection log.

The manufacturer's specification sheet for the SSDS fan/blower is attached for reference.

Inspection

The entire SSDS will be inspected once a year to verify that the active system is operating properly. Inspections will include reading the monometers and identifying if repairs are required for the system. The inspection log to be completed during each event is included. This inspection log must be maintained on-site at all times. If repairs are required during 2 or more successive inspections, the Wisconsin Department of Natural Resources (WDNR) project manager, Ms. Gina Keenan, must be contacted at (715) 839-3700.

Notifications

Changes in land or property use or system changes are required to be reported to Ms. Keenan. Her complete information and other pertinent contacts are included in the following section.

Contacts

Property Location: 1228 La Crosse Street
La Crosse, WI 54601

Property Owner: Mr. David Wise
2914 Heather Court
Onalaska, WI 54650
(608) 792-6629

Responsible Party: Dorprop, LLC
Mr. Richard Miletto
3516 Crown Boulevard
La Crosse, WI 54601
(608) 780-4155

Consultant: Braun Intertec Corporation
Mr. Mark Gretebeck
2309 Palace Street
La Crosse, WI 54603
(608) 781-7277
mgretebeck@braunintertec.com

-or-

Braun Intertec Corporation
Mr. Kevin Nestingen
2309 Palace Street
La Crosse, WI 54603
(608) 781-7277
knestingen@braunintertec.com

WDNR: Wisconsin Department of Natural Resources
West-Central Region Remediation and Redevelopment Program
Ms. Gina Keenan
1300 West Clairemont Avenue
Eau Claire, WI 54702-4001
(715) 839-3700
Gina.Keenan@wisconsin.gov

SSDS Contact: Healthy Homes
Mr. Robert Carlson
674 Nebraska Avenue E
St. Paul, MN 55106
952-220-9409
healthyhomemn@hotmail.com
www.healthyhomesradon.com

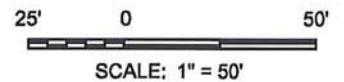
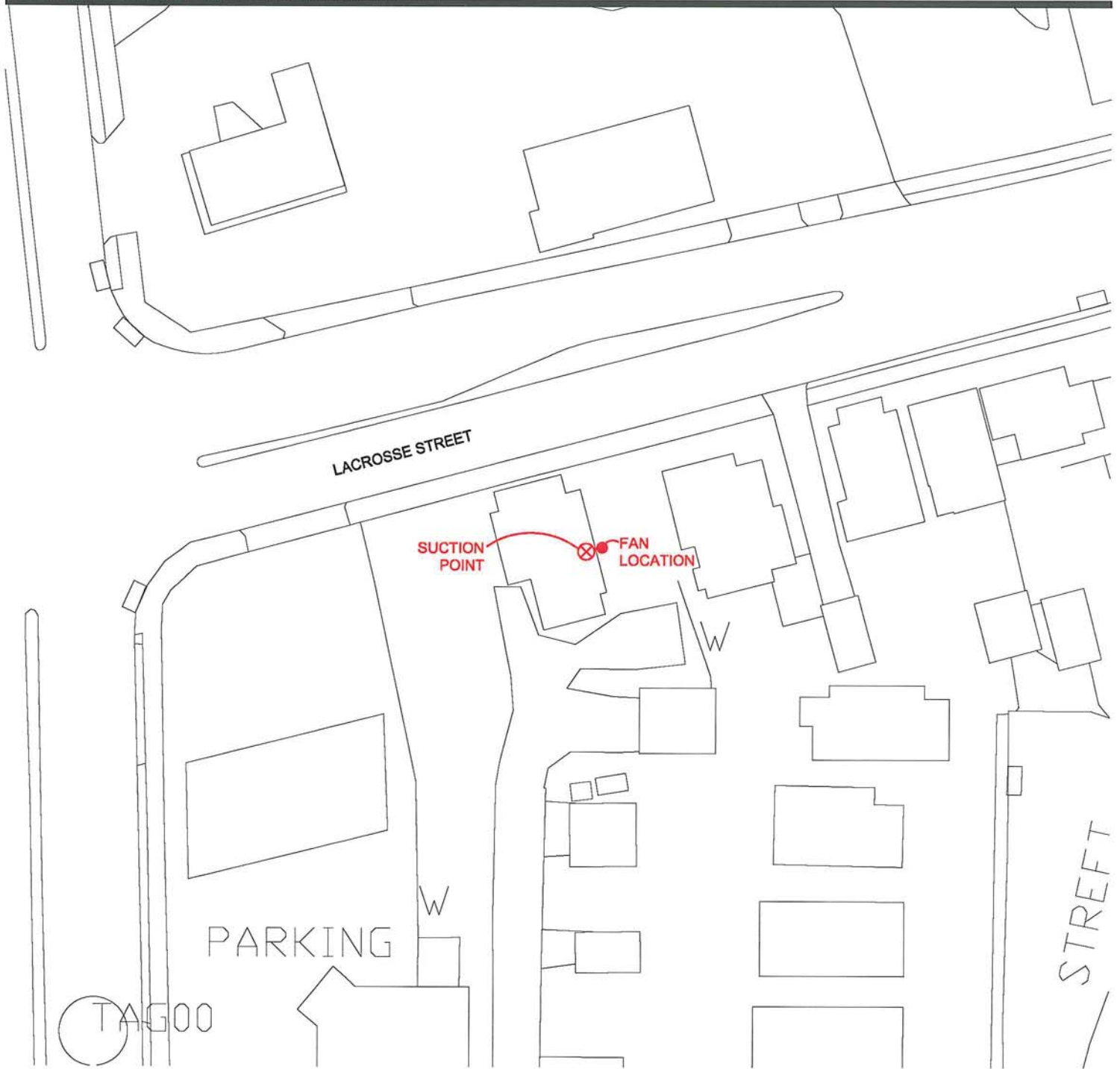

Sheet:	Project No:
of	CNEX-02-125A
Fig:	Drawing No:
	NE2125A
	Scale: 1" = 50'
	Drawn By: BJB
	Date Drawn: 4/19/02
	Checked By: KDN
	Last Modified: 3/12/10

SUB-SLAB DEPRESSURIZATION SYSTEM LAYOUT
 DORPROP, LLC. - ONE HOUR CLEANERS
 1227 LACROSSE STREET
 LACROSSE, WISCONSIN

BRAUN
INTERTEC

11001 Hampshire Avenue So.
 Minneapolis, MN 55438
 PH. (952) 995-2000
 FAX (952) 995-2020



Photograph #: 1
Date: 11/9/2012
Direction: Facing North
Subject: Sub-slab depressurization system fan and exhaust

CNEX-02-125A

BRAUN
INTERTEC



Photograph #: 2
Date: 11/9/2012
Direction: East side of building
Subject: System fan and on/off switch

CNEX-02-125A

BRAUN
INTERTEC



Photograph #: 3
Date: 11/9/2012
Direction: Basement
Subject: System suction point

CNEX-02-125A

BRAUN
INTERTEC



Photograph #: 4
Date: 11/9/2012
Direction: Basement
Subject: U-tube monometer

CNEX-02-125A

BRAUN
INTERTEC

State of Wisconsin
DEPARTMENT OF NATURAL RESOURCES
West Central Region Headquarters
1300 West Clairemont Avenue
Eau Claire WI 54702-4001

OFF-SOURCE
A
PROPERTY

Scott Walker, Governor
Cathy Stepp, Secretary
Daniel Baumann, Regional Director
Telephone 715-839-3700
FAX 715-839-6076
TTY Access via relay - 711



Mr. Dave Wise
2914 Heather Court
Onalaska, Wisconsin 54560

SUBJECT: Continuing Obligations and Property Owner Requirements for 1228 La Crosse Street, La Crosse, WI Parcel Identification Number: 17-20140-80. Final Case Closure for One Hour Cleaners, 1227 La Crosse Street, La Crosse, WI (BRRTS#02-32-279690).

Dear Mr. Wise:

The purpose of this letter is to notify you that certain continuing obligations apply to the property at 1228 La Crosse Street, La Crosse, WI, (referred to in this letter as the "Property") due to contamination remaining on the Property. The continuing obligations are part of the cleanup and case closure approved for the above referenced case, located at 1227 La Crosse Street, La Crosse, WI. (The case is referenced by the location of the source property, i.e. the property where the original discharge occurred, prior to contamination migrating to the Property.) The continuing obligations that apply to the Property are stated as conditions in the attached closure approval letter, and are consistent with s. 292.12, Wis. Stats., and ch. NR 700, Wis. Adm. Code, rule series. They are meant to limit exposure to any remaining environmental contamination at the Property. These continuing obligations will also apply to future owners of the Property, until the conditions no longer exist at the Property.

It is common for properties with approved cleanups to have continuing obligations as part of cleanup/closure approvals. Information on continuing obligations on properties is shown on the Internet at dnrmaps.wi.gov/imf/imf.jsp?site=brrts2. How to find further information about the closure and residual contamination for this site can be located at dnr.wi.gov/topic/Brownfields/clean.html.

The Department reviewed and approved the case closure request regarding the chlorinated contamination in soil, groundwater and vapor at this site, based on the information submitted by Braun Intertec, the environmental consultant for the former One Hour Cleaners site. As required by state law, you received notification about the requested closure from the person conducting the cleanup. No further investigation or cleanup is required at this time. However, the closure decision is conditioned on the long-term compliance with certain continuing obligations, as described below.

Continuing Obligations Applicable to Your Property

A number of continuing obligations are described in the attached case closure letter to the owners of the former One Hour Cleaners, dated March 21, 2013. However, only the following continuing obligations apply to your Property.

- Identify maintenance actions required
- Maintain inspection log on-site, or identify frequency of inspection log submittal to DNR
- Language regarding use of an existing soil vapor mitigation system
- Residual groundwater contamination

GIS Registry – Well Construction Approval Needed

Because of the residual type of media contaminated contamination and the continuing obligations, this site, which includes your Property, will be listed on the Department's internet accessible GIS Registry, at dnrmaps.wi.gov/imf/imf.jsp?site=brrts2. If you intend to construct or reconstruct a well on the Property, you will need to get Department approval in accordance with s. NR 812.09(4) (w), Wis. Adm. Code. To obtain approval, Form 3300-254 needs to be completed and submitted to the DNR Drinking and Groundwater program's regional water supply specialist. A well driller can help with this form. This form can be obtained on-line at dnr.wi.gov/topic/wells/documents/3300254.pdf. If at some time, all these continuing obligations are fulfilled, and the remaining contamination is either removed or meets applicable standards, you may request the removal of the Property from the GIS Registry.

Property Owner Responsibilities

The owner (you and any subsequent property owner) of this Property is responsible for compliance with these continuing obligations, pursuant to s. 292.12, Wis. Stats. You are strongly encouraged to pass on the information about these continuing obligations to anyone who purchases this property from you (i.e. pass on this letter). For residential property transactions, you are required to make disclosures under Wis. Stats. s. 709.02. You may have additional obligations to notify buyers of the condition of the property and the continuing obligations set out in this letter and the closure letter.

Please be aware that failure to comply with the continuing obligations may result in enforcement action by the Department. The Department intends to conduct inspections in the future to ensure that the conditions included in this letter, including compliance with referenced maintenance plans, are met.

These responsibilities are the property owner's. A property owner may enter into a legally binding agreement (such as a contract) with someone else (the person responsible for the cleanup) to take responsibility for compliance with the continuing obligations. If the person with whom any property owner has an agreement fails to adequately comply with the appropriate continuing obligations, the Department has the authority to require the property owner to complete the necessary work.

A legal agreement between you and another party to carry out any of the continuing obligations listed in this letter does not automatically transfer to a new owner of the property. If a subsequent property owner cannot negotiate a new agreement, the responsibility for compliance with the applicable continuing obligations resides with that Property owner.

When maintenance of a continuing obligation is required, the Property owner is responsible for inspections, repairs, or replacements as needed. Such actions should be documented by the Property owner and the records kept accessible for the Department to review for as long as the Department directs.

You and any subsequent Property owners are responsible for notifying the Department, and obtaining approval, before making any changes to the property that would affect the obligations applied to the Property. Send all written notifications in accordance with the above requirements to the attention of Gina Keenan, DNR, 1300 West Clairemont Avenue, Eau Claire, WI, 54701.

The following DNR fact sheet, RR-819, "Continuing Obligations for Environmental Protection" has been included with this letter, to help explain a property owner's responsibility for continuing obligations on their property. If the fact sheet is lost, you may obtain a copy at dnr.wi.gov/files/PDF/pubs/rr/RR819.pdf.

Under s. 292.13, Wis. Stats., owners of properties affected by contamination from another property are generally exempt from investigating or cleaning up a hazardous substance discharge that has migrated onto a

property from another property, through the soil, groundwater or sediment pathway. However, the exemption under s. 292.13, Wis. Stats., does not exempt the property owner from the responsibility to maintain a continuing obligation placed on the property in accordance with s. 292.12, Wis. Stats. To maintain this exemption, that statute requires the current property owner and any subsequent property owners, to meet the conditions in the statute, including:

- Granting reasonable access to DNR or responsible party, or their contractors;
- Avoiding interference with response actions taken; and
- Avoiding actions that make the contamination worse (e.g., demolishing a structure and causing or worsening the discharges to the environment).

The Department appreciates your efforts. If you have any questions regarding this closure decision or anything outlined in this letter, please contact Gina Keenan at 715.839.3765.

Sincerely,

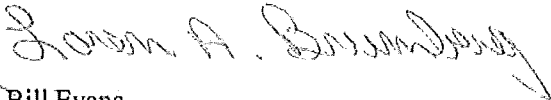

Bill Evans
WCR Remediation & Redevelopment Team Supervisor

Attach:

- closure letter
- maintenance plan

cc: Kevin Nestingen, Braun Intertec, 2309 Palace Street, La Crosse, WI 54603
Ms. Phyllis Miletto, Dorprop LLC, 1817 Jackson Street, La Crosse, Wisconsin 54601

Enclosure: RR 819 – Continuing Obligations Fact Sheet



State of Wisconsin \ DEPARTMENT OF NATURAL RESOURCES

Scott Walker, Governor
Kathy Stepp, Secretary
Dan Baumann, Regional Director

West Central Region Headquarters
1300 W. Clairemont Avenue
PO Box 4001
Eau Claire, Wisconsin 54702-4001
Telephone 715-839-3700
FAX 715-839-6076
TTY Access via relay - 711

December 26, 2012

Mr. Richard Miletto
Dorprop LLC
1817 Jackson Street
La Crosse, Wisconsin 54601

SUBJECT: Conditional Closure Decision with Requirements to Achieve Final Closure, One Hour Cleaners, 1227 Street, La Crosse, Wisconsin. BRRTS# 02-32-279690.

Dear Mr. Miletto:

On November 11, 2012, the West Central Region (WCR) Closure Committee reviewed your request for closure of the case described above. The WCR Closure Committee reviews environmental remediation cases for compliance with state rules and statutes to maintain consistency in the closure of these cases. Based on this review, the WCR Closure Committee has determined that the chlorinated solvent contamination on the site generated from the former drycleaner operations appears to have been investigated and remediated to the extent practicable under site conditions. Your case has been remediated to Department standards in accordance with s. NR 726.05, Wis. Adm. Code and will be closed if the following conditions are satisfied:

MONITORING WELL ABANDONMENT

The monitoring wells at the site must be properly abandoned in accordance with ch. NR 141, Wis. Adm. Code. Documentation of well abandonment must be submitted to my attention on Form 3300-005, found at <http://dnr.wi.gov/org/water/dwg/forms/3300005.pdf> or provided by the Department of Natural Resources.

PURGE WATER, WASTE AND SOIL PILE REMOVAL

Any remaining purge water, waste and/or soil piles generated as part of site investigation or remediation activities must be removed from the site and disposed of or treated in accordance with Department of Natural Resources' rules. Once that work is completed, please send appropriate documentation regarding the treatment or disposal of the remaining purge water, waste and/or soil piles.

RIGHT OF WAY AND OFF-SITE SOIL AND GROUNDWATER CONTAMINATION

There is residual soil and/or groundwater contamination in a public street or highway right-of-way at this site. Section NR 726.05(2) (a) 4, Wis. Adm. Code, requires you to provide written notification of the presence of residual soil (and groundwater contamination, if present) to the clerk of the town and county or municipality where the right-of-way is located and to the municipal department or state agency that maintains the right-of-way.

There is groundwater contamination on properties that are not the same property as the source of the contamination (off-source properties) that do not have soil contamination. Section NR 726.05(2) (b) 4, Wis. Adm. Code, requires you to also provide written notice of the presence of residual groundwater contamination to the owner of any off-source properties within this site that do not have soil contamination if they are affected by groundwater contamination. Please note the "site" is defined as all

locations where the contamination is and is not limited to the source property.

These notifications must include warnings that excavation of potentially contaminated soil or groundwater may pose inhalation or other direct contact hazards and will require soil and groundwater sampling and analysis, as well as proper storage, treatment, or disposal of any excavated materials, based upon the results of the analysis. Please provide me with a copy of any written notifications that have been sent.

When the above conditions have been satisfied, please submit the appropriate documentation (for example, well abandonment forms, disposal receipts, copies of correspondence, etc.) to verify that applicable conditions have been met, and your case will be closed. Your site will be listed on the DNR's Remediation and Redevelopment GIS Registry. Information that was submitted with your closure request application will be included on the GIS Registry. To review the site on the GIS Registry web page, visit the RR Sites Map page at: <http://dnrmaps.wi.gov/imf/imf.jsp?site=brrts2>.

CONTINUING OBLIGATIONS AND RESPONSIBILITIES

As part of the approval of the closure of this case, you will be responsible for maintaining the following continuing obligations: remaining soil contamination could result in vapor intrusion if future construction activities occur. If new building construction is planned, vapor control technologies will be required for occupied buildings, unless the property owner assesses the potential for vapor intrusion, and the DNR agrees that conditions are protective of the new use. In the final closure approval, you will also be required to submit an annual update on development of the property and whether or not vapor intrusion potential has been evaluated.

Please be aware that the case may be reopened pursuant to s. NR 726.09, Wis. Adm. Code, if additional information regarding site conditions indicates that contamination on or from the site poses a threat to public health, safety, or welfare or to the environment.

We appreciate your efforts to restore the environment at this site. If you have any questions regarding this letter, please contact me at 715.839.3765.

Sincerely,

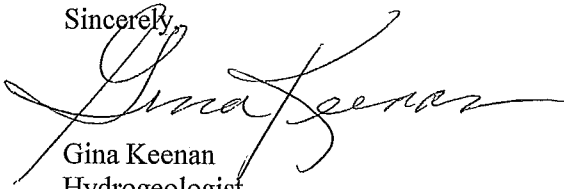

Gina Keenan
Hydrogeologist
Remediation & Redevelopment Program

cc: Kevin Nestingen-Braun Intertec, 2309 Palace Street, La Crosse, WI 54603
WCR case file

WARRANTY DEED
STATE BAR OF WISCONSIN FORM 2 - 1982

1268720

LACROSSE COUNTY, WI
REGISTER OF DEEDS
DEBORAH J. FLOCK

RECORDED ON 02-20-2001
AT 1:31 PM

REC. FEE: 14.00
TRANSFER FEE: 1877.10

PAGES: 3

VOL 1425 PAGE 132

RETURN: DAVID E SMITHSON
900 JOHN NOLEN DR STE 220
MADISON WI 53713

Dorlee, Inc., a Wisconsin Corporation
conveys and warrants to Dorprop, LLC
the following described real estate in LaCrosse County,
State of Wisconsin:

See Attached Legal Descriptions

Tax Parcel No:

- 12-20139-90
17-20139-100
17-10076-120
18-745-0
17-20139-110
17-30238.040

This is not homestead property.
(is) (is not)

Exception to warranties: Municipal and zoning ordinances, recorded easements for public utilities, recorded building and use
restrictions and covenants, and general taxes levied in the year of closing.

Dated this 28 day of December, 2000

Earl V. Reuschlein, President
Earl V. Reuschlein, Secretary

Dorlee, Inc., By:
Robert W. Reuschlein, Secretary

AUTHENTICATION

Signature(s) Robert W. Reuschlein, Secretary
Earl V. Reuschlein, President of Dorlee, Inc.

authenticated this 28 day of December, 2000

TITLE: MEMBER STATE BAR OF WISCONSIN

(If not, authorized by § 706.06, Wis. Stats.)

THIS INSTRUMENT WAS DRAFTED BY

Attorney David E. Smithson

(Signatures may be authenticated or acknowledged. Both
are not necessary.)

ACKNOWLEDGMENT

STATE OF WISCONSIN

Dane County.
Personally came before me this 28th day of
February, 2001, the above named
Earl V. Reuschlein
Robert W. Reuschlein

to me known to be the person(s) who executed the
foregoing instrument and acknowledge the same.

Danna M. Bosch
Danna M. Bosch
Notary Public Dane County, Wis.
My Commission is permanent. (If not, state expiration
date: January 4, 2004)

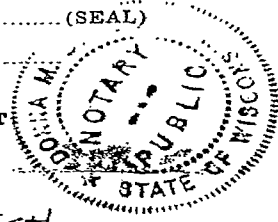

Parcel 1

Lots 22, and 23, Block 2 of D.C. Evans Addition to the City of LaCrosse, La Crosse County, Wisconsin

1231 La Crosse Street, La Crosse, La Crosse County, Wisconsin, Parcel # 12-20139-90

Parcel 2

Lot 24 in Block 2 of D.C. Evans' Addition to the City of La Crosse, except that part described as follows: Beginning at the Southwest corner of said Lot 24; thence North 15 57'19" West along the West line of said lot 24, a distance of 4.88 feet thence North 76 22' 45" East, 59.93 feet to the East line of said Lot 24; thence South 74 02' 41" West along the South line of said Lot 24, a distance of 59.89 feet to the point of beginning.

1241 La Crosse Street, La Crosse, La Crosse County, Wisconsin, Parcel #17-20139-100

Parcel 3

The North 46 feet of Lot 13 in Block 7 of Northern Addition to the Village of North LaCrosse, now City of La Crosse

1307-1309 Caledonia Street, La Crosse, La Crosse County, Wisconsin, Parcel # 17-10076-120

Parcel 4

Part of Outlot 10 of Assessor's Plat, City of Onalaska, described as follows: Commencing on the West line of said Outlot 10 and on the centerline of Sand Lake Coulee Road at the Southwest corner of the Northwest Quarter of Southeast Quarter of Southeast Quarter, Section 4, Township 16 North of Range 7 West; thence North along said line 60 feet; thence East 140 feet to the point of beginning of this description; thence continuing East 124 feet; thence North 150 feet; thence Southwesterly to the West line of said Outlot 10 at a point 200 feet North of said Southwest corner of the Northwest Quarter of Southwest quarter of Southeast Quarter; thence South along said West line 70 feet; thence East 140 feet; thence South 70 feet to the point of beginning, except the West 33 feet thereof taken for road purposes.

306 Sand Lake Road, Onalaska, La Crosse County, Wisconsin, Parcel # 18-745-0

Parcel 5

Lots 32, 23, 24 and 25, Block 2 of D.C. Evans' Addition to the City of La Crosse and 1/2 the vacated alley to the North, La Crosse County, Wisconsin except land taken for road right of way described as follows:

Part of Lots 22 and 23 in Block 2 of D.C. Evans' Addition to the City of La Crosse, La Crosse County, Wisconsin, described as follows:

Beginning at the Southwest corner of said Lot 22; thence North 15 degrees 57' 19" West along the West line of said Lot 22, 9.74 feet, thence North 76 degrees 22' 45" East, 119.86 feet to the East line of Lot 23; thence South 15 degrees 57' 19" East, 4.88 feet to the Southeast corner of said Lot 23, thence South 74 degrees 02' 41" West along the South line of said Lots 22 and 23, 119.76 feet to the point of beginning.

1247 La Crosse Street, La Crosse, WI Parcel # 17-20139-110

Parcel 6

Lot 176 in Block 15 of Salzer Terrace and part of State Road, now vacated, being a part of the NW of the SW of Section 4, T15N, R7W, in the City of La Crosse, described as follows: Commencing at the SW corner of said Lot 175, thence North along the West line of said Lot 175 and the East right-of-way line of the Chicago, Burlington and Quincy Railroad Company 78.27 feet; thence East parallel with the North line of Jackson Street 52.9 feet to the West line of the alley in said Block 15, thence South along said West line to the South line of said Lot 176 extended east; thence West along said south line and the North line of Jackson Street to the point of beginning.

Also, the Easterly one-half of the right-of-way of the Chicago, Burlington and Quincy Railroad Company (Formerly the Green Bay and Western Railroad Company) in the Northwest Quarter of the Southwest Quarter of Section 4, T15N, R7W of the fourth Principal Meridian, that lies between the Westerly prolongations of the North and South lines of, and abuts upon Lot 176, Block 15 of Salzer Terrace, an addition to the City of La Crosse, Wisconsin according to the recorded plat thereof of record in the Office of the Register of Deeds in and for said county.

Also, Part of Lot 175 in Block 15 of Salzer Terrace Addition to the City of La Crosse, Wisconsin and part of the Northwest 1/4 of the Southwest 1/4 of Section 4, T15N, R7W, City of La Crosse, being part of the vacated State Road Coulee Road and described as follows: Commencing at the SE corner of Block 15; thence South 88 degrees 17' 54" West along the North line of Jackson Street a distance of 140.71 feet to the West line of an alley; thence North along the West line of the alley, a distance of 78.45 feet to the point of beginning, thence continuing North along the West line of the alley a distance of 30.77 feet; thence South 88 degrees 17' 54" West a distance of 52.50 feet; thence South a distance of 30.77 feet; thence North 88 degrees 17' 54" East a distance of 52.50 feet to the point of beginning. Said parcel contains 1615 square feet more or less

1817 Jackson Street, La Crosse, WI, Parcel 17-30238-040

Re: Geographic Information System Registry for the One Hour Cleaners - La Crosse Street Site, La Crosse, Wisconsin – WDNR BRRTS # 02-32-279690

Regulatory file closure has been requested for the above referenced site. Tetrachloroethylene impacted soil and/or groundwater exceeding Wisconsin Department of Natural Resources (WDNR) ch. NR 140 groundwater enforcement standards (ESs) may be still be present beneath the site, the adjacent city right-of-way (La Crosse Street) and several properties located south of the site (1228,1234, 1240,1242 and 1246 La Crosse Street, and 530 West Avenue North). Therefore, pursuant to WDNR ch. NR 726, the required Geographic Information System (GIS) registry information must include legal descriptions and/or plat maps. Legal descriptions and/or plat maps must be included for all properties (within or partially within the site's boundaries), which have soil contamination that exceeds the RCLs and/or groundwater contamination that exceeds the ESs at the time closure is requested. Additionally, the GIS registry information must include a statement signed by the responsible party, which states that he or she believes that the legal description has been attached for each property that is within, or partially within, the contaminated site boundary. (The purpose of this requirement is that a legal description for each of the contaminated properties has been submitted. The responsible party is not required to attest to the accuracy of the attached legal descriptions.) Therefore, the following statement has been included:

I, Richard Miletto, representing Dorprop, LLC, certify that to the best of my knowledge the legal description has been attached for each property that is within, or partially within, the contaminated site boundary for the One Hour Cleaners - La Crosse Street site.

Signature:

Richard Miletto

Date:

4/6/05

BRAUN INTERTEC

11001 Hampshire Avenue So.
Minneapolis, MN 55438
PH: (952) 995-2000
FAX: (952) 995-2020

Base Dwg Provided By:

PROJECT AREA MAP
DORRPROP, U.S. ENVIRONMENTAL CLEANERS
1227 LA CROSSE STREET
LACROSSE, WISCONSIN

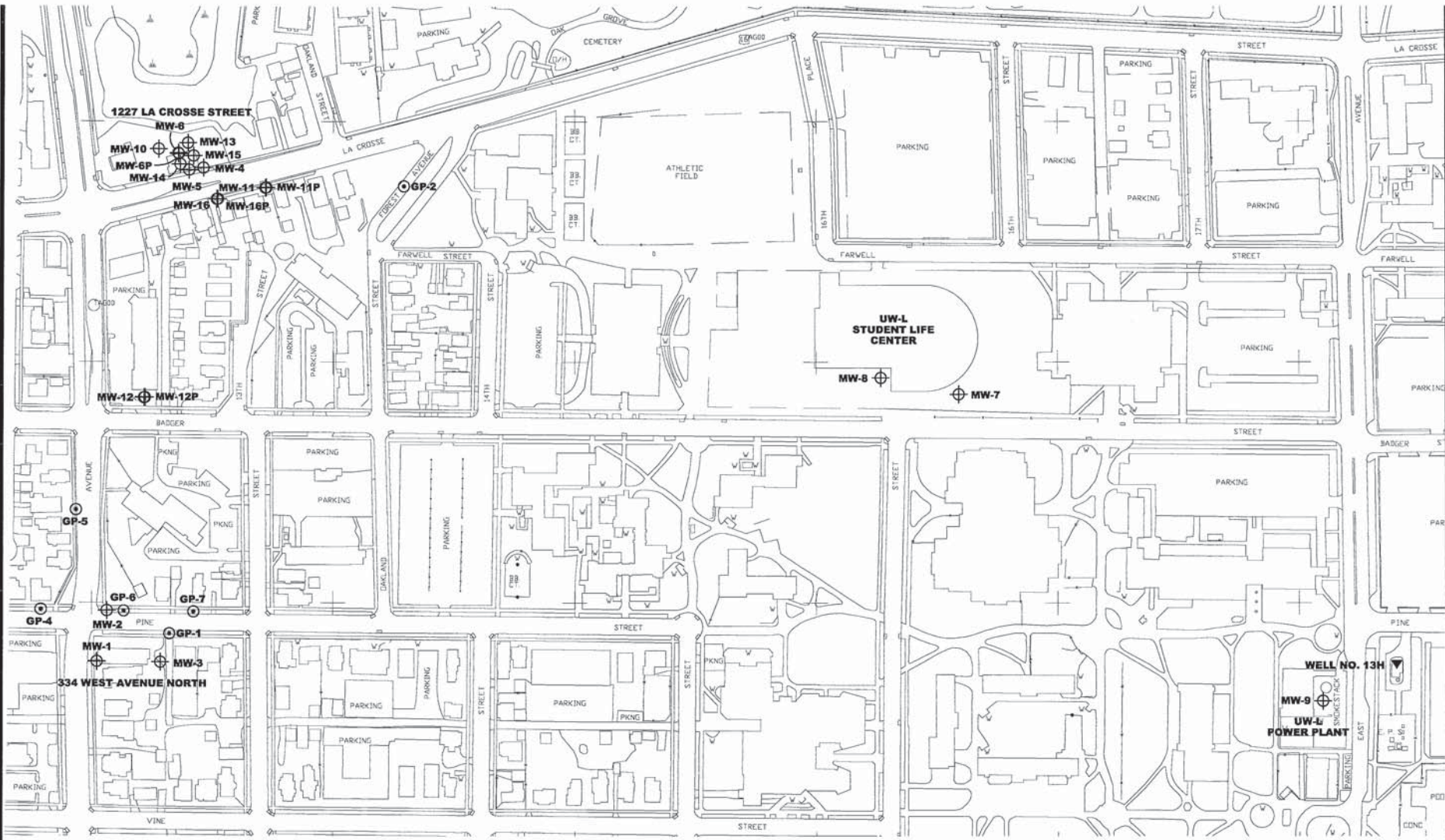

-  **MONITORING WELL**
-  **LACROSSE WELL NO. 13H**
-  **SOIL PROBE LOCATION**



100' 0 200'
SCALE: 1"= 200'

Project No:	CNEX-02-125A
Drawing No:	NE2125A
Scale:	1"= 200'
Drawn By:	BJB
Date Drawn:	4/18/02
Checked By:	KDN
Last Modified:	9/15/09
Sheet:	Fig.
of	2

F:\dip\cnex\ne2125a.dwg, B.LAND, 9/15/2009 9:25:34 AM

DATE	3-6-03
DRAWN BY: BJB	3-6-03
APP'D BY: MD	1-12-07
JOB NO. CNEX-02-125A	
DWG. NO. NE2125A1	SHEET 0F
SCALE	1" = 20'

FIGURE NO.

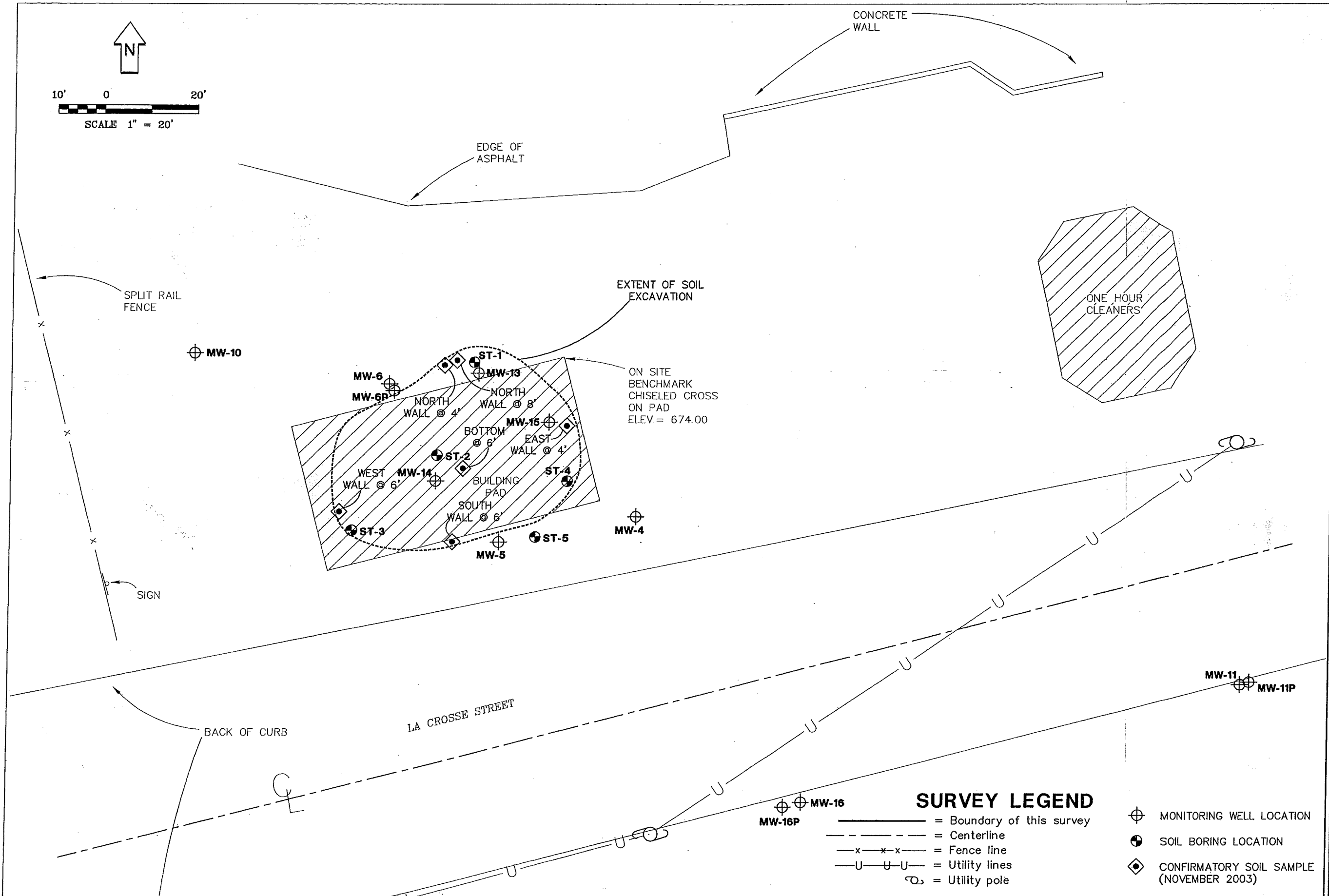

SURVEY LEGEND

- = Boundary of this survey
- - - = Centerline
- x-x- = Fence line
- U-U- = Utility lines
- ⊕ = MONITORING WELL LOCATION
- ⊙ = SOIL BORING LOCATION
- ◆ = CONFIRMATORY SOIL SAMPLE (NOVEMBER 2003)
- ⊕ = Utility pole

SOIL ANALYTICAL RESULTS (AUGUST, 2006)
DORPROP LLC - ONE HOUR CLEANERS
1227 LA CROSSE STREET
LACROSSE, WISCONSIN

DATE	3-6-03
DRAWN BY:	BJB
APP'D BY:	KLH
JOB NO.	CNEX-02-125A
DWG. NO.	NE2125A1
SCALE	1" = 20'
SHEET	OF
FIGURE NO.	5

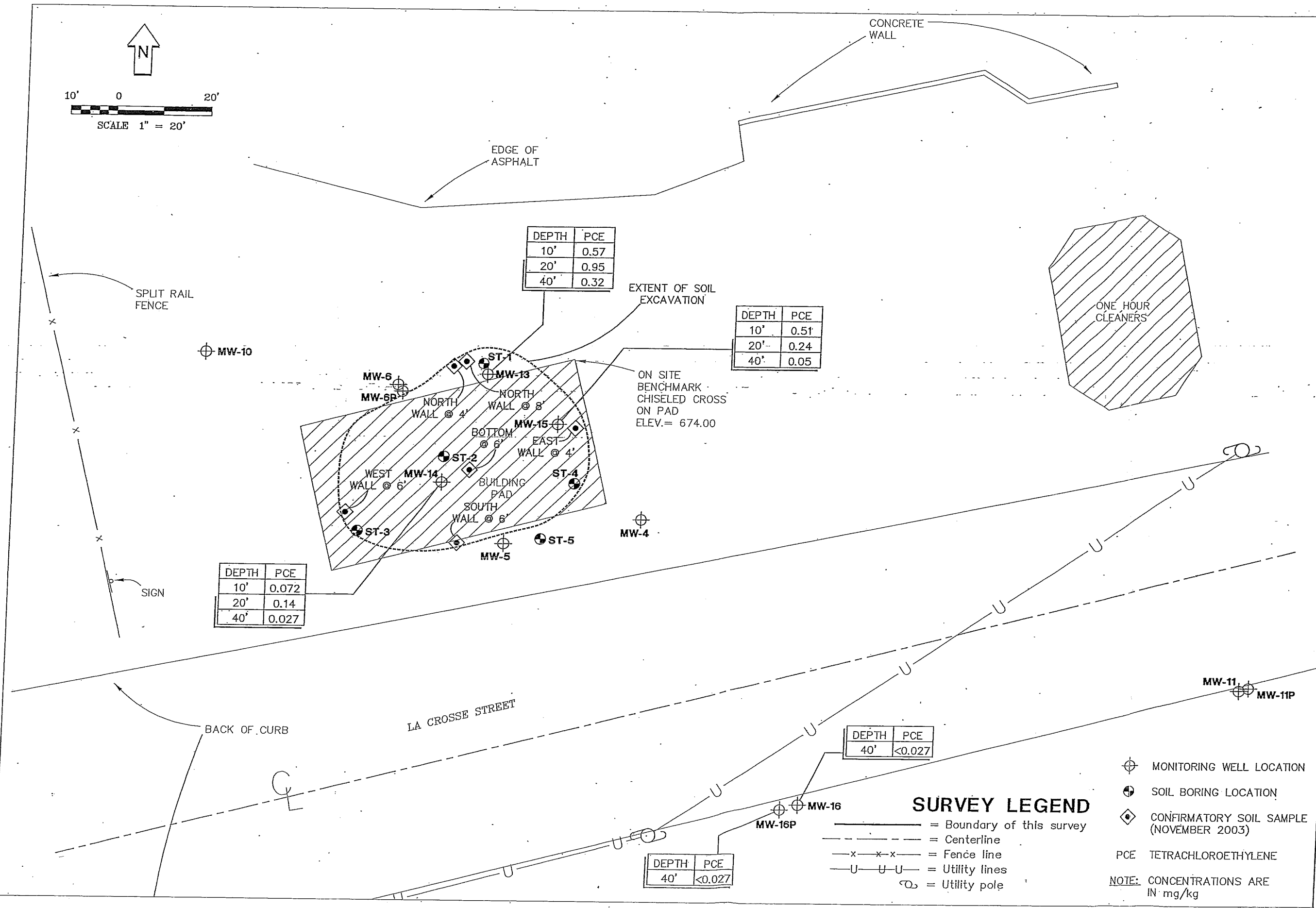
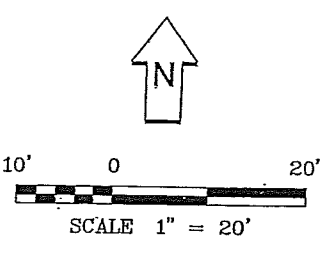

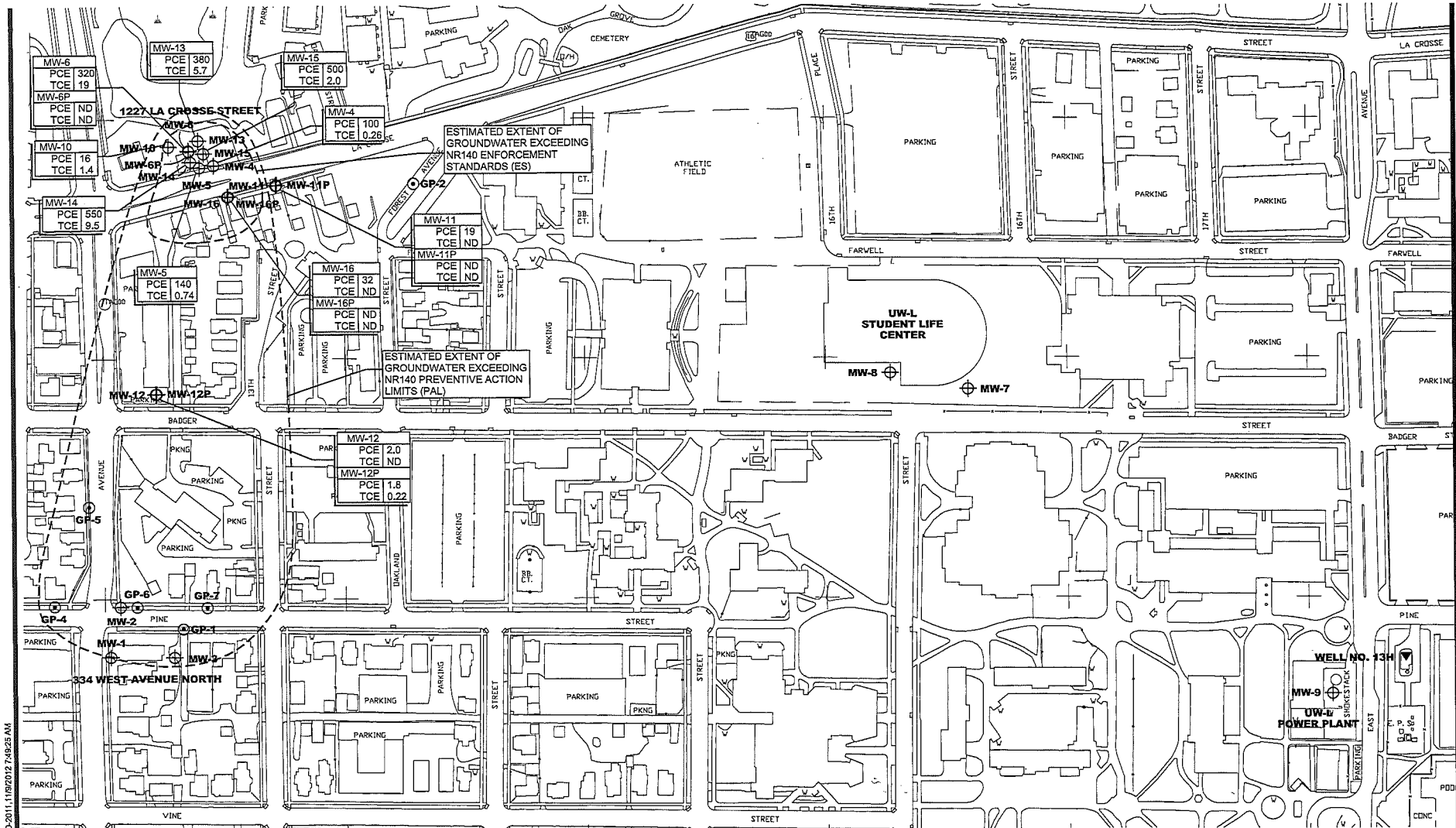

F:\DEPT\NE2125A.dwg, GW CONTAM 6-30-2011, 11/9/2012 7:48:25 AM

- ⊕ **MONITORING WELL**
 - ▼ **LACROSSE WELL NO. 13H**
 - **SOIL PROBE LOCATION**
- | | |
|-----|---|
| PCE | TETRACHLOROETHYLENE |
| TCE | TRICHLOROETHYLENE |
| ND | COMPOUND WAS NOT DETECTED ABOVE THE LABORATORY METHOD DETECTION LIMIT |
- NOTE:** CONCENTRATIONS ARE REPORTED IN µg/L

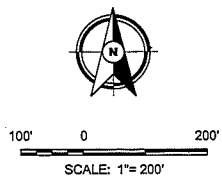
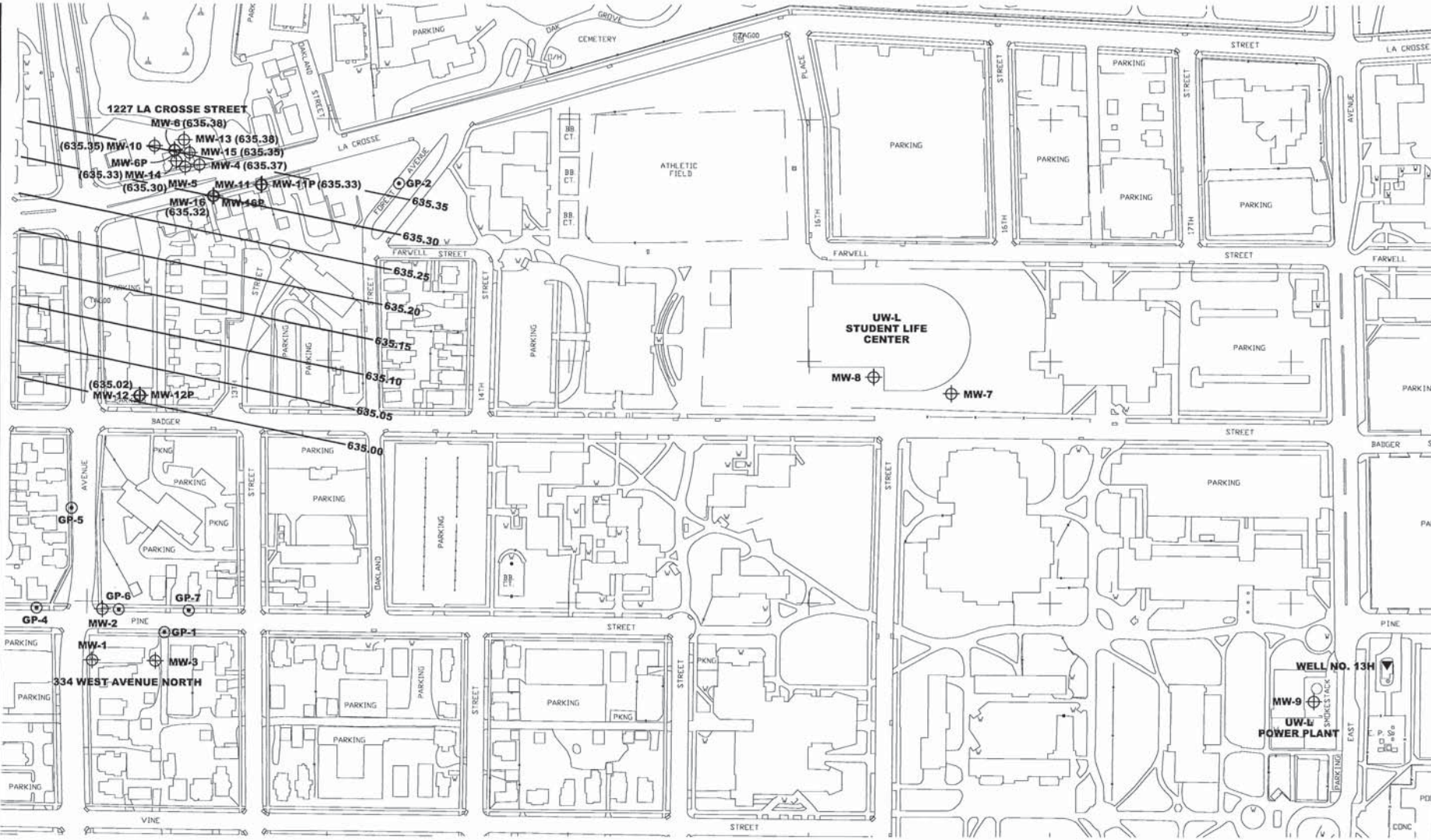

Figure # | GROUNDWATER CONCENTRATION MAP (6/30/2011)
DORPROP, LLC - ONE HOUR CLEANERS
1227 LACROSSE STREET
LACROSSE, WISCONSIN





Project No:	ONEX-02-125A
Drawing No:	NE2125A
Scale:	1"= 200'
Drawn By:	BJB
Date Drawn:	4/19/02
Checked By:	KEM
Last Modified:	11/9/12
Sheet:	Fig:
of	

**BRAUN
INTERTEC**

11001 Hampshire Avenue So.
Minneapolis, MN 55438
PH. (952) 995-2000
FAX (952) 995-2000



ESTIMATED GROUNDWATER CONTOUR MAP (6/30/2011)
DORPROP, LLC - ONE HOUR CLEANERS
1227 LACROSSE STREET
LACROSSE, WISCONSIN

-  **MONITORING WELL**
-  **(635.02) GROUNDWATER ELEVATION (FT.)**
-  **LACROSSE WELL NO. 13H**
-  **GROUNDWATER ELEVATION CONTOUR (ESTIMATED)**
-  **SOIL PROBE LOCATION**



Project No:	CNEX-02-125A
Drawing No:	NE2125A
Scale:	1" = 200'
Drawn By:	BUB
Date Drawn:	4/19/02
Checked By:	KDN
Last Modified:	11/9/12
Sheet:	Fig.
of	

Project #: CNEX-02-125A
 Dorprop, LLC - One Hour Cleaners
 1227 La Crosse Street
 La Crosse, Wisconsin

Soil Sample Analytical Results - August 1, 2006 through August 3, 2006

PARAMETER (mg/kg):	MW-13			MW-14			MW-15			MW-16	MW-16P	NR720 RCLs ¹	NR746.06 Table 1 ²	NR746.06 Table 2 ³
	8/3/2006 5-10 feet	8/3/2006 20-25 feet	8/3/2006 35-40 feet	8/3/2006 5-10 feet	8/3/2006 15-20 feet	8/3/2006 35-40 feet	8/2/2006 5-10 feet	8/2/2006 15-20 feet	8/2/2006 35-40 feet	8/1/2006 35-40 feet	8/1/2006 35-40 feet			
Bromodichloromethane	<0.027	<0.027	<0.026	<0.026	<0.026	<0.026	<0.027	<0.026	<0.026	<0.027	<0.027	NS	NS	NS
Chloroform	<0.027	<0.027	<0.026	<0.026	<0.026	<0.026	<0.027	<0.026	<0.026	<0.027	<0.027	NS	NS	NS
cis-1,2-Dichloroethylene	<0.027	<0.027	<0.026	<0.026	<0.026	<0.026	<0.027	<0.026	<0.026	<0.027	<0.027	NS	NS	NS
trans-1,2-Dichloroethylene	<0.027	<0.027	<0.026	<0.026	<0.026	<0.026	<0.027	<0.026	<0.026	<0.027	<0.027	NS	NS	NS
Ethylbenzene	<0.027	<0.027	<0.026	<0.026	<0.026	<0.026	<0.027	<0.026	<0.026	<0.027	<0.027	NS	NS	NS
Methylene Chloride	<0.054	<0.053	<0.053	<0.052	<0.052	<0.052	<0.054	<0.053	<0.052	<0.053	<0.053	2.9	4.6	NS
Tetrachloroethylene	0.57	0.95	0.32	0.072	0.14	0.027	0.51	0.24	0.05	<0.027	<0.027	NS	NS	NS
Toluene	<0.027	<0.027	<0.026	<0.026	<0.026	<0.026	<0.027	<0.026	<0.026	<0.027	<0.027	1.5	3.8	NS
Trichloroethylene	<0.027	<0.027	<0.026	<0.026	<0.026	<0.026	<0.027	<0.026	<0.026	<0.027	<0.027	NS	NS	NS
1,2,4-Trimethylbenzene	<0.027	<0.027	<0.026	<0.026	<0.026	<0.026	<0.027	<0.026	<0.026	<0.027	<0.027	NS	NS	NS
1,3,5-Trimethylbenzene	<0.027	<0.027	<0.026	<0.026	<0.026	<0.026	<0.027	<0.026	<0.026	<0.027	<0.027	NS	83	NS
Xylenes, Total	<0.091	<0.091	<0.090	<0.089	<0.089	<0.089	<0.092	<0.089	<0.088	<0.090	<0.090	4.1	4.2	NS

Notes:

Sources for Wisconsin soil standards:

¹ - Wisconsin Administrative Code, Chapter NR720, Table 1 and Table 2, Residual Contaminant Levels (metals standards are Industrial)

² - Wisconsin Administrative Code, Chapter NR746, Table 1 - Indicators of Residual Petroleum Product in Soil Pores

³ - Wisconsin Administrative Code, Chapter NR746, Table 2 - Protection of Human Health from Direct Contact with Contaminated Soil

BOLD values exceed one or more Wisconsin Soil Standards

NS - No Wisconsin Soil Standards have been established

Project #: CNEX-02-125A
Dorprop, LLC - One Hour Cleaners
1227 La Crosse Street
La Crosse, Wisconsin

Soil Sample Organic Vapor Results - August 2, 2006 (concentrations in ppm)

Depth (feet)	MW-13	MW-14	MW-15	MW-16	MW-16P
5	12.1	4.1	41.3	2.7	NS
10	19.6	20.2	34.5	1.9	NS
15	7.7	16.5	32.3	2.0	NS
20	9.2	21.5	50.8	2.5	NS
25	31.2	10.0	46.6	3.2	NS
30	22.6	8.6	30.1	2.0	NS
35	25.4	18.6	48.5	2.8	NS
40	31.3	8.3	33.9	3.2	2.4

NS = Not Sampled

Project #: CNEX-02-125A
 Dorprop, LLC - One Hour Cleaners
 1227 La Crosse Street
 La Crosse, Wisconsin

Soil Excavation Sampling Results - November 2003

Parameter	Southwall @ 6'	Westwall @ 6'	Eastwall @ 4'
Sample Location	South Sidewall	West Sidewall	East Sidewall
ASTM Soil Classification	SP	SP	SP
Organic Vapor Reading (ppm)	0.4	0.4	2.2
VOCs (µg/kg)			
Tetrachloroethylene	420	<100	1,600

Parameter	Northwall @ 4'	Northwall @ 8'	Bottom @ 6'
Sample Location	North Sidewall	North Sidewall	Bottom Center
ASTM Soil Classification	SP	SP	SP
Organic Vapor Reading (ppm)	4.4	4.2	7.2
VOCs (µg/kg)			
Tetrachloroethylene	360	4,800	490

SP = Poorly-graded sand

All other volatile organic compounds were less than the method detection limits.

Project #: CNEX-02-125A
 Dorprop, LLC - One Hour Cleaners
 1227 La Crosse Street
 La Crosse, Wisconsin

Soil Sample Analytical Results - July 22 and July 29, 2002

PARAMETER (mg/kg):	ST-1 2.5 feet	ST-2 2.5 feet	ST-3 2.5 feet	ST-4 10 feet	ST-5 5 feet	MW-6P 25 feet	NR720 RCLs ¹	NR746.06 Table 1 ²	NR746.06 Table 2 ³
Bromodichloromethane	<0.050	<0.050	<0.050	<0.050	<0.050	<0.050	NS	NS	NS
Chloroform	<0.050	<0.050	<0.050	<0.050	<0.050	<0.050	NS	NS	NS
cis-1,2-Dichloroethylene	<0.050	<0.050	<0.050	<0.050	<0.050	<0.050	NS	NS	NS
trans-1,2-Dichloroethylene	<0.050	<0.050	<0.050	<0.050	<0.050	<0.050	NS	NS	NS
Ethylbenzene	<0.050	<0.050	<0.050	<0.050	<0.050	<0.050	NS	NS	NS
Methylene Chloride	<0.250	<0.250	<0.250	<0.250	<0.250	<0.250	2.9	4.6	NS
Tetrachloroethylene	1.8	30	1.4	0.17	<0.100	0.5	NS	NS	NS
Toluene	<0.050	<0.050	<0.050	<0.050	<0.050	<0.050	NS	NS	NS
Trichloroethylene	<0.050	<0.050	<0.050	<0.050	<0.050	<0.050	1.5	3.8	NS
1,2,4-Trimethylbenzene	<0.050	<0.050	<0.050	<0.050	<0.050	<0.050	NS	NS	NS
1,3,5-Trimethylbenzene	<0.050	<0.050	<0.050	<0.050	<0.050	<0.050	NS	83	NS
Xylenes, Total	<0.050	<0.050	<0.050	<0.050	<0.050	<0.050	NS	11	NS
							4.1	4.2	NS

Notes:

Sources for Wisconsin soil standards:

¹ - Wisconsin Administrative Code, Chapter NR720, Table 1 and Table 2, Residual Contaminant Levels (metals standards are Industrial)

² - Wisconsin Administrative Code, Chapter NR746, Table 1 - Indicators of Residual Petroleum Product in Soil Pores

³ - Wisconsin Administrative Code, Chapter NR746, Table 2 - Protection of Human Health from Direct Contact with Contaminated Soil

BOLD values exceed one or more Wisconsin Soil Standards

NS - No Wisconsin Soil Standards have been established

Project #: CNEX-02-125A
Dorprop, LLC - One Hour Cleaners
1227 La Crosse Street
La Crosse, Wisconsin

Soil Sample Organic Vapor Results - July 22, 2002 (concentrations in ppm)

Depth (feet)	ST-1	ST-2	ST-3	ST-4	ST-5
2.5'	0.5	78.1	2.6	0.0	2.6
5'	0.1	48.6	1.3	0.0	1.3
7.5'	0.3	18.3	0.0	1.3	0.0
10'	0.0	21.7	0.0	3.9	0.0
12.5'	0.0	11.8	0.0	0.0	0.0
15'	0.0	51.3	0.0	3.9	1.3
17.5'	0.0	28.7	0.0	0.0	0.0
20'	0.0	19.1	0.0	2.6	3.9

Project #: CNEX-02-125A
 Dorprop, LLC - One Hour Cleaners
 1227 La Crosse Street
 La Crosse, Wisconsin

Soil Sample Analytical Results - July 9 through July 11, 2001

PARAMETER (mg/kg):	GP-1 1 - 3 feet	MW-3 9 - 11 feet	MW-4 39 - 41 feet	MW-7 34 - 36 feet	MW-9 39 - 41 feet	NR720 RCLs ¹	NR746.06 Table 1 ²	NR746.06 Table 2 ³
Bromodichloromethane	<0.025	<0.025	<0.025	<0.025	<0.025	NS	NS	NS
Chloroform	<0.025	<0.025	<0.025	<0.025	<0.025	NS	NS	NS
cis-1,2-Dichloroethylene	<0.025	<0.025	<0.025	<0.025	<0.025	NS	NS	NS
trans-1,2-Dichloroethylene	<0.025	<0.025	<0.025	<0.025	<0.025	NS	NS	NS
Ethylbenzene	<0.025	<0.025	<0.025	<0.025	<0.025	NS	NS	NS
Methylene Chloride	0.0522	<0.025	<0.025	<0.025	<0.025	2.9	4.6	NS
Tetrachloroethylene	<0.025	<0.025	<0.025	<0.025	<0.025	NS	NS	NS
Toluene	<0.025	<0.025	<0.025	<0.025	<0.025	NS	NS	NS
Trichloroethylene	<0.025	<0.025	<0.025	<0.025	<0.025	1.5	3.8	NS
1,2,4-Trimethylbenzene	<0.025	<0.025	<0.025	<0.025	<0.025	NS	NS	NS
1,3,5-Trimethylbenzene	<0.025	<0.025	<0.025	<0.025	<0.025	NS	83	NS
Xylenes, Total	<0.025	<0.025	<0.025	<0.025	<0.025	NS	11	NS
						4.1	4.2	NS

Notes:

Sources for Wisconsin soil standards:

¹ - Wisconsin Administrative Code, Chapter NR720, Table 1 and Table 2, Residual Contaminant Levels (metals standards are Industrial)

² - Wisconsin Administrative Code, Chapter NR746, Table 1 - Indicators of Residual Petroleum Product in Soil Pores

³ - Wisconsin Administrative Code, Chapter NR746, Table 2 - Protection of Human Health from Direct Contact with Contaminated Soil

BOLD values exceed one or more Wisconsin Soil Standards

NS - No Wisconsin Soil Standards have been established

Project #: CNEX-02-125A
Dorprop, LLC - One Hour Cleaners
1227 La Crosse Street
La Crosse, Wisconsin

Soil Sample Organic Vapor Results - July 9 through July 11, 2001 (concentrations in ppm)

Depth (feet)	MW-3	MW-4	MW-7	MW-9
1' - 3'	2.6	0.3	---	0.4
4' - 6'	1.8	0.3	1.0	1.2
9' - 11'	5.6	0.4	1.0	1.4
14' - 16'	3.6	0.3	1.6	2.0
19' - 21'	5.0	0.4	1.5	2.8
24' - 26'	3.0	0.6	1.6	2.8
29' - 31'	2.8	0.6	1.8	2.6
34' - 36'	3.8	2.2	1.8	3.0
39' - 41'	---	7.2	1.0	4.0
44' - 46'	---	---	---	3.2

Project #: CNEX-02-125A
 Dorprop, LLC - One Hour Cleaners
 1227 La Crosse Street
 La Crosse, Wisconsin

Table 2
 MW-1 Groundwater Analytical Results
 (concentrations are in µg/L)

Date	Bromodichloromethane	Chloroform	cis-1,2-Dichloroethylene	trans-1,2-Dichloroethylene	Ethylbenzene	Tetrachloroethylene	Toluene	Trichloroethylene	Trimethylbenzenes, Combined	Xylenes, Total
NR140 ES ¹	0.6	6	70	100	700	5	1,000	5	480	10,000
NR 140 PAL ²	0.06	0.6	7	20	140	0.5	200	0.5	96	1,000
7/24/2001	<0.2	<0.24	<0.25	<0.25	<0.5	11.1	<0.4	<0.26	<0.57	<0.57
9/11/2001	<0.2	<0.24	<0.25	<0.25	<0.5	7.93	<0.4	<0.26	<0.57	<0.57

Notes:

Sources for Wisconsin groundwater standards:

¹ - Wisconsin Administrative Code, Chapter NR140 Groundwater Enforcement Standards (ES)

² - Wisconsin Administrative Code, Chapter NR140 Groundwater Preventive Action Limits (PALs)

BOLD values exceed NR140 ES

values in *italics* exceed NR140 PAL

Project #: CNEX-02-125A
 Dorprop, LLC - One Hour Cleaners
 1227 La Crosse Street
 La Crosse, Wisconsin

Table 3
 MW-2 Groundwater Analytical Results
 (concentrations are in µg/L)

Date	Bromodichloromethane	Chloroform	cis-1,2-Dichloroethylene	trans-1,2-Dichloroethylene	Ethylbenzene	Tetrachloroethylene	Toluene	Trichloroethylene	Trimethylbenzenes, Combined	Xylenes, Total
NR140 ES ¹	0.6	6	70	100	700	5	1,000	5	480	10,000
NR 140 PAL ²	0.06	0.6	7	20	140	0.5	200	0.5	96	1,000
7/24/2001	<0.2	<i>0.645</i>	<0.25	<0.25	<0.5	<i>1.75</i>	<0.4	0.361	<0.57	<0.57
9/11/2001	<0.2	0.471	<0.25	<0.25	<0.5	<i>0.683</i>	<0.4	0.284	<0.57	<0.57

Notes:

Sources for Wisconsin groundwater standards:

¹ - Wisconsin Administrative Code, Chapter NR140 Groundwater Enforcement Standards (ES)

² - Wisconsin Administrative Code, Chapter NR140 Groundwater Preventive Action Limits (PALs)

BOLD values exceed NR140 ES
 values in *italics* exceed NR140 PAL

Project #: CNEX-02-125A
 Dorprop, LLC - One Hour Cleaners
 1227 La Crosse Street
 La Crosse, Wisconsin

Table 4
 MW-3 Groundwater Analytical Results
 (concentrations are in µg/L)

Date	Bromodichloromethane	Chloroform	cis-1,2-Dichloroethylene	trans-1,2-Dichloroethylene	Ethylbenzene	Tetrachloroethylene	Toluene	Trichloroethylene	Trimethylbenzenes, Combined	Xylenes, Total
NR140 ES ¹	0.6	6	70	100	700	5	1,000	5	480	10,000
NR 140 PAL ²	0.06	0.6	7	20	140	0.5	200	0.5	96	1,000
7/24/2001	<0.2	<0.24	<0.25	<0.25	<0.5	9.60	<0.4	<0.26	<0.57	<0.57
9/11/2001	<0.2	0.304	<0.25	<0.25	<0.5	<i>4.46</i>	<0.4	<0.26	<0.57	<0.57

Notes:

Sources for Wisconsin groundwater standards:

¹ - Wisconsin Administrative Code, Chapter NR140 Groundwater Enforcement Standards (ES)

² - Wisconsin Administrative Code, Chapter NR140 Groundwater Preventive Action Limits (PALs)

BOLD values exceed NR140 ES

values in *italics* exceed NR140 PAL

Project #: CNEX-02-125A
 Dorprop, LLC - One Hour Cleaners
 1227 La Crosse Street
 La Crosse, Wisconsin

Table 5
 MW-4 Groundwater Analytical Results
 (concentrations are in µg/L)

Date	Bromodichloromethane	Chloroform	cis-1,2-Dichloroethylene	trans-1,2-Dichloroethylene	Ethylbenzene	Tetrachloroethylene	Toluene	Trichloroethylene	Trimethylbenzenes Combined	Xylenes, Total	Naphthalene
NR140 ES ¹	0.6	6	70	100	700	5	1,000	5	480	10,000	100
NR 140 PAL ²	0.06	0.6	7	20	140	0.5	200	0.5	96	1,000	10
7/23/2001	<0.2	<0.24	8.93	1.12	<0.5	673	<0.4	19.0	<0.57	<0.57	ND
9/11/2001	<10.0	<12.0	<12.5	<12.5	<25.0	187	<20.0	<13.0	<28.5	<28.5	ND
8/16/2002	<1.0	<1.0	<1.0	<1.0	<1.0	270	<1.0	2.4	<2.0	<2.0	ND
12/3/2002	<1.0	<1.0	<1.0	<1.0	<1.0	110	<1.0	<i>1.1</i>	<2.0	<2.0	ND
1/23/2004	<1.0	<1.0	1.8	<1.0	<1.0	370	<1.0	9.2	<2.0	<2.0	ND
5/28/2004	<1.0	<1.0	2.2	<1.0	<1.0	250	<1.0	4.4	<2.0	<2.0	ND
8/4/2006	<0.40	<0.40	3.2	<1.0	<1.0	270	<0.40	3.2	<0.80	<1.0	ND
11/1/2006	<0.20	<0.20	6.4	<0.50	<0.50	280	<0.20	7.2	<0.40	<0.50	ND
6/19/2007	<1.0	<1.0	<i>10</i>	<2.5	<2.5	340	<1.0	6.5	<2.0	<2.5	ND
11/25/2008	<0.20	<0.20	<0.50	<0.50	<0.50	47	<0.50	1.0	<0.40	<0.50	ND
2/12/2009	<0.20	<0.20	<0.50	<0.50	<0.50	19	<0.50	0.50	<0.40	<0.50	0.27
5/8/2009	<0.20	<0.20	<0.50	<0.50	<0.50	350	<0.50	1.9	<0.40	<0.50	<0.25
8/27/2009	<0.40	<0.40	<1.0	<1.0	<1.0	78	<1.0	<i>1.0</i>	<0.80	<1.0	<0.50
11/30/2009	<0.20	<0.20	<0.50	<0.50	<0.50	43	<0.50	0.46	<0.40	<0.50	<0.25
2/23/2010	<0.20	<0.20	<0.50	<0.50	<0.50	95	<0.50	0.49	<0.40	<0.50	2.6
9/20/2010	<0.20	<0.20	<0.50	<0.50	<0.50	83	<0.50	0.39	<0.40	<0.50	<0.25
12/15/2010	<0.20	<0.20	<0.50	<0.50	<0.50	87	<0.50	0.30	<0.40	<0.50	<0.25
3/18/2011	<0.20	<0.20	<0.50	<0.50	<0.50	180	<0.50	0.41	<0.40	<0.50	<0.25
6/30/2011	<0.20	<0.20	<0.50	<0.50	<0.50	100	<0.50	0.26	<0.40	<0.50	<0.25

Notes:

Sources for Wisconsin groundwater standards:

¹ - Wisconsin Administrative Code, Chapter NR140 Groundwater Enforcement Standards (ES)

² - Wisconsin Administrative Code, Chapter NR140 Groundwater Preventive Action Limits (PALs)

BOLD values exceed NR140 ES

values in *italics* exceed NR140 PAL

ND - No Detection above laboratory detection limit

Project #: CNEX-02-125A
 Dorprop, LLC - One Hour Cleaners
 1227 La Crosse Street
 La Crosse, Wisconsin

Table 6
 MW-5 Groundwater Analytical Results
 (concentrations are in µg/L)

Date	Bromodichloromethane	Chloroform	cis-1,2-Dichloroethylene	trans-1,2-Dichloroethylene	Ethylbenzene	Tetrachloroethylene	Toluene	Trichloroethylene	Trimethylbenzenes, Combined	Xylenes, Total	n-Butylbenzene
NR140 ES ¹	0.6	6	70	100	700	5	1,000	5	480	10,000	NS
NR 140 PAL ²	0.06	0.6	7	20	140	0.5	200	0.5	96	1,000	NS
7/23/2001	<0.2	<0.24	<0.25	<0.25	<0.5	1,130	<0.4	5.12	<0.57	<0.57	ND
9/11/2001	<20.0	<24.0	<25.0	<25.0	<50.0	402	<40.0	<26.0	<57.0	<57.0	ND
8/16/2002	<1.0	<1.0	1.1	<1.0	<1.0	290	<1.0	4.8	<2.0	<2.0	ND
12/4/2002	<1.0	<1.0	<1.0	<1.0	<1.0	400	<1.0	4.2	<2.0	<2.0	ND
1/23/2004	<1.0	<1.0	<i>12</i>	<1.0	<1.0	300	<1.0	8.7	<2.0	<2.0	ND
5/28/2004	<1.0	<1.0	<i>14</i>	<1.0	<1.0	620	<1.0	14	<2.0	<2.0	ND
8/4/2006	<2.0	<2.0	<i>13</i>	<5.0	<5.0	400	<2.0	8.3	<4.0	<5.0	ND
11/1/2006	<0.20	<0.20	7.5	<0.50	<0.50	360	<0.20	9.9	<0.40	<0.50	ND
6/19/2007	<1.6	<1.6	6.6	<4.0	<4.0	580	<1.6	9.7	<3.2	<4.0	ND
11/25/2008	<0.20	<0.20	2.5	<0.50	<0.50	480	<0.50	7.9	<0.40	<0.50	ND
2/12/2009	<1.6	<1.6	<4.0	<4.0	<4.0	460	<4.0	3.4	<3.2	<4.0	ND
5/8/2009	<2.0	<2.0	<5.0	<5.0	<5.0	640	<5.0	3.9	<4.0	<5.0	ND
8/27/2009	<0.20	<0.20	<0.50	<0.50	<0.50	1,100	<0.50	3.6	<0.40	<0.50	ND
11/30/2009	<0.20	<0.20	<0.50	<0.50	<0.50	84	<0.50	<i>0.85</i>	<0.40	<0.50	ND
2/22/2010	<0.20	<0.20	<0.50	<0.50	<0.50	130	<0.50	<i>1.2</i>	<0.40	<0.50	ND
9/20/2010	<0.20	<0.20	<0.50	<0.50	<0.50	140	<0.50	<i>1.1</i>	<0.40	<0.50	ND
12/15/2010	<0.20	<0.20	0.65	<0.50	<0.50	310	<0.50	<i>2.0</i>	<0.40	<0.50	ND
3/18/2011	<0.20	<0.20	0.65	<0.50	<0.50	460	<0.50	<i>2.0</i>	25	<0.50	25
6/30/2011	<0.40	<0.40	<1.0	<1.0	<1.0	140	<1.0	<i>0.74</i>	<0.80	<1.0	<0.40

Notes:
 Sources for Wisconsin groundwater standards:
¹ - Wisconsin Administrative Code, Chapter NR140 Groundwater Enforcement Standards (ES)
² - Wisconsin Administrative Code, Chapter NR140 Groundwater Preventive Action Limits (PALs)
BOLD values exceed NR140 ES
 values in *italics* exceed NR140 PAL
 ND - No Detection above laboratory detection limit
 NS - No Standard established

Project #: CNEX-02-125A
 Dorprop, LLC - One Hour Cleaners
 1227 La Crosse Street
 La Crosse, Wisconsin

Table 7
 MW-6 Groundwater Analytical Results
 (concentrations are in µg/L)

Date	Bromodichloromethane	Chloroform	cis-1,2-Dichloroethylene	trans-1,2-Dichloroethylene	Ethylbenzene	Tetrachloroethylene	Toluene	Trichloroethylene	Trimethylbenzenes, Combined	Vinyl Chloride	Aylenes, Total	Chloromethane
NR140 ES ¹	0.6	6	70	100	700	5	1,000	5	480	0.2	10,000	3
NR 140 PAL ²	0.06	0.6	7	20	140	0.5	200	0.5	96	0.02	1,000	0.3
7/23/2001	<0.2	<0.24	2.08	<0.25	<0.5	1,630	<0.4	11.8	<0.57	<0.4	<0.57	ND
9/11/2001	<2.20	<2.40	12.6	<2.50	<5.00	77.6	<4.00	2.67	<5.70	<4.00	<5.70	ND
8/16/2002	<2.0	<2.0	11	<2.0	<2.0	250	<2.0	6.6	<4.0	<2.0	<4.0	ND
12/4/2002	<1.0	<1.0	2.8	<1.0	<1.0	920	<1.0	7.7	<2.0	<1.0	<2.0	ND
1/23/2004	<1.0	<1.0	34	<1.0	<1.0	230	<1.0	10	<2.0	<1.0	<2.0	ND
5/28/2004	<1.0	<1.0	3.5	<1.0	<1.0	140	<1.0	2.5	<2.0	<1.0	<2.0	ND
8/4/2006	<0.20	<0.20	6.9	<0.50	<0.50	220	<0.20	12	<0.44	0.33	<0.50	ND
10/31/2006	<0.20	<0.20	15	<0.50	<0.50	120	<0.20	17	<0.44	0.73	<0.50	ND
6/19/2007	<1.0	<1.0	<2.5	<2.5	<2.5	290	<1.0	5.0	<2.0	<1.0	<2.5	ND
11/24/2008	<0.20	<0.20	11	<0.50	<0.50	690	<0.50	29	<0.40	<0.20	<0.50	ND
2/12/2009	<0.20	<0.20	7.0	<0.50	<0.50	140	<0.50	19	<0.40	<0.20	<0.50	ND
5/8/2009	<0.20	<0.20	6.1	<0.50	<0.50	400	<0.50	9.1	<0.40	<0.20	<0.50	ND
8/27/2009	<0.20	<0.20	6.4	<0.50	<0.50	830	<0.50	18	<0.40	<0.20	<0.50	ND
11/30/2009	<0.20	<0.20	7.5	<0.50	<0.50	33	<0.50	5.8	<0.40	<0.20	<0.50	ND
2/23/2010	<0.20	<0.20	6.9	<0.50	<0.50	120	<0.50	12	<0.40	<0.20	<0.50	ND
9/20/2010	<0.20	<0.20	9.0	<0.50	<0.50	250	<0.50	16	<0.40	0.24	<0.50	ND
12/15/2010	<0.20	<0.20	7.8	<0.50	<0.50	590	<0.50	25	<0.40	<0.20	<0.50	ND
3/18/2011	<0.20	<0.20	28	<0.50	<0.50	330	<0.50	17	<0.40	<0.20	<0.50	ND
6/30/2011	<1.0	<1.0	6.9	<2.5	<2.5	320	<2.5	19	<2.0	<1.0	<2.5	2.9

Notes:

Sources for Wisconsin groundwater standards:

¹ - Wisconsin Administrative Code, Chapter NR140 Groundwater Enforcement Standards (ES)

² - Wisconsin Administrative Code, Chapter NR140 Groundwater Preventive Action Limits (PALs)

BOLD values exceed NR140 ES

values in *italics* exceed NR140 PAL

ND - No Detection above laboratory detection limit

Project #: CNEX-02-125A
 Dorprop, LLC - One Hour Cleaners
 1227 La Crosse Street
 La Crosse, Wisconsin

Table 8
 MW-6P Groundwater Analytical Results
 (concentrations are in µg/L)

Date	Bromodichloromethane	Chloroform	cis-1,2-Dichloroethylene	trans-1,2-Dichloroethylene	Ethylbenzene	Tetrachloroethylene	Toluene	Trichloroethylene	Trimethylbenzenes, Combined	Xylenes, Total	Bromomethane	Chloromethane
NR140 ES ¹	0.6	6	70	100	700	5	1,000	5	480	10,000	10	3
NR 140 PAL ²	0.06	0.6	7	20	140	0.5	200	0.5	96	1,000	1	0.3
8/16/2002	<1.0	<1.0	<1.0	<1.0	3.3	<2.0	1.1	<1.0	6.9	16.7	ND	ND
12/3/2002	<1.0	<1.0	<1.0	<1.0	<1.0	3.1	<1.0	<1.0	4.5	2.7	ND	ND
1/23/2004	<1.0	<1.0	<1.0	<1.0	<1.0	3.4	<1.0	<1.0	<2.0	<2.0	ND	ND
5/28/2004	<1.0	<1.0	<1.0	<1.0	<1.0	3.7	<1.0	<1.0	<2.0	<2.0	ND	ND
8/7/2006	<0.20	<0.20	<0.50	<0.50	<0.50	55	0.56	0.36	<0.96	<0.50	ND	ND
10/31/2006	<0.20	<0.20	<0.50	<0.50	<0.50	20	<0.20	<0.20	<0.40	<0.50	ND	ND
6/19/2007	<0.20	<0.20	<0.50	<0.50	<0.50	71	<0.20	<0.20	<0.40	<0.50	ND	ND
11/24/2008	<0.20	<0.20	<0.50	<0.50	<0.50	1.9	<0.50	<0.20	<0.40	<0.50	ND	ND
2/12/2009	<0.20	<0.20	<0.50	<0.50	<0.50	18	<0.50	<0.20	<0.40	<0.50	ND	ND
5/8/2009	<0.20	<0.20	<0.50	<0.50	<0.50	19	<0.50	<0.20	<0.40	<0.50	ND	ND
8/27/2009	<0.20	<0.20	<0.50	<0.50	<0.50	<0.50	<0.50	<0.20	<0.40	<0.50	ND	ND
11/30/2009	<0.20	<0.20	<0.50	<0.50	<0.50	15	<0.50	<0.20	<0.40	<0.50	ND	ND
2/23/2010	<0.20	<0.20	<0.50	<0.50	<0.50	<0.50	<0.50	<0.20	<0.40	<0.50	ND	ND
9/20/2010	<0.20	<0.20	<0.50	<0.50	<0.50	<0.50	<0.50	0.27	<0.40	<0.50	ND	ND
12/15/2010	<0.20	<0.20	<0.50	<0.50	<0.50	<0.50	<0.50	<0.20	<0.40	<0.50	ND	ND
3/18/2011	<0.20	<0.20	<0.50	<0.50	<0.50	<0.50	<0.50	<0.20	<0.40	<0.50	ND	ND
6/30/2011	<0.20	<0.20	<0.50	<0.50	<0.50	<0.50	<0.50	<0.20	<0.40	<0.50	1.0	0.66

Notes:
 Sources for Wisconsin groundwater standards:
¹ - Wisconsin Administrative Code, Chapter NR140 Groundwater Enforcement Standards (ES)
² - Wisconsin Administrative Code, Chapter NR140 Groundwater Preventive Action Limits (PALs)
BOLD values exceed NR140 ES
 values in *italics* exceed NR140 PAL
 ND - No Detection above laboratory detection limit

Project #: CNEX-02-125A
 Dorprop, LLC - One Hour Cleaners
 1227 La Crosse Street
 La Crosse, Wisconsin

Table 9
 MW-7 Groundwater Analytical Results
 (concentrations are in µg/L)

Date	Bromodichloromethane	Chloroform	cis-1,2-Dichloroethylene	trans-1,2-Dichloroethylene	Ethylbenzene	Tetrachloroethylene	Toluene	Trichloroethylene	Trimethylbenzenes Combined	Xylenes, Total
NR140 ES ¹	0.6	6	70	100	700	5	1,000	5	480	10,000
NR 140 PAL ²	0.06	0.6	7	20	140	0.5	200	0.5	96	1,000
7/23/2001	<0.2	<0.24	<0.25	<0.25	<0.5	<i>2.05</i>	<0.4	<0.26	<0.57	<0.57
9/11/2001	<0.2	<0.24	<0.25	<0.25	<0.5	<0.26	<0.4	<0.26	<0.57	<0.57
8/16/2002	<1.0	<1.0	<1.0	<1.0	<1.0	<2.0	<1.0	<1.0	<2.0	<2.0
12/2/2002	<1.0	<1.0	<1.0	<1.0	<1.0	<2.0	<1.0	<1.0	<2.0	<2.0

Notes:

Sources for Wisconsin groundwater standards:

¹ - Wisconsin Administrative Code, Chapter NR140 Groundwater Enforcement Standards (ES)

² - Wisconsin Administrative Code, Chapter NR140 Groundwater Preventive Action Limits (PALs)

BOLD values exceed NR140 ES

values in *italics* exceed NR140 PAL

Project #: CNEX-02-125A
 Dorprop, LLC - One Hour Cleaners
 1227 La Crosse Street
 La Crosse, Wisconsin

Table 10
 MW-8 Groundwater Analytical Results
 (concentrations are in µg/L)

Date	Bromodichloromethane	Chloroform	cis-1,2-Dichloroethylene	trans-1,2-Dichloroethylene	Ethylbenzene	Tetrachloroethylene	Toluene	Trichloroethylene	Trimethylbenzenes, Combined	Xylenes, Total
NR140 ES ¹	0.6	6	70	100	700	5	1,000	5	480	10,000
NR 140 PAL ²	0.06	0.6	7	20	140	0.5	200	0.5	96	1,000
7/23/2001	<0.2	<0.24	<0.25	<0.25	<0.5	2.62	<0.4	<0.26	<0.57	<0.57
9/11/2001	<0.2	<0.24	<0.25	<0.25	<0.5	<0.26	<0.4	<0.26	<0.57	<0.57
8/16/2002	<1.0	<1.0	<1.0	<1.0	<1.0	<2.0	<1.0	<1.0	<2.0	<2.0
12/2/2002	<1.0	<1.0	<1.0	<1.0	<1.0	<2.0	<1.0	<1.0	<2.0	<2.0

Notes:

Sources for Wisconsin groundwater standards:

¹ - Wisconsin Administrative Code, Chapter NR140 Groundwater Enforcement Standards (ES)

² - Wisconsin Administrative Code, Chapter NR140 Groundwater Preventive Action Limits (PALs)

BOLD values exceed NR140 ES
 values in *italics* exceed NR140 PAL

Project #: CNEX-02-125A
 Dorprop, LLC - One Hour Cleaners
 1227 La Crosse Street
 La Crosse, Wisconsin

Table 11
 MW-9 Groundwater Analytical Results
 (concentrations are in µg/L)

Date	Bromodichloromethane	Chloroform	cis-1,2-Dichloroethylene	trans-1,2-Dichloroethylene	Ethylbenzene	Tetrachloroethylene	Toluene	Trichloroethylene	Trimethylbenzenes Combined	Xylenes Total
NR140 ES ¹	0.6	6	70	100	700	5	1,000	5	480	10,000
NR 140 PAL ²	0.06	0.6	7	20	140	0.5	200	0.5	96	1,000
7/23/2001	<0.2	<0.24	<0.25	<0.25	<0.5	0.988	<0.4	<0.26	<0.57	<0.57
9/11/2001	<0.2	<0.24	<0.25	<0.25	<0.5	<0.26	<0.4	<0.26	<0.57	<0.57
8/16/2002	<1.0	<1.0	<1.0	<1.0	<1.0	<2.0	<1.0	<1.0	<2.0	<2.0
12/2/2002	<1.0	<1.0	<1.0	<1.0	<1.0	<2.0	<1.0	<1.0	<2.0	<2.0

Notes:

Sources for Wisconsin groundwater standards:

¹ - Wisconsin Administrative Code, Chapter NR140 Groundwater Enforcement Standards (ES)

² - Wisconsin Administrative Code, Chapter NR140 Groundwater Preventive Action Limits (PALs)

BOLD values exceed NR140 ES
 values in *italics* exceed NR140 PAL

Project #: CNEX-02-125A
 Dorprop, LLC - One Hour Cleaners
 1227 La Crosse Street
 La Crosse, Wisconsin

Table 12
 MW-10 Groundwater Analytical Results
 (concentrations are in µg/L)

Date	Bromomethane	Bromodichloromethane	Chloroform	cis-1,2-Dichloroethylene	trans-1,2-Dichloroethylene	Ethylbenzene	Tetrachloroethylene	Toluene	Trichloroethylene	Trimethylbenzenes, Combined	Xylenes, Total	Vinyl chloride	1,1-Dichloroethane	Naphthalene	Chloromethane
NR140 ES ¹	10	0.6	6	70	100	700	5	1,000	5	480	10,000	0.2	850	100	3
NR 140 PAL ²	1	0.06	0.6	7	20	140	0.5	200	0.5	96	1,000	0.02	85	10	0.3
8/16/2002	<1.0	<1.0	<1.0	1.3	<1.0	<1.0	12	<1.0	<i>1.0</i>	<2.0	<2.0	ND	ND	ND	ND
12/3/2002	<1.0	<1.0	<1.0	<1.0	<1.0	<1.0	43	<1.0	<1.0	<2.0	<2.0	ND	ND	ND	ND
1/23/2004	<1.0	<1.0	<1.0	2.4	<1.0	<1.0	42	<1.0	<i>1.5</i>	<2.0	<2.0	ND	ND	ND	ND
5/28/2004	<1.0	<1.0	<1.0	<1.0	<1.0	<1.0	12	<1.0	<1.0	<2.0	<2.0	ND	ND	ND	ND
8/4/2006	<0.20	<0.20	<0.20	2.2	<0.50	<0.50	48	<0.20	<i>4.1</i>	<0.40	<0.50	ND	ND	ND	ND
10/31/2006	0.43	<0.20	<0.20	0.82	<0.50	<0.50	83	<0.20	<i>2.9</i>	<0.40	<0.50	ND	ND	ND	ND
6/19/2007	<0.20	<0.20	<0.20	0.77	<0.50	<0.50	51	<0.20	<i>1.4</i>	<0.40	<0.50	ND	ND	ND	ND
11/25/2008	<0.50	<0.20	<0.20	<i>21</i>	<0.50	<0.50	140	<0.50	21	<0.40	<0.50	ND	ND	ND	ND
2/12/2009	<0.50	<0.20	<0.20	<i>8.1</i>	<0.50	<0.50	8.9	<0.50	<i>1.3</i>	<0.40	<0.50	0.40	ND	ND	ND
5/8/2009	<0.50	<0.20	<0.20	<0.50	<0.50	<0.50	<i>2.5</i>	<0.50	0.26	<0.40	<0.50	<0.20	ND	ND	ND
8/27/2009	<0.50	<0.20	<0.20	6.6	<0.50	2.2	96	8.8	6.5	<0.40	14	0.56	2.0	5.2	ND
11/30/2009	<0.50	<0.20	<0.20	1.4	<0.50	<0.50	<i>4.1</i>	<0.50	<i>0.89</i>	<0.40	<0.50	<0.20	<0.50	<0.25	ND
2/23/2010	<0.50	<0.20	<0.20	0.83	<0.50	<0.50	18	<0.50	<i>1.1</i>	<0.40	<0.50	<0.20	<0.50	<0.25	ND
9/20/2010	<0.50	<0.20	<0.20	0.95	<0.50	<0.50	27	<0.50	<i>0.90</i>	<0.40	<0.50	0.22	<0.50	<0.25	ND
12/15/2010	<0.50	<0.20	<0.20	<i>42</i>	<0.50	<0.50	6.0	<0.50	16	<0.40	<0.50	0.48	<0.50	<0.25	ND
3/18/2011	<0.50	<0.20	<0.20	3.5	<0.50	<0.50	12	<0.50	<i>2.5</i>	<0.40	<0.50	0.23	<0.50	<0.25	ND
6/30/2011	<0.50	<0.20	<0.20	<i>34</i>	<0.50	<0.50	16	<0.50	<i>1.4</i>	<0.40	<0.50	<0.20	<0.50	<0.25	<i>0.52</i>

Notes:
 Sources for Wisconsin groundwater standards:
¹ - Wisconsin Administrative Code, Chapter NR140 Groundwater Enforcement Standards (ES)
² - Wisconsin Administrative Code, Chapter NR140 Groundwater Preventive Action Limits (PALs)
BOLD values exceed NR140 ES
 values in *italics* exceed NR140 PAL
 ND - No Detection above laboratory detection limit

Project #: CNEX-02-125A
 Dorprop, LLC - One Hour Cleaners
 1227 La Crosse Street
 La Crosse, Wisconsin

Table 13
 MW-11 Groundwater Analytical Results
 (concentrations are in µg/L)

Date	Bromodichloromethane	Chloroform	Chloromethane	cis-1,2-Dichloroethylene	trans-1,2-Dichloroethylene	Ethylbenzene	Tetrachloroethylene	Toluene	Trichloroethylene	Trimethylbenzenes Combined	Xylenes, Total
NR140 ES ¹	0.6	6	3	70	100	700	5	1,000	5	480	10,000
NR 140 PAL ²	0.06	0.6	0.3	7	20	140	0.5	200	0.5	96	1,000
8/16/2002	1.0	<i>1.9</i>	ND	<1.0	<1.0	<1.0	10	<1.0	<1.0	<2.0	<2.0
12/2/2002	1.9	<i>3.2</i>	ND	<1.0	<1.0	<1.0	11	<1.0	<1.0	<2.0	<2.0
1/23/2004	<1.0	<i>1.0</i>	ND	<1.0	<1.0	<1.0	14	<1.0	<1.0	<2.0	<2.0
5/28/2004	<1.0	<1.0	ND	<1.0	<1.0	<1.0	9.7	<1.0	<1.0	<2.0	<2.0
8/4/2006	<0.20	<0.20	ND	<0.50	<0.50	<0.50	31	<0.20	<0.20	<0.40	<0.50
11/1/2006	<0.20	<0.20	ND	<0.50	<0.50	<0.50	37	<0.20	<0.20	<0.40	<0.50
6/19/2007	<0.20	<0.20	ND	<0.50	<0.50	<0.50	30	<0.20	<0.20	<0.40	<0.50
11/24/2008	<0.20	<0.20	ND	<0.50	<0.50	<0.50	30	<0.50	<0.20	<0.40	<0.50
2/12/2009	<0.20	<0.20	ND	<0.50	<0.50	<0.50	18	<0.50	<0.20	<0.40	<0.50
5/8/2009	<i>0.44</i>	<i>1.5</i>	ND	<0.50	<0.50	<0.50	19	<0.50	<0.20	<0.40	<0.50
8/31/2009	<0.20	<0.20	ND	<0.50	<0.50	<0.50	15	<0.50	<0.20	<0.40	<0.50
11/30/2009	<0.20	<0.20	ND	<0.50	<0.50	<0.50	17	<0.50	<0.20	<0.40	<0.50
2/23/2010	<0.20	<0.20	ND	<0.50	<0.50	<0.50	6.8	<0.50	<0.20	<0.40	<0.50
9/20/2010	<0.20	<0.20	ND	<0.50	<0.50	<0.50	18	<0.50	<0.20	<0.40	<0.50
12/15/2010	<0.20	<0.20	<i>0.94</i>	<0.50	<0.50	<0.50	27	<0.50	<0.20	<0.40	<0.50
3/18/2011	<0.20	<0.20	<0.30	<0.50	<0.50	<0.50	19	<0.50	<0.20	<0.40	<0.50
6/30/2011	<0.20	<0.20	<i>0.52</i>	<0.50	<0.50	<0.50	19	<0.50	<0.20	<0.40	<0.50

Notes:
 Sources for Wisconsin groundwater standards:
¹ - Wisconsin Administrative Code, Chapter NR140 Groundwater Enforcement Standards (ES)
² - Wisconsin Administrative Code, Chapter NR140 Groundwater Preventive Action Limits (PALs)
BOLD values exceed NR140 ES
 values in *italics* exceed NR140 PAL
 ND - No Detection above laboratory detection limit

Project #: CNEX-02-125A
 Dorprop, LLC - One Hour Cleaners
 1227 La Crosse Street
 La Crosse, Wisconsin

Table 14
 MW-11P Groundwater Analytical Results
 (concentrations are in µg/L)

Date	Bromodichloromethane	Chloroform	cis-1,2-Dichloroethylene	trans-1,2-Dichloroethylene	Ethylbenzene	Tetrachloroethylene	Toluene	Trichloroethylene	Trimethylbenzenes, Combined	Xylenes, Total	Chloromethane
NR140 ES ¹	0.6	6	70	100	700	5	1,000	5	480	10,000	3
NR 140 PAL ²	0.06	0.6	7	20	140	0.5	200	0.5	96	1,000	0.3
8/16/2002	<1.0	<1.0	<1.0	<1.0	<1.0	<2.0	<1.0	<1.0	<2.0	1.9	ND
12/2/2002	<1.0	<1.0	<1.0	<1.0	<1.0	<2.0	<1.0	<1.0	6.0	2.8	ND
1/23/2004	<1.0	<1.0	<1.0	<1.0	<1.0	<2.0	<1.0	<1.0	<2.0	<2.0	ND
5/28/2004	<1.0	<1.0	<1.0	<1.0	<1.0	<2.0	<1.0	<1.0	<2.0	<2.0	ND
8/4/2006	<0.20	<0.20	<0.50	<0.50	<0.50	2.4	0.52	<0.20	<1.80	<0.50	ND
11/1/2006	<0.20	<0.20	<0.50	<0.50	<0.50	<0.50	<0.50	<0.20	<0.40	<0.50	ND
6/19/2007	<0.20	<0.20	<0.50	<0.50	<0.50	<0.50	<0.20	<0.20	<0.40	<0.50	ND
11/24/2008	<0.20	<0.20	<0.50	<0.50	<0.50	<0.50	<0.50	<0.20	<0.40	<0.50	ND
2/12/2009	<0.20	<0.20	<0.50	<0.50	<0.50	<0.50	<0.50	<0.20	<0.40	<0.50	ND
5/8/2009	<0.20	<0.20	<0.50	<0.50	<0.50	<0.50	<0.50	<0.20	<0.40	<0.50	ND
8/31/2009	<0.20	<0.20	<0.50	<0.50	<0.50	<0.50	<0.50	<0.20	<0.40	<0.50	ND
11/30/2009	<0.20	<0.20	<0.50	<0.50	<0.50	<0.50	<0.50	<0.20	<0.40	<0.50	ND
2/23/2010	<0.20	<0.20	<0.50	<0.50	<0.50	<0.50	<0.50	<0.20	<0.40	<0.50	ND
9/20/2010	<0.20	<0.20	<0.50	<0.50	<0.50	<0.50	<0.50	<0.20	<0.40	<0.50	ND
12/15/2010	<0.20	<0.20	<0.50	<0.50	<0.50	<0.50	<0.50	<0.20	<0.40	<0.50	ND
3/18/2011	<0.20	<0.20	<0.50	<0.50	<0.50	<0.50	<0.50	<0.20	<0.40	<0.50	ND
6/30/2011	<0.20	<0.20	<0.50	<0.50	<0.50	<0.50	<0.50	<0.20	<0.40	<0.50	0.59

Notes:

Sources for Wisconsin groundwater standards:

¹ - Wisconsin Administrative Code, Chapter NR140 Groundwater Enforcement Standards (ES)

² - Wisconsin Administrative Code, Chapter NR140 Groundwater Preventive Action Limits (PALs)

BOLD values exceed NR140 ES

values in *italics* exceed NR140 PAL

ND - No Detection above laboratory detection limit

Project #: CNEX-02-125A
Dorprop, LLC - One Hour Cleaners
1227 La Crosse Street
La Crosse, Wisconsin

Table 15
MW-12 Groundwater Analytical Results
(concentrations are in µg/L)

Date	Bromodichloromethane	Chloroform	Chlorodibromomethane	Chloromethane	cis-1,2-Dichloroethylene	trans-1,2-Dichloroethylene	Ethylbenzene	Tetrachloroethylene	Toluene	Trichloroethylene	Trimethylbenzenes, Combined	Xylenes, Total
NR140 ES ¹	0.6	6	60	3	70	100	700	5	1,000	5	480	10,000
NR 140 PAL ²	0.06	0.6	6	0.3	7	20	140	0.5	200	0.5	96	1,000
1/23/2004	<1.0	<1.0	ND	ND	<1.0	<1.0	<1.0	2.2	<1.0	<1.0	<2.0	<2.0
5/28/2004	<1.0	<1.0	ND	ND	<1.0	<1.0	<1.0	3.7	<1.0	<1.0	<2.0	<2.0
8/7/2006	<0.20	<0.20	ND	ND	<0.50	<0.50	<0.50	19	<0.20	0.37	<0.40	<0.50
10/31/2006	<0.20	<0.20	ND	ND	<0.50	<0.50	<0.50	16	0.26	0.26	<0.40	<0.50
6/19/2007	4.6	5.7	ND	ND	<0.50	<0.50	<0.50	2.9	<0.20	<0.20	<0.40	<0.50
11/24/2008	1.9	3.2	0.86	<i>0.33</i>	<0.50	<0.50	<0.50	<i>0.86</i>	<0.50	<0.20	<0.40	<0.50
2/12/2009	1.5	2.6	0.61	<0.30	<0.50	<0.50	<0.50	<i>0.89</i>	<0.50	<0.20	<0.40	<0.50
5/8/2009	1.2	<i>1.7</i>	0.54	<0.30	<0.50	<0.50	<0.50	<i>1.0</i>	<0.40	<0.20	<0.40	<0.50
8/31/2009	<0.20	<0.20	<0.20	<0.30	<0.50	<0.50	<0.50	<i>0.70</i>	<0.50	<0.20	<0.40	<0.50
12/1/2009	<0.20	<0.20	<0.20	<0.30	<0.50	<0.50	<0.50	<i>1.1</i>	<0.50	<0.20	<0.40	<0.50
2/22/2010	<0.20	<0.20	<0.20	<0.30	<0.50	<0.50	<0.50	<i>0.75</i>	<0.50	<0.20	<0.40	<0.50
9/20/2010	<0.20	0.29	<0.20	<0.30	<0.50	<0.50	<0.50	<i>1.0</i>	<0.50	<0.20	<0.40	<0.50
12/15/2010	<0.20	<0.20	<0.20	<0.30	<0.50	<0.50	<0.50	<i>1.4</i>	<0.50	<0.20	<0.40	<0.50
3/18/2011	<0.20	0.22	<0.20	<0.30	<0.50	<0.50	<0.50	<i>2.1</i>	<0.50	<0.20	<0.40	<0.50
6/30/2011	<0.20	<0.20	<0.20	<0.30	<0.50	<0.50	<0.50	<i>2.0</i>	<0.50	<0.20	<0.40	<0.50

Notes:

Sources for Wisconsin groundwater standards:

¹ - Wisconsin Administrative Code, Chapter NR140 Groundwater Enforcement Standards (ES)

² - Wisconsin Administrative Code, Chapter NR140 Groundwater Preventive Action Limits (PALs)

BOLD values exceed NR140 ES

values in *italics* exceed NR140 PAL

ND - No Detection above laboratory detection limit

Project #: CNEX-02-125A
 Dorprop, LLC - One Hour Cleaners
 1227 La Crosse Street
 La Crosse, Wisconsin

Table 16
 MW-12P Groundwater Analytical Results
 (concentrations are in µg/L)

Date	Bromodichloromethane	Chloroform	Chlorodibromomethane	cis-1,2-Dichloroethylene	trans-1,2-Dichloroethylene	Ethylbenzene	Tetrachloroethylene	Toluene	Trichloroethylene	Trimethylbenzenes, Combined	Xylenes, Total	Chloromethane	1,1-Dichloropropene
NR140 ES ¹	0.6	6	60	70	100	700	5	1,000	5	480	10,000	3	NS
NR 140 PAL ²	0.06	0.6	6	7	20	140	0.5	200	0.5	96	1,000	0.3	NS
1/23/2004	<1.0	<1.0	ND	<1.0	<1.0	<1.0	<2.0	5.8	<1.0	<2.0	<2.0	ND	ND
5/28/2004	<1.0	<1.0	ND	<1.0	<1.0	<1.0	<2.0	<1.0	<1.0	<2.0	<2.0	ND	ND
8/7/2006	<0.20	<0.20	ND	<0.50	<0.50	<0.50	0.57	0.20	<0.20	<0.40	<0.50	ND	ND
10/31/2006	<0.20	<0.20	ND	<0.50	<0.50	<0.50	<0.50	<0.2	<0.20	<0.40	<0.50	ND	ND
6/19/2007	0.96	<i>1.1</i>	ND	<0.50	<0.50	<0.50	<0.50	<0.20	<0.20	<0.40	<0.50	ND	ND
11/24/2008	4.7	8.0	0.66	<0.50	<0.50	<0.50	0.69	<0.50	<0.20	<0.40	<0.50	ND	ND
2/12/2009	1.3	1.9	<0.20	<0.50	<0.50	<0.50	7.7	<0.50	0.53	<0.40	<0.50	ND	ND
5/8/2009	<i>0.28</i>	0.42	<0.20	0.53	<0.50	<0.50	16	<0.50	0.82	<0.40	<0.50	ND	ND
8/31/2009	<0.20	0.30	<0.20	<0.50	<0.50	<0.50	17	<0.50	0.78	<0.40	<0.50	ND	ND
12/1/2009	<0.20	<0.20	<0.20	<0.50	<0.50	<0.50	17	<0.50	1.0	<0.40	<0.50	ND	ND
2/22/2010	<0.20	<0.20	<0.20	<0.50	<0.50	<0.50	9.2	<0.50	0.72	<0.40	<0.50	ND	ND
9/20/2010	<0.20	<0.20	<0.20	<0.50	<0.50	<0.50	1.6	<0.50	0.32	<0.40	<0.50	ND	ND
12/15/2010	<0.20	<0.20	<0.20	<0.50	<0.50	<0.50	1.6	<0.50	<0.20	<0.40	<0.50	ND	ND
3/18/2011	<0.20	<0.20	<0.20	<0.50	<0.50	<0.50	2.4	<0.50	0.26	<0.40	<0.50	ND	ND
6/30/2011	<0.20	<0.20	<0.20	<0.50	<0.50	<0.50	1.8	<0.50	0.22	<0.40	<0.50	0.66	3.8

Notes:

Sources for Wisconsin groundwater standards:

¹ - Wisconsin Administrative Code, Chapter NR140 Groundwater Enforcement Standards (ES)

² - Wisconsin Administrative Code, Chapter NR140 Groundwater Preventive Action Limits (PALs)

BOLD values exceed NR140 ES

values in *italics* exceed NR140 PAL

ND - No Detection above laboratory detection limit

NS - No Standard established

Project #: CNEX-02-125A
 Dorprop, LLC - One Hour Cleaners
 1227 La Crosse Street
 La Crosse, Wisconsin

Table 17
 MW-13 Groundwater Analytical Results
 (concentrations are in µg/L)

Date	Bromochloroethane	Chloroform	cis-1,2-Dichloroethylene	trans-1,2-Dichloroethylene	Ethylbenzene	Tetrachloroethylene	Toluene	Trichloroethylene	Triethylbenzenes, Combined	Vinyl Chloride	Xylenes, Total	Chloroethane	1,1-Dichloroethane	n-Butylbenzene	Naphthalene
NR140 ES ¹	0.6	6	70	100	700	5	1,000	5	480	0.2	10,000	400	850	NS	100
NR 140 PAL ²	0.06	0.6	7	20	140	0.5	200	0.5	96	0.02	1,000	80	85	NS	10
8/7/2006	<0.80	<0.80	<i>19</i>	<2.0	<2.0	200	<0.80	13	<1.60	<0.8	<2.0	ND	ND	ND	ND
11/1/2006	<0.20	<0.20	71	<0.50	<0.50	440	1.5	15	<0.40	1.2	0.66	ND	ND	ND	ND
6/19/2007	<1.6	<1.6	5.0	<4.0	<4.0	380	<1.6	6.4	<3.2	<1.6	<4.0	ND	ND	ND	ND
11/25/2008	<0.80	<0.80	7.7	<2.0	<2.0	410	<2.0	11	<1.6	<0.80	<2.0	ND	ND	ND	ND
2/12/2009	<0.20	<0.20	0.85	<0.50	<0.50	190	<0.50	5.4	<0.40	<0.20	<0.50	ND	ND	ND	ND
5/8/2009	<1.6	<1.6	<i>7.4</i>	<4.0	<4.0	540	<4.0	11	<3.2	<1.6	<4.0	ND	ND	ND	ND
8/27/2009	<0.20	<0.20	<i>1.3</i>	<0.50	<0.50	970	<0.50	7.6	<0.40	<0.20	<0.50	ND	ND	ND	ND
11/30/2009	<2.0	<2.0	<i>6.6</i>	<5.0	<5.0	370	<5.0	8.2	<4.0	<2.0	<5.0	ND	ND	ND	ND
2/23/2010	<1.0	<1.0	<2.5	9.0	<2.5	310	<2.5	5.6	<2.0	<1.0	<2.5	<i>120</i>	<i>160</i>	ND	ND
9/20/2010	<0.40	<0.40	2.6	<1.0	<1.0	250	<1.0	5.2	<0.80	<0.40	<1.0	<2.0	<1.0	ND	ND
12/15/2010	<0.80	<0.80	2.5	<2.0	<0.20	590	<0.20	8.7	<1.6	<0.80	<2.0	<4.0	<2.0	ND	ND
3/18/2011	<0.80	<0.80	2.5	<2.0	<0.20	610	<0.20	4.8	8.2	<0.80	<2.0	<4.0	<2.0	10	4.4
6/30/2011	<0.80	<0.80	<2.0	<2.0	<2.0	380	<2.0	5.7	<1.6	<0.80	<2.0	<4.0	<2.0	<0.80	<1.0

Notes:
 Sources for Wisconsin groundwater standards:
¹ - Wisconsin Administrative Code, Chapter NR140 Groundwater Enforcement Standards (ES)
² - Wisconsin Administrative Code, Chapter NR140 Groundwater Preventive Action Limits (PALs)
BOLD values exceed NR140 ES
 values in *italics* exceed NR140 PAL
 ND - No Detection above laboratory detection limit
 NS - No Standard established

Project #: CNEX-02-125A
 Dorprop, LLC - One Hour Cleaners
 1227 La Crosse Street
 La Crosse, Wisconsin

Table 18
 MW-14 Groundwater Analytical Results
 (concentrations are in µg/L)

Date	Bromodichloromethane	Chloroform	cis-1,2-Dichloroethylene	trans-1,2-Dichloroethylene	Ethylbenzene	Tetrachloroethylene	Toluene	Trichloroethylene	Trimethylbenzenes, Combined	Vinyl Chloride	Xylenes, Total	n-Butylbenzene	Naphthalene	Bromomethane	Chloromethane
NR140 ES ¹	0.6	6	70	100	700	5	1,000	5	480	0.2	10,000	NS	100	10	3
NR 140 PAL ²	0.06	0.6	7	20	140	0.5	200	0.5	96	0.02	1,000	NS	10	1	0.3
8/7/2006	<0.80	<0.80	3.5	<2.0	<2.0	1100	<0.80	11	<1.60	<0.8	<2.0	ND	ND	ND	ND
11/1/2006	<0.20	<0.20	<i>13</i>	<0.50	<0.50	81	<20	11	<0.40	0.35	<2.0	ND	ND	ND	ND
6/19/2007	<0.40	<0.40	4.2	<1.0	<1.0	390	<0.40	7.0	<0.80	<0.40	<1.0	ND	ND	ND	ND
11/25/2008	<4.0	<4.0	<10	<10	<10	1000	<10	15	<8.0	<4.0	<10	ND	ND	ND	ND
2/12/2009	<1.6	<1.6	<4.0	<4.0	<4.0	710	<4.0	6.6	<3.2	<1.6	<4.0	ND	ND	ND	ND
5/8/2009	<1.6	<1.6	<4.0	<4.0	<4.0	430	<4.0	5.9	<3.2	<1.6	<4.0	ND	ND	ND	ND
8/27/2009	<1.6	<1.6	<4.0	<4.0	<4.0	330	<4.0	5.6	<3.2	<1.6	<4.0	ND	ND	ND	ND
11/30/2009	<1.0	<1.0	<2.5	<2.5	<2.5	710	<2.5	5.2	<2.0	<1.0	<2.5	ND	ND	ND	ND
2/23/2010	<2.0	<2.0	<5.0	<5.0	<5.0	700	<5.0	3.8	<4.0	<2.0	<5.0	ND	ND	ND	ND
9/20/2010	<0.80	<0.80	2.1	<2.0	<2.0	510	<5.0	6.9	<1.6	<0.80	<2.0	ND	ND	ND	ND
12/15/2010	<1.6	<1.6	<4.0	<4.0	<4.0	340	<4.0	5.2	<3.2	<1.6	<4.0	ND	ND	ND	ND
3/18/2011	<0.80	<0.80	2.0	<0.20	<0.20	320	<0.20	4.4	0.96	<0.80	<0.20	1.1	1.1	ND	ND
6/30/2011	<1.0	<1.0	<i>7.0</i>	<2.5	<2.5	550	<2.5	9.5	<2.0	<1.0	<2.5	<1.0	1.3	<i>4.2</i>	3.4

Notes:
 Sources for Wisconsin groundwater standards:
¹ - Wisconsin Administrative Code, Chapter NR140 Groundwater Enforcement Standards (ES)
² - Wisconsin Administrative Code, Chapter NR140 Groundwater Preventive Action Limits (PALs)
BOLD values exceed NR140 ES
 values in *italics* exceed NR140 PAL
 ND - No Detection above laboratory detection limit
 NS - No Standard established

Project #: CNEX-02-125A
 Dorprop, LLC - One Hour Cleaners
 1227 La Crosse Street
 La Crosse, Wisconsin

Table 19
 MW-15 Groundwater Analytical Results
 (concentrations are in µg/L)

Date	Bromodichloromethane	Chloroform	cis-1,2-Dichloroethylene	trans-1,2-Dichloroethylene	Ethylbenzene	Tetrachloroethylene	Toluene	Trichloroethylene	Trimethylbenzenes, Combined	Xylenes, Total	n-Butylbenzene	Chloromethane
NR140 ES ¹	0.6	6	70	100	700	5	1,000	5	480	10,000	NS	3
NR 140 PAL ²	0.06	0.6	7	20	140	0.5	200	0.5	96	1,000	NS	0.3
8/7/2006	<0.80	<0.80	<i>8.6</i>	<2.0	<2.0	290	<0.80	5.2	<1.60	<2.0	ND	ND
11/1/2006	<0.40	<0.40	<i>11</i>	<1.0	<1.0	170	<0.40	7.1	<0.80	<1.0	ND	ND
6/19/2007	<0.40	<0.40	<i>10</i>	<1.0	<1.0	380	<0.40	10	<0.80	<1.0	ND	ND
11/25/2008	<1.0	<1.0	<2.5	<2.5	<2.5	200	<2.5	<i>2.8</i>	<2.0	<2.5	ND	ND
2/12/2009	<2.0	<2.0	<5.0	<5.0	<5.0	590	<5.0	<i>2.8</i>	<4.0	<5.0	ND	ND
5/8/2009	<2.0	<2.0	<5.0	<5.0	<5.0	470	<5.0	<i>2.1</i>	<4.0	<5.0	ND	ND
8/31/2009	<2.0	<2.0	<5.0	<5.0	<5.0	380	<5.0	<2.0	<4.0	<5.0	ND	ND
11/30/2009	<0.40	<0.40	<1.0	<1.0	<1.0	240	<1.0	<i>2.2</i>	<0.80	<1.0	ND	ND
2/22/2010	<0.80	<0.80	<0.20	<2.0	<2.0	250	<2.0	<i>1.0</i>	<1.60	<2.0	ND	ND
9/20/2010	<0.80	<0.80	<0.20	<2.0	<2.0	270	<2.0	<i>1.6</i>	<1.60	<2.0	ND	ND
12/15/2010	<0.20	<0.20	<0.50	<0.50	<0.50	61	<0.50	<i>1.4</i>	<0.40	<0.50	ND	ND
3/18/2011	<0.40	<0.40	<1.0	<1.0	<1.0	400	<1.0	<i>1.0</i>	<0.80	<1.0	0.40	ND
6/30/2011	<1.6	<1.6	<4.0	<4.0	<4.0	500	<4.0	<i>2.0</i>	<3.2	<4.0	<1.6	5.9

Notes:

Sources for Wisconsin groundwater standards:

¹ - Wisconsin Administrative Code, Chapter NR140 Groundwater Enforcement Standards (ES)

² - Wisconsin Administrative Code, Chapter NR140 Groundwater Preventive Action Limits (PALs)

BOLD values exceed NR140 ES

values in *italics* exceed NR140 PAL

ND - No Detection above laboratory detection limit

NS - No Standard established

Project #: CNEX-02-125A
 Dorprop, LLC - One Hour Cleaners
 1227 La Crosse Street
 La Crosse, Wisconsin

Table 20
 MW-16 Groundwater Analytical Results
 (concentrations are in µg/L)

Date	Bromodichloromethane	Chloroform	cis-1,2-Dichloroethylene	trans-1,2-Dichloroethylene	Ethylbenzene	Tetrachloroethylene	Toluene	1,1,2-Trichloroethane	Trichloroethylene	Trimethylbenzenes, Combined	Xylenes, Total	Naphthalene	Chloroethane
NR140 ES ¹	0.6	6	70	100	700	5	1,000	200	5	480	10,000	100	3
NR 140 PAL ²	0.06	0.6	7	20	140	0.5	200	40	0.5	96	1,000	10	0.3
8/4/2006	<0.80	<0.80	<2.0	<2.0	<2.0	300	<0.80	2.8	<0.80	<1.60	<2.0	ND	ND
11/1/2006	<0.40	<0.40	3.8	<1.0	<1.0	200	<0.40	<0.50	<i>1.5</i>	<0.80	<1.0	ND	ND
6/19/2007	<0.80	<0.80	<2.0	<2.0	<2.0	400	<0.80	<1.0	<0.80	<1.6	<2.0	ND	ND
11/24/2008	<1.0	<1.0	<2.5	<2.5	<2.5	360	<2.5	<1.2	<1.0	<2.0	<2.5	ND	ND
2/12/2009	<0.40	<0.40	1.4	<1.0	<1.0	130	<1.0	<0.50	<i>1.9</i>	<0.80	<1.0	0.66	ND
5/8/2009	<0.80	<0.80	<2.0	<2.0	<2.0	220	<2.0	<2.0	2.2	<1.6	<2.0	<1.0	ND
8/31/2009	<0.80	<0.80	<2.0	<2.0	<2.0	280	<2.0	<1.0	<0.80	<1.6	<2.0	<1.0	ND
11/30/2009	<1.0	<1.0	<2.5	<2.5	<2.5	290	<2.5	<1.2	<1.0	<2.0	<2.5	<1.2	ND
2/23/2010	<1.0	<1.0	<2.5	<2.5	<2.5	270	<2.5	<1.2	<1.0	<2.0	<2.5	<1.2	ND
9/20/2010	<0.40	<0.40	<1.0	<1.0	<1.0	130	<1.0	<1.0	<0.40	<0.80	<1.0	<0.50	ND
12/15/2010	<0.40	<0.40	<1.0	<1.0	<1.0	110	<1.0	<1.0	<0.40	<0.80	<1.0	<0.50	ND
3/18/2011	<0.20	<0.20	<0.50	<0.50	<0.50	48	<0.50	<0.50	<0.20	<0.40	<0.50	<0.25	ND
6/30/2011	<0.20	<0.20	<0.50	<0.50	<0.50	32	<0.50	<0.25	<0.20	<0.40	<0.50	<0.25	<i>0.51</i>

Notes:

Sources for Wisconsin groundwater standards:

¹ - Wisconsin Administrative Code, Chapter NR140 Groundwater Enforcement Standards (ES)

² - Wisconsin Administrative Code, Chapter NR140 Groundwater Preventive Action Limits (PALs)

BOLD values exceed NR140 ES

values in *italics* exceed NR140 PAL.

ND - No Detection above laboratory detection limit

Project #: CNEX-02-125A
 Dorprop, LLC - One Hour Cleaners
 1227 La Crosse Street
 La Crosse, Wisconsin

Table 21
 MW-16P Groundwater Analytical Results
 (concentrations are in µg/L)

Date	Bromodichloromethane	Chloroform	Chloromethane	cis-1,2-Dichloroethylene	trans-1,2-Dichloroethylene	Ethylbenzene	Naphthalene	Tetrachloroethylene	Toluene	Trichloroethylene	Trimethylbenzenes, Combined	Xylenes, Total
NR140 ES ¹	0.6	6	3	70	100	700	40	5	1,000	5	480	10,000
NR 140 PAL ²	0.06	0.6	0.3	7	20	140	8	0.5	200	0.5	96	1,000
8/4/2006	<0.20	<0.20	<i>0.54</i>	<0.20	<0.20	0.50	0.28	8.5	1.2	0.30	<2.30	0.64
11/1/2006	<0.20	<0.20	<0.20	<0.50	<0.50	<0.50	<0.25	4.7	<0.20	0.40	<0.40	<0.50
6/19/2007	<0.20	<0.20	<0.20	<0.50	<0.50	<0.50	<0.25	1.2	<0.20	<0.20	<0.40	<0.50
11/24/2008	<0.20	<0.20	<0.30	<0.50	<0.50	<0.50	<0.25	4.1	<0.50	<0.20	<0.40	<0.50
2/12/2008	<0.20	<0.20	<0.30	<0.50	<0.50	<0.50	<0.25	2.4	<0.50	0.20	<0.40	<0.50
5/8/2009	<0.20	<0.20	<0.30	<0.50	<0.50	<0.50	<0.25	1.3	<0.50	0.32	<0.40	<0.50
8/31/2009	<0.20	<0.20	<0.30	<0.50	<0.50	<0.50	<0.25	<i>0.99</i>	<0.50	<0.20	<0.40	<0.50
11/30/2009	<0.20	<0.20	<0.30	<0.50	<0.50	<0.50	<0.25	<0.50	<0.50	<0.20	<0.40	<0.50
2/23/2010	<0.20	<0.20	<0.30	<0.50	<0.50	<0.50	<0.25	<0.50	<0.50	<0.20	<0.40	<0.50
9/20/2010	<0.20	<0.20	<0.30	<0.50	<0.50	<0.50	<0.25	<0.50	<0.50	<0.20	<0.40	<0.50
12/15/2010	<0.20	<0.20	<0.30	<0.50	<0.50	<0.50	<0.25	<0.50	<0.50	<0.20	<0.40	<0.50
3/18/2011	<0.20	<0.20	<0.30	<0.50	<0.50	<0.50	<0.25	<0.50	<0.50	<0.20	<0.40	<0.50
6/30/2011	<0.20	<0.20	<i>0.63</i>	<0.50	<0.50	<0.50	<0.25	<0.50	<0.50	<0.20	<0.40	<0.50

Notes:

Sources for Wisconsin groundwater standards:

¹ - Wisconsin Administrative Code, Chapter NR140 Groundwater Enforcement Standards (ES)

² - Wisconsin Administrative Code, Chapter NR140 Groundwater Preventive Action Limits (PALs)

BOLD values exceed NR140 ES

values in *italics* exceed NR140 PAL

Project #: CNEX-02-125A
 Dorprop, LLC - One Hour Cleaners
 1227 La Crosse Street
 La Crosse, Wisconsin

Remediation by Natural Attenuation (RNA) Results - December 2002

VOC Compounds (µg/L)	MW-4	MW-5	MW-6	MW-6P	MW-7	MW-8	MW-9	MW-10	MW-11	MW-11P
cis-1,2-Dichloroethylene	<1.0	<1.0	2.8	<1.0	<1.0	<1.0	<1.0	<1.0	<1.0	<1.0
Tetrachloroethylene	110	400	920	3.1	<2.0	<2.0	<2.0	43	11	<2.0
Trichloroethylene	1.1	4.2	7.7	<1.0	<1.0	<1.0	<1.0	<1.0	<1.0	<1.0
RNA Laboratory Parameters (mg/L)										
Alkalinity	320	380	540	200	320	620	260	330	820	200
Chloride	44	31	35	34	160	56	76	37	100	36
Sulfate	5.8	10	28	<5.0	27	22	24	5.3	17	<5.0
Nitrate/Nitrite	0.15	4.3	3.4	<0.10	6.2	5.4	3.1	0.22	2.0	<0.02
Iron, total	20	15	130	0.16	26	48	8	55	10	0.21
Iron, dissolved	<0.035	<0.035	<0.035	0.036	<0.035	<0.035	<0.035	0.98	<0.035	0.15
Total Organic Carbon	7.1	7.7	16	5.7	3.0	3.1	2.3	14	2.6	6.1
RNA Field Parameters										
Temperature (°C)	10.4	10.50	10.6	10.8	10.4	10.5	10.6	10.5	10.6	10.7
Conductivity (µs/cm)	NM	NM	NM	NM	819	759	872	NM	1537	1316
Dissolved Oxygen (mg/L)	1.29	1.37	1.20	1.13	1.95	1.87	2.02	1.48	1.59	1.33
Redox Potential (mV)	-7	12	-41	-20	41	37	65	17	11	22
pH (units)	7.54	7.34	7.80	9.11	6.88	7.02	6.93	7.86	6.97	6.85

Notes:
 NM - Not measured

Project #: CNEX-02-125A
 Dorprop, LLC - One Hour Cleaners
 1227 La Crosse Street
 La Crosse, Wisconsin

Push Probe Groundwater Analytical Results - November 4, 2008

PARAMETER (µg/L):	GP-4 48'	GP-4 73'	GP-5 48'	GP-5 73'	GP-6 48'	GP-6 73'	GP-7 48'	GP-7 73'	NR140 ES ¹	NR 140 PAL ²
Benzene	<0.20	<0.20	<0.20	<0.20	<0.20	<0.20	0.22	0.45	5	0.5
Bromodichloromethane	<0.20	<0.20	<0.20	<0.20	<0.20	<0.20	<0.20	<0.20	0.6	0.06
Chloroform	<0.20	<0.20	<i>3.0</i>	<i>5.4</i>	<0.20	<0.20	<0.20	<0.20	6	0.6
cis-1,2-Dichloroethylene	<0.50	<0.50	<0.50	<0.50	<0.50	<0.50	<0.50	<0.50	70	7
trans-1,2-Dichloroethylene	<0.50	<0.50	<0.50	<0.50	<0.50	<0.50	<0.50	<0.50	100	20
Ethylbenzene	<0.50	<0.50	<0.50	<0.50	<0.50	<0.50	<0.50	0.57	700	140
Naphthalene	<0.25	<0.25	<0.25	<0.25	<0.25	<0.25	<0.25	<0.25	100	10
Tetrachloroethylene	<i>0.51</i>	<0.50	<0.50	<i>0.58</i>	<0.50	<0.50	<i>2.4</i>	<i>1.6</i>	5	0.5
Toluene	<0.50	<0.50	<0.50	<0.50	<0.50	0.66	0.95	1.2	1,000	200
Trichloroethylene	<0.20	<0.20	<0.20	<0.20	<0.20	<0.20	<0.20	<0.20	5	0.5
Trimethylbenzenes, Combined	<0.40	<0.40	<0.40	<0.40	<0.40	<0.40	<0.40	<0.40	480	96
Xylenes, Total	<0.50	<0.50	<0.50	<0.50	0.99	0.55	0.50	0.88	10,000	1,000

Notes:

Sources for Wisconsin groundwater standards:

¹ - Wisconsin Administrative Code, Chapter NR140 Groundwater Enforcement Standards (ES)

² - Wisconsin Administrative Code, Chapter NR140 Groundwater Preventive Action Limits (PALs)

BOLD values exceed NR140 ES

values in *italics* exceed NR140 PAL

NS - No Wisconsin Groundwater Standards have been established

Project #: CNEX-02-125A
Dorprop, LLC - One Hour Cleaners
1227 La Crosse Street
La Crosse, Wisconsin

Table 1 (Page 1 of 2)
Groundwater Elevation Data (elevations in feet)

Location	Top of Riser Elevation	7/23/2001	9/11/2001	8/16/2002	12/2/2002	1/23/2004	5/28/2004	8/4/2006	10/31/2006	6/19/2007	11/24/2008
MW-1	674.93	631.62	629.58	---	---	---	---	---	---	---	---
MW-2	673.97	631.69	629.67	---	---	---	---	---	---	---	---
MW-3	672.63	631.58	629.53	---	---	---	---	---	---	---	---
MW-4	673.07	632.48	630.84	630.95	632.19	630.68	632.81	630.29	629.80	631.00	632.20
MW-5	672.73	632.44	630.81	630.91	632.16	630.65	632.78	630.28	629.79	630.98	632.17
MW-6	673.67	632.50	630.92	630.96	632.22	630.68	632.85	630.31	629.84	631.11	632.20
MW-6P	673.60	---	---	630.97	632.22	630.70	632.91	630.27	629.85	630.97	632.22
MW-7	671.61	629.59	627.73	629.66	631.15	---	---	---	---	---	---
MW-8	671.76	630.04	628.15	629.86	631.28	---	---	---	---	---	---
MW-9	671.45	625.96	624.18	627.28	629.17	---	---	---	---	---	---
MW-10	673.02	---	---	630.93	632.17	630.65	632.84	630.25	629.85	631.05	632.20
MW-11	672.90	---	---	631.02	632.36	630.69	632.80	630.24	629.77	630.95	632.27
MW-11P	672.78	---	---	630.88	632.15	630.70	632.84	630.17	629.78	630.95	632.29
MW-12	673.41	---	---	---	---	630.51	632.27	---	629.70	630.81	632.08
MW-12P	673.19	---	---	---	---	630.52	632.28	---	629.70	630.82	632.06
MW-13	673.00	---	---	---	---	---	---	630.27	629.81	631.01	632.19
MW-14	673.15	---	---	---	---	---	---	630.29	629.81	631.01	632.18
MW-15	672.98	---	---	---	---	---	---	630.29	629.81	631.02	632.21
MW-16	672.97	---	---	---	---	---	---	630.27	629.79	630.97	632.22
MW-16P	673.05	---	---	---	---	---	---	630.21	629.80	630.96	632.20

Project #: CNEX-02-125A
Dorprop, LLC - One Hour Cleaners
1227 La Crosse Street
La Crosse, Wisconsin

Table 1 (Page 2 of 2)
Groundwater Elevation Data (elevations in feet)

Location	Top of Riser Elevation	2/10/2009	5/8/2009	8/27/2009	11/23/2009	2/22/2010	9/20/2010	12/15/2010	3/18/2011	6/30/2011
MW-1	674.93	---	---	---	---	---	---	---	---	---
MW-2	673.97	---	---	---	---	---	---	---	---	---
MW-3	672.63	---	---	---	---	---	---	---	---	---
MW-4	673.07	632.68	633.35	630.99	632.11	632.34	633.63	634.77	634.22	635.37
MW-5	672.73	632.65	633.30	631.02	632.08	632.31	633.60	634.73	634.19	635.30
MW-6	673.67	632.69	633.36	631.05	632.13	632.34	633.63	634.78	634.24	635.38
MW-6P	673.60	632.71	633.38	631.03	632.13	632.35	633.64	634.76	634.24	635.34
MW-7	671.61	---	---	---	---	---	---	---	---	---
MW-8	671.76	---	---	---	---	---	---	---	---	---
MW-9	671.45	---	---	---	---	---	---	---	---	---
MW-10	673.02	632.69	633.38	631.07	632.14	632.35	633.65	634.77	634.23	635.35
MW-11	672.90	632.76	633.39	631.05	632.15	632.39	633.66	634.81	634.25	635.33
MW-11P	672.78	632.77	633.39	631.02	632.16	632.39	633.64	634.81	634.26	635.33
MW-12	673.41	632.45	633.03	630.80	631.81	632.08	633.21	634.49	633.89	635.02
MW-12P	673.19	632.46	633.04	630.81	631.85	632.10	633.24	634.31	633.91	635.03
MW-13	673.00	632.68	633.36	631.08	632.11	632.33	633.63	634.76	634.21	635.36
MW-14	673.15	632.65	633.34	631.00	632.11	632.33	633.62	634.74	634.21	635.33
MW-15	672.98	632.69	633.36	631.05	632.13	632.35	633.64	634.77	634.22	635.35
MW-16	672.97	632.70	633.34	631.03	632.11	632.35	633.62	634.76	634.19	635.32
MW-16P	673.05	632.62	633.32	630.98	632.10	632.34	633.57	634.75	634.14	635.28

Impacted Off-Source Property Information

Form 4400-246 (R 3/08)

This fillable form is intended to provide a list of information that must be submitted for evaluation for case closure. It is to be used in conjunction with Form 4400-202, Case Closure Request (Section H). The closure of a case means that the Department has determined that no further response is required at that time based on the information that has been submitted to the Department.

NOTICE: Completion of this form is mandatory for applications for case closure pursuant to ch. 292, Wis. Stats. and ch. NR 726, Wis. Adm. Code, including cases closed under ch. NR 746 and ch. NR 726. The Department will not consider, or act upon your application, unless all applicable sections are completed on this form and the closure fee and any other applicable fees, required under ch. NR 749, Wis. Adm. Code, Table 1 are included. It is not the Department's intention to use any personally identifiable information from this form for any purpose other than reviewing closure requests and determining the need for additional response action. The Department may provide this information to requesters as required by Wisconsin's Open Records law [ss. 19.31 - 19.39, Wis. Stats.].

BRRTS #:

ACTIVITY NAME:

ID	Off-Source Property Address	Parcel Number	WTM X	WTM Y
<input type="text" value="A"/>	<input type="text" value="1228 La Crosse ST"/>	<input type="text" value="17-20140-80"/>	<input type="text" value="420418"/>	<input type="text" value="372325"/>
<input type="text" value="B"/>	<input type="text" value="1234 La Crosse ST"/>	<input type="text" value="17-20140-70"/>	<input type="text" value="420432"/>	<input type="text" value="372326"/>
<input type="text" value="C"/>	<input type="text" value="1240 La Crosse ST"/>	<input type="text" value="17-20140-65"/>	<input type="text" value="420447"/>	<input type="text" value="372332"/>
<input type="text" value="D"/>	<input type="text" value="1242 La Crosse ST"/>	<input type="text" value="17-20140-60"/>	<input type="text" value="420456"/>	<input type="text" value="372333"/>
<input type="text" value="E"/>	<input type="text" value="1246 La Crosse ST"/>	<input type="text" value="17-20140-50"/>	<input type="text" value="420469"/>	<input type="text" value="372335"/>
<input type="text" value="F"/>	<input type="text" value="1224 La Crosse ST"/>	<input type="text" value="17-20140-100"/>	<input type="text" value="420400"/>	<input type="text" value="372322"/>
<input type="text" value="G"/>	<input type="text"/>	<input type="text"/>	<input type="text"/>	<input type="text"/>
<input type="text" value="H"/>	<input type="text"/>	<input type="text"/>	<input type="text"/>	<input type="text"/>
<input type="text" value="I"/>	<input type="text"/>	<input type="text"/>	<input type="text"/>	<input type="text"/>

One Hour Cleaners La Crosse ST
02-32-279690

RE: Impacted Off-Source Property Letters and Deeds

Due to the amount of off-source letters and deeds the file size became too large to include them on the GIS Registry.

These documents are in the case file and can be reviewed by contacting the Project Manager.

April 13, 2005

Project No. CNEX-02-125A

City of La Crosse
City Clerk
400 La Crosse Street
La Crosse, Wisconsin 54601

Re: Notification of Residual Impacted Groundwater in the Right-of-way of La Crosse Street, La Crosse, Wisconsin (One Hour Cleaners - La Crosse Street Site, 1227 La Crosse Street, La Crosse, Wisconsin, WDNR BRRTS #02-32-279690).

As required by Wisconsin Administrative Code NR 726 this letter is to notify the City of La Crosse of groundwater NR-140 enforcement standard (ES) exceedances in the right-of-way of La Crosse Street (adjacent to the One Hour Cleaners - La Crosse Street site, 1227 La Crosse Street, La Crosse, Wisconsin). Remedial activities up-gradient of the city right-of-way (completed for the One Hour Cleaners - La Crosse Street site) indicated petroleum constituent concentrations exceeded ESs in some groundwater samples collected. Figure 1 indicates the locations (MW-4 and MW-5) of groundwater samples collected up-gradient of the city right-of-way, which contained tetrachloroethylene constituent concentrations greater than the ESs.

Please contact the Wisconsin Department of Natural Resources at 715.839.1603 or Braun Intertec Corporation at 608.781.7277 if you have questions regarding this notice.

Sincerely,

BRAUN INTERTEC CORPORATION



Mark Gretebeck
Senior Environmental Scientist/Project Manager

c: Mr. Richard Miletto, Dorprop, LLC

April 13, 2005

Project No. CNEX-02-125A

City of La Crosse
Department of Public Works
400 La Crosse Street
La Crosse, Wisconsin 54601

Re: Notification of Residual Impacted Groundwater in the Right-of-way of La Crosse Street, La Crosse, Wisconsin (One Hour Cleaners - La Crosse Street Site, 1227 La Crosse Street, La Crosse, Wisconsin, WDNR BRRS #02-32-279690).

As required by Wisconsin Administrative Code NR 726 this letter is to notify the City of La Crosse of groundwater NR-140 enforcement standard (ES) exceedances in the right-of-way of La Crosse Street (adjacent to the One Hour Cleaners - La Crosse Street site, 1227 La Crosse Street, La Crosse, Wisconsin). Remedial activities up-gradient of the city right-of-way (completed for the One Hour Cleaners - La Crosse Street site) indicated petroleum constituent concentrations exceeded ESs in some groundwater samples collected. Figure 1 indicates the locations (MW-4 and MW-5) of groundwater samples collected up-gradient of the city right-of-way, which contained tetrachloroethylene constituent concentrations greater than the ESs.

Please contact the Wisconsin Department of Natural Resources at 715.839.1603 or Braun Intertec Corporation at 608.781.7277 if you have questions regarding this notice.

Sincerely,

BRAUN INTERTEC CORPORATION

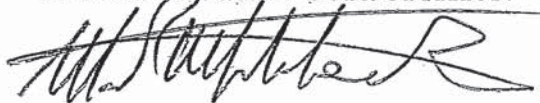

Mark Gretebeck
Senior Environmental Scientist/Project Manager

c: Mr. Richard Miletto, Dorprop, LLC