

State of Wisconsin \ DEPARTMENT OF NATURAL RESOURCES

Jim Doyle, Governor
Matthew J. Frank, Secretary
Scott Humrickhouse, Regional Director

West Central Region Headquarters
1300 W. Clairemont Avenue
PO Box 4001
Eau Claire, Wisconsin 54702-4001
Telephone 715-839-3700
FAX 715-839-6076
TTY Access via relay - 711

December 2, 2008

Alan L. Balliett
Environmental Branch Chief
Fort McCoy
2171 South 8th Avenue
Fort McCoy, WI 54656

Subject: Acknowledgment of Well Abandonment
Fort McCoy LF#7, Fort McCoy, Sparta, WI
WDNR BRRTS Activity #02-42-279996
License No. 4223 (Inactive)

Dear Mr. Balliett:

On April 12, 2007, the Department issued a "Remedial Action Closure with Land Use Limitations or Conditions and Transfer of Case to Waste and Materials Management Program." On January 16, 2008, the Department issued a letter rescinding the transfer of the case to the Waste and Materials Management Program and requesting that site wells be abandoned.

On November 25, 2008, the Department received correspondence indicating that monitoring wells OW-144 (DNR ID #130) and OW-146 (DNR ID #134) have been properly abandoned. As stated in the Department's April 12, 2007 letter, monitoring well OW-145 (DNR ID #132) is currently being utilized as an upgradient monitoring well at Fire Training Burn Pit #1, an adjacent remediation site; therefore, OW-145 was retained for that purpose. Based on the correspondence and data provided, the Department considers this case closed and no further investigation or remediation is required at this time. The land use limitations or conditions outlined in the Department's April 12, 2007, Remedial Action Closure letter remain in effect.

The Department appreciates your efforts to restore the environment at this site. If you have any questions regarding anything outlined in this letter, please contact me at (715) 839-3748 or via e-mail at mae.willkom@wisconsin.gov.

Sincerely,

Mae E. Willkom
Hydrogeologist
Remediation and Redevelopment Program

Cc Richard Lyster, P. G., MSA Professional Services, Inc., 1230 South Blvd., Baraboo, WI 53913
Larry Emerson, KEMRON Environmental Services, Inc., 1355 Blackhawk Drive, Bldg. 379, Suite 17, Fort Sheridan, IL 60037-1289



State of Wisconsin \ DEPARTMENT OF NATURAL RESOURCES

Jim Doyle, Governor
Matthew J. Frank, Secretary
Scott Humrickhouse, Regional Director

West Central Region Headquarters
1300 W. Clairemont Avenue
PO Box 4001
Eau Claire, Wisconsin 54702-4001
Telephone 715-839-3700
FAX 715-839-6076
TTY Access via relay - 711

January 16, 2008

Alan L. Balliett
Environmental Branch Chief
Fort McCoy
2171 South 8th Avenue
Fort McCoy, WI 54656

Subject: Request for Well Abandonment
Fort McCoy LF#7, Fort McCoy, Sparta, WI
WDNR BRRTS Activity #02-42-279996
License No. 4223 (Inactive)

Dear Mr. Balliett:

On December 14, 2006, the West Central Region Closure Committee of the Department of Natural Resources (Department) Remediation and Redevelopment program reviewed the above referenced case for closure of the ongoing remedial action. On April 12, 2007, the Department issued a "Remedial Action Closure with Land Use Limitations or Conditions and Transfer of Case to Waste and Materials Management Program." The letter stated, in part, that "... the owner or operator of the solid waste site or facility must still abide by any conditions required by the Department's Waste and Materials Management program and/or the NR 500 rule series, Wis. Adm. Code, as long as any waste materials remain in place." The file was then transferred to the Department's Waste and Materials Management program. Since that time, new Department guidance has been issued clarifying programmatic responsibility for certain waste sites, and the decision to transfer the above case has been rescinded.

MONITORING WELL ABANDONMENT

The land use limitations or conditions outlined in the Department's April 12, 2007, letter remain in effect. However, the Department does not intend to require any specific conditions for monitoring and maintenance beyond those requirements. Therefore, monitoring wells OW-144 (DNR ID#130) and OW-146 (DNR ID#134) must be properly abandoned in compliance with ch. NR 141, Wis. Adm. Code. Documentation of well abandonment must be submitted to me on DNR Form 3300-005, found at <http://dnr.wi.gov/org/water/dwg/forms/3300005.pdf>.

PLEASE NOTE: As stated in the Department's April 12, 2007, letter, monitoring well OW-145 (DNR ID#132) is being utilized as an upgradient monitoring well at Fire Training Burn Pit #1, an adjacent remediation site to the west of Landfill #7. Monitoring well OW-145 should be retained for this purpose.

Please satisfy these requirements within 60 days of the date of this letter. If these requirements have not been met, your site will be reopened, and additional remedial actions may be necessary by you to eliminate the need for these requirements.

Mr. Alan L. Balliett
Fort McCoy Landfill #7
January 16, 2008
Page 2

The Department appreciates your efforts to restore the environment at this site. If you have any questions regarding anything outlined in this letter, please contact me at (715) 839-3748 or via e-mail at mae.willkom@wisconsin.gov.

Sincerely,



Mae E. Willkom
Hydrogeologist
Remediation and Redevelopment Program

Cc Ken Gradall, MSA Professional Services, Inc., 1230 South Blvd., Baraboo, WI 53913
Larry Emerson, KEMRON Environmental Services, Inc., 1355 Blackhawk Drive, Bldg. 379, Suite
17, Fort Sheridan, IL 60037-1289



State of Wisconsin \ DEPARTMENT OF NATURAL RESOURCES

Jim Doyle, Governor
Scott Hassett, Secretary
Scott Humrickhouse, Regional Director

West Central Region Headquarters
1300 W. Clairemont Avenue
PO Box 4001
Eau Claire, Wisconsin 54702-4001
Telephone 715-839-3700
FAX 715-839-6076
TTY Access via relay - 711

April 12, 2007

Alan L. Balliett
Environmental Branch Chief
Fort McCoy
2171 South 8th Avenue
Fort McCoy, WI 54656

SUBJECT: Remedial Action Closure with Land Use Limitations or Conditions
and Transfer of Case to Waste and Materials Management Program
Fort McCoy LF#7, Fort McCoy, Sparta, WI
WDNR BRRTS Activity #: 02-42-279996
License No. 4223 (Inactive)

Dear Mr. Balliett:

On December 14, 2006, the West Central Region Closure Committee of the Department of Natural Resources (Department) Remediation and Redevelopment program reviewed the above referenced case for closure of the ongoing remedial action. This committee reviews environmental remediation cases for compliance with state laws and standards to maintain consistency in the closure of remediation cases.

Based on the correspondence and data provided, it appears that your case meets the requirements of ch. NR 726 of the Wisconsin Administrative Code. The Department's Remediation and Redevelopment Program considers this remedial work complete and no further remedial investigation or remediation is required at this time. **This determination is the final step in returning regulatory oversight for monitoring and long-term care of a solid waste site or facility to the Department's Waste and Materials Management Program. You should understand that while a closure determination for the current investigation and remediation can be issued by the Department's Remediation and Redevelopment program, the owner or operator of the solid waste site or facility must still abide by any conditions required by the Department's Waste and Materials Management program and/or the NR 500 rule series, Wis. Adm. Code, as long as any waste materials remain in place.**

Please be aware that pursuant to s. 292.12 Wisconsin Statutes, compliance with the requirements of this letter is a responsibility to which the current property owner and any subsequent property owners must adhere. If these requirements are not followed or if additional information regarding site conditions indicates that contamination on or from the site poses a threat to public health, safety, welfare, or the environment, the Department may take enforcement action under s. 292.11 Wisconsin Statutes to ensure compliance with the specified requirements, limitations or other conditions related to the property or this case may be reopened pursuant to s. NR 726.09, Wis. Adm. Code. It is the Department's intent to conduct inspections in the future to ensure that the conditions included in this letter including compliance with referenced maintenance plans are met.

Pursuant to s. 292.12(2)(a), Wis. Stats., the soil cover that currently exists in the location shown on the attached map shall be maintained in compliance with the attached maintenance plan in order to minimize the infiltration of water and prevent additional groundwater contamination that would violate the groundwater quality standards in ch. NR 140, Wis. Adm. Code, and to prevent direct contact with residual waste that might otherwise pose a threat to human health.

The following activities are prohibited on any portion of the property where a soil cover is required as shown on the attached map, unless prior written approval has been obtained from the Wisconsin Department of Natural Resources: 1) removal of the existing barrier; 2) replacement with another barrier; 3) excavating or grading of the land surface; 4) filling on capped or paved areas; 5) plowing for agricultural cultivation; or 6) construction or placement of a building or other structure.

Any future redevelopment of this property will need to take into consideration the presence of waste materials and will require the Department to issue an exemption to build on a historic fill site, prior to the start of any construction activities. Please refer to our guidance document, "Development at Historic Fill Sites and Licensed Landfills," PUB-RR-683. Any soils or waste material that are removed and/or excavated as part of a redevelopment or other on-site activities need to be handled as waste and disposed of properly.

Your site will be listed on the DNR Remediation and Redevelopment GIS Registry of Closed Remediation Sites. Information that was submitted with your closure request application will be included on the GIS Registry. To review the sites on the GIS Registry web page, visit <http://dnr.wi.gov/org/aw/rr/gis/index.htm>. Because your property is listed on the GIS Registry due to remaining contamination, if you intend to construct or reconstruct a well, you will need prior Department approval in accordance with s. NR 812.09(4)(w), Wis. Adm. Code. To obtain approval, Form 3300-254 needs to be completed and submitted to the DNR Drinking and Groundwater program's regional water supply specialist. This form can be obtained on-line <http://www.dnr.state.wi.us/org/water/dwg/3300254.pdf> or at the web address listed above for the GIS Registry.

Your responsibilities for the long-term care of this solid waste site, based upon your ownership of the site, will remain intact. You will be required to conduct any monitoring and maintenance of the site deemed necessary by the Waste and Materials Management program. **It should be noted that Monitoring well OW-145 is being utilized as an upgradient monitoring well at Fire Training Burn Pit #1, an adjacent remediation site to the west of Landfill #7. In the event that monitoring at Landfill #7 is discontinued prior to closure of Fire Training Burn Pit #1, monitoring well OW-145 should be retained for this purpose.**

Brian Kalvelage will be the project manager for any remaining monitoring and long-term care that may be required under solid waste management rules, in accordance with the NR 500 rule series, Wis. Adm. Code. If you have any questions regarding future monitoring and long term care requirements, please contact Brian Kalvelage at (608) 785-9983.

Mr. Alan L. Balliett
Fort McCoy
April 12, 2007
Page 3

The Department appreciates your efforts to restore the environment at this site. If you have any questions regarding this closure decision or anything outlined in this letter, please contact Mae Willkom at (715) 839-3748.

Sincerely,

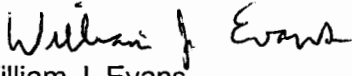

William J. Evans

West Central Remediation & Redevelopment Team Supervisor

cc: Ken Gradall, MSA Professional Services, Inc., 1230 South Blvd., Baraboo, WI 53913
Larry Emerson, KEMRON Environmental Services, Inc., 3155 Blackhawk Drive, Bldg.
379, Suite 17, Fort Sheridan, IL 60037-1289
Brian Kalvelage, WDNR, La Crosse (via e-mail)

CLOSED LANDFILL 7 MAINTENANCE PLAN

April 2, 2007

Property Located at: Fort McCoy, Sparta, WI

BRRTS # 02-42-279996

DNR FID#: 642024900

Introduction:

This document is the Maintenance Plan for a gravel cover at the above referenced property in accordance with the requirements of s. NR 724.13(2), Wisconsin Administrative Code. The maintenance activities relate to the gravel surface that completely covers Closed Landfill 7 and the underlying waste. The gravel surface is currently used for vehicle parking and staging of heavy equipment. The location of Closed Landfill 7, over which the gravel surface is to be maintained, is identified in the attached maps (Exhibit A).

Cover Purpose

The gravel surfaces over the waste serve as a barrier to prevent direct human contact with the waste that might otherwise pose a threat to human health. Based on the current and future use of the property, the barrier should function as intended unless disturbed.

Annual Inspection

The gravel surface overlying the waste will be inspected once a year, normally in the spring after all the snow and ice is gone, for disturbance or other potential problems that can cause exposure of underlying soils or waste. The inspections will be performed to evaluate damage due to settling, exposure to the weather and wear from traffic and other factors. Any area where soils or wastes have become or are likely to become exposed will be documented. A log of the inspections and any repairs will be maintained by the property owner and is included as Exhibit B, Cap Inspection Log. The log will include recommendations for necessary repair of any areas where underlying soils or waste are exposed. Once repairs are completed, they will be documented in the inspection log. A copy of the inspection log will be kept on file at the site's Owner/Operator address shown below and sent to the Wisconsin Department of Natural Resources (WDNR) upon request.

Maintenance Activities

If problems are noted during the annual inspections or at any other time during the year, repairs will be scheduled as soon as practical and funding will be sought to complete repairs. This plan is subject to the provisions of the Anti-Deficiency Act and repairs will be conducted as soon as funding is available. Repairs can include filling operations necessary as a result of the

aforementioned wear factors as well as any repairs due to unforeseen events such as a spill response. If necessary maintenance or response activities expose the underlying soil or waste, the owner must inform maintenance workers of the direct contact exposure hazard and provide them with appropriate personal protection equipment (PPE). The owner must also sample any soil that is excavated from the site prior to disposal to ascertain if contamination exists. The soil must be treated, stored and disposed of off-site by the owner in accordance with applicable local, state and federal law.

In the event the gravel surfaces overlying the waste are removed or replaced, any replacement barrier will be subject to the same maintenance and inspection guidelines as outlined in this Maintenance Plan unless indicated otherwise by the WDNR or its successor.

The property owner, in order to maintain the integrity of the gravel and soil surfaces, will maintain a copy of this Maintenance Plan on-site and make it available to all interested parties (i.e., on-site employees, contractors, future property owners, etc.) for viewing.

Amendment or Withdrawal of Maintenance Plan

This Maintenance Plan can be amended or withdrawn by the property owner and its successors with the written approval of WDNR.

Contact Information

April, 2007

Site Owner and Operator: Department of the Army
Alan Balliett, Chief, Environmental Branch
Directorate of Support Services
Attn: IMNW-MCY-SSP
2171 S. 8th Ave
Fort McCoy, WI 54656-5136
608-388-4776

Consultant: KEMRON Environmental Services, Inc.
Mr. Larry Emerson, P.E.
3155 Blackhawk Dr, Bldg 379, Suite 17
Fort Sheridan, IL 60037
847-266-1350

**Wisconsin Department of
Natural Resources:** Mae Willkom, Hydrogeologist
1300 West Clairemont Avenue
P.O. Box 4001
Eau Claire, WI 54702-4001
(715) 839-3748

Exhibits A and B

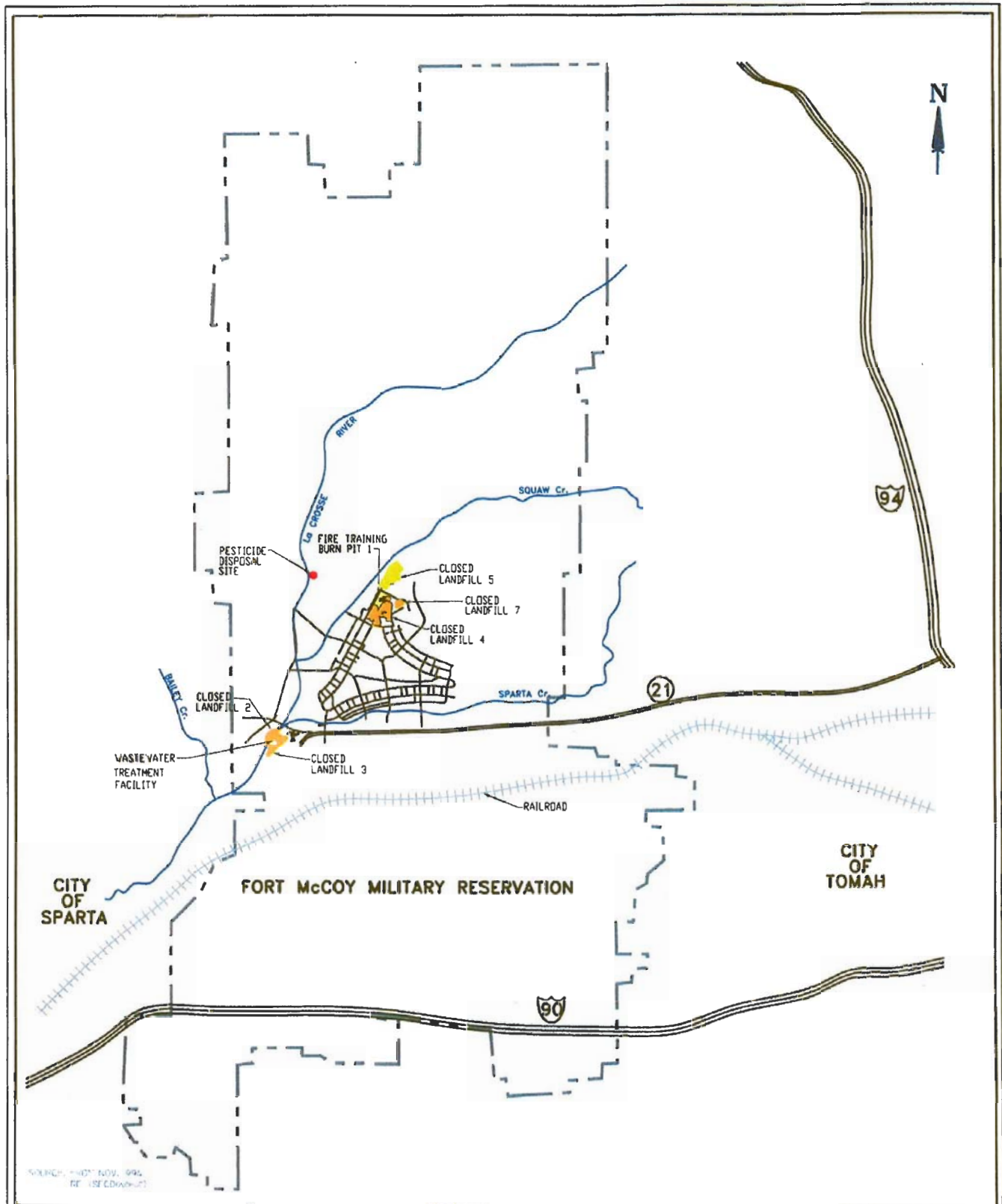

SOURCE: 11/07 NOV. 1995
 BY: JST/EDW/ST

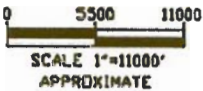

DRAWN BY:
 KG
 REVIEWED:
 APPROVED:

DATE
 10 SEPTEMBER 2004
 PROJECT NO.
 40031-AA-001
 DWG. FILE NO.
 SWMU LOC. MAP

FIGURE 2

GENERAL SITE
 FORT McCOY
 MONROE COUNTY, WISCONSIN

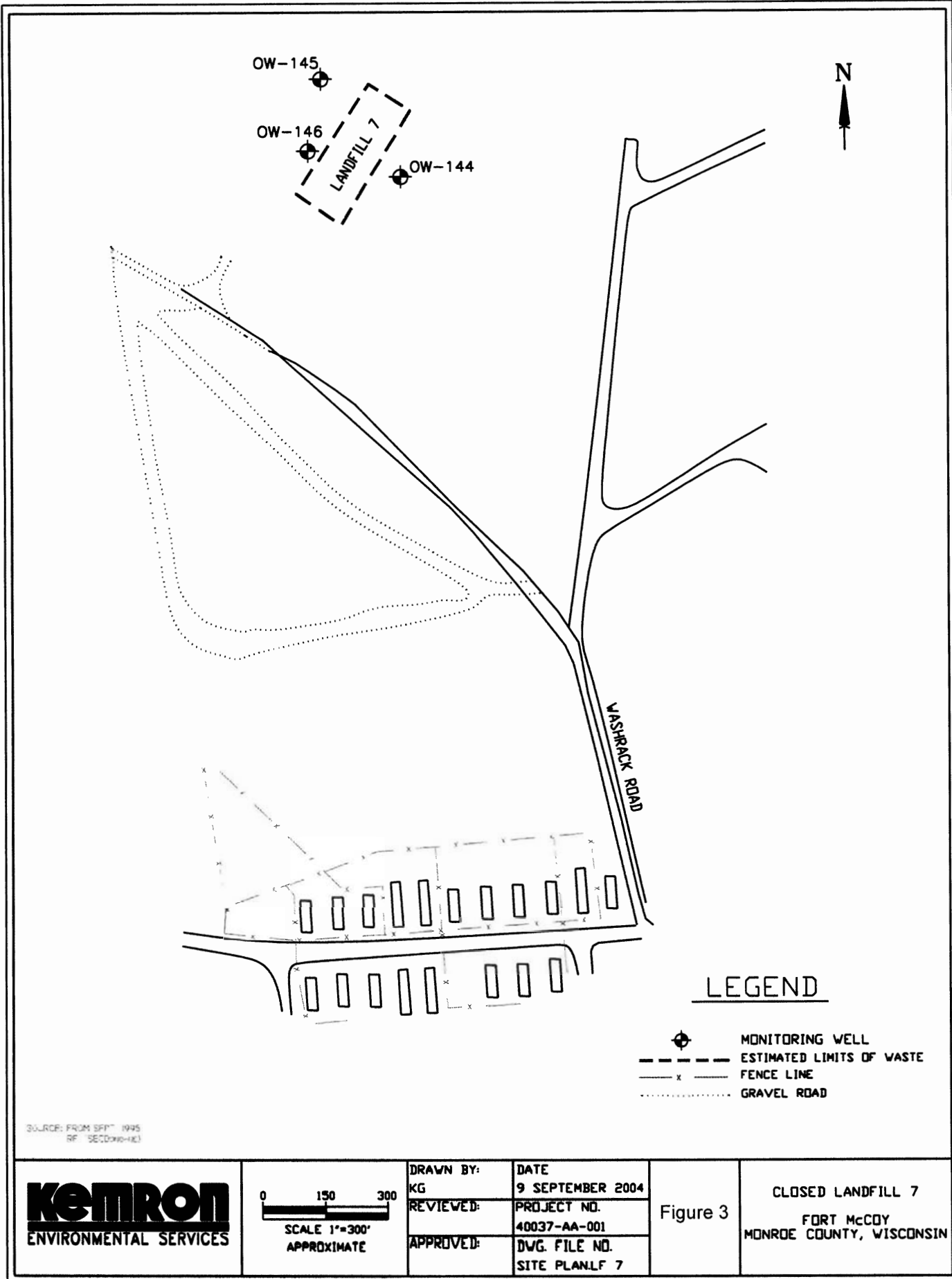

OPINION
OF THE ATTORNEY GENERAL
THAT THE UNITED STATES OF AMERICA
IS IN POSSESSION UNDER A CLEAR AND
COMPLETE TITLE OF CERTAIN LAND SITUATED
IN THE COUNTY OF MONROE, STATE OF WISCONSIN,
DESIGNATED CAMP MC COY

DEPARTMENT OF JUSTICE

WHEREAS, Section 1.02, Chapter 1, Title 1, Wisconsin Statutes, 1949, provides that:

"Subject to the conditions mentioned in section 1.03 the legislature hereby consents to the acquisitions heretofore effected and hereafter to be effected by the United States, by gift, purchase or condemnation proceedings, of the title to places or tracts of land within the state; and, subject to said conditions, the state hereby grants, cedes and conforms to the United States exclusive jurisdiction over all such places and tracts. Such acquisitions are limited to the following purposes:

(1) To sites for the erection of forts, magazines, arsenals, dockyards, custom houses, courthouses, post offices, or other public buildings or for any purpose whatsoever contemplated by the seventeenth clause of section eight of article one of the constitution of the United States.

(2) To a tract of forty thousand acres of land in township 17 and 18 north, ranges 2 and 3 west, near Sparta, in Monroe County, to be used for military purposes as a target and maneuver range and such other purposes as the war department may deem necessary and proper.

(3) To erect thereon dams, abutments, locks, lockkeepers' dwellings, chutes, or other structures necessary or desirable in improving the navigation of the rivers or other waters within the borders of this state,"; and

WHEREAS, Section 1.03, Chapter 1, Title 1, Wisconsin Statutes, 1949, provides that:

"The conditions mentioned in section 1.02 are the following conditions precedent:

(1) That an application setting forth an exact description of the place or tract so acquired shall be made by an authorized officer of the United States to the governor, accompanied by a plat thereof, and by proof that all conveyances and a copy of the record of all judicial proceedings necessary to the acquisition of an unincumbered title by the United States have been recorded in the office of the register of deeds of each county in which such place or tract may be situated in whole or in part.

(2) That the ceded jurisdiction shall not vest in the United States until they shall have complied with all the requirements on their part of sections 1.02 and 1.03, and shall continue so long only as the place or tract shall remain the property of the United States.

(3) THAT THE STATE SHALL FOREVER RETAIN JURISDICTION over every such place or tract to the extent that all legal and military process issued under the authority of the state may be served anywhere thereon, or in any building situate in whole or in part thereon."; and

WHEREAS, pursuant to said Section 1.02 the United States of America, in my opinion acquired fee simple title by purchase and condemnation proceedings to a tract of land in Townships 17, 18, and 19 North, Ranges 2 and 3 West, in Monroe County, Wisconsin; and

WHEREAS, pursuant to said Section 1.03 an exact description of the area so acquired containing 47,414.88 acres of land, more or less, and comprising a portion of the Camp McCoy military reservation, and accompanied by a plat thereof, and copies of deeds and judgments on declaration of taking certified by the Register of Deeds in the County of Monroe, in which said land is situated in whole, was submitted to the Governor of the State of Wisconsin under date of March 6, 1952.

NOW THEREFORE, it is my opinion:

1. That the United States of America is in possession of the lands and premises hereinafter particularly described for certain works or purposes provided for in the aforementioned Section 1.02 of Chapter 1, Title 1, particularly for use as a target and maneuver range and for construction of needful buildings and structures for use in connection with a military reservation officially designated as Camp McCoy, being 47,414.88 acres of land, more or less, and that such possession is under a clear and complete fee simple title, subject to existing easements for public roads and highways, public utilities, railroads and pipelines; and
2. That the land and premises that have been acquired by the United States of America for the purposes above stated are situated in the County of Monroe, State of Wisconsin, and more particularly described as follows:

All that part of Townships Seventeen (17), Eighteen (18) and Nineteen (19) North, Ranges Two (2) and Three (3) West, Fourth Principal Meridian, Monroe County, Wisconsin, more particularly described as follows:

Beginning at a point, said point being the Section corner common to Sections Twenty-seven (27), Twenty-eight (28), Thirty-three (33) and Thirty-four (34), Twp. Eighteen (18) North, Range Three (3) West; thence North along the West line of said Section Twenty-seven (27) and along the West line of Section Twenty-two (22), Twp. Eighteen (18) North, Range Three (3) West to a point in the South Quarter Quarter line of Section Twenty-one (21), Twp. Eighteen (18) North, Range Three (3) West; thence West along said Quarter Quarter line to a point in the East Quarter Quarter line of said Section Twenty-one (21); thence North along said Quarter Quarter line to a point in the East and West center line

... of said Section Twenty-one (21); thence East along said center line to a point in the East line of said Section Twenty-one (21); thence North along said East line and the East line of Section Sixteen (16), Twp. Eighteen (18) North, Range Three (3) West to a point in the East and West center line of said Section Sixteen (16); thence West along said center line to a point in the East Quarter Quarter line of said Section Sixteen (16); thence North along said East Quarter Quarter line and the East Quarter Quarter line of Section Nine (9), Twp. Eighteen (18) North, Range Three (3) West to a point in the South Quarter Quarter line of said Section Nine (9); thence East along said Quarter Quarter line to a point in the West line of said Section Nine (9); thence North along said West line and the West line of Section Four (4), Twp. Eighteen (18) North, Range Three (3) West, and the West lines of Sections Thirty-four (34) and Twenty-seven (27), Twp. Nineteen (19) North, Range Three (3) West to the Southeast corner of Section Twenty-one (21), Twp. Nineteen (19) North, Range Three (3) West; thence West along the South line of said Section Twenty-one (21) to the East Quarter Quarter line of said Section Twenty-one (21); thence North along said East Quarter Quarter line to a point in the North line of said Section Twenty-one (21); thence East along said North line to the Northeast corner of said Section Twenty-one (21); thence North along the West Section lines of Sections Fifteen (15) and Ten (10), Twp. Nineteen (19) North, Range Three (3) West to the Northwest corner of said Section Ten (10); thence East along the North lines of said Section Ten (10) and Section Eleven (11), Twp. Nineteen (19) North, Range Three (3) West to the West Quarter Quarter line of said Section Eleven (11); thence South along said Quarter Quarter line to a point in the East and West center line of said Section Eleven (11); thence East along said center line to a point in the North and South center line of said Section Eleven (11); thence South along said center line to a point in the South line of said Section Eleven (11); thence East along said Section line and the South Section line of Section Twelve (12), Twp. Nineteen (19) North, Range Three (3) West, to the North and South center line of said Section Twelve (12); thence North along said center line to a point in the East and West center line of said Section Twelve (12); thence East along said center line to a point in the West line of said Section Twelve (12); thence North along said West line and the West line of Section Six (6), Twp. Nineteen (19) North, Range Three (3) West, to Northwest corner of said Section Six (6); thence East along the North lines of said Section Six (6) and Sections Five (5) and Four (4), Twp. Nineteen (19) North, Range Two (2) West to the Northeast corner of said Section Four (4); thence South along the East lines of said Section Four (4) and Section Nine (9), Twp. Nineteen (19) North, Range Two (2) West, to the East and West center line of said Section Nine (9); thence West along said center line to a point in the East Quarter Quarter line of said Section Nine (9); thence South along said Quarter Quarter line to a point in the South Quarter Quarter line of said Section Nine (9); thence East along said Quarter Quarter line to a point in the East line of said Section Nine (9); thence South along said East line and the East line of Section Sixteen (16), Township Nineteen (19) North, Range Two (2) West, to the East and West center line of Section Fifteen (15), Twp. Nineteen (19) North, Range Two (2) West; thence East along said center line to a point in the West Quarter Quarter line of said Section Fifteen (15); thence South along said Quarter Quarter line to a point in the South line of said Section Fifteen (15); thence West

along said South line to the Northeast corner of Section Twenty-one (21), Twp. Nineteen (19) North, Range Two (2) West; thence South along the East lines of said Section Twenty-one (21) and Section Twenty-eight (28), Twp. Nineteen (19) North, Range Two (2) West to the East and West center line of said Section Twenty-eight (28); thence West along said center line to a point in the East Quarter Quarter line of said Section Twenty-eight (28); thence South along said Quarter Quarter line to a point in the South Quarter Quarter line of said Section Twenty-eight (28); thence West along said Quarter Quarter line to a point in the North and South center line of said Section Twenty-eight (28); thence South along said center line and the North and South center line of Section Thirty-Three (33), Township Nineteen (19) North, Range Two (2) West to a point in the North quarter quarter line of said Section Thirty-Three (33); thence East along said quarter quarter line to the East line of the West twenty-two (22) acres of the Southwest Quarter (SW $\frac{1}{4}$) of the Northeast Quarter (NE $\frac{1}{4}$) of said Section Thirty-Three (33); thence south along said East line to a point in the East and West center line of said Section Thirty-Three (33); thence East along said center line to a point in the East line of said Section Thirty-Three (33); thence South along said East line to the South quarter quarter line of said Section Thirty-Three (33); thence West six (6) rods along said quarter quarter line to a point on a line lying six (6) rods West of and parallel to said East line of Section Thirty-Three (33); thence South along said line to a point on the Northerly line of a private road known as Franklin Road; thence northwesterly along said Northerly line of Franklin Road to the point of intersection of said Northerly line with the Southerly line of the highway which runs through the Northeast Quarter (NE $\frac{1}{4}$) of the Southeast Quarter (SE $\frac{1}{4}$) of said Section Thirty-Three (33); thence Southwesterly along said Southerly line of said highway to the intersection of said Southerly line with the Southerly line of aforesaid Franklin Road; thence Southeasterly along said Southerly line of Franklin Road to a point on a line lying six (6) rods West of and parallel to the East line of said Section Thirty-Three (33); thence South along said line to a point which is forty (40) rods North of the South line of said Section Thirty-Three (33); thence East six (6) rods to a point on the East line of said Section Thirty-Three (33); thence South along said East line to the Northeast corner of Section Four (4), Township Eighteen (18) North, Range Two (2) West; thence continuing South along the East line of said Section Four (4) to the North quarter quarter line of said Section Four (4); thence West along said quarter quarter line to a point on the North and South center line of said Section Four (4); thence South along said center line to a point in the North line of Section Nine (9), Township Eighteen (18) North, Range Two (2) West; thence West along said North line to the West quarter quarter line of said Section Nine (9); thence South along said quarter quarter line to a point in the North quarter quarter line of said Section Nine (9); thence East along said quarter quarter line to a point in the north and south center line of said Section Nine (9); thence South along said center line to a point in the North line of Section Sixteen (16), Township Eighteen (18) North, Range Two (2) West; thence West along said North line to the West quarter quarter line of said Section Sixteen (16); thence South along said quarter quarter line and the West quarter quarter line of Section Twenty-One (21), Township Eighteen (18) North, Range Two (2) West to a point in the North line of Section Twenty-Eight (28), Township Eighteen (18) North, Range Two (2) West; thence West along said North line to the Northwest corner of said Section Twenty-Eight (28); thence South along the West line of said Section Twenty-Eight (28) to the North quarter quarter line of Section Twenty-Nine (29), Township Eighteen (18) North, Range

Two (2) West; thence West one (1) rod along said quarter quarter line to a point on a line lying one (1) rod West of and parallel to the East line of said Section Twenty-Nine (29); thence South along said line to the East and West center line of said Section Twenty-Nine (29); thence West along said center line and the East and West center lines of Section Thirty (30), Township Eighteen (18) North, Range Two (2) West, and Section Twenty-Five (25), Township Eighteen (18) North, Range Three (3) West to a point on the East line of Section Twenty-Six (26), Township Eighteen (18) North, Range Three (3) West; thence South along said East line to the South quarter quarter line of said Section Twenty-Six (26); thence West along said quarter quarter line to a point on the North and South center line of said Section Twenty-Six (26); thence South along said center line and the North and South center line of Section Thirty-Five (35), Township Eighteen (18) North, Range Three (3) West to a point on the East and West center line of said Section Thirty-Five (35); thence West along said center line to a point on the West quarter quarter line of said Section Thirty-Five (35); thence South along said quarter quarter line to a point in the Southerly right-of-way line of the Chicago, Milwaukee, St. Paul and Pacific Railroad Company; thence in a Southwesterly direction, three thousand and ten (3,010) feet, more or less, along said Southerly right-of-way line through Sections Thirty-Five (35) and Thirty-Four (34), Township Eighteen (18) North, Range Three (3) West to a point in the South line of said Section Thirty-Four (34); thence West one thousand three hundred twenty (1,320) feet, more or less, along said South line, crossing the rights-of-way of the Chicago, Milwaukee, St. Paul and Pacific Railroad Company and the Chicago and North-Western Railway Company, to a point in the North and South Center line of Section Three (3), Township Seventeen (17) North, Range Three (3) West; thence South seven hundred twenty-two (722) feet, more or less, along said center line, crossing the rights-of-way of said railway companies to a point in the aforesaid Southerly right-of-way line; thence in a Southwesterly direction along said Southerly right-of-way line to a point in the West line of said Section Three (3); thence North along said West line and the West line of Section Thirty-Four (34), Twp. Eighteen (18) North, Range Three (3) West to the South Quarter Quarter line of said Section Thirty-Four (34); thence East along said Quarter Quarter line to a point in the North and South center line of said Section Thirty-four (34); thence North along said center line to a point in the North Quarter Quarter line of said Section Thirty-four (34); thence West along said Quarter Quarter line to a point in the West Quarter Quarter line of said Section Thirty-four (34); thence North along said Quarter Quarter line to a point in the North line of said Section Thirty-four (34); thence West along said North line to the point of beginning.

Excepting from the above described parcel the Southwest Quarter (SW $\frac{1}{4}$) of the Northeast Quarter (NE $\frac{1}{4}$) of Section Six (6), Township Nineteen (19) North, Range Two (2) West; the rights-of-way of the Chicago, Milwaukee, St. Paul and Pacific Railroad Company and the Chicago and Northwestern Railway Company; and the following described parcel:

Beginning at the Southeast corner of the Southeast Quarter (SE $\frac{1}{4}$) of the Northeast Quarter (NE $\frac{1}{4}$) of Section Twenty-seven (27), Township Eighteen (18) North, Range Three (3) West; thence West Ten (10) rods along the East and West center line of said Section Twenty-seven (27); thence North Ten (10) rods; thence East Ten (10) rods; thence South Ten (10) rods, to the point of beginning.

Also, beginning at a point, said point being the Section corner common to Sections Three (3), Four (4), Nine (9) and Ten (10), Township Eighteen (18) North, Range Two (2) West; thence East along the North line of said Section Ten (10) to the East Quarter Quarter line of said Section Ten (10); thence South along said Quarter Quarter line to a point in the East and West center line of said Section Ten (10); thence West along said center line to a point in the West line of said Section Ten (10); thence North along said West line to the North Quarter Quarter line of aforesaid Section Nine (9); thence West along said Quarter Quarter line to a point in the East Quarter Quarter line of said Section Nine (9); thence North along said Quarter Quarter line to a point in the North line of said Section Nine (9); thence East along said North line to the point of beginning.

Also, beginning at a point, said point being the Section corner common to Sections Fifteen (15), Sixteen (16), Twenty-one (21) and Twenty-two (22), Township Eighteen (18) North, Range Two (2) West; thence West along the South line of said Section Sixteen (16) to the North and South center line of said Section Sixteen (16); thence North along said center line to a point in the east and west center line of said Section Sixteen (16); thence East along said center line to a point in the East Quarter Quarter line of said Section Sixteen (16); thence North along said Quarter Quarter line to a point in the North Quarter Quarter line of said Section Sixteen (16); thence East along said Quarter Quarter line to a point in the East line of said Section Sixteen (16); thence South along said East line to the point of beginning.

Also, beginning at the Northeast corner of the Northeast Quarter ($NE\frac{1}{4}$) of the Southeast Quarter ($SE\frac{1}{4}$) of Section Eighteen (18), Township Seventeen (17) North, Range Two (2) West; thence West, Fifteen (15) chains, on the Quarter line; thence South, Eight (8) chains; thence East, Fifteen (15) chains; thence North, Eight (8) chains, to the point of beginning.

Also, beginning at the Southeast corner of the Southwest Quarter ($SW\frac{1}{4}$) of the Northwest Quarter ($NW\frac{1}{4}$), Section Ten (10), Twp. Seventeen (17) North, Range Two (2) West; thence North along the West Quarter Quarter line of said Section Ten (10) to a point, said point being the center of the Northwest Quarter ($NW\frac{1}{4}$) of said Section Ten (10); thence West, along the North Quarter Quarter line of said Section Ten (10) and the North Quarter Quarter Line of Section Nine (9), Township Seventeen (17) North, Range Two (2) West, to a point, said point being the center of the Northeast Quarter ($NE\frac{1}{4}$) of said Section Nine (9); thence South, along the East Quarter Quarter line of said Section Nine (9) and the East Quarter Quarter line of Section Sixteen (16), Twp. Seventeen (17) North, Range Two (2) West, to a point in the East and West center line of said Section Sixteen (16); thence due West, along said East and West center line, to a point, said point being the center of said Section Sixteen (16); thence due North, Nine Hundred Ninety (990) feet, more or less, along the center line of said Section Sixteen (16), to a point in the South line of the North One Hundred (100) acres of the Northwest Quarter ($NW\frac{1}{4}$) of said Section Sixteen (16); thence due West, along said South line of said North One Hundred (100) acres, to a point in the West line of said Section Sixteen (16); thence due North, along said West line, to a point in the North Quarter Quarter line of Section Seventeen (17), Township Seventeen (17) North, Range Two (2) West; thence due West, along said North Quarter Quarter line, to a point in a North and South

line drawn parallel to and Sixty-four (64) rods East of the East Quarter Quarter line of said Section Seventeen (17); thence due South, Twenty (20) rods, along said North and South line, to a point; thence due West, Sixty-four (64) rods, to a point in the East Quarter Quarter line of said Section Seventeen (17); thence due South, along said East Quarter Quarter line to a point in the East and West center line of said Section Seventeen (17); thence due East, along said East and West center line, to a point in the East line of said Section Seventeen (17); thence due South, along said East line, to a point in the South Quarter Quarter line of said Section Seventeen (17); thence due West, along said South Quarter Quarter line and the South Quarter Quarter line of Section Eighteen (18), Twp. Seventeen (17) North, Range Two (2) West, and the South Quarter Quarter line of Section Thirteen (13), Twp. Seventeen (17) North, Range Three (3) West, to a point in the North and South center line of said Section Thirteen (13); thence due North, along said North and South center line, to a point, said point being the center of said Section Thirteen (13); thence due West, along the East and West center line of said Section Thirteen (13) to a point in the West Quarter Quarter line of said Section Thirteen (13); thence due North, along said West Quarter Quarter line, to a point in the North line of said Section Thirteen (13); thence due West, along said North line and the North line of Section Fourteen (14), Twp. Seventeen (17) North, Range Three (3) West, to a point in the North and South center line of said Section Fourteen (14); thence due South, One Thousand Three Hundred Twenty (1,320) feet, more or less, along said North and South center line, to a point in the North side of road running through said Section Fourteen (14); thence Northwesterly, Two Thousand Nine Hundred Fifty (2,950) feet, more or less, along the Northerly side of said road, to a point, said point being the Northwest corner of said Section Fourteen (14); thence due West, along the South line of Section Ten (10), Twp. Seventeen (17) North, Range Three (3) West, to a point in the West Quarter Quarter line of said Section Ten (10); thence due North, along said West Quarter Quarter line, to a point, said point being the center of the Southwest Quarter (SW $\frac{1}{4}$) of said Section Ten (10); thence due West, along the South Quarter Quarter line of said Section Ten (10), to a point in the west line of said Section Ten (10); thence due North, along said West line, to a point in the North Quarter Quarter line of Section Nine (9), Twp. Seventeen (17) North, Range Three (3) West; thence due West, along said North Quarter Quarter line, to a point, said point being the center of the Northeast Quarter (NE $\frac{1}{4}$) of said Section Nine (9); thence due North, along the East Quarter Quarter line of said Section Nine (9), to a point in the North line of said Section Nine (9); thence West, along said North line, to a point, said point being the intersection of the North and South center line and the South line of Section Four (4), Township Seventeen (17) North, Range Three (3) West; thence in a Southwesterly direction along said Southerly railroad right-of-way line across said Section Nine (9) and Section Eight (8), Township Seventeen (17) North, Range Three (3) West, to a point on the North line of Section Seventeen (17), Twp. Seventeen (17) North, Range Three (3) West; thence East along said North line to the Northeast corner of said Section Seventeen (17); thence South along the East line of said Section Seventeen (17) to the East and West center line of said Section Seventeen (17); thence West along said center line to a point in the North and South center line of said Section Seventeen (17); thence South along said center line to a point on the North line of Section Twenty (20), Twp. Seventeen (17) North, Range Three (3) West; thence West along said North line to the West Quarter Quarter line of

thence South along said Quarter Quarter line to a point in the South Quarter Quarter line of said Section Twenty (20); thence East along said Quarter Quarter line to a point in the North and South center line of said Section Twenty (20); thence South along said center line to a point in the North line of Section Twenty-nine (29); Twp. Seventeen (17) North, Range Three (3) West; thence West along said North line to the West Quarter Quarter line of said Section Twenty-nine (29); thence South along said Quarter Quarter line to a point in the East and West center line of said Section Twenty-nine (29); thence East along said center line to a point in the North and South center line of said Section Twenty-nine (29); thence South along said center line to a point in the South Quarter Quarter line of said Section Twenty-nine (29); thence West along said Quarter Quarter line to a point in the West Quarter Quarter line of said Section Twenty-nine (29); thence South along said Quarter Quarter line to a point in the North line of Section Thirty-two (32), Twp. Seventeen (17) North, Range Three (3) West; thence East along said North line to the North and South center line of said Section Thirty-two (32); thence South along said center line to a point in the North Quarter Quarter line of said Section Thirty-two (32); thence East along said Quarter Quarter line to a point in the West line of Section Thirty-three (33), Twp. Seventeen (17) North, Range Three (3) West; thence North along said West line to a point, said point being Four Hundred Twelve (412) feet South of the Northwest corner of said Section Thirty-three (33); thence due East Four Hundred Fifty-two (452) feet to a point; thence South Thirty-two Degrees, Forty-five Minutes East (S 32°45' E) Four Hundred Seventy (470) feet to a point; thence continuing South Forty-five Degrees, Fifteen Minutes East (S 45°15' E) Four Hundred Twenty-eight (428) feet; thence South Fifty-three Degrees, Forty-five Minutes East (S 53°45' E) Three Hundred (300) feet; thence due East Sixty (60) feet to a point in West Quarter Quarter line, said point being One Thousand Three Hundred Four (1,304) feet South of the North line of said Section Thirty-three (33), Township Seventeen (17) North, Range Three (3) West; thence South along said Quarter Quarter line to a point in the East and West center line of said Section Thirty-three (33); thence East along said center line to a point in the North and South center line of said Section Thirty-three (33); thence South along said center line to a point in the South Quarter Quarter line of said Section Thirty-three (33); thence East along said Quarter Quarter line and the South Quarter Quarter line of Section Thirty-four (34), Twp. Seventeen (17) North, Range Three (3) West, to a point in the North and South center line of said Section Thirty-four (34); thence South along said center line to a point in the South line of said Section Thirty-four (34); thence East along said South line to the Southeast corner of said Section Thirty-four (34); thence North along the East line of said Section Thirty-four (34) to the North Quarter Quarter line of said Section Thirty-four (34); thence West along said Quarter Quarter line to a point in the North Quarter Quarter line of said Section Thirty-four (34); thence North along said Quarter Quarter line to a point in the North line of said Section Thirty-four (34); thence West along said North line to the Southeast corner of Section Twenty-eight (28), Twp. Seventeen (17) North, Range Three (3) West; thence North along the East lines of said Section Twenty-eight (28) and Section Twenty-one (21), Twp. Seventeen (17) North, Range Three (3) West, to the South Quarter Quarter line of Section Twenty-two (22), Twp. Seventeen (17) North, Range Three (3) West; thence East along said Quarter Quarter line to a point in the West Quarter Quarter line of said Section Twenty-two (22); thence North along said Quarter Quarter

line to a point in the East and West center line of said Section Twenty-two (22); thence East along said center line to a point in the West line of Section Twenty-three (23), Twp. Seventeen (17) North, Range Three (3) West; thence South along said West line to the North line of the South Half ($S\frac{1}{2}$) of the Northwest Quarter ($NW\frac{1}{4}$) of the Southwest Quarter ($SW\frac{1}{4}$); thence East along said North line to a point in the West Quarter Quarter line of said Section Twenty-three (23); thence South along said Quarter Quarter line to a point in the center line of Old United States Highway No. Sixteen (16), which is equal to Station 851 + 00 of Wisconsin Highway Commission Road Plans of Project Number 325-A; thence Easterly along said centerline on a curve to the left of Two Thousand Eight Hundred Sixty-four and Nine Tenths (2,864.9) feet radius, a distance of One Thousand Three Hundred Sixty-two (1,362) feet to a point, said point being the intersection of the North and South center line of said Section Twenty-three (23) with the center line of aforesaid highway, which is equal to Station 837 + 38 of said highway plans; thence East along South Quarter Quarter line of Section Twenty-three (23) and the South Quarter Quarter line of Section Twenty-four (24), Twp. Seventeen (17) North, Range Three (3) West, to a point in the North and South center line of said Section Twenty-four (24); thence North along said center line to a point on a line lying One Hundred Twenty-six (126) feet Northerly of and parallel to the center line of New United States Highway No. Sixteen (16) as now located; thence Easterly along said line to a point in the East Quarter Quarter line of said Section Twenty-four (24); thence South along said Quarter Quarter line to a point on the North right-of-way line of New United States Highway No. Sixteen (16); thence in a Southeasterly direction along said North right-of-way line to a point in the West line of Section Nineteen (19), Township Seventeen (17) North, Range Two (2) West; thence South along said West line to the North Quarter Quarter line of said Section Nineteen (19); thence East along said Quarter Quarter line to a point in the North and South center line of said Section Nineteen (19); thence South along said center line to a point in the North right-of-way line of Old Highway Sixteen (16); thence Northeasterly along said North right-of-way line to a point in the West line of Section Twenty (20), Township Seventeen (17) North, Range Two (2) West; thence South along said West line to the Northwest corner of Section Twenty-nine (29), Township Seventeen (17) North, Range Two (2) West; thence East along the North line of said Section Twenty-nine (29) to the West Quarter Quarter line of said Section Twenty-nine (29); thence South along said Quarter Quarter line to a point in the North Quarter Quarter line; thence East along said Quarter Quarter line and the North Quarter Quarter line of Section Twenty-eight (28), Township Seventeen (17) North, Range Two (2) West to a point in the West Quarter Quarter line of said Section Twenty-eight (28); thence North along said Quarter Quarter line to a point in the South line of Section Twenty-one (21); Township Seventeen (17) North, Range Two (2) West; thence East along said South line to the East Quarter Quarter line of said Section Twenty-one (21); thence North along said Quarter Quarter line to a point in the South Quarter Quarter line of said Section Twenty-one (21); thence East along said Quarter Quarter line to a point in the East line of said Section Twenty-one (21); thence North along said East line and the West line of Section Fifteen (15), Township Seventeen (17) North, Range Two (2) West, to the East and West center line of said Section Fifteen (15); thence East along center line to a point in the West Quarter Quarter line of said Section Fifteen (15); thence North along said Quarter

112-89-3
1524
which was added to the original
file of the original
New York

Quarter line to a point in the North Quarter Quarter line of said Section Fifteen (15); thence East along said Quarter Quarter line to a point in the North and South center line of said Section Fifteen (15); thence North along said center line to a point in the South line of Section Ten (10), Township Seventeen (17) North, Range Two (2) West; thence West along said South line to the Southwest corner of said Section Ten (10); thence North along the West line of said Section Ten (10) to the East and West center line of said Section Ten (10); thence East along said center line to the Southeast corner of the Southwest Quarter (SW $\frac{1}{4}$) of the Northwest Quarter (NW $\frac{1}{4}$) of said Section Ten (10), said corner being the point of beginning.

Excepting from the above described parcel the right-of-way of new U. S. Highway No. 16.

Containing within the limits above described 47,444.88 acres of land, more or less.

IN WITNESS WHEREOF, I have hereunto set my hand and caused the seal of the Department of Justice to be affixed this 22nd day of September, A.D., 1952.



Attorney General of the United States





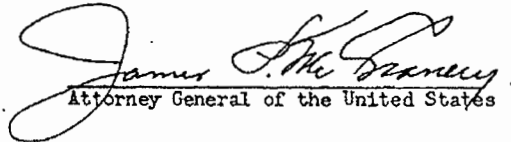
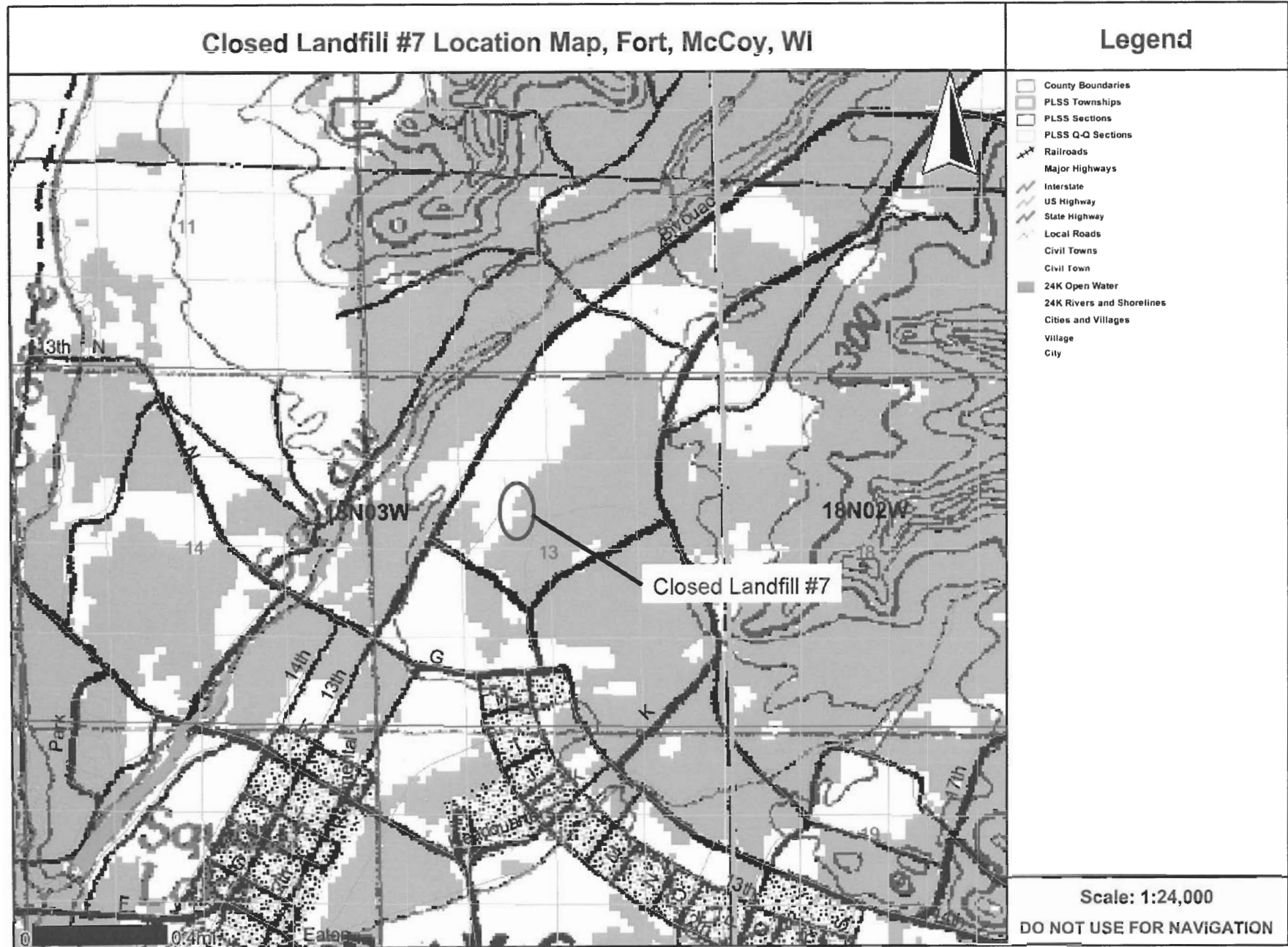
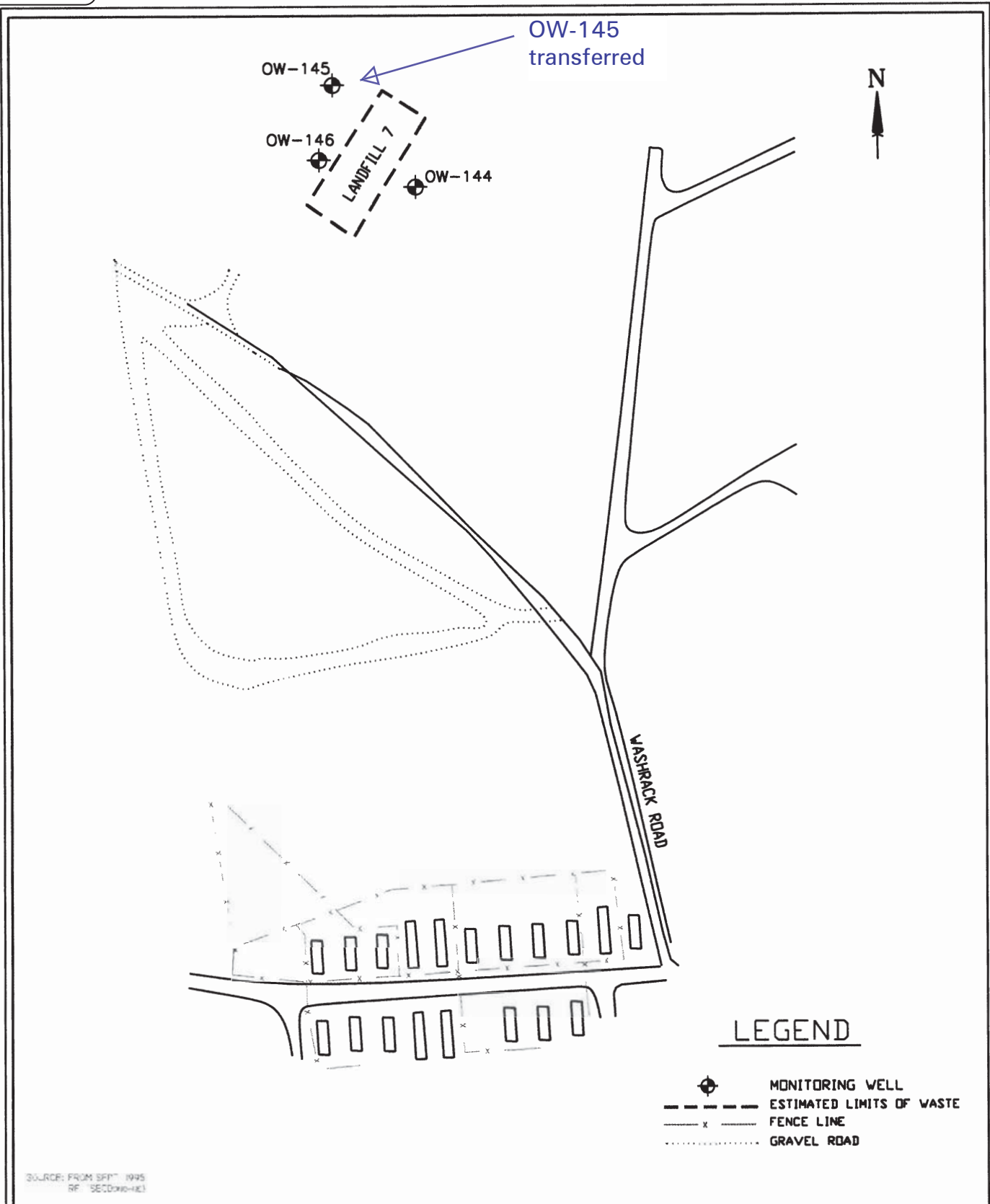

Figure 1



MONITORING WELL
NOT ABANDONED



LEGEND

-  MONITORING WELL
-  ESTIMATED LIMITS OF WASTE
-  FENCE LINE
-  GRAVEL ROAD

SOURCE: FROM SFP™ 1995
RF 1520010-14E1

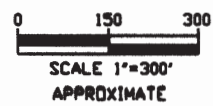

DRAWN BY:	DATE
KG	9 SEPTEMBER 2004
REVIEWED:	PROJECT NO.
	40037-AA-001
APPROVED:	DWG. FILE NO.
	SITE PLAN LF 7

Figure 3

CLOSED LANDFILL 7
FORT MCCOY
MONROE COUNTY, WISCONSIN

TABLE 2
Closed Landfill #7 PAL and ES Exceedances
USARC - Fort McCoy, Sparta, WI

Max of Result for plotting					WELL ID		
PARAMETER NAME	NR140 PAL	NR140 Enf Std	Result Units	Sample Date	OW-144	OW-145	OW-146
Arsenic (As) Total	1	10	ug/L	12/14/1993	<2	<2	<2
				7/27/1994	<10	<10	<10
				5/5/1998	<1.1	<1.1	<1.1
				12/3/1998	<1.8	<1.8	<1.8
				5/6/1999	<1.3	<1.3	<1.3
				11/3/1999	<2.8	<2.8	<2.8
				5/2/2000	<1.7	<1.7	<1.7
				11/7/2000	<2.4	<2.4	<2.4
				5/1/2001	<2.4	<2.4	<2.4
				11/6/2001	<2.1	4.2	<2.1
				4/24/2002	<2.4	<2.4	<2.4
				1/8/2004	<1.14	<1.14	<1.14
				2/25/2004	NS	<1.14	<1.14
				5/19/2004	<0.77	<0.77	<0.77
				10/20/2004	<0.5	<0.5	<0.5
				4/28/2005	<0.5	<0.5	<0.5
11/16/2005	<0.25	<0.25	<0.25				
4/21/2006	<0.25	0.571	<0.25				
BENZENE	0.5	5	ug/L	12/14/1993	<1	6.4	<1
				7/27/1994	<1	3.8	<1
				5/5/1998	<0.2	<0.2	<0.2
				12/3/1998	<0.2	0.5	<0.2
				5/6/1999	<0.2	<0.2	<0.2
				11/3/1999	<0.1	<0.1	<0.1
				5/2/2000	<0.07	<0.07	<0.07
				11/7/2000	<0.07	<0.07	<0.07
				5/1/2001	<0.12	<0.12	<0.12
				11/6/2001	<0.12	<0.12	<0.12
				4/24/2002	<0.12	0.88	<0.12
				1/8/2004	<0.4	<0.4	<0.4
				2/25/2004	<0.4	<0.4	<0.4
				5/19/2004	<0.4	<0.4	<0.4
				10/20/2004	<0.125	<0.125	<0.125
				4/28/2005	<0.125	<0.125	<0.125
11/16/2005	<0.125	0.161	<0.125				
4/21/2006	<0.125	<0.125	<0.125				
Beryllium (BE) Total	0.4	4	ug/L	12/14/1993	<1	<1	<1
				7/27/1994	<4	<4	<4
				5/5/1998	1.2	1.8	1
				12/3/1998	<0.6	<0.1	<0.6
				5/6/1999	<0.4	0.5	<0.4
				11/3/1999	<0.1	<0.1	<0.1
				5/2/2000	<0.2	<0.2	<0.2
				11/7/2000	<0.2	<0.2	<0.2
				5/1/2001	<0.2	<0.2	<0.2
				11/6/2001	<0.2	<0.2	<0.2
				4/24/2002	<0.2	<0.2	<0.2
				1/8/2004	<0.16	<0.16	<0.16
				2/25/2004	NS	<0.16	<0.16
				5/19/2004	NS	0.38	0.27
				10/20/2004	<0.25	<0.25	<0.25
				4/28/2005	<0.25	<0.25	<0.25
11/16/2005	<0.25	<0.25	<0.25				
4/21/2006	<0.25	<0.25	<0.25				

TABLE 2
Closed Landfill #7 PAL and ES Exceedances
USARC - Fort McCoy, Sparta, WI

Max of Result for plotting					WELL ID		
PARAMETER NAME	NR140 PAL	NR140 Enf Std	Result Units	Sample Date	OW-144	OW-145	OW-146
BIS(2-ETHYLHEXYL) PHTHALATE	0.6	6	ug/L	12/14/1993	<10	<10	<10
				7/27/1994	<5	<5	<5
				5/5/1998	<0.7	<0.7	<0.7
				12/3/1998	<3.7	<3.7	<3.7
				5/6/1999	12.1	<3.7	<3.7
				11/3/1999	0.9	0.6	1.8
				5/2/2000	11	9	<0.6
				11/7/2000	1	2.5	<0.8
				5/1/2001	1.5	3.9	3.9
				11/6/2001	<0.7	<0.7	<0.7
				4/24/2002	<0.8	<0.8	<0.8
				1/8/2004	<0.35	<0.34	0.42
				2/25/2004	<0.34	0.79	0.81
				5/19/2004	<0.35	<0.35	<0.35
				10/20/2004	<2.5	<2.5	<2.5
				4/28/2005	<2.55	<2.55	<2.55
				11/16/2005	<2.5	<2.5	<2.5
4/21/2006	<2.5	<2.5	<2.5				
CADMIUM (CD) TOTAL	0.5	5	ug/L	12/14/1993	<2	<2	>2
				7/27/1994	<5	<5	<5
				5/5/1998	0.2	2	0.5
				12/3/1998	0.6	1.9	1
				5/6/1999	0.1	0.7	0.3
				11/3/1999	<0.2	<0.2	<0.2
				5/2/2000	<0.1	0.4	<0.1
				11/7/2000	<0.1	<0.1	<0.1
				5/1/2001	<0.05	<0.05	<0.05
				11/6/2001	<0.17	<0.17	<0.18
				4/24/2002	<0.1	0.47	0.99
				1/8/2004	<0.39	<0.39	<0.39
				2/25/2004	NS	<0.48	<0.48
				5/19/2004	<0.48	<0.48	<0.48
				10/20/2004	<0.25	<0.25	<0.25
				4/28/2005	<0.25	<0.25	<0.25
				11/16/2005	<0.25	<0.25	<0.25
4/21/2006	<0.25	<0.25	<0.25				
CHROMIUM, TOTAL	10	100	ug/L	12/14/1993	<5	5	5
				7/27/1994	<10	<10	<10
				5/5/1998	5.9	<5.3	<5.3
				12/3/1998	<6.1	15.9	14.1
				5/6/1999	<4.5	<4.5	<4.5
				11/3/1999	<0.9	0.9	<0.9
				5/2/2000	<7.9	<7.9	<7.9
				11/7/2000	0.9	<0.7	<0.7
				5/1/2001	<8.2	<8.2	<8.2
				11/6/2001	<9.9	<9.9	<9.9
				4/24/2002	<3.8	<3.8	<3.8
				1/8/2004	1.2	<0.99	<0.99
				2/25/2004	NS	<2.7	<2.7
				5/19/2004	<2.7	<2.7	<2.7
				10/20/2004	<2.5	<2.5	<2.5
				4/28/2005	<2.5	<2.5	<2.5
				11/16/2005	<2.5	<2.5	<2.5
4/21/2006	<2.5	<2.5	<2.5				

TABLE 2
Closed Landfill #7 PAL and ES Exceedances
USARC - Fort McCoy, Sparta, WI

Max of Result for plotting					WELL ID		
PARAMETER NAME	NR140 PAL	NR140 Enf Std	Result Units	Sample Date	OW-144	OW-145	OW-146
COBALT, TOTAL	8	40	ug/L	12/14/1993	7	7	5
				7/27/1994	<50	<50	<50
				5/5/1998	<5.4	<5.4	<5.4
				12/3/1998	<7.4	<7.4	<7.4
				5/6/1999	<6.9	<6.9	<6.9
				11/3/1999	<5.3	11	11
				5/2/2000	<7.3	<7.3	9.3
				11/7/2000	<8.4	<8.4	<8.4
				5/1/2001	<5.5	<5.5	<5.5
				11/6/2001	<4.8	<4.8	<4.8
				4/24/2002	<6.8	<6.8	<6.8
				1/8/2004	<0.43	<0.43	<0.43
				2/25/2004	NS	<6.63	<7.7
				5/19/2004	<6.6	<6.6	<9.1
				10/20/2004	<2.5	<2.5	<2.5
				4/28/2005	<2.5	<2.5	<2.5
11/16/2005	<2.5	<2.5	<2.5				
4/21/2006	<2.5	<2.5	<2.5				
2-4-DINITROTOLUENE	0.005	0.05	ug/L	12/14/1993	<10	<10	<10
				7/27/1994	<5	<5	<5
				5/5/1998	<0.9	<0.9	<0.9
				12/3/1998	<0.5	<0.5	<0.5
				5/6/1999	<0.5	<0.5	<0.5
				11/3/1999	<0.4	<0.4	<0.4
				5/2/2000	<0.4	<0.4	<0.4
				11/7/2000	<0.4	<0.4	<0.4
				5/1/2001	<0.4	<0.4	<0.4
				11/6/2001	<0.4	<0.4	<0.4
				4/24/2002	<0.7	<0.7	<0.5
				1/8/2004	0.91	0.88	0.86
				2/25/2004	NS	<0.43	<0.43
				5/19/2004	<0.43	<0.43	<0.43
				10/20/2004	<2.5	<2.5	<2.5
				4/28/2005	<2.5	<2.5	<2.5
11/16/2005	<2.5	<2.5	<2.5				
4/21/2006	<2.5	<2.5	<2.55				
IRON (FE), TOTAL	0.15	0.3	mg/L	12/14/1993	650	15000	440
				7/27/1994	300	32500	3200
				5/5/1998	2.12	25.6	4.61
				12/3/1998	0.038	4.92	0.057
				5/6/1999	0.032	6.25	0.042
				11/3/1999	<0.12	0.935	<0.12
				5/2/2000	0.035	8.98	0.022
				11/7/2000	0.016	1.05	0.106
				5/1/2001	0.01	2.73	0.007
				11/6/2001	0.032	0.071	0.011
				4/24/2002	0.022	2.38	0.037
				1/8/2004	<0.032	0.212	<0.032
				2/25/2004	NS	3.79	2.82
				5/19/2004	<0.05	2.15	2.35
				10/20/2004	<0.02	0.189	<0.02
				4/28/2005	<0.02	<0.02	<0.02
11/16/2005	0.171	0.31	<0.02				
4/21/2006	<0.025	5.6	1.02				

TABLE 2
Closed Landfill #7 PAL and ES Exceedances
USARC - Fort McCoy, Sparta, WI

Max of Result for plotting					WELL ID		
PARAMETER NAME	NR140 PAL	NR140 Enf Std	Result Units	Sample Date	OW-144	OW-145	OW-146
LEAD (PB), TOTAL	1.5	15	ug/L	12/14/1993	3.3	12	4.6
				7/27/1994	<3	20	4
				5/5/1998	<1.4	14	<1.4
				12/3/1998	2.8	3.1	8.7
				5/6/1999	<1.9	<1.9	<1.9
				11/3/1999	6	8.5	8.5
				5/2/2000	<1.9	2.9	<1.9
				11/7/2000	<1.1	<1.1	<1.1
				5/1/2001	<1.1	<1.1	<1.1
				11/6/2001	<1.1	<1.1	<1.1
				4/24/2002	<0.6	<0.6	<0.6
				1/8/2004	<2.8	<2.8	<2.8
				2/25/2004	NS	2.8	2.5
				5/19/2004	<1.6	<1.6	<1.6
				10/20/2004	<0.5	<0.5	<0.5
				4/28/2005	<0.5	<0.5	<0.5
				11/16/2005	<0.25	<0.25	<0.25
4/21/2006	<0.25	<0.25	<0.25				
MANGANESE (MN), TOTAL	25	50	ug/L	12/14/1993	340	1400	210
				7/27/1994	30	3620	1430
				5/5/1998	1030	1970	2420
				12/3/1998	1330	1780	858
				5/6/1999	428	1900	1070
				11/3/1999	156	756	764
				5/2/2000	43	620	1290
				11/7/2000	41	417	487
				5/1/2001	17	1500	1020
				11/6/2001	12.4	826	546
				4/24/2002	14.5	2420	982
				1/8/2004	17.8	680	1690
				2/25/2004	NS	739	1660
				5/19/2004	7	1220	2020
				10/20/2004	11.2	1370	438
				4/28/2005	<1.0	271	884
				11/16/2005	<1.0	208	502
4/21/2006	<1.0	1160	651				
MERCURY	0.2	2	ug/L	12/14/1993	<0.2	0.23	<0.2
				7/27/1994	0.9	1.1	1.3
				5/5/1998	<0.09	<0.09	<0.09
				12/3/1998	<0.2	<0.2	<0.2
				5/6/1999	<0.2	<0.2	<0.2
				11/3/1999	<0.9	<0.9	<0.9
				5/2/2000	<0.9	<0.9	<0.9
				11/7/2000	<0.9	<0.9	<0.9
				5/1/2001	<0.1	<0.1	<0.1
				11/6/2001	<0.08	<0.08	<0.08
				4/24/2002	<0.08	<0.08	<0.08
				1/8/2004	<0.11	<0.11	<0.11
				2/25/2004	NS	<0.11	<0.11
				5/19/2004	<0.11	<0.11	<0.11
				10/20/2004	<0.1	<0.1	<0.1
				4/28/2005	<0.1	<0.1	<0.1
				11/16/2005	<0.1	<0.1	<0.1
4/21/2006	<0.1	<0.1	<0.1				

TABLE 2
Closed Landfill #7 PAL and ES Exceedances
USARC - Fort McCoy, Sparta, WI

Max of Result for plotting					WELL ID		
PARAMETER NAME	NR140 PAL	NR140 Enf Std	Result Units	Sample Date	OW-144	OW-145	OW-146
NAPHTHALENE	8	40	ug/L	12/14/1993	<10	<10	<10
				7/27/1994	<5	<5	<5
				5/5/1998	<0.3	9.38	<0.3
				12/3/1998	<0.4	19	<0.4
				5/6/1999	<0.4	5	<0.4
				11/3/1999	<0.2	<0.2	<0.2
				5/2/2000	<0.2	1.4	<0.2
				11/7/2000	<0.2	<0.2	<0.2
				5/1/2001	<0.09	<0.09	<0.09
				11/6/2001	<0.09	<0.09	<0.09
				4/24/2002	<0.09	3.23	<0.09
				1/8/2004	<0.19	<0.19	<0.19
				2/25/2004	NS	<0.19	<0.19
				5/19/2004	<0.19	<0.19	<0.19
				10/20/2004	<0.2	<0.2	<0.2
				4/28/2005	<0.2	<0.2	<0.2
11/16/2005	<2.5	<2.5	<2.5				
4/21/2006	<2.5	6.2	<2.5				
NITRATE NITROGEN, TOTAL	2	10	mg/L	12/14/1993	<100	560	600
				7/27/1994	300	1400	15200
				5/5/1998	15.9	2.4	6.8
				12/3/1998	15.7	2.2	2
				5/6/1999	10.4	0.86	2.25
				11/3/1999	6.17	2.8	6.52
				5/2/2000	5.5	1.2	1.5
				11/7/2000	10.5	7.96	4.39
				5/1/2001	12.1	1	6.32
				11/6/2001	12.1	13.7	10.1
				4/24/2002	11.6	4.99	9.65
				1/8/2004	11	2.2	4.8
				2/25/2004	NS	2.7	2.8
				5/19/2004	9.5	4.1	9.55
				10/20/2004	16.4	13.8	3.3
				4/28/2005	5	6.3	4.41
11/16/2005	3.57	7.05	11.9				
4/21/2006	9.76	<0.1	7.95				
NITRITE PLUS NITRATE, DISSOLVED NITRITE NITRATE NITROGEN				12/14/1993	<25	<25	57
				7/27/1994	<20	<20	<20
				5/5/1998	<3.2	<3.2	<3.2
				12/3/1998	<0.5	<0.5	<0.5
				5/6/1999	<0.5	<0.5	<0.5
				11/3/1999	<6	<6	<6
				5/2/2000	<6	<6	<6
				11/7/2000	<2.3	<2.3	<2.3
				5/1/2001	<2.3	<2.3	<2.3
				11/6/2001	<1	<1	<1
				4/24/2002	<0.6	<0.6	<0.6
				1/8/2004	<1.4	<1.4	<1.4
				2/25/2004	NS	<1.4	<1.4
				5/19/2004	<1.4	<1.4	<1.4
				10/20/2004	<2.5	<2.5	<2.5
				4/28/2005	<2.5	<2.5	<2.5
11/16/2005	<2.5	<2.5	<2.5				
4/21/2006	<2.5	<2.5	<2.5				

TABLE 2
Closed Landfill #7 PAL and ES Exceedances
USARC - Fort McCoy, Sparta, WI

Max of Result for plotting					WELL ID		
PARAMETER NAME	NR140 PAL	NR140 Enf Std	Result Units	Sample Date	OW-144	OW-145	OW-146
SILVER	10	50	ug/L	12/14/1993	<40	<40	190
				7/27/1994	<10	<10	<10
				5/5/1998	<3.5	<3.5	<3.5
				12/3/1998	<0.8	<0.8	<0.8
				5/6/1999	4.7	4.9	6.1
				11/3/1999	<0.4	<0.4	<0.4
				5/2/2000	<6.1	<6.1	<6.1
				11/7/2000	<0.9	<0.9	<0.9
				5/1/2001	<0.9	<0.9	<0.9
				11/6/2001	<0.9	<0.9	<0.9
				4/24/2002	<0.9	<0.9	<0.9
				1/8/2004	<0.59	<0.59	<0.59
				2/25/2004	NS	<1.3	<1.3
				5/19/2004	<1.3	<1.3	<1.3
				10/20/2004	<5.0	<5.0	<5.0
				4/28/2005	<5.0	<5.0	<5.0
				11/16/2005	<5.0	<5.0	<5.0
4/21/2006	<5.0	<5.0	<5.0				
TETRACHLOROETHYLENE	0.5	5	ug/L	12/14/1993	<0.5	<0.5	<0.5
				7/27/1994	<1	<1	<1
				5/5/1998	<0.5	<0.5	<0.5
				12/3/1998	<0.6	<0.6	<0.6
				5/6/1999	<0.6	0.9	<0.6
				11/3/1999	<0.07	<0.07	<0.07
				5/2/2000	<0.2	<0.2	<0.2
				11/7/2000	<0.2	<0.2	<0.2
				5/1/2001	<0.17	<0.17	<0.17
				11/6/2001	<0.17	<0.17	<0.17
				4/24/2002	<0.17	<0.17	<0.17
				1/8/2004	<0.4	0.87	<0.4
				2/25/2004	NS	0.54	<0.4
				5/19/2004	<0.4	1	<0.4
				10/20/2004	<0.25	0.942	<0.25
				4/28/2005	<0.25	<0.25	<0.25
				11/16/2005	<0.25	<0.25	<0.25
4/21/2006	<0.25	1.42	<0.25				
VANADIUM (V)	6	30	ug/L	12/14/1993	<3	<3	3
				7/27/1994	<50	<50	<50
				5/5/1998	<4.9	25	<4.9
				12/3/1998	<3.2	<3.2	<3.2
				5/6/1999	5.1	7.7	<4.5
				11/3/1999	<1.9	<1.9	<1.9
				5/2/2000	21	27	15
				11/7/2000	7.6	<5.8	<5.8
				5/1/2001	<6.6	<6.6	<6.6
				11/6/2001	<6.7	<6.7	<6.7
				4/24/2002	<6.7	<6.7	<6.7
				1/8/2004	<2.9	<2.9	<2.9
				2/25/2004	NS	<4.86	<2.9
				5/19/2004	<4.9	<4.9	<4.9
				10/20/2004	<5.0	<5.0	<5.0
				4/28/2005	<5.0	<5.0	<5.0
				11/16/2005	8.8	<5.0	<5.0
4/21/2006	7.85	<5.0	<5.0				

Only Compounds with NR 140 PAL or ES exceedances are included in the Table.

NS indicates not sampled



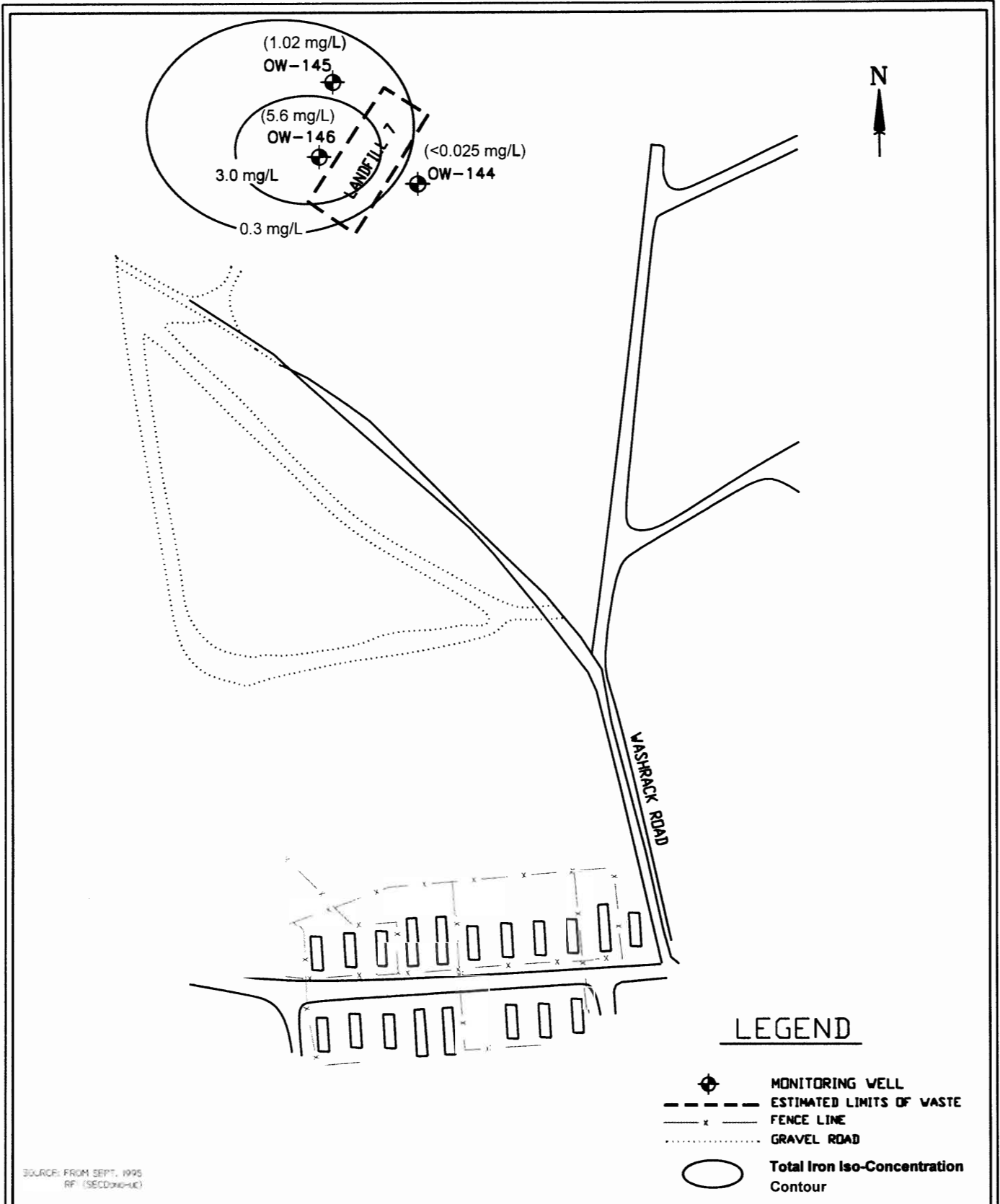

Bold numbers indicate NR 140 Enforcement Standard Exceedances

OW-144 is the Upgradient Well

Italic numbers indicate NR 140 Preventive Action Limit exceedances



LEGEND

-  MONITORING WELL
-  ESTIMATED LIMITS OF WASTE
-  FENCE LINE
-  GRAVEL ROAD
-  Total Iron Iso-Concentration Contour

SOURCE: FROM SEPT. 1995
RF (SECD)06-010

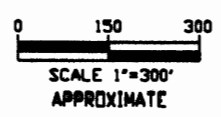

DRAWN BY: KG	DATE 9 SEPTEMBER 2004
REVIEWED:	PROJECT NO. 40037-AA-001
APPROVED:	DWG. FILE NO. SITE PLAN/LF 7



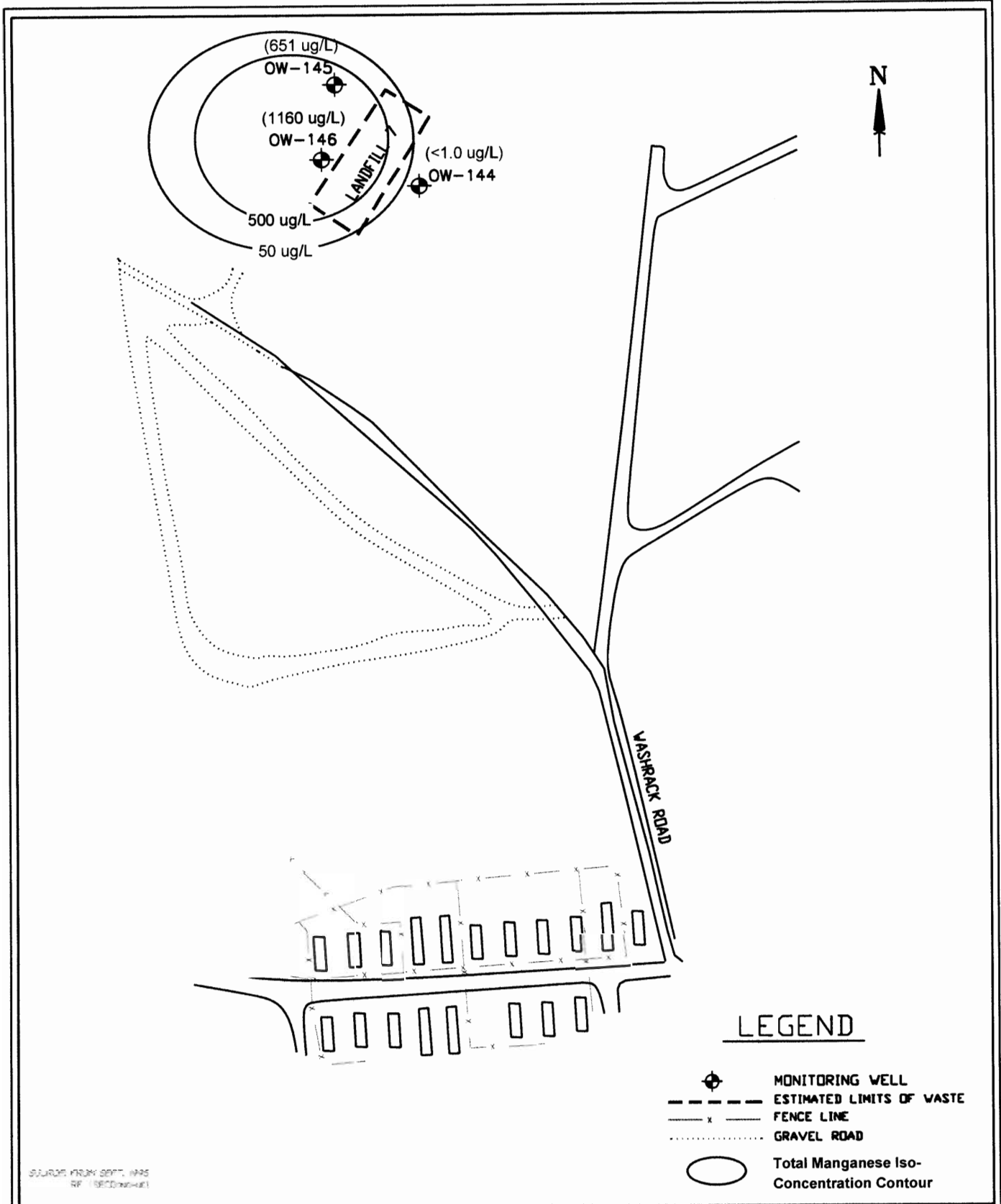

Figure 8

CLF7 Total Iron Iso-Concentration Contours,
April 21, 2006
Fort McCoy
Monroe County, Wisconsin



ADAPTED FROM SEPT. 1995
RF 1 (SEC03msh041)

LEGEND

-  MONITORING WELL
-  ESTIMATED LIMITS OF WASTE
-  FENCE LINE
-  GRAVEL ROAD
-  Total Manganese Iso-Concentration Contour

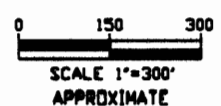

DRAWN BY: KG	DATE: 9 SEPTEMBER 2004
REVIEWED:	PROJECT NO.: 40037-AA-001
APPROVED:	DWG. FILE NO.: SITE PLAN.LF 7

Figure 10

CLF7 Total Manganese
Iso-Concentration Contours,
April 21, 2006
Fort McCoy
Monroe County, Wisconsin

**Table 1
Groundwater Elevations
Closed Landfill #7
Fort McMoy, Sparta, WI**

Well Number Top of Casing Screen Bottom Date	OW-144		OW-145		OW-146	
	Depth	Elevation	Depth	Elevation	Depth	Elevation
		901.12		898.14		898.25
		880.3		877.4		877.4
5/4/1998	17.72	883.4	16.74	881.4	17.65	880.6
12/8/1998	15.94	885.18	15.34	882.8	16.14	882.11
5/6/1999	16.4	884.72	15.42	882.72	16.5	881.75
11/4/1999	16.4	884.72	15.72	882.42	16.6	881.65
5/2/2000	18.56	882.56	17.7	880.44	18.58	879.67
11/7/2000	16.84	884.28	16.12	882.02	16.94	881.31
11/6/2001	16.64	884.48	15.88	882.26	16.76	881.49
4/24/2002	17.5	883.62	16.5	881.64	17.5	880.75
1/8/2004	18.36	882.76	17.88	880.26	18.73	879.52
2/25/2004			18.18	879.96	19.05	879.2
5/19/2004			16.89	881.25	17.93	880.32
10/20/2004	16.28	884.84	15.57	882.57	16.44	881.81
4/28/2005	17.32	883.8	16.33	881.81	17.44	880.81
11/16/2005	17.61	883.51	16.78	881.36	17.61	880.64
4/21/2006	17.33	883.79	16.81	881.33	17.82	880.43

Note: Elevations in ft Mean Sea Level (MSL)

PRF = G:\PLOT\PLOTS\A\ETA.PRF

DATE=Fri Aug 25 12:06:42 1995

D:\proj\400099\rf\1\17a.dgn

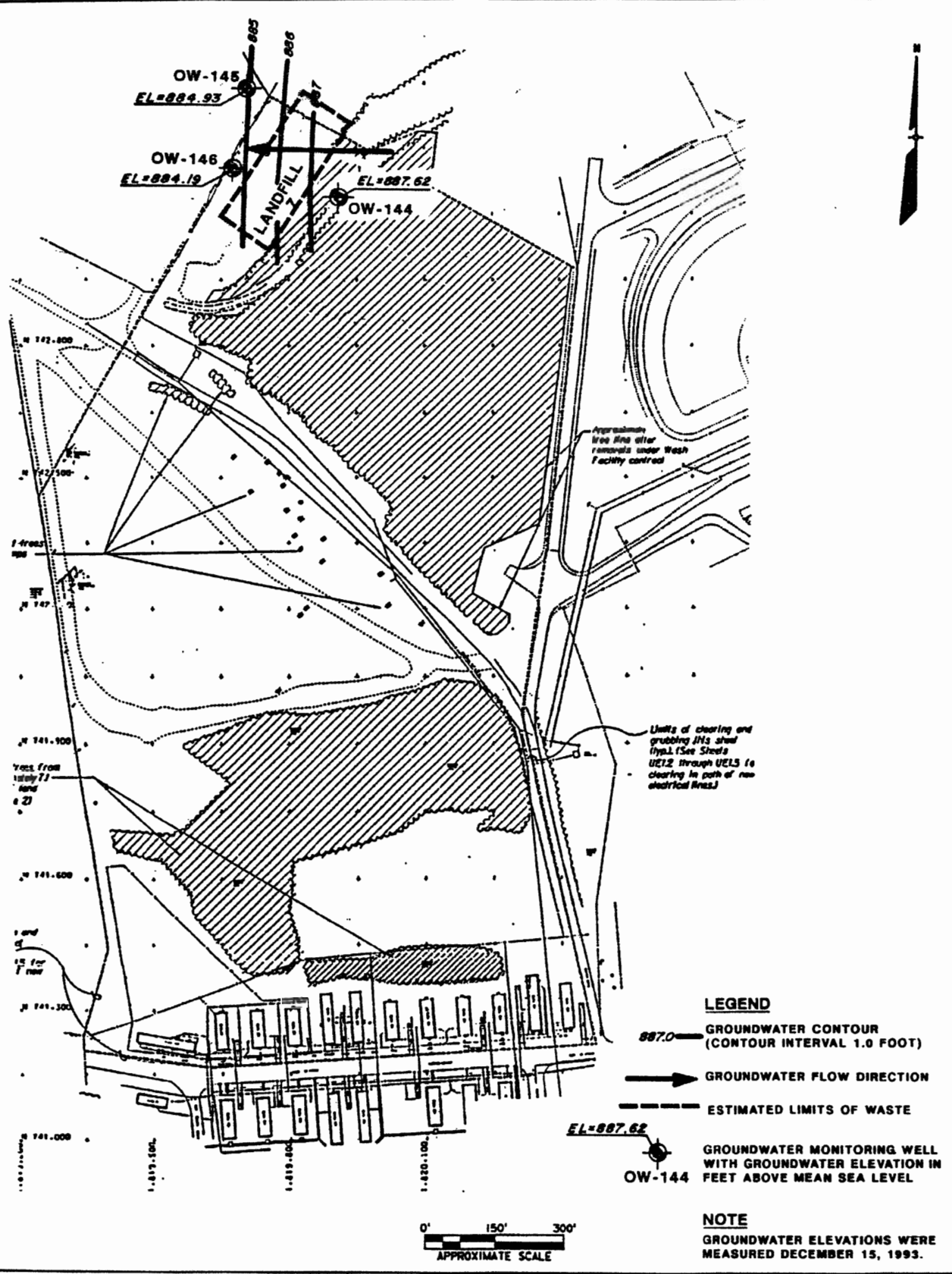
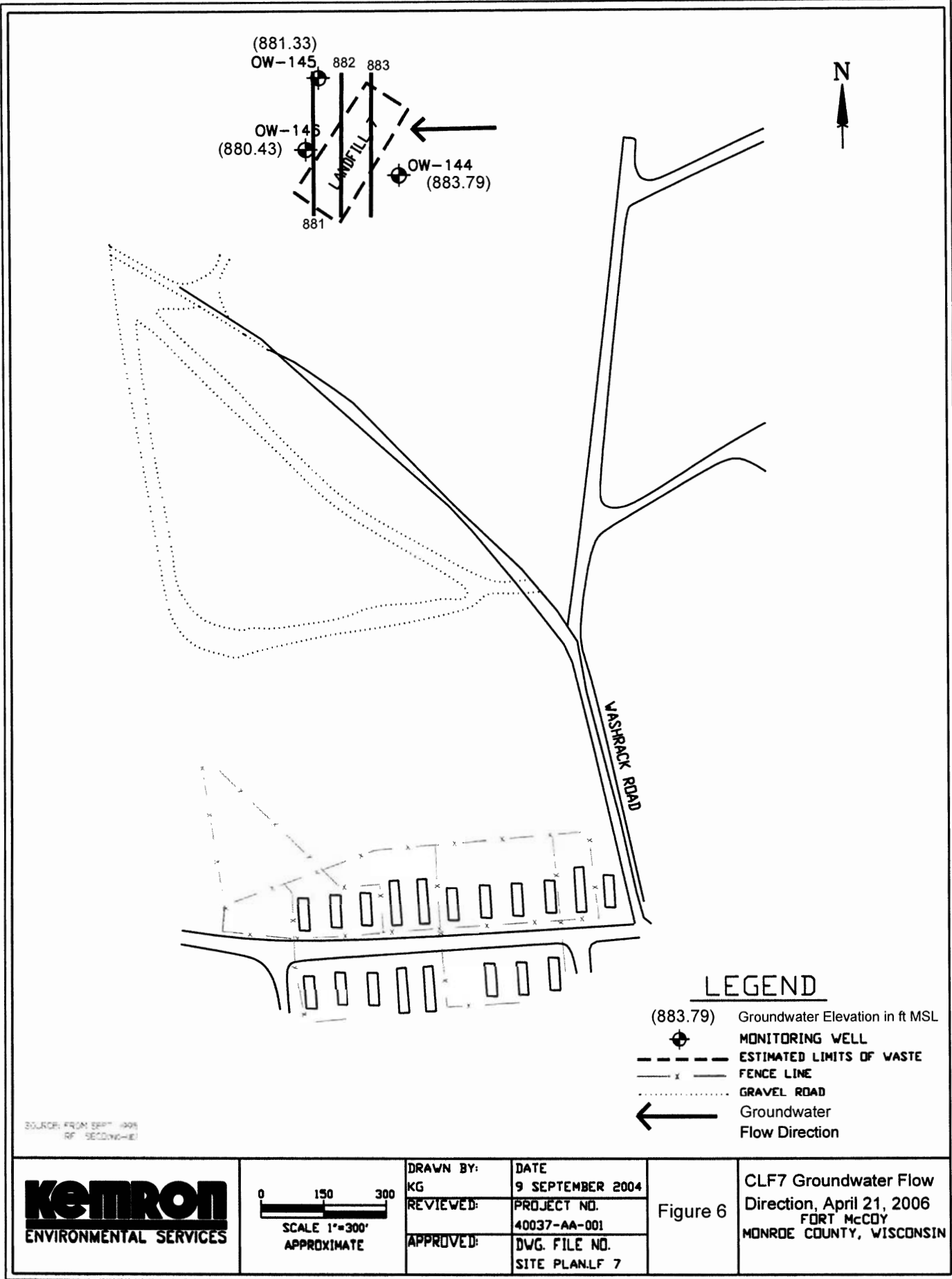

Figure 5
 Closed Landfill 7 Groundwater Flow Direction,
 December 15, 1993
 Fort McCoy, Monroe County, WI



RESPONSIBLE PARTY AFFIRMATION OF PROPERTY DESCRIPTIONS
CLOSED LANDFILL #7
FORT MCCOY, MONROE COUNTY, WI

The following affirmation by the responsible party is required by Wisconsin Administrative Code, Ch. NR 726.05 paragraph (3)(b)4.f.

I hereby affirm the following:

1. I believe that legal descriptions for all of the properties within or partially within the contaminated site's boundaries that have soil contamination exceeding generic residual contaminant levels as determined under ss. NR 720.09, 720.11 and 720.19, and groundwater contamination exceeding the enforcement standards as determined under ss. NR 140 at the time that case closure was requested, other than public street or highway rights-of-way or railroad rights-of-way, have been submitted to the agency with administrative authority for the site, either as an attachment to the site investigation report or as part of the groundwater GIS registry attachment to the case close out report.

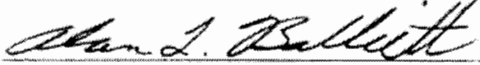

Alan L. Balliett on behalf of Fort McCoy
(Responsible Party)

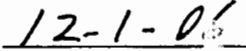

(Date)