



ENVIRONMENTAL & REGULATORY SERVICES
BUREAU OF PECFA
2129 Jackson Street
Oshkosh, Wisconsin 54901-1805
TDD #: (608) 264-8777
Fax #: (920) 424-0217
<http://www.commerce.state.wi.us>
<http://www.wisconsin.gov>
Scott McCallum, Governor
Phillip Edw. Albert, Secretary

April 23, 2002

Mr. Douglas Deaton
Mirro Company
PO Box 1330
Manitowoc, WI 54220

RE: Final Closure

Commerce # 54220-6744-01 WDNR BRRTS # 03-36-280532
Mirro Company Plant #2, 2401 Mirro Drive, Manitowoc

Two 20,000-gallon fuel oil USTs

Dear Mr. Deaton:

This letter acknowledges receipt of the information requested in the Wisconsin Department of Commerce's (Commerce) PECFA Site Review Section February 25, 2002 conditional closure letter. On April 23, 2002, Commerce received the monitoring well abandonment forms for the sump.

This site is now listed as "closed" on the Commerce database. It is in your best interest to keep all documentation related to the investigation and remediation of your site.

If future site conditions indicate that any remaining contamination poses a threat, and subsequent information indicates a need to reopen this case, any original claim under the PECFA fund would also reopen and you may apply for assistance to the extent of remaining eligibility. If contamination is encountered, appropriate measures must be implemented to assure any residual contamination is managed following all applicable State of Wisconsin regulations and standards.

Thank you for your efforts to protect Wisconsin's environment. If you have any questions, please contact me in writing at the letterhead address or by telephone at (920) 424-0046.

Sincerely,

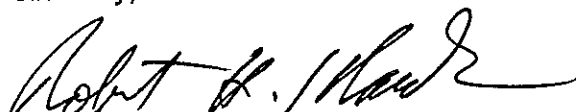

Robert H. Klauk, PG
Hydrogeologist
Site Review Section

cc: Lynelle Caine – Northern Environmental
Case File

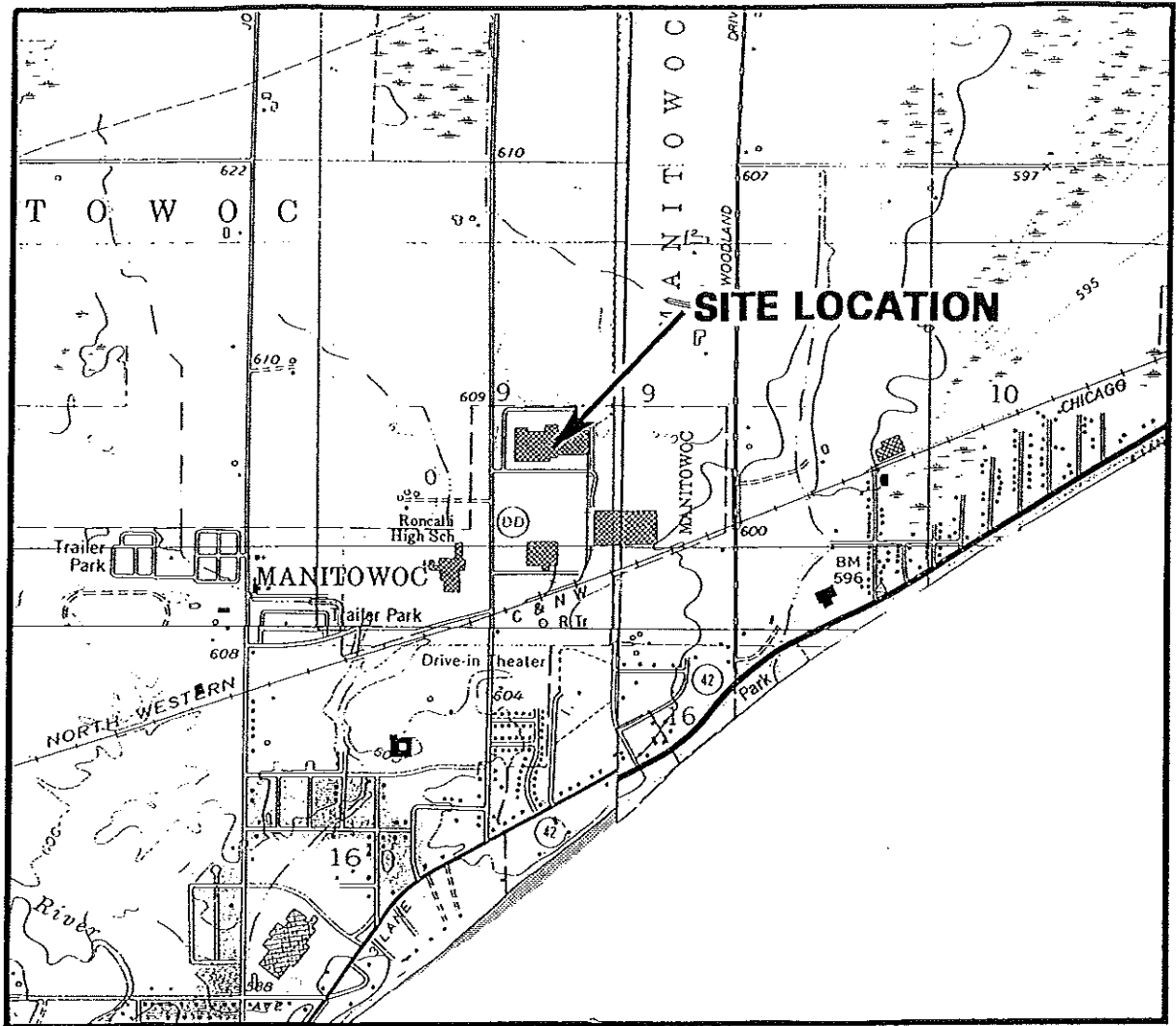

SCALE IN FEET

1" = 2000'



CONTOUR INTERVAL 10 FEET
NATIONAL GEODETIC VERTICAL DATUM OF 1929



QUADRANGLE LOCATION

BASE MAP SOURCE: USGS MISHICOT, AND TWO RIVERS, WISCONSIN 7.5 MINUTE QUADRANGLE (REVISED 1978)
BASE MAP SOURCE: USGS MANITOWOC, WISCONSIN 7.5 MINUTE QUADRANGLE (REVISED 1973)

DRAWN BY: JJK PROJECT: MIR-0919 DATE: 8/11/99

REV. DATE

THIS DRAWING AND ALL INFORMATION CONTAINED THEREON IS THE PROPERTY OF NORTHERN ENVIRONMENTAL INCORPORATED AND SHALL NOT BE COPIED OR USED EXCEPT FOR THE PURPOSE FOR WHICH IT IS EXPRESSLY FURNISHED.



Northern EnvironmentalSM
Hydrologists • Engineers • Geologists

MIRO PLANT #2
MANITOWOC, WISCONSIN

SITE LOCATION AND
LOCAL TOPOGRAPHY



ACCESS ROAD

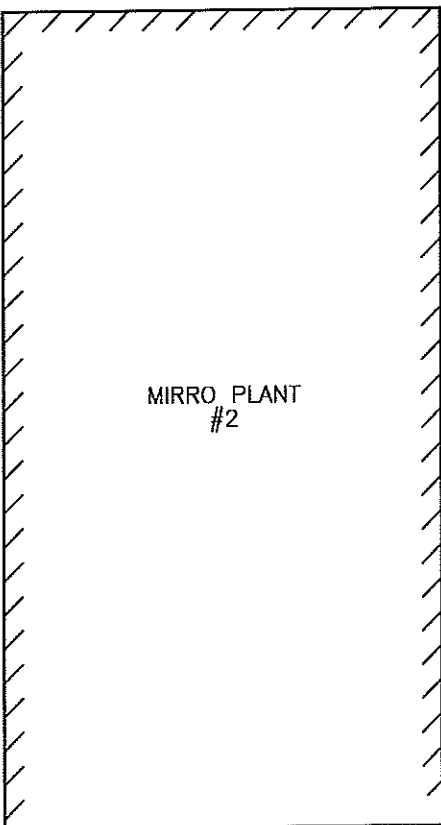
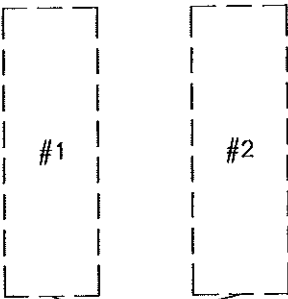

MIRRO PLANT #2

LEGEND

- PP — PRODUCT LINE
- [#] EXISTING UST LOCATION

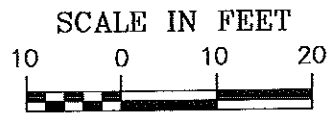

S:\PROJ\ESP_22001267\DRAWINGS\092501-2.DWG

DRAWN BY: JRB PROJECT: ESP-1267 DATE: 09/25/01

MIRRO COMPANY
MANITOWOC, WISCONSIN

REV. DATE THIS DRAWING AND ALL INFORMATION CONTAINED THEREON IS THE PROPERTY OF NORTHERN ENVIRONMENTAL INCORPORATED AND SHALL NOT BE COPIED OR USED EXCEPT FOR THE PURPOSE FOR WHICH IT IS EXPRESSLY FURNISHED.

Northern Environmental SM
Hydrologists • Engineers • Geologists

SITE LAYOUT

FIGURE 2

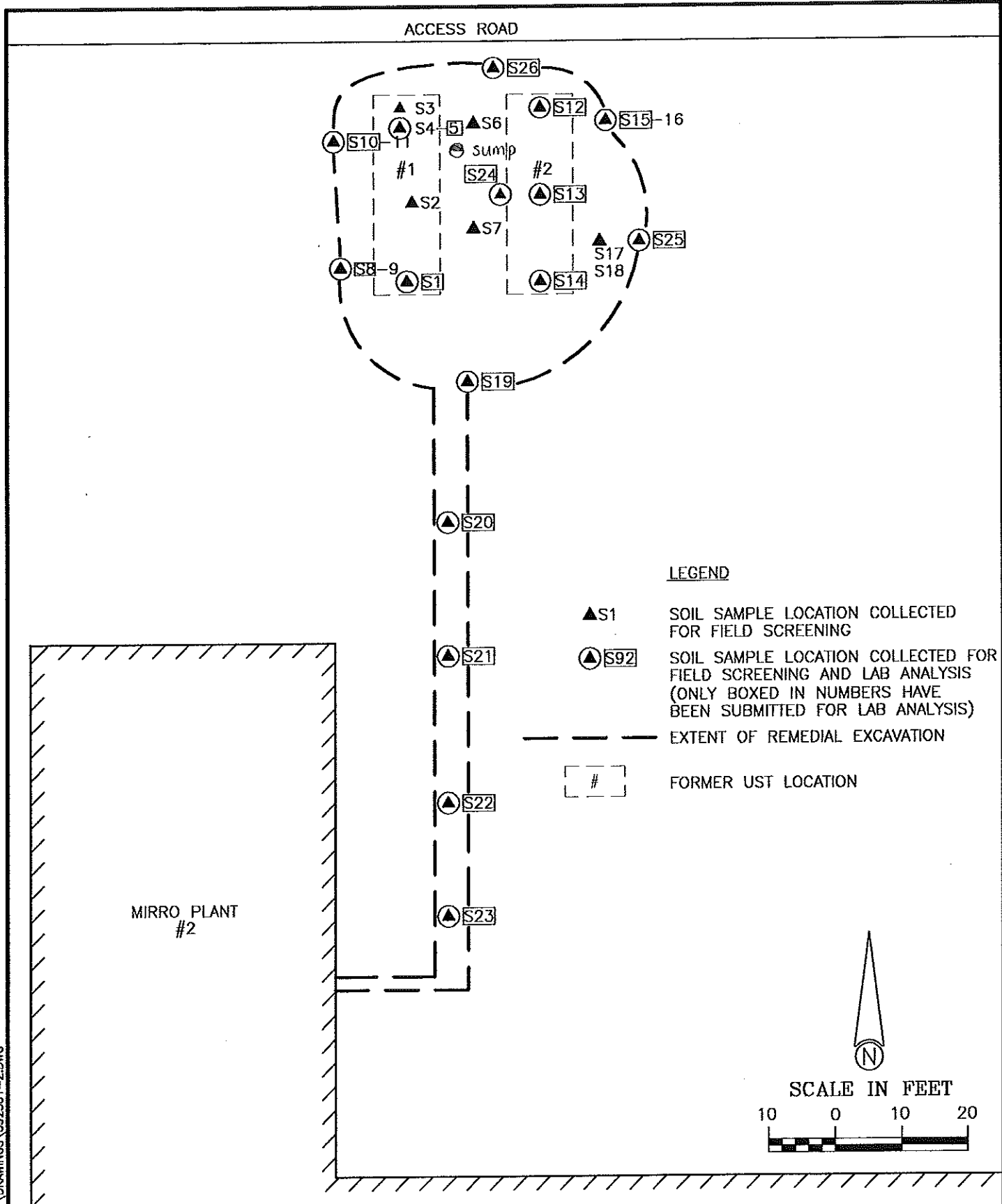

S:\PROJ\ESP_22001267\DRAWINGS\092501-2.DWG

DRAWN BY: JRB | PROJECT: ESP-1267 | DATE: 09/25/01

REV. DATE | THIS DRAWING AND ALL INFORMATION CONTAINED THEREON IS THE PROPERTY OF NORTHERN ENVIRONMENTAL INCORPORATED AND SHALL NOT BE COPIED OR USED EXCEPT FOR THE PURPOSE FOR WHICH IT IS EXPRESSLY FURNISHED.

Northern Environmental SM
Hydrologists • Engineers • Geologists

MIRRO COMPANY
MANITOWOC, WISCONSIN

EXTENT OF EXCAVATION
WITH SOIL SAMPLE LOCATIONS

FIGURE 3