



*Excellence through experience™*

709 Gillette St., Ste #3 ♦ La Crosse, WI 54603 ♦ 1-800-552-2932 ♦ Fax (608) 781-8893 Email: rona@metcohq.com ♦ www.metcohq.com

---

March 9, 2017

Riley Neumann  
Wisconsin Department of Natural Resources  
2300 N. Dr. Martin Luther King Drive  
Milwaukee, WI 53212

**Subject:** Auto Repair on Vliet – Site Investigation cost cap exceedence request (>\$20K).  
BRRTS #: 03-41-286924, PECFA #: 53205-1833-81

Dear Mr. Neumann,

A cost estimate (using Usual & Customary schedule of charges) is being submitted for completion of the site investigation at the subject property located at 2481 W. Vliet Street in Milwaukee, Wisconsin. This is required due to COMM 47 rule changes (Comm 47.337(2)) which requires WDNR approval to exceed the cap, meaning any costs incurred above \$20,000 after April 30, 2006, will not be eligible for reimbursement unless previously approved.

As of today's date, \$19,985.69 has been spent of the \$20,000 Site Investigation Cap and included: [1] workplan, [2] Geoprobe/Drilling Project (17 Geoprobe borings ranging from 12-16 feet bgs, 5 soil borings ranging from 16-17 feet bgs (which were converted to five monitoring wells to 16-17 feet bgs), and a total of 78 soil samples and 14 Geoprobe groundwater samples collected) with field (PID) and/or laboratory analysis (Lead, VOC, PVOC, Naphthalene, and 1,2-DCA)), [3] well development, and [4] hydraulic conductivity testing.

The proposed workscope to complete the site investigation includes: [1] two rounds of groundwater monitoring from all five site wells for laboratory analysis (VOC, PVOC+ Naphthalene+1,2-DCA, Pb, Nitrate/Nitrite, Sulfate, Dissolved Iron and Manganese), [2] surveying, [3] waste disposal, and [4] completion of the Soil and Groundwater Investigation Report. The cost estimate is as follows:

Groundwater Monitoring (two events)	\$ 2,481.57
Laboratory Analysis	\$ 1,027.27
Surveying	\$ 1,288.88
Investigative Waste Disposal	\$ 1,007.69
Soil and Groundwater Investigation Report	\$ 4,965.35
Change Order Request	\$ 381.78
Total	\$11,152.54

METCO is requesting a cost cap exceedence in the amount of **\$11,138.23** (proposed additional costs to complete the investigation \$11,152.54 minus the remaining investigation budget \$14.31). This will bring the total site investigation costs to \$31,138.23.

Upon state approval of the proposed workscope and budget, METCO will proceed with the site investigation.

Attached is a site layout map, data tables, and draft standardized invoice form for the above workscope as required.

Should you have any questions, comments, or recommendations please contact me at our La Crosse office (608) 781-8879 or email at [jasonp@metcohq.com](mailto:jasonp@metcohq.com).

Sincerely,



Jason T. Powell  
Staff Scientist

Attachments

c: Raisa Beyder c/o Anna Shtivelberg, POA - Client

B.1.b DETAILED SITE MAP  
 AUTO REPAIR ON VLIET



709 Gillette St. Suite 3  
 La Crosse, WI 54603  
 Tel: (608) 781-8879  
 Fax: (608) 781-8893

MILWAUKEE, WISCONSIN  
 DRAWN BY: ED  
 DATE: 8/24/16

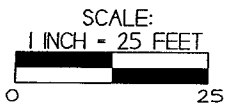

NOTE: INFORMATION BASED ON AVAILABLE DATA. ACTUAL CONDITIONS MAY DIFFER.

- A - FORMER PUMP ISLAND (2005, 1985, 1980, 1975, AND 1967 AERIAL PHOTOS)
- B - FORMER PUMP ISLAND (1951 AERIAL PHOTO)

- - UTILITY POLE
- ⊙ - STREET LIGHT
- ⊗ - SEWER MAN HOLE
- ⊠ - STORM DRAIN
- - SOIL BORING LOCATION (GILES P2ESA)
- ⊙ - GEOPROBE BORING LOCATION
- ⊙ - MONITORING WELL LOCATION
- - - - - PROPERTY BOUNDARY
- - - - - WATER LINE
- - - - - SEWER LINE
- - - - - NATURAL GAS LINE
- - - - - BURIED ELECTRIC LINE
- ==== OVERHEAD UTILITIES
- - - - - TELEPHONE/CABLE LINE
- \*\*\*\*\* FENCE

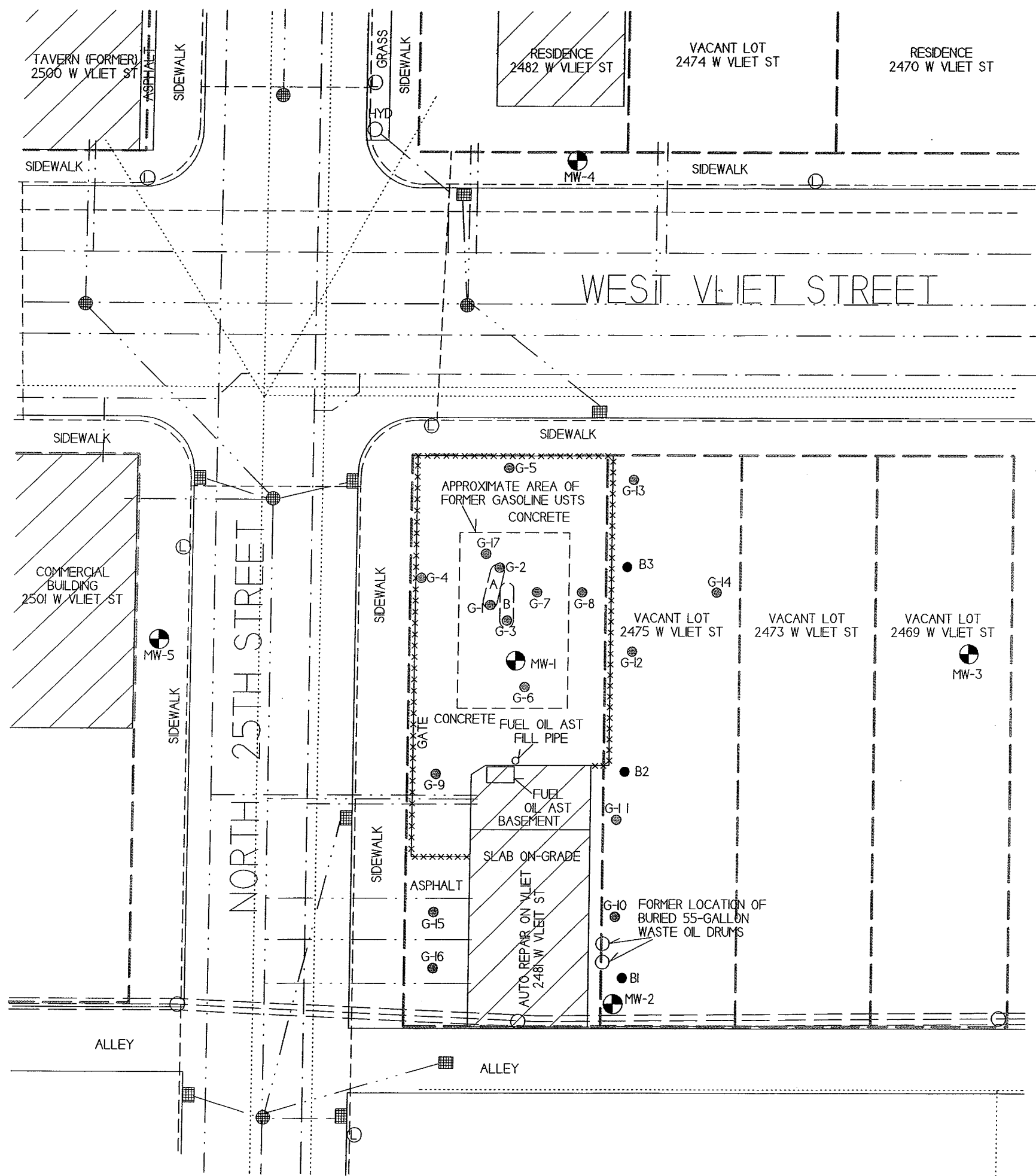



A.1 Groundwater Analytical Table  
(Geoprobe)

Auto Repair on Vliet BRRTS #03-41-286924

Sample ID	Date	Benzene (ppb)	Ethyl Benzene (ppb)	MTBE (ppb)	Naphthalene (ppb)	Toluene (ppb)	Trimethylbenzenes (ppb)	Xylene (Total) (ppb)
G-4-W	02/06/17	7600	3400	<86	470	20500	1860	14100
G-5-W	02/06/17	1.05	1.36	<0.43	1.99	4.7	2.25	6.04
G-6-W	02/06/17	7300	2330	<21.5	390	11300	3250	9570
G-7-W	02/06/17	2430	1140	<21.5	233	4500	1041	4270
G-8-W	02/06/17	5800	910	<21.5	253	7500	1068	4260
G-9-W	02/06/17	1790	890	<21.5	246	3500	957	3600
G-10-W	02/06/17	1.75	2.76	<0.43	<1.7	4.4	7.41	14.4
G-11-W	02/06/17	1.85	0.61	<0.43	<1.7	4.0	1.35-1.93	2.71
G-12-W	02/06/17	<1.35	<2.8	<2.15	<8.5	<1.65	<5.7	<8.55
G-13-W	02/06/17	4.1	19.6	<0.43	<1.7	18.3	8.36	39.6
G-14-W	02/07/17	0.88	<0.56	<0.43	<1.7	0.94	<1.14	<1.71
G-15-W	02/07/17	5.7	3.8	<2.15	<8.5	14.9	20.8	13.9
G-16-W	02/07/17	<1.35	<2.8	<2.15	<8.5	<1.65	<5.7	<8.55
G-17-W	02/07/17	3050	3800	<21.5	610	17900	3170	15800
<b>ENFORCE MENT STANDARD ES = Bold</b>		5	700	60	100	800	480	2000
<b>PREVENTIVE ACTION LIMIT PAL = Italics</b>		0.5	140	12	10	160	96	400

NS = Not Sampled  
 (ppb) = parts per billion  
 (ppm) = parts per million  
 DRO = Diesel Range Organics  
 GRO = Gasoline Range Organics

**Usual and Customary Standardized Invoice #21**  
**January 2017 - June 2017**



RR-068A

PECFA #: 53205-1833-81  
 BRR's #: 03-41-286924  
 Site Name: Auto Repair on Vliet  
 Site Address: 2481 W. Vliet St., Milwaukee, WI

Vendor Name: \_\_\_\_\_  
 Invoice #: \_\_\_\_\_  
 Invoice Date: \_\_\_\_\_  
 Check #: \_\_\_\_\_

U&C Total \$11,152.54  
 Variance to U&C Total \$-  
 Grand Total \$11,152.54

TASK	TASK DESCRIPTION	SERVICES	ACTIVITY CODE	ACTIVITY REFERENCE CODE DESCRIPTION	UNIT	MAX UNIT COST	UNITS	TOTAL MAX
1	GW Sampling		GS05	Sample Collection	Well	\$72.45	10	\$724.50
1	GW Sampling		GS10	Incremental Sample Collection (natural attenuation)	Well	\$47.67	5	\$238.35
1	GW Sampling		GS15	Incremental Sample Collection (cadmium & lead)	Well	\$26.25	10	\$262.50
1	GW Sampling		GS25	Primary Mob/Demob	Site	\$628.11	2	\$1,256.22
4	Waste Disposal	Consultant	WD05	Consultant Coordination	Site	\$137.13	1	\$137.13
4	Waste Disposal	Commodity	WD10	GW Sample and/or Purge	Drum	\$42.11	1	\$42.11
4	Waste Disposal	Commodity	WD15	Drill Cuttings	Drum	\$108.15	5	\$540.75
4	Waste Disposal	Commodity	WD25	Primary Mob/Demob	Site	\$287.70	1	\$287.70
10	Initial Site Survey	Consultant	IS05	Coordination of Initial Site Survey (features + well elevations)	Survey	\$117.18	1	\$117.18
10	Initial Site Survey	Commodity	IS15	Initial Survey	Survey	\$1,171.70	1	\$1,171.70
23	Soil And GW Investigation Report		SGIR05	Soil and GW Investigation Report	Report	\$4,965.35	1	\$4,965.35
33	Schedule Of Laboratory Maximums	Commodity		Laboratory (see task 33 total on Lab Schedule)	Lab Schedule		42	\$1,027.27
36	Change Order Request		COR05	Change Order Request (cost cap exceedance requests)	Change Order	\$381.78	1	\$381.78

Variance  
 Variance

**Usual and Customary Standardized Invoice #21**  
**January 2017 - June 2017**



RR-068A

**TOTAL LAB CHARGES      ### TASK 33      42      \$1,027.27      TASK 24      0      \$-**

MATRIX REF CODE	REIMBURSABLE ANALYTE	UNITS	MAX COST	SAMPLES	TOTAL	MAX COST	SAMPLES	TOTAL
AIR A1	Benzene	SAMPLE	\$44.94		\$-			
AIR A2	BETX	SAMPLE	\$49.46		\$-			
AIR A3	GRO	SAMPLE	\$46.10		\$-			
AIR A4	VOC's	SAMPLE	\$71.93		\$-			
WATER W1	GRO/PVOC	SAMPLE	\$29.19		\$-			
WATER W2	PVOC	SAMPLE	\$26.99		\$-			
WATER W3	PVOC + 1,2 DCA	SAMPLE	\$43.79	6	\$262.74			
WATER W4	PVOC + Naphthalene	SAMPLE	\$30.35		\$-			
WATER W5	VOC	SAMPLE	\$71.93	6	\$431.58			
WATER W6	PAH	SAMPLE	\$72.98		\$-			
WATER W7	Lead	SAMPLE	\$12.39	10	\$123.90			
WATER W8	Cadmium	SAMPLE	\$13.55		\$-			
WATER W9	Hardness	SAMPLE	\$12.39		\$-			
WATER W10	BOD, Total	SAMPLE	\$23.63		\$-			
WATER W11	Nitrate	SAMPLE	\$11.24	5	\$56.20			
WATER W12	Total Kjeldahl	SAMPLE	\$20.27		\$-			
WATER W13	Ammonia	SAMPLE	\$16.91		\$-			
WATER W14	Sulfate	SAMPLE	\$10.19	5	\$50.95			
WATER W15	Iron	SAMPLE	\$10.19	5	\$50.95			
WATER W16	Manganese	SAMPLE	\$10.19	5	\$50.95			
WATER W17	Alkalinity	SAMPLE	\$10.19		\$-			
WATER W18	methane	SAMPLE	\$46.10		\$-			
WATER W19	Phosphorous	SAMPLE	\$18.06		\$-			
WATER W20	VOC Method 524.2	SAMPLE	\$176.30		\$-			
WATER W21	EDB Method 504	SAMPLE	\$95.45		\$-			
SOILS S1	GRO	SAMPLE	\$24.78		\$-	\$24.78		\$-
SOILS S2	DRO	SAMPLE	\$30.35		\$-	\$30.35		\$-
SOILS S3	GRO/PVOC	SAMPLE	\$28.14		\$-	\$28.14		\$-
SOILS S4	PVOC	SAMPLE	\$25.83		\$-	\$25.83		\$-
SOILS S5	PVOC + 1,2 DCA + Naphthalene	SAMPLE	\$49.46		\$-	\$49.46		\$-
SOILS S6	PVOC + Naphthalene	SAMPLE	\$36.02		\$-	\$36.02		\$-
SOILS S7	VOC	SAMPLE	\$71.93		\$-	\$71.93		\$-
SOILS S8	SPLP Extraction VOC only	SAMPLE	\$50.61		\$-	\$50.61		\$-
SOILS S9	PAH	SAMPLE	\$72.98		\$-	\$72.98		\$-
SOILS S10	Lead	SAMPLE	\$12.39		\$-	\$12.39		\$-
SOILS S11	Cadmium	SAMPLE	\$14.60		\$-			
SOILS S12	Free Liquid	SAMPLE	\$11.24		\$-			
SOILS S13	Flash Point	SAMPLE	\$25.83		\$-			
SOILS S14	Grain Size - dry	SAMPLE	\$42.74		\$-			
SOILS S15	Grain Size - wet	SAMPLE	\$57.33		\$-			
SOILS S16	Bulk Density	SAMPLE	\$13.55		\$-			
SOILS S17	Permeability	SAMPLE	\$41.58		\$-			
SOILS S18	Nitrogen as Total Kjeldahl	SAMPLE	\$20.27		\$-			
SOILS S19	Nitrogen as Ammonia	SAMPLE	\$16.91		\$-			
SOILS S20	% Organic Matter	SAMPLE	\$29.19		\$-			
SOILS S21	TOC as NPOC	SAMPLE	\$57.33		\$-			
SOILS S22	Soil Moisture Content	SAMPLE	\$6.83		\$-			
SOILS S23	Air Filled Porosity	SAMPLE	\$25.83		\$-			
SOILS S24	% Total Solids	SAMPLE	\$6.83		\$-			
SOILS S25	Field Capacity	SAMPLE	\$28.14		\$-			
SOILS S26	TCLP Lead	SAMPLE	\$83.16		\$-			
SOILS S27	Cation Exchange (Ca, MG, & K)	SAMPLE	\$26.99		\$-			
SOILS S28	TCLP Cadmium	SAMPLE	\$83.16		\$-			
SOILS S29	TCLP Benzene	SAMPLE	\$83.16		\$-			
	Viscosity + Density							
LNAPL LFPS01	Interfacial tension I (LNAPL/water [dyne/	SAMPLE	\$561.33		\$-			
	Interfacial tension II (LNAPL/air [dyne/							
	Interfacial tension III (water/air) [dyne/							

MAX COST	SAMPLES	TOTAL
\$-		
\$24.78		\$-
\$30.35		\$-
\$28.14		\$-
\$25.83		\$-
\$49.46		\$-
\$36.02		\$-
\$71.93		\$-
\$50.61		\$-
\$72.98		\$-
\$12.39		\$-
<b>TASK 24 TOTAL</b>		<b>\$-</b>

**TASK 33 TOTAL      \$1,027.27**