



Excellence through experience™

709 Gillette St., Ste #3 ♦ La Crosse, WI 54603 ♦ 1-800-552-2932 ♦ Fax (608) 781-8893 Email: rona@metcohq.com ♦ www.metcohq.com

June 6, 2019

Tom Verstegen
Wisconsin Department of Natural Resources
625 E. County Road Y, Suite #700
Oshkosh, WI 54901

Subject: Korth Property – Bid Deferment Request for Additional Soil, Groundwater, and Sub-Slab Vapor Sampling. BRRTS #: 03-45-002078, PECFA #: 54914-3412-29

Dear Mr. Verstegen,

A bid deferment request (using Usual & Customary schedule of charges) is being submitted for the subject property located at 1629 W. Washington Street in Appleton, Wisconsin. This includes: [1] Geoprobe Project which will consist of three Geoprobe borings to 4 feet bgs with one soil sample collected per boring for laboratory analysis (PVOC+Naphthalene at ~3 feet bgs Two will be conducted within the footprint of the source property building and one west of G-19 at 1713 W. Washington Street. [2] Conduct one round of groundwater monitoring from all site wells (6 total). Sample MW-1 for PVOC and PAH analysis, MW-4 for VOC analysis, and MW-2, -3, -5, and -6 for PVOC+Naphthalene. [3] Install and collect three sub-slab vapor samples from within the source property building for TO-15 (PVOC+Naphthalene) analysis Investigative waste disposal. [4] Complete a neighbor notification for 116 N. Linwood Avenue and [5] Letter Report. The cost estimate is as follows:

Access Agreement	\$ 401.94
Geoprobe Project	\$1,344.77
Groundwater Monitoring (1 Round)	\$1,125.62
Laboratory Analysis	\$ 509.31
Sub Slab Vapor Sampling	\$2,344.73
Letter Report	\$1,039.29
Neighbor Notification	\$ 222.71
Change Order Request	\$ 381.78
Total	\$7,370.15

METCO is requesting bid deferment in the amount of \$7,370.15 to complete the above

activities. Once the above work and associated costs are approved, METCO will proceed with the project.

Attached are a site map with proposed Geoprobe boring locations, Sub Slab Vapor Sample locations, and draft standardized invoice form for the work scope as required.

Should you have any questions, comments, or recommendations please contact me at our La Crosse office (608) 781-8879 or email at jasonp@metcohq.com

Sincerely,

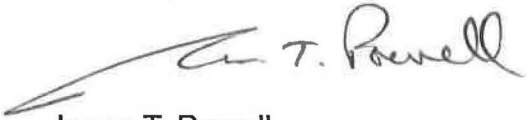
A handwritten signature in black ink that reads "Jason T. Powell". The signature is written in a cursive style with a long, sweeping underline that extends to the left.

Jason T. Powell
Staff Scientist

Attachments

c: Robert Korth – Client

B.I.B. DETAILED SITE MAP

KORTH PROPERTY

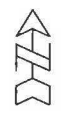

NOTE: INFORMATION BASED ON AVAILABLE DATA. ACTUAL CONDITIONS MAY DIFFER.

- GEOPROBE BORING LOCATION
- ⊕ MONITORING WELL LOCATION
- ▲ PROPOSED GEOPROBE BORING LOCATION
- PROPOSED SSVS LOCATION
- FIRE HYDRANT
- UTILITY POLE
- STORM DRAIN

- A - FORMER PUMP HOUSE - 1970 SANBORN MAP
- B - FORMER GASOLINE TANKS - 1970 SANBORN MAP
- C - APPROXIMATE LOCATION OF REMOVED 20,000-GALLON FUEL OIL UST

- PROPERTY BOUNDARIES: ———
- WATER LINE: ———
- SANITARY SEWER: ———
- STORM SEWER: ———
- NATURAL GAS: ———
- TELEPHONE/CABLE: - - - - -
- BURIED ELECTRIC LINE: ———
- FENCE: x x x x x x x x x x x x x x x x
- OVERHEAD UTILITIES: ———

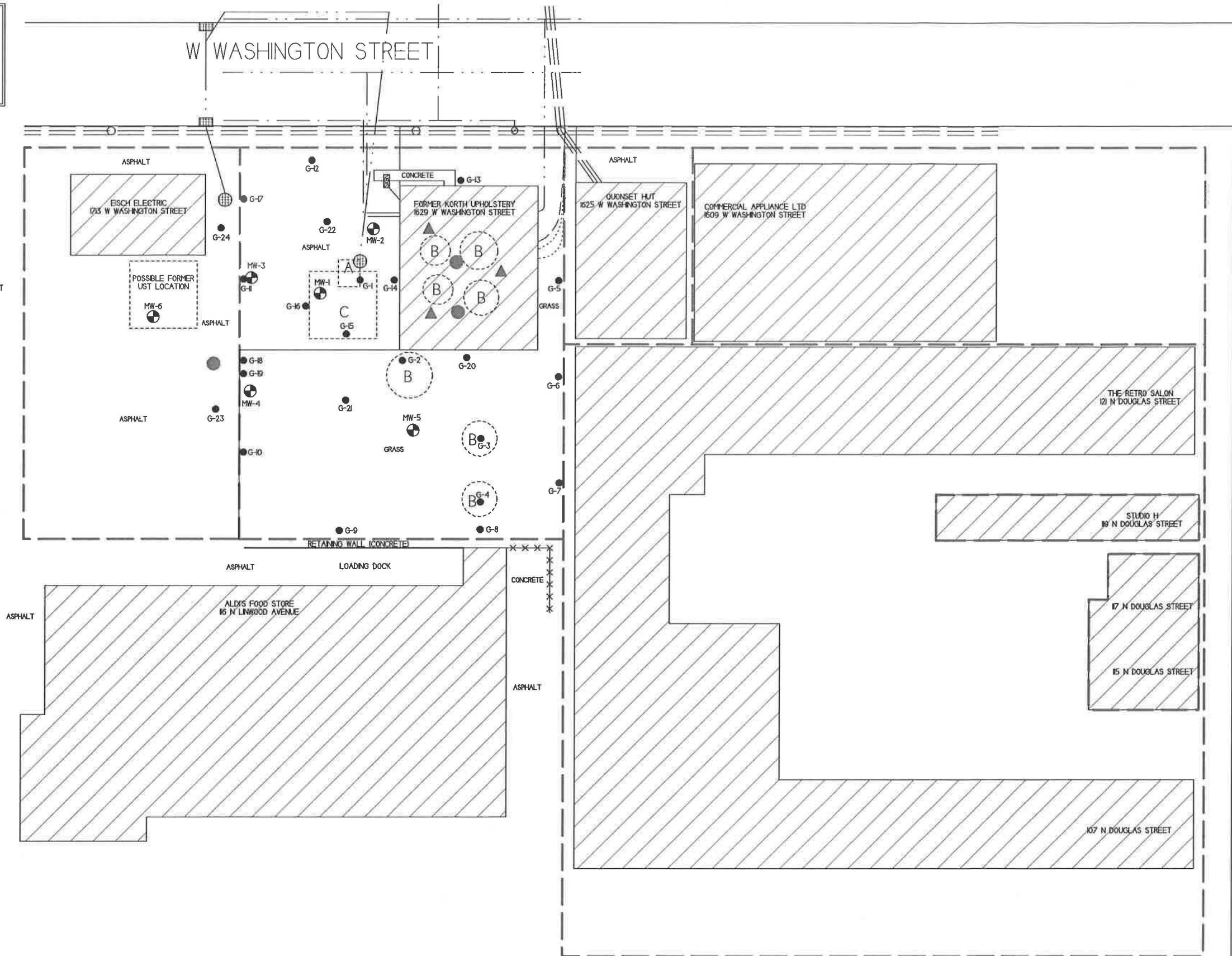

N DOUGLAS STREET

Usual and Customary Standardized Invoice #25

January 2019 - June 2019 (updated 2/25/19)



PECFA #: 54914-3412-29
 BRRTS #: 03-45-002078
 Site Name: Korth Property
 Site Address: 1629 W. Washington St., Appleton, WI

Vendor Name: _____
 Invoice #: _____
 Invoice Date: _____
 Check #: _____

U&C Total \$ 7,370.15
 Variance to U&C Total \$ -
 Grand Total \$ 7,370.15

TASK	TASK DESCRIPTION	SERVICES	ACTIVITY CODE	ACTIVITY REFERENCE CODE DESCRIPTION	UNIT	MAX UNIT COST	UNITS	TOTAL MAX
1	GW Sampling		GS05	Sample Collection	Well	\$ 72.45	6	\$ 434.70
1	GW Sampling		GS25	Primary Mob/Demob	Site	\$ 690.92	1	\$ 690.92
5	Closure Request		CR20	Continuing Obligation Packet Submittal (For off-site Properties only)	Per Additional Property	\$ 222.71	1	\$ 222.71
6	Letter Report/Addendum		LRA05	Letter Report/Addendum	Letter	\$ 1,039.29	1	\$ 1,039.29
12	Direct Push	Consultant	DP05	0 - 24 ft bgs W/ Continuous Soil Sampling	Ft	\$ 5.36	12	\$ 64.32
12	Direct Push	Consultant	DP30	Primary Mob/Demob	Site	\$ 563.31	1	\$ 563.31
12	Direct Push	Commodity	DP35	0 - 24 ft bgs W/ Continuous Soil Sampling	Ft	\$ 6.93	12	\$ 83.16
12	Direct Push	Commodity	DP60	Borehole Abandonment	Ft	\$ 1.26	12	\$ 15.12
12	Direct Push	Commodity	DP65	Concrete Penetration	Each	\$ 20.10	2	\$ 40.20
12	Direct Push	Commodity	DP80	Mob/Demob (Includes decon)	Site	\$ 578.66	1	\$ 578.66
21	Access Agreements		AA05	Access Agreements	Property	\$ 401.94	1	\$ 401.94
33	Schedule Of Laboratory Maximums	Commodity		Laboratory (see task 33 total on Lab Schedule)	Lab Schedule			\$ 509.31
36	Change Order Request		COR05	Change Order Request (cost cap exceedance requests)	Change Order	\$ 381.78	1	\$ 381.78
37	Vapor Point Installation & Sampling		VIS05	Installation & Sampling (up to 5 points)	Point	\$ 510.26	3	\$ 1,530.78
37	Vapor Point Installation & Sampling		VIS10	Mob/Demob (up to 5 points)	Site	\$ 813.95	1	\$ 813.95

Usual and Customary Standardized Invoice #25

January 2019 - June 2019



RR-107a

TOTAL LAB CHARGES \$ 509.31 TASK 33 12 \$ 509.31 TASK 24 0 \$ -

MATRIX	REF CODE	REIMBURSABLE ANALYTE	UNITS	MAX COST	SAMPLES	TOTAL	MAX COST	SAMPLES	TOTAL
AIR	A1	Benzene	SAMPLE	\$ 44.94		\$ -			
AIR	A2	BETX	SAMPLE	\$ 49.46		\$ -			
AIR	A3	GRO	SAMPLE	\$ 46.10		\$ -			
AIR	A4	VOC's	SAMPLE	\$ 71.93		\$ -			
WATER	W1	GRO/PVOC	SAMPLE	\$ 29.19		\$ -			
WATER	W2	PVOC	SAMPLE	\$ 26.99	1	\$ 26.99			
WATER	W3	PVOC + 1,2 DCA	SAMPLE	\$ 43.79		\$ -			
WATER	W4	PVOC + Naphthalene	SAMPLE	\$ 30.35	4	\$ 121.40			
WATER	W5	VOC	SAMPLE	\$ 71.93	2	\$ 143.86			
WATER	W6	PAH	SAMPLE	\$ 72.98	1	\$ 72.98			
WATER	W7	Lead	SAMPLE	\$ 12.39		\$ -			
WATER	W8	Cadmium	SAMPLE	\$ 13.55		\$ -			
WATER	W9	Hardness	SAMPLE	\$ 12.39		\$ -			
WATER	W10	BOD, Total	SAMPLE	\$ 23.63		\$ -			
WATER	W11	Nitrate	SAMPLE	\$ 11.24		\$ -			
WATER	W12	Total Kjeldahl	SAMPLE	\$ 20.27		\$ -			
WATER	W13	Ammonia	SAMPLE	\$ 16.91		\$ -			
WATER	W14	Sulfate	SAMPLE	\$ 10.19		\$ -			
WATER	W15	Iron	SAMPLE	\$ 10.19		\$ -			
WATER	W16	Manganese	SAMPLE	\$ 10.19		\$ -			
WATER	W17	Alkalinity	SAMPLE	\$ 10.19		\$ -			
WATER	W18	methane	SAMPLE	\$ 46.10		\$ -			
WATER	W19	Phosphorous	SAMPLE	\$ 18.06		\$ -			
WATER	W20	VOC Method 524.2	SAMPLE	\$ 176.30		\$ -			
WATER	W21	EDB Method 504	SAMPLE	\$ 95.45		\$ -	MAX COST	SAMPLES	TOTAL
SOILS	S1	GRO	SAMPLE	\$ 24.78		\$ -	\$ 24.78		\$ -
SOILS	S2	DRO	SAMPLE	\$ 30.35		\$ -	\$ 30.35		\$ -
SOILS	S3	GRO/PVOC	SAMPLE	\$ 28.14		\$ -	\$ 28.14		\$ -
SOILS	S4	PVOC	SAMPLE	\$ 25.83		\$ -	\$ 25.83		\$ -
SOILS	S5	PVOC + 1,2 DCA + Naphthalene	SAMPLE	\$ 49.46		\$ -	\$ 49.46		\$ -
SOILS	S6	PVOC + Naphthalene	SAMPLE	\$ 36.02	4	\$ 144.08	\$ 36.02		\$ -
SOILS	S7	VOC	SAMPLE	\$ 71.93		\$ -	\$ 71.93		\$ -
SOILS	S8	SPLP Extraction VOC only	SAMPLE	\$ 50.61		\$ -	\$ 50.61		\$ -
SOILS	S9	PAH	SAMPLE	\$ 72.98		\$ -	\$ 72.98		\$ -
SOILS	S10	Lead	SAMPLE	\$ 12.39		\$ -	\$ 12.39		\$ -
SOILS	S11	Cadmium	SAMPLE	\$ 14.60		\$ -			
SOILS	S12	Free Liquid	SAMPLE	\$ 11.24		\$ -			
SOILS	S13	Flash Point	SAMPLE	\$ 25.83		\$ -			
SOILS	S14	Grain Size - dry	SAMPLE	\$ 42.74		\$ -			
SOILS	S15	Grain Size - wet	SAMPLE	\$ 57.33		\$ -			
SOILS	S16	Bulk Density	SAMPLE	\$ 13.55		\$ -			
SOILS	S17	Permeability	SAMPLE	\$ 41.58		\$ -			
SOILS	S18	Nitrogen as Total Kjeldahl	SAMPLE	\$ 20.27		\$ -			
SOILS	S19	Nitrogen as Ammonia	SAMPLE	\$ 16.91		\$ -			
SOILS	S20	% Organic Matter	SAMPLE	\$ 29.19		\$ -			
SOILS	S21	TOC as NPOC	SAMPLE	\$ 57.33		\$ -			
SOILS	S22	Soil Moisture Content	SAMPLE	\$ 6.83		\$ -			
SOILS	S23	Air Filled Porosity	SAMPLE	\$ 25.83		\$ -			
SOILS	S24	% Total Solids	SAMPLE	\$ 6.83		\$ -			
SOILS	S25	Field Capacity	SAMPLE	\$ 28.14		\$ -			
SOILS	S26	TCLP Lead	SAMPLE	\$ 83.16		\$ -			
SOILS	S27	Cation Exchange (Ca, MG, & K)	SAMPLE	\$ 26.99		\$ -			
SOILS	S28	TCLP Cadmium	SAMPLE	\$ 83.16		\$ -			
SOILS	S29	TCLP Benzene	SAMPLE	\$ 83.16		\$ -			
		Viscosity + Density							
LNAPL	LFPS01	Interfacial tension I (LNAPL/water [dyne/cm])	SAMPLE	\$ 561.33		\$ -			
		Interfacial tension II (LNAPL/air [dyne/cm])							
		Interfacial tension III (water/air) [dyne/cm]							
						TASK 33 TOTAL \$	509.31		

MAX COST	SAMPLES	TOTAL
\$ 24.78		\$ -
\$ 30.35		\$ -
\$ 28.14		\$ -
\$ 25.83		\$ -
\$ 49.46		\$ -
\$ 36.02		\$ -
\$ 71.93		\$ -
\$ 50.61		\$ -
\$ 72.98		\$ -
\$ 12.39		\$ -
TASK 24 TOTAL \$ -		