



May 9, 2018

Jennifer Borski
Wisconsin Department of Natural Resources
625 E. County Rd Y, Suite 700
Oshkosh, WI 54901

**Re: Remedial Action Plan Response
Former Barb and Ron's Cleaners
1700 Lawe Street
Appleton, Wisconsin 54915
BRRTS#: 02-45-297744**

Dear Ms. Borski:

Thank you for approving the Remedial Action Plan (RAP) dated January 29, 2018. The excavation is proposed to take place starting May 14, 2018. Monitoring well MW4100 will be reinstalled on June 4, 2018.

In your response to the submittal of the RAP, you requested that all media excavated at the site should be characterized for proper disposal. The concrete slab was sampled during January 2017. The sampling concluded that the concrete cannot be recycled and will need to go to a landfill. The laboratory report for the slab samples is attached. The building foundation will be sampled once exposed during excavation activities.

You also requested the results of the pre-excavation groundwater samples. The sampling locations are depicted on the attached **Figure 1**. The results of the groundwater samples are summarized and compared to WDNR standards on the attached **Table 1**. A copy of the laboratory report that relates to the groundwater samples is also attached.

Responses to the comments regarding the investigation status will be provided with the remedial documentation. If you have any additional questions or comments, we can be reached by telephone at 262.510.0612 or by email at rhoverman@enviroforensics.com or kheimstead@enviroforensics.com.

Sincerely,
EnviroForensics, LLC

Handwritten signature of Robert Hoverman in blue ink.

Robert Hoverman, PG
Senior Project Manager

Handwritten signature of Kyle Heimstead in blue ink.

Kyle Heimstead
Project Manager

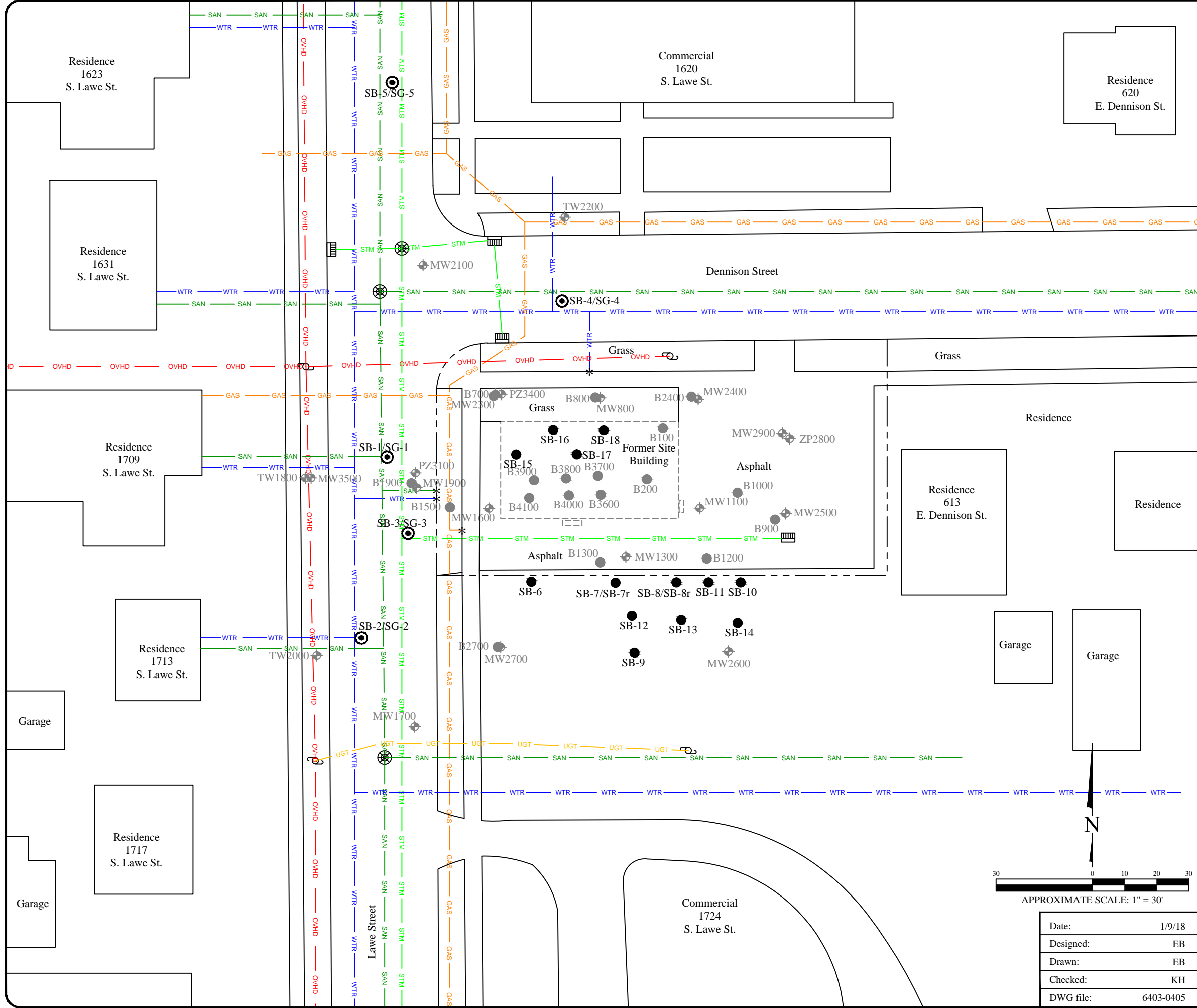

Legend

- Property boundary
- Underground gas utility line
- Underground water utility line
- Underground sanitary utility line
- Underground telephone line
- Underground storm utility line
- Over head electrical utility line
- Underground electrical utility line
- Utility Pole
- Catch Basin
- Manhole
- Monitoring well location (By Others)
- Soil boring location (By Others)
- Soil boring location
- Soil gas sample

Note:
 1. * = utilities abandoned during building demolition

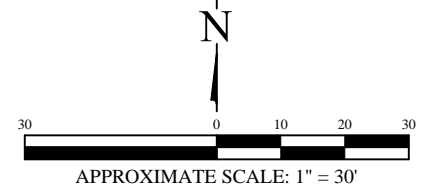

SITE PLAN

Former Barb and Ron's Cleaners
 1700 South Lawe Street
 Appleton, Wisconsin

Date: 1/9/18 Designed: EB Drawn: EB Checked: KH DWG file: 6403-0405	<p style="font-size: small;">825 North Capitol Avenue • Indianapolis, IN 46204 EnviroForensics.com</p>
Figure <div style="text-align: center; font-size: 24px; font-weight: bold;">1</div> Project <div style="text-align: center; font-size: 24px; font-weight: bold;">6403</div>	

TABLE 1
MONITORING WELL SAMPLE ANALYTICAL RESULTS

Former Barb and Ron's Cleaners
1700 S. Lawe Street, Appleton, Wisconsin

Monitoring Well Identification	Sample Date	Consultant	Tetrachloroethene	Trichloroethene	cis-1,2-Dichloroethene	trans-1,2-Dichloroethene	Vinyl Chloride
			Volatile Organic Compounds (VOC)				
Public Health Enforcement Standard			5	5	70	100	0.2
Public Health Preventive Action Limit			0.5	0.5	7	20	0.02
MW 800	12/01/17	EnviroForensics	1.0 J	<0.45	<0.41	<0.35	<0.19
MW 1100	12/01/17		10.1	0.63 J	<0.41	<0.35	<0.19
MW 1300	12/01/17		10	<0.45	<0.41	<0.35	<0.19
MW 1600	12/01/17		302	13 J	5.4 J	<3.5	<1.9
MW 2300	12/01/17		4.6	<0.45	<0.41	<0.35	<0.19
MW 4100	12/01/17		7,800	250	142	<17.5	<9.5

Notes:

All concentrations reported in units of micrograms per liter (µg/l)

Only detected compounds are listed

Samples analyzed according to US EPA Method 8260

Bolded values are above detection limits

Bolded and Orange Shaded values indicates an exceedance of the Public Health Enforcement Standard

Bolded and Blue Shaded values indicates an exceedance the Public Health Preventive Action Limit

J = Analyte concentration detected between the laboratory Reporting Limit and the laboratory Method Detection Limit

Synergy Environmental Lab, INC.

1990 Prospect Ct., Appleton, WI 54914 *P 920-830-2455 * F 920-733-0631

KYLE VANDERHEIDEN
ENVIROFORENSICS
602 N. CAPITOL AVENUE
INDIANAPOLIS, IN 46204

Report Date 07-Feb-17

Project Name BARB&RON'S CLEANERS
Project # 6403 PO#2017-0148

Invoice # E32423

Lab Code 5032423A
Sample ID 6403-SLAB-1
Sample Matrix Soil
Sample Date 1/31/2017

	Result	Unit	LOD	LOQ	Dil	Method	Ext Date	Run Date	Analyst	Code
General										
General										
Solids Percent	85.7	%			1	5021		2/2/2017	NJC	1
Organic										
VOC's										
Benzene	< 0.03	mg/kg	0.03	0.96	1	8260B		2/3/2017	CJR	1
Bromobenzene	< 0.025	mg/kg	0.025	0.081	1	8260B		2/3/2017	CJR	1
Bromodichloromethane	< 0.074	mg/kg	0.074	0.24	1	8260B		2/3/2017	CJR	1
Bromoform	< 0.029	mg/kg	0.029	0.092	1	8260B		2/3/2017	CJR	1
tert-Butylbenzene	< 0.026	mg/kg	0.026	0.084	1	8260B		2/3/2017	CJR	1
sec-Butylbenzene	< 0.033	mg/kg	0.033	0.1	1	8260B		2/3/2017	CJR	1
n-Butylbenzene	0.065 "J"	mg/kg	0.04	0.13	1	8260B		2/3/2017	CJR	1
Carbon Tetrachloride	< 0.016	mg/kg	0.016	0.053	1	8260B		2/3/2017	CJR	1
Chlorobenzene	< 0.013	mg/kg	0.013	0.04	1	8260B		2/3/2017	CJR	1
Chloroethane	< 0.091	mg/kg	0.091	0.29	1	8260B		2/3/2017	CJR	1
Chloroform	< 0.035	mg/kg	0.035	0.11	1	8260B		2/3/2017	CJR	1
Chloromethane	< 0.076	mg/kg	0.076	0.24	1	8260B		2/3/2017	CJR	1
2-Chlorotoluene	< 0.015	mg/kg	0.015	0.047	1	8260B		2/3/2017	CJR	1
4-Chlorotoluene	< 0.018	mg/kg	0.018	0.057	1	8260B		2/3/2017	CJR	1
1,2-Dibromo-3-chloropropane	< 0.058	mg/kg	0.058	0.18	1	8260B		2/3/2017	CJR	1
Dibromochloromethane	< 0.025	mg/kg	0.025	0.079	1	8260B		2/3/2017	CJR	1
1,4-Dichlorobenzene	< 0.037	mg/kg	0.037	0.12	1	8260B		2/3/2017	CJR	1
1,3-Dichlorobenzene	< 0.037	mg/kg	0.037	0.12	1	8260B		2/3/2017	CJR	1
1,2-Dichlorobenzene	< 0.028	mg/kg	0.028	0.088	1	8260B		2/3/2017	CJR	1
Dichlorodifluoromethane	< 0.048	mg/kg	0.048	0.15	1	8260B		2/3/2017	CJR	1
1,2-Dichloroethane	< 0.038	mg/kg	0.038	0.12	1	8260B		2/3/2017	CJR	1
1,1-Dichloroethane	< 0.034	mg/kg	0.034	0.11	1	8260B		2/3/2017	CJR	1
1,1-Dichloroethene	< 0.022	mg/kg	0.022	0.069	1	8260B		2/3/2017	CJR	1
cis-1,2-Dichloroethene	< 0.032	mg/kg	0.032	0.1	1	8260B		2/3/2017	CJR	1
trans-1,2-Dichloroethene	< 0.028	mg/kg	0.028	0.09	1	8260B		2/3/2017	CJR	1

Project Name BARB&RON'S CLEANERS
Project # 6403 PO#2017-0148

Invoice # E32423

Lab Code 5032423A
Sample ID 6403-SLAB-1
Sample Matrix Soil
Sample Date 1/31/2017

	Result	Unit	LOD	LOQ	Dil	Method	Ext Date	Run Date	Analyst	Code
1,2-Dichloropropane	< 0.035	mg/kg	0.035	0.11	1	8260B		2/3/2017	CJR	1
2,2-Dichloropropane	< 0.037	mg/kg	0.037	0.12	1	8260B		2/3/2017	CJR	1
1,3-Dichloropropane	< 0.025	mg/kg	0.025	0.079	1	8260B		2/3/2017	CJR	1
Di-isopropyl ether	< 0.01	mg/kg	0.01	0.032	1	8260B		2/3/2017	CJR	1
EDB (1,2-Dibromoethane)	< 0.023	mg/kg	0.023	0.072	1	8260B		2/3/2017	CJR	1
Ethylbenzene	< 0.035	mg/kg	0.035	0.11	1	8260B		2/3/2017	CJR	1
Hexachlorobutadiene	< 0.085	mg/kg	0.085	0.27	1	8260B		2/3/2017	CJR	1
Isopropylbenzene	< 0.034	mg/kg	0.034	0.11	1	8260B		2/3/2017	CJR	1
p-Isopropyltoluene	< 0.029	mg/kg	0.029	0.093	1	8260B		2/3/2017	CJR	1
Methylene chloride	< 0.15	mg/kg	0.15	0.46	1	8260B		2/3/2017	CJR	1
Methyl tert-butyl ether (MTBE)	< 0.05	mg/kg	0.05	0.16	1	8260B		2/3/2017	CJR	1
Naphthalene	0.20 "J"	mg/kg	0.094	0.3	1	8260B		2/3/2017	CJR	1
n-Propylbenzene	< 0.033	mg/kg	0.033	0.1	1	8260B		2/3/2017	CJR	1
1,1,2,2-Tetrachloroethane	< 0.028	mg/kg	0.028	0.88	1	8260B		2/3/2017	CJR	1
1,1,1,2-Tetrachloroethane	< 0.028	mg/kg	0.028	0.09	1	8260B		2/3/2017	CJR	1
Tetrachloroethene	0.135	mg/kg	0.032	0.1	1	8260B		2/3/2017	CJR	1
Toluene	0.040 "J"	mg/kg	0.032	0.1	1	8260B		2/3/2017	CJR	1
1,2,4-Trichlorobenzene	< 0.064	mg/kg	0.064	0.2	1	8260B		2/3/2017	CJR	1
1,2,3-Trichlorobenzene	< 0.066	mg/kg	0.066	0.21	1	8260B		2/3/2017	CJR	1
1,1,1-Trichloroethane	< 0.03	mg/kg	0.03	0.96	1	8260B		2/3/2017	CJR	1
1,1,2-Trichloroethane	< 0.033	mg/kg	0.033	0.11	1	8260B		2/3/2017	CJR	1
Trichloroethene (TCE)	< 0.041	mg/kg	0.041	0.13	1	8260B		2/3/2017	CJR	1
Trichlorofluoromethane	< 0.041	mg/kg	0.041	0.13	1	8260B		2/3/2017	CJR	1
1,2,4-Trimethylbenzene	0.228	mg/kg	0.025	0.08	1	8260B		2/3/2017	CJR	1
1,3,5-Trimethylbenzene	0.061 "J"	mg/kg	0.032	0.1	1	8260B		2/3/2017	CJR	1
Vinyl Chloride	< 0.019	mg/kg	0.019	0.062	1	8260B		2/3/2017	CJR	1
m&p-Xylene	0.105 "J"	mg/kg	0.072	0.23	1	8260B		2/3/2017	CJR	1
o-Xylene	< 0.044	mg/kg	0.044	0.14	1	8260B		2/3/2017	CJR	1
SUR - Toluene-d8	101	Rec %			1	8260B		2/3/2017	CJR	1
SUR - 1,2-Dichloroethane-d4	104	Rec %			1	8260B		2/3/2017	CJR	1
SUR - 4-Bromofluorobenzene	105	Rec %			1	8260B		2/3/2017	CJR	1
SUR - Dibromofluoromethane	98	Rec %			1	8260B		2/3/2017	CJR	1

Project Name BARB&RON'S CLEANERS
Project # 6403 PO#2017-0148

Invoice # E32423

Lab Code 5032423B
Sample ID 6403-SLAB-2
Sample Matrix Soil
Sample Date 1/31/2017

	Result	Unit	LOD	LOQ	Dil	Method	Ext Date	Run Date	Analyst	Code
General										
General										
Solids Percent	88.9	%			1	5021		2/2/2017	NJC	1
Organic										
VOC's										
Benzene	< 0.03	mg/kg	0.03	0.96	1	8260B		2/3/2017	CJR	1
Bromobenzene	< 0.025	mg/kg	0.025	0.081	1	8260B		2/3/2017	CJR	1
Bromodichloromethane	< 0.074	mg/kg	0.074	0.24	1	8260B		2/3/2017	CJR	1
Bromoform	< 0.029	mg/kg	0.029	0.092	1	8260B		2/3/2017	CJR	1
tert-Butylbenzene	< 0.026	mg/kg	0.026	0.084	1	8260B		2/3/2017	CJR	1
sec-Butylbenzene	< 0.033	mg/kg	0.033	0.1	1	8260B		2/3/2017	CJR	1
n-Butylbenzene	< 0.04	mg/kg	0.04	0.13	1	8260B		2/3/2017	CJR	1
Carbon Tetrachloride	< 0.016	mg/kg	0.016	0.053	1	8260B		2/3/2017	CJR	1
Chlorobenzene	< 0.013	mg/kg	0.013	0.04	1	8260B		2/3/2017	CJR	1
Chloroethane	< 0.091	mg/kg	0.091	0.29	1	8260B		2/3/2017	CJR	1
Chloroform	< 0.035	mg/kg	0.035	0.11	1	8260B		2/3/2017	CJR	1
Chloromethane	< 0.076	mg/kg	0.076	0.24	1	8260B		2/3/2017	CJR	1
2-Chlorotoluene	< 0.015	mg/kg	0.015	0.047	1	8260B		2/3/2017	CJR	1
4-Chlorotoluene	< 0.018	mg/kg	0.018	0.057	1	8260B		2/3/2017	CJR	1
1,2-Dibromo-3-chloropropane	< 0.058	mg/kg	0.058	0.18	1	8260B		2/3/2017	CJR	1
Dibromochloromethane	< 0.025	mg/kg	0.025	0.079	1	8260B		2/3/2017	CJR	1
1,4-Dichlorobenzene	< 0.037	mg/kg	0.037	0.12	1	8260B		2/3/2017	CJR	1
1,3-Dichlorobenzene	< 0.037	mg/kg	0.037	0.12	1	8260B		2/3/2017	CJR	1
1,2-Dichlorobenzene	< 0.028	mg/kg	0.028	0.088	1	8260B		2/3/2017	CJR	1
Dichlorodifluoromethane	< 0.048	mg/kg	0.048	0.15	1	8260B		2/3/2017	CJR	1
1,2-Dichloroethane	< 0.038	mg/kg	0.038	0.12	1	8260B		2/3/2017	CJR	1
1,1-Dichloroethane	< 0.034	mg/kg	0.034	0.11	1	8260B		2/3/2017	CJR	1
1,1-Dichloroethene	< 0.022	mg/kg	0.022	0.069	1	8260B		2/3/2017	CJR	1
cis-1,2-Dichloroethene	< 0.032	mg/kg	0.032	0.1	1	8260B		2/3/2017	CJR	1
trans-1,2-Dichloroethene	< 0.028	mg/kg	0.028	0.09	1	8260B		2/3/2017	CJR	1
1,2-Dichloropropane	< 0.035	mg/kg	0.035	0.11	1	8260B		2/3/2017	CJR	1
2,2-Dichloropropane	< 0.037	mg/kg	0.037	0.12	1	8260B		2/3/2017	CJR	1
1,3-Dichloropropane	< 0.025	mg/kg	0.025	0.079	1	8260B		2/3/2017	CJR	1
Di-isopropyl ether	< 0.01	mg/kg	0.01	0.032	1	8260B		2/3/2017	CJR	1
EDB (1,2-Dibromoethane)	< 0.023	mg/kg	0.023	0.072	1	8260B		2/3/2017	CJR	1
Ethylbenzene	< 0.035	mg/kg	0.035	0.11	1	8260B		2/3/2017	CJR	1
Hexachlorobutadiene	< 0.085	mg/kg	0.085	0.27	1	8260B		2/3/2017	CJR	1
Isopropylbenzene	< 0.034	mg/kg	0.034	0.11	1	8260B		2/3/2017	CJR	1
p-Isopropyltoluene	< 0.029	mg/kg	0.029	0.093	1	8260B		2/3/2017	CJR	1
Methylene chloride	< 0.15	mg/kg	0.15	0.46	1	8260B		2/3/2017	CJR	1
Methyl tert-butyl ether (MTBE)	< 0.05	mg/kg	0.05	0.16	1	8260B		2/3/2017	CJR	1
Naphthalene	0.104 "J"	mg/kg	0.094	0.3	1	8260B		2/3/2017	CJR	1
n-Propylbenzene	< 0.033	mg/kg	0.033	0.1	1	8260B		2/3/2017	CJR	1
1,1,2,2-Tetrachloroethane	< 0.028	mg/kg	0.028	0.88	1	8260B		2/3/2017	CJR	1
1,1,1,2-Tetrachloroethane	< 0.028	mg/kg	0.028	0.09	1	8260B		2/3/2017	CJR	1
Tetrachloroethene	< 0.032	mg/kg	0.032	0.1	1	8260B		2/3/2017	CJR	1
Toluene	< 0.032	mg/kg	0.032	0.1	1	8260B		2/3/2017	CJR	1
1,2,4-Trichlorobenzene	< 0.064	mg/kg	0.064	0.2	1	8260B		2/3/2017	CJR	1
1,2,3-Trichlorobenzene	< 0.066	mg/kg	0.066	0.21	1	8260B		2/3/2017	CJR	1
1,1,1-Trichloroethane	< 0.03	mg/kg	0.03	0.96	1	8260B		2/3/2017	CJR	1
1,1,2-Trichloroethane	< 0.033	mg/kg	0.033	0.11	1	8260B		2/3/2017	CJR	1

Project Name BARB&RON'S CLEANERS
Project # 6403 PO#2017-0148

Invoice # E32423

Lab Code 5032423B
Sample ID 6403-SLAB-2
Sample Matrix Soil
Sample Date 1/31/2017

	Result	Unit	LOD	LOQ	Dil	Method	Ext Date	Run Date	Analyst	Code
Trichloroethene (TCE)	< 0.041	mg/kg	0.041	0.13	1	8260B		2/3/2017	CJR	1
Trichlorofluoromethane	< 0.041	mg/kg	0.041	0.13	1	8260B		2/3/2017	CJR	1
1,2,4-Trimethylbenzene	0.058 "J"	mg/kg	0.025	0.08	1	8260B		2/3/2017	CJR	1
1,3,5-Trimethylbenzene	< 0.032	mg/kg	0.032	0.1	1	8260B		2/3/2017	CJR	1
Vinyl Chloride	< 0.019	mg/kg	0.019	0.062	1	8260B		2/3/2017	CJR	1
m&p-Xylene	< 0.072	mg/kg	0.072	0.23	1	8260B		2/3/2017	CJR	1
o-Xylene	< 0.044	mg/kg	0.044	0.14	1	8260B		2/3/2017	CJR	1
SUR - Dibromofluoromethane	95	Rec %			1	8260B		2/3/2017	CJR	1
SUR - 1,2-Dichloroethane-d4	100	Rec %			1	8260B		2/3/2017	CJR	1
SUR - 4-Bromofluorobenzene	108	Rec %			1	8260B		2/3/2017	CJR	1
SUR - Toluene-d8	100	Rec %			1	8260B		2/3/2017	CJR	1

Project Name BARB&RON'S CLEANERS
Project # 6403 PO#2017-0148

Invoice # E32423

Lab Code 5032423C
Sample ID 6403-SLAB-3
Sample Matrix Soil
Sample Date 1/31/2017

	Result	Unit	LOD	LOQ	Dil	Method	Ext Date	Run Date	Analyst	Code
General										
General										
Solids Percent	92.2	%			1	5021		2/2/2017	NJC	1
Organic										
VOC's										
Benzene	< 0.03	mg/kg	0.03	0.96	1	8260B		2/3/2017	CJR	1
Bromobenzene	< 0.025	mg/kg	0.025	0.081	1	8260B		2/3/2017	CJR	1
Bromodichloromethane	< 0.074	mg/kg	0.074	0.24	1	8260B		2/3/2017	CJR	1
Bromoform	< 0.029	mg/kg	0.029	0.092	1	8260B		2/3/2017	CJR	1
tert-Butylbenzene	< 0.026	mg/kg	0.026	0.084	1	8260B		2/3/2017	CJR	1
sec-Butylbenzene	< 0.033	mg/kg	0.033	0.1	1	8260B		2/3/2017	CJR	1
n-Butylbenzene	< 0.04	mg/kg	0.04	0.13	1	8260B		2/3/2017	CJR	1
Carbon Tetrachloride	< 0.016	mg/kg	0.016	0.053	1	8260B		2/3/2017	CJR	1
Chlorobenzene	< 0.013	mg/kg	0.013	0.04	1	8260B		2/3/2017	CJR	1
Chloroethane	< 0.091	mg/kg	0.091	0.29	1	8260B		2/3/2017	CJR	1
Chloroform	< 0.035	mg/kg	0.035	0.11	1	8260B		2/3/2017	CJR	1
Chloromethane	< 0.076	mg/kg	0.076	0.24	1	8260B		2/3/2017	CJR	1
2-Chlorotoluene	< 0.015	mg/kg	0.015	0.047	1	8260B		2/3/2017	CJR	1
4-Chlorotoluene	< 0.018	mg/kg	0.018	0.057	1	8260B		2/3/2017	CJR	1
1,2-Dibromo-3-chloropropane	< 0.058	mg/kg	0.058	0.18	1	8260B		2/3/2017	CJR	1
Dibromochloromethane	< 0.025	mg/kg	0.025	0.079	1	8260B		2/3/2017	CJR	1
1,4-Dichlorobenzene	< 0.037	mg/kg	0.037	0.12	1	8260B		2/3/2017	CJR	1
1,3-Dichlorobenzene	< 0.037	mg/kg	0.037	0.12	1	8260B		2/3/2017	CJR	1
1,2-Dichlorobenzene	< 0.028	mg/kg	0.028	0.088	1	8260B		2/3/2017	CJR	1
Dichlorodifluoromethane	< 0.048	mg/kg	0.048	0.15	1	8260B		2/3/2017	CJR	1
1,2-Dichloroethane	< 0.038	mg/kg	0.038	0.12	1	8260B		2/3/2017	CJR	1
1,1-Dichloroethane	< 0.034	mg/kg	0.034	0.11	1	8260B		2/3/2017	CJR	1
1,1-Dichloroethene	< 0.022	mg/kg	0.022	0.069	1	8260B		2/3/2017	CJR	1
cis-1,2-Dichloroethene	< 0.032	mg/kg	0.032	0.1	1	8260B		2/3/2017	CJR	1
trans-1,2-Dichloroethene	< 0.028	mg/kg	0.028	0.09	1	8260B		2/3/2017	CJR	1
1,2-Dichloropropane	< 0.035	mg/kg	0.035	0.11	1	8260B		2/3/2017	CJR	1
2,2-Dichloropropane	< 0.037	mg/kg	0.037	0.12	1	8260B		2/3/2017	CJR	1
1,3-Dichloropropane	< 0.025	mg/kg	0.025	0.079	1	8260B		2/3/2017	CJR	1
Di-isopropyl ether	< 0.01	mg/kg	0.01	0.032	1	8260B		2/3/2017	CJR	1
EDB (1,2-Dibromoethane)	< 0.023	mg/kg	0.023	0.072	1	8260B		2/3/2017	CJR	1
Ethylbenzene	< 0.035	mg/kg	0.035	0.11	1	8260B		2/3/2017	CJR	1
Hexachlorobutadiene	< 0.085	mg/kg	0.085	0.27	1	8260B		2/3/2017	CJR	1
Isopropylbenzene	< 0.034	mg/kg	0.034	0.11	1	8260B		2/3/2017	CJR	1
p-Isopropyltoluene	< 0.029	mg/kg	0.029	0.093	1	8260B		2/3/2017	CJR	1
Methylene chloride	< 0.15	mg/kg	0.15	0.46	1	8260B		2/3/2017	CJR	1
Methyl tert-butyl ether (MTBE)	< 0.05	mg/kg	0.05	0.16	1	8260B		2/3/2017	CJR	1
Naphthalene	< 0.094	mg/kg	0.094	0.3	1	8260B		2/3/2017	CJR	1
n-Propylbenzene	< 0.033	mg/kg	0.033	0.1	1	8260B		2/3/2017	CJR	1
1,1,2,2-Tetrachloroethane	< 0.028	mg/kg	0.028	0.88	1	8260B		2/3/2017	CJR	1
1,1,1,2-Tetrachloroethane	< 0.028	mg/kg	0.028	0.09	1	8260B		2/3/2017	CJR	1
Tetrachloroethene	< 0.032	mg/kg	0.032	0.1	1	8260B		2/3/2017	CJR	1
Toluene	< 0.032	mg/kg	0.032	0.1	1	8260B		2/3/2017	CJR	1
1,2,4-Trichlorobenzene	< 0.064	mg/kg	0.064	0.2	1	8260B		2/3/2017	CJR	1
1,2,3-Trichlorobenzene	< 0.066	mg/kg	0.066	0.21	1	8260B		2/3/2017	CJR	1
1,1,1-Trichloroethane	< 0.03	mg/kg	0.03	0.96	1	8260B		2/3/2017	CJR	1
1,1,2-Trichloroethane	< 0.033	mg/kg	0.033	0.11	1	8260B		2/3/2017	CJR	1

Project Name BARB&RON'S CLEANERS
Project # 6403 PO#2017-0148

Invoice # E32423

Lab Code 5032423C
Sample ID 6403-SLAB-3
Sample Matrix Soil
Sample Date 1/31/2017

	Result	Unit	LOD	LOQ	Dil	Method	Ext Date	Run Date	Analyst	Code
Trichloroethene (TCE)	< 0.041	mg/kg	0.041	0.13	1	8260B		2/3/2017	CJR	1
Trichlorofluoromethane	< 0.041	mg/kg	0.041	0.13	1	8260B		2/3/2017	CJR	1
1,2,4-Trimethylbenzene	0.039 "J"	mg/kg	0.025	0.08	1	8260B		2/3/2017	CJR	1
1,3,5-Trimethylbenzene	< 0.032	mg/kg	0.032	0.1	1	8260B		2/3/2017	CJR	1
Vinyl Chloride	< 0.019	mg/kg	0.019	0.062	1	8260B		2/3/2017	CJR	1
m&p-Xylene	< 0.072	mg/kg	0.072	0.23	1	8260B		2/3/2017	CJR	1
o-Xylene	< 0.044	mg/kg	0.044	0.14	1	8260B		2/3/2017	CJR	1
SUR - Toluene-d8	101	Rec %			1	8260B		2/3/2017	CJR	1
SUR - 1,2-Dichloroethane-d4	95	Rec %			1	8260B		2/3/2017	CJR	1
SUR - 4-Bromofluorobenzene	107	Rec %			1	8260B		2/3/2017	CJR	1
SUR - Dibromofluoromethane	95	Rec %			1	8260B		2/3/2017	CJR	1

Project Name BARB&RON'S CLEANERS
 Project # 6403 PO#2017-0148

Invoice # E32423

Lab Code 5032423D
 Sample ID 6403-SLAB-4
 Sample Matrix Soil
 Sample Date 1/31/2017

	Result	Unit	LOD	LOQ	Dil	Method	Ext Date	Run Date	Analyst	Code
General										
General										
Solids Percent	91.3	%			1	5021		2/2/2017	NJC	1
Organic										
VOC's										
Benzene	< 0.03	mg/kg	0.03	0.96	1	8260B		2/3/2017	CJR	1
Bromobenzene	< 0.025	mg/kg	0.025	0.081	1	8260B		2/3/2017	CJR	1
Bromodichloromethane	< 0.074	mg/kg	0.074	0.24	1	8260B		2/3/2017	CJR	1
Bromoform	< 0.029	mg/kg	0.029	0.092	1	8260B		2/3/2017	CJR	1
tert-Butylbenzene	< 0.026	mg/kg	0.026	0.084	1	8260B		2/3/2017	CJR	1
sec-Butylbenzene	< 0.033	mg/kg	0.033	0.1	1	8260B		2/3/2017	CJR	1
n-Butylbenzene	< 0.04	mg/kg	0.04	0.13	1	8260B		2/3/2017	CJR	1
Carbon Tetrachloride	< 0.016	mg/kg	0.016	0.053	1	8260B		2/3/2017	CJR	1
Chlorobenzene	< 0.013	mg/kg	0.013	0.04	1	8260B		2/3/2017	CJR	1
Chloroethane	< 0.091	mg/kg	0.091	0.29	1	8260B		2/3/2017	CJR	1
Chloroform	< 0.035	mg/kg	0.035	0.11	1	8260B		2/3/2017	CJR	1
Chloromethane	< 0.076	mg/kg	0.076	0.24	1	8260B		2/3/2017	CJR	1
2-Chlorotoluene	< 0.015	mg/kg	0.015	0.047	1	8260B		2/3/2017	CJR	1
4-Chlorotoluene	< 0.018	mg/kg	0.018	0.057	1	8260B		2/3/2017	CJR	1
1,2-Dibromo-3-chloropropane	< 0.058	mg/kg	0.058	0.18	1	8260B		2/3/2017	CJR	1
Dibromochloromethane	< 0.025	mg/kg	0.025	0.079	1	8260B		2/3/2017	CJR	1
1,4-Dichlorobenzene	< 0.037	mg/kg	0.037	0.12	1	8260B		2/3/2017	CJR	1
1,3-Dichlorobenzene	< 0.037	mg/kg	0.037	0.12	1	8260B		2/3/2017	CJR	1
1,2-Dichlorobenzene	< 0.028	mg/kg	0.028	0.088	1	8260B		2/3/2017	CJR	1
Dichlorodifluoromethane	< 0.048	mg/kg	0.048	0.15	1	8260B		2/3/2017	CJR	1
1,2-Dichloroethane	< 0.038	mg/kg	0.038	0.12	1	8260B		2/3/2017	CJR	1
1,1-Dichloroethane	< 0.034	mg/kg	0.034	0.11	1	8260B		2/3/2017	CJR	1
1,1-Dichloroethene	< 0.022	mg/kg	0.022	0.069	1	8260B		2/3/2017	CJR	1
cis-1,2-Dichloroethene	< 0.032	mg/kg	0.032	0.1	1	8260B		2/3/2017	CJR	1
trans-1,2-Dichloroethene	< 0.028	mg/kg	0.028	0.09	1	8260B		2/3/2017	CJR	1
1,2-Dichloropropane	< 0.035	mg/kg	0.035	0.11	1	8260B		2/3/2017	CJR	1
2,2-Dichloropropane	< 0.037	mg/kg	0.037	0.12	1	8260B		2/3/2017	CJR	1
1,3-Dichloropropane	< 0.025	mg/kg	0.025	0.079	1	8260B		2/3/2017	CJR	1
Di-isopropyl ether	< 0.01	mg/kg	0.01	0.032	1	8260B		2/3/2017	CJR	1
EDB (1,2-Dibromoethane)	< 0.023	mg/kg	0.023	0.072	1	8260B		2/3/2017	CJR	1
Ethylbenzene	0.040 "J"	mg/kg	0.035	0.11	1	8260B		2/3/2017	CJR	1
Hexachlorobutadiene	< 0.085	mg/kg	0.085	0.27	1	8260B		2/3/2017	CJR	1
Isopropylbenzene	< 0.034	mg/kg	0.034	0.11	1	8260B		2/3/2017	CJR	1
p-Isopropyltoluene	< 0.029	mg/kg	0.029	0.093	1	8260B		2/3/2017	CJR	1
Methylene chloride	< 0.15	mg/kg	0.15	0.46	1	8260B		2/3/2017	CJR	1
Methyl tert-butyl ether (MTBE)	< 0.05	mg/kg	0.05	0.16	1	8260B		2/3/2017	CJR	1
Naphthalene	< 0.094	mg/kg	0.094	0.3	1	8260B		2/3/2017	CJR	1
n-Propylbenzene	< 0.033	mg/kg	0.033	0.1	1	8260B		2/3/2017	CJR	1
1,1,2,2-Tetrachloroethane	< 0.028	mg/kg	0.028	0.88	1	8260B		2/3/2017	CJR	1
1,1,1,2-Tetrachloroethane	< 0.028	mg/kg	0.028	0.09	1	8260B		2/3/2017	CJR	1
Tetrachloroethene	0.157	mg/kg	0.032	0.1	1	8260B		2/3/2017	CJR	1
Toluene	0.13	mg/kg	0.032	0.1	1	8260B		2/3/2017	CJR	1
1,2,4-Trichlorobenzene	< 0.064	mg/kg	0.064	0.2	1	8260B		2/3/2017	CJR	1
1,2,3-Trichlorobenzene	< 0.066	mg/kg	0.066	0.21	1	8260B		2/3/2017	CJR	1
1,1,1-Trichloroethane	< 0.03	mg/kg	0.03	0.96	1	8260B		2/3/2017	CJR	1
1,1,2-Trichloroethane	< 0.033	mg/kg	0.033	0.11	1	8260B		2/3/2017	CJR	1

Project Name BARB&RON'S CLEANERS
Project # 6403 PO#2017-0148

Invoice # E32423

Lab Code 5032423D
Sample ID 6403-SLAB-4
Sample Matrix Soil
Sample Date 1/31/2017

	Result	Unit	LOD	LOQ	Dil	Method	Ext Date	Run Date	Analyst	Code
Trichloroethene (TCE)	< 0.041	mg/kg	0.041	0.13	1	8260B		2/3/2017	CJR	1
Trichlorofluoromethane	< 0.041	mg/kg	0.041	0.13	1	8260B		2/3/2017	CJR	1
1,2,4-Trimethylbenzene	0.0265 "J"	mg/kg	0.025	0.08	1	8260B		2/3/2017	CJR	1
1,3,5-Trimethylbenzene	< 0.032	mg/kg	0.032	0.1	1	8260B		2/3/2017	CJR	1
Vinyl Chloride	< 0.019	mg/kg	0.019	0.062	1	8260B		2/3/2017	CJR	1
m&p-Xylene	0.21 "J"	mg/kg	0.072	0.23	1	8260B		2/3/2017	CJR	1
o-Xylene	0.090 "J"	mg/kg	0.044	0.14	1	8260B		2/3/2017	CJR	1
SUR - Toluene-d8	102	Rec %			1	8260B		2/3/2017	CJR	1
SUR - 1,2-Dichloroethane-d4	90	Rec %			1	8260B		2/3/2017	CJR	1
SUR - 4-Bromofluorobenzene	107	Rec %			1	8260B		2/3/2017	CJR	1
SUR - Dibromofluoromethane	97	Rec %			1	8260B		2/3/2017	CJR	1

"J" Flag: Analyte detected between LOD and LOQ

LOD Limit of Detection

LOQ Limit of Quantitation

Code **Comment**

1 Laboratory QC within limits.

All solid sample results reported on a dry weight basis unless otherwise indicated. All LOD's and LOQ's are adjusted for dilutions but not dry weight. Subcontracted results are denoted by SUB in the analyst field.

Authorized Signature

Synergy Environmental Lab, INC.

1990 Prospect Ct., Appleton, WI 54914 *P 920-830-2455 * F 920-733-0631

ROB HOVERMAN
ENVIROFORENSICS
825 N. CAPITOL AVENUE
INDIANAPOLIS, IN 46204

Report Date 08-Dec-17

Project Name FMR BARB & RON'S CLEANERS
Project # 6403 PO#2017-1718

Invoice # E33986

Lab Code 5033986A
Sample ID 6403 MW 1100
Sample Matrix Water
Sample Date 12/1/2017

	Result	Unit	LOD	LOQ	Dil	Method	Ext Date	Run Date	Analyst	Code
Organic										
VOC's										
Benzene	< 0.17	ug/l	0.17	0.55	1	8260B	12/5/2017	12/5/2017	CJR	1
Bromobenzene	< 0.43	ug/l	0.43	1.37	1	8260B	12/5/2017	12/5/2017	CJR	1
Bromodichloromethane	< 0.31	ug/l	0.31	1	1	8260B	12/5/2017	12/5/2017	CJR	1
Bromoform	< 0.49	ug/l	0.49	1.56	1	8260B	12/5/2017	12/5/2017	CJR	1
tert-Butylbenzene	< 0.39	ug/l	0.39	1.23	1	8260B	12/5/2017	12/5/2017	CJR	1
sec-Butylbenzene	< 0.24	ug/l	0.24	0.76	1	8260B	12/5/2017	12/5/2017	CJR	1
n-Butylbenzene	< 0.34	ug/l	0.34	1.08	1	8260B	12/5/2017	12/5/2017	CJR	1
Carbon Tetrachloride	< 0.21	ug/l	0.21	0.68	1	8260B	12/5/2017	12/5/2017	CJR	1
Chlorobenzene	< 0.27	ug/l	0.27	0.86	1	8260B	12/5/2017	12/5/2017	CJR	1
Chloroethane	< 0.5	ug/l	0.5	1.6	1	8260B	12/5/2017	12/5/2017	CJR	1
Chloroform	< 0.96	ug/l	0.96	3.04	1	8260B	12/5/2017	12/5/2017	CJR	1
Chloromethane	< 1.3	ug/l	1.3	4.15	1	8260B	12/5/2017	12/5/2017	CJR	1
2-Chlorotoluene	< 0.36	ug/l	0.36	1.15	1	8260B	12/5/2017	12/5/2017	CJR	1
4-Chlorotoluene	< 0.35	ug/l	0.35	1.11	1	8260B	12/5/2017	12/5/2017	CJR	1
1,2-Dibromo-3-chloropropane	< 1.88	ug/l	1.88	5.98	1	8260B	12/5/2017	12/5/2017	CJR	1
Dibromochloromethane	< 0.45	ug/l	0.45	1.44	1	8260B	12/5/2017	12/5/2017	CJR	1
1,4-Dichlorobenzene	< 0.42	ug/l	0.42	1.34	1	8260B	12/5/2017	12/5/2017	CJR	1
1,3-Dichlorobenzene	< 0.45	ug/l	0.45	1.43	1	8260B	12/5/2017	12/5/2017	CJR	1
1,2-Dichlorobenzene	< 0.34	ug/l	0.34	1.09	1	8260B	12/5/2017	12/5/2017	CJR	1
Dichlorodifluoromethane	< 0.38	ug/l	0.38	1.2	1	8260B	12/5/2017	12/5/2017	CJR	1
1,2-Dichloroethane	< 0.45	ug/l	0.45	1.43	1	8260B	12/5/2017	12/5/2017	CJR	1
1,1-Dichloroethane	< 0.42	ug/l	0.42	1.34	1	8260B	12/5/2017	12/5/2017	CJR	1
1,1-Dichloroethene	< 0.46	ug/l	0.46	1.47	1	8260B	12/5/2017	12/5/2017	CJR	1
cis-1,2-Dichloroethene	< 0.41	ug/l	0.41	1.29	1	8260B	12/5/2017	12/5/2017	CJR	1
trans-1,2-Dichloroethene	< 0.35	ug/l	0.35	1.12	1	8260B	12/5/2017	12/5/2017	CJR	1
1,2-Dichloropropane	< 0.39	ug/l	0.39	1.24	1	8260B	12/5/2017	12/5/2017	CJR	1
1,3-Dichloropropane	< 0.49	ug/l	0.49	1.55	1	8260B	12/5/2017	12/5/2017	CJR	1
trans-1,3-Dichloropropene	< 0.42	ug/l	0.42	1.33	1	8260B	12/5/2017	12/5/2017	CJR	1
cis-1,3-Dichloropropene	< 0.21	ug/l	0.21	0.65	1	8260B	12/5/2017	12/5/2017	CJR	1

Project Name FMR BARB & RON'S CLEANERS
Project # 6403 PO#2017-1718

Invoice # E33986

Lab Code 5033986A
Sample ID 6403 MW 1100
Sample Matrix Water
Sample Date 12/1/2017

	Result	Unit	LOD	LOQ	Dil	Method	Ext Date	Run Date	Analyst	Code
Di-isopropyl ether	< 0.26	ug/l	0.26	0.83	1	8260B		12/5/2017	CJR	1
EDB (1,2-Dibromoethane)	< 0.34	ug/l	0.34	1.09	1	8260B		12/5/2017	CJR	1
Ethylbenzene	< 0.2	ug/l	0.2	0.63	1	8260B		12/5/2017	CJR	1
Hexachlorobutadiene	< 1.47	ug/l	1.47	4.68	1	8260B		12/5/2017	CJR	1
Isopropylbenzene	< 0.29	ug/l	0.29	0.93	1	8260B		12/5/2017	CJR	1
p-Isopropyltoluene	< 0.28	ug/l	0.28	0.91	1	8260B		12/5/2017	CJR	1
Methylene chloride	< 0.94	ug/l	0.94	2.98	1	8260B		12/5/2017	CJR	1
Methyl tert-butyl ether (MTBE)	< 0.82	ug/l	0.82	2.6	1	8260B		12/5/2017	CJR	1
Naphthalene	< 2.17	ug/l	2.17	6.9	1	8260B		12/5/2017	CJR	1
n-Propylbenzene	< 0.19	ug/l	0.19	0.62	1	8260B		12/5/2017	CJR	1
1,1,2,2-Tetrachloroethane	< 0.69	ug/l	0.69	2.21	1	8260B		12/5/2017	CJR	1
1,1,1,2-Tetrachloroethane	< 0.47	ug/l	0.47	1.48	1	8260B		12/5/2017	CJR	1
Tetrachloroethene	10.1	ug/l	0.48	1.52	1	8260B		12/5/2017	CJR	1
Toluene	< 0.67	ug/l	0.67	2.13	1	8260B		12/5/2017	CJR	1
1,2,4-Trichlorobenzene	< 1.29	ug/l	1.29	4.1	1	8260B		12/5/2017	CJR	1
1,2,3-Trichlorobenzene	< 0.83	ug/l	0.83	2.63	1	8260B		12/5/2017	CJR	1
1,1,1-Trichloroethane	< 0.35	ug/l	0.35	1.11	1	8260B		12/5/2017	CJR	1
1,1,2-Trichloroethane	< 0.65	ug/l	0.65	2.06	1	8260B		12/5/2017	CJR	1
Trichloroethene (TCE)	0.63 "J"	ug/l	0.45	1.43	1	8260B		12/5/2017	CJR	1
Trichlorofluoromethane	< 0.64	ug/l	0.64	2.04	1	8260B		12/5/2017	CJR	1
1,2,4-Trimethylbenzene	< 1.14	ug/l	1.14	3.63	1	8260B		12/5/2017	CJR	1
1,3,5-Trimethylbenzene	< 0.91	ug/l	0.91	2.9	1	8260B		12/5/2017	CJR	1
Vinyl Chloride	< 0.19	ug/l	0.19	0.62	1	8260B		12/5/2017	CJR	1
m&p-Xylene	< 1.56	ug/l	1.56	4.95	1	8260B		12/5/2017	CJR	1
o-Xylene	< 0.39	ug/l	0.39	1.25	1	8260B		12/5/2017	CJR	1
SUR - 4-Bromofluorobenzene	107	REC %			1	8260B		12/5/2017	CJR	1
SUR - Dibromofluoromethane	105	REC %			1	8260B		12/5/2017	CJR	1
SUR - 1,2-Dichloroethane-d4	100	REC %			1	8260B		12/5/2017	CJR	1
SUR - Toluene-d8	100	REC %			1	8260B		12/5/2017	CJR	1

Project Name FMR BARB & RON'S CLEANERS
 Project # 6403 PO#2017-1718

Invoice # E33986

Lab Code 5033986B
 Sample ID 6403 MW 1300
 Sample Matrix Water
 Sample Date 12/1/2017

	Result	Unit	LOD	LOQ	Dil	Method	Ext Date	Run Date	Analyst	Code
Organic										
VOC's										
Benzene	< 0.17	ug/l	0.17	0.55	1	8260B		12/5/2017	CJR	1
Bromobenzene	< 0.43	ug/l	0.43	1.37	1	8260B		12/5/2017	CJR	1
Bromodichloromethane	< 0.31	ug/l	0.31	1	1	8260B		12/5/2017	CJR	1
Bromoform	< 0.49	ug/l	0.49	1.56	1	8260B		12/5/2017	CJR	1
tert-Butylbenzene	< 0.39	ug/l	0.39	1.23	1	8260B		12/5/2017	CJR	1
sec-Butylbenzene	< 0.24	ug/l	0.24	0.76	1	8260B		12/5/2017	CJR	1
n-Butylbenzene	< 0.34	ug/l	0.34	1.08	1	8260B		12/5/2017	CJR	1
Carbon Tetrachloride	< 0.21	ug/l	0.21	0.68	1	8260B		12/5/2017	CJR	1
Chlorobenzene	< 0.27	ug/l	0.27	0.86	1	8260B		12/5/2017	CJR	1
Chloroethane	< 0.5	ug/l	0.5	1.6	1	8260B		12/5/2017	CJR	1
Chloroform	< 0.96	ug/l	0.96	3.04	1	8260B		12/5/2017	CJR	1
Chloromethane	< 1.3	ug/l	1.3	4.15	1	8260B		12/5/2017	CJR	1
2-Chlorotoluene	< 0.36	ug/l	0.36	1.15	1	8260B		12/5/2017	CJR	1
4-Chlorotoluene	< 0.35	ug/l	0.35	1.11	1	8260B		12/5/2017	CJR	1
1,2-Dibromo-3-chloropropane	< 1.88	ug/l	1.88	5.98	1	8260B		12/5/2017	CJR	1
Dibromochloromethane	< 0.45	ug/l	0.45	1.44	1	8260B		12/5/2017	CJR	1
1,4-Dichlorobenzene	< 0.42	ug/l	0.42	1.34	1	8260B		12/5/2017	CJR	1
1,3-Dichlorobenzene	< 0.45	ug/l	0.45	1.43	1	8260B		12/5/2017	CJR	1
1,2-Dichlorobenzene	< 0.34	ug/l	0.34	1.09	1	8260B		12/5/2017	CJR	1
Dichlorodifluoromethane	< 0.38	ug/l	0.38	1.2	1	8260B		12/5/2017	CJR	1
1,2-Dichloroethane	< 0.45	ug/l	0.45	1.43	1	8260B		12/5/2017	CJR	1
1,1-Dichloroethane	< 0.42	ug/l	0.42	1.34	1	8260B		12/5/2017	CJR	1
1,1-Dichloroethene	< 0.46	ug/l	0.46	1.47	1	8260B		12/5/2017	CJR	1
cis-1,2-Dichloroethene	< 0.41	ug/l	0.41	1.29	1	8260B		12/5/2017	CJR	1
trans-1,2-Dichloroethene	< 0.35	ug/l	0.35	1.12	1	8260B		12/5/2017	CJR	1
1,2-Dichloropropane	< 0.39	ug/l	0.39	1.24	1	8260B		12/5/2017	CJR	1
1,3-Dichloropropane	< 0.49	ug/l	0.49	1.55	1	8260B		12/5/2017	CJR	1
trans-1,3-Dichloropropene	< 0.42	ug/l	0.42	1.33	1	8260B		12/5/2017	CJR	1
cis-1,3-Dichloropropene	< 0.21	ug/l	0.21	0.65	1	8260B		12/5/2017	CJR	1
Di-isopropyl ether	< 0.26	ug/l	0.26	0.83	1	8260B		12/5/2017	CJR	1
EDB (1,2-Dibromoethane)	< 0.34	ug/l	0.34	1.09	1	8260B		12/5/2017	CJR	1
Ethylbenzene	< 0.2	ug/l	0.2	0.63	1	8260B		12/5/2017	CJR	1
Hexachlorobutadiene	< 1.47	ug/l	1.47	4.68	1	8260B		12/5/2017	CJR	1
Isopropylbenzene	< 0.29	ug/l	0.29	0.93	1	8260B		12/5/2017	CJR	1
p-Isopropyltoluene	< 0.28	ug/l	0.28	0.91	1	8260B		12/5/2017	CJR	1
Methylene chloride	< 0.94	ug/l	0.94	2.98	1	8260B		12/5/2017	CJR	1
Methyl tert-butyl ether (MTBE)	< 0.82	ug/l	0.82	2.6	1	8260B		12/5/2017	CJR	1
Naphthalene	< 2.17	ug/l	2.17	6.9	1	8260B		12/5/2017	CJR	1
n-Propylbenzene	< 0.19	ug/l	0.19	0.62	1	8260B		12/5/2017	CJR	1
1,1,2,2-Tetrachloroethane	< 0.69	ug/l	0.69	2.21	1	8260B		12/5/2017	CJR	1
1,1,1,2-Tetrachloroethane	< 0.47	ug/l	0.47	1.48	1	8260B		12/5/2017	CJR	1
Tetrachloroethene	10	ug/l	0.48	1.52	1	8260B		12/5/2017	CJR	1
Toluene	< 0.67	ug/l	0.67	2.13	1	8260B		12/5/2017	CJR	1
1,2,4-Trichlorobenzene	< 1.29	ug/l	1.29	4.1	1	8260B		12/5/2017	CJR	1
1,2,3-Trichlorobenzene	< 0.83	ug/l	0.83	2.63	1	8260B		12/5/2017	CJR	1
1,1,1-Trichloroethane	< 0.35	ug/l	0.35	1.11	1	8260B		12/5/2017	CJR	1
1,1,2-Trichloroethane	< 0.65	ug/l	0.65	2.06	1	8260B		12/5/2017	CJR	1
Trichloroethene (TCE)	< 0.45	ug/l	0.45	1.43	1	8260B		12/5/2017	CJR	1
Trichlorofluoromethane	< 0.64	ug/l	0.64	2.04	1	8260B		12/5/2017	CJR	1
1,2,4-Trimethylbenzene	< 1.14	ug/l	1.14	3.63	1	8260B		12/5/2017	CJR	1

Project Name FMR BARB & RON'S CLEANERS
Project # 6403 PO#2017-1718

Invoice # E33986

Lab Code 5033986B
Sample ID 6403 MW 1300
Sample Matrix Water
Sample Date 12/1/2017

	Result	Unit	LOD	LOQ	Dil	Method	Ext Date	Run Date	Analyst	Code
1,3,5-Trimethylbenzene	< 0.91	ug/l	0.91	2.9	1	8260B		12/5/2017	CJR	1
Vinyl Chloride	< 0.19	ug/l	0.19	0.62	1	8260B		12/5/2017	CJR	1
m&p-Xylene	< 1.56	ug/l	1.56	4.95	1	8260B		12/5/2017	CJR	1
o-Xylene	< 0.39	ug/l	0.39	1.25	1	8260B		12/5/2017	CJR	1
SUR - 1,2-Dichloroethane-d4	101	REC %			1	8260B		12/5/2017	CJR	1
SUR - Toluene-d8	98	REC %			1	8260B		12/5/2017	CJR	1
SUR - Dibromofluoromethane	104	REC %			1	8260B		12/5/2017	CJR	1
SUR - 4-Bromofluorobenzene	105	REC %			1	8260B		12/5/2017	CJR	1

Project Name FMR BARB & RON'S CLEANERS
Project # 6403 PO#2017-1718

Invoice # E33986

Lab Code 5033986C
Sample ID 6403 MW 1600
Sample Matrix Water
Sample Date 12/1/2017

	Result	Unit	LOD	LOQ	Dil	Method	Ext Date	Run Date	Analyst	Code
Organic										
VOC's										
Benzene	< 1.7	ug/l	1.7	5.5	10	8260B		12/5/2017	CJR	1
Bromobenzene	< 4.3	ug/l	4.3	13.7	10	8260B		12/5/2017	CJR	1
Bromodichloromethane	< 3.1	ug/l	3.1	10	10	8260B		12/5/2017	CJR	1
Bromoform	< 4.9	ug/l	4.9	15.6	10	8260B		12/5/2017	CJR	1
tert-Butylbenzene	< 3.9	ug/l	3.9	12.3	10	8260B		12/5/2017	CJR	1
sec-Butylbenzene	< 2.4	ug/l	2.4	7.6	10	8260B		12/5/2017	CJR	1
n-Butylbenzene	< 3.4	ug/l	3.4	10.8	10	8260B		12/5/2017	CJR	1
Carbon Tetrachloride	< 2.1	ug/l	2.1	6.8	10	8260B		12/5/2017	CJR	1
Chlorobenzene	< 2.7	ug/l	2.7	8.6	10	8260B		12/5/2017	CJR	1
Chloroethane	< 5	ug/l	5	16	10	8260B		12/5/2017	CJR	1
Chloroform	< 9.6	ug/l	9.6	30.4	10	8260B		12/5/2017	CJR	1
Chloromethane	< 13	ug/l	13	41.5	10	8260B		12/5/2017	CJR	1
2-Chlorotoluene	< 3.6	ug/l	3.6	11.5	10	8260B		12/5/2017	CJR	1
4-Chlorotoluene	< 3.5	ug/l	3.5	11.1	10	8260B		12/5/2017	CJR	1
1,2-Dibromo-3-chloropropane	< 18.8	ug/l	18.8	59.8	10	8260B		12/5/2017	CJR	1
Dibromochloromethane	< 4.5	ug/l	4.5	14.4	10	8260B		12/5/2017	CJR	1
1,4-Dichlorobenzene	< 4.2	ug/l	4.2	13.4	10	8260B		12/5/2017	CJR	1
1,3-Dichlorobenzene	< 4.5	ug/l	4.5	14.3	10	8260B		12/5/2017	CJR	1
1,2-Dichlorobenzene	< 3.4	ug/l	3.4	10.9	10	8260B		12/5/2017	CJR	1
Dichlorodifluoromethane	< 3.8	ug/l	3.8	12	10	8260B		12/5/2017	CJR	1
1,2-Dichloroethane	< 4.5	ug/l	4.5	14.3	10	8260B		12/5/2017	CJR	1
1,1-Dichloroethane	< 4.2	ug/l	4.2	13.4	10	8260B		12/5/2017	CJR	1
1,1-Dichloroethene	< 4.6	ug/l	4.6	14.7	10	8260B		12/5/2017	CJR	1
cis-1,2-Dichloroethene	5.4 "J"	ug/l	4.1	12.9	10	8260B		12/5/2017	CJR	1
trans-1,2-Dichloroethene	< 3.5	ug/l	3.5	11.2	10	8260B		12/5/2017	CJR	1
1,2-Dichloropropane	< 3.9	ug/l	3.9	12.4	10	8260B		12/5/2017	CJR	1
1,3-Dichloropropane	< 4.9	ug/l	4.9	15.5	10	8260B		12/5/2017	CJR	1
trans-1,3-Dichloropropene	< 4.2	ug/l	4.2	13.3	10	8260B		12/5/2017	CJR	1
cis-1,3-Dichloropropene	< 2.1	ug/l	2.1	6.5	10	8260B		12/5/2017	CJR	1
Di-isopropyl ether	< 2.6	ug/l	2.6	8.3	10	8260B		12/5/2017	CJR	1
EDB (1,2-Dibromoethane)	< 3.4	ug/l	3.4	10.9	10	8260B		12/5/2017	CJR	1
Ethylbenzene	< 2	ug/l	2	6.3	10	8260B		12/5/2017	CJR	1
Hexachlorobutadiene	< 14.7	ug/l	14.7	46.8	10	8260B		12/5/2017	CJR	1
Isopropylbenzene	< 2.9	ug/l	2.9	9.3	10	8260B		12/5/2017	CJR	1
p-Isopropyltoluene	< 2.8	ug/l	2.8	9.1	10	8260B		12/5/2017	CJR	1
Methylene chloride	< 9.4	ug/l	9.4	29.8	10	8260B		12/5/2017	CJR	1
Methyl tert-butyl ether (MTBE)	< 8.2	ug/l	8.2	26	10	8260B		12/5/2017	CJR	1
Naphthalene	< 21.7	ug/l	21.7	69	10	8260B		12/5/2017	CJR	1
n-Propylbenzene	< 1.9	ug/l	1.9	6.2	10	8260B		12/5/2017	CJR	1
1,1,2,2-Tetrachloroethane	< 6.9	ug/l	6.9	22.1	10	8260B		12/5/2017	CJR	1
1,1,1,2-Tetrachloroethane	< 4.7	ug/l	4.7	14.8	10	8260B		12/5/2017	CJR	1
Tetrachloroethene	302	ug/l	4.8	15.2	10	8260B		12/5/2017	CJR	1
Toluene	< 6.7	ug/l	6.7	21.3	10	8260B		12/5/2017	CJR	1
1,2,4-Trichlorobenzene	< 12.9	ug/l	12.9	41	10	8260B		12/5/2017	CJR	1
1,2,3-Trichlorobenzene	< 8.3	ug/l	8.3	26.3	10	8260B		12/5/2017	CJR	1
1,1,1-Trichloroethane	< 3.5	ug/l	3.5	11.1	10	8260B		12/5/2017	CJR	1
1,1,2-Trichloroethane	< 6.5	ug/l	6.5	20.6	10	8260B		12/5/2017	CJR	1
Trichloroethene (TCE)	13 "J"	ug/l	4.5	14.3	10	8260B		12/5/2017	CJR	1
Trichlorofluoromethane	< 6.4	ug/l	6.4	20.4	10	8260B		12/5/2017	CJR	1
1,2,4-Trimethylbenzene	< 11.4	ug/l	11.4	36.3	10	8260B		12/5/2017	CJR	1

Project Name FMR BARB & RON'S CLEANERS
Project # 6403 PO#2017-1718

Invoice # E33986

Lab Code 5033986C
Sample ID 6403 MW 1600
Sample Matrix Water
Sample Date 12/1/2017

	Result	Unit	LOD	LOQ	Dil	Method	Ext Date	Run Date	Analyst	Code
1,3,5-Trimethylbenzene	< 9.1	ug/l	9.1	29	10	8260B	12/5/2017	12/5/2017	CJR	1
Vinyl Chloride	< 1.9	ug/l	1.9	6.2	10	8260B	12/5/2017	12/5/2017	CJR	1
m&p-Xylene	< 15.6	ug/l	15.6	49.5	10	8260B	12/5/2017	12/5/2017	CJR	1
o-Xylene	< 3.9	ug/l	3.9	12.5	10	8260B	12/5/2017	12/5/2017	CJR	1
SUR - Toluene-d8	97	REC %			10	8260B	12/5/2017	12/5/2017	CJR	1
SUR - Dibromofluoromethane	111	REC %			10	8260B	12/5/2017	12/5/2017	CJR	1
SUR - 1,2-Dichloroethane-d4	106	REC %			10	8260B	12/5/2017	12/5/2017	CJR	1
SUR - 4-Bromofluorobenzene	107	REC %			10	8260B	12/5/2017	12/5/2017	CJR	1

Project Name FMR BARB & RON'S CLEANERS
Project # 6403 PO#2017-1718

Invoice # E33986

Lab Code 5033986D
Sample ID 6403 MW 800
Sample Matrix Water
Sample Date 12/1/2017

	Result	Unit	LOD	LOQ	Dil	Method	Ext Date	Run Date	Analyst	Code
Organic										
VOC's										
Benzene	< 0.17	ug/l	0.17	0.55	1	8260B		12/5/2017	CJR	1
Bromobenzene	< 0.43	ug/l	0.43	1.37	1	8260B		12/5/2017	CJR	1
Bromodichloromethane	< 0.31	ug/l	0.31	1	1	8260B		12/5/2017	CJR	1
Bromoform	< 0.49	ug/l	0.49	1.56	1	8260B		12/5/2017	CJR	1
tert-Butylbenzene	< 0.39	ug/l	0.39	1.23	1	8260B		12/5/2017	CJR	1
sec-Butylbenzene	< 0.24	ug/l	0.24	0.76	1	8260B		12/5/2017	CJR	1
n-Butylbenzene	< 0.34	ug/l	0.34	1.08	1	8260B		12/5/2017	CJR	1
Carbon Tetrachloride	< 0.21	ug/l	0.21	0.68	1	8260B		12/5/2017	CJR	1
Chlorobenzene	< 0.27	ug/l	0.27	0.86	1	8260B		12/5/2017	CJR	1
Chloroethane	< 0.5	ug/l	0.5	1.6	1	8260B		12/5/2017	CJR	1
Chloroform	< 0.96	ug/l	0.96	3.04	1	8260B		12/5/2017	CJR	1
Chloromethane	< 1.3	ug/l	1.3	4.15	1	8260B		12/5/2017	CJR	1
2-Chlorotoluene	< 0.36	ug/l	0.36	1.15	1	8260B		12/5/2017	CJR	1
4-Chlorotoluene	< 0.35	ug/l	0.35	1.11	1	8260B		12/5/2017	CJR	1
1,2-Dibromo-3-chloropropane	< 1.88	ug/l	1.88	5.98	1	8260B		12/5/2017	CJR	1
Dibromochloromethane	< 0.45	ug/l	0.45	1.44	1	8260B		12/5/2017	CJR	1
1,4-Dichlorobenzene	< 0.42	ug/l	0.42	1.34	1	8260B		12/5/2017	CJR	1
1,3-Dichlorobenzene	< 0.45	ug/l	0.45	1.43	1	8260B		12/5/2017	CJR	1
1,2-Dichlorobenzene	< 0.34	ug/l	0.34	1.09	1	8260B		12/5/2017	CJR	1
Dichlorodifluoromethane	< 0.38	ug/l	0.38	1.2	1	8260B		12/5/2017	CJR	1
1,2-Dichloroethane	< 0.45	ug/l	0.45	1.43	1	8260B		12/5/2017	CJR	1
1,1-Dichloroethane	< 0.42	ug/l	0.42	1.34	1	8260B		12/5/2017	CJR	1
1,1-Dichloroethene	< 0.46	ug/l	0.46	1.47	1	8260B		12/5/2017	CJR	1
cis-1,2-Dichloroethene	< 0.41	ug/l	0.41	1.29	1	8260B		12/5/2017	CJR	1
trans-1,2-Dichloroethene	< 0.35	ug/l	0.35	1.12	1	8260B		12/5/2017	CJR	1
1,2-Dichloropropane	< 0.39	ug/l	0.39	1.24	1	8260B		12/5/2017	CJR	1
1,3-Dichloropropane	< 0.49	ug/l	0.49	1.55	1	8260B		12/5/2017	CJR	1
trans-1,3-Dichloropropene	< 0.42	ug/l	0.42	1.33	1	8260B		12/5/2017	CJR	1
cis-1,3-Dichloropropene	< 0.21	ug/l	0.21	0.65	1	8260B		12/5/2017	CJR	1
Di-isopropyl ether	< 0.26	ug/l	0.26	0.83	1	8260B		12/5/2017	CJR	1
EDB (1,2-Dibromoethane)	< 0.34	ug/l	0.34	1.09	1	8260B		12/5/2017	CJR	1
Ethylbenzene	< 0.2	ug/l	0.2	0.63	1	8260B		12/5/2017	CJR	1
Hexachlorobutadiene	< 1.47	ug/l	1.47	4.68	1	8260B		12/5/2017	CJR	1
Isopropylbenzene	< 0.29	ug/l	0.29	0.93	1	8260B		12/5/2017	CJR	1
p-Isopropyltoluene	< 0.28	ug/l	0.28	0.91	1	8260B		12/5/2017	CJR	1
Methylene chloride	< 0.94	ug/l	0.94	2.98	1	8260B		12/5/2017	CJR	1
Methyl tert-butyl ether (MTBE)	< 0.82	ug/l	0.82	2.6	1	8260B		12/5/2017	CJR	1
Naphthalene	< 2.17	ug/l	2.17	6.9	1	8260B		12/5/2017	CJR	1
n-Propylbenzene	< 0.19	ug/l	0.19	0.62	1	8260B		12/5/2017	CJR	1
1,1,2,2-Tetrachloroethane	< 0.69	ug/l	0.69	2.21	1	8260B		12/5/2017	CJR	1
1,1,1,2-Tetrachloroethane	< 0.47	ug/l	0.47	1.48	1	8260B		12/5/2017	CJR	1
Tetrachloroethene	1.0 "J"	ug/l	0.48	1.52	1	8260B		12/5/2017	CJR	1
Toluene	< 0.67	ug/l	0.67	2.13	1	8260B		12/5/2017	CJR	1
1,2,4-Trichlorobenzene	< 1.29	ug/l	1.29	4.1	1	8260B		12/5/2017	CJR	1
1,2,3-Trichlorobenzene	< 0.83	ug/l	0.83	2.63	1	8260B		12/5/2017	CJR	1
1,1,1-Trichloroethane	< 0.35	ug/l	0.35	1.11	1	8260B		12/5/2017	CJR	1
1,1,2-Trichloroethane	< 0.65	ug/l	0.65	2.06	1	8260B		12/5/2017	CJR	1
Trichloroethene (TCE)	< 0.45	ug/l	0.45	1.43	1	8260B		12/5/2017	CJR	1
Trichlorofluoromethane	< 0.64	ug/l	0.64	2.04	1	8260B		12/5/2017	CJR	1
1,2,4-Trimethylbenzene	< 1.14	ug/l	1.14	3.63	1	8260B		12/5/2017	CJR	1

Project Name FMR BARB & RON'S CLEANERS
Project # 6403 PO#2017-1718

Invoice # E33986

Lab Code 5033986D
Sample ID 6403 MW 800
Sample Matrix Water
Sample Date 12/1/2017

	Result	Unit	LOD	LOQ	Dil	Method	Ext Date	Run Date	Analyst	Code
1,3,5-Trimethylbenzene	< 0.91	ug/l	0.91	2.9	1	8260B		12/5/2017	CJR	1
Vinyl Chloride	< 0.19	ug/l	0.19	0.62	1	8260B		12/5/2017	CJR	1
m&p-Xylene	< 1.56	ug/l	1.56	4.95	1	8260B		12/5/2017	CJR	1
o-Xylene	< 0.39	ug/l	0.39	1.25	1	8260B		12/5/2017	CJR	1
SUR - Toluene-d8	99	REC %			1	8260B		12/5/2017	CJR	1
SUR - Dibromofluoromethane	106	REC %			1	8260B		12/5/2017	CJR	1
SUR - 4-Bromofluorobenzene	111	REC %			1	8260B		12/5/2017	CJR	1
SUR - 1,2-Dichloroethane-d4	100	REC %			1	8260B		12/5/2017	CJR	1

Project Name FMR BARB & RON'S CLEANERS
 Project # 6403 PO#2017-1718

Invoice # E33986

Lab Code 5033986E
 Sample ID 6403 MW 2300
 Sample Matrix Water
 Sample Date 12/1/2017

	Result	Unit	LOD	LOQ	Dil	Method	Ext Date	Run Date	Analyst	Code
Organic										
VOC's										
Benzene	< 0.17	ug/l	0.17	0.55	1	8260B		12/5/2017	CJR	1
Bromobenzene	< 0.43	ug/l	0.43	1.37	1	8260B		12/5/2017	CJR	1
Bromodichloromethane	< 0.31	ug/l	0.31	1	1	8260B		12/5/2017	CJR	1
Bromoform	< 0.49	ug/l	0.49	1.56	1	8260B		12/5/2017	CJR	1
tert-Butylbenzene	< 0.39	ug/l	0.39	1.23	1	8260B		12/5/2017	CJR	1
sec-Butylbenzene	< 0.24	ug/l	0.24	0.76	1	8260B		12/5/2017	CJR	1
n-Butylbenzene	< 0.34	ug/l	0.34	1.08	1	8260B		12/5/2017	CJR	1
Carbon Tetrachloride	< 0.21	ug/l	0.21	0.68	1	8260B		12/5/2017	CJR	1
Chlorobenzene	< 0.27	ug/l	0.27	0.86	1	8260B		12/5/2017	CJR	1
Chloroethane	< 0.5	ug/l	0.5	1.6	1	8260B		12/5/2017	CJR	1
Chloroform	< 0.96	ug/l	0.96	3.04	1	8260B		12/5/2017	CJR	1
Chloromethane	< 1.3	ug/l	1.3	4.15	1	8260B		12/5/2017	CJR	1
2-Chlorotoluene	< 0.36	ug/l	0.36	1.15	1	8260B		12/5/2017	CJR	1
4-Chlorotoluene	< 0.35	ug/l	0.35	1.11	1	8260B		12/5/2017	CJR	1
1,2-Dibromo-3-chloropropane	< 1.88	ug/l	1.88	5.98	1	8260B		12/5/2017	CJR	1
Dibromochloromethane	< 0.45	ug/l	0.45	1.44	1	8260B		12/5/2017	CJR	1
1,4-Dichlorobenzene	< 0.42	ug/l	0.42	1.34	1	8260B		12/5/2017	CJR	1
1,3-Dichlorobenzene	< 0.45	ug/l	0.45	1.43	1	8260B		12/5/2017	CJR	1
1,2-Dichlorobenzene	< 0.34	ug/l	0.34	1.09	1	8260B		12/5/2017	CJR	1
Dichlorodifluoromethane	< 0.38	ug/l	0.38	1.2	1	8260B		12/5/2017	CJR	1
1,2-Dichloroethane	< 0.45	ug/l	0.45	1.43	1	8260B		12/5/2017	CJR	1
1,1-Dichloroethane	< 0.42	ug/l	0.42	1.34	1	8260B		12/5/2017	CJR	1
1,1-Dichloroethene	< 0.46	ug/l	0.46	1.47	1	8260B		12/5/2017	CJR	1
cis-1,2-Dichloroethene	< 0.41	ug/l	0.41	1.29	1	8260B		12/5/2017	CJR	1
trans-1,2-Dichloroethene	< 0.35	ug/l	0.35	1.12	1	8260B		12/5/2017	CJR	1
1,2-Dichloropropane	< 0.39	ug/l	0.39	1.24	1	8260B		12/5/2017	CJR	1
1,3-Dichloropropane	< 0.49	ug/l	0.49	1.55	1	8260B		12/5/2017	CJR	1
trans-1,3-Dichloropropene	< 0.42	ug/l	0.42	1.33	1	8260B		12/5/2017	CJR	1
cis-1,3-Dichloropropene	< 0.21	ug/l	0.21	0.65	1	8260B		12/5/2017	CJR	1
Di-isopropyl ether	< 0.26	ug/l	0.26	0.83	1	8260B		12/5/2017	CJR	1
EDB (1,2-Dibromoethane)	< 0.34	ug/l	0.34	1.09	1	8260B		12/5/2017	CJR	1
Ethylbenzene	< 0.2	ug/l	0.2	0.63	1	8260B		12/5/2017	CJR	1
Hexachlorobutadiene	< 1.47	ug/l	1.47	4.68	1	8260B		12/5/2017	CJR	1
Isopropylbenzene	< 0.29	ug/l	0.29	0.93	1	8260B		12/5/2017	CJR	1
p-Isopropyltoluene	< 0.28	ug/l	0.28	0.91	1	8260B		12/5/2017	CJR	1
Methylene chloride	< 0.94	ug/l	0.94	2.98	1	8260B		12/5/2017	CJR	1
Methyl tert-butyl ether (MTBE)	< 0.82	ug/l	0.82	2.6	1	8260B		12/5/2017	CJR	1
Naphthalene	< 2.17	ug/l	2.17	6.9	1	8260B		12/5/2017	CJR	1
n-Propylbenzene	< 0.19	ug/l	0.19	0.62	1	8260B		12/5/2017	CJR	1
1,1,2,2-Tetrachloroethane	< 0.69	ug/l	0.69	2.21	1	8260B		12/5/2017	CJR	1
1,1,1,2-Tetrachloroethane	< 0.47	ug/l	0.47	1.48	1	8260B		12/5/2017	CJR	1
Tetrachloroethene	4.6	ug/l	0.48	1.52	1	8260B		12/5/2017	CJR	1
Toluene	< 0.67	ug/l	0.67	2.13	1	8260B		12/5/2017	CJR	1
1,2,4-Trichlorobenzene	< 1.29	ug/l	1.29	4.1	1	8260B		12/5/2017	CJR	1
1,2,3-Trichlorobenzene	< 0.83	ug/l	0.83	2.63	1	8260B		12/5/2017	CJR	1
1,1,1-Trichloroethane	< 0.35	ug/l	0.35	1.11	1	8260B		12/5/2017	CJR	1
1,1,2-Trichloroethane	< 0.65	ug/l	0.65	2.06	1	8260B		12/5/2017	CJR	1
Trichloroethene (TCE)	< 0.45	ug/l	0.45	1.43	1	8260B		12/5/2017	CJR	1
Trichlorofluoromethane	< 0.64	ug/l	0.64	2.04	1	8260B		12/5/2017	CJR	1
1,2,4-Trimethylbenzene	< 1.14	ug/l	1.14	3.63	1	8260B		12/5/2017	CJR	1

Project Name FMR BARB & RON'S CLEANERS
Project # 6403 PO#2017-1718

Invoice # E33986

Lab Code 5033986E
Sample ID 6403 MW 2300
Sample Matrix Water
Sample Date 12/1/2017

	Result	Unit	LOD	LOQ	Dil	Method	Ext Date	Run Date	Analyst	Code
1,3,5-Trimethylbenzene	< 0.91	ug/l	0.91	2.9	1	8260B		12/5/2017	CJR	1
Vinyl Chloride	< 0.19	ug/l	0.19	0.62	1	8260B		12/5/2017	CJR	1
m&p-Xylene	< 1.56	ug/l	1.56	4.95	1	8260B		12/5/2017	CJR	1
o-Xylene	< 0.39	ug/l	0.39	1.25	1	8260B		12/5/2017	CJR	1
SUR - 4-Bromofluorobenzene	112	REC %			1	8260B		12/5/2017	CJR	1
SUR - Dibromofluoromethane	103	REC %			1	8260B		12/5/2017	CJR	1
SUR - Toluene-d8	100	REC %			1	8260B		12/5/2017	CJR	1
SUR - 1,2-Dichloroethane-d4	105	REC %			1	8260B		12/5/2017	CJR	1

Project Name FMR BARB & RON'S CLEANERS
Project # 6403 PO#2017-1718

Invoice # E33986

Lab Code 5033986F
Sample ID 6403 MW 4100
Sample Matrix Water
Sample Date 12/1/2017

	Result	Unit	LOD	LOQ	Dil	Method	Ext Date	Run Date	Analyst	Code
Organic										
VOC's										
Benzene	< 8.5	ug/l	8.5	27.5	50	8260B		12/5/2017	CJR	1
Bromobenzene	< 21.5	ug/l	21.5	68.5	50	8260B		12/5/2017	CJR	1
Bromodichloromethane	< 15.5	ug/l	15.5	50	50	8260B		12/5/2017	CJR	1
Bromoform	< 24.5	ug/l	24.5	78	50	8260B		12/5/2017	CJR	1
tert-Butylbenzene	< 19.5	ug/l	19.5	61.5	50	8260B		12/5/2017	CJR	1
sec-Butylbenzene	< 12	ug/l	12	38	50	8260B		12/5/2017	CJR	1
n-Butylbenzene	< 17	ug/l	17	54	50	8260B		12/5/2017	CJR	1
Carbon Tetrachloride	< 10.5	ug/l	10.5	34	50	8260B		12/5/2017	CJR	1
Chlorobenzene	< 13.5	ug/l	13.5	43	50	8260B		12/5/2017	CJR	1
Chloroethane	< 25	ug/l	25	80	50	8260B		12/5/2017	CJR	1
Chloroform	< 48	ug/l	48	152	50	8260B		12/5/2017	CJR	1
Chloromethane	< 65	ug/l	65	207.5	50	8260B		12/5/2017	CJR	1
2-Chlorotoluene	< 18	ug/l	18	57.5	50	8260B		12/5/2017	CJR	1
4-Chlorotoluene	< 17.5	ug/l	17.5	55.5	50	8260B		12/5/2017	CJR	1
1,2-Dibromo-3-chloropropane	< 94	ug/l	94	299	50	8260B		12/5/2017	CJR	1
Dibromochloromethane	< 22.5	ug/l	22.5	72	50	8260B		12/5/2017	CJR	1
1,4-Dichlorobenzene	< 21	ug/l	21	67	50	8260B		12/5/2017	CJR	1
1,3-Dichlorobenzene	< 22.5	ug/l	22.5	71.5	50	8260B		12/5/2017	CJR	1
1,2-Dichlorobenzene	< 17	ug/l	17	54.5	50	8260B		12/5/2017	CJR	1
Dichlorodifluoromethane	< 19	ug/l	19	60	50	8260B		12/5/2017	CJR	1
1,2-Dichloroethane	< 22.5	ug/l	22.5	71.5	50	8260B		12/5/2017	CJR	1
1,1-Dichloroethane	< 21	ug/l	21	67	50	8260B		12/5/2017	CJR	1
1,1-Dichloroethene	< 23	ug/l	23	73.5	50	8260B		12/5/2017	CJR	1
cis-1,2-Dichloroethene	142	ug/l	20.5	64.5	50	8260B		12/5/2017	CJR	1
trans-1,2-Dichloroethene	< 17.5	ug/l	17.5	56	50	8260B		12/5/2017	CJR	1
1,2-Dichloropropane	< 19.5	ug/l	19.5	62	50	8260B		12/5/2017	CJR	1
1,3-Dichloropropane	< 24.5	ug/l	24.5	77.5	50	8260B		12/5/2017	CJR	1
trans-1,3-Dichloropropene	< 21	ug/l	21	66.5	50	8260B		12/5/2017	CJR	1
cis-1,3-Dichloropropene	< 10.5	ug/l	10.5	32.5	50	8260B		12/5/2017	CJR	1
Di-isopropyl ether	< 13	ug/l	13	41.5	50	8260B		12/5/2017	CJR	1
EDB (1,2-Dibromoethane)	< 17	ug/l	17	54.5	50	8260B		12/5/2017	CJR	1
Ethylbenzene	< 10	ug/l	10	31.5	50	8260B		12/5/2017	CJR	1
Hexachlorobutadiene	< 73.5	ug/l	73.5	234	50	8260B		12/5/2017	CJR	1
Isopropylbenzene	< 14.5	ug/l	14.5	46.5	50	8260B		12/5/2017	CJR	1
p-Isopropyltoluene	< 14	ug/l	14	45.5	50	8260B		12/5/2017	CJR	1
Methylene chloride	< 47	ug/l	47	149	50	8260B		12/5/2017	CJR	1
Methyl tert-butyl ether (MTBE)	< 41	ug/l	41	130	50	8260B		12/5/2017	CJR	1
Naphthalene	< 108.5	ug/l	108.5	345	50	8260B		12/5/2017	CJR	1
n-Propylbenzene	< 9.5	ug/l	9.5	31	50	8260B		12/5/2017	CJR	1
1,1,2,2-Tetrachloroethane	< 34.5	ug/l	34.5	110.5	50	8260B		12/5/2017	CJR	1
1,1,1,2-Tetrachloroethane	< 23.5	ug/l	23.5	74	50	8260B		12/5/2017	CJR	1
Tetrachloroethene	7800	ug/l	24	76	50	8260B		12/5/2017	CJR	1
Toluene	< 33.5	ug/l	33.5	106.5	50	8260B		12/5/2017	CJR	1
1,2,4-Trichlorobenzene	< 64.5	ug/l	64.5	205	50	8260B		12/5/2017	CJR	1
1,2,3-Trichlorobenzene	< 41.5	ug/l	41.5	131.5	50	8260B		12/5/2017	CJR	1
1,1,1-Trichloroethane	< 17.5	ug/l	17.5	55.5	50	8260B		12/5/2017	CJR	1
1,1,2-Trichloroethane	< 32.5	ug/l	32.5	103	50	8260B		12/5/2017	CJR	1
Trichloroethene (TCE)	250	ug/l	22.5	71.5	50	8260B		12/5/2017	CJR	1
Trichlorofluoromethane	< 32	ug/l	32	102	50	8260B		12/5/2017	CJR	1
1,2,4-Trimethylbenzene	< 57	ug/l	57	181.5	50	8260B		12/5/2017	CJR	1

Project Name FMR BARB & RON'S CLEANERS
Project # 6403 PO#2017-1718

Invoice # E33986

Lab Code 5033986F
Sample ID 6403 MW 4100
Sample Matrix Water
Sample Date 12/1/2017

	Result	Unit	LOD	LOQ	Dil	Method	Ext Date	Run Date	Analyst	Code
1,3,5-Trimethylbenzene	< 45.5	ug/l	45.5	145	50	8260B		12/5/2017	CJR	1
Vinyl Chloride	< 9.5	ug/l	9.5	31	50	8260B		12/5/2017	CJR	1
m&p-Xylene	< 78	ug/l	78	247.5	50	8260B		12/5/2017	CJR	1
o-Xylene	< 19.5	ug/l	19.5	62.5	50	8260B		12/5/2017	CJR	1
SUR - 1,2-Dichloroethane-d4	102	REC %			50	8260B		12/5/2017	CJR	1
SUR - 4-Bromofluorobenzene	105	REC %			50	8260B		12/5/2017	CJR	1
SUR - Dibromofluoromethane	106	REC %			50	8260B		12/5/2017	CJR	1
SUR - Toluene-d8	96	REC %			50	8260B		12/5/2017	CJR	1

Project Name FMR BARB & RON'S CLEANERS
 Project # 6403 PO#2017-1718

Invoice # E33986

Lab Code 5033986G
 Sample ID 6403 DUP1
 Sample Matrix Water
 Sample Date 12/1/2017

	Result	Unit	LOD	LOQ	Dil	Method	Ext Date	Run Date	Analyst	Code
Organic										
VOC's										
Benzene	< 0.17	ug/l	0.17	0.55	1	8260B		12/5/2017	CJR	1
Bromobenzene	< 0.43	ug/l	0.43	1.37	1	8260B		12/5/2017	CJR	1
Bromodichloromethane	< 0.31	ug/l	0.31	1	1	8260B		12/5/2017	CJR	1
Bromoform	< 0.49	ug/l	0.49	1.56	1	8260B		12/5/2017	CJR	1
tert-Butylbenzene	< 0.39	ug/l	0.39	1.23	1	8260B		12/5/2017	CJR	1
sec-Butylbenzene	< 0.24	ug/l	0.24	0.76	1	8260B		12/5/2017	CJR	1
n-Butylbenzene	< 0.34	ug/l	0.34	1.08	1	8260B		12/5/2017	CJR	1
Carbon Tetrachloride	< 0.21	ug/l	0.21	0.68	1	8260B		12/5/2017	CJR	1
Chlorobenzene	< 0.27	ug/l	0.27	0.86	1	8260B		12/5/2017	CJR	1
Chloroethane	< 0.5	ug/l	0.5	1.6	1	8260B		12/5/2017	CJR	1
Chloroform	< 0.96	ug/l	0.96	3.04	1	8260B		12/5/2017	CJR	1
Chloromethane	< 1.3	ug/l	1.3	4.15	1	8260B		12/5/2017	CJR	1
2-Chlorotoluene	< 0.36	ug/l	0.36	1.15	1	8260B		12/5/2017	CJR	1
4-Chlorotoluene	< 0.35	ug/l	0.35	1.11	1	8260B		12/5/2017	CJR	1
1,2-Dibromo-3-chloropropane	< 1.88	ug/l	1.88	5.98	1	8260B		12/5/2017	CJR	1
Dibromochloromethane	< 0.45	ug/l	0.45	1.44	1	8260B		12/5/2017	CJR	1
1,4-Dichlorobenzene	< 0.42	ug/l	0.42	1.34	1	8260B		12/5/2017	CJR	1
1,3-Dichlorobenzene	< 0.45	ug/l	0.45	1.43	1	8260B		12/5/2017	CJR	1
1,2-Dichlorobenzene	< 0.34	ug/l	0.34	1.09	1	8260B		12/5/2017	CJR	1
Dichlorodifluoromethane	< 0.38	ug/l	0.38	1.2	1	8260B		12/5/2017	CJR	1
1,2-Dichloroethane	< 0.45	ug/l	0.45	1.43	1	8260B		12/5/2017	CJR	1
1,1-Dichloroethane	< 0.42	ug/l	0.42	1.34	1	8260B		12/5/2017	CJR	1
1,1-Dichloroethene	< 0.46	ug/l	0.46	1.47	1	8260B		12/5/2017	CJR	1
cis-1,2-Dichloroethene	0.46 "J"	ug/l	0.41	1.29	1	8260B		12/5/2017	CJR	1
trans-1,2-Dichloroethene	< 0.35	ug/l	0.35	1.12	1	8260B		12/5/2017	CJR	1
1,2-Dichloropropane	< 0.39	ug/l	0.39	1.24	1	8260B		12/5/2017	CJR	1
1,3-Dichloropropane	< 0.49	ug/l	0.49	1.55	1	8260B		12/5/2017	CJR	1
trans-1,3-Dichloropropene	< 0.42	ug/l	0.42	1.33	1	8260B		12/5/2017	CJR	1
cis-1,3-Dichloropropene	< 0.21	ug/l	0.21	0.65	1	8260B		12/5/2017	CJR	1
Di-isopropyl ether	< 0.26	ug/l	0.26	0.83	1	8260B		12/5/2017	CJR	1
EDB (1,2-Dibromoethane)	< 0.34	ug/l	0.34	1.09	1	8260B		12/5/2017	CJR	1
Ethylbenzene	< 0.2	ug/l	0.2	0.63	1	8260B		12/5/2017	CJR	1
Hexachlorobutadiene	< 1.47	ug/l	1.47	4.68	1	8260B		12/5/2017	CJR	1
Isopropylbenzene	< 0.29	ug/l	0.29	0.93	1	8260B		12/5/2017	CJR	1
p-Isopropyltoluene	< 0.28	ug/l	0.28	0.91	1	8260B		12/5/2017	CJR	1
Methylene chloride	< 0.94	ug/l	0.94	2.98	1	8260B		12/5/2017	CJR	1
Methyl tert-butyl ether (MTBE)	< 0.82	ug/l	0.82	2.6	1	8260B		12/5/2017	CJR	1
Naphthalene	< 2.17	ug/l	2.17	6.9	1	8260B		12/5/2017	CJR	1
n-Propylbenzene	< 0.19	ug/l	0.19	0.62	1	8260B		12/5/2017	CJR	1
1,1,2,2-Tetrachloroethane	< 0.69	ug/l	0.69	2.21	1	8260B		12/5/2017	CJR	1
1,1,1,2-Tetrachloroethane	< 0.47	ug/l	0.47	1.48	1	8260B		12/5/2017	CJR	1
Tetrachloroethene	1.69	ug/l	0.48	1.52	1	8260B		12/5/2017	CJR	1
Toluene	< 0.67	ug/l	0.67	2.13	1	8260B		12/5/2017	CJR	1
1,2,4-Trichlorobenzene	< 1.29	ug/l	1.29	4.1	1	8260B		12/5/2017	CJR	1
1,2,3-Trichlorobenzene	< 0.83	ug/l	0.83	2.63	1	8260B		12/5/2017	CJR	1
1,1,1-Trichloroethane	< 0.35	ug/l	0.35	1.11	1	8260B		12/5/2017	CJR	1
1,1,2-Trichloroethane	< 0.65	ug/l	0.65	2.06	1	8260B		12/5/2017	CJR	1
Trichloroethene (TCE)	1.29 "J"	ug/l	0.45	1.43	1	8260B		12/5/2017	CJR	1
Trichlorofluoromethane	< 0.64	ug/l	0.64	2.04	1	8260B		12/5/2017	CJR	1
1,2,4-Trimethylbenzene	< 1.14	ug/l	1.14	3.63	1	8260B		12/5/2017	CJR	1

Project Name FMR BARB & RON'S CLEANERS
Project # 6403 PO#2017-1718

Invoice # E33986

Lab Code 5033986G
Sample ID 6403 DUP1
Sample Matrix Water
Sample Date 12/1/2017

	Result	Unit	LOD	LOQ	Dil	Method	Ext Date	Run Date	Analyst	Code
1,3,5-Trimethylbenzene	< 0.91	ug/l	0.91	2.9	1	8260B		12/5/2017	CJR	1
Vinyl Chloride	< 0.19	ug/l	0.19	0.62	1	8260B		12/5/2017	CJR	1
m&p-Xylene	< 1.56	ug/l	1.56	4.95	1	8260B		12/5/2017	CJR	1
o-Xylene	< 0.39	ug/l	0.39	1.25	1	8260B		12/5/2017	CJR	1
SUR - 1,2-Dichloroethane-d4	101	REC %			1	8260B		12/5/2017	CJR	1
SUR - 4-Bromofluorobenzene	111	REC %			1	8260B		12/5/2017	CJR	1
SUR - Dibromofluoromethane	107	REC %			1	8260B		12/5/2017	CJR	1
SUR - Toluene-d8	97	REC %			1	8260B		12/5/2017	CJR	1

Project Name FMR BARB & RON'S CLEANERS
 Project # 6403 PO#2017-1718

Invoice # E33986

Lab Code 5033986H
 Sample ID 6403 TB
 Sample Matrix Water
 Sample Date 12/1/2017

	Result	Unit	LOD	LOQ	Dil	Method	Ext Date	Run Date	Analyst	Code
Organic										
VOC's										
Benzene	< 0.17	ug/l	0.17	0.55	1	8260B		12/5/2017	CJR	1
Bromobenzene	< 0.43	ug/l	0.43	1.37	1	8260B		12/5/2017	CJR	1
Bromodichloromethane	< 0.31	ug/l	0.31	1	1	8260B		12/5/2017	CJR	1
Bromoform	< 0.49	ug/l	0.49	1.56	1	8260B		12/5/2017	CJR	1
tert-Butylbenzene	< 0.39	ug/l	0.39	1.23	1	8260B		12/5/2017	CJR	1
sec-Butylbenzene	< 0.24	ug/l	0.24	0.76	1	8260B		12/5/2017	CJR	1
n-Butylbenzene	< 0.34	ug/l	0.34	1.08	1	8260B		12/5/2017	CJR	1
Carbon Tetrachloride	< 0.21	ug/l	0.21	0.68	1	8260B		12/5/2017	CJR	1
Chlorobenzene	< 0.27	ug/l	0.27	0.86	1	8260B		12/5/2017	CJR	1
Chloroethane	< 0.5	ug/l	0.5	1.6	1	8260B		12/5/2017	CJR	1
Chloroform	< 0.96	ug/l	0.96	3.04	1	8260B		12/5/2017	CJR	1
Chloromethane	< 1.3	ug/l	1.3	4.15	1	8260B		12/5/2017	CJR	1
2-Chlorotoluene	< 0.36	ug/l	0.36	1.15	1	8260B		12/5/2017	CJR	1
4-Chlorotoluene	< 0.35	ug/l	0.35	1.11	1	8260B		12/5/2017	CJR	1
1,2-Dibromo-3-chloropropane	< 1.88	ug/l	1.88	5.98	1	8260B		12/5/2017	CJR	1
Dibromochloromethane	< 0.45	ug/l	0.45	1.44	1	8260B		12/5/2017	CJR	1
1,4-Dichlorobenzene	< 0.42	ug/l	0.42	1.34	1	8260B		12/5/2017	CJR	1
1,3-Dichlorobenzene	< 0.45	ug/l	0.45	1.43	1	8260B		12/5/2017	CJR	1
1,2-Dichlorobenzene	< 0.34	ug/l	0.34	1.09	1	8260B		12/5/2017	CJR	1
Dichlorodifluoromethane	< 0.38	ug/l	0.38	1.2	1	8260B		12/5/2017	CJR	1
1,2-Dichloroethane	< 0.45	ug/l	0.45	1.43	1	8260B		12/5/2017	CJR	1
1,1-Dichloroethane	< 0.42	ug/l	0.42	1.34	1	8260B		12/5/2017	CJR	1
1,1-Dichloroethene	< 0.46	ug/l	0.46	1.47	1	8260B		12/5/2017	CJR	1
cis-1,2-Dichloroethene	< 0.41	ug/l	0.41	1.29	1	8260B		12/5/2017	CJR	1
trans-1,2-Dichloroethene	< 0.35	ug/l	0.35	1.12	1	8260B		12/5/2017	CJR	1
1,2-Dichloropropane	< 0.39	ug/l	0.39	1.24	1	8260B		12/5/2017	CJR	1
1,3-Dichloropropane	< 0.49	ug/l	0.49	1.55	1	8260B		12/5/2017	CJR	1
trans-1,3-Dichloropropene	< 0.42	ug/l	0.42	1.33	1	8260B		12/5/2017	CJR	1
cis-1,3-Dichloropropene	< 0.21	ug/l	0.21	0.65	1	8260B		12/5/2017	CJR	1
Di-isopropyl ether	< 0.26	ug/l	0.26	0.83	1	8260B		12/5/2017	CJR	1
EDB (1,2-Dibromoethane)	< 0.34	ug/l	0.34	1.09	1	8260B		12/5/2017	CJR	1
Ethylbenzene	< 0.2	ug/l	0.2	0.63	1	8260B		12/5/2017	CJR	1
Hexachlorobutadiene	< 1.47	ug/l	1.47	4.68	1	8260B		12/5/2017	CJR	1
Isopropylbenzene	< 0.29	ug/l	0.29	0.93	1	8260B		12/5/2017	CJR	1
p-Isopropyltoluene	< 0.28	ug/l	0.28	0.91	1	8260B		12/5/2017	CJR	1
Methylene chloride	< 0.94	ug/l	0.94	2.98	1	8260B		12/5/2017	CJR	1
Methyl tert-butyl ether (MTBE)	< 0.82	ug/l	0.82	2.6	1	8260B		12/5/2017	CJR	1
Naphthalene	< 2.17	ug/l	2.17	6.9	1	8260B		12/5/2017	CJR	1
n-Propylbenzene	< 0.19	ug/l	0.19	0.62	1	8260B		12/5/2017	CJR	1
1,1,2,2-Tetrachloroethane	< 0.69	ug/l	0.69	2.21	1	8260B		12/5/2017	CJR	1
1,1,1,2-Tetrachloroethane	< 0.47	ug/l	0.47	1.48	1	8260B		12/5/2017	CJR	1
Tetrachloroethene	< 0.48	ug/l	0.48	1.52	1	8260B		12/5/2017	CJR	1
Toluene	< 0.67	ug/l	0.67	2.13	1	8260B		12/5/2017	CJR	1
1,2,4-Trichlorobenzene	< 1.29	ug/l	1.29	4.1	1	8260B		12/5/2017	CJR	1
1,2,3-Trichlorobenzene	< 0.83	ug/l	0.83	2.63	1	8260B		12/5/2017	CJR	1
1,1,1-Trichloroethane	< 0.35	ug/l	0.35	1.11	1	8260B		12/5/2017	CJR	1
1,1,2-Trichloroethane	< 0.65	ug/l	0.65	2.06	1	8260B		12/5/2017	CJR	1
Trichloroethene (TCE)	< 0.45	ug/l	0.45	1.43	1	8260B		12/5/2017	CJR	1
Trichlorofluoromethane	< 0.64	ug/l	0.64	2.04	1	8260B		12/5/2017	CJR	1
1,2,4-Trimethylbenzene	< 1.14	ug/l	1.14	3.63	1	8260B		12/5/2017	CJR	1

Project Name FMR BARB & RON'S CLEANERS
Project # 6403 PO#2017-1718

Invoice # E33986

Lab Code 5033986H
Sample ID 6403 TB
Sample Matrix Water
Sample Date 12/1/2017

	Result	Unit	LOD	LOQ	Dil	Method	Ext Date	Run Date	Analyst	Code
1,3,5-Trimethylbenzene	< 0.91	ug/l	0.91	2.9	1	8260B		12/5/2017	CJR	1
Vinyl Chloride	< 0.19	ug/l	0.19	0.62	1	8260B		12/5/2017	CJR	1
m&p-Xylene	< 1.56	ug/l	1.56	4.95	1	8260B		12/5/2017	CJR	1
o-Xylene	< 0.39	ug/l	0.39	1.25	1	8260B		12/5/2017	CJR	1
SUR - Toluene-d8	97	REC %			1	8260B		12/5/2017	CJR	1
SUR - 1,2-Dichloroethane-d4	97	REC %			1	8260B		12/5/2017	CJR	1
SUR - 4-Bromofluorobenzene	103	REC %			1	8260B		12/5/2017	CJR	1
SUR - Dibromofluoromethane	105	REC %			1	8260B		12/5/2017	CJR	1

Project Name FMR BARB & RON'S CLEANERS
 Project # 6403 PO#2017-1718

Invoice # E33986

Lab Code 5033986I
 Sample ID 6403 IDM
 Sample Matrix Water
 Sample Date 12/1/2017

	Result	Unit	LOD	LOQ	Dil	Method	Ext Date	Run Date	Analyst	Code
Organic										
VOC's										
Benzene	< 1.7	ug/l	1.7	5.5	10	8260B		12/7/2017	CJR	1
Bromobenzene	< 4.3	ug/l	4.3	13.7	10	8260B		12/7/2017	CJR	1
Bromodichloromethane	< 3.1	ug/l	3.1	10	10	8260B		12/7/2017	CJR	1
Bromoform	< 4.9	ug/l	4.9	15.6	10	8260B		12/7/2017	CJR	1
tert-Butylbenzene	< 3.9	ug/l	3.9	12.3	10	8260B		12/7/2017	CJR	1
sec-Butylbenzene	< 2.4	ug/l	2.4	7.6	10	8260B		12/7/2017	CJR	1
n-Butylbenzene	< 3.4	ug/l	3.4	10.8	10	8260B		12/7/2017	CJR	1
Carbon Tetrachloride	< 2.1	ug/l	2.1	6.8	10	8260B		12/7/2017	CJR	1
Chlorobenzene	< 2.7	ug/l	2.7	8.6	10	8260B		12/7/2017	CJR	1
Chloroethane	< 5	ug/l	5	16	10	8260B		12/7/2017	CJR	1
Chloroform	< 9.6	ug/l	9.6	30.4	10	8260B		12/7/2017	CJR	1
Chloromethane	< 13	ug/l	13	41.5	10	8260B		12/7/2017	CJR	1
2-Chlorotoluene	< 3.6	ug/l	3.6	11.5	10	8260B		12/7/2017	CJR	1
4-Chlorotoluene	< 3.5	ug/l	3.5	11.1	10	8260B		12/7/2017	CJR	1
1,2-Dibromo-3-chloropropane	< 18.8	ug/l	18.8	59.8	10	8260B		12/7/2017	CJR	1
Dibromochloromethane	< 4.5	ug/l	4.5	14.4	10	8260B		12/7/2017	CJR	1
1,4-Dichlorobenzene	< 4.2	ug/l	4.2	13.4	10	8260B		12/7/2017	CJR	1
1,3-Dichlorobenzene	< 4.5	ug/l	4.5	14.3	10	8260B		12/7/2017	CJR	1
1,2-Dichlorobenzene	< 3.4	ug/l	3.4	10.9	10	8260B		12/7/2017	CJR	1
Dichlorodifluoromethane	< 3.8	ug/l	3.8	12	10	8260B		12/7/2017	CJR	1
1,2-Dichloroethane	< 4.5	ug/l	4.5	14.3	10	8260B		12/7/2017	CJR	1
1,1-Dichloroethane	< 4.2	ug/l	4.2	13.4	10	8260B		12/7/2017	CJR	1
1,1-Dichloroethene	< 4.6	ug/l	4.6	14.7	10	8260B		12/7/2017	CJR	1
cis-1,2-Dichloroethene	5.5 "J"	ug/l	4.1	12.9	10	8260B		12/7/2017	CJR	1
trans-1,2-Dichloroethene	< 3.5	ug/l	3.5	11.2	10	8260B		12/7/2017	CJR	1
1,2-Dichloropropane	< 3.9	ug/l	3.9	12.4	10	8260B		12/7/2017	CJR	1
1,3-Dichloropropane	< 4.9	ug/l	4.9	15.5	10	8260B		12/7/2017	CJR	1
trans-1,3-Dichloropropene	< 4.2	ug/l	4.2	13.3	10	8260B		12/7/2017	CJR	1
cis-1,3-Dichloropropene	< 2.1	ug/l	2.1	6.5	10	8260B		12/7/2017	CJR	1
Di-isopropyl ether	< 2.6	ug/l	2.6	8.3	10	8260B		12/7/2017	CJR	1
EDB (1,2-Dibromoethane)	< 3.4	ug/l	3.4	10.9	10	8260B		12/7/2017	CJR	1
Ethylbenzene	< 2	ug/l	2	6.3	10	8260B		12/7/2017	CJR	1
Hexachlorobutadiene	< 14.7	ug/l	14.7	46.8	10	8260B		12/7/2017	CJR	1
Isopropylbenzene	< 2.9	ug/l	2.9	9.3	10	8260B		12/7/2017	CJR	1
p-Isopropyltoluene	< 2.8	ug/l	2.8	9.1	10	8260B		12/7/2017	CJR	1
Methylene chloride	< 9.4	ug/l	9.4	29.8	10	8260B		12/7/2017	CJR	1
Methyl tert-butyl ether (MTBE)	< 8.2	ug/l	8.2	26	10	8260B		12/7/2017	CJR	1
Naphthalene	< 21.7	ug/l	21.7	69	10	8260B		12/7/2017	CJR	1
n-Propylbenzene	< 1.9	ug/l	1.9	6.2	10	8260B		12/7/2017	CJR	1
1,1,2,2-Tetrachloroethane	< 6.9	ug/l	6.9	22.1	10	8260B		12/7/2017	CJR	1
1,1,1,2-Tetrachloroethane	< 4.7	ug/l	4.7	14.8	10	8260B		12/7/2017	CJR	1
Tetrachloroethene	320	ug/l	4.8	15.2	10	8260B		12/7/2017	CJR	1
Toluene	< 6.7	ug/l	6.7	21.3	10	8260B		12/7/2017	CJR	1
1,2,4-Trichlorobenzene	< 12.9	ug/l	12.9	41	10	8260B		12/7/2017	CJR	1
1,2,3-Trichlorobenzene	< 8.3	ug/l	8.3	26.3	10	8260B		12/7/2017	CJR	1
1,1,1-Trichloroethane	< 3.5	ug/l	3.5	11.1	10	8260B		12/7/2017	CJR	1
1,1,2-Trichloroethane	< 6.5	ug/l	6.5	20.6	10	8260B		12/7/2017	CJR	1
Trichloroethene (TCE)	14.3 "J"	ug/l	4.5	14.3	10	8260B		12/7/2017	CJR	1
Trichlorofluoromethane	< 6.4	ug/l	6.4	20.4	10	8260B		12/7/2017	CJR	1
1,2,4-Trimethylbenzene	< 11.4	ug/l	11.4	36.3	10	8260B		12/7/2017	CJR	1

Project Name FMR BARB & RON'S CLEANERS
Project # 6403 PO#2017-1718

Invoice # E33986

Lab Code 5033986I
Sample ID 6403 IDM
Sample Matrix Water
Sample Date 12/1/2017

	Result	Unit	LOD	LOQ	Dil	Method	Ext Date	Run Date	Analyst	Code
1,3,5-Trimethylbenzene	< 9.1	ug/l	9.1	29	10	8260B		12/7/2017	CJR	1
Vinyl Chloride	< 1.9	ug/l	1.9	6.2	10	8260B		12/7/2017	CJR	1
m&p-Xylene	< 15.6	ug/l	15.6	49.5	10	8260B		12/7/2017	CJR	1
o-Xylene	< 3.9	ug/l	3.9	12.5	10	8260B		12/7/2017	CJR	1
SUR - Toluene-d8	98	REC %			10	8260B		12/7/2017	CJR	1
SUR - 1,2-Dichloroethane-d4	96	REC %			10	8260B		12/7/2017	CJR	1
SUR - 4-Bromofluorobenzene	107	REC %			10	8260B		12/7/2017	CJR	1
SUR - Dibromofluoromethane	103	REC %			10	8260B		12/7/2017	CJR	1

"J" Flag: Analyte detected between LOD and LOQ

LOD Limit of Detection

LOQ Limit of Quantitation

Code ***Comment***

1 Laboratory QC within limits.

All solid sample results reported on a dry weight basis unless otherwise indicated. All LOD's and LOQ's are adjusted for dilutions but not dry weight. Subcontracted results are denoted by SUB in the analyst field.

Authorized Signature



1990 Prospect Ct. • Appleton, WI 54914
920-830-2455 • FAX 920-733-0631

Sample Handling Request

Rush Analysis Date Required _____
(Rushes accepted only with prior authorization)

Normal Turn Around

Lab I.D. # _____
Account No.: _____
Quote No.: _____
Project #: 6403
Sampler: (signature) _____

Project (Name / Location): former Barb and Pans Cleaners / Appleton, WI

Reports To: R. Haverman / K. Hemstead
Company: Enviro Forensics
Address: 216 W23390 Stone Ridge Dr., STE 6
City State Zip: Waukesha WI 53188
Phone: _____
FAX: _____

Invoice To: _____
Company: _____
Address: _____
City State Zip: _____
Phone: _____
FAX: _____

Lab I.D.	Sample I.D.	Collection Date	Time	Comp	Grab	Filtered Y/N	No. of Containers	Sample Type (Matrix)*	Preservation	Analysis Requested										Other Analysis	PID/ FID					
										DRO (Mod DRO Sep 95)	GRO (Mod GRO Sep 95)	LEAD	NITRATE/NITRITE	OIL & GREASE	PAH (EPA 8270)	PCB	PVOC (EPA 8021)	PVOC + NAPHTHALENE	SULFATE			TOTAL SUSPENDED SOLIDS	VOC DW (EPA 524.2)	VOC (EPA 8260)	8-RCRA METALS	
A	6403-MW1100	12-17	950		X	N	3	GW	HCC																	
B	6403-MW1300	12-17	958		X	N	3	GW	HCC																	
C	6403-MW1600	12-17	907		X	N	1	GW	HCC																	
D	6407-MW800	12-17	914		X	N	3	GW	HCC																	
E	6403-MW2300	12-17	925		X	N	3	GW	HCC																	
F	6407-MW4100	12-17	933		X	N	3	GW	HCC																	
G	6403-DJF1	12-17	-		X	N	3	GW	HCC																	
H	6403-TB	12-17	-		X	N	1	GW	HCC																	
I	6403-1PM	12-17	945	X		N	3	GW	HCC																	

Comments/Special Instructions ("Specify groundwater "GW", Drinking Water "DW", Waste Water "WW", Soil "S", Air "A", Oil, Sludge etc.)

PO# 2017-1718

Sample Integrity - To be completed by receiving lab.
Method of Shipment: Overnight °C On Ice: A
Temp. of Temp. Blank: _____ Yes ___ No ___
Cooler seal intact upon receipt: X Yes ___ No ___

Relinquished By: (sign) _____ Time 1033 Date 12-17
Received in Laboratory By: [Signature] Time: 1033 Date: 12/17