



March 12, 2014

RECEIVED

MAR 18 2014

BY: JS

Ms. Kathryn Knowlton  
Off-site Property Owner  
7219 W. Center Street  
Wauwatosa, Wisconsin 53210

**Subject: Environmental sampling results  
Former Hoffman Valet Cleaners  
7215 W. Center Street  
Wauwatosa, Wisconsin  
FID # 241083150  
BRRTs # 02-41-307576**

Dear Ms. Knowlton:

In accordance with Wisconsin Department of Natural Resources (WDNR) regulation NR 716.14, Environmental Forensic Investigations, Inc. (EnviroForensics) is providing the results of environmental samples collected from your property located at 7219 W. Center Street, Wauwatosa, Wisconsin on February 20, 2014. The sampling activities are part of an environmental investigation being performed for Mr. Ralph Hoffman under the direction of the WDNR pursuant to the authority granted to it under State and Federal law. The chemicals of concern for the investigation are the dry cleaning solvent tetrachloroethylene (PCE) and its associated breakdown products, collectively referred to as chlorinated volatile organic compounds (CVOCs).

The Responsible Party is:

Mr. Ralph Hoffman  
**(Summer Address)**  
2010 W. Woodbury Lane  
Glendale, WI 53209  
Telephone: (414) 581-2777

**(Winter Address)**  
14000 N. 94<sup>th</sup> Street, Unit 3092  
Scottsdale, AZ 85260

### Sampling Type, Locations, and Results

Two (2) sub-slab vapor samples were collected from within the basement and one (1) sample of indoor air was collected from the first floor of your property at the locations

depicted on the enclosed hand sketch. In addition, one (1) sample of outdoor air was collected to determine background levels of CVOCs. The sample results are summarized and compared to Vapor Risk Screening Levels (VRSLs) on enclosed **Table 1 and Table 2**. The laboratory report sheets that relate to the vapor samples are also attached.

CVOCs were not detected in any of the sub-slab vapor samples or the indoor air sample in concentrations which exceed applicable standards.

We will likely need to collect one more round of sampling sometime this summer to confirm these results. We will contact you to discuss additional investigation or remediation work as may be required.

If you have any questions or concerns, please contact me at 414-982-3988 or by email at [wfassbender@enviroforensics.com](mailto:wfassbender@enviroforensics.com). The WDNR project manager, John Hnat, can be reached at 414-263-8644. We greatly appreciate your help and patience with this matter.

Sincerely,  
**Environmental Forensic Investigations, Inc.**

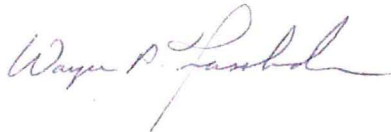
A handwritten signature in blue ink that reads "Wayne P. Fassbender".

Wayne Fassbender, PG, PMP  
*Senior Project Manager*

Attachments: Sub-Slab Vapor Sampling Location Hand Sketch  
Analytical Results Summary Table  
Analytical Report for Sub-Slab Samples

Copy:

Ralph Hoffman  
John Hnat, Wisconsin Department of Natural Resources

7219 West Center St

2/20/2017

O = Sump  
a = Sample location

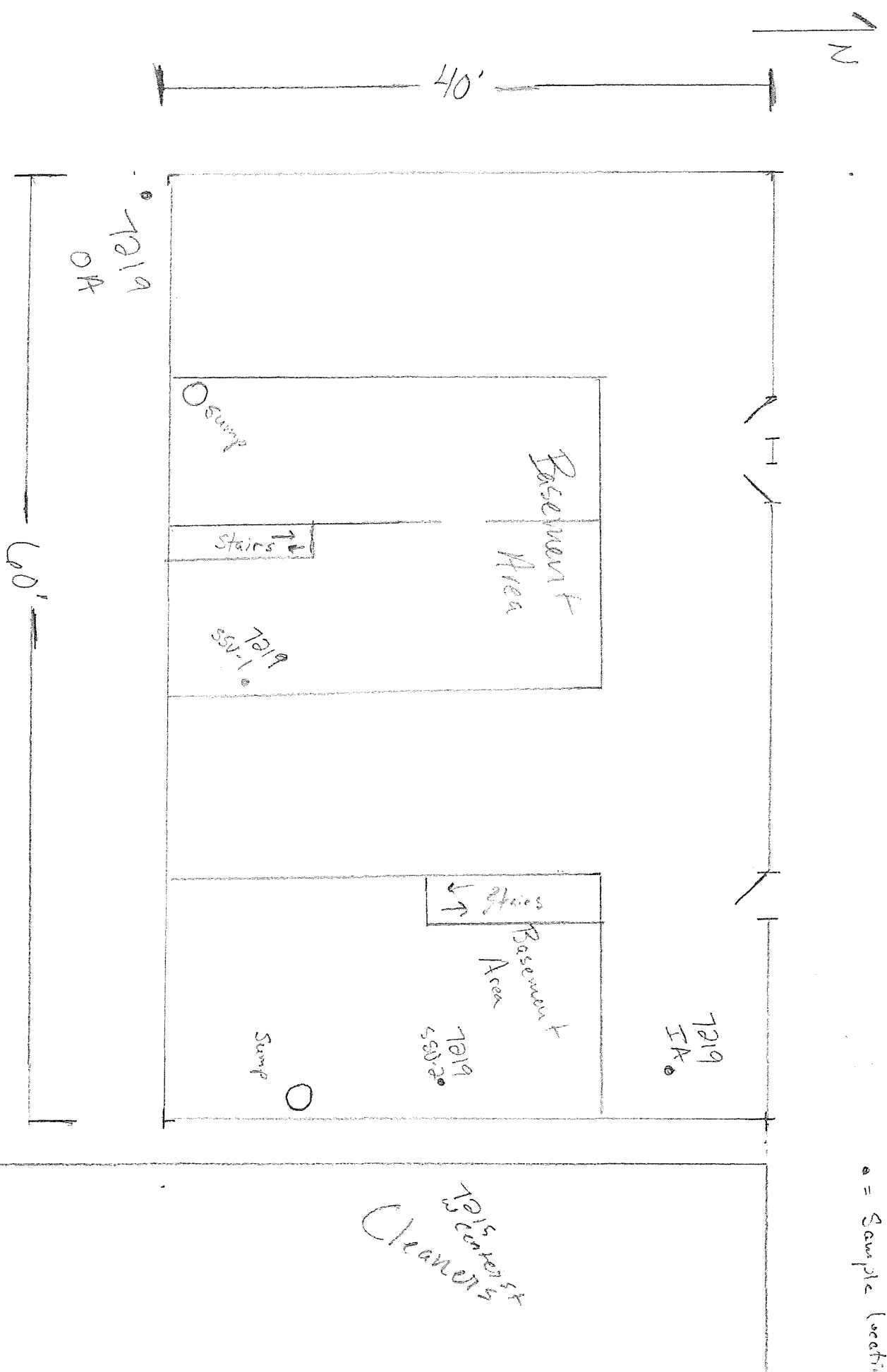

**TABLE 1**  
**SUMMARY OF CURRENT SUB-SLAB VAPOR SAMPLE**  
**ANALYTICAL RESULTS**  
 7219 West Center Street  
 Wauwatosa, Wisconsin

| Sample Identification                          | Sample Date | Property Address (W. Center St) | Tetrachloroethene | Trichloroethene | cis-1-2-Dichloroethene |
|--|-------------|---------------------------------|-------------------|-----------------|------------------------|
| 7219-SSV-1                                     | 9/4/2013    | 7219                            | <b>298</b>        | <b>8.54</b>     | <19.8                  |
|  | 2/20/2014   |                                 | <b>239</b>        | <10.7           | <7.90                  |
| 7219-SSV-2                                     | 9/4/2013    | 7219                            | <b>36.6</b>       | <1.07           | <19.8                  |
|  | 2/20/2014   |                                 | <b>118.0</b>      | <10.7           | <7.90                  |
| <b>Vapor Risk Screening Level <sup>1</sup></b> |             |                                 | <b>1,800</b>      | <b>88</b>       | <b>NE</b>              |

**Notes:**

<sup>1</sup> The Vapor Risk Screening Levels are based on U.S. EPA Regional Screening Levels for non-residential indoor air with an attenuation factor of 0.1 and a 0.1 adjustment for 1 x 10<sup>-5</sup> excess cancer risk for carcinogens.

2006 and 2009 data collected by ARCADIS

All concentrations reported in units of micrograms per cubic meter (ug/m3)

**Bolded** and orange shaded values exceed the Vapor Risk Screening Level

**Bolded** values are above detection limits

NE = Not Established

**TABLE 2**  
**SUMMARY OF INDOOR/OUTDOOR AIR SAMPLE ANALYTICAL RESULTS**  
**7219 WEST CENTER STREET**  
Wawuwatosa, Wisconsin

| Sample Identification     | Sample Date | Tetrachloroethene | Trichloroethene |
|---------------------------|-------------|-------------------|-----------------|
| 7219-IA                   | 9/4/2013    | <b>9.16</b>       | <1.07           |
|                           | 2/19/2014   | <b>2.71</b>       | <1.07           |
| 7219-OA                   | 9/4/2013    | <b>22.4</b>       | <b>1.07</b>     |
|                           | 2/19/2014   | <1.4              | <1.07           |
| <b>Vapor Action Level</b> |             | <b>180</b>        | <b>8.8</b>      |

**Notes:**

Units in micrograms per cubic meter = ug/m<sup>3</sup>

**Bolded** values are above the method detection limit.

**Bolded** and orange shaded values exceed the non-residential Vapor Action Level defined in WDNR publication RR-800.



**EnvisionAir**  
 1437 Sadlier Circle West Drive  
 Indianapolis, IN 46239  
 Ph: 317-351-0885  
 Fax: 317-351-0882  
 www.envision-air.com

**Client Name:** ENVIROFORENSICS

**Project ID:** 6200 - HOFFMANS

**Client Project Manager:** JONATHON JORDAN

**EnvisionAir Project Number:** 2014-67

**Analytical Method:** TO-15  
**Analytical Batch:** 030114AIR

**Client Sample ID:** 6200-7219-OA

**Sample Collection START Date/Time:** 2/19/14 8:15

**Sample Collection END Date/Time:** 2/19/14 16:10

**Envision Sample Number:** 14-345

**Sample Received Date/Time:** 2/25/14 12:00

**Sample Matrix:** AIR

| <u>Compounds</u>                 | <u>Sample Results ug/m<sup>3</sup></u> | <u>Reporting Limit ug/m<sup>3</sup></u> | <u>Flag</u> |
|----------------------------------|--|---|-------------|
| cis-1,2-Dichloroethene           | < 0.79                                 | 0.79                                    |             |
| Tetrachloroethene                | < 1.4                                  | 1.4                                     |             |
| trans-1,2-Dichloroethene         | < 39.6                                 | 39.6                                    |             |
| Trichlorethene                   | < 1.07                                 | 1.07                                    |             |
| Vinyl Chloride                   | < 0.51                                 | 0.51                                    |             |
| 4-bromofluorobenzene (surrogate) | 104%                                   |   |             |
| Analysis Date/Time:              | 3-1-14/20:15                           |   |             |
| Analyst Initials                 | tjg                                    |   |             |



**EnvisionAir**  
 1437 Sadlier Circle West Drive  
 Indianapolis, IN 46239  
 Ph: 317-351-0885  
 Fax: 317-351-0882  
 www.envision-air.com

**Client Name:** ENVIROFORENSICS

**Project ID:** 6200 - HOFFMANS

**Client Project Manager:** JONATHON JORDAN

**EnvisionAir Project Number:** 2014-67

**Analytical Method:** TO-15  
**Analytical Batch:** 030114AIR

**Client Sample ID:** 6200-7219-IA

**Sample Collection START Date/Time:** 2/19/14 8:05  
**Sample Collection END Date/Time:** 2/19/14 16:00  
**Sample Received Date/Time:** 2/25/14 12:00

**Envision Sample Number:** 14-346  
**Sample Matrix:** AIR

| <u>Compounds</u>                 | <u>Sample Results ug/m<sup>3</sup></u> | <u>Reporting Limit ug/m<sup>3</sup></u> | <u>Flag</u> |
|----------------------------------|--|---|-------------|
| cis-1,2-Dichloroethene           | < 0.79                                 | 0.79                                    |             |
| Tetrachloroethene                | <b>2.71</b>                            | 1.4                                     |             |
| trans-1,2-Dichloroethene         | < 39.6                                 | 39.6                                    |             |
| Trichlorethene                   | < 1.07                                 | 1.07                                    |             |
| Vinyl Chloride                   | < 0.51                                 | 0.51                                    |             |
| 4-bromofluorobenzene (surrogate) | 104%                                   |   |             |
| Analysis Date/Time:              | 3-1-14/20:52                           |   |             |
| Analyst Initials                 | tjg                                    |   |             |



**EnvisionAir**  
 1437 Sadlier Circle West Drive  
 Indianapolis, IN 46239  
 Ph: 317-351-0885  
 Fax: 317-351-0882  
 www.envision-air.com

**Client Name:** ENVIROFORENSICS  
**Project ID:** 6200 - HOFFMANS  
**Client Project Manager:** JONATHON JORDAN  
**EnvisionAir Project Number:** 2014-67

**Analytical Method:** TO-15  
**Analytical Batch:** 022714AIR

**Client Sample ID:** 6200-7219-SSV-1      **Sample Collection START Date/Time:** 2/20/14      11:25  
**Envision Sample Number:** 14-347      **Sample Collection END Date/Time:** 2/20/14      11:30  
**Sample Matrix:** AIR      **Sample Received Date/Time:** 2/25/14      12:00

| <u>Compounds</u>                 | <u>Sample Results ug/m<sup>3</sup></u> | <u>Reporting Limit ug/m<sup>3</sup></u> | <u>Flag</u> |
|----------------------------------|--|---|-------------|
| cis-1,2-Dichloroethene           | < 7.90                                 | 7.90                                    | 1           |
| Tetrachloroethene                | 239                                    | 14.0                                    | 1           |
| trans-1,2-Dichloroethene         | < 396                                  | 396                                     | 1           |
| Trichlorethene                   | < 10.7                                 | 10.7                                    | 1           |
| Vinyl Chloride                   | < 5.10                                 | 5.10                                    | 1           |
| 4-bromofluorobenzene (surrogate) | 100%                                   |   |             |
| <b>Analysis Date/Time:</b>       | 2-28-14/07:18                          |   |             |
| <b>Analyst Initials</b>          | tjg                                    |   |             |





**EnvisionAir**  
 1437 Sadlier Circle West Drive  
 Indianapolis, IN 46239  
 Ph: 317-351-0885  
 Fax: 317-351-0882  
 www.envision-air.com

**Client Name:** ENVIROFORENSICS  
**Project ID:** 6200 - HOFFMANS  
**Client Project Manager:** JONATHON JORDAN  
**EnvisionAir Project Number:** 2014-67

**Analytical Method:** TO-15  
**Analytical Batch:** 022714AIR

**Client Sample ID:** 6200-7219-SSV-2  
**Envision Sample Number:** 14-348  
**Sample Matrix:** AIR

**Sample Collection START Date/Time:** 2/20/14 10:45  
**Sample Collection END Date/Time:** 2/20/14 10:50  
**Sample Received Date/Time:** 2/25/14 12:00

| <u>Compounds</u>                 | <u>Sample Results ug/m<sup>3</sup></u> | <u>Reporting Limit ug/m<sup>3</sup></u> | <u>Flag</u> |
|----------------------------------|--|---|-------------|
| cis-1,2-Dichloroethene           | < 7.90                                 | 7.90                                    | 1           |
| Tetrachloroethene                | <b>118</b>                             | 14.0                                    | 1           |
| trans-1,2-Dichloroethene         | < 396                                  | 396                                     | 1           |
| Trichlorethene                   | < 10.7                                 | 10.7                                    | 1           |
| Vinyl Chloride                   | < 5.10                                 | 5.10                                    | 1           |
| 4-bromofluorobenzene (surrogate) | 94%                                    |   |             |
| <b>Analysis Date/Time:</b>       | 2-28-14/07:50                          |   |             |
| <b>Analyst Initials</b>          | tjg                                    |   |             |



**EnvisionAir**  
1437 Sadlier Circle West Drive  
Indianapolis, IN 46239  
Ph: 317-351-0885  
Fax: 317-351-0882  
[www.envision-air.com](http://www.envision-air.com)

**Flag Number**

1

**Comments**

Reported value is from a 10x dilution. TJG 3-6-14