

May 9, 2003

Project Reference #7115/7377

Ms. Gina Keenan
Wisconsin Department of Natural Resources
Southeast Region
Milwaukee Service Center
2300 N. Dr. ML King Drive
P.O. Box 12436
Milwaukee, WI 53212-0436

Re: **WORK PLAN ADDENDUM**

Badger Leasing Property
9601 West Greenfield Avenue
West Allis, Wisconsin
FID #241855460
BRRTS #02-41-305222/03-41-005185

LUST

Dear Ms. Keenan:

In compliance with NR 169.21 (2)(e), this letter has been prepared as an addendum to the Wisconsin Department of Natural Resources (WDNR) approved Sigma Environmental Services, Inc. (Sigma) January 2001, work plan for subsurface investigation work and January 17, 2002, addendum work plan letter for the Badger Leasing Property. As outlined in the approved work plans, Sigma has implemented and completed the installation and sampling of test soil borings and groundwater monitoring wells at the above referenced site. A summary of site data including a map of the current site layout, proposed boring locations, groundwater flow direction, groundwater quality, and tables presenting soil and groundwater quality data generated to date are presented as Attachment 1.

Based on a review of the site environmental data generated to date, Sigma recommends the following scope of work to further delineate the extent of chlorinated hydrocarbon impacts:

- o Conduct a site history evaluation (through City permits and Sanborn Map review) to determine the approximate location of historical dry cleaning equipment and activities within the site building.
- o The installation of four off-site groundwater monitoring wells to the north south and east of the site to assist in the delineation of identified petroleum and chlorinated hydrocarbon impacts in groundwater. The proposed locations are shown on the attached Figure 6.

check locations



WDNR
May 9, 2003

- o The advancement of a minimum two hand auger soil borings within the site building to further delineate the extent of chlorinated impacts to soil in potential source areas. The locations of the soil borings will be selected based on the findings of the site history evaluation.
- o The collection of two rounds of groundwater samples from the monitoring well network for laboratory analysis of EPA Method 8021 VOCs.
- o The preparation of a comprehensive site investigation report and remedial action plan, if appropriate.

The scope of work and associated costs to complete the above referenced activities and adequately delineate the extent of identified impacts are anticipated to exceed the WDNR approved scope of work and cost by more than \$3,000. Therefore, presented as an attachment to this letter for WDNR approval is a breakout of anticipated additional project costs. It is recommended due to the elevated concentration of detected compounds that the proposed activities be implemented as soon as possible.

Upon your review of the attached information should you have any questions, please contact our office at (414) 768-7144. We will initiate the supplemental site investigation activities upon your authorization.

Respectfully submitted,

SIGMA ENVIRONMENTAL SERVICES, INC.



Martin D. Nessman, P.G.
Project Hydrogeologist



Randy E. Boness, P.G.
Geosciences Group Leader

Enclosures

cc: Ms. Christine Vernon – Badger Leasing
Mr. Mark Treter – Reinhart, Boerner, Van Deuren

ATTACHMENT 1

SITE DATA

Table 1
Soil Quality Results - Detections Only
Badger Lease & Auto Sales, Inc.
9601 W. Greenfield Avenue
West Allis, WI

Boring ID		MW-4	MW-4	MW-5	MW-5	MV/-6	MW-6	NR 720	NR 746	NR 746	USEPA
Depth (feet bgs)	Units	2-4	12-14	4-6	10-12	2-4	8-10	RCL	Table 1	Table 2	Inhalation SSLs
Volatile Organic Compounds											
Benzene	µg/kg	<29	<31	129	181	<?8	<31	5.5	8,500	1,100	**
Ethylbenzene	µg/kg	<29	<31	1,150	3,610	<?8	<31	2,900	4,600	**	**
Toluene	µg/kg	<29	<31	54	650	<?8	<31	1,500	38,000	**	**
Xylenes	µg/kg	<41	<44	982	11,700	<?0	<43	4,100	42,000	**	**
n-Butylbenzene	µg/kg	<29	<31	245	<144	<?8	<31	**	**	**	**
sec-Butylbenzene	µg/kg	<29	<31	72	<144	<?8	<31	**	**	**	**
cis-1,2-Dichloroethene	µg/kg	<29	1,380	<36	1,440	<?8	4,790	**	**	**	1,300,000
trans-1,2-Dichloroethene	µg/kg	<29	36	<36	<144	<?8	<31	**	**	**	3,200,000
Isopropylbenzene	µg/kg	<29	<31	129	337	<?8	<31	**	**	**	**
Naphthalene	µg/kg	<29	<31	2,580	3,010	<?8	<31	**	2,700	**	**
n-Propylbenzene	µg/kg	<29	<31	543	1,180	<?8	<31	**	**	**	**
Tetrachloroethene	µg/kg	5,570	122,000	<36	<144	1.4	24,500	**	**	**	35,000
Trichloroethene	µg/kg	81	1,000	<36	<144	<?8	11,200	**	**	**	15,000
1,2,4-Trimethylbenzene	µg/kg	<29	65	245	7,940	<?8	<31	**	83,000	**	**
1,3,5-Trimethylbenzene	µg/kg	<29	<31	155	2,890	<?8	<31	**	11,000	**	**
Vinyl Chloride	µg/kg	<29	<31	<36	313	<?8	52	**	**	**	930

KEY: Soil Samples collected on June 13, 2002
µg/kg micrograms per kilogram
** No standard established
BOLD Analyte detected above NR 720 Residual Contaminant Levels
NR 720 RCL Chapter NR 720 Generic Residual Contaminant Limit
NR 746 Table 1 Chapter NR 746 Table 1, Indicators of Residual Petroleum Products.
NR 746 Table 2 Chapter NR 746 Table 2, Protection of Human Health from Direct Contact with Contaminated Soil.

Table 1
Soil Quality Results - Detections Only
Badger Lease & Auto Sales, Inc.
9601 W. Greenfield Avenue
West Allis, WI

Boring ID		MW-7	MW-7	MW-8	MW-8	PZ-1	PZ-1	PZ-2	NR 720	NR 746	NR 746	USEPA
Depth (feet bgs)	Units	2-4	12-14	4-6	10-12	2-4	13-20	16-18	RCL	Table 1	Table 2	Inhalation SSLs
Volatile Organic Compounds												
Benzene	µg/kg	<28	<30	<32	<31	<29	<28	<29	5.5	8,500	1,100	**
Ethylbenzene	µg/kg	<28	<30	<32	<31	<29	<28	<29	2,900	4,600	**	**
Toluene	µg/kg	<28	<30	<32	<31	<29	<28	<29	1,500	38,000	**	**
Xylenes	µg/kg	<39	<42	<45	<44	<40	<40	<41	4,100	42,000	**	**
n-Butylbenzene	µg/kg	<28	<30	<32	<31	<29	<28	<29	**	**	**	**
sec-Butylbenzene	µg/kg	<28	<30	<32	<31	<29	<28	<29	**	**	**	**
cis-1,2-Dichloroethene	µg/kg	<28	214	<32	452	<29	<28	<29	**	**	**	1,300,000
trans-1,2-Dichloroethene	µg/kg	<28	<30	<32	<31	<29	<28	<29	**	**	**	3,200,000
Isopropylbenzene	µg/kg	<28	<30	<32	<31	<29	<28	<29	**	**	**	**
Naphthalene	µg/kg	<28	<30	<32	<31	<29	<28	<29	**	2,700	**	**
n-Propylbenzene	µg/kg	<28	<30	<32	<31	<29	<28	<29	**	**	**	**
Tetrachloroethene	µg/kg	<28	14,200	421	28,900	<29	262	<29	**	**	**	35,000
Trichloroethene	µg/kg	<28	1,010	<32	5,140	<29	<28	<29	**	**	**	15,000
1,2,4-Trimethylbenzene	µg/kg	<28	<30	<32	<31	<29	<28	<29	**	83,000	**	**
1,3,5-Trimethylbenzene	µg/kg	<28	<30	<32	<31	<29	<28	<29	**	11,000	**	**
Vinyl Chloride	µg/kg	<28	<30	<32	<31	<29	<28	<29	**	**	**	930

KEY: Soil Samples collected on June 13, 2002
µg/kg micrograms per kilogram
** No standard established
BOLD Analyte detected above NR 720 Residual Contaminant Levels
NR 720 RCL Chapter NR 720 Generic Residual Contaminant Limit
NR 746 Table 1 Chapter NR 746 Table 1, Indicators of Residual Petroleum Products.
NR 746 Table 2 Chapter NR 746 Table 2, Protection of Human Health from Direct Contact with Contaminated Soil.

Table 1
Soil Quality Results - Detections Only
Badger Lease & Auto Sales, Inc.
9601 W. Greenfield Avenue
West Allis, WI

Boring ID		MW-1		MW-2	MW-3		B-3		NR 720 RCL	NR 746 Table 1	NR 746 Table 2	USEPA SSL For Inhalation*
Depth (feet bgs)		9 - 11	19 - 21	11 - 13	3 - 5	7 - 9	9 - 11	13-15				
Date	Units	02/15/1996	02/15/1996	02/15/1996	02/16/1996	02/16/1996	02/15/1996	02/15/1996				
Analyte												
GRO	mg/kg	238	<6.3	450	<6.3	<6.3	803	29.8	100	**	**	**
Lead	mg/kg	<4.7	<4.7	<4.7	18.8	<4.7	<4.7	<4.9	50	**	**	**
Volatile Organic Compounds												
Benzene	µg/kg	591	7.8	1250	<26	1.1	197	52.7	5.5	8500	1100	**
Ethylbenzene	µg/kg	4540	<3.7	12,000	<26	<5.5	1320	28.1	2900	4600	**	**
Toluene	µg/kg	552	<7.3	2250	<26	<11	1040	135	1500	38000	**	**
Xylenes	µg/kg	19800	<3.7	43840	30	6.45	1378	158.1	4100	42000	**	**
n-Butylbenzene	µg/kg	3750	<3.7	9340	<26	<5.5	10200	451	**	**	**	**
sec-Butylbenzene	µg/kg	<470	<3.7	<1200	<26	<5.5	1580	62	**	**	**	**
tert-Butylbenzene	µg/kg	<470	<3.7	<1200	<26	<5.5	731	<24	**	**	**	**
1,2-Dichloroethane	µg/kg	<470	2.95	<1200	<26	<2.3	<47	<24	4.9	600	540	**
1,1-Dichloroethylene	µg/kg	<470	8.98	<1200	<26	<2.3	<47	<24	**	**	**	**
cis-1,2-Dichloroethylene & 2,2-Dichloropropane	µg/kg	<470	3.9	<1200	<26	<2.3	<47	<24	**	**	**	1,300,000
1,3-Dichloropropane	µg/kg	<470	<1.9	<1200	<26	107	<47	<24	**	**	**	**
Isopropylbenzene	µg/kg	<470	<3.7	<1200	<26	<5.5	1000	68.2	**	**	**	**
Isopropyl Ether	µg/kg	1290	<3.7	3750	<26	<5.5	370	79.3	**	**	**	**
p-Isopropyltoluene	µg/kg	<470	<3.7	<1200	<26	<5.5	823	29.3	**	**	**	**
Naphthalene	µg/kg	2650	<3.7	6770	<26	<5.5	837	70.1	**	2700	**	**
n-Propylbenzene	µg/kg	1940	<3.7	5220	<26	<5.5	3090	366	**	**	**	**
Tetrachloroethylene	µg/kg	<470	4.13	<1200	<26	80.9	<47	33.5	**	**	**	35,000
Trichloroethylene	µg/kg	<470	7.32	<1200	<26	3.89	<47	<24	**	**	**	15,000
1,2,4-Trimethylbenzene	µg/kg	11400	<3.7	26300	<26	<5.5	2140	390	**	83000	**	**
1,3,5-Trimethylbenzene	µg/kg	3310	<3.7	7580	<26	<5.5	3990	149	**	11000	**	**

KEY:

mg/kg milligrams per kilogram
 ** No standard established
Bold Analyte detected above NR 720 Residual Contaminant Level;
Bold Analyte detected above NR 746 Table 1 and 2 values
 NR 720 RCL Chapter NR 720 Generic Residual Contaminant Limit
 NR 746 Table 1 Chapter NR 746 Table 1, Indicators of Residual Petroleum Products.
 NR 746 Table 2 Chapter NR 746 Table 2, Protection of Human Health from Direct Contact with Contaminated Soil.

Table 1
Soil Quality Results - Detections: Only
Badger Lease & Auto Sales, Inc.
9601 W. Greenfield Avenue
West Allis, WI

Boring ID		B-4		B-5		B-6		NR 720 RCL	NR 746 Table 1	NR 746 Table 2	USEPA SSL For Inhalation*
Depth (feet bgs)	Units	5-7	17-19	3-5	13-15	3-5	17-19				
Date		02/15/1996	02/15/1996	02/16/1996	02/16/1996	02/16/1996	02/16/1996				
Analyte											
GRO	mg/kg	752	9	40.4	<6.3	<6.3	<6.3	100	**	**	**
Lead	mg/kg	12.3	<5.0	8.42	<4.7	12.7	<5.1	50	**	**	**
Volatile Organic Compounds											
Benzene	µg/kg	<101,000	<1	<2.4	<0.80	<1.2	<0.9	5.5	8500	1100	**
Ethylbenzene	µg/kg	<101,000	<4.9	27.3	<4.2	<6.3	<4.3	2900	4600	**	**
Toluene	µg/kg	<101,000	<4.9	168	<8.4	<12	<8.6	1500	38000	**	**
Xylenes	µg/kg	<101,000	8.9	145.3	<4.2	<6.3	<4.3	4100	42000	**	**
n-Butylbenzene	µg/kg	<101,000	<4.9	<24	<4.2	<6.3	<4.3	**	**	**	**
sec-Butylbenzene	µg/kg	<101,000	<4.9	<24	<4.2	<6.3	<4.3	**	**	**	**
tert-Butylbenzene	µg/kg	<101,000	<4.9	<24	<4.2	<6.3	<4.3	**	**	**	**
1,2-Dichloroethane	µg/kg	<101,000	7.74	<24	<2.1	<3.1	<2.2	4.9	600	540	**
1,1-Dichloroethylene	µg/kg	<101,000	15.6	<24	<1.6	<2.5	<1.8	**	**	**	**
cis-1,2-Dichloroethylene & 2,2-Dichloropropane	µg/kg	<101,000	130	<24	<2.1	<3.1	<2.2	**	**	**	1,300,000
1,3-Dichloropropane	µg/kg	<101,000	<2.4	<24	<2.1	<3.1	<2.2	**	**	**	**
Isopropylbenzene	µg/kg	<101,000	<4.9	<24	<4.2	<6.3	<4.3	**	**	**	**
Isopropyl Ether	µg/kg	<101,000	<4.9	<24	<4.2	<6.3	<4.3	**	**	**	**
p-Isopropyltoluene	µg/kg	<101,000	<4.9	<24	<4.2	<6.3	<4.3	**	**	**	**
Naphthalene	µg/kg	<101,000	<4.9	<24	<4.2	<6.3	<4.3	**	2700	**	**
n-Propylbenzene	µg/kg	<101,000	<4.9	<24	<4.2	<6.3	<4.3	**	**	**	**
Tetrachloroethylene	µg/kg	2,650,000	19.7	<24	5.01	8.1	<2.2	**	**	**	35,000
Trichloroethylene	µg/kg	<101,000	30	<24	<0.80	<1.2	<0.9	**	**	**	15,000
1,2,4-Trimethylbenzene	µg/kg	<101,000	<4.9	<24	<4.2	<6.3	<4.3	**	83000	**	**
1,3,5-Trimethylbenzene	µg/kg	<101,000	<4.9	<24	<4.2	<6.3	<4.3	**	11000	**	**

KEY:

- mg/kg milligrams per kilogram
- ** No standard established
- BOLD** Analyte detected above NR 720 Residual Contaminant Levels
- Bold** Analyte detected above NR 746 Table 1 and 2 values
- NR 720 RCL Chapter NR 720 Generic Residual Contaminant Limit
- NR 746 Table 1 Chapter NR 746 Table 1, Indicators of Residual Petroleum Products.
- NR 746 Table 2 Chapter NR 746 Table 2, Protection of Human Health from Direct Contact with Contaminated Soil.

Table
Drum Composite Soil Samples - Protocol B Results
Badger Lease & Auto Sales, Inc.
9601 W. Greenfield Avenue
West Allis, WI

Sample ID	Units	DC-1	DC-2	Acceptance Limits
Miscellaneous Analysis				
pH		8.0	7.9	2.0 ≤ pH ≤ 12.5
Specific Gravity	g/ml	2.31	2.36	no limit
Total Solids	%	84.7	83.0	no limit
Free Liquids	%	0	0	0%
Flash Point	° F	>200	>200	≥ 140° F
Chlorine (Total Halogens)	%	<0.01	<0.01	<1.0
Reactive Sulfide	mg/kg	<49.5	<47.2	<200
Phenol	mg/l	<100	<0.100	<2000
Reactive Cyanide	mg/kg	<0.495	<0.472	200
TOC	mg/kg	80000	72000	no limit
Metals TCLP Extraction				
Arsenic	mg/l	0.874	<0.050	<5.0
Barium	mg/l	0.523	0.41	<100.0
Cadmium	mg/l	<0.00500	<0.00500	<1.0
Chromium	mg/l	<0.0500	<0.0500	<5.0
Copper	mg/l	<0.0500	<0.0500	<100.0
Lead	mg/l	<0.0150	<0.0150	<5.0
Mercury	mg/l	<0.00100	<0.00100	<0.2
Nickel	mg/l	<0.100	<0.100	<35.0
Selenium	mg/l	<0.0750	<0.0750	<1.0
Silver	mg/l	<0.050	<0.050	<5.0
Zinc	mg/l	<0.100	<0.100	<200.0
PCB's				<50 mg/kg (Total)
Aroclor 1016	mg/kg	<0.039	<0.040	"
Aroclor 1221	mg/kg	<0.039	<0.040	"
Aroclor 1232	mg/kg	<0.039	<0.040	"
Aroclor 1242	mg/kg	<0.039	<0.040	"
Aroclor 1248	mg/kg	<0.039	<0.040	"
Aroclor 1254	mg/kg	<0.039	<0.040	"
Aroclor 1260	mg/kg	<0.039	<0.040	"
Aroclor 1268	mg/kg	<0.039	<0.040	"
Volatile Organic Compounds - TCLP Extraction				
Benzene	mg/l	<0.050	<0.050	<0.5
Carbon Tetrachloride	mg/l	<0.050	<0.050	<0.5
Chlorobenzene	mg/l	<0.050	<0.050	<100.0
Chloroform	mg/l	<0.050	<0.050	<6.0
o-Cresol	mg/l	<0.100	<0.100	<200.0
m-Cresol	mg/l	<0.100	<0.100	<200.0
p-Cresol	mg/l	<0.100	<0.100	<200.0
1,4-Dichlorobenzene	mg/l	<0.100	<0.100	<7.5
1,2-Dichloroethane	mg/l	<0.050	<0.050	<0.5
1,1-Dichloroethylene	mg/l	<0.050	<0.050	<0.7
2,4-Dinitrotoluene	mg/l	<0.100	<0.100	<0.13
Hexachlorobenzene	mg/l	<0.100	<0.100	<0.13
Hexachloro-1,3-butadiene	mg/l	<0.100	<0.100	<0.5
Hexachloroethane	mg/l	<0.100	<0.100	<3.0
Methyl Ethyl Ketone	mg/l	<0.250	<0.250	<200.0
Nitrobenzene	mg/l	<0.100	<0.100	<2.0
Pentachlorophenol	mg/l	<0.350	<0.350	<100.0
Pyridine	mg/l	<0.100	<0.100	<5.0
Tetrachloroethylene	mg/l	0.28	0.3	<0.7
Trichloroethylene	mg/l	<0.050	<0.050	<0.5
2,4,5-Trichlorophenol	mg/l	<0.500	<0.500	<400.0
2,4,6-Trichlorophenol	mg/l	<0.100	<0.100	<2.0
Vinyl Chloride	mg/l	<0.050	<0.050	<0.2
KEY:				
	mg/l	milligrams per liter		
	**	No standard established		
	DC-1	Composite soil sample of auger spoils from borings: MW-1, MW-2, MW-5, B-6 and PZ-1.		
	DC-2	Composite soil sample of auger spoils from borings: MW-6, MW-7, MW-8, and PZ-2.		

Table 1
Groundwater Quality Results - Detections Only
Badger Lease & Auto Sales, Inc.
9601 W. Greefield Avenue
West Allis, WI

Sample Location		MW-4		MW-5		MW-6		MW-7		MW-8		PZ-1	PZ-2	NR 140	NR 140
Date	Units	07/24/2002	10/11/2002	07/24/2002	10/11/2002	07/24/2002	10/11/2002	07/24/2002	10/11/2002	07/24/2002	10/11/2002	10/11/2002	10/11/2002	ES	PAL
Volatile Organic Compounds															
Benzene	µg/l	<10	<1.6	590	490	<40	<25	<4.0	<2.5	<5.0	<5.0	<0.10	<0.10	5	0.5
Chloromethane	µg/l	<25 B	<4.0	45 B	<25	<100	<62	15 B	<6.2	21 B	<12	<0.25	<0.25	3	0.3
cis-1,2-Dichloroethylene	µg/l	290	84	6,100	3,400	10,000	7,500	260	310	580	700	<0.25	<0.25	70	7
trans-1,2-Dichloroethylene	µg/l	<25	<4.0	45	<25	<100	<62	12	18	34	30	<0.25	<0.25	100	20
Ethylbenzene	µg/l	<25	<4.0	1,600	1,600	<100	<62	<10	<6.2	<12	<12	<0.25	<0.25	700	140
Isopropylbenzene	µg/l	<25	<4.0	45	50	<100	<62	<10	<6.2	<12	<12	<0.25	<0.25	**	**
Methylene Chloride	µg/l	140 L	5.9L	190 L	77L	580 L	110L	53 L	10L	69 L	22L	<0.25	<0.25	5	0.5
Naphthalene	µg/l	45	<4.0	270	360	<100	<62	<10	<6.2	<12	<12	<0.25	<0.25	40	8
n-Propylbenzene	µg/l	<25	<4.0	120	120	<100	<62	<10	<6.2	<12	<12	<0.25	<0.25	**	**
Tetrachloroethene	µg/l	4,100	740	<25	<25	14,000	12,000	1,200	1,400	2,700	2,100	4.5	<0.25	5	0.5
Toluene	µg/l	<10	<1.6	850	710	<40	<25	<4.0	<2.5	<5.0	<5.0	<0.10	<0.10	1000	200
Trichloroethene	µg/l	170	52	<25	<25	9,800	7,700	330	370	1,600	1,300	<0.25	<0.25	5	0.5
1,2,4-Trimethylbenzene	µg/l	22	<1.6	1,000	1,000	<40	<25	<4.0	<2.5	<5.0	<5.0	<0.10	<0.10	480	96
1,3,5-Trimethylbenzene	µg/l	<10	<1.6	240	290	<40	<25	<4.0	<2.5	<5.0	<5.0	<0.10	<0.10	480	96
Vinyl Chloride	µg/l	<25	9.8	2,200	1,700	<100	190	<10.0	20	<12	20	<0.25	<0.25	0.2	0.02
Xylene (total)	µg/l	<25	<4.0	4,500	3,800	<100	<62	<10.0	<6.2	<12	<12	<0.25	<0.25	10,000	1,000

Key:

- ** = No Standard Established
- B = Blank is contaminated
- C = Standard outside of control limits
- L = Common lab solvent and contaminant
- = concentration exceeds Chapter NR 140 ES
- = concentration exceeds Chapter NR 140 PAL

Table 1
Groundwater Quality Results - Detections Only
Badger Lease & Auto Sales, Inc.
9601 W. Greenfield Avenue
West Allis, WI

Sample Location	Units	MW-1				MW-2				MW-3				NR 140	NR 140
		03/01/1996	07/03/1997	07/24/2002	10/11/2002	03/01/1996	07/03/1997	07/24/2002	10/11/2002	03/01/1996	07/03/1997	07/24/2002	10/11/2002	ES	PAL
Volatile Organic Compounds															
Benzene	µg/l	635	890	440	430	<4000	660	380	310	<0.2	<0.21	<0.10	<0.10	5	0.5
Chloromethane	µg/l	ND	ND	31 B	<12	ND	ND	<500 B	<20	ND	ND	0.78 C	<0.25	3	0.3
cis-1,2-Dichloroethylene	µg/l	2,440	8,800	2,400	2,300	<10,000	6700	1,300	1,800	<0.5	0.78	<0.25	<0.25	70	7
trans-1,2-Dichloroethylene	µg/l	79.9	200	340	290	<10,000	37	<500	<20	<0.5	0.78	<0.25	<0.25	100	20
Ethylbenzene	µg/l	<100	290	430	590	<20000	680	1,500	1,300	<1.0	<0.68	<0.25	<0.25	700	140
Isopropylbenzene	µg/l	<100	<38	14	16	<20000	22	<500	41	<1.0	<0.38	<0.25	<0.25	**	**
Methylene Chloride	µg/l	ND	ND	78 L	30L	ND	ND	2,700 L	43L	ND	ND	0.37 L	<0.25	5	0.5
Naphthalene	µg/l	<100	<100	20	64	<20000	180	<500	290	<1.0	<1	<0.25	<0.25	40	8
n-Propylbenzene	µg/l	<100	>40	26	27	<20000	49	<500	110	<1.0	<0.4	<0.25	<0.25	**	**
Tetrachloroethene	µg/l	2,750	600	290	65	222,000	1,900	94,000	3,600	<0.5	1.1	<0.25	<0.25	5	0.5
Toluene	µg/l	<200	176	100	120	<40000	160	<200	200	<2.0	<1.5	<0.10	<0.10	1000	200
Trichloroethene	µg/l	70.2	440	330	180	<4,000	240	<500	37	<0.2	<0.13	<0.25	<0.25	5	0.5
1,2,4-Trimethylbenzene	µg/l	<100	<100	110	120	<20000	170	1,100	860	<1.0	<1	<0.10	<0.10	480	96
1,3,5-Trimethylbenzene	µg/l	<100	<86	<5.0	<5.0	<20000	19	<200	130	<1.0	<0.86	<0.10	<0.10	480	96
Vinyl Chloride	µg/l	500	760	1,200	1,200	<4,000	<0.45	660	440	<0.2	<0.045	<0.25	<0.25	0.2	0.02
Xylene (total)	µg/l	<100	228	190	260	<20000	507	1,800	1,500	<1.0	<1.2	<0.25	<0.25	10,000	1,000

Key:

- ** = No Standard Established
- B = Blank is contaminated
- C = Standard outside of control limits
- L = Common lab solvent and contaminant
- Boxed** = concentration exceeds Chapter NR 140 ES
- Bold** = concentration exceeds Chapter NR 140 PAL

W. GREENFIELD AVE.

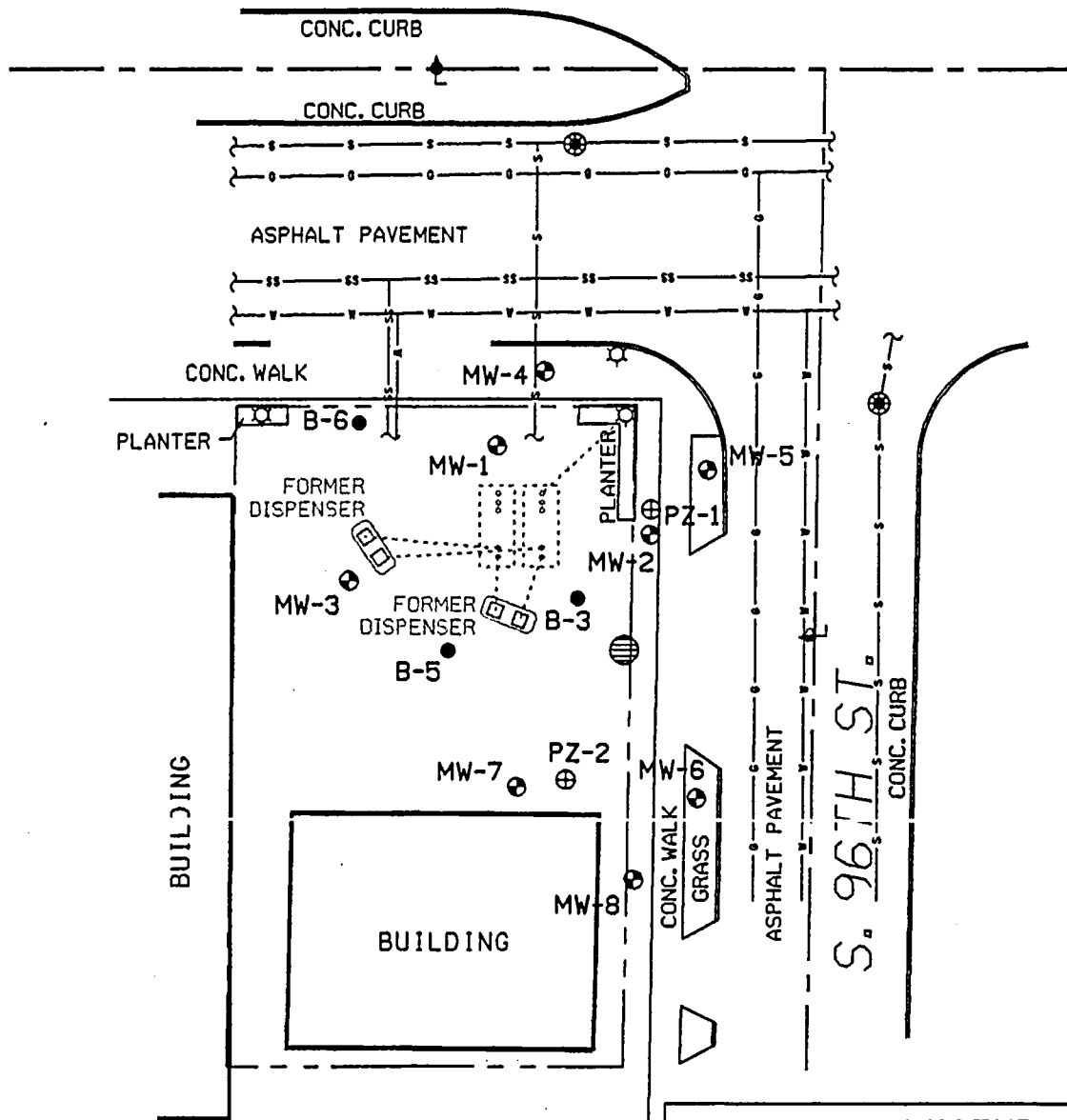

GRAPHIC SCALE



NOTES:

1. MAP BASED ON A SURVEY PERFORMED BY NORTH SHORE ENGINEERING ON (JULY 29, 2002).
2. UTILITIES AND SOIL BORING LOCATIONS WERE NOT INCLUDED IN SURVEY AND ARE APPROXIMATE.

LEGEND

- ⊕ = PIEZOMETER LOCATION
- ⊙ = MONITORING WELL LOCATION
- = SOIL BORING LOCATION
- = OVERHEAD ELECTRIC LINE
- = UNDERGROUND GAS LINE
- v— = UNDERGROUND WATER LINE
- ss— = UNDERGROUND SANITARY SEWER LINE
- s— = UNDERGROUND STORM SEWER LINE
- = UST AND PIPING LOCATION

<p>BADGER LEASING 9601 W. GREENFIELD AVE., WEST ALLIS, WI</p>			
DATE: 8-1-02	DR. BY: TMM	DR.# 7115-005	
<p>SITE PLAN MAP</p>			<p>FIGURE 3</p>

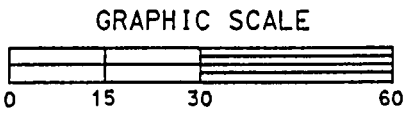
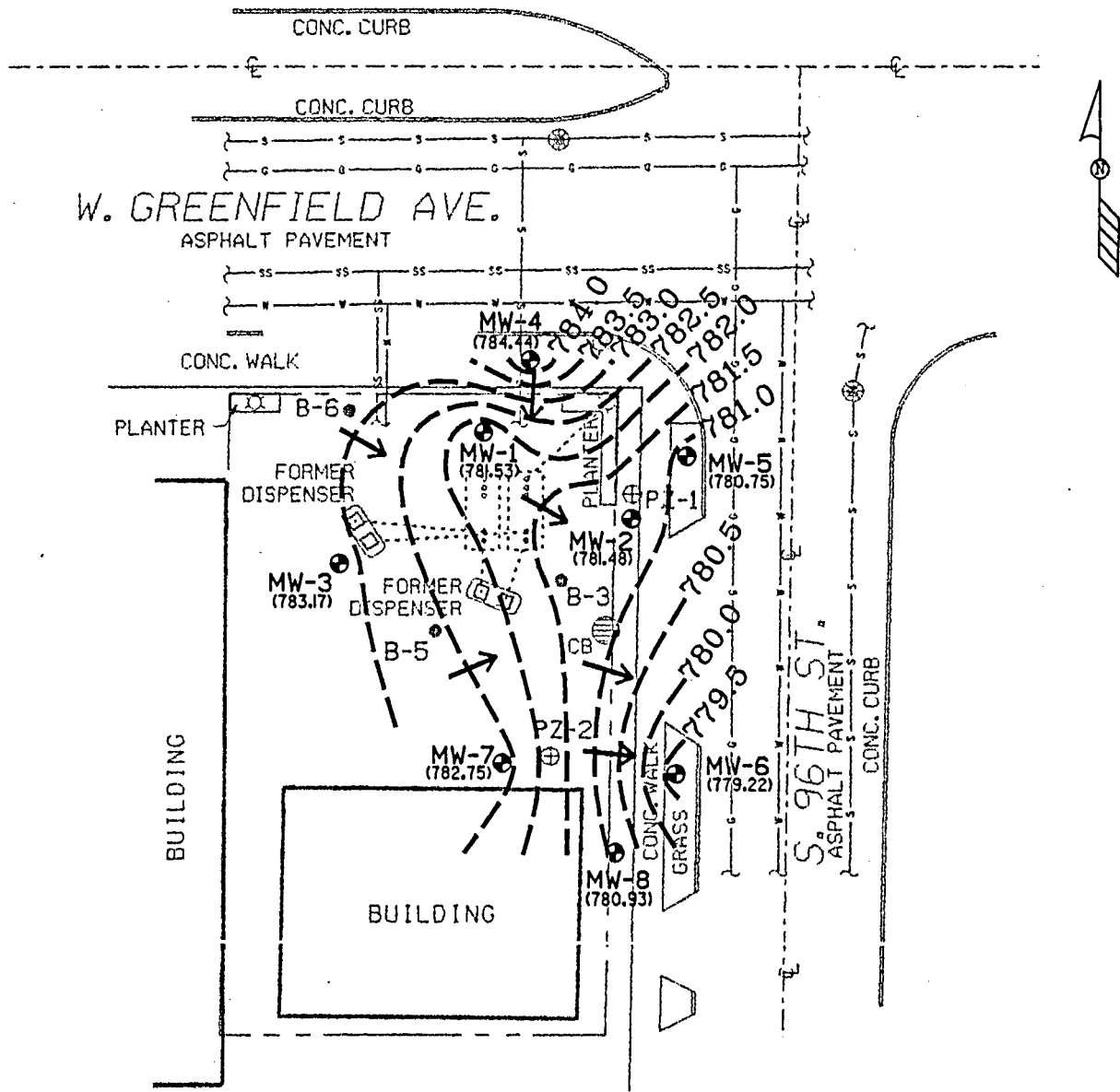

- NOTES:**
1. MAP BASED ON A SURVEY PERFORMED BY NORTH SHORE ENGINEERING ON (JULY 29, 2002).
 2. UTILITIES AND SOIL BORING LOCATIONS WERE NOT INCLUDED IN SURVEY AND ARE APPROXIMATE.

LEGEND	
\oplus	PIEZOMETER LOCATION
\odot	MONITORING WELL LOCATION
\bullet	SOIL BORING LOCATION
α	OVERHEAD ELECTRIC LINE
\circ	UNDERGROUND GAS LINE
∇	UNDERGROUND WATER LINE
--ss--	UNDERGROUND SANITARY SEWER LINE
--s--	UNDERGROUND STORM SEWER LINE
\cdots	UST AND PIPING LOCATION
---	GROUNDWATER CONTOUR LINE, CONTOUR INTERVAL = 0.5'
()	STATIC GROUNDWATER LEVEL (7-24-02)
\rightarrow	GROUNDWATER FLOW DIRECTION

BADGER LEASING			 SIGMA ENVIRONMENTAL SERVICES INC.
9601 W. GREENFIELD AVE., WEST ALLIS, WI			
DATE: 8-8-02	DR. BY: BEB	DR.# 7115-006	SCALE: 1" = 30'
GROUNDWATER CONTOUR MAP (7-24-02)			FIGURE 4

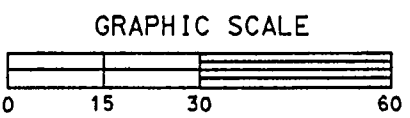
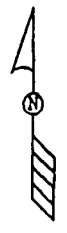
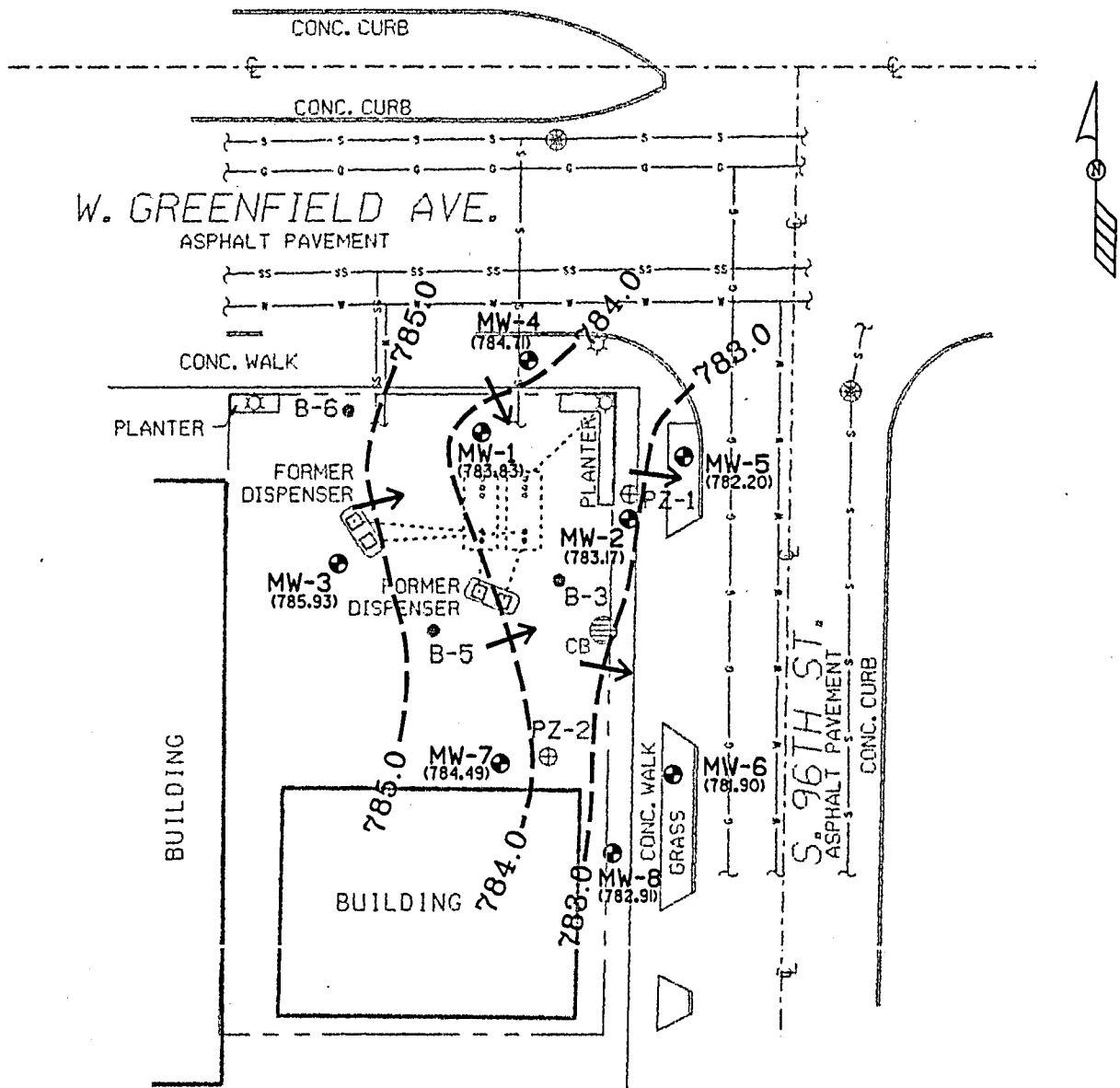

- NOTES:**
1. MAP BASED ON A SURVEY PERFORMED BY NORTH SHORE ENGINEERING ON (JULY 29, 2002).
 2. UTILITIES AND SOIL BORING LOCATIONS WERE NOT INCLUDED IN SURVEY AND ARE APPROXIMATE.

LEGEND

- ⊕ = PIEZOMETER LOCATION
- ⊙ = MONITORING WELL LOCATION
- = SOIL BORING LOCATION
- α— = OVERHEAD ELECTRIC LINE
- o— = UNDERGROUND GAS LINE
- v— = UNDERGROUND WATER LINE
- ss— = UNDERGROUND SANITARY SEWER LINE
- s— = UNDERGROUND STORM SEWER LINE
- = UST AND PIPING LOCATION
- - - - = GROUNDWATER CONTOUR LINE, CONTOUR INTERVAL = 1.0'
- () = STATIC GROUNDWATER LEVEL (10-11-02)
- = GROUNDWATER FLOW DIRECTION

BADGER LEASING			 SIGMA ENVIRONMENTAL SERVICES INC.
9601 W. GREENFIELD AVE., WEST ALLIS, WI			
DATE: 3-18-03	DR. BY: BEB	DR.# 7115-008	SCALE: 1" = 30'
GROUNDWATER CONTOUR MAP (10-11-02)			FIGURE 5



MW-4		
DATE	7-24-02	10-11-02
B	<10	<1.6
T	<10	<1.6
E	<25	<4.0
X	<25	<4.0
PCE	[4,100]	[740]
TCE	[170]	[52]
cis-1,2-DCE	[290]	84
trans-1,2-DCE	<25	<4.0
VC	<25	[9.8]

MW-5		
DATE	7-24-02	10-11-02
B	[590]	[490]
T	850	710
E	[1,600]	[1,600]
X	4,500	3,800
PCE	<25	<25
TCE	<25	<25
cis-1,2-DCE	[6,100]	[3,400]
trans-1,2-DCE	45	<25
VC	[2,200]	[1,700]

MW-1		
DATE	7-24-02	10-11-02
B	[440]	[430]
T	100	120
E	430	590
X	190	260
PCE	[290]	[65]
TCE	[330]	[180]
cis-1,2-DCE	[2,400]	[2,300]
trans-1,2-DCE	[340]	[290]
VC	[1,200]	[1,200]

PZ-1		
DATE	10-11-02	
B	<0.10	
T	<0.10	
E	<0.25	
X	<0.25	
PCE	4.5	
TCE	<0.25	
cis-1,2-DCE	<0.25	
trans-1,2-DCE	<0.25	
VC	<0.25	

MW-3		
DATE	7-24-02	10-11-02
B	<0.10	<0.10
T	<0.10	<0.10
E	<0.25	<0.25
X	<0.25	<0.25
PCE	<0.25	<0.25
TCE	<0.25	<0.25
cis-1,2-DCE	<0.25	<0.25
trans-1,2-DCE	<0.25	<0.25
VC	<0.25	<0.25

MW-2		
DATE	7-24-02	10-11-02
B	[380]	310
T	<200	200
E	1,500	1,300
X	1,800	1,500
PCE	[94,000]	[3,600]
TCE	<500	[37]
cis-1,2-DCE	[1,300]	[1,800]
trans-1,2-DCE	<500	<20
VC	[660]	[440]

PZ-2		
DATE	10-11-02	
B	<0.10	
T	<0.10	
E	<0.25	
X	<0.25	
PCE	<0.25	
TCE	<0.25	
cis-1,2-DCE	<0.25	
trans-1,2-DCE	<0.25	
VC	<0.25	

MW-6		
DATE	7-24-02	10-11-02
B	<40	[490]
T	<40	710
E	<100	1,600
X	<100	3,800
PCE	[14,000]	<25
TCE	[9,800]	<25
cis-1,2-DCE	[10,000]	[3,400]
trans-1,2-DCE	<100	<25
VC	<100	[1,700]

MW-7		
DATE	7-24-02	10-11-02
B	<4.0	<2.5
T	<4.0	<2.5
E	<10.0	<6.2
X	<10.0	<6.2
PCE	[1,200]	[1,400]
TCE	[330]	[370]
cis-1,2-DCE	[260]	[310]
trans-1,2-DCE	12	18
VC	<10.0	<6.2

MW-8		
DATE	7-24-02	10-11-02
B	<5.0	<5.0
T	<5.0	<5.0
E	<12	<12
X	<12	<12
PCE	[2,700]	[2,100]
TCE	[1,600]	[1,300]
cis-1,2-DCE	[580]	[700]
trans-1,2-DCE	34	30
VC	<12	[20]

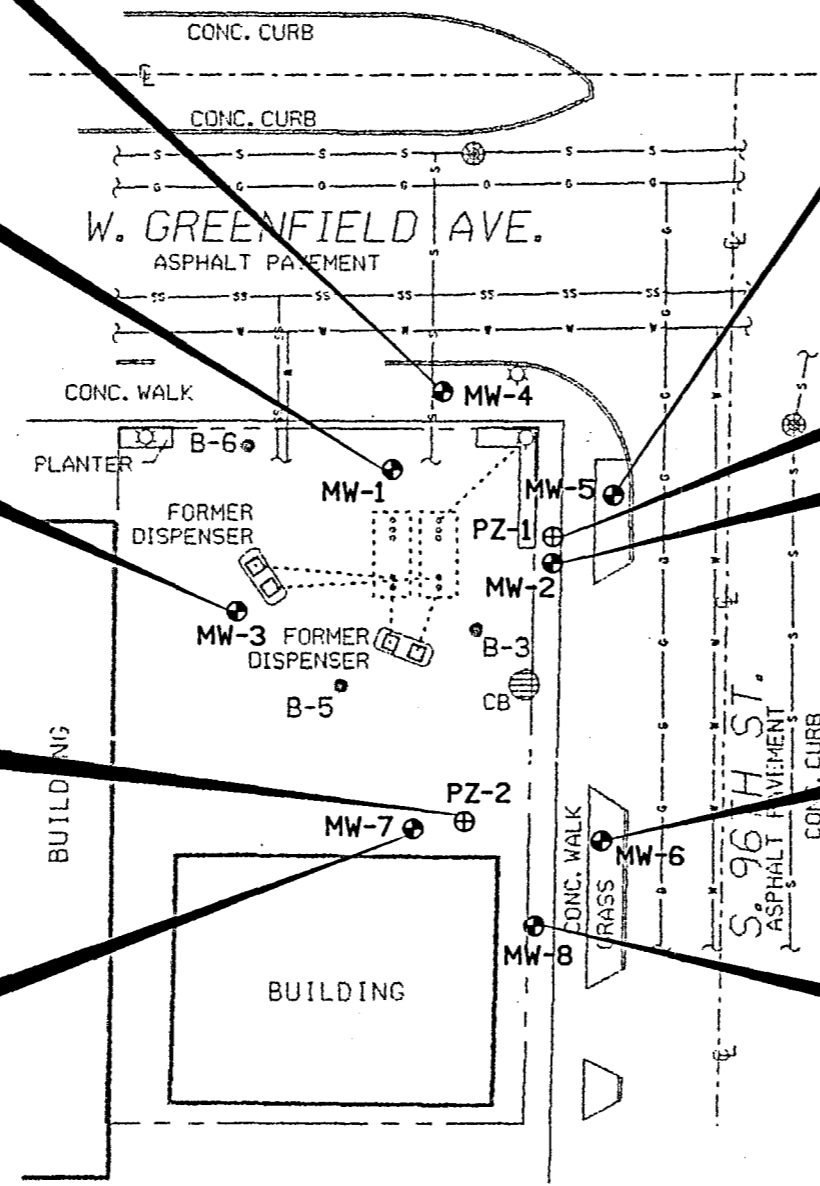

ANALYTICAL KEY	
B	= BENZENE
T	= TOLUENE
E	= ETHYLBENZENE
X	= TOTAL XYLENES
PCE	= TETRACHLOROETHYLENE
TCE	= TRICHLOROETHYLENE
cis-1,2-DCE	= cis-1,2-DICHLOROETHYLENE
trans-1,2-DCE	= trans-1,2-DICHLOROETHYLENE
VC	= VINYL CHLORIDE
[]	= EXCEEDS NR 140 ES
ALL CONCENTRATIONS EXPRESSED IN MICROGRAMS PER LITER (ug/l)	

LEGEND	
⊕	= PIEZOMETER LOCATION
⊙	= MONITORING WELL LOCATION
●	= SOIL BORING LOCATION
—o—	= OVERHEAD ELECTRIC LINE
—o—	= UNDERGROUND GAS LINE
—w—	= UNDERGROUND WATER LINE
—ss—	= UNDERGROUND SANITARY SEWER LINE
—s—	= UNDERGROUND STORM SEWER LINE
.....	= UST AND PIPING LOCATION

- NOTES:
1. MAP BASED ON A SURVEY PERFORMED BY NORTH SHORE ENGINEERING ON (JULY 29, 2002).
 2. UTILITIES AND SOIL BORING LOCATIONS WERE NOT INCLUDED IN SURVEY AND ARE APPROXIMATE.

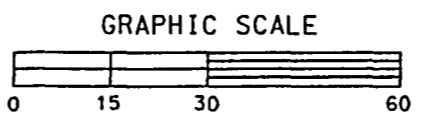

BADGER LEASING			
9601 W. GREENFIELD AVE., WEST ALLIS, WI			
DATE: 10-31-02	DR. BY: BEB	DR. # 7115-007	SCALE: 1" = 30'
GROUNDWATER QUALITY MAP			FIGURE 6

SIGMA ENVIRONMENTAL SERVICES, INC.

REQUEST FOR COST ESTIMATE ANALYTICAL SERVICES

Sigma Project # 7115/7377 Cost Estimate Required By 03/21/03

Project Manager Merry Nessman Date Samples Expected 04/15/03

Phone No. (414)768-7144 Fax No. (414)768-7158

NOTE: THE BELOW UNIT COSTS WILL BE HONORED FOR ONE (1) CALENDAR YEAR STARTING ON THE DATE THE FIRST SAMPLE IS SUBM ALL BIDS WILL FOLLOW FAX REQUESTS/RESPONSE WITH A SIGNED HARD COPY TO BE CONSIDERED.

Analytical Parameters Requested	Soil			Water					Analytical Method	Detr U
	Number of Samples	Unit Cost	Total Cost	Number of Samples per Sampling Round	Number of Sampling Rounds	Total Number of Samples	Unit Cost	Total Cost		
VOC	2	\$50.00	\$100.00	14	2	28	\$50.00	\$1400.00	EPA 8021	
VOC				Trip Blank	2	2	—	—	EPA 8021	
VOC				Equip. Blank	2	2	—	—	EPA 8021	
	Me OH Blank			Duplicate	2	2	\$50.00	\$100.00	EPA 8021	

Turnaround Time (Working Days) 3
 Cost for Sample Bottles _____
 Cost for Shipping _____
 Cost for Chromatograms _____
 Courier Service Provided YES
 Courier Service Provider GLA
 (Attach Sheet with Procedures/Directions)
 Cost for Courier Service _____
 Cost for Soil/Water Disposal _____

1. (Laboratory) warrants and represents that all times while providing services under this Agreement, it shall maintain in place errors and omissions (professional liability) insurance coverage of no less than \$1,000,000 per claim; \$1,000,000 annual aggregate and a deductible no more than \$100,000 per claim. The insurance coverage shall be provided by a firm that has an A.M. Best rating of at least "A-".

2. Laboratory shall notify (Consultant) immediately if the insurance coverage required in paragraph 1 above is interrupted, suspended, lap or terminated for any reason.

3. Laboratory shall indemnify Consultant or (Owner) for all laboratory costs determined to be ineligible for PECFA reimbursement by the PE staff due to Laboratory's failure to maintain the insurance coverage required in paragraph 1 above.

Douk
 Signature

SUBTOTAL SOIL ANALYSIS	<u>\$ 100.00</u>	QUOTE # <u>PK 30320 E</u>
SUBTOTAL WATER ANALYSIS	<u>\$ 1500.00</u>	
SUBTOTAL - OTHER (BOTTLES, ETC.)	<u>—</u>	
SHIPPING CHARGES	<u>\$ 0</u>	
TOTAL PROJECT BID	<u>\$ 1,600.00</u>	

Douk Account Mgr. Great Lakes Analytical 3/20/03
 Signature Title Company Date

ATTACHMENT 2
COST ESTIMATE
AND
COMMODITY SERVICES BIDS

ATTACHMENT 2

**COST ESTIMATE
AND
COMMODITY SERVICES BIDS**

Budgetary Cost Estimate

Badger Leasing, 9601 W. Greenfield Ave. West Allis, WI Summary of work: Task 1: Site History Documentation Task 2: Off-site Monitoring Well Installation and Task 3: Hand Auger Advancement Task 4: Two Rounds of Groundwater Sampling Task 5: Project Coordination, Data Analysis and Report Preparation		TASK 1 Site History Documentation		TASK 2 Off-site Monitoring Well Installation and Development		TASK 3 Hand Auger Advancement		TASK 4 Two Rounds of Groundwater Sampling		TASK 5 Project Coordination, Data Analysis and Report Preparation		PROJECT TOTALS	
LABOR	RATE	Hrs	Amount	Hrs	Amount	Hrs	Amount	Hrs	Amount	Hrs	Amount	Hrs	Amount
Senior Project Manager	\$105.00	2	\$210.00	2	\$210.00	2	\$210.00	4	\$420.00	8	\$840.00	18	\$1,890.00
Project Hydrogeologist	\$85.00	8	\$680.00	8	\$680.00	6	\$510.00	8	\$680.00	24	\$2,040.00	54	\$4,590.00
Engineer/Scientist	\$65.00	16	\$1,040.00	20	\$1,300.00	20	\$1,300.00	0	\$0.00	60	\$3,900.00	116	\$7,540.00
Field Tech	\$60.00	0	\$0.00	8	\$480.00	0	\$0.00	20	\$1,200.00	0	\$0.00	28	\$1,680.00
Drafting	\$60.00	2	\$120.00	0	\$0.00	0	\$0.00	1	\$60.00	8	\$480.00	11	\$660.00
Clerical/Administrative	\$40.00	2	\$80.00	0	\$0.00	0	\$0.00	1	\$40.00	6	\$240.00	9	\$360.00
TOTAL LABOR		30	\$2,130.00	38	\$2,670.00	28	\$2,020.00	34	\$2,400.00	106	\$7,500.00	236	\$16,720.00
TOTAL SUBCONTRACTORS			\$0.00		\$5,018.00		-\$0.00		\$710.00		\$0.00		\$5,728.00
TOTAL LABORATORY			\$0.00		\$0.00		\$100.00		\$1,500.00		\$0.00		\$1,600.00
TOTAL EXPENSES			\$15.00		\$180.00		\$165.00		\$340.00		\$0.00		\$700.00
TOTAL ESTIMATED COSTS			\$2,145.00		\$7,868.00		\$2,285.00		\$4,950.00		\$7,500.00		\$24,748.00

EXPENSE DETAILS		TASK 1 Site History Documentation		TASK 2 Off-site Monitoring Well Installation and Development		TASK 3 Hand Auger Advancement		TASK 4 Two Rounds of Groundwater Sampling		TASK 5 Project Coordination, Data Analysis and Report Preparation		PROJECT TOTALS	
SUBCONTRACTORS	RATE	Units	Amount	Units	Amount	Units	Amount	Units	Amount	Units	Amount	Units	Amount
Soil Boring/Monitoring Well Installation	\$1,926.00	0	\$0.00	1	\$1,926.00	0	\$0.00	0	\$0.00	0	\$0.00	1	\$1,926.00
Professional Monitoring Well Survey	\$500.00	0	\$0.00	1	\$500.00	0	\$0.00	0	\$0.00	0	\$0.00	1	\$500.00
Soil Disposal - Solid Waste Drums	\$52.00	0	\$0.00	39	\$2,028.00	0	\$0.00	0	\$0.00	0	\$0.00	39	\$2,028.00
Soil Disposal - Hazardous Waste Drums	\$188.00	0	\$0.00	3	\$564.00	0	\$0.00	0	\$0.00	0	\$0.00	3	\$564.00
Groundwater Disposal - Per Drum	\$355.00	0	\$0.00	0	\$0.00	0	\$0.00	2	\$710.00	0	\$0.00	2	\$710.00
TOTAL SUBCONTRACTORS			\$0.00		\$5,018.00		\$0.00		\$710.00		\$0.00		\$5,728.00
LABORATORY													
VOC - Soil	\$50.00	0	\$0.00	0	\$0.00	2	\$100.00	0	\$0.00	0	\$0.00	2	\$100.00
VOC - Water	\$50.00	0	\$0.00	0	\$0.00	0	\$0.00	30	\$1,500.00	0	\$0.00	30	\$1,500.00
TOTAL LABORATORY COSTS			\$0.00		\$0.00		\$100.00		\$1,500.00		\$0.00		\$1,600.00
EXPENSES													
GIS Registry	\$450.00	0	\$0.00	0	\$0.00	0	\$0.00	0	\$0.00	0	\$0.00	0	\$0.00
WDNR Review	\$750.00	0	\$0.00	0	\$0.00	0	\$0.00	0	\$0.00	0	\$0.00	0	\$0.00
Mileage	\$0.50	30	\$15.00	60	\$30.00	30	\$15.00	60	\$30.00	0	\$0.00	180	\$90.00
Lodging	\$75.00	0	\$0.00	0	\$0.00	0	\$0.00	0	\$0.00	0	\$0.00	0	\$0.00
Meals	\$25.00	0	\$0.00	0	\$0.00	0	\$0.00	0	\$0.00	0	\$0.00	0	\$0.00
PID	\$70.00	0	\$0.00	1	\$70.00	1	\$70.00	0	\$0.00	0	\$0.00	2	\$140.00
Water Level Ind	\$10.00	0	\$0.00	2	\$20.00	0	\$0.00	2	\$20.00	0	\$0.00	4	\$40.00
Concrete Coring Machine	\$50.00	0	\$0.00	0	\$0.00	1	\$50.00	0	\$0.00	0	\$0.00	1	\$50.00
pH meter	\$20.00	0	\$0.00	0	\$0.00	0	\$0.00	2	\$40.00	0	\$0.00	2	\$40.00
Peristaltic Pump	\$50.00	0	\$0.00	0	\$0.00	0	\$0.00	0	\$0.00	0	\$0.00	0	\$0.00
DO Meter	\$25.00	0	\$0.00	0	\$0.00	0	\$0.00	2	\$50.00	0	\$0.00	2	\$50.00
Bentonite Chips	\$12.50	0	\$0.00	0	\$0.00	0	\$0.00	0	\$0.00	0	\$0.00	0	\$0.00
Disposable Bailers	\$15.00	0	\$0.00	4	\$60.00	0	\$0.00	0	\$0.00	0	\$0.00	4	\$60.00
55 Gallon drum	\$30.00	0	\$0.00	0	\$0.00	0	\$0.00	0	\$0.00	0	\$0.00	0	\$0.00
Redox Meter	\$25.00	0	\$0.00	0	\$0.00	0	\$0.00	2	\$50.00	0	\$0.00	2	\$50.00
Rope	\$0.10	0	\$0.00	0	\$0.00	0	\$0.00	0	\$0.00	0	\$0.00	0	\$0.00
Asphalt Patch	\$10.00	0	\$0.00	0	\$0.00	3	\$30.00	0	\$0.00	0	\$0.00	3	\$30.00
Ferrous Iron (Hach Kit)	\$5.00	0	\$0.00	0	\$0.00	0	\$0.00	30	\$150.00	0	\$0.00	30	\$150.00
TOTAL EXPENSES			\$15.00		\$180.00		\$165.00		\$340.00		\$0.00		\$700.00

FAX

Date MARCH 20, 2003

Number of pages including cover sheet (2)

TO: Aimee Hennings

FROM: ~~Aimee Hennings~~ Jim House



North Shore Engineering, Inc.
11433 N. Port Washington Rd.
Mequon, WI 53092

Phone

Phone (262) 241-9400

Fax Phone

Fax Phone (262) 241-5337

RE:

REMARKS: Urgent For your review Reply ASAP Please Comment

Original to Follow

CONFIDENTIALITY NOTICE: The information in this facsimile transmission is confidential. It may also be privileged work product or proprietary information. The information is intended for the exclusive use of the addressee named above. If you are not the intended recipient, you are hereby notified that any use, disclosure, dissemination, distribution (other than the addressee named above), copying, or the taking of any action because of this information is strictly prohibited. If you have received this information in error, please immediately notify us by telephone to arrange for return of the documents.

SIGMA ENVIRONMENTAL SERVICES, INC.

220 East Ryan Road
Oak Creek, WI 53154
(414) 768-7144
Fax: (414) 788-7158

REQUEST FOR COST ESTIMATE - PROPERTY SURVEY AND MAP

1. Sigma Project # 7115 & 7377 Cost Estimate Required by 3-21-03

Project Manager Aimee Hennings Anticipated Start Date 6-15-03

2. Site Name Badger Lease and Auto

Site Address 9801 Greenfield Avenue, West Allis, WI

Site Map or Drawing Attached X Site Legal Description Attached

3. Request for Services:

- Property Survey referenced to National Geodetic Datum (NR 716.15)
X Vertical accuracy of 0.01 ft. and horizontal accuracy of 1.0 ft.
X Horizontal locations are to be referenced to the Wisconsin State Plane Coordinate System.
X Survey to include elevations and location data referenced to USGS benchmark for soil borings and monitoring wells (ground and top of casing), utilities, building locations and important land features (see attached drawing).
X Provide a 3 1/2" HD floppy computer disk with .DWG R13 or less, .DGN or .DXF file format and 2 hard copies of the map by Within two weeks of completion of field work.

4. Cost Estimate:

Mobilization/Demobilization
Labor including travel time: hours @ \$ /hour \$
Survey Equipment Fee:
Flat Rate of \$ or hours @ \$ /hour (if necessary) \$
Per Diem: night(s) @ \$ /night (if necessary) \$
Estimated Total Cost or Lump Sum \$500

5. Signature James W. Feusel Date March 20, 2003
Print Name James Feusel
Company North Shore Engineering, Inc.
Telephone # 262-241-9400



FACSIMILE TRANSMITTAL SHEET

TO:	Aimee Hennings	FROM:	Pete Nielson
COMPANY:	Sigma Environmental	DATE:	20 March, 2003
FAX NUMBER:	(414) 768-7158	TOTAL NO. OF PAGES INCLUDING COVER:	3
PHONE NUMBER:	(414) 768-7144	E-MAIL:	nielson@emcsinc.com
RE:	Survey Estimate	CC:	

URGENT
 FOR REVIEW
 PLEASE COMMENT
 PLEASE REPLY

NOTES/COMMENTS:

Aimee,

Thank you for considering EMCS for this project. If you would like to select us, please sign and fax back the "Authorization to Proceed" form. If you have any questions, please call. We look forward to working with you.

Pete Nielson

MILWAUKEE OFFICE:

205 WEST HIGHLAND AVENUE, SUITE 501, MILWAUKEE, WI 53203
PHONE: 414.347.1607 FAX: 414.347.1347

WAUSAU OFFICE:

605 SOUTH 34TH AVENUE, SUITE 34, WAUSAU, WI 54401
PHONE: 715.845.1081 FAX: 715.845.1099



EMCS Design Group
 205 W. Highland Avenue, Suite 501
 Milwaukee, WI 53203
 Telephone: (414) 347-1607
 Fax: (414) 347-1347

Price Proposal

Client: Aimee Hennings
 Sigma Environmental Services
 220 East Ryan Road
 Oak Creek, WI 53154

Project: Badger Lease and Auto
 9601 Greenfield Ave.
 West Allis, WI

Date: 20 March 2003

Scope of Services: Survey Work: Monitoring Wells-Property Survey

- 1) Horizontal and Vertical location of 4 Monitoring Wells. Horizontal datum will be State Plane coordinates – South Zone. Vertical datum will be NGVD '29 (Sea Level). Elevations to be taken at the top of PVC pipe and at ground surface at each well.
- 2) EMCS to deliver a spreadsheet of coordinates and elevations.

Schedule: Work scheduled to start by 15 May, 2003 – Deliverables within 1 week.

Cost: Lump Sum = \$550

Authorization to proceed:

Client
 Signature: _____
 Date: _____

This is a quote for the above-referenced items only, any extra work will be considered additional, and quoted separately. 48 hours advance notice is required to schedule survey crew.

Thank you for considering us for this project.
Please call if you have any questions or would like to discuss anything further.

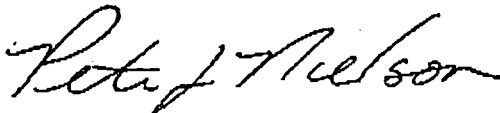
A handwritten signature in black ink that reads "Pete Nielson". The signature is written in a cursive style with a large initial "P" and "N".

Pete Nielson

SIGMA ENVIRONMENTAL SERVICES, INC.

220 East Ryan Road
Oak Creek, WI 53154
(414) 768-7144
Fax: (414) 768-7158

REQUEST FOR COST ESTIMATE - PROPERTY SURVEY AND MAP

1. Sigma Project # 7115 & 7377 Cost Estimate Required by 3-21-03
Project Manager Aimee Hennings Anticipated Start Date 5-15-03

2. Site Name Badger Lease and Auto
Site Address 9601 Greenfield Avenue, West Allis, WI
Site Map or Drawing Attached X Site Legal Description Attached

3. Request for Services:
 Property Survey referenced to National Geodetic Datum (NR 716.15)
 Vertical accuracy of 0.01 ft. and horizontal accuracy of 1.0 ft.
 Horizontal locations are to be referenced to the Wisconsin State Plane Coordinate System.
 Survey to include elevations and location data referenced to USGS benchmark for soil borings and monitoring wells (ground and top of casing), utilities, building locations and important land features (see attached drawing).
 Provide a 3 1/2" HD floppy computer disk with .DWG R13 or less, .DGN or .DXF file format and 2 hard copies of the map by Within two weeks of completion of field work.

4. Cost Estimate:
Mobilization/Demobilization
Labor including travel time: 6.0 hours @ \$ 125/hour \$ 750.00
Survey Equipment Fee:
Flat Rate of \$ _____ or _____ hours @ \$ _____/hour (if necessary) \$ _____
Per Diem: _____ night(s) @ \$ _____/night (if necessary) \$ _____
Estimated Total Cost or Lump Sum \$ 750.00

5. Signature *Fred Shibilski* Date 3-19-03
Print Name Fred Shibilski
Company Surveying Associates, Inc.
Telephone # (414) 257-2212

SIGMA ENVIRONMENTAL SERVICES, INC.

REQUEST FOR COST ESTIMATE ANALYTICAL SERVICES

Sigma Project # 7115/7377 Cost Estimate Required By 03/21/03

Project Manager Marty Nassman Date Samples Expected 04/15/03

Phone No. (414)768-7144 Fax No. (414)768-7158

NOTE: THE BELOW UNIT COSTS WILL BE HONORED FOR ONE (1) CALENDAR YEAR STARTING ON THE DATE THE FIRST SAMPLE IS SUBMITTED. ALL BIDS WILL FOLLOW FAX REQUESTS/RESPONSE WITH A SIGNED HARD COPY TO BE CONSIDERED.

Analytical Parameters Requested	Soil			Water					Analytical Method	Detection Limit
	Number of Samples	Unit Cost	Total Cost	Number of Samples per Sampling Round	Number of Sampling Rounds	Total Number of Samples	Unit Cost	Total Cost		
VOC	2	55	110	14	2	28	55	1540	EPA 8021	
VOC				Trip Blank	2	2	NC		EPA 8021	
VOC				Equip. Blank	2	2	55	110	EPA 8021	
	Me OH Blank	NC		Duplicate	2	2	55	110	EPA 8021	

Turnaround Time (Working Days) _____

Cost for Sample Bottles _____

Cost for Shipping _____

Cost for Chromatograms _____

Courier Service Provided _____

Courier Service Provider _____
(Attach Sheet with Procedures/Directions)

Cost for Courier Service _____

Cost for Soil/Water Disposal _____

1. (Laboratory) warrants and represents that all times while providing services under this Agreement, it shall maintain in place errors and omissions (professional liability) insurance coverage of no less than \$1,000,000 per claim; \$1,000,000 annual aggregate and a deductible of no more than \$100,000 per claim. The insurance coverage shall be provided by a firm that has an A.M. Best rating of at least "A-".
2. Laboratory shall notify (Consultant) immediately if the insurance coverage required in paragraph 1 above is interrupted, suspended, lapsed or terminated for any reason.
3. Laboratory shall indemnify Consultant or (Owner) for all laboratory costs determined to be ineligible for PECFA reimbursement by the PECFA staff due to Laboratory's failure to maintain the insurance coverage required in paragraph 1 above.

Signature _____

SUBTOTAL SOIL ANALYSIS 110

QUOTE #

SUBTOTAL WATER ANALYSIS 1760

SUBTOTAL - OTHER (BOTTLES, ETC.) _____

SHIPPING CHARGES _____

TOTAL PROJECT BID 1870

Danny Welfel
Signature

Title

Company

Enchem 3/21/03
Date

SIGMA ENVIRONMENTAL SERVICES, INC.

REQUEST FOR COST ESTIMATE ANALYTICAL SERVICES

Sigma Project # 7115/7377 Cost Estimate Required By 03/21/03

Project Manager Marty Nessman Date Samples Expected 04/15/03

Phone No. (414)788-7144 Fax No. (414)788-7158

NOTE: THE BELOW UNIT COSTS WILL BE HONORED FOR ONE (1) CALENDAR YEAR STARTING ON THE DATE THE FIRST SAMPLE IS SUBMITTED. ALL BIDS WILL FOLLOW FAX REQUESTS/RESPONSE WITH A SIGNED HARD COPY TO BE CONSIDERED.

Analytical Parameters Requested	Soil			Water					Analytical Method	Detection Limit
	Number of Samples	Unit Cost	Total Cost	Number of Samples per Sampling Round	Number of Sampling Rounds	Total Number of Samples	Unit Cost	Total Cost		
VOC	2	80	160	14	2	28	70	1960	EPA 8021	
VOC				Trip Blank	2	2	0		EPA 8021	
VOC				Equip. Blank	2	2	35	70	EPA 8021	
	Me OH Blank			Duplicate	2	2	70	140	EPA 8021	

Turnaround Time (Working Days) _____

Cost for Sample Bottles _____

Cost for Shipping _____

Cost for Chromatograms _____

Courier Service Provided _____

Courier Service Provider _____
(Attach Sheet with Procedures/Directions)

Cost for Courier Service _____

Cost for Soil/Water Disposal _____

1. (Laboratory) warrants and represents that all times while providing services under this Agreement, it shall maintain in place errors and omissions (professional liability) insurance coverage of no less than \$1,000,000 per claim; \$1,000,000 annual aggregate and a deductible of no more than \$100,000 per claim. The insurance coverage shall be provided by a firm that has an A.M. Best rating of at least "A".

2. Laboratory shall notify (Consultant) immediately if the insurance coverage required in paragraph 1 above is interrupted, suspended, lapsed or terminated for any reason.

3. Laboratory shall indemnify Consultant or (Owner) for all laboratory costs determined to be ineligible for PECFA reimbursement by the PECFA staff due to Laboratory's failure to maintain the insurance coverage required in paragraph 1 above.

Signature _____

SUBTOTAL SOIL ANALYSIS	<u>160</u>	QUOTE #
SUBTOTAL WATER ANALYSIS	<u>2170</u>	
SUBTOTAL - OTHER (BOTTLES, ETC.)	_____	
SHIPPING CHARGES	_____	
TOTAL PROJECT BID	<u>2330</u>	

Dan Milay
Signature
Proj. Mgr
Title
TESTAMERICA
Company
3/19/03
Date

Sigma Environmental Services, Inc.

REQUEST FOR COST ESTIMATE - DRILLING SERVICES		Page 1 of 2	
Sigma Project # <u>7115/7377</u>		Project Location: <u>9801 W. Greenfield Ave.</u>	
Project Manager <u>Marty Nessman</u>		<u>West Allis, Wisconsin</u>	
Phone # <u>414-768-7144</u>		Cost Estimate Required by: <u>March 21, 2003</u>	
Fax # <u>414-768-7158</u>		Anticipated Start Date: <u>April 15, 2003</u>	
1. Project Summary/ Conditions:		Drill and install four 2" PVC groundwater monitoring wells with a 10 foot well screen to a depth of 14 feet bgs. Wells to be drilled in street ROW's, traffic control will be needed.	
2. Responsible for Utility Clearance:		Sigma <input checked="" type="checkbox"/> Drilling Contractor	
3. Water Provided by:		Site Owner <input type="checkbox"/> Drilling Contractor <input checked="" type="checkbox"/>	
4. Electric Provided by:		Site Owner <input checked="" type="checkbox"/> Drilling Contractor <input type="checkbox"/>	
5. Drilling Method: Geoprobe _____ Air Hammer/Rotary _____		Hollow Stem Auger <input checked="" type="checkbox"/> Mud Rotary _____	
6. Drilling Surface: Asphalt/Concrete			
7. Sampling Interval: Continuous <input checked="" type="checkbox"/> 2 1/2 ft. _____ Other _____			
Explain:			
8. Estimated Depth to Groundwater: <u>7-9</u> ft.			
9. Cost Estimate: This bid form must be used. All costs must be included in the lump sums or unit rates for the tasks listed below. No exceptions or substitutions will be considered.			
Task	Quantity	Unit Rate	Cost
Mobilization (includes support vehicles)	1	Lump Sum	\$ 150.00
Soil Boring Drilling	56 /feet	10.00 /foot	560.00
Borehole Abandonment	0 /feet	4.00 /foot	0
Well Installation (includes all well supplies)	56 /feet	11.00 /foot	616.00
Well Protective Covers	4	75.00/each	300.00
<input checked="" type="checkbox"/> Flush Mount <input type="checkbox"/> Above Ground			
Decon/Steam Cleaning	1	Lump Sum	100.00
55- Gallon Drums	4	25.00/Drum	100.00
Visqueen	/Rolls	/Rolls	NA
Traffic Control	1	100.00	100.00
TOTAL COST			\$ 1,926.00

It is our understanding that Sigma will arrange for any necessary permits. 1/89

f:\sigma\forms\drilling.bid

Sigma Project # 7115/7377

Page 2 of 2

REQUEST FOR COST ESTIMATE - DRILLING SERVICES
(CONTINUED)

10. Conditions:

1. Drilling Contractor warrants and represents that all times while providing services under this Agreement, it shall maintain general liability coverage including, pollution impairment liability coverage of no less than \$1,000,000 per claim; \$1,000,000 annual aggregate and a deductible of no more than \$100,000 per claim. The insurance coverage shall be provided by a firm that has an A.M. Best rating of at least "A-".
2. Drilling Contractor shall notify (Consultant) immediately if the insurance coverage required in paragraph 1 above is interrupted, suspended, lapsed or terminated for any reason.
3. Drilling Contractor shall indemnify Consultant or (Owner) for all drilling costs determined to be ineligible for PECFA reimbursement by the PECFA staff due to Contractor's failure to maintain the insurance coverage required in paragraph 1 above.
4. The above unit costs will be honored for one (1) calendar year starting on the date of the first mobilization.
5. All bids will follow fax requests/responses with a signed hard copy of this form to be considered.
6. All drilling equipment will be decontaminated before arrival on-site.

Kim R. Kapugi
Name (Print)

Name (Print)

Kim R. Kapugi
Signature

Signature

President
Title

Title

(608) 837-8992
Phone

Phone

On-site Environmental Svcs, Inc
Company

Company

Date

Sigma Environmental Services, Inc.

REQUEST FOR COST ESTIMATE - DRILLING SERVICES		Page 1 of 2	
Sigma Project # <u>7115/7377</u>		Project Location: <u>9601 W. Greenfield Ave.</u>	
Project Manager <u>Marty Nessman</u>		<u>West Allis, Wisconsin</u>	
Phone # <u>414-768-7144</u>		Cost Estimate Required by: <u>March 21, 2003</u>	
Fax # <u>414-768-7158</u>		Anticipated Start Date: <u>April 15, 2003</u>	
1. Project Summary/ Conditions:		Drill and install four 2" PVC groundwater monitoring wells with a 10 foot well screen to a depth of 14 feet bgs. Wells to be drilled in street ROW's, traffic control will be needed.	
2. Responsible for Utility Clearance:		Sigma <input checked="" type="checkbox"/> Drilling Contractor	
3. Water Provided by:		Site Owner Drilling Contractor <input checked="" type="checkbox"/>	
4. Electric Provided by:		Site Owner <input checked="" type="checkbox"/> Drilling Contractor	
5. Drilling Method: Geoprobe _____ Air Hammer/Rotary _____		Hollow Stem Auger <input checked="" type="checkbox"/> Mud Rotary _____	
6. Drilling Surface: Asphalt/Concrete			
7. Sampling Interval: Continuous <input checked="" type="checkbox"/> 2 1/2 ft. _____ Other _____			
Explain:			
8. Estimated Depth to Groundwater: <u>7-9</u> ft.			
9. Cost Estimate: This bid form must be used. All costs must be included in the lump sums or unit rates for the tasks listed below. No exceptions or substitutions will be considered.			
Task	Quantity	Unit Rate	Cost
Mobilization (includes support vehicles)	1	Lump Sum	\$ 325. ⁰⁰
Soil Boring Drilling	56 /feet	13. ⁰⁰ /foot	728. ⁰⁰
Borehole Abandonment	0 /feet	/foot	
Well Installation (Includes all well supplies)	56 /feet	13. ⁰⁰ /foot	728. ⁰⁰
Well Protective Covers <input type="checkbox"/> Flush Mount <input type="checkbox"/> Above Ground	4	125. ⁰⁰ /each	500. ⁰⁰
Decon/Steam Cleaning	1	Lump Sum	150. ⁰⁰
55- Gallon Drums	4	35. ⁰⁰ /Drum	140. ⁰⁰
Visqueen	/Rolls	/Rolls	
Traffic Control	1	LS	200. ⁰⁰
TOTAL COST			\$ 2771.00

Sigma Project # 7115/7377

Page 2 of 2

REQUEST FOR COST ESTIMATE - DRILLING SERVICES
(CONTINUED)

10. Conditions:

1. Drilling Contractor warrants and represents that all times while providing services under this Agreement, it shall maintain general liability coverage including, pollution impairment liability coverage of no less than \$1,000,000 per claim; \$1,000,000 annual aggregate and a deductible of no more than \$100,000 per claim. The insurance coverage shall be provided by a firm that has an A.M. Best rating of at least "A-".
2. Drilling Contractor shall notify (Consultant) immediately if the insurance coverage required in paragraph 1 above is interrupted, suspended, lapsed or terminated for any reason.
3. Drilling Contractor shall indemnify Consultant or (Owner) for all drilling costs determined to be ineligible for PECFA reimbursement by the PECFA staff due to Contractor's failure to maintain the insurance coverage required in paragraph 1 above.
4. The above unit costs will be honored for one (1) calendar year starting on the date of the first mobilization.
5. All bids will follow fax requests/responses with a signed hard copy of this form to be considered.
6. All drilling equipment will be decontaminated before arrival on-site.

Mark Garwick
Name (Print)

[Signature]
Signature

President
Title

608-877-9770
Phone

Badger State Drilling, Inc.
Company

3/20/03
Date

Sigma Environmental Services, Inc.

REQUEST FOR COST ESTIMATE - DRILLING SERVICES

Page 1 of 2

Sigma Project # 7116/7377

Project Location: 9601 W. Greenfield Ave.

Project Manager Marty Nessman

West Allis, Wisconsin

Phone # 414-768-7144

Cost Estimate Required by: March 21, 2003

Fax # 414-768-7158

Anticipated Start Date: April 15, 2003

1. Project Summary/ Conditions: Drill and install four 2" PVC groundwater monitoring wells with a 10 foot well screen to a depth of 14 feet bgs. Wells to be drilled in street ROW's, traffic control will be needed.

Post-it* Fax Note	7671	Date	3-19	# of pages	2
To	Marty Nessman	From	Ron Tralander		
Co./Dept.	Sigma	Co.	Boart Longyear		
Phone #		Phone #	715 359 7090		
Fax #	414 768 7158	Fax #	715 355 5715		

Sigma
Drilling Contractor

Site Owner
Drilling Contractor

Site Owner
Drilling Contractor

Hollow Stem Auger
Mud Rotary

Air Hammer/Rotary _____

6. Drilling Surface: Asphalt/Concrete

7. Sampling Interval: Continuous 2 1/2 ft. _____ Other _____

Explain:

8. Estimated Depth to Groundwater: 7-9 ft.

9. Cost Estimate: This bid form must be used. All costs must be included in the lump sums or unit rates for the tasks listed below. No exceptions or substitutions will be considered.

Task	Quantity	Unit Rate	Cost
Mobilization (includes support vehicles)	1	Lump Sum	\$ 400
Soil Boring Drilling	56 feet	12 /foot	672
Borehole Abandonment	0 /feet	4 /foot	0
Well Installation (includes all well supplies)	56 /feet	12 /foot	672
Well Protective Covers.			
<input checked="" type="checkbox"/> Flush Mount	4	165 /each	660
<input type="checkbox"/> Above Ground	0	135	
Decon/Steam Cleaning	1	Lump Sum	150
55- Gallon Drums	4	40 /Drum	160
Visqueen	0 /Rolls	100 /Rolls	0
Traffic Control	1	Lump Sum	275
TOTAL COST			\$ 2989

Sigma Project # 7786

Page 2 of 2

REQUEST FOR COST ESTIMATE - DRILLING SERVICES
(CONTINUED)

10. Conditions:

1. Drilling Contractor warrants and represents that all times while providing services under this Agreement, it shall maintain general liability coverage including, pollution impairment liability coverage of no less than \$1,000,000 per claim; \$1,000,000 annual aggregate and a deductible of no more than \$100,000 per claim. The insurance coverage shall be provided by a firm that has an A.M. Best rating of at least "A-".
2. Drilling Contractor shall notify (Consultant) immediately if the insurance coverage required in paragraph 1 above is interrupted, suspended, lapsed or terminated for any reason.
3. Drilling Contractor shall indemnify Consultant or (Owner) for all drilling costs determined to be ineligible for PECFA reimbursement by the PECFA staff due to Contractor's failure to maintain the insurance coverage required in paragraph 1 above.
4. The above unit costs will be honored for one (1) calendar year starting on the date of the first mobilization.
5. All bids will follow fax requests/responses with a signed hard copy of this form to be considered.
6. All drilling equipment will be decontaminated before arrival on-site.

Ron Thalacker

Name (Print)

[Signature]

Signature

Zone Manager

Title

715 359 7090

Phone

Boart Longyear

Company

3-19-03

Date



Fax Coversheet

TO: Marty Nessman

COMPANY: Sigma

FAX NUMBER: 414-768-7158

FROM: Chris Duba

DATE: 3/21/03

THIS MESSAGE IS INTENDED ONLY FOR THE USE OF THE INDIVIDUAL OR ENTITY TO WHICH IT IS ADDRESSED, AND MAY CONTAIN INFORMATION THAT IS PRIVILEGED OR CONFIDENTIAL.

If the reader of this message is not the intended recipient, or the employee or agent responsible for delivering the message to the intended recipient, you are notified that any dissemination or distribution of this communication is strictly prohibited. If you have received this communication in error, please notify us immediately by telephone, and return the original message to us by mail. Thank You.

Number of Total Pages Including Cover: 2

Special Comments / Instructions: Following is the bid you requested. If you have any questions please give me a call.

Thanks Chris



220 East Ryan Road
 Oak Creek, WI 53154-4533
 414-768-7144
 FAX: 414-768-7158

**COST ESTIMATE FOR
 SOIL TRANSPORTATION AND LANDFILL DISPOSAL**
 Sigma Project Reference # 7115
 Project Name: Badger Lease
 Project Location: West Allis, Wisconsin
 Estimate Required By: March 20, 2003

<u>Task</u>	<u># of Units</u>	<u>Unit</u>	<u>Unit Price</u>	<u>Extended Price</u>
Mobilization/demobilization (per event)	1	Lump sum	\$ <u>500.00</u>	\$ <u>500.00</u>
Solid Waste Disposal (Subtitle D Landfill)	39	Drums	\$ <u>33.00</u>	\$ <u>1,287.00</u>
Hazardous Waste Disposal (Subtitle C Landfill)	3	Drums	\$ <u>176.00</u>	\$ <u>528.00</u>
Other (describe): Over-packing of Damaged 55 gal. Soil Drums (Solid Waste)	11	Drums	\$ <u>25.00</u>	\$ <u>275.00</u>
*Waste will be approved for disposal through Onyx Special Services.				TOTAL BID COST \$ <u>2,590.00</u>

Company Name: Onyx Special Services
 Signature: [Signature]
 Title: Project Manager

Date: 3/21/03

Please return to:
 Sigma Environmental Services, Inc. Fax: (414) 768-7158
 ATTN: Martin Nessman Phone: (414) 768-7144
 220 E. Ryan Road
 Oak Creek, WI 53154

Attachment(s): Soil Analytical Summary Tables, WDNR "Contained-In Determination"



220 East Ryan Road
 Oak Creek, WI 53154-4533
 414-768-7144
 FAX: 414-768-7158

**COST ESTIMATE FOR
 SOIL TRANSPORTATION AND LANDFILL DISPOSAL.**

Sigma Project Reference # 7115
 Project Name: Badger Lease
 Project Location: West Allis, Wisconsin
 Estimate Required By: March 20, 2003

<u>Task</u>	<u># of Units</u>	<u>Unit</u>	<u>Unit Price</u>	<u>Extended Price</u>
Mobilization/demobilization (per event)	1	Lump sum	\$ <u>600.00</u>	\$ <u>600.00</u>
Solid Waste Disposal (Subtitle D Landfill)	39	Drums	\$ <u>50.00</u>	\$ <u>1,950.00</u>
Hazardous Waste Disposal (Subtitle C Landfill)	3	Drums	\$ <u>175.00</u>	\$ <u>525.00</u>
Other (describe): Over-packing of Damaged 55 gal. Soil Drums (Solid Waste)	11	Drums	\$ <u>90.00</u>	\$ <u>990.00</u>
TOTAL BID COST				\$ <u>4,065.00</u>

Company Name: Waste Management of Wisconsin, Inc.

Signature: [Signature]

Date: 3/20/03

Title: Landfill Sales

Please return to:

Sigma Environmental Services, Inc.
 ATTN: Martin Nessman
 220 E. Ryan Road
 Oak Creek, WI 53154

Fax: (414) 768-7158
 Phone: (414) 768-7144

Attachment(s): Soil Analytical Summary Tables, WDNR "Contained-In Determination"





220 East Ryan Road
Oak Creek, WI 53154-4533
414-768-7144
FAX: 414-768-7158

**COST ESTIMATE FOR
SOIL TRANSPORTATION AND LANDFILL DISPOSAL**

Sigma Project Reference # 7115
Project Name: Badger Lease
Project Location: West Allis, Wisconsin
Estimate Required By: March 20, 2003

Task	# of Units	Unit	Unit Price	Extended Price
Mobilization/demobilization (per event)	1	Lump sum	\$ N/A	\$ _____
Solid Waste Disposal (Subtitle D Landfill)	39	Drums	\$ <u>73.00</u>	\$ <u>2,847.00</u>
Hazardous Waste Disposal (Subtitle C Landfill)	3	Drums	\$ <u>425.00</u>	\$ <u>1,275.00</u>
Other (describe): Over-packing of Damaged 55 gal. Soil Drums (Solid Waste)	11	Drums	\$ <u>83.00</u>	\$ <u>913.00</u>
TOTAL BID COST				\$ <u>5,035.00</u>

Company Name: Republic Services, Inc.

Signature: *[Handwritten Signature]*

Date: March 25, 2003

Title: Special Waste Consultant

Please return to:

Sigma Environmental Services, Inc.
ATTN: Martin Nessman
220 E. Ryan Road
Oak Creek, WI 53154

Fax: (414) 768-7158
Phone: (414) 768-7144

Attachment(s): Soil Analytical Summary Tables, WDNR "Contained-In Determination"

Note: Number of units specified in the bid is the minimum charge for drum disposal: If hazardous drums meet treatment standards of 60 ppm a reduced charge of \$275.00 per drum would apply. One hour of site time is provided, \$85.00 per hour charge for time over one hour. Rates are valid for 60 days.





Fax Coversheet

TO: Marty Nessman

COMPANY: Sigma

FAX NUMBER: 414-768-7158

FROM: Chris Duba

DATE: 3/19/03

**THIS MESSAGE IS INTENDED ONLY FOR THE USE OF THE INDIVIDUAL OR ENTITY TO WHICH IT IS
ADDRESSED, AND MAY CONTAIN INFORMATION THAT IS PRIVILEGED OR CONFIDENTIAL.**

If the reader of this message is not the intended recipient, or the employee or agent responsible for delivering the message to the intended recipient, you are notified that any dissemination or distribution of this communication is strictly prohibited. If you have received this communication in error, please notify us immediately by telephone, and return the original message to us by mail. Thank You.

Number of Total Pages Including Cover: 2

Special Comments / Instructions: Following is the bid you requested. If you have any questions please give me a call.

Thanks Chris



220 East Ryan Road
 Oak Creek, WI 53154-4533
 414-768-7144
 FAX: 414-768-7158

**COST ESTIMATE FOR
 LISTED HAZARDOUS WASTE WATER DISPOSAL**
 Sigma Project Reference # 7115
 Project Name: Budger Lease
 Project Location: West Allis, WI
 Estimate Required By: March 21, 2003
 Process: Dry Cleaning
 Impacted with: PCE

Task	# of Units	Unit	Unit Price	Extended Price
Mobilization/demobilization	1	Lump sum	\$ _____	\$ <u>INCLUDED</u>
Water Disposal <u>↓</u>	100	Gallons	\$ _____	\$ _____
Other (describe): <u>55 gallon drum</u>	<u>2</u>	<u>DRM</u>	<u>\$ 250.00</u>	<u>\$ 500.00</u>
TOTAL BID COST				\$ <u>500.00</u>

Company Name: JENSEN ENVIRONMENTAL MGT, INC.
 Signature: [Signature] David Jensen Date: 4/1/2003
 Title: President

Please return to:
 Sigma Environmental Services, Inc. Fax: (414) 768-7158
 ATTN: Martin Nessman Phone: (414) 768-7144
 220 E. Ryan Road
 Oak Creek, WI 53154

Attachment(s): Groundwater Analytical Summary Tables

Post-It® Fax Note 7671	Date <u>4/1/03</u>	# of pages <u>1</u>
To <u>MARTIN NESSMAN</u>	From <u>DAVE JENSEN</u>	
Co./Dept <u>SIGMA</u>	Co. <u>JENSEN ENVIRON.</u>	
Phone # <u>768-7144</u>	Phone # <u>414 4229169</u>	
Fax # <u>768-7158</u>	Fax #	



220 East Ryan Road
Oak Creek, WI 53154-4533
414-768-7144
FAX: 414-768-7158

**COST ESTIMATE FOR
LISTED HAZARDOUS WASTE WATER DISPOSAL**

Sigma Project Reference # 7115
Project Name: Badger Lease
Project Location: West Allis, WI
Estimate Required By: March 21, 2003
Process: Dry Cleaning
Impacted with: PCE

<u>Task</u>	<u># of Units</u>	<u>Unit</u>	<u>Unit Price</u>	<u>Extended Price</u>
Mobilization/demobilization	1	Lump sum	\$ <u>250.00</u>	\$ <u>250.00</u>
Water Disposal	100 <u>2</u>	Gallons <u>Drums</u>	\$ <u>230.00</u>	\$ <u>460.00</u>
Other (describe):			\$ <u>—</u>	\$ <u>—</u>
TOTAL BID COST				\$ <u>710.00</u>

Company Name: Onyx Special Services
Signature: [Signature]
Title: Project Manager

Date: 3/19/03

Please return to:
Sigma Environmental Services, Inc. Fax: (414) 768-7158
ATTN: Martin Nessman Phone: (414) 768-7144
220 E. Ryan Road
Oak Creek, WI 53154

Attachment(s): Groundwater Analytical Summary Tables





Fax Coversheet

TO: Marty Nessman

COMPANY: Sigma

FAX NUMBER: 414-768-7158

FROM: Chris Duba

DATE: 3/21/03

**THIS MESSAGE IS INTENDED ONLY FOR THE USE OF THE INDIVIDUAL OR ENTITY TO WHICH IT IS
ADDRESSED, AND MAY CONTAIN INFORMATION THAT IS PRIVILEGED OR CONFIDENTIAL.**

If the reader of this message is not the intended recipient, or the employee or agent responsible for delivering the message to the intended recipient, you are notified that any dissemination or distribution of this communication is strictly prohibited. If you have received this communication in error, please notify us immediately by telephone, and return the original message to us by mail. Thank You.

Number of Total Pages Including Cover: 2

Special Comments / Instructions: Following is the bid you requested. If you have any questions please give me a call.

Thanks Chris



220 East Ryan Road
Oak Creek, WI 53154-4533
414-768-7144
FAX: 414-768-7158

**COST ESTIMATE FOR
SOIL TRANSPORTATION AND LANDFILL DISPOSAL**

Sigma Project Reference # 7115

Project Name: Badger Lease

Project Location: West Allis, Wisconsin

Estimate Required By: March 20, 2003

<u>Task</u>	<u># of Units</u>	<u>Unit</u>	<u>Unit Price</u>	<u>Extended Price</u>
Mobilization/demobilization (per event)	1	Lump sum	\$ 500.00	\$ <u>500.00</u>
Solid Waste Disposal (Subtitle D Landfill)	39	Drums	\$ <u>33.00</u>	\$ <u>\$1,287.00</u>
Hazardous Waste Disposal (Subtitle C Landfill)	3	Drums	\$ <u>176.00</u>	\$ <u>\$528.00</u>
Other (describe): Over-packing of Damaged 55 gal. Soil Drums (Solid Waste)	11	Drums	\$ <u>25.00</u>	\$ <u>275.00</u>
*Waste will be approved for disposal through Onyx Special Services.				TOTAL BID COST \$ <u>2590.00</u>

Company Name: Onyx Special Services
Signature: [Signature]
Title: Project Manager

Date: 3/21/03

Please return to:
Sigma Environmental Services, Inc. Fax: (414) 768-7158
ATTN: Martin Nessman Phone: (414) 768-7144
220 E. Ryan Road
Oak Creek, WI 53154

Attachment(s): Soil Analytical Summary Tables, WDNR "Contained-In Determination"



220 East Ryan Road
 Oak Creek, WI 53154-4533
 414-768-7144
 FAX: 414-768-7158

**COST ESTIMATE FOR
 SOIL TRANSPORTATION AND LANDFILL DISPOSAL**

Sigma Project Reference # 7115
 Project Name: Badger Lease
 Project Location: West Allis, Wisconsin
 Estimate Required By: March 20, 2003

Task	# of Units	Unit	Unit Price	Extended Price
Mobilization/demobilization (per event)	1	Lump sum	\$ <u>600.00</u>	\$ <u>600.00</u>
Solid Waste Disposal (Subtitle D Landfill)	39	Drums	\$ <u>50.00</u>	\$ <u>1,950.00</u>
Hazardous Waste Disposal (Subtitle C Landfill)	3	Drums	\$ <u>175.00</u>	\$ <u>525.00</u>
Other (describe): Over-packing of Damaged 55 gal. Soil Drums (Solid Waste)	11	Drums	\$ <u>90.00</u>	\$ <u>990.00</u>
TOTAL BID COST				\$ <u>4,065.00</u>

Company Name: Waste Management of Wisconsin, Inc.

Signature: [Signature]

Date: 3/20/03

Title: Landfill Sales

Please return to:

Sigma Environmental Services, Inc.
 ATTN: Martin Nessman
 220 E. Ryan Road
 Oak Creek, WI 53154

Fax: (414) 768-7158
 Phone: (414) 768-7144

Attachment(s): Soil Analytical Summary Tables, WDNR "Contained-In Determination"





220 East Ryan Road
Oak Creek, WI 53154-4533
414-768-7144
FAX: 414-768-7158

**COST ESTIMATE FOR
SOIL TRANSPORTATION AND LANDFILL DISPOSAL**

Sigma Project Reference # 7115

Project Name: Badger Lease

Project Location: West Allis, Wisconsin

Estimate Required By: March 20, 2003

Task	# of Units	Unit	Unit Price	Extended Price
Mobilization/demobilization (per event)	1	Lump sum	\$ N/A	\$ _____
Solid Waste Disposal (Subtitle D Landfill)	39	Drums	\$ 73.00	\$ 2,847.00
Hazardous Waste Disposal (Subtitle C Landfill)	3	Drums	\$ 425.00	\$ 1,275.00
Other (describe): Over-packing of Damaged 55 gal. Soil Drums (Solid Waste)	11	Drums	\$ 83.00	\$ 913.00
TOTAL BID COST				\$ 5,035.00

Company Name: Republic Services, Inc.

Signature: *[Handwritten Signature]*

Date: March 25, 2003

Title: Special Waste Consultant

Please return to:

Sigma Environmental Services, Inc.
ATTN: Martin Nessman
220 E. Ryan Road
Oak Creek, WI 53154

Fax: (414) 768-7158
Phone: (414) 768-7144

Attachment(s): Soil Analytical Summary Tables, WDNR "Contained-In Determination"

Note: Number of units specified in the bid is the minimum charge for drum disposal. If hazardous drums meet treatment standards of 60 ppm a reduced charge of \$275.00 per drum would apply. One hour of site time is provided, \$85.00 per hour charge for time over one hour. Rates are valid for 60 days.

