

State of Wisconsin Substance Release Notification Form

24 Hour Emergency Hotline Number: 1-800-943-0003

LE Form

04-38-262454

Date & Mil. Time of Incident: 5-23-2000 0750		Date & Mil. Time Reported 5-23-2000 0850	
Person Reporting/Representing: George Rogers			Phone # (715) 735-7411
Responsible Party/Spiller Ansul, Inc. Tyco Suppression Systems - Agent			Phone # (715) 735-7411
Contact Name George Rogers			Phone # (715) 735-7411 ext. 3304
Address 1 Stanton St.		City, State, Zip Code Marinette, WI 54143	
Substance Involved Metallic Mercury	Amount & Units Released unknown	Amount Recovered none	
<input type="checkbox"/> Solid <input type="checkbox"/> Semisolid <input checked="" type="checkbox"/> Liquid <input type="checkbox"/> Gas Color: Odor:			
Exact Location (Inc. address, facility name, mileage, bldg. #, etc) 1 Stanton St. Above address, building #30, the electrical panel in the SW corner of the building. Dry Chemical Process Dept. in Building 30			
City Marinette		County Marinette	Lat/Long
DNR Region NER		1/4 1/4 sec NR (E/W)	Weather Cond.
Cause of Incident: Overflow of a manometer inside the electrical panel spilled a small amount of mercury into the bottom of the panel's case - contained there. Manometer in box leaked			Action Taken by Spiller: <input type="checkbox"/> No Action Taken <input type="checkbox"/> No Action Needed <input type="checkbox"/> Monitor <input type="checkbox"/> Cleanup Method: <input checked="" type="checkbox"/> Waste Destination: Superior <input type="checkbox"/> Containment <input checked="" type="checkbox"/> Contractor Hired Name: Superior Special Services of Norway <input type="checkbox"/> Other:
Spilled Substance Impact To: Check ( ) all that apply: <input type="checkbox"/> Air <input type="checkbox"/> Potential <input type="checkbox"/> Soil <input type="checkbox"/> Potential <input type="checkbox"/> Groundwater <input type="checkbox"/> Potential <input type="checkbox"/> Surface Water <input type="checkbox"/> Potential Name: <input type="checkbox"/> Storm Sewer <input type="checkbox"/> Potential <input type="checkbox"/> Sanitary Sewer <input type="checkbox"/> Potential <input type="checkbox"/> Concrete/Asphalt <input type="checkbox"/> Potential <input type="checkbox"/> Private Well <input type="checkbox"/> Potential <input checked="" type="checkbox"/> Contained/Recovered in box <input type="checkbox"/> Other:		Spill Source: <input type="checkbox"/> Transportation Accident, Fuel Tank Spill <input type="checkbox"/> Transportation Accident, Load Spill <input checked="" type="checkbox"/> Industrial Facility <input type="checkbox"/> Paper Mill <input type="checkbox"/> Chemical Co. <input type="checkbox"/> Ag Coop/Facility/Food Factory/Facility <input type="checkbox"/> Gas/Service Station/Garage/Auto Dealer/Repair Shop <input type="checkbox"/> Pipeline/Terminal/Tank Farm/Oil Jobber/Wholesaler <input type="checkbox"/> Public Property (city, state, church, school, etc.) <input type="checkbox"/> Utility Co. Power Generating/Transfer Facility <input type="checkbox"/> Private Property (home/farm) <input type="checkbox"/> Construction, Evacuation, Wrecking, Quarry, Mine <input type="checkbox"/> Airport Facility <input type="checkbox"/> Railroad Facility <input type="checkbox"/> Other:	
Injuries? <input type="checkbox"/> Yes <input checked="" type="checkbox"/> No If yes how many?		Has an evacuation occurred? <input type="checkbox"/> Yes <input checked="" type="checkbox"/> No Potential? <input type="checkbox"/> Yes <input checked="" type="checkbox"/> No	
Are there any resource damages? <input type="checkbox"/> Yes <input checked="" type="checkbox"/> No <input type="checkbox"/> Potential? What kinds?			
Other agencies notified (check first column if notified) check both columns if on the scene <input type="checkbox"/> Fire Department <input type="checkbox"/> Local DNR <input type="checkbox"/> EPA <input type="checkbox"/> Local Law Enforcement <input type="checkbox"/> Div. Emerg. Mgt. <input type="checkbox"/> Nat'l Resp Ctr 800-442-8802 <input type="checkbox"/> LEPC or Local Emer. Mgt. <input type="checkbox"/> Coast Guard <input type="checkbox"/> Chemtrec 800-424-9300 <input type="checkbox"/> Level A/Level B Team <input type="checkbox"/> DHFS 608-258-0099 <input type="checkbox"/> Other:			Incident Commander, if known:
Prepared by: Tom Collier 608-261-4939		Phone: (608)261-4939	Date: 5-23-2000
Person Notified: faxed to Roxanne Chronert Did not call Warden		Phone: (920)492-5592	Date: 5-23-2000
Investigated by:		Sign	Date
Spill Coordinator Signoff: M J CMT 6-9-00		Date:	Transferred to: ERP <input type="checkbox"/> DATCP <input type="checkbox"/> Date: NO Case #
		Incident Closed? <input checked="" type="checkbox"/> Yes <input type="checkbox"/> No Date: 6-9-00 NFA Letter Sent? <input type="checkbox"/> Yes <input checked="" type="checkbox"/> No Spill Packet Sent? <input type="checkbox"/> Yes <input checked="" type="checkbox"/> No To:	

Additional Comments on Reverse

**tyco**

*Tyco Suppression  
Systems*

**ANSUL**

ISO 9001 REGISTERED

*Ansul Incorporated  
One Stanton Street  
Marinette, WI 54143-2542*

*Tele: 715 735-7411  
www.ansul.com*

July 12, 2000



Roxanne Nelezen-Chronert, Spills Coordinator  
Wisconsin DNR  
1125 N. Military Ave., PO Box 10448  
Green Bay, WI 54307-0448

**RE: Final Incident Response Report  
Mercury Release-May 23, 2000  
Ansul's Stanton Street Plant**

Dear Ms. Nelezen-Chronert:

I have attached an Incident Response Report we recently received from Superior Special Services for the above spill. The information it contains is essentially the same as that in the Final Summary Report I submitted to you on June 6, 2000.

If you have any questions, please contact me.

Sincerely,

George E. Rogers, CHMM  
Environmental Control Manager

PC: Dennis Orszulak  
Brad Goldapske



Superior Special Services, Inc.  
410 11<sup>th</sup> Avenue  
Norway, MI 49870  
(906) 774-4280  
FAX (906) 774-3118

## INCIDENT RESPONSE REPORT FOR ANSUL

Superior Project No: 220157A.00.005

Date: May 23, 2000

**Prepared by:**

Ken Clark  
Project Manager

Superior Special Services, Inc.  
Emergency Response Division  
100 West Larsen Drive  
Fond du Lac, WI 54936



May 23, 2000

Superior Services – Norway  
410 11th Avenue, P.O. Box 245  
Norway, Michigan 49870  
(906) 774-4280  
FAX (906) 774-3118

Mr. George Rogers  
ANSUL  
1 Stanton Street  
Marinette, Wisconsin 54143

Via fax : 715-732-3468 (3 pages)  
Via U.S. Mail

Dear Mr. Rogers,

The attached report summarizes Superior Special Services, Inc.'s activities responding to a mercury spill at Building 30 of Ansul.

If you have any questions, or if Superior can be of further assistance to you, please contact either our Immediate Response Dispatch Center at (920) 923-9000, or you may contact me directly at (906) 774-4280.

Thank you for calling on Superior Special Services, Inc. to serve your needs.

Sincerely,

A handwritten signature in black ink, appearing to read "Ken Clark".

Ken Clark  
Response Manager

Attachment

## SCOPE OF WORK

### A. Authorization

Mr. George Rogers of Ansul notified the Superior Special Services, Inc. Immediate Response Department of the incident by phone call at 08:40 on May 23, 2000.

### B. Location

Ansul, 1 Stanton Street, Marinette, WI 54143

### C. Weather

Not applicable; the mercury was released indoors.

### D. Incident / Chemicals Involved

Mercury was spilled from a manometer inside an electrical panel in Building 30. All material was contained within the panel.

### E. Overview

The amount of mercury released from the manometer appeared to be less than one ounce of material.

### F. Response

Upon receipt of a phone call from the Superior Special Services, Inc. Immediate Response dispatch office, a crew from Norway, Michigan mobilized to Ansul in Marinette, Wisconsin. The response team arrived on site at 10:30.

George Rogers of Ansul briefed Superior on the situation. After determining that all of the mercury was contained within the panel, the material was removed with a mercury vacuum unit and the area was cleaned with a nitrate wash.

Air monitoring was done with a Jerome meter. Initially, the concentration within the panel read .79. Following cleanup, the concentration read .02. The outside and surrounding areas of the control panel had a meter reading of 0.00.

All mercury, cleanup materials and containment suits were placed in an on-site drum for pick up and disposal at the Superior facility in Port Washington, Wisconsin.



Tyco Suppression  
Systems

**ANSUL**

ISO 9001 REGISTERED

Ansul Incorporated  
One Stanton Street  
Marinette, WI 54143-2542

Tele: 715 735-7411  
www.ansul.com

June 7, 2000

Roxanne Nelezen-Chronert, Spills Coordinator  
Wisconsin DNR  
1125 N. Military Ave., PO Box 10448  
Green Bay, WI 54307-0448



**RE: FINAL SUMMARY REPORT  
MERCURY RELEASE-MAY 23, 2000  
ANSUL'S STANTON STREET PLANT**

Dear Ms. Nelezen-Chronert:

On May 23, 2000 Ansul discovered a small amount of metallic mercury in an electrical box in the Dry Chemical Processing Department in Bldg. 30 at the Stanton Street site. A manometer in the box had leaked. The mercury was cleaned up by Superior Special Services of Norway, Michigan. Subsection NR 708.05(6)a (WI Adm. Code) requires that a report summarizing response activities for such incidents be filed with the Department within 45 days of the incident

**PURPOSE OF THE SUBMITTAL/DESIRED DEPARTMENT RESPONSE**

The purpose of this report is to satisfy the requirements of subsection NR 708.05 (WI Adm. Code). The Department was notified immediately upon discovery of the spill, the spill was completely contained within the electrical box, and no excavation of soils was required. For these reasons Ansul considers the incident to be a "non-emergency" as defined by Department regulations. Ansul does not feel that any further Departmental response is required.

**RESPONSIBLE PARTIES**

Tyco Suppression Systems-Ansul  
1 Stanton Street  
Marinette, WI 54143  
Attn: George Rogers, Env. Control. Manager  
(715) 735-7411

**LOCATION AND TIME OF RELEASE**

The spill was discovered at approximately 8 AM on May 23, 2000 in Bldg. 30 at the Stanton Street address. I have attached a map of the site showing the location of the spill.

**TYPE AND AMOUNT OF MATERIAL RELEASED**

Ansul estimates that less than one pound of liquid, metallic mercury was released from the manometer to the electrical box.

**RESPONSE ACTION/SAMPLING ACTIVITIES**

Ansul's Environmental Control Manager immediately isolated the electrical box with barrier tape and warned nearby Associates to remain out of the exclusion area. Superior Special Services was contacted immediately and were on-site by 10:30 AM. Please refer to the attached Superior report for their on-site activities, including sampling.

**DOCUMENTATION OF TREATMENT OR DISPOSAL**

The single drum of mercury residue (including the defective manometer) was shipped to Superior's Port Washington WI facility on June 6, 2000. I have attached a copy of the shipping manifest. Superior is required by state and Federal regulation to provide the Department with a receipt copy.

If you have any questions, please contact me.

Sincerely,

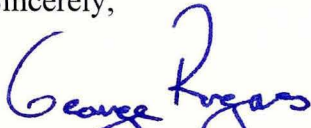

George E. Rogers, CHMM  
Environmental Control Manager

PC: Kris Knauss (Tyco)  
Karl Kinhead  
Ira Luplow  
Dennis Orszulak  
Brad Goldapske  
Rick Rickaby



Superior Special Services, Inc.  
410 11<sup>th</sup> Avenue  
Norway, MI 49870  
(906) 774-4280  
FAX (906) 774-3118

**INCIDENT RESPONSE REPORT  
FOR ANSUL**

Superior Project No: 220157A.00.005

Date: May 23, 2000

**Prepared by:**

Ken Clark  
Project Manager

Superior Special Services, Inc.  
Emergency Response Division  
100 West Larsen Drive  
Fond du Lac, WI 54936





May 23, 2000

Superior Services - Norway  
410 11th Avenue, P.O. Box 245  
Norway, Michigan 49870  
(906) 774-4280  
FAX (906) 774-3118

Mr. George Rogers  
ANSUL  
1 Stanton Street  
Marinette, Wisconsin 54143

Via fax : 715-732-3468 (3 pages)  
Via U.S. Mail

Dear Mr. Rogers,

The attached report summarizes Superior Special Services, Inc.'s activities responding to a mercury spill at Building 30 of Ansul.

If you have any questions, or if Superior can be of further assistance to you, please contact either our Immediate Response Dispatch Center at (920) 923-9000, or you may contact me directly at (906) 774-4280.

Thank you for calling on Superior Special Services, Inc. to serve your needs.

Sincerely,

A handwritten signature in black ink that reads "Ken Clark".

Ken Clark  
Response Manager

Attachment

## SCOPE OF WORK

### A. Authorization

Mr. George Rogers of Ansul notified the Superior Special Services, Inc. Immediate Response Department of the incident by phone call at 08:40 on May 23, 2000.

### B. Location

Ansul, 1 Stanton Street, Marinette, WI 54143

### C. Weather

Not applicable; the mercury was released indoors.

### D. Incident / Chemicals Involved

Mercury was spilled from a manometer inside an electrical panel in Building 30. All material was contained within the panel.

### E. Overview

The amount of mercury released from the manometer appeared to be less than one ounce of material.

### F. Response

Upon receipt of a phone call from the Superior Special Services, Inc. Immediate Response dispatch office, a crew from Norway, Michigan mobilized to Ansul in Marinette, Wisconsin. The response team arrived on site at 10:30.

George Rogers of Ansul briefed Superior on the situation. After determining that all of the mercury was contained within the panel, the material was removed with a mercury vacuum unit and the area was cleaned with a nitrate wash.

Air monitoring was done with a Jerome meter. Initially, the concentration within the panel read .79. Following cleanup, the concentration read .02. The outside and surrounding areas of the control panel had a meter reading of 0.00.

All mercury, cleanup materials and containment suits were placed in an on-site drum for pick up and disposal at the Superior facility in Port Washington, Wisconsin.

MARINETTE MARINE CORP.

Mercury Spill Location

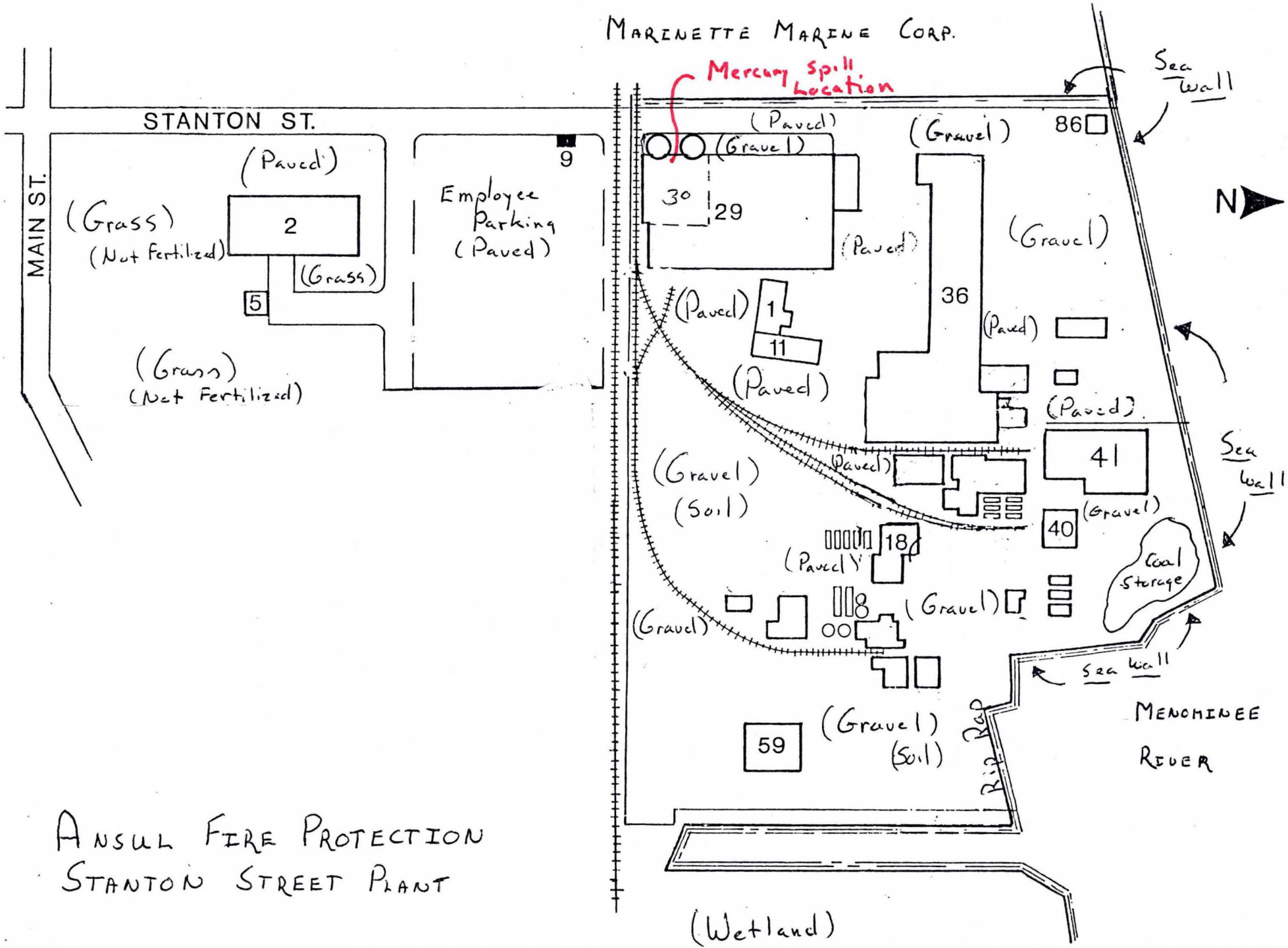

ANSUL FIRE PROTECTION  
STANTON STREET PLANT

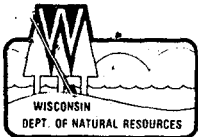

STATE OF WISCONSIN

Chapter 291, Wis. Stats.  
Form 4400-66P

Rev. 1-99

ALL COPIES MUST BE LEGIBLE,  
PLEASE TYPE

State of Wisconsin  
Department of Natural Resources  
Bureau of Waste Management  
Box 8094  
Madison, WI 53708

FOR DNR USE ONLY

Form designed for use on elite (12-pitch) typewriter.

Form Approved. OMB No. 2050-0039.

<b>UNIFORM HAZARDOUS WASTE MANIFEST</b>		1. Generator's US EPA ID No. <b>WID006125215</b>		Manifest Document No. <b>613358</b>		2. Page 1 of 2		Information in the shaded areas is not required by Federal law.			
3. Generator's Name and Mailing Address <b>Ansul Fire Protection One Stanton Street Marinette, WI 54143-2542</b>		Site Location If Different <b>One Stanton Street Marinette, WI 54143-2542</b>		A. State Manifest Document Number <b>WIK163358</b>		B. State Generator's ID					
4. Generator's Phone <b>(715) 735-7411</b>		6. US EPA ID Number <b>WID988566543</b>		C. State Transporter's ID		D. Transporter's Phone <b>1-800-688-4005</b>					
5. Transporter 1 Company Name <b>Superior Special Services</b>		8. US EPA ID Number		E. State Transporter's ID		F. Transporter's Phone					
7. Transporter 2 Company Name		10. US EPA ID Number <b>WID988566543</b>		G. State Facility's ID		H. Facility's Phone <b>(800) 000-0000 262/284-6855</b>					
9. Designated Facility Name and Site Address <b>Superior Special Services 1275 Mineral Springs Drive Port Washington, WI 53074</b>		12. Containers		13. Total Quantity		14. Unit w/vol		I. Waste No.			
11. US DOT Description (Including Proper Shipping Name, Hazard Class, and ID Number) <b>RQ Hazardous waste, solid, n.o.s.(Mercury), 9, NA3077, PGM</b>		No. Type <b>001 DF</b>		<b>000,40</b>		<b>P</b>		<b>D009</b>			
J. Additional Descriptions for Materials Listed Above <b>a Profile 39055 SH749 ERG#171 RQ 1</b> <b>b Profile RQ</b>		K. Handling Codes for Wastes Listed Above									
15. Special Handling Instructions and Additional Information <b>c Profile RQ</b> <b>d Profile RQ</b> <i>From Dry Clean Area Sp. 11</i>		Emergency Contact# <b>1-800-688-4005</b> <b>SO# 31389</b> <b>Document 0060521543</b>									
16. GENERATOR'S CERTIFICATION: I hereby declare that the contents of this consignment are fully and accurately described above by proper shipping name and are classified, packed, marked, and labeled, and are in all respects in proper condition for transport by highway according to applicable international and national governmental regulations and according to the requirements of the Wisconsin Department of Natural Resources. If I am a large quantity generator, I also certify that I have a program in place to reduce the volume and toxicity of waste generated to the degree I have determined to be economically practicable and I have selected the practicable method of treatment, storage, or disposal currently available to me which minimizes the present and future threat to human health and the environment;  OR, if I am a small quantity generator, I have made a good faith effort to minimize my waste generation and select the best waste management method that is available to me and that I can afford.											
Printed/Typed Name & Position Title <b>George R. Grys / Env. Control Manager</b>		Signature <i>George R. Grys</i>		Date Month Day Year <b>9/6/96 20/96</b>							
17. TRANSPORTER 1 Acknowledgement of Receipt of Materials		Printed/Typed Name & Position Title <b>JOE BRUNNBAUER / DRIVER</b>		Signature <i>Joe Brunnbauer</i>		Date Month Day Year <b>96093009</b>					
18. TRANSPORTER 2 Acknowledgement of Receipt of Materials		Printed/Typed Name & Position Title		Signature		Date Month Day Year					
19. Discrepancy Indication Space											
20. FACILITY OWNER OR OPERATOR: Certification of receipt of hazardous materials covered by this manifest except as noted in Item 19.											
Printed/Typed Name & Position Title		Signature		Date Month Day Year							

EPA Form 8700-22 (Rev. 9-88) Previous editions are obsolete.

Copy Distribution: 1 - Generator send to Wis. DNR  
2 - Generator retain  
3 - Facility send to Wis. DNR

4 - Facility retain  
5 - Facility send to Generator  
6 - Transporter retain

Emergency 24 Hour Assistance  
and Spill Reporting

Telephone Number: (800) 943-0003

Copies 1 & 3 mail to Wis. DNR at above address.

COPY 2-