

**From:** warren hohn <warrenhohn4919@gmail.com>  
**Sent:** Saturday, September 5, 2020 4:19 AM  
**To:** Beggs, Tauren R - DNR; adelforge@reiengineering.com  
**Subject:** SUMMARY OF DISSOLVED ARSENIC WATER TESTING AFTER EPA CLEANUP  
**Attachments:** TOWN OF ANIWA (2020-2016 ) POST EPA CLEANUP) ARSENIC WATER RESULTS).pdf

HAVE TOWN MEETING ON SEPT. 14, 2020 TO DISCUSS RESULTS. WARREN HOHN



warren hohn &lt;warrenhohn4919@gmail.com&gt;

---

## Notice to Proceed with Comments for Town of Aniwa 2020 Monitoring Plan

3 messages

---

**Beggs, Tauren R - DNR** <Tauren.Beggs@wisconsin.gov>  
To: warren hohn <warrenhohn4919@gmail.com>  
Cc: "Tammy@reschinsurance.com" <Tammy@reschinsurance.com>

Wed, Apr 22, 2020 at 1:49 PM

Hi Warren,

As discussed on our call today, below are the revisions needed for the work plan that you plan to implement. It is my understanding you will be working with REI to provide the data and they will be generating the figures and data tables.

- The soil samples should be collected from the same shallow interval as previous samples (0-2' depth).
- Eliminate sample location B-17, the other four samples should be sufficient to characterize that area.
- Collect a second set of step-out samples (total of five samples) from the four areas and have them held at the lab (one west of B-13/B-14 area, two west/southwest of B-15 - B-19 area, one southeast of B-20 – B-22 area, and one east of B-23 – B-24 area. If the first set of samples come back with exceedances for arsenic above the 8mg/kg background threshold value (BTV), then have the lab run the second set. This is to prevent additional mobilizations to the site if exceedances are still found in the first set of samples.
- Existing monitoring wells and the TIMM private well should only be sampled one round this year, which you indicated will likely happen in June 2020.
- REI will generate a map with delineation of soil above arsenic BTV and summary tables for the soil sample results compared to soil standards and BTV (results should include a summary of all the soil results completed post-EPA removal action).
- REI will generate a GW flow map, a groundwater map of arsenic delineated above the enforcement standard (ES) and preventive action limit (PAL) and summary tables of the groundwater results compared to groundwater standards (results should include a summary of all the results completed by you post-EPA removal action). Data tables should also include the other contaminants sampled for post-EPA removal action.

Based on the additional soil sample data, it can then be determined what additional areas need to be capped with clean soil.

Regards,

**We are committed to service excellence.**

Visit our survey at <http://dnr.wi.gov/customersurvey> to evaluate how I did.

2020 Arsenic (Town of Aniwa Arsenic Dump)  
Water Results  
5/15/20

Well #	Dpth to Water	Top of Well (ft)	GWH T (ft)	As (ug/L)
B-12	10.24'	97.64'	87.24'	610.0
B-13R	11.24'	99.28'	88.04'	1900.00
B-13 Dupl	11.24'	99.28'	88.04'	1900.00
B-21	6.50'	93.67'	87.17'	2.80

6/11/20

Well #	Dpth to Water (ft)	Top of Well (ft)	GWH T (ft)	As ug/L
B-10	6.40'	98.64'	90.24'	ND
B-11	10.56'	99.77'	89.21'	ND
B-12	9.32'	97.64'	88.32'	560.0
B-13R	10.48'	99.28'	88.80'	1100.0*
B-13 Dupl	10.48'	99.28'	88.80'	1200.0*
B-19	10.87'	98.12'	87.25'	ND
B-20	9.16'	97.70'	88.54'	ND
B-21	6.00'	93.67'	87.67'	5.20
Timm Well				3.4

ND = LOD - Limit of Detection = 2.6 ug/L

\* Lower than expected / GWH T levels -  
retested on 7-6-20 (possibly a dilution problem)

Well #	Dpth to Water (ft)	Top of Well (ft)	GWH T (ft)	As (ug/L)
B-13R	10.42'	99.28'	88.86'	4900.0
B-13 Dupl	10.42'	99.28'	88.86'	4600.0

\* Appear more what was expected

Wanda A. Nohr (Sampled by)

Date: 6-11-20 (Readings)

<u>Well #</u>	<u>Temp °C</u>	<u>pH</u>	<u>Spec. Cond.</u> <u>mS/cm</u>	<u>Gallons</u> <u>Pumped</u>
B-10	12.9	5.18	0.73	4.0
B-11	11.7	6.97	0.61	2.0
B-12	11.6	7.10	0.54	4.0
B-13R	12.1	7.07	0.77	4.0
B-19R	12.3	7.04	0.78	3.0
B-20	11.9	6.99	0.59	3.0
B-21	11.6	6.89	0.51	3.0

Date: 5-15-20 (Readings)

B-12	12.7	7.09	0.68	4.0
B-13R	12.1	7.11	0.72	4.0
B-21	13.4	6.87	0.55	3.0

Date: 7-6-20 (Readings)

B-13R	13.4	7.17	0.76	4.0
-------	------	------	------	-----

Done by Warren A. Hohn

# Town of Aniwa Wells (2019)

## Aniwa Arsenic Sampling & Lead

<u>D-TE</u>	<u>Well #</u>	<u>ug/L As/ Top of Well (Ft.)</u> <u>ug/L Pb</u>	<u>Dpth to Water</u>	<u>Gw Ht</u>
6-10-19	B-10	1.1 / <0.24	96.64'	7.26' / 89.38'
6-10-19	B-11	0.28 / 1.40	99.77'	11.66' / 88.11'
6-10-19	B-12	230.0 / 1.20	97.64'	11.05' / 86.59'
6-10-19	B-13R	4970.0 / 0.27	99.28'	12.25' / 87.03'
6-10-19	B-19R	4850.0 / <0.24	99.44'	12.51' / 86.93'
6-10-19	B-20	2.0 / 0.31	97.70'	10.25' / 87.45'
6-10-19	B-21	1.3 / <0.24	93.67'	7.74' / 86.17'
6-10-19	TimmWell	41.4 / 11.70	3.4 / 1.30	
7-08-19	B-12	460.0	97.64	11.30 / 86.34'
7-08-19	B-13R	4230.0	99.28	12.51 / 86.77'
7-08-19	B-21	5.0	93.67	7.74 / 85.93'

<u>Well #</u>	<u>6-10-19 Temp °C</u>	<u>Readings pH</u>	<u>Spec. Cond. mS/CM</u>	<u>Gallons Pumped</u>
B-10	13.7	5.20	0.84	4
B-11	11.8	6.94	0.54	2
B-12	11.5	7.25	0.49	4
B-13R	12.0	7.19	0.72	4
B-19R	12.1	6.81	0.89	3
B-20	11.8	6.85	0.48	3
B-21	14.6	6.60	0.46	3

	<u>7-08-19</u>	<u>Readings</u>		
B-12	13.8	7.19	0.52	4
B-13R	12.1	7.14	0.70	4
B-21	14.4	6.71	0.49	3

Wanen A. Hahn 7-8-19

Client: Township of Aniwa  
 Attn: Warren Hohn  
 1201 Lake St  
 Merrill, WI 54452

NLS Project: 347298

NLS Customer: 104168

Fax: 715 536 1277 Phone: 715 551 9080

Project: Aniwa Arsenic DWP

**B-12 NLS ID: 1196111**

LOC: 243344:1 Matrix: GW

Collected: 05/15/20 11:09 Received: 06/30/20

Parameter	Result	Units	Dilution	LOD	LOQ	Analyzed	Method	Lab
Arsenic, dis. as As by ICP-MS	6.70	ug/L	1	2.6	8.6	07/05/20	EPA 200.8, Rev 5.4	721026460
Metals digestion - dissolved ICP-MS	yes					07/04/20	EPA 200.8, Rev 5.4	721026460

**B-13r NLS ID: 1196112**

LOC: 243344:2 Matrix: GW

Collected: 05/15/20 11:45 Received: 06/30/20

Parameter	Result	Units	Dilution	LOD	LOQ	Analyzed	Method	Lab
Arsenic, dis. as As by ICP-MS	1900	ug/L	1	2.6	8.6	07/05/20	EPA 200.8, Rev 5.4	721026460
Metals digestion - dissolved ICP-MS	yes					07/04/20	EPA 200.8, Rev 5.4	721026460

**B-13r dupl NLS ID: 1196113**

LOC: 243344:3 Matrix: GW

Collected: 05/15/20 11:50 Received: 06/30/20

Parameter	Result	Units	Dilution	LOD	LOQ	Analyzed	Method	Lab
Arsenic, dis. as As by ICP-MS	1900	ug/L	1	2.6	8.6	07/05/20	EPA 200.8, Rev 5.4	721026460
Metals digestion - dissolved ICP-MS	yes					07/04/20	EPA 200.8, Rev 5.4	721026460

**B-21 NLS ID: 1196114**

LOC: 243344:4 Matrix: GW

Collected: 05/15/20 11:00 Received: 06/30/20

Parameter	Result	Units	Dilution	LOD	LOQ	Analyzed	Method	Lab
Arsenic, dis. as As by ICP-MS	[2.8]	ug/L	1	2.6	8.6	07/05/20	EPA 200.8, Rev 5.4	721026460
Metals digestion - dissolved ICP-MS	yes					07/04/20	EPA 200.8, Rev 5.4	721026460

**Timm Well NLS ID: 1196115**

LOC: 243344:5 Matrix: GW

Collected: 05/15/20 10:45 Received: 06/30/20

Parameter	Result	Units	Dilution	LOD	LOQ	Analyzed	Method	Lab
Arsenic, dis. as As by ICP-MS	[3.4]	ug/L	1	2.6	8.6	07/05/20	EPA 200.8, Rev 5.4	721026460
Metals digestion - dissolved ICP-MS	yes					07/04/20	EPA 200.8, Rev 5.4	721026460

**B-10 NLS ID: 1196116**

LOC: 243344:6 Matrix: GW

Collected: 06/11/20 14:15 Received: 06/30/20

Parameter	Result	Units	Dilution	LOD	LOQ	Analyzed	Method	Lab
Arsenic, dis. as As by ICP-MS	ND	ug/L	1	2.6	8.6	07/05/20	EPA 200.8, Rev 5.4	721026460
Metals digestion - dissolved ICP-MS	yes					07/04/20	EPA 200.8, Rev 5.4	721026460

**B-11 NLS ID: 1196117**

LOC: 243344:7 Matrix: GW

Collected: 06/11/20 14:30 Received: 06/30/20

Parameter	Result	Units	Dilution	LOD	LOQ	Analyzed	Method	Lab
Arsenic, dis. as As by ICP-MS	ND	ug/L	1	2.6	8.6	07/05/20	EPA 200.8, Rev 5.4	721026460
Metals digestion - dissolved ICP-MS	yes					07/04/20	EPA 200.8, Rev 5.4	721026460

# ANALYTICAL REPORT

WDNR Laboratory ID No. 721026460  
 WDATCP Laboratory Certification No. 105-330  
 EPA Laboratory ID No. WI00034

Printed: 07/09/20 Page 2 of 3

NLS Project: 347298

NLS Customer: 104168

Fax: 715 536 1277 Phone: 715 551 9080

NORTHERN LAKE SERVICE, INC.  
 Analytical Laboratory and Environmental Services  
 400 North Lake Avenue - Crandon, WI 54520  
 Ph: (715)-478-2777 Fax: (715)-478-3060

Client: Township of Aniwa  
 Attn: Warren Hohn  
 1201 Lake St  
 Merrill, WI 54452

Project: Aniwa Arsenic DWP

<b>B-12 NLS ID: 1196118</b>								
COC: 243344:8 Matrix: GW								
Collected: 06/11/20 15:45 Received: 06/30/20								
Parameter	Result	Units	Dilution	LOD	LOQ	Analyzed	Method	Lab
Arsenic, dis. as As by ICP-MS	560	ug/L	1	2.6	8.6	07/05/20	EPA 200.8, Rev 5.4	721026460
Metals digestion - dissolved ICP-MS	yes					07/04/20	EPA 200.8, Rev 5.4	721026460
<b>B-13R NLS ID: 1196119</b>								
COC: 243344:9 Matrix: GW								
Collected: 06/11/20 17:05 Received: 06/30/20								
Parameter	Result	Units	Dilution	LOD	LOQ	Analyzed	Method	Lab
Arsenic, dis. as As by ICP-MS	1100	ug/L	1	2.6	8.6	07/05/20	EPA 200.8, Rev 5.4	721026460
Metals digestion - dissolved ICP-MS	yes					07/04/20	EPA 200.8, Rev 5.4	721026460
<b>B-13 dupl NLS ID: 1196120</b>								
COC: 243344:10 Matrix: GW								
Collected: 06/11/20 17:20 Received: 06/30/20								
Parameter	Result	Units	Dilution	LOD	LOQ	Analyzed	Method	Lab
Arsenic, dis. as As by ICP-MS	1200	ug/L	1	2.6	8.6	07/05/20	EPA 200.8, Rev 5.4	721026460
Metals digestion - dissolved ICP-MS	yes					07/04/20	EPA 200.8, Rev 5.4	721026460
<b>B-19 NLS ID: 1196121</b>								
COC: 243345:1 Matrix: GW								
Collected: 06/11/20 15:05 Received: 06/30/20								
Parameter	Result	Units	Dilution	LOD	LOQ	Analyzed	Method	Lab
Arsenic, dis. as As by ICP-MS	ND	ug/L	1	2.6	8.6	07/05/20	EPA 200.8, Rev 5.4	721026460
Metals digestion - dissolved ICP-MS	yes					07/04/20	EPA 200.8, Rev 5.4	721026460
<b>B-20 NLS ID: 1196122</b>								
COC: 243345:2 Matrix: GW								
Collected: 06/11/20 15:20 Received: 06/30/20								
Parameter	Result	Units	Dilution	LOD	LOQ	Analyzed	Method	Lab
Arsenic, dis. as As by ICP-MS	ND	ug/L	1	2.6	8.6	07/05/20	EPA 200.8, Rev 5.4	721026460
Metals digestion - dissolved ICP-MS	yes					07/04/20	EPA 200.8, Rev 5.4	721026460
<b>B-21 NLS ID: 1196123</b>								
COC: 243345:3 Matrix: GW								
Collected: 06/11/20 16:00 Received: 06/30/20								
Parameter	Result	Units	Dilution	LOD	LOQ	Analyzed	Method	Lab
Arsenic, dis. as As by ICP-MS	[5.2]	ug/L	1	2.6	8.6	07/05/20	EPA 200.8, Rev 5.4	721026460
Metals digestion - dissolved ICP-MS	yes					07/04/20	EPA 200.8, Rev 5.4	721026460
<b>Blank NLS ID: 1196124</b>								
COC: 243345:4 Matrix: GW								
Collected: 06/11/20 18:00 Received: 06/30/20								
Parameter	Result	Units	Dilution	LOD	LOQ	Analyzed	Method	Lab
Arsenic, dis. as As by ICP-MS	ND	ug/L	1	2.6	8.6	07/05/20	EPA 200.8, Rev 5.4	721026460
Metals digestion - dissolved ICP-MS	yes					07/04/20	EPA 200.8, Rev 5.4	721026460

# ANALYTICAL REPORT

WDNR Laboratory ID No. 721026460  
WDATCP Laboratory Certification No. 105-330  
EPA Laboratory ID No. WI00034

Printed: 08/12/20 Page 1 of 1

NLS Project: 349121

NLS Customer: 104168

Fax: 715 536 1277 Phone: 715 551 9080

NORTHERN LAKE SERVICE, INC.  
Analytical Laboratory and Environmental Services  
400 North Lake Avenue - Crandon, WI 54520  
Ph: (715)-478-2777 Fax: (715)-478-3060

Client: Township of Aniwa  
Attn: Warren Hohn  
1201 Lake St  
Merrill, WI 54452

Project: Arsenic Dump

## B-13R NLS ID: 1201796

COC: 242634:1 Matrix: GW

Collected: 07/06/20 10:10 Received: 07/24/20

### Parameter

Arsenic, dis. as As by ICP-MS

Metals digestion - dissolved ICP-MS

Result	Units	Dilution	LOD	LOQ	Analyzed	Method	Lab
4900	ug/L	1	2.6	8.6	08/11/20	EPA 200.8, Rev 5.4	721026460
yes					08/08/20	EPA 200.8, Rev 5.4	721026460

## B-13R Dup 1 NLS ID: 1201797

COC: 242634:2 Matrix: GW

Collected: 07/06/20 10:30 Received: 07/24/20

### Parameter

Arsenic, dis. as As by ICP-MS

Metals digestion - dissolved ICP-MS

Result	Units	Dilution	LOD	LOQ	Analyzed	Method	Lab
4600	ug/L	1	2.6	8.6	08/11/20	EPA 200.8, Rev 5.4	721026460
yes					08/08/20	EPA 200.8, Rev 5.4	721026460

Values in brackets represent results greater than or equal to the LOD but less than the LOQ and are within a region of "Less-Certain Quantitation". Results greater than or equal to the LOQ are considered to be in the region of "Certain Quantitation". LOD and/or LOQ tagged with an asterisk(\*) are considered Reporting Limits. All LOD/LOQs adjusted to reflect dilution and/or solids content.

ND = Not Detected (< LOD)

LOD = Limit of Detection

LOQ = Limit of Quantitation

NA = Not Applicable

DWB = Dry Weight Basis

%DWB = (mg/kg DWB) / 10000

1000 ug/l = 1 mg/L

MCL = Maximum Contaminant Levels for Drinking Water Samples

Shaded results indicate >MCL.

Reviewed by:

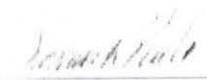

Authorized by:  
R. T. Krueger  
President



NORTHERN LAKE SERVICE, INC.  
Analytical Laboratory and Environmental Services  
400 North Lake Avenue - Crandon, WI 54520  
Ph: (715)-478-2777 Fax: (715)-478-3060

# ANALYTICAL REPORT

WDNR Laboratory ID No. 721026460  
WDATEP Laboratory Certification No. 105-330  
EPA Laboratory ID No. WI00034

Printed: 07/09/20 Page 3 of 3

NLS Project: 347298

NLS Customer: 104168

Fax: 715 536 1277 Phone 715 551 9080

Client: Township of Aniwa  
Attn: Warren Hohn  
1201 Lake St  
Merrill, WI 54452

Project: Aniwa Arsenic DWP

Values in brackets represent results greater than or equal to the LOD but less than the LOQ and are within a region of "Less-Certain Quantitation". Results greater than or equal to the LOQ are considered to be in the region of "Certain Quantitation". LOD and/or LOQ tagged with an asterisk(\*) are considered Reporting Limits. All LOD/LOQs adjusted to reflect dilution and/or solids content.

ND = Not Detected (< LOD)    LOD = Limit of Detection    LOQ = Limit of Quantitation    NA = Not Applicable  
DWB = Dry Weight Basis    %DWB = (mg/kg DWB) / 10000    1000 ug/L = 1 mg/L  
MCL = Maximum Contaminant Levels for Drinking Water Samples. Shaded results indicate >MCL

Reviewed by:

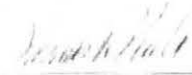

Authorized by:  
R. T. Krueger  
President

Town of Aniwa Monitoring Wells Pg 1  
 Dissolved Arsenic Results (ug/L)

Date	Well #	ug/L AS	Top of Well Ft. / Depth to Water	Depth
6-10-19	B-12	230.0	99.64' /	11.05'
6-10-19	B-13R / B-13R Dupl	4970.0 / 4850.0	99.28' /	12.25'
6-10-19	B-21	41.4	93.67' /	7.50'
7-18-19	B-12	460.0	99.64' /	11.30'
7-18-19	B-13R	4230.0	99.28' /	12.25'
7-18-19	B-21	5.0	93.67' /	7.74'
3-13-18	B-12	310.0	99.64' /	12.16'
3-13-18	B-13R	1000.0	99.28' /	14.32'
3-13-18	B-21	7.1	93.67' /	9.50'
4-14-18	B-12	220.0	99.64' /	10.16'
4-14-18	B-13R	3200.0	99.28' /	11.40'
4-14-18	B-21	7.8'	93.67' /	6.56'
6-16-18	B-12	No Sample		
6-16-18	B-13R	5300.0	99.28' /	12.24'
6-10-18	B-21	11.0	93.67' /	7.64'
7-22-18	B-12	446.0	99.64' /	11.10'
7-22-18	B-13R	4460.0	99.28' /	12.30'
7-22-18	B-21	11.9	93.67' /	7.60'
8-31-18	B-12	510.0	99.64' /	12.54'
8-31-18	B-13R	3300.0	99.28' /	13.29'
8-31-18	B-21	13.0	93.67' /	9.16'
6-10-19	Timm Well	3.4 ug/L		
6-10-18	Timm Well	6.1 ug/L		

Town of Aniwaq Monitoring Wells  
Dissolved Arsenic Results (ug/L As)

<u>DATE</u>	<u>Well #</u>	<u>ug/L As</u>	<u>Top of Well Ft /</u>	<u>Depth to Water</u>	<u>GW HT</u>
4-8-17	B-13R	6300.0	99.28'	11.18'	88.10'
4-8-17	B-21	22.0	93.67'	6.54'	87.13'
4-22-17	B-12	150.0	97.64'	8.64'	89.00'
4-22-17	B-13R	8800.0	99.28'	9.80'	89.48'
4-22-17	B-21	8.5	93.67'	5.45'	88.22'
4-29-17	B-12	210.0	97.64'	8.88'	88.76'
4-29-17	B-13R	8200.0	99.28'	10.06'	89.22'
4-29-17	B-21	3.1	93.67'	5.56'	88.11'
4-29-17	Tinn Well Outside 3.50 ug/L Faucet				
5-30-17	B-12	120.0	97.64'	9.40'	88.24'
5-30-17	B-13R/DupL	8400.0/8300.0	99.28'	18.44'	88.84'
5-36-17	B-21	3.9	93.67'	6.08'	87.59'
5-36-17	Tinn Well (Hse) 1.5 ug/L				
6-24-17	B-13R	7700.0	99.28'	11.16'	88.12'
6-24-17	B-21	4.0	93.67'	6.90'	87.77'
8-28-17	B-12	530.0	97.64'	11.64'	86.00'
8-28-17	B-13R	4000.0	99.28'	13.01'	86.27'
8-28-17	B-21	5.3	93.67'	8.16'	85.51'
10-17-17	B-12	210.0	97.64'	12.40'	85.24'
10-17-17	B-13R	3200.0	99.28'	13.60'	85.68'
10-17-17	B-21	7.7	93.67'	8.80'	84.87'
10-28-17	B-12	410.0	97.64'	12.56'	85.08'
10-28-17	B-13R	2400.0	99.28'	13.78'	85.50'
10-28-17	B-21	7.6	93.67'	8.99'	84.68'

Town of Anisua Monitoring Wells  
 Dissolved Arsenic Results (ug/L As)

<u>Date</u>	<u>Well #</u>	<u>ug/L As</u>	<u>Top of Well (ft.)</u>	<u>Dpth to Water</u>	<u>GWT</u>
7-14-16	B-12	490.0	97.64'	10.80'	86.84'
7-14-16	B-13 R	5400.0	99.28'	12.01'	87.27'
	B-13 R	Dup L (5400.0)			
7-14-16	B-21		93.67'	7.32'	86.35'
7-14-16	Tinn Well (Faucet)		1.4 ug/L AS		
	Tinn Well (Ext. hose R. b)		1.5 ug/L AS		
10-10-16	B-12	560.0	97.64'	12.08'	85.56'
10-10-16	B-13R	2900.0	99.28'	13.35'	85.93'
10-10-16	B-21	No Sample			
10-29-16	B-12	1000.0	97.64'	12.61'	85.03'
10-29-16	B-13 R	2700.0	99.28'	13.98'	85.30'
10-29-16	B-21	1.4	93.67'	9.00'	84.67'

**From:** warren hohn <warrenhohn4919@gmail.com>  
**Sent:** Friday, September 4, 2020 6:58 AM  
**To:** adelforge@reiengineering.com; Beggs, Tauren R - DNR  
**Subject:** 2020 ANIWA ARSENIC SOIL BORING RESULTS.  
**Attachments:** 2020 ANIWA SOIL BORINGS FINAL.pdf

WARREN HOHN

# Plot Plan For Township of Aniwa Soil Sampling Results (2020)



Page 3

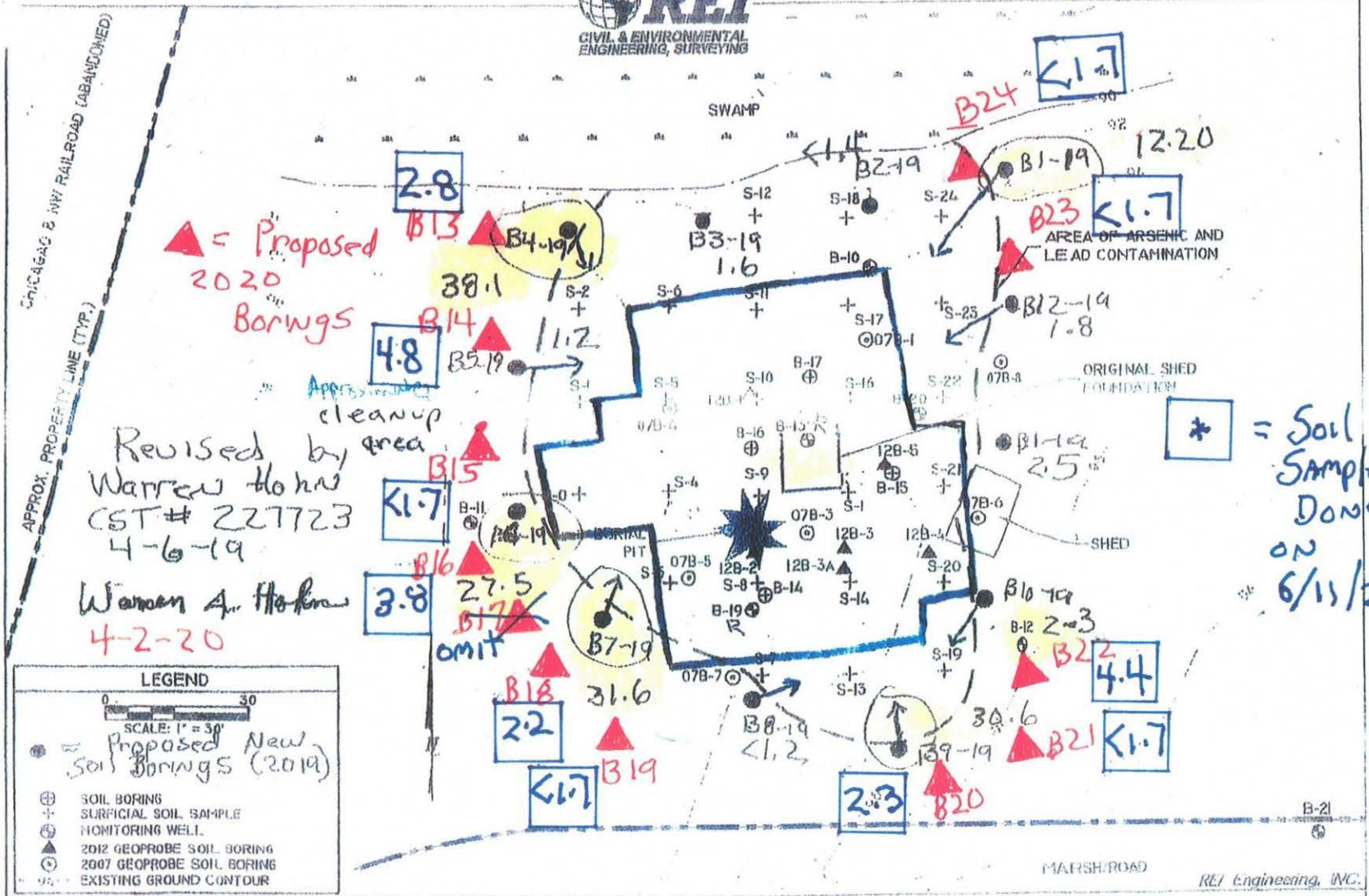

### SAMPLE SUMMARY

Project: ARSENIC DUMP  
Pace Project No.: 40212233

Lab ID	Sample ID	Matrix	Date Collected	Date Received
40212233001	B-13 10:00 AM	Solid	06/11/20 10:00	08/04/20 09:50
40212233002	B-14 10:15 AM	Solid	06/11/20 10:15	08/04/20 09:50
40212233003	B-15 10:35 AM	Solid	06/11/20 10:35	08/04/20 09:50
40212233004	B-16 11:00 AM	Solid	06/11/20 11:00	08/04/20 09:50
40212233005	B-18 11:20 AM	Solid	06/11/20 11:20	08/04/20 09:50
40212233006	B-19 11:36 AM	Solid	06/11/20 11:36	08/04/20 09:50
40212233007	B-20 12:05 PM	Solid	06/11/20 12:05	08/04/20 09:50
40212233008	B-21 1:00 PM	Solid	06/11/20 13:00	08/04/20 09:50
40212233009	B-22 1:30 PM	Solid	06/11/20 13:30	08/04/20 09:50
40212233010	B-23 2:05 PM	Solid	06/11/20 14:05	08/04/20 09:50
40212233011	B-24 2:15 PM	Solid	06/11/20 14:15	08/04/20 09:50

### REPORT OF LABORATORY ANALYSIS

This report shall not be reproduced, except in full,  
without the written consent of Pace Analytical Services, LLC.

### ANALYTICAL RESULTS

Project: ARSENIC DUMP  
Pace Project No.: 40212233

**Sample: B-13 10:00 AM**      **Lab ID: 40212233001**      Collected: 06/11/20 10:00      Received: 08/04/20 09:50      Matrix: Solid

*Results reported on a "dry weight" basis and are adjusted for percent moisture, sample size and any dilutions.*

Parameters	Results	Units	LOQ	LOD	DF	Prepared	Analyzed	CAS No.	Qual
<b>6010 MET ICP</b>	Analytical Method: EPA 6010 Preparation Method: EPA 3050 Pace Analytical Services - Green Bay								
Arsenic	<b>2.6J</b>	mg/kg	5.8	1.7	1	08/11/20 06:34	08/11/20 17:43	7440-38-2	
<b>Percent Moisture</b>	Analytical Method: ASTM D2974-87 Pace Analytical Services - Green Bay								
Percent Moisture	<b>19.5</b>	%	0.10	0.10	1		08/14/20 16:17		

**Sample: B-14 10:15 AM**      **Lab ID: 40212233002**      Collected: 06/11/20 10:15      Received: 08/04/20 09:50      Matrix: Solid

*Results reported on a "dry weight" basis and are adjusted for percent moisture, sample size and any dilutions.*

Parameters	Results	Units	LOQ	LOD	DF	Prepared	Analyzed	CAS No.	Qual
<b>6010 MET ICP</b>	Analytical Method: EPA 6010 Preparation Method: EPA 3050 Pace Analytical Services - Green Bay								
Arsenic	<b>4.9J</b>	mg/kg	5.9	1.8	1	08/11/20 06:34	08/11/20 17:45	7440-38-2	
<b>Percent Moisture</b>	Analytical Method: ASTM D2974-87 Pace Analytical Services - Green Bay								
Percent Moisture	<b>20.1</b>	%	0.10	0.10	1		08/14/20 16:17		

**Sample: B-15 10:35 AM**      **Lab ID: 40212233003**      Collected: 06/11/20 10:35      Received: 08/04/20 09:50      Matrix: Solid

*Results reported on a "dry weight" basis and are adjusted for percent moisture, sample size and any dilutions.*

Parameters	Results	Units	LOQ	LOD	DF	Prepared	Analyzed	CAS No.	Qual
<b>6010 MET ICP</b>	Analytical Method: EPA 6010 Preparation Method: EPA 3050 Pace Analytical Services - Green Bay								
Arsenic	<b>&lt;1.7</b>	mg/kg	5.6	1.7	1	08/11/20 06:34	08/11/20 17:48	7440-38-2	
<b>Percent Moisture</b>	Analytical Method: ASTM D2974-87 Pace Analytical Services - Green Bay								
Percent Moisture	<b>18.8</b>	%	0.10	0.10	1		08/14/20 16:17		

### REPORT OF LABORATORY ANALYSIS

This report shall not be reproduced, except in full,  
without the written consent of Pace Analytical Services, LLC.



### ANALYTICAL RESULTS

Project: ARSENIC DUMP  
Pace Project No.: 40212233

Sample: B-16 11:00 AM Lab ID: 40212233004 Collected: 06/11/20 11:00 Received: 08/04/20 09:50 Matrix: Solid

Results reported on a "dry weight" basis and are adjusted for percent moisture, sample size and any dilutions.

Parameters	Results	Units	LOQ	LOD	DF	Prepared	Analyzed	CAS No.	Qual
<b>6010 MET ICP</b>	Analytical Method: EPA 6010 Preparation Method: EPA 3050 Pace Analytical Services - Green Bay								
Arsenic	3.8J	mg/kg	5.6	1.7	1	08/11/20 06:34	08/11/20 17:50	7440-38-2	
<b>Percent Moisture</b>	Analytical Method: ASTM D2974-87 Pace Analytical Services - Green Bay								
Percent Moisture	16.4	%	0.10	0.10	1		08/14/20 16:17		

Sample: B-18 11:20 AM Lab ID: 40212233005 Collected: 06/11/20 11:20 Received: 08/04/20 09:50 Matrix: Solid

Results reported on a "dry weight" basis and are adjusted for percent moisture, sample size and any dilutions.

Parameters	Results	Units	LOQ	LOD	DF	Prepared	Analyzed	CAS No.	Qual
<b>6010 MET ICP</b>	Analytical Method: EPA 6010 Preparation Method: EPA 3050 Pace Analytical Services - Green Bay								
Arsenic	2.2J	mg/kg	5.8	1.7	1	08/11/20 06:34	08/11/20 17:53	7440-38-2	
<b>Percent Moisture</b>	Analytical Method: ASTM D2974-87 Pace Analytical Services - Green Bay								
Percent Moisture	17.4	%	0.10	0.10	1		08/14/20 16:17		

Sample: B-19 11:36 AM Lab ID: 40212233006 Collected: 06/11/20 11:36 Received: 08/04/20 09:50 Matrix: Solid

Results reported on a "dry weight" basis and are adjusted for percent moisture, sample size and any dilutions.

Parameters	Results	Units	LOQ	LOD	DF	Prepared	Analyzed	CAS No.	Qual
<b>6010 MET ICP</b>	Analytical Method: EPA 6010 Preparation Method: EPA 3050 Pace Analytical Services - Green Bay								
Arsenic	<1.7	mg/kg	5.8	1.7	1	08/11/20 06:34	08/11/20 17:55	7440-38-2	
<b>Percent Moisture</b>	Analytical Method: ASTM D2974-87 Pace Analytical Services - Green Bay								
Percent Moisture	16.8	%	0.10	0.10	1		08/14/20 16:17		

### REPORT OF LABORATORY ANALYSIS

This report shall not be reproduced, except in full,  
without the written consent of Pace Analytical Services, LLC.

### ANALYTICAL RESULTS

Project: ARSENIC DUMP  
Pace Project No.: 40212233

**Sample: B-20 12:05 PM**      **Lab ID: 40212233007**      Collected: 06/11/20 12:05      Received: 08/04/20 09:50      Matrix: Solid

*Results reported on a "dry weight" basis and are adjusted for percent moisture, sample size and any dilutions.*

Parameters	Results	Units	LOQ	LOD	DF	Prepared	Analyzed	CAS No.	Qual
<b>6010 MET ICP</b>	Analytical Method: EPA 6010    Preparation Method: EPA 3050 Pace Analytical Services - Green Bay								
Arsenic	<b>2.3J</b>	mg/kg	6.4	1.9	1	08/11/20 06:34	08/11/20 17:57	7440-38-2	
<b>Percent Moisture</b>	Analytical Method: ASTM D2974-87 Pace Analytical Services - Green Bay								
Percent Moisture	<b>28.8</b>	%	0.10	0.10	1		08/14/20 16:17		

**Sample: B-21 1:00 PM**      **Lab ID: 40212233008**      Collected: 06/11/20 13:00      Received: 08/04/20 09:50      Matrix: Solid

*Results reported on a "dry weight" basis and are adjusted for percent moisture, sample size and any dilutions.*

Parameters	Results	Units	LOQ	LOD	DF	Prepared	Analyzed	CAS No.	Qual
<b>6010 MET ICP</b>	Analytical Method: EPA 6010    Preparation Method: EPA 3050 Pace Analytical Services - Green Bay								
Arsenic	<b>&lt;1.7</b>	mg/kg	5.7	1.7	1	08/11/20 06:34	08/11/20 18:00	7440-38-2	
<b>Percent Moisture</b>	Analytical Method: ASTM D2974-87 Pace Analytical Services - Green Bay								
Percent Moisture	<b>17.7</b>	%	0.10	0.10	1		08/14/20 16:17		

**Sample: B-22 1:30 PM**      **Lab ID: 40212233009**      Collected: 06/11/20 13:30      Received: 08/04/20 09:50      Matrix: Solid

*Results reported on a "dry weight" basis and are adjusted for percent moisture, sample size and any dilutions.*

Parameters	Results	Units	LOQ	LOD	DF	Prepared	Analyzed	CAS No.	Qual
<b>6010 MET ICP</b>	Analytical Method: EPA 6010    Preparation Method: EPA 3050 Pace Analytical Services - Green Bay								
Arsenic	<b>4.4J</b>	mg/kg	5.7	1.7	1	08/11/20 06:34	08/11/20 18:02	7440-38-2	
<b>Percent Moisture</b>	Analytical Method: ASTM D2974-87 Pace Analytical Services - Green Bay								
Percent Moisture	<b>20.2</b>	%	0.10	0.10	1		08/14/20 16:17		

### REPORT OF LABORATORY ANALYSIS

This report shall not be reproduced, except in full,  
without the written consent of Pace Analytical Services, LLC.

### ANALYTICAL RESULTS

Project: ARSENIC DUMP  
Pace Project No.: 40212233

**Sample: B-23 2:05 PM**      **Lab ID: 40212233010**      Collected: 06/11/20 14:05      Received: 08/04/20 09:50      Matrix: Solid

*Results reported on a "dry weight" basis and are adjusted for percent moisture, sample size and any dilutions.*

Parameters	Results	Units	LOQ	LOD	DF	Prepared	Analyzed	CAS No.	Qual
<b>6010 MET ICP</b>	Analytical Method: EPA 6010 Preparation Method: EPA 3050 Pace Analytical Services - Green Bay								
Arsenic	<1.7	mg/kg	5.8	1.7	1	08/11/20 06:34	08/11/20 18:05	7440-38-2	
<b>Percent Moisture</b>	Analytical Method: ASTM D2974-87 Pace Analytical Services - Green Bay								
Percent Moisture	<b>20.8</b>	%	0.10	0.10	1		08/14/20 16:17		

**Sample: B-24 2:15 PM**      **Lab ID: 40212233011**      Collected: 06/11/20 14:15      Received: 08/04/20 09:50      Matrix: Solid

*Results reported on a "dry weight" basis and are adjusted for percent moisture, sample size and any dilutions.*

Parameters	Results	Units	LOQ	LOD	DF	Prepared	Analyzed	CAS No.	Qual
<b>6010 MET ICP</b>	Analytical Method: EPA 6010 Preparation Method: EPA 3050 Pace Analytical Services - Green Bay								
Arsenic	<1.7	mg/kg	5.5	1.7	1	08/11/20 06:34	08/11/20 18:12	7440-38-2	
<b>Percent Moisture</b>	Analytical Method: ASTM D2974-87 Pace Analytical Services - Green Bay								
Percent Moisture	<b>19.0</b>	%	0.10	0.10	1		08/14/20 16:17		

### REPORT OF LABORATORY ANALYSIS

This report shall not be reproduced, except in full,  
without the written consent of Pace Analytical Services, LLC.

**From:** warren hohn <warrenhohn4919@gmail.com>  
**Sent:** Thursday, September 3, 2020 4:45 PM  
**To:** Beggs, Tauren R - DNR  
**Subject:** TOWN OF ANIWA WATER ARSEN RESULTS  
**Attachments:** TWP ANIWA ARSENIC WELL RESULTS.pdf; ANIWA SOILS 2020.pdf

TAUREN: HERE ARE THE 2020 ARSENIC WELL RESULTS. ALSO GOT BACK THE SOILS DONE EARLIER. ALL LESS THAN 5.0 MG/L. HAVE TO UPDATE MY MAP YET.I THINK WE NOW HAVE THE AREA DEFINED. WARREN

2020 Arsenic (Town of  
Water Results Aniwa Arsenic  
5/15/20 Dump)

Well #	Dpth to Water	Top of Well (ft.)	GSHT (ft.)	As (ug/L)
B-12	10.24'	99.64'	87.24'	610.0
B-13R	11.24'	99.28'	88.04'	1900.00
B-13 Dup	11.24'	99.28'	88.04'	1900.00
B-21	6.50'	93.67'	87.17'	2.80

6/11/20

Well #	Dpth to Water (ft.)	Top of Well (ft.)	GSHT (ft.)	As ug/L
B-10	6.40'	96.64'	90.24'	ND
B-11	10.56'	99.77'	89.21'	ND
B-12	9.32'	97.64'	88.32'	560.0
B-13R	10.48'	99.28'	88.80'	1100.0*
B-13 DupL	10.48'	99.28'	88.80'	1200.0*
B-19	10.87'	98.12'	87.25'	ND
B-20	9.16'	97.70'	88.54'	ND
B-21	6.00'	93.67'	87.67'	5.20'
Timm Well				3.4

ND = LOD - Limit of Detection = 2.6 ug/L

\* Lower than expected / GSHT levels -  
retested on 7-6-20 (possibly a dilution problem)

Well #	Dpth to Water (ft.)	Top of Well (ft.)	GSHT (ft.)	As (ug/L)
B-13R	10.42'	99.28'	88.86'	4900.0
B-13 DupL	10.42'	99.28'	88.86'	4600.0

\* Appear more what was expected

Wanda A. Nohr (Sampled by)

Client: Township of Aniwa  
 Attn: Warren Hohn  
 1201 Lake St  
 Merrill, WI 54452

NLS Project: 347298

NLS Customer: 104168

Fax: 715 536 1277 Phone: 715 551 9080

Project: Aniwa Arsenic DWP

**B-12 NLS ID: 1196111**

COC: 243344:1 Matrix: GW  
 Collected: 05/15/20 11:09 Received: 06/30/20

Parameter	Result	Units	Dilution	LOD	LOQ	Analyzed	Method	Lab
Arsenic, dis. as As by ICP-MS	670	ug/L	1	2.6	8.6	07/05/20	EPA 200.8, Rev 5.4	721026460
Metals digestion - dissolved ICP-MS	yes					07/04/20	EPA 200.8, Rev 5.4	721026460

**B-13r NLS ID: 1196112**

COC: 243344:2 Matrix: GW  
 Collected: 05/15/20 11:45 Received: 06/30/20

Parameter	Result	Units	Dilution	LOD	LOQ	Analyzed	Method	Lab
Arsenic, dis. as As by ICP-MS	1900	ug/L	1	2.6	8.6	07/05/20	EPA 200.8, Rev 5.4	721026460
Metals digestion - dissolved ICP-MS	yes					07/04/20	EPA 200.8, Rev 5.4	721026460

**B-13r dupl NLS ID: 1196113**

COC: 243344:3 Matrix: GW  
 Collected: 05/15/20 11:50 Received: 06/30/20

Parameter	Result	Units	Dilution	LOD	LOQ	Analyzed	Method	Lab
Arsenic, dis. as As by ICP-MS	1900	ug/L	1	2.6	8.6	07/05/20	EPA 200.8, Rev 5.4	721026460
Metals digestion - dissolved ICP-MS	yes					07/04/20	EPA 200.8, Rev 5.4	721026460

**B-21 NLS ID: 1196114**

COC: 243344:4 Matrix: GW  
 Collected: 05/15/20 11:00 Received: 06/30/20

Parameter	Result	Units	Dilution	LOD	LOQ	Analyzed	Method	Lab
Arsenic, dis. as As by ICP-MS	[2.8]	ug/L	1	2.6	8.6	07/05/20	EPA 200.8, Rev 5.4	721026460
Metals digestion - dissolved ICP-MS	yes					07/04/20	EPA 200.8, Rev 5.4	721026460

**Timm Well NLS ID: 1196115**

COC: 243344:5 Matrix: GW  
 Collected: 05/15/20 10:45 Received: 06/30/20

Parameter	Result	Units	Dilution	LOD	LOQ	Analyzed	Method	Lab
Arsenic, dis. as As by ICP-MS	[3.4]	ug/L	1	2.6	8.6	07/05/20	EPA 200.8, Rev 5.4	721026460
Metals digestion - dissolved ICP-MS	yes					07/04/20	EPA 200.8, Rev 5.4	721026460

**B-10 NLS ID: 1196116**

COC: 243344:6 Matrix: GW  
 Collected: 06/11/20 14:15 Received: 06/30/20

Parameter	Result	Units	Dilution	LOD	LOQ	Analyzed	Method	Lab
Arsenic, dis. as As by ICP-MS	ND	ug/L	1	2.6	8.6	07/05/20	EPA 200.8, Rev 5.4	721026460
Metals digestion - dissolved ICP-MS	yes					07/04/20	EPA 200.8, Rev 5.4	721026460

**B-11 NLS ID: 1196117**

COC: 243344:7 Matrix: GW  
 Collected: 06/11/20 14:30 Received: 06/30/20

Parameter	Result	Units	Dilution	LOD	LOQ	Analyzed	Method	Lab
Arsenic, dis. as As by ICP-MS	ND	ug/L	1	2.6	8.6	07/05/20	EPA 200.8, Rev 5.4	721026460
Metals digestion - dissolved ICP-MS	yes					07/04/20	EPA 200.8, Rev 5.4	721026460

# ANALYTICAL REPORT

**NORTHERN LAKE SERVICE, INC.**  
 Analytical Laboratory and Environmental Services  
 400 North Lake Avenue - Crandon, WI 54520  
 Ph: (715)-478-2777 Fax: (715)-478-3060

WDNR Laboratory ID No. 721026460  
 WDATCP Laboratory Certification No. 105-330  
 EPA Laboratory ID No. WI00034

Printed: 07/09/20 Page 2 of 3

NLS Project: 347298

NLS Customer: 104168

Fax: 715 536 1277 Phone: 715 551 9080

**Client:** Township of Aniwa  
 Attn: Warren Hohn  
 1201 Lake St  
 Merrill, WI 54452

**Project:** Aniwa Arsenic DWP

**B-12 NLS ID: 1196118**

COC: 243344:8 Matrix: GW

Collected: 06/11/20 15:45 Received: 06/30/20

Parameter	Result	Units	Dilution	LOD	LOQ	Analyzed	Method	Lab
Arsenic, dis. as As by ICP-MS	560	ug/L	1	2.6	8.6	07/05/20	EPA 200.8, Rev 5.4	721026460
Metals digestion - dissolved ICP-MS	yes					07/04/20	EPA 200.8, Rev 5.4	721026460

**B-13R NLS ID: 1196119**

COC: 243344:9 Matrix: GW

Collected: 06/11/20 17:05 Received: 06/30/20

Parameter	Result	Units	Dilution	LOD	LOQ	Analyzed	Method	Lab
Arsenic, dis. as As by ICP-MS	1100	ug/L	1	2.6	8.6	07/05/20	EPA 200.8, Rev 5.4	721026460
Metals digestion - dissolved ICP-MS	yes					07/04/20	EPA 200.8, Rev 5.4	721026460

**B-13 dupl NLS ID: 1196120**

COC: 243344:10 Matrix: GW

Collected: 06/11/20 17:20 Received: 06/30/20

Parameter	Result	Units	Dilution	LOD	LOQ	Analyzed	Method	Lab
Arsenic, dis. as As by ICP-MS	1200	ug/L	1	2.6	8.6	07/05/20	EPA 200.8, Rev 5.4	721026460
Metals digestion - dissolved ICP-MS	yes					07/04/20	EPA 200.8, Rev 5.4	721026460

**B-19 NLS ID: 1196121**

COC: 243345:1 Matrix: GW

Collected: 06/11/20 15:05 Received: 06/30/20

Parameter	Result	Units	Dilution	LOD	LOQ	Analyzed	Method	Lab
Arsenic, dis. as As by ICP-MS	ND	ug/L	1	2.6	8.6	07/05/20	EPA 200.8, Rev 5.4	721026460
Metals digestion - dissolved ICP-MS	yes					07/04/20	EPA 200.8, Rev 5.4	721026460

**B-20 NLS ID: 1196122**

COC: 243345:2 Matrix: GW

Collected: 06/11/20 15:20 Received: 06/30/20

Parameter	Result	Units	Dilution	LOD	LOQ	Analyzed	Method	Lab
Arsenic, dis. as As by ICP-MS	ND	ug/L	1	2.6	8.6	07/05/20	EPA 200.8, Rev 5.4	721026460
Metals digestion - dissolved ICP-MS	yes					07/04/20	EPA 200.8, Rev 5.4	721026460

**B-21 NLS ID: 1196123**

COC: 243345:3 Matrix: GW

Collected: 06/11/20 16:00 Received: 06/30/20

Parameter	Result	Units	Dilution	LOD	LOQ	Analyzed	Method	Lab
Arsenic, dis. as As by ICP-MS	[5.2]	ug/L	1	2.6	8.6	07/05/20	EPA 200.8, Rev 5.4	721026460
Metals digestion - dissolved ICP-MS	yes					07/04/20	EPA 200.8, Rev 5.4	721026460

**Blank NLS ID: 1196124**

COC: 243345:4 Matrix: GW

Collected: 06/11/20 18:00 Received: 06/30/20

Parameter	Result	Units	Dilution	LOD	LOQ	Analyzed	Method	Lab
Arsenic, dis. as As by ICP-MS	ND	ug/L	1	2.6	8.6	07/05/20	EPA 200.8, Rev 5.4	721026460
Metals digestion - dissolved ICP-MS	yes					07/04/20	EPA 200.8, Rev 5.4	721026460

# ANALYTICAL REPORT

NORTHERN LAKE SERVICE, INC.  
Analytical Laboratory and Environmental Services  
400 North Lake Avenue - Crandon, WI 54520  
Ph: (715)-478-2777 Fax: (715)-478-3060

WDNR Laboratory ID No. 721026460  
WDATCP Laboratory Certification No. 105-330  
EPA Laboratory ID No. WI00034

Printed: 08/12/20 Page 1 of 1

NLS Project: 349121

NLS Customer: 104168

Fax: 715 536 1277 Phone: 715 551 9080

Client: Township of Aniwa  
Attn: Warren Hohn  
1201 Lake St  
Merrill, WI 54452

Project: Arsenic Dump

**B-13R NLS ID: 1201796**

COC: 242634:1 Matrix: GW

Collected: 07/06/20 10:10 Received: 07/24/20

Parameter	Result	Units	Dilution	LOD	LOQ	Analyzed	Method	Lab
Arsenic, dis. as As by ICP-MS	4900	ug/L	1	2.6	8.6	08/11/20	EPA 200.8, Rev 5.4	721026460
Metals digestion - dissolved ICP-MS	yes					08/08/20	EPA 200.8, Rev 5.4	721026460

**B-13R Dup 1 NLS ID: 1201797**

COC: 242634:2 Matrix: GW

Collected: 07/06/20 10:30 Received: 07/24/20

Parameter	Result	Units	Dilution	LOD	LOQ	Analyzed	Method	Lab
Arsenic, dis. as As by ICP-MS	4600	ug/L	1	2.6	8.6	08/11/20	EPA 200.8, Rev 5.4	721026460
Metals digestion - dissolved ICP-MS	yes					08/08/20	EPA 200.8, Rev 5.4	721026460

Values in brackets represent results greater than or equal to the LOD but less than the LOQ and are within a region of "Less-Certain Quantitation". Results greater than or equal to the LOQ are considered to be in the region of "Certain Quantitation". LOD and/or LOQ tagged with an asterisk(\*) are considered Reporting Limits. All LOD/LOQs adjusted to reflect dilution and/or solids content.

ND = Not Detected (< LOD) LOD = Limit of Detection LOQ = Limit of Quantitation NA = Not Applicable

DWB = Dry Weight Basis %DWB = (mg/kg DWB) / 10000 1000 ug/L = 1 mg/L

MCL = Maximum Contaminant Levels for Drinking Water Samples. Shaded results indicate >MCL.

Reviewed by:



Authorized by:  
R. T. Krueger  
President



# ANALYTICAL REPORT

NORTHERN LAKE SERVICE, INC.  
Analytical Laboratory and Environmental Services  
400 North Lake Avenue - Crandon, WI 54520  
Ph: (715)-478-2777 Fax: (715)-478-3060

WDNR Laboratory ID No. 721026460  
WDATCP Laboratory Certification No. 105-330  
EPA Laboratory ID No. WI00034

Printed: 07/09/20 Page 3 of 3

NLS Project: 347298

NLS Customer: 104168

Fax: 715 536 1277 Phone: 715 551 9080

Client: Township of Aniwa  
Attn: Warren Hohn  
1201 Lake St  
Merrill, WI 54452

Project: Aniwa Arsenic DWP

Values in brackets represent results greater than or equal to the LOD but less than the LOQ and are within a region of "Less-Certain Quantitation". Results greater than or equal to the LOQ are considered to be in the region of "Certain Quantitation". LOD and/or LOQ tagged with an asterisk(\*) are considered Reporting Limits. All LOD/LOQs adjusted to reflect dilution and/or solids content.

ND = Not Detected (< LOD) LOD = Limit of Detection LOQ = Limit of Quantitation NA = Not Applicable

DWB = Dry Weight Basis %DWB = (mg/kg DWB) / 10000 1000 ug/L = 1 mg/L

MCL = Maximum Contaminant Levels for Drinking Water Samples. Shaded results indicate >MCL.

Reviewed by:



Authorized by:  
R. T. Krueger  
President

August 17, 2020

Warren Hohn  
Township of Aniwa  
1201 Lake Street  
Merrill, WI 54452

RE: Project: ARSENIC DUMP  
Pace Project No.: 40212233

Dear Warren Hohn:

Enclosed are the analytical results for sample(s) received by the laboratory on August 04, 2020. The results relate only to the samples included in this report. Results reported herein conform to the applicable TNI/NELAC Standards and the laboratory's Quality Manual, where applicable, unless otherwise noted in the body of the report.

The test results provided in this final report were generated by each of the following laboratories within the Pace Network:

- Pace Analytical Services - Green Bay

If you have any questions concerning this report, please feel free to contact me.

Sincerely,

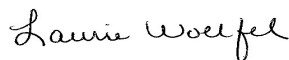

Laurie Woelfel  
laurie.woelfel@pacelabs.com  
(920)469-2436  
Project Manager

Enclosures



## REPORT OF LABORATORY ANALYSIS

This report shall not be reproduced, except in full,  
without the written consent of Pace Analytical Services, LLC.

## CERTIFICATIONS

Project: ARSENIC DUMP

Pace Project No.: 40212233

---

### **Pace Analytical Services Green Bay**

1241 Bellevue Street, Green Bay, WI 54302

Florida/NELAP Certification #: E87948

Illinois Certification #: 200050

Kentucky UST Certification #: 82

Louisiana Certification #: 04168

Minnesota Certification #: 055-999-334

New York Certification #: 12064

North Dakota Certification #: R-150

Virginia VELAP ID: 460263

South Carolina Certification #: 83006001

Texas Certification #: T104704529-14-1

Wisconsin Certification #: 405132750

Wisconsin DATCP Certification #: 105-444

USDA Soil Permit #: P330-16-00157

Federal Fish & Wildlife Permit #: LE51774A-0

---

## REPORT OF LABORATORY ANALYSIS

This report shall not be reproduced, except in full,  
without the written consent of Pace Analytical Services, LLC.

## SAMPLE SUMMARY

Project: ARSENIC DUMP

Pace Project No.: 40212233

---

Lab ID	Sample ID	Matrix	Date Collected	Date Received
40212233001	B-13 10:00 AM	Solid	06/11/20 10:00	08/04/20 09:50
40212233002	B-14 10:15 AM	Solid	06/11/20 10:15	08/04/20 09:50
40212233003	B-15 10:35 AM	Solid	06/11/20 10:35	08/04/20 09:50
40212233004	B-16 11:00 AM	Solid	06/11/20 11:00	08/04/20 09:50
40212233005	B-18 11:20 AM	Solid	06/11/20 11:20	08/04/20 09:50
40212233006	B-19 11:36 AM	Solid	06/11/20 11:36	08/04/20 09:50
40212233007	B-20 12:05 PM	Solid	06/11/20 12:05	08/04/20 09:50
40212233008	B-21 1:00 PM	Solid	06/11/20 13:00	08/04/20 09:50
40212233009	B-22 1:30 PM	Solid	06/11/20 13:30	08/04/20 09:50
40212233010	B-23 2:05 PM	Solid	06/11/20 14:05	08/04/20 09:50
40212233011	B-24 2:15 PM	Solid	06/11/20 14:15	08/04/20 09:50

## REPORT OF LABORATORY ANALYSIS

This report shall not be reproduced, except in full,  
without the written consent of Pace Analytical Services, LLC.

### SAMPLE ANALYTE COUNT

Project: ARSENIC DUMP  
Pace Project No.: 40212233

Lab ID	Sample ID	Method	Analysts	Analytes Reported	Laboratory
40212233001	B-13 10:00 AM	EPA 6010	TXW	1	PASI-G
		ASTM D2974-87	MMX	1	PASI-G
40212233002	B-14 10:15 AM	EPA 6010	TXW	1	PASI-G
		ASTM D2974-87	MMX	1	PASI-G
40212233003	B-15 10:35 AM	EPA 6010	TXW	1	PASI-G
		ASTM D2974-87	MMX	1	PASI-G
40212233004	B-16 11:00 AM	EPA 6010	TXW	1	PASI-G
		ASTM D2974-87	MMX	1	PASI-G
40212233005	B-18 11:20 AM	EPA 6010	TXW	1	PASI-G
		ASTM D2974-87	MMX	1	PASI-G
40212233006	B-19 11:36 AM	EPA 6010	TXW	1	PASI-G
		ASTM D2974-87	MMX	1	PASI-G
40212233007	B-20 12:05 PM	EPA 6010	TXW	1	PASI-G
		ASTM D2974-87	MMX	1	PASI-G
40212233008	B-21 1:00 PM	EPA 6010	TXW	1	PASI-G
		ASTM D2974-87	MMX	1	PASI-G
40212233009	B-22 1:30 PM	EPA 6010	TXW	1	PASI-G
		ASTM D2974-87	MMX	1	PASI-G
40212233010	B-23 2:05 PM	EPA 6010	TXW	1	PASI-G
		ASTM D2974-87	MMX	1	PASI-G
40212233011	B-24 2:15 PM	EPA 6010	TXW	1	PASI-G
		ASTM D2974-87	MMX	1	PASI-G

PASI-G = Pace Analytical Services - Green Bay

### REPORT OF LABORATORY ANALYSIS

This report shall not be reproduced, except in full,  
without the written consent of Pace Analytical Services, LLC.

### ANALYTICAL RESULTS

Project: ARSENIC DUMP  
Pace Project No.: 40212233

**Sample: B-13 10:00 AM**      **Lab ID: 40212233001**      Collected: 06/11/20 10:00      Received: 08/04/20 09:50      Matrix: Solid  
*Results reported on a "dry weight" basis and are adjusted for percent moisture, sample size and any dilutions.*

Parameters	Results	Units	LOQ	LOD	DF	Prepared	Analyzed	CAS No.	Qual
<b>6010 MET ICP</b>	Analytical Method: EPA 6010    Preparation Method: EPA 3050 Pace Analytical Services - Green Bay								
Arsenic	<b>2.6J</b>	mg/kg	5.8	1.7	1	08/11/20 06:34	08/11/20 17:43	7440-38-2	
<b>Percent Moisture</b>	Analytical Method: ASTM D2974-87 Pace Analytical Services - Green Bay								
Percent Moisture	<b>19.5</b>	%	0.10	0.10	1		08/14/20 16:17		

**Sample: B-14 10:15 AM**      **Lab ID: 40212233002**      Collected: 06/11/20 10:15      Received: 08/04/20 09:50      Matrix: Solid  
*Results reported on a "dry weight" basis and are adjusted for percent moisture, sample size and any dilutions.*

Parameters	Results	Units	LOQ	LOD	DF	Prepared	Analyzed	CAS No.	Qual
<b>6010 MET ICP</b>	Analytical Method: EPA 6010    Preparation Method: EPA 3050 Pace Analytical Services - Green Bay								
Arsenic	<b>4.9J</b>	mg/kg	5.9	1.8	1	08/11/20 06:34	08/11/20 17:45	7440-38-2	
<b>Percent Moisture</b>	Analytical Method: ASTM D2974-87 Pace Analytical Services - Green Bay								
Percent Moisture	<b>20.1</b>	%	0.10	0.10	1		08/14/20 16:17		

**Sample: B-15 10:35 AM**      **Lab ID: 40212233003**      Collected: 06/11/20 10:35      Received: 08/04/20 09:50      Matrix: Solid  
*Results reported on a "dry weight" basis and are adjusted for percent moisture, sample size and any dilutions.*

Parameters	Results	Units	LOQ	LOD	DF	Prepared	Analyzed	CAS No.	Qual
<b>6010 MET ICP</b>	Analytical Method: EPA 6010    Preparation Method: EPA 3050 Pace Analytical Services - Green Bay								
Arsenic	<b>&lt;1.7</b>	mg/kg	5.6	1.7	1	08/11/20 06:34	08/11/20 17:48	7440-38-2	
<b>Percent Moisture</b>	Analytical Method: ASTM D2974-87 Pace Analytical Services - Green Bay								
Percent Moisture	<b>18.8</b>	%	0.10	0.10	1		08/14/20 16:17		

### REPORT OF LABORATORY ANALYSIS

This report shall not be reproduced, except in full,  
without the written consent of Pace Analytical Services, LLC.

### ANALYTICAL RESULTS

Project: ARSENIC DUMP  
Pace Project No.: 40212233

**Sample: B-16 11:00 AM**      **Lab ID: 40212233004**      Collected: 06/11/20 11:00      Received: 08/04/20 09:50      Matrix: Solid  
*Results reported on a "dry weight" basis and are adjusted for percent moisture, sample size and any dilutions.*

Parameters	Results	Units	LOQ	LOD	DF	Prepared	Analyzed	CAS No.	Qual
<b>6010 MET ICP</b>	Analytical Method: EPA 6010    Preparation Method: EPA 3050 Pace Analytical Services - Green Bay								
Arsenic	<b>3.8J</b>	mg/kg	5.6	1.7	1	08/11/20 06:34	08/11/20 17:50	7440-38-2	
<b>Percent Moisture</b>	Analytical Method: ASTM D2974-87 Pace Analytical Services - Green Bay								
Percent Moisture	<b>16.4</b>	%	0.10	0.10	1		08/14/20 16:17		

**Sample: B-18 11:20 AM**      **Lab ID: 40212233005**      Collected: 06/11/20 11:20      Received: 08/04/20 09:50      Matrix: Solid  
*Results reported on a "dry weight" basis and are adjusted for percent moisture, sample size and any dilutions.*

Parameters	Results	Units	LOQ	LOD	DF	Prepared	Analyzed	CAS No.	Qual
<b>6010 MET ICP</b>	Analytical Method: EPA 6010    Preparation Method: EPA 3050 Pace Analytical Services - Green Bay								
Arsenic	<b>2.2J</b>	mg/kg	5.8	1.7	1	08/11/20 06:34	08/11/20 17:53	7440-38-2	
<b>Percent Moisture</b>	Analytical Method: ASTM D2974-87 Pace Analytical Services - Green Bay								
Percent Moisture	<b>17.4</b>	%	0.10	0.10	1		08/14/20 16:17		

**Sample: B-19 11:36 AM**      **Lab ID: 40212233006**      Collected: 06/11/20 11:36      Received: 08/04/20 09:50      Matrix: Solid  
*Results reported on a "dry weight" basis and are adjusted for percent moisture, sample size and any dilutions.*

Parameters	Results	Units	LOQ	LOD	DF	Prepared	Analyzed	CAS No.	Qual
<b>6010 MET ICP</b>	Analytical Method: EPA 6010    Preparation Method: EPA 3050 Pace Analytical Services - Green Bay								
Arsenic	<b>&lt;1.7</b>	mg/kg	5.8	1.7	1	08/11/20 06:34	08/11/20 17:55	7440-38-2	
<b>Percent Moisture</b>	Analytical Method: ASTM D2974-87 Pace Analytical Services - Green Bay								
Percent Moisture	<b>16.8</b>	%	0.10	0.10	1		08/14/20 16:17		

### REPORT OF LABORATORY ANALYSIS

This report shall not be reproduced, except in full,  
without the written consent of Pace Analytical Services, LLC.

### ANALYTICAL RESULTS

Project: ARSENIC DUMP  
Pace Project No.: 40212233

**Sample: B-20 12:05 PM**      **Lab ID: 40212233007**      Collected: 06/11/20 12:05      Received: 08/04/20 09:50      Matrix: Solid  
*Results reported on a "dry weight" basis and are adjusted for percent moisture, sample size and any dilutions.*

Parameters	Results	Units	LOQ	LOD	DF	Prepared	Analyzed	CAS No.	Qual
<b>6010 MET ICP</b>	Analytical Method: EPA 6010    Preparation Method: EPA 3050 Pace Analytical Services - Green Bay								
Arsenic	<b>2.3J</b>	mg/kg	6.4	1.9	1	08/11/20 06:34	08/11/20 17:57	7440-38-2	
<b>Percent Moisture</b>	Analytical Method: ASTM D2974-87 Pace Analytical Services - Green Bay								
Percent Moisture	<b>28.8</b>	%	0.10	0.10	1		08/14/20 16:17		

**Sample: B-21 1:00 PM**      **Lab ID: 40212233008**      Collected: 06/11/20 13:00      Received: 08/04/20 09:50      Matrix: Solid  
*Results reported on a "dry weight" basis and are adjusted for percent moisture, sample size and any dilutions.*

Parameters	Results	Units	LOQ	LOD	DF	Prepared	Analyzed	CAS No.	Qual
<b>6010 MET ICP</b>	Analytical Method: EPA 6010    Preparation Method: EPA 3050 Pace Analytical Services - Green Bay								
Arsenic	<b>&lt;1.7</b>	mg/kg	5.7	1.7	1	08/11/20 06:34	08/11/20 18:00	7440-38-2	
<b>Percent Moisture</b>	Analytical Method: ASTM D2974-87 Pace Analytical Services - Green Bay								
Percent Moisture	<b>17.7</b>	%	0.10	0.10	1		08/14/20 16:17		

**Sample: B-22 1:30 PM**      **Lab ID: 40212233009**      Collected: 06/11/20 13:30      Received: 08/04/20 09:50      Matrix: Solid  
*Results reported on a "dry weight" basis and are adjusted for percent moisture, sample size and any dilutions.*

Parameters	Results	Units	LOQ	LOD	DF	Prepared	Analyzed	CAS No.	Qual
<b>6010 MET ICP</b>	Analytical Method: EPA 6010    Preparation Method: EPA 3050 Pace Analytical Services - Green Bay								
Arsenic	<b>4.4J</b>	mg/kg	5.7	1.7	1	08/11/20 06:34	08/11/20 18:02	7440-38-2	
<b>Percent Moisture</b>	Analytical Method: ASTM D2974-87 Pace Analytical Services - Green Bay								
Percent Moisture	<b>20.2</b>	%	0.10	0.10	1		08/14/20 16:17		

### REPORT OF LABORATORY ANALYSIS

This report shall not be reproduced, except in full,  
without the written consent of Pace Analytical Services, LLC.



### ANALYTICAL RESULTS

Project: ARSENIC DUMP  
Pace Project No.: 40212233

**Sample: B-23 2:05 PM**      **Lab ID: 40212233010**      Collected: 06/11/20 14:05      Received: 08/04/20 09:50      Matrix: Solid  
*Results reported on a "dry weight" basis and are adjusted for percent moisture, sample size and any dilutions.*

Parameters	Results	Units	LOQ	LOD	DF	Prepared	Analyzed	CAS No.	Qual
<b>6010 MET ICP</b>	Analytical Method: EPA 6010    Preparation Method: EPA 3050 Pace Analytical Services - Green Bay								
Arsenic	<1.7	mg/kg	5.8	1.7	1	08/11/20 06:34	08/11/20 18:05	7440-38-2	
<b>Percent Moisture</b>	Analytical Method: ASTM D2974-87 Pace Analytical Services - Green Bay								
Percent Moisture	<b>20.8</b>	%	0.10	0.10	1		08/14/20 16:17		

**Sample: B-24 2:15 PM**      **Lab ID: 40212233011**      Collected: 06/11/20 14:15      Received: 08/04/20 09:50      Matrix: Solid  
*Results reported on a "dry weight" basis and are adjusted for percent moisture, sample size and any dilutions.*

Parameters	Results	Units	LOQ	LOD	DF	Prepared	Analyzed	CAS No.	Qual
<b>6010 MET ICP</b>	Analytical Method: EPA 6010    Preparation Method: EPA 3050 Pace Analytical Services - Green Bay								
Arsenic	<1.7	mg/kg	5.5	1.7	1	08/11/20 06:34	08/11/20 18:12	7440-38-2	
<b>Percent Moisture</b>	Analytical Method: ASTM D2974-87 Pace Analytical Services - Green Bay								
Percent Moisture	<b>19.0</b>	%	0.10	0.10	1		08/14/20 16:17		

### REPORT OF LABORATORY ANALYSIS

This report shall not be reproduced, except in full,  
without the written consent of Pace Analytical Services, LLC.

### QUALITY CONTROL DATA

Project: ARSENIC DUMP

Pace Project No.: 40212233

QC Batch:	362203	Analysis Method:	EPA 6010
QC Batch Method:	EPA 3050	Analysis Description:	6010 MET
		Laboratory:	Pace Analytical Services - Green Bay

Associated Lab Samples: 40212233001, 40212233002, 40212233003, 40212233004, 40212233005, 40212233006, 40212233007, 40212233008, 40212233009, 40212233010, 40212233011

METHOD BLANK: 2093595 Matrix: Solid

Associated Lab Samples: 40212233001, 40212233002, 40212233003, 40212233004, 40212233005, 40212233006, 40212233007, 40212233008, 40212233009, 40212233010, 40212233011

Parameter	Units	Blank Result	Reporting Limit	Analyzed	Qualifiers
Arsenic	mg/kg	<1.5	4.9	08/11/20 17:14	

LABORATORY CONTROL SAMPLE: 2093596

Parameter	Units	Spike Conc.	LCS Result	LCS % Rec	% Rec Limits	Qualifiers
Arsenic	mg/kg	50	49.8	100	80-120	

MATRIX SPIKE & MATRIX SPIKE DUPLICATE: 2093597 2093598

Parameter	Units	40212272006		MS		MSD		MS		MSD		% Rec Limits	Max RPD	Qual
		Result	MS Spike Conc.	MSD Spike Conc.	MS Result	MSD Result	MS % Rec	MSD % Rec						
Arsenic	mg/kg	<2.4	82.5	82.2	79.6	81.5	94	97	75-125	2	20			

Results presented on this page are in the units indicated by the "Units" column except where an alternate unit is presented to the right of the result.

### REPORT OF LABORATORY ANALYSIS

This report shall not be reproduced, except in full,  
without the written consent of Pace Analytical Services, LLC.

### QUALITY CONTROL DATA

Project: ARSENIC DUMP

Pace Project No.: 40212233

QC Batch: 363025

Analysis Method: ASTM D2974-87

QC Batch Method: ASTM D2974-87

Analysis Description: Dry Weight/Percent Moisture

Laboratory: Pace Analytical Services - Green Bay

Associated Lab Samples: 40212233001, 40212233002, 40212233003, 40212233004, 40212233005, 40212233006, 40212233007, 40212233008, 40212233009, 40212233010, 40212233011

SAMPLE DUPLICATE: 2098846

Parameter	Units	40212907001 Result	Dup Result	RPD	Max RPD	Qualifiers
Percent Moisture	%	5.1	5.1	0	10	

Results presented on this page are in the units indicated by the "Units" column except where an alternate unit is presented to the right of the result.

### REPORT OF LABORATORY ANALYSIS

This report shall not be reproduced, except in full,  
without the written consent of Pace Analytical Services, LLC.

## QUALIFIERS

Project: ARSENIC DUMP  
Pace Project No.: 40212233

---

### DEFINITIONS

DF - Dilution Factor, if reported, represents the factor applied to the reported data due to dilution of the sample aliquot.

ND - Not Detected at or above LOD.

J - Estimated concentration at or above the LOD and below the LOQ.

LOD - Limit of Detection adjusted for dilution factor, percent moisture, initial weight and final volume.

LOQ - Limit of Quantitation adjusted for dilution factor, percent moisture, initial weight and final volume.

S - Surrogate

1,2-Diphenylhydrazine decomposes to and cannot be separated from Azobenzene using Method 8270. The result for each analyte is a combined concentration.

Consistent with EPA guidelines, unrounded data are displayed and have been used to calculate % recovery and RPD values.

LCS(D) - Laboratory Control Sample (Duplicate)

MS(D) - Matrix Spike (Duplicate)

DUP - Sample Duplicate

RPD - Relative Percent Difference

NC - Not Calculable.

SG - Silica Gel - Clean-Up

U - Indicates the compound was analyzed for, but not detected at or above the adjusted LOD.

N-Nitrosodiphenylamine decomposes and cannot be separated from Diphenylamine using Method 8270. The result reported for each analyte is a combined concentration.

Pace Analytical is TNI accredited. Contact your Pace PM for the current list of accredited analytes.

TNI - The NELAC Institute.

## REPORT OF LABORATORY ANALYSIS

This report shall not be reproduced, except in full,  
without the written consent of Pace Analytical Services, LLC.

### QUALITY CONTROL DATA CROSS REFERENCE TABLE

Project: ARSENIC DUMP

Pace Project No.: 40212233

Lab ID	Sample ID	QC Batch Method	QC Batch	Analytical Method	Analytical Batch
40212233001	B-13 10:00 AM	EPA 3050	362203	EPA 6010	362666
40212233002	B-14 10:15 AM	EPA 3050	362203	EPA 6010	362666
40212233003	B-15 10:35 AM	EPA 3050	362203	EPA 6010	362666
40212233004	B-16 11:00 AM	EPA 3050	362203	EPA 6010	362666
40212233005	B-18 11:20 AM	EPA 3050	362203	EPA 6010	362666
40212233006	B-19 11:36 AM	EPA 3050	362203	EPA 6010	362666
40212233007	B-20 12:05 PM	EPA 3050	362203	EPA 6010	362666
40212233008	B-21 1:00 PM	EPA 3050	362203	EPA 6010	362666
40212233009	B-22 1:30 PM	EPA 3050	362203	EPA 6010	362666
40212233010	B-23 2:05 PM	EPA 3050	362203	EPA 6010	362666
40212233011	B-24 2:15 PM	EPA 3050	362203	EPA 6010	362666
40212233001	B-13 10:00 AM	ASTM D2974-87	363025		
40212233002	B-14 10:15 AM	ASTM D2974-87	363025		
40212233003	B-15 10:35 AM	ASTM D2974-87	363025		
40212233004	B-16 11:00 AM	ASTM D2974-87	363025		
40212233005	B-18 11:20 AM	ASTM D2974-87	363025		
40212233006	B-19 11:36 AM	ASTM D2974-87	363025		
40212233007	B-20 12:05 PM	ASTM D2974-87	363025		
40212233008	B-21 1:00 PM	ASTM D2974-87	363025		
40212233009	B-22 1:30 PM	ASTM D2974-87	363025		
40212233010	B-23 2:05 PM	ASTM D2974-87	363025		
40212233011	B-24 2:15 PM	ASTM D2974-87	363025		

### REPORT OF LABORATORY ANALYSIS

This report shall not be reproduced, except in full,  
without the written consent of Pace Analytical Services, LLC.

(Please Print Clearly)

Company Name: **W-H Soil Testing**  
 Branch/Location: **TN OF ANIWA**  
 Project Contact: **Warren Hohn**  
 Phone: **715-551-9080**  
 Project Number:  
 Project Name: **ARSENIC Dump**  
 Project State:  
 Sampled By (Print): **Warren Hohn**  
 Sampled By (Sign): *Warren Hohn*  
 PO #:

**Data Package Options** (billable)  
 EPA Level III  
 EPA Level IV

**MS/MSD**  
 On your sample (billable)  
 NOT needed on your sample

**Matrix Codes**  
 A = Air W = Water  
 B = Biota DW = Drinking Water  
 C = Charcoal GW = Ground Water  
 O = Oil SW = Surface Water  
 S = Soil WW = Waste Water  
 Sl = Sludge WP = Wipe

PACE LAB #	CLIENT FIELD ID	COLLECTION		MATRIX
		DATE	TIME	
001	B-13	10:00AM	6-11 10:AM	S
002	B-14	10:15AM	6-11 10:15	S
003	B-15	10:35AM	6-11 10:35	S
004	B-16	11:00AM	6-11 11:00AM	S
005	B-18	11:20AM	6-11 11:20	S
006	B-19	11:36AM	6-11 11:36AM	S
007	B-20	12:05PM	6-11 12:05PM	S
008	B-21	1:00PM	6-11-20 1:00PM	S
009	B-22	1:30 PM	6-11-20 1:30PM	S
010	B-23	2:05 PM	6-11-20 2:05PM	S
011	B-24	2:15 pm	6-11-20 DilS	S



40212233  
 my new email - warren.hohn.4919@gmail.com

### CHAIN OF CUSTODY

**Preservation Codes**  
 A=None B=HCL C=H2SO4 D=HNO3 E=DI Water F=Methanol G=NaOH  
 H=Sodium Bisulfate Solution I=Sodium Thiosulfate J=Other

FILTERED? (YES/NO)  
 PRESERVATION (CODE)\*

Y/N	Pick Letter	Analysis Requested
N	None (A)	Arsenic Soil

**Quote #:**  
**Mail To Contact:** Warren Hohn  
**Mail To Company:** W-H Soil Testing  
**Mail To Address:** 1201 Lake St  
 Merrill, WI 54452  
**Invoice To Contact:** TN OF ANIWA  
**Invoice To Company:** c/o T Army Resch  
**Invoice To Address:** PO Box 52  
 N 90485 Cherry Rd.  
 Burnhamwood, WI 54414  
**Invoice To Phone:** 715-449-2351  
**CLIENT COMMENTS**  
**LAB COMMENTS (Lab Use Only)**  
**Profile #**

Rush Turnaround Time Requested - Prelims (Rush TAT subject to approval/surcharge)  
 Date Needed:  
 Transmit Prelim Rush Results by (complete what you want):  
 Email #1:  
 Email #2:  
 Telephone: **715-551-9080**  
 Fax: **715-536-1277**  
 Samples on HOLD are subject to special pricing and release of liability

Relinquished By: *Warren A. Hohn* Date/Time: **2:30 PM 8/2/20**  
 Relinquished By: *Fedex* Date/Time: **8/4/20 0950**  
 Relinquished By: \_\_\_\_\_ Date/Time: \_\_\_\_\_  
 Relinquished By: \_\_\_\_\_ Date/Time: \_\_\_\_\_

Received By: \_\_\_\_\_ Date/Time: \_\_\_\_\_  
 Received By: *M. J. [Signature]* Date/Time: **8/4/20 0950**  
 Received By: \_\_\_\_\_ Date/Time: \_\_\_\_\_  
 Received By: \_\_\_\_\_ Date/Time: \_\_\_\_\_

PACE Project No.  
 Receipt Temp = **4/25** °C  
 Sample Receipt pH  
 OK / Adjusted  
 Cooler Custody Seal  
 Present / Not Present  
 Intact / Not Intact



40212233

Shawano County Home Page    FAQ    Employment    Contact Us

Font Size: a a a    Search

HOME PAGE

**Municipalities » Aniwa**

[« Back](#)

DEPARTMENTS

Town meetings: 2nd Monday May - Sept. at 8:00 p.m. and Oct. - Mar at 7:30 p.m. Annual meeting: 3rd Tuesday in April at 7:30 p.m. at the town hall, W17712 County Road Z, Birnamwood, WI 54414

SERVICES

COUNTY BOARD

**Chairman**  
Dan Lex  
Phone: 715-449-2114  
  
N10750 Sugarbush Rd  
Birnamwood 54414-8618  
[Map](#)

COMMITTEES

MINUTES & AGENDAS

NEWS & ANNOUNCEMENTS

**Supervisor #1**  
Robert Sippl  
Phone: 715-449-2738

COUNTY CALENDAR

FORMS & DOCUMENTS

N11491 Bluebird Ln  
Birnamwood, WI 54414  
[Map](#)

LINKS

**Supervisor #2**  
Dale Matsche  
Phone: 715-449-2680

MUNICIPALITIES

ONLINE SERVICES

N9906 White Birch Ln  
Birnamwood, WI 54414  
[Map](#)

**Clerk**  
Tammy Resch  
Phone: 715-449-2351 (work) or 715-449-3116 (home)

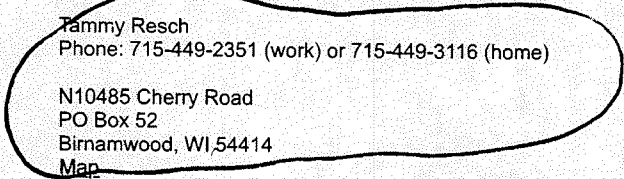

N10485 Cherry Road  
PO Box 52  
Birnamwood, WI 54414  
[Map](#)

INVOICE to :

**Treasurer**  
Ken Schram  
Phone: 715-449-2817  
[Click here to email](#)

N11961 Summer St  
Aniwa WI 54408-9709  
[Map](#)

**Assessor**  
Jeremy Kurtzweil  
Phone: 715-486-9019  
[Click here to email](#)

1501 N Hume Ave.  
Marshfield WI 54499  
[Map](#)

Sampled by Warner A. Hohn  
warrenhohn 4919@gmail.com  
715-551-9080 cell  
715-536-1277 office + fax





 1241 Bellevue Street, Green Bay, WI 54302	Document Name: <b>Sample Condition Upon Receipt (SCUR)</b>	Document Revised: 26Mar2020
	Document No.: <b>ENV-FRM-GBAY-0014-Rev.00</b>	Author: Pace Green Bay Quality Office

### Sample Condition Upon Receipt Form (SCUR)

Client Name: W-H Soil Testing Project #: \_\_\_\_\_

Courier:  CS Logistics  Fed Ex  Speedee  UPS  Waltco  
 Client  Pace Other: \_\_\_\_\_

Tracking #: 1751 3260 2557

Custody Seal on Cooler/Box Present:  yes  no Seals intact:  yes  no  
 Custody Seal on Samples Present:  yes  no Seals intact:  yes  no  
 Packing Material:  Bubble Wrap  Bubble Bags  None  Other \_\_\_\_\_  
 Thermometer Used SR - NA Type of Ice:  Wet  Blue Dry None  Samples on ice, cooling process has begun  
 Cooler Temperature Uncorr: pot /Corr: \_\_\_\_\_

Temp Blank Present:  yes  no Biological Tissue is Frozen:  yes  no

Temp should be above freezing to 6°C.  
 Biota Samples may be received at ≤ 0°C if shipped on Dry Ice.

**WO# : 40212233**

  
 40212233

Person examining contents:  
 Date: 8/4/20 /Initials: MP  
 Labeled By Initials: SRK

Chain of Custody Present: <input checked="" type="checkbox"/> Yes <input type="checkbox"/> No <input type="checkbox"/> N/A	1.
Chain of Custody Filled Out: <input type="checkbox"/> Yes <input checked="" type="checkbox"/> No <input type="checkbox"/> N/A	2. <u>Pr # , Pr State , Pg#</u> <u>8/4/20</u>
Chain of Custody Relinquished: <input checked="" type="checkbox"/> Yes <input type="checkbox"/> No <input type="checkbox"/> N/A	3.
Sampler Name & Signature on COC: <input checked="" type="checkbox"/> Yes <input type="checkbox"/> No <input type="checkbox"/> N/A	4.
Samples Arrived within Hold Time: <input checked="" type="checkbox"/> Yes <input type="checkbox"/> No	5.
- VOA Samples frozen upon receipt <input type="checkbox"/> Yes <input type="checkbox"/> No	Date/Time:
Short Hold Time Analysis (<72hr): <input type="checkbox"/> Yes <input checked="" type="checkbox"/> No	6.
Rush Turn Around Time Requested: <input type="checkbox"/> Yes <input checked="" type="checkbox"/> No	7.
Sufficient Volume: <input checked="" type="checkbox"/> Yes <input type="checkbox"/> No MS/MSD: <input type="checkbox"/> Yes <input checked="" type="checkbox"/> No <input type="checkbox"/> N/A	8.
Correct Containers Used: <input checked="" type="checkbox"/> Yes <input type="checkbox"/> No	9.
-Pace Containers Used: <input checked="" type="checkbox"/> Yes <input type="checkbox"/> No <input type="checkbox"/> N/A	
-Pace IR Containers Used: <input type="checkbox"/> Yes <input type="checkbox"/> No <input checked="" type="checkbox"/> N/A	
Containers Intact: <input checked="" type="checkbox"/> Yes <input type="checkbox"/> No	10.
Filtered volume received for Dissolved tests <input type="checkbox"/> Yes <input type="checkbox"/> No <input checked="" type="checkbox"/> N/A	11.
Sample Labels match COC: <input checked="" type="checkbox"/> Yes <input type="checkbox"/> No <input type="checkbox"/> N/A	12.
-Includes date/time/ID/Analysis Matrix: <u>S</u>	
Trip Blank Present: <input type="checkbox"/> Yes <input checked="" type="checkbox"/> No <input type="checkbox"/> N/A	13.
Trip Blank Custody Seals Present <input type="checkbox"/> Yes <input type="checkbox"/> No <input checked="" type="checkbox"/> N/A	
Pace Trip Blank Lot # (if purchased): _____	

Client Notification/ Resolution: \_\_\_\_\_ If checked, see attached form for additional comments

Person Contacted: \_\_\_\_\_ Date/Time: \_\_\_\_\_

Comments/ Resolution: \_\_\_\_\_