



Contamination Detected TCE
02-44-000267

Environmental and Geological
Scientists and Engineers

www.sand-creek.com

November 17, 2006

WI Dept. of Natural Resources
Attn: Mr. Chuck Weister
107 Sutliff Avenue
Rhineland, WI 54501

Dear Mr. Weister:

RE: Groundwater Sampling Results
SITE: Draeger Oil, 1742 Superior Street, Three Lakes, WI

On November 2, 2006, I went to the Draeger Oil site in Three Lakes to collect groundwater samples from monitoring wells MW-1 and MW-2, as discussed in email correspondence with you dated October 13, 25, and 26, 2006. Following is a summary of the work.

Depth to groundwater in MW-1 was 29.15 feet on 11/2/06. The well construction report for MW-1 indicates the total well depth is 33 feet, which is what I measured on the day of sampling. Five gallons of groundwater were removed from MW-1 using a bailer. The water was slightly turbid. A VOC sample was collected following bailing of the well. The sample was immediately placed on ice and was shipped to CT Laboratories in Baraboo, WI, for analysis.

Laboratory results indicate 2.8 ug/L of tetrachloroethene was detected in the groundwater sample collected from MW-1. Tetrachloroethene was not detected in the trip blank. The laboratory report is attached to this letter.

MW-2 could not be sampled. A bailer appeared to be stuck in the well about 8" below the top of the PVC pipe and appeared to be frozen in place. Attempts to dislodge the bailer were unsuccessful.

Thank you for contacting Sand Creek Consultants, Inc. to perform this work. Please do not hesitate to call if we can be of further assistance.

Sincerely,
SAND CREEK CONSULTANTS, INC.

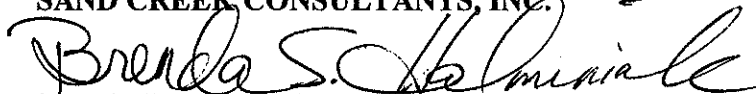
Brenda S. Halminiak, P.G.
Project Manager

Enc.

03-44-0010696
0

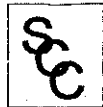

SAND CREEK CONSULTANTS, INC.
ENVIRONMENTAL AND GEOLOGICAL SCIENTISTS
P.O. Box 1512, RHINELANDER, WI 54501

MEMO

to: Bob Herubin, NRP
Norm Dunbar, WDNR
Laurel Sukup, COMM, Rhinelander
Bob Warren, SCC
Ben Bonack, Three Lakes Gas Company

re: Three Lakes PCE Ground Water Contamination

date: October 29, 1997

+ Chuck FITZ
FYI

Last week I was working on our Three Lakes Standard Station ground water and soil data. I compiled the ground water data from three sources:

- SCCs recent (fall, '97) ground water sampling of 9 monitoring wells on the former Standard Station
- NRPs 1995 ground water data from 4 monitoring wells installed on the Drager Amoco Property
- WDNR data from three private potable wells along Huffman Street, collected by Chuck Fitzgerald in 1992.

Since these data were collected over a 5 year period, the map that arises from the data is more of a compilation than a snapshot of current conditions.

The plotted data is attached. I know there have been questions lately on the distribution of PCE in this part of Three Lakes, and I think this map provides some useful insight into the spatial distribution of PCE in the area.

From the desk of...

Christopher J. Rog
Sr. Hydrogeologist
Sand Creek Consultants, Inc.
150 S. Stevens Street
P.O. Box 1512
Rhinelander, WI 54501

(715)365-1818
Fax: (715)365-1819
e-mail: chrisr@newnorth.net

MAPLE LAKE



PCE IN GROUND WATER (IN PPB) compilation of GW data from 1993 - 1997

APPROXIMATE EXTENT
OF PCE PLUME WITH
CONCENTRATIONS
> ENFORCEMENT STANDARD
(>5PPB)

FORMER SODER POTABLE WELL
BENZENE 56 PPB
EDB 3.6 PPB
TCE, PCE, ND
(abandoned in 1993)



FORMER LEONHARDT POTABLE WELL
BENZENE 1 PPB
EDB 2.1 PPB
TCE 34 PPB
(abandoned in 1993)



FORMER PETERSON POTABLE WELL
BENZENE 54 PPB
EDB 5.1 PPB
TCE, PCE, ND
(abandoned in 1993)

PETERSON RESIDENCE



2 PCE



SECURITY BUNKER

5 PCE

ANDERSON STREET



3 PCE

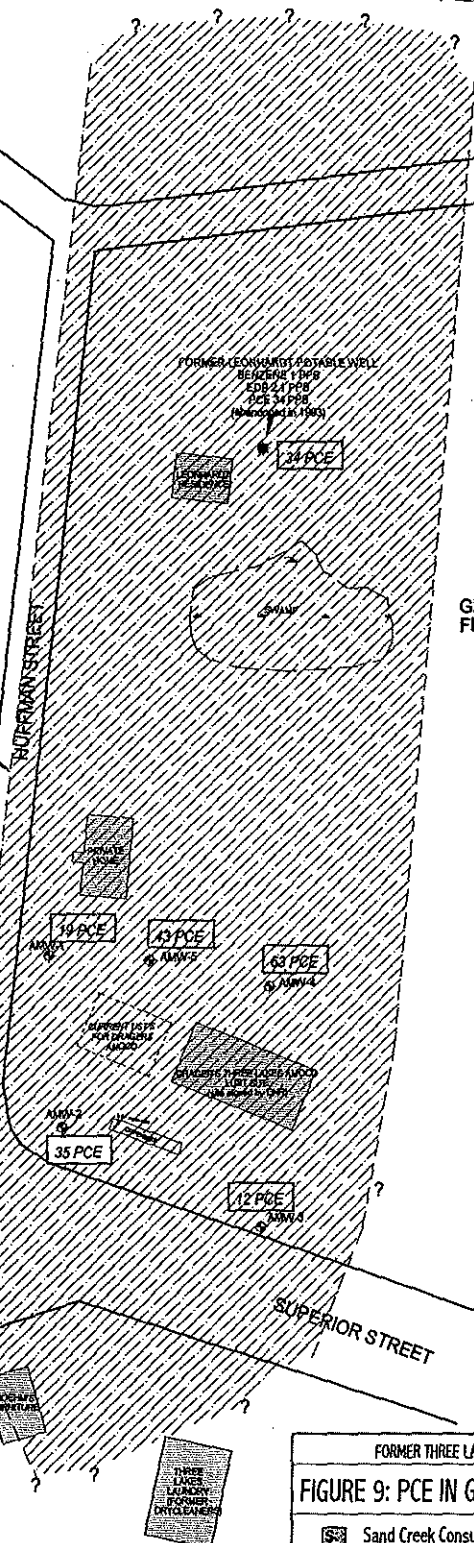

GROUND WATER
FLOW DIRECTION



FORMER THREE LAKES STANDARD

FIGURE 9: PCE IN GROUND WATER

Sand Creek Consultants, Inc.
Environmental & Geological Scientists, Riverdale, IL

Draw 1097